

ADDENDUM

PROJECT: DOT-200009 Putnam County FSMF

DATE: 02/28/2025

ADDENDUM NO.: 2

PROJECT: 240652

This addendum must be receipted for on the proposal form.

TO ALL BIDDERS:

This addendum supplements and amends the original drawings and project manual and shall be taken into account in preparing proposals and shall become a part of the contract document.

NOTE: Addenda are issued via Bid Express. Each Prime Contractor is responsible for notifying subcontractors of any addenda issue.

Item #1 Specification Section 03 30 00 Cast-in-Place Concrete

- Substitution Request: Floor Joint Filler by Euclid Chemical, 19215 Redwood Road, Cleveland, OH 44110, Ph. 800-321-7628, www.euclidchemical.com, is an acceptable manufacturer.

Item #2 Specification Section 04 20 00 Unit Masonry

- RFI: Spec 042000, part 2.1, A, 4 provide IWR repellent, clarify if this only applies to exterior exposed units to the elements or shall all CMU require IWR for this project.
 - Response: All concrete block in exterior walls and around Wash Bay shall have IWR repellent. Other locations are not required to have IWR repellent.
- RFI: The masonry spec 042000 part 2.1, A, indicated standard CMU and IWR additive during the manufacturing process, 2.1, B, indicates HI-R CMU (Omni Block). Within the wall type description tag on A2.2, there is no indication of using HI-R CMU (Omni Block) for the exterior walls. Sheet A2.0 under the second column, walls metal exterior and Concrete Block, Maintenance and Wash Bay indicates CMU at these locations and not the HI-R CMU (Omni Block) The Omni block only applies at the Brine shelter. Within the door schedule sheet A7.1 for doors 118D, 119B, 120C, 121B, 127A, 128B, and 128D they have jamb details J5, J7, and J8 indicating 8" Concrete block wall foam insulation cores, which I interpret as the Omni Block. Clarify the jamb description at these doors that are requiring an insulated CMU.
 - Response: HI-R CMU is only located at the Brine Shelter exterior walls. The door jambs in these walls are the only one's needing core insulation.

Item #3 Specification Section 08 11 16 Aluminum Doors and Frames, 08 51 13 Aluminum Windows

- RFI: The specs for the Storefront/FRP/Windows have Capitol Aluminum as basis of design for everything. The finish is called out as Powder Coat Paint with manufactures full range of standard colors. Capitol does not offer Powder Coat. They are happy to price material only if it can be Clear or Dark Bronze Anodize. Is this acceptable?
 - Response: Per Capital Aluminum & Glass Corp, 08 11 16 Aluminum Doors (500 WS) are available in "painted finishes", FRP Doors (4900) shall be provided with "custom color paint", Windows listed in 08 51 13 windows (325SS) are available in "painted finishes".

Item #4 Specification Section 08 71 00 Door Hardware

- Substitution Request: BEST cylinder locksets, Dormakaba USA, Inc., 6161 E. 75th St, Indianapolis, IN, Ph 1-800-711-6814, are an acceptable manufacturer for cylinder locksets.
- Clarification: All Yale cores shall be for cylindrical locksets (not mortis as listed). Model number TBD.

Item #5 Specification Section 09 51 00 Acoustical Ceilings

- RFI: Refer to the finish schedule page A1.1 – There are ceiling tile types as C1, C2, and C8. In the

spec section 095100 item 2.5A you have types C1 and C9. C9 is a drywall ceiling according to the finish schedule on A1.1. Can we get ceiling tile types for C1, C2, and C8?

- Response: C1 and C2 are specified as USG: Aspen Item 650, Armstrong: Cortega Tengular Item 704, and CertainTeed: Performa Baroque Item BET-154. C8 shall be USG: Radar Item 2220, Armstrong: Fine Fissured Item 1717, and CertainTeed: Fine Fissured Item HHF-154.
- RFI: In spec section 095100 item 2.4E calls for fire rated grid. Are there any areas that require fire rated ceilings? If so what ceiling tile is to be used for those areas?
 - Response: There are no fire rated ceiling tiles or grid required in this project.

Item #6 Specification Section 10 75 00 Flagpoles

- RFI: Refer to the Flagpole spec under “Manufacturer”. The model number does not meet the specifications you give. Please revise. The model number you give is: “Independence”, winch, 30’ tall, .188” wall, 6” base 1 piece flagpole
 - Response: Revise part 1.5.A 1), so the model number should read “Independent Series – Model IRW40D71-ACL” to align with the flagpole description listed elsewhere in the spec.

Item #7 Specification Section 10 21 13 Toilet Partitions

- Substitution Request: Hadrian Inc.Solid Polymer Toilet Partitions, 7420 Clover Ave, Mentor, Ohio 44060, Ph : 440-942-9118, www.hadrian-inc.com, are an acceptable manufacturer.

Item #8 Specification Section 13 31 23 Tension Fabric Structures

- Substitution Request: Calhoun Superstructures complying with all requirements of the specifications is an acceptable manufacturer.

Item #9 Specification Section 14 45 00 Vehicle Lifts

- Under Part 2, only vertical scissor lifts will acceptable, parallelogram lifts will not be acceptable.
- Omit Part 2.2.A.1)i) If needed: Lift platforms and legs shall be galvanized for wash bay applications.
- Omit Part 2.2.A.1)j) Lift shall have automatic pit covers.

Item #10 Specification Section 26 32 13 Packaged Engine Generators

- Substitution Request: MTU Generators meeting the specifications are an acceptable manufacturer.
- Under part 2.1.H.1)a)[1], change “400 AMP” to “600AMP”
- Under part 1.2.H. 1), Rehlko which acquired Kohler is approved.

Item #11 Specification Section 32 12 16 Asphalt Paving

- RFI: In the asphalt specs there is a section in there regarding placing Paving Geotextile Fabric prior to paving. Are we to include this geotextile fabric? This is not called out on the asphalt details that are shown in the plans
 - Response: Part 3.6 Paving Geotextile Installation is not applicable to this project. This specification pertains to mill and overlay restoration of deteriorated existing pavement. Paving geotextile fabric is not to be included.

Item #12 Specification Section 33 30 00 Sanitary Sewers

- RFI: Are the joints of the HDPE storm supposed to be soil or water tight? I’ve seen both in the plans and specs.
 - Response: The HDPE storm is supposed to be soil-tight, please disregard references to water-tight. All HDPE sanitary pipe joints need to be water tight.

Item #13 Specification Section 33 56 13 Aboveground Fuel-Storage Tanks

- RFI: It appears that the written specification calls out a UL 142 Flameshield Tank, but then it contradicts it with a UL 2085 Fireguard Tank later in the spec. Which should I be quoting?
 - Response: Under parts 2.6.A.1) a) and 4.2.A. 1) and 3) change “Fireguard” to Flameshield”.This tank is a UL 142 Flameshield tank as clearly indicated in this specification section.

Item #14 Sheet TS1

- Revision: Updated Index of Sheets

Item #15 Sheet C0.0

- Revision: Updated Index of Sheets

Item #16 Sheet C0.1

- RFI: Will surplus spoils need to be exported from the site or can the soil stock pile be made larger?
 - Response: Surplus spoils shall be stock piled just north of construction as noted on the grading plans.
- RFI: The specs say the A/E will take care of the testing for the storm and sanitary (611). Can you verify if we are responsible for any of the 611 spec?
 - Response: A/E will pay for the first 611 inspection. The general contractor will be responsible for the cost of any alterations required to make work conforming and all re-inspections.
- RFI: Can we directionally bore the waterline at SR 109?
 - Response: Directional bore installation of the waterline at SR 109 is acceptable but it will need to be permitted through ODOT and performed according to their guidelines.

Item #17 Sheet C2.0

- RFI: On sheet S1.4, detail C1.4/S3.4 shows 8" concrete at the Brine tanks with 4x4-W4.0XW4.0 WWF on 8" of 304. On sheet C2.0, that area is indicated as Heavy Duty Concrete Pavement. The Heavy Duty Concrete Pavement detail on sheet C0.2 shows 6x6-W2.9XW2.9 WWF on 6" of 304. Which detail should be used for that area?
 - Response: Use detail C1.4/S3.4 for slab supporting the brine tanks.

Item #18 Sheet C3.0

- RFI: The waterline is called out as C-900. Village of Ottawa spec is C-909. Please verify which is required.
 - Response: C-909 should be used as required by the Village of Ottawa.
- RFI: Would HDPE be acceptable for the 2" force main?
 - Response: 2" DR11 PE pipe is acceptable for the force main.

Item #19 Sheet C3.1

- RFI: Sheet C3.1 - structure 16 which is a clean out is 15" pipe flow line. Are we to reduce to a typical 6" cleanout or place a catch basin?
 - Response: Our intent was to reduce to a 6" clean-out.

Item #20 Sheet C3.2

- Revision: Sanitary MH #14 removed, 8" gravity sewer segment Q removed, force main extended to existing sanitary MH #18

Item #21 Sheet C3.6

- Revision: Sanitary MH #14 removed, 8" gravity sewer segment Q removed, force main extended to existing sanitary MH #18

Item #22 Sheet C4.2

- Revision: This sheet added to capture northern portion of stockpile grading limits

Item #23 Sheet C4.3

- Revision: This sheet re-numbered, previously sheet C4.2

Item #24 Sheet C4.4

- Revision: This sheet re-numbered, previously sheet C4.3

Item #25 Sheet C5.2

- Revision: This sheet added to capture northern portion of stockpile grading limits

Item #26 Sheet C5.3

- Revision: This sheet re-numbered, previously sheet C5.2

Item #27 Sheet A2.2

- RFI: According to the room finish schedule, Room 118 Truck Storage receives liner panels on the west and east walls only but on the floor plan the north and south walls are Wall Type 1 which also gets liner panels. Please confirm which walls receive the liner panels.
 - Response: Wall type 1 doesn't include liner panels. Wall type 1* includes liner panels. The liner panels are location on the east and west walls of the truck storage where the room meets the office and mechanical services bay. The liner panel will continue horizontally to the next PEMB column as soon on the floor plan.
- RFI: In the wall legend on A2.2 there is talk of this continuous water shield. Can you tell me what material this is supposed to be or tell me where to find it in the specs?
 - Response: Flashing should be similar to the rubber asphalt sheet flashing listed in 04 20 00 Unit Masonry under part 2.4.A.2 and 2.4.B.1. The flashing should be laid down before the bottom track is installed and then folded up the wall framing at least 7" on both sides.

Item #28 Sheet A2.3

- RFI: On sheet A2.3, detail D2.3 is surface mounted bollards. In the Northwest corner of the building where these go it calls for 2 guard rails to be mounted to them. Please provide that detail. Also, will the guardrail mount over the PVC pipe cover or should the whole assembly be painted yellow?
 - Response: Omit the guardrail called out between bollards at Cold Storage Building.

Item #29 Sheet A6.3

- RFI: I do not see any downspout connection details on the plans. Are the downspout fittings to be SDR36 or SDR35 or are you expecting just to keep with HDPE all the way to the downspout?
 - Response: The bottom of the downspout shall be connected to the storm pipe with a HDPE connector fitting.

Item #30 Sheet A7.3

- RFI: Refer to details J5 and J9 on A7.3 – both of these call for Foam Insulate Cores. We cannot find any spec for this nor is any of the other block called to have foam. Please clarify.
 - Response: Foam insulated cores are not required. Omit this note from the details.

Item #31 Sheet S0.1

- Clarification: Rebar suppliers are not required to be ODOT certified.
- RFI: Just to be clear with the Epoxy Rebar/Wire-Mesh schedule on drawing S0.1, is all of the reinforcing required for the Wash Bay to be epoxy coated or just the slab on grade reinforcing? Would this include the grade beam reinforcing and masonry or can those be uncoated bars?
 - Response: Epoxy rebar and epoxy wire mesh only required in the slab on grade including the aprons.
- RFI: Plans show that all concrete slabs are reinforced in the top half of the slab, is that correct?
 - Response: G.C. to supply chairs for rebar as specified.

Item #32 Sheet S2.2

- RFI: Sheet S2.2 detail A2.2, this indicates the plank bearing to be 753.14' and a dimension stating 18' from FF. The elevation 753.14 is 17'6" from FF, clarify if the plank bearing height should be 753.64'.
 - Response: Elev. 653.64' is correct which is 18' above f/fl. 735.64'
- RFI: Sheet S2.2 detail B2.2 this indicates the plank bearing to be 755.47' and a dimension stating 20'4" from FF. Clarify if the plank bearing elevation should be 755.97'.
 - Response: Elev. 655.97' is correct which is 20'-4" above f/fl. 735.64'

- RFI: Similarly, the vertical rebar schedule on sheet S2.2 detail A2.2, B2.2. C2.2 call for #5 @ 2' OC, sheet S1.2 requires all the wash bay walls to have a vertical rebar schedule of #5 @ 2'8" OC, clarify the vertical rebar schedule.
 - Response: #5 @ 32" o/c is correct

Item #33 Sheet S3.4

- RFI: There is a conflict in the depth of stone placed underneath the Brine slab seen on C1.4/S3.4 where it shows 8" of 304 stone and D1.4/S3.4 where it shows 22" of 304 stone.
 - Response: Stone is required between the Salt Storage foundation footing and the top of the brine slab. The stone then can taper to 8" thickness.

Item #34 Sheet FP2.2

- RFI: Sheet FP2.2 mentions corrosion resistant sprinkler heads, piping and hangers in the wash bay area. Can we get a more specific spec on type of pipe, hanger material and sprinkler heads?
 - Response: Piping and fittings shall be galvanized. Sprinkler head shall be UL and FM Approved as corrosion resistant. Hangers shall be zinc plated.

Attachments:

Revised Sheet TS1
Revised Sheet C0.0
Revised Sheet C0.1
Revised Sheet C3.0
Revised Sheet C3.1
Revised Sheet C3.2
Revised Sheet C3.6
New Sheet C4.2
Renumbered Sheet C4.3
Renumbered Sheet C4.4
New Sheet C5.2
Renumbered Sheet C5.3

END OF ADDENDUM No. 2

PUTNAM COUNTY FSM FACILITY FOR OHIO DEPARTMENT OF TRANSPORTATION

PREPARED FOR
OHIO DEPARTMENT OF TRANSPORTATION
PUTNAM COUNTY, OHIO

9979 SR 109, VILLAGE OF OTTAWA,
COUNTY OF PUTNAM, AND STATE OF OHIO

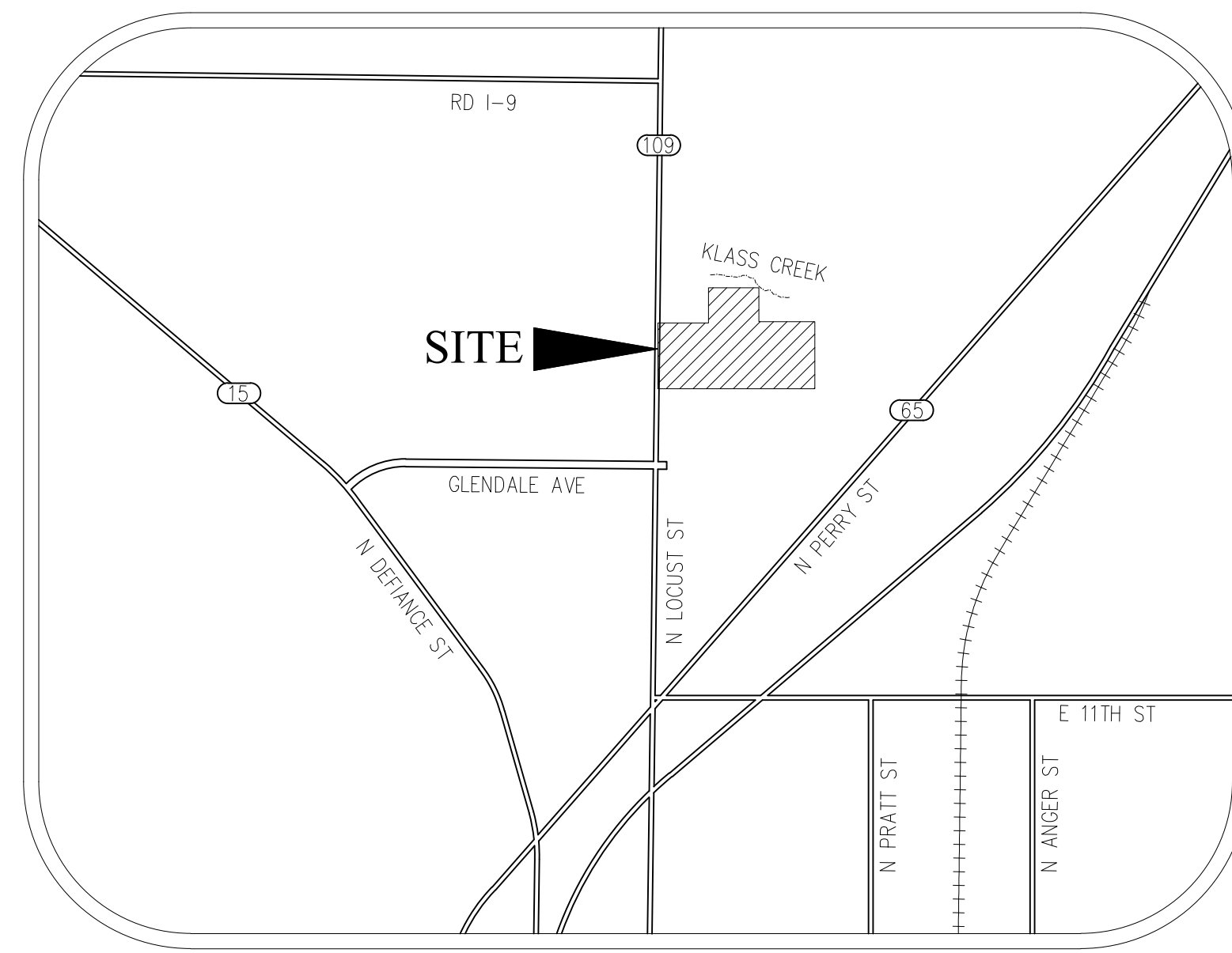

VICINITY MAP
NOT TO SCALE

STANDARD ODOT DETAILS

STANDARD DRAWING NUMBER	ITEM DESCRIPTION
CB 2-3	CATCH BASIN 2-3
CB 2-4	CATCH BASIN 2-4
MH-3	MANHOLE NO.3
ODOT CB-3A	CURB INLET
HW-2.1	HALF HEIGHT HEADWALL

APPROVALS

SIGNATURES BELOW SIGNIFY CONCURRENCE WITH THE GENERAL PURPOSE AND LOCATION OF THE PROPOSED PROJECT. ALL TECHNICAL DETAILS REMAIN THE RESPONSIBILITY OF THE DESIGN ENGINEER PREPARING THE PLANS.

PLAN SET APPROVED BY:

VILLAGE OF OTTAWA _____ DATE _____

UTILITY CONTACTS

SANITARY SEWERS
VILLAGE OF OTTAWA
1371 DEFIANCE STREET
OTTAWA, OH 45875
CONTACT: RUSS BALES
PHONE: 419-296-0913

WATER SERVICE
VILLAGE OF OTTAWA
1972 AGNER STREET
OTTAWA, OH 45875
CONTACT: DOUG SCHROEDER
PHONE: 419-889-9323

ELECTRIC COMPANY
AEP
ONE RIVERSIDE PLAZA
COLUMBUS, OHIO 43215
CONTACT: REBEKAH BOTH
PHONE: 419-998-5103

GAS COMPANY
ENBRIDGE GAS/DOMINION ENERGY
W OHIO DIVISION
200 SOUTH CIVIC CENTER DR
COLUMBUS, OHIO 43215
CONTACT: DEBRA HASSO
PHONE: 330-664-2443

COMMUNICATIONS COMPANY
CENTURYLINK
250 W OLD WILSON BRIDGE ROAD
#130
WORTHINGTON, OHIO 43085
PHONE: 614-347-3263

COMMUNICATIONS COMPANY
SPECTRUM
205 CRYSTAL AVE
FINDLAY, OH 45840
CONTACT: GARY HILL
PHONE: 419-204-0544

COMMUNICATIONS COMPANY
GLANDORF TELEPHONE
135 S MAIN STREET
GLANDORF, OH 45848
PHONE: 419-538-6987

SANITARY LIFT STATION
VILLAGE OF OTTAWA
1371 DEFIANCE STREET
OTTAWA, OH 45875
CONTACT: RUSS BALES
PHONE: 419-296-0913

PROJECT CONTACTS

OWNER
OHIO DEPARTMENT OF TRANSPORTATION
1980 W BROAD STREET
COLUMBUS, OHIO 43223
CONTACT: SULAIMAN BAH, PE, MBA
PHONE: (614) 752-0410

ARCHITECT
BUEHRER GROUP ARCHITECTURE & ENGINEERING, INC.
314 CONANT STREET
MAUMEE, OHIO 43537
CONTACT: KENT BUEHRER, AIA, PE, F. NSPE, RCDD, LEED AP
PHONE: (419) 893-9021

CIVIL ENGINEER
THE MANNIK & SMITH GROUP, INC.
20600 CHAGRIN BOULEVARD, SUITE 500
SHAKER HEIGHTS, OH 44122
CONTACT: CHRIS COPELAND, PE
PHONE: (216) 378-1490

INDEX OF SHEETS

TITLE SHEET.....	C0.0
GENERAL NOTES.....	C0.1
GENERAL DETAILS.....	C0.2-C0.5
ROAD EXISTING CONDITIONS.....	C1.0
SITE EXISTING CONDITIONS.....	C1.1
DEMOLITION PLAN.....	C1.2
OVERALL SITE PLAN.....	C2.0
SITE PLAN.....	C2.1-C2.3
UTILITY PLAN.....	C3.0-C3.2
UTILITY PROFILES.....	C3.3-C3.6
GRADING PLAN.....	C4.0-C4.3
GRADING DETAILS.....	C4.4
STORMWATER POLLUTION PREVENTION PLAN.....	C5.0-C5.3
SWPPP NOTES & DETAILS.....	C6.0-C6.4

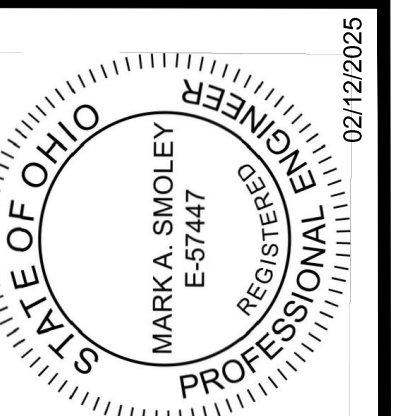

PUTNAM COUNTY FSM FACILITY
FOR
OHIO DEPARTMENT OF
TRANSPORTATION
VILLAGE OF OTTAWA, OH 45875



REVISION SCHEDULE

02/28/2025 - ADDENDUM #2

ISSUE DATE: 02/12/2025

JOB NUMBER: 240659

BID DOCUMENTS

C0.0

TITLE SHEET

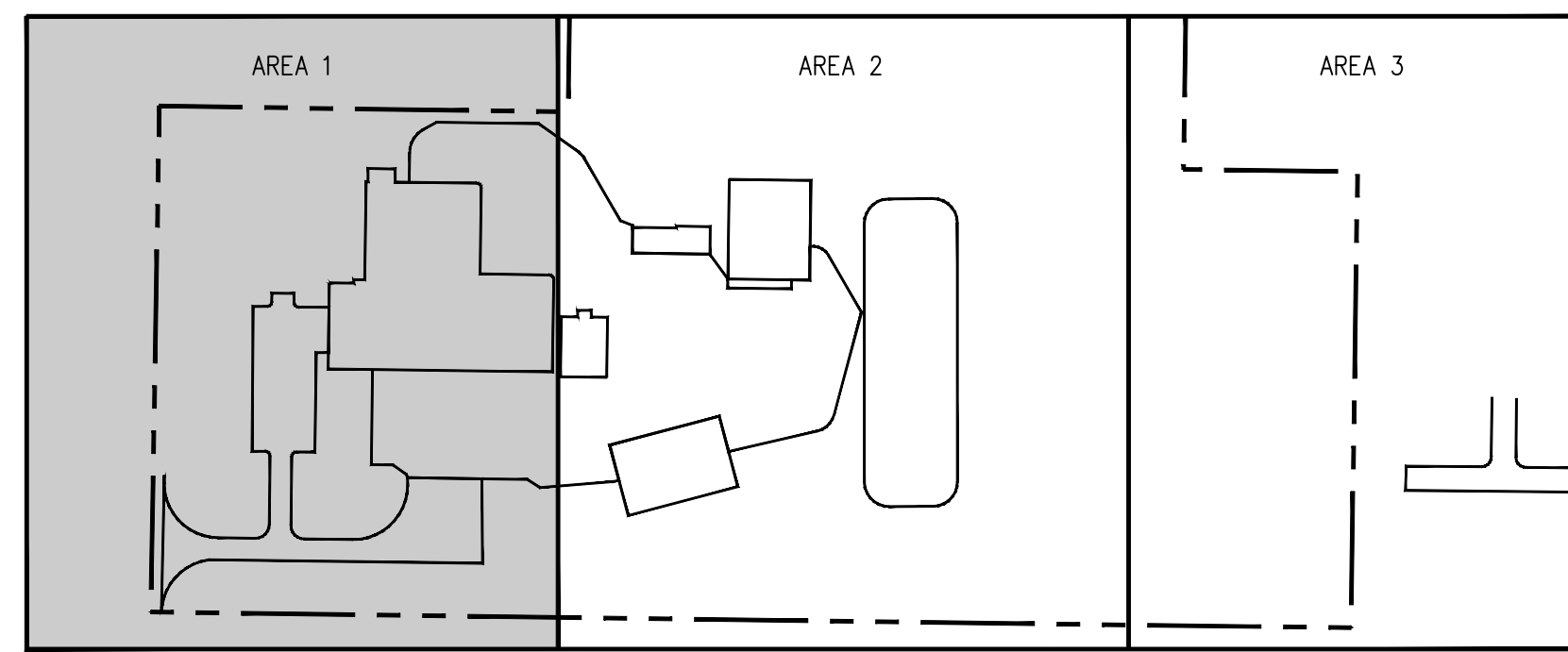
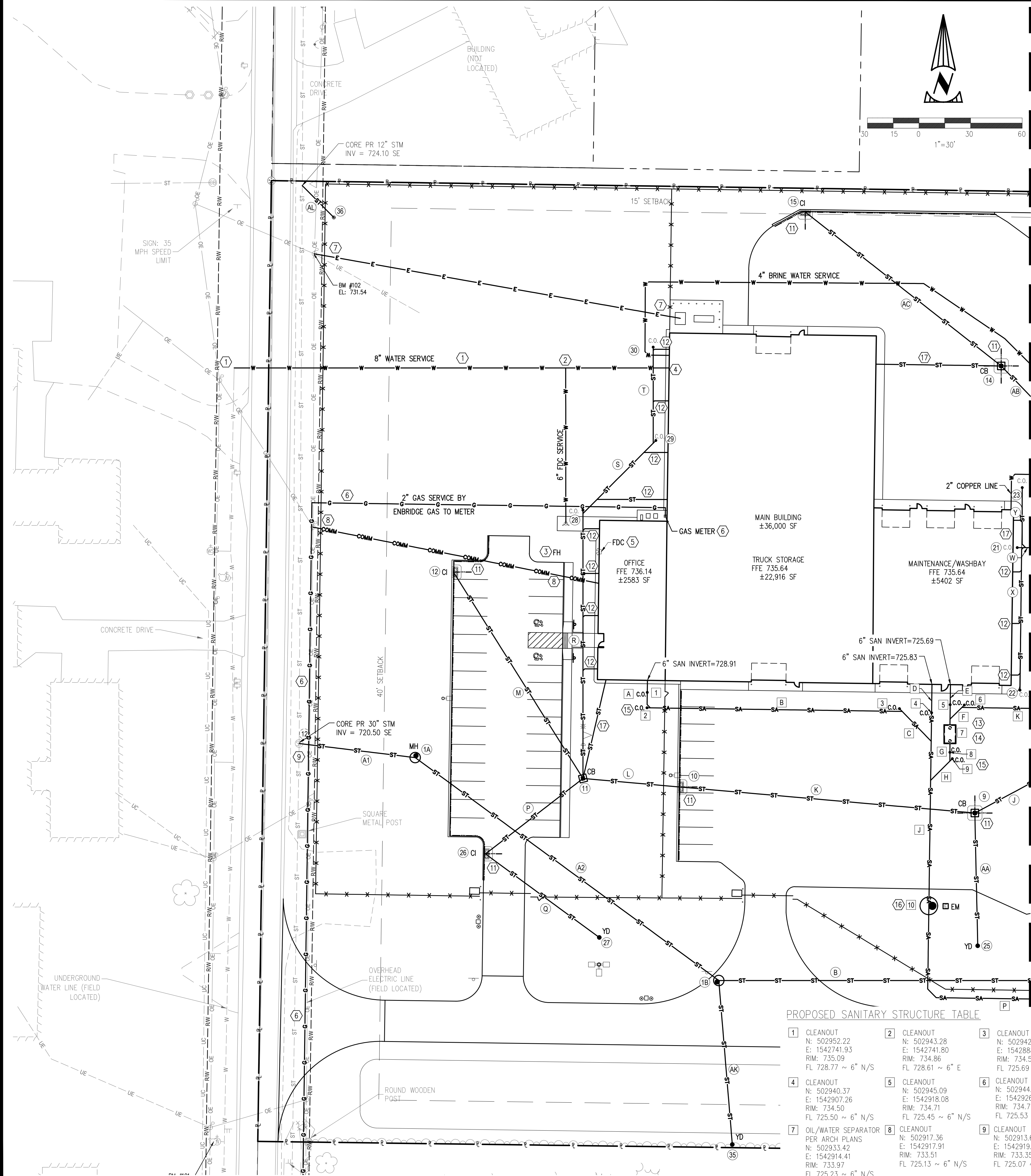

- PROPOSED UTILITIES LEGEND**
- ST STORM SEWER
 - SA SANITARY SEWER
 - W WATER LINE
 - E ELECTRIC SERVICE
 - COMM TELECOM. SERVICE
 - G GAS LINE
 - MH / MANHOLE
 - LS / LIFT STATION
 - CB / CATCH BASIN FINGER DRAINS WHERE INDICATED ON PLAN
 - CI / CURB INLET FINGER DRAINS WHERE INDICATED ON PLAN
 - YD / YARD DRAIN FINGER DRAINS WHERE INDICATED ON PLAN
 - HW / HEADWALL
 - C.O. CLEAN OUT
 - FH / FIRE HYDRANT
 - FDC / FIRE DEPARTMENT CONNECTION
 - EM / ELECTRIC METER
 - OWS / OIL WATER SEPARATOR

CODED NOTES:

- 1 CONTRACTOR SHALL COORDINATE THE SIZE AND INSTALLATION OF 8" PVC C-909 WATER SERVICE TAP AND VALVE WITH THE VILLAGE OF OTTAWA. CONTRACTOR SHALL INSTALL 8" PVC C-909 TO BUILDING. CONTRACTOR SHALL REFER TO PLUMBING DRAWINGS TO COORDINATE LOCATION OF WATER SERVICE TO THE BUILDING. CONTRACTOR SHALL PROVIDE TRAFFIC CONTROL DEVICES AND SIGNAGE PER ODOT MTS CD (MAINTAINING TRAFFIC STANDARD CONSTRUCTION DRAWINGS).
- 2 CONTRACTOR SHALL INSTALL A 8"x8"x6" TEE ON THE FIRE LINE. CONTRACTOR SHALL INSTALL A 8" DOMESTIC/FIRE LINE TO BUILDING AND 6" FIRE LINE TO HYDRANT.
- 3 CONTRACTOR SHALL INSTALL HYDRANT PER NOTES AND DETAILS.
- 4 CONTRACTOR SHALL INSTALL WALL MOUNTED POST INDICATOR VALVE PER MEP PLANS.
- 5 CONTRACTOR SHALL INSTALL WALL MOUNTED FIRE DEPARTMENT CONNECTION (FDC) PER MEP PLANS.
- 6 ENBRIDGE GAS TO EXTEND GAS MAINLINE IN THE RIGHT-OF-WAY AND INSTALL A 2" GAS SERVICE LINE TO THE GAS METER. CONTRACTOR SHALL COORDINATE WORK WITH ENBRIDGE GAS AND MEP, AND MAKE THE SERVICE LINE CONNECTION TO BUILDING. THE MAINLINE AND LATERAL ROUTE HAS BEEN SHOWN FOR INTENT AND SHALL BE THE CONTRACTOR'S RESPONSIBILITY TO CONFIRM ROUTE WITH THE GAS COMPANY.
- 7 CONTRACTOR SHALL COORDINATE AND INSTALL ELECTRIC SERVICE TO THE BUILDING AS DETAILED ON THE ELECTRICAL PLANS.
- 8 CONTRACTOR SHALL COORDINATE THE INSTALLATION OF THE COMMUNICATION SERVICES TO THE BUILDING WITH UTILITY PROVIDER AND THE ELECTRICAL PLANS.
- 9 CONTRACTOR SHALL CORE EXISTING CATCH BASIN TO RECEIVE THE PROPOSED STORM LATERALS PER UTILITY PLAN.
- 10 NOT USED.
- 11 CONTRACTOR SHALL INSTALL 4" FINGER DRAINS AT INLETS IN PAVEMENT PER DETAIL ON SHEET C0.2.
- 12 CONTRACTOR SHALL INSTALL 6" DOWNSPOUT EXTENSIONS FROM LOCATIONS SHOWN ON PLUMBING PLANS AT 1.00% MINIMUM SLOPE AND CONNECT TO PROPOSED HEADER PIPES.
- 13 CONTRACTOR SHALL INSTALL 1500 GALLON OIL INTERCEPTOR FOR FUEL ISLAND.
- 14 PLUMBING CONTRACTOR SHALL SUPPLY BOTH OIL INTERCEPTORS AND INSTALL THE BUILDING 2000 GALLON OIL INTERCEPTOR AND PIPING TO AND INCLUDING THE SANITARY CLEAN OUT.
- 15 PLUMBING CONTRACTOR SHALL SUPPLY AND INSTALL THE PIPING TO AND INCLUDING THE SANITARY CLEAN OUT.
- 16 CONTRACTOR SHALL PROVIDE AND INSTALL EXCEL LIFT STATION WITH BARNES PUMPS HEAVY DUTY WIRING AND 2" FORCE MAIN. SYSTEM SHALL BE ABLE TO HANDLE UP TO 2,600 GPD OF SANITARY FLOW FROM FACILITY. SEE SHEET C0.4 FOR DETAILS.
- 17 CONTRACTOR SHALL EXTEND FOOTER DRAIN SHOWN IN THE MEP PLANS TO THE PROPOSED STORM SEWER AS SHOWN WITH A 4" STORM PIPE AT 1% MINIMUM SLOPE.

PROPOSED STORM STRUCTURE TABLE

1A	PR ODOT MH-3 RIM = 735.49 N:502914.31 E:1542607.01 FL 720.91 ~ 30" W FL 720.96 ~ 30" SE	22	PR CLEAN OUT RIM = 735.07 N:502953.53 E:1542958.66 FL 730.20 ~ 6" N
1B	PR ODOT MH-3 RIM = 735.45 N:502784.69 E:1542783.53 FL 722.27 ~ 30" NW FL 722.32 ~ 30" E FL 732.73 ~ 12" S	23	PR CLEAN OUT RIM = 734.89 N:503071.30 E:1542959.96 FL 729.89 ~ 6" S
9	PR ODOT CB 2-4 RIM = 733.00 N:502882.09 E:1542932.41 FL 731.16 ~ 4" N/NE FL 728.40 ~ 36" NE FL 728.40 ~ 24" W FL 730.38 ~ 15" S	26	PR YARD DRAIN RIM = 735.39 N:502804.88 E:1542934.09 FL 730.75 ~ 15" N
10	PR ODOT CB-4A RIM = 733.50 N:502897.27 E:1542760.45 FL 731.66 ~ 4" N/SE FL 727.01 ~ 24" E FL 727.01 ~ 24" W	26	PR ODOT CB-3A RIM = 735.56 N:502858.31 E:1542647.85 FL 733.72 ~ 4" N/SE/W FL 729.34 ~ 15" NE FL 729.34 ~ 15" SE
11	PR ODOT CB 2-3 RIM = 736.36 N:502902.06 E:1542704.66 FL 731.50 ~ 4" NE FL 727.21 ~ 24" E FL 727.96 ~ 15" NW FL 728.98 ~ 15" SW FL 729.89 ~ 15" N	28	PR CLEANOUT RIM = 735.26 N:503058.20 E:1542704.54 FL 730.36 ~ 15" S
12	PR ODOT CB-3A RIM = 733.75 N:503022.22 E:1542629.24 FL 731.91 ~ 4" N/SE FL 728.22 ~ 15" SE	30	PR CLEAN OUT RIM = 735.41 N:503153.04 E:1542745.38 FL 730.92 ~ 6" S
14	PR ODOT CB 2-3 RIM = 733.33 N:503142.09 E:1542947.73 FL 731.13 ~ 4" N/SE/W FL 730.50 ~ 4" W FL 728.32 ~ 24" SE FL 728.82 ~ 18" NW	35	PR YARD DRAIN RIM = 737.15 N:502689.31 E:1542791.38 FL 734.65 ~ 12" N
15	PR ODOT CB-3A RIM = 734.66 N:503231.61 E:1542833.76 FL 732.81 ~ 4" S/NE FL 729.33 ~ 18" SE	36	PR YARD DRAIN RIM = 728.68 N:503228.42 E:1542559.70 FL 726.18 ~ 12" NW
21	PR CLEAN OUT RIM = 735.56 N:503036.44 E:1542957.08 FL 729.68 ~ 8" E		

GENERAL NOTES:

1. THE CONTRACTOR MUST OBTAIN A SEWER PERMIT FROM THE VILLAGE OF OTTAWA, PRIOR TO PERFORMING THE SEWER WORK.
2. TO OBTAIN A SEWER PERMIT THE CONTRACTOR MUST BE A LICENSED AND BONDED SEWER BUILDER WITH THE VILLAGE OF OTTAWA.
3. CONTRACTOR TO VERIFY INVERT OF EXISTING SEWERS PRIOR TO ORDERING STRUCTURES.
4. CONTRACTOR IS RESPONSIBLE FOR REPLACING ANY ONSITE AND OFFSITE ITEMS DAMAGED DURING CONSTRUCTION IN THE SAME OR BETTER CONDITION THAN THEY WERE PRIOR TO CONSTRUCTION.

SANITARY PIPE SCHEDULE

	LENGTH* (FT.)	DIA (IN.)	SLOPE (%)	TYPE
A	17	6	2.0	PVC SDR-26
B	148	6	2.0	PVC SDR-26
C	26	6	2.0	PVC SDR-26
D	33	6	2.0	PVC SDR-26
E	23	6	2.0	PVC SDR-26
F	12	6	2.0	PVC SDR-26
G	10	6	2.0	PVC SDR-26
H	18	6	2.0	PVC SDR-26
J	96	6	2.0	PVC SDR-26
K	105	6	1.5	PVC SDR-26
P	1342	2	N/A	PVC SDR-26

*LENGTH REFLECTS OVERALL LENGTH OF LINE FROM STRUCTURE TO STRUCTURE

PROPOSED SANITARY STRUCTURE TABLE

1	CLEANOUT N: 502952.22 E: 1542741.93 RIM: 735.09 FL 728.77 ~ 6" N/S	2	CLEANOUT N: 502943.28 E: 1542741.80 RIM: 734.86 FL 728.61 ~ 6" E	3	CLEANOUT N: 502942.76 E: 1542888.60 RIM: 734.59 FL 725.69 ~ 6" SE
4	CLEANOUT N: 502940.37 E: 1542907.26 RIM: 734.50 FL 725.50 ~ 6" N/S	5	CLEANOUT N: 502945.09 E: 1542918.08 RIM: 734.71 FL 725.45 ~ 6" N/S	6	CLEANOUT N: 502944.89 E: 1542926.35 RIM: 734.71 FL 725.53 ~ 6" SW
7	OIL/WATER SEPARATOR PER ARCH PLANS N: 502933.42 E: 1542914.41 RIM: 733.97 FL 725.23 ~ 6" N/S	8	CLEANOUT N: 502917.36 E: 1542917.91 RIM: 733.51 FL 725.13 ~ 6" N/S	9	CLEANOUT N: 502913.66 E: 1542919.35 RIM: 733.35 FL 725.07 ~ 6" SW
10	LIFT STATION SEE DETAIL N: 502827.97 E: 1542905.67 RIM: 734.11 FL 723.25 ~ 6" N FORCE MAIN 729.50 ~ 2" S				

STORM PIPE SCHEDULE

	LENGTH* (FT.)	DIA (IN.)	SLOPE (%)	TYPE
A1	68	30	0.60	HDPE
A2	219	30	0.60	HDPE
B	300	30	0.60	HDPE
J	199	36	0.18	HDPE
K	173	24	0.35	HDPE
L	56	24	0.36	HDPE
M	142	15	0.18	HDPE
P	72	15	0.50	HDPE
Q	82	15	0.50	HDPE
R	156	15	0.30	HDPE
S	60	6	0.50	HDPE
T	56	6	0.50	HDPE
W	34	8	0.50	HDPE
X	83	6	0.65	HDPE
Y	36	6	0.65	HDPE
AA	77	15	0.45	HDPE
AB	105	24	0.25	HDPE
AC	146	18	0.35	HDPE
AK	96	12	2.00	HDPE
AL	26	12	8.00	HDPE

*LENGTH REFLECTS OVERALL LENGTH OF LINE FROM STRUCTURE TO STRUCTURE

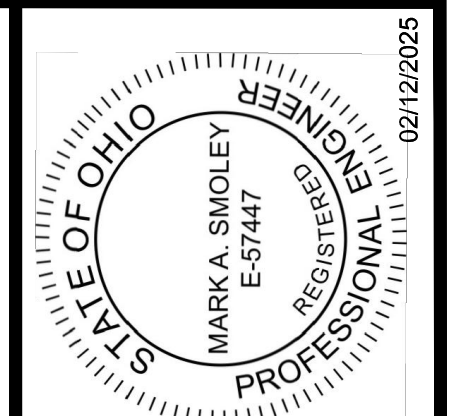

BUERER GROUP
20800 CHAGIN BLVD, SUITE 500
SHAKER HEIGHTS, OH 44122
TEL: 216.378.1480
FAX: 216.378.1487

PUTNAM COUNTY FSM FACILITY
FOR
OHIO DEPARTMENT OF TRANSPORTATION
VILLAGE OF OTTAWA, OH 45875

BUERER GROUP
architecture & engineering, inc.
314 CONANT ST., MAUMEE, OH 43537 | P: 419.893.9621 | F: 419.893.9627 | BUERERGROUP.COM

REVISION SCHEDULE

1	02/28/2025 - ADDENDUM #2
---	--------------------------

ISSUE DATE: 02/12/2025
JOB NUMBER: 240659
BID DOCUMENTS

C3.0
UTILITY PLAN

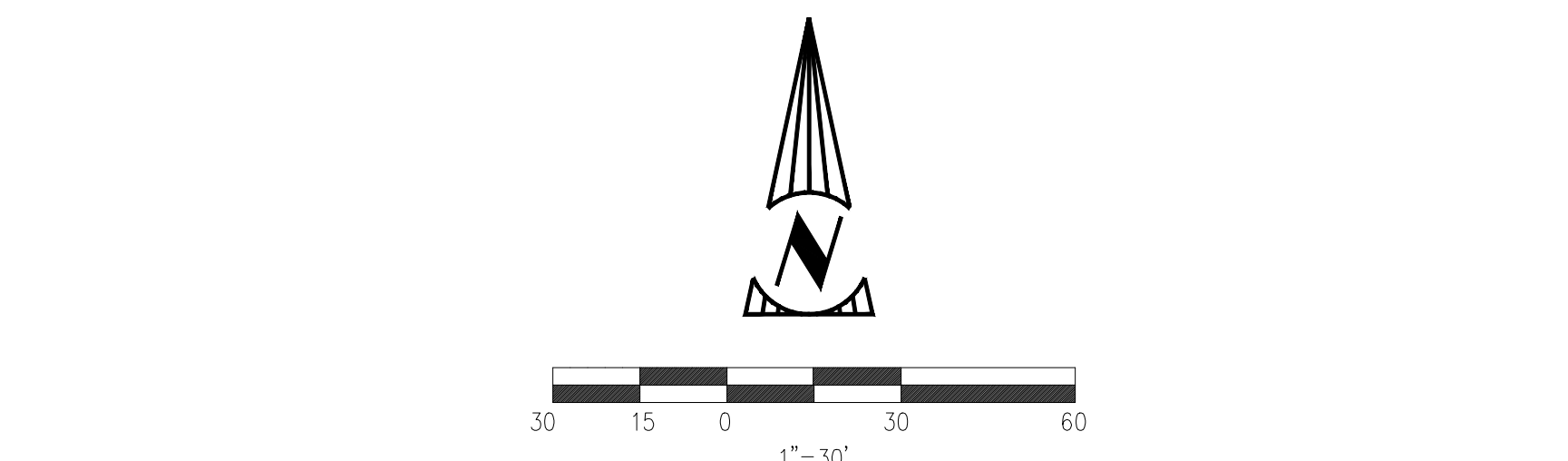
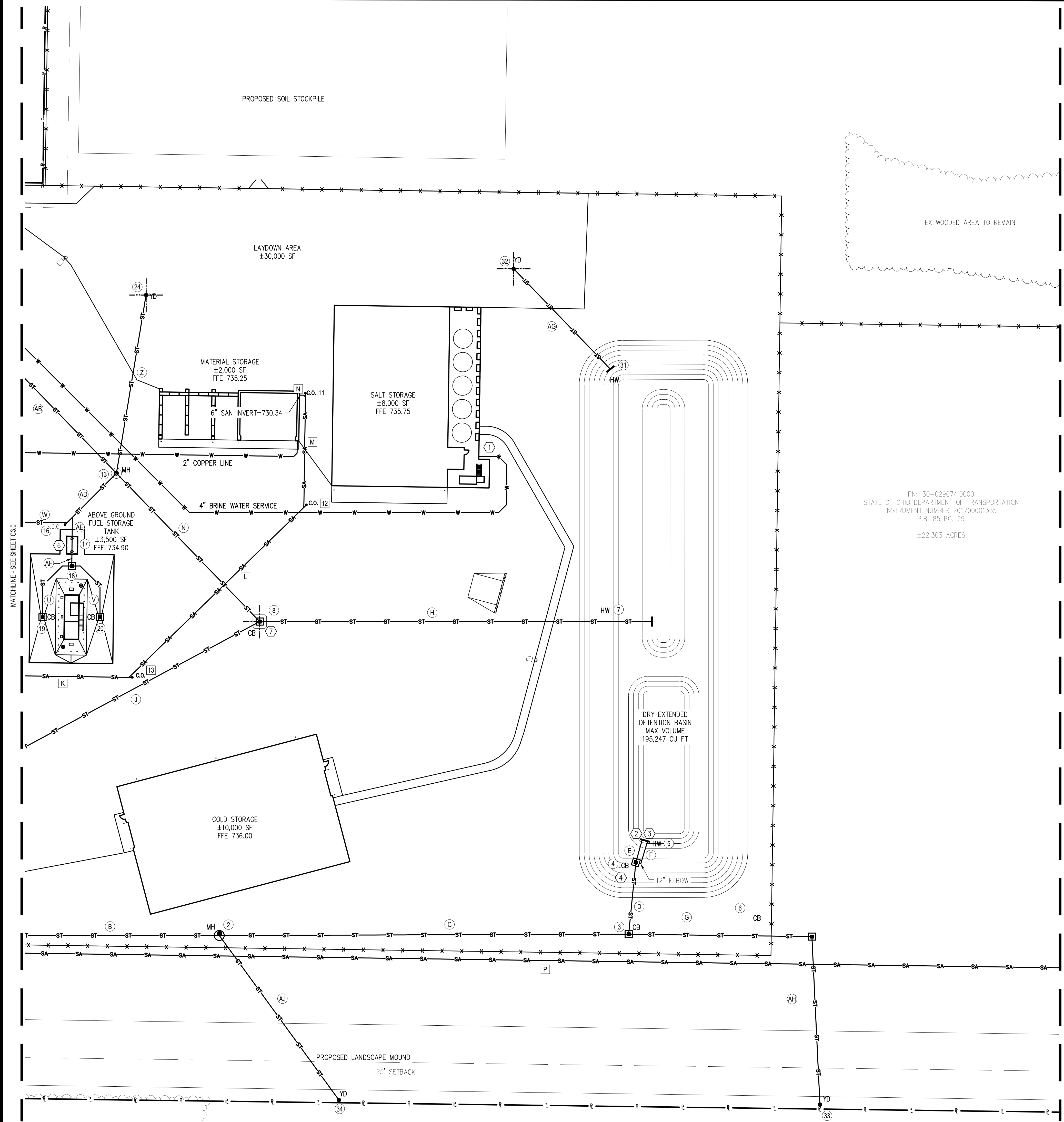

- CODED NOTES:**
- CONTRACTOR SHALL INSTALL A 4" PVC C-909 WATER SERVICE FROM THE MAIN BUILDING STUB TO THE BRINE MAKER AREA AND CONNECT TO STUBS PER THE PLUMBING PLANS.
 - CONTRACTOR SHALL INSTALL ODOT HALF HEIGHT HEADWALL PER DETAIL.
 - CONTRACTOR SHALL INSTALL PIPE APRON ROCK CHANNEL PROTECTION ALONG THE SLOPE FROM THE DAYLIGHT PIPE TO THE TOE OF SLOPE PER DETAIL.
 - CONTRACTOR SHALL INSTALL A SHUT OFF VALVE ON THE 18" OUTLET BASIN PIPE AND PROVIDE A 12" LONG VALVE SHUTOFF.
 - CONTRACTOR SHALL CORE EXISTING MANHOLE AND MAKE A WATER TIGHT CONNECTION TO THE PROPOSED SANITARY LATERAL.
 - PLUMBING CONTRACTOR SHALL SUPPLY BOTH OIL INTERCEPTORS AND INSTALL THE BUILDING 2000 GALLON OIL INTERCEPTOR AND PIPING TO AND INCLUDING THE STORM CLEAN OUT.
 - CONTRACTOR SHALL INSTALL FINGER DRAINS AT INLETS IN PAVEMENT PER DETAIL ON SHEET C0.2.

- PROPOSED UTILITIES LEGEND**
- ST - STORM SEWER
 - SA - SANITARY SEWER
 - W - WATER LINE
 - E - ELECTRIC SERVICE
 - COMM - TELECOM. SERVICE
 - G - GAS LINE
 - MH / MANHOLE
 - LS / LIFT STATION
 - CB / CATCH BASIN FINGER DRAINS WHERE INDICATED ON PLAN
 - CI / CURB INLET FINGER DRAINS WHERE INDICATED ON PLAN
 - YD / YARD DRAIN FINGER DRAINS WHERE INDICATED ON PLAN
 - HW / HEADWALL
 - C.O. - CLEAN OUT
 - FH / FIRE HYDRANT
 - FDC / FIRE DEPARTMENT CONNECTION
 - EM / ELECTRIC METER
 - OWS / OIL WATER SEPARATOR

GENERAL NOTES:

- THE CONTRACTOR MUST OBTAIN A SEWER PERMIT FROM THE VILLAGE OF OTTAWA, PRIOR TO PERFORMING THE SEWER WORK.
- TO OBTAIN A SEWER PERMIT THE CONTRACTOR MUST BE A LICENSED AND BONDED SEWER BUILDER WITH THE VILLAGE OF OTTAWA.
- CONTRACTOR TO VERIFY INVERT OF EXISTING SEWERS PRIOR TO ORDERING STRUCTURES.
- CONTRACTOR IS RESPONSIBLE FOR REPLACING ANY ONSITE AND OFFSITE ITEMS DAMAGED DURING CONSTRUCTION IN THE SAME OR BETTER CONDITION THAN THEY WERE PRIOR TO CONSTRUCTION.

PROPOSED STORM STRUCTURE TABLE

- | | | | |
|----|--|----|---|
| 1 | PR ODOT MH-3
RIM = 735.07
N:502784.69
E:1543083.53
FL 724.12 - 30" W
FL 725.12 - 30" E
FL 728.52 - 12" SE | 16 | PR CLEAN OUT
RIM = 734.75
N:503035.10
E:1542989.55
FL 729.52 - 15" NE |
| 2 | PR ODOT CB 2-3
RIM = 735.46
N:502785.47
E:1543333.01
FL 726.19 - 30" W
FL 726.69 - 24" E
FL 726.68 - 24" N | 17 | PR OIL WATER SEPARATOR
RIM = 734.59
N:503022.56
E:1542993.78
FL 729.59 - 12" N
FL 729.59 - 12" S |
| 3 | PR ODOT CB 2-3
RIM = 734.15
N:502829.29
E:1543337.34
FL 728.50 - 24" N
FL 727.00 - 24" S
FL 727.00 - 12" E | 18 | PR ODOT CB 2-3
RIM = 734.40
N:503009.89
E:1542993.63
FL 729.65 - 6" EW
FL 729.65 - 12" N |
| 4 | PR ODOT HW-2.1
RIM = 725.34
N:502843.00
E:1543343.09
FL 725.51 - 12" S
FL 725.51 - 24" S | 19 | PR ODOT CB 2-3
RIM = 734.00
N:502978.65
E:1542975.79
FL 729.86 - 6" N |
| 5 | CLEANOUT
N: 503047.10
E: 1543136.57
RIM: 735.23
FL 729.30 ~ 6" SW | 20 | PR ODOT CB 2-3
RIM = 734.00
N:502978.66
E:1543010.83
FL 729.86 - 6" N |
| 6 | PR ODOT CB 2-3
RIM = 733.16
N:502784.03
E:1543444.63
FL 727.84 - 24" W
FL 728.92 - 12" S | 24 | PR YARD DRAIN
RIM = 734.00
N:503175.08
E:1543038.89
FL 732.16 - 4" N/S/E/W
FL 729.76 - 15" S |
| 7 | PR ODOT HW-2.1
RIM = 725.00
N:502976.04
E:1543347.22
FL 725.00 - 36" W | 31 | PR ODOT HW-2.1
RIM = 730.00
N:503129.65
E:1543322.22
FL 730.00 - 15" NW |
| 8 | PR ODOT CB 2-4
RIM = 733.13
N:502976.04
E:1543108.14
FL 731.29 - 4" N/S/E/W
FL 725.48 - 36" E
FL 726.04 - 36" SW
FL 727.75 - 24" NW | 32 | PR YARD DRAIN
RIM = 734.31
N:503191.08
E:1543262.87
FL 732.47 - 4" N/S/E/W
FL 730.47 - 15" SE |
| 13 | PR ODOT MH-3
RIM = 734.39
N:503066.44
E:1543020.82
FL 728.06 - 24" SE
FL 728.06 - 24" NW
FL 729.43 - 15" N
FL 729.43 - 15" SW | 33 | PR YARD DRAIN
RIM = 733.50
N:502684.40
E:1543156.39
FL 731.00 - 12" NW |

SANITARY PIPE SCHEDULE

	LENGTH* (FT.)	DIA (IN.)	SLOPE (%)	TYPE
K	105	6	1.5	PVC SDR-26
L	151	6	1.5	PVC SDR-26
M	70	6	1.5	PVC SDR-26
N	4	6	1.5	PVC SDR-26
P	1342	2	N/A	PVC SDR-26

*LENGTH REFLECTS OVERALL LENGTH OF LINE FROM STRUCTURE TO STRUCTURE

STORM PIPE SCHEDULE

	LENGTH* (FT.)	DIA (IN.)	SLOPE (%)	TYPE
B	300	30	0.60	HDPE
C	249	30	0.43	HDPE
D	44	24	0.74	HDPE
E	13	24	2.3	HDPE
F	15	12	9.9	HDPE
G	112	24	1.03	HDPE
H	239	36	0.20	HDPE
J	199	36	0.18	HDPE
N	126	24	0.25	HDPE
U	42	6	0.50	PVC
V	42	6	0.50	PVC
W	34	8	0.50	HDPE
Z	110	15	0.30	HDPE
AB	105	24	0.25	HDPE
AD	44	15	0.20	HDPE
AE	17	12	0.50	HDPE
AF	13	12	0.50	PVC
AG	85	15	0.55	HDPE
AH	103	12	2.24	HDPE
AJ	124	12	2.00	HDPE

*LENGTH REFLECTS OVERALL LENGTH OF LINE FROM STRUCTURE TO STRUCTURE

PN: 30-029074.0000
STATE OF OHIO DEPARTMENT OF TRANSPORTATION
INSTRUMENT NUMBER 201700001335
P.B. 85 PG. 29
±22.303 ACRES

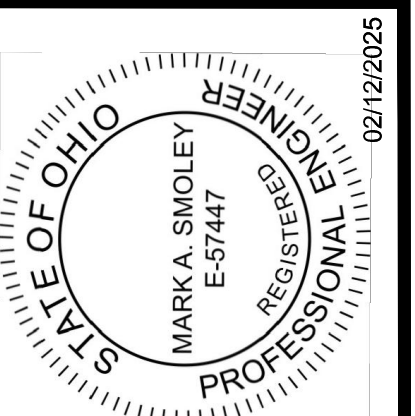

Bluer Group
20600 CHAGIN BLVD, SUITE 500
SHAKER HEIGHTS, OH 44122
TEL: 216.376.1480
FAX: 216.376.1497

PUTNAM COUNTY FSM FACILITY
FOR
OHIO DEPARTMENT OF
TRANSPORTATION
VILLAGE OF OTTAWA, OH 45875

Bluer Group
architecture & engineering, inc.
314 CONANT ST., MAUMEE, OH 43537 P: 419.893.9621 F: 419.893.9627 bluergroup.com

REVISION SCHEDULE

2	02/28/2025 - ADDENDUM #2
---	--------------------------

ISSUE DATE: 02/12/2025
JOB NUMBER: 240659

BID DOCUMENTS

C3.1
UTILITY PLAN

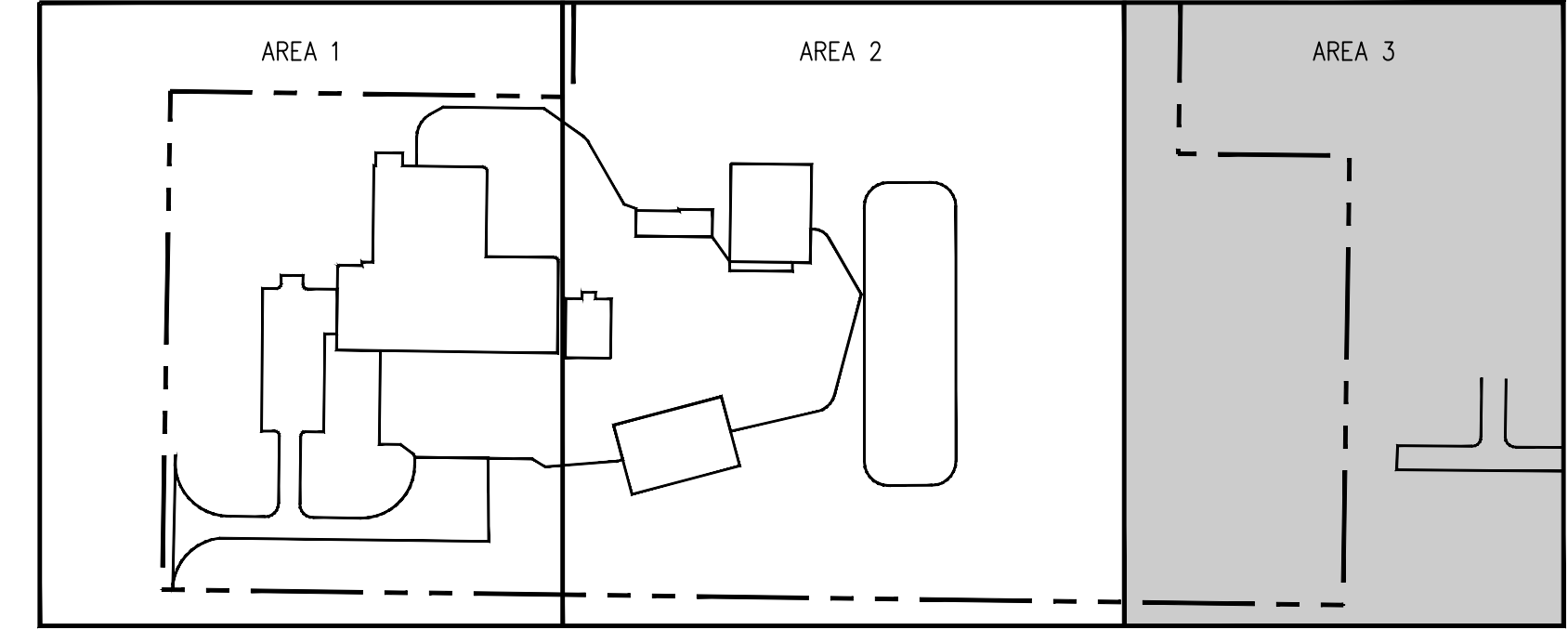
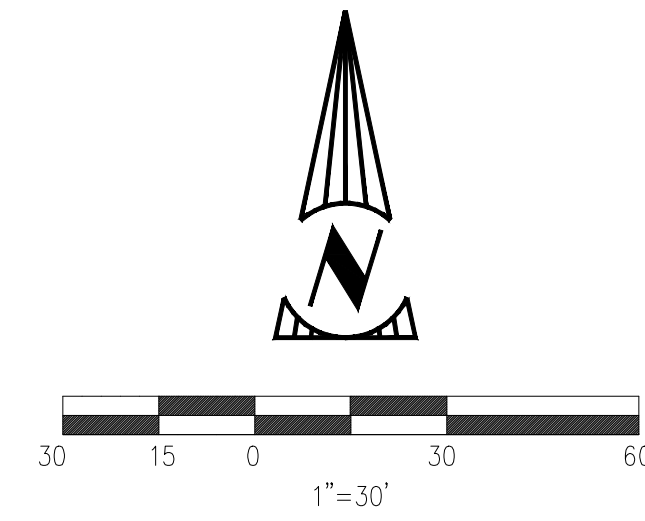
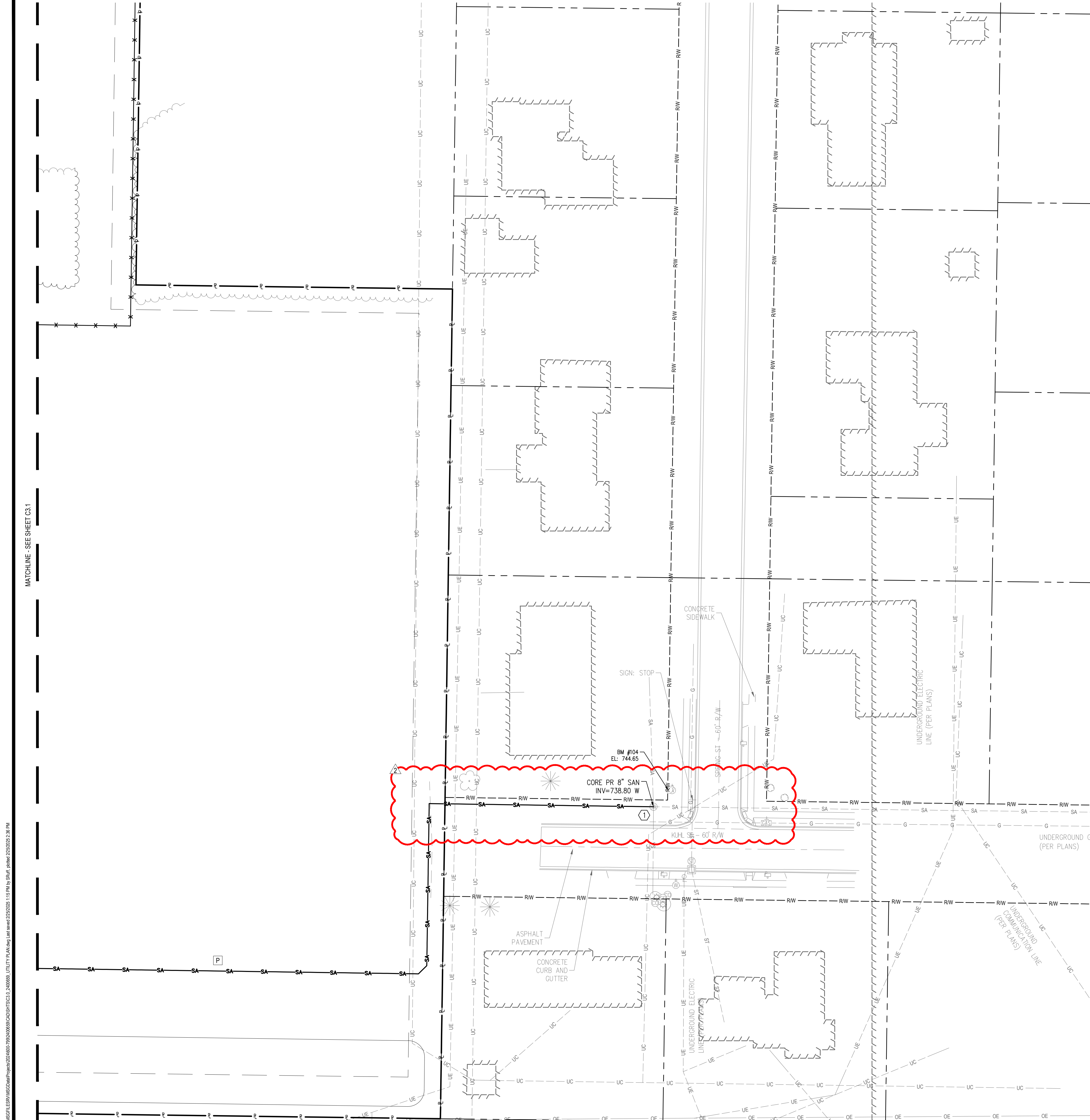

KEY PLAN
SCALE: 1" = 200'

GENERAL NOTES:

1. THE CONTRACTOR MUST OBTAIN A SEWER PERMIT FROM THE VILLAGE OF OTTAWA, PRIOR TO PERFORMING THE SEWER WORK.
2. TO OBTAIN A SEWER PERMIT THE CONTRACTOR MUST BE A LICENSED AND BONDED SEWER BUILDER WITH THE VILLAGE OF OTTAWA.
3. CONTRACTOR TO VERIFY INVERT OF EXISTING SEWERS PRIOR TO ORDERING STRUCTURES.
4. CONTRACTOR IS RESPONSIBLE FOR REPLACING ANY ONSITE AND OFFSITE ITEMS DAMAGED DURING CONSTRUCTION IN THE SAME OR BETTER CONDITION THAN THEY WERE PRIOR TO CONSTRUCTION.

CODED NOTES:

- ① CONTRACTOR SHALL CORE EXISTING MANHOLE AND MAKE A WATER TIGHT CONNECTION TO THE PROPOSED SANITARY LATERAL.

SANITARY PIPE SCHEDULE				
	LENGTH* (FT.)	DIA (IN.)	SLOPE (%)	TYPE
P	1342	2	N/A	PVC SDR-26

*LENGTH REFLECTS OVERALL LENGTH OF LINE FROM STRUCTURE TO STRUCTURE

PROPOSED UTILITIES LEGEND

- ST— STORM SEWER
- SA— SANITARY SEWER
- W— WATER LINE
- E— ELECTRIC SERVICE
- COMM— TELECOM. SERVICE
- G— GAS LINE
- MH / MANHOLE
- ⊙ LS / LIFT STATION
- ▣ CB / CATCH BASIN
FINGER DRAINS WHERE INDICATED ON PLAN
- ▤ CI / CURB INLET
FINGER DRAINS WHERE INDICATED ON PLAN
- YD / YARD DRAIN
FINGER DRAINS WHERE INDICATED ON PLAN
- HW / HEADWALL
- C.O. CLEAN OUT
- ⊕ FH / FIRE HYDRANT
- ⊕ FDC / FIRE DEPARTMENT CONNECTION
- ⊕ EM / ELECTRIC METER
- ⊕ OWS / OIL WATER SEPARATOR

MATCHLINE - SEE SHEET C3.1

M:\2025\15379\15379.dwg: 02/28/2025 10:19:19 AM: 20250228.Plot: 20250228.Plot

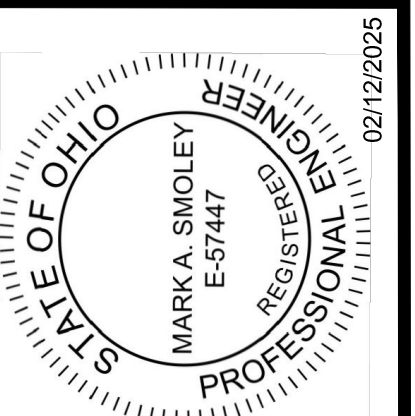

Magnik Smith Group
20600 CHAGIN BLVD, SUITE 500
SHAKER HEIGHTS, OH 44122
TEL: 216.378.1490
FAX: 216.378.1497

PUTNAM COUNTY FSM FACILITY
FOR
OHIO DEPARTMENT OF
TRANSPORTATION
VILLAGE OF OTTAWA, OH 45875

BUEHRERGROUP
architecture & engineering, inc.
314 CONANT ST., MAUMEE, OH 43537 | P: 419.893.9021 | F: 419.893.9027 | BUEHRERGROUP.COM

REVISION SCHEDULE	
△	02/28/2025 - ADDENDUM #2

ISSUE DATE: 02/12/2025
JOB NUMBER: 240659

BID DOCUMENTS

C3.2
UTILITY PLAN

W:\PROJECTS\2025\240659 - UTILITY PLAN\DWG\240659-01-UTILITY PLAN.dwg, Date: 02/28/2025, 10:39:19 AM, User: jhicks, 2/28/2025 2:38 PM

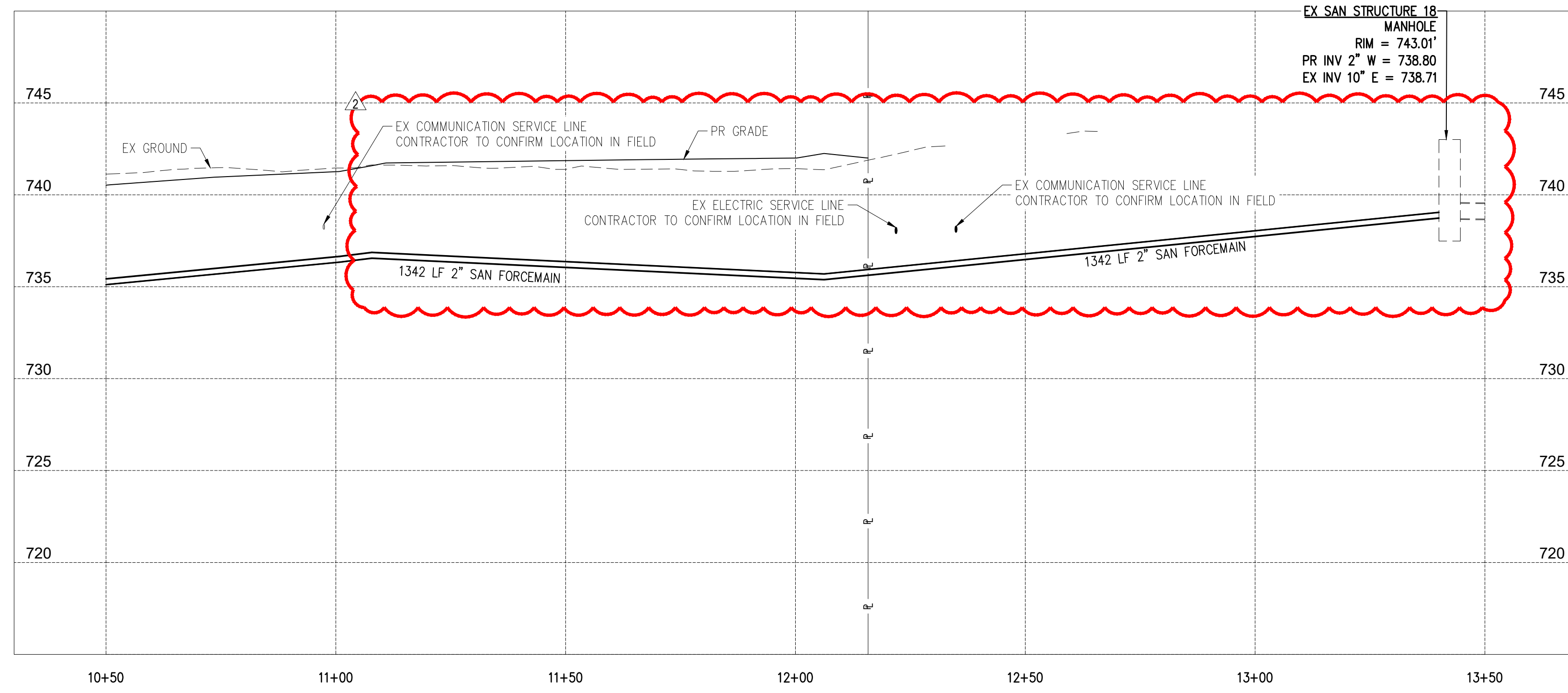

SANITARY MAIN EXTENSION PROFILE
SCALE: H:1"=20', V:1"=5'

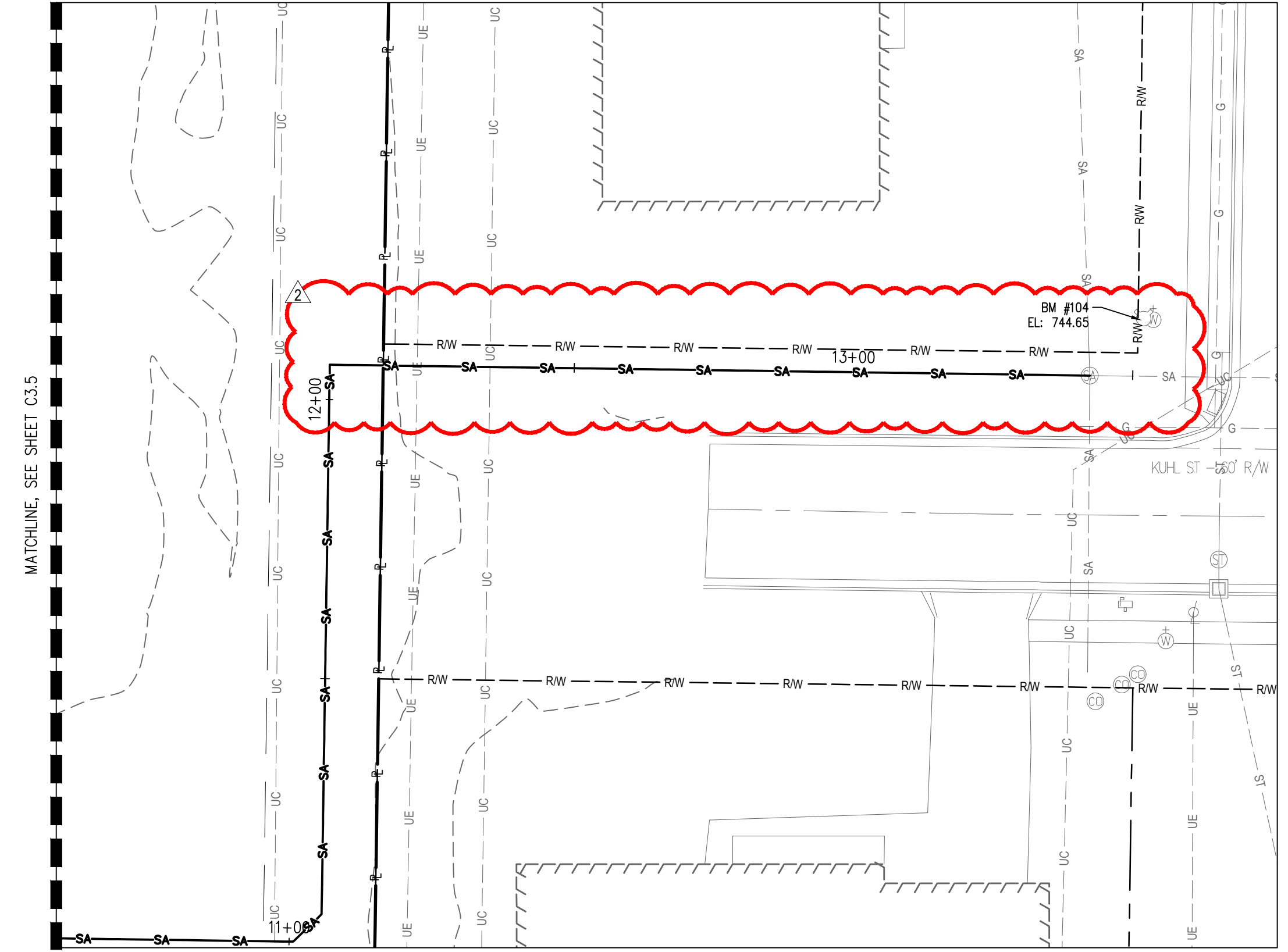

SANITARY MAIN EXTENSION PLAN
SCALE: 1"=20'

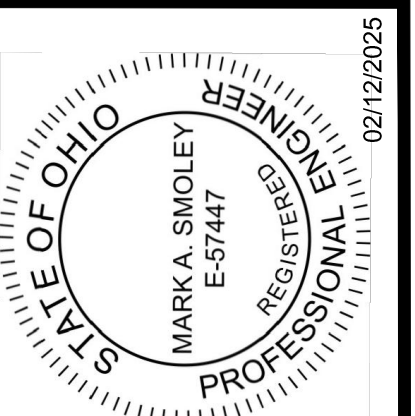
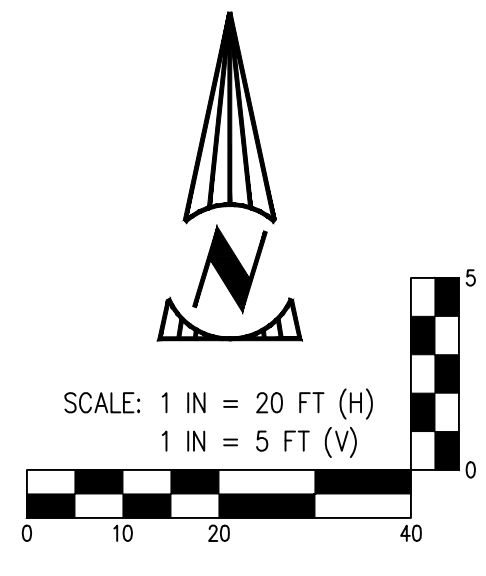

Magnik Smith GROUP
 20600 CHAGIN BLVD, SUITE 500
 SHAKER HEIGHTS, OH 44122
 TEL: 216.378.1490
 FAX: 216.378.1497

PUTNAM COUNTY FSM FACILITY
 FOR
 OHIO DEPARTMENT OF
 TRANSPORTATION
 VILLAGE OF OTTAWA, OH 45875

BUEHRERGROUP
 architecture & engineering, inc.
 514 CONANT ST., MAUMEE, OH 43537 | P: 419.893.9021 | F: 419.893.9027 | BUEHRERGROUP.COM

REVISION SCHEDULE
02/28/2025 - ADDENDUM #2

ISSUE DATE: 02/12/2025
 JOB NUMBER: 240659

BID DOCUMENTS
C3.6
 UTILITY PROFILES

M:\2025\10\28\1025025\1025025.dwg (PLOT) DATEPLOT: 02/12/2025 10:28:25 AM BY: [redacted] PLOT: 02/12/2025 10:28:25 AM

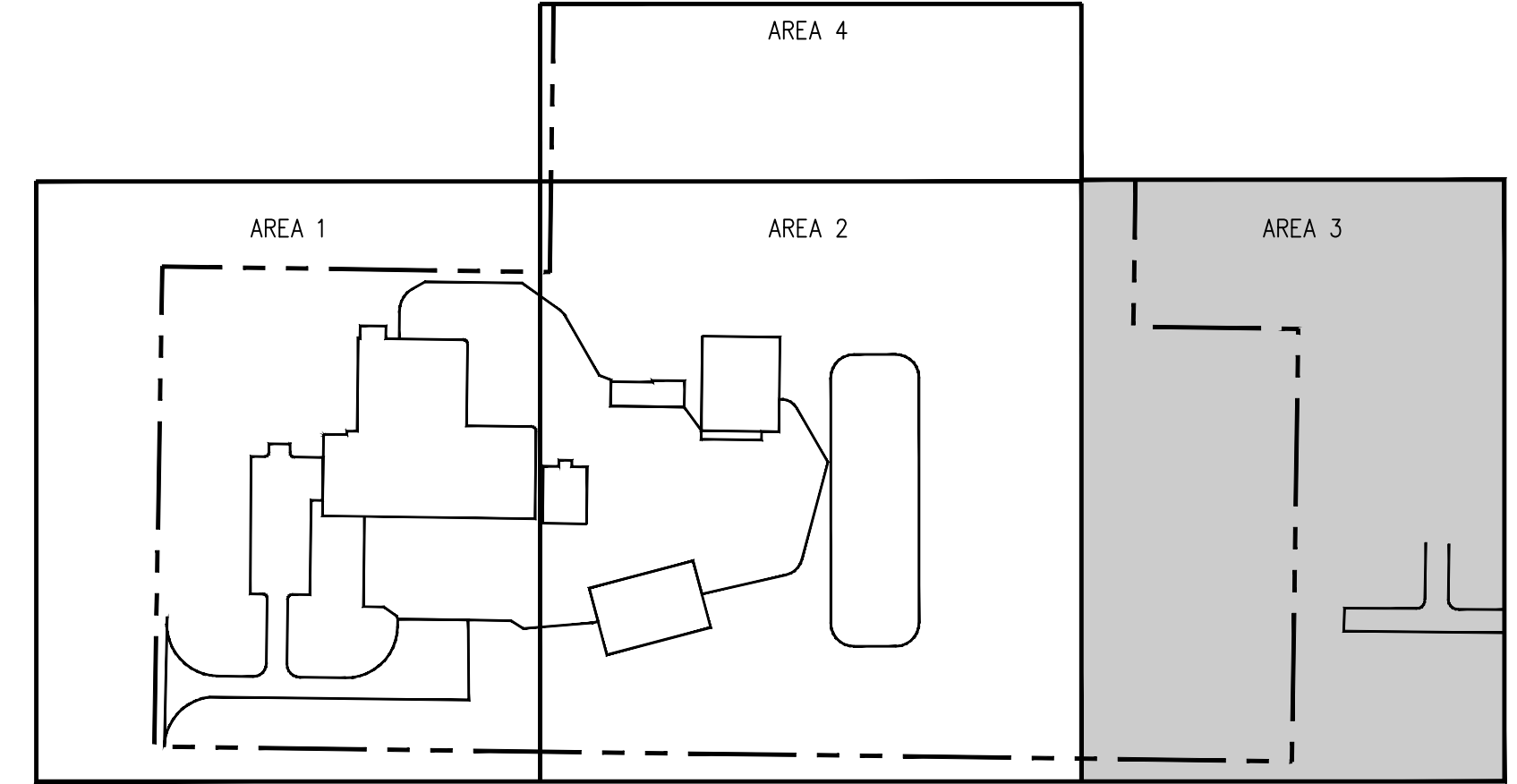
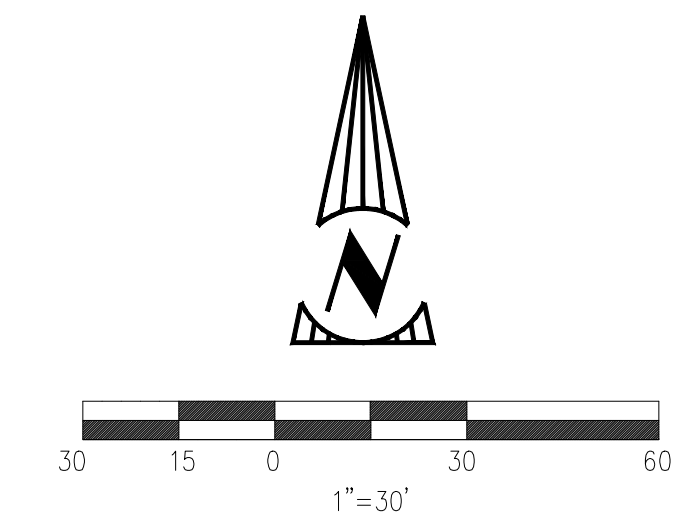
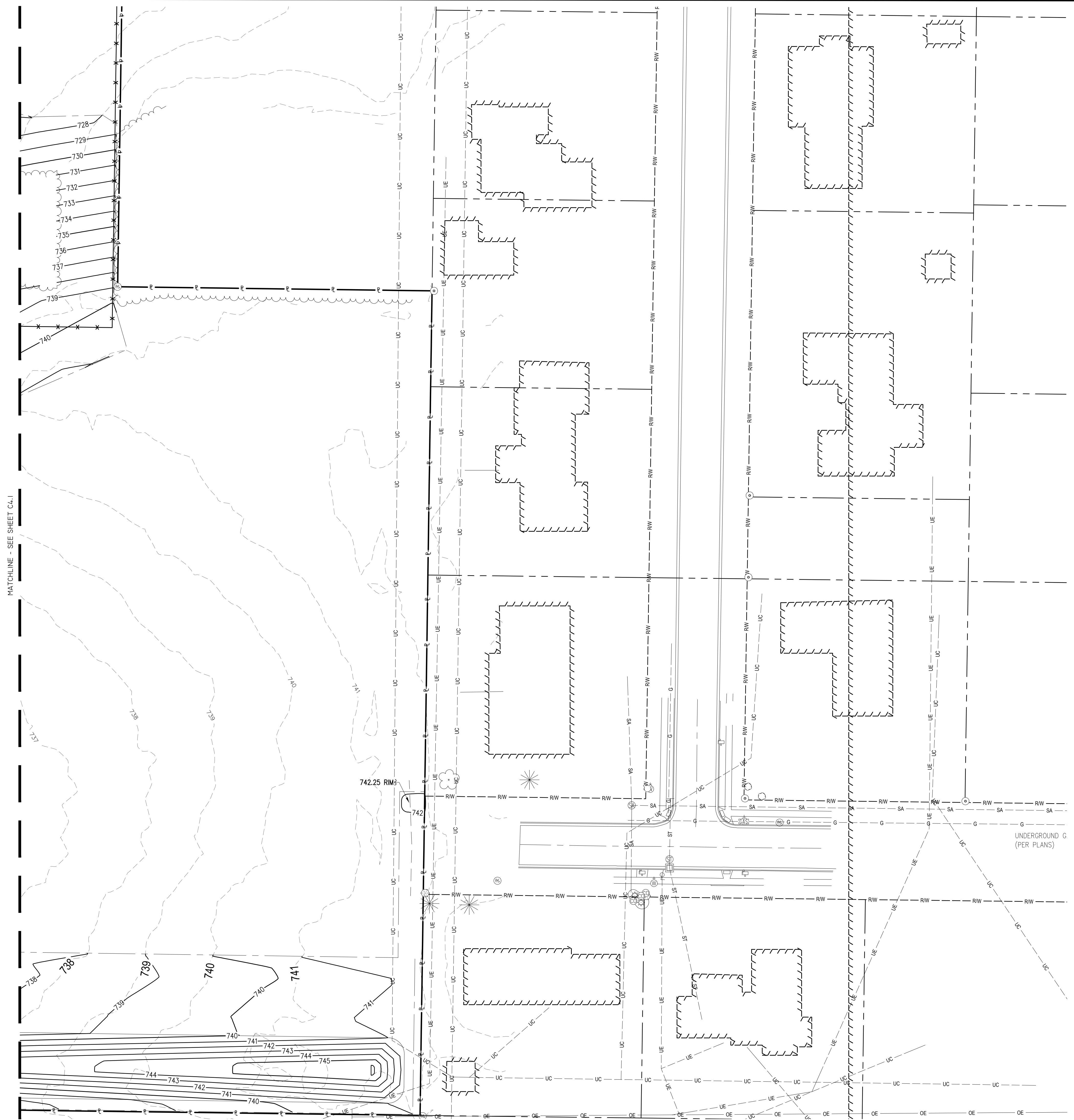

KEY PLAN
SCALE: 1" = 200'

LEGEND

- 99 — PROP. INTERMEDIATE CONTOUR
- 100 — PROP. INDEX CONTOUR
- 99 --- EXISTING INTERMEDIATE CONTOURS
- RIDGE --- RIDGE, VALLEY, OR GRADE BREAK AS INDICATED
- VALLEY ---
- SWALE CENTERLINE
- GRADING EXTENTS
- W WALK
- TC TOP OF CURB
- BC BOTTOM OF CURB
- PA PAVEMENT
- RIM STRUCTURE RIM

GENERAL NOTES:

1. CONTRACTOR SHALL ENSURE POSITIVE DRAINAGE THROUGHOUT CONSTRUCTION.
2. CONTRACTOR SHALL INSTALL PROPOSED PAVEMENT FLUSH WITH EXISTING PAVEMENT TO REMAIN IN THE SAME OR BETTER CONDITION THAN THEY WERE PRIOR TO CONSTRUCTION.
3. CONTRACTOR IS RESPONSIBLE FOR REPLACING ANY ONSITE AND OFFSITE ITEMS DAMAGED DURING CONSTRUCTION IN THE SAME OR BETTER CONDITION THAN THEY WERE PRIOR TO CONSTRUCTION.
4. THE EXISTING TOPOGRAPHY SHOWN ON THESE PLANS IS THE SURVEY OF RECORD FOR THIS PROJECT. SHOULD THE CONTRACTOR TAKE EXCEPTION TO THE EXISTING TOPOGRAPHY AS SHOWN IN THESE PLANS THEY SHALL SUBMIT A TOPOGRAPHIC SURVEY PREPARED BY A REGISTERED PROFESSIONAL SUVERYOR DOCUMENTING THEIR EXCEPTION PRIOR TO THE INITIATION OF ANY EARTH MOVING ACTIVITIES. OTHERWISE THE TOPOGRAPHY CONTAINED WITHIN THESE PLANS IS ACCEPTED BY THE CONTRACTOR AND DEEMED ACCURATE FOR ALL GRADING AND SOILS MANAGEMENT ISSUES.
5. THE CONTRACTOR IS RESPONSIBLE FOR CONSTRUCTING THE LINES AND GRADES ILLUSTRATED WITHIN THIS PLAN SET. THE CONTRACTOR IS TO INCLUDE ALL SOILS IMPORT OR EXPORT NECESSARY TO ATTAIN THE LINES AND GRADES ILLUSTRATED HEREIN WITHIN THE BASE BID OF THIS PROJECT WITH NO ADDITIONAL COST FOR SOILS IMPORT OR EXPORT.
6. A GEOTECHNICAL REPORT WAS PREPARED BY PROFESSIONAL SERVICE INDUSTRIES, INC. (PSI) AN INTERTEK COMPANY DATED SEPTEMBER 16, 2024.

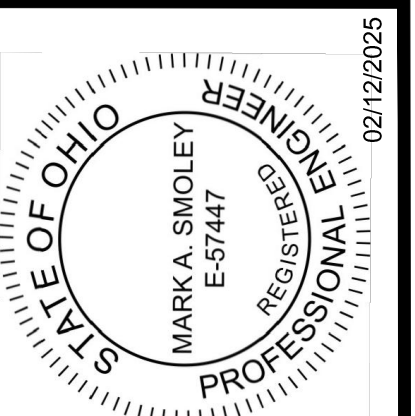

Blueher Group
 20600 CHAGIN BLVD, SUITE 500
 SHAKER HEIGHTS, OH 44122
 TEL: 216.378.1490
 FAX: 216.378.1497

PUTNAM COUNTY FSM FACILITY
 FOR
OHIO DEPARTMENT OF
TRANSPORTATION
 VILLAGE OF OTTAWA, OH 45875



REVISION SCHEDULE	
Δ	02/28/2025 - ADDENDUM #2
ISSUE DATE: 02/12/2025	
JOB NUMBER: 240659	
BID DOCUMENTS	
<div style="border: 2px solid red; border-radius: 50%; padding: 10px; display: inline-block;"> C4.3 <small>GRADING PLAN</small> </div>	

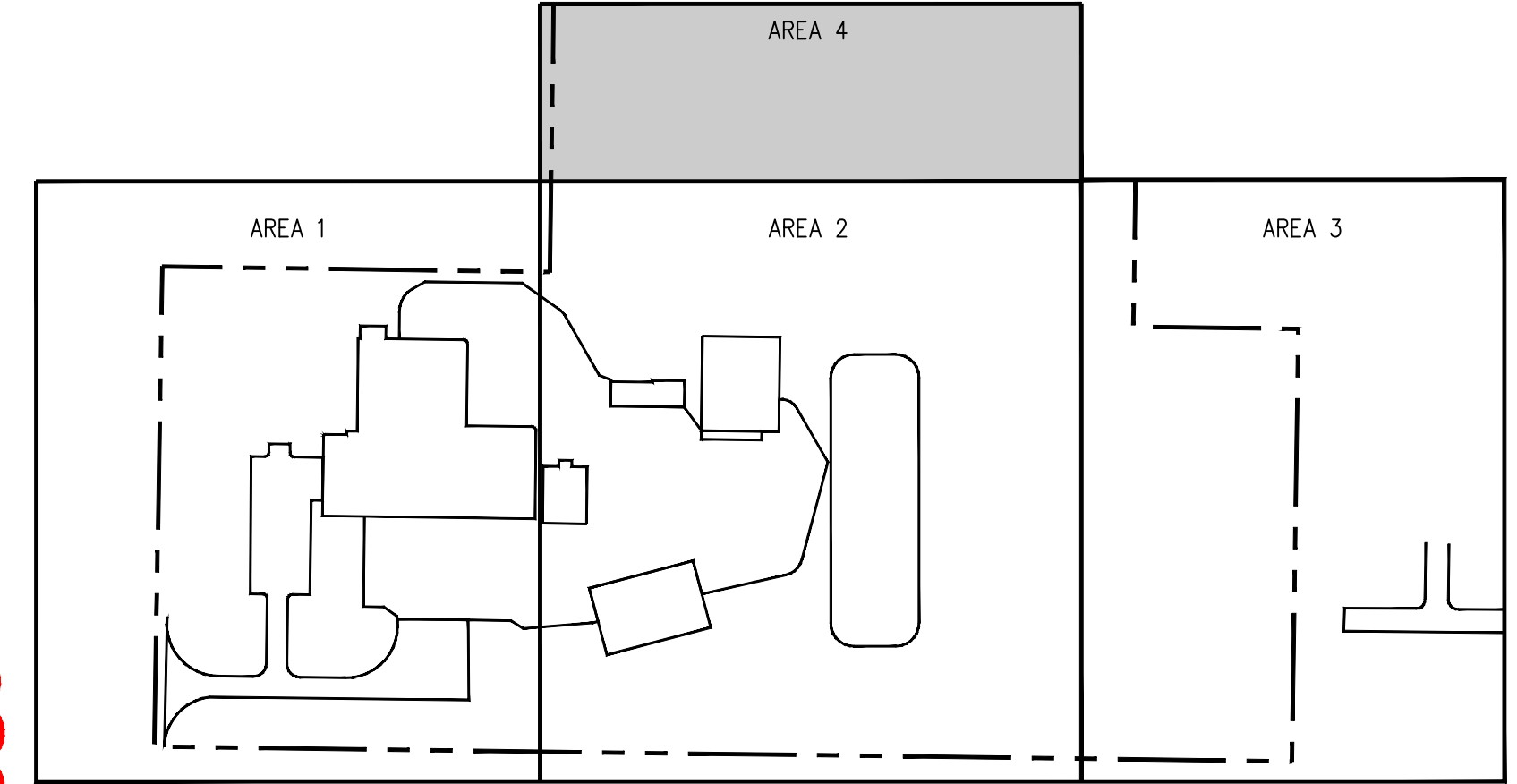
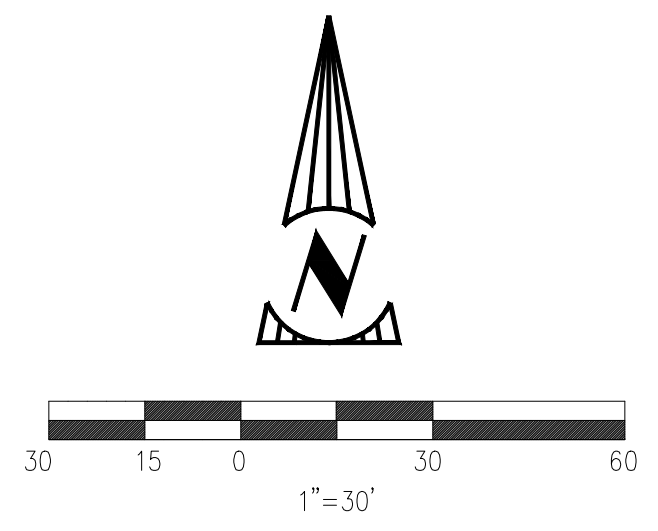
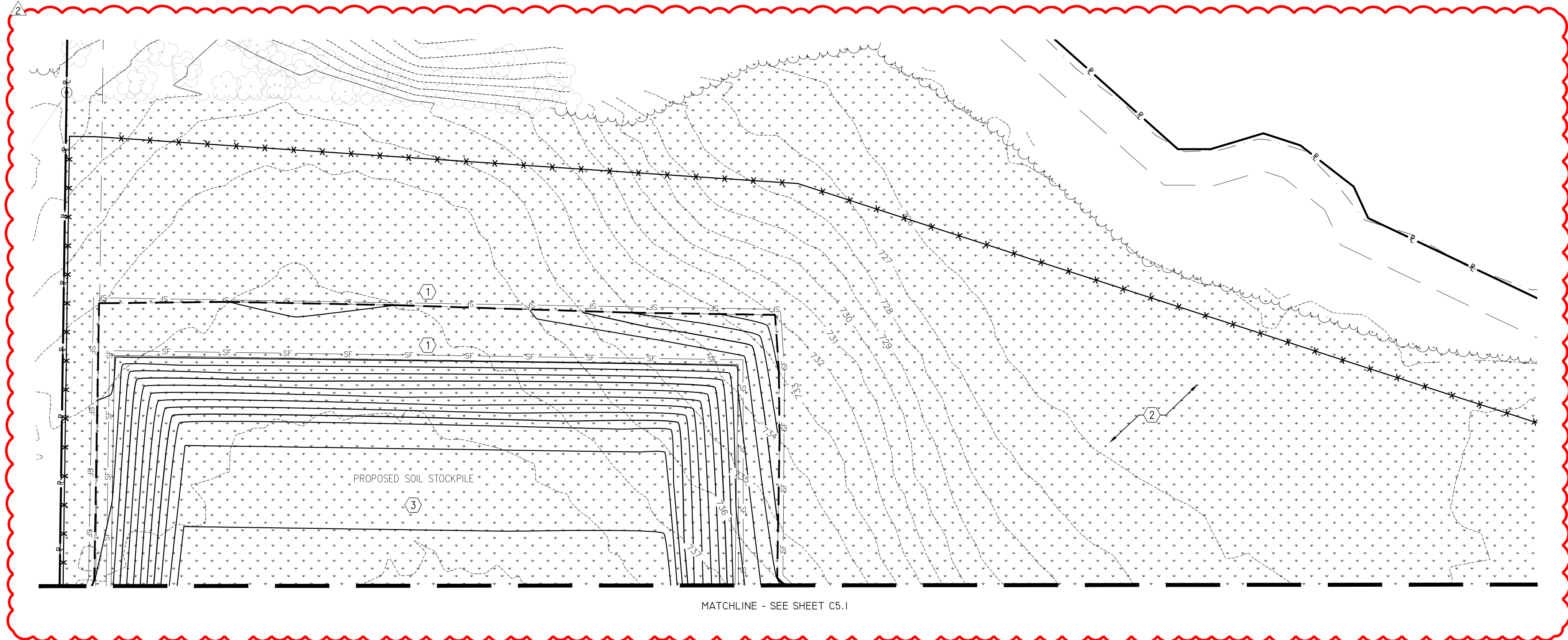

KEY PLAN
SCALE: 1" = 200'

LEGEND

- GEOTEXTILE INLET PROTECTION. FOR INLET PROTECTION IN PAVED AREAS USE DANDY BAG INLET PROTECTION OR APPROVED EQUAL.
- CONCRETE WASHOUT PIT
- CONSTRUCTION ENTRANCE
- PROPOSED SILT FENCE
- DISTURBED LIMITS
- EROSION CONTROL BLANKET
- TEMPORARY SEEDING
- ROCK CHECK DAM
- EMERGENCY SPILLWAY PER DETAIL SHEET C6.3
- REFUELING AREA
- DUMPSTER
- 100-YEAR FLOOD ROUTE
- SWPPP CODED NOTE

GENERAL NOTES:

1. CONTRACTOR IS RESPONSIBLE FOR REPLACING ANY ONSITE AND OFFSITE ITEMS DAMAGED DURING CONSTRUCTION IN THE SAME OR BETTER CONDITION THAN THEY WERE PRIOR.

CODED NOTES:

- ① CONTRACTOR SHALL INSTALL AND MAINTAIN THE SILT FENCE PER DETAIL ON SHEET C6.1.
- ② CONTRACTOR SHALL INSTALL TEMPORARY SEEDING PER NOTES AND SPECIFICATIONS ON SHEET C6.0.
- ③ CONTRACTOR SHALL LOCATE STOCK PILE AS SHOWN UNLESS APPROVED OTHERWISE BY PUTNAM SOIL AND WATER CONSERVATION DISTRICT. EXCESS SOIL SHALL BE SPREAD AND PERMANENTLY STABILIZED AFTER CONSTRUCTION.

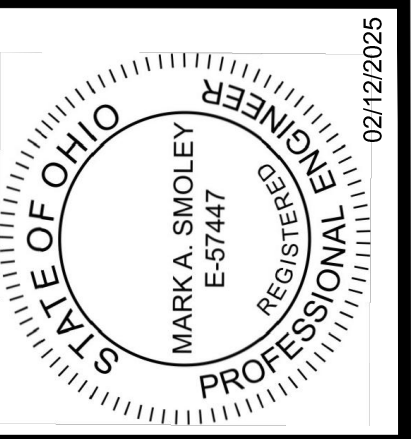

Bluer Group
20600 CHAGIN BLVD, SUITE 500
SHAKER HEIGHTS, OH 44122
TEL: 216.376.1490
FAX: 216.376.1497

PUTNAM COUNTY FSM FACILITY
FOR
OHIO DEPARTMENT OF
TRANSPORTATION
VILLAGE OF OTTAWA, OH 45875

BUEHRERGROUP
architecture & engineering, inc.
314 CONANT ST., MAUMEE, OH 43537 | P: 419.893.9021 | F: 419.893.9027 | BUEHRERGROUP.COM

REVISION SCHEDULE	
△	02/28/2025 - ADDENDUM #2

ISSUE DATE: 02/12/2025
JOB NUMBER: 240659

BID DOCUMENTS

C5.2
STORMWATER POLLUTION
PREVENTION PLAN

\\BUEHRERGROUP\BUEHRERGROUP\Projects\240659\240659-C5.2\Drawings\240659-C5.2.dwg, 02/12/2025, 2:11:14 PM, JMS, 02/12/2025, 2:11:14 PM

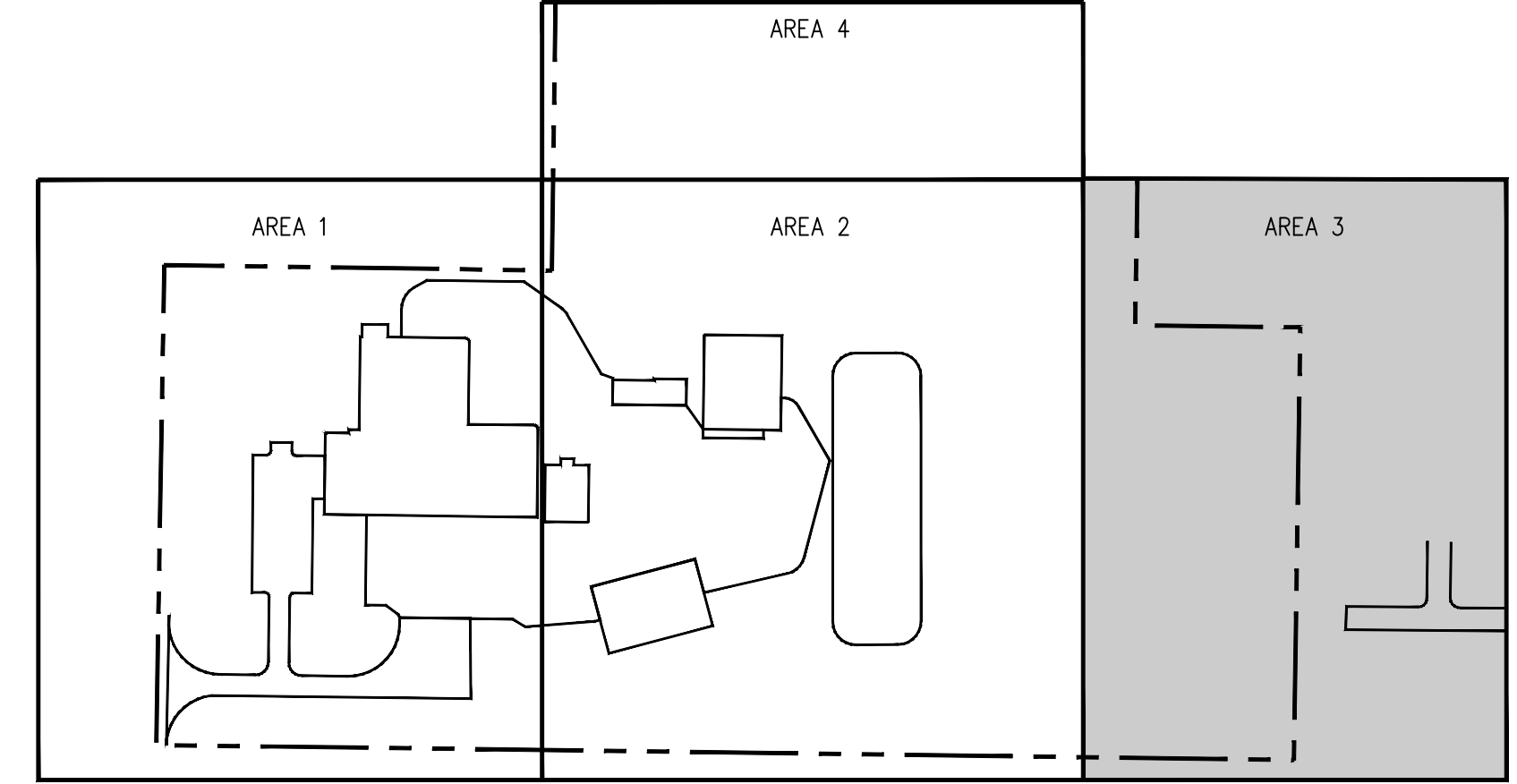
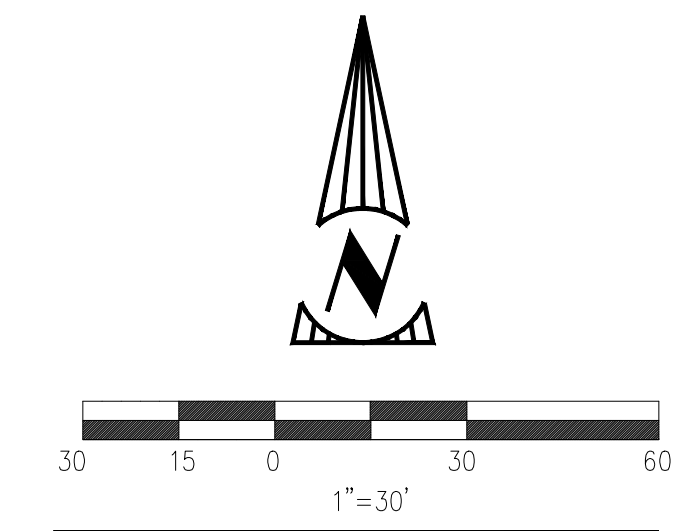
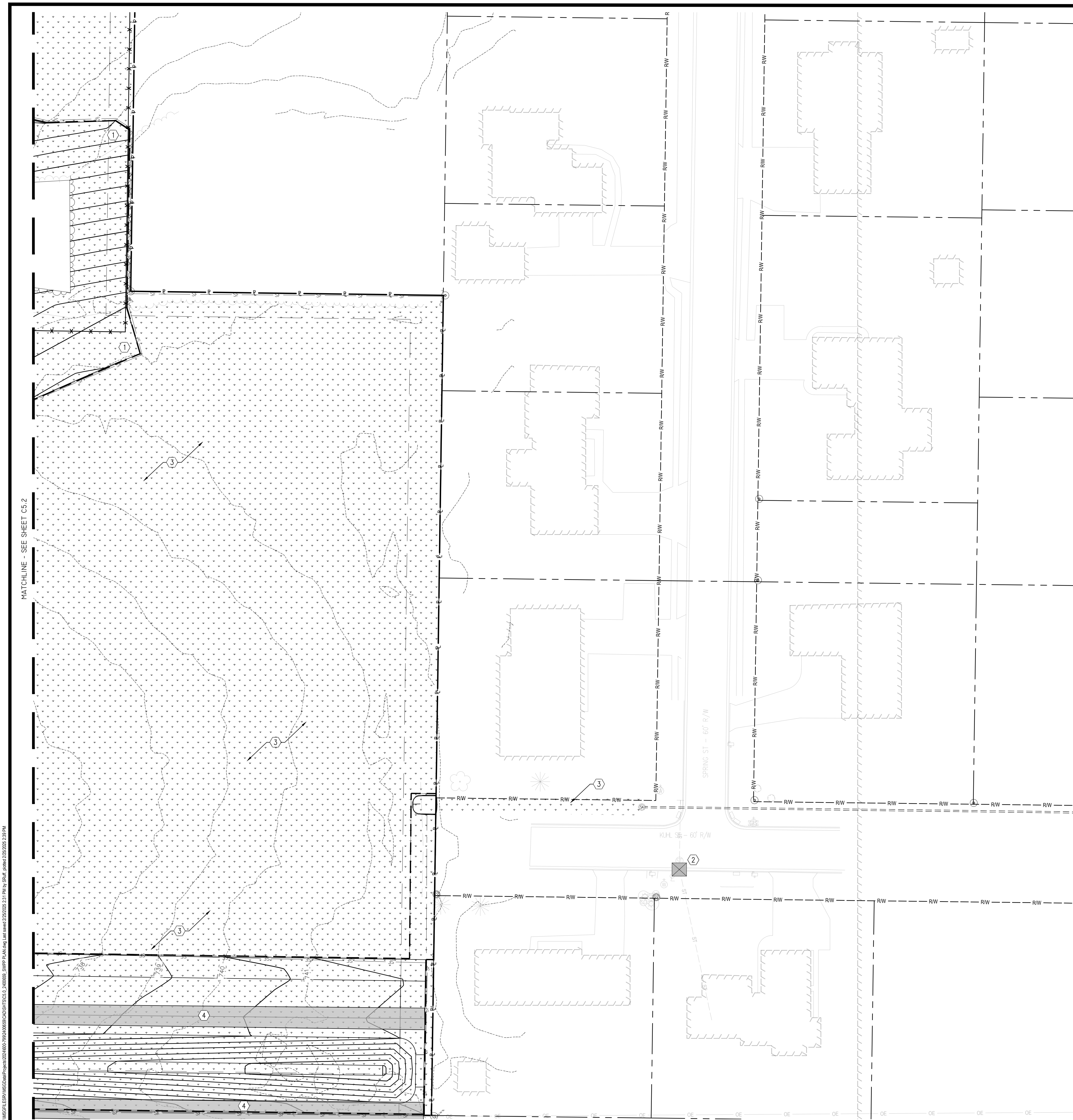

KEY PLAN
SCALE: 1" = 200'

LEGEND

	GEOTEXTILE INLET PROTECTION. FOR INLET PROTECTION IN PAVED AREAS USE DANDY BAG INLET PROTECTION OR APPROVED EQUAL.
	CONCRETE WASHOUT PIT
	CONSTRUCTION ENTRANCE
	PROPOSED SILT FENCE
	DISTURBED LIMITS
	EROSION CONTROL BLANKET
	TEMPORARY SEEDING
	ROCK CHECK DAM
	EMERGENCY SPILLWAY PER DETAIL SHEET C6.3
	REFUELING AREA
	DUMPSTER
	100-YEAR FLOOD ROUTE
	SWPPP CODED NOTE

GENERAL NOTES:

- BUILDING DIMENSIONS SHOWN FOR REFERENCE ONLY, CONTRACTOR TO VERIFY ARCHITECTURAL PLAN DIMENSIONS FOR BUILDING LAYOUT.
- CONTRACTOR IS RESPONSIBLE FOR REPLACING ANY ONSITE AND OFFSITE ITEMS DAMAGED DURING CONSTRUCTION IN THE SAME OR BETTER CONDITION THAN THEY WERE PRIOR.

CODED NOTES:

- CONTRACTOR SHALL INSTALL AND MAINTAIN THE SILT FENCE PER DETAIL ON SHEET C6.1.
- CONTRACTOR SHALL INSTALL AND MAINTAIN THE INLET PROTECTION PER DETAILS ON SHEET C6.1. FOR INLET PROTECTION IN PAVED AREAS USE DANDY BAG INLET PROTECTION OR APPROVED EQUAL. FOR ON SITE CURB INLETS USE DANDY CURB INLET FILTER OR APPROVED EQUAL. FOR CURB INLETS IN THE RIGHT OF WAY USE DANDY CURB SACK INLET FILTER WITH OVERFLOW PORTS OR APPROVED EQUAL.
- CONTRACTOR SHALL INSTALL TEMPORARY SEEDING PER NOTES AND SPECIFICATIONS ON SHEET C6.0.
- CONTRACTOR SHALL INSTALL EROSION CONTROL BLANKET ON 3:1 SLOPE PER DETAIL ON SHEET C6.2.

MATCHLINE - SEE SHEET C5.2

\\snp\p\cadd\2025\240659\240659.dwg (2/25/2025 2:11 PM) by: snp (p) (date: 2/25/2025 2:11 PM)

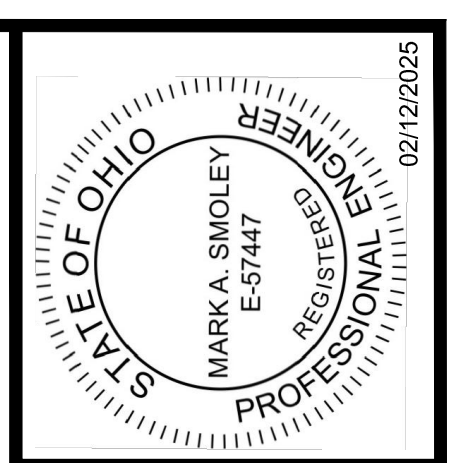

Blueher Group
20600 CHAGIN BLVD, SUITE 500
SHAKER HEIGHTS, OH 44122
TEL: 216.378.1490
FAX: 216.378.1497

PUTNAM COUNTY FSM FACILITY
FOR
OHIO DEPARTMENT OF
TRANSPORTATION
VILLAGE OF OTTAWA, OH 45875



REVISION SCHEDULE	
△	02/28/2025 - ADDENDUM #2

ISSUE DATE: 02/12/2025
JOB NUMBER: 240659

