



Ohio Department of Natural Resources

MIKE DEWINE, GOVERNOR

MARY MERTZ, DIRECTOR

Eric Vendel, Chief

Division of Oil and Gas Resources Management
2045 Morse Rd, Building F
Columbus, Ohio 43229
Phone: (614) 265-6922; Fax: (614) 265-6910

Via Certified Mail: 9489009000276354903499

ORDER BY THE CHIEF

September 2, 2021

ORDER NO. 2021-155

**TO: Ascent Resources - Utica, LLC
P.O. Box 13678
Oklahoma City, OK 73113**

**RE: Application for Unitization
Cricket E SHC HR Unit
Harrison and Jefferson Counties, Ohio**

**SUBJECT: Order for Unit Operations of the Utica/Point Pleasant Formations for the
Cricket E SHC HR Unit**

Pursuant to Ohio Revised Code (“R.C.”) § 1509.28, the Chief of the Division of Oil and Gas Resources Management (“Chief” or “Division”) makes the following Findings and issues the following Order with respect to Ascent Resources - Utica, LLC’s (“Ascent”) Application for Unit Operations for the Cricket E SHC HR Unit:

DEFINITIONS:

As used in this order:

- 1) “Person” has the same meaning as in R.C. § 1509.01.
- 2) “Application” means the application of Ascent Resources - Utica, LLC for Unit Operation of the Cricket E SHC HR Unit dated April 29, 2021, consisting of a minimum of a Unit Agreement, Model Form Operating Agreement, relevant exhibits, and pre-filed testimony from a geologist, a reservoir engineer, and a landman, and includes all updates, amendments, and supplements to it.

- 3) "Royalty interest owner" means a person or the estate of a person, other than a working interest owner, who owns the right to or interest in any portion of the oil and/or gas, or proceeds from the sale thereof, from a tract.
- 4) "Working interest" means an interest in oil and/or gas in the unit area by virtue of a lease, operating agreement, fee title, or otherwise, including a carried interest, the owner of which is obligated to pay, either in cash or out of production or otherwise a portion of the unit expense.
- 5) "Working interest owner" means a person or the estate of a person who owns an interest in oil and/or gas in the unit area by virtue of a lease, operating agreement, fee title, or otherwise, including a carried interest, the owner of which is obligated to pay, either in cash or out of production or otherwise a portion of the unit expense. "Working interest owner" does not include an unleased mineral owner.
- 6) "Unleased mineral owner" means a royalty interest owner who owns oil and/or gas rights free of a lease or other instrument conveying all or any portion of the working interest in such rights to another. At the time of this order, the unleased mineral owners identified by Ascent include those listed on Exhibit A for the corresponding tracts in the exhibit.
- 7) "Consenting working interest owner" means any working interest owner who enters into an agreement with Ascent pertaining to the operation of the Cricket E SHC HR Unit.
- 8) "Non-consenting working interest owner" means a working interest owner who does not enter into an agreement with Ascent pertaining to the operation of the Cricket E SHC HR Unit. At the time of this order, there are no non-consenting working interest owners identified by Ascent.
- 9) "Gas" has the same meaning as in R.C. § 1509.01.
- 10) "Oil" has the same meaning as in R.C. § 1509.01.
- 11) "Unit Area" means all of the lands, oil and gas leases and/or oil and gas interests of the tracts as shown in Exhibit B totaling 447.700 acres located in Short Creek, Green, and Smithfield Townships, in Harrison and Jefferson Counties, Ohio as shown in Exhibit C.
- 12) "Unit Participation" means the ratio of the surface acreage of a specific tract in the unit area to the total surface acreage of the unit area as that total surface acreage is specified in paragraph one of the Plan for Unit Operations of this order.
- 13) "Gross Proceeds" means a share of the gross production of oil, gas, condensate, and natural gas liquids free of any and all cost of producing, gathering, storing, separating, treating, dehydrating, compressing, processing, transporting, marketing, or pipeline construction and maintenance.

- 14) "Net Proceeds" means the share of gross production of oil, gas, condensate, or natural gas liquids after payment of all costs of producing, gathering, storing, separating, treating, dehydrating, compressing, processing, transporting, and marketing and taxes.

BACKGROUND:

- 1) Ascent filed the application pursuant to R.C. § 1509.28 to conduct unit operations of the Utica/Point Pleasant Formations. The unit operations will occur at an approximate true vertical depth located from 50 feet above the top of the Utica Shale to 50 feet below the base of the Point Pleasant Formation.
- 2) Pursuant to R.C. § 1509.28, the Division held a hearing on July 7, 2021 in Columbus, Ohio at the Ohio Department of Natural Resources ("ODNR"). The hearing was held to consider the need for the operation as a unit of an entire pool or part thereof. Ascent employees provided testimony on the application and answered questions from Division staff.

FINDINGS:

- 1) Based on the application and testimony by Ascent's employees, the Chief finds that Ascent has established that it is the "owner," as that term is defined in R.C. § 1509.01(K), of greater than 65% of the land area overlying the pool in the Cricket E SHC HR Unit as required by R.C. § 1509.28(A).
- 2) Based on the application and testimony by Ascent's employees, the Chief finds that the operation of the Cricket E SHC HR Unit is reasonably necessary to increase substantially the ultimate recovery of oil and gas.
- 3) Based on the application and testimony by Ascent's employees, the Chief finds the value of the estimated additional recovery of oil or gas from the Cricket E SHC HR Unit exceeds the estimated additional cost incident to conducting the operation of the Cricket E SHC HR Unit.

ORDER:

IT IS HEREBY ORDERED:

Pursuant to R.C. § 1509.28, Ascent is authorized to conduct operations within the Cricket E SHC HR Unit in accordance with all of the following:

Plan for Unit Operations

- 1) The unit area is comprised of the tracts totaling 447.700 acres in Short Creek, Green, and Smithfield Townships, in Harrison and Jefferson Counties, Ohio, as shown on Exhibit C.

- 2) Ascent proposes to drill one well in the Cricket E SHC HR Unit for the purpose of recovering oil and gas. Ascent shall drill at least one well to total measured depth as specified in the application in the unit area within 12 months from the date of approval of this Order as prescribed in Paragraph 10 of this order. If Ascent fails to drill at least one well to total measured depth as specified in the application in the unit area within 12 months from the date of approval of this Order as prescribed in Paragraph 10 of this order, the Chief may revoke this order. In order to achieve the stated goal of substantially increasing the ultimate recovery of oil and gas from the Utica/Point Pleasant Formations within the unit area, Ascent shall produce from one well no later than two years after the date of approval of this order. If Ascent fails to drill, complete, and produce at least one well in the unit area, the Chief may amend or terminate this order. Any additional wells permitted by the Chief for the Utica/Point Pleasant Formations in the unit area are subject to this order.
- 3) Evidence introduced by Ascent at the Cricket E SHC HR Unit hearing establishes that the Utica/Point Pleasant Formation uniformly underlies the unit area. Therefore, the allocated share of production to each tract shall be equal to that tract's unit participation.
- 4) Except as provided in Paragraph 9(d) of this order, all charges and credits made for investments in wells, tanks, pumps, machinery, materials, and equipment contributed to the Cricket E SHC HR unit operations shall be allocated among the working interest owners of each tract based on the unit participation. The proportionate share of the expenses attributable to tracts of the unleased mineral owners shall be allocated to Ascent and the working interest owners.
- 5) All unit operation expenses, including capital investment, shall be charged to, and paid by, Ascent and working interest owners in amounts based on the unit participation plus their proportionate share of the expenses attributable to the tracts of unleased mineral owners. All unit operation expenses concerning wells and operating equipment shall be just and reasonable.
- 6) If necessary, Ascent and the consenting working interest owners shall carry, or otherwise finance, any non-consenting working interest owners who are unable to meet their financial obligations in connection with the unit operations. Ascent and all other consenting working interest owners' reasonable interest charge for carrying or financing the non-consenting working interest owners shall be determined by the terms of Ascent's Unit Agreement and Model Form Operating Agreement for the Cricket E SHC HR Unit. Once a specific cost is charged to the initial well, that same cost cannot be charged to subsequent wells in the unit area.
- 7) Ascent shall supervise and conduct all unit operations. Each working interest owner shall have a voting interest equal to its Unit Participation. Approval of unit operations shall be subject to the terms of Ascent's Unit Agreement and Model Form Operating Agreement for the Cricket E SHC HR Unit.

- 8) Unit operations may commence as of 7:00 a.m. on the day following the date of approval of this order as prescribed in Paragraph 10 of this order. Once the initial well is placed into production, operations within the Cricket E SHC HR Unit may continue as long as hydrocarbons are produced from any well in the unit area without a cessation of more than 90 days, unless otherwise approved by the Chief in writing. The Cricket E SHC HR Unit may be terminated if working interest owners owning at least 51% of the working interest in the unit area determine that the unit operations are no longer warranted. If the unit operations are so terminated, Ascent shall provide written notice of the termination to the Division and to all unleased mineral owners. In addition to the notice of termination, Ascent shall provide an affidavit to the Division attesting to the basis of the termination and all dates applicable to that basis. If termination of unit operations occurs prior to drilling and completing for production of one well in the Cricket E SHC HR Unit, the Chief may amend this order.
- 9) The following additional provisions are found to be appropriate:
 - a) No activity associated with the drilling, completion, or operation of the Cricket E SHC HR Unit shall be conducted on the surface of any unleased property without the prior written consent of the owner of the surface rights of the unleased property.
 - b) Unleased mineral owners shall not incur liability for any personal or property damage associated with any drilling, testing, completing, producing, operating, or plugging and restoration activities within the Cricket E SHC HR Unit.
 - c) Each unleased mineral owner shall receive a monthly cash payment equal to a one-eighth share of the gross proceeds from production. Allocation of the one-eighth share shall be based on the unit participation of each unleased mineral owner's tract. Ascent shall make monthly cash payments to all unleased mineral owners at the same time the royalty interest owners are paid.
 - d) In addition to the cash payment specified in paragraph 9(c) of this Order, each unleased mineral owner shall receive a monthly cash payment equal to a seven-eighths share of the net proceeds from production. Allocation of the seven-eighths share shall be based on the unit participation of each unleased mineral owner's tract. After Ascent recovers 200% of the cost of drilling, testing, and completing the initial well, Ascent shall begin making the monthly payments to the unleased mineral owners for that well. For each additional well drilled in the unit area, Ascent shall begin making monthly payments equal to seven-eighths share of net proceeds from production to each unleased mineral owner once the working interest owners have recovered 150% of the cost of drilling, testing, and completing each additional well. Once a specific cost is charged to the initial well, that same cost cannot be charged to subsequent wells in the unit area.
 - e) Nothing in this order prohibits an unleased mineral owner from entering into a lease agreement with Ascent or with any other person. An unleased mineral owner who

enters into a lease of their mineral interests with any person after the issuance of this order is no longer an unleased mineral owner under this order as of the effective date of the lease. Ascent shall notify the Division upon the execution of a lease agreement with any unleased mineral owner who is subject to this order.

- f) Except as provided in Paragraph 9(d) of this order, no expenses shall be paid by an unleased mineral owner for drilling, testing, completing, producing, or operating any well in the unit area. Moreover, unleased mineral owners are not responsible for any costs related to plugging any well or any restoration in the unit area.
- g) If requested in writing by any unleased mineral owner or by any non-consenting working interest owner, or in any manner by the Division, Ascent shall provide, not later than 30 days after the request, any of the following:
 - i. A monthly statement of all costs incurred, together with the quantity of oil and gas produced, and the amount of proceeds realized from the sale of production during the preceding month; and
 - ii. Any authorization for expenditure (AFE) prepared by Ascent; and
 - iii. A statement of all costs and expenses for purposes of Paragraphs 6 and 9(d) of this order.
- h) Ascent shall notify the Division of the assignment or transfer of any of its working interest in the Cricket E SHC HR Unit. If Ascent assigns or transfers any of its working interest, the assignee or transferee shall comply with this order. Within 60 days of the notice of assignment or transfer, Ascent shall file a copy of the notice with the Harrison and Jefferson Counties (Ohio) Recorder's Office, in the records of each of the tracts that are subject to this order and referenced in Exhibit C of this order. Ascent shall submit a certification of the filing to the Division within 14 days of filing.
- i) Ascent shall notify the Division within 30 days if a person that is leased by Ascent, or any other consenting working interest owner, for purposes of operating the Cricket E SHC HR Unit becomes unleased. If a person becomes unleased, the person is an unleased owner under this order and paragraphs 9(a) through 9(g) of this order apply.

- j) Ascent shall notify the Division if any consenting working interest owner revokes, rescinds, or otherwise terminates the agreement with Ascent pertaining to the operation of the Cricket E SHC HR Unit. If a consenting working interest owner revokes, rescinds, or otherwise terminates the agreement with Ascent, the working interest owner becomes a non-consenting working interest owner pursuant to this order. Ascent also shall notify the Division if any consenting working interest owner assigns or transfers all or part of its working interest in the Cricket E SHC HR Unit. All such assignees or transferees are subject to this order.
 - k) Ascent shall notify the Division if any non-consenting working interest owner enters into an agreement with Ascent pertaining to the operation of the Cricket E SHC HR Unit. If a non-consenting working interest owner enters into an agreement with Ascent, the non-consenting working interest owner becomes a consenting working interest owner pursuant to this order.
 - l) If at any point Ascent and consenting working interest owners own less than 65% of the unit, the Chief may amend or terminate this order.
- 10) This order becomes effective on the date Ascent provides the Chief with final written approval of the unit operations as prescribed in this order by Ascent and consenting working interest owners, and also by the royalty interest owners or, with respect to unleased acreage, unleased mineral owners of 65% of the acreage to be included in the unit. Unit operations may commence as set forth in Paragraph 8 of this Order. If Ascent fails to provide all required approvals by March 2, 2022, the order is revoked, and the Chief shall provide notice of the revocation to Ascent and to all persons listed in Exhibit B to this order.
 - 11) If this Chief's Order is appealed, the time periods specified in this order are tolled pending final determination of the appeal.
 - 12) Within 21 days of this order becoming effective, Ascent shall file a copy of this order with the Harrison and Jefferson Counties (Ohio) Recorder's Office, in the records of each of the tracts that are subject to this order and referenced in Exhibit C of this order. Ascent shall submit a certification of the filing to the Division within 14 days of filing. The certification shall include a reference to the volume and page number corresponding to each record where the Chief's Order is recorded.
 - 13) The Chief of the Division retains continuing jurisdiction over the Cricket E SHC HR Unit as is consistent with the Chief's powers and duties as established by R.C. Chapter 1509 and Ohio Admin. Code 1501:9. The Chief reserves the right to amend or terminate this Order subsequent to the commencement of unit operations within the unit area.
 - 14) Except as specifically set forth in the terms of this order, nothing herein shall be construed as a release or waiver of any private right, obligation, duty, claim, or cause of action.

- 15) If there is a conflict between this Chief's Order and Ascent's Unit Agreement and Model Form Operating Agreement attached to the application, this Chief's Order takes precedence.

September 2, 2021

Date

/s/ Eric Vendel

Eric Vendel, Chief

Division of Oil and Gas Resources Management

Addressee is hereby notified that this action is final and effective and may be appealed pursuant to Section 1509.36 of the Ohio Revised Code. If the Order is appealed to the Ohio Oil and Gas Commission, the appeal must be in writing and must set forth the Orders complained of and the grounds upon which the appeal is based. Such appeal must be filed with the Oil and Gas Commission, 2045 Morse Road, Building E-1, Office 103, Columbus, Ohio 43229-6693, within 30 days after the date upon which the person to whom the Order was issued received the order and, for all other persons adversely affected by the order, within 30 days after the date of the Order.

In addition, within three days after the appeal is filed with the Oil and Gas Commission, notice of the filing must be submitted to Eric Vendel, Chief, Division of Oil and Gas Resources Management, Ohio Department of Natural Resources, 2045 Morse Road, Building F, Columbus, Ohio 43229-6693.

Enclosures: Exhibit A
Exhibit B
Exhibit C – C-3

Exhibit A

Unleased Mineral Owners

Tract Number	Lease ID Number (optional)	Unleased Mineral Owner	Leased Yes or No	Decimal Interest in Tract	Surface Acres in Unit	Tract Participation in Unit	Tax Map Parcel ID	Tract Surface Use	Township	County	Address	City	State	Zip
4a	N/A	ROBERT PAUL DAINO	NO	0.500000	0.0020	0.000447%	31-00000-000	RESIDENTIAL	SMITHFIELD	JEFFERSON	1510 AQUINO LANE	LADY LAKE	FL	32159
4a	N/A	ANTHONY L. FALCICCHIO	NO	0.250000	0.0010	0.000223%	31-00000-000	RESIDENTIAL	SMITHFIELD	JEFFERSON	114 FRANCES ST.	ALBANY	NY	13021
4a	N/A	LINDA R. LITTLEJOHN FKA LINDA R. FALCICCHIO	NO	0.250000	0.0010	0.000223%	31-00000-000	RESIDENTIAL	SMITHFIELD	JEFFERSON	3920 CHASE RD.	UNION SPRINGS	NY	13160
8	N/A	JOSEPH NAGY, JR	NO	0.055556	0.0117	0.002618%	31-02525-000	RESIDENTIAL	SMITHFIELD	JEFFERSON	610 MAIN STREET	MCCLURE	OH	43534
8	N/A	MARY ELLEN NAGY	NO	0.055556	0.0117	0.002618%	31-02525-000	RESIDENTIAL	SMITHFIELD	JEFFERSON	13518 SHERRY AVENUE 1530 BAYTHORN DRIVE	CLEVELAND WESLEY CHAPEL	OH FL	44135 33543
8	N/A	WILLIAM NAGY	NO	0.055556	0.0117	0.002618%	31-02525-000	RESIDENTIAL	SMITHFIELD	JEFFERSON	1064 WEST RIVER ROAD	VALLEY CITY	OH	44280
8	N/A	THE SWEDEN FAMILY TRUST, CREATED BY TRUST AGREEMENT DATED DECEMBER 13, 1978 ATTN: FIRST NATIONAL BANK IN DALLAS, AS TRUSTEE	NO	0.025926	0.0055	0.001222%	31-02525-000	RESIDENTIAL	SMITHFIELD	JEFFERSON	5500 PRESTON ROAD	DALLAS	TX	75205
8	N/A	SCOTT A. SWEDEN	NO	0.003704	0.0008	0.000175%	31-02525-000	RESIDENTIAL	SMITHFIELD	JEFFERSON	2315 OAKWOOD DRIVE	CARROLLTON	TX	75006
8	N/A	JAMES A. SWEDEN	NO	0.033333	0.0070	0.001571%	31-02525-000	RESIDENTIAL	SMITHFIELD	JEFFERSON	47 FOUR ROD ROAD	BERLIN	CT	06037
8	N/A	SHERRY SROKA	NO	0.020370	0.0043	0.000960%	31-02525-000	RESIDENTIAL	SMITHFIELD	JEFFERSON	9697 ROUNDSTONE CIRCLE	FORT MYERS	FL	33967
8	N/A	KENNETH ALLEN	NO	0.012963	0.0027	0.000611%	31-02525-000	RESIDENTIAL	SMITHFIELD	JEFFERSON	33 HILL STREET	ADENA	OH	43901
8	N/A	MARK EDWARD SWEDEN AKA MARK EDWARD ALLEN	NO	0.020370	0.0043	0.000960%	31-02525-000	RESIDENTIAL	SMITHFIELD	JEFFERSON	6109 ALBERT AVENUE, APT 101	NORTH RIDGEVILLE	OH	44039
8	N/A	BRIAN PUMMELL	NO	0.002469	0.0005	0.000116%	31-02525-000	RESIDENTIAL	SMITHFIELD	JEFFERSON	4305 MCNAUL ROAD	MANSFIELD	OH	44903
8	N/A	RYAN E. SWEDEN	NO	0.051440	0.0109	0.002424%	31-02525-000	RESIDENTIAL	SMITHFIELD	JEFFERSON	C/O MARJORIE CARROTHERS 86105 NORTH BAY ROAD CALLE ALCALA MZ J IOTE 15 URBANIZACIIN MAYORAZGI CUARTA ETAPA ATE	SCIO LIMA	OH PERU	43988 N/A
8	N/A	MARVIN KETCHEM	NO	0.041667	0.0088	0.001964%	31-02525-000	RESIDENTIAL	SMITHFIELD	JEFFERSON	5502 EAST BAYWOOD AVENUE	MESA	AZ	85206
8	N/A	THOMAS KETCHEM	NO	0.041667	0.0088	0.001964%	31-02525-000	RESIDENTIAL	SMITHFIELD	JEFFERSON	3371 SOUTHERN ROAD	RICHFIELD	OH	44286
8	N/A	MOLLY MACIEJEWSKI	NO	0.041667	0.0088	0.001964%	31-02525-000	RESIDENTIAL	SMITHFIELD	JEFFERSON	1220 CENTER ROAD, #135	HINCKLEY	OH	44233
8	N/A	DONALD SWEDINOVICH, JR.	NO	0.083333	0.0176	0.003927%	31-02525-000	RESIDENTIAL	SMITHFIELD	JEFFERSON	139 IDAHO DRIVE	ELYRIA	OH	44035
8	N/A	DOUGLAS SWEDINOVICH	NO	0.083333	0.0176	0.003927%	31-02525-000	RESIDENTIAL	SMITHFIELD	JEFFERSON	5445 ALTOONA STREET	LAS VEGAS	NV	89122
11	N/A	LINDA COLEMAN	NO	0.333333	0.6827	0.152483%	30-01102-000	RESIDENTIAL	SMITHFIELD	JEFFERSON	76 HAMILTON STREET	ADENA	OH	43901
16	N/A	ERNEST J. CUNNINGHAM	NO	1.000000	0.5970	0.133348%	30-00718-000	RESIDENTIAL	SMITHFIELD	JEFFERSON	49930 BLAIRMONT ROAD	ADENA	OH	43901
23	N/A	KAREN LOU VANEK	NO	0.125000	0.1205	0.026915%	25-0000176000	RESIDENTIAL	SHORT CREEK	HARRISON	132 FLORAL AVENUE NORTHWEST	CANTON	OH	44708
23	N/A	THOMAS R. AINSCOUGH	NO	0.083333	0.0803	0.017944%	25-0000176000	RESIDENTIAL	SHORT CREEK	HARRISON	189 MCMAKIN STREET	SUMMERVILLE	SC	29483
26a	N/A	THOMAS R. AINSCOUGH	NO	0.041667	0.0264	0.005891%	25-0000000000	RESIDENTIAL	SHORT CREEK	HARRISON	189 MCMAKIN STREET	SUMMERVILLE	SC	29483
26a	N/A	KAREN LOU VANEK	NO	0.062500	0.0396	0.008837%	25-0000000000	RESIDENTIAL	SHORT CREEK	HARRISON	132 FLORAL AVENUE NORTHWEST	CANTON	OH	44708
26a	N/A	THOMAS G. DURBIN	NO	0.013889	0.0088	0.001964%	25-0000000000	RESIDENTIAL	SHORT CREEK	HARRISON	936 LONGVIEW CIR	ADAMSVILLE	AL	35005
26a	N/A	KIMBERLY L. STASKEY	NO	0.031746	0.0201	0.004489%	25-0000000000	RESIDENTIAL	SHORT CREEK	HARRISON	3855 HARRISON STREET	BELLAIRE	OH	43906
27	N/A	KAREN LOU VANEK	NO	0.125000	0.4493	0.100346%	25-0000177000	RESIDENTIAL	SHORT CREEK	HARRISON	132 FLORAL AVENUE NORTHWEST	CANTON	OH	44708
27	N/A	THOMAS R. AINSCOUGH	NO	0.083333	0.2995	0.066897%	25-0000177000	RESIDENTIAL	SHORT CREEK	HARRISON	189 MCMAKIN STREET	SUMMERVILLE	SC	29483
30a	N/A	ERNEST J. CUNNINGHAM	NO	1.000000	0.3920	0.087559%	25-0000204000	RESIDENTIAL	SHORT CREEK	HARRISON	49930 BLAIRMONT ROAD	ADENA	OH	43901
30b	N/A	ERNEST J. CUNNINGHAM	NO	1.000000	0.2870	0.064105%	25-0000204000	RESIDENTIAL	SHORT CREEK	HARRISON	49930 BLAIRMONT ROAD	ADENA	OH	43901

65a	N/A	GOODMAN MASH	NO	0.004630	0.0005	0.000114%	25-0000214000	RESIDENTIAL	SHORT CREEK	HARRISON	3793 CAYUGAS DRIVE	AKRON	OH	44319
65a	N/A	PATRICIA L WHITEMAN	NO	0.004630	0.0005	0.000114%	25-0000214000	RESIDENTIAL	SHORT CREEK	HARRISON	140 HILLTOP DRIVE	SCIO	OH	43988
65a	N/A	BARBARA A HOLYAK	NO	0.027778	0.0031	0.000683%	25-0000214000	RESIDENTIAL	SHORT CREEK	HARRISON	12200 EDEN AVENUE	HUDSON	FL	34667
65a	N/A	LARRY HOLYAK	NO	0.007576	0.0008	0.000186%	25-0000214000	RESIDENTIAL	SHORT CREEK	HARRISON	4056 UNION CHURCH ROAD	SALISBURY	MD	21804
65b	N/A	GOODMAN MASH	NO	0.004630	0.0017	0.000371%	25-0000214000	RESIDENTIAL	SHORT CREEK	HARRISON	3793 CAYUGAS DRIVE	AKRON	OH	44319
65b	N/A	PATRICIA L WHITEMAN	NO	0.004630	0.0017	0.000371%	25-0000214000	RESIDENTIAL	SHORT CREEK	HARRISON	140 HILLTOP DRIVE	SCIO	OH	43988
65b	N/A	BARBARA A HOLYAK	NO	0.027778	0.0100	0.002227%	25-0000214000	RESIDENTIAL	SHORT CREEK	HARRISON	12200 EDEN AVENUE	HUDSON	FL	34667
65b	N/A	LARRY HOLYAK	NO	0.007576	0.0027	0.000607%	25-0000214000	RESIDENTIAL	SHORT CREEK	HARRISON	4056 UNION CHURCH ROAD	SALISBURY	MD	21804
77	N/A	CLAUDE E .DENNO	NO	0.053571	0.0415	0.009274%	25-0000194000	RESIDENTIAL	SHORT CREEK	HARRISON	15093 RIVER ROAD	BUCHANAN	MI	49107
77	N/A	ROSEMARY A. LOLLAR	NO	0.053571	0.0415	0.009274%	25-0000194000	RESIDENTIAL	SHORT CREEK	HARRISON	15081 RIVER ROAD	BUCHANAN	MI	49107
77	N/A	KEVIN HATFIELD	NO	0.053571	0.0415	0.009274%	25-0000194000	RESIDENTIAL	SHORT CREEK	HARRISON	1380 NELSON ROAD	ST. JOSEPH	MI	49085
77	N/A	DANIEL T. PIHULIC	NO	0.017857	0.0138	0.003091%	25-0000194000	RESIDENTIAL	SHORT CREEK	HARRISON	12019 BIRCHVIEW DRIVE, SUITE 100	CLINTON	MD	20735
77	N/A	DENNIS G. BRADO	NO	0.035714	0.0277	0.006182%	25-0000194000	RESIDENTIAL	SHORT CREEK	HARRISON	PO BOX 5505	PALM SPRINGS	CA	92263
77	N/A	JENNIFER L. BUCKNER	NO	0.053571	0.0415	0.009274%	25-0000194000	RESIDENTIAL	SHORT CREEK	HARRISON	1912 OXFORD DRIVE	HENDERSONVILLE	NC	28792
77	N/A	KRISTEN E. RIDDER	NO	0.026786	0.0208	0.004637%	25-0000194000	RESIDENTIAL	SHORT CREEK	HARRISON	22011 W. MILLER COURT	PLAINFIELD	IL	60544
77	N/A	SKYLAR YEAGER	NO	0.026786	0.0208	0.004637%	25-0000194000	RESIDENTIAL	SHORT CREEK	HARRISON	22011 W. MILLER COURT	PLAINFIELD	IL	60544
77	N/A	JAMES S. KESSLER	NO	0.053571	0.0415	0.009274%	25-0000194000	RESIDENTIAL	SHORT CREEK	HARRISON	1805 KILARNEY LANE	NILES	MI	49120
77	N/A	JON C. GAUNDER	NO	0.008929	0.0069	0.001546%	25-0000194000	RESIDENTIAL	SHORT CREEK	HARRISON	2191 MCCORMICK TRAIL	STEVENSVILLE	MI	49127
77	N/A	CRAIG GAST	NO	0.017857	0.0138	0.003091%	25-0000194000	RESIDENTIAL	SHORT CREEK	HARRISON	5820 TRAILWOOD DRIVE	SALIDA	CA	95368
77	N/A	LATICIA BENTON	NO	0.017857	0.0138	0.003091%	25-0000194000	RESIDENTIAL	SHORT CREEK	HARRISON	13433 E. SHAW AVENUE	SANGER	CA	93657
77	N/A	MARY SUSAN GAST	NO	0.035714	0.0277	0.006182%	25-0000194000	RESIDENTIAL	SHORT CREEK	HARRISON	766 WEST J STREET	BENICIA	CA	94510
77	N/A	THE UNKNOWN HEIRS OF WILLIAM ROULIS	NO	0.250000	0.1938	0.043277%	25-0000194000	RESIDENTIAL	SHORT CREEK	HARRISON	UNKNOWN	UNKNOWN	UNKNOWN	UNKNOWN
86	N/A	POCAHONTAS LAND, LLC FKA POCAHONTAS LAND CORPORATION ATTN: MICHAEL BLACKBURN	NO	1.000000	0.6170	0.137816%	25-0000268000	RESIDENTIAL	SHORT CREEK	HARRISON	P.O. BOX 1517	BLUEFIELD	WV	24701

87	N/A	KIMBERLY S. CATE	NO	0.033333	0.0276	0.006165%	25-0000248000	RESIDENTIAL	SHORT CREEK	HARRISON	2111 PRESLEY DRIVE	GROVE CITY	OH	43123
87	N/A	EDWIN DEHNART	NO	0.027778	0.0230	0.005137%	25-0000248000	RESIDENTIAL	SHORT CREEK	HARRISON	2100 LAKESIDE AVENUE EAST	CLEVELAND	OH	44114
105c	N/A	THE MARGARET E. SALTSMAN TRUST UAD 9/14/98 ATTN: LINDA CHUGH ULINSKI, TRUSTEE	NO	0.500000	0.0040	0.000893%	25-0000000000	RESIDENTIAL	SHORT CREEK	HARRISON	1650 W. MARKET STREET, STE #32	AKRON	OH	44313
				Total Unleased Acres:	4.3789	0.978099%								
				Total Unit Acres:	447.7000									

Tracts 26a, 26b, 26c, 38, 44a, 44b, 57, 105a, 105b, and 105c are all identified as being Tax Parcel 25-0000000000. This is intentional and is the result of the county attributing these tracts the Short Creek Township generic tax parcel number.

Exhibit B

Tract Number	Lease ID Number (optional)	Mineral Owner	Leased Yes or No	Decimal Interest in Tract	Surface Acres in Unit	Tract Participation in Unit	Tax Map Parcel ID	Township	County	Committed Working Interest Percentage	Applicant Working Interest Percentage	XTO Energy Inc. Working Interest Percentage	Address	City	State	Zip
1	UTC006722000	BEDWAY LAND AND MINERALS COMPANY ATTN: JONATHAN BEDWAY	YES	1.000000	16.5920	3.706053%	30-01801-000	SMITHFIELD	JEFFERSON	3.706053%	3.520751%	0.185303%	67877 PANCOAST ROAD NORTH	BELMONT	OH	43718
2	UTC006722000	BEDWAY LAND AND MINERALS COMPANY ATTN: JONATHAN BEDWAY	YES	1.000000	0.1960	0.043779%	31-02593-000	SMITHFIELD	JEFFERSON	0.043779%	0.041590%	0.002189%	67877 PANCOAST ROAD NORTH	BELMONT	OH	43718
3	UTC025902000	WHEELING & LAKE ERIE RAILWAY COMPANY ATTN: JEFF DAVIS, JR.	YES	1.000000	0.2900	0.064776%	31-00000-000	SMITHFIELD	JEFFERSON	0.064776%	0.064776%	0.000000%	100 E. FIRST STREET	BREWSTER	OH	44613
4a	N/A	ROBERT PAUL DAINO	NO	0.500000	0.0020	0.000447%	31-00000-000	SMITHFIELD	JEFFERSON	0.000000%	0.000000%	0.000000%	1510 AQUINO LANE	LADY LAKE	FL	32159
4a	N/A	ANTHONY L. FALCICCHIO	NO	0.250000	0.0010	0.000223%	31-00000-000	SMITHFIELD	JEFFERSON	0.000000%	0.000000%	0.000000%	114 FRANCES ST.	ALBANY	NY	13021
4a	N/A	LINDA R. LITTLE/JOHN FKA LINDA R. FALCICCHIO	NO	0.250000	0.0010	0.000223%	31-00000-000	SMITHFIELD	JEFFERSON	0.000000%	0.000000%	0.000000%	3920 CHASE RD.	UNION SPRINGS	NY	13160
4b	UTC025902000	WHEELING & LAKE ERIE RAILWAY COMPANY ATTN: JEFF DAVIS, JR.	YES	1.000000	0.0180	0.004021%	31-00000-000	SMITHFIELD	JEFFERSON	0.004021%	0.004021%	0.000000%	100 E. FIRST STREET	BREWSTER	OH	44613
5	UTC019736000	STEPHEN L. POTKOSKI AND MARLENE F. POTKOSKI, AS SURVIVORSHIP TENANTS	YES	1.000000	0.0030	0.000670%	31-02469-000	SMITHFIELD	JEFFERSON	0.000670%	0.000670%	0.000000%	429 BLAIRMONT ROAD	ADENA	OH	43901
6	UTC019735000	BARRY HARUBIN	YES	1.000000	0.1400	0.031271%	31-02383-000	SMITHFIELD	JEFFERSON	0.031271%	0.031271%	0.000000%	9 HILL STREET	ADENA	OH	43901
7	UTC020192000	CAROL S. HILL	YES	1.000000	0.1580	0.035291%	31-02414-000	SMITHFIELD	JEFFERSON	0.035291%	0.035291%	0.000000%	15 HILL STREET	ADENA	OH	43901
8	N/A	JOSEPH NAGY, JR	NO	0.055556	0.0117	0.002618%	31-02525-000	SMITHFIELD	JEFFERSON	0.000000%	0.000000%	0.000000%	610 MAIN STREET	MCCLURE	OH	43534
8	N/A	MARY ELLEN NAGY	NO	0.055556	0.0117	0.002618%	31-02525-000	SMITHFIELD	JEFFERSON	0.000000%	0.000000%	0.000000%	13518 SHERRY AVENUE	CLEVELAND	OH	44135
8	N/A	WILLIAM NAGY	NO	0.055556	0.0117	0.002618%	31-02525-000	SMITHFIELD	JEFFERSON	0.000000%	0.000000%	0.000000%	1530 BAYTHORN DRIVE	WESLEY CHAPEL	FL	33543
8	UTC025634001	JOLLEEN SZILAGYI	YES	0.055556	0.0117	0.002618%	31-02525-000	SMITHFIELD	JEFFERSON	0.002618%	0.002618%	0.000000%	1064 WEST RIVER ROAD	VALLEY CITY	OH	44280
8	UTC025637001	EMILY DUNNFFEE	YES	0.055556	0.0117	0.002618%	31-02525-000	SMITHFIELD	JEFFERSON	0.002618%	0.002618%	0.000000%	6761 PARK BLVD. N, APT 415	PINELLAS PARK	FL	33781
8	UTC025636001	EVELYN KANOSKI	YES	0.055556	0.0117	0.002618%	31-02525-000	SMITHFIELD	JEFFERSON	0.002618%	0.002618%	0.000000%	368 A. ROSSER AVE.	BELLAIRE	OH	43906
8	N/A	THE SWEDEN FAMILY TRUST, CREATED BY TRUST AGREEMENT DATED DECEMBER 13, 1978 ATTN: FIRST NATIONAL BANK IN DALLAS, AS TRUSTEE	NO	0.025926	0.0055	0.001222%	31-02525-000	SMITHFIELD	JEFFERSON	0.000000%	0.000000%	0.000000%	365 COUNTY RD. 10	DILLONVALE	OH	43917
8	UTC025682001	CHRISTOPHER JOSEPH SWEDEN	YES	0.003704	0.0008	0.000175%	31-02525-000	SMITHFIELD	JEFFERSON	0.000175%	0.000175%	0.000000%	5500 PRESTON ROAD	DALLAS	TX	75205
8	N/A	SCOTT A. SWEDEN	NO	0.003704	0.0008	0.000175%	31-02525-000	SMITHFIELD	JEFFERSON	0.000000%	0.000000%	0.000000%	2315 OAKWOOD DRIVE	CARROLLTON	TX	75006
8	UTC027715000	ASCENT UTICA MINERALS, LLC ATTN: MIKE MCLAUGHLIN	YES	0.033333	0.0070	0.001571%	31-02525-000	SMITHFIELD	JEFFERSON	0.001571%	0.001571%	0.000000%	3501 N.W. 63RD ST	OKLAHOMA CITY	OK	73116
8	N/A	JAMES A. SWEDEN	NO	0.033333	0.0070	0.001571%	31-02525-000	SMITHFIELD	JEFFERSON	0.000000%	0.000000%	0.000000%	47 FOUR ROD ROAD	BERLIN	CT	06037
8	UTC026576001	LOUIS FERENCHAK	YES	0.012963	0.0027	0.000611%	31-02525-000	SMITHFIELD	JEFFERSON	0.000611%	0.000611%	0.000000%	7643 ALBION RD.	NORTH ROYALTON	OH	44133
8	N/A	SHERRY SROKA	NO	0.020370	0.0043	0.000960%	31-02525-000	SMITHFIELD	JEFFERSON	0.000000%	0.000000%	0.000000%	9697 ROUNDSTONE CIRCLE	FORT MYERS	FL	33967
8	N/A	KENNETH ALLEN	NO	0.012963	0.0027	0.000611%	31-02525-000	SMITHFIELD	JEFFERSON	0.000000%	0.000000%	0.000000%	33 HILL STREET	ADENA	OH	43901
8	N/A	MARK EDWARD SWEDEN AKA MARK EDWARD ALLEN	NO	0.020370	0.0043	0.000960%	31-02525-000	SMITHFIELD	JEFFERSON	0.000000%	0.000000%	0.000000%	6109 ALBERT AVENUE, APT 101	NORTH RIDGEVILLE	OH	44039
8	UTC025687001	RALPH CLARK	YES	0.002469	0.0005	0.000116%	31-02525-000	SMITHFIELD	JEFFERSON	0.000116%	0.000116%	0.000000%	1120 WESTVIEW AVE.	ASHLAND	OH	44805
8	UTC025631001	AUDREY OUSLEY	YES	0.002469	0.0005	0.000116%	31-02525-000	SMITHFIELD	JEFFERSON	0.000116%	0.000116%	0.000000%	23 HOWARDSMITH BLVD, APT. B	BELLVILLE	OH	44813
8	UTC026629001	DEBORAH EVERETT	YES	0.002469	0.0005	0.000116%	31-02525-000	SMITHFIELD	JEFFERSON	0.000116%	0.000116%	0.000000%	200 JUMPER DR. S, APT 13	BUSHNELL	FL	33513
8	UTC025899001	LINDA KLINE	YES	0.002469	0.0005	0.000116%	31-02525-000	SMITHFIELD	JEFFERSON	0.000116%	0.000116%	0.000000%	516 R. EVERGREEN ST.	ASHLAND	OH	44805
8	N/A	BRIAN PUMMELL	NO	0.002469	0.0005	0.000116%	31-02525-000	SMITHFIELD	JEFFERSON	0.000000%	0.000000%	0.000000%	4305 MCNAUL ROAD	MANSFIELD	OH	44903
8	UTC026132001	BONNIE JEAN MILLS WARREN	YES	0.051440	0.0109	0.002424%	31-02525-000	SMITHFIELD	JEFFERSON	0.002424%	0.002424%	0.000000%	118 AMHURST ST.	VICTORIA	TX	77904
8	UTC025766001	MARJORIE ANN CARROTHERS	YES	0.051440	0.0109	0.002424%	31-02525-000	SMITHFIELD	JEFFERSON	0.002424%	0.002424%	0.000000%	86105 N BAY RD.	SCIO	OH	43988
8	N/A	RYAN E. SWEDEN	NO	0.051440	0.0109	0.002424%	31-02525-000	SMITHFIELD	JEFFERSON	0.000000%	0.000000%	0.000000%	C/O MARJORIE CARROTHERS 86105 NORTH BAY ROAD	SCIO	OH	43988
8	N/A	MARVIN KETCHEM	NO	0.041667	0.0088	0.001964%	31-02525-000	SMITHFIELD	JEFFERSON	0.000000%	0.000000%	0.000000%	CALLE ALCALA MZ J IOTE 15 URBANIZACIN MAYORAZGI CUARTA ETAPA ATE	LIMA	PERU	N/A
8	UTC026363001	LINDA KETCHEM WEBB	YES	0.041667	0.0088	0.001964%	31-02525-000	SMITHFIELD	JEFFERSON	0.001964%	0.001964%	0.000000%	5502 EAST BAYWOOD AVENUE	MESA	AZ	85206
8	N/A	THOMAS KETCHEM	NO	0.041667	0.0088	0.001964%	31-02525-000	SMITHFIELD	JEFFERSON	0.000000%	0.000000%	0.000000%	8227 LAUREL RUN DR.	CHARLOTTE	NC	28269
8	N/A	MOLLY MACIEJEWSKI	NO	0.041667	0.0088	0.001964%	31-02525-000	SMITHFIELD	JEFFERSON	0.000000%	0.000000%	0.000000%	3371 SOUTHERN ROAD	RICHFIELD	OH	44286
8	N/A	DONALD SWEDINOVICH, JR.	NO	0.083333	0.0176	0.003927%	31-02525-000	SMITHFIELD	JEFFERSON	0.000000%	0.000000%	0.000000%	1220 CENTER ROAD, #135	HINCKLEY	OH	44233
8	N/A	DOUGLAS SWEDINOVICH	NO	0.083333	0.0176	0.003927%	31-02525-000	SMITHFIELD	JEFFERSON	0.000000%	0.000000%	0.000000%	139 IDAHO DRIVE	ELYRIA	OH	44035
9	UTC021427000	MARK EDWARD SWEDEN	YES	1.000000	0.2080	0.046460%	31-02517-000	SMITHFIELD	JEFFERSON	0.046460%	0.046460%	0.000000%	5445 ALTOONA STREET	LAS VEGAS	NV	89122
10	UTC027715000	ASCENT UTICA MINERALS, LLC ATTN: MIKE MCLAUGHLIN	YES	1.000000	0.5030	0.112352%	30-01614-000	SMITHFIELD	JEFFERSON	0.112352%	0.112352%	0.000000%	6109 ALBERT AVENUE, APT #101	NORTH RIDGEVILLE	OH	44039
11	UTC027715000	ASCENT UTICA MINERALS, LLC ATTN: MIKE MCLAUGHLIN	YES	0.333333	0.6827	0.152483%	30-01102-000	SMITHFIELD	JEFFERSON	0.152483%	0.152483%	0.000000%	3501 N.W. 63RD ST	OKLAHOMA CITY	OK	73116

11	UTC027715000	ASCENT UTICA MINERALS, LLC ATTN: MIKE MCLAUGHLIN	YES	0.333333	0.6827	0.152483%	30-01102-000	SMITHFIELD	JEFFERSON	0.152483%	0.152483%	0.000000%	3501 N.W. 63RD ST	OKLAHOMA CITY	OK	73116
11	N/A	LINDA COLEMAN	NO	0.333333	0.6827	0.152483%	30-01102-000	SMITHFIELD	JEFFERSON	0.000000%	0.000000%	0.000000%	76 HAMILTON STREET	ADENA	OH	43901
12	UTC025902000	WHEELING & LAKE ERIE RAILWAY COMPANY ATTN: JEFF DAVIS, JR.	YES	1.000000	2.2640	0.505696%	30-00000-000	SMITHFIELD	JEFFERSON	0.505696%	0.505696%	0.000000%	100 E. FIRST STREET	BREWSTER	OH	44613
13	UTC024966000	CURTIS R. TSCHAPPAT AND CYNTHIA L. TSCHAPPAT, AS SURVIVORSHIP TENANTS	YES	1.000000	0.4190	0.093589%	31-02513-000	SMITHFIELD	JEFFERSON	0.093589%	0.093589%	0.000000%	61 HILL STREET	ADENA	OH	43901
14	UTC028345001	DELORIS K. MARTIN	YES	0.333333	0.1200	0.026804%	31-02065-000	SMITHFIELD	JEFFERSON	0.026804%	0.026804%	0.000000%	2912 STEPP DR.	COLUMBIA	SC	29204
14	UTC027715000	ASCENT UTICA MINERALS, LLC ATTN: MIKE MCLAUGHLIN	YES	0.333333	0.1200	0.026804%	31-02065-000	SMITHFIELD	JEFFERSON	0.026804%	0.026804%	0.000000%	3501 N.W. 63RD ST	OKLAHOMA CITY	OK	73116
14	PENDING	PATRICIA ANN VARGO	YES	0.125000	0.0450	0.010051%	31-02065-000	SMITHFIELD	JEFFERSON	0.010051%	0.010051%	0.000000%	9919 COPPER BEECH CIRCLE	FREDERICKSBURG	VA	22407
14	PENDING	MARY MARGARET SMITH	YES	0.125000	0.0450	0.010051%	31-02065-000	SMITHFIELD	JEFFERSON	0.010051%	0.010051%	0.000000%	2533 CLEVELAND AVE.	STEBENVILLE	OH	43952
14	UTC026620001	JENNIFER BOAMAN	YES	0.041667	0.0150	0.003350%	31-02065-000	SMITHFIELD	JEFFERSON	0.003350%	0.003350%	0.000000%	442 PLANTERS TRACE DRIVE	CHARLESTON	SC	29412
14	UTC026303001	STEVEN GALLO	YES	0.041667	0.0150	0.003350%	31-02065-000	SMITHFIELD	JEFFERSON	0.003350%	0.003350%	0.000000%	1570 DUNNES LANE	CHARLESTON	SC	29407
15	UTC012264000	JOHN PILLA	YES	0.500000	1.6125	0.360174%	30-01799-000	SMITHFIELD	JEFFERSON	0.360174%	0.360174%	0.000000%	13194 MEADOW STREET	ALLIANCE	OH	44601
15	UTC012266000	GLEND A DEBICK	YES	0.500000	1.6125	0.360174%	30-01799-000	SMITHFIELD	JEFFERSON	0.360174%	0.360174%	0.000000%	1129 CHAPARRAL DRIVE	LADY LAKES	FL	32159
16	N/A	ERNEST J. CUNNINGHAM	NO	1.000000	0.5970	0.113348%	30-00718-000	SMITHFIELD	JEFFERSON	0.000000%	0.000000%	0.000000%	49930 BLAIRMONT ROAD	ADENA	OH	43901
17	UTC018795000	JOSIE NEUBERT	YES	1.000000	0.2850	0.063659%	30-01135-000	SMITHFIELD	JEFFERSON	0.063659%	0.063659%	0.000000%	679 BLAIRMONT RD.	ADENA	OH	43901
18	UTC018795000	JOSIE NEUBERT	YES	1.000000	0.3840	0.085772%	30-01243-000	SMITHFIELD	JEFFERSON	0.085772%	0.085772%	0.000000%	679 BLAIRMONT RD.	ADENA	OH	43901
19	UTC020023000	BRENDA R. BISHOP AND JAMES W. BISHOP, AS SURVIVORSHIP TENANTS	YES	1.000000	0.1380	0.030824%	30-01020-000	SMITHFIELD	JEFFERSON	0.030824%	0.030824%	0.000000%	5654 COUNTY ROAD 6	ADENA	OH	43901
20	UTC017809000	BEDWAY LAND AND MINERALS COMPANY ATTN: JONATHAN BEDWAY	YES	1.000000	7.6160	1.701139%	25-0000457000	SHORT CREEK	HARRISON	1.701139%	1.701139%	0.000000%	67877 PANCOAST ROAD NORTH	BELMONT	OH	43718
21	UTC026119001	CHRISTOPHER MYER	YES	0.500000	0.1885	0.042104%	25-0000254000	SHORT CREEK	HARRISON	0.042104%	0.042104%	0.000000%	PO BOX 543	SCIO	OH	43988
21	UTC026118001	CATHY HEAVENER	YES	0.500000	0.1885	0.042104%	25-0000254000	SHORT CREEK	HARRISON	0.042104%	0.042104%	0.000000%	214 EAST MAIN ST.	SCIO	OH	43988
22	UTC024531000	TRESA CUNNINGHAM	YES	1.000000	1.8500	0.413223%	25-0000183000	SHORT CREEK	HARRISON	0.413223%	0.413223%	0.000000%	80300 CUNNINGHAM ROAD	ADENA	OH	43901
23	PENDING	WATCH TOWER BIBLE AND TRACT SOCIETY OF PENNSYLVANIA ATTN: STEPHEN LUNSFORD	YES	0.250000	0.2410	0.053831%	25-0000176000	SHORT CREEK	HARRISON	0.053831%	0.053831%	0.000000%	625 RED MILLS ROAD	WALLKILL	NY	12589
23	N/A	KAREN LOU VANEK	NO	0.125000	0.1205	0.026915%	25-0000176000	SHORT CREEK	HARRISON	0.000000%	0.000000%	0.000000%	132 FLORAL AVENUE NORTHWEST	CANTON	OH	44708
23	UTC026150001	CHARLES CARTER	YES	0.083333	0.0803	0.017944%	25-0000176000	SHORT CREEK	HARRISON	0.017944%	0.017944%	0.000000%	440 N 12TH ST.	CAMBRIDGE	OH	43715
23	UTC026107001	ANNA CARTER	YES	0.083333	0.0803	0.017944%	25-0000176000	SHORT CREEK	HARRISON	0.017944%	0.017944%	0.000000%	62830 RIGGS ROAD	BELLAIRE	OH	43906
23	UTC026106001	NICOLE HAMILTON	YES	0.083333	0.0803	0.017944%	25-0000176000	SHORT CREEK	HARRISON	0.017944%	0.017944%	0.000000%	62830 RIGGS ROAD	BELLAIRE	OH	43906
23	UTC026029001	SANDRA S. DUVAL	YES	0.083333	0.0803	0.017944%	25-0000176000	SHORT CREEK	HARRISON	0.017944%	0.017944%	0.000000%	PO BOX 4	HARRISVILLE	OH	43974
23	N/A	THOMAS R. AINSCOUGH	NO	0.083333	0.0803	0.017944%	25-0000176000	SHORT CREEK	HARRISON	0.000000%	0.000000%	0.000000%	189 MCMAKIN STREET	SUMMERVILLE	SC	29483
23	UTC026226001	PATRICIA A. DOUCE	YES	0.083333	0.0803	0.017944%	25-0000176000	SHORT CREEK	HARRISON	0.017944%	0.017944%	0.000000%	10052 NW 208TH TERRACE	ALACHUA	FL	32615
23	UTC026162001	ANDREW GINGERICH	YES	0.020833	0.0201	0.004486%	25-0000176000	SHORT CREEK	HARRISON	0.004486%	0.004486%	0.000000%	214 E. MAIN ST.	BALTIC	OH	43804
23	UTC026254001	DAVID GINGERICH	YES	0.020833	0.0201	0.004486%	25-0000176000	SHORT CREEK	HARRISON	0.004486%	0.004486%	0.000000%	7488 DIBBLE ROAD	CELINA	OH	45822
23	UTC026213001	JACOB GINGERICH	YES	0.020833	0.0201	0.004486%	25-0000176000	SHORT CREEK	HARRISON	0.004486%	0.004486%	0.000000%	6819 HOWICK ROAD	CELINA	OH	45822
23	UTC026149001	EMMA EICHER	YES	0.020833	0.0201	0.004486%	25-0000176000	SHORT CREEK	HARRISON	0.004486%	0.004486%	0.000000%	5190 S 200 E	BERNE	IN	46711
23	UTC026154001	ELIZABETH SCHWARTZ	YES	0.020833	0.0201	0.004486%	25-0000176000	SHORT CREEK	HARRISON	0.004486%	0.004486%	0.000000%	6789 HOWICK ROAD	CELINA	OH	45822
23	UTC026218001	MARY EICHER	YES	0.020833	0.0201	0.004486%	25-0000176000	SHORT CREEK	HARRISON	0.004486%	0.004486%	0.000000%	6239 HASIS ROAD	CELINA	OH	45822
24	UTC026073000	THOMAS CARTER AND JENNIFER CARTER, AS SURVIVORSHIP TENANTS	YES	1.000000	0.3320	0.074157%	25-0000288000	SHORT CREEK	HARRISON	0.074157%	0.074157%	0.000000%	49985 BLAIRMONT ROAD	ADENA	OH	43901
25	UTC026073000	THOMAS ALLEN CARTER	YES	1.000000	0.4740	0.105874%	25-0000178000	SHORT CREEK	HARRISON	0.105874%	0.105874%	0.000000%	49985 BLAIRMONT ROAD	ADENA	OH	43901
26a	N/A	THOMAS R. AINSCOUGH	NO	0.041667	0.0264	0.005891%	25-0000000000	SHORT CREEK	HARRISON	0.000000%	0.000000%	0.000000%	189 MCMAKIN STREET	SUMMERVILLE	SC	29483
26a	UTC026245001	SANDRA S. DUVAL	YES	0.041667	0.0264	0.005891%	25-0000000000	SHORT CREEK	HARRISON	0.005891%	0.005891%	0.000000%	P.O.BOX 4	HARRISVILLE	OH	43974
26a	UTC026606001	PATRICIA DOUCE	YES	0.041667	0.0264	0.005891%	25-0000000000	SHORT CREEK	HARRISON	0.005891%	0.005891%	0.000000%	10052 NW 208TH TERRACE	ALACHUA	FL	32615
26a	UTC026262001	NICOLE L. HAMILTON	YES	0.041667	0.0264	0.005891%	25-0000000000	SHORT CREEK	HARRISON	0.005891%	0.005891%	0.000000%	62830 RIGGS ROAD	BELLAIRE	OH	43906
26a	UTC026264001	CHARLES E. CARTER	YES	0.041667	0.0264	0.005891%	25-0000000000	SHORT CREEK	HARRISON	0.005891%	0.005891%	0.000000%	440 N 12TH STREET	CAMBRIDGE	OH	43725
26a	UTC026263001	ANNA MARIE CARTER	YES	0.041667	0.0264	0.005891%	25-0000000000	SHORT CREEK	HARRISON	0.005891%	0.005891%	0.000000%	62830 RIGGS ROAD	BELLAIRE	OH	43906
26a	PENDING	WATCH TOWER BIBLE AND TRACT SOCIETY OF PENNSYLVANIA ATTN: STEPHEN LUNSFORD	YES	0.125000	0.0791	0.017674%	25-0000000000	SHORT CREEK	HARRISON	0.017674%	0.017674%	0.000000%	625 RED MILLS ROAD	WALLKILL	NY	12589
26a	N/A	KAREN LOU VANEK	NO	0.062500	0.0396	0.008837%	25-0000000000	SHORT CREEK	HARRISON	0.000000%	0.000000%	0.000000%	132 FLORAL AVENUE NORTHWEST	CANTON	OH	44708
26a	UTC026353001	JACOB D. GINGERICH	YES	0.010417	0.0066	0.001473%	25-0000000000	SHORT CREEK	HARRISON	0.001473%	0.001473%	0.000000%	6819 HOWICK ROAD	CELINA	OH	45822
26a	UTC026361001	MARY D. EICHER	YES	0.010417	0.0066	0.001473%	25-0000000000	SHORT CREEK	HARRISON	0.001473%	0.001473%	0.000000%	6239 HASIS ROAD	CELINA	OH	45822
26a	UTC026313001	ELIZABETH D. SCHWARTZ	YES	0.010417	0.0066	0.001473%	25-0000000000	SHORT CREEK	HARRISON	0.001473%	0.001473%	0.000000%	6789 HOWICK ROAD	CELINA	OH	45822
26a	UTC027169001	DAVID D. GINGERICH	YES	0.010417	0.0066	0.001473%	25-0000000000	SHORT CREEK	HARRISON	0.001473%	0.001473%	0.000000%	7488 DIBBLE ROAD	CELINA	OH	45822
26a	UTC026309001	ANDREW D. GINGERICH	YES	0.010417	0.0066	0.001473%	25-0000000000	SHORT CREEK	HARRISON	0.001473%	0.001473%	0.000000%	214 E. MAIN ST.	BALTIC	OH	43804
26a	UTC026591001	EMMA D. EICHER	YES	0.010417	0.0066	0.001473%	25-0000000000	SHORT CREEK	HARRISON	0.001473%	0.001473%	0.000000%	5190 S 200 E	BERNE	IN	46711
26a	UTC027092001	RICHARD M. GAVORCIK	YES	0.063492	0.0402	0.008977%	25-0000000000	SHORT CREEK	HARRISON	0.008977%	0.008977%	0.000000%	252 SOUTH BRIDGE ST.	ADENA	OH	43901
26a	UTC027089001	SHIRLEY L. CAMPSE	YES	0.063492	0.0402	0.008977%	25-0000000000	SHORT CREEK	HARRISON	0.008977%	0.008977%	0.000000%	310 LOTTI DR., APT A	HOPEDALE	OH	43976
26a	UTC026362001	SHARON SUE EVANS	YES	0.063492	0.0402	0.008977%	25-0000000000	SHORT CREEK	HARRISON	0.008977%	0.008977%	0.000000%	1639 CEDAR KNOLL ST	MASSILLON	OH	44646
26a	UTC026578001	DEAN P. DURBIN, JR.	YES	0.012698	0.0080	0.001795%	25-0000000000	SHORT CREEK	HARRISON	0.001795%	0.001795%	0.000000%	3406 FRANCIE AVE.	CANTON	OH	44718
26a	UTC026332001	GARY R. DURBIN	YES	0.012698	0.0080	0.001795%	25-0000000000	SHORT CREEK	HARRISON	0.001795%	0.001795%	0.000000%	212 WESTLAND AVE.	MASSILLON	OH	44646
26a	UTC026306001	ROGER A. DURBIN	YES	0.012698	0.0080	0.001795%	25-0000000000	SHORT CREEK	HARRISON	0.001795%	0.001795%	0.000000%	6433 CLEVELAND AVE.	EAST SPARTA	OH	44626
26a	UTC026322001	WILLIAM W. DURBIN	YES	0.012698	0.0080	0.001795%	25-0000000000	SHORT CREEK	HARRISON	0.001795%	0.001795%	0.000000%	12 SPRANKLE ST. NE	NAVARRA	OH	44662
26a	UTC026328001	JERRI L. STAHL	YES	0.006349	0.0040	0.000898%	25-0000000000	SHORT CREEK	HARRISON	0.000898%	0.000898%	0.000000%	712 ROSLYN AVE. SW	CANTON	OH	44710
26a	UTC026324001	MATTHEW D R STAHL	YES	0.006349	0.0040	0.000898%	25-0000000000	SHORT CREEK	HARRISON	0.000898%	0.000898%	0.000000%	6464 NAVE ST. SW	CANTON	OH	44706

26a	UTC026307001	CECIL E. DURBIN	YES	0.063492	0.0402	0.008977%	25-000000000	SHORT CREEK	HARRISON	0.008977%	0.008977%	0.000000%	77200 ORBYVILLE RD.	ADENA	OH	43901
26a	PENDING	CAROLENE E. STONEBRAKER	YES	0.055556	0.0352	0.007855%	25-000000000	SHORT CREEK	HARRISON	0.007855%	0.007855%	0.000000%	47900 FRONT ST	CADIZ	OH	43907
26a	UTC026287001	SUNDAY J. CARADINE	YES	0.021825	0.0138	0.003086%	25-000000000	SHORT CREEK	HARRISON	0.003086%	0.003086%	0.000000%	3160 MULGA LOOP RD.	BIRMINGHAM	AL	35224
26a	UTC026607001	GLENDIA K. FRYE	YES	0.013889	0.0088	0.001964%	25-000000000	SHORT CREEK	HARRISON	0.001964%	0.001964%	0.000000%	936 LONGVIEW CIR.	ADAMSVILLE	AL	35005
26a	N/A	THOMAS G. DURBIN	NO	0.013889	0.0088	0.001964%	25-000000000	SHORT CREEK	HARRISON	0.000000%	0.000000%	0.000000%	936 LONGVIEW CIR.	ADAMSVILLE	AL	35005
26a	UTC026323001	TERESA M. ELKINS	YES	0.013889	0.0088	0.001964%	25-000000000	SHORT CREEK	HARRISON	0.001964%	0.001964%	0.000000%	3914 WETZEL AVE.	CLEVELAND	OH	44109
26a	N/A	KIMBERLY L. STASKEY	NO	0.031746	0.0201	0.004489%	25-000000000	SHORT CREEK	HARRISON	0.000000%	0.000000%	0.000000%	3855 HARRISON STREET	BELLAIRE	OH	43906
26a	PENDING	BRUCE L. DURBIN HARRIS	YES	0.031746	0.0201	0.004489%	25-000000000	SHORT CREEK	HARRISON	0.004489%	0.004489%	0.000000%	PO BOX 416	FLUSHING	OH	43977
26b	UTC017809000	BEDWAY LAND AND MINERALS COMPANY ATTN: JONATHAN BEDWAY	YES	1.000000	0.1410	0.031494%	25-000000000	SHORT CREEK	HARRISON	0.031494%	0.031494%	0.000000%	67877 PANCOAST ROAD NORTH	BELMONT	OH	43718
26c	UTC017809000	BEDWAY LAND AND MINERALS COMPANY ATTN: JONATHAN BEDWAY	YES	1.000000	0.1940	0.043333%	25-000000000	SHORT CREEK	HARRISON	0.043333%	0.043333%	0.000000%	67877 PANCOAST ROAD NORTH	BELMONT	OH	43718
27	PENDING	WATCH TOWER BIBLE AND TRACT SOCIETY OF PENNSYLVANIA ATTN: STEPHEN LUNSFORD	YES	0.250000	0.8985	0.200692%	25-0000177000	SHORT CREEK	HARRISON	0.200692%	0.200692%	0.000000%	625 RED MILLS ROAD	WALLKILL	NY	12589
27	N/A	KAREN LOU VANEK	NO	0.125000	0.4493	0.100346%	25-0000177000	SHORT CREEK	HARRISON	0.000000%	0.000000%	0.000000%	132 FLORAL AVENUE NORTHWEST	CANTON	OH	44708
27	UTC026150001	CHARLES CARTER	YES	0.083333	0.2995	0.066897%	25-0000177000	SHORT CREEK	HARRISON	0.066897%	0.066897%	0.000000%	440 N 12TH ST.	CAMBRIDGE	OH	43715
27	UTC026107001	ANNA CARTER	YES	0.083333	0.2995	0.066897%	25-0000177000	SHORT CREEK	HARRISON	0.066897%	0.066897%	0.000000%	62830 RIGGS ROAD	BELLAIRE	OH	43906
27	UTC026106001	NICOLE HAMILTON	YES	0.083333	0.2995	0.066897%	25-0000177000	SHORT CREEK	HARRISON	0.066897%	0.066897%	0.000000%	62830 RIGGS ROAD	BELLAIRE	OH	43906
27	UTC026029001	SANDRA DUVALL	YES	0.083333	0.2995	0.066897%	25-0000177000	SHORT CREEK	HARRISON	0.066897%	0.066897%	0.000000%	PO BOX 4	HARRISVILLE	OH	43974
27	N/A	THOMAS R. AINSCOUGH	NO	0.083333	0.2995	0.066897%	25-0000177000	SHORT CREEK	HARRISON	0.000000%	0.000000%	0.000000%	189 MCMAKIN STREET	SUMMERVILLE	SC	29483
27	UTC026226001	PATRICIA A. DOUCE	YES	0.083333	0.2995	0.066897%	25-0000177000	SHORT CREEK	HARRISON	0.066897%	0.066897%	0.000000%	10052 NW 208TH TERRACE	ALACHUA	FL	32615
27	UTC026162001	ANDREW GINGERICH	YES	0.020833	0.0749	0.016724%	25-0000177000	SHORT CREEK	HARRISON	0.016724%	0.016724%	0.000000%	214 E. MAIN ST.	BALTIC	OH	43804
27	UTC026254001	DAVID GINGERICH	YES	0.020833	0.0749	0.016724%	25-0000177000	SHORT CREEK	HARRISON	0.016724%	0.016724%	0.000000%	7488 DIBBLE ROAD	CELINA	OH	45822
27	UTC026213001	JACOB GINGERICH	YES	0.020833	0.0749	0.016724%	25-0000177000	SHORT CREEK	HARRISON	0.016724%	0.016724%	0.000000%	6819 HOWICK ROAD	CELINA	OH	45822
27	UTC026149001	EMMA EICHER	YES	0.020833	0.0749	0.016724%	25-0000177000	SHORT CREEK	HARRISON	0.016724%	0.016724%	0.000000%	5190 S 200 E	BERNE	IN	46711
27	UTC026154001	ELIZABETH SCHWARTZ	YES	0.020833	0.0749	0.016724%	25-0000177000	SHORT CREEK	HARRISON	0.016724%	0.016724%	0.000000%	6789 HOWICK ROAD	CELINA	OH	45822
27	UTC026218001	MARY EICHER	YES	0.020833	0.0749	0.016724%	25-0000177000	SHORT CREEK	HARRISON	0.016724%	0.016724%	0.000000%	6239 HASIS ROAD	CELINA	OH	45822
28a	UTC015427000	KAREN DAVIA	YES	0.333333	2.0620	0.460576%	25-0000191000	SHORT CREEK	HARRISON	0.460576%	0.460576%	0.000000%	49895 BLAIRMONT ROAD	ADENA	OH	43901
28a	UTC015428000	KOLLEEN KOVALSKI	YES	0.333333	2.0620	0.460576%	25-0000191000	SHORT CREEK	HARRISON	0.460576%	0.460576%	0.000000%	6060 WHITE OAK DR.	MENTOR	OH	44060
28a	UTC015429000	KATHY MASLOSKI	YES	0.333333	2.0620	0.460576%	25-0000191000	SHORT CREEK	HARRISON	0.460576%	0.460576%	0.000000%	6951 JACKSON PIKE	LOCKBOURNE	OH	43137
28b	UTC015427000	KAREN DAVIA	YES	0.333333	0.2130	0.047577%	25-0000191000	SHORT CREEK	HARRISON	0.047577%	0.047577%	0.000000%	49895 BLAIRMONT ROAD	ADENA	OH	43901
28b	UTC015428000	KOLLEEN KOVALSKI	YES	0.333333	0.2130	0.047577%	25-0000191000	SHORT CREEK	HARRISON	0.047577%	0.047577%	0.000000%	6060 WHITE OAK DR.	MENTOR	OH	44060
28b	UTC015429000	KATHY MASLOSKI	YES	0.333333	0.2130	0.047577%	25-0000191000	SHORT CREEK	HARRISON	0.047577%	0.047577%	0.000000%	6951 JACKSON PIKE	LOCKBOURNE	OH	43137
29a	UTC015426000	JOSEPH W. DAVIA AND KAREN S. DAVIA, AS SURVIVORSHIP TENANTS	YES	1.000000	3.4810	0.777530%	25-0000336000	SHORT CREEK	HARRISON	0.777530%	0.777530%	0.000000%	49895 BLAIRMONT ROAD	ADENA	OH	43901
29b	UTC015426000	JOSEPH W. DAVIA AND KAREN S. DAVIA, AS SURVIVORSHIP TENANTS	YES	1.000000	0.7410	0.165513%	25-0000336000	SHORT CREEK	HARRISON	0.165513%	0.165513%	0.000000%	49895 BLAIRMONT ROAD	ADENA	OH	43901
30a	N/A	ERNEST J. CUNNINGHAM	NO	1.000000	0.3920	0.087559%	25-0000204000	SHORT CREEK	HARRISON	0.000000%	0.000000%	0.000000%	49930 BLAIRMONT ROAD	ADENA	OH	43901
30b	N/A	ERNEST J. CUNNINGHAM	NO	1.000000	0.2870	0.064105%	25-0000204000	SHORT CREEK	HARRISON	0.000000%	0.000000%	0.000000%	49930 BLAIRMONT ROAD	ADENA	OH	43901
31	UTC018640000	KEVIN WALKER	YES	0.500000	0.0820	0.018316%	25-0000333000	SHORT CREEK	HARRISON	0.018316%	0.018316%	0.000000%	872 TOWNSHIP ROAD 142A	CADIZ	OH	43907
31	UTC018655000	CHERYL SIMON	YES	0.500000	0.0820	0.018316%	25-0000333000	SHORT CREEK	HARRISON	0.018316%	0.018316%	0.000000%	13 HAZELWOOD DR.	WHEELING	WV	26003
32a	UTC017809000	BEDWAY LAND AND MINERALS COMPANY ATTN: JONATHAN BEDWAY	YES	1.000000	12.7170	2.840518%	25-0000052000	SHORT CREEK	HARRISON	2.840518%	2.840518%	0.000000%	67877 PANCOAST ROAD NORTH	BELMONT	OH	43718
32b	UTC017809000	BEDWAY LAND AND MINERALS COMPANY ATTN: JONATHAN BEDWAY	YES	1.000000	0.9690	0.216440%	25-0000052000	SHORT CREEK	HARRISON	0.216440%	0.216440%	0.000000%	67877 PANCOAST ROAD NORTH	BELMONT	OH	43718
33a	UTC018279000	DONNA JEAN STEMKOWSKI	YES	1.000000	11.7570	2.626089%	25-0000052001	SHORT CREEK	HARRISON	2.626089%	2.626089%	0.000000%	57500 KILGORE RD.	BELLAIRE	OH	43906
33b	UTC017809000	BEDWAY LAND AND MINERALS COMPANY ATTN: JONATHAN BEDWAY	YES	1.000000	3.3070	0.738664%	25-0000052001	SHORT CREEK	HARRISON	0.738664%	0.738664%	0.000000%	67877 PANCOAST ROAD NORTH	BELMONT	OH	43718
33c	UTC018279000	DONNA JEAN STEMKOWSKI	YES	1.000000	0.6490	0.144963%	25-0000052001	SHORT CREEK	HARRISON	0.144963%	0.144963%	0.000000%	57500 KILGORE RD.	BELLAIRE	OH	43906
33d	UTC017809000	BEDWAY LAND AND MINERALS COMPANY ATTN: JONATHAN BEDWAY	YES	1.000000	0.3540	0.079071%	25-0000052001	SHORT CREEK	HARRISON	0.079071%	0.079071%	0.000000%	67877 PANCOAST ROAD NORTH	BELMONT	OH	43718
34	UTC027200000	VICKIE K. BASICH	YES	1.000000	0.2610	0.058298%	25-0000160000	SHORT CREEK	HARRISON	0.058298%	0.058298%	0.000000%	49740 BLAIRMONT RD.	ADENA	OH	43901
35	UTC016577000	STEVEN K. WHITING AND JUDITH A. WHITING, AS SURVIVORSHIP TENANTS	YES	1.000000	0.8860	0.197900%	25-0000230000	SHORT CREEK	HARRISON	0.197900%	0.197900%	0.000000%	49725 BLAIRMONT RD.	ADENA	OH	43901
36a	UTC016577000	STEVEN K. WHITING AND JUDITH A. WHITING, AS SURVIVORSHIP TENANTS	YES	1.000000	1.1880	0.265356%	25-0000321000	SHORT CREEK	HARRISON	0.265356%	0.265356%	0.000000%	49725 BLAIRMONT RD.	ADENA	OH	43901
36b	UTC016577000	STEVEN K. WHITING AND JUDITH A. WHITING, AS SURVIVORSHIP TENANTS	YES	1.000000	0.2130	0.047577%	25-0000321000	SHORT CREEK	HARRISON	0.047577%	0.047577%	0.000000%	49725 BLAIRMONT RD.	ADENA	OH	43901
37a	UTC016788000	JOHN W. UTTER AND SHIRLEY ANN UTTER, AS SURVIVORSHIP TENANTS	YES	1.000000	1.2480	0.278758%	25-0000323000	SHORT CREEK	HARRISON	0.278758%	0.278758%	0.000000%	49715 BLAIRMONT ROAD	ADENA	OH	43901
37b	UTC016788000	JOHN W. UTTER AND SHIRLEY ANN UTTER, AS SURVIVORSHIP TENANTS	YES	1.000000	0.4410	0.098503%	25-0000323000	SHORT CREEK	HARRISON	0.098503%	0.098503%	0.000000%	49715 BLAIRMONT ROAD	ADENA	OH	43901
38	UTC026348000	THE BOARD OF COMMISSIONERS OF HARRISON COUNTY ATTN: DALE NORRIS	YES	1.000000	0.3820	0.085325%	25-0000000000	SHORT CREEK	HARRISON	0.085325%	0.085325%	0.000000%	100 W MARKET ST.	CADIZ	OH	43907
39	UTC026082000	ROBERT SOBLESKI	YES	0.200000	0.0498	0.011124%	25-0000310000	SHORT CREEK	HARRISON	0.011124%	0.011124%	0.000000%	49760 BLAIRMONT RD.	ADENA	OH	43901
39	UTC026103001	ANTHONY SOBLESKI	YES	0.200000	0.0498	0.011124%	25-0000310000	SHORT CREEK	HARRISON	0.011124%	0.011124%	0.000000%	11313 VERNON AVE	PORT RICHEY	FL	34668
39	UTC026079001	JAMES SOBLESKI	YES	0.200000	0.0498	0.011124%	25-0000310000	SHORT CREEK	HARRISON	0.011124%	0.011124%	0.000000%	190 COUNTY ROAD 71	ADENA	OH	43901
39	UTC026239001	BERNARD SOBLESKI	YES	0.200000	0.0498	0.011124%	25-0000310000	SHORT CREEK	HARRISON	0.011124%	0.011124%	0.000000%	805 TOWNSHIP RD. 1186	ADENA	OH	43901
39	UTC026208001	PHYLLIS SCHWARTEN	YES	0.200000	0.0498	0.011124%	25-0000310000	SHORT CREEK	HARRISON	0.011124%	0.011124%	0.000000%	1316 CLEARVIEW AVE.	PARMA	OH	44134

40	UTC026082000	ROBERT P. SOBLESKI	YES	0.200000	0.1812	0.040474%	25-0000311000	SHORT CREEK	HARRISON	0.040474%	0.040474%	0.000000%	49760 BLAIRMONT RD.	ADENA	OH	43901
40	UTC026103001	ANTHONY SOBLESKI	YES	0.200000	0.1812	0.040474%	25-0000311000	SHORT CREEK	HARRISON	0.040474%	0.040474%	0.000000%	11313 VERNON AVE	PORT RICHEY	FL	34668
40	UTC026079001	JAMES SOBLESKI	YES	0.200000	0.1812	0.040474%	25-0000311000	SHORT CREEK	HARRISON	0.040474%	0.040474%	0.000000%	190 COUNTY ROAD 71	ADENA	OH	43901
40	UTC026239001	BERNARD SOBLESKI	YES	0.200000	0.1812	0.040474%	25-0000311000	SHORT CREEK	HARRISON	0.040474%	0.040474%	0.000000%	805 TOWNSHIP RD. 1186	ADENA	OH	43901
40	UTC026208001	PHYLLIS SCHWARTEN	YES	0.200000	0.1812	0.040474%	25-0000311000	SHORT CREEK	HARRISON	0.040474%	0.040474%	0.000000%	1316 CLEARVIEW AVE.	PARMA	OH	44134
41	UTC026367000	THOMAS TIPPIE AND CINDY TIPPIE, AS SURVIVORSHIP TENANTS	YES	1.000000	0.2610	0.058298%	25-0000444000	SHORT CREEK	HARRISON	0.058298%	0.058298%	0.000000%	49695 BLAIRMONT RD.	ADENA	OH	43901
42	UTC026359000	ROBERT SICKLE AND CAROL SICKLE, AS SURVIVORSHIP TENANTS	YES	1.000000	0.1140	0.025463%	25-0000443000	SHORT CREEK	HARRISON	0.025463%	0.025463%	0.000000%	48650 CADIZ HARRISVILLE RD.	CADIZ	OH	43907
43	UTC026359000	ROBERT SICKLE AND CAROL SICKLE, AS SURVIVORSHIP TENANTS	YES	1.000000	0.2600	0.058075%	25-0000345000	SHORT CREEK	HARRISON	0.058075%	0.058075%	0.000000%	48650 CADIZ HARRISVILLE RD.	CADIZ	OH	43907
44a	UTC026348000	THE BOARD OF COMMISSIONERS OF HARRISON COUNTY ATTN: DALE NORRIS	YES	1.000000	0.4530	0.101184%	25-0000000000	SHORT CREEK	HARRISON	0.101184%	0.101184%	0.000000%	100 W MARKET ST.	CADIZ	OH	43907
44b	UTC026348000	THE BOARD OF COMMISSIONERS OF HARRISON COUNTY ATTN: DALE NORRIS	YES	1.000000	0.2070	0.046236%	25-0000000000	SHORT CREEK	HARRISON	0.046236%	0.046236%	0.000000%	100 W MARKET ST.	CADIZ	OH	43907
45	UTC025978000	JENNIFER S. LUYSTER	YES	1.000000	0.6680	0.149207%	25-0000435000	SHORT CREEK	HARRISON	0.149207%	0.149207%	0.000000%	49675 BLAIRMONT ROAD	ADENA	OH	43901
46a	UTC018579000	PAUL R. CRANE	YES	1.000000	0.0150	0.003350%	25-0000237000	SHORT CREEK	HARRISON	0.003350%	0.003350%	0.000000%	49665 BLAIRMONT RD.	ADENA	OH	43901
46b	UTC018579000	PAUL R. CRANE	YES	1.000000	0.0040	0.000893%	25-0000237000	SHORT CREEK	HARRISON	0.000893%	0.000893%	0.000000%	49665 BLAIRMONT RD.	ADENA	OH	43901
47	UTC026311001	FRANK R. HARTLEY (SURVIVORSHIP TENANT)	YES	0.500000	0.0900	0.020103%	25-0000181000	SHORT CREEK	HARRISON	0.020103%	0.020103%	0.000000%	49690 BLAIRMONT ROAD	ADENA	OH	43901
47	PENDING	JANET L. HARTLEY (SURVIVORSHIP TENANT)	YES	0.500000	0.0900	0.020103%	25-0000181000	SHORT CREEK	HARRISON	0.020103%	0.020103%	0.000000%	242 HILLTOP ROAD	STONEWALL	LA	71078
48	UTC026311001	FRANK R. HARTLEY (SURVIVORSHIP TENANT)	YES	0.500000	0.0620	0.013849%	25-0000162000	SHORT CREEK	HARRISON	0.013849%	0.013849%	0.000000%	49690 BLAIRMONT ROAD	ADENA	OH	43901
48	PENDING	JANET L. HARTLEY (SURVIVORSHIP TENANT)	YES	0.500000	0.0620	0.013849%	25-0000162000	SHORT CREEK	HARRISON	0.013849%	0.013849%	0.000000%	242 HILLTOP ROAD	STONEWALL	LA	71078
49	UTC018718000	THE BAIER FAMILY TRUST DATED 29TH DAY OF NOVEMBER, 2005 ATTN: RONALD C. BAIER AND PATRICIA J. BAIER, AS TRUSTEES	YES	1.000000	0.1400	0.031271%	25-0000243000	SHORT CREEK	HARRISON	0.031271%	0.031271%	0.000000%	49670 BLAIRMONT RD.	ADENA	OH	43901
50	UTC026348000	THE BOARD OF COMMISSIONERS OF HARRISON COUNTY ATTN: DALE NORRIS	YES	1.000000	0.0330	0.007371%	25-00ROW	SHORT CREEK	HARRISON	0.007371%	0.007371%	0.000000%	100 W MARKET ST.	CADIZ	OH	43907
51	UTC018718000	THE BAIER FAMILY TRUST DATED 29TH DAY OF NOVEMBER, 2005 ATTN: RONALD C. BAIER AND PATRICIA J. BAIER, AS TRUSTEES	YES	1.000000	0.1250	0.027920%	25-0000322000	SHORT CREEK	HARRISON	0.027920%	0.027920%	0.000000%	49670 BLAIRMONT RD.	ADENA	OH	43901
52	UTC018718000	THE BAIER FAMILY TRUST DATED 29TH DAY OF NOVEMBER, 2005 ATTN: RONALD C. BAIER AND PATRICIA J. BAIER, AS TRUSTEES	YES	1.000000	0.1540	0.034398%	25-0000327000	SHORT CREEK	HARRISON	0.034398%	0.034398%	0.000000%	49670 BLAIRMONT RD.	ADENA	OH	43901
53	UTC018718000	THE BAIER FAMILY TRUST DATED 29TH DAY OF NOVEMBER, 2005 ATTN: RONALD C. BAIER AND PATRICIA J. BAIER, AS TRUSTEES	YES	1.000000	0.0860	0.019209%	25-0000242000	SHORT CREEK	HARRISON	0.019209%	0.019209%	0.000000%	49670 BLAIRMONT RD.	ADENA	OH	43901
54	UTC026100000	WILLIAM C. AXFORD, III	YES	1.000000	0.2480	0.055394%	25-0000339000	SHORT CREEK	HARRISON	0.055394%	0.055394%	0.000000%	18270 STATE ROUTE 301	LAGRANGE	OH	44050
55	UTC026100000	WILLIAM C. AXFORD, III	YES	1.000000	0.1800	0.040205%	25-0000338000	SHORT CREEK	HARRISON	0.040205%	0.040205%	0.000000%	18270 STATE ROUTE 301	LAGRANGE	OH	44050
56	UTC018071000	WILLIAM C. AXFORD, III	YES	1.000000	0.6180	0.138039%	25-0000090000	SHORT CREEK	HARRISON	0.138039%	0.138039%	0.000000%	18270 ROUTE 301	LAGRANGE	OH	44050
57	UTC017809000	BEDWAY LAND AND MINERALS COMPANY ATTN: JONATHAN BEDWAY	YES	1.000000	0.0910	0.020326%	25-0000000000	SHORT CREEK	HARRISON	0.020326%	0.020326%	0.000000%	67877 PANCOAST ROAD NORTH	BELMONT	OH	43718
58	UTC026100000	WILLIAM C. AXFORD, III	YES	1.000000	0.6630	0.148090%	25-0000164000	SHORT CREEK	HARRISON	0.148090%	0.148090%	0.000000%	18270 STATE ROUTE 301	LAGRANGE	OH	44050
59a	UTC018579000	PAUL R. CRANE	YES	1.000000	2.1780	0.486486%	25-0000238000	SHORT CREEK	HARRISON	0.486486%	0.486486%	0.000000%	49665 BLAIRMONT RD.	ADENA	OH	43901
59b	UTC018579000	PAUL R. CRANE	YES	1.000000	0.6020	0.134465%	25-0000238000	SHORT CREEK	HARRISON	0.134465%	0.134465%	0.000000%	49665 BLAIRMONT RD.	ADENA	OH	43901
60a	UTC017809000	BEDWAY LAND AND MINERALS COMPANY ATTN: JONATHAN BEDWAY	YES	1.000000	1.5500	0.346214%	25-0000163001	SHORT CREEK	HARRISON	0.346214%	0.346214%	0.000000%	67877 PANCOAST ROAD NORTH	BELMONT	OH	43718
60b	UTC017809000	BEDWAY LAND AND MINERALS COMPANY ATTN: JONATHAN BEDWAY	YES	1.000000	0.1450	0.032388%	25-0000163001	SHORT CREEK	HARRISON	0.032388%	0.032388%	0.000000%	67877 PANCOAST ROAD NORTH	BELMONT	OH	43718
61a	UTC017626000	KEVIN HOLYAK AND DEBRA HOLYAK, AS SURVIVORSHIP TENANTS	YES	1.000000	0.2420	0.054054%	25-0000173000	SHORT CREEK	HARRISON	0.054054%	0.054054%	0.000000%	P.O. BOX 175	ADENA	OH	43901
61b	UTC017626000	KEVIN HOLYAK AND DEBRA HOLYAK, AS SURVIVORSHIP TENANTS	YES	1.000000	0.2510	0.056064%	25-0000173000	SHORT CREEK	HARRISON	0.056064%	0.056064%	0.000000%	P.O. BOX 175	ADENA	OH	43901
62a	UTC017543000	CAROL INFANTE	YES	0.500000	4.7185	1.053942%	25-0000006000	SHORT CREEK	HARRISON	1.053942%	1.053942%	0.000000%	46920 LOCUST PLACE	ST. CLAIRSVILLE	OH	43950
62a	UTC021253000	MARY HARDESTY	YES	0.250000	2.3593	0.526971%	25-0000006000	SHORT CREEK	HARRISON	0.526971%	0.526971%	0.000000%	5 B STREET SW	NAVARRRE	OH	44662
62a	UTC022419000	ROBERT L. VEST	YES	0.083333	0.7864	0.175657%	25-0000006000	SHORT CREEK	HARRISON	0.175657%	0.175657%	0.000000%	P.O. BOX 883	FLOYD	VA	24091
62a	UTC023450000	ARVA LEE BREWER JR.	YES	0.055556	0.5243	0.117105%	25-0000006000	SHORT CREEK	HARRISON	0.117105%	0.117105%	0.000000%	P.O. BOX 945	FLOYD	VA	24091
62a	UTC02776001	SCOTT C. BREWER	YES	0.055556	0.5243	0.117105%	25-0000006000	SHORT CREEK	HARRISON	0.117105%	0.117105%	0.000000%	4545 WEBBS MILL ROAD NORTH	FLOYD	VA	24091
62a	UTC026185001	SHAWN A. BREWER	YES	0.055556	0.5243	0.117105%	25-0000006000	SHORT CREEK	HARRISON	0.117105%	0.117105%	0.000000%	P.O. BOX 32	FLOYD	VA	24091
62b	UTC017543000	CAROL INFANTE	YES	0.500000	0.7370	0.164619%	25-0000006000	SHORT CREEK	HARRISON	0.164619%	0.164619%	0.000000%	46920 LOCUST PLACE	ST. CLAIRSVILLE	OH	43950

62b	UTC021253000	MARY HARDESTY	YES	0.250000	0.3685	0.082310%	25-000006000	SHORT CREEK	HARRISON	0.082310%	0.082310%	0.000000%	5 B STREET SW	NAVARRE	OH	44662
62b	UTC022419000	ROBERT L. VEST	YES	0.083333	0.1228	0.027437%	25-000006000	SHORT CREEK	HARRISON	0.027437%	0.027437%	0.000000%	P.O. BOX 883	FLOYD	VA	24091
62b	UTC023450000	ARVA LEE BREWER JR.	YES	0.055556	0.0819	0.018291%	25-000006000	SHORT CREEK	HARRISON	0.018291%	0.018291%	0.000000%	P.O. BOX 945	FLOYD	VA	24091
62b	UTC02776001	SCOTT C. BREWER	YES	0.055556	0.0819	0.018291%	25-000006000	SHORT CREEK	HARRISON	0.018291%	0.018291%	0.000000%	4545 WEBBS MILL ROAD NORTH	FLOYD	VA	24091
62b	UTC026185001	SHAWN A. BREWER	YES	0.055556	0.0819	0.018291%	25-000006000	SHORT CREEK	HARRISON	0.018291%	0.018291%	0.000000%	P.O. BOX 32	FLOYD	VA	24091
63a	UTC017543000	CAROL INFANTE	YES	0.500000	0.7580	0.169310%	25-000007000	SHORT CREEK	HARRISON	0.169310%	0.169310%	0.000000%	46920 LOCUST PLACE	ST. CLAIRSVILLE	OH	43950
63a	UTC021253000	MARY HARDESTY	YES	0.250000	0.3790	0.084655%	25-000007000	SHORT CREEK	HARRISON	0.084655%	0.084655%	0.000000%	5 B STREET SW	NAVARRE	OH	44662
63a	UTC022419000	ROBERT L. VEST	YES	0.083333	0.1263	0.028218%	25-000007000	SHORT CREEK	HARRISON	0.028218%	0.028218%	0.000000%	P.O. BOX 883	FLOYD	VA	24091
63a	UTC023450000	ARVA LEE BREWER JR.	YES	0.055556	0.0842	0.018812%	25-000007000	SHORT CREEK	HARRISON	0.018812%	0.018812%	0.000000%	P.O. BOX 945	FLOYD	VA	24091
63a	UTC02776001	SCOTT C. BREWER	YES	0.055556	0.0842	0.018812%	25-000007000	SHORT CREEK	HARRISON	0.018812%	0.018812%	0.000000%	4545 WEBBS MILL ROAD NORTH	FLOYD	VA	24091
63a	UTC026185001	SHAWN A. BREWER	YES	0.055556	0.0842	0.018812%	25-000007000	SHORT CREEK	HARRISON	0.018812%	0.018812%	0.000000%	P.O. BOX 32	FLOYD	VA	24091
63b	UTC017543000	CAROL INFANTE	YES	0.500000	0.1570	0.035068%	25-000007000	SHORT CREEK	HARRISON	0.035068%	0.035068%	0.000000%	46920 LOCUST PLACE	ST. CLAIRSVILLE	OH	43950
63b	UTC021253000	MARY HARDESTY	YES	0.250000	0.0785	0.017534%	25-000007000	SHORT CREEK	HARRISON	0.017534%	0.017534%	0.000000%	5 B STREET SW	NAVARRE	OH	44662
63b	UTC022419000	ROBERT L. VEST	YES	0.083333	0.0262	0.005845%	25-000007000	SHORT CREEK	HARRISON	0.005845%	0.005845%	0.000000%	P.O. BOX 883	FLOYD	VA	24091
63b	UTC023450000	ARVA LEE BREWER JR.	YES	0.055556	0.0174	0.003896%	25-000007000	SHORT CREEK	HARRISON	0.003896%	0.003896%	0.000000%	P.O. BOX 945	FLOYD	VA	24091
63b	UTC02776001	SCOTT C. BREWER	YES	0.055556	0.0174	0.003896%	25-000007000	SHORT CREEK	HARRISON	0.003896%	0.003896%	0.000000%	4545 WEBBS MILL ROAD NORTH	FLOYD	VA	24091
63b	UTC026185001	SHAWN A. BREWER	YES	0.055556	0.0174	0.003896%	25-000007000	SHORT CREEK	HARRISON	0.003896%	0.003896%	0.000000%	P.O. BOX 32	FLOYD	VA	24091
64	UTC017543000	CAROL INFANTE	YES	0.500000	0.0020	0.000447%	25-000005000	SHORT CREEK	HARRISON	0.000447%	0.000447%	0.000000%	46920 LOCUST PLACE	ST. CLAIRSVILLE	OH	43950
64	UTC021253000	MARY HARDESTY	YES	0.250000	0.0010	0.000223%	25-000005000	SHORT CREEK	HARRISON	0.000223%	0.000223%	0.000000%	5 B STREET SW	NAVARRE	OH	44662
64	UTC022419000	ROBERT L. VEST	YES	0.083333	0.0003	0.000074%	25-000005000	SHORT CREEK	HARRISON	0.000074%	0.000074%	0.000000%	P.O. BOX 883	FLOYD	VA	24091
64	UTC023450000	ARVA LEE BREWER JR.	YES	0.055556	0.0002	0.000050%	25-000005000	SHORT CREEK	HARRISON	0.000050%	0.000050%	0.000000%	P.O. BOX 945	FLOYD	VA	24091
64	UTC02776001	SCOTT C. BREWER	YES	0.055556	0.0002	0.000050%	25-000005000	SHORT CREEK	HARRISON	0.000050%	0.000050%	0.000000%	4545 WEBBS MILL ROAD NORTH	FLOYD	VA	24091
64	UTC026185001	SHAWN A. BREWER	YES	0.055556	0.0002	0.000050%	25-000005000	SHORT CREEK	HARRISON	0.000050%	0.000050%	0.000000%	P.O. BOX 32	FLOYD	VA	24091
65a	UTC026256001	BARBARA KOVACIK	YES	0.291667	0.0321	0.007166%	25-0000214000	SHORT CREEK	HARRISON	0.007166%	0.007166%	0.000000%	273 BLAIRMONT ROAD	ADENA	OH	43901
65a	UTC026316001	JO ANN HENDERSON	YES	0.291667	0.0321	0.007166%	25-0000214000	SHORT CREEK	HARRISON	0.007166%	0.007166%	0.000000%	7120 AYERS ROAD	ST. CLAIRSVILLE	OH	43950
65a	UTC026238001	DOROTHY E MASH	YES	0.004630	0.0005	0.000114%	25-0000214000	SHORT CREEK	HARRISON	0.000114%	0.000114%	0.000000%	356 MOORE RD	AKRON	OH	44319
65a	N/A	GOODMAN MASH	NO	0.004630	0.0005	0.000114%	25-0000214000	SHORT CREEK	HARRISON	0.000000%	0.000000%	0.000000%	3793 CAYUGAS DRIVE	AKRON	OH	44319
65a	UTC028289001	LEE ANN ROBINSON	YES	0.004630	0.0005	0.000114%	25-0000214000	SHORT CREEK	HARRISON	0.000114%	0.000114%	0.000000%	2691 RADFORD STREET NORTHWEST	NORTH CANTON	OH	44720
65a	PENDING	ASCENT UTICA MINERALS, LLC ATTN: MIKE MCLAUGHLIN	YES	0.004630	0.0005	0.000114%	25-0000214000	SHORT CREEK	HARRISON	0.000114%	0.000114%	0.000000%	3501 N.W. 63RD ST	OKLAHOMA CITY	OK	73116
65a	UTC027715000	ASCENT UTICA MINERALS, LLC ATTN: MIKE MCLAUGHLIN	YES	0.004630	0.0005	0.000114%	25-0000214000	SHORT CREEK	HARRISON	0.000114%	0.000114%	0.000000%	3501 N.W. 63RD ST	OKLAHOMA CITY	OK	73116
65a	N/A	PATRICIA L WHITEMAN	NO	0.004630	0.0005	0.000114%	25-0000214000	SHORT CREEK	HARRISON	0.000000%	0.000000%	0.000000%	140 HILLTOP DRIVE	SCIO	OH	43988
65a	N/A	BARBARA A HOLYAK	NO	0.027778	0.0031	0.000683%	25-0000214000	SHORT CREEK	HARRISON	0.000000%	0.000000%	0.000000%	12200 EDEN AVENUE	HUDSON	FL	34667
65a	UTC026290001	DANA E DUSTMAN	YES	0.027778	0.0031	0.000683%	25-0000214000	SHORT CREEK	HARRISON	0.000683%	0.000683%	0.000000%	69365 GLENVIEW ROAD	LORE CITY	OH	43755
65a	UTC026337001	JOHN BODAK, JR.	YES	0.041667	0.0046	0.001024%	25-0000214000	SHORT CREEK	HARRISON	0.001024%	0.001024%	0.000000%	49350 BLAIRMONT ROAD	ADENA	OH	43901
65a	UTC026602001	DEEANN BEVERIDGE	YES	0.041667	0.0046	0.001024%	25-0000214000	SHORT CREEK	HARRISON	0.001024%	0.001024%	0.000000%	10966 ROSE WOOD LANE	ATHENS	OH	45701
65a	UTC026614001	DOLLY M. SMITH	YES	0.027778	0.0031	0.000683%	25-0000214000	SHORT CREEK	HARRISON	0.000683%	0.000683%	0.000000%	5526 E. PARADISE DRIVE	SCOTTSDALE	AZ	85254
65a	UTC026310001	RICHARD J. OLINE	YES	0.027778	0.0031	0.000683%	25-0000214000	SHORT CREEK	HARRISON	0.000683%	0.000683%	0.000000%	422 CANTERBURY ROAD	BAY VILLAGE	OH	44140
65a	UTC026312001	BOB R. OLINE	YES	0.027778	0.0031	0.000683%	25-0000214000	SHORT CREEK	HARRISON	0.000683%	0.000683%	0.000000%	49190 BLAIRMONT ROAD	ADENA	OH	43901
65a	UTC026074001	JOHN W. HOLYAK	YES	0.013889	0.0015	0.000341%	25-0000214000	SHORT CREEK	HARRISON	0.000341%	0.000341%	0.000000%	1110 LAKESIDE CIRCLE	HIXSON	TN	37343
65a	UTC026197001	KEVIN J. HOLYAK	YES	0.013889	0.0015	0.000341%	25-0000214000	SHORT CREEK	HARRISON	0.000341%	0.000341%	0.000000%	P.O. BOX 175	ADENA	OH	43901
65a	UTC026643001	RANDALL L. HOLYAK	YES	0.013889	0.0015	0.000341%	25-0000214000	SHORT CREEK	HARRISON	0.000341%	0.000341%	0.000000%	3315 WASHINGTON ST.	BELLAIRE	OH	43906
65a	UTC026235001	KAREN K. MESSER	YES	0.013889	0.0015	0.000341%	25-0000214000	SHORT CREEK	HARRISON	0.000341%	0.000341%	0.000000%	73235 1/2 FLUSHING NORTH EAST ROAD	FLUSHING	OH	43977
65a	UTC026257001	SANDRA S. HOLYAK	YES	0.013889	0.0015	0.000341%	25-0000214000	SHORT CREEK	HARRISON	0.000341%	0.000341%	0.000000%	5776 COUNTY ROAD 6	ADENA	OH	43901
65a	UTC026673001	LORA J. KARKULA	YES	0.013889	0.0015	0.000341%	25-0000214000	SHORT CREEK	HARRISON	0.000341%	0.000341%	0.000000%	55972 NATIONAL ROAD	BRIDGEPORT	OH	43912
65a	UTC026249001	ROSE MARIE HOLYAK	YES	0.007576	0.0008	0.000186%	25-0000214000	SHORT CREEK	HARRISON	0.000186%	0.000186%	0.000000%	149 HARRISON AVENUE	CADIZ	OH	43907
65a	UTC026194001	ELAINE WOOLDRIDGE	YES	0.007576	0.0008	0.000186%	25-0000214000	SHORT CREEK	HARRISON	0.000186%	0.000186%	0.000000%	529 SCENIC DRIVE	HARRODSBURG	KY	40330
65a	UTC026202001	JOAN DONLEY	YES	0.007576	0.0008	0.000186%	25-0000214000	SHORT CREEK	HARRISON	0.000186%	0.000186%	0.000000%	46228 DONLEY ROAD	JEWETT	OH	43968
65a	UTC026355001	SHIRLEY UTTER	YES	0.007576	0.0008	0.000186%	25-0000214000	SHORT CREEK	HARRISON	0.000186%	0.000186%	0.000000%	49715 BLAIRMONT ROAD APT 74	ADENA	OH	43901
65a	UTC026857001	DAVID J. MALISIAK	YES	0.007576	0.0008	0.000186%	25-0000214000	SHORT CREEK	HARRISON	0.000186%	0.000186%	0.000000%	11145 PECK RD #2	MANTUA	OH	44255
65a	UTC026352001	LINDA BANDYK	YES	0.007576	0.0008	0.000186%	25-0000214000	SHORT CREEK	HARRISON	0.000186%	0.000186%	0.000000%	3195 COUNTY ROAD 10	ADENA	OH	43901
65a	UTC026300001	JOYCE BROWN	YES	0.007576	0.0008	0.000186%	25-0000214000	SHORT CREEK	HARRISON	0.000186%	0.000186%	0.000000%	100 E. MAIN STREET	ADENA	OH	43901
65a	UTC026358001	RAYMOND L. JESKEY, SR.	YES	0.007576	0.0008	0.000186%	25-0000214000	SHORT CREEK	HARRISON	0.000186%	0.000186%	0.000000%	PO BOX 207	ADENA	OH	43901
65a	UTC026368001	ROBERT HOLYAK	YES	0.007576	0.0008	0.000186%	25-0000214000	SHORT CREEK	HARRISON	0.000186%	0.000186%	0.000000%	49336 BLAIRMONT ROAD	ADENA	OH	43901
65a	UTC026351001	DIANA HORNYAK	YES	0.007576	0.0008	0.000186%	25-0000214000	SHORT CREEK	HARRISON	0.000186%	0.000186%	0.000000%	1816 COUNTY ROAD 11	DILLONVALE	OH	43917
65a	N/A	LARRY HOLYAK	NO	0.007576	0.0008	0.000186%	25-0000214000	SHORT CREEK	HARRISON	0.000000%	0.000000%	0.000000%	4056 UNION CHURCH ROAD	SALISBURY	MD	21804
65b	UTC026256001	BARBARA KOVACIK	YES	0.291667	0.1047	0.023388%	25-0000214000	SHORT CREEK	HARRISON	0.023388%	0.023388%	0.000000%	273 BLAIRMONT ROAD	ADENA	OH	43901
65b	UTC026316001	JO ANN HENDERSON	YES	0.291667	0.1047	0.023388%	25-0000214000	SHORT CREEK	HARRISON	0.023388%	0.023388%	0.000000%	7120 AYERS ROAD	ST. CLAIRSVILLE	OH	43950
65b	UTC026238001	DOROTHY E MASH	YES	0.004630	0.0017	0.000371%	25-0000214000	SHORT CREEK	HARRISON	0.000371%	0.000371%	0.000000%	356 MOORE RD	AKRON	OH	44319
65b	N/A	GOODMAN MASH	NO	0.004630	0.0017	0.000371%	25-0000214000	SHORT CREEK	HARRISON	0.000000%	0.000000%	0.000000%	3793 CAYUGAS DRIVE	AKRON	OH	44319
65b	UTC028289001	LEE ANN ROBINSON	YES	0.004630	0.0017	0.000371%	25-0000214000	SHORT CREEK	HARRISON	0.000371%	0.000371%	0.000000%	2691 RADFORD STREET NORTHWEST	NORTH CANTON	OH	44720
65b	PENDING	ASCENT UTICA MINERALS, LLC ATTN: MIKE MCLAUGHLIN	YES	0.004630	0.0017	0.000371%	25-0000214000	SHORT CREEK	HARRISON	0.000371%	0.000371%	0.000000%	3501 N.W. 63RD ST	OKLAHOMA CITY	OK	73116
65b	UTC027715000	ASCENT UTICA MINERALS, LLC ATTN: MIKE MCLAUGHLIN	YES	0.004630	0.0017	0.000371%	25-0000214000	SHORT CREEK	HARRISON	0.000371%	0.000371%	0.000000%	3501 N.W. 63RD ST	OKLAHOMA CITY	OK	73116
65b	N/A	PATRICIA L WHITEMAN	NO	0.004630	0.0017	0.000371%	25-0000214000	SHORT CREEK	HARRISON	0.000000%	0.000000%	0.000000%	140 HILLTOP DRIVE	SCIO	OH	43988
65b	N/A	BARBARA A HOLYAK	NO	0.027778	0.0100	0.002227%	25-0000214000	SHORT CREEK	HARRISON	0.000000%	0.000000%	0.000000%	12200 EDEN AVENUE	HUDSON	FL	34667
65b	UTC026290001	DANA E DUSTMAN	YES	0.027778	0.0100	0.002227%	25-0000214000	SHORT CREEK	HARRISON	0.						

65b	UTC02637001	JOHN BODAK, JR.	YES	0.041667	0.0150	0.003341%	25-0000214000	SHORT CREEK	HARRISON	0.003341%	0.003341%	0.000000%	49350 BLAIRMONT ROAD	ADENA	OH	43901
65b	UTC026602001	DEANN BEVERIDGE	YES	0.041667	0.0150	0.003341%	25-0000214000	SHORT CREEK	HARRISON	0.003341%	0.003341%	0.000000%	10966 ROSE WOOD LANE	ATHENS	OH	45701
65b	UTC026614001	DOLLY M. SMITH	YES	0.027778	0.0100	0.002227%	25-0000214000	SHORT CREEK	HARRISON	0.002227%	0.002227%	0.000000%	5526 E. PARADISE DRIVE	SCOTTSDALE	AZ	85254
65b	UTC026310001	RICHARD J. OLINE	YES	0.027778	0.0100	0.002227%	25-0000214000	SHORT CREEK	HARRISON	0.002227%	0.002227%	0.000000%	422 CANTERBURY ROAD	BAY VILLAGE	OH	44140
65b	UTC026312001	BOB R. OLIVE	YES	0.027778	0.0100	0.002227%	25-0000214000	SHORT CREEK	HARRISON	0.002227%	0.002227%	0.000000%	49190 BLAIRMONT ROAD	ADENA	OH	43901
65b	UTC026074001	JOHN W. HOLYAK	YES	0.013889	0.0050	0.001114%	25-0000214000	SHORT CREEK	HARRISON	0.001114%	0.001114%	0.000000%	1110 LAKE SIDE CIRCLE	HIXSON	TN	37343
65b	UTC026197001	KEVIN J. HOLYAK	YES	0.013889	0.0050	0.001114%	25-0000214000	SHORT CREEK	HARRISON	0.001114%	0.001114%	0.000000%	P.O. BOX 175	ADENA	OH	43901
65b	UTC026643001	RANDALL L. HOLYAK	YES	0.013889	0.0050	0.001114%	25-0000214000	SHORT CREEK	HARRISON	0.001114%	0.001114%	0.000000%	3315 WASHINGTON ST.	BELLAIRE	OH	43906
65b	UTC026235001	KAREN K. MESSER	YES	0.013889	0.0050	0.001114%	25-0000214000	SHORT CREEK	HARRISON	0.001114%	0.001114%	0.000000%	73235 1/2 FLUSHING NORTH EAST ROAD	FLUSHING	OH	43977
65b	UTC026257001	SANDRA S. HOLYAK	YES	0.013889	0.0050	0.001114%	25-0000214000	SHORT CREEK	HARRISON	0.001114%	0.001114%	0.000000%	5776 COUNTY ROAD 6	ADENA	OH	43901
65b	UTC026673001	LORA J. KARKULA	YES	0.013889	0.0050	0.001114%	25-0000214000	SHORT CREEK	HARRISON	0.001114%	0.001114%	0.000000%	55972 NATIONAL ROAD	BRIDGEPORT	OH	43912
65b	UTC026249001	ROSE MARIE HOLYAK	YES	0.007576	0.0027	0.000607%	25-0000214000	SHORT CREEK	HARRISON	0.000607%	0.000607%	0.000000%	149 HARRISON AVENUE	CADIZ	OH	43907
65b	UTC026194001	ELAINE WOOLDRIDGE	YES	0.007576	0.0027	0.000607%	25-0000214000	SHORT CREEK	HARRISON	0.000607%	0.000607%	0.000000%	529 SCENIC DRIVE	HARRODSBURG	KY	40330
65b	UTC026202001	JOAN DONLEY	YES	0.007576	0.0027	0.000607%	25-0000214000	SHORT CREEK	HARRISON	0.000607%	0.000607%	0.000000%	46228 DONLEY ROAD	JEWETT	OH	43986
65b	UTC026355001	SHIRLEY UTTER	YES	0.007576	0.0027	0.000607%	25-0000214000	SHORT CREEK	HARRISON	0.000607%	0.000607%	0.000000%	49715 BLAIRMONT ROAD APT 74	ADENA	OH	43901
65b	UTC026857001	DAVID J. MALISIAK	YES	0.007576	0.0027	0.000607%	25-0000214000	SHORT CREEK	HARRISON	0.000607%	0.000607%	0.000000%	11145 PECK RD #2	MANTUA	OH	44255
65b	UTC026352001	LINDA BANDYK	YES	0.007576	0.0027	0.000607%	25-0000214000	SHORT CREEK	HARRISON	0.000607%	0.000607%	0.000000%	3195 COUNTY ROAD 10	ADENA	OH	43901
65b	UTC026300001	JOYCE BROWN	YES	0.007576	0.0027	0.000607%	25-0000214000	SHORT CREEK	HARRISON	0.000607%	0.000607%	0.000000%	100 E. MAIN STREET	ADENA	OH	43901
65b	UTC026358001	RAYMOND L. JESKEY, SR.	YES	0.007576	0.0027	0.000607%	25-0000214000	SHORT CREEK	HARRISON	0.000607%	0.000607%	0.000000%	PO BOX 207	ADENA	OH	43901
65b	UTC026368001	ROBERT HOLYAK	YES	0.007576	0.0027	0.000607%	25-0000214000	SHORT CREEK	HARRISON	0.000607%	0.000607%	0.000000%	49336 BLAIRMONT ROAD	ADENA	OH	43901
65b	UTC026351001	DIANA HORNYAK	YES	0.007576	0.0027	0.000607%	25-0000214000	SHORT CREEK	HARRISON	0.000607%	0.000607%	0.000000%	1816 COUNTY ROAD 11	DILLONVALE	OH	43917
65b	N/A	LARRY HOLYAK	NO	0.007576	0.0027	0.000607%	25-0000214000	SHORT CREEK	HARRISON	0.000000%	0.000000%	0.000000%	4056 UNION CHURCH ROAD	SALISBURY	MD	21804
66a	UTC025294000	WHEELING & LAKE ERIE RAILWAY COMPANY ATTN: JEFF DAVIS, JR.	YES	1.000000	4.9910	1.114809%	25-0000367003	SHORT CREEK	HARRISON	1.114809%	1.114809%	0.000000%	100 E. FIRST STREET	BREWSTER	OH	44613
66b	UTC025294000	WHEELING & LAKE ERIE RAILWAY COMPANY ATTN: JEFF DAVIS, JR.	YES	1.000000	0.9200	0.205495%	25-0000367003	SHORT CREEK	HARRISON	0.205495%	0.205495%	0.000000%	100 E. FIRST STREET	BREWSTER	OH	44613
67	UTC019895000	AARON D. MOSTIA	YES	1.000000	4.1990	0.937905%	25-0000070000	SHORT CREEK	HARRISON	0.937905%	0.937905%	0.000000%	49363 BLAIRMONT ROAD	ADENA	OH	43901
68	UTC021347000	MICHAEL D. KITCHEN	YES	0.500000	3.0715	0.686062%	25-0000433000	SHORT CREEK	HARRISON	0.686062%	0.686062%	0.000000%	PO BOX 31	NEW PHILADELPHIA	OH	44663
68	UTC021346000	JOHN A. GARTRELL	YES	0.500000	3.0715	0.686062%	25-0000433000	SHORT CREEK	HARRISON	0.686062%	0.686062%	0.000000%	PO BOX 31	NEW PHILADELPHIA	OH	44663
69	UTC018071000	WILLIAM C. AXFORD, III	YES	1.000000	32.4250	7.242573%	25-0000080000	SHORT CREEK	HARRISON	7.242573%	7.242573%	0.000000%	18270 ROUTE 301	LAGRANGE	OH	44050
70	UTC021347000	MICHAEL D. KITCHEN	YES	0.500000	0.5010	0.111905%	25-0000432000	SHORT CREEK	HARRISON	0.111905%	0.111905%	0.000000%	PO BOX 31	NEW PHILADELPHIA	OH	44663
70	UTC021346000	JOHN A. GARTRELL	YES	0.500000	0.5010	0.111905%	25-0000432000	SHORT CREEK	HARRISON	0.111905%	0.111905%	0.000000%	PO BOX 31	NEW PHILADELPHIA	OH	44663
71	UTC019864000	JOHN R. BODAK, JR. AND RHONDA BODAK, AS SURVIVORSHIP TENANTS	YES	1.000000	1.0000	0.223364%	25-0000253001	SHORT CREEK	HARRISON	0.223364%	0.223364%	0.000000%	49350 BLAIRMONT ROAD	ADENA	OH	43901
72	UTC019894000	CHARLOTTE R. MOSTIA	YES	1.000000	1.8730	0.418361%	25-0000253000	SHORT CREEK	HARRISON	0.418361%	0.418361%	0.000000%	49360 BLAIRMONT ROAD	ADENA	OH	43901
73	UTC019900000	JOHN R. BODAK AND RUTH ANNE BODAK	YES	1.000000	0.4010	0.089569%	25-0000170000	SHORT CREEK	HARRISON	0.089569%	0.089569%	0.000000%	49350 BLAIRMONT ROAD	ADENA	OH	43901
74	UTC017045000	ROBERT HOLYAK	YES	1.000000	0.4130	0.092249%	25-0000217000	SHORT CREEK	HARRISON	0.092249%	0.092249%	0.000000%	49336 BLAIRMONT RD	ADENA	OH	43901
75	UTC019894000	CHARLOTTE R. MOSTIA	YES	1.000000	6.1510	1.373911%	25-0000070001	SHORT CREEK	HARRISON	1.373911%	1.373911%	0.000000%	49360 BLAIRMONT ROAD	ADENA	OH	43901
76	UTC006832001	BARBARA J. KOVACIK	YES	0.500000	0.7195	0.160710%	25-0000215000	SHORT CREEK	HARRISON	0.160710%	0.152675%	0.008036%	273 BLAIRMONT ROAD	ADENA	OH	43901
76	UTC026318001	JO ANN HENDERSON	YES	0.500000	0.7195	0.160710%	25-0000215000	SHORT CREEK	HARRISON	0.160710%	0.160710%	0.000000%	7120 AYERS ROAD	ST. CLAIRSVILLE	OH	43950
77	N/A	CLAUDE E. DENNO	NO	0.053571	0.0415	0.009274%	25-0000194000	SHORT CREEK	HARRISON	0.000000%	0.000000%	0.000000%	15093 RIVER ROAD	BUCHANAN	MI	49107
77	N/A	ROSEMARY A. LOLLAR	NO	0.053571	0.0415	0.009274%	25-0000194000	SHORT CREEK	HARRISON	0.000000%	0.000000%	0.000000%	15081 RIVER ROAD	BUCHANAN	MI	49107
77	UTC026574001	CARTER CHRISTOPHER HATFIELD	YES	0.026786	0.0208	0.004637%	25-0000194000	SHORT CREEK	HARRISON	0.004637%	0.004637%	0.000000%	57088 MAIN STREET	MATTAWAN	MI	49071
77	PENDING	MACKENZIE G HATFIELD	YES	0.026786	0.0208	0.004637%	25-0000194000	SHORT CREEK	HARRISON	0.004637%	0.004637%	0.000000%	1122 VASSAR DRIVE	KALAMAZOO	MI	49001
77	N/A	KEVIN HATFIELD	NO	0.053571	0.0415	0.009274%	25-0000194000	SHORT CREEK	HARRISON	0.000000%	0.000000%	0.000000%	1380 NELSON ROAD	ST. JOSEPH	MI	49085
77	UTC026243001	THOMAS PIHULIC	YES	0.017857	0.0138	0.003091%	25-0000194000	SHORT CREEK	HARRISON	0.003091%	0.003091%	0.000000%	342 TIMBER CREEK CIRCLE NORTHWEST	COMSTOCK PARK	MI	49321
77	UTC026069001	DIANE R PIHULIC	YES	0.017857	0.0138	0.003091%	25-0000194000	SHORT CREEK	HARRISON	0.003091%	0.003091%	0.000000%	5321 NW GLENN AVE	LAWTON	OK	73505
77	UTC027715000	ASCENT UTICA MINERALS, LLC ATTN: MIKE MCLAUGHLIN	YES	0.017857	0.0138	0.003091%	25-0000194000	SHORT CREEK	HARRISON	0.003091%	0.003091%	0.000000%	3501 N.W. 63RD ST	OKLAHOMA CITY	OK	73116
77	UTC026120001	LUELLA M. JONES	YES	0.017857	0.0138	0.003091%	25-0000194000	SHORT CREEK	HARRISON	0.003091%	0.003091%	0.000000%	215 TELFAIR AVE	ALBANY	GA	31701
77	N/A	DANIEL T. PIHULIC	NO	0.017857	0.0138	0.003091%	25-0000194000	SHORT CREEK	HARRISON	0.000000%	0.000000%	0.000000%	12019 BIRCHVIEW DRIVE, SUITE 100	CLINTON	MD	20735
77	PENDING	CAROLYN S. WILSON	YES	0.017857	0.0138	0.003091%	25-0000194000	SHORT CREEK	HARRISON	0.003091%	0.003091%	0.000000%	2153 STANHOPE STREET	GROSSE POINTE WOODS	MI	48236
77	UTC026261001	ROLANDA S. DUNHAM	YES	0.035714	0.0277	0.006182%	25-0000194000	SHORT CREEK	HARRISON	0.006182%	0.006182%	0.000000%	9449 OAK TRAIL CIRCLE	SANTA ROSA	CA	95409
77	N/A	DENNIS G. BRADO	NO	0.035714	0.0277	0.006182%	25-0000194000	SHORT CREEK	HARRISON	0.000000%	0.000000%	0.000000%	PO BOX 5505	PALM SPRINGS	CA	92263
77	UTC026623001	ROLLAND M. BRADO	YES	0.035714	0.0277	0.006182%	25-0000194000	SHORT CREEK	HARRISON	0.006182%	0.006182%	0.000000%	P.O. BOX 68082	GRAND RAPIDS	MI	49516
77	N/A	JENNIFER L. BUCKNER	NO	0.053571	0.0415	0.009274%	25-0000194000	SHORT CREEK	HARRISON	0.000000%	0.000000%	0.000000%	1912 OXFORD DRIVE	HENDERSONVILLE	NC	28792
77	N/A	KRISTEN E. RIDDER	NO	0.026786	0.0208	0.004637%	25-0000194000	SHORT CREEK	HARRISON	0.000000%	0.000000%	0.000000%	22011 W. MILLER COURT	PLAINFIELD	IL	60544
77	N/A	SKYLAR YEAGER	NO	0.026786	0.0208	0.004637%	25-0000194000	SHORT CREEK	HARRISON	0.000000%	0.000000%	0.000000%	22011 W. MILLER COURT	PLAINFIELD	IL	60544
77	PENDING	KENNETH M. KESSLER	YES	0.053571	0.0415	0.009274%	25-0000194000	SHORT CREEK	HARRISON	0.009274%	0.009274%	0.000000%	126 GROVE STREET	MISHAWAKA	IN	46545
77	N/A	JAMES S. KESSLER	NO	0.053571	0.0415	0.009274%	25-0000194000	SHORT CREEK	HARRISON	0.000000%	0.000000%	0.000000%	1805 KILARNEY LANE	NILES	MI	49120
77	UTC026201001	PATRICE A. HEERAN	YES	0.008929	0.0069	0.001546%	25-0000194000	SHORT CREEK	HARRISON	0.001546%	0.001546%	0.000000%	5010 LEO BINGO CT.	WASHOE VALLEY	NV	89704
77	UTC026325001	CHRISTINE C. GAUNDER	YES	0.008929	0.0069	0.001546%	25-0000194000	SHORT CREEK	HARRISON	0.001546%	0.001546%	0.000000%	17700 AMBLEN BLVD., SPC 28	CARSON	CA	90746
77	UTC026148001	STEPHEN T. GAUNDER	YES	0.008929	0.0069	0.001546%	25-0000194000	SHORT CREEK	HARRISON	0.001546%	0.001546%	0.000000%	489 W. NAPIER AVE.	BENTON HARBOR	MI	49022
77	N/A	JON C. GAUNDER	NO	0.008929	0.0069	0.001546%	25-0000194000	SHORT CREEK	HARRISON	0.000000%	0.000000%	0.000000%	2191 MCCORMICK TRAIL	STEVENSVILLE	MI	49127
77	N/A	CRAIG GAST	NO	0.017857	0.0138	0.003091%	25-0000194000	SHORT CREEK	HARRISON	0.000000%	0.000000%	0.000000%	5820 TRAILWOOD DRIVE	SALIDA	CA	95368
77	N/A	LATICIA BENTON	NO	0.017857	0.0138	0.003091%	25-0000194000	SHORT CREEK	HARRISON	0.000000%	0.000000%	0.000000%	13433 E. SHAW AVENUE	SANGER	CA	93657
77	N/A	MARY SUSAN GAST	NO	0.035714	0.0277	0.006182%	25-0000194000	SHORT CREEK	HARRISON	0.000000%	0.000000%	0.000000%	766 WEST J STREET	BENICIA	CA	94510

77	N/A	THE UNKNOWN HEIRS OF WILLIAM ROULIS	NO	0.250000	0.1938	0.043277%	25-0000194000	SHORT CREEK	HARRISON	0.000000%	0.000000%	0.000000%	UNKNOWN	UNKNOWN	UNKNOWN	UNKNOWN
78	UTC018055000	GATEWAY ROYALTY V, LLC ATTN: LARRY CHRISTOPHER OLDHAM	YES	1.000000	3.0710	0.685950%	25-0000253004	SHORT CREEK	HARRISON	0.685950%	0.685950%	0.000000%	P.O. BOX 189	CANFIELD	OH	44406
79	UTC019894000	CHARLOTTE R. MOSTIA	YES	0.500000	4.8415	1.081416%	25-0000069000	SHORT CREEK	HARRISON	1.081416%	1.081416%	0.000000%	49360 BLAIRMONT ROAD	ADENA	OH	43901
79	UTC024179001	BRUNO TABACCHI, JR.	YES	0.150000	1.4525	0.324425%	25-0000069000	SHORT CREEK	HARRISON	0.324425%	0.324425%	0.000000%	5145 NORTH STATE ROUTE 559	NORTH LEWISBURG	OH	43060
79	UTC024197001	CONELLA MARIE TABACCHI BIELANSKI	YES	0.200000	1.9366	0.432566%	25-0000069000	SHORT CREEK	HARRISON	0.432566%	0.432566%	0.000000%	314 SALT CREEK DR.	NORTH PORT	FL	34287
79	UTC025974001	MARCI R. TABACCHI WOJCIK	YES	0.150000	1.4525	0.324425%	25-0000069000	SHORT CREEK	HARRISON	0.324425%	0.324425%	0.000000%	1528 KING BRIDGE ROAD	GRAND BLANC	MI	48439
80	UTC026053001	JOHN O. TABACCHI	YES	0.500000	0.7975	0.178133%	25-0000259000	SHORT CREEK	HARRISON	0.178133%	0.178133%	0.000000%	P.O. BOX 283	CADIZ	OH	43907
80	UTC025998001	CONELLA MARIE TABACCHI BIELANSKI	YES	0.200000	0.3190	0.071253%	25-0000259000	SHORT CREEK	HARRISON	0.071253%	0.071253%	0.000000%	314 SALT CREEK DR.	NORTH PORT	FL	34287
80	UTC025988001	BRUNO TABACCHI, JR.	YES	0.150000	0.2393	0.053440%	25-0000259000	SHORT CREEK	HARRISON	0.053440%	0.053440%	0.000000%	5145 STATE ROUTE 559	NORTH LEWISBURG	OH	43060
80	UTC025974001	MARCI R. TABACCHI WOJCIK	YES	0.150000	0.2393	0.053440%	25-0000259000	SHORT CREEK	HARRISON	0.053440%	0.053440%	0.000000%	1528 KING BRIDGE ROAD	GRAND BLANC	MI	48439
81	UTC026315001	BOB OLINE	YES	0.333333	0.3697	0.082570%	25-0000082000	SHORT CREEK	HARRISON	0.082570%	0.082570%	0.000000%	49190 BLAIRMONT ROAD	ADENA	OH	43901
81	UTC026627001	DOLLY M. SMITH	YES	0.333333	0.3697	0.082570%	25-0000082000	SHORT CREEK	HARRISON	0.082570%	0.082570%	0.000000%	5526 E. PARADISE DRIVE	SCOTTSDALE	AZ	85254
81	UTC026308001	RICHARD J. OLINE	YES	0.333333	0.3697	0.082570%	25-0000082000	SHORT CREEK	HARRISON	0.082570%	0.082570%	0.000000%	422 CANTERBURY ROAD	BAY VILLAGE	OH	44140
82	UTC018056000	ANGELA ROSE SCHLABACH FAMILY TRUST ATTN: ANGELA ROSE SCHLABACH	YES	1.000000	23.9030	5.339066%	25-0000141000	SHORT CREEK	HARRISON	5.339066%	5.339066%	0.000000%	5321 PINEDALE STREET NE	HARTVILLE	OH	44432
83	UTC018509000	JOHN O. TABACCHI REVOCABLE TRUST ATTN: JOHN O. TABACCHI AS TRUSTEE	YES	0.062500	1.7759	0.396666%	25-0000140000	SHORT CREEK	HARRISON	0.396666%	0.396666%	0.000000%	145 S MAIN ST.	CADIZ	OH	43907
83	UTC018509000	SARA M. TABACCHI	YES	0.062500	1.7759	0.396666%	25-0000140000	SHORT CREEK	HARRISON	0.396666%	0.396666%	0.000000%	4445 N. 36TH ST., #424	PHOENIX	AZ	85018
83	UTC018509000	AMELIA G. RYAN	YES	0.062500	1.7759	0.396666%	25-0000140000	SHORT CREEK	HARRISON	0.396666%	0.396666%	0.000000%	320 WYNNE RIDGE COURT	COLUMBUS	OH	43230
83	UTC018510000	THE JOHN L. TABACCHI REVOCABLE TRUST DATED OCTOBER 6, 1997 ATTN: JOHN O. TABACCHI	YES	0.312500	8.8794	1.983331%	25-0000140000	SHORT CREEK	HARRISON	1.983331%	1.983331%	0.000000%	P.O. BOX 283	CADIZ	OH	43907
83	UTC025998001	CONELLA MARIE TABACCHI BIELANSKI	YES	0.200000	5.6828	1.269332%	25-0000140000	SHORT CREEK	HARRISON	1.269332%	1.269332%	0.000000%	314 SALT CREEK DR.	NORTH PORT	FL	34287
83	UTC025988001	BRUNO TABACCHI, JR.	YES	0.150000	4.2621	0.951999%	25-0000140000	SHORT CREEK	HARRISON	0.951999%	0.951999%	0.000000%	5145 STATE ROUTE 559	NORTH LEWISBURG	OH	43060
83	UTC025974001	MARCI R. TABACCHI WOJCIK	YES	0.150000	4.2621	0.951999%	25-0000140000	SHORT CREEK	HARRISON	0.951999%	0.951999%	0.000000%	1528 KING BRIDGE ROAD	GRAND BLANC	MI	48439
84	UTC018508000	JOHN P. WOODS	YES	1.000000	0.0560	0.012508%	25-0000023000	SHORT CREEK	HARRISON	0.012508%	0.012508%	0.000000%	49115 BLAIRMONT ROAD	ADENA	OH	43901
85	UTC018210000	FRANK L. ZEROSKI AND MARY ANN ZEROSKI, AS SURVIVORSHIP TENANTS	YES	1.000000	2.9750	0.664507%	25-0000393000	SHORT CREEK	HARRISON	0.664507%	0.664507%	0.000000%	PO BOX 342	ADENA	OH	43901
86	N/A	POCAHONTAS LAND, LLC FKA POCAHONTAS LAND CORPORATION ATTN: MICHAEL BLACKBURN	NO	1.000000	0.6170	0.137816%	25-0000268000	SHORT CREEK	HARRISON	0.000000%	0.000000%	0.000000%	P.O. BOX 1517	BLUEFIELD	WV	24701
87	UTC026065001	ROBERT O. MEREDITH	YES	0.250000	0.2070	0.046236%	25-0000248000	SHORT CREEK	HARRISON	0.046236%	0.046236%	0.000000%	2545 FRONTIER ROAD	AUBURN	CA	95603
87	UTC026067001	DEAN ALLEN MEREDITH	YES	0.125000	0.1035	0.023118%	25-0000248000	SHORT CREEK	HARRISON	0.023118%	0.023118%	0.000000%	48634 WALNUT AVENUE	ST. CLAIRSVILLE	OH	43950
87	UTC026068001	WILLIAM D. MEREDITH	YES	0.125000	0.1035	0.023118%	25-0000248000	SHORT CREEK	HARRISON	0.023118%	0.023118%	0.000000%	38480 COUNTY ROAD 72	FLUSHING	OH	43977
87	UTC026109001	RANDY MESZAROS	YES	0.033333	0.0276	0.006165%	25-0000248000	SHORT CREEK	HARRISON	0.006165%	0.006165%	0.000000%	70479 NAGY DRIVE	MARTINS FERRY	OH	43935
87	N/A	KIMBERLY S. CATE	NO	0.033333	0.0276	0.000000%	25-0000248000	SHORT CREEK	HARRISON	0.000000%	0.000000%	0.000000%	2111 PRESLEY DRIVE	GROVE CITY	OH	43123
87	UTC026108001	CONNIE OWEN	YES	0.033333	0.0276	0.006165%	25-0000248000	SHORT CREEK	HARRISON	0.006165%	0.006165%	0.000000%	899 STATE ROUTE 151	MINGO JUNCTION	OH	43938
87	UTC026134001	MARK MESZAROS	YES	0.033333	0.0276	0.006165%	25-0000248000	SHORT CREEK	HARRISON	0.006165%	0.006165%	0.000000%	418 WABURN WALK	DALLAS	GA	30132
87	UTC026190001	JENNIFER TATE	YES	0.033333	0.0276	0.006165%	25-0000248000	SHORT CREEK	HARRISON	0.006165%	0.006165%	0.000000%	510 RIDGEVIEW AVENUE	BRIGHTON	OH	43913
87	UTC026603001	KIMBERLY DEHNART	YES	0.027778	0.0230	0.005137%	25-0000248000	SHORT CREEK	HARRISON	0.005137%	0.005137%	0.000000%	3587 STATE ROUTE 151	MINGO JUNCTION	OH	43942
87	UTC026169001	DIANNA L. SMITH	YES	0.027778	0.0230	0.005137%	25-0000248000	SHORT CREEK	HARRISON	0.005137%	0.005137%	0.000000%	1203 OAKGROVE AVENUE	STUEBENVILLE	OH	43952
87	N/A	EDWIN DEHNART	NO	0.027778	0.0230	0.005137%	25-0000248000	SHORT CREEK	HARRISON	0.000000%	0.000000%	0.000000%	2100 LAKESIDE AVENUE EAST	CLEVELAND	OH	44114
87	UTC026205001	PAULA A. MEREDITH	YES	0.083333	0.0690	0.015412%	25-0000248000	SHORT CREEK	HARRISON	0.015412%	0.015412%	0.000000%	114 VALLEJO STREET	PETALUMA	CA	94952
87	UTC026211001	JENNA MEREDITH	YES	0.083333	0.0690	0.015412%	25-0000248000	SHORT CREEK	HARRISON	0.015412%	0.015412%	0.000000%	2620 POINT SUR COURT	ANTIOCH	CA	94531
87	UTC026064000	CRYSTAL MEREDITH	YES	0.083333	0.0690	0.015412%	25-0000248000	SHORT CREEK	HARRISON	0.015412%	0.015412%	0.000000%	1637 NEW JERSEY STREET	FAIRFIELD	CA	94533
88	UTC020641000	ANDY P. GRIM	YES	1.000000	0.0100	0.002234%	25-0000282000	SHORT CREEK	HARRISON	0.002234%	0.002234%	0.000000%	79958 ROSE VALLEY RD	ADENA	OH	43901
89	UTC017806002	JOSEPH TABACCHI	YES	0.250000	0.6553	0.146359%	25-0000373000	SHORT CREEK	HARRISON	0.146359%	0.146359%	0.000000%	50198 W. RUSTIC DR., APT 32	ST. CLAIRSVILLE	OH	43950
89	UTC017806002	MARY ANN ZEROSKI	YES	0.250000	0.6553	0.146359%	25-0000373000	SHORT CREEK	HARRISON	0.146359%	0.146359%	0.000000%	PO BOX 342	ADENA	OH	43901
89	UTC017806001	LAURIE KOEHLER	YES	0.125000	0.3276	0.073180%	25-0000373000	SHORT CREEK	HARRISON	0.073180%	0.073180%	0.000000%	438 COUNTY ROAD 71	ADENA	OH	43901
89	UTC017806001	DONNA GAMBLE	YES	0.125000	0.3276	0.073180%	25-0000373000	SHORT CREEK	HARRISON	0.073180%	0.073180%	0.000000%	3407 MAPLEWOOD AVE, SW	CANTON	OH	44706
89	UTC017806001	MELISSA SZCZEPANSKI	YES	0.125000	0.3276	0.073180%	25-0000373000	SHORT CREEK	HARRISON	0.073180%	0.073180%	0.000000%	19 SANTA RITA DR.	WEIRTON	WV	26062
89	UTC017806001	LYNN SWEENEY	YES	0.125000	0.3276	0.073180%	25-0000373000	SHORT CREEK	HARRISON	0.073180%	0.073180%	0.000000%	79675 UNIONVALE-KENWOOD RD.	ADENA	OH	43901
90	UTC026019000	DEAN SCOTT MYERS AND JANET WASKO MYERS, AS SURVIVORSHIP TENANTS	YES	1.000000	0.4130	0.092249%	25-0000175000	SHORT CREEK	HARRISON	0.092249%	0.092249%	0.000000%	11625 COLLINS ARBOGAST RD.	SOUTH VIENNA	OH	45369
91	UTC026625001	PRISCILLA JOHNSON	YES	0.166667	0.1225	0.027362%	25-0000218000	SHORT CREEK	HARRISON	0.027362%	0.027362%	0.000000%	401 EAST WARREN ST.	CADIZ	OH	43907
91	UTC026831001	PATRICIA LEWIS	YES	0.166667	0.1225	0.027362%	25-0000218000	SHORT CREEK	HARRISON	0.027362%	0.027362%	0.000000%	401 EAST WARREN ST.	CADIZ	OH	43907
91	UTC026746001	JAMES MANNS	YES	0.166667	0.1225	0.027362%	25-0000218000	SHORT CREEK	HARRISON	0.027362%	0.027362%	0.000000%	1222 WOODNELL AVE.	COLUMBUS	OH	43219
91	UTC026744001	DEBORAH MANNS	YES	0.166667	0.1225	0.027362%	25-0000218000	SHORT CREEK	HARRISON	0.027362%	0.027362%	0.000000%	7953 SAINT MONICA DRIVE	DUNDALK	MD	21222
91	UTC026153001	CATHERINE WILLIAMS	YES	0.055556	0.0408	0.009121%	25-0000218000	SHORT CREEK	HARRISON	0.009121%	0.009121%	0.000000%	104 LINABURY AVE.	WESTERVILLE	OH	43081
91	UTC026161001	CARLA JACKSON	YES	0.055556	0.0408	0.009121%	25-0000218000	SHORT CREEK	HARRISON	0.009121%	0.009121%	0.000000%	1300 CORTINA LN.	COLUMBUS	OH	43085
91	UTC026157001	JERRY W. MANNS, JR.	YES	0.055556	0.0408	0.009121%	25-0000218000	SHORT CREEK	HARRISON	0.009121%	0.009121%	0.000000%	2145 STRIMPLE AVE.	COLUMBUS	OH	43229
91	UTC026206001	WILLIAM M. MANNS, III	YES	0.041667	0.0306	0.006841%	25-0000218000	SHORT CREEK	HARRISON	0.006841%	0.006841%	0.000000%	2245 FENTON ST.	COLUMBUS	OH	43224
91	UTC026207001	WADE MANNS	YES	0.041667	0.0306	0.006841%	25-0000218000	SHORT CREEK	HARRISON	0.006841%	0.006841%	0.000000%	5959 SLIPPERY ROCK DR	COLUMBUS	OH	43229
91	UTC026248001	JAMES JORDAN	YES	0.041667	0.0306	0.006841%	25-0000218000	SHORT CREEK	HARRISON	0.006841%	0.006841%	0.000000%	471 SLOANE AVE.	MANSFIELD	OH	44903
91	UTC026158001	LATRICIA MANNS	YES	0.041667	0.0306	0.006841%	25-0000218000	SHORT CREEK	HARRISON	0.006841%	0.006841%	0.000000%	1815 RANKIN AVE.	COLUMBUS	OH	43219
92	UTC026625001	PRISCILLA JOHNSON	YES	0.166667	0.1535	0.034286%	25-0000244000	SHORT CREEK	HARRISON	0.034286%	0.034286%	0.000000%	401 EAST WARREN ST.	CADIZ	OH	43907
92	UTC026831001	PATRICIA LEWIS	YES	0.166667	0.1535	0.034286%	25-0000244000	SHORT CREEK	HARRISON	0.034286%	0.034286%	0.000000%	401 EAST WARREN ST.	CADIZ	OH	43907
92	UTC026746001	JAMES MANNS	YES	0.166667	0.1535	0.034286%	25-0000244000	SHORT CREEK	HARRISON	0.034286%	0.034286%	0.000000%	1222 WOODNELL AVE.	COLUMBUS	OH	43219
92	UTC026744001	DEBORAH MANNS	YES	0.166667	0.1535	0.034286%	25-0000244000	SHORT CREEK	HARRISON	0.034286%	0.034286%	0.000000%	7953 SAINT MONICA DRIVE	DUNDALK	MD	21222

92	UTC026153001	CATHERINE WILLIAMS	YES	0.055556	0.0512	0.011429%	25-0000244000	SHORT CREEK	HARRISON	0.011429%	0.011429%	0.000000%	104 LINABURY AVE.	WESTERVILLE	OH	43081
92	UTC026161001	CARLA JACKSON	YES	0.055556	0.0512	0.011429%	25-0000244000	SHORT CREEK	HARRISON	0.011429%	0.011429%	0.000000%	1300 CORTINA LN.	COLUMBUS	OH	43085
92	UTC026157001	JERRY MANNS, JR.	YES	0.055556	0.0512	0.011429%	25-0000244000	SHORT CREEK	HARRISON	0.011429%	0.011429%	0.000000%	2145 STRIMPLE AVE.	COLUMBUS	OH	43229
92	UTC026206001	WILLIAM M. MANNS, III	YES	0.041667	0.0384	0.008572%	25-0000244000	SHORT CREEK	HARRISON	0.008572%	0.008572%	0.000000%	2245 FENTON ST.	COLUMBUS	OH	43224
92	UTC026207001	WADE MANNS	YES	0.041667	0.0384	0.008572%	25-0000244000	SHORT CREEK	HARRISON	0.008572%	0.008572%	0.000000%	5959 SLIPPERY ROCK DR	COLUMBUS	OH	43229
92	UTC026248001	JAMES JORDAN	YES	0.041667	0.0384	0.008572%	25-0000244000	SHORT CREEK	HARRISON	0.008572%	0.008572%	0.000000%	471 SLOANE AVE.	MANSFIELD	OH	44903
92	UTC026158001	LATRICIA MANNS	YES	0.041667	0.0384	0.008572%	25-0000244000	SHORT CREEK	HARRISON	0.008572%	0.008572%	0.000000%	1815 RANKIN AVE.	COLUMBUS	OH	43219
93	UTC018055000	GATEWAY ROYALTY V, LLC ATTN: LARRY CHRISTOPHER OLDHAM	YES	1.000000	13.7290	3.066562%	25-0000025000	SHORT CREEK	HARRISON	3.066562%	3.066562%	0.000000%	P.O. BOX 189	CANFIELD	OH	44406
94	UTC018103001	THE JANICE MARIE TWEEDY LIVING TRUST 2018 ATTN: JANICE MARIE TWEEDY, AS TRUSTEE	YES	0.500000	7.3700	1.646192%	13-0000377003	GREEN	HARRISON	1.646192%	1.646192%	0.000000%	PO BOX 232	BOLENAS	CA	94924
94	UTC018103002	AMP IV, LP ATTN: MARK PHILIP THOMAS, JR	YES	0.500000	7.3700	1.646192%	13-0000377003	GREEN	HARRISON	1.646192%	1.646192%	0.000000%	225 ROSS STREET, SUITE 301	PITTSBURG	PA	15219
95	UTC017806002	JOSEPH TABACCHI	YES	0.250000	6.3048	1.408253%	13-0000348000	GREEN	HARRISON	1.408253%	1.408253%	0.000000%	50198 W. RUSTIC DR., APT 32	ST. CLAIRSVILLE	OH	43950
95	UTC017806002	MARY ANN ZEROSKI	YES	0.250000	6.3048	1.408253%	13-0000348000	GREEN	HARRISON	1.408253%	1.408253%	0.000000%	PO BOX 342	ADENA	OH	43901
95	UTC017806001	LAURIE KOEHLER	YES	0.125000	3.1524	0.704127%	13-0000348000	GREEN	HARRISON	0.704127%	0.704127%	0.000000%	438 COUNTY ROAD 71	ADENA	OH	43901
95	UTC017806001	DONNA GAMBLE	YES	0.125000	3.1524	0.704127%	13-0000348000	GREEN	HARRISON	0.704127%	0.704127%	0.000000%	3407 MAPLEWOOD AVE, SW	CANTON	OH	44706
95	UTC017806001	MELISSA SZCZEPANSKI	YES	0.125000	3.1524	0.704127%	13-0000348000	GREEN	HARRISON	0.704127%	0.704127%	0.000000%	19 SANTA RITA DR.	WEIRTON	WV	26062
95	UTC017806001	LYNN SWEENEY	YES	0.125000	3.1524	0.704127%	13-0000348000	GREEN	HARRISON	0.704127%	0.704127%	0.000000%	79675 UNIONVALE-KENWOOD RD.	ADENA	OH	43901
96	UTC017807000	RIDGETOP APPALACHIA, LLC ATTN: BRADLEY CARPENTER	YES	1.000000	69.6250	15.551709%	13-0000158000	GREEN	HARRISON	15.551709%	15.551709%	0.000000%	380 SOUTHPOINTE BLVD PLAZA II, SUITE 405	CANONSBURG	PA	15317
97	UTC017807000	RIDGETOP APPALACHIA, LLC ATTN: BRADLEY CARPENTER	YES	1.000000	29.5680	6.604423%	13-0000160000	GREEN	HARRISON	6.604423%	6.604423%	0.000000%	380 SOUTHPOINTE BLVD PLAZA II, SUITE 405	CANONSBURG	PA	15317
98	UTC022616000	MARY ANN SICKLE	YES	0.500000	0.6660	0.148760%	13-0000520000	GREEN	HARRISON	0.148760%	0.148760%	0.000000%	9638 PUTNAM CT.	TWINSBURG	OH	44087
98	UTC022687000	ANTHONY S. PIRRO	YES	0.500000	0.6660	0.148760%	13-0000520000	GREEN	HARRISON	0.148760%	0.148760%	0.000000%	600 HARVEST GLEN DR.	RICHARDSON	TX	75081
99	UTC017807000	RIDGETOP APPALACHIA, LLC ATTN: BRADLEY CARPENTER	YES	1.000000	17.7490	3.964485%	13-0000159000	GREEN	HARRISON	3.964485%	3.964485%	0.000000%	380 SOUTHPOINTE BLVD PLAZA II, SUITE 405	CANONSBURG	PA	15317
100	UTC020009000	THOMAS F. SALZMANN AND SUSAN L. SALZMANN, AS SURVIVORSHIP TENANTS	YES	1.000000	1.1700	0.261336%	13-0000223001	GREEN	HARRISON	0.261336%	0.261336%	0.000000%	5720 GOLDEN GATE PKWY	NAPLES	FL	34116
101	UTC026345001	JOSEPH H. HARRAH	YES	0.250000	3.9130	0.874023%	13-0000190000	GREEN	HARRISON	0.874023%	0.874023%	0.000000%	822 BAKERS ADDITION	HOPEDALE	OH	43976
101	UTC026342001	W. FRED HARRAH	YES	0.250000	3.9130	0.874023%	13-0000190000	GREEN	HARRISON	0.874023%	0.874023%	0.000000%	47700 OLD HOPEDALE ROAD	CADIZ	OH	43907
101	UTC026344001	SHARON K. HARRAH	YES	0.250000	3.9130	0.874023%	13-0000190000	GREEN	HARRISON	0.874023%	0.874023%	0.000000%	1034 BUCK ROAD, NW	CARROLLTON	OH	44615
101	UTC026301001	JOHN L. HARRAH	YES	0.250000	3.9130	0.874023%	13-0000190000	GREEN	HARRISON	0.874023%	0.874023%	0.000000%	48319 UNIONVALE RD	CADIZ	OH	43907
102	UTC017807000	RIDGETOP APPALACHIA, LLC ATTN: BRADLEY CARPENTER	YES	1.000000	1.0790	0.241010%	13-0000898000	GREEN	HARRISON	0.241010%	0.241010%	0.000000%	380 SOUTHPOINTE BLVD PLAZA II, SUITE 405	CANONSBURG	PA	15317
103	UTC025294000	WHEELING & LAKE ERIE RAILWAY COMPANY ATTN: JEFF DAVIS, JR.	YES	1.000000	0.2100	0.046906%	25-0000367000	SHORT CREEK	HARRISON	0.046906%	0.046906%	0.000000%	100 E. FIRST STREET	BREWSTER	OH	44613
104	UTC025294000	WHEELING & LAKE ERIE RAILWAY COMPANY ATTN: JEFF DAVIS, JR.	YES	1.000000	1.1560	0.258209%	25-0000367000	SHORT CREEK	HARRISON	0.258209%	0.258209%	0.000000%	100 E. FIRST STREET	BREWSTER	OH	44613
105a	UTC025294000	WHEELING & LAKE ERIE RAILWAY COMPANY ATTN: JEFF DAVIS, JR.	YES	1.000000	0.1540	0.034398%	25-0000000000	SHORT CREEK	HARRISON	0.034398%	0.034398%	0.000000%	100 E. FIRST STREET	BREWSTER	OH	44613
105b	UTC025294000	WHEELING & LAKE ERIE RAILWAY COMPANY ATTN: JEFF DAVIS, JR.	YES	1.000000	2.0310	0.453652%	25-0000000000	SHORT CREEK	HARRISON	0.453652%	0.453652%	0.000000%	100 E. FIRST STREET	BREWSTER	OH	44613
105c	PENDING	JANICE MARIE TWEEDY	YES	0.500000	0.0040	0.000893%	25-0000000000	SHORT CREEK	HARRISON	0.000893%	0.000893%	0.000000%	PO BOX 232	BOLENAS	CA	94924
105c	N/A	THE MARGARET E. SALTSMAN TRUST UAD 9/14/98 ATTN: LINDA CHUGH ULINSKI, TRUSTEE	NO	0.500000	0.0040	0.000893%	25-0000000000	SHORT CREEK	HARRISON	0.000000%	0.000000%	0.000000%	1650 W. MARKET STREET, STE #32	AKRON	OH	44313
106	UTC018103001	THE JANICE MARIE TWEEDY LIVING TRUST 2018 ATTN: JANICE MARIE TWEEDY, AS TRUSTEE	YES	0.500000	0.5275	0.117824%	13-0000000000	GREEN	HARRISON	0.117824%	0.117824%	0.000000%	PO BOX 232	BOLENAS	CA	94924
106	UTC018103002	AMP IV, LP ATTN: MARK PHILIP THOMAS, JR	YES	0.500000	0.5275	0.117824%	13-0000000000	GREEN	HARRISON	0.117824%	0.117824%	0.000000%	225 ROSS STREET, SUITE 301	PITTSBURG	PA	15219
107	UTC026311001	FRANK R. HARTLEY (SURVIVORSHIP TENANT)	YES	0.500000	0.0265	0.005919%	25-0000181001	SHORT CREEK	HARRISON	0.005919%	0.005919%	0.000000%	49690 BLAIRMONT ROAD	ADENA	OH	43901
107	PENDING	JANET L. HARTLEY (SURVIVORSHIP TENANT)	YES	0.500000	0.0265	0.005919%	25-0000181001	SHORT CREEK	HARRISON	0.005919%	0.005919%	0.000000%	242 HILLTOP ROAD	STONEWALL	LA	71078

108	PENDING	JANET L. HARTLEY (SURVIVORSHIP TENANT)	YES	0.500000	0.0075	0.001675%	25-0000162001	SHORT CREEK	HARRISON	0.001675%	0.001675%	0.000000%	242 HILLTOP ROAD	STONEWALL	LA	71078
108	UTC026311001	FRANK R. HARTLEY (SURVIVORSHIP TENANT)	YES	0.500000	0.0075	0.001675%	25-0000162001	SHORT CREEK	HARRISON	0.001675%	0.001675%	0.000000%	49690 BLAIRMONT ROAD	ADENA	OH	43901
109	UTC018718000	THE BAIER FAMILY TRUST DATED 29TH DAY OF NOVEMBER, 2005 ATTN: RONALD C. BAIER AND PATRICIA J. BAIER, AS TRUSTEES	YES	1.000000	0.0170	0.003797%	25-0000243001	SHORT CREEK	HARRISON	0.003797%	0.003797%	0.000000%	49670 BLAIRMONT RD.	ADENA	OH	43901
110	UTC018718000	THE BAIER FAMILY TRUST DATED 29TH DAY OF NOVEMBER, 2005 ATTN: RONALD C. BAIER AND PATRICIA J. BAIER, AS TRUSTEES	YES	1.000000	0.0140	0.003127%	25-0000322001	SHORT CREEK	HARRISON	0.003127%	0.003127%	0.000000%	49670 BLAIRMONT RD.	ADENA	OH	43901
				Total Unit Acres:	447.7000	100.000000%				Total:	99.021901%	98.826374%	0.195527%			
				Total Leased Acres:	443.3211											

Tracts 26a, 26b, 26c, 38, 44a, 44b, 57, 105a, 105b, and 105c are all identified as being Tax Parcel 25-0000000000. This is intentional and is the result of the county attributing these tracts the Short Creek Township generic tax parcel number.

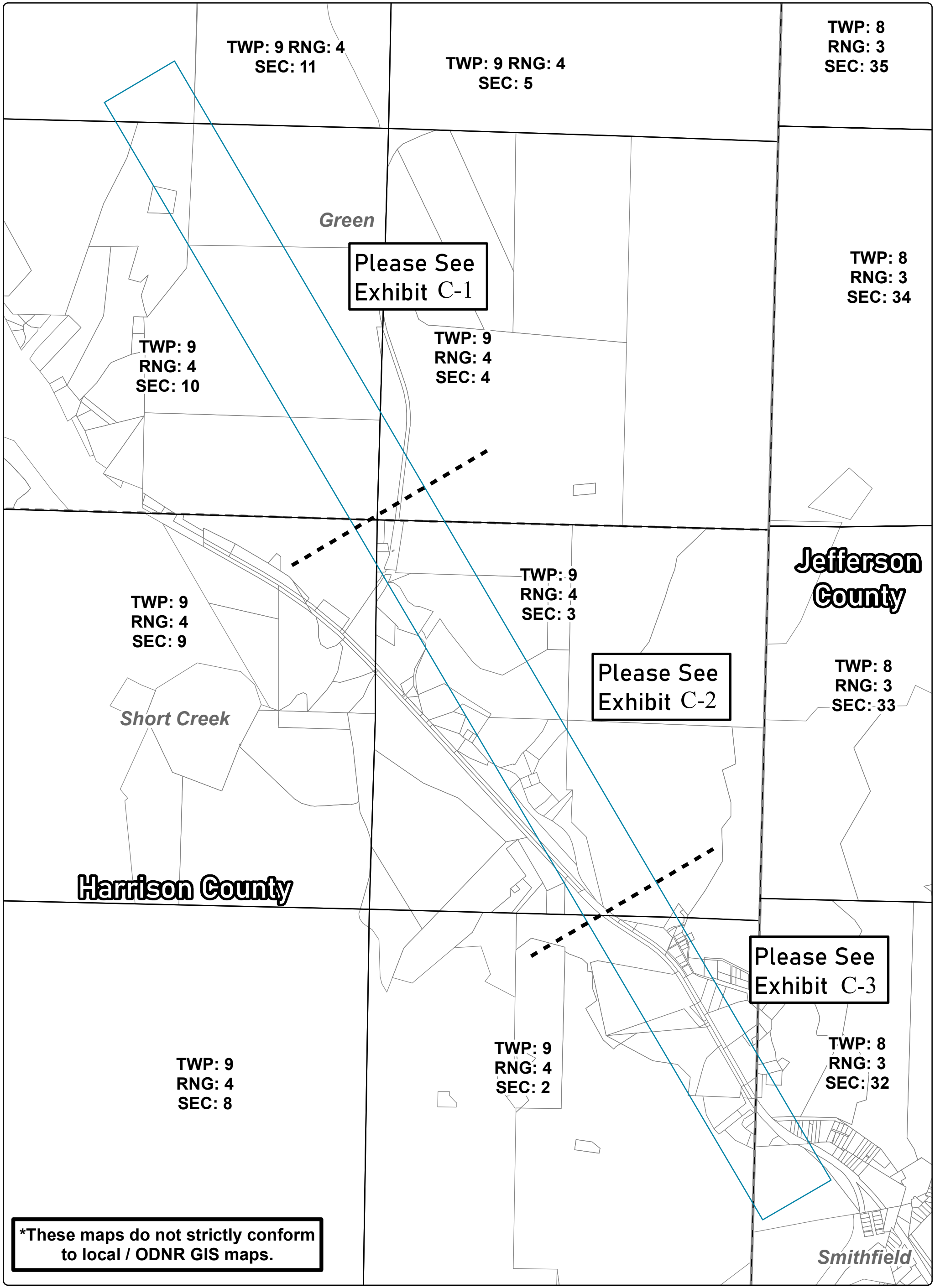

*These maps do not strictly conform to local / ODNR GIS maps.

CRICKET E SHC HR

Exhibit C

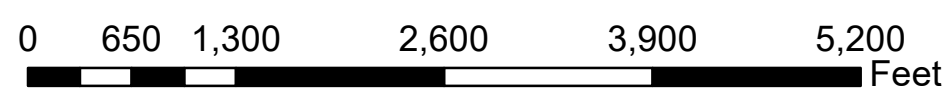

1 INCH = 1,021 FEET
Cricket E SHC HR Unit

- Cricket E SHC HR Unit - 447.700 Ac.
- Municipal Townships
- PLSS Section
- Tax Parcels
- County Boundaries

TRACT NO.	PARCEL NO.	AREA IN UNIT (ACRES)
89	25-0000373000	2.621
94	13-0000377003	14.740
95	13-0000348000	25.219
96	13-0000158000	69.625
97	13-0000160000	29.568
98	13-0000520000	1.332
99	13-0000159000	17.749
100	13-0000223001	1.170
101	13-0000190000	15.652
102	13-0000898000	1.079
106	13-0000000000	1.055

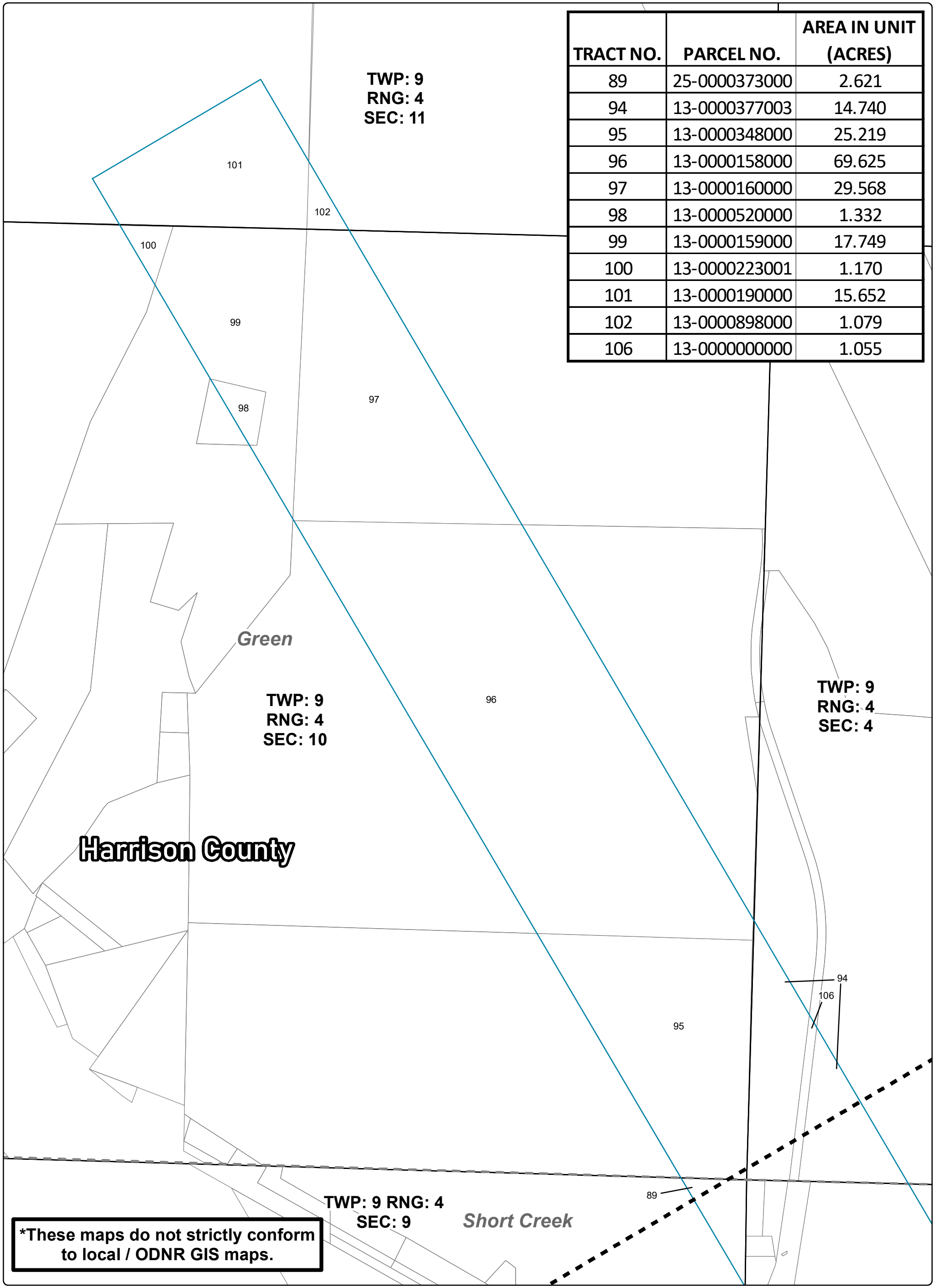

*These maps do not strictly conform to local / ODNR GIS maps.

CRICKET E SHC HR

Exhibit C-1

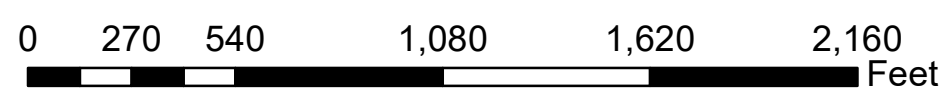

1 INCH = 1,021 FEET
Cricket E SHC HR Unit

- Cricket E SHC HR Unit - 447.700 Ac.
- Municipal Townships
- PLSS Section
- Tax Parcels
- County Boundaries

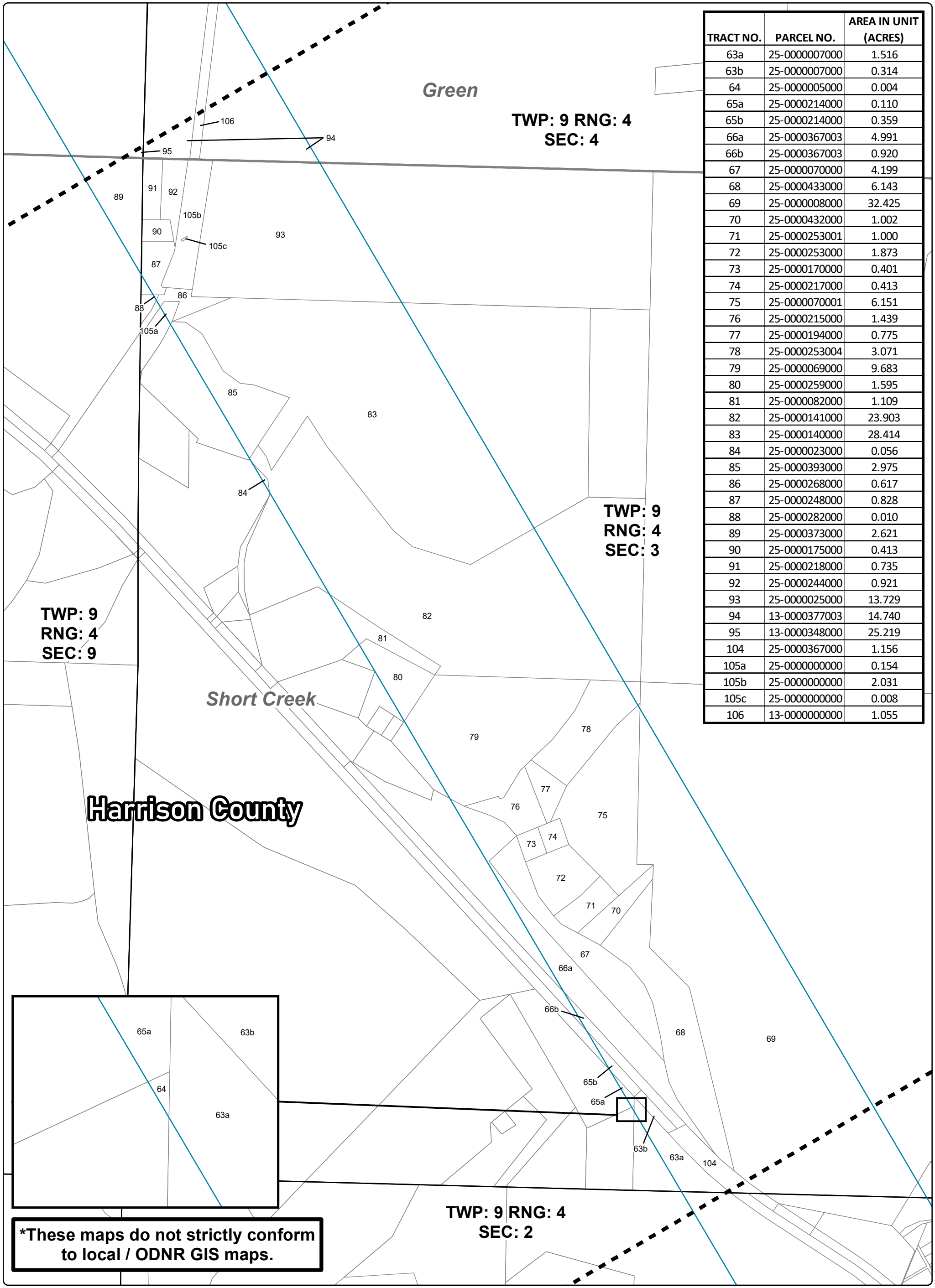

TRACT NO.	PARCEL NO.	AREA IN UNIT (ACRES)
63a	25-000007000	1.516
63b	25-000007000	0.314
64	25-000005000	0.004
65a	25-0000214000	0.110
65b	25-0000214000	0.359
66a	25-0000367003	4.991
66b	25-0000367003	0.920
67	25-0000070000	4.199
68	25-0000433000	6.143
69	25-0000080000	32.425
70	25-0000432000	1.002
71	25-0000253001	1.000
72	25-0000253000	1.873
73	25-0000170000	0.401
74	25-0000217000	0.413
75	25-0000070001	6.151
76	25-0000215000	1.439
77	25-0000194000	0.775
78	25-0000253004	3.071
79	25-0000069000	9.683
80	25-0000259000	1.595
81	25-0000082000	1.109
82	25-0000141000	23.903
83	25-0000140000	28.414
84	25-0000023000	0.056
85	25-0000393000	2.975
86	25-0000268000	0.617
87	25-0000248000	0.828
88	25-0000282000	0.010
89	25-0000373000	2.621
90	25-0000175000	0.413
91	25-0000218000	0.735
92	25-0000244000	0.921
93	25-0000025000	13.729
94	13-0000377003	14.740
95	13-0000348000	25.219
104	25-0000367000	1.156
105a	25-0000000000	0.154
105b	25-0000000000	2.031
105c	25-0000000000	0.008
106	13-0000000000	1.055

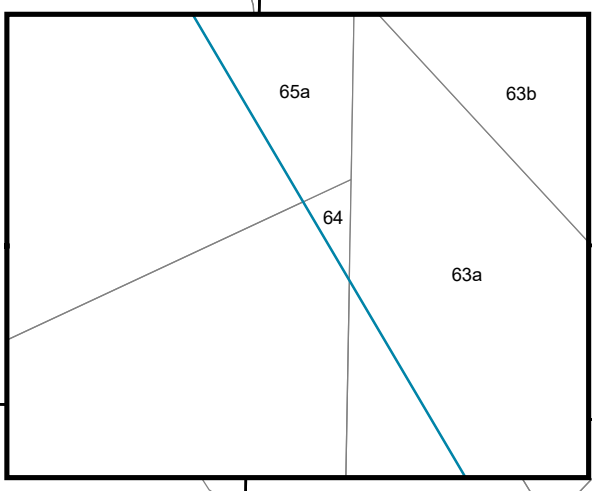

*These maps do not strictly conform to local / ODNR GIS maps.

CRICKET E SHC HR

Exhibit C-2



NAD 1927 StatePlane Ohio South FIPS 3402

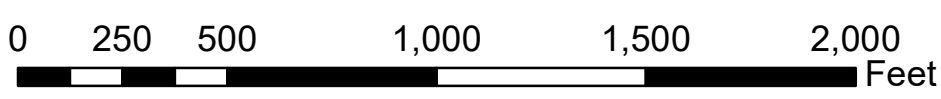

1 INCH = 1,021 FEET
Cricket E SHC HR Unit

- Cricket E SHC HR Unit - 447.700 Ac.
- Municipal Townships
- PLSS Section
- Tax Parcels
- County Boundaries

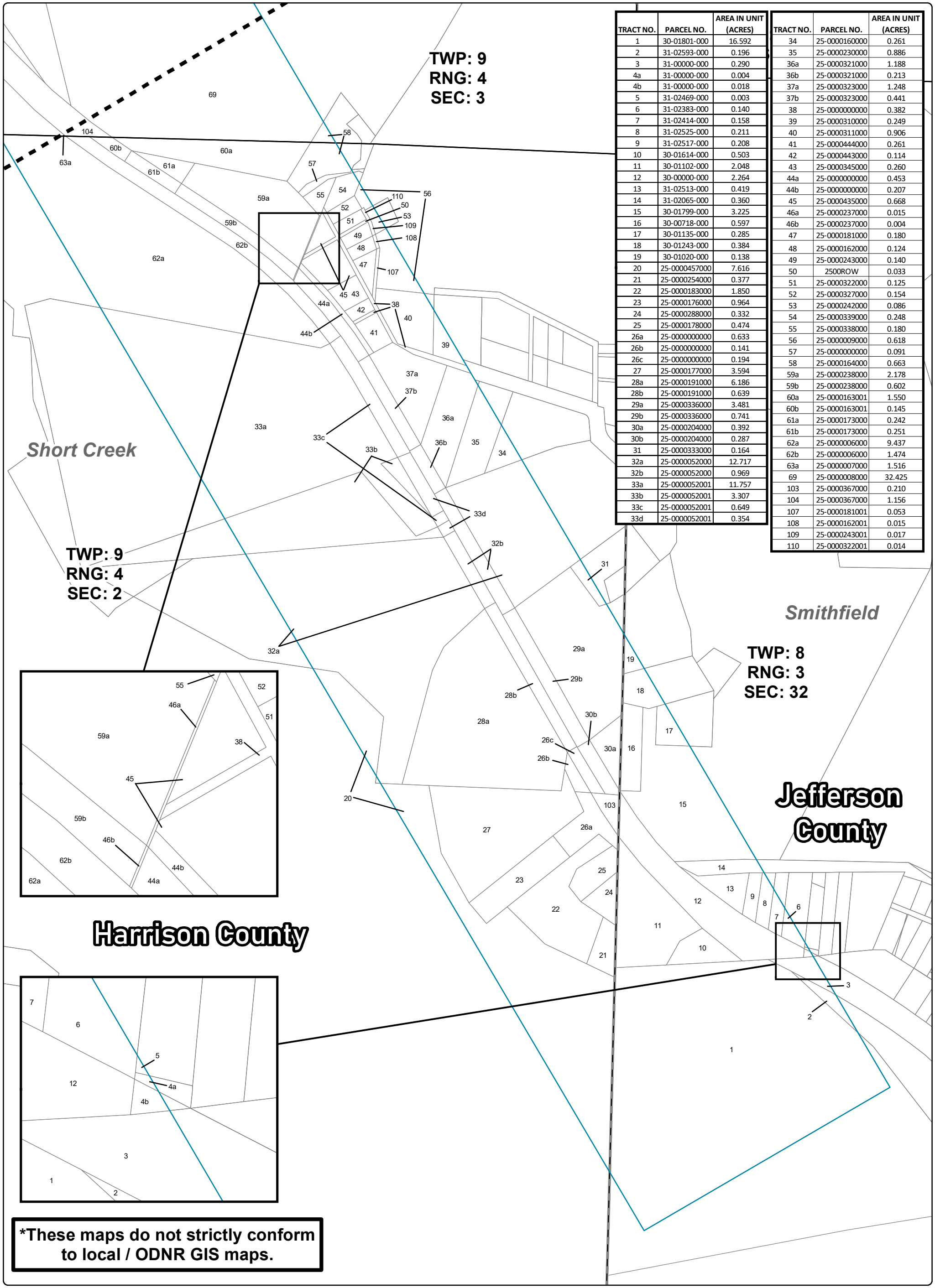

TRACT NO.	PARCEL NO.	AREA IN UNIT (ACRES)	TRACT NO.	PARCEL NO.	AREA IN UNIT (ACRES)
1	30-01801-000	16.592	34	25-0000160000	0.261
2	31-02593-000	0.196	35	25-0000230000	0.886
3	31-00000-000	0.290	36a	25-0000321000	1.188
4a	31-00000-000	0.004	36b	25-0000321000	0.213
4b	31-00000-000	0.018	37a	25-0000323000	1.248
5	31-02469-000	0.003	37b	25-0000323000	0.441
6	31-02383-000	0.140	38	25-0000000000	0.382
7	31-02414-000	0.158	39	25-0000310000	0.249
8	31-02525-000	0.211	40	25-0000311000	0.906
9	31-02517-000	0.208	41	25-0000444000	0.261
10	30-01614-000	0.503	42	25-0000443000	0.114
11	30-01102-000	2.048	43	25-0000345000	0.260
12	30-00000-000	2.264	44a	25-0000000000	0.453
13	31-02513-000	0.419	44b	25-0000000000	0.207
14	31-02065-000	0.360	45	25-0000435000	0.668
15	30-01799-000	3.225	46a	25-0000237000	0.015
16	30-00718-000	0.597	46b	25-0000237000	0.004
17	30-01135-000	0.285	47	25-0000181000	0.180
18	30-01243-000	0.384	48	25-0000162000	0.124
19	30-01020-000	0.138	49	25-0000243000	0.140
20	25-0000457000	7.616	50	2500ROW	0.033
21	25-0000254000	0.377	51	25-0000322000	0.125
22	25-0000183000	1.850	52	25-0000327000	0.154
23	25-0000176000	0.964	53	25-0000242000	0.086
24	25-0000288000	0.332	54	25-0000339000	0.248
25	25-0000178000	0.474	55	25-0000338000	0.180
26a	25-0000000000	0.633	56	25-0000009000	0.618
26b	25-0000000000	0.141	57	25-0000000000	0.091
26c	25-0000000000	0.194	58	25-0000164000	0.663
27	25-0000177000	3.594	59a	25-0000238000	2.178
28a	25-0000191000	6.186	59b	25-0000238000	0.602
28b	25-0000191000	0.639	60a	25-0000163001	1.550
29a	25-0000336000	3.481	60b	25-0000163001	0.145
29b	25-0000336000	0.741	61a	25-0000173000	0.242
30a	25-0000204000	0.392	61b	25-0000173000	0.251
30b	25-0000204000	0.287	62a	25-0000060000	9.437
31	25-0000333000	0.164	62b	25-0000060000	1.474
32a	25-0000052000	12.717	63a	25-0000070000	1.516
32b	25-0000052000	0.969	69	25-0000080000	32.425
33a	25-0000052001	11.757	103	25-0000367000	0.210
33b	25-0000052001	3.307	104	25-0000367000	1.156
33c	25-0000052001	0.649	107	25-0000181001	0.053
33d	25-0000052001	0.354	108	25-0000162001	0.015
			109	25-0000243001	0.017
			110	25-0000322001	0.014

*These maps do not strictly conform to local / ODNR GIS maps.

CRICKET E SHC HR

Exhibit C-3



NAD 1927 StatePlane Ohio South FIPS 3402

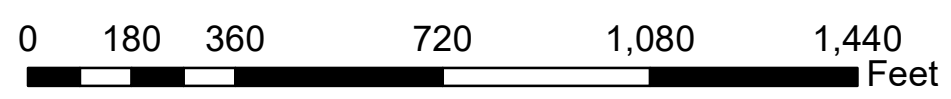

1 INCH = 1,021 FEET
Cricket E SHC HR Unit

- Cricket E SHC HR Unit - 447.700 Ac.
- Municipal Townships
- PLSS Section
- Tax Parcels
- County Boundaries

UNIT PARCEL CHART:

TRACT NO.	PARCEL NO.	AREA IN UNIT (ACRES)
1	30-01801-000	16.592
2	31-02593-000	0.196
3	31-00000-000	0.290
4a	31-00000-000	0.004
4b	31-00000-000	0.018
5	31-02469-000	0.003
6	31-02383-000	0.140
7	31-02414-000	0.158
8	31-02525-000	0.211
9	31-02517-000	0.208
10	30-01614-000	0.503
11	30-01102-000	2.048
12	30-00000-000	2.264
13	31-02513-000	0.419
14	31-02065-000	0.360
15	30-01799-000	3.225
16	30-00718-000	0.597
17	30-01135-000	0.285
18	30-01243-000	0.384
19	30-01020-000	0.138
20	25-0000457000	7.616
21	25-0000254000	0.377
22	25-0000183000	1.850
23	25-0000176000	0.964
24	25-0000288000	0.332
25	25-0000178000	0.474
26a	25-0000000000	0.633
26b	25-0000000000	0.141
26c	25-0000000000	0.194
27	25-0000177000	3.594
28a	25-0000191000	6.186
28b	25-0000191000	0.639
29a	25-0000336000	3.481
29b	25-0000336000	0.741
30a	25-0000204000	0.392
30b	25-0000204000	0.287
31	25-0000333000	0.164
32a	25-0000052000	12.717
32b	25-0000052000	0.969
33a	25-0000052001	11.757
33b	25-0000052001	3.307
33c	25-0000052001	0.649
33d	25-0000052001	0.354
34	25-0000160000	0.261
35	25-0000230000	0.886
36a	25-0000321000	1.188
36b	25-0000321000	0.213
37a	25-0000323000	1.248
37b	25-0000323000	0.441
38	25-0000000000	0.382
39	25-0000310000	0.249
40	25-0000311000	0.906
41	25-0000444000	0.261
42	25-0000443000	0.114
43	25-0000345000	0.260
44a	25-0000000000	0.453
44b	25-0000000000	0.207
45	25-0000435000	0.668
46a	25-0000237000	0.015
46b	25-0000237000	0.004
47	25-0000181000	0.180
48	25-0000162000	0.124
49	25-0000243000	0.140
50	2500ROW	0.033
51	25-0000322000	0.125
52	25-0000327000	0.154
53	25-0000242000	0.086
54	25-0000339000	0.248
55	25-0000338000	0.180

TRACT NO.	PARCEL NO.	AREA IN UNIT (ACRES)
56	25-0000009000	0.618
57	25-0000000000	0.091
58	25-0000164000	0.663
59a	25-0000238000	2.178
59b	25-0000238000	0.602
60a	25-0000163001	1.550
60b	25-0000163001	0.145
61a	25-0000173000	0.242
61b	25-0000173000	0.251
62a	25-0000060000	9.437
62b	25-0000060000	1.474
63a	25-0000007000	1.516
63b	25-0000007000	0.314
64	25-0000005000	0.004
65a	25-0000214000	0.110
65b	25-0000214000	0.359
66a	25-0000367003	4.991
66b	25-0000367003	0.920
67	25-0000070000	4.199
68	25-0000433000	6.143
69	25-0000008000	32.425
70	25-0000432000	1.002
71	25-0000253001	1.000
72	25-0000253000	1.873
73	25-0000170000	0.401
74	25-0000217000	0.413
75	25-0000070001	6.151
76	25-0000215000	1.439
77	25-0000194000	0.775
78	25-0000253004	3.071
79	25-0000069000	9.683
80	25-0000259000	1.595
81	25-0000082000	1.109
82	25-0000141000	23.903
83	25-0000140000	28.414
84	25-0000023000	0.056
85	25-0000393000	2.975
86	25-0000268000	0.617
87	25-0000248000	0.828
88	25-0000282000	0.010
89	25-0000373000	2.621
90	25-0000175000	0.413
91	25-0000218000	0.735
92	25-0000244000	0.921
93	25-0000025000	13.729
94	13-0000377003	14.740
95	13-0000348000	25.219
96	13-0000158000	69.625
97	13-0000160000	29.568
98	13-0000520000	1.332
99	13-0000159000	17.749
100	13-0000223001	1.170
101	13-0000190000	15.652
102	13-0000898000	1.079
103	25-0000367000	0.210
104	25-0000367000	1.156
105a	25-0000000000	0.154
105b	25-0000000000	2.031
105c	25-0000000000	0.008
106	13-0000000000	1.055
107	25-0000181001	0.053
108	25-0000162001	0.015
109	25-0000243001	0.017
110	25-0000322001	0.014
	TOTALS:	447.7

