



Ohio Department of Natural Resources

MIKE DEWINE, GOVERNOR

MARY MERTZ, DIRECTOR

Eric Vendel, Chief

Division of Oil and Gas Resources Management
2045 Morse Rd, Building F
Columbus, Ohio 43229
Phone: (614) 265-6922; Fax: (614) 265-6910

9489009000276359198104

ORDER BY THE CHIEF

June 21, 2022

ORDER NO. 2022-146

**TO: EAP Ohio, LLC
5847 San Felipe, Suite 400
Houston, TX 77057**

**RE: Application for Unitization
Crawford North Unit
Jefferson County, Ohio**

**SUBJECT: Order for Unit Operations of the Utica shale and Point Pleasant Formation
for the Crawford North Unit**

Pursuant to Ohio Revised Code (“R.C.”) § 1509.28, the Chief of the Division of Oil and Gas Resources Management (“Chief” or “Division”) makes the following Findings and issues the following Order with respect to EAP Ohio, LLC’s (“EAP”) Application for Unit Operations for the Crawford North Unit:

DEFINITIONS:

As used in this order:

- 1) “Person” has the same meaning as in R.C. § 1509.01.
- 2) “Application” means the application of EAP Ohio, LLC for Unit Operation of the Crawford North Unit dated February 8, 2022, and includes all updates, amendments, and supplements to it.
- 3) “Royalty interest owner” means a person or the estate of a person, other than a working interest owner, who owns the right to or interest in any portion of the oil and/or gas, or proceeds from the sale thereof, from a tract.

- 4) “Working interest” means an interest in oil and/or gas in the unit area by virtue of a lease, operating agreement, fee title, or otherwise, including a carried interest, the owner of which is obligated to pay, either in cash or out of production or otherwise a portion of the unit expense.
- 5) “Working interest owner” means a person or the estate of a person who owns an interest in oil and/or gas in the unit area by virtue of a lease, operating agreement, fee title, or otherwise, including a carried interest, the owner of which is obligated to pay, either in cash or out of production or otherwise a portion of the unit expense. “Working interest owner” does not include an unleased mineral owner.
- 6) “Unleased mineral owner” means a royalty interest owner who owns oil and/or gas rights free of a lease or other instrument conveying all or any portion of the working interest in such rights to another. At the time of this order, the unleased mineral owners identified by EAP include those listed on Exhibit A.
- 7) “Consenting working interest owner” means any working interest owner who enters into an agreement with EAP pertaining to the operation of the Crawford North Unit.
- 8) “Non-consenting working interest owner” means a working interest owner who does not enter into an agreement with EAP pertaining to the operation of the Crawford North Unit. At the time of this order, the non-consenting working interest owners identified by EAP include those listed on Exhibit B.
- 9) “Gas” has the same meaning as in R.C. § 1509.01.
- 10) “Oil” has the same meaning as in R.C. § 1509.01.
- 11) “Unit Area” means all of the lands, oil and gas leases and/or oil and gas interests of the tracts as shown in Exhibit C totaling 565.497 acres located in Salem Township, Jefferson County, Ohio as shown in Exhibit D.
- 12) “Unit Participation” means the ratio of the surface acreage of a specific tract in the unit area to the total surface acreage of the unit area as that total surface acreage is specified in paragraph one of the Plan for Unit Operations of this order.
- 13) “Gross Proceeds” means a share of the gross production of oil, gas, condensate, and natural gas liquids free of any and all cost of producing, gathering, storing, separating, treating, dehydrating, compressing, processing, transporting, marketing, or pipeline construction and maintenance.
- 14) “Net Proceeds” means the share of gross production of oil, gas, condensate, or natural gas liquids after payment of all costs of producing, gathering, storing, separating, treating, dehydrating, compressing, processing, transporting, and marketing and taxes.

BACKGROUND:

- 1) EAP filed the application pursuant to R.C. § 1509.28 to conduct unit operations.
- 2) Pursuant to R.C. § 1509.28, the Division held a hearing on April 27, 2022 in Columbus, Ohio at the Ohio Department of Natural Resources ("ODNR"). The hearing was held to consider the need for the operation as a unit of an entire pool or part thereof. EAP representatives provided testimony on the application and answered questions from Division staff.
- 3) The unit operations will occur at an approximate true vertical depth located from the top of the Utica shale to the base of the Point Pleasant Formation.

FINDINGS:

- 1) Based on the application and testimony by EAP's representatives, the Chief finds that EAP has established that it is the "owner," as that term is defined in R.C. § 1509.01(K), of greater than 65% of the land area overlying the pool in the Crawford North Unit as required by R.C. § 1509.28(A).
- 2) Based on the application and testimony by EAP's representatives, the Chief finds that the operation of the Crawford North Unit is reasonably necessary to increase substantially the ultimate recovery of oil and gas.
- 3) Based on the application and testimony by EAP's representatives, the Chief finds the value of the estimated additional recovery of oil or gas from the Crawford North Unit exceeds the estimated additional cost incident to conducting the operation of the Crawford North Unit.

ORDER:

IT IS HEREBY ORDERED:

Pursuant to R.C. § 1509.28, EAP is authorized to conduct operations within the Crawford North Unit in accordance with all of the following:

Plan for Unit Operations

- 1) The unit area is comprised of the tracts totaling 565.497 acres in Salem Township, Jefferson County, Ohio, as shown on Exhibit D.
- 2) EAP proposes to drill three wells in the Crawford North Unit for the purpose of recovering oil and gas. EAP shall drill at least one well to total measured depth as specified in the application in the unit area within 12 months from the date of approval of this Order as prescribed in Paragraph 10 of this order. If EAP fails to drill at least one well to total

measured depth as specified in the application in the unit area within 12 months from the date of approval of this Order as prescribed in Paragraph 10 of this order, the Chief may revoke this order. In order to achieve the stated goal of substantially increasing the ultimate recovery of oil and gas from the Utica shale and Point Pleasant Formation within the unit area, EAP shall produce from three wells no later than four years after the date of approval of this order. If EAP fails to drill, complete, and produce at least three wells in the unit area, the Chief may amend or revoke this order. Any additional wells permitted by the Chief for the Utica shale and Point Pleasant Formation in the unit area are subject to this order.

- 3) Evidence introduced by EAP at the Crawford North Unit hearing establishes that the Utica shale and Point Pleasant Formation uniformly underlies the unit area. Therefore, the allocated share of production to each tract shall be equal to that tract's unit participation.
- 4) Except as provided in Paragraph 9(d) of this order, all charges and credits made for investments in wells, tanks, pumps, machinery, materials, and equipment contributed to the Crawford North Unit operations shall be allocated among the working interest owners of each tract based on the unit participation. The proportionate share of the expenses attributable to tracts of the unleased mineral owners shall be allocated to EAP and the working interest owners.
- 5) All unit operation expenses, including capital investment, shall be charged to, and paid by, EAP and working interest owners in amounts based on the unit participation plus their proportionate share of the expenses attributable to the tracts of unleased mineral owners. All unit operation expenses concerning wells and operating equipment shall be just and reasonable.
- 6) If necessary, EAP and the consenting working interest owners shall carry, or otherwise finance, any non-consenting working interest owners who are unable to meet their financial obligations in connection with the unit operations. EAP and all other consenting working interest owners' reasonable interest charge for carrying or financing the non-consenting working interest owners shall be determined by the terms of EAP's Unit Agreement and Model Form Operating Agreement for the Crawford North Unit. Once a specific cost is charged to the initial well, that same cost cannot be charged to subsequent wells in the unit area.
- 7) EAP shall supervise and conduct all unit operations. Each working interest owner shall have a voting interest equal to its Unit Participation. Approval of unit operations shall be subject to the terms of EAP's Unit Agreement and Model Form Operating Agreement for the Crawford North Unit.
- 8) Unit operations may commence as of 7:00 a.m. on the day following the date of approval of this order as prescribed in Paragraph 10 of this order. Once the initial well is placed into production, operations within the Crawford North Unit may continue as long as hydrocarbons are produced from any well in the unit area without a cessation of more than

90 days, unless otherwise approved by the Chief in writing. The Crawford North Unit may be terminated if working interest owners owning at least 51% of the working interest in the unit area determine that the unit operations are no longer warranted. If the unit operations are so terminated, EAP shall provide written notice of the termination to the Division and to all unleased mineral owners. In addition to the notice of termination, EAP shall provide an affidavit to the Division attesting to the basis of the termination and all dates applicable to that basis. If termination of unit operations occurs prior to drilling and completing for production of two wells in the Crawford North Unit, the Chief may amend this order.

- 9) The following additional provisions are found to be appropriate:
- a) No activity associated with the drilling, completion, or operation of the Crawford North Unit shall be conducted on the surface of any unleased property without the prior written consent of the owner of the surface rights of the unleased property.
 - b) Unleased mineral owners shall not incur liability for any personal or property damage associated with any drilling, testing, completing, producing, operating, or plugging and restoration activities within the Crawford North Unit.
 - c) Each unleased mineral owner shall receive a monthly cash payment equal to a one-eighth share of the gross proceeds from production. Allocation of the one-eighth share shall be based on the unit participation of each unleased mineral owner's tract. EAP shall make monthly cash payments to all unleased mineral owners at the same time the royalty interest owners are paid.
 - d) In addition to the cash payment specified in paragraph 9(c) of this Order, each unleased mineral owner shall receive a monthly cash payment equal to a seven-eighths share of the net proceeds from production. Allocation of the seven-eighths share shall be based on the unit participation of each unleased mineral owner's tract. After EAP recovers 200% of the cost of drilling, testing, and completing the initial well, EAP shall begin making the monthly payments to the unleased mineral owners for that well. For each additional well drilled in the unit area, EAP shall begin making monthly payments equal to seven-eighths share of net proceeds from production to each unleased mineral owner once the working interest owners have recovered 150% of the cost of drilling, testing, and completing each additional well. Once a specific cost is charged to the initial well, that same cost cannot be charged to subsequent wells in the unit area.
 - e) Nothing in this order prohibits an unleased mineral owner from entering into a lease agreement with EAP or with any other person. An unleased mineral owner who enters into a lease of their mineral interests with any person after the issuance of this order is no longer an unleased mineral owner under this order as of the effective date of the lease. EAP shall notify the Division upon the execution of a lease agreement with any unleased mineral owner who is subject to this order.

- f) Except as provided in Paragraph 9(d) of this order, no expenses shall be paid by an unleased mineral owner for drilling, testing, completing, producing, or operating any well in the unit area. Moreover, unleased mineral owners are not responsible for any costs related to plugging any well or any restoration in the unit area.
- g) If requested in writing by any unleased mineral owner or by any non-consenting working interest owner, or in any manner by the Division, EAP shall provide, not later than 30 days after the request, any of the following:
 - i. A monthly statement of all costs incurred, together with the quantity of oil and gas produced, and the amount of proceeds realized from the sale of production during the preceding month; and
 - ii. Any authorization for expenditure (AFE) prepared by EAP; and
 - iii. A statement of all costs and expenses for purposes of Paragraphs 6 and 9(d) of this order.
- h) EAP shall notify the Division of the assignment or transfer of any of its working interest in the Crawford North Unit. If EAP assigns or transfers any of its working interest, the assignee or transferee shall comply with this order. Within 60 days of the notice of assignment or transfer, EAP shall file a copy of the notice with the Jefferson County (Ohio) Recorder's Office, in the records of each of the tracts that are subject to this order and referenced in Exhibit D of this order. EAP shall submit a certification of the filing to the Division within 14 days of filing.
- i) EAP shall notify the Division within 30 days if a person that is leased by EAP, or any other consenting working interest owner, for purposes of operating the Crawford North Unit becomes unleased. If a person becomes unleased, the person is an unleased owner under this order and paragraphs 9(a) through 9(g) of this order apply.
- j) EAP shall notify the Division if any consenting working interest owner revokes, rescinds, or otherwise terminates the agreement with EAP pertaining to the operation of the Crawford North Unit. If a consenting working interest owner revokes, rescinds, or otherwise terminates the agreement with EAP, the working interest owner becomes a non-consenting working interest owner pursuant to this order. EAP also shall notify the Division if any consenting working interest owner assigns or transfers all or part of its working interest in the Crawford North Unit. All such assignees or transferees are subject to this order.
- k) EAP shall notify the Division if any non-consenting working interest owner enters into an agreement with EAP pertaining to the operation of the Crawford North Unit. If a non-consenting working interest owner enters into an agreement with EAP, the

non-consenting working interest owner becomes a consenting working interest owner pursuant to this order.

- 1) If at any point EAP and consenting working interest owners own less than 65% of the unit, the Chief may amend or revoke this order.
- 10) This order becomes effective on the date EAP provides the Chief with final written approval of the unit operations as prescribed in this order by EAP and consenting working interest owners, and also by the royalty interest owners or, with respect to unleased acreage, unleased mineral owners of 65% of the acreage to be included in the unit. Unit operations may commence as set forth in Paragraph 8 of this Order. If EAP fails to provide all required approvals by December 21, 2022, the order is revoked, and the Chief shall provide notice of the revocation to EAP and to all persons listed in Exhibit C to this order.
- 11) If this Chief's Order is appealed, the time periods specified in this order are tolled pending final determination of the appeal.
- 12) Within 21 days of this order becoming effective, EAP shall file a copy of this order within the records of each of the tracts that are subject to this order and referenced in Exhibit D of this order. EAP shall submit a certification of the filing to the Division within 14 days of filing. The certification shall include a reference to the volume and page number corresponding to each record where the Chief's Order is recorded.
- 13) The Chief of the Division retains continuing jurisdiction over the Crawford North Unit as is consistent with the Chief's powers and duties as established by R.C. Chapter 1509 and Ohio Admin. Code 1501:9. The Chief reserves the right to amend or revoke this Order subsequent to the commencement of unit operations within the unit area.
- 14) Except as specifically set forth in the terms of this order, nothing herein shall be construed as a release or waiver of any private right, obligation, duty, claim, or cause of action.

- 15) If there is a conflict between the terms of this Chief's Order and any part of EAP's application, the Chief's Order takes precedence.

June 22, 2022

Date

/s/ *Eric Vendel*

Eric Vendel, Chief

Division of Oil and Gas Resources Management

Addressee is hereby notified that this action is final and effective and may be appealed pursuant to Section 1509.36 of the Ohio Revised Code. If the Order is appealed to the Ohio Oil and Gas Commission, the appeal must be in writing and must set forth the Orders complained of and the grounds upon which the appeal is based. Such appeal must be filed with the Oil and Gas Commission, 2045 Morse Road, Building E-1, Office 103, Columbus, Ohio 43229-6693, within 30 days after the date upon which the person to whom the Order was issued received the order and, for all other persons adversely affected by the order, within 30 days after the date of the Order.

In addition, within three days after the appeal is filed with the Oil and Gas Commission, notice of the filing must be submitted to Eric Vendel, Chief, Division of Oil and Gas Resources Management, Ohio Department of Natural Resources, 2045 Morse Road, Building F, Columbus, Ohio 43229-6693.

Enclosures: Exhibit A
Exhibit B
Exhibit C
Exhibit D

Exhibit A

Unleased Mineral Owners

| TRACT NUMBER | LEASE ID NUMBER | CURRENT MINERAL OWNERS | LEASED YES/NO | DECIMAL INTEREST IN TRACT | SURFACE ACRES IN UNIT (NET) | TRACT PARTICIPATION IN UNIT | TAX MAP PARCEL ID | TRACT SURFACE USE | TOWNSHIP | COUNTY | ADDRESS | CITY | STATE | ZIP CODE |
|------------------------------|-----------------|--|---------------|---------------------------|-----------------------------|-----------------------------|-------------------|-------------------|----------|-----------|--|------------------|-------|----------|
| 22 | UNLEASED | Samuel L Williams Jr and Julie S Williams, Husband and Wife | No | 1.000000 | 0.205000 | 0.036251% | 24-01375-000 | Residential | Salem | Jefferson | 103 Township Road 261 | Bergholz | OH | 43908 |
| 24 | UNLEASED | William Plant and Janice Plant, Husband and Wife | No | 1.000000 | 0.023000 | 0.004067% | 24-02572-000 | Vacant | Salem | Jefferson | P.O. Box 124 | East Springfield | OH | 43925 |
| 25 | UNLEASED | William Plant and Janice Plant, Husband and Wife | No | 1.000000 | 0.773000 | 0.136694% | 24-01014-000 | Residential | Salem | Jefferson | P.O. Box 124 | East Springfield | OH | 43925 |
| 30 | UNLEASED | Richard A Hutchison and Barara L Hutchison, Husband and Wife | No | 1.000000 | 0.896000 | 0.158445% | 24-00217-000 | Vacant | Salem | Jefferson | 702 Longhorn St NW | Carrollton | OH | 44615 |
| 31 | UNLEASED | William W Plant | No | 0.500000 | 0.400000 | 0.070734% | 24-01017-000 | Vacant | Salem | Jefferson | P.O. Box 124 | East Springfield | OH | 43925 |
| 31 | UNLEASED | Janice Faye Plant | No | 0.500000 | 0.400000 | 0.070734% | 24-01017-000 | Vacant | Salem | Jefferson | P.O. Box 124 | East Springfield | OH | 43925 |
| 32 | UNLEASED | William W Plant | No | 0.500000 | 0.641500 | 0.113440% | 24-00228-000 | Residential | Salem | Jefferson | P.O. Box 124 | East Springfield | OH | 43925 |
| 32 | UNLEASED | Janice Faye Plant | No | 0.500000 | 0.641500 | 0.113440% | 24-00228-000 | Residential | Salem | Jefferson | P.O. Box 124 | East Springfield | OH | 43925 |
| 33 | UNLEASED | William Plant and Janice Plant, Husband and Wife | No | 1.000000 | 0.991000 | 0.175244% | 24-00562-000 | Residential | Salem | Jefferson | P.O. Box 124 | East Springfield | OH | 43925 |
| 34 | UNLEASED | William Plant and Janice Plant, Husband and Wife | No | 1.000000 | 0.969000 | 0.171354% | 24-01020-000 | Vacant | Salem | Jefferson | P.O. Box 124 | East Springfield | OH | 43925 |
| 37 | UNLEASED | B & D McElroy Enterprises, Inc | No | 1.000000 | 1.008000 | 0.178250% | 24-00395-000 | Commercial | Salem | Jefferson | C/O William D McElroy 7531 State Route 43 | East Springfield | OH | 43925 |
| 39 | UNLEASED | William Plant and Janice Plant, Husband and Wife | No | 1.000000 | 0.476000 | 0.084174% | 24-01015-000 | Residential | Salem | Jefferson | P.O. Box 124 | East Springfield | OH | 43925 |
| 40 | UNLEASED | Daniel Stacey | No | 1.000000 | 0.747000 | 0.132096% | 24-01226-000 | Vacant | Salem | Jefferson | 7295 State Route 43 | Bergholz | OH | 43908 |
| 41 | UNLEASED | Richard A Hutchison and Barara L Hutchison, Husband and Wife | No | 1.000000 | 0.512000 | 0.090540% | 24-00219-000 | Residential | Salem | Jefferson | 702 Longhorn St NW | Carrollton | OH | 44615 |
| 42 | UNLEASED | Daniel Stacey | No | 1.000000 | 0.318000 | 0.056234% | 24-01227-000 | Residential | Salem | Jefferson | 7295 State Route 43 | Bergholz | OH | 43908 |
| 45 | UNLEASED | Cheryl Fisher nka Cheryl Pugh | No | 0.333333 | 0.510667 | 0.090304% | 24-00402-000 | Residential | Salem | Jefferson | 2344 Castle Road SE | Scio | OH | 43988 |
| 45 | UNLEASED | Peter Flenniken | No | 0.333333 | 0.510667 | 0.090304% | 24-00402-000 | Residential | Salem | Jefferson | 1753 Maple Ave. | Wellsville | OH | 43968 |
| 45 | UNLEASED | Phillip Flenniken | No | 0.333333 | 0.510667 | 0.090304% | 24-00402-000 | Residential | Salem | Jefferson | 373 Township Road 262 | Bloomingtondale | OH | 43910 |
| 68 | UNLEASED | Richard A Hutchison and Barara L Hutchison, Husband and Wife | No | 1.000000 | 0.030000 | 0.005305% | 24-00218-000 | Vacant | Salem | Jefferson | 702 Longhorn St NW | Carrollton | OH | 44615 |
| 69 | UNLEASED | William W Plant | No | 0.500000 | 0.095500 | 0.016888% | 24-01016-000 | Residential | Salem | Jefferson | P.O. Box 124 | East Springfield | OH | 43925 |
| 69 | UNLEASED | Janice Faye Plant | No | 0.500000 | 0.095500 | 0.016888% | 24-01016-000 | Residential | Salem | Jefferson | P.O. Box 124 | East Springfield | OH | 43925 |
| 70 | UNLEASED | Anthony Edward Polverini | No | 1.000000 | 22.818000 | 4.035035% | 24-02074-000 | Agricultural | Salem | Jefferson | 4538 Sunset Boulevard | Steubenville | OH | 43952 |
| 71 | UNLEASED | Stacy J Denoon | No | 1.000000 | 0.083000 | 0.014677% | 24-00240-000 | Residential | Salem | Jefferson | 2737 County Road 78 | Amsterdam | OH | 43903 |
| 82 | UNLEASED | Daniel E Stacey and Mary C Stacey, Husband and Wife | No | 1.000000 | 0.395000 | 0.069850% | 24-00505-000 | Residential | Salem | Jefferson | 7295 State Route 43 | Bergholz | OH | 43908 |
| 98 | UNLEASED | Anthony Edward Polverini | No | 1.000000 | 54.712000 | 9.675029% | 24-00004-000 | Agricultural | Salem | Jefferson | 4538 Sunset Boulevard | Steubenville | OH | 43952 |
| 99 | UNLEASED | William D McElroy | No | 1.000000 | 2.122000 | 0.375245% | 24-00387-000 | Residential | Salem | Jefferson | 6854 State Route 43 | East Springfield | OH | 43925 |
| 101 | UNLEASED | William D McElroy | No | 1.000000 | 0.138000 | 0.024403% | 24-01999-000 | Vacant | Salem | Jefferson | 6854 State Route 43 | East Springfield | OH | 43925 |
| TOTAL UNLEASED ACRES: | | | | | 91.022 | 16.095930% | | | | | | | | |
| TOTAL UNIT ACRES: | | | | | 565.497 | | | | | | | | | |

Exhibit B

Non-Consenting Working Interest Owners

| TRACT NUMBER | NON-CONSENTING WORKING INTEREST OWNER | ADDRESS | CITY | STATE | ZIP CODE | LEASED YES/NO | DECIMAL INTEREST IN TRACT (NET) | SURFACE ACRES IN UNIT (NET) | TRACT PARTICIPATION IN UNIT | TAX MAP PARCEL ID | TOWNSHIP | COUNTY |
|------------------------------------|---|--------------------------------|---------------|-------|----------|---------------|---------------------------------|-----------------------------|-----------------------------|-------------------|----------|-----------|
| 8 | CALIBER RESOURCE PARTNERS ATTN: SHILPA ABBITT | 6301 WATERFORD BLVD, SUITE 215 | OKLAHOMA CITY | OK | 73118 | Yes | 0.666667 | 20.517 | 3.628195% | 24-02469-000 | Salem | Jefferson |
| 23 | CALIBER RESOURCE PARTNERS ATTN: SHILPA ABBITT | 6301 WATERFORD BLVD, SUITE 215 | OKLAHOMA CITY | OK | 73118 | Yes | 0.666667 | 0.649 | 0.114825% | 24-00238-000 | Salem | Jefferson |
| 53 | ANTHONY MINING COMPANY, INC. ATTN: PAUL CARAPELLOTTI | PO BOX 1298 | STEUBENVILLE | OH | 43952 | Yes | 1.000000 | 0.315 | 0.055703% | 24-00716-000 | Salem | Jefferson |
| 57 | CALIBER RESOURCE PARTNERS ATTN: SHILPA ABBITT | 6301 WATERFORD BLVD, SUITE 215 | OKLAHOMA CITY | OK | 73118 | Yes | 1.000000 | 1.086 | 0.192043% | 24-01894-000 | Salem | Jefferson |
| 60 | CALIBER RESOURCE PARTNERS ATTN: SHILPA ABBITT | 6301 WATERFORD BLVD, SUITE 215 | OKLAHOMA CITY | OK | 73118 | Yes | 1.000000 | 9.543 | 1.687542% | 24-01303-000 | Salem | Jefferson |
| 74 | CALIBER RESOURCE PARTNERS ATTN: SHILPA ABBITT | 6301 WATERFORD BLVD, SUITE 215 | OKLAHOMA CITY | OK | 73118 | Yes | 1.000000 | 5.451 | 0.963931% | 24-02376-000 | Salem | Jefferson |
| 79 | CALIBER RESOURCE PARTNERS ATTN: SHILPA ABBITT | 6301 WATERFORD BLVD, SUITE 215 | OKLAHOMA CITY | OK | 73118 | Yes | 1.000000 | 0.343 | 0.060655% | 24-00366-000 | Salem | Jefferson |
| 90 | CALIBER RESOURCE PARTNERS ATTN: SHILPA ABBITT | 6301 WATERFORD BLVD, SUITE 215 | OKLAHOMA CITY | OK | 73118 | Yes | 1.000000 | 5.569 | 0.984797% | 24-02525-002 | Salem | Jefferson |
| 93 | CALIBER RESOURCE PARTNERS ATTN: SHILPA ABBITT | 6301 WATERFORD BLVD, SUITE 215 | OKLAHOMA CITY | OK | 73118 | Yes | 1.000000 | 3.181 | 0.562514% | 24-02526-000 | Salem | Jefferson |
| 94 | CALIBER RESOURCE PARTNERS ATTN: SHILPA ABBITT | 6301 WATERFORD BLVD, SUITE 215 | OKLAHOMA CITY | OK | 73118 | Yes | 1.000000 | 1.338 | 0.236606% | 24-02525-001 | Salem | Jefferson |
| TOTAL NON-CONSENTING ACRES: | | | | | | | | 47.993 | 8.486812% | | | |
| TOTAL UNIT ACRES: | | | | | | | | 565.497 | | | | |

Exhibit C

| TRACT NUMBER | LEASE ID NUMBER | CURRENT MINERAL OWNERS | LEASED YES/NO | DECIMAL INTEREST IN TRACT | SURFACE ACRES IN UNIT (NET) | TRACT PARTICIPATION IN UNIT | TAX MAP PARCEL ID | TOWNSHIP | COUNTY | CONSENTING WORKING INTEREST PERCENTAGE | APPLICANT WORKING INTEREST PERCENTAGE | RIVERBEND OIL & GAS VI-B, LLC WORKING INTEREST PERCENTAGE | ASCENT RESOURCES - UTICA, LLC WORKING INTEREST PERCENTAGE | CALIBER RESOURCE PARTNERS WORKING INTEREST PERCENTAGE | ANTHONY MINING COMPANY, INC. WORKING INTEREST PERCENTAGE | ADDRESS | CITY | STATE | ZIP CODE |
|--------------|-----------------|---|---------------|---------------------------|-----------------------------|-----------------------------|-------------------|----------|-----------|--|---------------------------------------|---|---|---|--|---|------------------|-------|----------|
| 1 | EAP | Betty W Mazur | Yes | 1.000000 | 11.127 | 1.967650% | 24-02511-001 | Salem | Jefferson | 1.967650% | 1.967650% | 0.000000% | 0.000000% | 0.000000% | 0.000000% | 201 Township Road 263 | Bergholz | OH | 43908 |
| 2 | EAP | Marian Decker, a single woman | Yes | 1.000000 | 13.328 | 2.356865% | 24-01981-000 | Salem | Jefferson | 2.356865% | 2.356865% | 0.000000% | 0.000000% | 0.000000% | 0.000000% | P.O. Box 86 | East Springfield | OH | 43925 |
| 3 | EAP | Charles W Corder Sr and Diana Corder | Yes | 1.000000 | 0.019 | 0.003360% | 24-01845-000 | Salem | Jefferson | 0.003360% | 0.003360% | 0.000000% | 0.000000% | 0.000000% | 0.000000% | Box 128 | East Springfield | OH | 43925 |
| 4 | EAP | Betty W Mazur | Yes | 1.000000 | 2.057 | 0.363751% | 24-02511-000 | Salem | Jefferson | 0.363751% | 0.363751% | 0.000000% | 0.000000% | 0.000000% | 0.000000% | 201 Township Road 263 | Bergholz | OH | 43908 |
| 5 | EAP | Peyper Properties LLC | Yes | 1.000000 | 0.544 | 0.096199% | 24-01844-000 | Salem | Jefferson | 0.096199% | 0.096199% | 0.000000% | 0.000000% | 0.000000% | 0.000000% | C/O James Mills 1819 Township Highway 219 | Richmond | OH | 43944 |
| 6 | EAP | Ronald G Waggoner, Divorced and unremarried | Yes | 1.000000 | 11.242 | 1.987986% | 24-00754-000 | Salem | Jefferson | 1.987986% | 1.987986% | 0.000000% | 0.000000% | 0.000000% | 0.000000% | 7849 State Route 43 | Bergholz | OH | 43908 |
| 7 | EAP | Ronald G Waggoner, Divorced and unremarried | Yes | 1.000000 | 7.108 | 1.256947% | 24-00756-000 | Salem | Jefferson | 1.256947% | 1.256947% | 0.000000% | 0.000000% | 0.000000% | 0.000000% | 7849 State Route 43 | Bergholz | OH | 43908 |
| 8 | CALIBER | Mary M Zatta | Yes | 0.666667 | 20.517 | 3.628195% | 24-02469-000 | Salem | Jefferson | 0.000000% | 0.000000% | 0.000000% | 0.000000% | 3.628195% | 0.000000% | 55127 Maple Ave | Bridgeport | OH | 43912 |
| 8 | EAP | Anthony F Zatta Jr, A single man | Yes | 0.333333 | 10.259 | 1.814097% | 24-02469-000 | Salem | Jefferson | 1.814097% | 1.814097% | 0.000000% | 0.000000% | 0.000000% | 0.000000% | 1108 Bantam Ridge Road | Steubenville | OH | 43953 |
| 9 | EAP | Diane Wiley, a widow and not remarried | Yes | 1.000000 | 1.031 | 0.182318% | 24-01342-000 | Salem | Jefferson | 0.182318% | 0.182318% | 0.000000% | 0.000000% | 0.000000% | 0.000000% | 302 Township Road 263 | Bergholz | OH | 43908 |
| 10 | EAP | Terry L Call and Cathleen R Call, Husband and Wife | Yes | 0.500000 | 1.971 | 0.348543% | 24-00215-000 | Salem | Jefferson | 0.348543% | 0.348543% | 0.000000% | 0.000000% | 0.000000% | 0.000000% | 8060 County Road 39 | Bloomington | OH | 43910 |
| 10 | EAP | Donald H Call and Donna C Call, Husband and Wife | Yes | 0.500000 | 1.971 | 0.348543% | 24-00215-000 | Salem | Jefferson | 0.348543% | 0.348543% | 0.000000% | 0.000000% | 0.000000% | 0.000000% | 6250 Desert Road SW | Carrollton | OH | 44615 |
| 11 | EAP | Jack Cleary Cagot, a single person | Yes | 1.000000 | 6.697 | 1.184268% | 24-00213-000 | Salem | Jefferson | 1.184268% | 1.184268% | 0.000000% | 0.000000% | 0.000000% | 0.000000% | P.O. Box 154 | East Springfield | OH | 43925 |
| 12 | EAP | Robert Allen Galloway and Sandra K Galloway, Husband and Wife | Yes | 1.000000 | 9.430 | 1.667560% | 24-00653-000 | Salem | Jefferson | 1.667560% | 1.667560% | 0.000000% | 0.000000% | 0.000000% | 0.000000% | 5266 County Road 352 | Keystone Heights | FL | 32656 |
| 13a | EAP | VK Oil & Gas Enterprises LLC | Yes | 1.000000 | 16.032 | 2.835028% | 24-01101-000 | Salem | Jefferson | 2.835028% | 2.835028% | 0.000000% | 0.000000% | 0.000000% | 0.000000% | C/O Von Kurty 4517 Fairway Drive | Steubenville | OH | 43957 |
| 13b | EAP | Jack Lee Davis and Judith Ann Davis, Husband and Wife | Yes | 1.000000 | 0.143 | 0.025287% | 24-01101-000 | Salem | Jefferson | 0.025287% | 0.025287% | 0.000000% | 0.000000% | 0.000000% | 0.000000% | 28 Township Road 281, #18 Pleasant Hill Mobile Village | Steubenville | OH | 43952 |
| 14 | EAP | Ronald G Waggoner, Divorced and unremarried | Yes | 1.000000 | 5.075 | 0.897441% | 24-00755-000 | Salem | Jefferson | 0.897441% | 0.897441% | 0.000000% | 0.000000% | 0.000000% | 0.000000% | 7849 State Route 43 | Bergholz | OH | 43908 |
| 15 | EAP | Terry L Call and Cathleen R Call, Husband and Wife | Yes | 0.500000 | 2.263 | 0.400179% | 24-00214-000 | Salem | Jefferson | 0.400179% | 0.400179% | 0.000000% | 0.000000% | 0.000000% | 0.000000% | 8060 County Road 39 | Bloomington | OH | 43910 |
| 15 | EAP | Donald H Call and Donna C Call, Husband and Wife | Yes | 0.500000 | 2.263 | 0.400179% | 24-00214-000 | Salem | Jefferson | 0.400179% | 0.400179% | 0.000000% | 0.000000% | 0.000000% | 0.000000% | 6250 Desert Road SW | Carrollton | OH | 44615 |
| 16 | EAP/RIVER | Ronald D McElroy and Rayelene McElroy, Husband and Wife | Yes | 1.000000 | 0.049 | 0.008665% | 24-01319-000 | Salem | Jefferson | 0.008665% | 0.006499% | 0.002166% | 0.000000% | 0.000000% | 0.000000% | 2157 County Road 60 | Bergholz | OH | 43908 |
| 17 | EAP | Theresa M Lash, Divorced and not remarried | Yes | 1.000000 | 4.415 | 0.780729% | 24-02468-000 | Salem | Jefferson | 0.780729% | 0.780729% | 0.000000% | 0.000000% | 0.000000% | 0.000000% | P.O. Box 34 | East Springfield | OH | 43925 |
| 18 | EAP | Jeffco Resources, Inc | Yes | 1.000000 | 6.184 | 1.093551% | 24-01321-000 | Salem | Jefferson | 1.093551% | 1.093551% | 0.000000% | 0.000000% | 0.000000% | 0.000000% | C/O Paul Carapellotti P. O. Box 1298 | Steubenville | OH | 43952 |
| 19 | EAP | Terry L Call and Cathleen R Call, Husband and Wife | Yes | 0.500000 | 2.107 | 0.372593% | 24-00216-000 | Salem | Jefferson | 0.372593% | 0.372593% | 0.000000% | 0.000000% | 0.000000% | 0.000000% | 8060 County Road 39 | Bloomington | OH | 43910 |
| 19 | EAP | Donald H Call and Donna C Call, Husband and Wife | Yes | 0.500000 | 2.107 | 0.372593% | 24-00216-000 | Salem | Jefferson | 0.372593% | 0.372593% | 0.000000% | 0.000000% | 0.000000% | 0.000000% | 6250 Desert Road SW | Carrollton | OH | 44615 |
| 20 | EAP | Robert Allen Galloway and Sandra K Galloway, Husband and Wife | Yes | 1.000000 | 0.403 | 0.071265% | 24-00653-001 | Salem | Jefferson | 0.071265% | 0.071265% | 0.000000% | 0.000000% | 0.000000% | 0.000000% | 5266 County Road 352 | Keystone Heights | FL | 32656 |
| 21 | EAP | VK Oil & Gas Enterprises LLC | Yes | 1.000000 | 6.446 | 1.139882% | 24-01101-002 | Salem | Jefferson | 1.139882% | 1.139882% | 0.000000% | 0.000000% | 0.000000% | 0.000000% | C/O Von Kurty 4517 Fairway Drive | Steubenville | OH | 43957 |
| 22 | UNLEASED | Samuel L Williams Jr and Julie S Williams, Husband and Wife | No | 1.000000 | 0.205 | 0.036251% | 24-01375-000 | Salem | Jefferson | 0.000000% | 0.000000% | 0.000000% | 0.000000% | 0.000000% | 0.000000% | 103 Township Road 261 | Bergholz | OH | 43908 |
| 23 | CALIBER | Mary M Zatta | Yes | 0.666667 | 0.649 | 0.114825% | 24-00238-000 | Salem | Jefferson | 0.000000% | 0.000000% | 0.000000% | 0.000000% | 0.114825% | 0.000000% | 55127 Maple Ave | Bridgeport | OH | 43912 |
| 23 | EAP | Anthony F Zatta Jr, A single man | Yes | 0.333333 | 0.325 | 0.057413% | 24-00238-000 | Salem | Jefferson | 0.057413% | 0.057413% | 0.000000% | 0.000000% | 0.000000% | 0.000000% | 1108 Bantam Ridge Road | Steubenville | OH | 43953 |
| 24 | UNLEASED | William Plant and Janice Plant, Husband and Wife | No | 1.000000 | 0.023 | 0.004067% | 24-02572-000 | Salem | Jefferson | 0.000000% | 0.000000% | 0.000000% | 0.000000% | 0.000000% | 0.000000% | P.O. Box 124 | East Springfield | OH | 43925 |
| 25 | UNLEASED | William Plant and Janice Plant, Husband and Wife | No | 1.000000 | 0.773 | 0.136694% | 24-01014-000 | Salem | Jefferson | 0.000000% | 0.000000% | 0.000000% | 0.000000% | 0.000000% | 0.000000% | P.O. Box 124 | East Springfield | OH | 43925 |
| 26 | EAP | Kathleen A Snodgrass and Thomas L Snodgrass, Wife and Husband | Yes | 1.000000 | 1.004 | 0.177543% | 24-01286-000 | Salem | Jefferson | 0.177543% | 0.177543% | 0.000000% | 0.000000% | 0.000000% | 0.000000% | P.O. Box 185 | East Springfield | OH | 43925 |

| TRACT NUMBER | LEASE ID NUMBER | CURRENT MINERAL OWNERS | LEASED YES/NO | DECIMAL INTEREST IN TRACT | SURFACE ACRES IN UNIT (NET) | TRACT PARTICIPATION IN UNIT | TAX MAP PARCEL ID | TOWNSHIP | COUNTY | CONSENTING WORKING INTEREST PERCENTAGE | APPLICANT WORKING INTEREST PERCENTAGE | RIVERBEND OIL & GAS VI-B, LLC WORKING INTEREST PERCENTAGE | ASCENT RESOURCES - UTICA, LLC WORKING INTEREST PERCENTAGE | CALIBER RESOURCE PARTNERS WORKING INTEREST PERCENTAGE | ANTHONY MINING COMPANY, INC. WORKING INTEREST PERCENTAGE | ADDRESS | CITY | STATE | ZIP CODE |
|--------------|-----------------|---|---------------|---------------------------|-----------------------------|-----------------------------|-------------------|----------|-----------|--|---------------------------------------|---|---|---|--|--|------------------|-------|----------|
| 27 | EAP | Ronald G Waggoner, Divorced and unremarried | Yes | 1.000000 | 0.209 | 0.036959% | 24-00757-000 | Salem | Jefferson | 0.036959% | 0.036959% | 0.000000% | 0.000000% | 0.000000% | 0.000000% | 7849 State Route 43 | Bergholz | OH | 43908 |
| 28 | EAP | Ronald G Waggoner, Divorced and unremarried | Yes | 1.000000 | 0.855 | 0.151194% | 24-00241-001 | Salem | Jefferson | 0.151194% | 0.151194% | 0.000000% | 0.000000% | 0.000000% | 0.000000% | 7849 State Route 43 | Bergholz | OH | 43908 |
| 29 | EAP | Kathleen A Snodgrass and Thomas L Snodgrass, Wife and Husband | Yes | 1.000000 | 1.968 | 0.348012% | 24-01285-000 | Salem | Jefferson | 0.348012% | 0.348012% | 0.000000% | 0.000000% | 0.000000% | 0.000000% | P.O. Box 185 | East Springfield | OH | 43925 |
| 30 | UNLEASED | Richard A Hutchison and Barara L Hutchison, Husband and Wife | No | 1.000000 | 0.896 | 0.158445% | 24-00217-000 | Salem | Jefferson | 0.000000% | 0.000000% | 0.000000% | 0.000000% | 0.000000% | 0.000000% | 702 Longhorn St NW | Carrolton | OH | 44615 |
| 31 | UNLEASED | William W Plant | No | 0.500000 | 0.400 | 0.070734% | 24-01017-000 | Salem | Jefferson | 0.000000% | 0.000000% | 0.000000% | 0.000000% | 0.000000% | 0.000000% | P.O. Box 124 | East Springfield | OH | 43925 |
| 31 | UNLEASED | Janice Faye Plant | No | 0.500000 | 0.400 | 0.070734% | 24-01017-000 | Salem | Jefferson | 0.000000% | 0.000000% | 0.000000% | 0.000000% | 0.000000% | 0.000000% | P.O. Box 124 | East Springfield | OH | 43925 |
| 32 | UNLEASED | William W Plant | No | 0.500000 | 0.642 | 0.113440% | 24-00228-000 | Salem | Jefferson | 0.000000% | 0.000000% | 0.000000% | 0.000000% | 0.000000% | 0.000000% | P.O. Box 124 | East Springfield | OH | 43925 |
| 32 | UNLEASED | Janice Faye Plant | No | 0.500000 | 0.642 | 0.113440% | 24-00228-000 | Salem | Jefferson | 0.000000% | 0.000000% | 0.000000% | 0.000000% | 0.000000% | 0.000000% | P.O. Box 124 | East Springfield | OH | 43925 |
| 33 | UNLEASED | William Plant and Janice Plant, Husband and Wife | No | 1.000000 | 0.991 | 0.175244% | 24-00562-000 | Salem | Jefferson | 0.000000% | 0.000000% | 0.000000% | 0.000000% | 0.000000% | 0.000000% | P.O. Box 124 | East Springfield | OH | 43925 |
| 34 | UNLEASED | William Plant and Janice Plant, Husband and Wife | No | 1.000000 | 0.969 | 0.171354% | 24-01020-000 | Salem | Jefferson | 0.000000% | 0.000000% | 0.000000% | 0.000000% | 0.000000% | 0.000000% | P.O. Box 124 | East Springfield | OH | 43925 |
| 35 | EAP | Dorothy J Moran | Yes | 1.000000 | 0.070 | 0.012378% | 24-00655-000 | Salem | Jefferson | 0.012378% | 0.012378% | 0.000000% | 0.000000% | 0.000000% | 0.000000% | PO Box 104 | East Springfield | OH | 43925 |
| 36 | EAP | Nichola S Tennant, a widow and not remarried | Yes | 1.000000 | 1.774 | 0.313706% | 24-01273-000 | Salem | Jefferson | 0.313706% | 0.313706% | 0.000000% | 0.000000% | 0.000000% | 0.000000% | 7805 State Route 43 | Bergholz | OH | 43908 |
| 37 | UNLEASED | B & D McElroy Enterprises, Inc | No | 1.000000 | 1.008 | 0.178250% | 24-00395-000 | Salem | Jefferson | 0.000000% | 0.000000% | 0.000000% | 0.000000% | 0.000000% | 0.000000% | C/O William D McElroy 7531 State Route 43 | East Springfield | OH | 43925 |
| 38 | EAP | Jack L Davis Jr and Karen J Davis, Husband and Wife | Yes | 1.000000 | 1.016 | 0.179665% | 24-01387-000 | Salem | Jefferson | 0.179665% | 0.179665% | 0.000000% | 0.000000% | 0.000000% | 0.000000% | 7821 State Route 43 | Bergholz | OH | 43908 |
| 39 | UNLEASED | William Plant and Janice Plant, Husband and Wife | No | 1.000000 | 0.476 | 0.084174% | 24-01015-000 | Salem | Jefferson | 0.000000% | 0.000000% | 0.000000% | 0.000000% | 0.000000% | 0.000000% | P.O. Box 124 | East Springfield | OH | 43925 |
| 40 | UNLEASED | Daniel Stacey | No | 1.000000 | 0.747 | 0.132096% | 24-01226-000 | Salem | Jefferson | 0.000000% | 0.000000% | 0.000000% | 0.000000% | 0.000000% | 0.000000% | 7295 State Route 43 | Bergholz | OH | 43908 |
| 41 | UNLEASED | Richard A Hutchison and Barara L Hutchison, Husband and Wife | No | 1.000000 | 0.512 | 0.090540% | 24-00219-000 | Salem | Jefferson | 0.000000% | 0.000000% | 0.000000% | 0.000000% | 0.000000% | 0.000000% | 702 Longhorn St NW | Carrolton | OH | 44615 |
| 42 | UNLEASED | Daniel Stacey | No | 1.000000 | 0.318 | 0.056234% | 24-01227-000 | Salem | Jefferson | 0.000000% | 0.000000% | 0.000000% | 0.000000% | 0.000000% | 0.000000% | 7295 State Route 43 | Bergholz | OH | 43908 |
| 43 | EAP | Sheryl J Wiley Maple | Yes | 1.000000 | 1.428 | 0.252521% | 24-02281-000 | Salem | Jefferson | 0.252521% | 0.252521% | 0.000000% | 0.000000% | 0.000000% | 0.000000% | 5784 State Route 213 | Toronto | OH | 43964 |
| 44 | EAP | Ross Miller and Samantha Shay Miller, Husband and Wife | Yes | 1.000000 | 0.991 | 0.175244% | 24-02282-000 | Salem | Jefferson | 0.175244% | 0.175244% | 0.000000% | 0.000000% | 0.000000% | 0.000000% | 849 County Road 36 | Bloomingtondale | OH | 43910 |
| 45 | UNLEASED | Cheryl Fisher rka Cherly Pugh | No | 0.333333 | 0.511 | 0.090304% | 24-00402-000 | Salem | Jefferson | 0.000000% | 0.000000% | 0.000000% | 0.000000% | 0.000000% | 0.000000% | 2344 Castle Road SE | Scio | OH | 43988 |
| 45 | UNLEASED | Peter Flenniken | No | 0.333333 | 0.511 | 0.090304% | 24-00402-000 | Salem | Jefferson | 0.000000% | 0.000000% | 0.000000% | 0.000000% | 0.000000% | 0.000000% | 1753 Maple Ave. | Wellsville | OH | 43968 |
| 45 | UNLEASED | Phillip Flenniken | No | 0.333333 | 0.511 | 0.090304% | 24-00402-000 | Salem | Jefferson | 0.000000% | 0.000000% | 0.000000% | 0.000000% | 0.000000% | 0.000000% | 373 Township Road 262 | Bloomingtondale | OH | 43910 |
| 46 | EAP | Karen Goddard and Carl Goddard, Wife and Husband | Yes | 1.000000 | 19.742 | 3.491088% | 24-01229-005 | Salem | Jefferson | 3.491088% | 3.491088% | 0.000000% | 0.000000% | 0.000000% | 0.000000% | 7630 State Route 43 | Bergholz | OH | 43908 |
| 47 | EAP | Jeffrey J Turnbull | Yes | 1.000000 | 0.188 | 0.033245% | 24-00484-000 | Salem | Jefferson | 0.033245% | 0.033245% | 0.000000% | 0.000000% | 0.000000% | 0.000000% | 7520 State Route 43 | Bergholz | OH | 43908 |
| 48 | EAP | Jeffrey J Turnbull | Yes | 1.000000 | 0.781 | 0.138109% | 24-00483-000 | Salem | Jefferson | 0.138109% | 0.138109% | 0.000000% | 0.000000% | 0.000000% | 0.000000% | 7520 State Route 43 | Bergholz | OH | 43908 |
| 49 | EAP | Steven Ray Henry and Jill E Miser, Husband and Wife | Yes | 1.000000 | 0.485 | 0.085765% | 24-00241-000 | Salem | Jefferson | 0.085765% | 0.085765% | 0.000000% | 0.000000% | 0.000000% | 0.000000% | 7853 State Route 43 | Bergholz | OH | 43908 |
| 50 | EAP | Verona M James, a widow and not remarried | Yes | 1.000000 | 0.377 | 0.066667% | 24-00911-000 | Salem | Jefferson | 0.066667% | 0.066667% | 0.000000% | 0.000000% | 0.000000% | 0.000000% | 15799 Bowman Street NE | Homeworth | OH | 44634 |
| 51 | EAP | Karen Goddard and Carl Goddard, Wife and Husband | Yes | 1.000000 | 6.687 | 1.182500% | 24-01229-004 | Salem | Jefferson | 1.182500% | 1.182500% | 0.000000% | 0.000000% | 0.000000% | 0.000000% | 7630 State Route 43 | Bergholz | OH | 43908 |
| 52 | EAP | Verona M James, a widow and not remarried | Yes | 1.000000 | 2.335 | 0.412911% | 24-01595-000 | Salem | Jefferson | 0.412911% | 0.412911% | 0.000000% | 0.000000% | 0.000000% | 0.000000% | 15799 Bowman Street NE | Homeworth | OH | 44634 |
| 53 | ANTHONY | Jeffco Resources, Inc | Yes | 1.000000 | 0.315 | 0.055703% | 24-00716-000 | Salem | Jefferson | 0.000000% | 0.000000% | 0.000000% | 0.000000% | 0.000000% | 0.055703% | C/O Paul Carapellotti P. O. Box 1298 | Steubenville | OH | 43952 |
| 54 | EAP | Nichola S Tennant, a widow and not remarried | Yes | 1.000000 | 0.015 | 0.002653% | 24-01387-001 | Salem | Jefferson | 0.002653% | 0.002653% | 0.000000% | 0.000000% | 0.000000% | 0.000000% | 7805 State Route 43 | Bergholz | OH | 43908 |
| 55 | EAP | Jack L Davis Jr and Karen J Davis, Husband and Wife | Yes | 1.000000 | 0.214 | 0.037843% | 24-01388-000 | Salem | Jefferson | 0.037843% | 0.037843% | 0.000000% | 0.000000% | 0.000000% | 0.000000% | 7821 State Route 43 | Bergholz | OH | 43908 |
| 56 | EAP | Enoch M Farmer, A Widower and not remarried | Yes | 1.000000 | 0.473 | 0.083643% | 24-01229-002 | Salem | Jefferson | 0.083643% | 0.083643% | 0.000000% | 0.000000% | 0.000000% | 0.000000% | 7708 State Route 43 | Bergholz | OH | 43908 |

| TRACT NUMBER | LEASE ID NUMBER | CURRENT MINERAL OWNERS | LEASED YES/NO | DECIMAL INTEREST IN TRACT | SURFACE ACRES IN UNIT (NET) | TRACT PARTICIPATION IN UNIT | TAX MAP PARCEL ID | TOWNSHIP | COUNTY | CONSENTING WORKING INTEREST PERCENTAGE | APPLICANT WORKING INTEREST PERCENTAGE | RIVERBEND OIL & GAS VI-B, LLC WORKING INTEREST PERCENTAGE | ASCENT RESOURCES - UTICA, LLC WORKING INTEREST PERCENTAGE | CALIBER RESOURCE PARTNERS WORKING INTEREST PERCENTAGE | ANTHONY MINING COMPANY, INC. WORKING INTEREST PERCENTAGE | ADDRESS | CITY | STATE | ZIP CODE |
|--------------|-----------------|--|---------------|---------------------------|-----------------------------|-----------------------------|-------------------|----------|-----------|--|---------------------------------------|---|---|---|--|---|------------------|-------|----------|
| 57 | CALIBER | East Springfield United Brethren Church Inc, now known as The United Methodist Church of the Cross | Yes | 1.000000 | 1.086 | 0.192043% | 24-01894-000 | Salem | Jefferson | 0.000000% | 0.000000% | 0.000000% | 0.000000% | 0.192043% | 0.000000% | C/O Bob Carson P.O. Box 6 | East Springfield | OH | 43925 |
| 58 | EAP | Verona M James, a widow and not remarried | Yes | 1.000000 | 0.678 | 0.119895% | 24-01596-000 | Salem | Jefferson | 0.119895% | 0.119895% | 0.000000% | 0.000000% | 0.000000% | 0.000000% | 15799 Bowman Street NE | Homeworth | OH | 44634 |
| 59 | EAP | Verona M James, a widow and not remarried | Yes | 1.000000 | 0.344 | 0.060831% | 24-00639-000 | Salem | Jefferson | 0.060831% | 0.060831% | 0.000000% | 0.000000% | 0.000000% | 0.000000% | 15799 Bowman Street NE | Homeworth | OH | 44634 |
| 60 | CALIBER | East Springfield United Brethren Church Inc, now known as The United Methodist Church of the Cross | Yes | 1.000000 | 9.543 | 1.687542% | 24-01303-000 | Salem | Jefferson | 0.000000% | 0.000000% | 0.000000% | 0.000000% | 1.687542% | 0.000000% | C/O Bob Carson P.O. Box 6 | East Springfield | OH | 43925 |
| 61 | EAP | Verona M James, a widow and not remarried | Yes | 1.000000 | 0.046 | 0.008134% | 24-00640-000 | Salem | Jefferson | 0.008134% | 0.008134% | 0.000000% | 0.000000% | 0.000000% | 0.000000% | 15799 Bowman Street NE | Homeworth | OH | 44634 |
| 62 | EAP | Robert T Morley and Jan Morley, Husband and Wife | Yes | 1.000000 | 1.108 | 0.195934% | 24-00835-000 | Salem | Jefferson | 0.195934% | 0.195934% | 0.000000% | 0.000000% | 0.000000% | 0.000000% | 7396 State Route 43 | Bergholz | OH | 43908 |
| 63 | EAP | VK Oil & Gas Enterprises LLC | Yes | 1.000000 | 1.474 | 0.260656% | 24-01102-002 | Salem | Jefferson | 0.260656% | 0.260656% | 0.000000% | 0.000000% | 0.000000% | 0.000000% | C/O Von Kurty 4517 Fairway Drive | Stuebenville | OH | 43957 |
| 64 | EAP | Jacqueline Hoffman FKA Jacqueline Baker, widowed and not remarried | Yes | 1.000000 | 3.798 | 0.671622% | 24-02287-000 | Salem | Jefferson | 0.671622% | 0.671622% | 0.000000% | 0.000000% | 0.000000% | 0.000000% | 12394 State Route 150 | Rayland | OH | 43943 |
| 65 | EAP | Kevin C Bendle and Chrisina J Bendle, Husband and Wife | Yes | 1.000000 | 0.834 | 0.147481% | 24-02417-000 | Salem | Jefferson | 0.147481% | 0.147481% | 0.000000% | 0.000000% | 0.000000% | 0.000000% | 7760 State Route 43 | Bergholz | OH | 43908 |
| 67 | EAP | Linda Moran | Yes | 1.000000 | 0.535 | 0.094607% | 24-01930-000 | Salem | Jefferson | 0.094607% | 0.094607% | 0.000000% | 0.000000% | 0.000000% | 0.000000% | PO Box 26 | East Springfield | OH | 43925 |
| 68 | UNLEASED | Richard A Hutchison and Barara L Hutchison, Husband and Wife | No | 1.000000 | 0.030 | 0.005305% | 24-00218-000 | Salem | Jefferson | 0.000000% | 0.000000% | 0.000000% | 0.000000% | 0.000000% | 0.000000% | 702 Longhorn St NW | Carrolton | OH | 44615 |
| 69 | UNLEASED | William W Plant | No | 0.500000 | 0.096 | 0.016888% | 24-01016-000 | Salem | Jefferson | 0.000000% | 0.000000% | 0.000000% | 0.000000% | 0.000000% | 0.000000% | P.O. Box 124 | East Springfield | OH | 43925 |
| 69 | UNLEASED | Janice Faye Plant | No | 0.500000 | 0.096 | 0.016888% | 24-01016-000 | Salem | Jefferson | 0.000000% | 0.000000% | 0.000000% | 0.000000% | 0.000000% | 0.000000% | P.O. Box 124 | East Springfield | OH | 43925 |
| 70 | UNLEASED | Anthony Edward Polverini | No | 1.000000 | 22.818 | 4.035035% | 24-02074-000 | Salem | Jefferson | 0.000000% | 0.000000% | 0.000000% | 0.000000% | 0.000000% | 0.000000% | 4538 Sunset Boulevard | Stuebenville | OH | 43952 |
| 71 | UNLEASED | Stacy J Denoon | No | 1.000000 | 0.083 | 0.014677% | 24-00240-000 | Salem | Jefferson | 0.000000% | 0.000000% | 0.000000% | 0.000000% | 0.000000% | 0.000000% | 2737 County Road 78 | Amsterdam | OH | 43903 |
| 72 | EAP | Albert R Gelder and Karen S Gelder, Husband and Wife | Yes | 1.000000 | 0.611 | 0.108047% | 24-02076-000 | Salem | Jefferson | 0.108047% | 0.108047% | 0.000000% | 0.000000% | 0.000000% | 0.000000% | 7836 State Route 43 | Bergholz | OH | 43908 |
| 73 | EAP | Jeffrey N Mencer and Cheryl Mencer, Husband and Wife | Yes | 1.000000 | 13.954 | 2.467564% | 24-00921-000 | Salem | Jefferson | 2.467564% | 2.467564% | 0.000000% | 0.000000% | 0.000000% | 0.000000% | 7882 State Route 43 | Bergholz | OH | 43908 |
| 74 | CALIBER | Ray O Wells | Yes | 1.000000 | 5.451 | 0.963931% | 24-02376-000 | Salem | Jefferson | 0.000000% | 0.000000% | 0.000000% | 0.000000% | 0.963931% | 0.000000% | 7388 State Route 43 | Bergholz | OH | 43908 |
| 75 | EAP | Gary Della Penna and Kristine R Della Penna, Husband and Wife | Yes | 1.000000 | 0.652 | 0.115297% | 24-00530-000 | Salem | Jefferson | 0.115297% | 0.115297% | 0.000000% | 0.000000% | 0.000000% | 0.000000% | 395 Township Road 267 | Amsterdam | OH | 43903 |
| 76 | EAP | Hamilton Development LLC | Yes | 1.000000 | 0.239 | 0.042264% | 24-00904-000 | Salem | Jefferson | 0.042264% | 0.042264% | 0.000000% | 0.000000% | 0.000000% | 0.000000% | C/O Joseph W Hamilton Jr 8159 State Route 43 | East Springfield | OH | 43925 |
| 77 | EAP | Robert T Morley and Jan Morley, Husband and Wife | Yes | 1.000000 | 0.438 | 0.077454% | 24-02377-000 | Salem | Jefferson | 0.077454% | 0.077454% | 0.000000% | 0.000000% | 0.000000% | 0.000000% | 7396 State Route 43 | Bergholz | OH | 43908 |
| 78 | EAP | Kevin C Bendle and Chrisina J Bendle, Husband and Wife | Yes | 1.000000 | 0.191 | 0.033776% | 24-00796-000 | Salem | Jefferson | 0.033776% | 0.033776% | 0.000000% | 0.000000% | 0.000000% | 0.000000% | 7760 State Route 43 | Bergholz | OH | 43908 |
| 79 | CALIBER | East Springfield United Brethren Church Inc, now known as The United Methodist Church of the Cross | Yes | 1.000000 | 0.343 | 0.060655% | 24-00366-000 | Salem | Jefferson | 0.000000% | 0.000000% | 0.000000% | 0.000000% | 0.060655% | 0.000000% | C/O Bob Carson P.O. Box 6 | East Springfield | OH | 43925 |
| 80 | EAP | Saline Oil Company | Yes | 1.000000 | 0.523 | 0.092485% | 24-01102-001 | Salem | Jefferson | 0.092485% | 0.092485% | 0.000000% | 0.000000% | 0.000000% | 0.000000% | C/O Charles W Corder Sr P.O. Box 128 | East Springfield | OH | 43925 |
| 81 | EAP | Enoch M Farmer, A Widower and not remarried | Yes | 1.000000 | 1.004 | 0.177543% | 24-01229-001 | Salem | Jefferson | 0.177543% | 0.177543% | 0.000000% | 0.000000% | 0.000000% | 0.000000% | 7708 State Route 43 | Bergholz | OH | 43908 |
| 82 | UNLEASED | Daniel E Stacey and Mary C Stacey, Husband and Wife | No | 1.000000 | 0.395 | 0.069850% | 24-00505-000 | Salem | Jefferson | 0.000000% | 0.000000% | 0.000000% | 0.000000% | 0.000000% | 0.000000% | 7295 State Route 43 | Bergholz | OH | 43908 |
| 83 | EAP | Enoch M Farmer, A Widower and not remarried | Yes | 1.000000 | 7.159 | 1.265966% | 24-01229-003 | Salem | Jefferson | 1.265966% | 1.265966% | 0.000000% | 0.000000% | 0.000000% | 0.000000% | 7708 State Route 43 | Bergholz | OH | 43908 |
| 84a | EAP | Tara M Culp FKA Tara M Keenan and Lee Culp, Wife and Husband | Yes | 1.000000 | 2.522 | 0.445979% | 24-01598-000 | Salem | Jefferson | 0.445979% | 0.445979% | 0.000000% | 0.000000% | 0.000000% | 0.000000% | 7240 State Route 43 | Bergholz | OH | 43908 |
| 84b | EAP | Tara M Culp FKA Tara M Keenan and Lee Culp, Wife and Husband | Yes | 1.000000 | 0.334 | 0.059063% | 24-01598-000 | Salem | Jefferson | 0.059063% | 0.059063% | 0.000000% | 0.000000% | 0.000000% | 0.000000% | 7240 State Route 43 | Bergholz | OH | 43908 |
| 85 | EAP | David W Hendrix and Maria Ann Hendrix, Husband and Wife | Yes | 1.000000 | 1.583 | 0.279931% | 24-01488-000 | Salem | Jefferson | 0.279931% | 0.279931% | 0.000000% | 0.000000% | 0.000000% | 0.000000% | 7184 State Route 43 | Bergholz | OH | 43908 |
| 86 | EAP | David W Hendrix and Maria Ann Hendrix, Husband and Wife | Yes | 1.000000 | 0.563 | 0.099558% | 24-00553-000 | Salem | Jefferson | 0.099558% | 0.099558% | 0.000000% | 0.000000% | 0.000000% | 0.000000% | 7184 State Route 43 | Bergholz | OH | 43908 |
| 87 | EAP | Mildred E Huber, Trustee of the 2014 Mildred E Huber Irrevocable Trust dated 9/25/2014 | Yes | 1.000000 | 3.058 | 0.540763% | 24-00558-000 | Salem | Jefferson | 0.540763% | 0.540763% | 0.000000% | 0.000000% | 0.000000% | 0.000000% | 7166 State Route 43 | Bergholz | OH | 43908 |
| 88 | EAP | William Richard Dye | Yes | 0.166667 | 3.704 | 0.654940% | 24-00181-000 | Salem | Jefferson | 0.654940% | 0.654940% | 0.000000% | 0.000000% | 0.000000% | 0.000000% | 16416 US Highway 19N, Apt 1818 | Clearwater | FL | 33764 |
| 88 | EAP | Deborah Sue Coleman and Paul Coleman, Wife and Husband | Yes | 0.166667 | 3.704 | 0.654940% | 24-00181-000 | Salem | Jefferson | 0.654940% | 0.654940% | 0.000000% | 0.000000% | 0.000000% | 0.000000% | 1299 Haddon Road | Columbus | OH | 43209 |

| TRACT NUMBER | LEASE ID NUMBER | CURRENT MINERAL OWNERS | LEASED YES/NO | DECIMAL INTEREST IN TRACT | SURFACE ACRES IN UNIT (NET) | TRACT PARTICIPATION IN UNIT | TAX MAP PARCEL ID | TOWNSHIP | COUNTY | CONSENTING WORKING INTEREST PERCENTAGE | APPLICANT WORKING INTEREST PERCENTAGE | RIVERBEND OIL & GAS VI-B, LLC WORKING INTEREST PERCENTAGE | ASCENT RESOURCES - UTICA, LLC WORKING INTEREST PERCENTAGE | CALIBER RESOURCE PARTNERS WORKING INTEREST PERCENTAGE | ANTHONY MINING COMPANY, INC. WORKING INTEREST PERCENTAGE | ADDRESS | CITY | STATE | ZIP CODE |
|--------------|-----------------|--|---------------|---------------------------|-----------------------------|-----------------------------|-------------------|----------|-----------|--|---------------------------------------|---|---|---|--|------------------------------|------------------|-------|----------|
| 88 | EAP | Julia M Dye, a widow and not remarried | Yes | 0.166667 | 3.704 | 0.654940% | 24-00181-000 | Salem | Jefferson | 0.654940% | 0.654940% | 0.000000% | 0.000000% | 0.000000% | 0.000000% | 1020 Grove Street, Apt 40 | Evanston | IL | 60201 |
| 88 | EAP | Donald Ray Dye Jr, a single man | Yes | 0.166667 | 3.704 | 0.654940% | 24-00181-000 | Salem | Jefferson | 0.654940% | 0.654940% | 0.000000% | 0.000000% | 0.000000% | 0.000000% | 345 W 13th Street, #6H | New York | NY | 10014 |
| 88 | EAP | Marvin Ray Banton, Widower and not remarried | Yes | 0.111111 | 2.469 | 0.436627% | 24-00181-000 | Salem | Jefferson | 0.436627% | 0.436627% | 0.000000% | 0.000000% | 0.000000% | 0.000000% | 17509 Pinehurst Court | Purcellville | VA | 20132 |
| 88 | EAP | Ellen Masterson, widow and not remarried | Yes | 0.111111 | 2.469 | 0.436627% | 24-00181-000 | Salem | Jefferson | 0.436627% | 0.436627% | 0.000000% | 0.000000% | 0.000000% | 0.000000% | 1651 Mentor Avenue, Apt 2903 | Painesville | OH | 44077 |
| 88 | EAP | Douglas Fogel and Bonita S Fogel, Husband and Wife | Yes | 0.027778 | 0.617 | 0.109157% | 24-00181-000 | Salem | Jefferson | 0.109157% | 0.109157% | 0.000000% | 0.000000% | 0.000000% | 0.000000% | 4054 Creekview Drive | Madison | OH | 44057 |
| 88 | EAP | James Fogel, a single man | Yes | 0.027778 | 0.617 | 0.109157% | 24-00181-000 | Salem | Jefferson | 0.109157% | 0.109157% | 0.000000% | 0.000000% | 0.000000% | 0.000000% | 7280 N Ridge Road | Madison | OH | 44057 |
| 88 | EAP | Cynthia M Buehner, A Single Woman | Yes | 0.027778 | 0.617 | 0.109157% | 24-00181-000 | Salem | Jefferson | 0.109157% | 0.109157% | 0.000000% | 0.000000% | 0.000000% | 0.000000% | 606 High Street #D | Fairport Harbor | OH | 44077 |
| 88 | EAP | Ruth K Fogel AKA Katherine Ruth Fogel, a widow and not remarried | Yes | 0.027778 | 0.617 | 0.109157% | 24-00181-000 | Salem | Jefferson | 0.109157% | 0.109157% | 0.000000% | 0.000000% | 0.000000% | 0.000000% | 425 Howard Street | Schinnston | WV | 26431 |
| 89 | EAP | Enoch M Farmer, A Widower and not remarried | Yes | 1.000000 | 14.316 | 2.531578% | 24-01229-000 | Salem | Jefferson | 2.531578% | 2.531578% | 0.000000% | 0.000000% | 0.000000% | 0.000000% | 7708 State Route 43 | Bergholz | OH | 43908 |
| 90 | CALIBER | Jack C Steele and Debra K Steele, Husband and Wife | Yes | 1.000000 | 5.569 | 0.984797% | 24-02525-002 | Salem | Jefferson | 0.000000% | 0.000000% | 0.000000% | 0.000000% | 0.984797% | 0.000000% | 221 S Sugar St | Richmond | OH | 43944 |
| 91 | EAP | Enoch M Farmer, A Widower and not remarried | Yes | 1.000000 | 3.245 | 0.573832% | 24-01229-006 | Salem | Jefferson | 0.573832% | 0.573832% | 0.000000% | 0.000000% | 0.000000% | 0.000000% | 7708 State Route 43 | Bergholz | OH | 43908 |
| 92 | EAP | Glenn R Mills and Kelly M Mills, Husband and Wife | Yes | 1.000000 | 1.748 | 0.309109% | 24-01620-000 | Salem | Jefferson | 0.309109% | 0.309109% | 0.000000% | 0.000000% | 0.000000% | 0.000000% | 2565 Abbey Knoll Dr | Lewis Center | OH | 43035 |
| 93 | CALIBER | Jack C Steele and Debra K Steele, Husband and Wife | Yes | 1.000000 | 3.181 | 0.562514% | 24-02526-000 | Salem | Jefferson | 0.000000% | 0.000000% | 0.000000% | 0.000000% | 0.562514% | 0.000000% | 221 S Sugar St | Richmond | OH | 43944 |
| 94 | CALIBER | Jack C Steele and Debra K Steele, Husband and Wife | Yes | 1.000000 | 1.338 | 0.236806% | 24-02525-001 | Salem | Jefferson | 0.000000% | 0.000000% | 0.000000% | 0.000000% | 0.236806% | 0.000000% | 221 S Sugar St | Richmond | OH | 43944 |
| 95 | EAP | Richard Schneider and Kathryn Schneider, Husband and Wife | Yes | 1.000000 | 5.317 | 0.940235% | 24-01134-000 | Salem | Jefferson | 0.940235% | 0.940235% | 0.000000% | 0.000000% | 0.000000% | 0.000000% | 312 Indian Ridge Drive | Lake Orion | MI | 48362 |
| 96 | EAP | Robert L Straka and Patricia A Straka, Husband and Wife | Yes | 1.000000 | 5.603 | 0.990810% | 24-01241-000 | Salem | Jefferson | 0.990810% | 0.990810% | 0.000000% | 0.000000% | 0.000000% | 0.000000% | 816 Federal Street | Toronto | OH | 43964 |
| 97 | EAP | William R Meyer and Jo Ann Meyer, Husband and Wife | Yes | 1.000000 | 1.003 | 0.177368% | 24-01240-000 | Salem | Jefferson | 0.177368% | 0.177368% | 0.000000% | 0.000000% | 0.000000% | 0.000000% | 550 Township Road 262 | Bloomington | OH | 43910 |
| 98 | UNLEASED | Anthony Edward Polverini | No | 1.000000 | 54.712 | 9.675029% | 24-00004-000 | Salem | Jefferson | 0.000000% | 0.000000% | 0.000000% | 0.000000% | 0.000000% | 0.000000% | 4538 Sunset Boulevard | Steubenville | OH | 43952 |
| 99 | UNLEASED | William D McElroy | No | 1.000000 | 2.122 | 0.375245% | 24-00387-000 | Salem | Jefferson | 0.000000% | 0.000000% | 0.000000% | 0.000000% | 0.000000% | 0.000000% | 6854 State Route 43 | East Springfield | OH | 43925 |
| 100 | EAP | Glenn R Mills and Kelly M Mills, Husband and Wife | Yes | 1.000000 | 0.014 | 0.002476% | 24-01602-000 | Salem | Jefferson | 0.002476% | 0.002476% | 0.000000% | 0.000000% | 0.000000% | 0.000000% | 2565 Abbey Knoll Dr | Lewis Center | OH | 43035 |
| 101 | UNLEASED | William D McElroy | No | 1.000000 | 0.138 | 0.024403% | 24-01999-000 | Salem | Jefferson | 0.000000% | 0.000000% | 0.000000% | 0.000000% | 0.000000% | 0.000000% | 6854 State Route 43 | East Springfield | OH | 43925 |
| 102 | EAP | Cloyd Neal Kernen, Unmarried | Yes | 1.000000 | 1.271 | 0.224758% | 24-02029-000 | Salem | Jefferson | 0.224758% | 0.224758% | 0.000000% | 0.000000% | 0.000000% | 0.000000% | 6820 State Route 43 | Bloomington | OH | 43910 |
| 103 | EAP | Richard Keenan, Divorced and not remarried | Yes | 0.500000 | 13.375 | 2.365176% | 24-00180-000 | Salem | Jefferson | 2.365176% | 2.365176% | 0.000000% | 0.000000% | 0.000000% | 0.000000% | 2654 Township Road 221 | Bloomington | OH | 43910 |
| 103 | EAP | Anita Keenan FKA Anita Bartels, Divorced and not remarried | Yes | 0.500000 | 13.375 | 2.365176% | 24-00180-000 | Salem | Jefferson | 2.365176% | 2.365176% | 0.000000% | 0.000000% | 0.000000% | 0.000000% | 608 East Fernwood Drive | Toronto | OH | 43964 |
| 104 | EAP | Glenn R Mills and Kelly M Mills, Husband and Wife | Yes | 1.000000 | 0.317 | 0.056057% | 24-02028-000 | Salem | Jefferson | 0.056057% | 0.056057% | 0.000000% | 0.000000% | 0.000000% | 0.000000% | 2565 Abbey Knoll Dr | Lewis Center | OH | 43035 |
| 105 | EAP | David W Chuich and Elaine M Chuich, Husband and Wife | Yes | 1.000000 | 48.360 | 8.551770% | 24-01525-000 | Salem | Jefferson | 8.551770% | 8.551770% | 0.000000% | 0.000000% | 0.000000% | 0.000000% | 2703 Township Road 221 | Bloomington | OH | 43910 |
| 106 | EAP | Glenn R Mills and Kelly M Mills, Husband and Wife | Yes | 1.000000 | 0.019 | 0.003360% | 24-00803-000 | Salem | Jefferson | 0.003360% | 0.003360% | 0.000000% | 0.000000% | 0.000000% | 0.000000% | 2565 Abbey Knoll Dr | Lewis Center | OH | 43035 |
| 107 | EAP | Glenn R Mills and Kelly M Mills, Husband and Wife | Yes | 1.000000 | 0.004 | 0.000707% | 24-00802-000 | Salem | Jefferson | 0.000707% | 0.000707% | 0.000000% | 0.000000% | 0.000000% | 0.000000% | 2565 Abbey Knoll Dr | Lewis Center | OH | 43035 |
| 108 | EAP | Glenn R Mills and Kelly M Mills, Husband and Wife | Yes | 1.000000 | 5.098 | 0.901508% | 24-02081-000 | Salem | Jefferson | 0.901508% | 0.901508% | 0.000000% | 0.000000% | 0.000000% | 0.000000% | 2565 Abbey Knoll Dr | Lewis Center | OH | 43035 |
| 109 | EAP | Richard Schneider and Kathryn Schneider, Husband and Wife | Yes | 1.000000 | 5.005 | 0.885062% | 24-02120-000 | Salem | Jefferson | 0.885062% | 0.885062% | 0.000000% | 0.000000% | 0.000000% | 0.000000% | 312 Indian Ridge Drive | Lake Orion | OH | 48362 |
| 110 | EAP | James W Peters Jr | Yes | 1.000000 | 4.199 | 0.742533% | 24-02482-000 | Salem | Jefferson | 0.742533% | 0.742533% | 0.000000% | 0.000000% | 0.000000% | 0.000000% | 8945 County Road 39 | Bloomington | OH | 43910 |
| 111 | EAP | David W Chuich and Elaine M Chuich, Husband and Wife | Yes | 0.500000 | 34.023 | 6.016389% | 24-00286-000 | Salem | Jefferson | 6.016389% | 6.016389% | 0.000000% | 0.000000% | 0.000000% | 0.000000% | 2703 Township Road 221 | Bloomington | OH | 43910 |
| 111 | EAP | Karen E Peters | Yes | 0.166667 | 11.341 | 2.005463% | 24-00286-000 | Salem | Jefferson | 2.005463% | 2.005463% | 0.000000% | 0.000000% | 0.000000% | 0.000000% | 4288 E Hawaii Lane | Hernando | FL | 34442 |
| 111 | EAP | Edward B Crawford | Yes | 0.166667 | 11.341 | 2.005463% | 24-00286-000 | Salem | Jefferson | 2.005463% | 2.005463% | 0.000000% | 0.000000% | 0.000000% | 0.000000% | 1017 Sunset Drive | Findlay | OH | 45840 |

| TRACT NUMBER | LEASE ID NUMBER | CURRENT MINERAL OWNERS | LEASED YES/NO | DECIMAL INTEREST IN TRACT | SURFACE ACRES IN UNIT (NET) | TRACT PARTICIPATION IN UNIT | TAX MAP PARCEL ID | TOWNSHIP | COUNTY | CONSENTING WORKING INTEREST PERCENTAGE | APPLICANT WORKING INTEREST PERCENTAGE | RIVERBEND OIL & GAS VI-B, LLC WORKING INTEREST PERCENTAGE | ASCENT RESOURCES - UTICA, LLC WORKING INTEREST PERCENTAGE | CALIBER RESOURCE PARTNERS WORKING INTEREST PERCENTAGE | ANTHONY MINING COMPANY, INC. WORKING INTEREST PERCENTAGE | ADDRESS | CITY | STATE | ZIP CODE |
|---|-----------------|--|---------------|----------------------------|-----------------------------|-----------------------------|-------------------|----------|---------------|--|---------------------------------------|---|---|---|--|------------------------|-----------------|-------|----------|
| 111 | EAP | James T Crawford | Yes | 0.166667 | 11.341 | 2.005463% | 24-00286-000 | Salem | Jefferson | 2.005463% | 2.005463% | 0.000000% | 0.000000% | 0.000000% | 0.000000% | 2104 Township Road 221 | Bloomingtondale | OH | 43910 |
| 112 | EAP | Ronald L Smyth and Nacy Smyth, Husband and Wife | Yes | 1.000000 | 2.813 | 0.497439% | 24-00197-001 | Salem | Jefferson | 0.497439% | 0.497439% | 0.000000% | 0.000000% | 0.000000% | 0.000000% | 6436 State Route 43 | Bloomingtondale | OH | 43910 |
| 113 | EAP | Daniel K Chivers and Linda D Patino-Chivers, Husband and Wife | Yes | 1.000000 | 0.722 | 0.127675% | 24-00197-000 | Salem | Jefferson | 0.127675% | 0.127675% | 0.000000% | 0.000000% | 0.000000% | 0.000000% | 2676 Township Road 220 | Bloomingtondale | OH | 43910 |
| 114 | ARU | Brenda L Dustolfo aka Brenda L Banovsky aka Brenda L Johns and Anthony Luis Dustolfo, Wife and Husband | Yes | 1.000000 | 0.035 | 0.006189% | 24-02284-000 | Salem | Jefferson | 0.006189% | 0.000000% | 0.000000% | 0.006189% | 0.000000% | 0.000000% | 2742 Township Road 220 | Bloomingtondale | OH | 43910 |
| 115 | EAP | Lois A Crawford | Yes | 0.333333 | 1.174 | 0.207546% | 24-00286-002 | Salem | Jefferson | 0.207546% | 0.207546% | 0.000000% | 0.000000% | 0.000000% | 0.000000% | 2104 Township Road 221 | Bloomingtondale | OH | 43910 |
| 115 | EAP | Elaine M Chuich | Yes | 0.166667 | 0.587 | 0.103773% | 24-00286-002 | Salem | Jefferson | 0.103773% | 0.103773% | 0.000000% | 0.000000% | 0.000000% | 0.000000% | 2703 Township Road 221 | Bloomingtondale | OH | 43910 |
| 115 | EAP | Karen E Peters | Yes | 0.166667 | 0.587 | 0.103773% | 24-00286-002 | Salem | Jefferson | 0.103773% | 0.103773% | 0.000000% | 0.000000% | 0.000000% | 0.000000% | 4288 E Hawaii Lane | Hernando | FL | 34442 |
| 115 | EAP | Edward B Crawford | Yes | 0.166667 | 0.587 | 0.103773% | 24-00286-002 | Salem | Jefferson | 0.103773% | 0.103773% | 0.000000% | 0.000000% | 0.000000% | 0.000000% | 1017 Sunset Drive | Findlay | OH | 45840 |
| 115 | EAP | James T Crawford | Yes | 0.166667 | 0.587 | 0.103773% | 24-00286-002 | Salem | Jefferson | 0.103773% | 0.103773% | 0.000000% | 0.000000% | 0.000000% | 0.000000% | 2104 Township Road 221 | Bloomingtondale | OH | 43910 |
| * Due to internal record-keeping needs, there is no tract designated as Tract 66. | | | | TOTAL LEASED ACRES: | 426.482 | 100.000000% | | | TOTAL: | 75.417258% | 75.408903% | 0.002166% | 0.006189% | 8.431109% | 0.055703% | | | | |
| | | | | TOTAL UNIT ACRES: | 565.497 | | | | | | | | | | | | | | |

Exhibit D

JEFFERSON
SALEM
T 10 N R 3 W

| Tract Number | Tax Map Parcel ID | Surface Acres in Unit | Tract Number | Tax Map Parcel ID | Surface Acres in Unit |
|--------------|-------------------|-----------------------|--------------|-------------------|-----------------------|
| 1 | 24-02511-001 | 11.127 | 58 | 24-01596-000 | 0.678 |
| 2 | 24-01981-000 | 13.328 | 59 | 24-00639-000 | 0.344 |
| 3 | 24-01845-000 | 0.019 | 60 | 24-01303-000 | 9.543 |
| 4 | 24-02511-000 | 2.057 | 61 | 24-00640-000 | 0.046 |
| 5 | 24-01844-000 | 0.544 | 62 | 24-00835-000 | 1.108 |
| 6 | 24-00754-000 | 11.242 | 63 | 24-01102-002 | 1.474 |
| 7 | 24-00756-000 | 7.108 | 64 | 24-02287-000 | 3.798 |
| 8 | 24-02469-000 | 30.776 | 65 | 24-02417-000 | 0.834 |
| 9 | 24-01342-000 | 1.031 | 67 | 24-01930-000 | 0.535 |
| 10 | 24-00215-000 | 3.942 | 68 | 24-00218-000 | 0.03 |
| 11 | 24-00213-000 | 6.697 | 69 | 24-01016-000 | 0.191 |
| 12 | 24-00653-000 | 9.430 | 70 | 24-02074-000 | 22.818 |
| 13A | 24-01101-000 | 16.032 | 71 | 24-00240-000 | 0.083 |
| 13B | 24-01101-000 | 0.143 | 72 | 24-02076-000 | 0.611 |
| 14 | 24-00755-000 | 5.075 | 73 | 24-00921-000 | 13.954 |
| 15 | 24-00214-000 | 4.526 | 74 | 24-02376-000 | 5.451 |
| 16 | 24-01319-000 | 0.049 | 75 | 24-00530-000 | 0.652 |
| 17 | 24-02468-000 | 4.415 | 76 | 24-00904-000 | 0.239 |
| 18 | 24-01321-000 | 6.184 | 77 | 24-02377-000 | 0.438 |
| 19 | 24-00216-000 | 4.214 | 78 | 24-00796-000 | 0.191 |
| 20 | 24-00653-001 | 0.403 | 79 | 24-00366-000 | 0.343 |
| 21 | 24-01101-002 | 6.446 | 80 | 24-01102-001 | 0.523 |
| 22 | 24-01375-000 | 0.205 | 81 | 24-01229-001 | 1.004 |
| 23 | 24-00238-000 | 0.974 | 82 | 24-00505-000 | 0.395 |
| 24 | 24-02572-000 | 0.023 | 83 | 24-01229-003 | 7.159 |
| 25 | 24-01014-000 | 0.773 | 84A | 24-01598-000 | 2.522 |
| 26 | 24-01286-000 | 1.004 | 84B | 24-01598-000 | 0.344 |
| 27 | 24-00757-000 | 0.209 | 85 | 24-01488-000 | 1.583 |
| 28 | 24-00241-001 | 0.855 | 86 | 24-00553-000 | 0.563 |
| 29 | 24-01285-000 | 1.968 | 87 | 24-00558-000 | 3.058 |
| 30 | 24-00217-000 | 0.896 | 88 | 24-00181-000 | 22.222 |
| 31 | 24-01017-000 | 0.800 | 89 | 24-01229-000 | 14.316 |
| 32 | 24-00228-000 | 1.283 | 90 | 24-02525-002 | 5.569 |
| 33 | 24-00562-000 | 0.991 | 91 | 24-01229-006 | 3.245 |
| 34 | 24-01020-000 | 0.969 | 92 | 24-01620-000 | 1.748 |
| 35 | 24-00655-000 | 0.070 | 93 | 24-02526-000 | 3.181 |
| 36 | 24-01273-000 | 1.774 | 94 | 24-02525-001 | 1.338 |
| 37 | 24-00395-000 | 1.008 | 95 | 24-01134-000 | 5.317 |
| 38 | 24-01387-000 | 1.016 | 96 | 24-01241-000 | 5.603 |
| 39 | 24-01015-000 | 0.476 | 97 | 24-01240-000 | 1.003 |
| 40 | 24-01226-000 | 0.747 | 98 | 24-00004-000 | 54.712 |
| 41 | 24-00199-000 | 0.512 | 99 | 24-00387-000 | 2.122 |
| 42 | 24-01227-000 | 0.318 | 100 | 24-01602-000 | 0.014 |
| 43 | 24-02282-000 | 1.428 | 101 | 24-01999-000 | 0.138 |
| 44 | 24-02282-000 | 0.991 | 102 | 24-02029-000 | 1.271 |
| 45 | 24-00402-000 | 1.532 | 103 | 24-00180-000 | 26.75 |
| 46 | 24-01229-005 | 19.742 | 104 | 24-02028-000 | 0.317 |
| 47 | 24-00484-000 | 0.188 | 105 | 24-01525-000 | 48.36 |
| 48 | 24-00483-000 | 0.781 | 106 | 24-00803-000 | 0.019 |
| 49 | 24-00241-000 | 0.485 | 107 | 24-00802-000 | 0.004 |
| 50 | 24-00911-000 | 0.377 | 108 | 24-02081-000 | 5.098 |
| 51 | 24-01229-004 | 6.687 | 109 | 24-02120-000 | 5.005 |
| 52 | 24-01595-000 | 2.335 | 110 | 24-02482-000 | 4.199 |
| 53 | 24-00716-000 | 0.315 | 111 | 24-00286-000 | 68.045 |
| 54 | 24-01387-001 | 0.015 | 112 | 24-00197-001 | 2.813 |
| 55 | 24-01388-000 | 0.214 | 113 | 24-00197-000 | 0.722 |
| 56 | 24-01229-002 | 0.473 | 114 | 24-02284-000 | 0.035 |
| 57 | 24-01894-000 | 1.086 | 115 | 24-00286-002 | 3.521 |

* Unit Tract 66 is intentionally omitted.

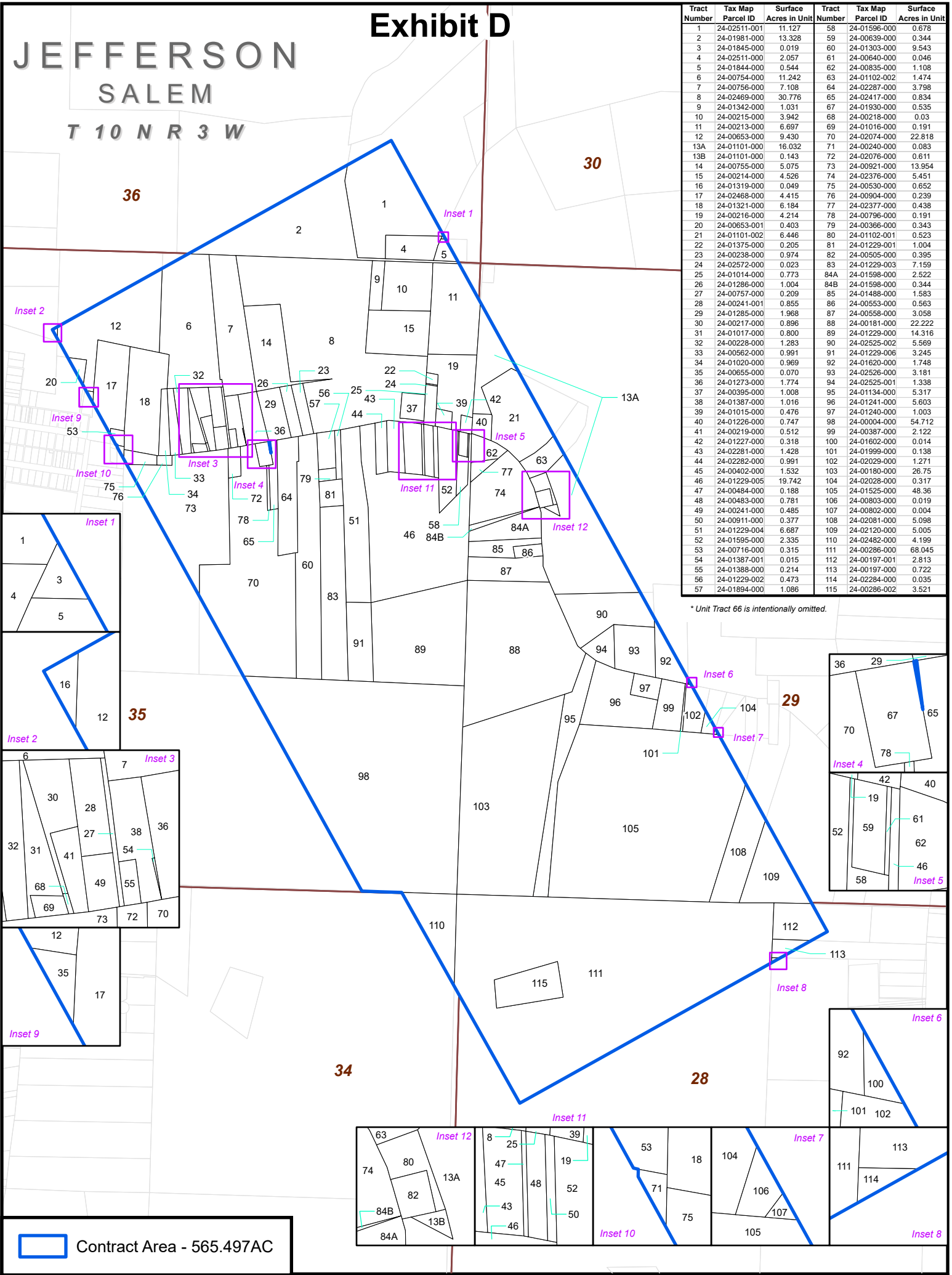

Contract Area - 565.497AC



ENCINO
Energy

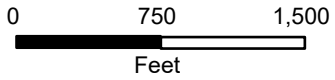

Exhibit D

Crawford North Unit
Salem Township
Jefferson Co., OH

1 inch = 1,000 feet

Due to internal record-keeping needs, there is no tract designated as Tract 66. Further, the parcel of land (i.e., Parcel 24-02521-000) located between Tracts 67 and 65 is not included in the proposed unit. This parcel is shown in solid blue in Inset 4 and above.

Projection: NAD 1927 BLM Zone 17N
Path: X:\Working\MXD\Land_Exhibits\Crawford North\Crawford North Exhibit A1.aprx