



# Ohio Department of Natural Resources

MIKE DEWINE, GOVERNOR

MARY MERTZ, DIRECTOR

**Eric Vendel, Chief**

Division of Oil and Gas Resources Management  
2045 Morse Rd, Building F  
Columbus, Ohio 43229  
Phone: (614) 265-6922; Fax: (614) 265-6910

## **ORDER BY THE CHIEF**

**November 09, 2023**

**ORDER NO. 2023-235**

**TO: Gulfport Appalachia, LLC  
713 Market Drive  
Oklahoma City, OK 73114**

**RE: Application for Unitization  
**Westhawk I Unit**  
Belmont and Monroe Counties, Ohio**

**SUBJECT: Order for Unit Operations of the Utica shale and Point Pleasant Formation  
for the Westhawk I Unit**

Pursuant to Ohio Revised Code (“R.C.”) § 1509.28, the Chief of the Division of Oil and Gas Resources Management (“Chief” or “Division”) makes the following Findings and issues the following Order with respect to Gulfport Appalachia, LLC’s (“Gulfport”) Application for Unit Operations for the Westhawk I Unit:

### **DEFINITIONS:**

As used in this order:

- 1) “Person” has the same meaning as in R.C. § 1509.01.
- 2) “Application” means the application of Gulfport Appalachia, LLC for Unit Operation of the Westhawk I Unit signed on September 5, 2023, and includes all updates, amendments, and supplements to it.
- 3) “Royalty interest owner” means a person or the estate of a person, other than a working interest owner, who owns the right to or interest in any portion of the oil and/or gas, or proceeds from the sale thereof, from a tract.

- 4) "Working interest" means an interest in oil and/or gas in the unit area by virtue of a lease, operating agreement, fee title, or otherwise, including a carried interest, the owner of which is obligated to pay, either in cash or out of production or otherwise a portion of the unit expense.
- 5) "Working interest owner" means a person or the estate of a person who owns an interest in oil and/or gas in the unit area by virtue of a lease, operating agreement, fee title, or otherwise, including a carried interest, the owner of which is obligated to pay, either in cash or out of production or otherwise a portion of the unit expense. "Working interest owner" does not include an unleased mineral owner.
- 6) "Unleased mineral owner" means a royalty interest owner who owns oil and/or gas rights free of a lease or other instrument conveying all or any portion of the working interest in such rights to another. At the time of this order, the unleased mineral owners identified by Gulfport include those listed on Exhibit A.
- 7) "Consenting working interest owner" means any working interest owner who enters into an agreement with Gulfport pertaining to the operation of the Westhawk I Unit.
- 8) "Non-consenting working interest owner" means a working interest owner who does not enter into an agreement with Gulfport pertaining to the operation of the Westhawk I Unit. At the time of this order, the non-consenting working interest owners identified by Gulfport include those listed as leased on Exhibit A with a 0.000% consenting working interest percentage.
- 9) "Gas" has the same meaning as in R.C. § 1509.01.
- 10) "Oil" has the same meaning as in R.C. § 1509.01.
- 11) "Unit Area" means all of the lands, oil and gas leases and/or oil and gas interests of the tracts as shown in Exhibit A totaling 619.413 acres located in Wayne Township, Belmont County and Sunbury Township, Monroe County, Ohio as shown in Exhibit B.
- 12) "Unit Participation" means the ratio of the surface acreage of a specific tract in the unit area to the total surface acreage of the unit area as that total surface acreage is specified in paragraph one of the Plan for Unit Operations of this order.
- 13) "Gross Proceeds" means a share of the gross production of oil, gas, condensate, and natural gas liquids free of any and all cost of producing, gathering, storing, separating, treating, dehydrating, compressing, processing, transporting, marketing, or pipeline construction and maintenance.
- 14) "Net Proceeds" means the share of gross production of oil, gas, condensate, or natural gas liquids after payment of all costs of producing, gathering, storing, separating, treating, dehydrating, compressing, processing, transporting, and marketing and taxes.

**BACKGROUND:**

- 1) Gulfport filed the application pursuant to R.C. § 1509.28 to conduct unit operations.
- 2) Pursuant to R.C. § 1509.28, the Division held a hearing on November 1, 2023. The hearing was held to consider the need for the operation as a unit of an entire pool or part thereof. Gulfport representatives provided testimony on the application and answered questions from Division staff.
- 3) The unit operations will occur at an approximate true vertical depth located from the top of the Utica shale to the base of the Point Pleasant Formation.

**FINDINGS:**

- 1) Based on the application and testimony by Gulfport's representatives, the Chief finds that Gulfport has established that it is the "owner," as that term is defined in R.C. § 1509.01(K), of greater than 65% of the land area overlying the pool in the Westhawk I Unit as required by R.C. § 1509.28(A).
- 2) Based on the application and testimony by Gulfport's representatives, the Chief finds that the operation of the Westhawk I Unit is reasonably necessary to increase substantially the ultimate recovery of oil and gas.
- 3) Based on the application and testimony by Gulfport's representatives, the Chief finds the value of the estimated additional recovery of oil or gas from the Westhawk I Unit exceeds the estimated additional cost incident to conducting the operation of the Westhawk I Unit.

**ORDER:**

**IT IS HEREBY ORDERED:**

Pursuant to R.C. § 1509.28, Gulfport is authorized to conduct operations within the Westhawk I Unit in accordance with all of the following:

**Plan for Unit Operations**

- 1) The unit area is comprised of the tracts totaling 619.413 acres located in Wayne Township, Belmont County and Sunbury Township, Monroe County, Ohio as shown in Exhibit B.
- 2) Gulfport proposes to drill one well in the Westhawk I Unit for the purpose of recovering oil and gas. Gulfport shall drill at least one well to total measured depth as specified in the application in the unit area within 12 months from the date of approval of this Order as prescribed in Paragraph 10 of this order. If Gulfport fails to drill at least one well to total measured depth as specified in the application in the unit area within 12 months from the date of approval of this Order as prescribed in Paragraph 10 of this order, the Chief may

revoke this order. In order to achieve the stated goal of substantially increasing the ultimate recovery of oil and gas from the Utica shale and Point Pleasant Formation within the unit area, Gulfport shall produce from one well no later than two years after the date of approval of this order. If Gulfport fails to drill, complete, and produce at least one well in the unit area, the Chief may amend or revoke this order. Any additional wells permitted by the Chief for the Utica shale and Point Pleasant Formation in the unit area are subject to this order.

- 3) Information from Gulfport for the Westhawk I Unit establishes that the Utica shale and Point Pleasant Formation uniformly underlies the unit area. Therefore, the allocated share of production to each tract shall be equal to that tract's unit participation.
- 4) Except as provided in Paragraph 9(d) of this order, all charges and credits made for investments in wells, tanks, pumps, machinery, materials, and equipment contributed to the Westhawk I Unit operations shall be allocated among the working interest owners of each tract based on the unit participation. The proportionate share of the expenses attributable to tracts of the unleased mineral owners shall be allocated to Gulfport and the working interest owners.
- 5) All unit operation expenses, including capital investment, shall be charged to, and paid by, Gulfport and working interest owners in amounts based on the unit participation plus their proportionate share of the expenses attributable to the tracts of unleased mineral owners. All unit operation expenses concerning wells and operating equipment shall be just and reasonable.
- 6) If necessary, Gulfport and the consenting working interest owners shall carry, or otherwise finance, any non-consenting working interest owners who are unable to meet their financial obligations in connection with the unit operations. Gulfport and all other consenting working interest owners' reasonable interest charge for carrying or financing the non-consenting working interest owners shall be determined by the terms of Gulfport's Unit Agreement and Model Form Operating Agreement for the Westhawk I Unit. Once a specific cost is charged to the initial well, that same cost cannot be charged to subsequent wells in the unit area.
- 7) Gulfport shall supervise and conduct all unit operations. Each working interest owner shall have a voting interest equal to its Unit Participation. Approval of unit operations shall be subject to the terms of Gulfport's Unit Agreement and Model Form Operating Agreement for the Westhawk I Unit.
- 8) Unit operations may commence as of 7:00 a.m. on the day following the date of approval of this order as prescribed in Paragraph 10 of this order. Once the initial well is placed into production, operations within the Westhawk I Unit may continue as long as hydrocarbons are produced from any well in the unit area without a cessation of more than 90 days, unless otherwise approved by the Chief in writing. The Westhawk I Unit may be terminated if working interest owners owning at least 51% of the working interest in the unit area

determine that the unit operations are no longer warranted. If the unit operations are so terminated, Gulfport shall provide written notice of the termination to the Division and to all unleased mineral owners. In addition to the notice of termination, Gulfport shall provide an affidavit to the Division attesting to the basis of the termination and all dates applicable to that basis. If termination of unit operations occurs prior to drilling and completing for production of one well in the Westhawk I Unit, the Chief may amend this order.

- 9) The following additional provisions are found to be appropriate:
- a) No activity associated with the drilling, completion, or operation of the Westhawk I Unit shall be conducted on the surface of any unleased property without the prior written consent of the owner of the surface rights of the unleased property.
  - b) Unleased mineral owners shall not incur liability for any personal or property damage associated with any drilling, testing, completing, producing, operating, or plugging and restoration activities within the Westhawk I Unit.
  - c) Each unleased mineral owner shall receive a monthly cash payment equal to a one-eighth share of the gross proceeds from production. Allocation of the one-eighth share shall be based on the unit participation of each unleased mineral owner's tract. Gulfport shall make monthly cash payments to all unleased mineral owners at the same time the royalty interest owners are paid.
  - d) In addition to the cash payment specified in paragraph 9(c) of this Order, each unleased mineral owner shall receive a monthly cash payment equal to a seven-eighths share of the net proceeds from production. Allocation of the seven-eighths share shall be based on the unit participation of each unleased mineral owner's tract. After Gulfport recovers 200% of the cost of drilling, testing, and completing the initial well, Gulfport shall begin making the monthly payments to the unleased mineral owners for that well. For each additional well drilled in the unit area, Gulfport shall begin making monthly payments equal to seven-eighths share of net proceeds from production to each unleased mineral owner once the working interest owners have recovered 150% of the cost of drilling, testing, and completing each additional well. Once a specific cost is charged to the initial well, that same cost cannot be charged to subsequent wells in the unit area.
  - e) Nothing in this order prohibits an unleased mineral owner from entering into a lease agreement with Gulfport or with any other person. An unleased mineral owner who enters into a lease of their mineral interests with any person after the issuance of this order is no longer an unleased mineral owner under this order as of the effective date of the lease. Gulfport shall notify the Division upon the execution of a lease agreement with any unleased mineral owner who is subject to this order.
  - f) Except as provided in Paragraph 9(d) of this order, no expenses shall be paid by an unleased mineral owner for drilling, testing, completing, producing, or operating

any well in the unit area. Moreover, unleased mineral owners are not responsible for any costs related to plugging any well or any restoration in the unit area.

- g) If requested in writing by any unleased mineral owner or by any non-consenting working interest owner, or in any manner by the Division, Gulfport shall provide, not later than 30 days after the request, any of the following:
  - i. A monthly statement of all costs incurred, together with the quantity of oil and gas produced, and the amount of proceeds realized from the sale of production during the preceding month; and
  - ii. Any authorization for expenditure (AFE) prepared by Gulfport; and
  - iii. A statement of all costs and expenses for purposes of Paragraphs 6 and 9(d) of this order.
- h) Gulfport shall notify the Division of the assignment or transfer of any of its working interest in the Westhawk I Unit. If Gulfport assigns or transfers any of its working interest, the assignee or transferee shall comply with this order. Within 60 days of the notice of assignment or transfer, Gulfport shall file a copy of the notice with each applicable county recorder's office in the records of each of the tracts that are subject to this order and referenced in Exhibit B of this order. Gulfport shall submit a certification of the filing to the Division within 14 days of filing.
- i) Gulfport shall notify the Division within 30 days if a person that is leased by Gulfport, or any other consenting working interest owner, for purposes of operating the Westhawk I Unit becomes unleased. If a person becomes unleased, the person is an unleased owner under this order and paragraphs 9(a) through 9(g) of this order apply.
- j) Gulfport shall notify the Division if any consenting working interest owner revokes, rescinds, or otherwise terminates the agreement with Gulfport pertaining to the operation of the Westhawk I Unit. If a consenting working interest owner revokes, rescinds, or otherwise terminates the agreement with Gulfport, the working interest owner becomes a non-consenting working interest owner pursuant to this order. Gulfport also shall notify the Division if any consenting working interest owner assigns or transfers all or part of its working interest in the Westhawk I Unit. All such assignees or transferees are subject to this order.
- k) Gulfport shall notify the Division if any non-consenting working interest owner enters into an agreement with Gulfport pertaining to the operation of the Westhawk I Unit. If a non-consenting working interest owner enters into an agreement with Gulfport, the non-consenting working interest owner becomes a consenting working interest owner pursuant to this order.

- l) If at any point Gulfport and consenting working interest owners own less than 65% of the unit, the Chief may amend or revoke this order.
- 10) This order becomes effective on the date Gulfport provides the Chief with final written approval of the unit operations as prescribed in this order by Gulfport and consenting working interest owners, and also by the royalty interest owners or, with respect to unleased acreage, unleased mineral owners of 65% of the acreage to be included in the unit. Unit operations may commence as set forth in Paragraph 8 of this Order. If Gulfport fails to provide all required approvals by May 9, 2024, the order is revoked, and the Chief shall provide notice of the revocation to Gulfport and to all persons listed in Exhibit A to this order.
- 11) If this Chief's Order is appealed, the time periods specified in this order are tolled pending final determination of the appeal.
- 12) Within 21 days of this order becoming effective, Gulfport shall file a copy of this order with each applicable county recorder's office in the records of each of the tracts that are subject to this order and referenced in Exhibit B of this order. Gulfport shall submit a certification of the filing to the Division within 14 days of filing. The certification shall include a reference to the volume and page number corresponding to each record where the Chief's Order is recorded.
- 13) The Chief of the Division retains continuing jurisdiction over the Westhawk I Unit as is consistent with the Chief's powers and duties as established by R.C. Chapter 1509 and Ohio Admin. Code 1501:9. The Chief reserves the right to amend or revoke this Order subsequent to the commencement of unit operations within the unit area.
- 14) Except as specifically set forth in the terms of this order, nothing herein shall be construed as a release or waiver of any private right, obligation, duty, claim, or cause of action.
- 15) If there is a conflict between the terms of this Chief's Order and any part of Gulfport's application, the Chief's Order takes precedence.

November 9, 2023

\_\_\_\_\_  
Date

*Eric Vendel*

/s/

\_\_\_\_\_  
Eric Vendel, Chief  
Division of Oil and Gas Resources Management

Addressee is hereby notified that this action is final and effective and may be appealed pursuant to Section 1509.36 of the Ohio Revised Code. If the Order is appealed to the Ohio Oil and Gas Commission, the appeal must be in writing and must set forth the Orders complained of and the grounds upon which the appeal is based. Such appeal must be filed with the Oil and Gas Commission, 2045 Morse Road, Building E-1, Office 103, Columbus, Ohio 43229-6693, within 30 days after the date upon which the person to whom the Order was issued received the order and, for all other persons adversely affected by the order, within 30 days after the date of the Order.

In addition, within three days after the appeal is filed with the Oil and Gas Commission, notice of the filing must be submitted to Eric Vendel, Chief, Division of Oil and Gas Resources Management, Ohio Department of Natural Resources, 2045 Morse Road, Building F, Columbus, Ohio 43229-6693.

Enclosures: Exhibit A  
Exhibit B



# Westhawk I Unit Chief's Order Exhibit A

EXHIBIT "A"  
All Mineral Owners in the proposed Westhawk I Unit

Tract Number	Lease ID Number	Mineral Owner	Leased Yes or No	Decimal Interest in Tract	Surface Acres in Unit	Tract Participation in Unit	Tax Map Parcel ID	Township	County	Consenting Working Interest Percentage	Gulfport Appalachia, LLC Working Interest	Rice Drilling D, LLC Working Interest	SWN Energy Company Working Interest	Antero Resources Corp Working Interest	Address	City	State	Zip	Supplement 11.2.2023
1	L034169000	Jerdene, LLC Attn: Nadene P. Hamilton and Jerry E. Hamilton, Members	Y	1.000	3.012	0.486%	46-00100.000	Wayne	Belmont	0.486%	0.486%	0.000%	0.000%	0.000%	54235 New Castle Road	Beallsville	OH	43716	
2	L034169000	Jerdene, LLC Attn: Nadene P. Hamilton and Jerry E. Hamilton, Members	Y	1.000	30.114	4.862%	46-00076.000	Wayne	Belmont	4.862%	4.862%	0.000%	0.000%	0.000%	54235 New Castle Road	Beallsville	OH	43716	
3A	Consenting Working Interest Owner	Bounty Minerals, LLC Attn: Tracie R. Palmer, President	Y	0.474	11.410	1.842%	46-00123.000	Wayne	Belmont	1.365%	0.000%	1.365%	0.000%	0.000%	777 Main Street, Suite 3400	Fort Worth	TX	76102	
3A	Non-Consenting Working Interest Owner		Y				46-00123.000	Wayne	Belmont	0.000%	0.000%	0.000%	0.000%	0.477%					
3A	Consenting Working Interest Owner	Gateway Royalty III, LLC Attn: Chris Oldham, President	Y	0.118	2.853	0.461%	46-00123.000	Wayne	Belmont	0.341%	0.000%	0.341%	0.000%	0.000%	PO Box 637	Carrollton	OH	44615	
3A	Non-Consenting Working Interest Owner		Y				46-00123.000	Wayne	Belmont	0.000%	0.000%	0.000%	0.000%	0.119%					
3A	Consenting Working Interest Owner	Greenbrier Royalty Fund II, LLC Attn: Raymond J. Rice, Manager and Steven R. Knox, Manager	Y	0.204	4.913	0.793%	46-00123.000	Wayne	Belmont	0.588%	0.000%	0.588%	0.000%	0.000%	6608 North Western Avenue, #278	Oklahoma City	OK	73116	
3A	Non-Consenting Working Interest Owner		Y				46-00123.000	Wayne	Belmont	0.000%	0.000%	0.000%	0.000%	0.206%					
3A	Consenting Working Interest Owner	Haystack Minerals, LLC Attn: Peter Lambert, Manager, and Julie Lock Lambert, Manager	Y	0.204	4.913	0.793%	46-00123.000	Wayne	Belmont	0.588%	0.000%	0.588%	0.000%	0.000%	2406 Spring Creek Drive	Austin	TX	78704	
3A	Non-Consenting Working Interest Owner		Y				46-00123.000	Wayne	Belmont	0.000%	0.000%	0.000%	0.000%	0.206%					
3B	L029978000 Consenting Working Interest Owner	Bounty Minerals, LLC Attn: Tracie R. Palmer, President	Y	0.474	4.059	0.655%	46-00123.000	Wayne	Belmont	0.655%	0.170%	0.485%	0.000%	0.000%	777 Main Street, Suite 3400	Fort Worth	TX	76102	
3B	L029978000 Consenting Working Interest Owner	Gateway Royalty III, LLC Attn: Chris Oldham, President	Y	0.118	1.015	0.164%	46-00123.000	Wayne	Belmont	0.164%	0.042%	0.121%	0.000%	0.000%	PO Box 637	Carrollton	OH	44615	
3B	L029978000 Consenting Working Interest Owner	Greenbrier Royalty Fund II, LLC Attn: Raymond J. Rice, Manager and Steven R. Knox, Manager	Y	0.204	1.748	0.282%	46-00123.000	Wayne	Belmont	0.282%	0.073%	0.209%	0.000%	0.000%	6608 North Western Avenue, #278	Oklahoma City	OK	73116	
3B	L029978000 Consenting Working Interest Owner	Haystack Minerals, LLC Attn: Peter Lambert, Manager, and Julie Lock Lambert, Manager	Y	0.204	1.748	0.282%	46-00123.000	Wayne	Belmont	0.282%	0.073%	0.209%	0.000%	0.000%	2406 Spring Creek Drive	Austin	TX	78704	
4	L034081000	Davis Family Trust Attn: William E. Davis and Hazel M. Davis, Trustees	Y	1.000	0.024	0.004%	46-00081.000	Wayne	Belmont	0.004%	0.004%	0.000%	0.000%	0.000%	54190 New Castle-Beallsville Road	Beallsville	OH	43716	
5	L034034000	Marvin A. Ward and Betty L. Ward, husband and wife, joint tenants	Y	1.000	64.179	10.361%	46-00223.000	Wayne	Belmont	10.361%	10.361%	0.000%	0.000%	0.000%	54120 New Castle Road	Beallsville	OH	43716	
5	L034034000	Sandra S. Fisher	Y	**	**	**	46-00223.000	Wayne	Belmont	**	**	**	**	**	942 Cabrillo Drive	Glendale	CA	91207	
5	L034034000	Tamara A. Petty	Y	**	**	**	46-00223.000	Wayne	Belmont	**	**	**	**	**	399 Tullare Avenue	Morro Bay	CA	93442	
5	L034034000	Roberta Stavely	Y	**	**	**	46-00223.000	Wayne	Belmont	**	**	**	**	**	2707 Spyglass Drive	Carrollton	TX	75007	
5	L034034000	Estate of George G. Thrall, his unknown heirs and assigns	Y	**	**	**	46-00223.000	Wayne	Belmont	**	**	**	**	**	Undetermined	Undetermined	Undetermined	Undetermined	
6	Non-Consenting Working Interest	Switzerland of Ohio Country Club Attn: David Dietrich, President	Y	1.000	11.565	1.867%	46-00244.000	Wayne	Belmont	0.000%	0.000%	0.000%	0.000%	1.867%	52936 Ohio 26	Beallsville	OH	43716	
7	L034081000	Davis Family Trust Attn: William E. Davis and Hazel M. Davis, Trustees	Y	1.000	50.091	8.087%	46-00082.000	Wayne	Belmont	8.087%	8.087%	0.000%	0.000%	0.000%	54190 New Castle-Beallsville Road	Beallsville	OH	43716	
8	Consenting Working Interest	Lisa J. Francis, a married woman	Y	0.500	0.185	0.030%	46-00087.000	Wayne	Belmont	0.030%	0.000%	0.000%	0.030%	0.000%	53910 New Castle-Beallsville Road	Beallsville	OH	43716	
8	Consenting Working Interest	Charles J. Francis and Lisa J. Francis, husband and wife, joint tenants	Y	0.500	0.185	0.030%	46-00087.000	Wayne	Belmont	0.030%	0.000%	0.000%	0.030%	0.000%	53910 New Castle-Beallsville Road	Beallsville	OH	43716	
9	Consenting Working Interest	REDHawk Acres, LLC Roger D. Hickman, Member and Edwina D. Hickman, Member	Y	1.000	1.851	0.299%	46-00107.000	Wayne	Belmont	0.299%	0.000%	0.000%	0.299%	0.000%	53659 New Castle-Beallsville Road	Beallsville	OH	43716	
10	Unleased Mineral Interest	Michael Alan Billiter and Teddy O'Dell Billiter, joint tenants	N	1.000	95.619	15.437%	46-00054.000	Wayne	Belmont	0.000%	0.000%	0.000%	0.000%	0.000%	4601 W San Miguel Avenue PO Box 151	North Las Vegas Beallsville	NV OH	89032 43716	
11	Unleased Mineral Interest	Michael Alan Billiter and Teddy O'Dell Billiter, joint tenants	N	1.000	0.008	0.001%	46-00053.000	Wayne	Belmont	0.000%	0.000%	0.000%	0.000%	0.000%	4601 W San Miguel Avenue PO Box 151	North Las Vegas Beallsville	NV OH	89032 43716	

**EXHIBIT "A"**  
**All Mineral Owners in the proposed Westhawk I Unit**

Tract Number	Lease ID Number	Mineral Owner	Leased Yes or No	Decimal Interest in Tract	Surface Acres in Unit	Tract Participation in Unit	Tax Map Parcel ID	Township	County	Consenting Working Interest Percentage	Gulfport Appalachia, LLC Working Interest	Rice Drilling D, LLC Working Interest	SWN Energy Company Working Interest	Antero Resources Corp Working Interest	Address	City	State	Zip	Supplement 11.2.2023
12	GPOR	Mary Jane Piatt, a widow	Y	1.000	17.590	2.840%	46-00192.000	Wayne	Belmont	2.840%	2.840%	0.000%	0.000%	0.000%	52365 State Route 145	Beallsville	OH	43716	
13	GPOR	Mary Jane Piatt, a widow	Y	1.000	9.951	1.607%	46-00191.000	Wayne	Belmont	1.607%	1.607%	0.000%	0.000%	0.000%	52365 State Route 145	Beallsville	OH	43716	
14	GPOR	Mary Jane Piatt, a widow	Y	1.000	1.258	0.203%	24-002004.4000	Sunsbury	Monroe	0.203%	0.203%	0.000%	0.000%	0.000%	52365 State Route 145	Beallsville	OH	43716	
15	GPOR	Mary Jane Piatt, a widow	Y	1.000	1.733	0.280%	24-002004.2000	Sunsbury	Monroe	0.280%	0.280%	0.000%	0.000%	0.000%	52365 State Route 145	Beallsville	OH	43716	
16	GPOR	Mary Jane Piatt, a widow	Y	1.000	22.343	3.607%	24-002004.1000	Sunsbury	Monroe	3.607%	3.607%	0.000%	0.000%	0.000%	52365 State Route 145	Beallsville	OH	43716	
17	GPOR	Mary Jane Piatt, a widow	Y	1.000	36.606	5.910%	24-003004.0000	Sunsbury	Monroe	5.910%	5.910%	0.000%	0.000%	0.000%	52365 State Route 145	Beallsville	OH	43716	
18	GPOR	Mary Jane Piatt, a widow	Y	1.000	0.239	0.039%	24-002004.3000	Sunsbury	Monroe	0.039%	0.039%	0.000%	0.000%	0.000%	52365 State Route 145	Beallsville	OH	43716	
19	L014012000	Campbell OMG, LLC Attn: Ray E. Campbell, Member	Y	1.000	129.887	20.969%	24-003001.0000	Sunsbury	Monroe	20.969%	20.969%	0.000%	0.000%	0.000%	42384 Paine Road	Beallsville	OH	43716	
20	Unleased Mineral Interest	Moose's Place, LLC Attn: Susan A. Mellott, Sole Member	N	1.000	13.898	2.244%	24-003003.0000	Sunsbury	Monroe	0.000%	0.000%	0.000%	0.000%	0.000%	915 Indiana Avenue	South Pasadena	CA	91030	
21	GPOR	Gary D. Crum and Carla J. Crum, husband and wife, joint tenants	Y	1.000	1.030	0.166%	24-003025.0000	Sunsbury	Monroe	0.166%	0.166%	0.000%	0.000%	0.000%	52531 SR 145	Beallsville	OH	43716	
22	Unleased Mineral Interest	Larry L. Phillips and Mercy C. Phillips, husband and wife, joint tenants	N	1.000	0.585	0.094%	24-003028.0000	Sunsbury	Monroe	0.000%	0.000%	0.000%	0.000%	0.000%	51300 Trembly Ridge Road	Beallsville	OH	43716	
23	Unleased Mineral Interest	Larry L. Phillips and Mercy C. Phillips, husband and wife, joint tenants	N	1.000	0.553	0.089%	24-003027.0000	Sunsbury	Monroe	0.000%	0.000%	0.000%	0.000%	0.000%	51300 Trembly Ridge Road	Beallsville	OH	43716	
24	L025008000	Michelle R. Moore, a single woman	Y	1.000	0.054	0.009%	24-003023.0000	Sunsbury	Monroe	0.009%	0.009%	0.000%	0.000%	0.000%	52577 State Route 145	Beallsville	OH	43716	
25	L025008000	Michelle R. Moore, a single woman	Y	1.000	0.347	0.056%	24-003021.0000	Sunsbury	Monroe	0.056%	0.056%	0.000%	0.000%	0.000%	52577 State Route 145	Beallsville	OH	43716	
26	L033805000	E. Michael Lloyd, Ima L. Highman, and James Helmann, Board Members on behalf of Monroe County Park District	Y	1.000	21.621	3.491%	24-003029.0000	Sunsbury	Monroe	3.491%	3.491%	0.000%	0.000%	0.000%	105 W Court Street	Woodsfield	OH	43793	
27	L025035000	Switzerland of Ohio Water District Attn: Roger Hendershot, President	Y	1.000	0.095	0.015%	24-003020.0000	Sunsbury	Monroe	0.015%	0.015%	0.000%	0.000%	0.000%	51746 Main Street	Jerusalem	OH	43747	
28	L025641000	Rodney G. Ray, a widower	Y	1.000	2.644	0.427%	24-032001.0000	Sunsbury	Monroe	0.427%	0.427%	0.000%	0.000%	0.000%	52586 State Route 145	Beallsville	OH	43716	
29	L025516000	William M. Wain and Deborah K. Wain, husband and wife, joint tenants	Y	1.000	0.910	0.147%	24-032002.0000	Sunsbury	Monroe	0.147%	0.147%	0.000%	0.000%	0.000%	52116 Sunbury Township Road 127	Beallsville	OH	43716	
30	GPOR	Bradley T. Thornberry and Karen S. Thornberry, joint tenants, TOD to Rayna Sue Hess and Nicole Trigg	Y	1.000	0.395	0.064%	24-032004.0000	Sunsbury	Monroe	0.064%	0.064%	0.000%	0.000%	0.000%	52112 Township Road 127	Beallsville	OH	43716	
31	GPOR	Bradley T. Thornberry and Karen S. Thornberry, joint tenants, TOD to Rayna Sue Hess and Nicole Trigg	Y	1.000	0.533	0.086%	24-032005.0000	Sunsbury	Monroe	0.086%	0.086%	0.000%	0.000%	0.000%	52112 Township Road 127	Beallsville	OH	43716	
32	Unleased Mineral Interest	Larry R. Rucker and Nancy L. Rucker, Trustees of the Rucker Family Trust, dated December 23, 2015	N	1.000	1.985	0.320%	24-032008.0000	Sunsbury	Monroe	0.000%	0.000%	0.000%	0.000%	0.000%	52612 State Route 145	Beallsville	OH	43716	
33	GPOR	Christopher M. Ashland, a single man	Y	1.000	3.223	0.520%	24-003010.0000	Sunsbury	Monroe	0.520%	0.520%	0.000%	0.000%	0.000%	52625 State Route 145	Beallsville	OH	43716	
34	GPOR	Bradley T. Thornberry and Karen S. Thornberry, joint tenants, TOD to Rayna Sue Hess and Nicole Trigg	Y	1.000	1.209	0.195%	24-032006.0000	Sunsbury	Monroe	0.195%	0.195%	0.000%	0.000%	0.000%	52112 Township Road 127	Beallsville	OH	43716	
35	GPOR	Sandra K. Lucas Living Trust dated May 24, 2016	Y	1.000	1.894	0.306%	24-032009.0000	Sunsbury	Monroe	0.306%	0.306%	0.000%	0.000%	0.000%	52134 Township Highway 127	Beallsville	OH	43716	
36	L025387000	Donald Carlos Headley and Ruth A. Headley, husband and wife	Y	1.000	1.502	0.242%	24-003011.0000	Sunsbury	Monroe	0.242%	0.242%	0.000%	0.000%	0.000%	PO Box 45	Beallsville	OH	43716	
37	L034298000	The Board of Education for the Switzerland of Ohio Local School District Attn: Phil Ackerman, Superintendent	Y	1.000	2.049	0.331%	24-003012.1000	Sunsbury	Monroe	0.331%	0.331%	0.000%	0.000%	0.000%	304 Mill Street	Woodsfield	OH	43793	
38	L025745000	The Board of Education for the Switzerland of Ohio Local School District Attn: Phil Ackerman, Superintendent	Y	1.000	0.245	0.040%	24-003012.0000	Sunsbury	Monroe	0.040%	0.040%	0.000%	0.000%	0.000%	304 Mill Street	Woodsfield	OH	43793	
39	Unleased Mineral Interest	Weaver W. Hanes, Heir of Fred Tschappat and Linda Tschappat, deceased	N	0.003	0.001	0.0001%	24-003012.2000	Sunsbury	Monroe	0.000%	0.000%	0.000%	0.000%	0.000%	320 Woody Road NW	Adairsville	GA	30103	

**EXHIBIT "A"**  
**All Mineral Owners in the proposed Westhawk I Unit**

Tract Number	Lease ID Number	Mineral Owner	Leased Yes or No	Decimal Interest in Tract	Surface Acres in Unit	Tract Participation in Unit	Tax Map Parcel ID	Township	County	Consenting Working Interest Percentage	Gulfport Appalachia, LLC Working Interest	Rice Drilling D, LLC Working Interest	SWN Energy Company Working Interest	Antero Resources Corp Working Interest	Address	City	State	Zip	Supplement 11.2.2023
39	L027469000	Harry F. Hanes, Heir of Fred Tschappat and Linda Tschappat, deceased	Y	0.003	0.001	0.0001%	24-003012.2000	Sunsbury	Monroe	0.0001%	0.0001%	0.000%	0.000%	0.000%	14000 N 94th Street, Unit 1170	Scottsdale	AZ	85260	
39	L028903000	Cathy Winifred King, Heir of Fred Tschappat and Linda Tschappat, deceased	Y	0.003	0.001	0.0001%	24-003012.2000	Sunsbury	Monroe	0.0001%	0.0001%	0.000%	0.000%	0.000%	22517 E Hoover Place	Aurora	CO	80016	
39	Unleased Mineral Interest	Stephen W. Hanes, Heir of Fred Tschappat and Linda Tschappat, deceased	N	0.003	0.001	0.0001%	24-003012.2000	Sunsbury	Monroe	0.000%	0.000%	0.000%	0.000%	0.000%	2051 Exeter C	Boca Raton	FL	33434	
39	L028515000	Ian Christopher Wain, Heir of Fred Tschappat and Linda Tschappat, deceased	Y	0.002	0.0004	0.0001%	24-003012.2000	Sunsbury	Monroe	0.0001%	0.0001%	0.000%	0.000%	0.000%	1736 Spring Meadows Drive	Xenia	OH	45385	
39	L028910000	David McKinley Wain, Heir of Fred Tschappat and Linda Tschappat, deceased	Y	0.002	0.0004	0.0001%	24-003012.2000	Sunsbury	Monroe	0.0001%	0.0001%	0.000%	0.000%	0.000%	109 Village Green Avenue	Woodstock	GA	30189	
39	Unleased Mineral Interest	William M. Wain, Heir of Fred Tschappat and Linda Tschappat, deceased	N	0.004	0.001	0.0001%	24-003012.2000	Sunsbury	Monroe	0.000%	0.000%	0.000%	0.000%	0.000%	52116 Township Road 127	Beallsville	OH	43716	
39	Unleased Mineral Interest	Melinda Wain Fisher, Heir of Fred Tschappat and Linda Tschappat, deceased	N	0.004	0.001	0.0001%	24-003012.2000	Sunsbury	Monroe	0.000%	0.000%	0.000%	0.000%	0.000%	448 Ross Road	Columbus	OH	43213	
39	L027124000	Nile Frederick Wain, Heir of Fred Tschappat and Linda Tschappat, deceased	Y	0.004	0.001	0.0001%	24-003012.2000	Sunsbury	Monroe	0.0001%	0.0001%	0.000%	0.000%	0.000%	845 Shirley Ann Trail	Lakeland	FL	33809	
39	Unleased Mineral Interest	Nancy W. Altemus, Heir of Fred Tschappat and Linda Tschappat, deceased	N	0.004	0.001	0.0001%	24-003012.2000	Sunsbury	Monroe	0.000%	0.000%	0.000%	0.000%	0.000%	8 Hillvale Circle	Wilmington	DE	19808	
39	L026934000	Dorothy W. Casteel, Heir of Fred Tschappat and Linda Tschappat, deceased	Y	0.004	0.001	0.0001%	24-003012.2000	Sunsbury	Monroe	0.0001%	0.0001%	0.000%	0.000%	0.000%	534 Planters Manor Way	Bradenton	FL	34212	
39	L026798000	Gloria J. Jenkins, Heir of Fred Tschappat and Linda Tschappat, deceased	Y	0.011	0.002	0.0004%	24-003012.2000	Sunsbury	Monroe	0.0004%	0.0004%	0.000%	0.000%	0.000%	36859 Fiddleneck Court	Palmdale	CA	93550	
39	Unleased Mineral Interest	Heirs of Mary Louise Forristall, deceased, Heir of Fred Tschappat and Linda Tschappat, deceased	N	0.004	0.001	0.0001%	24-003012.2000	Sunsbury	Monroe	0.000%	0.000%	0.000%	0.000%	0.000%	2549 Emerald Way N	Deerfield Beach	FL	33442	
39	L028134000	Gerald F. Suffoletta, Heir of Fred Tschappat and Linda Tschappat, deceased	Y	0.004	0.001	0.0001%	24-003012.2000	Sunsbury	Monroe	0.0001%	0.0001%	0.000%	0.000%	0.000%	1272 Virginia Avenue	Midland	PA	15059	
39	Unleased Mineral Interest	Daniel B. Suffoletta, Heir of Fred Tschappat and Linda Tschappat, deceased	N	0.004	0.001	0.0001%	24-003012.2000	Sunsbury	Monroe	0.000%	0.000%	0.000%	0.000%	0.000%	715 Nova Circle	Stockbridge	GA	30281	
39	Unleased Mineral Interest	Robert W. MacKall, Heir of Fred Tschappat and Linda Tschappat, deceased	N	0.006	0.001	0.0002%	24-003012.2000	Sunsbury	Monroe	0.000%	0.000%	0.000%	0.000%	0.000%	2 Tillou Ct	South Orange	NJ	07079	
39	Unleased Mineral Interest	Brenda U. Cekanski, Heir of Fred Tschappat and Linda Tschappat, deceased	N	0.006	0.001	0.0002%	24-003012.2000	Sunsbury	Monroe	0.000%	0.000%	0.000%	0.000%	0.000%	1248 White Stone Circle NE	Canton	OH	44721	
39	Unleased Mineral Interest	Penelope Hutchinson, Heir of Fred Tschappat and Linda Tschappat, deceased	N	0.006	0.001	0.0002%	24-003012.2000	Sunsbury	Monroe	0.000%	0.000%	0.000%	0.000%	0.000%	15560 County Airport Road	East Liverpool	OH	43920	
39	Unleased Mineral Interest	Jack F. Wain, Jr., Heir of Fred Tschappat and Linda Tschappat, deceased	N	0.006	0.001	0.0002%	24-003012.2000	Sunsbury	Monroe	0.000%	0.000%	0.000%	0.000%	0.000%	15726 Maple Drive	East Liverpool	OH	43920	
39	Unleased Mineral Interest	Gary Dean Wain, Heir of Fred Tschappat and Linda Tschappat, deceased	N	0.004	0.001	0.0001%	24-003012.2000	Sunsbury	Monroe	0.000%	0.000%	0.000%	0.000%	0.000%	4997 Castlewood Drive SW	Lilburn	GA	30047	
39	L009294000	Nile L. Wain, Heir of Fred Tschappat and Linda Tschappat, deceased	Y	0.004	0.001	0.0001%	24-003012.2000	Sunsbury	Monroe	0.0001%	0.0001%	0.000%	0.000%	0.000%	33919 Coddle Court	Wesley Chapel	FL	33543	
39	L027698000	Mark Glen Wain, Heir of Fred Tschappat and Linda Tschappat, deceased	Y	0.004	0.001	0.0001%	24-003012.2000	Sunsbury	Monroe	0.0001%	0.0001%	0.000%	0.000%	0.000%	3802 Hathaway Avenue, Unit 710	Long Beach	CA	90815	
39	Unleased Mineral Interest	Kenneth A. Boisvert, Heir of Fred Tschappat and Linda Tschappat, deceased	N	0.002	0.001	0.0001%	24-003012.2000	Sunsbury	Monroe	0.000%	0.000%	0.000%	0.000%	0.000%	2984 Martin Place	Dupont	WA	98327	
39	Unleased Mineral Interest	Elaine A. Workman, Heir of Fred Tschappat and Linda Tschappat, deceased	N	0.002	0.001	0.0001%	24-003012.2000	Sunsbury	Monroe	0.000%	0.000%	0.000%	0.000%	0.000%	5801 Orchard Street W, Apt 135	University Place	WA	98467	
39	Unleased Mineral Interest	Steve C. Boisvert, Heir of Fred Tschappat and Linda Tschappat, deceased	N	0.002	0.001	0.0001%	24-003012.2000	Sunsbury	Monroe	0.000%	0.000%	0.000%	0.000%	0.000%	406 4th Street NW, Apt A	Puyallup	WA	98371	
39	Unleased Mineral Interest	Charles Richard Meyers, aka Rick Meyers, Heir of Fred Tschappat and Linda Tschappat, deceased	N	0.002	0.0004	0.0001%	24-003012.2000	Sunsbury	Monroe	0.000%	0.000%	0.000%	0.000%	0.000%	2788 Busby Road	Oak Harbor	WA	98277	
39	Unleased Mineral Interest	Ronald G. Meyers, Heir of Fred Tschappat and Linda Tschappat, deceased	N	0.002	0.0004	0.0001%	24-003012.2000	Sunsbury	Monroe	0.000%	0.000%	0.000%	0.000%	0.000%	8765 Talln Lane NE, Suite A	Lacey	WA	98516	
39	L028218000	Lauren Alyssa Anderson, Heir of Fred Tschappat and Linda Tschappat, deceased	Y	0.004	0.001	0.0001%	24-003012.2000	Sunsbury	Monroe	0.0001%	0.0001%	0.000%	0.000%	0.000%	1006 Sterling Lane	Summerville	SC	29483	
39	L028056000	Andrew William Wain, Heir of Fred Tschappat and Linda Tschappat, deceased	Y	0.004	0.001	0.0001%	24-003012.2000	Sunsbury	Monroe	0.0001%	0.0001%	0.000%	0.000%	0.000%	124 Newington Road	Summerville	SC	29485	
39	Unleased Mineral Interest	Jennifer Diane Wain, Heir of Fred Tschappat and Linda Tschappat, deceased	N	0.004	0.001	0.0001%	24-003012.2000	Sunsbury	Monroe	0.000%	0.000%	0.000%	0.000%	0.000%	104 Foxfire Ct	Summerville	SC	29483	

**EXHIBIT "A"**  
**All Mineral Owners in the proposed Westhawk I Unit**

Tract Number	Lease ID Number	Mineral Owner	Leased Yes or No	Decimal Interest in Tract	Surface Acres in Unit	Tract Participation in Unit	Tax Map Parcel ID	Township	County	Consenting Working Interest Percentage	Gulfport Appalachia, LLC Working Interest	Rice Drilling D, LLC Working Interest	SWN Energy Company Working Interest	Antero Resources Corp Working Interest	Address	City	State	Zip	Supplement 11.2.2023
39	GPOR	Eugenia Benton D'Elia, as Trustee of the Jean Marie Wain Revocable Trust dated July 12, 2002 as amended and restated February 2, 2010, as an Heir of Fred Tschappat and Linda Tschappat, deceased	Y	0.011	0.002	0.0004%	24-003012.2000	Sunsbury	Monroe	0.0004%	0.0004%	0.000%	0.000%	0.000%	16600 Bahner Ct	Mount Airy	MD	21771	
39	Unleased Mineral Interest	Rebecca Darlene Steigelman, Heir of Fred Tschappat and Linda Tschappat, deceased	N	0.011	0.002	0.0004%	24-003012.2000	Sunsbury	Monroe	0.000%	0.000%	0.000%	0.000%	0.000%	1 Sandy Bottom Road	Carlisle	PA	17015	
39	L026782000	Heirs of Richard A. Wain, deceased, Heir of Fred Tschappat and Linda Tschappat, deceased c/o Michael R. Wain	Y	0.004	0.001	0.0001%	24-003012.2000	Sunsbury	Monroe	0.0001%	0.0001%	0.000%	0.000%	0.000%	3169 Locust Boulevard	Bullhead City	AZ	86429	
39	Unleased Mineral Interest	Heirs of Wallace G. Wain, deceased, Heir of Fred Tschappat and Linda Tschappat, deceased	N	0.004	0.001	0.0001%	24-003012.2000	Sunsbury	Monroe	0.000%	0.000%	0.000%	0.000%	0.000%	Undetermined	Undetermined	Undetermined	Undetermined	
39	GPOR	William L. Gotschall, Heir of Fred Tschappat and Linda Tschappat, deceased	Y	0.004	0.001	0.0001%	24-003012.2000	Sunsbury	Monroe	0.0001%	0.0001%	0.000%	0.000%	0.000%	8231 Fallglo Lane	Land O Lakes	FL	34637	
39	L028216000	Richard Kenneth Tschappat, Jr., Heir of Fred Tschappat and Linda Tschappat, deceased	Y	0.009	0.002	0.0003%	24-003012.2000	Sunsbury	Monroe	0.0003%	0.0003%	0.000%	0.000%	0.000%	510 Dry Fork Road	Rarden	OH	45671	
39	L028938000	Sharon A. Yantes, Heir of Fred Tschappat and Linda Tschappat, deceased	Y	0.009	0.002	0.0003%	24-003012.2000	Sunsbury	Monroe	0.0003%	0.0003%	0.000%	0.000%	0.000%	939 Walhonding Avenue	Logan	OH	43138	
39	L028936000	Roger G. Tschappat, Heir of Fred Tschappat and Linda Tschappat, deceased	Y	0.004	0.001	0.0001%	24-003012.2000	Sunsbury	Monroe	0.0001%	0.0001%	0.000%	0.000%	0.000%	939 Walhonding Avenue	Logan	OH	43138	
39	Unleased Mineral Interest	The Kathleen Mogg Revocable Trust, Kathleen Mogg Trustee of that certain Trust dated October 22, 1985, as amended, Heir of Fred Tschappat and Linda Tschappat, deceased	N	0.011	0.002	0.0004%	24-003012.2000	Sunsbury	Monroe	0.000%	0.000%	0.000%	0.000%	0.000%	248 Chippingstone Road	Chatham	MA	02633	
39	L026953000	Michael M. Decker, Heir of Fred Tschappat and Linda Tschappat, deceased	Y	0.017	0.004	0.001%	24-003012.2000	Sunsbury	Monroe	0.001%	0.001%	0.000%	0.000%	0.000%	1200 W Buena Vista Road, Apt 201	Evansville	IN	47710	
39	L027359000	Kimberly D. Fromm, aka Kimberly Anne Fromm, Heir of Fred Tschappat and Linda Tschappat, deceased	Y	0.017	0.004	0.001%	24-003012.2000	Sunsbury	Monroe	0.001%	0.001%	0.000%	0.000%	0.000%	7650 Deskin Road	Elberfeld	IN	47613	
39	L009369000	Betty Joan Tschappat, Heir of Fred Tschappat and Linda Tschappat, deceased	Y	0.022	0.005	0.001%	24-003012.2000	Sunsbury	Monroe	0.001%	0.001%	0.000%	0.000%	0.000%	702 Washington Avenue	Lancaster	OH	43130	
39	Unleased Mineral Interest	Melanie Coleman, Heir of Fred Tschappat and Linda Tschappat, deceased	N	0.008	0.002	0.0003%	24-003012.2000	Sunsbury	Monroe	0.000%	0.000%	0.000%	0.000%	0.000%	Taigh Na Phoiste Main Street	Barry, Angus (Scotland)	United Kingdom	Dd7 7rp	
39	Unleased Mineral Interest	Katherine Tschappat, Heir of Fred Tschappat and Linda Tschappat, deceased	N	0.008	0.002	0.0003%	24-003012.2000	Sunsbury	Monroe	0.000%	0.000%	0.000%	0.000%	0.000%	60 N Beretania Street, Apt 2909	Honolulu	HI	96817	
39	L027539000	Ellanora Pardike, Heir of Fred Tschappat and Linda Tschappat, deceased	Y	0.017	0.004	0.001%	24-003012.2000	Sunsbury	Monroe	0.001%	0.001%	0.000%	0.000%	0.000%	61 W Breitmeyer Place	Mount Clemens	MI	48043	
39	Unleased Mineral Interest	Heirs of William H. Tschappat, deceased, Heir of Fred Tschappat and Linda Tschappat, deceased	N	0.015	0.003	0.001%	24-003012.2000	Sunsbury	Monroe	0.000%	0.000%	0.000%	0.000%	0.000%	Undetermined	Undetermined	Undetermined	Undetermined	
39	L027739000	Elizabeth Schafer Tschappat, Heir of Fred Tschappat and Linda Tschappat, deceased	Y	0.015	0.003	0.001%	24-003012.2000	Sunsbury	Monroe	0.001%	0.001%	0.000%	0.000%	0.000%	1407 W Broadway Street	Mount Pleasant	MI	48858	
39	Unleased Mineral Interest	Heirs of Mary Jane Tschappat, deceased, Heir of Fred Tschappat and Linda Tschappat, deceased	N	0.022	0.005	0.001%	24-003012.2000	Sunsbury	Monroe	0.000%	0.000%	0.000%	0.000%	0.000%	Undetermined	Undetermined	Undetermined	Undetermined	
39	Unleased Mineral Interest	Carol Anne Carmel, Heir of Fred Tschappat and Linda Tschappat, deceased	N	0.006	0.001	0.0002%	24-003012.2000	Sunsbury	Monroe	0.000%	0.000%	0.000%	0.000%	0.000%	78865 Sunbrook Lane	La Quinta	CA	92253	
39	Unleased Mineral Interest	Linda Diane Fite, Heir of Fred Tschappat and Linda Tschappat, deceased	N	0.006	0.001	0.0002%	24-003012.2000	Sunsbury	Monroe	0.000%	0.000%	0.000%	0.000%	0.000%	8750 Timberwick Street	San Antonio	TX	78250	
39	Unleased Mineral Interest	Debra Kay Muller, Heir of Fred Tschappat and Linda Tschappat, deceased	N	0.006	0.001	0.0002%	24-003012.2000	Sunsbury	Monroe	0.000%	0.000%	0.000%	0.000%	0.000%	12922 Majestic Cedar	Helotes	TX	78023	
39	L026953000	Pamela Ruth Jones, Heir of Fred Tschappat and Linda Tschappat, deceased	Y	0.006	0.001	0.0002%	24-003012.2000	Sunsbury	Monroe	0.0002%	0.0002%	0.000%	0.000%	0.000%	2215 Pecan Villa	New Braunfels	TX	78130	
39	Unleased Mineral Interest	Earl Jones, Heir of Fred Tschappat and Linda Tschappat, deceased	N	0.006	0.001	0.0002%	24-003012.2000	Sunsbury	Monroe	0.000%	0.000%	0.000%	0.000%	0.000%	39 Gerrard Street	London	Ontario, Canada	N6C 4C6	
39	Unleased Mineral Interest	Martin Leroy Jones, Heir of Fred Tschappat and Linda Tschappat, deceased	N	0.006	0.001	0.0002%	24-003012.2000	Sunsbury	Monroe	0.000%	0.000%	0.000%	0.000%	0.000%	1927 Edgewater Falls	Canyon Lane	TX	78133	
39	Unleased Mineral Interest	David Wayne Fite, Heir of Fred Tschappat and Linda Tschappat, deceased	N	0.017	0.004	0.001%	24-003012.2000	Sunsbury	Monroe	0.000%	0.000%	0.000%	0.000%	0.000%	8818 Ridgefront	San Antonio	TX	78250	
39	Unleased Mineral Interest	Donald Lee McIntosh Trust dated March 5, 1991, Heir of Fred Tschappat and Linda Tschappat, deceased	N	0.025	0.005	0.001%	24-003012.2000	Sunsbury	Monroe	0.000%	0.000%	0.000%	0.000%	0.000%	232 Allen Street	Franklin	OH	45005	
39	L027955000	Bruce Edward Jeffis, Heir of Fred Tschappat and Linda Tschappat, deceased	Y	0.006	0.001	0.0002%	24-003012.2000	Sunsbury	Monroe	0.0002%	0.0002%	0.000%	0.000%	0.000%	20534 E Girard Place	Aurora	CO	80013	

**EXHIBIT "A"**  
**All Mineral Owners in the proposed Westhawk I Unit**

Tract Number	Lease ID Number	Mineral Owner	Leased Yes or No	Decimal Interest in Tract	Surface Acres in Unit	Tract Participation in Unit	Tax Map Parcel ID	Township	County	Consenting Working Interest Percentage	Gulfport Appalachia, LLC Working Interest	Rice Drilling D, LLC Working Interest	SWN Energy Company Working Interest	Antero Resources Corp Working Interest	Address	City	State	Zip	Supplement 11.2.2023
39	L027954000	Donna L. Haug, Heir of Fred Tschappat and Linda Tschappat, deceased	Y	0.006	0.001	0.0002%	24-003012.2000	Sunsbury	Monroe	0.0002%	0.0002%	0.000%	0.000%	0.000%	12193 W Capri Avenue	Littleton	CO	80127	
39	L028514000	Ellen Kay Sanders, Heir of Fred Tschappat and Linda Tschappat, deceased	Y	0.006	0.001	0.0002%	24-003012.2000	Sunsbury	Monroe	0.0002%	0.0002%	0.000%	0.000%	0.000%	9 Shore Pine	Littleton	CO	80127	
39	GPOR	Patrick Harrison, Trustee of the Ruth M. Jeffs Trust for the benefit of Dylan Robert Harrison and Gavin William Harrison, Heir of Fred Tschappat and Linda Tschappat, deceased	Y	0.006	0.001	0.0002%	24-003012.2000	Sunsbury	Monroe	0.0002%	0.0002%	0.000%	0.000%	0.000%	5262 Maplewood Pl	Centennial	CO	80121	Added decimal point
39	GPOR	Timothy Wayne Farel, Heir of George Ronald Farel, IV, deceased and Rebecca Ann Farel	Y	0.001	0.0002	0.00003%	24-003012.2000	Sunsbury	Monroe	0.00003%	0.00003%	0.000%	0.000%	0.000%	10 Sarasota Court	Montgomery	TX	77356	
39	Unleased Mineral Interest	Tristan Ronald Farel, Heir of Fred Tschappat and Linda Tschappat, deceased	N	0.001	0.0002	0.00003%	24-003012.2000	Sunsbury	Monroe	0.000%	0.000%	0.000%	0.000%	0.000%	11255 Raritan Street	Denver	CO	80234	
39	Unleased Mineral Interest	Theresa Farel Stanton, Heir of Fred Tschappat and Linda Tschappat, deceased	N	0.001	0.0002	0.00003%	24-003012.2000	Sunsbury	Monroe	0.000%	0.000%	0.000%	0.000%	0.000%	416 N 4 1/2	Murphysboro	IL	62966	
39	Unleased Mineral Interest	Tiffany Farel, Heir of Fred Tschappat and Linda Tschappat, deceased	N	0.001	0.0002	0.00003%	24-003012.2000	Sunsbury	Monroe	0.000%	0.000%	0.000%	0.000%	0.000%	2115 Logan Street	Murphysboro	IL	62966	
39	L028977000	Michael Thomas Farel, Heir of Fred Tschappat and Linda Tschappat, deceased	Y	0.001	0.0003	0.00005%	24-003012.2000	Sunsbury	Monroe	0.00005%	0.00005%	0.000%	0.000%	0.000%	215 Stone Street	Demorest	GA	30535	
39	GPOR	Jonna Straight, Heir of Fred Tschappat and Linda Tschappat, deceased	Y	0.001	0.0001	0.00002%	24-003012.2000	Sunsbury	Monroe	0.00002%	0.00002%	0.000%	0.000%	0.000%	211 E 18th Street	Grand Island	NE	68801	
39	Unleased Mineral Interest	James Earl Napier, Heir of Fred Tschappat and Linda Tschappat, deceased	N	0.001	0.0001	0.00002%	24-003012.2000	Sunsbury	Monroe	0.000%	0.000%	0.000%	0.000%	0.000%	405 Parker Street	Tahlequah	OK	74464	
39	Unleased Mineral Interest	Mary Ann Brinkman, Heir of Fred Tschappat and Linda Tschappat, deceased	N	0.006	0.001	0.0002%	24-003012.2000	Sunsbury	Monroe	0.000%	0.000%	0.000%	0.000%	0.000%	5122 E Avenue	Kearney	NE	68847	
39	Unleased Mineral Interest	Susan C. Nelson, Heir of Fred Tschappat and Linda Tschappat, deceased	N	0.001	0.0002	0.00003%	24-003012.2000	Sunsbury	Monroe	0.000%	0.000%	0.000%	0.000%	0.000%	818 E 10th Avenue	Spokane	WA	99202	
39	L027523000	Debra L. Kiessling, Heir of Fred Tschappat and Linda Tschappat, deceased	Y	0.001	0.0002	0.00003%	24-003012.2000	Sunsbury	Monroe	0.00003%	0.00003%	0.000%	0.000%	0.000%	7837 Deerfield Lane	Panama City	FL	32404	
39	L028154000	Eric Anthony Brinkman, Heir of Fred Tschappat and Linda Tschappat, deceased	Y	0.0005	0.0001	0.00002%	24-003012.2000	Sunsbury	Monroe	0.00002%	0.00002%	0.000%	0.000%	0.000%	650 Whites School Road	Sevierville	TN	37876	
39	Unleased Mineral Interest	Michelle M. Hope, Heir of Fred Tschappat and Linda Tschappat, deceased	N	0.0005	0.0001	0.00002%	24-003012.2000	Sunsbury	Monroe	0.000%	0.000%	0.000%	0.000%	0.000%	115 Sinjon Lane, Lot 37	Dandridge	TN	37725	
39	L027360000	Patricia Nickles, Heir of Fred Tschappat and Linda Tschappat, deceased	Y	0.003	0.001	0.0001%	24-003012.2000	Sunsbury	Monroe	0.0001%	0.0001%	0.000%	0.000%	0.000%	12066 Shore Drive	Republican City	NE	68971	
39	L028516000	Robert Wilbur Davis, Heir of Fred Tschappat and Linda Tschappat, deceased	Y	0.004	0.001	0.0001%	24-003012.2000	Sunsbury	Monroe	0.0001%	0.0001%	0.000%	0.000%	0.000%	7240 Otis Court	Arvada	CO	80003	
39	Unleased Mineral Interest	Gary Michel Perotin, Heir of Fred Tschappat and Linda Tschappat, deceased	N	0.001	0.0003	0.00005%	24-003012.2000	Sunsbury	Monroe	0.000%	0.000%	0.000%	0.000%	0.000%	478 Washington Street, Apt 202	Newark	NJ	07102	
39	Unleased Mineral Interest	Sheri Lee Hanson, Heir of Fred Tschappat and Linda Tschappat, deceased	N	0.001	0.0003	0.00005%	24-003012.2000	Sunsbury	Monroe	0.000%	0.000%	0.000%	0.000%	0.000%	8376 E 35th Avenue	Denver	CO	80238	
39	Unleased Mineral Interest	Shelby Jordan, Heir of Fred Tschappat and Linda Tschappat, deceased	N	0.001	0.0002	0.00002%	24-003012.2000	Sunsbury	Monroe	0.000%	0.000%	0.000%	0.000%	0.000%	6301 W Hampden Avenue, Apt 7-207	Denver	CO	80227	
39	Unleased Mineral Interest	Seth Jordan, Heir of Fred Tschappat and Linda Tschappat, deceased	N	0.001	0.0002	0.00002%	24-003012.2000	Sunsbury	Monroe	0.000%	0.000%	0.000%	0.000%	0.000%	15401 E Temple Pl	Aurora	CO	80015	
39	L028911000	Patricia A. Glynn, Heir of Fred Tschappat and Linda Tschappat, deceased	Y	0.004	0.001	0.0001%	24-003012.2000	Sunsbury	Monroe	0.0001%	0.0001%	0.000%	0.000%	0.000%	6411 W 5th Avenue	Lakewood	CO	80226	
39	Unleased Mineral Interest	Carolyn J. Sutton, Heir of Fred Tschappat and Linda Tschappat, deceased	N	0.001	0.0003	0.00005%	24-003012.2000	Sunsbury	Monroe	0.000%	0.000%	0.000%	0.000%	0.000%	1180 Corporate Way, Apt 324	Sacramento	CA	95831	
39	Unleased Mineral Interest	Oscar Ray Combs, Heir of Fred Tschappat and Linda Tschappat, deceased	N	0.0005	0.0001	0.00002%	24-003012.2000	Sunsbury	Monroe	0.000%	0.000%	0.000%	0.000%	0.000%	5202 N Mayfield Avenue	San Bernardino	CA	92407	
39	Unleased Mineral Interest	Robert E. Park, Heir of Fred Tschappat and Linda Tschappat, deceased	N	0.0005	0.0001	0.00002%	24-003012.2000	Sunsbury	Monroe	0.000%	0.000%	0.000%	0.000%	0.000%	2640 S Cottonwood Lane #71	Tucson	AZ	85713	
39	Unleased Mineral Interest	John Christopher Combs, Heir of Fred Tschappat and Linda Tschappat, deceased	N	0.0005	0.0001	0.00002%	24-003012.2000	Sunsbury	Monroe	0.000%	0.000%	0.000%	0.000%	0.000%	14333 Bellbrook Street	Baldwin Park	CA	91706	
39	Unleased Mineral Interest	Cheri Lynn Sutton, Heir of Fred Tschappat and Linda Tschappat, deceased	N	0.001	0.0003	0.00005%	24-003012.2000	Sunsbury	Monroe	0.000%	0.000%	0.000%	0.000%	0.000%	15103 Twain Ville Lane	Conroe	TX	77302	
39	L027547000	Maken G. Cornell, Heir of Fred Tschappat and Linda Tschappat, deceased	Y	0.011	0.002	0.0004%	24-003012.2000	Sunsbury	Monroe	0.0004%	0.0004%	0.000%	0.000%	0.000%	1465 Hawthorne Parkway	Grove City	OH	43123	
39	L028135000	Floyd Owen Cornell, Heir of Fred Tschappat and Linda Tschappat, deceased	Y	0.011	0.002	0.0004%	24-003012.2000	Sunsbury	Monroe	0.0004%	0.0004%	0.000%	0.000%	0.000%	160 Jefferson Street	Brantree	MA	2184	

**EXHIBIT "A"**  
**All Mineral Owners in the proposed Westhawk I Unit**

Tract Number	Lease ID Number	Mineral Owner	Leased Yes or No	Decimal Interest in Tract	Surface Acres in Unit	Tract Participation in Unit	Tax Map Parcel ID	Township	County	Consenting Working Interest Percentage	Gulfport Appalachia, LLC Working Interest	Rice Drilling D, LLC Working Interest	SWN Energy Company Working Interest	Antero Resources Corp Working Interest	Address	City	State	Zip	Supplement 11.2.2023
39	Unleased Mineral Interest	Marilyn Frances Roy, Heir of Fred Tschappat and Linda Tschappat, deceased	N	0.007	0.002	0.0003%	24-003012.2000	Sunbury	Monroe	0.000%	0.000%	0.000%	0.000%	0.000%	52322 Lakeview Drive, Apt 2	Dillonvale	OH	43917	
39	Unleased Mineral Interest	William E. Slater, Heir of Fred Tschappat and Linda Tschappat, deceased	N	0.007	0.002	0.0003%	24-003012.2000	Sunbury	Monroe	0.000%	0.000%	0.000%	0.000%	0.000%	2860 Poplar Street NW	Massillon	OH	44647	
39	Unleased Mineral Interest	Heirs of William A. Bess, deceased, Heir of Fred Tschappat and Linda Tschappat, deceased	N	0.004	0.001	0.0001%	24-003012.2000	Sunbury	Monroe	0.000%	0.000%	0.000%	0.000%	0.000%	1049 Springmill Street, Apt 5	Mansfield	OH	44906	
39	L027988000	Bruce Alan Lewis, Heir of Fred Tschappat and Linda Tschappat, deceased	Y	0.001	0.0002	0.00003%	24-003012.2000	Sunbury	Monroe	0.00003%	0.00003%	0.000%	0.000%	0.000%	13574 Winewood Road	Victorville	CA	92392	
39	L027552000	Tammy Sue Hughes, Heir of Fred Tschappat and Linda Tschappat, deceased	Y	0.001	0.0002	0.00003%	24-003012.2000	Sunbury	Monroe	0.00003%	0.00003%	0.000%	0.000%	0.000%	720 Mayhill Ridge Road	League City	TX	77573	
39	L027654000	Herbert Anthony Lewis, Heir of Fred Tschappat and Linda Tschappat, deceased	Y	0.001	0.0002	0.00003%	24-003012.2000	Sunbury	Monroe	0.00003%	0.00003%	0.000%	0.000%	0.000%	52 Pelican Drive	Ellenton	FL	34222	
39	L027456000	Gerald Lee Lewis, Heir of Fred Tschappat and Linda Tschappat, deceased	Y	0.001	0.0002	0.00003%	24-003012.2000	Sunbury	Monroe	0.00003%	0.00003%	0.000%	0.000%	0.000%	15251 Crampton Road	Camden	MI	49232	
39	L026888000	Barbara Ann Harris, Heir of Fred Tschappat and Linda Tschappat, deceased	Y	0.011	0.002	0.0004%	24-003012.2000	Sunbury	Monroe	0.0004%	0.0004%	0.000%	0.000%	0.000%	1017 Rome Beauty Drive	Amherst	OH	44001	
39	L027952000	Harry Robert Zimmerman, Heir of Fred Tschappat and Linda Tschappat, deceased	Y	0.011	0.002	0.0004%	24-003012.2000	Sunbury	Monroe	0.0004%	0.0004%	0.000%	0.000%	0.000%	6123 Osweeey Lane	Dublin	OH	43016	
39	L027443000	Sandra Lee Margritz, Heir of Fred Tschappat and Linda Tschappat, deceased	Y	0.022	0.005	0.001%	24-003012.2000	Sunbury	Monroe	0.001%	0.001%	0.000%	0.000%	0.000%	18956 Mount Cimarron Street	Fountain Valley	CA	92708	
39	Unleased Mineral Interest	Heirs of George R. Bierkorte, deceased, Heir of Fred Tschappat and Linda Tschappat, deceased	N	0.022	0.005	0.001%	24-003012.2000	Sunbury	Monroe	0.000%	0.000%	0.000%	0.000%	0.000%	Undetermined	Undetermined	Undetermined	Undetermined	
39	L027529000	Emma C. Nero, Heir of Fred Tschappat and Linda Tschappat, deceased	Y	0.022	0.005	0.001%	24-003012.2000	Sunbury	Monroe	0.001%	0.001%	0.000%	0.000%	0.000%	23317 Sonnet Drive	Moreno Valley	CA	92557	
39	Unleased Mineral Interest	Albert W. Lotze, III, Heir of Fred Tschappat and Linda Tschappat, deceased	N	0.057	0.012	0.002%	24-003012.2000	Sunbury	Monroe	0.000%	0.000%	0.000%	0.000%	0.000%	548 Spruce Street	Aptos	CA	95003	
39	L027615000	Patrick H. Thomas, Heir of Fred Tschappat and Linda Tschappat, deceased	Y	0.039	0.008	0.001%	24-003012.2000	Sunbury	Monroe	0.001%	0.001%	0.000%	0.000%	0.000%	9884 Chambray Drive	Indianapolis	IN	46280	
39	L027710000	Frederick Charles Lotze, Heir of Fred Tschappat and Linda Tschappat, deceased	Y	0.039	0.008	0.001%	24-003012.2000	Sunbury	Monroe	0.001%	0.001%	0.000%	0.000%	0.000%	1314 Puterbaugh Street	San Diego	CA	92103	
39	Unleased Mineral Interest	Mark David Meaney, Heir of Fred Tschappat and Linda Tschappat, deceased	N	0.004	0.001	0.0002%	24-003012.2000	Sunbury	Monroe	0.000%	0.000%	0.000%	0.000%	0.000%	956 10th Avenue E, Apt 1	Seattle	WA	98102	
39	Unleased Mineral Interest	Heirs of Duncan Roy Talbot, deceased, Heir of Fred Tschappat and Linda Tschappat, deceased	N	0.004	0.001	0.0002%	24-003012.2000	Sunbury	Monroe	0.000%	0.000%	0.000%	0.000%	0.000%	266 Terrace Avenue	Riverside	RI	02915	
39	Unleased Mineral Interest	Stevan Keyser, Heir of Fred Tschappat and Linda Tschappat, deceased	N	0.004	0.001	0.0002%	24-003012.2000	Sunbury	Monroe	0.000%	0.000%	0.000%	0.000%	0.000%	481 Twin View Boulevard, Lot 11	Redding	CA	96003	
39	Unleased Mineral Interest	Martha Lou Pontius, Heir of Fred Tschappat and Linda Tschappat, deceased	N	0.013	0.003	0.0005%	24-003012.2000	Sunbury	Monroe	0.000%	0.000%	0.000%	0.000%	0.000%	525 N Gilbert Street, Spc 14	Anaheim	CA	92801	
39	Unleased Mineral Interest	Gina M. Rudy, Heir of Fred Tschappat and Linda Tschappat, deceased	N	0.001	0.0002	0.00003%	24-003012.2000	Sunbury	Monroe	0.000%	0.000%	0.000%	0.000%	0.000%	11450 E Rafael Avenue	Mesa	AZ	85212	
39	Unleased Mineral Interest	Rebecca A. Shuter, Heir of Fred Tschappat and Linda Tschappat, deceased	N	0.001	0.0002	0.00003%	24-003012.2000	Sunbury	Monroe	0.000%	0.000%	0.000%	0.000%	0.000%	6453 E Ingram Street, Apt A	Mesa	AZ	85205	
39	Unleased Mineral Interest	Nancy K. Schneider, Heir of Fred Tschappat and Linda Tschappat, deceased	N	0.001	0.0002	0.00003%	24-003012.2000	Sunbury	Monroe	0.000%	0.000%	0.000%	0.000%	0.000%	4274 Lawnview Drive	Columbus	OH	43214	
39	Unleased Mineral Interest	Randy D. Carter, Heir of Fred Tschappat and Linda Tschappat, deceased	N	0.0001	0.00002	0.000003%	24-003012.2000	Sunbury	Monroe	0.000%	0.000%	0.000%	0.000%	0.000%	353 Spring Avenue	Panama City	FL	32401	
39	Unleased Mineral Interest	Mark A. Carter, Heir of Fred Tschappat and Linda Tschappat, deceased	N	0.0001	0.00002	0.000003%	24-003012.2000	Sunbury	Monroe	0.000%	0.000%	0.000%	0.000%	0.000%	13102 Pinewood Road	Andalusia	AL	36421	
39	Unleased Mineral Interest	Jackie M. Clark, Heir of Fred Tschappat and Linda Tschappat, deceased	N	0.0001	0.00002	0.000003%	24-003012.2000	Sunbury	Monroe	0.000%	0.000%	0.000%	0.000%	0.000%	355 E Garretts Creek Road	Westmoreland	TN	37186	
39	Unleased Mineral Interest	Cortez Scott Williams, Heir of Fred Tschappat and Linda Tschappat, deceased	N	0.0001	0.00002	0.000003%	24-003012.2000	Sunbury	Monroe	0.000%	0.000%	0.000%	0.000%	0.000%	256 George Akins Road	Westmoreland	TN	37186	
39	Unleased Mineral Interest	Marcia J. Williams, Heir of Fred Tschappat and Linda Tschappat, deceased	N	0.0004	0.0001	0.00001%	24-003012.2000	Sunbury	Monroe	0.000%	0.000%	0.000%	0.000%	0.000%	1659 Mount Pleasant Road	Russell Springs	KY	42642	
39	Unleased Mineral Interest	Julie Michelle DiMenna, Heir of Fred Tschappat and Linda Tschappat, deceased	N	0.0002	0.00004	0.00001%	24-003012.2000	Sunbury	Monroe	0.000%	0.000%	0.000%	0.000%	0.000%	4308 Oxford Reily Road	Oxford	OH	45056	
39	Unleased Mineral Interest	Michael David Gaskins, Heir of Fred Tschappat and Linda Tschappat, deceased	N	0.0002	0.00004	0.00001%	24-003012.2000	Sunbury	Monroe	0.000%	0.000%	0.000%	0.000%	0.000%	4540 SE Mason Hill Drive	Portland	OR	97222	

**EXHIBIT "A"**  
**All Mineral Owners in the proposed Westhawk I Unit**

Tract Number	Lease ID Number	Mineral Owner	Leased Yes or No	Decimal Interest in Tract	Surface Acres in Unit	Tract Participation in Unit	Tax Map Parcel ID	Township	County	Consenting Working Interest Percentage	Gulfport Appalachia, LLC Working Interest	Rice Drilling D, LLC Working Interest	SWN Energy Company Working Interest	Antero Resources Corp Working Interest	Address	City	State	Zip	Supplement 11.2.2023
39	Unleased Mineral Interest	John Edward Garen, Heir of Fred Tschappat and Linda Tschappat, deceased	N	0.002	0.0004	0.0001%	24-003012.2000	Sunsbury	Monroe	0.000%	0.000%	0.000%	0.000%	0.000%	816 Springwater Circle	Lexington	KY	40515	
39	Unleased Mineral Interest	David Garen, Heir of Fred Tschappat and Linda Tschappat, deceased	N	0.002	0.0004	0.0001%	24-003012.2000	Sunsbury	Monroe	0.000%	0.000%	0.000%	0.000%	0.000%	1415 SE Flavel Street	Portland	OR	97202	
39	Unleased Mineral Interest	Susan D. Cole, Heir of Fred Tschappat and Linda Tschappat, deceased	N	0.001	0.0001	0.00002%	24-003012.2000	Sunsbury	Monroe	0.000%	0.000%	0.000%	0.000%	0.000%	810 Cody Road	Ennis	TX	75119	
39	Unleased Mineral Interest	Vicki Kay Metzler, Heir of Fred Tschappat and Linda Tschappat, deceased	N	0.001	0.0001	0.00002%	24-003012.2000	Sunsbury	Monroe	0.000%	0.000%	0.000%	0.000%	0.000%	815 Township Road 129 S	Zanesfield	OH	43360	
39	Unleased Mineral Interest	Samuel R. Ward, Heir of Fred Tschappat and Linda Tschappat, deceased	N	0.001	0.0003	0.00004%	24-003012.2000	Sunsbury	Monroe	0.000%	0.000%	0.000%	0.000%	0.000%	3443 Karl Road	Columbus	OH	43224	
39	Unleased Mineral Interest	Patty Jo Sharrock, Heir of Fred Tschappat and Linda Tschappat, deceased	N	0.001	0.0003	0.00004%	24-003012.2000	Sunsbury	Monroe	0.000%	0.000%	0.000%	0.000%	0.000%	11510 Orilla Del Rio Place	Temple Terrace	FL	33617	
39	Unleased Mineral Interest	Heirs of Dennis Mack Julien, deceased, Heir of Fred Tschappat and Linda Tschappat, deceased	N	0.003	0.001	0.0001%	24-003012.2000	Sunsbury	Monroe	0.000%	0.000%	0.000%	0.000%	0.000%	Undetermined	Undetermined	Undetermined	Undetermined	
39	Unleased Mineral Interest	Heirs of Robert L. Andrews, deceased, Heir of Fred Tschappat and Linda Tschappat, deceased	N	0.003	0.001	0.0001%	24-003012.2000	Sunsbury	Monroe	0.000%	0.000%	0.000%	0.000%	0.000%	Undetermined	Undetermined	Undetermined	Undetermined	
39	Unleased Mineral Interest	Paul F. Petru, II, Heir of Fred Tschappat and Linda Tschappat, deceased	N	0.001	0.0002	0.00003%	24-003012.2000	Sunsbury	Monroe	0.000%	0.000%	0.000%	0.000%	0.000%	5735 Turner Lane	Hilliard	OH	43026	
39	Unleased Mineral Interest	John Ward Petru, Heir of Fred Tschappat and Linda Tschappat, deceased	N	0.001	0.0002	0.00003%	24-003012.2000	Sunsbury	Monroe	0.000%	0.000%	0.000%	0.000%	0.000%	436 Trailview Lane	Cincinnati	OH	45244	
39	Unleased Mineral Interest	Frank J. Petru, Heir of Fred Tschappat and Linda Tschappat, deceased	N	0.001	0.0002	0.00003%	24-003012.2000	Sunsbury	Monroe	0.000%	0.000%	0.000%	0.000%	0.000%	127 Haley Farm Drive	Canton	GA	30115	
39	Unleased Mineral Interest	Kevin Petru, Heir of Fred Tschappat and Linda Tschappat, deceased	N	0.001	0.0002	0.00003%	24-003012.2000	Sunsbury	Monroe	0.000%	0.000%	0.000%	0.000%	0.000%	130 Woodland Terrace	Aurora	OH	44202	
39	Unleased Mineral Interest	Jeffrey L. Julian, Heir of Fred Tschappat and Linda Tschappat, deceased	N	0.0002	0.00003	0.00001%	24-003012.2000	Sunsbury	Monroe	0.000%	0.000%	0.000%	0.000%	0.000%	20684 Ringgold Southern Road	Circleville	OH	43113	
39	Unleased Mineral Interest	Jonathan M. Julien, Heir of Fred Tschappat and Linda Tschappat, deceased	N	0.0002	0.00003	0.00001%	24-003012.2000	Sunsbury	Monroe	0.000%	0.000%	0.000%	0.000%	0.000%	3257 W 23rd Avenue	Denver	CO	80211	
39	Unleased Mineral Interest	Jennifer Julien Mathias, Heir of Fred Tschappat and Linda Tschappat, deceased	N	0.0002	0.00003	0.00001%	24-003012.2000	Sunsbury	Monroe	0.000%	0.000%	0.000%	0.000%	0.000%	7707 Winding Way	Tipp City	OH	45371	
39	Unleased Mineral Interest	Beth E. Andrews, Heir of Fred Tschappat and Linda Tschappat, deceased	N	0.0002	0.00003	0.00001%	24-003012.2000	Sunsbury	Monroe	0.000%	0.000%	0.000%	0.000%	0.000%	334 Styers Road	Winston Salem	NC	27105	
39	Unleased Mineral Interest	Cynthia Andrews Wood, Heir of Fred Tschappat and Linda Tschappat, deceased	N	0.0002	0.00003	0.00001%	24-003012.2000	Sunsbury	Monroe	0.000%	0.000%	0.000%	0.000%	0.000%	17822 182nd Street	Tonganoxie	KS	66086	
39	Unleased Mineral Interest	Phillip C. Andrews, Heir of Fred Tschappat and Linda Tschappat, deceased	N	0.0002	0.00003	0.00001%	24-003012.2000	Sunsbury	Monroe	0.000%	0.000%	0.000%	0.000%	0.000%	204 W 114th Street	Kansas City	MO	64114	
39	Unleased Mineral Interest	Heirs of Ruth E. Tabor, deceased, Heir of Fred Tschappat and Linda Tschappat, deceased	N	0.004	0.001	0.0001%	24-003012.2000	Sunsbury	Monroe	0.000%	0.000%	0.000%	0.000%	0.000%	Undetermined	Undetermined	Undetermined	Undetermined	
39	Unleased Mineral Interest	VFW National Home, Devisee of Fred Tschappat and Linda Tschappat, deceased Attn: Richard Stiver, Facilities Director	N	0.004	0.001	0.0001%	24-003012.2000	Sunsbury	Monroe	0.000%	0.000%	0.000%	0.000%	0.000%	3573 Waverly Road	Eaton Rapids	MI	48827	
39	L027423000	Donald Lee Ayres, Heir of Fred Tschappat and Linda Tschappat, deceased	Y	0.001	0.0001	0.00002%	24-003012.2000	Sunsbury	Monroe	0.00002%	0.00002%	0.000%	0.000%	0.000%	761 Cedar Mill Drive	Belleville	IL	62221	
39	Unleased Mineral Interest	Darrell Allan Ayres, Heir of Fred Tschappat and Linda Tschappat, deceased	N	0.001	0.0001	0.00002%	24-003012.2000	Sunsbury	Monroe	0.000%	0.000%	0.000%	0.000%	0.000%	102 Whittlesey Drive	Tallmadge	OH	44278	
39	L027688000	Drexie L. Frech, Heir of Fred Tschappat and Linda Tschappat, deceased	Y	0.001	0.0001	0.00002%	24-003012.2000	Sunsbury	Monroe	0.00002%	0.00002%	0.000%	0.000%	0.000%	25843 83rd Road	Branford	FL	32008	
39	L027435000	Lori A. Colbert, Heir of Fred Tschappat and Linda Tschappat, deceased	Y	0.001	0.0001	0.00002%	24-003012.2000	Sunsbury	Monroe	0.00002%	0.00002%	0.000%	0.000%	0.000%	4179 Ledgewater	Mogadore	OH	44260	
39	L027581000	Judith L. Pearcy, Heir of Fred Tschappat and Linda Tschappat, deceased	Y	0.001	0.0001	0.00002%	24-003012.2000	Sunsbury	Monroe	0.00002%	0.00002%	0.000%	0.000%	0.000%	10093 Chardonnay Drive	Orlando	FL	32832	
39	L027202000	Nancy L. Muckleroy, Heir of Fred Tschappat and Linda Tschappat, deceased	Y	0.003	0.001	0.0001%	24-003012.2000	Sunsbury	Monroe	0.0001%	0.0001%	0.000%	0.000%	0.000%	575 Deborah Drive	New Franklin	OH	44319	
39	L027785000	Thomas Chalmers Hutchison, Heir of Fred Tschappat and Linda Tschappat, deceased	Y	0.005	0.001	0.0002%	24-003012.2000	Sunsbury	Monroe	0.0002%	0.0002%	0.000%	0.000%	0.000%	727 Frase Avenue	Akron	OH	44305	
39	Unleased Mineral Interest	Heirs of Kathryn Sue Swan, deceased, Heir of Fred Tschappat and Linda Tschappat, deceased	N	0.003	0.001	0.0001%	24-003012.2000	Sunsbury	Monroe	0.000%	0.000%	0.000%	0.000%	0.000%	Undetermined	Undetermined	Undetermined	Undetermined	

**EXHIBIT "A"**  
**All Mineral Owners in the proposed Westhawk I Unit**

Tract Number	Lease ID Number	Mineral Owner	Leased Yes or No	Decimal Interest in Tract	Surface Acres in Unit	Tract Participation in Unit	Tax Map Parcel ID	Township	County	Consenting Working Interest Percentage	Gulfport Appalachia, LLC Working Interest	Rice Drilling D, LLC Working Interest	SWN Energy Company Working Interest	Antero Resources Corp Working Interest	Address	City	State	Zip	Supplement 11.2.2023
39	Unleased Mineral Interest	Highland United Presbyterian Church of Largo, Devisee of Fred Tschappat and Linda Tschappat, deceased Attn: Ginny Ellis	N	0.004	0.001	0.0001%	24-003012.2000	Sunbury	Monroe	0.000%	0.000%	0.000%	0.000%	0.000%	11 Church Road	Newport	PA	17074	
39	Unleased Mineral Interest	J. Michael Spriggs, as Successor Trustee under the John S. Spriggs Trust dated August 28, 1996, Heir of Fred Tschappat and Linda Tschappat, deceased	N	0.006	0.001	0.0002%	24-003012.2000	Sunbury	Monroe	0.000%	0.000%	0.000%	0.000%	0.000%	191 University Boulevard, Suite 719	Denver	CO	80206	
39	L027591000	Pauline A. Spriggs, Heir of Fred Tschappat and Linda Tschappat, deceased	Y	0.002	0.0004	0.0001%	24-003012.2000	Sunbury	Monroe	0.0001%	0.0001%	0.000%	0.000%	0.000%	141 University Drive, Apt 101	Chillicothe	OH	45601	
39	Unleased Mineral Interest	Craig A. Spriggs, Heir of Fred Tschappat and Linda Tschappat, deceased	N	0.002	0.0004	0.0001%	24-003012.2000	Sunbury	Monroe	0.000%	0.000%	0.000%	0.000%	0.000%	324 S Xenia Drive	Enon	OH	45323	
39	Unleased Mineral Interest	James D. Spriggs, Heir of Fred Tschappat and Linda Tschappat, deceased	N	0.002	0.0004	0.0001%	24-003012.2000	Sunbury	Monroe	0.000%	0.000%	0.000%	0.000%	0.000%	11753 State Route 38 NE 38	Bloomingsburg	OH	43106	
39	L029005000	Alice L. Regan, as Trustee of the Sara Hiler Family Trust dated January 29, 2008, and amended and restated October 3, 2014	Y	0.006	0.001	0.0002%	24-003012.2000	Sunbury	Monroe	0.0002%	0.0002%	0.000%	0.000%	0.000%	676 E 5600 S	Murray	UT	84107	
39	Unleased Mineral Interest	Heirs of James P. Spriggs, deceased, Heir of Fred Tschappat and Linda Tschappat, deceased	N	0.006	0.001	0.0002%	24-003012.2000	Sunbury	Monroe	0.000%	0.000%	0.000%	0.000%	0.000%	Undetermined	Undetermined	Undetermined	Undetermined	
39	Unleased Mineral Interest	Barbara Ann Hobart, Heir of Fred Tschappat and Linda Tschappat, deceased	N	0.006	0.001	0.0002%	24-003012.2000	Sunbury	Monroe	0.000%	0.000%	0.000%	0.000%	0.000%	4624 Andover Avenue	Lorain	OH	44055	
39	Unleased Mineral Interest	James W. Cline, Heir of Fred Tschappat and Linda Tschappat, deceased	N	0.015	0.003	0.001%	24-003012.2000	Sunbury	Monroe	0.000%	0.000%	0.000%	0.000%	0.000%	206 N Main Street	Woodfield	OH	43793	
39	Unleased Mineral Interest	Jeffery Ross Porter, Heir of Fred Tschappat and Linda Tschappat, deceased	N	0.005	0.001	0.0002%	24-003012.2000	Sunbury	Monroe	0.000%	0.000%	0.000%	0.000%	0.000%	173 Buena Vista Avenue E	San Francisco	CA	94117	
39	Unleased Mineral Interest	Christopher J. Porter, Heir of Fred Tschappat and Linda Tschappat, deceased	N	0.005	0.001	0.0002%	24-003012.2000	Sunbury	Monroe	0.000%	0.000%	0.000%	0.000%	0.000%	6224 Pinefield Drive	Columbus	OH	43026	
39	Unleased Mineral Interest	Jon Eugene Porter, Sr., Heir of Fred Tschappat and Linda Tschappat, deceased	N	0.005	0.001	0.0002%	24-003012.2000	Sunbury	Monroe	0.000%	0.000%	0.000%	0.000%	0.000%	18 Soden Drive	Yardville	NJ	08620	
39	GPOR	Barbara Sutter Tschappat, Heir of Fred Tschappat and Linda Tschappat, deceased	Y	0.024	0.005	0.001%	24-003012.2000	Sunbury	Monroe	0.001%	0.001%	0.000%	0.000%	0.000%	4602 Tall Pines Drive NW	Atlanta	GA	30327	
39	Unleased Mineral Interest	Susan P. Johnston, Heir of Fred Tschappat and Linda Tschappat, deceased	N	0.004	0.001	0.0001%	24-003012.2000	Sunbury	Monroe	0.000%	0.000%	0.000%	0.000%	0.000%	154 Pickerington Ridge Drive	Pickerington	OH	43147	
39	Unleased Mineral Interest	Sandra L. Clark, Heir of Fred Tschappat and Linda Tschappat, deceased	N	0.004	0.001	0.0001%	24-003012.2000	Sunbury	Monroe	0.000%	0.000%	0.000%	0.000%	0.000%	6880 Regency Drive	Westerville	OH	43082	
39	Unleased Mineral Interest	David C. Porter, Heir of Fred Tschappat and Linda Tschappat, deceased	N	0.004	0.001	0.0001%	24-003012.2000	Sunbury	Monroe	0.000%	0.000%	0.000%	0.000%	0.000%	814 Grandon Avenue	Columbus	OH	43209	
39	Unleased Mineral Interest	John Michael Durbin, Heir of Fred Tschappat and Linda Tschappat, deceased	N	0.011	0.002	0.0004%	24-003012.2000	Sunbury	Monroe	0.000%	0.000%	0.000%	0.000%	0.000%	2875 Apple Valley Drive	Howard	OH	43028	
39	Unleased Mineral Interest	Alex N. Durbin, Heir of Fred Tschappat and Linda Tschappat, deceased	N	0.011	0.002	0.0004%	24-003012.2000	Sunbury	Monroe	0.000%	0.000%	0.000%	0.000%	0.000%	10021 Springwater Drive	Mount Vernon	OH	43050	
39	Unleased Mineral Interest	Christopher Anthony, Heir of Fred Tschappat and Linda Tschappat, deceased	N	0.005	0.001	0.0002%	24-003012.2000	Sunbury	Monroe	0.000%	0.000%	0.000%	0.000%	0.000%	721 Royal Circle	Howard	OH	43028	
39	L026915000	Raymond Fred Peterson, Heir of Fred Tschappat and Linda Tschappat, deceased	Y	0.005	0.001	0.0002%	24-003012.2000	Sunbury	Monroe	0.0002%	0.0002%	0.000%	0.000%	0.000%	10327 Monroe Mills Road	Gambier	OH	43022	
39	L027115000	James Everett McMillan, Heir of Fred Tschappat and Linda Tschappat, deceased	Y	0.012	0.003	0.0004%	24-003012.2000	Sunbury	Monroe	0.0004%	0.0004%	0.000%	0.000%	0.000%	5485 Freedom Run	Orient	OH	43146	
39	L027114000	John Paul McMillan, Heir of Fred Tschappat and Linda Tschappat, deceased	Y	0.012	0.003	0.0004%	24-003012.2000	Sunbury	Monroe	0.0004%	0.0004%	0.000%	0.000%	0.000%	144 Grandmar Chase	Canton	GA	30115	
39	L028907000	Kathleen S. Smith, Heir of Fred Tschappat and Linda Tschappat, deceased	Y	0.008	0.002	0.0003%	24-003012.2000	Sunbury	Monroe	0.0003%	0.0003%	0.000%	0.000%	0.000%	924 Golden Yarrow Trail	Bernalillo	NM	87004	
39	L029017000	Mark Wareham, Heir of Fred Tschappat and Linda Tschappat, deceased	Y	0.008	0.002	0.0003%	24-003012.2000	Sunbury	Monroe	0.0003%	0.0003%	0.000%	0.000%	0.000%	5740 Peppertree Place NE	Albuquerque	NM	87111	
39	L029025000	Laura Crosse, Heir of Fred Tschappat and Linda Tschappat, deceased	Y	0.008	0.002	0.0003%	24-003012.2000	Sunbury	Monroe	0.0003%	0.0003%	0.000%	0.000%	0.000%	9658 E Pine Valley Road	Scottsdale	AZ	85260	
39	L029028000	James A. Swetlic, Heir of Fred Tschappat and Linda Tschappat, deceased	Y	0.028	0.006	0.001%	24-003012.2000	Sunbury	Monroe	0.001%	0.001%	0.000%	0.000%	0.000%	10640 Summer Lane	Mount Vernon	OH	43050	
40	L014012000	Campbell OMG, LLC Attn: Ray E. Campbell, Member	Y	1.000	5.650	0.912%	24-012004.0000	Sunbury	Monroe	0.912%	0.912%	0.000%	0.000%	0.000%	42384 Paine Road	Beallsville	OH	43716	
41	L014012000	Campbell OMG, LLC Attn: Ray E. Campbell, Member	Y	1.000	0.309	0.050%	24-012036.0000	Sunbury	Monroe	0.050%	0.050%	0.000%	0.000%	0.000%	42384 Paine Road	Beallsville	OH	43716	



**EXHIBIT "A"**  
**All Mineral Owners in the proposed Westhawk I Unit**

Tract Number	Lease ID Number	Mineral Owner	Leased Yes or No	Decimal Interest in Tract	Surface Acres in Unit	Tract Participation in Unit	Tax Map Parcel ID	Township	County	Consenting Working Interest Percentage	Gulfport Appalachia, LLC Working Interest	Rice Drilling D, LLC Working Interest	SWN Energy Company Working Interest	Antero Resources Corp Working Interest	Address	City	State	Zip	Supplement 11.2.2023
42	L034330000	Charles Monticello	Y	0.500	5.282	0.853%	24-012012.0000	Sunsbury	Monroe	0.853%	0.853%	0.000%	0.000%	0.000%	52032 Township Road 127	Beallsville	OH	43716	
42	L027444000	Haydn Guthrie Decker and Monique C. Decker, husband and wife	Y	0.063	0.660	0.107%	24-012012.0000	Sunsbury	Monroe	0.107%	0.107%	0.000%	0.000%	0.000%	3321 Wauwinet Way	Norman	OK	73071	
42	L027356000	Baron Brant Decker and Carol S. Decker, husband and wife	Y	0.063	0.660	0.107%	24-012012.0000	Sunsbury	Monroe	0.107%	0.107%	0.000%	0.000%	0.000%	690 Cypress Creek Drive	Mount Vernon	TX	75457	
42	L009344000	Cheryl Decker Worch and Ross L. Worch, wife and husband	Y	0.063	0.660	0.107%	24-012012.0000	Sunsbury	Monroe	0.107%	0.107%	0.000%	0.000%	0.000%	2229 South Brook Drive	Fleming Island	FL	32003	
42	L027685000	Bernice April Tilton and Andrew Scott Tilton, wife and husband	Y	0.063	0.660	0.107%	24-012012.0000	Sunsbury	Monroe	0.107%	0.107%	0.000%	0.000%	0.000%	8017 Flint Road	Columbus	OH	43235	
42	F000553000 F000554000 F000555000 F000556000	Gulfport Appalachia, LLC	Y	0.250	2.641	0.426%	24-012012.0000	Sunsbury	Monroe	0.426%	0.426%	0.000%	0.000%	0.000%	713 Market Drive	Oklahoma City	OK	73114	
43	L034330000	Charles Monticello	Y	1.000	3.418	0.552%	24-012012.1000	Sunsbury	Monroe	0.552%	0.552%	0.000%	0.000%	0.000%	52032 Township Road 127	Beallsville	OH	43716	
44	L025387000	Donald Carlos Headley and Ruth A. Headley, husband and wife	Y	1.000	0.280	0.045%	24-012003.0000	Sunsbury	Monroe	0.045%	0.045%	0.000%	0.000%	0.000%	PO Box 45	Beallsville	OH	43716	
45	L034327000	Beallsville Cemetery Association, Inc. Attn: Thomas G. Coss, Jr., Agent	Y	1.000	10.008	1.616%	24-012011.0000	Sunsbury	Monroe	1.616%	1.616%	0.000%	0.000%	0.000%	54131 Belmont Ridge Road	Beallsville	OH	43716	
46	L034327000	Beallsville Cemetery Association, Inc. Attn: Thomas G. Coss, Jr., Agent	Y	1.000	6.144	0.992%	24-012025.0000	Sunsbury	Monroe	0.992%	0.992%	0.000%	0.000%	0.000%	54131 Belmont Ridge Road	Beallsville	OH	43716	
47	L034298000	The Board of Education for the Switzerland of Ohio Local School District Attn: Phil Ackerman, Superintendent	Y	1.000	0.311	0.050%	24-012026.0000	Sunsbury	Monroe	0.050%	0.050%	0.000%	0.000%	0.000%	304 Mill Street	Woodsfield	OH	43793	
48	GPOR	Connie J. Stephens and Jaime J. Swallie, joint tenants	Y	1.000	1.550	0.250%	24-012028.0000	Sunsbury	Monroe	0.250%	0.250%	0.000%	0.000%	0.000%	50748 SR 26 (Stephens) 51949 Township Road 127 (Swallie)	Jerusalem Beallsville	OH OH	43747 43716	
49	GPOR	William R. Shriver, a single man	Y	1.000	8.026	1.296%	24-012024.0000	Sunsbury	Monroe	1.296%	1.296%	0.000%	0.000%	0.000%	51955 Township Road 127	Beallsville	OH	43716	
50	GPOR	Samuel D. Shriver and Rebecca L. Shriver, husband and wife	Y	1.000	3.427	0.553%	24-012030.0000	Sunsbury	Monroe	0.553%	0.553%	0.000%	0.000%	0.000%	51553 Kings Highway	Beallsville	OH	43716	
51	GPOR	William R. Shriver, a single man	Y	1.000	1.529	0.247%	24-012033.0000	Sunsbury	Monroe	0.247%	0.247%	0.000%	0.000%	0.000%	51955 Township Road 127	Beallsville	OH	43716	
52	L019108000	William R. Shriver, a single man	Y	1.000	4.034	0.651%	24-012031.0000	Sunsbury	Monroe	0.651%	0.651%	0.000%	0.000%	0.000%	51955 Township Road 127	Beallsville	OH	43716	
53	GPOR	Samuel D. Shriver and Rebecca L. Shriver, husband and wife	Y	1.000	0.007	0.001%	24-012032.0000	Sunsbury	Monroe	0.001%	0.001%	0.000%	0.000%	0.000%	51553 Kings Highway	Beallsville	OH	43716	
54	GPOR	Paul D. Schaffer and Vickie J. Schaffer, husband and wife, joint tenants	Y	1.000	0.067	0.011%	24-012022.0000	Sunsbury	Monroe	0.011%	0.011%	0.000%	0.000%	0.000%	51820 Kings Highway	Beallsville	OH	43716	

**Total Unit Acres: 619.413 100.000%**

**78.921% 74.657% 3.906% 0.359% 2.875%**

**Total Leased Acres: 488.850**

\*\*NPRI Owner

END OF EXHIBIT "A"

Westhawk I Unit  
Chief's Order  
Exhibit B

**EXHIBIT "B"**  
GULFPORT APPALACHIA, LLC  
WESTHAWK I UNIT  
BELMONT & MONROE COUNTY, OHIO  
619.413 ACRES

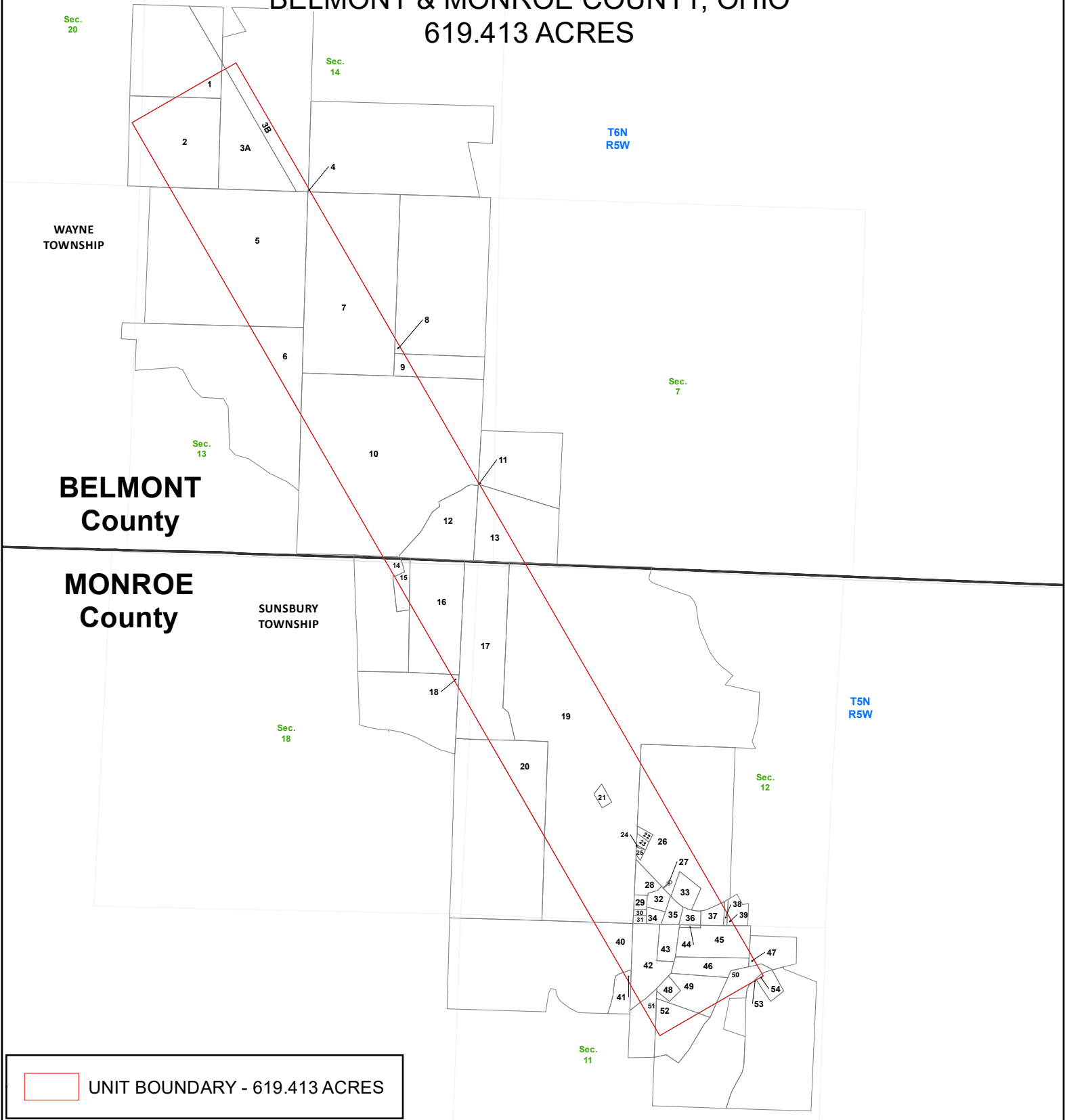

WESTHAWK I  
WAYNE TOWNSHIP, BELMONT COUNTY, OHIO  
AND  
SUNSBURY TOWNSHIP, MONROE COUNTY, OHIO

1 in = 1,900 ft

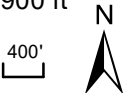

Last Updated: August 23, 2023  
Version 1

## Master Table of Tracts

MAP ID	PARCEL NUMBER	ACRES
1	46-00100.000	3.012
2	46-00076.000	30.114
3A	46-00123.000	24.089
3B	46-00123.000	8.569
4	46-00081.000	0.024
5	46-00223.000	64.179
6	46-00244.000	11.565
7	46-00082.000	50.091
8	46-00087.000	0.370
9	46-00107.000	1.851
10	46-00054.000	95.619
11	46-00053.000	0.008
12	46-00192.000	17.590
13	46-00191.000	9.951
14	24-002004.4000	1.258
15	24-002004.2000	1.733
16	24-002004.1000	22.343
17	24-003004.0000	36.606
18	24-002004.3000	0.239
19	24-003001.0000	129.887
20	24-003003.0000	13.898
21	24-003025.0000	1.030
22	24-003028.0000	0.585
23	24-003027.0000	0.553
24	24-003023.0000	0.054
25	24-003021.0000	0.347
26	24-003029.0000	21.621
27	24-003020.0000	0.095
28	24-032001.0000	2.644
29	24-032002.0000	0.910
30	24-032004.0000	0.395
31	24-032005.0000	0.533
32	24-032008.0000	1.985
33	24-003010.0000	3.223
34	24-032006.0000	1.209
35	24-032009.0000	1.894
36	24-003011.0000	1.502

MAP ID	PARCEL NUMBER	ACRES
37	24-003012.1000	2.049
38	24-003012.0000	0.245
39	24-003012.2000	0.219
40	24-012004.0000	5.650
41	24-012036.0000	0.309
42	24-012012.0000	10.564
43	24-012012.1000	3.418
44	24-012003.0000	0.280
45	24-012011.0000	10.008
46	24-012025.0000	6.144
47	24-012026.0000	0.311
48	24-012028.0000	1.550
49	24-012024.0000	8.026
50	24-012030.0000	3.427
51	24-012033.0000	1.529
52	24-012031.0000	4.034
53	24-012032.0000	0.007
54	24-012022.0000	0.067



WESTHAWK I  
 WAYNE TOWNSHIP, BELMONT COUNTY, OHIO  
 AND  
 SUNSBURY TOWNSHIP, MONROE COUNTY, OHIO