



Ohio Department of Natural Resources

MIKE DEWINE, GOVERNOR

MARY MERTZ, DIRECTOR

Eric Vendel, Chief

Division of Oil and Gas Resources Management
2045 Morse Rd, Building F
Columbus, Ohio 43229
Phone: (614) 265-6922; Fax: (614) 265-6910

9489009000276346813881

ORDER BY THE CHIEF

April 26, 2023

ORDER NO. 2023-91

TO: EAP Ohio, LLC
5847 San Felipe, Suite 400
Houston, TX 77057

RE: Application for Unitization
Edie North Unit
Carroll County, Ohio

SUBJECT: Amendment of Chief's Order No. 2016-42 for Unit Operations of the
Utica/Point Pleasant Formations

Pursuant to Ohio Revised Code ("R.C.") § 1509.28, the Chief of the Division of Oil and Gas Resources Management ("Chief" or "Division") makes the following Findings and issues the following Order with respect to EAP Ohio, LLC's ("EAP") Request for Amendment of Unit Operations for the Edie North Unit:

BACKGROUND:

- 1) On April 9, 2015, Chesapeake Exploration, LLC filed its Edie North application with the Division for unit operation of the Utica/Point Pleasant Formations in Carroll County, Ohio.
- 2) Pursuant to R.C. 1509.28, a hearing was held on August 20, 2015, to consider the need for operation as a unit of an entire pool or part thereof.
- 3) On February 29, 2016, Chief's Order No. 2016-42 was issued pursuant to R.C. 1509.28 approving unit operations for the Edie North Unit.
- 4) On May 14, 2019, Chesapeake transferred all its working interest in the Edie North Unit to EAP.

- 5) On January 4, 2023, EAP submitted to the Division a Request for Amendment of Chief's Order No. 2016-42 to drill three (3) wells within the unit instead of five (5) wells as is required by Order ("Request for Amendment").
- 6) Pursuant to R.C. 1509.28, the Division held a hearing on March 1, 2023, to consider the request to drill three (3) wells instead of five (5) wells as required by the Order.

FINDINGS:

- 1) Based on the Request for Amendment and the testimony at the March 1, 2023 hearing, the Chief finds that the Request for Amendment is reasonably necessary to increase substantially the ultimate recovery of oil and gas.
- 2) Based on the Request for Amendment and the testimony at the March 1, 2023 hearing, the Chief finds the value of the estimated additional recovery of oil or gas from the Edie North Unit exceeds the estimated additional cost incident to conducting the operation of the Edie North Unit.
- 3) Based on the application and testimony at the March 1, 2023 hearing, the Chief finds that the Request for Amendment of Chief's Order No. 2016-42 should be amended.

ORDERS:

Paragraphs 2 and 8 of the Plan for Unit Operations in Chief's Order No. 2016-42 are amended to read as follows:

- (2) EAP proposes to drill three (3) wells from a single pad site in the Edie North Unit for the purpose of recovering oil and gas. Drilling operations shall commence in the unit area within twelve (12) months from the date of approval of this Order. In order to achieve the stated goal of substantially increasing the ultimate recovery of oil and gas from the Utica/Point Pleasant Formations within the unit area, EAP shall produce from three (3) wells no later than five (5) years after the date of approval of this order. If EAP fails to drill, complete, and produce at least three (3) wells in the unit area, the Chief may amend or terminate this order. Any additional wells permitted by the Chief for the Utica/Point Pleasant Formations in the unit area are subject to this order.
- (8) Unit operations may commence as of 7:00 a.m. on the day following the date of approval of this order. Once the initial well is placed into production, operations within the Edie North Unit may continue as long as hydrocarbons are produced from any well in the Unit Area without a cessation of more than ninety (90) days, unless otherwise approved by the Chief in writing. The Edie North Unit may be terminated if working interest owners owning at least fifty-one percent (51%) of the working interest in the Unit Area determine that the unit operations are no

longer warranted. If the unit operations are so terminated, EAP shall provide written notice of the termination to the Division and to all unleased mineral owners. In the event that termination of unit operations occurs prior to drilling and completing for production of three (3) wells in the Edie North Unit, the Chief may amend this order.

April 26, 2023

Date

/s/ *Eric Vendel*

Eric Vendel, Chief

Division of Oil and Gas Resources Management

Addressee is hereby notified that this action is final and effective and may be appealed pursuant to Section 1509.36 of the Ohio Revised Code. If the Order is appealed to the Ohio Oil and Gas Commission, the appeal must be in writing and must set forth the Orders complained of and the grounds upon which the appeal is based. Such appeal must be filed with the Oil and Gas Commission, 2045 Morse Road, Building E-1, Office 103, Columbus, Ohio 43229-6693, within 30 days after the date upon which the person to whom the Order was issued received the order and, for all other persons adversely affected by the order, within 30 days after the date of the Order.

In addition, within three days after the appeal is filed with the Oil and Gas Commission, notice of the filing must be submitted to Eric Vendel, Chief, Division of Oil and Gas Resources Management, Ohio Department of Natural Resources, 2045 Morse Road, Building F, Columbus, Ohio 43229-6693.

Enclosure: Chief's Order No. 2016-42



Ohio Department of Natural Resources

JOHN R. KASICH, GOVERNOR

JAMES ZEHRINGER, DIRECTOR

Richard J. Simmers, Chief

Division of Oil and Gas Resources Management

2045 Morse Road – Bldg. F-2

Columbus, OH 43229-6693

Phone: (614) 265-6922 Fax: (614) 265-6910

ORDER BY THE CHIEF

February 29, 2016

ORDER NO. 2016-42

TO: Chesapeake Exploration, L.L.C.
6100 N. Western Avenue
P.O Box 18496
Oklahoma City, Oklahoma 73154-0496

RE: Application for Unitization
Edie North Unit
Carroll County, Ohio

SUBJECT: Order for Unit Operations of the Utica/Point Pleasant Formations

Pursuant to Ohio Revised Code § 1509.28, the Chief of the Division of Oil and Gas Resources Management (“Chief” or “Division”) makes the following Findings and issues the following Order with respect to Chesapeake Exploration, L.L.C.’s (“Chesapeake”) Application for Unitization of the Edie North Unit:

DEFINITIONS:

As used in this order:

- 1) “Person” has the same meaning as in §1509.01 of the Ohio Revised Code.
- 2) “Application” means the Application of Edie North Unit for Unit Operation filed with the Division on April 9, 2015, and includes all updates, amendments, and supplements to it.
- 3) “Royalty interest owner” means a person, or the estate of a person, who owns the right to, or interest in, any portion of the oil and/or gas, or proceeds from the sale thereof, from a tract, other than a working interest owner.

- 4) "Working interest" means an interest in oil and/or gas in the Unit Area by virtue of a lease, operating agreement, fee title, or otherwise, including a carried interest, the owner of which is obligated to pay, either in cash or out of production or otherwise a portion of the unit expense.
- 5) "Working interest owner" means a person, or the estate of a person, who owns an interest in oil and/or gas in the Unit Area by virtue of a lease, operating agreement, fee title, or otherwise, including a carried interest, the owner of which is obligated to pay, either in cash or out of production or otherwise a portion of the unit expense. "Working interest owner" does not include an unleased mineral owner.
- 6) "Unleased mineral owner" means a royalty interest owner who owns oil and gas rights free of a lease or other instrument conveying all or any portion of the working interest in such rights to another. Each person, who at the time of this Order is an "unleased mineral owner" subject to this Order, is listed in Exhibit C.
- 7) "Consenting working interest owner" means any working interest owner who enters, into an agreement with Chesapeake pertaining to the operation of the Edie North Unit. Those persons, who at the time of this Order are "consenting working interest owners", are Enervest Operating, L.L.C.
- 8) "Non-consenting working interest owner" means a working interest owner who does not enter into an agreement with Chesapeake pertaining to the operation of the Edie North Unit.
- 9) "Gas" has the same meaning as in §1509.01 of the Ohio Revised Code.
- 10) "Oil" has the same meaning as in § 1509.01 of the Ohio Revised Code.
- 11) "Unit Participation" means the ratio of the surface acreage of a specific tract in the Unit Area to the total surface acreage of the Unit Area as that total surface acreage is specified in paragraph one of the Plan for Unit Operations of this Order.

BACKGROUND:

- 1) On April 9, 2015, Chesapeake filed an Application pursuant to Revised Code 1509.28 to operate as a unit the Utica/Point Pleasant Formations at an approximate true vertical depth located from fifty (50) feet above the top of the Utica Shale to fifty (50) feet below the base of the Point Pleasant Formation. Revised Applications were received on June 30, 2015, August 7, 2015, and September 14, 2015. The proposed "Unit Area" is 773.837417 acres in Perry and Orange Townships, Carroll County, Ohio as shown in "Exhibit A" attached hereto. The proposed Unit Area is comprised of a total of two hundred five (205) tracts, and is known as the "Edie North Unit." The Application includes a Plan for Unit Operations, Model Form Operating Agreement and relevant exhibits. The Application also includes the pre-

filed testimony of the following Chesapeake employees: Larry Carter, Geologist; Andrew W. Hopson, Reservoir Engineer; and Hannah McKenzie, Landman I.

- 2) Pursuant to R.C. 1509.28, the Division held a hearing on August 20, 2015, in Columbus, Ohio at the Ohio Department of Natural Resources ("ODNR"), to consider the need for the operation as a unit of an entire pool or part thereof. At the hearing, Chesapeake employees Mr. Carter, and Ms. McKenzie confirmed their pre-filed testimony and answered questions posed by Division staff members. Mr. Hopson was not able to attend the hearing, so Mr. David Yard, a reservoir engineer, appeared at the hearing, confirmed Mr. Hopson's pre-filed testimony, and answered questions posed by Division staff members.
- 3) Chesapeake's Application, proposes to include three tracts owned by unleased mineral owners.
- 4) The Division provided notice of the August 20, 2015 hearing, return receipt requested, to the unleased mineral owners. Address and title work were provided by Chesapeake.

FINDINGS:

- 1) Based on the Application and testimony by Chesapeake's employees, the Chief finds that Chesapeake has established that they are the "owner," as that term is defined in R.C. 1509.01(K), of greater than sixty-five percent (65%) of the land area overlying the pool in the Edie North Unit as required by R.C. 1509.28(A).
- 2) Based on the Application and testimony by Chesapeake's employees, the Chief finds that the operation of the Edie North Unit is reasonably necessary to increase substantially the ultimate recovery of oil and gas.
- 3) Based on the Application and testimony by Chesapeake's employees, the Chief finds the value of the estimated additional recovery of oil or gas from the Edie North Unit exceeds the estimated additional cost incident to conducting the operation of the Edie North Unit.

ORDER:

IT IS HEREBY ORDERED:

Pursuant to R.C. 1509.28, Chesapeake is authorized to conduct operations within the Edie North Unit in accordance with all of the following:

Plan for Unit Operations

- 1) The Unit Area is comprised of two hundred five (205) tracts totaling 773.837417 acres in Perry and Orange Townships, Carroll County, Ohio, as shown on Exhibit A.
- 2) Chesapeake proposes to drill five (5) wells from a single pad site in the Edie North Unit for the purpose of recovering oil and gas. Drilling operations shall commence in the Unit Area within twelve (12) months from the date of approval of this Order. In order to achieve the stated goal of substantially increasing the ultimate recovery of oil and gas from the Utica/Point Pleasant Formations within the Unit Area, Chesapeake shall produce from five (5) wells no later than five (5) years after the date of approval of this order. If Chesapeake fails to drill, complete, and produce at least five (5) wells in the Unit Area, the Chief may amend or terminate this Order. Any additional wells permitted by the Chief for the Utica/Point Pleasant Formations in the Unit Area are subject to this Order.
- 3) Evidence introduced by Chesapeake at the Edie North Unit hearing established that the Utica/Point Pleasant Formation uniformly underlies the Unit Area. Therefore, the value of each separately owned tract in the Unit Area shall be determined by calculating the ratio of the surface acreage of a specific tract to the total surface acreage of the Unit Area. This ratio shall be known as the "Unit Participation." The allocated share of production to each tract shall be equal to that tract's Unit Participation.
- 4) Except as provided in Paragraph 9(d) of this Order, all charges and credits made for investments in wells, tanks, pumps, machinery, materials, and equipment shall be allocated among the working interest owners of each tract based on the Unit Participation. The proportionate share of the expenses attributable to tracts of the unleased mineral owners shall be allocated to Chesapeake and the working interest owners.
- 5) All unit operation expenses shall be charged to, and paid by, Chesapeake and working interest owners in amounts based on the Unit Participation plus their proportionate share of the expenses attributable to the tracts of unleased mineral owners. All unit operation expenses concerning wells and operating equipment shall be just and reasonable.
- 6) If necessary, Chesapeake and the consenting working interest owners shall carry, or otherwise finance, any non-consenting working interest owners who are unable to meet their financial obligations in connection with the unit operations. Chesapeake and all other consenting working interest owners' reasonable interest charge for carrying or financing the non-consenting working interest owners shall be determined by the terms of Chesapeake's Plan for Unit Operations and Model Form Operating Agreement for the Edie North Unit. Once a specific cost is

charged to the initial well, that same cost cannot be charged to subsequent wells in the Unit Area.

- 7) Chesapeake shall supervise and conduct all unit operations. Each working interest owner shall have a voting interest equal to its Unit Participation. Approval of unit operations shall be subject to the terms of Chesapeake's Plan for Unit Operations and Model Form Operating Agreement for the Edie North Unit.
- 8) Unit operations may commence as of 7:00 a.m. on the day following the effective date of this Order. Once the initial well is placed into production, operations within the Edie North Unit may continue as long as hydrocarbons are produced from any well in the Unit Area without a cessation of more than ninety (90) days, unless otherwise approved by the Chief in writing. The Edie North Unit may be terminated if working interest owners owning at least fifty-one percent (51%) of the working interest in the Unit Area determine that the unit operations are no longer warranted. If the unit operations are so terminated, Chesapeake shall provide written notice of the termination to the Division and to all unleased mineral owners. In the event that termination of unit operation occurs prior to drilling and completing for production of two (2) wells in the Edie North Unit, the Chief may amend this Order.
- 9) The following additional provisions are found to be appropriate:
 - a) No activity associated with the drilling, completion, or operation of the Edie North Unit shall be conducted on the surface of any unleased property without the prior written consent of the owner of the surface rights of the unleased property.
 - b) Unleased mineral owners shall not incur liability for any personal or property damage associated with any drilling, testing, completing, producing, operating, or plugging activities within the Edie North Unit.
 - c) Each unleased mineral owner shall receive a monthly cash payment equal to a one-eighth (1/8) landowner royalty interest calculated on gross proceeds. Allocation of the one-eighth (1/8) landowner royalty shall be based on the Unit Participation of each unleased mineral owner's tract. Chesapeake shall make royalty payments to all royalty interest owners at the same time.
 - d) In addition to the royalty payment, each unleased mineral owner shall receive a monthly cash payment equal to a seven-eighths (7/8) share of the net proceeds from production. Allocation of the seven-eighths (7/8) share shall be based on the Unit Participation of each unleased mineral owner's tract. After the working interest owners recover a reasonable interest charge equal to 200% of the cost of drilling, testing, completing, and producing the initial well, the working interest owners shall begin making

such monthly payments for that well. For each additional well drilled in the Unit Area, the working interest owners shall begin making monthly payments equal to seven-eighths (7/8) share of net proceeds from production to each unleased mineral owner once the working interest owners have recovered a reasonable interest charge equal to 150% of the cost of drilling, testing, completing, and producing. Once a specific cost is charged to the initial well, that same cost cannot be charged to subsequent wells in the Unit Area.

- e) Nothing in this Order prohibits an unleased mineral owner from entering into a lease agreement with Chesapeake pursuant to terms agreeable to both parties. An unleased mineral owner who enters into a lease with Chesapeake after the issuance of this Order is no longer an unleased mineral owner under this Order as of the effective date of the lease. Chesapeake shall notify the Division upon the execution of a lease agreement with any unleased mineral owner who is subject to this Order.
- f) Except as provided in Paragraph 9(d) of this Order, no expenses shall be paid by an unleased mineral owner for drilling, testing, completing, producing, or operating any well in the Unit Area. However, the unleased mineral owner is not responsible for any costs related to plugging any well in the Unit Area.
- g) If requested in writing by any unleased mineral owner or by any non-consenting working interest owner, or in any manner by the Division, Chesapeake shall provide, not later than thirty (30) days after the request, any of the following:
 - i. A monthly statement of all costs incurred, together with the quantity of oil and gas produced, and the amount of proceeds realized from the sale of production during the preceding month; and
 - ii. Any authorization for expenditure (AFE) prepared by Chesapeake; and
 - iii. A statement of all costs and expenses for purposes of Paragraphs 6 and 9(d) of this Order.
- h) Chesapeake shall notify the Division of the assignment or transfer of any of its working interest in the Edie North Unit. If Chesapeake assigns or transfers any of its working interest, the assignee or transferee shall comply with this Order.
- i) Chesapeake shall notify the Division if a tract that is leased by Chesapeake, or any other consenting working interest owner, for purposes of operating the Edie North Unit becomes an unleased tract. If Chesapeake or the consenting working interest owner is unable to enter into lease agreement for the unleased tract, Chesapeake must submit a request to the

Division for an amendment of this Order, which will include a new hearing before the Chief.

- j) Chesapeake shall notify the Division if any consenting working interest owner revokes, rescinds or otherwise terminates the agreement with Chesapeake pertaining to the operation of the Edie North Unit. Chesapeake shall notify the Division if any consenting working interest owner assigns or transfers all or part of its working interest in the Edie North Unit.
 - k) Chesapeake shall notify the Division if any non-consenting working interest owner enters into an agreement with Chesapeake pertaining to the operation of the Edie North Unit.
- 10) This Order is not effective unless and until Chesapeake provides the Chief with final written approval of the unit operations as prescribed in this Order by Chesapeake and consenting working interest owners, and also by the royalty or, with respect to unleased acreage, fee owners of sixty-five percent (65%) of the acreage to be included in the unit. Upon receipt of this approval, this Order shall become effective, and unit operations may commence as set forth above. In the event that Chesapeake fails to provide all required approvals within six (6) months after the issuance date of this Order, the Order will be deemed revoked, and the Chief shall provide notice of the revocation to Chesapeake, to the unleased mineral owners, and to the non-consenting working interest owners.
 - 11) In the event that this Chief's Order is appealed, the time periods as specified in this Order are tolled pending final determination of the appeal.
 - 12) Within twenty-one (21) days of this Order becoming effective, Chesapeake shall file a copy of this Order with the Carroll County (Ohio) Recorder's Office, in the records of each of tracts that are subject to this Order and referenced in Exhibit A of this Order. Chesapeake shall submit a certification of the filing to the Division within fourteen (14) days of filing. The certification shall include a reference to the volume and page number corresponding to each record where the Chief's Order is recorded.
 - 13) The Chief of the Division retains continuing jurisdiction over the Edie North Unit as is consistent with the Chief's powers and duties as established by R.C. Chapter 1509 and Ohio Admin. Code 1501:9. The Chief reserves the right to amend this Order subsequent to the commencement of unit operations within the Unit Area.
 - 14) Except as specifically set forth in the terms of this Order, nothing herein shall be construed as a release or waiver of any private right, obligation, duty, claim or cause of action.

- 15) In the event of a conflict between this Chief's Order and Chesapeake's Plan for Unit Operations and Model Form Operating Agreement attached to the Application, this Chief's Order shall take precedence.

Feb 29, 2016
Date

Richard J. Simmers
Richard J. Simmers, Chief
Division of Oil and Gas Resources Management

Addressee is hereby notified that this action is final and effective and may be appealed pursuant to Section 1509.36 of the Ohio Revised Code. If the Order is appealed to the Ohio Oil and Gas Commission, the appeal must be in writing and must set forth the Orders complained of and the grounds upon which the appeal is based. Such appeal must be filed with the Oil and Gas Commission, 2045 Morse Road, Building H-3, Columbus, Ohio 43229-6693, within thirty (30) days after receipt of this Order.

In addition, within three (3) days after the appeal is filed with the Oil and Gas Commission, notice of the filing must be submitted to Richard J. Simmers, Chief, Division of Oil and Gas Resources Management, Ohio Department of Natural Resources, 2045 Morse Road, Building F-2, Columbus, Ohio 43229-6693.

Enclosures: Exhibit A
Exhibit B
Exhibit C

CERTIFIED MAIL TO All listed on A-2 and:

R. Neal Pierce
Katerina E. Milenkovski
Steptoe & Johnson PLLC
Huntington Center
41 South High Street, Suite 2200
Columbus, OH 43215

91 7199 9991 7036 4782 1440

Hannah McKenzie
Landman I - Appalachia South
Chesapeake Energy Corporation
6100 N. Western Avenue
P.O. Box 18496
Oklahoma City, Oklahoma 73154-0496

91 7199 9991 7036 4782 1457

Chief's Order 2016-42

91 7199 9991 7036 4782 1464

91 7199 9991 7036 4782 1471

Exhibit A

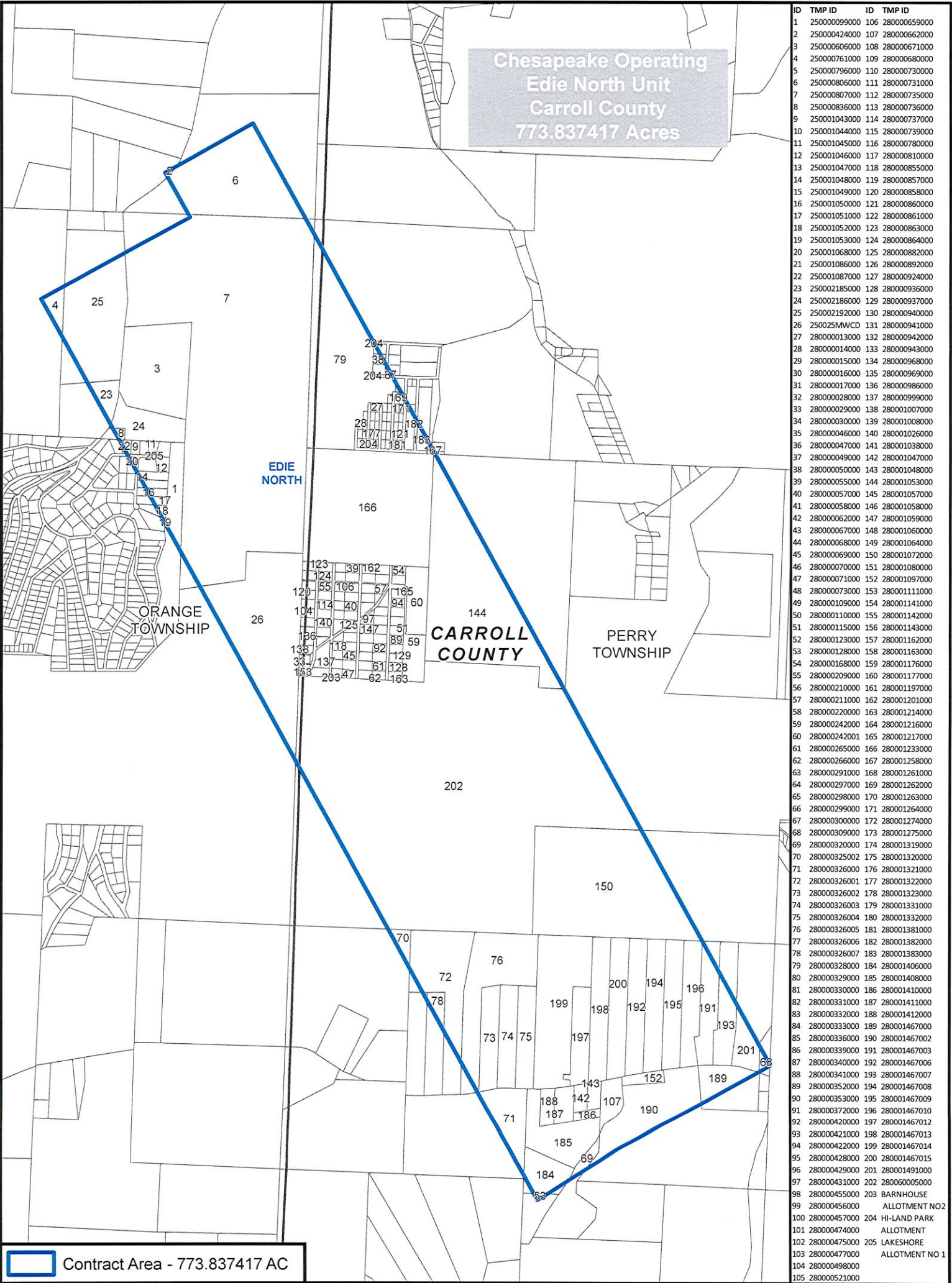

CONTRACT AREA

Edie North
Orange & Perry Townships
Carroll Co., OH

1 inch = 1,300 feet

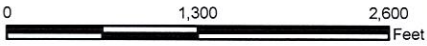

EXHIBIT B

Leases Within the Contract Area

Attached to and made a part of that certain Unit Operating Agreement dated April 9, 2015 for the East North Unit.

TRACT NUMBER	CHEAPEAKE LEASE ID NUMBER	LESSOR	LEASED YES/NO	SURFACE ACRES IN UNIT	TRACT PARTICIPATION	TAX MAP PARCEL ID NUMBERS	TOWNSHIP	COUNTY	STATE	UNIT WORKING INTEREST	CHEAPEAKE WORKING INTEREST	CHEAPEAKE UNIT PARTICIPATION	ENERVEST WORKING INTEREST	ENERVEST UNIT PARTICIPATION	ADDRESS	CITY	STATE	ZIP CODE
1	34-033798-000	JAMES E. BUTLER AND DOROTHY A. BUTLER	YES	3.996664	0.005148	2500020095000	Orange	Carril	OH	0.005148	1.0000000	0.005148			8343 SEEMAN DRIVE SW	CARROLLTON	OHIO	44615
2	34-030215-000	MICHAEL L. HAWKINS AND OLIE A. HAWKINS	YES	0.093356	0.000106	2500004310000	Orange	Carril	OH	0.000106	1.0000000	0.000106			6921 AUTUMN RD SW	CARROLLTON	OHIO	44615
3	34-034370-000	JAMES CHARLES KEEFER	YES	16.199371	0.010934	2500006060000	Orange	Carril	OH	0.010934	1.0000000	0.010934			7074 AUTUMN ROAD SW	CARROLLTON	OHIO	44615
4	34-033885-000	ROBERT W. AND SHARON L. MC FARLAND	YES	1.566748	0.002246	2500007610000	Orange	Carril	OH	0.002246	0.6250000	0.0012654	0.3750000	0.0007592	6164 DOOGEE ROAD SW	CANTON	OHIO	44766
5	34-030879-000	WILLIAM A. SMITH AND FAREY SMITH	YES	0.527062	0.006811	2500007960000	Orange	Carril	OH	0.006811	1.0000000	0.006811			331 CENTERS ST.	EAST WEEPOOL	OHIO	43920
6	1-326295-000	DOMINIC C. AND BERTHA ELEANOR PAGALUINGA	YES	21.650757	0.0179784	2500008080000	Orange	Carril	OH	0.0279784	1.0000000	0.0279784			4199 MEADOWVIEW DR NW	CANTON	OHIO	43920
7	1-326298-000	DOMINIC C. AND BERTHA ELEANOR PAGALUINGA	YES	132.247581	0.1712861	2500008070000	Orange	Carril	OH	0.1712861	1.0000000	0.1712861			4199 MEADOWVIEW DR NW	CANTON	OHIO	44718
8	1-326297-000	DOMINIC C. AND BERTHA ELEANOR PAGALUINGA	YES	0.265160	0.0003427	2500008060000	Orange	Carril	OH	0.0003427	1.0000000	0.0003427			4199 MEADOWVIEW DR NW	CANTON	OHIO	44718
9	34-030879-000	WILLIAM A. SMITH AND FAREY SMITH	YES	0.326893	0.0003446	2500010430000	Orange	Carril	OH	0.0003446	1.0000000	0.0003446			331 CENTERS ST.	EAST WEEPOOL	OHIO	43920
10	34-030879-000	WILLIAM A. SMITH AND FAREY SMITH	YES	0.328068	0.0004139	2500010450000	Orange	Carril	OH	0.0004139	1.0000000	0.0004139			331 CENTERS ST.	EAST WEEPOOL	OHIO	43920
11	34-030879-000	WILLIAM A. SMITH AND FAREY SMITH	YES	0.330796	0.0004351	2500010455000	Orange	Carril	OH	0.0004351	1.0000000	0.0004351			331 CENTERS ST.	EAST WEEPOOL	OHIO	43920
12	34-033798-000	JAMES E. BUTLER AND DOROTHY A. BUTLER	YES	0.524683	0.0006780	2500010460000	Orange	Carril	OH	0.0006780	1.0000000	0.0006780			8343 SEEMAN DRIVE SW	CARROLLTON	OHIO	44615
13	34-033798-000	JAMES E. BUTLER AND DOROTHY A. BUTLER	YES	0.605161	0.0008396	2500010470000	Orange	Carril	OH	0.0008396	1.0000000	0.0008396			8343 SEEMAN DRIVE SW	CARROLLTON	OHIO	44615
14	34-033798-000	JAMES E. BUTLER AND DOROTHY A. BUTLER	YES	0.606259	0.0008367	2500010480000	Orange	Carril	OH	0.0008367	1.0000000	0.0008367			8343 SEEMAN DRIVE SW	CARROLLTON	OHIO	44615
15	34-033798-000	JAMES E. BUTLER AND DOROTHY A. BUTLER	YES	0.549879	0.0007099	2500010490000	Orange	Carril	OH	0.0007099	1.0000000	0.0007099			8343 SEEMAN DRIVE SW	CARROLLTON	OHIO	44615
16	34-002731-000	KATHENE ARENS A WIDOW	YES	0.429450	0.0005550	2500010500000	Orange	Carril	OH	0.0005550	1.0000000	0.0005550			6315 PORTAGE ST NW	NORTH CANTON	OHIO	44720
17	34-002731-000	KATHENE ARENS A WIDOW	YES	0.316055	0.0004007	2500010510000	Orange	Carril	OH	0.0004007	1.0000000	0.0004007			6315 PORTAGE ST NW	NORTH CANTON	OHIO	44720
18	34-002731-000	KATHENE ARENS A WIDOW	YES	0.247344	0.0003196	2500010520000	Orange	Carril	OH	0.0003196	1.0000000	0.0003196			6315 PORTAGE ST NW	NORTH CANTON	OHIO	44720
19	34-002731-000	KATHENE ARENS A WIDOW	YES	0.013933	0.0001380	2500010530000	Orange	Carril	OH	0.0001380	1.0000000	0.0001380			6315 PORTAGE ST NW	NORTH CANTON	OHIO	44720
20	34-032371-000	STEVE L. AND SHERIE CENTEA	YES	0.121552	0.0001571	2500010600000	Orange	Carril	OH	0.0001571	1.0000000	0.0001571			23 CLARKS CHAPEL ROAD	WEAVERVILLE	NORTH CAROLINA	28787
21	34-031566-000	JOHN OSTER AND CHRISTHE OOSTER	YES	0.027932	0.0003351	2500010680000	Orange	Carril	OH	0.0003351	1.0000000	0.0003351			1516 DUKEETH DRIVE	CANTON	OHIO	44708
22	34-031566-000	JOHN OSTER AND CHRISTHE OOSTER	YES	0.272536	0.0003322	2500010690000	Orange	Carril	OH	0.0003322	1.0000000	0.0003322			1516 DUKEETH DRIVE	CANTON	OHIO	44708
23	34-002398-000	RICKY L. SNARE AND KAREN J	YES	2.077004	0.0026840	2500021830000	Orange	Carril	OH	0.0026840	1.0000000	0.0026840			7887 AUTUMN RD SW	CARROLLTON	OHIO	44615
24	1-326296-000	DOMINIC PAGALUINGA AND DELIAAR M. BURKHART AND DOBIE L.	YES	5.741677	0.0024197	2500021860000	Orange	Carril	OH	0.0024197	1.0000000	0.0024197			4199 MEADOWVIEW DR NW	CANTON	OHIO	44718
25	34-002731-000	THE MUSKOGHEA WATERBED CONSERVANCY DISTRICT	YES	17.342111	0.0224105	2500021920000	Orange	Carril	OH	0.0224105	1.0000000	0.0224105			7055 AUTUMN RD SW	CARROLLTON	OHIO	44615
26	34-030441-000	PATRICIA AND JAMES MORTGOW BARBARA AN DICHAD BRUDER	YES	29.942621	0.0386911	2500025140000	Orange	Carril	OH	0.0386911	1.0000000	0.0386911			1310 3RD ST NW, BOX 349	NEW PHILADELPHIA	OHIO	44663
27	34-0001877-001	PATRICIA AND JAMES MORTGOW BARBARA AN DICHAD BRUDER	YES	0.114285	0.0001483	28000000135000	Perry	Carril	OH	0.0001483	1.0000000	0.0001483			1620 CALAFORNIA AVE	LOUISVILLE	OHIO	44641
28	34-0001877-001	PATRICIA AND JAMES MORTGOW BARBARA AN DICHAD BRUDER LINDA ALEXANDER	YES	0.114784	0.0001483	28000000140000	Perry	Carril	OH	0.0001483	1.0000000	0.0001483			1620 CALAFORNIA AVE	LOUISVILLE	OHIO	44641
29	34-0001877-001	PATRICIA AND JAMES MORTGOW BARBARA AN DICHAD BRUDER	YES	0.114784	0.0001483	28000000150000	Perry	Carril	OH	0.0001483	1.0000000	0.0001483			1620 CALAFORNIA AVE	LOUISVILLE	OHIO	44641
30	34-033898-000	DANIEL C. FULLER AND DEBORAH K. FULLER	YES	0.114784	0.0001483	28000000155000	Perry	Carril	OH	0.0001483	1.0000000	0.0001483			2360 BRAMBLE RIDGE SW	CARROLLTON	OHIO	44615
31	34-033898-000	DANIEL C. FULLER AND DEBORAH K. FULLER	YES	0.114785	0.0001483	28000000170000	Perry	Carril	OH	0.0001483	1.0000000	0.0001483			2360 BRAMBLE RIDGE SW	CARROLLTON	OHIO	44615
32	34-030831-000	DAVID A. MISKIMEN AND DIANNA L. MISKIMEN	YES	0.027275	0.0003152	28000000280000	Perry	Carril	OH	0.0003152	1.0000000	0.0003152			7405 BOWE ROAD SW	CARROLLTON	OHIO	44615
33	34-030831-000	DAVID A. MISKIMEN AND DIANNA L. MISKIMEN	YES	0.232259	0.0003160	28000000290000	Perry	Carril	OH	0.0003160	1.0000000	0.0003160			7405 BOWE ROAD SW	CARROLLTON	OHIO	44615
34	34-030831-000	DAVID A. MISKIMEN AND DIANNA L. MISKIMEN	YES	0.068859	0.0000851	28000000300000	Perry	Carril	OH	0.0000851	1.0000000	0.0000851			7405 BOWE ROAD SW	CARROLLTON	OHIO	44615
35	34-0001646-000	JASON EDWARD WILDRIGT AND NICOLE RENEE WILDRIGT	YES	0.114784	0.0001483	28000000400000	Perry	Carril	OH	0.0001483	1.0000000	0.0001483			7330 CALWCHET COURT DAYTON	DAYTON	OHIO	45424
36	34-0001646-000	JASON EDWARD WILDRIGT AND NICOLE RENEE WILDRIGT	YES	0.114784	0.0001483	28000000410000	Perry	Carril	OH	0.0001483	1.0000000	0.0001483			7330 CALWCHET COURT DAYTON	DAYTON	OHIO	45424
37	34-030831-000	MARK O. SIEGENTHALER	YES	0.344352	0.0004450	28000000500000	Perry	Carril	OH	0.0004450	1.0000000	0.0004450			2000 FAIRCHET STREET SE	CANTON	OHIO	447047
38	34-0001587-001	PATRICIA AND JAMES MORTGOW BARBARA AN DICHAD BRUDER LINDA ALEXANDER	YES	0.284231	0.0003579	28000000500000	Perry	Carril	OH	0.0003579	1.0000000	0.0003579			1620 CALAFORNIA AVE 6033 KNOB ST P.O. BOX 42	LOUISVILLE LOUISVILLE ROCHESTER	OHIO OHIO WEST VIRGINIA	44641 44641 26169
39	34-031277-000	JOHN W. ELLIOTT	YES	0.347250	0.0004484	28000000500000	Perry	Carril	OH	0.0004484	1.0000000	0.0004484			2360 BRAMBLE ROAD SW	CARROLLTON	OHIO	44615
40	34-030831-000	THAOITH LEE BRACE & PATRICIA K BRACE	YES	0.344351	0.0004450	28000000510000	Perry	Carril	OH	0.0004450	1.0000000	0.0004450			7257 LEAFY GREEN STREET SW	CARROLLTON	OHIO	44615
41	34-030831-000	THAOITH LEE BRACE & PATRICIA K BRACE	YES	0.344352	0.0004450	28000000510000	Perry	Carril	OH	0.0004450	1.0000000	0.0004450			2463 THAILWOOD DRIVE SW	CARROLLTON	OHIO	44615
42	34-0000431-000	CHARLES O. JUNGSTON, SR. ET AL	YES	0.341357	0.0004134	28000000610000	Perry	Carril	OH	0.0004134	1.0000000	0.0004134			2463 THAILWOOD DRIVE SW	CARROLLTON	OHIO	44615
43	34-0002157-000	JOFY L. MCARDOW SHELLEY	YES	0.261209	0.0003176	28000000610000	Perry	Carril	OH	0.0003176	1.0000000	0.0003176			216813 JOHN ROAD	CHAMSTED FALLS	OHIO	44138
44	34-0002157-000	GARY A. MILLER	YES	0.344352	0.0004450	28000000610000	Perry	Carril	OH	0.0004450	1.0000000	0.0004450			14477 FURBERIDGE RD NE	ALLIANCE	OHIO	44601
45	34-030874-000	GEORGE E. STRICKMAYER	YES	0.344351	0.0004450	28000000690000	Perry	Carril	OH	0.0004450	1.0000000	0.0004450			1330 BUTINA VISTA STREET NE	CANTON	OHIO	44714
46	34-037290-000	GEORGE E. STRICKMAYER	YES	0.340882	0.0004405	28000000700000	Perry	Carril	OH	0.0004405	1.0000000	0.0004405			3135 WOODLAND AVENUE NW	CANTON	OHIO	44709
47	34-037290-000	GEORGE E. STRICKMAYER	YES	0.347612	0.0004495	28000000710000	Perry	Carril	OH	0.0004495	1.0000000	0.0004495			3135 WOODLAND AVENUE NW	CANTON	OHIO	44709
48	34-0002472-000	JAMES FABIAN & ROBIN FABIAN	YES	0.344352	0.0004450	28000000710000	Perry	Carril	OH	0.0004450	1.0000000	0.0004450			533 WESTWOOD DRIVE	STUEBENVILLE	OHIO	43093

TRACT NUMBER	CHEAPSAFE EASE ID NUMBER	LESSOR	LEASED YES/NO	SURFACE ACRES IN UNIT	TRACT PARTICIPATION	TAX MAP PARCEL ID NUMBERS	TOWNSHIP	COUNTY	STATE	UNIT WORKING INTEREST	CHEAPSAFE WORKING INTEREST	CHEAPSAFE UNIT PARTICIPATION	ENERVEST WORKING INTEREST	ENERVEST UNIT PARTICIPATION	ADDRESS	CITY	STATE	ZIP CODE
49	34-0001387-001 34-0001387-002 34-0001387-003 34-0001643-000	PATRICIA AND JAMES NORROW BARBARA A RICHARDS BRUDER DANIEL C AND DEBORAH K FULLER	YES	0.114785	0.0001483	2800001290000	Perry	Carroll	OH	0.0001483	1.0000000	0.0001483			1820 CALIFORNIA AVE 6033 KNOB ST P.O. BOX 42 3350 BARNHOUSE ROAD DAYTON	LOUISVILLE LOUISVILLE ROCKPORT CARROLLTON	OHIO OHIO WEST VIRGINIA OHIO	44641 44641 26169 44641
50	34-0001387-001 34-0001387-002 34-0001387-003 34-0001643-000	PATRICIA AND JAMES NORROW BARBARA A RICHARDS BRUDER LINDA ALEXANDER DANIEL C AND DEBORAH K FULLER	YES	0.114784	0.0001483	2800001130000	Perry	Carroll	OH	0.0001483	1.0000000	0.0001483			1820 CALIFORNIA AVE 6033 KNOB ST P.O. BOX 42 3350 BARNHOUSE ROAD DAYTON	LOUISVILLE LOUISVILLE ROCKPORT CARROLLTON	OHIO OHIO WEST VIRGINIA OHIO	44641 44641 26169 44615
51	34-0001246-000	ANDREW CIGAN AND HANCI CIGAN	YES	0.844851	0.0004450	2800001150000	Perry	Carroll	OH	0.0004450	1.0000000	0.0004450			2362 BEANBLE ROAD SW	NAVAHE	OHIO	44662
52	34-018415-000	STEPHAN BLURLEY AND ALICE BLURLEY	YES	0.113514	0.0001725	2800001200000	Perry	Carroll	OH	0.0001725	1.0000000	0.0001725			10331 SHELTER AVENUE SW	NAVAHE	OHIO	44662
53	34-018416-000	BEVERLY CHURCHILL AND ELIZABETH L CHURCHILL	YES	0.127577	0.0001649	2800001380000	Perry	Carroll	OH	0.0001649	1.0000000	0.0001649			251 NORTHIDGE STREET NW	NORTH CANTON	OHIO	44720
54	34-0002004-000	DOYNA J BROWN, A WIDOW	YES	0.340489	0.0004489	2800001180000	Perry	Carroll	OH	0.0004489	1.0000000	0.0004489			754 PONTIUS STREET NW	MORGANTHOE	OHIO	44760
55	34-018741-000	LINA GALLA A SINGLE WOMAN	YES	0.844852	0.0004450	2800002060000	Perry	Carroll	OH	0.0004450	1.0000000	0.0004450			7194 BARNHOUSE ROAD	CARROLLTON	OHIO	44615
56	34-018741-000	LINA GALLA A SINGLE WOMAN	YES	0.344353	0.0004450	2800002010000	Perry	Carroll	OH	0.0004450	1.0000000	0.0004450			2734 AINS ROAD	BROADVIEW HEIGHTS	OHIO	44147
57	34-0001556-000	TERRELL HEINZMAN & JOSEPHINE HEINZMAN	YES	0.271608	0.0003363	2800002110000	Perry	Carroll	OH	0.0003363	1.0000000	0.0003363			2734 AINS ROAD	BROADVIEW HEIGHTS	OHIO	44147
58	34-0000337-000	CHARLES O LIVINGSTON SR AND LENOIR D LIVINGSTON	YES	0.210814	0.0002724	2800002020000	Perry	Carroll	OH	0.0002724	1.0000000	0.0002724			P.O. BOX 791	NEW CAMBERLAND	OHIO	26047
59	34-0001410-000	EDWARD E & SANDRA L BALL	YES	3.141989	0.0046083	2800002040000	Perry	Carroll	OH	0.0046083	1.0000000	0.0046083			2601 BEACON DRIVE	WERTON	WEST VIRGINIA	26062
60	34-0001410-000	EDWARD E & SANDRA L BALL	YES	3.989933	0.0051483	2800002040001	Perry	Carroll	OH	0.0051483	1.0000000	0.0051483			2601 BEACON DRIVE	WERTON	WEST VIRGINIA	26062
61	34-017408-000	DAVID C FLOOD AND NANCY TOOTHMAN-FLOOD	YES	0.342842	0.0004430	2800002010000	Perry	Carroll	OH	0.0004430	1.0000000	0.0004430			918 FEDERAL STREET	TORONTO	OHIO	43964
62	34-017408-000	DAVID C FLOOD AND NANCY TOOTHMAN-FLOOD	YES	0.345859	0.0004459	2800002060000	Perry	Carroll	OH	0.0004459	1.0000000	0.0004459			918 FEDERAL STREET	TORONTO	OHIO	43964
63	34-0001770-000 34-0001770-001 34-0001770-002 34-0001770-003 34-0001770-004 34-0001770-005 34-0001770-006 34-0001770-007 34-0001770-008 34-0001770-009 34-0001770-010 34-0001770-011 34-0001770-012 34-0001770-013 34-0001770-014 34-0001770-015 34-0001770-016 34-0001770-017 34-0001770-018 34-0001770-019 34-0001770-020 34-0001770-021 34-0001770-022 34-0001770-023 34-0001770-024 34-0001770-025 34-0001770-026 34-0001770-027 34-0001770-028 34-0001770-029 34-0001770-030 34-0001770-031 34-0001770-032 34-0001770-033 34-0001770-034 34-0001770-035 34-0001770-036 34-0001770-037 34-0001770-038 34-0001770-039 34-0001770-040 34-0001770-041 34-0001770-042 34-0001770-043 34-0001770-044 34-0001770-045 34-0001770-046 34-0001770-047 34-0001770-048 34-0001770-049 34-0001770-050 34-0001770-051 34-0001770-052 34-0001770-053 34-0001770-054 34-0001770-055 34-0001770-056 34-0001770-057 34-0001770-058 34-0001770-059 34-0001770-060 34-0001770-061 34-0001770-062 34-0001770-063 34-0001770-064 34-0001770-065 34-0001770-066 34-0001770-067 34-0001770-068 34-0001770-069 34-0001770-070 34-0001770-071 34-0001770-072 34-0001770-073 34-0001770-074 34-0001770-075 34-0001770-076 34-0001770-077 34-0001770-078 34-0001770-079 34-0001770-080 34-0001770-081 34-0001770-082 34-0001770-083 34-0001770-084 34-0001770-085 34-0001770-086 34-0001770-087 34-0001770-088 34-0001770-089 34-0001770-090 34-0001770-091 34-0001770-092 34-0001770-093 34-0001770-094 34-0001770-095 34-0001770-096 34-0001770-097 34-0001770-098 34-0001770-099 34-0001770-100 34-0001770-101 34-0001770-102 34-0001770-103 34-0001770-104 34-0001770-105 34-0001770-106 34-0001770-107 34-0001770-108 34-0001770-109 34-0001770-110 34-0001770-111 34-0001770-112 34-0001770-113 34-0001770-114 34-0001770-115 34-0001770-116 34-0001770-117 34-0001770-118 34-0001770-119 34-0001770-120 34-0001770-121 34-0001770-122 34-0001770-123 34-0001770-124 34-0001770-125 34-0001770-126 34-0001770-127 34-0001770-128 34-0001770-129 34-0001770-130 34-0001770-131 34-0001770-132 34-0001770-133 34-0001770-134 34-0001770-135 34-0001770-136 34-0001770-137 34-0001770-138 34-0001770-139 34-0001770-140 34-0001770-141 34-0001770-142 34-0001770-143 34-0001770-144 34-0001770-145 34-0001770-146 34-0001770-147 34-0001770-148 34-0001770-149 34-0001770-150 34-0001770-151 34-0001770-152 34-0001770-153 34-0001770-154 34-0001770-155 34-0001770-156 34-0001770-157 34-0001770-158 34-0001770-159 34-0001770-160 34-0001770-161 34-0001770-162 34-0001770-163 34-0001770-164 34-0001770-165 34-0001770-166 34-0001770-167 34-0001770-168 34-0001770-169 34-0001770-170 34-0001770-171 34-0001770-172 34-0001770-173 34-0001770-174 34-0001770-175 34-0001770-176 34-0001770-177 34-0001770-178 34-0001770-179 34-0001770-180 34-0001770-181 34-0001770-182 34-0001770-183 34-0001770-184 34-0001770-185 34-0001770-186 34-0001770-187 34-0001770-188 34-0001770-189 34-0001770-190 34-0001770-191 34-0001770-192 34-0001770-193 34-0001770-194 34-0001770-195 34-0001770-196 34-0001770-197 34-0001770-198 34-0001770-199 34-0001770-200 34-0001770-201 34-0001770-202 34-0001770-203 34-0001770-204 34-0001770-205 34-0001770-206 34-0001770-207 34-0001770-208 34-0001770-209 34-0001770-210 34-0001770-211 34-0001770-212 34-0001770-213 34-0001770-214 34-0001770-215 34-0001770-216 34-0001770-217 34-0001770-218 34-0001770-219 34-0001770-220 34-0001770-221 34-0001770-222 34-0001770-223 34-0001770-224 34-0001770-225 34-0001770-226 34-0001770-227 34-0001770-228 34-0001770-229 34-0001770-230 34-0001770-231 34-0001770-232 34-0001770-233 34-0001770-234 34-0001770-235 34-0001770-236 34-0001770-237 34-0001770-238 34-0001770-239 34-0001770-240 34-0001770-241 34-0001770-242 34-0001770-243 34-0001770-244 34-0001770-245 34-0001770-246 34-0001770-247 34-0001770-248 34-0001770-249 34-0001770-250 34-0001770-251 34-0001770-252 34-0001770-253 34-0001770-254 34-0001770-255 34-0001770-256 34-0001770-257 34-0001770-258 34-0001770-259 34-0001770-260 34-0001770-261 34-0001770-262 34-0001770-263 34-0001770-264 34-0001770-265 34-0001770-266 34-0001770-267 34-0001770-268 34-0001770-269 34-0001770-270 34-0001770-271 34-0001770-272 34-0001770-273 34-0001770-274 34-0001770-275 34-0001770-276 34-0001770-277 34-0001770-278 34-0001770-279 34-0001770-280 34-0001770-281 34-0001770-282 34-0001770-283 34-0001770-284 34-0001770-285 34-0001770-286 34-0001770-287 34-0001770-288 34-0001770-289 34-0001770-290 34-0001770-291 34-0001770-292 34-0001770-293 34-0001770-294 34-0001770-295 34-0001770-296 34-0001770-297 34-0001770-298 34-0001770-299 34-0001770-300 34-0001770-301 34-0001770-302 34-0001770-303 34-0001770-304 34-0001770-305 34-0001770-306 34-0001770-307 34-0001770-308 34-0001770-309 34-0001770-310 34-0001770-311 34-0001770-312 34-0001770-313 34-0001770-314 34-0001770-315 34-0001770-316 34-0001770-317 34-0001770-318 34-0001770-319 34-0001770-320 34-0001770-321 34-0001770-322 34-0001770-323 34-0001770-324 34-0001770-325 34-0001770-326 34-0001770-327 34-0001770-328 34-0001770-329 34-0001770-330 34-0001770-331 34-0001770-332 34-0001770-333 34-0001770-334 34-0001770-335 34-0001770-336 34-0001770-337 34-0001770-338 34-0001770-339 34-0001770-340 34-0001770-341 34-0001770-342 34-0001770-343 34-0001770-344 34-0001770-345 34-0001770-346 34-0001770-347 34-0001770-348 34-0001770-349 34-0001770-350 34-0001770-351 34-0001770-352 34-0001770-353 34-0001770-354 34-0001770-355 34-0001770-356 34-0001770-357 34-0001770-358 34-0001770-359 34-0001770-360 34-0001770-361 34-0001770-362 34-0001770-363 34-0001770-364 34-0001770-365 34-0001770-366 34-0001770-367 34-0001770-368 34-0001770-369 34-0001770-370 34-0001770-371 34-0001770-372 34-0001770-373 34-0001770-374 34-0001770-375 34-0001770-376 34-0001770-377 34-0001770-378 34-0001770-379 34-0001770-380 34-0001770-381 34-0001770-382 34-0001770-383 34-0001770-384 34-0001770-385 34-0001770-386 34-0001770-387 34-0001770-388 34-0001770-389 34-0001770-390 34-0001770-391 34-0001770-392 34-0001770-393 34-0001770-394 34-0001770-395 34-0001770-396 34-0001770-397 34-0001770-398 34-0001770-399 34-0001770-400 34-0001770-401 34-0001770-402 34-0001770-403 34-0001770-404 34-0001770-405 34-0001770-406 34-0001770-407 34-0001770-408 34-0001770-409 34-0001770-410 34-0001770-411 34-0001770-412 34-0001770-413 34-0001770-414 34-0001770-415 34-0001770-416 34-0001770-417 34-0001770-418 34-0001770-419 34-0001770-420 34-0001770-421 34-0001770-422 34-0001770-423 34-0001770-424 34-0001770-425 34-0001770-426 34-0001770-427 34-0001770-428 34-0001770-429 34-0001770-430 34-0001770-431 34-0001770-432 34-0001770-433 34-0001770-434 34-0001770-435 34-0001770-436 34-0001770-437 34-0001770-438 34-0001770-439 34-0001770-440 34-0001770-441 34-0001770-442 34-0001770-443 34-0001770-444 34-0001770-445 34-0001770-446 34-0001770-447 34-0001770-448 34-0001770-449 34-0001770-450 34-0001770-451 34-0001770-452 34-0001770-453 34-0001770-454 34-0001770-455 34-0001770-456 34-0001770-457 34-0001770-458 34-0001770-459 34-0001770-460 34-0001770-461 34-0001770-462 34-0001770-463 34-0001770-464 34-0001770-465 34-0001770-466 34-0001770-467 34-0001770-468 34-0001770-469 34-0001770-470 34-0001770-471 34-0001770-472 34-0001770-473 34-0001770-474 34-0001770-475 34-0001770-476 34-0001770-477 34-0001770-478 34-0001770-479 34-0001770-480 34-0001770-481 34-0001770-482 34-0001770-483 34-0001770-484 34-0001770-485 34-0001770-486 34-0001770-487 34-0001770-488 34-0001770-489 34-0001770-490 34-0001770-491 34-0001770-492 34-0001770-493 34-0001770-494 34-0001770-495 34-0001770-496 34-0001770-497 34-0001770-498 34-0001770-499 34-0001770-500 34-0001770-501 34-0001770-502 34-0001770-503 34-0001770-504 34-0001770-505 34-0001770-506 34-0001770-507 34-0001770-508 34-0001770-509 34-0001770-510 34-0001770-511 34-0001770-512 34-0001770-513 34-0001770-514 34-0001770-515 34-0001770-516 34-0001770-517 34-0001770-518 34-0001770-519 34-0001770-520 34-0001770-521 34-0001770-522 34-0001770-523 34-0001770-524 34-0001770-525 34-0001770-526 34-0001770-527 34-0001770-528 34-0001770-529 34-0001770-530 34-0001770-531 34-0001770-532 34-0001770-533 34-0001770-534 34-0001770-535 34-0001770-536 34-0001770-537 34-0001770-538 34-0001770-539 34-0001770-540 34-0001770-541 34-0001770-542 34-0001770-543 34-0001770-544 34-0001770-545 34-0001770-546 34-0001770-547 34-0001770-548 34-0001770-549 34-0001770-550 34-0001770-551 34-0001770-552 34-0001770-553 34-0001770-554 34-0001770-555 34-0001770-556 34-0001770-557 34-0001770-558 34-0001770-559 34-0001770-560 34-00																	

TRACT NUMBER	CHESAPEAKE LEASE ID NUMBER	LESSOR	LEASED YES/NO	SURFACE ACRES IN UNIT	TRACT PARTICIPATION	TAX MAP PARCEL ID NUMBERS	TOWNSHIP	COUNTY	STATE	UNIT WORKING INTEREST	CHESAPEAKE WORKING INTEREST	CHESAPEAKE UNIT PARTICIPATION	ENERVEST WORKING INTEREST	ENERVEST UNIT PARTICIPATION	ADDRESS	CITY	STATE	ZIP CODE
96	UNLEASED	RONALD S. GELAK	NO	0.344813	0.000465	28000043000	Perry & Orange	Carrall	OH	0.000465	0.000000	0.000000			935 W MAIN ST	MALVERN	OHIO	44644
97	34-0001779-000	DANIEL W & ELIZABETH L. HARRIS	YES	0.366734	0.000479	2800000431000	Perry	Carrall	OH	0.000479	1.000000	0.000479			7180 BARNHOUSE STREET	CARROLLTON	OHIO	44615
98	UNLEASED	GREGORY KOZLUK AND JOSEPHINE KOZLUK (D&A ISSUE)					Perry								3652 INVERSIDE RD	BENTON HARBOR	MICHIGAN	49022
	UNLEASED	JOHN KOZLUK (D&A ISSUE)					Perry								107 SCHOOL STREET	ROSELLE	PENNSYLVANIA	16936
	34-0001391-001	PATRICIA AND RICHARD BRODER (D&A ISSUE)	YES	0.114784	0.0001483	280000455000	Perry	Carrall	OH	0.0001483	1.000000	0.0001483			180 CALAFORNIA AVE	LOUISVILLE	OHIO	44641
99	UNLEASED	LINDA ALEXANDER (D&A ISSUE)					Perry								PO BOX 42	ROOSTER	WEST VIRGINIA	26169
	UNLEASED	GREGORY KOZLUK AND JOSEPHINE KOZLUK (D&A ISSUE)					Perry								3653 INVERSIDE RD	BENTON HARBOR	MICHIGAN	49022
	34-0001391-001	JOHN KOZLUK (D&A ISSUE)	YES	0.114784	0.0001483	280000466000	Perry	Carrall	OH	0.0001483	1.000000	0.0001483			107 SCHOOL STREET	MALVERN	PENNSYLVANIA	16936
100	UNLEASED	PATRICIA AND RICHARD BRODER (D&A ISSUE)					Perry								180 CALAFORNIA AVE	LOUISVILLE	OHIO	44641
	UNLEASED	LINDA ALEXANDER (D&A ISSUE)					Perry								PO BOX 42	ROOSTER	WEST VIRGINIA	26170
	34-0001391-001	GREGORY KOZLUK AND JOSEPHINE KOZLUK (D&A ISSUE)	YES	0.114784	0.0001483	280000477000	Perry	Carrall	OH	0.0001483	1.000000	0.0001483			3654 INVERSIDE RD	BENTON HARBOR	MICHIGAN	49022
101	UNLEASED	STEPHEN A. STEWART AND LOB A.	YES	0.349759	0.000450	28000047000	Perry	Carrall	OH	0.000450	1.000000	0.000450			180 CALAFORNIA AVE	LOUISVILLE	OHIO	44641
	UNLEASED	STEPHEN A. STEWART AND LOB A.					Perry								PO BOX 42	ROOSTER	WEST VIRGINIA	26171
	34-0001392-001	LINDA ALEXANDER (D&A ISSUE)	YES	0.349759	0.000450	28000048000	Perry	Carrall	OH	0.000450	1.000000	0.000450			7180 BARNHOUSE STREET SW	CARROLLTON	OHIO	44615
102	34-0375731-000	STEPHEN A. STEWART AND LOB A.	YES	0.344352	0.000450	280000475000	Perry	Carrall	OH	0.000450	1.000000	0.000450			7913 BARNHOUSE STREET SW	CARROLLTON	OHIO	44615
103	34-0387351-000	JIMMY L. AND DESSIE M. SZANWIS	YES	0.344352	0.000450	280000477000	Perry	Carrall	OH	0.000450	1.000000	0.000450			7213 BARNHOUSE STREET SW	CARROLLTON	OHIO	44615
104	34-0387351-000	LEO J. KUNE, JR.	YES	0.344353	0.000450	280000488000	Perry	Carrall	OH	0.000450	1.000000	0.000450			11115 WRIGHT ROAD NW	UNIONTOWN	OHIO	44685
105	34-0386994-000	ANDREW BROOKS GARRISON AND CAROL GARRISON	YES	0.348699	0.000453	280000212000	Perry	Carrall	OH	0.000453	1.000000	0.000453			11778 RIVER RIDGE DRIVE	FISHERS	INDIANA	46038
106	34-0001841-000	JAMES G. SCHAMON AND JULIA A. SARAH SCHAMON	YES	0.261210	0.0003376	280000635000	Perry	Carrall	OH	0.0003376	1.000000	0.0003376			P.O. BOX 307	CARROLLTON	OHIO	44615
107	PENDING	MARK AND VICTORIA P. OBOY	YES	2.513484	0.0032481	280000662000	Perry	Carrall	OH	0.0032481	1.000000	0.0032481			2102 AMSTERDAM RD SW	BOVERSTON	OHIO	44695
108	34-0037346-000	WILLIAM L. MITCHELL & CRISTINE M. MITCHELL	YES	0.264429	0.000417	280000671000	Perry	Carrall	OH	0.000417	1.000000	0.000417			Rt. 1 BOX 71F	COLLERS	WEST VIRGINIA	26035
109	34-0245111-000	JOELLE F. TSCHANZ AND THOMAS TSCHANZ	YES	0.344352	0.000450	280000683000	Perry	Carrall	OH	0.000450	1.000000	0.000450			2771 DAISYBROOK STREET NW	CANTON	OHIO	44720
110	34-0028315-000	DANIEL C. FULLER													2380 BRAMBLE ROAD SW	CARROLLTON	OHIO	44615
	34-0002839-001	LINDA BOLAYARD													7558 PARKS AVE NE	ALLIANCE	OHIO	44601
	34-0028315-001	KAREN GREGORY													1710 STAGECOACH CHURCH	ROSELLE	CALIFORNIA	95747
111	UNLEASED	LEO J. KUNE, JR.	YES	0.114784	0.0001483	280000730000	Perry	Carrall	OH	0.0001483	1.000000	0.0001483			MYRTLE BEACH	ROSELLE	SOUTH CAROLINA	29573
	UNLEASED	LEO J. BUELETT													315 ROCKYVALE NW	CANTON	PENNSYLVANIA	19103
	34-0002834-001	MANLEY GEORGE													315 ROCKYVALE NW	CANTON	OHIO	44708
112	UNLEASED	RUSSELL RAVENHUGH													3698 ARGONNE ST	MAGADORE	OHIO	44360
	34-0002837-001	JUDY LANFRANCHI													1395 LAKE MARTIN DRIVE	KENT	OHIO	44340
	UNLEASED	LINDA BOLAYARD													2380 BRAMBLE ROAD SW	CARROLLTON	OHIO	44601
113	UNLEASED	KAREN GREGORY													7558 PARKS AVE NE	ALLIANCE	OHIO	44601
	34-0028315-001	SUE ALLEN													1710 STAGECOACH CHURCH	ROSELLE	CALIFORNIA	95747
	34-0002839-001	LEO J. KUNE, JR.	YES	0.114784	0.0001483	280000731000	Perry	Carrall	OH	0.0001483	1.000000	0.0001483			1710 PALM COVE CIRCLE	MYRTLE BEACH	SOUTH CAROLINA	29588
114	UNLEASED	LEO J. BUELETT													2355 CONGRESS ST	BRADFORD	PENNSYLVANIA	19103
	UNLEASED	LINDA BOLAYARD													3698 ARGONNE ST	MAGADORE	OHIO	44360
	34-0002838-001	RUSSELL RAVENHUGH													1395 LAKE MARTIN DRIVE	KENT	OHIO	44340
112	34-0387351-000	TIMOTHY LEE BRACE & PATRICIA K BRACE	YES	0.344352	0.000450	280000735000	Perry	Carrall	OH	0.000450	1.000000	0.000450			2481 TRAILWOOD DRIVE SW	CARROLLTON	OHIO	44615
113	34-0378262-000	SAUNDRA J. MCKEY AND CARL MCKEY	YES	0.341616	0.000415	280000736000	Perry	Carrall	OH	0.000415	1.000000	0.000415			2488 SPRING CRESS AVENUS	GROVE CITY	OHIO	43123
114	34-0378262-000	SAUNDRA J. MCKEY AND CARL MCKEY	YES	0.344351	0.000450	280000737000	Perry	Carrall	OH	0.000450	1.000000	0.000450			2488 SPRING CRESS AVENUS	GROVE CITY	OHIO	43123
115	34-0387351-000	JIMMY L. AND DESSIE M. SZANWIS	YES	0.344353	0.000450	280000739000	Perry	Carrall	OH	0.000450	1.000000	0.000450			7213 BARNHOUSE STREET SW	CARROLLTON	OHIO	44615
116	34-0001135-000	WADE E. RINGLER AND CHEVIE L. RINGLER	YES	0.478384	0.0006185	280000780000	Perry	Carrall	OH	0.0006185	1.000000	0.0006185			8601 CAVELOT AVENUE	CANAL FULTON	OHIO	44614
117	34-0028328-000	MICHAEL J. MCCARTHY AND DENISE M. MCCARTHY	YES	0.556405	0.000450	280000810000	Perry	Carrall	OH	0.000450	1.000000	0.000450			13071 MARINER DR	NORTH ROYALTON	OHIO	44133
118	34-0326795-000	MARK BOYLES & SHELBY L. MCNITS AND SPEICER T. MCNITS	YES	0.261211	0.0003376	280000855000	Perry	Carrall	OH	0.0003376	1.000000	0.0003376			6177 MACAW ROAD NE	NINNEBA	OHIO	44657
119	34-0376154-000	JAMES E. DOWDLE, JR. AND CLARA S. DOWDLE	YES	0.344350	0.000450	280000857000	Perry	Carrall	OH	0.000450	1.000000	0.000450			4912 MCCADILL STREET SOUTH	CANTON	OHIO	44706
120	34-0001792-000	THOMAS G. KUSTER AND BARBARA M. KUSTER	YES	0.344351	0.000450	280000858000	Perry	Carrall	OH	0.000450	1.000000	0.000450			639 ROSLYN AVE SW	CANTON	OHIO	44710
121	34-0001543-000	DANIEL C. FULLER & DEBORAH K. FULLER, HUSBAND AND WIFE	YES	0.114793	0.0001483	280000860000	Perry	Carrall	OH	0.0001483	1.000000	0.0001483			2360 BRAMBLE ROAD SW	CARROLLTON	OHIO	44615
122	34-0001543-000	DANIEL C. FULLER & DEBORAH K. FULLER, HUSBAND AND WIFE	YES	0.114784	0.0001483	280000861000	Perry	Carrall	OH	0.0001483	1.000000	0.0001483			510 TATE CIR. APT C	LOUISVILLE	OHIO	44641
123	34-0000118-000	JAMES S. BUSH AND CYNTHIA L. BUSH	YES	0.345322	0.000440	280000863000	Perry	Carrall	OH	0.000440	1.000000	0.000440			2360 BRAMBLE ROAD SW	CARROLLTON	OHIO	44615
124	34-0000118-000	JAMES S. BUSH AND CYNTHIA L. BUSH	YES	0.345322	0.000440	280000864000	Perry	Carrall	OH	0.000440	1.000000	0.000440			510 TATE CIR. APT C	LOUISVILLE	OHIO	44641
125	34-0083534-000	TIMOTHY LEE BRACE & PATRICIA K BRACE	YES	0.344328	0.000450	280000862000	Perry	Carrall	OH	0.000450	1.000000	0.000450			106 EVERGREEN DRIVE	CHESTON	OHIO	44615
126	34-0387351-000	JOSEPH C. MUSCO	YES	0.344352	0.000450	280000869000	Perry	Carrall	OH	0.000450	1.000000	0.000450			2481 TRAILWOOD DRIVE SW	CARROLLTON	OHIO	44615
127	34-0001792-000	DANIEL W & ELIZABETH L. HARRIS	YES	0.365156	0.000461	280000872000	Perry	Carrall	OH	0.000461	1.000000	0.000461			BOX 380 CHERRY LAKE	COLLERS	WEST VIRGINIA	26035
128	34-0386744-000	GARY A. MILLER	YES	0.345309	0.000444	280000874000	Perry	Carrall	OH	0.000444	1.000000	0.000444			7180 BARNHOUSE STREET	CARROLLTON	OHIO	44615
129	34-0386744-000	GARY A. MILLER	YES	0.344352	0.000450	280000873000	Perry	Carrall	OH	0.000450	1.000000	0.000450			1130 BUENA VISTA STREET NE	CANTON	OHIO	44714
130	34-0000428-000	TIMOTHY LEE BRACE & PATRICIA K BRACE	YES	0.361715	0.0004675	280000873000	Perry	Carrall	OH	0.0004675	1.000000	0.0004675			2481 TRAILWOOD DRIVE SW	CARROLLTON	OHIO	44615
131	34-0000428-000	JEFFREY W. COX AND HEAVIL L. COX	YES	0.187010	0.000417	280000874000	Perry	Carrall	OH	0.000417	1.000000	0.000417			615 S. MEDIALINE ROAD	COLEY	OHIO	44321
132	34-0000428-000	JEFFREY W. COX AND HEAVIL L. COX	YES	0.184519	0.000314	280000874000	Perry	Carrall	OH	0.000314	1.000000	0.000314			615 S. MEDIALINE ROAD	COLEY	OHIO	44321
133	34-0000428-000	JEFFREY W. COX AND HEAVIL L. COX	YES	0.144024	0.000457	280000874000	Perry	Carrall	OH	0.000457	1.000000	0.000457			615 S. MEDIALINE ROAD	COLEY	OHIO	44321
134	34-0001643-000	DANIEL C. FULLER & DEBORAH K. FULLER, HUSBAND AND WIFE	YES	0.114784	0.0001483	280000880000	Perry	Carrall	OH	0.0001483	1.000000	0.0001483			2360 BRAMBLE ROAD SW	CARROLLTON	OHIO	44615
135	34-0001927-001	PATRICIA MCKEY AND JAMES MCKEY	YES	0.114785	0.0001483	280000890000	Perry	Carrall	OH	0.0001483	1.000000	0.0001483			1620 CALAFORNIA AVE	LOUISVILLE	OHIO	44641
136	UNLEASED	BARBARA BRODER AND RICHARD BRODER	YES	0.683702	0.0008900	280000896000	Perry	Carrall	OH	0.0008900	1.000000	0.0008900			61300 RIGGLE HILL ROAD	SOMERDALE	OHIO	44678
	34-0376154-000	SUSAN R. ADAMS	YES	0.3993100	0.0011607	280000909000	Perry	Carrall	OH	0.0011607	1.000000	0.0011607			7395 TRAILWOOD DR	CARROLLTON	OHIO	44615
137	34-0376154-000	DAVID A. BUTLER	YES	0.3993100	0.0011607	280000909000	Perry	Carrall	OH	0.0011607	1.000000	0.0011607			7395 TRAILWOOD DR	CARROLLTON	OHIO	44615

TRACT NUMBER	CHEAPAKE LEASE ID NUMBER	LESSOR	LEAD YES/NO	SURFACE ACRES IN UNIT	TRACT PARTICIPATION	TAX MAP PARCEL ID NUMBERS	TOWNSHIP	COUNTY	STATE	UNIT WORKING INTEREST	CHEAPAKE WORKING INTEREST	CHEAPAKE UNIT PARTICIPATION	ADDRESS	CITY	STATE	ZIP CODE
138	34-037866-000	TERENCE L. ADAMS AND MAUREN	YES	0.339214	0.0004302	280001007000	Perry	Carrall	OH	0.0004302	1.0000000	0.0004302	331 LEONARD AVENUE SW	MASSILLON	OHIO	44646
139	34-037868-000	TERENCE L. ADAMS AND MAUREN	YES	0.033335	0.0000301	280001008000	Perry	Carrall	OH	0.0000301	1.0000000	0.0000301	331 LEONARD AVENUE SW	MASSILLON	OHIO	44646
140	34-038031-000	MARK D. SIEGENTHALER	YES	0.336053	0.0004310	280001009000	Perry	Carrall	OH	0.0004310	1.0000000	0.0004310	2209 FAIRCREST STREET SE	CANTON	OHIO	44707
141	34-038052-000	JOHN F. ANTHONY AND MINNERY	YES	0.344831	0.0004450	280001038000	Perry	Carrall	OH	0.0004450	1.0000000	0.0004450	14842 SALT CHURCH STREET NE	ALLIANCE	OHIO	44601
142	34-037916-000	MARK E. OHRY AND VICTORIA P. OHRY	YES	1.000018	0.0012933	280001047000	Perry	Carrall	OH	0.0012933	1.0000000	0.0012933	3710 AMSTERDAM ROAD SW	BOYESTON	OHIO	44695
143	34-037916-000	MARK E. OHRY AND VICTORIA P. OHRY	YES	1.000018	0.0012933	280001048000	Perry	Carrall	OH	0.0012933	1.0000000	0.0012933	3710 AMSTERDAM ROAD SW	BOYESTON	OHIO	44695
144	34-036242-000	DOVE ROAD LTD.	YES	37.512492	0.0489928	280001050000	Perry	Carrall	OH	0.0489928	0.6250000	0.0000000	464 ETHIRIDGE BOULEVARD	CANA LUTON	OHIO	44614
145	34-037267-000	EDWARD PRICE AND DARLENE PRICE	YES	0.344352	0.0004450	280001057000	Perry	Carrall	OH	0.0004450	1.0000000	0.0004450	7235 TRAILWOOD DRIVE	CARROLLTON	OHIO	44635
146	34-037267-000	EDWARD PRICE AND DARLENE PRICE	YES	0.344746	0.0004455	280001058000	Perry	Carrall	OH	0.0004455	1.0000000	0.0004455	7235 TRAILWOOD DRIVE	CARROLLTON	OHIO	44635
147	34-037267-000	EDWARD PRICE AND DARLENE PRICE	YES	0.344351	0.0004450	280001059000	Perry	Carrall	OH	0.0004450	1.0000000	0.0004450	7235 TRAILWOOD DRIVE	CARROLLTON	OHIO	44635
148	34-037267-000	EDWARD PRICE AND DARLENE PRICE	YES	0.344351	0.0004450	280001060000	Perry	Carrall	OH	0.0004450	1.0000000	0.0004450	7235 TRAILWOOD DRIVE	CARROLLTON	OHIO	44635
149	34-036764-000	ERIN NEFF & DOUG NEFF	YES	0.740210	0.0003376	280001064000	Perry	Carrall	OH	0.0003376	1.0000000	0.0003376	5845 SCHILLING AVENUE	LOUISVILLE	OHIO	44641
150	34-000397-001	WILLIAM A. SCOTT, A SINGLE MAN	YES	41.188319	0.0523261	280001072000	Perry	Carrall	OH	0.0523261	1.0000000	0.0523261	1148 FREEPORT RD	PITTSBURGH	PENNSYLVANIA	15238
151	34-000397-001	PATRICIA MORROW AND JAMES MORROW	YES	0.051190	0.0000067	280001080000	Perry	Carrall	OH	0.0000067	1.0000000	0.0000067	1620 CALAMONNA AVE	LOUISVILLE	OHIO	44641
152	34-037914-000	ADAM HOWARD AND ANGELA D. HOWARD	YES	1.168948	0.0016398	280001097000	Perry	Carrall	OH	0.0016398	1.0000000	0.0016398	2004 AMSTERDAM RD SW	BOYESTON	OHIO	44695
153	34-036934-000	DENIS S. ADAMS AND TANNA	YES	0.238233	0.0003367	280001113000	Perry	Carrall	OH	0.0003367	1.0000000	0.0003367	990 REBECCA TRAIL	TALLADGE	OHIO	44678
154	34-036976-000	JIMMY L. SPACKS AND DEBBIE M.	YES	0.288260	0.0003725	280001142000	Perry	Carrall	OH	0.0003725	1.0000000	0.0003725	7213 BARNHOUSE STREET SW	CARROLLTON	OHIO	44615
155	34-036976-000	JIMMY L. SPACKS AND DEBBIE M.	YES	0.339740	0.0004339	280001143000	Perry	Carrall	OH	0.0004339	1.0000000	0.0004339	7213 BARNHOUSE STREET SW	CARROLLTON	OHIO	44615
156	34-036976-000	JIMMY L. SPACKS AND DEBBIE M.	YES	0.344351	0.0004450	280001149000	Perry	Carrall	OH	0.0004450	1.0000000	0.0004450	7213 BARNHOUSE STREET SW	CARROLLTON	OHIO	44615
157	34-037296-000	GEORGE E. STICKMAKER	YES	0.349748	0.0004419	280001162000	Perry	Carrall	OH	0.0004419	1.0000000	0.0004419	3135 WOODLAND AVENUE NW	CANTON	OHIO	44709
158	34-037296-000	GEORGE E. STICKMAKER	YES	0.349748	0.0004419	280001163000	Perry	Carrall	OH	0.0004419	1.0000000	0.0004419	3135 WOODLAND AVENUE NW	CANTON	OHIO	44709
159	34-000397-001	PATRICIA MORROW AND JAMES MORROW	YES	0.114784	0.0001483	280001176000	Perry	Carrall	OH	0.0001483	1.0000000	0.0001483	1620 CALAMONNA AVE	LOUISVILLE	OHIO	44641
160	34-000397-001	PATRICIA MORROW AND JAMES MORROW	YES	0.114784	0.0001483	280001176000	Perry	Carrall	OH	0.0001483	1.0000000	0.0001483	1620 CALAMONNA AVE	LOUISVILLE	OHIO	44641
161	34-000397-001	PATRICIA MORROW AND JAMES MORROW	YES	0.114784	0.0001483	280001176000	Perry	Carrall	OH	0.0001483	1.0000000	0.0001483	1620 CALAMONNA AVE	LOUISVILLE	OHIO	44641
162	34-000397-001	PATRICIA MORROW AND JAMES MORROW	YES	0.114784	0.0001483	280001176000	Perry	Carrall	OH	0.0001483	1.0000000	0.0001483	1620 CALAMONNA AVE	LOUISVILLE	OHIO	44641
163	34-037768-000	DANIEL V. TOOTHMAN AND JANE ANN TOOTHMAN	YES	0.344352	0.0004450	280001197000	Perry	Carrall	OH	0.0004450	1.0000000	0.0004450	7061 SPRING WALK DRIVE NE	CANTON	OHIO	44721
164	34-037768-000	DANIEL V. TOOTHMAN AND JANE ANN TOOTHMAN	YES	0.344352	0.0004450	280001197000	Perry	Carrall	OH	0.0004450	1.0000000	0.0004450	7061 SPRING WALK DRIVE NE	CANTON	OHIO	44721
165	34-000314-000	WILLIAM J. MITCHELL & CHRISTINE M. MITCHELL	YES	0.347796	0.0004456	280001214000	Perry	Carrall	OH	0.0004456	1.0000000	0.0004456	1919 BELLAIR TERRACE	STUEBENVILLE	OHIO	43952
166	34-013819-000	EDWARD E. & SANDRA L. BALL	YES	0.344351	0.0004450	280001217000	Perry	Carrall	OH	0.0004450	1.0000000	0.0004450	841, BOX 71P	COLUPS	WEST VIRGINIA	26015
167	34-013819-000	DANIEL C. FULLER & DEBORAH F. FULLER	YES	0.124608	0.000161	280001218000	Perry	Carrall	OH	0.000161	1.0000000	0.000161	200 BLACON DRIVE	WERTON	WEST VIRGINIA	26062
168	34-000314-000	FRANK X. WEAVER, JR. AND FEGGY A. WEAVER	YES	0.10543	0.0001429	280001262000	Perry	Carrall	OH	0.0001429	1.0000000	0.0001429	7180 BARNHOUSE STREET	CARROLLTON	OHIO	44615
169	34-000314-000	FRANK X. WEAVER, JR. AND FEGGY A. WEAVER	YES	0.114784	0.0001483	280001262000	Perry	Carrall	OH	0.0001483	1.0000000	0.0001483	3792 N. GLENDRIDGE DRIVE	AKRON	OHIO	44319
170	34-000314-000	FRANK X. WEAVER, JR. AND FEGGY A. WEAVER	YES	0.114784	0.0001483	280001263000	Perry	Carrall	OH	0.0001483	1.0000000	0.0001483	3792 N. GLENDRIDGE DRIVE	AKRON	OHIO	44319
171	34-000314-000	FRANK X. WEAVER, JR. AND FEGGY A. WEAVER	YES	0.114784	0.0001483	280001263000	Perry	Carrall	OH	0.0001483	1.0000000	0.0001483	3792 N. GLENDRIDGE DRIVE	AKRON	OHIO	44319
172	34-036938-000	JOHN W. ELLIOTT	YES	0.344352	0.0004450	280001275000	Perry	Carrall	OH	0.0004450	1.0000000	0.0004450	7237 LAMP GREEN STREET SW	CARROLLTON	OHIO	44615
173	34-000397-001	PATRICIA MORROW AND JAMES MORROW	YES	0.114784	0.0001483	280001319000	Perry	Carrall	OH	0.0001483	1.0000000	0.0001483	1620 CALAMONNA AVE	LOUISVILLE	OHIO	44641
174	34-000397-001	PATRICIA MORROW AND JAMES MORROW	YES	0.114784	0.0001483	280001319000	Perry	Carrall	OH	0.0001483	1.0000000	0.0001483	1620 CALAMONNA AVE	LOUISVILLE	OHIO	44641
175	34-000397-001	PATRICIA MORROW AND JAMES MORROW	YES	0.114784	0.0001483	280001320000	Perry	Carrall	OH	0.0001483	1.0000000	0.0001483	1620 CALAMONNA AVE	LOUISVILLE	OHIO	44641
176	34-000397-001	PATRICIA MORROW AND JAMES MORROW	YES	0.114784	0.0001483	280001321000	Perry	Carrall	OH	0.0001483	1.0000000	0.0001483	1620 CALAMONNA AVE	LOUISVILLE	OHIO	44641
177	34-000397-001	PATRICIA MORROW AND JAMES MORROW	YES	0.114784	0.0001483	280001322000	Perry	Carrall	OH	0.0001483	1.0000000	0.0001483	1620 CALAMONNA AVE	LOUISVILLE	OHIO	44641
178	34-000397-001	PATRICIA MORROW AND JAMES MORROW	YES	0.114784	0.0001483	280001323000	Perry	Carrall	OH	0.0001483	1.0000000	0.0001483	1620 CALAMONNA AVE	LOUISVILLE	OHIO	44641
179	34-000397-001	PATRICIA MORROW AND JAMES MORROW	YES	0.114784	0.0001483	280001324000	Perry	Carrall	OH	0.0001483	1.0000000	0.0001483	1620 CALAMONNA AVE	LOUISVILLE	OHIO	44641
180	34-000397-001	PATRICIA MORROW AND JAMES MORROW	YES	0.114784	0.0001483	280001325000	Perry	Carrall	OH	0.0001483	1.0000000	0.0001483	1620 CALAMONNA AVE	LOUISVILLE	OHIO	44641
181	34-013819-000	DANIEL C. FULLER AND DEBORAH	YES	0.229568	0.0002967	280001381000	Perry	Carrall	OH	0.0002967	1.0000000	0.0002967	2360 BRAMBLE ROADS SW	CARROLLTON	OHIO	44615
182	34-013819-000	DANIEL C. FULLER AND DEBORAH	YES	0.229568	0.0002967	280001381000	Perry	Carrall	OH	0.0002967	1.0000000	0.0002967	2360 BRAMBLE ROADS SW	CARROLLTON	OHIO	44615
183	34-013819-000	DANIEL C. FULLER AND DEBORAH	YES	0.229568	0.0002967	280001381000	Perry	Carrall	OH	0.0002967	1.0000000	0.0002967	2360 BRAMBLE ROADS SW	CARROLLTON	OHIO	44615
184	34-013819-000	DANIEL C. FULLER AND DEBORAH	YES	0.229568	0.0002967	280001381000	Perry	Carrall	OH	0.0002967	1.0000000	0.0002967	2360 BRAMBLE ROADS SW	CARROLLTON	OHIO	44615

TRACT NUMBER	CHESAPEAKE LEASE ID NUMBER	LESSOR	LEASED YET/NO	SURFACE ACRES IN UNIT	TRACT PARTICIPATION	TAX MAP PARCEL ID NUMBERS	TOWNSHIP	COUNTY	STATE	UNIT WORKING INTEREST	CHESAPEAKE WORKING INTEREST	CHESAPEAKE UNIT PARTICIPATION	ENERVEST WORKING INTEREST	ENERVEST UNIT PARTICIPATION	ADDRESS	CITY	STATE	ZIP CODE
185	34-009748-000	MARK E. CROFT AND VICTORIA P. CROFT	YES	8.39397	0.009723	280001408200	Perry	Carrall	OH	0.0189733	1.000000	0.0095733			2102 AMSTERDAM ROAD SW	BOAVERSTON	OHIO	44695
186	34-009748-000	MARK E. CROFT AND VICTORIA P. CROFT	YES	0.07354	0.0009727	280001410000	Perry	Carrall	OH	0.0008777	1.000000	0.0008727			2102 AMSTERDAM ROAD SW	BOAVERSTON	OHIO	44695
187	34-015935-000	JAMES M. NELSON JR. AND MARTHA M. NELSON	YES	1.932105	0.0024968	280001411000	Perry	Carrall	OH	0.0024968	1.000000	0.0024968			2106 AMSTERDAM ROAD SW	BOAVERSTON	OHIO	44695
188	34-015935-000	JAMES M. NELSON JR. AND MARTHA M. NELSON	YES	1.424268	0.0018643	280001412000	Perry	Carrall	OH	0.0018643	1.000000	0.0018643			2106 AMSTERDAM ROAD SW	BOAVERSTON	OHIO	44695
189	34-043231-000	RONALD E. EDIE AND DONNA J.	YES	3.501874	0.0043277	280001467900	Perry	Carrall	OH	0.0043277	6.675000	0.0038398	0.1750000	0.0018679	2032 AMSTERDAM RD SW	BOAVERSTON	OHIO	44695
190	34-043231-000	RONALD E. EDIE AND DONNA J.	YES	12.821889	0.0167007	280001467902	Perry	Carrall	OH	0.0167007	6.675000	0.0104479	0.1750000	0.0062637	2032 AMSTERDAM RD SW	BOAVERSTON	OHIO	44695
191	34-0001315-000	ROGER M. ROWE AND ALISON A. ROWE	YES	5.793909	0.0064611	280001467903	Perry	Carrall	OH	0.0064611	1.000000	0.0064611			2039 AMSTERDAM RD SW	BOAVERSTON	OHIO	44695
192	13-092924-000	JEWEL M. MAYFIELD WIDOW	YES	6.814789	0.0006065	280001467906	Perry	Carrall	OH	0.0006065	1.000000	0.0008065			2071 AMSTERDAM RD SW	BOAVERSTON	OHIO	44695
193	34-0001315-000	ROGER M. ROWE AND ALISON A. ROWE	YES	4.964584	0.0053255	280001467907	Perry	Carrall	OH	0.0053255	1.000000	0.0053255			2039 AMSTERDAM RD SW	BOAVERSTON	OHIO	44695
194	34-0001315-000	SANDRA A. EBER	YES	6.658827	0.0008792	280001467908	Perry	Carrall	OH	0.0008792	1.000000	0.0008792			2061 AMSTERDAM RD SW	BOAVERSTON	OHIO	44695
195	34-003710-000	JANEEF S. SIMMONS AND NICHELE A. SIMMONS	YES	6.657973	0.0083449	280001467909	Perry	Carrall	OH	0.0083449	1.000000	0.0083449			2049 AMSTERDAM RD SW	BOAVERSTON	OHIO	44695
196	34-003710-000	JANEEF S. SIMMONS AND NICHELE A. SIMMONS	YES	6.118888	0.0078072	280001467910	Perry	Carrall	OH	0.0078072	1.000000	0.0078072			2049 AMSTERDAM RD SW	BOAVERSTON	OHIO	44695
197	34-015746-000	JUDIA A. PELUSO	YES	5.600973	0.0064626	280001467912	Perry	Carrall	OH	0.0064626	1.000000	0.0064626			2103 AMSTERDAM ROAD	BOAVERSTON	OHIO	44695
198	13-092924-000	JEWEL M. MAYFIELD WIDOW	YES	7.28032	0.0093405	280001467913	Perry	Carrall	OH	0.0093405	1.000000	0.0093405			2071 AMSTERDAM RD SW	BOAVERSTON	OHIO	44695
199	34-015008-000	RICK METZ AND LESAMETZ	YES	17.728865	0.0279103	280001467914	Perry	Carrall	OH	0.0279103	1.000000	0.0279103			1334 FELDSTONE CIRCLE	BOJAHAR	OHIO	44612
200	34-0078114-000	J. J. DETWILLER ENTERPRISES, INC.	YES	7.020688	0.0092884	280001467915	Perry	Carrall	OH	0.0092884	1.000000	0.0090884			2814 EDISON ST NW	UNIONTOWN	OHIO	44685
201	34-0001814-000	MARION L. HENDERSHOT, LARRY HENDERSHOT AND ALICE M. ADENBURGH	YES	3.179607	0.0041081	280001481000	Perry	Carrall	OH	0.0041081	1.000000	0.0041081			2017 AMSTERDAM ROAD SW	BOAVERSTON	OHIO	44695
203	34-008441-000	THE PALJANSKIUM WATERBURY CONSERVANCY DISTRICT	YES	174.149081	0.2250461	280000005000	Perry Charge	Carrall	OH	0.2250461	1.000000	0.2250461			1319 3RD ST NW, BOX 340	NEW PHILADELPHIA	OHIO	44663
202	PENDING	CARROLL COUNTY BOARD OF COMMISSIONERS	YES	4.482744	0.0057929	BARNSHOLE ALLOTMENT NO 2	Perry Charge	Carrall	OH	0.0057929	1.000000	0.0057929			119 SOUTH LIBBON ST, SUITE 201	CARROLLTON	OHIO	44615
204	PENDING	CARROLL COUNTY BOARD OF COMMISSIONERS	YES	2.874028	0.0037140	H-LAND PARK ALLOTMENT	Perry Charge	Carrall	OH	0.0037140	1.000000	0.0037140			119 SOUTH LIBBON ST, SUITE 201	CARROLLTON	OHIO	44615
205	34-0002680-000	CARROLL COUNTY BOARD OF COMMISSIONERS	YES	0.385418	0.0009722	LAKESHORE ALLOTMENT NO 1	Perry Charge	Carrall	OH	0.0009722	1.000000	0.0009722			119 SOUTH LIBBON ST, SUITE 201	CARROLLTON	OHIO	44615
				TOTAL LEASED ACRES:	773.110028	0.899004												
				TOTAL UNIT ACRES:	773.837418	1.226676%												

	CHESAPEAKE LEASE UNLEASED
--	---------------------------

EXHIBIT C

Unitized Parties

Attached to and made a part of that certain Unit Operating Agreement dated March 9, 2015 for the Edle North Unit.

TRACT NUMBER	LESSOR	ADDRESS	CITY	STATE	ZIP CODE	LEASED YES/NO	SURFACE ACRES IN UNIT	TRACT PARTICIPATION	TAX MAP PARCEL ID NUMBERS	TOWNSHIP	COUNTY	STATE	LESSOR WORKING INTEREST	UNIT PARTICIPATION
87	JAMES DEAN GREGORY	7080 BIRCH STREET	CARROLLTON	OHIO	44615	NO	0.037623666	0.0000486	2800000340000	Perry	Carroll	OH	0.00486%	0.00486%
95	RONALD S GESLAK	635 W MAIN ST	MALVERN	OHIO	44644	NO	0.344351426	0.0004450	2800000428000	Perry & Orange	Carroll	OH	0.04450%	0.04450%
96	RONALD S GESLAK	635 W MAIN ST	MALVERN	OHIO	44644	NO	0.344813124	0.0004456	2800000429000	Perry & Orange	Carroll	OH	0.04456%	0.04456%
TOTAL UNITIZED ACRES:								0.000939						
TOTAL UNIT ACRES:								773.837417						