



Ohio Department of Natural Resources

MIKE DEWINE, GOVERNOR

MARY MERTZ, DIRECTOR

Eric Vendel, Chief

Division of Oil and Gas Resources Management
2045 Morse Rd, Building F
Columbus, Ohio 43229
Phone: (614) 265-6922; Fax: (614) 265-6910

9489009000276359188877

ORDER BY THE CHIEF

March 1, 2024

ORDER NO. 2024-69

**TO: Gulfport Appalachia, LLC
713 Market Drive
Oklahoma City, OK 73114**

**RE: Application for Unitization
Kilburn III Unit
Monroe County, Ohio**

**SUBJECT: Order for Unit Operations of the Utica shale and Point Pleasant Formation
for the Kilburn III Unit**

Pursuant to Ohio Revised Code (“R.C.”) § 1509.28, the Chief of the Division of Oil and Gas Resources Management (“Chief” or “Division”) makes the following Findings and issues the following Order with respect to Gulfport Appalachia, LLC’s (“Gulfport”) Application for Unit Operations for the Kilburn III Unit:

DEFINITIONS:

As used in this order:

- 1) “Person” has the same meaning as in R.C. § 1509.01.
- 2) “Application” means the application of Gulfport Appalachia, LLC for Unit Operation of the Kilburn III Unit signed on November 10, 2023, and includes all updates, amendments, and supplements to it.
- 3) “Royalty interest owner” means a person or the estate of a person, other than a working interest owner, who owns the right to or interest in any portion of the oil and/or gas, or proceeds from the sale thereof, from a tract.

- 4) "Working interest" means an interest in oil and/or gas in the unit area by virtue of a lease, operating agreement, fee title, or otherwise, including a carried interest, the owner of which is obligated to pay, either in cash or out of production or otherwise a portion of the unit expense.
- 5) "Working interest owner" means a person or the estate of a person who owns an interest in oil and/or gas in the unit area by virtue of a lease, operating agreement, fee title, or otherwise, including a carried interest, the owner of which is obligated to pay, either in cash or out of production or otherwise a portion of the unit expense. "Working interest owner" does not include an unleased mineral owner.
- 6) "Unleased mineral owner" means a royalty interest owner who owns oil and/or gas rights free of a lease or other instrument conveying all or any portion of the working interest in such rights to another. At the time of this order, the unleased mineral owners identified by Gulfport include those listed on Exhibit A.
- 7) "Consenting working interest owner" means any working interest owner who enters into an agreement with Gulfport pertaining to the operation of the Kilburn III Unit.
- 8) "Non-consenting working interest owner" means a working interest owner who does not enter into an agreement with Gulfport pertaining to the operation of the Kilburn III Unit. At the time of this order, the non-consenting working interest owners were identified by Gulfport include those listed as leased on Exhibit A with a 0.000% consenting working interest percentage.
- 9) "Gas" has the same meaning as in R.C. § 1509.01.
- 10) "Oil" has the same meaning as in R.C. § 1509.01.
- 11) "Unit Area" means all of the lands, oil and gas leases and/or oil and gas interests of the tracts as shown in Exhibit A totaling 677.829 acres located in Center Township and Summit Township, Monroe County, Ohio as shown in Exhibit B.
- 12) "Unit Participation" means the ratio of the surface acreage of a specific tract in the unit area to the total surface acreage of the unit area as that total surface acreage is specified in paragraph one of the Plan for Unit Operations of this order.
- 13) "Gross Proceeds" means a share of the gross production of oil, gas, condensate, and natural gas liquids free of any and all cost of producing, gathering, storing, separating, treating, dehydrating, compressing, processing, transporting, marketing, or pipeline construction and maintenance.
- 14) "Net Proceeds" means the share of gross production of oil, gas, condensate, or natural gas liquids after payment of all costs of producing, gathering, storing, separating, treating, dehydrating, compressing, processing, transporting, and marketing and taxes.

BACKGROUND:

- 1) Gulfport filed the application pursuant to R.C. § 1509.28 to conduct unit operations.
- 2) Pursuant to R.C. § 1509.28, the Division held a hearing on January 3, 2024. The hearing was held to consider the need for the operation as a unit of an entire pool or part thereof. Gulfport representatives provided testimony on the application and answered questions from Division staff.
- 3) The unit operations will occur at an approximate true vertical depth located from the top of the Utica shale to the base of the Point Pleasant Formation.

FINDINGS:

- 1) Based on the application and testimony by Gulfport's representatives, the Chief finds that Gulfport has established that it is the "owner," as that term is defined in R.C. § 1509.01(K), of greater than 65% of the land area overlying the pool in the Kilburn III Unit as required by R.C. § 1509.28(A).
- 2) Based on the application and testimony by Gulfport's representatives, the Chief finds that the operation of the Kilburn III Unit is reasonably necessary to increase substantially the ultimate recovery of oil and gas.
- 3) Based on the application and testimony by Gulfport's representatives, the Chief finds the value of the estimated additional recovery of oil or gas from the Kilburn III Unit exceeds the estimated additional cost incident to conducting the operation of the Kilburn III Unit.

ORDER:

IT IS HEREBY ORDERED:

Pursuant to R.C. § 1509.28, Gulfport is authorized to conduct operations within the Kilburn III Unit in accordance with all of the following:

Plan for Unit Operations

- 1) The unit area is comprised of the tracts totaling 677.829 acres located in Center Township, and Summit Township, Monroe County, Ohio as shown in Exhibit B.
- 2) Gulfport proposes to drill one well in the Kilburn III Unit for the purpose of recovering oil and gas. Gulfport shall drill at least one well to total measured depth as specified in the application in the unit area within 12 months from the date of approval of this Order as prescribed in Paragraph 10 of this order. If Gulfport fails to drill at least one well to total

measured depth as specified in the application in the unit area within 12 months from the date of approval of this Order as prescribed in Paragraph 10 of this order, the Chief may revoke this order. In order to achieve the stated goal of substantially increasing the ultimate recovery of oil and gas from the Utica shale and Point Pleasant Formation within the unit area, Gulfport shall produce from one well no later than two years after the date of approval of this order. If Gulfport fails to drill, complete, and produce at least one well in the unit area, the Chief may amend or revoke this order. Any additional wells permitted by the Chief for the Utica shale and Point Pleasant Formation in the unit area are subject to this order.

- 3) Information from Gulfport for the Kilburn III Unit establishes that the Utica shale and Point Pleasant Formation uniformly underlies the unit area. Therefore, the allocated share of production to each tract shall be equal to that tract's unit participation.
- 4) Except as provided in Paragraph 9(d) of this order, all charges and credits made for investments in wells, tanks, pumps, machinery, materials, and equipment contributed to the Kilburn III Unit operations shall be allocated among the working interest owners of each tract based on the unit participation. The proportionate share of the expenses attributable to tracts of the unleased mineral owners shall be allocated to Gulfport and the working interest owners.
- 5) All unit operation expenses, including capital investment, shall be charged to, and paid by, Gulfport and working interest owners in amounts based on the unit participation plus their proportionate share of the expenses attributable to the tracts of unleased mineral owners. All unit operation expenses concerning wells and operating equipment shall be just and reasonable.
- 6) If necessary, Gulfport and the consenting working interest owners shall carry, or otherwise finance, any non-consenting working interest owners who are unable to meet their financial obligations in connection with the unit operations. Gulfport and all other consenting working interest owners' reasonable interest charge for carrying or financing the non-consenting working interest owners shall be determined by the terms of Gulfport's Unit Agreement and Model Form Operating Agreement for the Kilburn III Unit. Once a specific cost is charged to the initial well, that same cost cannot be charged to subsequent wells in the unit area.
- 7) Gulfport shall supervise and conduct all unit operations. Each working interest owner shall have a voting interest equal to its Unit Participation. Approval of unit operations shall be subject to the terms of Gulfport's Unit Agreement and Model Form Operating Agreement for the Kilburn III Unit.
- 8) Unit operations may commence as of 7:00 a.m. on the day following the date of approval of this order as prescribed in Paragraph 10 of this order. Once the initial well is placed into production, operations within the Kilburn III Unit may continue as long as hydrocarbons are produced from any well in the unit area without a cessation of more than 90 days, unless

otherwise approved by the Chief in writing. The Kilburn III Unit may be terminated if working interest owners owning at least 51% of the working interest in the unit area determine that the unit operations are no longer warranted. If the unit operations are so terminated, Gulfport shall provide written notice of the termination to the Division and to all unleased mineral owners. In addition to the notice of termination, Gulfport shall provide an affidavit to the Division attesting to the basis of the termination and all dates applicable to that basis. If termination of unit operations occurs prior to drilling and completing for production of one well in the Kilburn III Unit, the Chief may amend this order.

- 9) The following additional provisions are found to be appropriate:
- a) No activity associated with the drilling, completion, or operation of the Kilburn III Unit shall be conducted on the surface of any unleased property without the prior written consent of the owner of the surface rights of the unleased property.
 - b) Unleased mineral owners shall not incur liability for any personal or property damage associated with any drilling, testing, completing, producing, operating, or plugging and restoration activities within the Kilburn III Unit.
 - c) Each unleased mineral owner shall receive a monthly cash payment equal to a one-eighth share of the gross proceeds from production. Allocation of the one-eighth share shall be based on the unit participation of each unleased mineral owner's tract. Gulfport shall make monthly cash payments to all unleased mineral owners at the same time the royalty interest owners are paid.
 - d) In addition to the cash payment specified in paragraph 9(c) of this Order, each unleased mineral owner shall receive a monthly cash payment equal to a seven-eighths share of the net proceeds from production. Allocation of the seven-eighths share shall be based on the unit participation of each unleased mineral owner's tract. After Gulfport recovers 200% of the cost of drilling, testing, and completing the initial well, Gulfport shall begin making the monthly payments to the unleased mineral owners for that well. For each additional well drilled in the unit area, Gulfport shall begin making monthly payments equal to seven-eighths share of net proceeds from production to each unleased mineral owner once the working interest owners have recovered 150% of the cost of drilling, testing, and completing each additional well. Once a specific cost is charged to the initial well, that same cost cannot be charged to subsequent wells in the unit area.
 - e) Nothing in this order prohibits an unleased mineral owner from entering into a lease agreement with Gulfport or with any other person. An unleased mineral owner who enters into a lease of their mineral interests with any person after the issuance of this order is no longer an unleased mineral owner under this order as of the effective date of the lease. Gulfport shall notify the Division upon the execution of a lease agreement with any unleased mineral owner who is subject to this order.

- f) Except as provided in Paragraph 9(d) of this order, no expenses shall be paid by an unleased mineral owner for drilling, testing, completing, producing, or operating any well in the unit area. Moreover, unleased mineral owners are not responsible for any costs related to plugging any well or any restoration in the unit area.
- g) If requested in writing by any unleased mineral owner or by any non-consenting working interest owner, or in any manner by the Division, Gulfport shall provide, not later than 30 days after the request, any of the following:
 - i. A monthly statement of all costs incurred, together with the quantity of oil and gas produced, and the amount of proceeds realized from the sale of production during the preceding month; and
 - ii. Any authorization for expenditure (AFE) prepared by Gulfport; and
 - iii. A statement of all costs and expenses for purposes of Paragraphs 6 and 9(d) of this order.
- h) Gulfport shall notify the Division of the assignment or transfer of any of its working interest in the Kilburn III Unit. If Gulfport assigns or transfers any of its working interest, the assignee or transferee shall comply with this order. Within 60 days of the notice of assignment or transfer, Gulfport shall file a copy of the notice with each applicable county recorder's office in the records of each of the tracts that are subject to this order and referenced in Exhibit B of this order. Gulfport shall submit a certification of the filing to the Division within 14 days of filing.
- i) Gulfport shall notify the Division within 30 days if a person that is leased by Gulfport, or any other consenting working interest owner, for purposes of operating the Kilburn III Unit becomes unleased. If a person becomes unleased, the person is an unleased owner under this order and paragraphs 9(a) through 9(g) of this order apply.
- j) Gulfport shall notify the Division if any consenting working interest owner revokes, rescinds, or otherwise terminates the agreement with Gulfport pertaining to the operation of the Kilburn III Unit. If a consenting working interest owner revokes, rescinds, or otherwise terminates the agreement with Gulfport, the working interest owner becomes a non-consenting working interest owner pursuant to this order. Gulfport also shall notify the Division if any consenting working interest owner assigns or transfers all or part of its working interest in the Kilburn III Unit. All such assignees or transferees are subject to this order.
- k) Gulfport shall notify the Division if any non-consenting working interest owner enters into an agreement with Gulfport pertaining to the operation of the Kilburn III Unit. If a non-consenting working interest owner enters into an agreement with

Gulfport, the non-consenting working interest owner becomes a consenting working interest owner pursuant to this order.

- 1) If at any point Gulfport and consenting working interest owners own less than 65% of the unit, the Chief may amend or revoke this order.
- 10) This order becomes effective on the date Gulfport provides the Chief with final written approval of the unit operations as prescribed in this order by Gulfport and consenting working interest owners, and also by the royalty interest owners or, with respect to unleased acreage, unleased mineral owners of 65% of the acreage to be included in the unit. Unit operations may commence as set forth in Paragraph 8 of this Order. If Gulfport fails to provide all required approvals by September 1, 2024, the order is revoked, and the Chief shall provide notice of the revocation to Gulfport and to all persons listed in Exhibit A to this order.
- 11) If this Chief's Order is appealed, the time periods specified in this order are tolled pending final determination of the appeal.
- 12) Within 21 days of this order becoming effective, Gulfport shall file a copy of this order with each applicable county recorder's office in the records of each of the tracts that are subject to this order and referenced in Exhibit B of this order. Gulfport shall submit a certification of the filing to the Division within 14 days of filing. The certification shall include a reference to the volume and page number corresponding to each record where the Chief's Order is recorded.
- 13) The Chief of the Division retains continuing jurisdiction over the Kilburn III Unit as is consistent with the Chief's powers and duties as established by R.C. Chapter 1509 and Ohio Admin. Code 1501:9. The Chief reserves the right to amend or revoke this Order subsequent to the commencement of unit operations within the unit area.
- 14) Except as specifically set forth in the terms of this order, nothing herein shall be construed as a release or waiver of any private right, obligation, duty, claim, or cause of action.

- 15) If there is a conflict between the terms of this Chief's Order and any part of Gulfport's application, the Chief's Order takes precedence.

March 1, 2024

Eric Vendel

Date

/s/

Eric Vendel, Chief
Division of Oil and Gas Resources Management

Addressee is hereby notified that this action is final and effective and may be appealed pursuant to Section 1509.36 of the Ohio Revised Code. If the Order is appealed to the Ohio Oil and Gas Commission, the appeal must be in writing and must set forth the Orders complained of and the grounds upon which the appeal is based. Such appeal must be filed with the Oil and Gas Commission, 2045 Morse Road, Building E-1, Office 103, Columbus, Ohio 43229-6693, within 30 days after the date upon which the person to whom the Order was issued received the order and, for all other persons adversely affected by the order, within 30 days after the date of the Order.

In addition, within three days after the appeal is filed with the Oil and Gas Commission, notice of the filing must be submitted to Eric Vendel, Chief, Division of Oil and Gas Resources Management, Ohio Department of Natural Resources, 2045 Morse Road, Building F, Columbus, Ohio 43229-6693.

Enclosures: Exhibit A
Exhibit B

Kilburn III Unit Chiefs Order Exhibit A

All Mineral Owners in the Proposed Kilburn III Unit													Exhibit A					
Tract Number	Lease ID Number (optional)	Mineral Owner	Leased Yes or No	Decimal Interest in Tract	Surface Acres in Unit (Net)	Tract Participation in Unit (Net)	Tax Map Parcel ID	Township	County	Consenting Working Interest Percentage	Applicant Working Interest Percentage	Antero Resources Corporation Working Interest Percentage	P P & G OH Co. LLC Working Interest Percentage	Address	City	State	Zip	Changes
1	GPOR	J&S Reusser, FLP, L, an Ohio Family Partnership Attn: Jeffrey Reusser	Yes	1.000	28.23200	4.168013%	22-006010.0000	Summit	Monroe	4.168013%	4.168013%	0.000000%	0.000000%	7659 Westfield Road	Medina	OH	44256	None.
2	GPOR	Tari Jobey	Yes	1.000	13.11300	1.934559%	22-006015.0000	Summit	Monroe	1.934559%	1.934559%	0.000000%	0.000000%	35892 Rusbeck Road	Lewistville	OH	43754	None.
3	GPOR	Cory N. Bott and Jamie C. Bott, husband and wife, as survivorship tenants	Yes	0.390	20.27818	2.991636%	22-006009.0000	Summit	Monroe	2.991636%	2.991636%	0.000000%	0.000000%	205 Sapphire Point	Anderson	SC	29626	None.
3	GPOR	Bounty Minerals, LLC Attn: Tracee K. Palmer	Yes	0.610	31.69982	4.676679%	22-006009.0000	Summit	Monroe	4.676679%	4.676679%	0.000000%	0.000000%	777 Main Street, Suite 3400	Fort Worth	TX	76102	None.
4	GPOR	Blake Kilburn Tan Jobey	Yes	1.000	6.37880	0.940945%	04-005004.0000	Center	Monroe	0.940945%	0.940945%	0.000000%	0.000000%	35892 Rusbeck Road	Lewistville	OH	43754	Corrected Mineral Owner Name and Address.
5	Non-Consenting Working Interest	Lynn Reusser and Yvonne Reusser, husband and wife, as survivorship tenants	Yes	1.000	17.14200	2.528956%	22-006003.0000	Summit	Monroe	0.000000%	0.000000%	2.528956%	0.000000%	35642 Township Road 44	Lewistville	TX	43754	None.
6	Non-Consenting Working Interest	Lynn Reusser and Yvonne Reusser, husband and wife, as survivorship tenants	Yes	0.168	0.22294	0.032891%	22-006014.0000	Summit	Monroe	0.000000%	0.000000%	0.032891%	0.000000%	104 South Sycamore Street	Woodfield	OH	43793	None.
6	Non-Consenting Working Interest	Lynn Jordan Reusser, single	Yes	0.085	0.11314	0.016691%	22-006014.0000	Summit	Monroe	0.000000%	0.000000%	0.016691%	0.000000%	104 South Sycamore Street	Woodfield	OH	43793	None.
6	Non-Consenting Working Interest	Nadine Bott, married	Yes	0.050	0.06655	0.009818%	22-006014.0000	Summit	Monroe	0.000000%	0.000000%	0.009818%	0.000000%	104 South Sycamore Street	Woodfield	OH	43793	None.
6	Non-Consenting Working Interest	Karen Reusser, married	Yes	0.158	0.20963	0.030927%	22-006014.0000	Summit	Monroe	0.000000%	0.000000%	0.030927%	0.000000%	104 South Sycamore Street	Woodfield	OH	43793	None.
6	Non-Consenting Working Interest	Charles L. Brooks	Yes	0.490	0.65219	0.096217%	22-006014.0000	Summit	Monroe	0.000000%	0.000000%	0.096217%	0.000000%	204 Center Street	Woodfield	OH	43793	Corrected Address.
6	Non-Consenting Working Interest	George Reusser, single	Yes	0.050	0.06655	0.009818%	22-006014.0000	Summit	Monroe	0.000000%	0.000000%	0.009818%	0.000000%	104 South Sycamore Street	Woodfield	OH	43793	None.
7	GPOR	J&S Reusser, FLP, L, an Ohio Family Partnership Attn: Jeffrey Reusser	Yes	1.000	0.00200	0.000292%	04-005007.0000	Center	Monroe	0.000292%	0.000292%	0.000000%	0.000000%	7659 Westfield Road	Medina	OH	44256	None.
8	Unleased Mineral Interest	Charles L. Brooks	No	1.000	1.89900	0.280159%	04-005005.0000	Center	Monroe	0.000000%	0.000000%	0.000000%	0.000000%	204 Center Street	Woodfield	OH	43793	Updated Lease Status and Corrected Address.
9	GPOR	Lynn Reusser and Yvonne Reusser, husband and wife, as survivorship tenants	Yes	0.500	6.16200	0.909079%	04-018013.1000	Center	Monroe	0.909079%	0.909079%	0.000000%	0.000000%	104 South Sycamore Street	Woodfield	OH	43793	None.
9	GPOR	Janet M. Ryan	Yes	0.208	2.56750	0.378782%	04-018013.1000	Center	Monroe	0.378782%	0.378782%	0.000000%	0.000000%	2604 S. Robins Bow	Bloomington	IN	47401	None.
9	GPOR	Edward P. Ryan	Yes	0.042	0.51350	0.075757%	04-018013.1000	Center	Monroe	0.075757%	0.075757%	0.000000%	0.000000%	2604 S. Robins Bow	Bloomington	IN	47401	None.
9	GPOR	Edward T. Ryan	Yes	0.042	0.51350	0.075757%	04-018013.1000	Center	Monroe	0.075757%	0.075757%	0.000000%	0.000000%	488 Town Hill Road W.	Nashville	IN	47448	None.
9	GPOR	Robert M. Ryan	Yes	0.042	0.51350	0.075757%	04-018013.1000	Center	Monroe	0.075757%	0.075757%	0.000000%	0.000000%	7910 Sunnyside Lane	Charlotte	NC	28210	None.
9	GPOR	Beverly Jean Staudt	Yes	0.056	0.68467	0.101010%	04-018013.1000	Center	Monroe	0.101010%	0.101010%	0.000000%	0.000000%	2795 St. Andrew Square, Apt. 1715	Alison Park	PA	15101	None.
9	GPOR	Mary A. Staudt	Yes	0.111	1.36933	0.202017%	04-018013.1000	Center	Monroe	0.202017%	0.202017%	0.000000%	0.000000%	128 Boothbay Harbor	Bradford Woods	PA	15015	None.
10	Non-Consenting Working Interest	Ray L. Weber and Patricia F. Weber, as survivorship tenants	Yes	1.000	81.73100	12.057761%	04-005003.0000	Center	Monroe	12.057761%	12.057761%	0.000000%	0.000000%	36126 Rusbeck Road	Woodfield	OH	43793	None.
11	Non-Consenting Working Interest	Charles L. Brooks	Yes	1.000	0.53600	0.079076%	22-006005.0000	Summit	Monroe	0.000000%	0.000000%	0.079076%	0.000000%	204 Center Street	Woodfield	OH	43793	None.
12	Non-Consenting Working Interest	Lynn Reusser and Yvonne Reusser, husband and wife, as survivorship tenants	Yes	1.000	75.85500	11.190875%	04-018006.0000	Center	Monroe	0.000000%	0.000000%	11.190875%	0.000000%	104 South Sycamore Street	Woodfield	OH	43793	None.
13	Unleased Mineral Interest	Charles L. Brooks	No	1.000	15.61000	2.302941%	04-018003.0000	Center	Monroe	0.000000%	0.000000%	0.000000%	0.000000%	204 Center Street	Woodfield	OH	43793	Updated Lease Status.
14	GPOR / Non-Consenting Working Interest	Teresa C. Cook*	Yes	1.000	38.33100	5.654966%	04-018012.0000	Center	Monroe	4.871584%	4.871584%	0.000000%	0.000000%	36672 Township Road 42	Woodfield	OH	43793	None.
15	GPOR	Lynn Reusser and Yvonne Reusser, husband and wife, as survivorship tenants	Yes	1.000	8.67900	1.279084%	04-018013.0000	Center	Monroe	1.279084%	1.279084%	0.000000%	0.000000%	104 South Sycamore Street	Woodfield	OH	43793	None.
16	GPOR	Gary L. Hudson and wife, Nancy J. Hudson, as survivorship tenants	Yes	1.000	8.64700	1.275697%	04-018009.0000	Center	Monroe	1.275697%	1.275697%	0.000000%	0.000000%	47820 Rural Road	Woodfield	OH	43793	Updated Lease Status.
17	GPOR	Gary A. Ciesleczyk*	Yes	0.112	6.30750	0.930544%	04-019004.0000	Center	Monroe	0.930544%	0.930544%	0.000000%	0.000000%	4070 Mandariner Road 42	North Lawrence	OH	44666	None.
17	GPOR	Vine Kovaly, LP*	Yes	0.888	50.01850	7.379221%	04-019004.0000	Center	Monroe	7.379221%	7.379221%	0.000000%	0.000000%	600 Travis Street, Suite 2100	Houston	TX	77002	None.
18	GPOR	Richard Subburger and Karen Subburger, husband and wife, as survivorship tenants*	Yes	1.000	6.61700	0.976205%	04-019036.0000	Center	Monroe	0.976205%	0.976205%	0.000000%	0.000000%	46800 Yojo Road	Woodfield	OH	43793	None.
19	Non-Consenting Working Interest	Gary A. Ciesleczyk*	Yes	1.000	0.96500	0.142366%	04-018010.0000	Center	Monroe	0.000000%	0.000000%	0.142366%	0.000000%	4076 Mandariner Road	North Lawrence	OH	44666	None.
20	GPOR	Gary A. Ciesleczyk*	Yes	1.000	0.80900	0.119332%	04-018016.0000	Center	Monroe	0.119332%	0.119332%	0.000000%	0.000000%	4076 Mandariner Road	North Lawrence	OH	44666	None.
21	GPOR	Richard Subburger and Karen Subburger, husband and wife, as survivorship tenants*	Yes	1.000	6.86900	1.013382%	04-019012.0000	Center	Monroe	1.013382%	1.013382%	0.000000%	0.000000%	46800 Yojo Road	Woodfield	OH	43793	None.
22	GPOR	Michael W. Tenzel	Yes	1.000	1.61900	0.238851%	04-019026.0000	Center	Monroe	0.238851%	0.238851%	0.000000%	0.000000%	36731 State Route 78	Lewistville	OH	43754	None.
23	GPOR	Gary Cook and wife, Judith Cook*	Yes	1.000	19.83900	2.929795%	04-018008.0000	Center	Monroe	2.929795%	2.929795%	0.000000%	0.000000%	36870 Township Road 42	Woodfield	OH	43793	None.
24	GPOR	Lynn Reusser, a married man	Yes	0.400	6.35080	0.936932%	04-018008.0000	Center	Monroe	0.936932%	0.936932%	0.000000%	0.000000%	47443 Rural Road	Woodfield	OH	43793	None.
24	Unleased Mineral Interest	The Heirs of Lewis D. Weber, deceased	No	0.200	3.17540	0.468466%	04-018008.0000	Center	Monroe	0.000000%	0.000000%	0.000000%	0.000000%	Unknown	Unknown	Unknown	Unknown	Updated Lease Status.
24	Unleased Mineral Interest	The Heirs of Alice Leck, deceased	No	0.200	3.17540	0.468466%	04-018008.0000	Center	Monroe	0.000000%	0.000000%	0.000000%	0.000000%	Unknown	Unknown	Unknown	Unknown	Updated Lease Status.
24	Unleased Mineral Interest	The Heirs of William Supleton, deceased	No	0.200	3.17540	0.468466%	04-018008.0000	Center	Monroe	0.000000%	0.000000%	0.000000%	0.000000%	Unknown	Unknown	Unknown	Unknown	Updated Lease Status.
25	GPOR	Lawrence James Hubbard and wife, Michelle Hubbard	Yes	1.000	4.52800	0.668015%	04-018007.0000	Center	Monroe	0.668015%	0.668015%	0.000000%	0.000000%	1019 Willow Ridge Drive	Hendersonville	NC	28739	None.

26	Non-Consenting Working Interest	Sammy Adv and June A. Adv, husband and wife, as survivorship tenants	Yes	1.000	49.57200	7.313349%	04-018002.0000	Center	Moore	0.0000000%	0.0000000%	0.0000000%	7.313349%	0.0000000%	0.0000000%	46763 Township Road 45A	Lewisville	OH	43754	None
27	GPOR	Michael L. Hogue	Yes	0.333	0.00500	0.000738%	04-019017.0000	Center	Moore	0.000738%	0.000738%	0.000738%	0.000738%	0.000000%	0.000000%	46867 Yoho Road	Woodfield	OH	43793	None
27	GPOR	Alan Shane Hogue	Yes	0.333	0.00500	0.000738%	04-019017.0000	Center	Moore	0.000738%	0.000738%	0.000738%	0.000738%	0.000000%	0.000000%	46867 Yoho Road	Woodfield	OH	43793	None
27	GPOR	Lori A. Derkes	Yes	0.333	0.00500	0.000738%	04-019017.0000	Center	Moore	0.000738%	0.000738%	0.000738%	0.000738%	0.000000%	0.000000%	46867 Yoho Road	Woodfield	OH	43793	None
28	GPOR	Michael L. Hogue	Yes	0.333	0.06300	0.009294%	04-019013.0000	Center	Moore	0.009294%	0.009294%	0.009294%	0.009294%	0.000000%	0.000000%	46867 Yoho Road	Woodfield	OH	43793	None
28	GPOR	Alan Shane Hogue	Yes	0.333	0.06300	0.009294%	04-019013.0000	Center	Moore	0.009294%	0.009294%	0.009294%	0.009294%	0.000000%	0.000000%	46867 Yoho Road	Woodfield	OH	43793	None
28	GPOR	Lori A. Derkes	Yes	0.333	0.06300	0.009294%	04-019013.0000	Center	Moore	0.009294%	0.009294%	0.009294%	0.009294%	0.000000%	0.000000%	46867 Yoho Road	Woodfield	OH	43793	None
29	GPOR	Gary A. Ciesielecki*	Yes	1.000	0.31000	0.045734%	04-017023.0000	Center	Moore	0.045734%	0.045734%	0.045734%	0.045734%	0.000000%	0.000000%	4076 Mandeville Road	North Lawrence	OH	44666	None
30	GPOR	Gary A. Ciesielecki*	Yes	1.000	0.02700	0.003983%	04-017005.0000	Center	Moore	0.003983%	0.003983%	0.003983%	0.003983%	0.000000%	0.000000%	4076 Mandeville Road	North Lawrence	OH	44666	None
31	GPOR	Kenneth C. Young and Shelley A. Young, husband and wife, for their joint lives, remainder to the survivor of them*	Yes	1.000	0.47400	0.069929%	04-019019.0000	Center	Moore	0.069929%	0.069929%	0.069929%	0.069929%	0.000000%	0.000000%	36920 State Route 78	Woodfield	OH	43793	None
32	GPOR	Barbara Ann (Yoho) Hamilton	Yes	1.000	0.02700	0.010917%	04-019041.0000	Center	Moore	0.010917%	0.010917%	0.010917%	0.010917%	0.000000%	0.000000%	4115 Onville Road	Granville	OH	43023	None
33	Unleased Mineral Interest	Kenneth C. Young and Shelley A. Young, husband and wife, for their joint lives, remainder to the survivor of them	No	1.000	0.95900	0.141481%	04-020007.0000	Center	Moore	0.000000%	0.000000%	0.000000%	0.000000%	0.000000%	0.000000%	36920 State Route 78	Woodfield	OH	43793	None
34	GPOR	Alan Shane Hogue	Yes	0.208	0.04021	0.005932%	04-020008.0000	Center	Moore	0.005932%	0.005932%	0.005932%	0.005932%	0.000000%	0.000000%	47488 Swazey Road	Lewisville	OH	43754	None
34	GPOR	Michael L. Hogue and Trina Hogue, husband and wife, as survivorship tenants	Yes	0.208	0.04021	0.005932%	04-020008.0000	Center	Moore	0.005932%	0.005932%	0.005932%	0.005932%	0.000000%	0.000000%	46867 Yoho Road	Woodfield	OH	43793	None
34	GPOR	Lori A. Derkes	Yes	0.208	0.04021	0.005932%	04-020008.0000	Center	Moore	0.005932%	0.005932%	0.005932%	0.005932%	0.000000%	0.000000%	43360 Mt. Carrick Road	Woodfield	OH	43793	None
34	GPOR	Bonnie Reichenbuhler	Yes	0.188	0.03619	0.005339%	04-020008.0000	Center	Moore	0.005339%	0.005339%	0.005339%	0.005339%	0.000000%	0.000000%	47961 State Route 78	Woodfield	OH	43793	None
34	GPOR	Sharon Weber	Yes	0.188	0.03619	0.005339%	04-020008.0000	Center	Moore	0.005339%	0.005339%	0.005339%	0.005339%	0.000000%	0.000000%	104 Peach Blenheim Lane	Woodfield	OH	43793	None
35	GPOR	Beta Energy Partners, LLC	Yes	0.500	4.50150	0.664106%	04-020006.0000	Center	Moore	0.664106%	0.664106%	0.664106%	0.664106%	0.000000%	0.000000%	14 Parrell Ridge Drive	Seymour	TX	77479	None
35	GPOR	Alm, Ryan A. Turner	Yes	0.500	4.50150	0.664106%	04-020006.0000	Center	Moore	0.664106%	0.664106%	0.664106%	0.664106%	0.000000%	0.000000%	777 Main Street, Suite 3400	Fort Worth	TX	76102	None
36	Unleased Mineral Interest	Bonny Minerals, LLC	No	0.333	0.36667	0.054094%	04-020017.0000	Center	Moore	0.000000%	0.000000%	0.000000%	0.000000%	0.000000%	0.000000%	46867 Yoho Road	Woodfield	OH	43793	None
36	Unleased Mineral Interest	Alan Shane Hogue	No	0.333	0.36667	0.054094%	04-020017.0000	Center	Moore	0.000000%	0.000000%	0.000000%	0.000000%	0.000000%	0.000000%	47488 Swazey Road	Lewisville	OH	43754	None
36	Unleased Mineral Interest	Lori A. Derkes	No	0.333	0.36667	0.054094%	04-020017.0000	Center	Moore	0.000000%	0.000000%	0.000000%	0.000000%	0.000000%	0.000000%	43360 Mount Carick Road	Woodfield	OH	43793	None
37	Unleased Mineral Interest	Barbara Ann (Yoho) Hamilton	Yes	1.000	0.59000	0.087043%	04-019040.0000	Center	Moore	0.087043%	0.087043%	0.087043%	0.087043%	0.000000%	0.000000%	9900 Osprey Court	Thornville	OH	43706	None
38	GPOR	Michael L. Hogue and Trina Hogue, husband and wife, as survivorship tenants	Yes	0.333	1.53500	0.226015%	04-020026.0000	Center	Moore	0.226015%	0.226015%	0.226015%	0.226015%	0.000000%	0.000000%	46867 Yoho Road	Woodfield	OH	43793	None
38	GPOR	Alan Shane Hogue	Yes	0.333	1.53500	0.226015%	04-020026.0000	Center	Moore	0.226015%	0.226015%	0.226015%	0.226015%	0.000000%	0.000000%	47488 Swazey Road	Lewisville	OH	43754	None
38	GPOR	Lori A. Derkes	Yes	0.333	1.53500	0.226015%	04-020026.0000	Center	Moore	0.226015%	0.226015%	0.226015%	0.226015%	0.000000%	0.000000%	43360 Mount Carick Road	Woodfield	OH	43793	None
39	GPOR	Richard Sulzberger and Karen Sulzberger, husband and wife, as survivorship tenants*	Yes	1.000	26.32600	3.883879%	04-020003.0000	Center	Moore	3.883879%	3.883879%	3.883879%	3.883879%	0.000000%	0.000000%	46800 Yoho Road	Woodfield	OH	43793	None
40	GPOR	Michael W. Yantz	Yes	1.000	0.70000	0.103271%	04-020038.0000	Center	Moore	0.103271%	0.103271%	0.103271%	0.103271%	0.000000%	0.000000%	36731 State Route 78	Lewisville	OH	43754	None
41A	GPOR	Richard Sulzberger and Karen Sulzberger, husband and wife, as survivorship tenants*	Yes	0.500	7.11050	1.049011%	04-020012.0000	Center	Moore	1.049011%	1.049011%	1.049011%	1.049011%	0.000000%	0.000000%	46800 Yoho Road	Woodfield	OH	43793	None
41A	GPOR	AMP V, LP*	Yes	0.500	7.11050	1.049011%	04-020012.0000	Center	Moore	1.049011%	1.049011%	1.049011%	1.049011%	0.000000%	0.000000%	225 Ross St., Suite 301	Pittsburgh	PA	15219	None
41B	GPOR	Richard Sulzberger and Karen Sulzberger, husband and wife, as survivorship tenants	Yes	0.500	9.40800	1.387961%	04-020012.0000	Center	Moore	1.387961%	1.387961%	1.387961%	1.387961%	0.000000%	0.000000%	46800 Yoho Road	Woodfield	OH	43793	None
41B	Unleased Mineral Interest	AMP V, LP	No	0.500	9.40800	1.387961%	04-020012.0000	Center	Moore	0.000000%	0.000000%	0.000000%	0.000000%	0.000000%	0.000000%	225 Ross St., Suite 301	Pittsburgh	PA	15219	None
42	GPOR	Barbara Ann (Yoho) Hamilton	Yes	1.000	0.42100	0.062119%	04-020013.0000	Center	Moore	0.062119%	0.062119%	0.062119%	0.062119%	0.000000%	0.000000%	9900 Osprey Court	Thornville	OH	43706	None
43	GPOR	George F. Rockman and Linda C. Rockman, husband and wife, as survivorship tenants	Yes	1.000	2.87800	0.424591%	04-019027.0000	Center	Moore	0.424591%	0.424591%	0.424591%	0.424591%	0.000000%	0.000000%	50836 State Route 145	Mellega	OH	43757	None
44	GPOR	AMP V, LP	Yes	1.000	64.53000	9.523051%	04-020042.0000	Center	Moore	9.523051%	9.523051%	9.523051%	9.523051%	0.000000%	0.000000%	225 Ross St., Suite 301	Pittsburgh	PA	15219	None
45	GPOR	AMP V, LP	Yes	1.000	2.95700	0.436246%	04-020044.0000	Center	Moore	0.436246%	0.436246%	0.436246%	0.436246%	0.000000%	0.000000%	9900 Osprey Court	Thornville	OH	43706	None
46	GPOR	Barbara Ann (Yoho) Hamilton	Yes	1.000	3.94600	0.582153%	04-020043.0000	Center	Moore	0.582153%	0.582153%	0.582153%	0.582153%	0.000000%	0.000000%	9900 Osprey Court	Thornville	OH	43706	None
47	Non-Consenting Working Interest	Roger L. Dabrymple, Jr.*	Yes	0.500	0.01250	0.001844%	04-020003.0000	Center	Moore	0.000000%	0.000000%	0.000000%	0.001844%	0.000000%	0.000000%	31532 Camp Road 33	Lewisville	OH	43754	None
47	Non-Consenting Working Interest	The Heirs of Charles T. Lucas, deceased*	Yes	0.500	0.01250	0.001844%	04-020003.0000	Center	Moore	0.000000%	0.000000%	0.000000%	0.001844%	0.000000%	0.000000%	Unknown	Unknown	Unknown	Unknown	None
48	GPOR	Fiehman Oil and Gas	Yes	0.284	0.00795	0.001174%	NO TAX ID	Center	Moore	0.001174%	0.001174%	0.001174%	0.001174%	0.000000%	0.000000%	1117 E 42nd Avenue	Spokane	WA	99203	None
48	GPOR	John A. Bort	Yes	0.250	0.00700	0.001033%	NO TAX ID	Center	Moore	0.001033%	0.001033%	0.001033%	0.001033%	0.000000%	0.000000%	P.O. Box 20626	Columbus	OH	43220	None
48	GPOR	The Methodist Retirement Center of Central Ohio dba The Wesley Communities	Yes	0.125	0.00350	0.000516%	NO TAX ID	Center	Moore	0.000516%	0.000516%	0.000516%	0.000516%	0.000000%	0.000000%	5155 North High Street	Columbus	OH	43214	Updated Mineral Owner due to Will of Mary Gray, Deceased, and Updated Lease Status.
48	Unleased Mineral Interest	The Heirs of Charles E. Bandl, deceased	No	0.125	0.00350	0.000516%	NO TAX ID	Center	Moore	0.000000%	0.000000%	0.000000%	0.000000%	0.000000%	0.000000%	Unknown	Unknown	Unknown	Unknown	None
48	GPOR	FWZ Royal, LLC	Yes	0.091	0.00255	0.000376%	NO TAX ID	Center	Moore	0.000376%	0.000376%	0.000376%	0.000376%	0.000000%	0.000000%	6760 Forewest Drive	Houston	TX	77024	None
48	GPOR	Alan, Frederick W. Zimmerman	Yes	0.054	0.00151	0.000223%	NO TAX ID	Center	Moore	0.000223%	0.000223%	0.000223%	0.000223%	0.000000%	0.000000%	110 Old Western Road	Buckhannon	WV	26201	None
48	Unleased Mineral Interest	1803 Resources, LLC	No	0.024	0.00067	0.000099%	NO TAX ID	Center	Moore	0.000099%	0.000099%	0.000099%	0.000099%	0.000000%	0.000000%	P.O. Box 110836	Cleveland	OH	44111	None
48	Unleased Mineral Interest	The Heirs of Rosemary Clinic, deceased	No	0.010	0.00029	0.000043%	NO TAX ID	Center	Moore	0.000000%	0.000000%	0.000000%	0.000000%	0.000000%	0.000000%	Unknown	Unknown	Unknown	Unknown	None

48	Unleased Mineral Interest	The Heirs of Ralph Waldo Emerson Clinic, deceased	No	0.010	0.00029	0.000043%	NO TAX ID	Center	Monroe	0.000000%	0.000000%	0.000000%	0.000000%	0.000000%	Unknown	Unknown	Unknown	None	
48	Unleased Mineral Interest	The Heirs of Beaula Ferron, deceased	No	0.006	0.00018	0.000025%	NO TAX ID	Center	Monroe	0.000000%	0.000000%	0.000000%	0.000000%	0.000000%	Unknown	Unknown	Unknown	None	
48	Unleased Mineral Interest	The Heirs of Mabel D. Mobley, deceased	No	0.006	0.00018	0.000025%	NO TAX ID	Center	Monroe	0.000000%	0.000000%	0.000000%	0.000000%	0.000000%	Unknown	Unknown	Unknown	None	
48	Unleased Mineral Interest	The Heirs of Blanche Holder, deceased	No	0.005	0.00013	0.000019%	NO TAX ID	Center	Monroe	0.000000%	0.000000%	0.000000%	0.000000%	0.000000%	Unknown	Unknown	Unknown	None	
48	Unleased Mineral Interest	Linda Marshall	No	0.003	0.00009	0.000013%	NO TAX ID	Center	Monroe	0.000000%	0.000000%	0.000000%	0.000000%	0.000000%	Unknown	Unknown	Unknown	None	
48	Unleased Mineral Interest	Alan S. Jones	No	0.002	0.00006	0.000009%	NO TAX ID	Center	Monroe	0.000000%	0.000000%	0.000000%	0.000000%	0.000000%	Unknown	Unknown	Unknown	None	
48	Unleased Mineral Interest	Jim Marshall	No	0.001	0.00003	0.000004%	NO TAX ID	Center	Monroe	0.000000%	0.000000%	0.000000%	0.000000%	0.000000%	Unknown	Unknown	Unknown	None	
48	Unleased Mineral Interest	Sarah L. Marshall	No	0.001	0.00003	0.000004%	NO TAX ID	Center	Monroe	0.000000%	0.000000%	0.000000%	0.000000%	0.000000%	4275 Amlia Road	Alhadean	CA	91001	None
48	Unleased Mineral Interest	Hope Annette Albright Wills	No	0.001	0.00003	0.000004%	NO TAX ID	Center	Monroe	0.000000%	0.000000%	0.000000%	0.000000%	0.000000%	706 Highland Drive	Tyome	PA	16686	None
48	Unleased Mineral Interest	Denis Eugene Snyder, Jr.	No	0.001	0.00003	0.000004%	NO TAX ID	Center	Monroe	0.000000%	0.000000%	0.000000%	0.000000%	0.000000%	2730 Aristides Drive	Sparks	NV	89436	None
49	Unleased Mineral Interest	Cory N. Batt	No	1.000	0.59100	0.087190%	NO TAX ID	Center	Monroe	0.000000%	0.000000%	0.000000%	0.000000%	0.000000%	1799 Calhoun Falls Highway	Ebereton	GA	30635	None
			Total Unit Acres:	677.829	100.000000%														
			Total Consenting Acres:	487.994															
<p>¹ This Exhibit A is also referred to as Exhibit A-2 in the Unit Operating Agreement submitted by Gulfport as part of its application.</p> <p>² Lease contains a non-conforming pooling provision</p>										Total:	71.993721%	71.993721%	22.234368%	0.003688%					

END OF EXHIBIT A

Revised 12/29/2023

**MONROE
County**

EXHIBIT B
GULFPORT APPALACHIA, LLC
KILBURN III UNIT
MONROE COUNTY, OHIO
677.829 ACRES

**Kilburn III Unit
Chief's Order Exhibit
B**



This Exhibit B is also referred to as Exhibit A-1 in the Unit Operating Agreement submitted by Gulfport as part of its application.

 UNIT BOUNDARY - 677.829 ACRES



KILBURN III
CENTER & SUMMIT TOWNSHIPS
MONROE COUNTY, OHIO

1 in = 1,900 ft

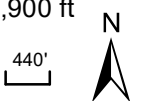

Last Updated: October 3, 2023
Version 1

Master Table of Tracts

MAP ID	TAX PARCEL NUMBER	ACRES
1	22-006010.0000	28.252
2	22-006015.0000	13.113
3	22-006009.0000	51.978
4	04-005004.0000	6.378
5	22-006003.0000	17.142
6	22-006014.0000	1.331
7	04-005007.0000	0.002
8	04-005005.0000	1.899
9	04-018013.1000	12.324
10	04-005003.0000	81.731
11	22-006005.0000	0.536
12	04-018006.0000	75.855
13	04-018003.0000	15.610
14	04-018012.0000	38.331
15	04-018013.0000	8.670
16	04-018009.0000	8.647
17	04-019004.0000	56.326
18	04-019036.0000	6.617
19	04-018010.0000	0.965
20	04-018016.0000	0.809
21	04-019012.0000	6.869
22	04-019026.0000	1.619
23	04-018005.0000	19.859
24	04-018008.0000	15.877
25	04-018007.0000	4.528
26	04-018002.0000	49.572
27	04-019017.0000	0.015
28	04-019013.0000	0.189
29	04-017023.0000	0.310
30	04-017005.0000	0.027
31	04-019019.0000	0.474
32	04-019041.0000	0.074
33	04-020007.0000	0.959
34	04-020008.0000	0.193
35	04-020006.0000	9.003
36	04-020017.0000	1.100
37	04-019040.0000	0.590

MAP ID	TAX PARCEL NUMBER	ACRES
38	04-020026.0000	4.596
39	04-020005.0000	26.326
40	04-020038.0000	0.700
41A	04-020012.0000	14.221
41B	04-020012.0000	18.816
42	04-020013.0000	0.421
43	04-019027.0000	2.878
44	04-020042.0000	64.550
45	04-020044.0000	2.957
46	04-020043.0000	3.946
47	04-020003.0000	0.025
48	NO TAX ID	0.028
49	NO TAX ID	0.591

