

# SALLSR00081\*\*C

State True Log 21.869

22.869

County True Log

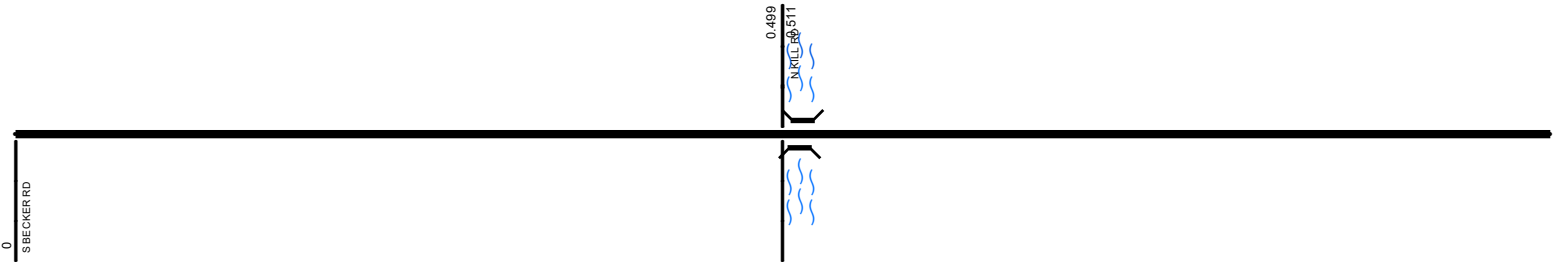

Surface Type & Width (Left / Right)

G (9'/10')  
0 - 3.066

Base Type (Left / Right)

I  
0 - 3.066

Shoulder Type & Width (Left / Right)

2 (6'/6')  
0 - 3.066

Through Lanes

2  
0 - 3.066

Street Name

ALLENTOWN RD  
0 - 3.066

- |                     |                   |                      |              |
|---------------------|-------------------|----------------------|--------------|
| Non-divided Highway | Bridge (on route) | Railroad (at grade)  | Intersection |
| Divided Highway     | Underpass         | Railroad (underpass) |              |
| Secondary Segment   | Overpass          | Railroad (overpass)  |              |
| Corporation         |                   |                      |              |

Created on: 6/24/2025



transportation.ohio.gov  
Prepared by  
The Ohio Department of Transportation  
Office of Technical Services  
Roadway Information

# SALLSR00081\*\*C

State True Log

23.869

County True Log



Surface Type & Width (Left / Right)

G (9/10')  
0 - 3.066

Base Type (Left / Right)

I  
0 - 3.066

Shoulder Type & Width (Left / Right)

2 (6/6)  
0 - 3.066

Through Lanes

2  
0 - 3.066

Street Name

ALLENTOWN RD  
0 - 3.066

- |                     |                   |                      |              |
|---------------------|-------------------|----------------------|--------------|
| Non-divided Highway | Bridge (on route) | Railroad (at grade)  | Intersection |
| Divided Highway     | Underpass         | Railroad (underpass) |              |
| Secondary Segment   | Overpass          | Railroad (overpass)  |              |
| <b>Corporation</b>  |                   |                      |              |

Created on: 6/24/2025

transportation.ohio.gov

Prepared by  
The Ohio Department of Transportation  
Office of Technical Services  
Roadway Information

# SALLSR00081\*\*C

State True Log

24.869

County True Log

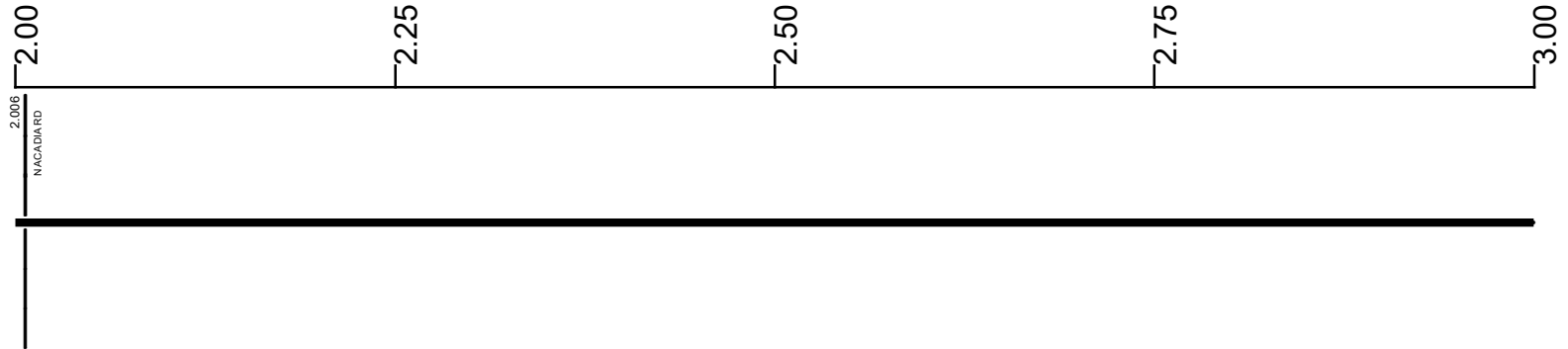

Surface Type & Width (Left / Right)

G (9/10')  
0 - 3.066

Base Type (Left / Right)

I  
0 - 3.066

Shoulder Type & Width (Left / Right)

2 (6/6)  
0 - 3.066

Through Lanes

2  
0 - 3.066

Street Name

ALLENTOWN RD  
0 - 3.066

- |  |   |   |   |
|--|---|---|---|
| <ul style="list-style-type: none"> <li> Non-divided Highway</li> <li> Divided Highway</li> <li> Secondary Segment</li> <li> Corporation</li> </ul> | <ul style="list-style-type: none"> <li> Bridge (on route)</li> <li> Underpass</li> <li> Overpass</li> </ul> | <ul style="list-style-type: none"> <li> Railroad (at grade)</li> <li> Railroad (underpass)</li> <li> Railroad (overpass)</li> </ul> | <ul style="list-style-type: none"> <li> Intersection</li> </ul> |
|--|---|---|---|

Created on: 6/24/2025

transportation.ohio.gov

Prepared by  
The Ohio Department of Transportation  
Office of Technical Services  
Roadway Information

# SALLSR00081\*\*C

State True Log

25.869

County True Log

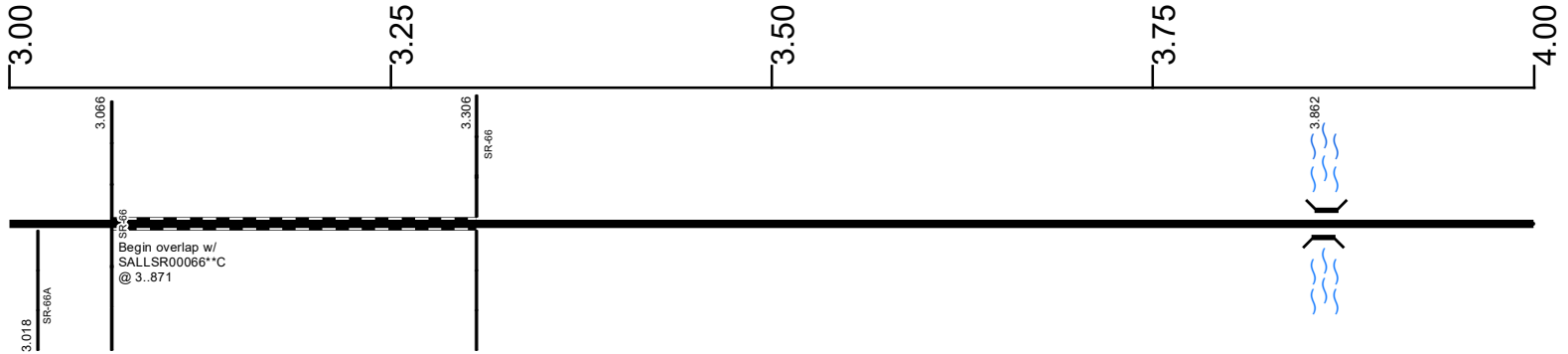

**Surface Type & Width (Left / Right)**

G (9'/10')

0 - 3.066

**Base Type (Left / Right)**

I

0 - 3.066

**Shoulder Type & Width (Left / Right)**

2 (6'/6')

0 - 3.066

**Through Lanes**

2

0 - 3.066

ALLENTOWN RD

0 - 3.066

**Surface Type & Width (Left / Right)**

G (20'/2')

3.306 - 7.237

**Base Type (Left / Right)**

I / L

3.306 - 7.237

**Shoulder Type & Width (Left / Right)**

2 (4'/4')

3.306 - 10.719

**Resurface Year**

2020

3.306 - 11.336

**Through Lanes**

2

3.306 - 13.467

**Street Name**

ALLENTOWN RD

3.306 - 15.718

- Non-divided Highway
- Divided Highway
- Secondary Segment
- Corporation
- Bridge (on route)
- Underpass
- Overpass
- Railroad (at grade)
- Railroad (underpass)
- Railroad (overpass)
- Intersection

Created on: 6/24/2025

transportation.ohio.gov

Prepared by  
The Ohio Department of Transportation  
Office of Technical Services  
Roadway Information

# SALLSR00081\*\*C

State True Log

26.869

County True Log

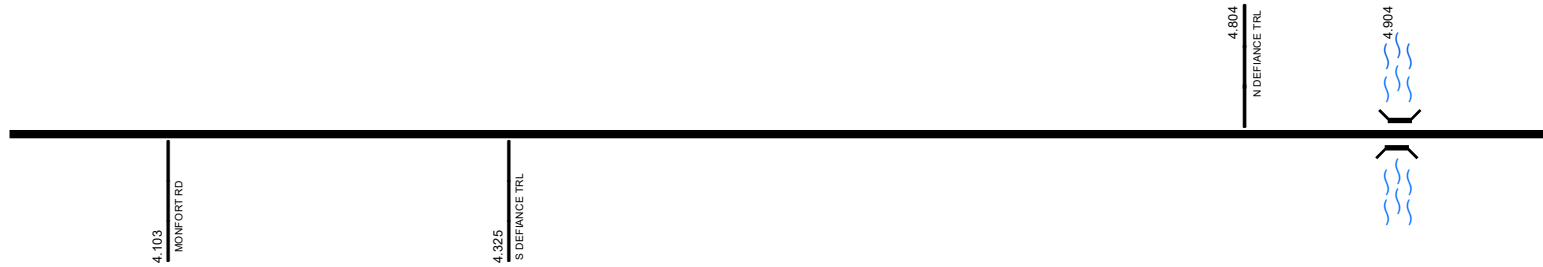

Surface Type & Width (Left / Right)

G (20'/2')  
3.306 - 7.237

Base Type (Left / Right)

I / L  
3.306 - 7.237

Shoulder Type & Width (Left / Right)

2 (4'/4')  
3.306 - 10.719

Resurface Year

2020

Through Lanes

2  
3.306 - 13.467

Street Name

ALLENTOWN RD  
3.306 - 15.718

<p> Non-divided Highway</p> <p> Divided Highway</p> <p> Secondary Segment</p> <p> Corporation</p>	<p> Bridge (on route)</p> <p> Underpass</p> <p> Overpass</p>	<p> Railroad (at grade)</p> <p> Railroad (underpass)</p> <p> Railroad (overpass)</p>	<p> Intersection</p>
---	--	--	----------------------

Created on: 6/24/2025

transportation.ohio.gov

Prepared by  
The Ohio Department of Transportation  
Office of Technical Services  
Roadway Information

# SALLSR00081\*\*C

State True Log

27.869

County True Log

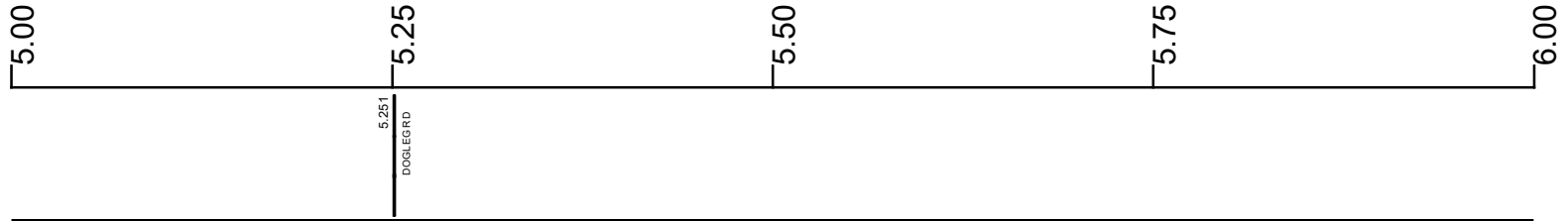

Surface Type & Width (Left / Right)

G (20'/2')  
3.306 - 7.237

Base Type (Left / Right)

I / L  
3.306 - 7.237

Shoulder Type & Width (Left / Right)

2 (4'/4')  
3.306 - 10.719

Resurface Year

2020

Through Lanes

2  
3.306 - 13.467

Street Name

ALLENTOWN RD  
3.306 - 15.718

- |                     |                   |                      |              |
|---------------------|-------------------|----------------------|--------------|
| Non-divided Highway | Bridge (on route) | Railroad (at grade)  | Intersection |
| Divided Highway     | Underpass         | Railroad (underpass) |              |
| Secondary Segment   | Overpass          | Railroad (overpass)  |              |
| Corporation         |                   |                      |              |

Created on: 6/24/2025



transportation.ohio.gov  
 Prepared by  
 The Ohio Department of Transportation  
 Office of Technical Services  
 Roadway Information

# SALLSR00081\*\*C

State True Log

28.869

County True Log



6.758  
SHAFFER RD

Surface Type & Width (Left / Right)

G (20'/2')  
3.306 - 7.237

Base Type (Left / Right)

I / L  
3.306 - 7.237

Shoulder Type & Width (Left / Right)

2 (4'/4')  
3.306 - 10.719

Resurface Year

2020

Through Lanes

2  
3.306 - 13.467

Street Name

ALLENTOWN RD  
3.306 - 15.718

- |                     |                   |                      |              |
|---------------------|-------------------|----------------------|--------------|
| Non-divided Highway | Bridge (on route) | Railroad (at grade)  | Intersection |
| Divided Highway     | Underpass         | Railroad (underpass) |              |
| Secondary Segment   | Overpass          | Railroad (overpass)  |              |
| Corporation         |                   |                      |              |

Created on: 6/24/2025

transportation.ohio.gov

Prepared by  
The Ohio Department of Transportation  
Office of Technical Services  
Roadway Information

# SALLSR00081\*\*C

State True Log

29.869

County True Log

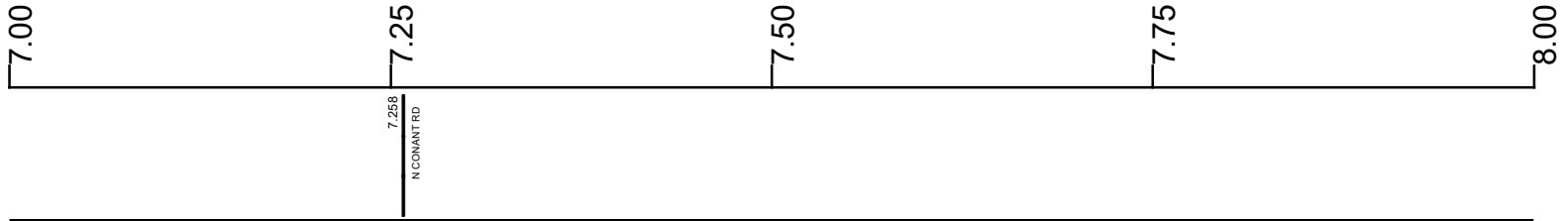

**Surface Type & Width (Left / Right)**

G (20'2") 3.306 - 7.237	G 24' 7.237 - 10.385
----------------------------	-------------------------

**Base Type (Left / Right)**

I / L 3.306 - 7.237	I 7.237 - 10.385
------------------------	---------------------

**Shoulder Type & Width (Left / Right)**

2 (4'4") 3.306 - 10.719	
----------------------------	--

**Resurface Year**

2020 3.306 - 11.336	
------------------------	--

**Through Lanes**

2 3.306 - 13.467	
---------------------	--

**Street Name**

ALLENTOWN RD 3.306 - 15.718	
--------------------------------	--

- Non-divided Highway
  Bridge (on route)
  Railroad (at grade)
  Intersection
- Divided Highway
  Underpass
  Railroad (underpass)
- Secondary Segment
  Overpass
  Railroad (overpass)
- Corporation**

Created on: 6/24/2025

transportation.ohio.gov

Prepared by  
The Ohio Department of Transportation  
Office of Technical Services  
Roadway Information

# SALLSR00081\*\*C

State True Log

30.869

County True Log

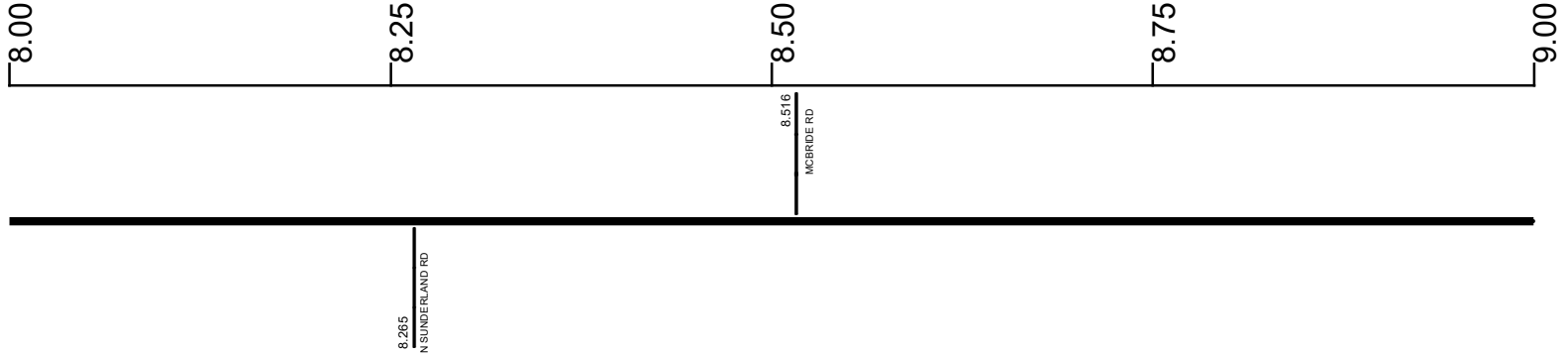

Surface Type & Width (Left / Right)

G 24'  
7.237 - 10.385

Base Type (Left / Right)

I  
7.237 - 10.385

Shoulder Type & Width (Left / Right)

2 (4/4')  
3.306 - 10.719

Resurface Year

2020  
3.306 - 11.336

Through Lanes

2  
3.306 - 13.467

Street Name

ALLENTOWN RD  
3.306 - 15.718

- |                     |                   |                      |              |
|---------------------|-------------------|----------------------|--------------|
| Non-divided Highway | Bridge (on route) | Railroad (at grade)  | Intersection |
| Divided Highway     | Underpass         | Railroad (underpass) |              |
| Secondary Segment   | Overpass          | Railroad (overpass)  |              |
| Corporation         |                   |                      |              |

Created on: 6/24/2025

transportation.ohio.gov

Prepared by  
The Ohio Department of Transportation  
Office of Technical Services  
Roadway Information

# SALLSR00081\*\*C

State True Log

31.869

County True Log

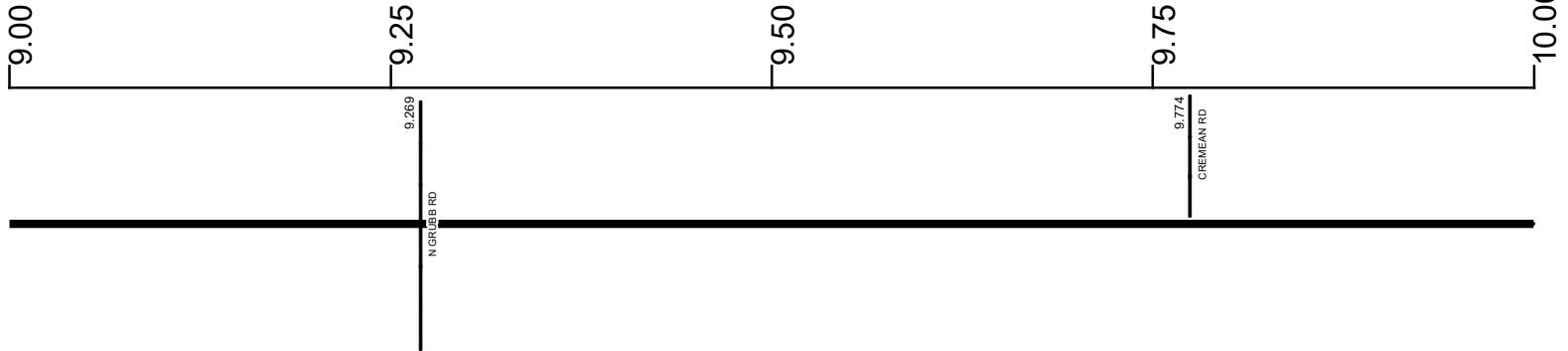

Surface Type & Width (Left / Right)

G 24'  
7.237 - 10.385

Base Type (Left / Right)

I  
7.237 - 10.385

Shoulder Type & Width (Left / Right)

2 (4/4')  
3.306 - 10.719

Resurface Year

2020  
3.306 - 11.336

Through Lanes

2  
3.306 - 13.467

Street Name

ALLENTOWN RD  
3.306 - 15.718

- |                     |                   |                      |              |
|---------------------|-------------------|----------------------|--------------|
| Non-divided Highway | Bridge (on route) | Railroad (at grade)  | Intersection |
| Divided Highway     | Underpass         | Railroad (underpass) |              |
| Secondary Segment   | Overpass          | Railroad (overpass)  |              |
| Corporation         |                   |                      |              |

Created on: 6/24/2025

transportation.ohio.gov

Prepared by  
The Ohio Department of Transportation  
Office of Technical Services  
Roadway Information

# SALLSR00081\*\*C

State True Log

32.869

County True Log

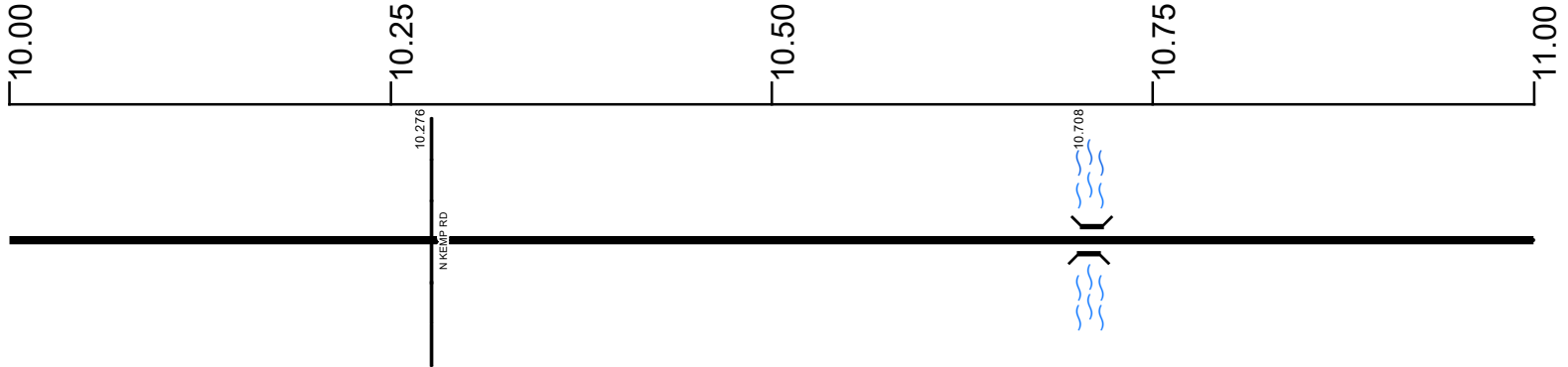

**Surface Type & Width (Left / Right)**

G 24'	G (19'5")
7.237 - 10.385	10.385 - 11.615

**Base Type (Left / Right)**

I	K / I
7.237 - 10.385	10.385 - 11.615

**Shoulder Type & Width (Left / Right)**

2 (4'4")	5 (2'2")
3.306 - 10.719	10.719 - 11.615

**Resurface Year**

2020
3.306 - 11.336

**Through Lanes**

2
3.306 - 13.467

**Street Name**

ALLENTOWN RD
3.306 - 15.718

- Non-divided Highway
- Divided Highway
- Secondary Segment
- Corporation
- Bridge (on route)
- Underpass
- Overpass
- Railroad (at grade)
- Railroad (underpass)
- Railroad (overpass)
- Intersection

Created on: 6/24/2025

transportation.ohio.gov

Prepared by  
The Ohio Department of Transportation  
Office of Technical Services  
Roadway Information

# SALLSR00081\*\*C

State True Log  
County True Log

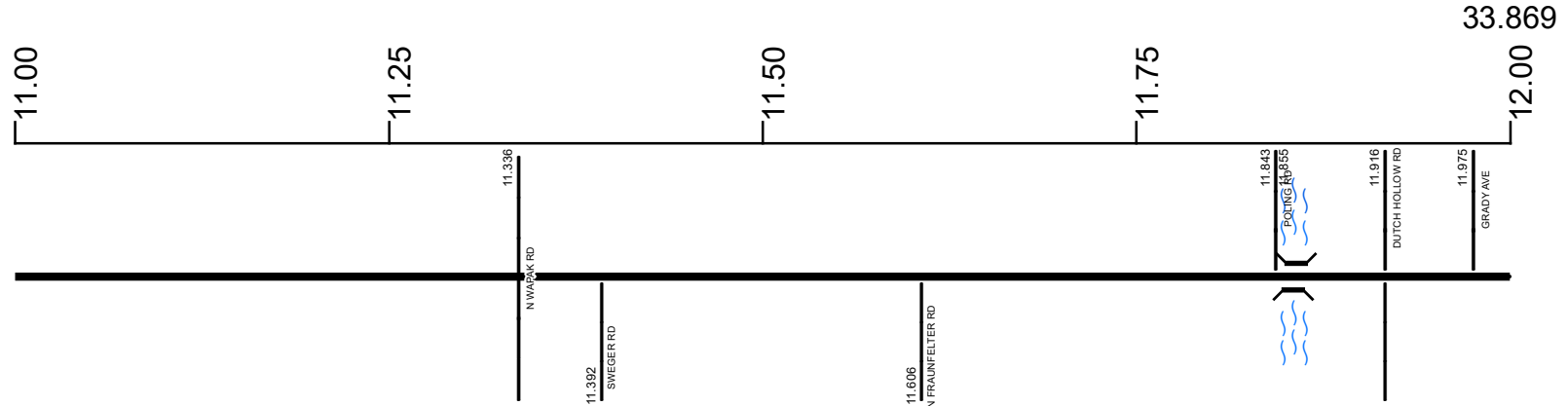

**Surface Type & Width (Left / Right)**

G (19/5')	G 24'
10.385 - 11.615	11.615 - 13.467

**Base Type (Left / Right)**

K / I	I
10.385 - 11.615	11.615 - 13.467

**Shoulder Type & Width (Left / Right)**

5 (2/2')	2 (4/4')
10.719 - 11.615	11.615 - 13.467

**Resurface Year**

2020
3.306 - 11.336

**Through Lanes**

2
3.306 - 13.467

**Street Name**

ALLENTOWN RD
3.306 - 15.718

- Non-divided Highway
- Divided Highway
- Secondary Segment
- Corporation
- Bridge (on route)
- Underpass
- Overpass
- Railroad (at grade)
- Railroad (underpass)
- Railroad (overpass)
- Intersection

Created on: 6/24/2025

transportation.ohio.gov

Prepared by  
The Ohio Department of Transportation  
Office of Technical Services  
Roadway Information

# SALLSR00081\*\*C

State True Log

34.869

County True Log

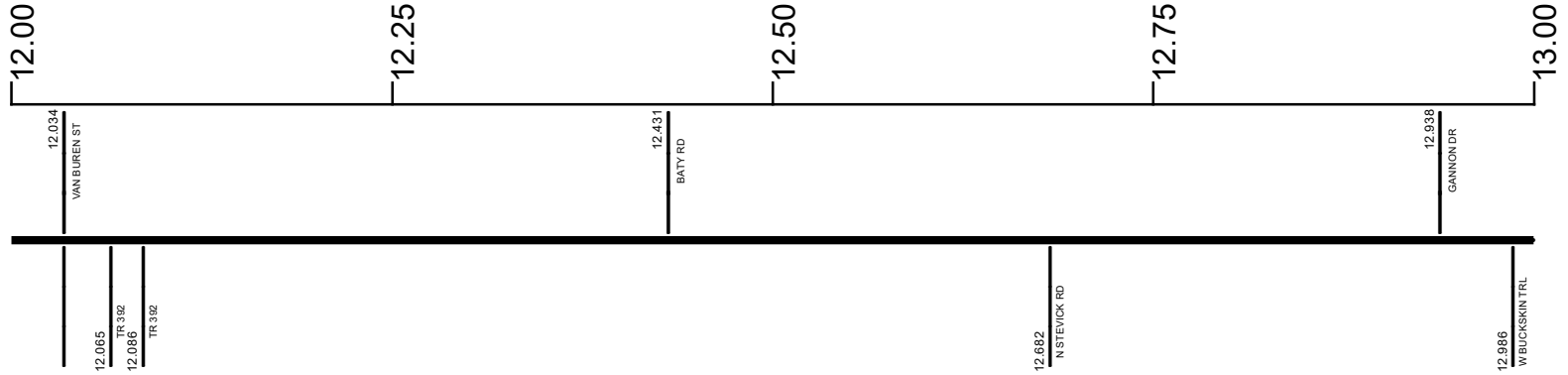

Surface Type & Width (Left / Right)

G 24'  
11.615 - 13.467

Base Type (Left / Right)

I  
11.615 - 13.467

Shoulder Type & Width (Left / Right)

2 (4/4')  
11.615 - 13.467

Through Lanes

2  
3.306 - 13.467

Street Name

ALLENTOWN RD  
3.306 - 15.718

- |                     |                   |                      |              |
|---------------------|-------------------|----------------------|--------------|
| Non-divided Highway | Bridge (on route) | Railroad (at grade)  | Intersection |
| Divided Highway     | Underpass         | Railroad (underpass) |              |
| Secondary Segment   | Overpass          | Railroad (overpass)  |              |
| Corporation         |                   |                      |              |

Created on: 6/24/2025



transportation.ohio.gov

Prepared by  
The Ohio Department of Transportation  
Office of Technical Services  
Roadway Information

# SALLSR00081\*\*C

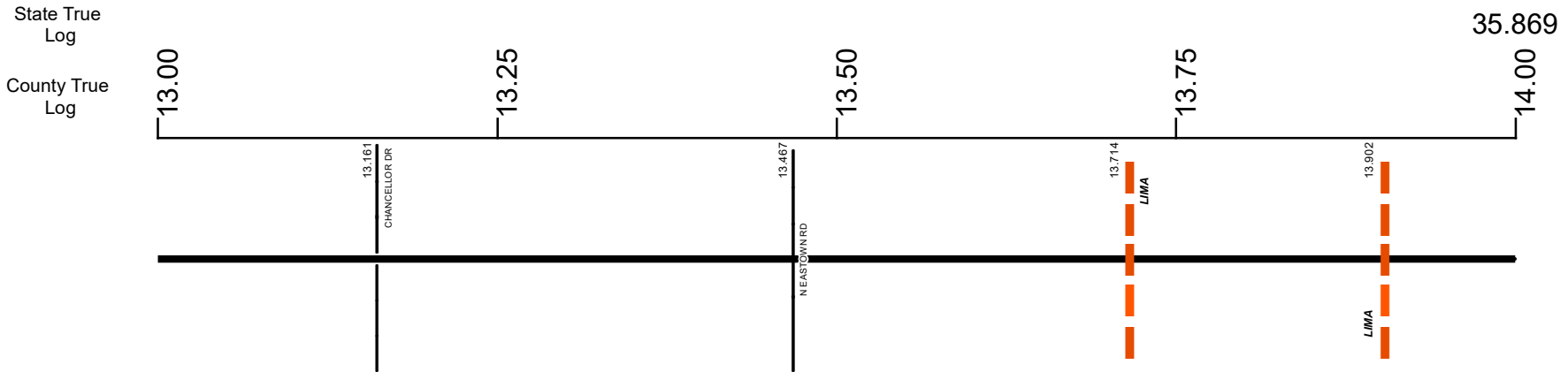

Surface Type & Width (Left / Right)	
G 24' 11.615 - 13.467	G 60' 13.467 - 14.47
Base Type (Left / Right)	
I 11.615 - 13.467	L 13.467 - 14.47
Shoulder Type & Width (Left / Right)	
2 (4'/4') 11.615 - 13.467	1 (0'/0') 13.467 - 14.47
Through Lanes	
2 3.306 - 13.467	4 13.467 - 14.575
Street Name	
ALLENTOWN RD 3.306 - 15.718	

- Non-divided Highway
- Divided Highway
- Secondary Segment
- Corporation
- Bridge (on route)
- Underpass
- Overpass
- Railroad (at grade)
- Railroad (underpass)
- Railroad (overpass)
- Intersection

Created on: 6/24/2025



transportation.ohio.gov  
 Prepared by  
 The Ohio Department of Transportation  
 Office of Technical Services  
 Roadway Information

# SALLSR00081\*\*C

State True Log

36.869

County True Log

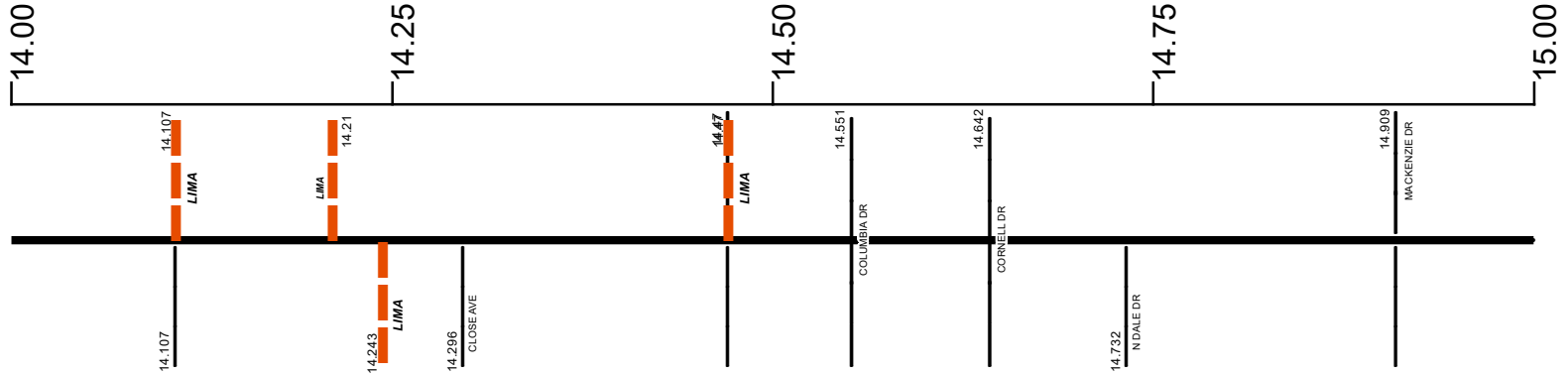

**Surface Type & Width (Left / Right)**

G 60'	G (20'4')	G (20'17')
13.467 - 14.47	14.47 - 14.559	14.559 - 15.54

**Base Type (Left / Right)**

L	T / I	T / L
13.467 - 14.47	14.47 - 14.559	14.559 - 15.54

**Shoulder Type & Width (Left / Right)**

1 (0'0')	1 (4'4')	1 (0'0')
13.467 - 14.47	14.47 - 14.559	14.559 - 18.521

**Resurface Year**

2023
14.58 - 15.718

**Through Lanes**

4	2
13.467 - 14.575	14.575 - 16.842

**Street Name**

ALLENTOWN RD
3.306 - 15.718

- Non-divided Highway
- Divided Highway
- Secondary Segment
- Corporation
- Bridge (on route)
- Underpass
- Overpass
- Railroad (at grade)
- Railroad (underpass)
- Railroad (overpass)
- Intersection

Created on: 6/24/2025

transportation.ohio.gov

Prepared by  
The Ohio Department of Transportation  
Office of Technical Services  
Roadway Information

# SALLSR00081\*\*C

State True Log

37.869

County True Log

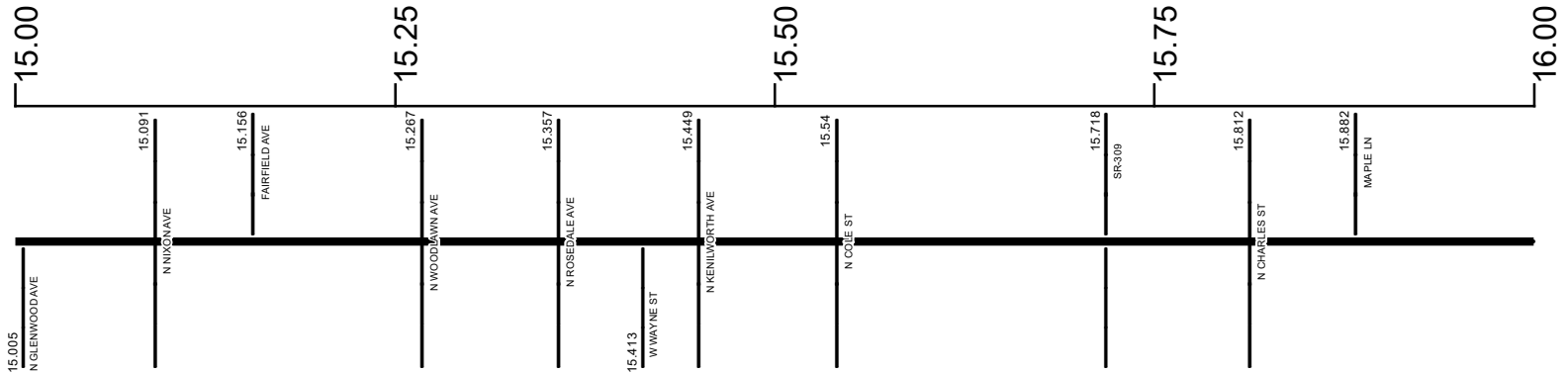

Surface Type & Width (Left / Right)

G (20'/17')	G 36'	G (28'/9')
14.559 - 15.54	15.54 - 15.718	15.718 - 16.306

Base Type (Left / Right)

T / L	R	R / I
14.559 - 15.54	15.54 - 15.718	15.718 - 16.306

Shoulder Type & Width (Left / Right)

1 (0'/0')
14.559 - 18.521

Resurface Year

2023
14.58 - 15.718

Through Lanes

2
14.575 - 16.842

Street Name

ALLENTOWN RD	W NORTH ST
3.306 - 15.718	15.718 - 16.737

- Non-divided Highway
- Divided Highway
- Secondary Segment
- Corporation
- Bridge (on route)
- Underpass
- Overpass
- Railroad (at grade)
- Railroad (underpass)
- Railroad (overpass)
- Intersection

Created on: 6/24/2025



transportation.ohio.gov  
 Prepared by  
 The Ohio Department of Transportation  
 Office of Technical Services  
 Roadway Information

# SALLSR00081\*\*C

State True  
Log

County True  
Log

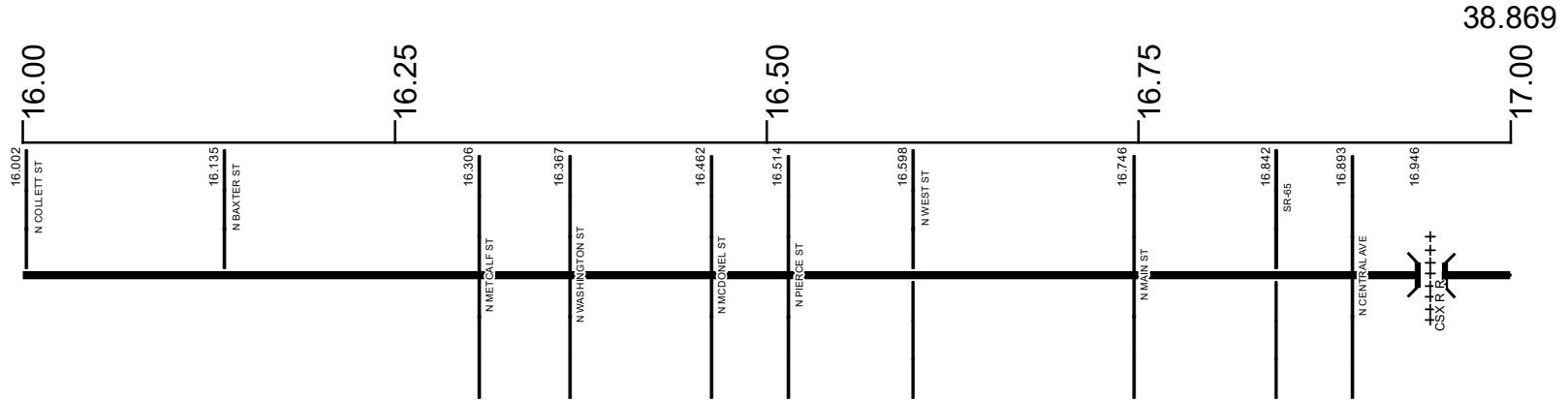

**Surface Type & Width (Left / Right)**

G (28'/9')	G 36'	G 40'	G (40'/8')	G (36'/15')
15.718 - 16.306	16.306 - 16.65	16.65 - 16.842	16.842 - 16.893	16.893 - 17.01

**Base Type (Left / Right)**

R / I	T	T / L
15.718 - 16.306	16.306 - 16.842	16.842 - 17.01

**Shoulder Type & Width (Left / Right)**

1 (0'/0')
14.559 - 18.521

**Through Lanes**

2	4	2
14.575 - 16.842	16.842 - 16.961	16.961 - 18.133

**Street Name**

W NORTH ST	E NORTH ST
15.718 - 16.737	16.737 - 17.01

- Non-divided Highway
- Divided Highway
- Secondary Segment
- Corporation
- Bridge (on route)
- Underpass
- Overpass
- Railroad (at grade)
- Railroad (underpass)
- Railroad (overpass)
- Intersection

Created on: 6/24/2025



transportation.ohio.gov  
Prepared by  
The Ohio Department of Transportation  
Office of Technical Services  
Roadway Information

# SALLSR00081\*\*C

State True Log

39.869

County True Log

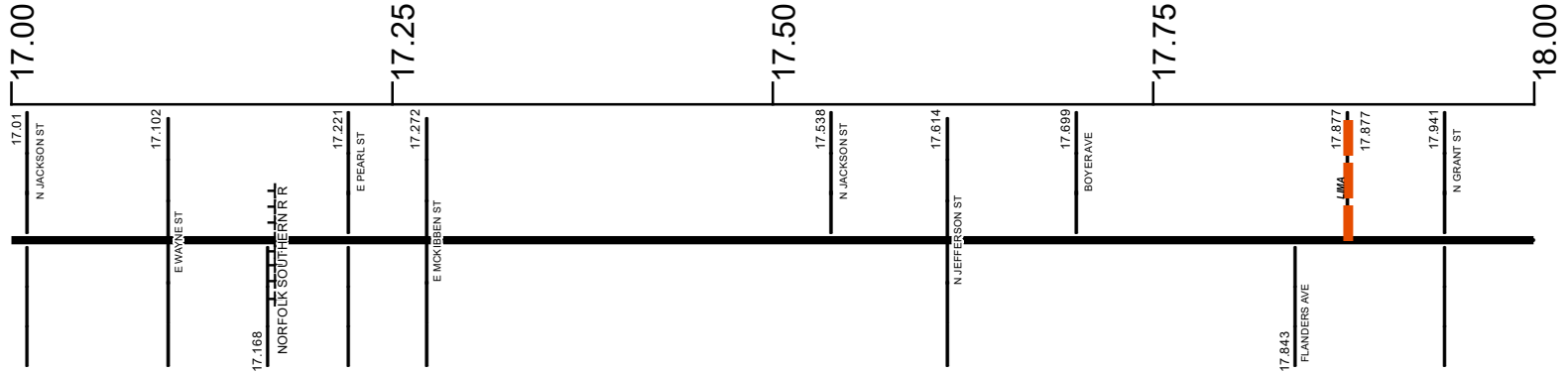

**Surface Type & Width (Left / Right)**

G (36'/15')	G (36'/4')	G 36'
17.01 - 17.102	17.102 - 18.145	

**Base Type (Left / Right)**

T/L	N/L	N
16.842 - 17.01	17.01 - 17.102	17.102 - 18.133

**Shoulder Type & Width (Left / Right)**

1	(0'/0')
14.559 - 18.521	

**Resurface Year**

2023
17.01 - 18.15

**Through Lanes**

2
16.961 - 18.133

**Street Name**

E NORTH ST	N JACKSON ST	FINDLAY RD
16.737 - 17.01	17.01 - 17.877	17.877 - 19.416

- Non-divided Highway
- Divided Highway
- Secondary Segment
- Corporation
- Bridge (on route)
- Underpass
- Overpass
- Railroad (at grade)
- Railroad (underpass)
- Railroad (overpass)
- Intersection

Created on: 6/24/2025



transportation.ohio.gov  
 Prepared by  
 The Ohio Department of Transportation  
 Office of Technical Services  
 Roadway Information

# SALLSR00081\*\*C

State True Log

40.869

County True Log

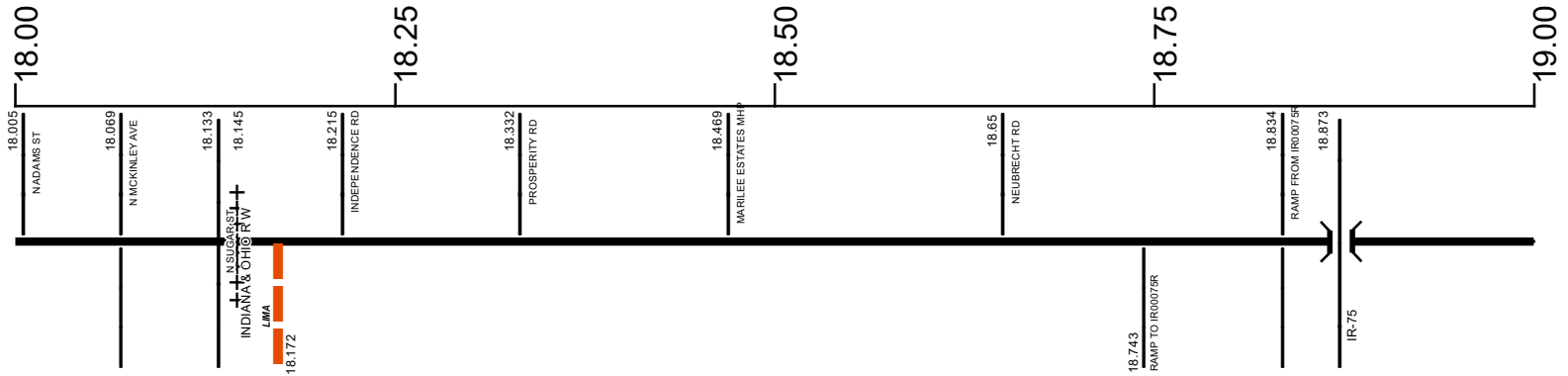

**Surface Type & Width (Left / Right)**

G 36'	G 48'	D 48'	E 48'	E 60'	E 72'
17.102 - 18.145	18.145 - 18.47	18.478 - 18.57		18.57 - 18.84	18.84 - 19.01

**Base Type (Left / Right)**

N	L
17.102 - 18.133	18.133 - 18.47

**Shoulder Type & Width (Left / Right)**

1 (0'/0')	5 (0'/0')
14.559 - 18.521	18.521 - 19.086

**Resurface Year**

2023
17.01 - 18.15

**Through Lanes**

2	4
16.961 - 18.133	18.133 - 19.67

**Street Name**

FINDLAY RD
17.877 - 19.416

- Non-divided Highway
  Bridge (on route)
  Railroad (at grade)
  Intersection
- Divided Highway
  Underpass
  Railroad (underpass)
- Secondary Segment
  Overpass
  Railroad (overpass)
- Corporation**

Created on: 6/24/2025

transportation.ohio.gov

Prepared by  
The Ohio Department of Transportation  
Office of Technical Services  
Roadway Information



INTERCHANGE  
IR 75 & SR 81  
ALLEN COUNTY  
INTERCHANGE ID NUMBER = 00500

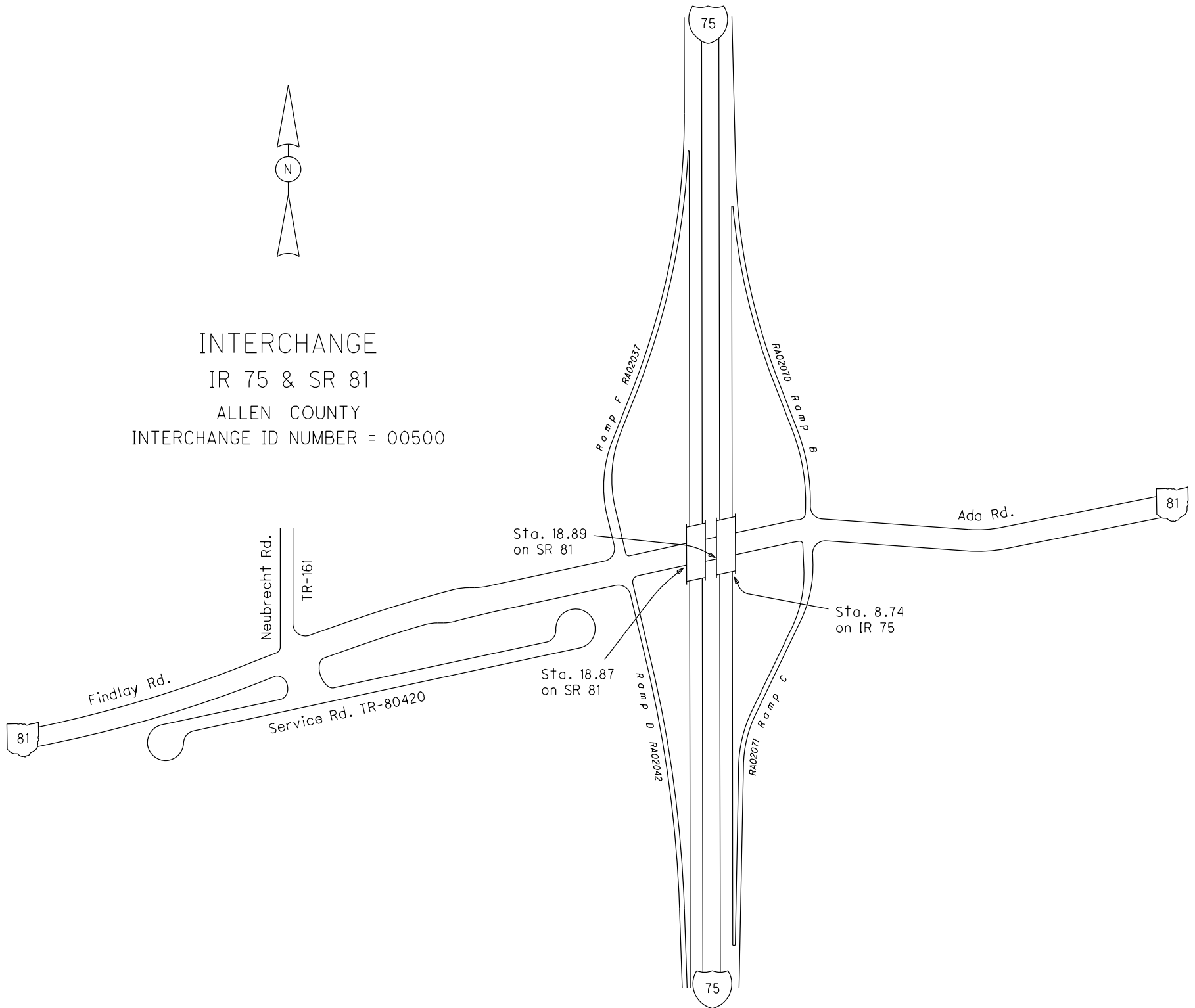

IR 75  
SR 81

REVISED May 2024

# SALLSR00081\*\*C

State True Log

41.869

County True Log

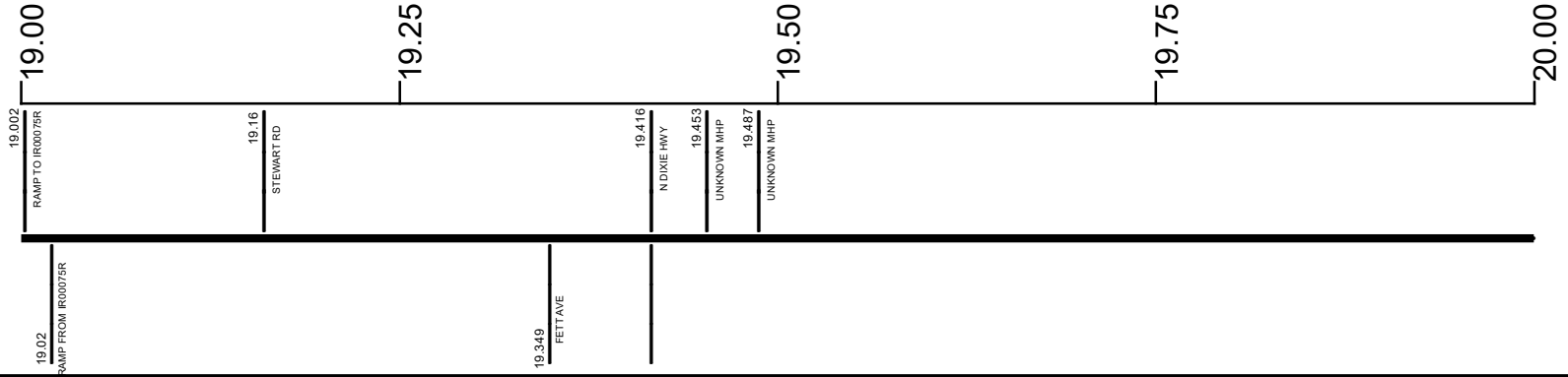

**Surface Type & Width (Left / Right)**

E 72'	E 60'	G 60'	G (16'6")	G 22'
19.01 - 19.09		19.09 - 19.67	19.67 - 19.922	19.922 - 20.618

**Base Type (Left / Right)**

P	K / L	L
19.09 - 19.67	19.67 - 19.922	19.922 - 20.618

**Shoulder Type & Width (Left / Right)**

5 (0'0")	1 (0'0")	2 (9'9")
18.521 - 19.086	19.086 - 19.67	19.67 - 21.558

**Through Lanes**

4	2
18.133 - 19.67	19.67 - 29.408

**Street Name**

FINDLAY RD	ADA RD
17.877 - 19.416	19.416 - 29.408

- Non-divided Highway
- Divided Highway
- Secondary Segment
- Corporation
- Bridge (on route)
- Underpass
- Overpass
- Railroad (at grade)
- Railroad (underpass)
- Railroad (overpass)
- Intersection

Created on: 6/24/2025

transportation.ohio.gov

Prepared by  
The Ohio Department of Transportation  
Office of Technical Services  
Roadway Information

# SALLSR00081\*\*C

State True Log

42.869

County True Log

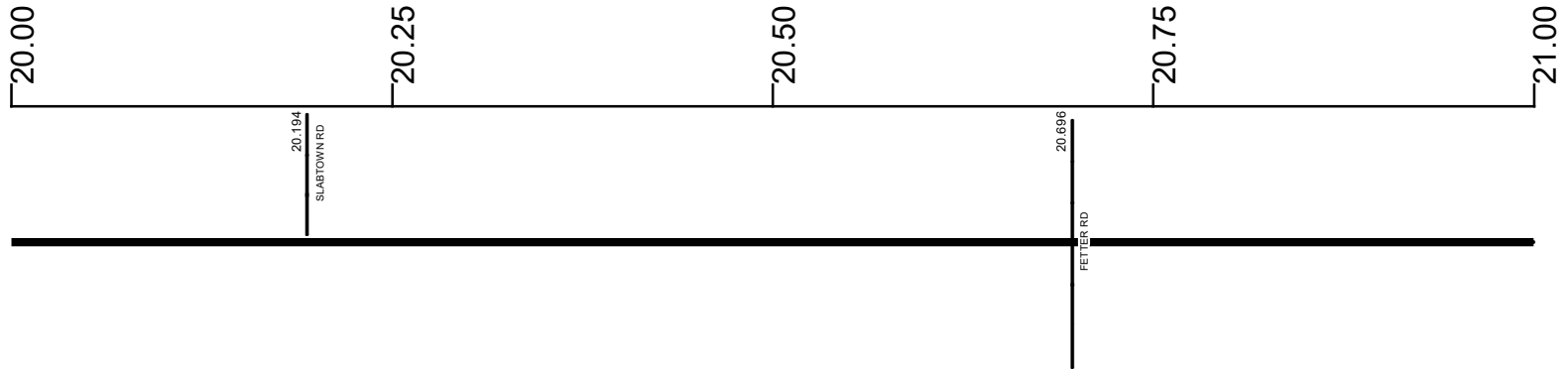

**Surface Type & Width (Left / Right)**

G 22' 19.922 - 20.618	G (16'/6') 20.618 - 21.204
--------------------------	-------------------------------

**Base Type (Left / Right)**

L 19.922 - 20.618	K / L 20.618 - 21.204
----------------------	--------------------------

**Shoulder Type & Width (Left / Right)**

2 (9'/9') 19.67 - 21.558
-----------------------------

**Through Lanes**

2 19.67 - 29.408
---------------------

**Street Name**

ADA RD 19.416 - 29.408
---------------------------

- Non-divided Highway
- Divided Highway
- Secondary Segment
- Corporation
- Bridge (on route)
- Underpass
- Overpass
- Railroad (at grade)
- Railroad (underpass)
- Railroad (overpass)
- Intersection

Created on: 6/24/2025

transportation.ohio.gov

Prepared by  
The Ohio Department of Transportation  
Office of Technical Services  
Roadway Information

# SALLSR00081\*\*C

State True Log

43.869

County True Log

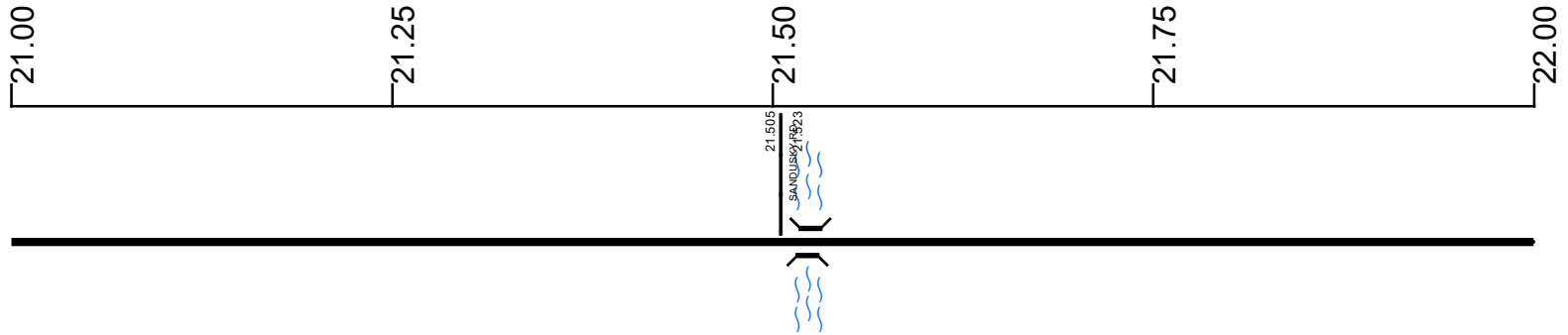

**Surface Type & Width (Left / Right)**

G (16'6") 20.618 - 21.204	G 22' 21.204 - 21.558	G 24' 21.558 - 23.75
------------------------------	--------------------------	-------------------------

**Base Type (Left / Right)**

K / L 20.618 - 21.204	L 21.204 - 23.75
--------------------------	---------------------

**Shoulder Type & Width (Left / Right)**

2 (9'9") 19.67 - 21.558	2 (10'10") 21.558 - 26.789
----------------------------	-------------------------------

**Through Lanes**

2 19.67 - 29.408
---------------------

**Street Name**

ADA RD 19.416 - 29.408
---------------------------

- Non-divided Highway
- Divided Highway
- Secondary Segment
- Corporation
- Bridge (on route)
- Underpass
- Overpass
- Railroad (at grade)
- Railroad (underpass)
- Railroad (overpass)
- Intersection

Created on: 6/24/2025

transportation.ohio.gov

Prepared by  
The Ohio Department of Transportation  
Office of Technical Services  
Roadway Information

# SALLSR00081\*\*C

State True Log

44.869

County True Log

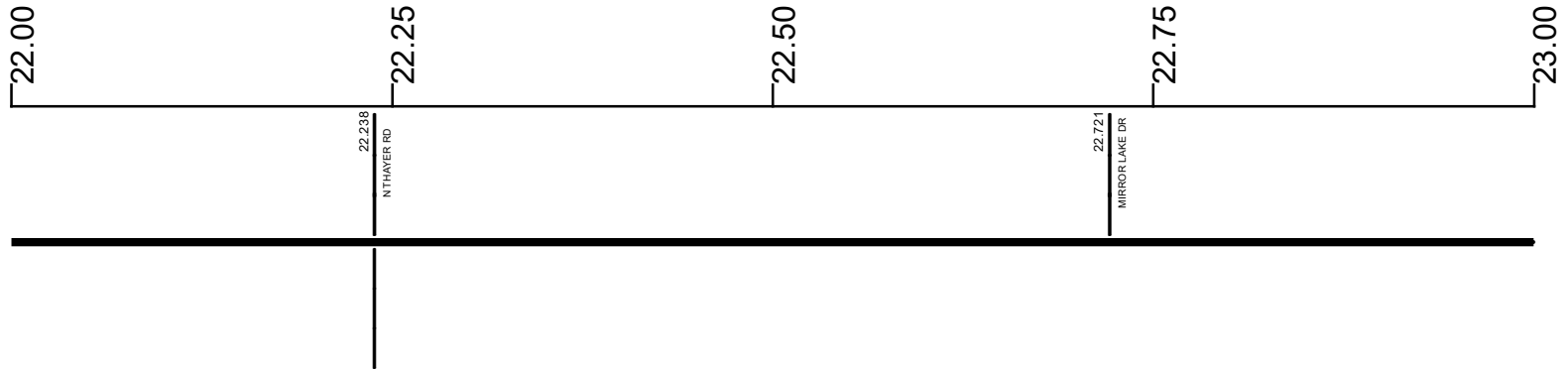

Surface Type & Width (Left / Right)

	G 24'
	21.558 - 23.75

Base Type (Left / Right)

	L
	21.204 - 23.75

Shoulder Type & Width (Left / Right)

	2 (10'/10')
	21.558 - 26.789

Through Lanes

	2
	19.67 - 29.408

Street Name

	ADA RD
	19.416 - 29.408

- |                     |                   |                      |              |
|---------------------|-------------------|----------------------|--------------|
| Non-divided Highway | Bridge (on route) | Railroad (at grade)  | Intersection |
| Divided Highway     | Underpass         | Railroad (underpass) |              |
| Secondary Segment   | Overpass          | Railroad (overpass)  |              |
| Corporation         |                   |                      |              |

Created on: 6/24/2025

transportation.ohio.gov

Prepared by  
The Ohio Department of Transportation  
Office of Technical Services  
Roadway Information

# SALLSR00081\*\*C

State True Log

County True Log

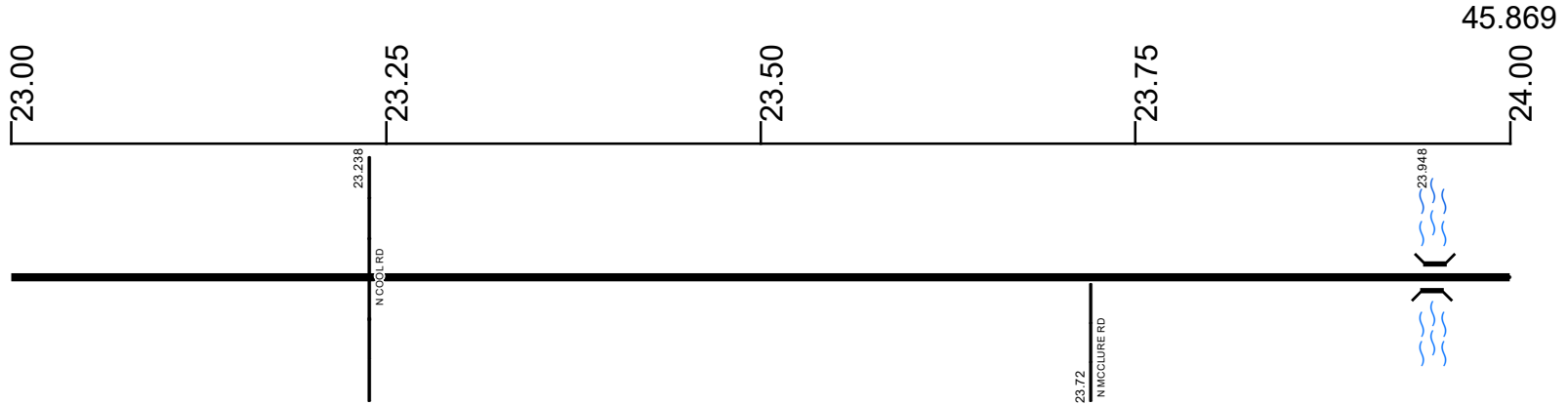

**Surface Type & Width (Left / Right)**

G 24'	G (17'7")
21.558 - 23.75	23.75 - 24.045

**Base Type (Left / Right)**

L	K / L
21.204 - 23.75	23.75 - 24.045

**Shoulder Type & Width (Left / Right)**

2 (10'/10')
21.558 - 26.789

**Through Lanes**

2
19.67 - 29.408

**Street Name**

ADA RD
19.416 - 29.408

- Non-divided Highway
- Divided Highway
- Secondary Segment
- Corporation
- Bridge (on route)
- Underpass
- Overpass
- Railroad (at grade)
- Railroad (underpass)
- Railroad (overpass)
- Intersection

Created on: 6/24/2025

transportation.ohio.gov

Prepared by  
The Ohio Department of Transportation  
Office of Technical Services  
Roadway Information

# SALLSR00081\*\*C

State True Log

46.869

County True Log

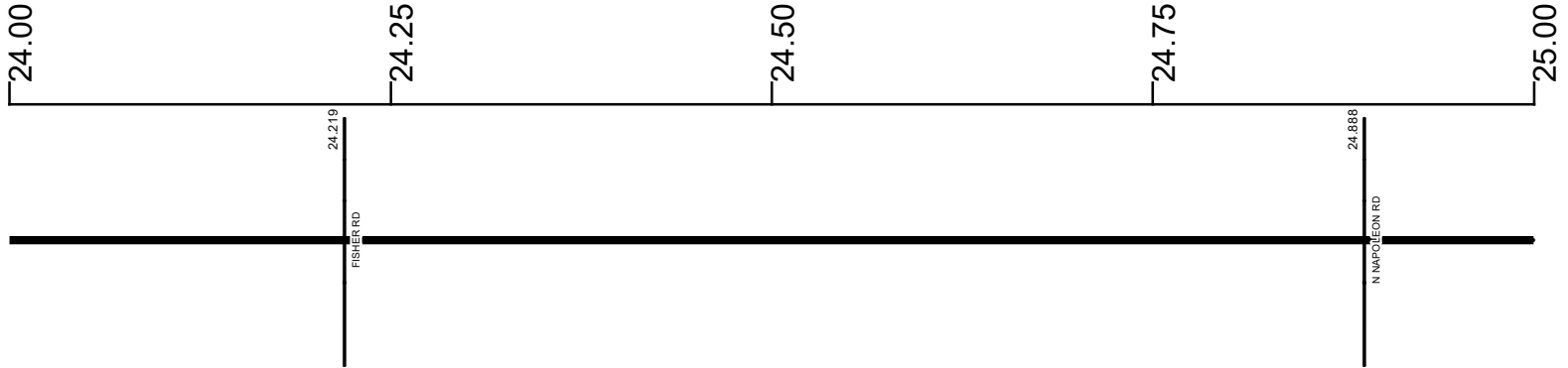

**Surface Type & Width (Left / Right)**

G (17'/7')	G 24'
23.75 - 24.045	24.045 - 26.789

**Base Type (Left / Right)**

K / L	L
23.75 - 24.045	24.045 - 26.789

**Shoulder Type & Width (Left / Right)**

	2 (10'/10')
	21.558 - 26.789

**Through Lanes**

	2
	19.67 - 29.408

**Street Name**

	ADA RD
	19.416 - 29.408

- |  |   |   |   |
|--|---|---|---|
| <ul style="list-style-type: none"> <li> Non-divided Highway</li> <li> Divided Highway</li> <li> Secondary Segment</li> <li> Corporation</li> </ul> | <ul style="list-style-type: none"> <li> Bridge (on route)</li> <li> Underpass</li> <li> Overpass</li> </ul> | <ul style="list-style-type: none"> <li> Railroad (at grade)</li> <li> Railroad (underpass)</li> <li> Railroad (overpass)</li> </ul> | <ul style="list-style-type: none"> <li> Intersection</li> </ul> |
|--|---|---|---|

Created on: 6/24/2025

transportation.ohio.gov

Prepared by  
The Ohio Department of Transportation  
Office of Technical Services  
Roadway Information

# SALLSR00081\*\*C

State True Log

47.869

County True Log

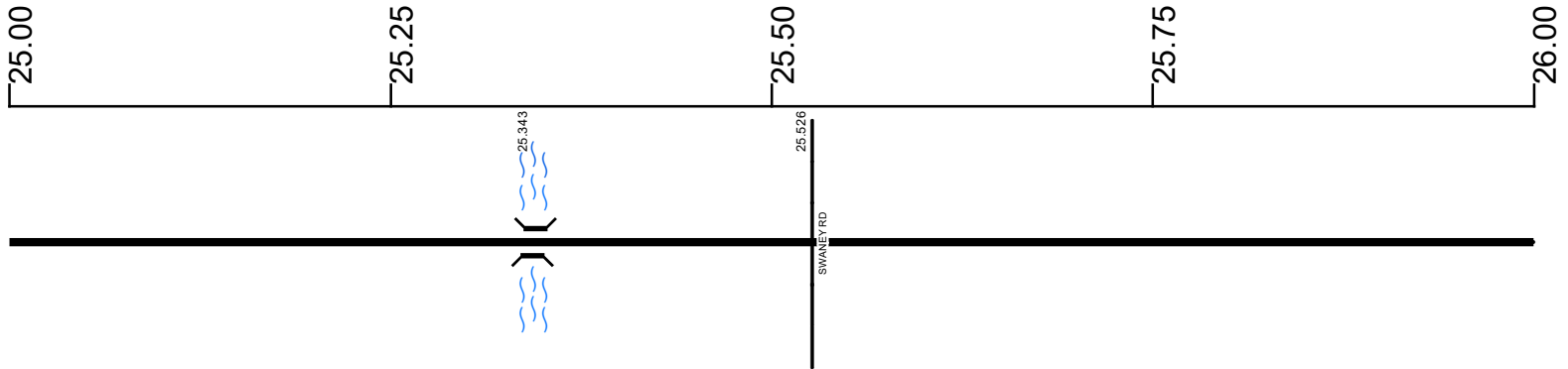

Surface Type & Width (Left / Right)

G 24'  
24.045 - 26.789

Base Type (Left / Right)

L  
24.045 - 26.789

Shoulder Type & Width (Left / Right)

2 (10'/10')  
21.558 - 26.789

Through Lanes

2  
19.67 - 29.408

Street Name

ADA RD  
19.416 - 29.408

- |                     |                   |                      |              |
|---------------------|-------------------|----------------------|--------------|
| Non-divided Highway | Bridge (on route) | Railroad (at grade)  | Intersection |
| Divided Highway     | Underpass         | Railroad (underpass) |              |
| Secondary Segment   | Overpass          | Railroad (overpass)  |              |
| Corporation         |                   |                      |              |

Created on: 6/24/2025

transportation.ohio.gov

Prepared by  
The Ohio Department of Transportation  
Office of Technical Services  
Roadway Information

# SALLSR00081\*\*C

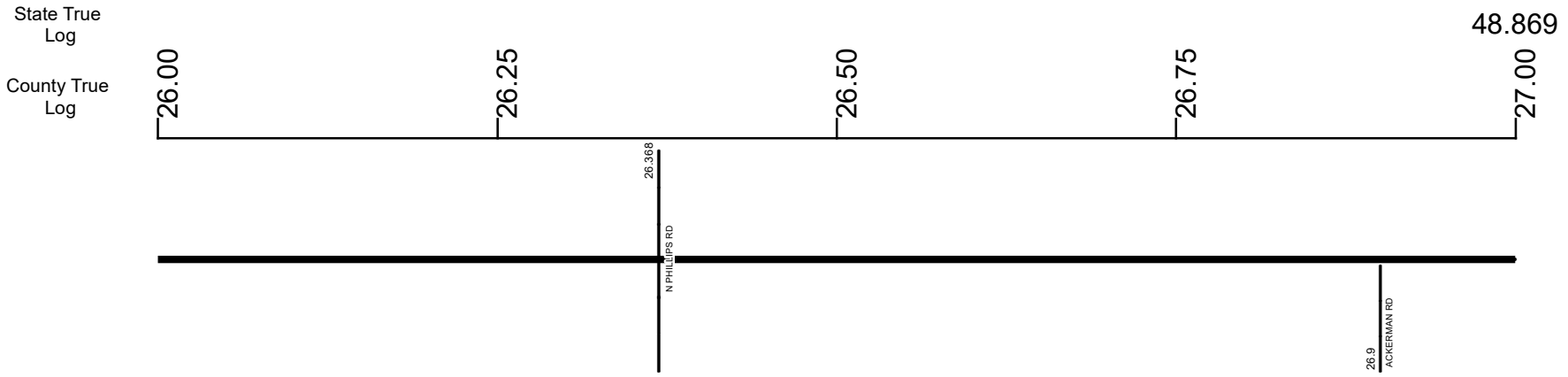

Surface Type & Width (Left / Right)	
G 24'	G 22'
24.045 - 26.789	26.789 - 29.408
Base Type (Left / Right)	
L	I
24.045 - 26.789	26.789 - 29.408
Shoulder Type & Width (Left / Right)	
2 (10'/10')	2 (5'/5')
21.558 - 26.789	26.789 - 29.408
Through Lanes	
2	
19.67 - 29.408	
Street Name	
ADA RD	
19.416 - 29.408	

- Non-divided Highway
- Divided Highway
- Secondary Segment
- Corporation
- Bridge (on route)
- Underpass
- Overpass
- Railroad (at grade)
- Railroad (underpass)
- Railroad (overpass)
- Intersection

Created on: 6/24/2025

transportation.ohio.gov

Prepared by  
The Ohio Department of Transportation  
Office of Technical Services  
Roadway Information

# SALLSR00081\*\*C

State True Log

49.869

County True Log

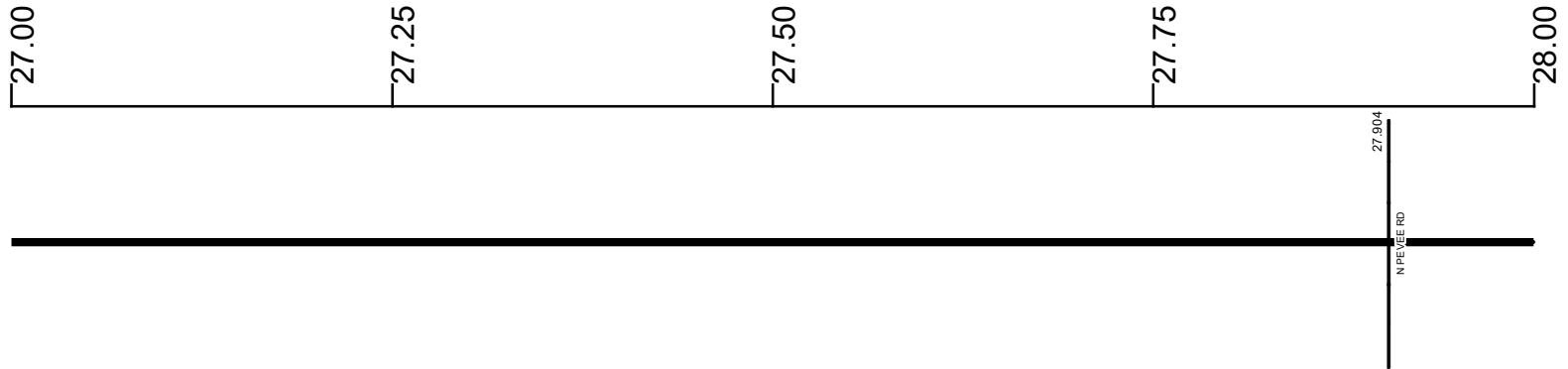

Surface Type & Width (Left / Right)

G 22'  
26.789 - 29.408

Base Type (Left / Right)

I  
26.789 - 29.408

Shoulder Type & Width (Left / Right)

2 (5/5)  
26.789 - 29.408

Through Lanes

2  
19.67 - 29.408

Street Name

ADA RD  
19.416 - 29.408

- |                     |                   |                      |              |
|---------------------|-------------------|----------------------|--------------|
| Non-divided Highway | Bridge (on route) | Railroad (at grade)  | Intersection |
| Divided Highway     | Underpass         | Railroad (underpass) |              |
| Secondary Segment   | Overpass          | Railroad (overpass)  |              |
| Corporation         |                   |                      |              |

Created on: 6/24/2025

transportation.ohio.gov

Prepared by  
The Ohio Department of Transportation  
Office of Technical Services  
Roadway Information

# SALLSR00081\*\*C

State True Log

50.869

County True Log

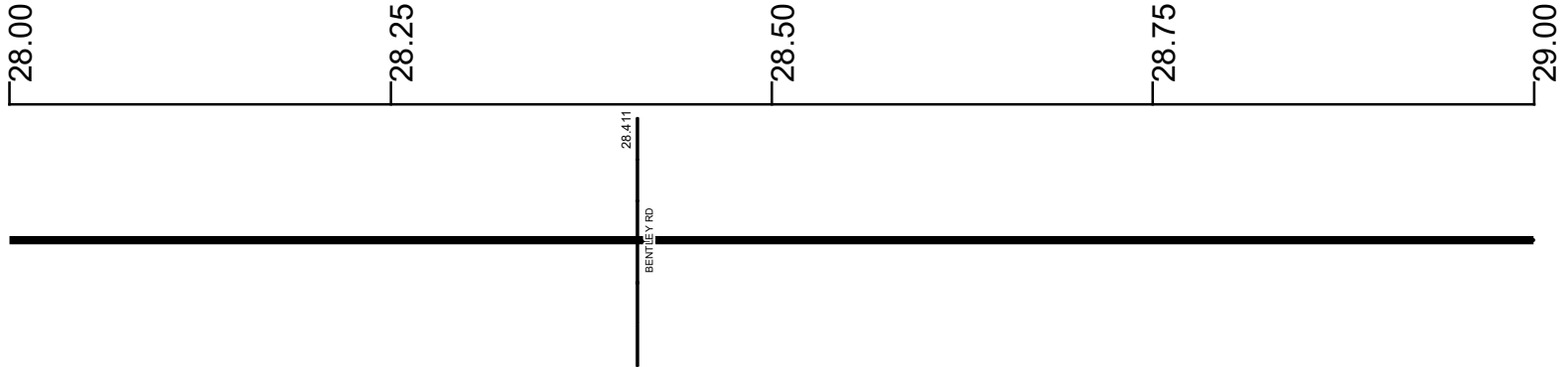

Surface Type & Width (Left / Right)

G 22'  
26.789 - 29.408

Base Type (Left / Right)

I  
26.789 - 29.408

Shoulder Type & Width (Left / Right)

2 (5/5)  
26.789 - 29.408

Through Lanes

2  
19.67 - 29.408

Street Name

ADA RD  
19.416 - 29.408

- |                     |                   |                      |              |
|---------------------|-------------------|----------------------|--------------|
| Non-divided Highway | Bridge (on route) | Railroad (at grade)  | Intersection |
| Divided Highway     | Underpass         | Railroad (underpass) |              |
| Secondary Segment   | Overpass          | Railroad (overpass)  |              |
| Corporation         |                   |                      |              |

Created on: 6/24/2025



transportation.ohio.gov

Prepared by  
The Ohio Department of Transportation  
Office of Technical Services  
Roadway Information

# SALLSR00081\*\*C

51.277

State True Log

County True Log

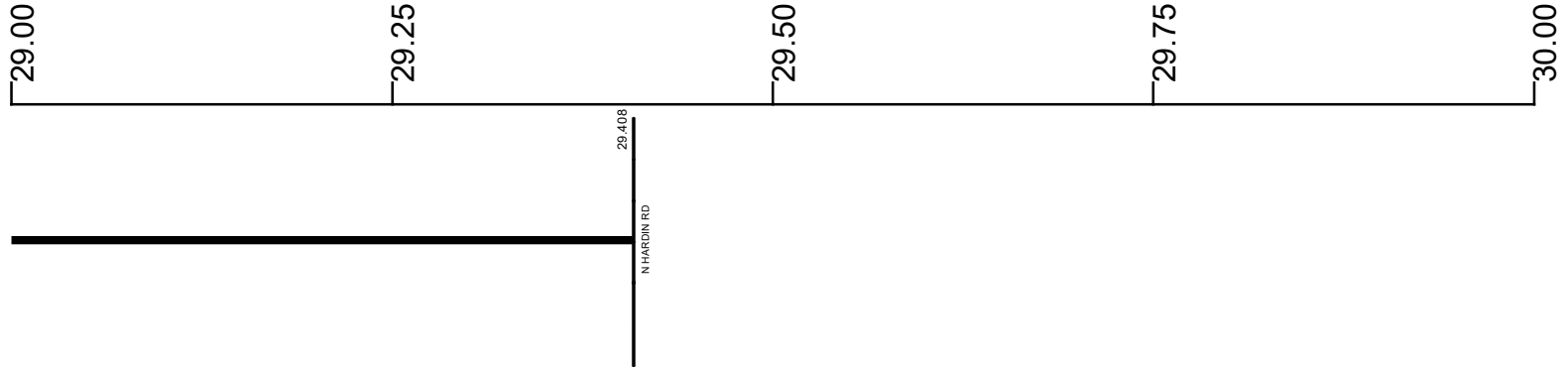

Surface Type & Width (Left / Right)

G 22'  
26.789 - 29.408

Base Type (Left / Right)

I  
26.789 - 29.408

Shoulder Type & Width (Left / Right)

2 (5'/5')  
26.789 - 29.408

Through Lanes

2  
19.67 - 29.408

Street Name

ADA RD  
19.416 - 29.408

- Non-divided Highway
- Divided Highway
- Secondary Segment
- Corporation
- Bridge (on route)
- Underpass
- Overpass
- Railroad (at grade)
- Railroad (underpass)
- Railroad (overpass)
- Intersection

Created on: 6/24/2025



transportation.ohio.gov

Prepared by

The Ohio Department of Transportation  
Office of Technical Services  
Roadway Information

## Historical Project List for SALLSR00081\*\*C

Begin Measure	End Measure	Project ID Number	Construction Completion Date	Treatment Category	Treatment Type
0.000	3.066	109214	7-2017	Preventive Maintenance	25-Chip Seal
0.000	3.066	80505	7-2012	Minor Rehabilitation	60-AC Overlay w/Rpr
3.306	11.338	105527	4-2021	Minor Rehabilitation	50-AC Overlay w/o Rpr
11.338	13.468	87188	10-2019	Minor Rehabilitation	60-AC Overlay w/Rpr
14.470	15.718	115562	6-2023	Minor Rehabilitation	60-AC Overlay w/Rpr
15.538	15.718	80457	6-2007	Minor Rehabilitation	52-AC Inlay
15.808	16.650	88840	8-2016	Minor Rehabilitation	50-AC Overlay w/o Rpr
16.650	16.842	88840	8-2016	Minor Rehabilitation	50-AC Overlay w/o Rpr
16.992	18.143	76575	6-2006	Minor Rehabilitation	52-AC Inlay
17.010	18.133	115562	6-2023	Minor Rehabilitation	60-AC Overlay w/Rpr
18.143	18.463	86634	9-2015	Minor Rehabilitation	60-AC Overlay w/Rpr
19.663	29.408	80492	11-2014	Minor Rehabilitation	60-AC Overlay w/Rpr
19.693	29.408	109878	10-2020	Preventive Maintenance	25-Chip Seal
23.875	23.975	88848	10-2018	Minor Rehabilitation	50-AC Overlay w/o Rpr

# Roadway Codes

## Access Control Journalized

- F - Full Access Control
- L - Limited Access Control
- N - No Access Control

## Access Control Operational

- 1 - Full Access Control
- 2 - Partial Access Control
- 3 - No Access Control

## Base Type

- F - Crack and Seat
- H - Rubblize and Roll
- I - Aggregate Base 304 or Traffic Compacted
- K - Water Bound Macadam
- L - Bituminous Concrete Mix or Penetration Macadam
- N - Plain Concrete
- P - Reinforced Concrete
- R - Brick (Flexible)
- T - Brick (Rigid)

## Direction of Travel

- B - Both (Two-way)
- F - One-way Cardinal
- T - One-way Non-cardinal

## Facility Type

- 1 - One-way Roadway
- 2 - Two-way Roadway
- 4 - Ramp
- 5 - Non-mainline
- 6 - Non-inventory Direction
- 7 - Planned / Unbuilt

## Historical Federal Aid Indicator

- N - Not a FAP Route
- Y - FAP Route

## Functional Classification

- 01 - Interstate
- 02 - Principal Arterial (Freeways)
- 03 - Principal Arterial (Other)
- 04 - Minor Arterial
- 05 - Major Collector
- 06 - Minor Collector
- 07 - Local

## Leave / Reenter Indicator

- Y - Route leaves/reenters at this point
- N - Route does not leave/reenter at this point

## Median Type

- 1 - None
- 2 - Unprotected
- 3 - Curbed
- 4 - Positive Barrier (Unspecified)
- 5 - Positive Barrier (Flexible)
- 6 - Positive Barrier (Semi-rigid)
- 7 - Positive Barrier (Rigid)

## NHS

- N - National Highway System
- H - Congressional Corridor
- 2 - Major Airport
- 3 - Major Port Facility
- 4 - Major Amtrak Station
- 5 - Major Rail / Truck Terminal
- 6 - Major Intercity Bus Terminal
- 7 - Major Public Transit / Multi-modal Passenger Terminal
- 8 - Major Pipeline Terminal
- 9 - Major Ferry Terminal

## Priority System

- G - General
- P - Priority System
- U - Urban

## Scenic Byway Code

- A - All American Road
- N - National Scenic Byway
- S - State Scenic Byway

## Shoulder Type

- 1 - None
- 2 - Surfaced shoulder exists (bituminous concrete {AC})
- 3 - Surfaced shoulder exists (Portland Cement Concrete {PCC})
- 4 - Stabilized shoulder exists (gravel or other granular material)
- 5 - Combination shoulder exists (two or more surface types)
- 6 - Earth shoulder exists
- 7 - Barrier curb exists; no shoulder in front of curb

## Surface Type

- A - Combination
- B - Brick
- C - Continuous Reinforced Concrete
- D - Reinforced Concrete
- E - Plain Concrete
- G - Bituminous Concrete
- I - Chipseal on Granular
- K - Open Graded Bituminous
- L - Chipseal or Micro
- M - Gravel
- U - Unimproved
- X - Right of Way Only