

SASDSR00095**C

State True Log 66.799

67.799

County True Log

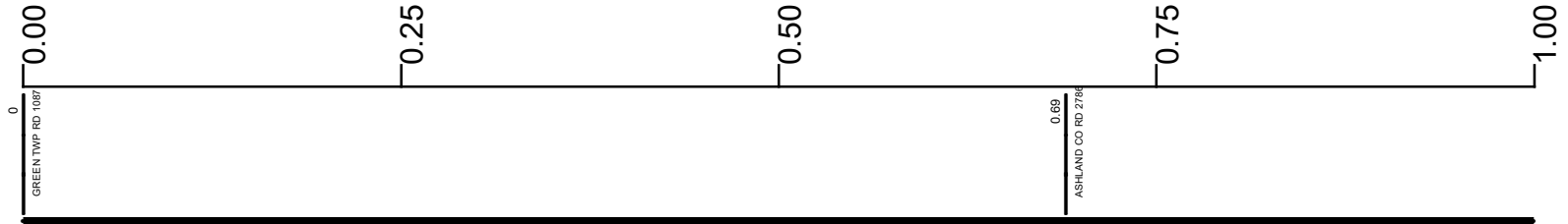

Surface Type & Width (Left / Right)

G 20'	G 24'
0 - 0.609	0.609 - 1.421

Base Type (Left / Right)

I	L
0 - 0.609	0.609 - 1.421

Shoulder Type & Width (Left / Right)

2 (2'/2')	2 (2'/3')
0 - 0.609	0.609 - 1.212

Through Lanes

2	
0 - 13.499	

Street Name

SR 95	
0 - 13.499	

- Non-divided Highway
- Divided Highway
- Secondary Segment
- Corporation
- Bridge (on route)
- Underpass
- Overpass
- Railroad (at grade)
- Railroad (underpass)
- Railroad (overpass)
- Intersection

Created on: 6/24/2025

transportation.ohio.gov

Prepared by
The Ohio Department of Transportation
Office of Technical Services
Roadway Information

SASDSR00095**C

State True Log

68.799

County True Log

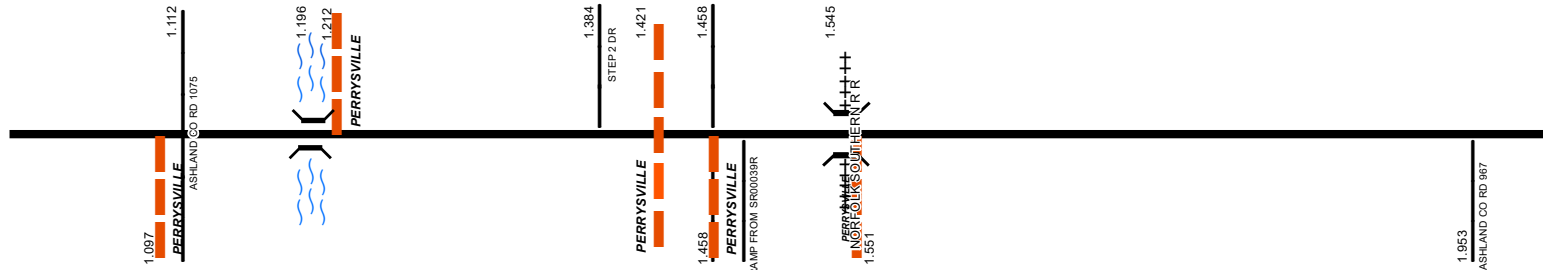

Surface Type & Width (Left / Right)	
G 24' 0.609 - 1.421	G 20' 1.421 - 10.165
Base Type (Left / Right)	
L 0.609 - 1.421	I 1.421 - 13.499
Shoulder Type & Width (Left / Right)	
2 (2/3') 0.609 - 1.212	2 (3/3') 1.212 - 13.499
Through Lanes	
2 0 - 13.499	
Street Name	
SR 95 0 - 13.499	

Non-divided Highway	Bridge (on route)	Railroad (at grade)	Intersection
Divided Highway	Underpass	Railroad (underpass)	
Secondary Segment	Overpass	Railroad (overpass)	
Corporation			

Created on: 6/24/2025

transportation.ohio.gov
Prepared by
The Ohio Department of Transportation
Office of Technical Services
Roadway Information

SASDSR00095**C

State True Log

69.799

County True Log



Surface Type & Width (Left / Right)	G 20' 1.421 - 10.165
Base Type (Left / Right)	I 1.421 - 13.499
Shoulder Type & Width (Left / Right)	2 (3/3) 1.212 - 13.499
Through Lanes	2 0 - 13.499
Street Name	SR 95 0 - 13.499

- | | | | |
|---------------------|-------------------|----------------------|--------------|
| Non-divided Highway | Bridge (on route) | Railroad (at grade) | Intersection |
| Divided Highway | Underpass | Railroad (underpass) | |
| Secondary Segment | Overpass | Railroad (overpass) | |
| Corporation | | | |

Created on: 6/24/2025

transportation.ohio.gov

Prepared by
The Ohio Department of Transportation
Office of Technical Services
Roadway Information

SASDSR00095**C

State True Log

70.799

County True Log

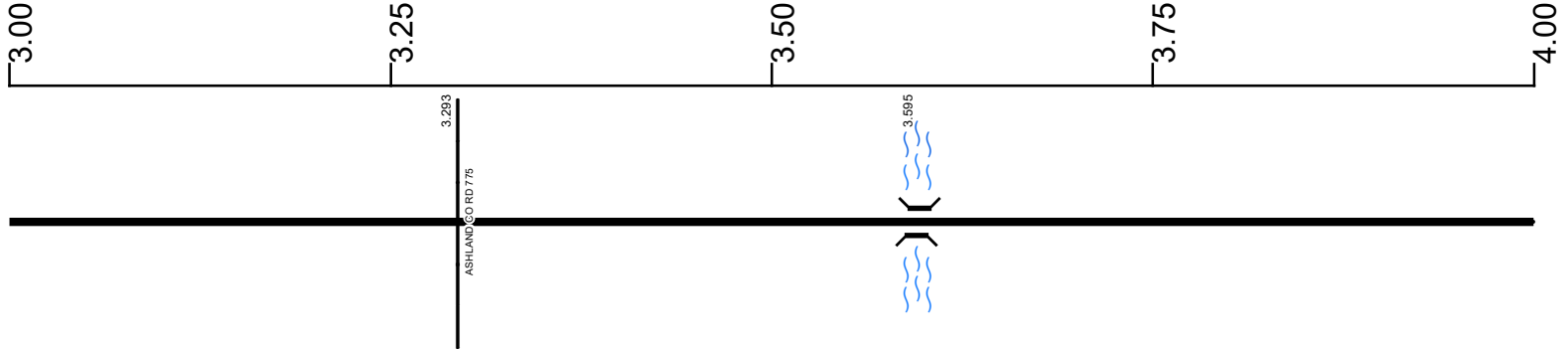

Surface Type & Width (Left / Right)

G 20'
1.421 - 10.165

Base Type (Left / Right)

I
1.421 - 13.499

Shoulder Type & Width (Left / Right)

2 (3/3')
1.212 - 13.499

Through Lanes

2
0 - 13.499

Street Name

SR 95
0 - 13.499

- Non-divided Highway
- Divided Highway
- Secondary Segment
- Corporation
- Bridge (on route)
- Underpass
- Overpass
- Railroad (at grade)
- Railroad (underpass)
- Railroad (overpass)
- Intersection

Created on: 6/24/2025



transportation.ohio.gov
 Prepared by
 The Ohio Department of Transportation
 Office of Technical Services
 Roadway Information

SASDSR00095**C

State True Log

71.799

County True Log



Surface Type & Width (Left / Right)

	G 20'
	1.421 - 10.165

Base Type (Left / Right)

	I
	1.421 - 13.499

Shoulder Type & Width (Left / Right)

	2 (3/3')
	1.212 - 13.499

Through Lanes

	2
	0 - 13.499

Street Name

	SR 95
	0 - 13.499

- | | | | |
|---------------------|-------------------|----------------------|--------------|
| Non-divided Highway | Bridge (on route) | Railroad (at grade) | Intersection |
| Divided Highway | Underpass | Railroad (underpass) | |
| Secondary Segment | Overpass | Railroad (overpass) | |
| Corporation | | | |

Created on: 6/24/2025

transportation.ohio.gov

Prepared by
The Ohio Department of Transportation
Office of Technical Services
Roadway Information

SASDSR00095**C

State True Log

72.799

County True Log

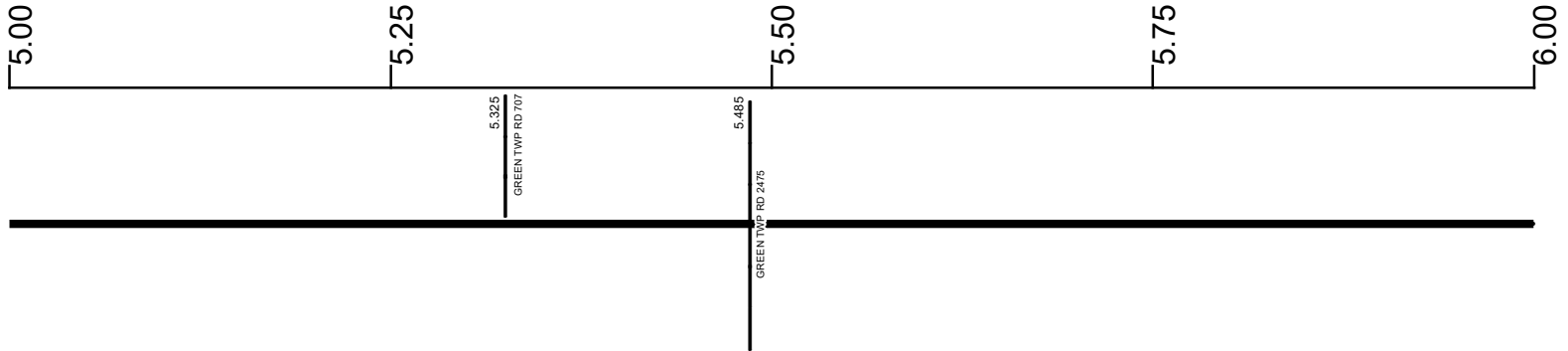

Surface Type & Width (Left / Right)

G 20'
1.421 - 10.165

Base Type (Left / Right)

I
1.421 - 13.499

Shoulder Type & Width (Left / Right)

2 (3/3)
1.212 - 13.499

Through Lanes

2
0 - 13.499

Street Name

SR 95
0 - 13.499

- Non-divided Highway
- Divided Highway
- Secondary Segment
- Corporation
- Bridge (on route)
- Underpass
- Overpass
- Railroad (at grade)
- Railroad (underpass)
- Railroad (overpass)
- Intersection

Created on: 6/24/2025

transportation.ohio.gov
Prepared by
The Ohio Department of Transportation
Office of Technical Services
Roadway Information

SASDSR00095**C

State True Log

73.799

County True Log

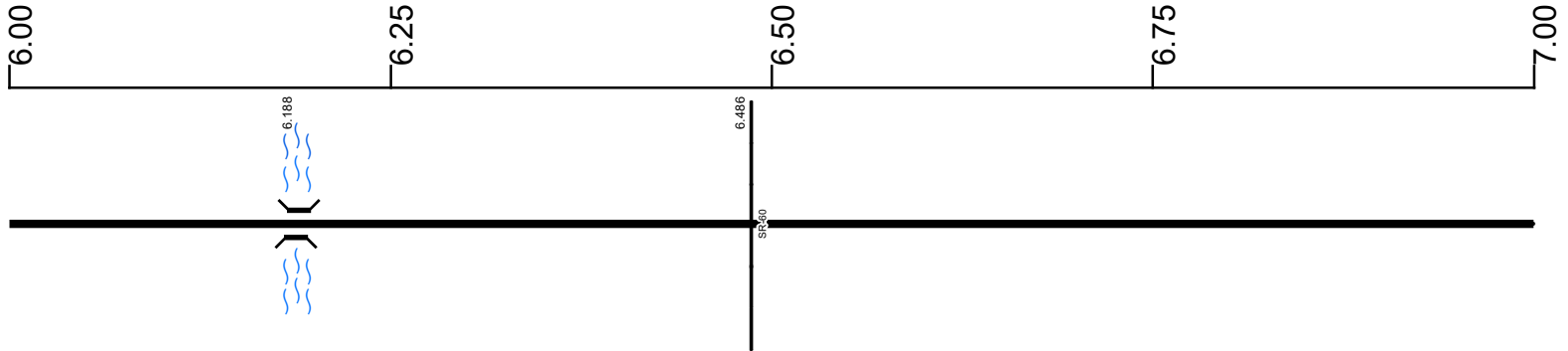

Surface Type & Width (Left / Right)

G 20'
1.421 - 10.165

Base Type (Left / Right)

I
1.421 - 13.499

Shoulder Type & Width (Left / Right)

2 (3/3')
1.212 - 13.499

Through Lanes

2
0 - 13.499

Street Name

SR 95
0 - 13.499

- Non-divided Highway
- Divided Highway
- Secondary Segment
- Corporation
- Bridge (on route)
- Underpass
- Overpass
- Railroad (at grade)
- Railroad (underpass)
- Railroad (overpass)
- Intersection

Created on: 6/24/2025

transportation.ohio.gov
 Prepared by
 The Ohio Department of Transportation
 Office of Technical Services
 Roadway Information

SASDSR00095**C

State True Log

74.799

County True Log

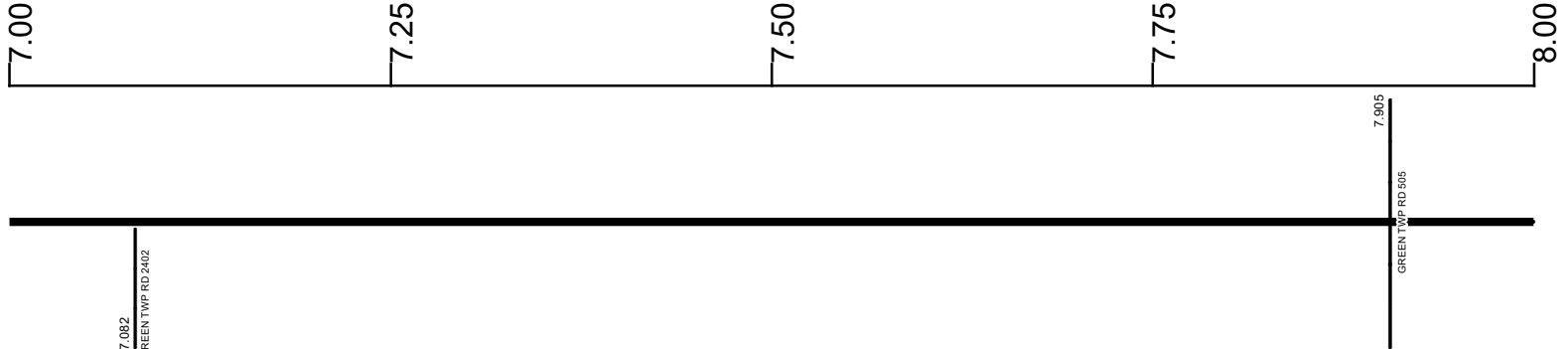

Surface Type & Width (Left / Right)

G 20'
1.421 - 10.165

Base Type (Left / Right)

I
1.421 - 13.499

Shoulder Type & Width (Left / Right)

2 (3/3)
1.212 - 13.499

Through Lanes

2
0 - 13.499

Street Name

SR 95
0 - 13.499

- Non-divided Highway
- Divided Highway
- Secondary Segment
- Corporation
- Bridge (on route)
- Underpass
- Overpass
- Railroad (at grade)
- Railroad (underpass)
- Railroad (overpass)
- Intersection

Created on: 6/24/2025



transportation.ohio.gov
Prepared by
The Ohio Department of Transportation
Office of Technical Services
Roadway Information

SASDSR00095**C

State True Log

75.799

County True Log

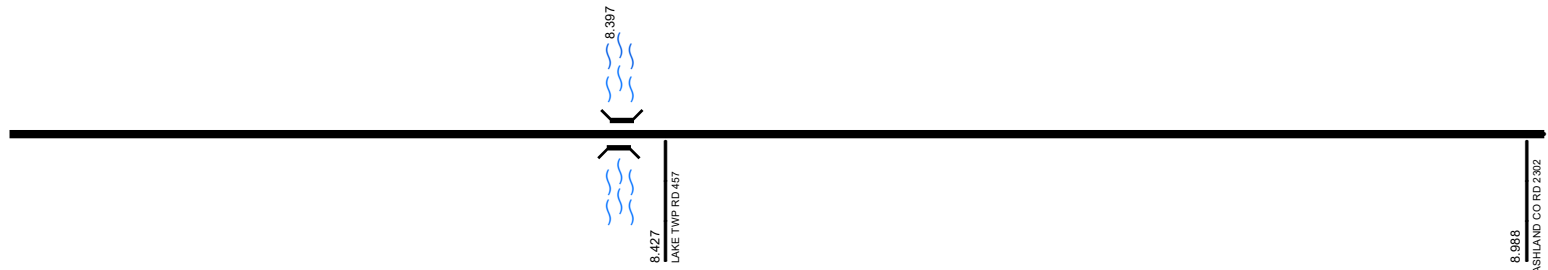

Surface Type & Width (Left / Right)	G 20' 1.421 - 10.165
Base Type (Left / Right)	I 1.421 - 13.499
Shoulder Type & Width (Left / Right)	2 (3/3) 1.212 - 13.499
Through Lanes	2 0 - 13.499
Street Name	SR 95 0 - 13.499

<ul style="list-style-type: none"> Non-divided Highway Divided Highway Secondary Segment Corporation 	<ul style="list-style-type: none"> Bridge (on route) Underpass Overpass 	<ul style="list-style-type: none"> Railroad (at grade) Railroad (underpass) Railroad (overpass) 	<ul style="list-style-type: none"> Intersection
--	---	---	---

Created on: 6/24/2025

transportation.ohio.gov

Prepared by
The Ohio Department of Transportation
Office of Technical Services
Roadway Information

SASDSR00095**C

State True Log

76.799

County True Log

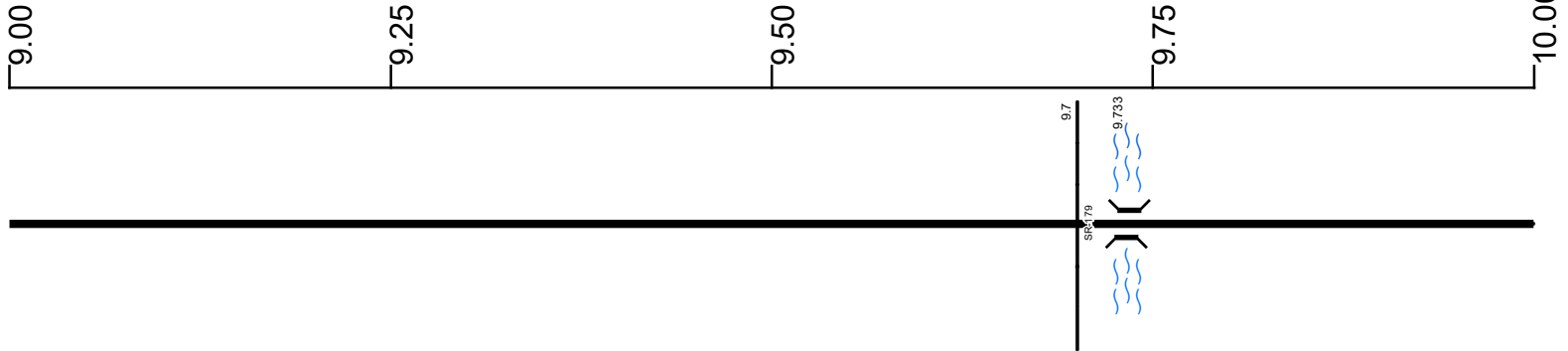

Surface Type & Width (Left / Right)

G 20'
1.421 - 10.165

Base Type (Left / Right)

I
1.421 - 13.499

Shoulder Type & Width (Left / Right)

2 (3/3)
1.212 - 13.499

Through Lanes

2
0 - 13.499

Street Name

SR 95
0 - 13.499

- | | | | |
|---------------------|-------------------|----------------------|--------------|
| Non-divided Highway | Bridge (on route) | Railroad (at grade) | Intersection |
| Divided Highway | Underpass | Railroad (underpass) | |
| Secondary Segment | Overpass | Railroad (overpass) | |
| Corporation | | | |

Created on: 6/24/2025

transportation.ohio.gov

Prepared by
The Ohio Department of Transportation
Office of Technical Services
Roadway Information

SASDSR00095**C

State True Log
County True Log

77.799

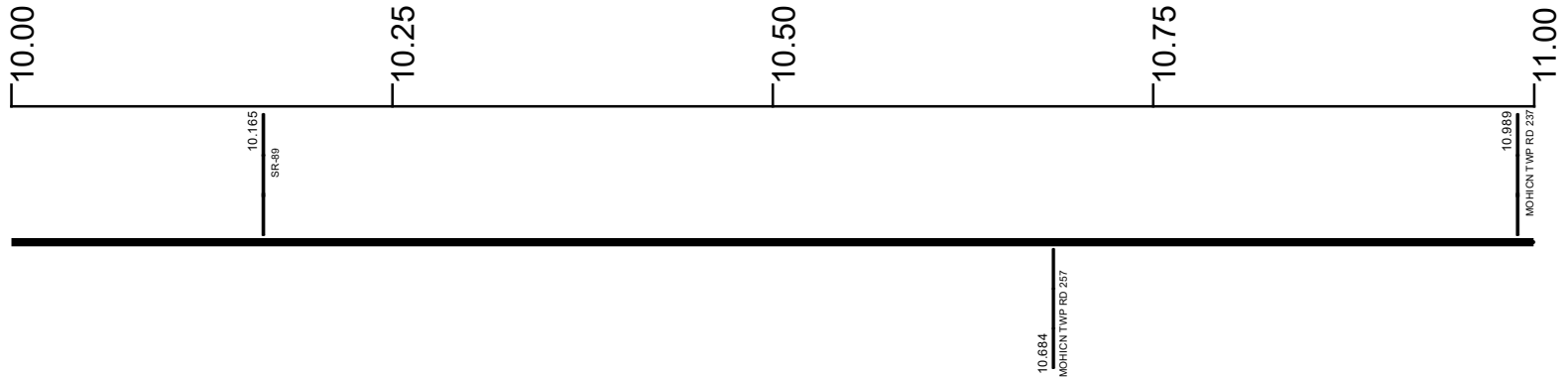

Surface Type & Width (Left / Right)

G 20'	G 18'
1.421 - 10.165	10.165 - 11.997

Base Type (Left / Right)

I	I
1.421 - 13.499	

Shoulder Type & Width (Left / Right)

2 (3/3')	2 (3/3')
1.212 - 13.499	

Through Lanes

2	2
0 - 13.499	

Street Name

SR 95	SR 95
0 - 13.499	

- Non-divided Highway
- Divided Highway
- Secondary Segment
- Corporation
- Bridge (on route)
- Underpass
- Overpass
- Railroad (at grade)
- Railroad (underpass)
- Railroad (overpass)
- Intersection

Created on: 6/24/2025

transportation.ohio.gov

Prepared by
The Ohio Department of Transportation
Office of Technical Services
Roadway Information

SASDSR00095**C

State True Log

78.799

County True Log

11.00

11.25

11.50

11.75

12.00

11.87
MOHICN TWP RD 2156



Surface Type & Width (Left / Right)

	G 18'	G (9'/10')
	10.165 - 11.997	

Base Type (Left / Right)

	I	
	1.421 - 13.499	

Shoulder Type & Width (Left / Right)

	2 (3/3')	
	1.212 - 13.499	

Through Lanes

	2	
	0 - 13.499	

Street Name

	SR 95	
	0 - 13.499	

- Non-divided Highway
- Divided Highway
- Secondary Segment
- Corporation
- Bridge (on route)
- Underpass
- Overpass
- Railroad (at grade)
- Railroad (underpass)
- Railroad (overpass)
- Intersection

Created on: 6/24/2025

transportation.ohio.gov

Prepared by
The Ohio Department of Transportation
Office of Technical Services
Roadway Information

SASDSR00095**C

State True Log
County True Log

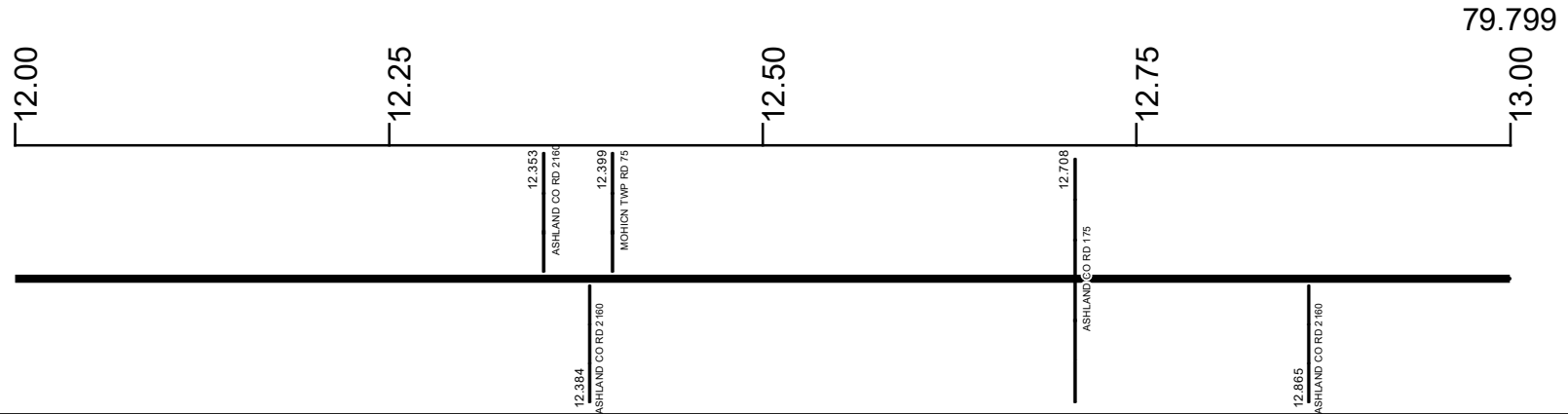

Surface Type & Width (Left / Right)	G (9'/10')
	11.997 - 13.499
Base Type (Left / Right)	I
	1.421 - 13.499
Shoulder Type & Width (Left / Right)	2 (3'/3')
	1.212 - 13.499
Through Lanes	2
	0 - 13.499
Street Name	SR 95
	0 - 13.499

Non-divided Highway	Bridge (on route)	Railroad (at grade)	Intersection
Divided Highway	Underpass	Railroad (underpass)	
Secondary Segment	Overpass	Railroad (overpass)	
Corporation			

 transportation.ohio.gov
 Prepared by
 The Ohio Department of Transportation
 Office of Technical Services
 Roadway Information

Created on: 6/24/2025

SASDSR00095**C

80.298

State True Log

County True Log

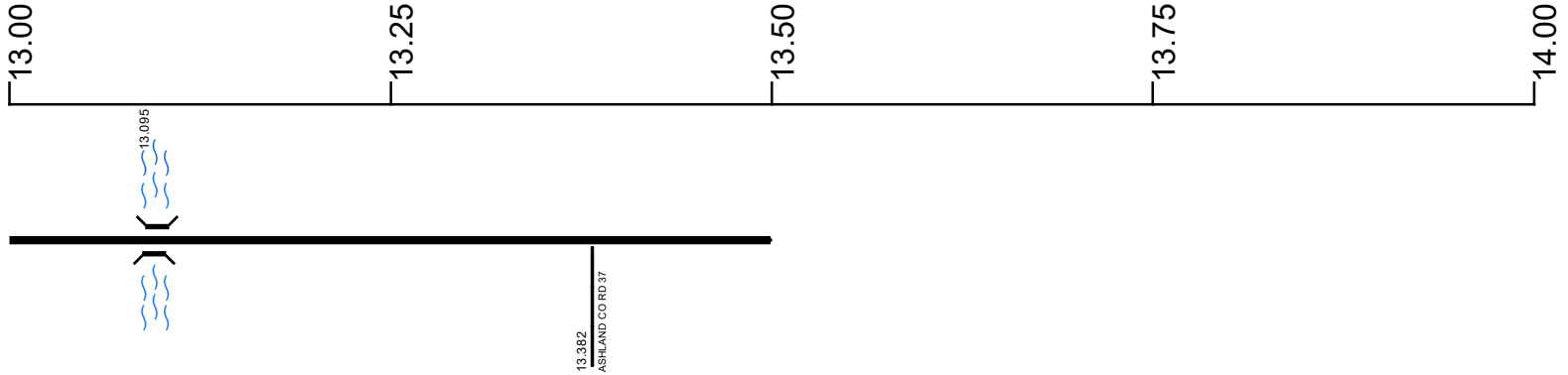

Surface Type & Width (Left / Right)	G (9'/10')
	11.997 - 13.499
Base Type (Left / Right)	I
	1.421 - 13.499
Shoulder Type & Width (Left / Right)	2 (3'/3')
	1.212 - 13.499
Through Lanes	2
	0 - 13.499
Street Name	SR 95
	0 - 13.499

Non-divided Highway	Bridge (on route)	Railroad (at grade)	Intersection
Divided Highway	Underpass	Railroad (underpass)	
Secondary Segment	Overpass	Railroad (overpass)	
Corporation			

Created on: 6/24/2025



transportation.ohio.gov
 Prepared by
 The Ohio Department of Transportation
 Office of Technical Services
 Roadway Information

Historical Project List for SASDSR00095**C

Begin Measure	End Measure	Project ID Number	Construction Completion Date	Treatment Category	Treatment Type
0.000	1.460	88808	5-2016	Minor Rehabilitation	60-AC Overlay w/Rpr
0.000	1.460	25657	9-2006	Minor Rehabilitation	60-AC Overlay w/Rpr
1.460	6.490	102972	5-2023	Preventive Maintenance	25-Chip Seal
1.460	13.499	98400	9-2017	Preventive Maintenance	25-Chip Seal
1.460	13.499	80170	11-2010	Minor Rehabilitation	60-AC Overlay w/Rpr

Roadway Codes

Access Control Journalized

- F - Full Access Control
- L - Limited Access Control
- N - No Access Control

Access Control Operational

- 1 - Full Access Control
- 2 - Partial Access Control
- 3 - No Access Control

Base Type

- F - Crack and Seat
- H - Rubblize and Roll
- I - Aggregate Base 304 or Traffic Compacted
- K - Water Bound Macadam
- L - Bituminous Concrete Mix or Penetration Macadam
- N - Plain Concrete
- P - Reinforced Concrete
- R - Brick (Flexible)
- T - Brick (Rigid)

Direction of Travel

- B - Both (Two-way)
- F - One-way Cardinal
- T - One-way Non-cardinal

Facility Type

- 1 - One-way Roadway
- 2 - Two-way Roadway
- 4 - Ramp
- 5 - Non-mainline
- 6 - Non-inventory Direction
- 7 - Planned / Unbuilt

Historical Federal Aid Indicator

- N - Not a FAP Route
- Y - FAP Route

Functional Classification

- 01 - Interstate
- 02 - Principal Arterial (Freeways)
- 03 - Principal Arterial (Other)
- 04 - Minor Arterial
- 05 - Major Collector
- 06 - Minor Collector
- 07 - Local

Leave / Reenter Indicator

- Y - Route leaves/reenters at this point
- N - Route does not leave/reenter at this point

Median Type

- 1 - None
- 2 - Unprotected
- 3 - Curbed
- 4 - Positive Barrier (Unspecified)
- 5 - Positive Barrier (Flexible)
- 6 - Positive Barrier (Semi-rigid)
- 7 - Positive Barrier (Rigid)

NHS

- N - National Highway System
- H - Congressional Corridor
- 2 - Major Airport
- 3 - Major Port Facility
- 4 - Major Amtrak Station
- 5 - Major Rail / Truck Terminal
- 6 - Major Intercity Bus Terminal
- 7 - Major Public Transit / Multi-modal Passenger Terminal
- 8 - Major Pipeline Terminal
- 9 - Major Ferry Terminal

Priority System

- G - General
- P - Priority System
- U - Urban

Scenic Byway Code

- A - All American Road
- N - National Scenic Byway
- S - State Scenic Byway

Shoulder Type

- 1 - None
- 2 - Surfaced shoulder exists (bituminous concrete {AC})
- 3 - Surfaced shoulder exists (Portland Cement Concrete {PCC})
- 4 - Stabilized shoulder exists (gravel or other granular material)
- 5 - Combination shoulder exists (two or more surface types)
- 6 - Earth shoulder exists
- 7 - Barrier curb exists; no shoulder in front of curb

Surface Type

- A - Combination
- B - Brick
- C - Continuous Reinforced Concrete
- D - Reinforced Concrete
- E - Plain Concrete
- G - Bituminous Concrete
- I - Chipseal on Granular
- K - Open Graded Bituminous
- L - Chipseal or Micro
- M - Gravel
- U - Unimproved
- X - Right of Way Only