

SASDSR00179**C

State True Log 5.066

6.066

County True Log



0.526
LAKE TWP RD 2650



Surface Type & Width (Left / Right)

G (18'/1')
0 - 1.946

Base Type (Left / Right)

I / L
0 - 1.946

Shoulder Type & Width (Left / Right)

2 (3'/3')
0 - 1.946

Resurface Year

2020

Through Lanes

2
0 - 10.468

Street Name

SR 179
0 - 9.839

- | | | | |
|---------------------|-------------------|----------------------|--------------|
| Non-divided Highway | Bridge (on route) | Railroad (at grade) | Intersection |
| Divided Highway | Underpass | Railroad (underpass) | |
| Secondary Segment | Overpass | Railroad (overpass) | |
| Corporation | | | |

Created on: 6/24/2025

transportation.ohio.gov

Prepared by
The Ohio Department of Transportation
Office of Technical Services
Roadway Information

SASDSR00179**C

State True Log

7.066

County True Log

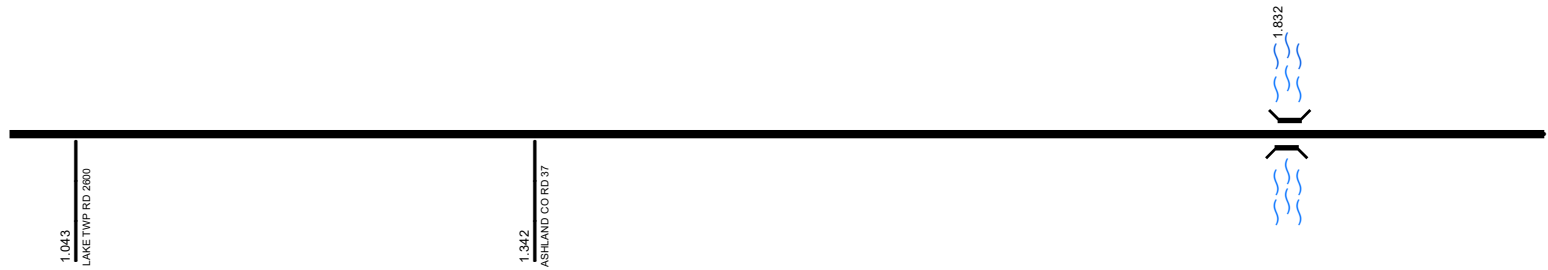

Surface Type & Width (Left / Right)

	G (18'/1')	G 20'
	0 - 1.946	1.946 - 2.703

Base Type (Left / Right)

	I / L	I
	0 - 1.946	1.946 - 2.703

Shoulder Type & Width (Left / Right)

	2 (3'/3')	2 (8'/8')
	0 - 1.946	1.946 - 2.703

Resurface Year

	2020	
	0 - 10.468	

Through Lanes

	2	
	0 - 10.394	

Street Name

	SR 179	
	0 - 9.839	

- Non-divided Highway
- Divided Highway
- Secondary Segment
- Corporation
- Bridge (on route)
- Underpass
- Overpass
- Railroad (at grade)
- Railroad (underpass)
- Railroad (overpass)
- Intersection

Created on: 6/24/2025

transportation.ohio.gov

Prepared by
The Ohio Department of Transportation
Office of Technical Services
Roadway Information

SASDSR00179**C

State True Log

8.066

County True Log



Surface Type & Width (Left / Right)

G 20'	G (18'/1')
1.946 - 2.703	2.703 - 3.411

Base Type (Left / Right)

I	I / L
1.946 - 2.703	2.703 - 3.411

Shoulder Type & Width (Left / Right)

2 (8'/8')	2 (3'/3')
1.946 - 2.703	2.703 - 3.411

Resurface Year

2020	
------	--

Through Lanes

0 - 10.468	
2	

Street Name

SR 179	
0 - 9.839	

- Non-divided Highway
- Divided Highway
- Secondary Segment
- Corporation
- Bridge (on route)
- Underpass
- Overpass
- Railroad (at grade)
- Railroad (underpass)
- Railroad (overpass)
- Intersection

Created on: 6/24/2025

transportation.ohio.gov

Prepared by
The Ohio Department of Transportation
Office of Technical Services
Roadway Information

SASDSR00179**C

State True Log

9.066

County True Log

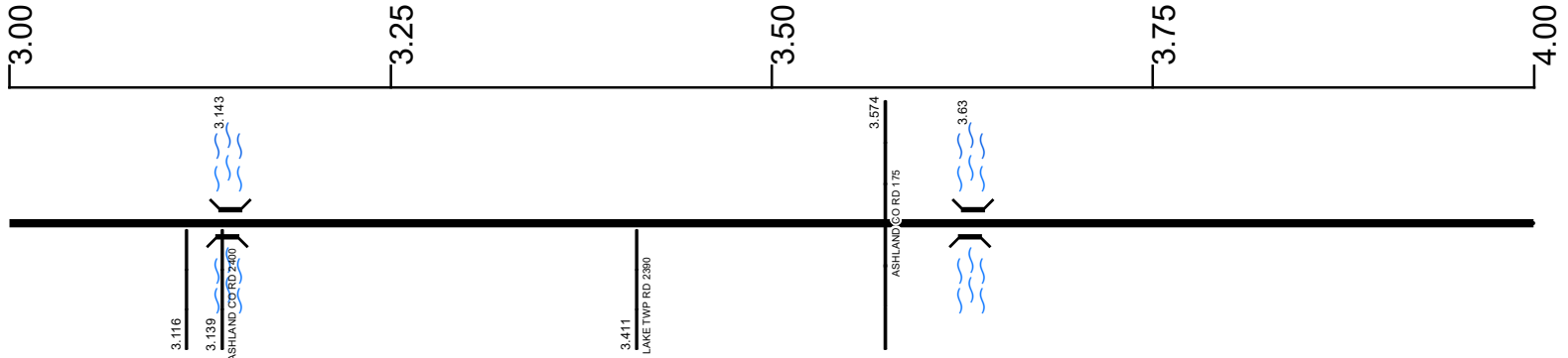

Surface Type & Width (Left / Right)

G (18'/1')	G 20'	G (18'/1')
2.703 - 3.411	3.411 - 3.798	3.798 - 8.337

Base Type (Left / Right)

I / L	I	I / L
2.703 - 3.411	3.411 - 3.798	3.798 - 8.337

Shoulder Type & Width (Left / Right)

2 (3'/3')	2 (8'/8')	2 (3'/3')
2.703 - 3.411	3.411 - 3.798	3.798 - 8.337

Resurface Year

2020

0 - 10.468

Through Lanes

2

0 - 10.394

Street Name

SR 179

0 - 9.839

- Non-divided Highway
- Divided Highway
- Secondary Segment
- Corporation
- Bridge (on route)
- Underpass
- Overpass
- Railroad (at grade)
- Railroad (underpass)
- Railroad (overpass)
- Intersection

Created on: 6/24/2025



transportation.ohio.gov
 Prepared by
 The Ohio Department of Transportation
 Office of Technical Services
 Roadway Information

SASDSR00179**C

State True Log

10.066

County True Log



4.012
LAKE TWP RD 257

Surface Type & Width (Left / Right)

G (18'/1')
3.798 - 8.337

Base Type (Left / Right)

I / L
3.798 - 8.337

Shoulder Type & Width (Left / Right)

2 (3'/3')
3.798 - 8.337

Resurface Year

2020

Through Lanes

0 - 10.468
2

Street Name

SR 179
0 - 9.839

- | | | | |
|---------------------|-------------------|----------------------|--------------|
| Non-divided Highway | Bridge (on route) | Railroad (at grade) | Intersection |
| Divided Highway | Underpass | Railroad (underpass) | |
| Secondary Segment | Overpass | Railroad (overpass) | |
| Corporation | | | |

Created on: 6/24/2025

transportation.ohio.gov

Prepared by
The Ohio Department of Transportation
Office of Technical Services
Roadway Information

SASDSR00179**C

State True Log

11.066

County True Log

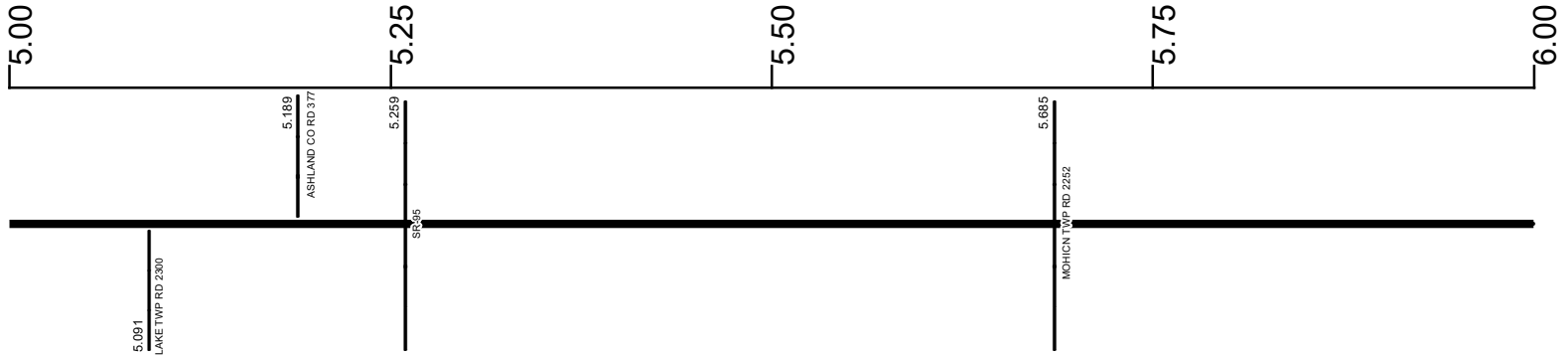

Surface Type & Width (Left / Right)

G (18'/1')
3.798 - 8.337

Base Type (Left / Right)

I / L
3.798 - 8.337

Shoulder Type & Width (Left / Right)

2 (3'/3')
3.798 - 8.337

Resurface Year

2020

Through Lanes

2
0 - 10.394

Street Name

SR 179
0 - 9.839

- Non-divided Highway
- Divided Highway
- Secondary Segment
- Corporation
- Bridge (on route)
- Underpass
- Overpass
- Railroad (at grade)
- Railroad (underpass)
- Railroad (overpass)
- Intersection

Created on: 6/24/2025

transportation.ohio.gov
Prepared by
The Ohio Department of Transportation
Office of Technical Services
Roadway Information

SASDSR00179**C

State True Log

12.066

County True Log



Surface Type & Width (Left / Right)	G (18'/1')
	3.798 - 8.337
Base Type (Left / Right)	I / L
	3.798 - 8.337
Shoulder Type & Width (Left / Right)	2 (3'/3')
	3.798 - 8.337
Resurface Year	2020
Through Lanes	0 - 10.468
	2
	0 - 10.394
Street Name	SR 179
	0 - 9.839

<ul style="list-style-type: none"> Non-divided Highway Divided Highway Secondary Segment Corporation 	<ul style="list-style-type: none"> Bridge (on route) Underpass Overpass 	<ul style="list-style-type: none"> Railroad (at grade) Railroad (underpass) Railroad (overpass) 	<ul style="list-style-type: none"> Intersection
--	---	---	---

Created on: 6/24/2025

transportation.ohio.gov

Prepared by
The Ohio Department of Transportation
Office of Technical Services
Roadway Information

SASDSR00179**C

State True Log

13.066

County True Log

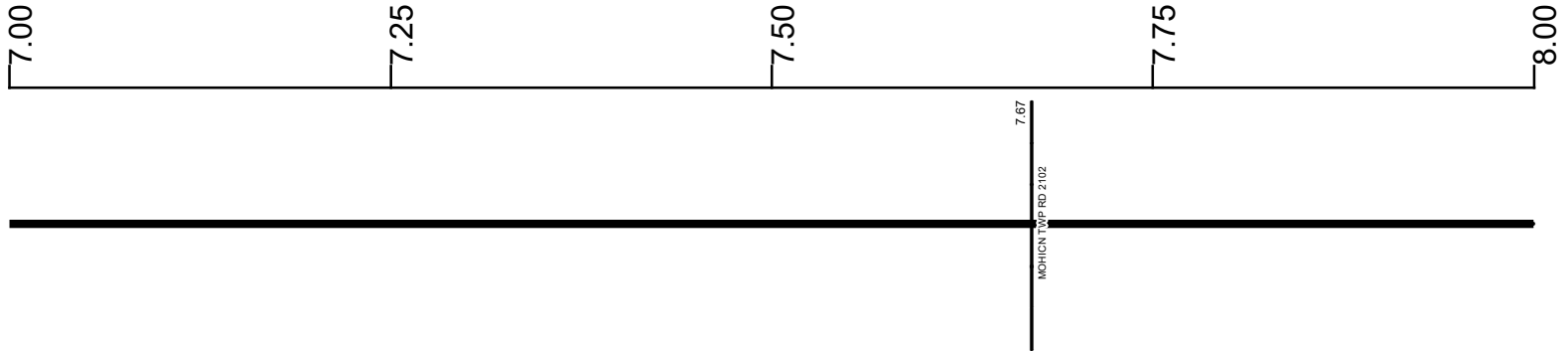

Surface Type & Width (Left / Right)

G (18'/1')
3.798 - 8.337

Base Type (Left / Right)

I / L
3.798 - 8.337

Shoulder Type & Width (Left / Right)

2 (3'/3')
3.798 - 8.337

Resurface Year

2020

Through Lanes

2
0 - 10.468

Street Name

SR 179
0 - 9.839

- | | | | |
|---------------------|-------------------|----------------------|--------------|
| Non-divided Highway | Bridge (on route) | Railroad (at grade) | Intersection |
| Divided Highway | Underpass | Railroad (underpass) | |
| Secondary Segment | Overpass | Railroad (overpass) | |
| Corporation | | | |

Created on: 6/24/2025

transportation.ohio.gov

Prepared by
The Ohio Department of Transportation
Office of Technical Services
Roadway Information

SASDSR00179**C

State True Log

14.066

County True Log

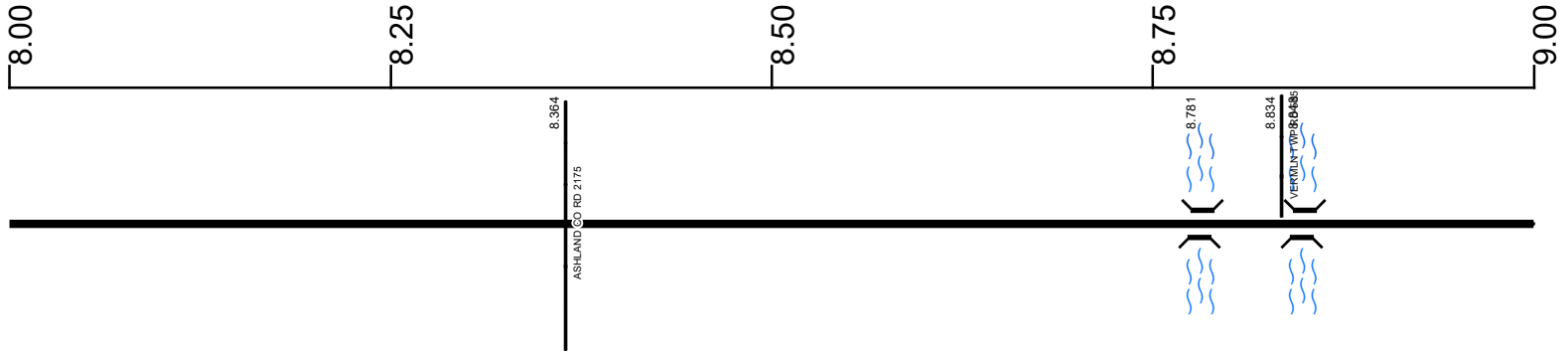

Surface Type & Width (Left / Right)

G (18'/1')	G 22'	G (18'/1')	G 22'	G (18'/1')
3.798 - 8.337	8.337 - 8.45	8.45 - 8.756	8.756 - 8.889	8.889 - 9.839

Base Type (Left / Right)

I/L	L	I/L	L	I/L
3.798 - 8.337	8.337 - 8.45	8.45 - 8.756	8.756 - 8.889	8.889 - 9.839

Shoulder Type & Width (Left / Right)

2 (3/3')	2 (2/2')	2 (3/3')	2 (4/4')	2 (3/3')
3.798 - 8.337	8.337 - 8.45	8.45 - 8.756	8.756 - 8.889	8.889 - 9.839

Resurface Year

2020

0 - 10.468

Through Lanes

2

0 - 10.394

Street Name

SR 179

0 - 9.839

- Non-divided Highway
- Divided Highway
- Secondary Segment
- Corporation
- Bridge (on route)
- Underpass
- Overpass
- Railroad (at grade)
- Railroad (underpass)
- Railroad (overpass)
- Intersection

Created on: 6/24/2025



transportation.ohio.gov
 Prepared by
 The Ohio Department of Transportation
 Office of Technical Services
 Roadway Information

SASDSR00179**C

State True Log

15.066

County True Log

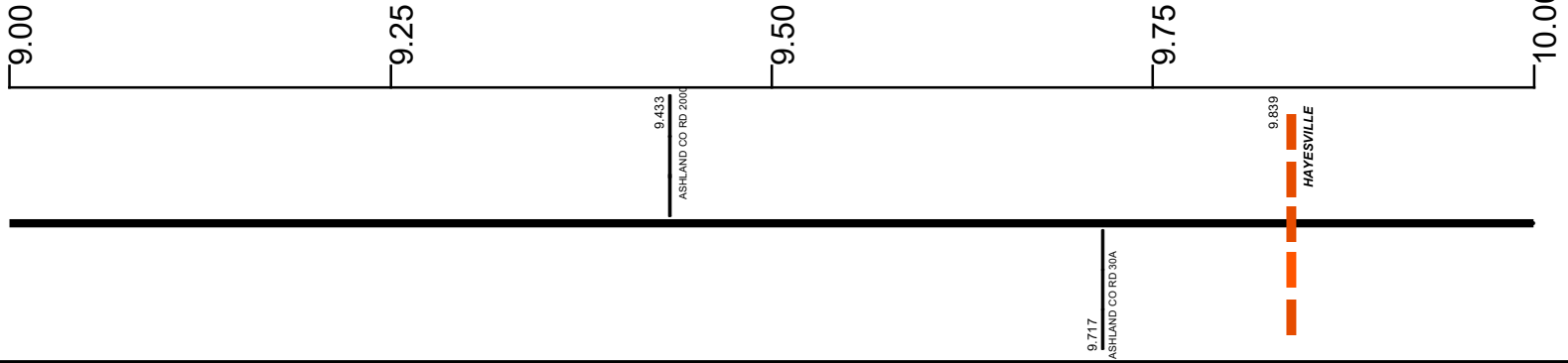

Surface Type & Width (Left / Right)	
G (18'1')	G 20'
8.889 - 9.839	9.839 - 10.394
Base Type (Left / Right)	
I / L	T
8.889 - 9.839	9.839 - 10.394
Shoulder Type & Width (Left / Right)	
2 (3'3')	2 (6'6')
8.889 - 9.839	9.839 - 10.394
Resurface Year	
2020	
0 - 10.468	
Through Lanes	
2	
0 - 10.394	
Street Name	
SR 179	MAIN ST
0 - 9.839	9.839 - 10.468

- Non-divided Highway
- Divided Highway
- Secondary Segment
- Corporation
- Bridge (on route)
- Underpass
- Overpass
- Railroad (at grade)
- Railroad (underpass)
- Railroad (overpass)
- Intersection

Created on: 6/24/2025

SASDSR00179**C

15.534

State True Log

County True Log

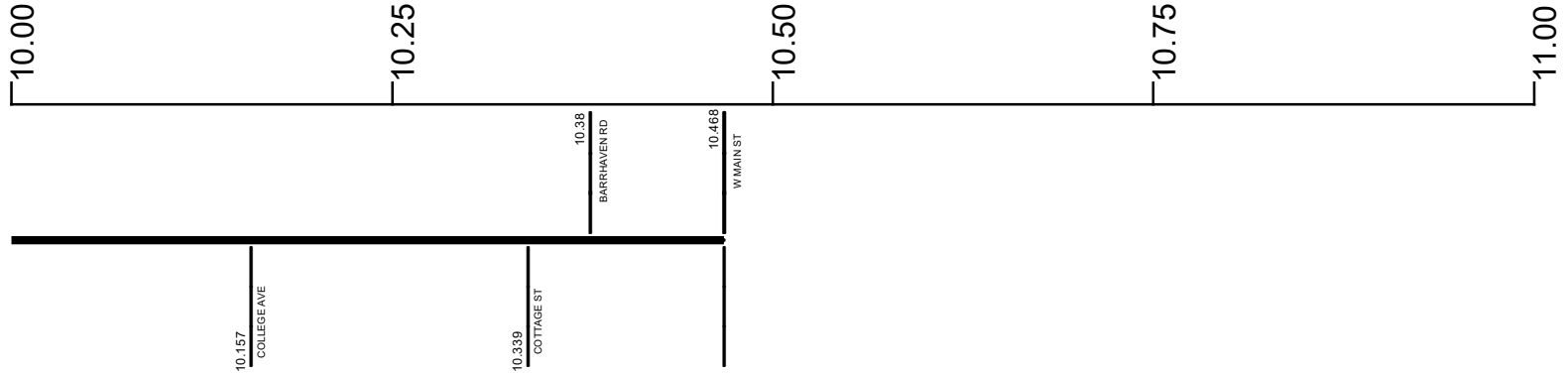

Surface Type & Width (Left / Right)

G 20'	G (20'/28')
9.839 - 10.394	10.394 - 10.468

Base Type (Left / Right)

T	T / I
9.839 - 10.394	10.394 - 10.468

Shoulder Type & Width (Left / Right)

2 (6'/6')	1 (0'/0')
9.839 - 10.394	10.394 - 10.468

Resurface Year

2020
0 - 10.468

Through Lanes

2	4
0 - 10.394	10.394 - 10.468

Street Name

MAIN ST
9.839 - 10.468

- Non-divided Highway
- Divided Highway
- Secondary Segment
- Corporation
- Bridge (on route)
- Underpass
- Overpass
- Railroad (at grade)
- Railroad (underpass)
- Railroad (overpass)
- Intersection

Created on: 6/24/2025



transportation.ohio.gov

Prepared by

The Ohio Department of Transportation
Office of Technical Services
Roadway Information

Historical Project List for SASDSR00179**C

Begin Measure	End Measure	Project ID Number	Construction Completion Date	Treatment Category	Treatment Type
0.000	9.717	102960	5-2021	Minor Rehabilitation	38-Fine Poly AC Overlay
0.000	9.717	86699	6-2016	Preventive Maintenance	25-Chip Seal
0.000	10.468	25665	8-2008	Minor Rehabilitation	60-AC Overlay w/Rpr
9.717	10.468	102960	5-2021	Minor Rehabilitation	60-AC Overlay w/Rpr

Roadway Codes

Access Control Journalized

- F - Full Access Control
- L - Limited Access Control
- N - No Access Control

Access Control Operational

- 1 - Full Access Control
- 2 - Partial Access Control
- 3 - No Access Control

Base Type

- F - Crack and Seat
- H - Rubblize and Roll
- I - Aggregate Base 304 or Traffic Compacted
- K - Water Bound Macadam
- L - Bituminous Concrete Mix or Penetration Macadam
- N - Plain Concrete
- P - Reinforced Concrete
- R - Brick (Flexible)
- T - Brick (Rigid)

Direction of Travel

- B - Both (Two-way)
- F - One-way Cardinal
- T - One-way Non-cardinal

Facility Type

- 1 - One-way Roadway
- 2 - Two-way Roadway
- 4 - Ramp
- 5 - Non-mainline
- 6 - Non-inventory Direction
- 7 - Planned / Unbuilt

Historical Federal Aid Indicator

- N - Not a FAP Route
- Y - FAP Route

Functional Classification

- 01 - Interstate
- 02 - Principal Arterial (Freeways)
- 03 - Principal Arterial (Other)
- 04 - Minor Arterial
- 05 - Major Collector
- 06 - Minor Collector
- 07 - Local

Leave / Reenter Indicator

- Y - Route leaves/reenters at this point
- N - Route does not leave/reenter at this point

Median Type

- 1 - None
- 2 - Unprotected
- 3 - Curbed
- 4 - Positive Barrier (Unspecified)
- 5 - Positive Barrier (Flexible)
- 6 - Positive Barrier (Semi-rigid)
- 7 - Positive Barrier (Rigid)

NHS

- N - National Highway System
- H - Congressional Corridor
- 2 - Major Airport
- 3 - Major Port Facility
- 4 - Major Amtrak Station
- 5 - Major Rail / Truck Terminal
- 6 - Major Intercity Bus Terminal
- 7 - Major Public Transit / Multi-modal Passenger Terminal
- 8 - Major Pipeline Terminal
- 9 - Major Ferry Terminal

Priority System

- G - General
- P - Priority System
- U - Urban

Scenic Byway Code

- A - All American Road
- N - National Scenic Byway
- S - State Scenic Byway

Shoulder Type

- 1 - None
- 2 - Surfaced shoulder exists (bituminous concrete {AC})
- 3 - Surfaced shoulder exists (Portland Cement Concrete {PCC})
- 4 - Stabilized shoulder exists (gravel or other granular material)
- 5 - Combination shoulder exists (two or more surface types)
- 6 - Earth shoulder exists
- 7 - Barrier curb exists; no shoulder in front of curb

Surface Type

- A - Combination
- B - Brick
- C - Continuous Reinforced Concrete
- D - Reinforced Concrete
- E - Plain Concrete
- G - Bituminous Concrete
- I - Chipseal on Granular
- K - Open Graded Bituminous
- L - Chipseal or Micro
- M - Gravel
- U - Unimproved
- X - Right of Way Only