

SASDSR00603**C

State True Log 5.848

6.848

County True Log

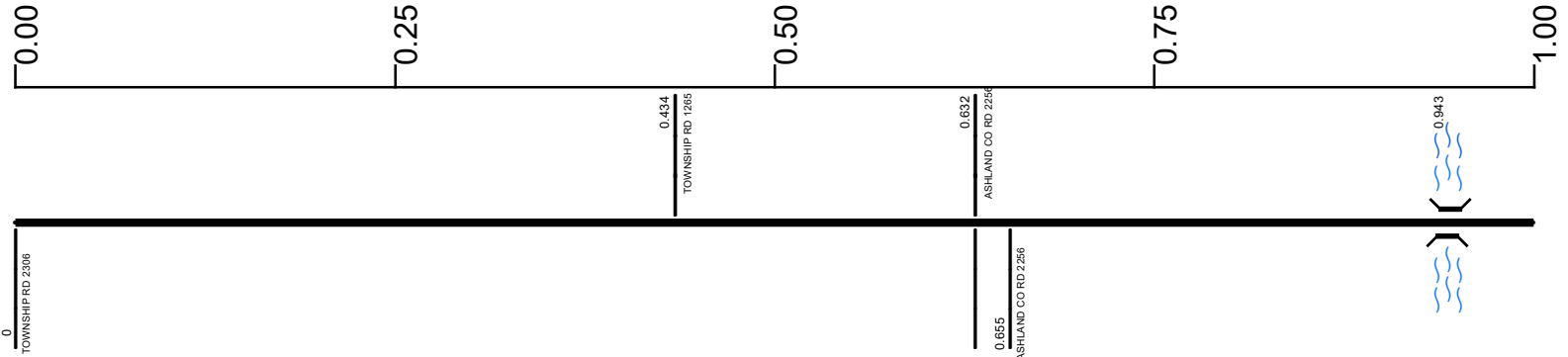

Surface Type & Width (Left / Right)

	G (18'4')	G (20'2')
	0 - 0.917	0.917 - 1.108

Base Type (Left / Right)

	I / L
	0 - 4.641

Shoulder Type & Width (Left / Right)

	5 (1'1')	5 (3'3')
	0 - 0.917	0.917 - 1.108

Through Lanes

	2
	0 - 11.533

Street Name

	SR 603
	0 - 3.623

- Non-divided Highway
- Divided Highway
- Secondary Segment
- Corporation**
- Bridge (on route)
- Underpass
- Overpass
- Railroad (at grade)
- Railroad (underpass)
- Railroad (overpass)
- Intersection

Created on: 6/24/2025

transportation.ohio.gov

Prepared by
The Ohio Department of Transportation
Office of Technical Services
Roadway Information

SASDSR00603**C

State True
Log

7.848

County True
Log



Surface Type & Width (Left / Right)

G (20'2") 0.917 - 1.108	G (18'4") 1.108 - 3.84
----------------------------	---------------------------

Base Type (Left / Right)

	I / L 0 - 4.641
--	--------------------

Shoulder Type & Width (Left / Right)

5 (3'3") 0.917 - 1.108	5 (1'1") 1.108 - 3.84
---------------------------	--------------------------

Through Lanes

	2 0 - 11.533
--	-----------------

Street Name

	SR 603 0 - 3.623
--	---------------------

- | | | | |
|--|---|---|---|
| <ul style="list-style-type: none"> Non-divided Highway Divided Highway Secondary Segment Corporation | <ul style="list-style-type: none"> Bridge (on route) Underpass Overpass | <ul style="list-style-type: none"> Railroad (at grade) Railroad (underpass) Railroad (overpass) | <ul style="list-style-type: none"> Intersection |
|--|---|---|---|

Created on: 6/24/2025

transportation.ohio.gov

Prepared by
The Ohio Department of Transportation
Office of Technical Services
Roadway Information

SASDSR00603**C

State True Log

8.848

County True Log

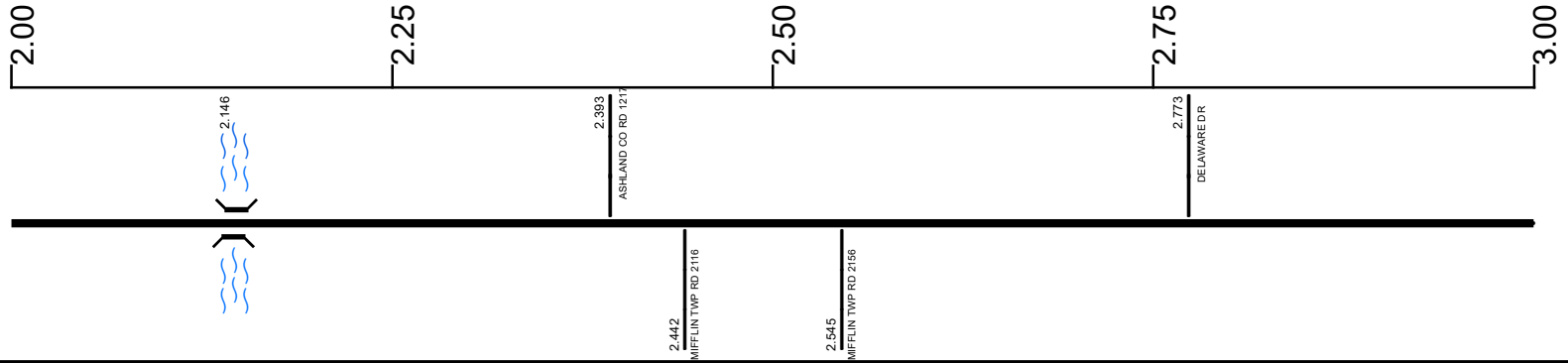

Surface Type & Width (Left / Right)

G (18'/4')
1.108 - 3.84

Base Type (Left / Right)

I / L
0 - 4.641

Shoulder Type & Width (Left / Right)

5 (1'/1')
1.108 - 3.84

Through Lanes

2
0 - 11.533

Street Name

SR 603
0 - 3.623

- Non-divided Highway
- Divided Highway
- Secondary Segment
- Corporation
- Bridge (on route)
- Underpass
- Overpass
- Railroad (at grade)
- Railroad (underpass)
- Railroad (overpass)
- Intersection

Created on: 6/24/2025

transportation.ohio.gov
Prepared by
The Ohio Department of Transportation
Office of Technical Services
Roadway Information

SASDSR00603**C

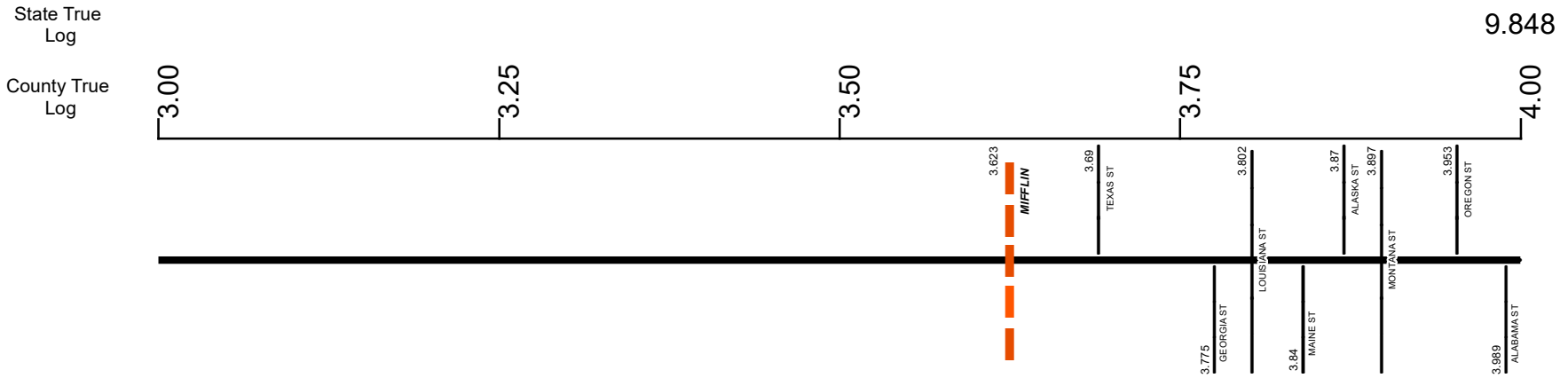

Surface Type & Width (Left / Right)	
G (18'4") 1.108 - 3.84	G (20'2") 3.84 - 4.703
Base Type (Left / Right)	
I / L 0 - 4.641	
Shoulder Type & Width (Left / Right)	
5 (1'1") 1.108 - 3.84	2 (5'9") 3.84 - 4.088
Through Lanes	
2 0 - 11.533	
Street Name	
SR 603 0 - 3.623	OHIO ST 3.623 - 3.84
	MAINE ST 3.84 - 4.088

- Non-divided Highway
- Divided Highway
- Secondary Segment
- Corporation
- Bridge (on route)
- Underpass
- Overpass
- Railroad (at grade)
- Railroad (underpass)
- Railroad (overpass)
- Intersection

Created on: 6/24/2025



transportation.ohio.gov
Prepared by
The Ohio Department of Transportation
Office of Technical Services
Roadway Information

SASDSR00603**C

State True Log

10.848

County True Log

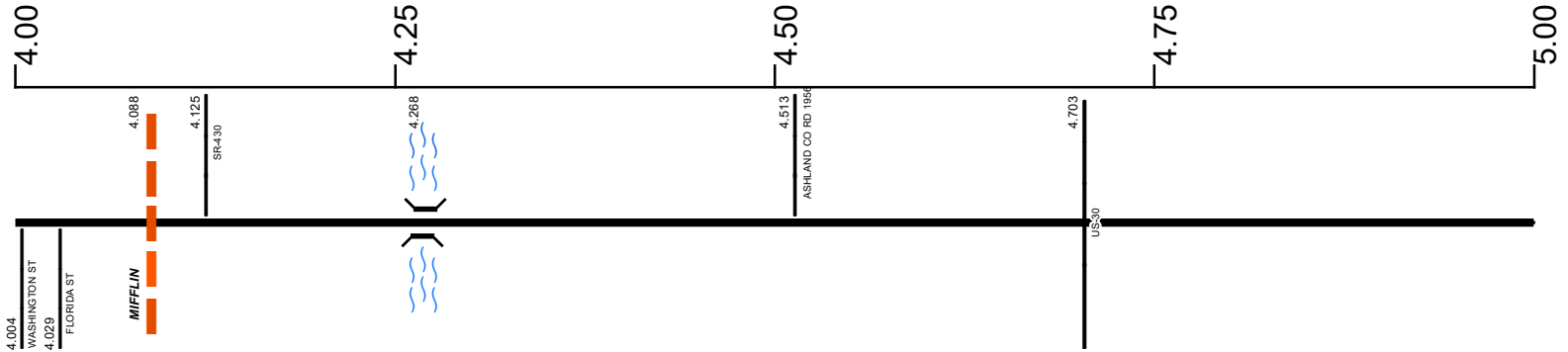

Surface Type & Width (Left / Right)

G (20'/2')	G (18'/3')
3.84 - 4.703	4.703 - 5.379

Base Type (Left / Right)

I / L	I	I / L
0 - 4.641	4.641 - 4.703	4.703 - 11.533

Shoulder Type & Width (Left / Right)

2 (5'/9')	5 (1'/1')
3.84 - 4.088	4.088 - 11.533

Resurface Year

2022
4.641 - 4.703

Through Lanes

2
0 - 11.533

Street Name

MAINE ST	SR 603
3.84 - 4.088	4.088 - 11.533

- Non-divided Highway
- Divided Highway
- Secondary Segment
- Corporation
- Bridge (on route)
- Underpass
- Overpass
- Railroad (at grade)
- Railroad (underpass)
- Railroad (overpass)
- Intersection

Created on: 6/24/2025



transportation.ohio.gov
Prepared by
The Ohio Department of Transportation
Office of Technical Services
Roadway Information

SASDSR00603**C

State True Log

11.848

County True Log



Surface Type & Width (Left / Right)	
G (18'3") 4.703 - 5.379	G (18'4") 5.379 - 7.302
Base Type (Left / Right)	
I / L 4.703 - 11.533	
Shoulder Type & Width (Left / Right)	
5 (1'1") 4.088 - 11.533	
Through Lanes	
2 0 - 11.533	
Street Name	
SR 603 4.088 - 11.533	

<ul style="list-style-type: none"> Non-divided Highway Divided Highway Secondary Segment Corporation 	<ul style="list-style-type: none"> Bridge (on route) Underpass Overpass 	<ul style="list-style-type: none"> Railroad (at grade) Railroad (underpass) Railroad (overpass) 	<ul style="list-style-type: none"> Intersection
--	---	---	---

Created on: 6/24/2025

transportation.ohio.gov

Prepared by
The Ohio Department of Transportation
Office of Technical Services
Roadway Information

SASDSR00603**C

State True Log

12.848

County True Log

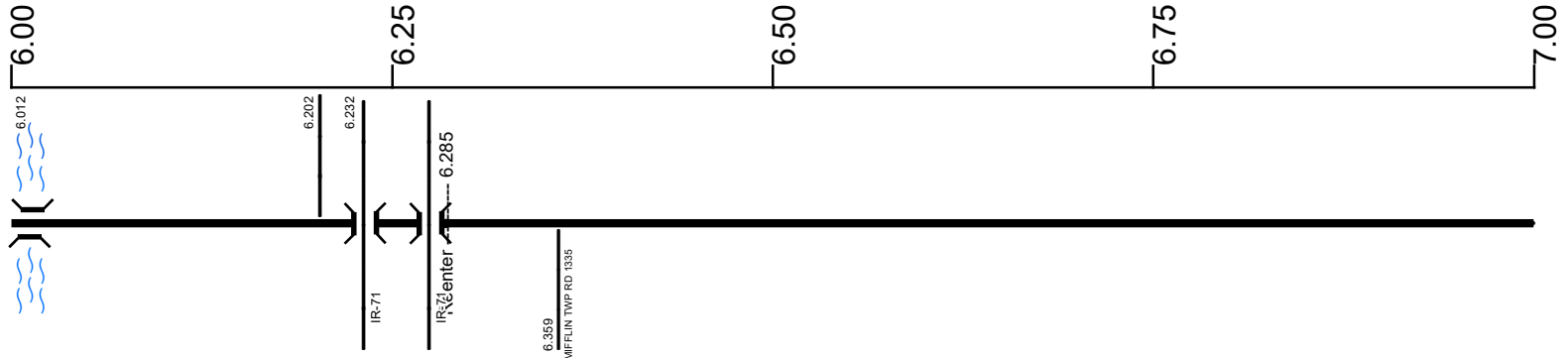

Surface Type & Width (Left / Right)

G (18'/4')
5.379 - 7.302

Base Type (Left / Right)

I / L
4.703 - 11.533

Shoulder Type & Width (Left / Right)

5 (1'/1')
4.088 - 11.533

Through Lanes

2
0 - 11.533

Street Name

SR 603
4.088 - 11.533

- Non-divided Highway
- Divided Highway
- Secondary Segment
- Corporation
- Bridge (on route)
- Underpass
- Overpass
- Railroad (at grade)
- Railroad (underpass)
- Railroad (overpass)
- Intersection

Created on: 6/24/2025



transportation.ohio.gov
 Prepared by
 The Ohio Department of Transportation
 Office of Technical Services
 Roadway Information

SASDSR00603**C

State True Log

13.848

County True Log

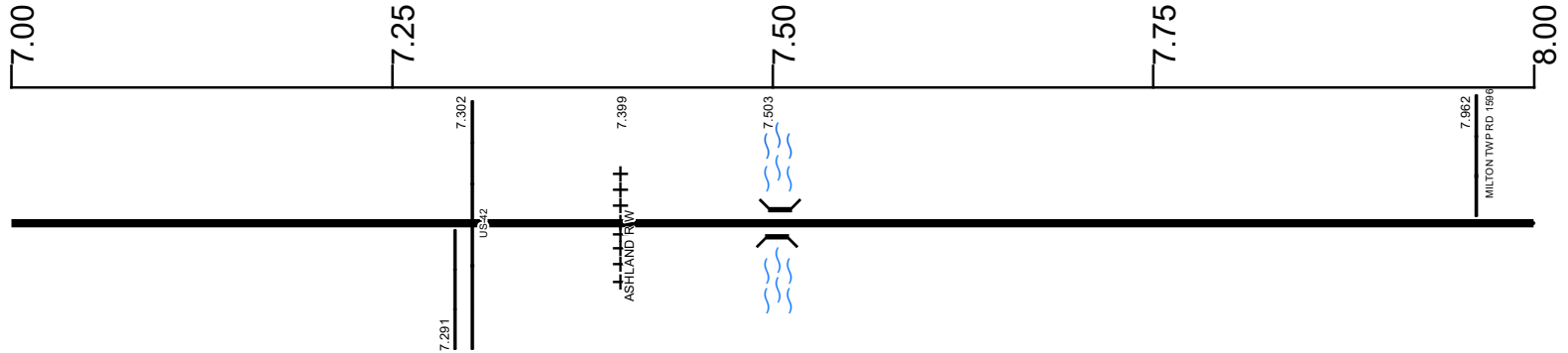

Surface Type & Width (Left / Right)

G (18'/4')	G (20'/2')	G (18'/4')
5.379 - 7.302	7.302 - 7.715	7.715 - 11.533

Base Type (Left / Right)

I / L
4.703 - 11.533

Shoulder Type & Width (Left / Right)

5 (1'/1')
4.088 - 11.533

Through Lanes

2
0 - 11.533

Street Name

SR 603
4.088 - 11.533

- Non-divided Highway
- Divided Highway
- Secondary Segment
- Corporation
- Bridge (on route)
- Underpass
- Overpass
- Railroad (at grade)
- Railroad (underpass)
- Railroad (overpass)
- Intersection

Created on: 6/24/2025

transportation.ohio.gov

Prepared by
The Ohio Department of Transportation
Office of Technical Services
Roadway Information

SASDSR00603**C

State True Log

14.848

County True Log



Surface Type & Width (Left / Right)

G (18/4')
7.715 - 11.533

Base Type (Left / Right)

I / L
4.703 - 11.533

Shoulder Type & Width (Left / Right)

5 (1/1')
4.088 - 11.533

Through Lanes

2
0 - 11.533

Street Name

SR 603
4.088 - 11.533

- | | | | |
|--|---|---|---|
| <ul style="list-style-type: none"> Non-divided Highway Divided Highway Secondary Segment Corporation | <ul style="list-style-type: none"> Bridge (on route) Underpass Overpass | <ul style="list-style-type: none"> Railroad (at grade) Railroad (underpass) Railroad (overpass) | <ul style="list-style-type: none"> Intersection |
|--|---|---|---|

Created on: 6/24/2025

transportation.ohio.gov

Prepared by
The Ohio Department of Transportation
Office of Technical Services
Roadway Information

SASDSR00603**C

State True Log

15.848

County True Log

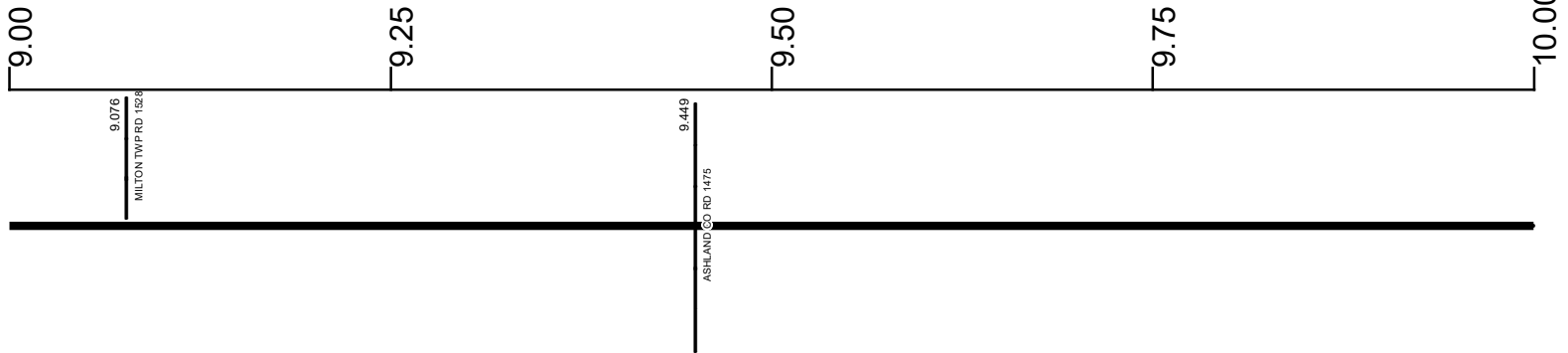

Surface Type & Width (Left / Right)

G (18'4')
7.715 - 11.533

Base Type (Left / Right)

I / L
4.703 - 11.533

Shoulder Type & Width (Left / Right)

5 (1'1')
4.088 - 11.533

Through Lanes

2
0 - 11.533

Street Name

SR 603
4.088 - 11.533

- | | | | |
|---------------------|-------------------|----------------------|--------------|
| Non-divided Highway | Bridge (on route) | Railroad (at grade) | Intersection |
| Divided Highway | Underpass | Railroad (underpass) | |
| Secondary Segment | Overpass | Railroad (overpass) | |
| Corporation | | | |

Created on: 6/24/2025

transportation.ohio.gov

Prepared by
The Ohio Department of Transportation
Office of Technical Services
Roadway Information

SASDSR00603**C

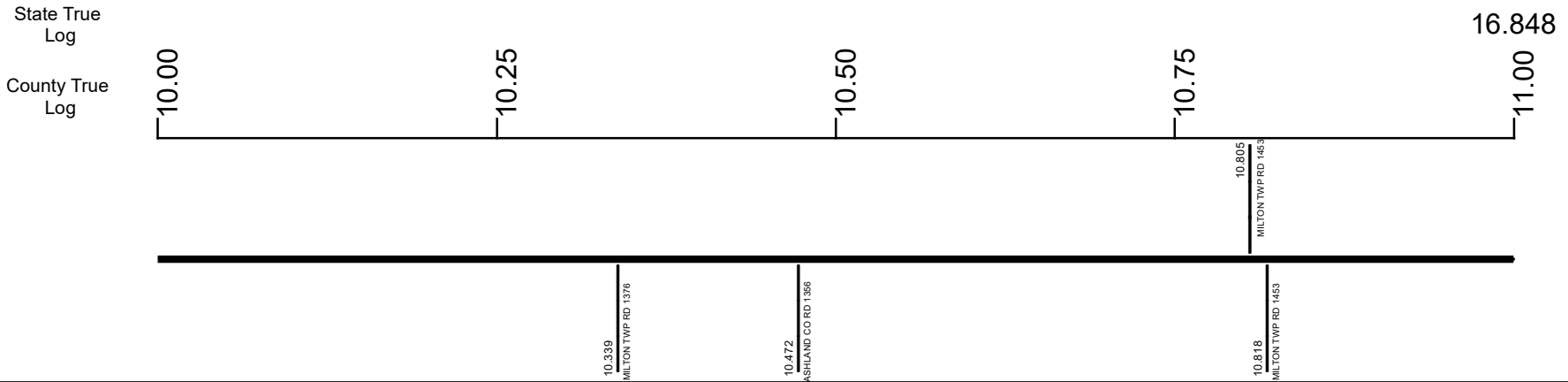

Surface Type & Width (Left / Right)	G (18'4') 7.715 - 11.533
Base Type (Left / Right)	I / L 4.703 - 11.533
Shoulder Type & Width (Left / Right)	5 (1'1') 4.088 - 11.533
Through Lanes	2 0 - 11.533
Street Name	SR 603 4.088 - 11.533

Non-divided Highway Divided Highway Secondary Segment Corporation	Bridge (on route) Underpass Overpass	Railroad (at grade) Railroad (underpass) Railroad (overpass)	Intersection
---	--	--	--------------

Created on: 6/24/2025

transportation.ohio.gov

Prepared by
 The Ohio Department of Transportation
 Office of Technical Services
 Roadway Information

SASDSR00603**C

State True Log

County True Log

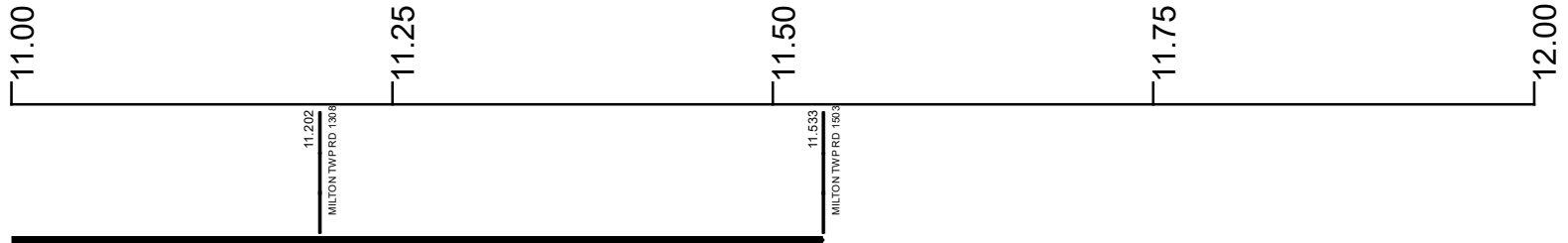

Surface Type & Width (Left / Right)

G (18'/4')
7.715 - 11.533

Base Type (Left / Right)

I / L
4.703 - 11.533

Shoulder Type & Width (Left / Right)

5 (1'/1')
4.088 - 11.533

Through Lanes

2
0 - 11.533

Street Name

SR 603
4.088 - 11.533

- Non-divided Highway
- Divided Highway
- Secondary Segment
- Corporation
- Bridge (on route)
- Underpass
- Overpass
- Railroad (at grade)
- Railroad (underpass)
- Railroad (overpass)
- Intersection

Created on: 6/24/2025



transportation.ohio.gov
Prepared by
The Ohio Department of Transportation
Office of Technical Services
Roadway Information

Historical Project List for SASDSR00603**C

Begin Measure	End Measure	Project ID Number	Construction Completion Date	Treatment Category	Treatment Type
0.000	6.326	86723	10-2014	Minor Rehabilitation	60-AC Overlay w/Rpr
0.000	6.326	16776	9-2004	Minor Rehabilitation	60-AC Overlay w/Rpr
4.817	4.997	76158	11-2005	Minor Rehabilitation	60-AC Overlay w/Rpr
6.326	11.574	86723	10-2014	Minor Rehabilitation	60-AC Overlay w/Rpr
6.326	11.574	16776	9-2004	Minor Rehabilitation	60-AC Overlay w/Rpr

Roadway Codes

Access Control Journalized

- F - Full Access Control
- L - Limited Access Control
- N - No Access Control

Access Control Operational

- 1 - Full Access Control
- 2 - Partial Access Control
- 3 - No Access Control

Base Type

- F - Crack and Seat
- H - Rubblize and Roll
- I - Aggregate Base 304 or Traffic Compacted
- K - Water Bound Macadam
- L - Bituminous Concrete Mix or Penetration Macadam
- N - Plain Concrete
- P - Reinforced Concrete
- R - Brick (Flexible)
- T - Brick (Rigid)

Direction of Travel

- B - Both (Two-way)
- F - One-way Cardinal
- T - One-way Non-cardinal

Facility Type

- 1 - One-way Roadway
- 2 - Two-way Roadway
- 4 - Ramp
- 5 - Non-mainline
- 6 - Non-inventory Direction
- 7 - Planned / Unbuilt

Historical Federal Aid Indicator

- N - Not a FAP Route
- Y - FAP Route

Functional Classification

- 01 - Interstate
- 02 - Principal Arterial (Freeways)
- 03 - Principal Arterial (Other)
- 04 - Minor Arterial
- 05 - Major Collector
- 06 - Minor Collector
- 07 - Local

Leave / Reenter Indicator

- Y - Route leaves/reenters at this point
- N - Route does not leave/reenter at this point

Median Type

- 1 - None
- 2 - Unprotected
- 3 - Curbed
- 4 - Positive Barrier (Unspecified)
- 5 - Positive Barrier (Flexible)
- 6 - Positive Barrier (Semi-rigid)
- 7 - Positive Barrier (Rigid)

NHS

- N - National Highway System
- H - Congressional Corridor
- 2 - Major Airport
- 3 - Major Port Facility
- 4 - Major Amtrak Station
- 5 - Major Rail / Truck Terminal
- 6 - Major Intercity Bus Terminal
- 7 - Major Public Transit / Multi-modal Passenger Terminal
- 8 - Major Pipeline Terminal
- 9 - Major Ferry Terminal

Priority System

- G - General
- P - Priority System
- U - Urban

Scenic Byway Code

- A - All American Road
- N - National Scenic Byway
- S - State Scenic Byway

Shoulder Type

- 1 - None
- 2 - Surfaced shoulder exists (bituminous concrete {AC})
- 3 - Surfaced shoulder exists (Portland Cement Concrete {PCC})
- 4 - Stabilized shoulder exists (gravel or other granular material)
- 5 - Combination shoulder exists (two or more surface types)
- 6 - Earth shoulder exists
- 7 - Barrier curb exists; no shoulder in front of curb

Surface Type

- A - Combination
- B - Brick
- C - Continuous Reinforced Concrete
- D - Reinforced Concrete
- E - Plain Concrete
- G - Bituminous Concrete
- I - Chipseal on Granular
- K - Open Graded Bituminous
- L - Chipseal or Micro
- M - Gravel
- U - Unimproved
- X - Right of Way Only