

SATBSR00084**C

State True Log 34.796

35.796

County True Log

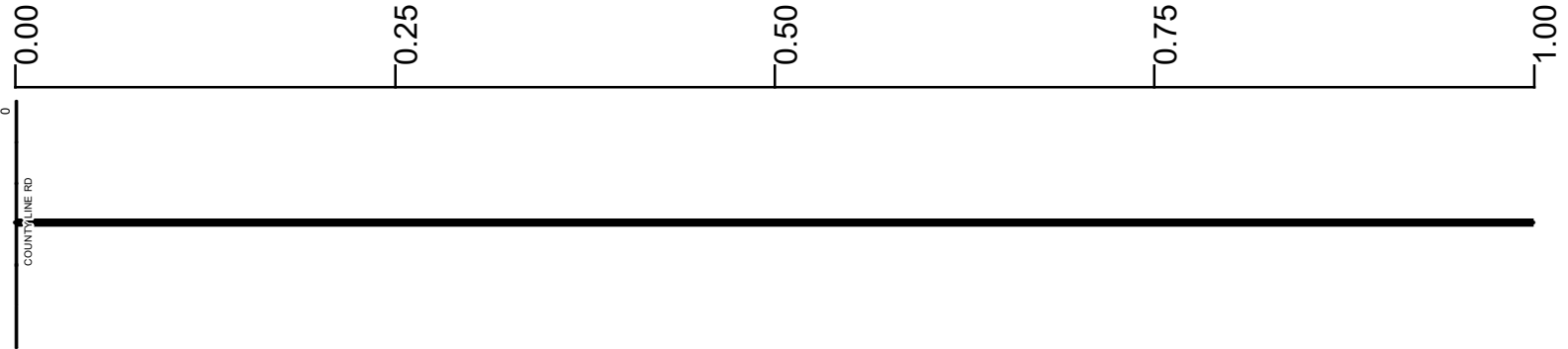

Surface Type & Width (Left / Right)

G 20'
0 - 2.911

Base Type (Left / Right)

P
0 - 2.911

Shoulder Type & Width (Left / Right)

2 (4/4')
0 - 2.911

Through Lanes

2
0 - 12.817

Street Name

S RIDGE RD
0 - 2.742

- | | | | |
|---------------------|-------------------|----------------------|--------------|
| Non-divided Highway | Bridge (on route) | Railroad (at grade) | Intersection |
| Divided Highway | Underpass | Railroad (underpass) | |
| Secondary Segment | Overpass | Railroad (overpass) | |
| Corporation | | | |

Created on: 6/24/2025

transportation.ohio.gov

Prepared by
The Ohio Department of Transportation
Office of Technical Services
Roadway Information

SATBSR00084**C

State True Log

36.796

County True Log

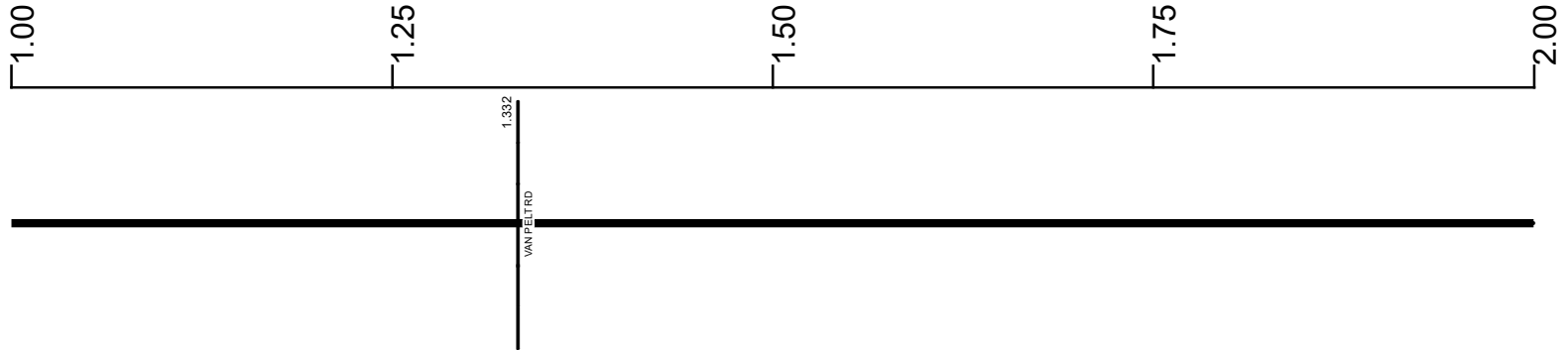

Surface Type & Width (Left / Right)

G 20'
0 - 2.911

Base Type (Left / Right)

P
0 - 2.911

Shoulder Type & Width (Left / Right)

2 (4/4')
0 - 2.911

Through Lanes

2
0 - 12.817

Street Name

S RIDGE RD
0 - 2.742

- | | | | |
|---------------------|-------------------|----------------------|--------------|
| Non-divided Highway | Bridge (on route) | Railroad (at grade) | Intersection |
| Divided Highway | Underpass | Railroad (underpass) | |
| Secondary Segment | Overpass | Railroad (overpass) | |
| Corporation | | | |

Created on: 6/24/2025

transportation.ohio.gov

Prepared by
The Ohio Department of Transportation
Office of Technical Services
Roadway Information

SATBSR00084**C

State True Log

37.796

County True Log

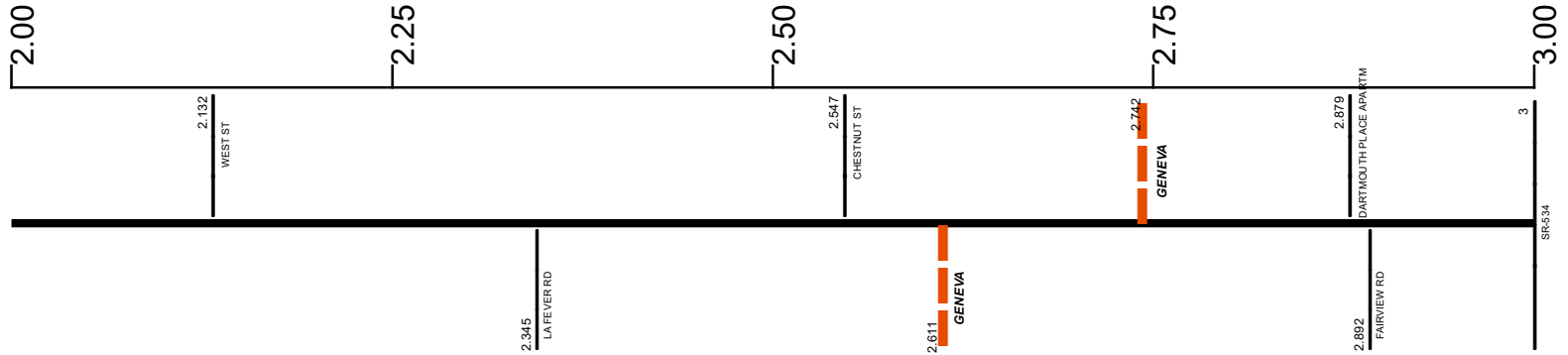

Surface Type & Width (Left / Right)

G 20'	G 36'
0 - 2.911	2.911 - 3.088

Base Type (Left / Right)

P	L
0 - 2.911	2.911 - 3.088

Shoulder Type & Width (Left / Right)

2 (4 1/4')	1 (0'/0')
0 - 2.911	2.911 - 3.088

Through Lanes

2	
0 - 12.817	

Street Name

S RIDGE RD	RIDGE
0 - 2.742	2.742 - 3

- Non-divided Highway
- Divided Highway
- Secondary Segment
- Corporation
- Bridge (on route)
- Underpass
- Overpass
- Railroad (at grade)
- Railroad (underpass)
- Railroad (overpass)
- Intersection

Created on: 6/24/2025

transportation.ohio.gov

Prepared by
The Ohio Department of Transportation
Office of Technical Services
Roadway Information

SATBSR00084**C

State True Log

38.796

County True Log

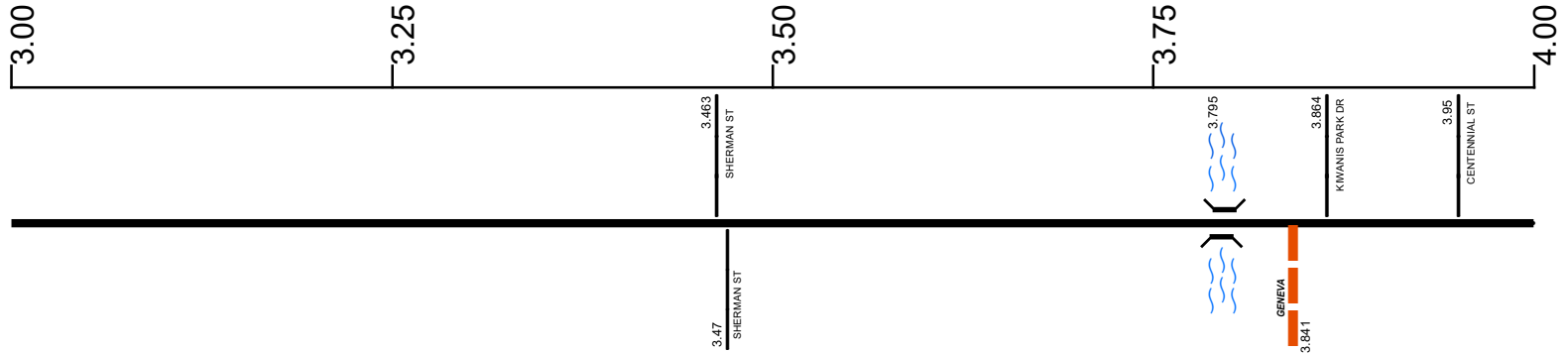

Surface Type & Width (Left / Right)

G 36'	G (16'4')
2.911 - 3.088	3.088 - 8.538

Base Type (Left / Right)

L	P / L
2.911 - 3.088	3.088 - 8.538

Shoulder Type & Width (Left / Right)

1 (0'/0')	2 (6'/6')
2.911 - 3.088	3.088 - 8.538

Through Lanes

	2
	0 - 12.817

Street Name

	RIDGE
	3 - 7.024

- Non-divided Highway
- Divided Highway
- Secondary Segment
- Corporation
- Bridge (on route)
- Underpass
- Overpass
- Railroad (at grade)
- Railroad (underpass)
- Railroad (overpass)
- Intersection

Created on: 6/24/2025

transportation.ohio.gov

Prepared by
The Ohio Department of Transportation
Office of Technical Services
Roadway Information

SATBSR00084**C

State True Log

39.796

County True Log

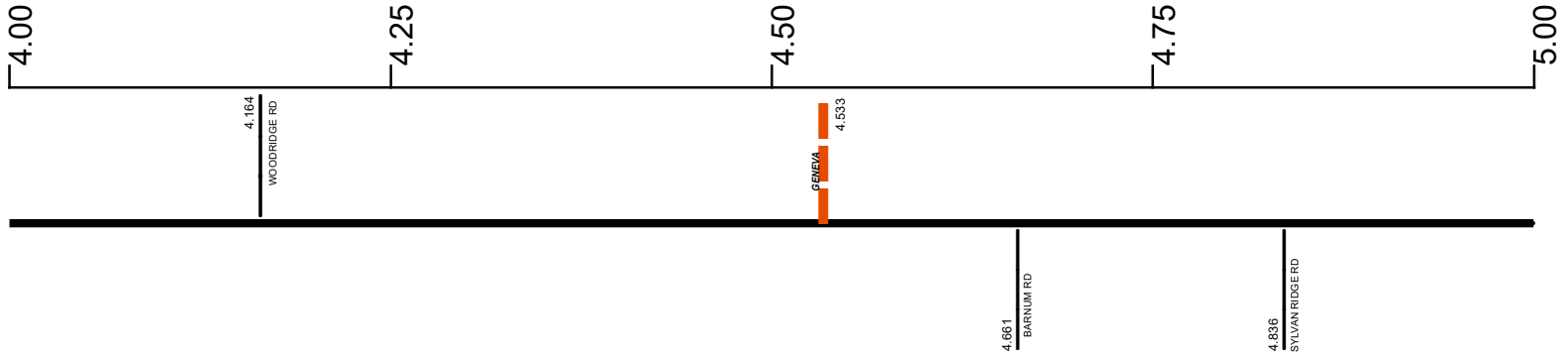

Surface Type & Width (Left / Right)

G (16'4')
3.088 - 8.538

Base Type (Left / Right)

P / L
3.088 - 8.538

Shoulder Type & Width (Left / Right)

2 (6'6')
3.088 - 8.538

Through Lanes

2
0 - 12.817

Street Name

RIDGE
3 - 7.024

- | | | | |
|---------------------|-------------------|----------------------|--------------|
| Non-divided Highway | Bridge (on route) | Railroad (at grade) | Intersection |
| Divided Highway | Underpass | Railroad (underpass) | |
| Secondary Segment | Overpass | Railroad (overpass) | |
| Corporation | | | |

Created on: 6/24/2025

transportation.ohio.gov

Prepared by
The Ohio Department of Transportation
Office of Technical Services
Roadway Information

SATBSR00084**C

State True Log

40.796

County True Log

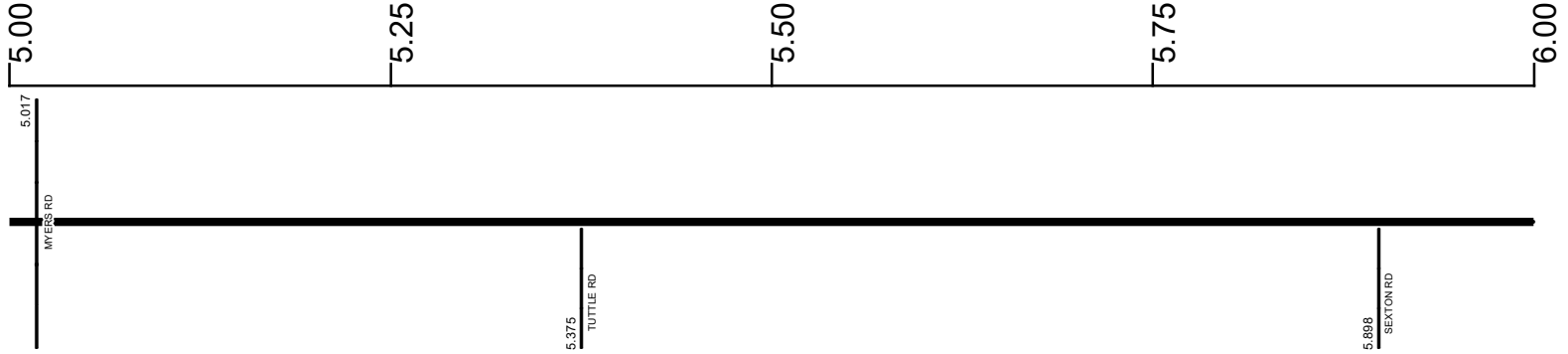

Surface Type & Width (Left / Right)

G (16'4')
3.088 - 8.538

Base Type (Left / Right)

P / L
3.088 - 8.538

Shoulder Type & Width (Left / Right)

2 (6'6')
3.088 - 8.538

Through Lanes

2
0 - 12.817

Street Name

RIDGE
3 - 7.024

- | | | | |
|---------------------|-------------------|----------------------|--------------|
| Non-divided Highway | Bridge (on route) | Railroad (at grade) | Intersection |
| Divided Highway | Underpass | Railroad (underpass) | |
| Secondary Segment | Overpass | Railroad (overpass) | |
| Corporation | | | |

Created on: 6/24/2025



transportation.ohio.gov

Prepared by
The Ohio Department of Transportation
Office of Technical Services
Roadway Information

SATBSR00084**C

State True Log

41.796

County True Log



Surface Type & Width (Left / Right)

G (16'4')
3.088 - 8.538

Base Type (Left / Right)

P / L
3.088 - 8.538

Shoulder Type & Width (Left / Right)

2 (6'6')
3.088 - 8.538

Through Lanes

2
0 - 12.817

Street Name

RIDGE
3 - 7.024

- | | | | |
|--|---|---|---|
| <ul style="list-style-type: none"> Non-divided Highway Divided Highway Secondary Segment Corporation | <ul style="list-style-type: none"> Bridge (on route) Underpass Overpass | <ul style="list-style-type: none"> Railroad (at grade) Railroad (underpass) Railroad (overpass) | <ul style="list-style-type: none"> Intersection |
|--|---|---|---|

Created on: 6/24/2025

transportation.ohio.gov

Prepared by
The Ohio Department of Transportation
Office of Technical Services
Roadway Information

SATBSR00084**C

State True Log

43.796

County True Log

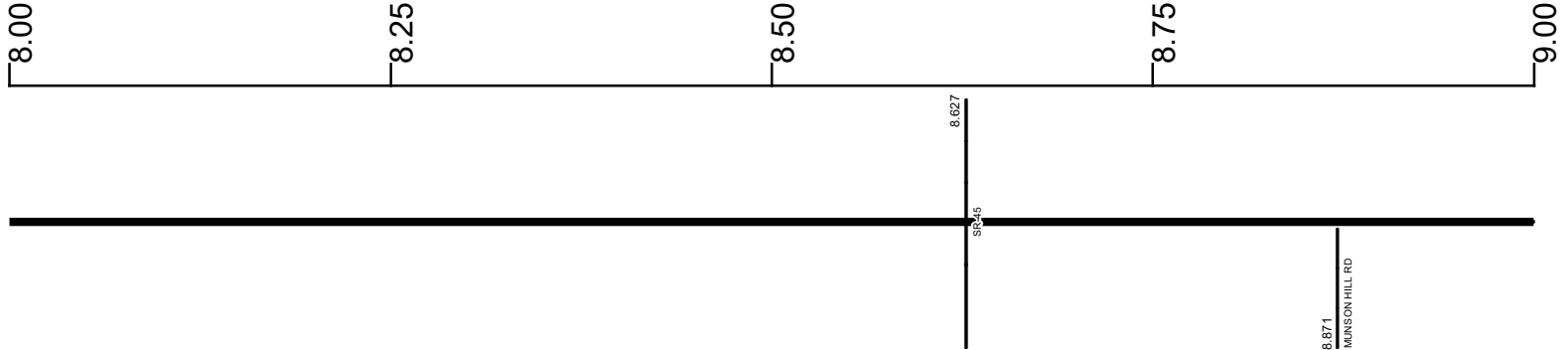

Surface Type & Width (Left / Right)

G (16'4')	G 36'	G 24'	G (16'4')
3.088 - 8.538	8.538 - 8.627	8.627 - 8.712	8.712 - 10.431

Base Type (Left / Right)

P / L	L	P / L
3.088 - 8.538	8.538 - 8.712	8.712 - 11.993

Shoulder Type & Width (Left / Right)

2 (6'6')	1 (0'0')	1 (6'0')	2 (6'6')
3.088 - 8.538	8.538 - 8.627	8.627 - 8.712	8.712 - 10.431

Through Lanes

2	0 - 12.817
---	------------

Street Name

RIDGE	7.024 - 11.993
-------	----------------

- Non-divided Highway
 Bridge (on route)
 Railroad (at grade)
 Intersection
- Divided Highway
 Underpass
 Railroad (underpass)
- Secondary Segment
 Overpass
 Railroad (overpass)
- Corporation**

Created on: 6/24/2025

transportation.ohio.gov

Prepared by
The Ohio Department of Transportation
Office of Technical Services
Roadway Information

SATBSR00084**C

State True Log

44.796

County True Log



Surface Type & Width (Left / Right)

G (16'4')
8.712 - 10.431

Base Type (Left / Right)

P / L
8.712 - 11.993

Shoulder Type & Width (Left / Right)

2 (6'6')
8.712 - 10.431

Through Lanes

2
0 - 12.817

Street Name

RIDGE
7.024 - 11.993

- | | | | |
|---------------------|-------------------|----------------------|--------------|
| Non-divided Highway | Bridge (on route) | Railroad (at grade) | Intersection |
| Divided Highway | Underpass | Railroad (underpass) | |
| Secondary Segment | Overpass | Railroad (overpass) | |
| Corporation | | | |

Created on: 6/24/2025

transportation.ohio.gov

Prepared by
The Ohio Department of Transportation
Office of Technical Services
Roadway Information

SATBSR00084**C

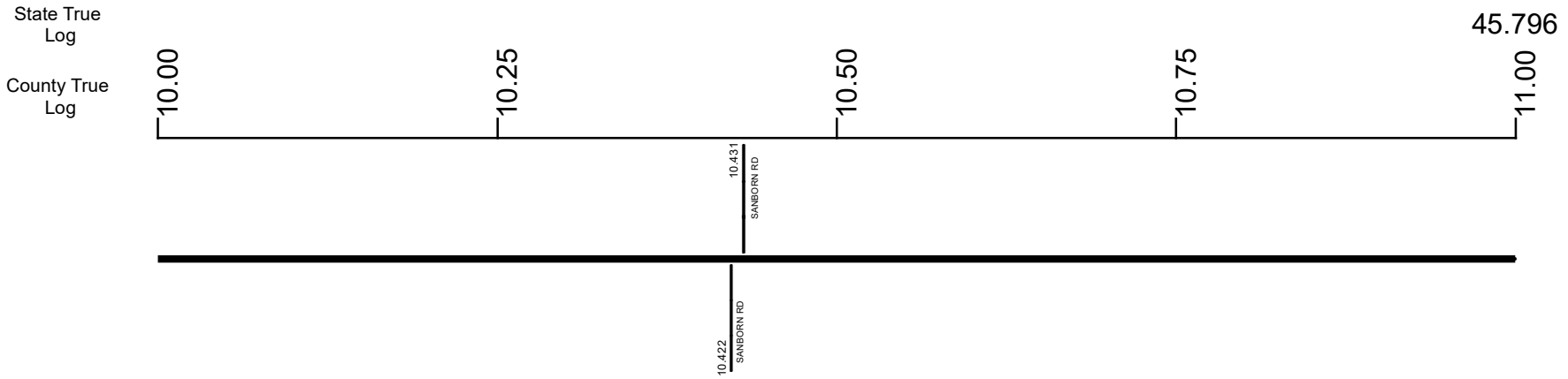

Surface Type & Width (Left / Right)	
G (16'4") 8.712 - 10.431	G (16'8") 10.431 - 11.993
Base Type (Left / Right)	
P / L 8.712 - 11.993	
Shoulder Type & Width (Left / Right)	
2 (6'6") 8.712 - 10.431	2 (4'4") 10.431 - 11.993
Through Lanes	
2 0 - 12.817	
Street Name	
RIDGE 7.024 - 11.993	

<ul style="list-style-type: none"> Non-divided Highway Divided Highway Secondary Segment Corporation 	<ul style="list-style-type: none"> Bridge (on route) Underpass Overpass 	<ul style="list-style-type: none"> Railroad (at grade) Railroad (underpass) Railroad (overpass) 	<ul style="list-style-type: none"> Intersection
--	---	---	---

Created on: 6/24/2025

transportation.ohio.gov

Prepared by
 The Ohio Department of Transportation
 Office of Technical Services
 Roadway Information

SATBSR00084**C

State True Log
County True Log

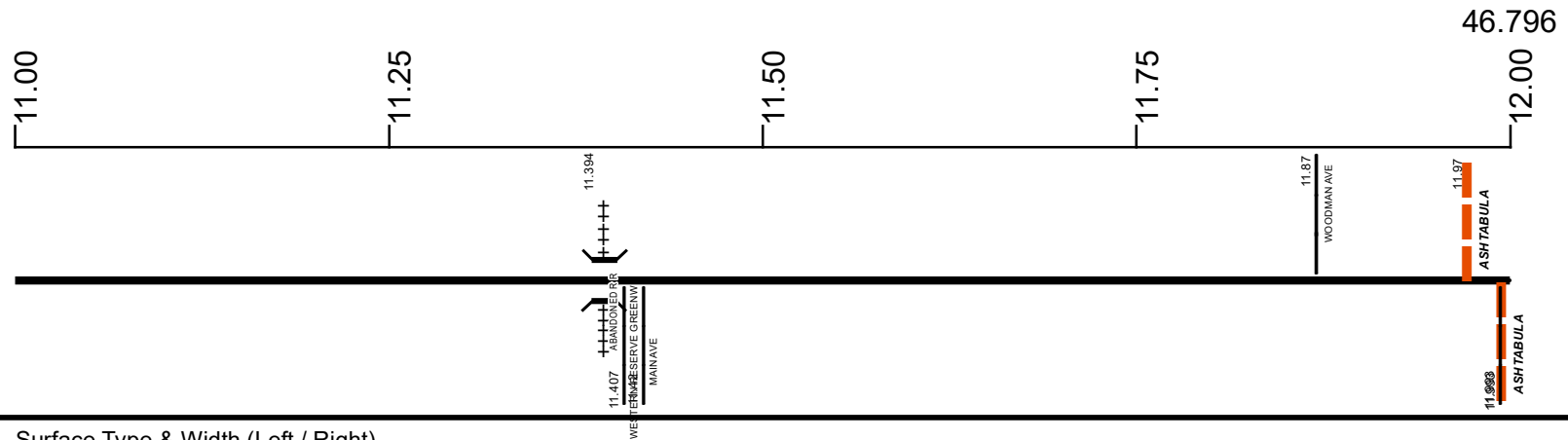

Surface Type & Width (Left / Right)	G (16/8')	G (32')
	10.431 - 11.993	
Base Type (Left / Right)	P / L	
	8.712 - 11.993	11.993 - 12.817
Shoulder Type & Width (Left / Right)	2 (4/4')	1 (0/0')
	10.431 - 11.993	11.993 - 14.091
		Resurface Year
		2024
Through Lanes	2	11.993 - 13.414
	0 - 12.817	
Street Name	RIDGE	BUNKER HILL RD
	7.024 - 11.993	11.993 - 12.783

- Non-divided Highway
- Divided Highway
- Secondary Segment
- Corporation
- Bridge (on route)
- Underpass
- Overpass
- Railroad (at grade)
- Railroad (underpass)
- Railroad (overpass)
- Intersection

Created on: 6/24/2025



transportation.ohio.gov

Prepared by
The Ohio Department of Transportation
Office of Technical Services
Roadway Information

SATBSR00084**C

State True Log
County True Log

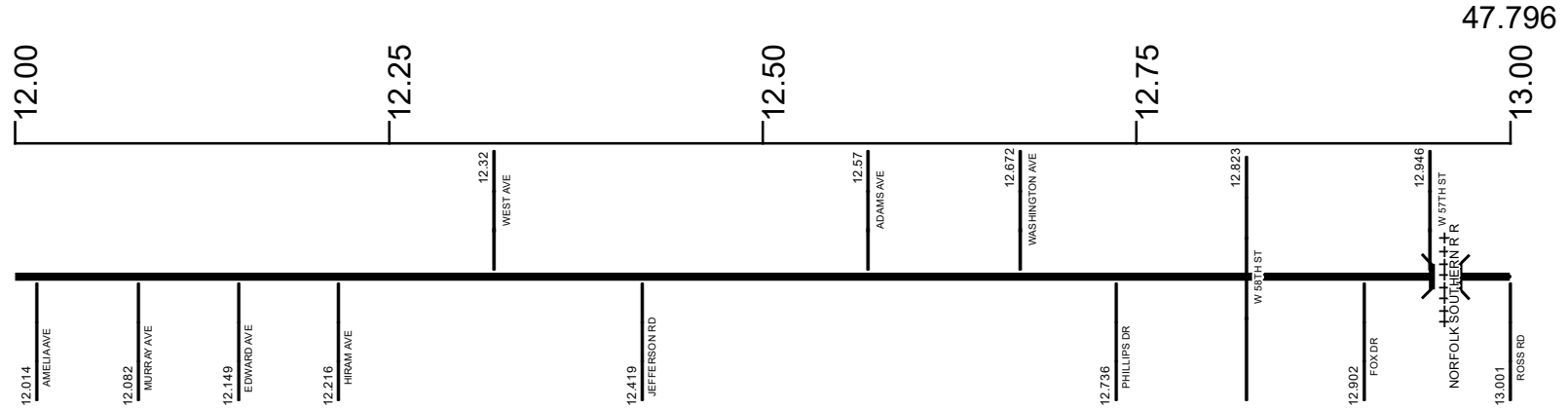

Surface Type & Width (Left / Right)	
G 32' 11.993 - 12.419	G 36' 12.419 - 12.817
Base Type (Left / Right)	
T 11.993 - 12.817	N 12.817 - 13.414
Shoulder Type & Width (Left / Right)	
1 (0'/0') 11.993 - 14.091	
Resurface Year	
2024 11.993 - 13.414	
Through Lanes	
2 0 - 12.817	4 12.817 - 13.414
Street Name	
BUNKER HILL RD 11.993 - 12.783	MAIN AVE 12.783 - 13.424

Non-divided Highway	Bridge (on route)	Railroad (at grade)	Intersection
Divided Highway	Underpass	Railroad (underpass)	
Secondary Segment	Overpass	Railroad (overpass)	
Corporation			

Created on: 6/24/2025

transportation.ohio.gov

Prepared by
The Ohio Department of Transportation
Office of Technical Services
Roadway Information

SATBSR00084**C

State True Log
County True Log

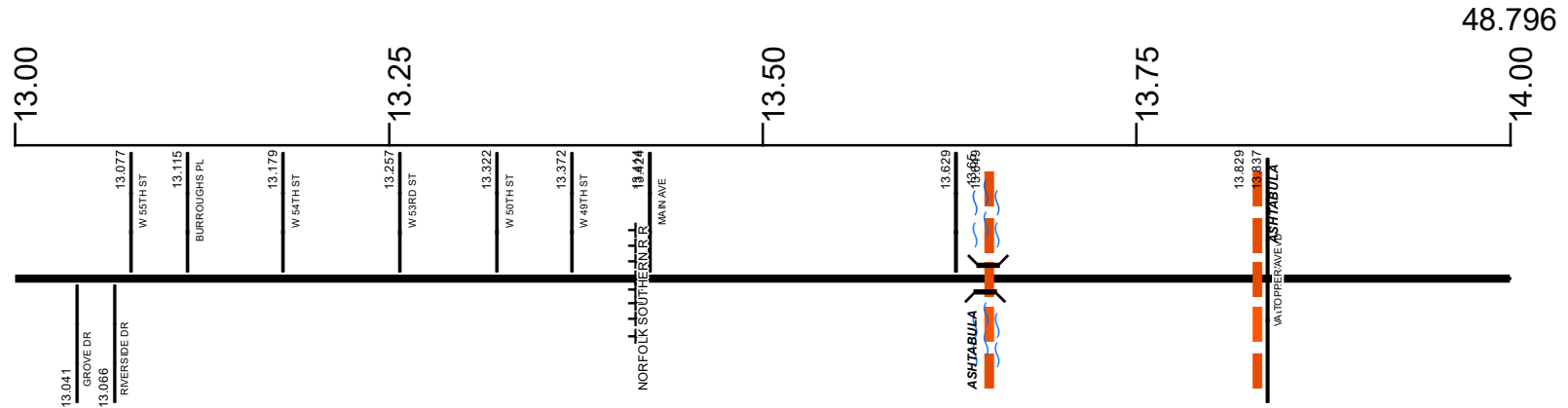

Surface Type & Width (Left / Right)

G (22'/23')	G 46'	D 46'	D 40'	G 40'
12.817 - 13.245	13.245 - 13.414	13.414 - 13.629	13.629 - 13.847	13.847 - 14.091

Base Type (Left / Right)

N	N
12.817 - 13.414	13.847 - 14.091

Shoulder Type & Width (Left / Right)

1 (0'/0')
11.993 - 14.091

Resurface Year

2024
11.993 - 13.414

Through Lanes

4	2
12.817 - 13.414	13.414 - 28.503

Street Name

MAIN AVE	COLLINS BLVD	W 46TH ST	E 46TH ST
12.783 - 13.424	13.424 - 13.629	13.629 - 13.65	13.65 - 14.091

- Non-divided Highway
- Divided Highway
- Secondary Segment
- Corporation
- Bridge (on route)
- Underpass
- Overpass
- Railroad (at grade)
- Railroad (underpass)
- Railroad (overpass)
- Intersection

Created on: 6/24/2025

transportation.ohio.gov

Prepared by
The Ohio Department of Transportation
Office of Technical Services
Roadway Information

SATBSR00084**C

State True Log
County True Log

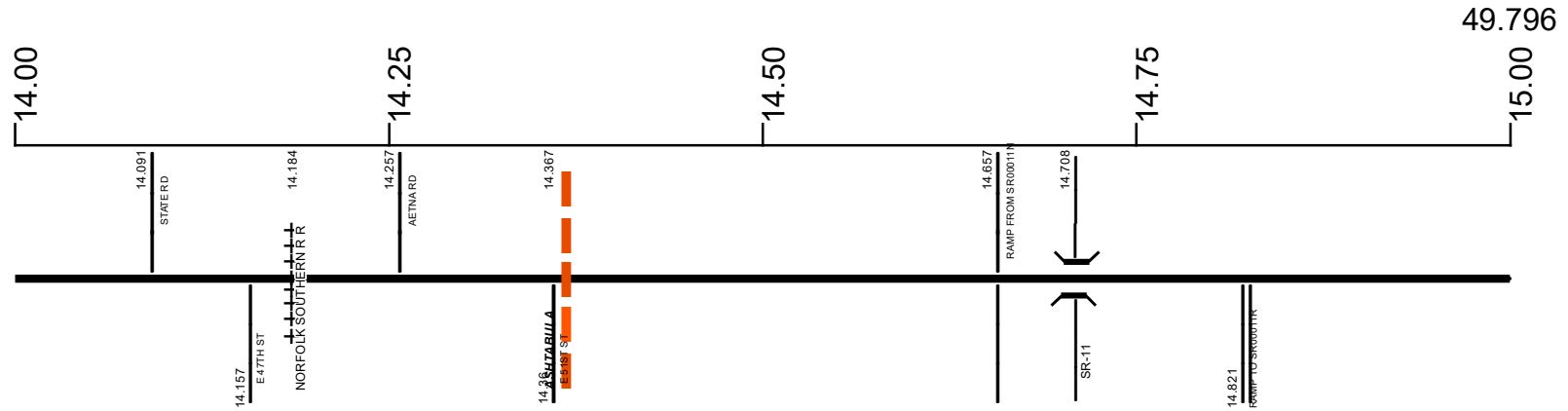

Surface Type & Width (Left / Right)

G 40'	G 26'	G 18'
13.847 - 14.091	14.091 - 14.195	14.195 - 19.688

Base Type (Left / Right)

N	T	P
13.847 - 14.091	14.091 - 14.195	14.195 - 19.688

Shoulder Type & Width (Left / Right)

1 (0'/0')	2 (2'/2')	2 (4'/4')
11.993 - 14.091	14.091 - 14.195	14.195 - 19.688

Resurface Year

2023
14.091 - 14.176

Through Lanes

	2	
	13.414 - 28.503	

Street Name

E 46TH ST	STATE RD	S RIDGE RD
13.65 - 14.091	14.091 - 14.36	14.36 - 19.396

- Non-divided Highway
- Divided Highway
- Secondary Segment
- Corporation
- Bridge (on route)
- Underpass
- Overpass
- Railroad (at grade)
- Railroad (underpass)
- Railroad (overpass)
- Intersection

Created on: 6/24/2025

transportation.ohio.gov

Prepared by
The Ohio Department of Transportation
Office of Technical Services
Roadway Information

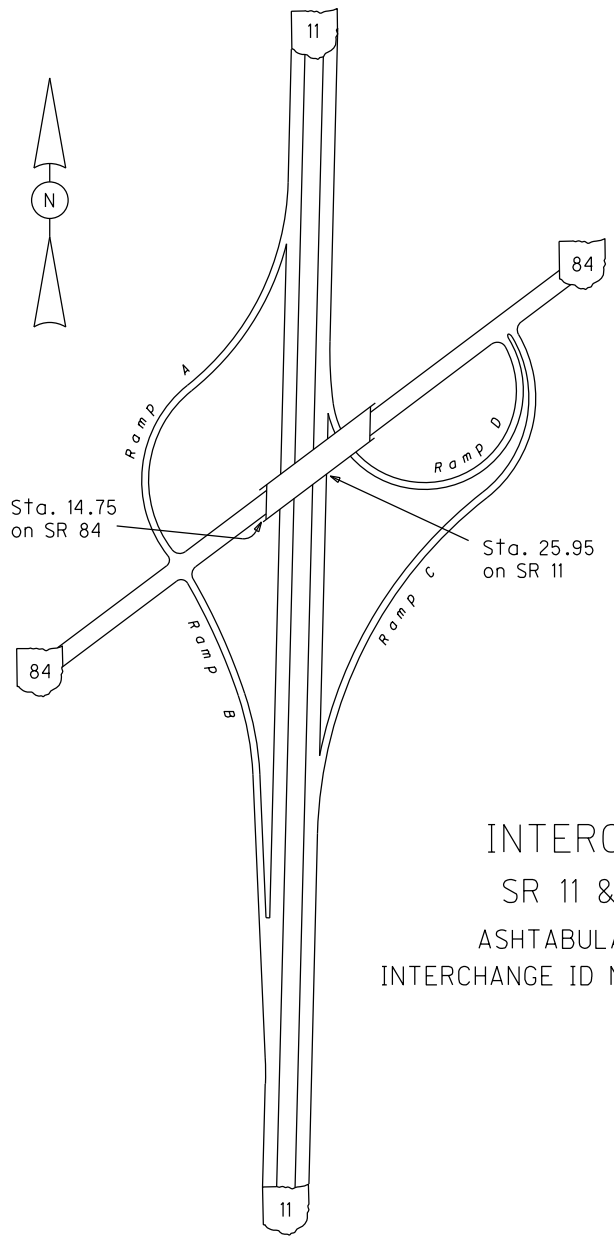

INTERCHANGE
SR 11 & SR 84
ASHTABULA COUNTY
INTERCHANGE ID NUMBER = 003400

SATBSR00084**C

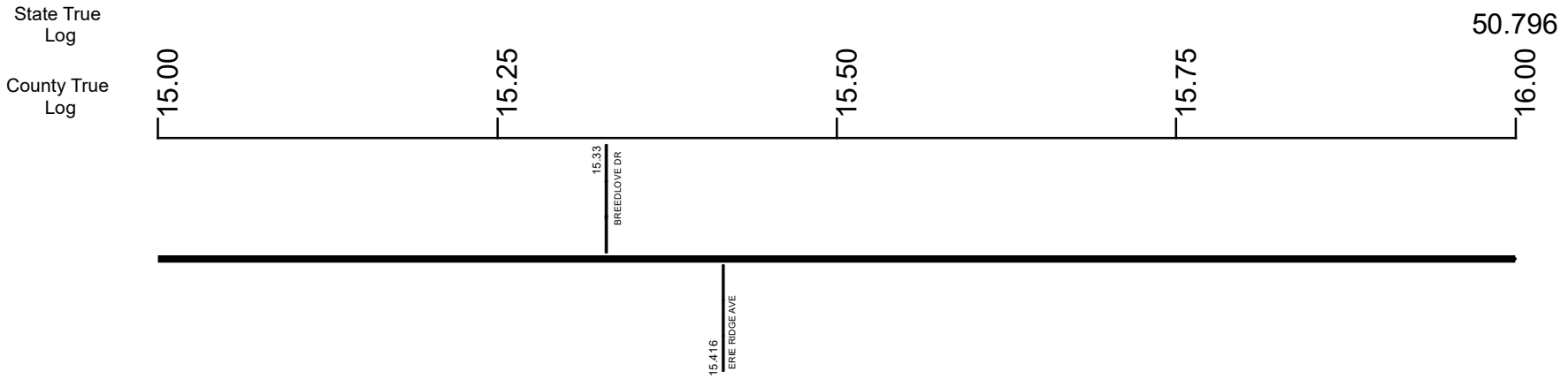

Surface Type & Width (Left / Right)	G 18'
	14.195 - 19.688
Base Type (Left / Right)	P
	14.195 - 19.688
Shoulder Type & Width (Left / Right)	2 (4/4')
	14.195 - 19.688
Through Lanes	2
	13.414 - 28.503
Street Name	S RIDGE RD
	14.36 - 19.396

- | | | | |
|---------------------|-------------------|----------------------|--------------|
| Non-divided Highway | Bridge (on route) | Railroad (at grade) | Intersection |
| Divided Highway | Underpass | Railroad (underpass) | |
| Secondary Segment | Overpass | Railroad (overpass) | |
| Corporation | | | |

Created on: 6/24/2025



transportation.ohio.gov

Prepared by
The Ohio Department of Transportation
Office of Technical Services
Roadway Information

SATBSR00084**C

State True Log 51.796
 County True Log 17.00

16.00 16.25 16.50 16.75

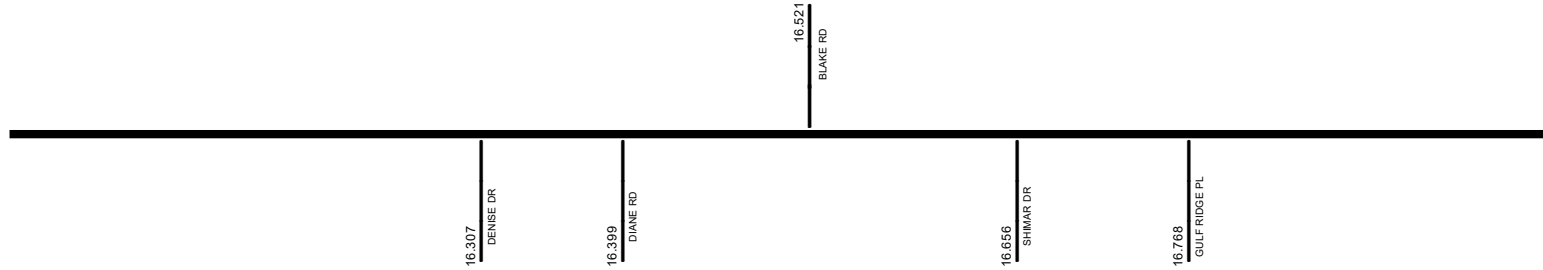

Surface Type & Width (Left / Right)	G 18'
	14.195 - 19.688
Base Type (Left / Right)	P
	14.195 - 19.688
Shoulder Type & Width (Left / Right)	2 (4/4')
	14.195 - 19.688
Through Lanes	2
	13.414 - 28.503
Street Name	S RIDGE RD
	14.36 - 19.396

Non-divided Highway	Bridge (on route)	Railroad (at grade)	Intersection
Divided Highway	Underpass	Railroad (underpass)	
Secondary Segment	Overpass	Railroad (overpass)	
Corporation			

Created on: 6/24/2025

transportation.ohio.gov

Prepared by
 The Ohio Department of Transportation
 Office of Technical Services
 Roadway Information

SATBSR00084**C

State True Log

52.796

County True Log

17.00

17.25

17.50

17.75

18.00



Surface Type & Width (Left / Right)

G 18'
14.195 - 19.688

Base Type (Left / Right)

P
14.195 - 19.688

Shoulder Type & Width (Left / Right)

2 (4/4')
14.195 - 19.688

Through Lanes

2
13.414 - 28.503

Street Name

S RIDGE RD
14.36 - 19.396

- | | | | |
|--|---|---|---|
| <ul style="list-style-type: none"> Non-divided Highway Divided Highway Secondary Segment Corporation | <ul style="list-style-type: none"> Bridge (on route) Underpass Overpass | <ul style="list-style-type: none"> Railroad (at grade) Railroad (underpass) Railroad (overpass) | <ul style="list-style-type: none"> Intersection |
|--|---|---|---|

Created on: 6/24/2025

transportation.ohio.gov

Prepared by
The Ohio Department of Transportation
Office of Technical Services
Roadway Information

SATBSR00084**C

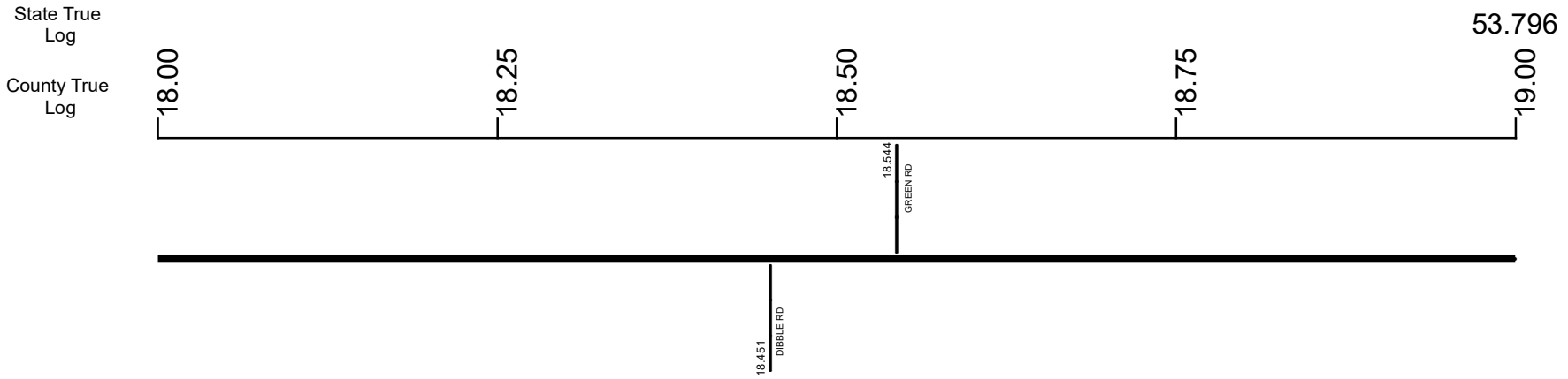

Surface Type & Width (Left / Right)	G 18'
	14.195 - 19.688
Base Type (Left / Right)	P
	14.195 - 19.688
Shoulder Type & Width (Left / Right)	2 (4/4')
	14.195 - 19.688
Through Lanes	2
	13.414 - 28.503
Street Name	S RIDGE RD
	14.36 - 19.396

- Non-divided Highway
- Divided Highway
- Secondary Segment
- Corporation
- Bridge (on route)
- Underpass
- Overpass
- Railroad (at grade)
- Railroad (underpass)
- Railroad (overpass)
- Intersection

Created on: 6/24/2025

transportation.ohio.gov

Prepared by
The Ohio Department of Transportation
Office of Technical Services
Roadway Information

SATBSR00084**C

State True Log

54.796

County True Log

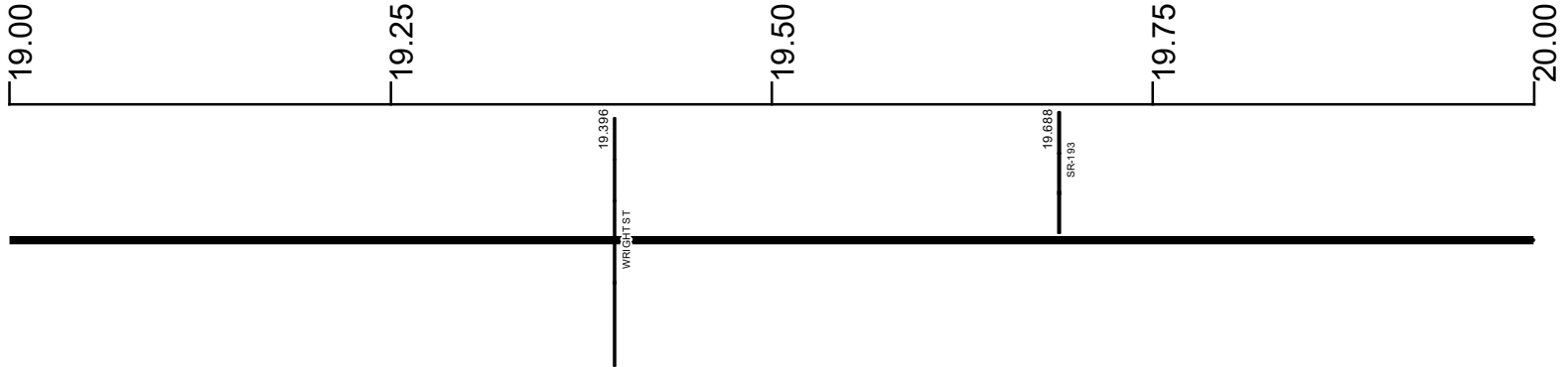

Surface Type & Width (Left / Right)

G 18' 14.195 - 19.688	G (16/8') 19.688 - 20.249
--------------------------	------------------------------

Base Type (Left / Right)

P 14.195 - 19.688	T / L 19.688 - 20.249
----------------------	--------------------------

Shoulder Type & Width (Left / Right)

2 (4/4') 14.195 - 19.688	2 (8/8') 19.688 - 20.249
-----------------------------	-----------------------------

Through Lanes

2 13.414 - 28.503

Street Name

S RIDGE RD 14.36 - 19.396	W MAIN ST 19.396 - 19.688	SR 84 19.688 - 23.434
------------------------------	------------------------------	--------------------------

- Non-divided Highway
 Bridge (on route)
 Railroad (at grade)
 Intersection
- Divided Highway
 Underpass
 Railroad (underpass)
- Secondary Segment
 Overpass
 Railroad (overpass)
- Corporation**

Created on: 6/24/2025

transportation.ohio.gov

Prepared by
The Ohio Department of Transportation
Office of Technical Services
Roadway Information

SATBSR00084**C

State True Log

55.796

County True Log

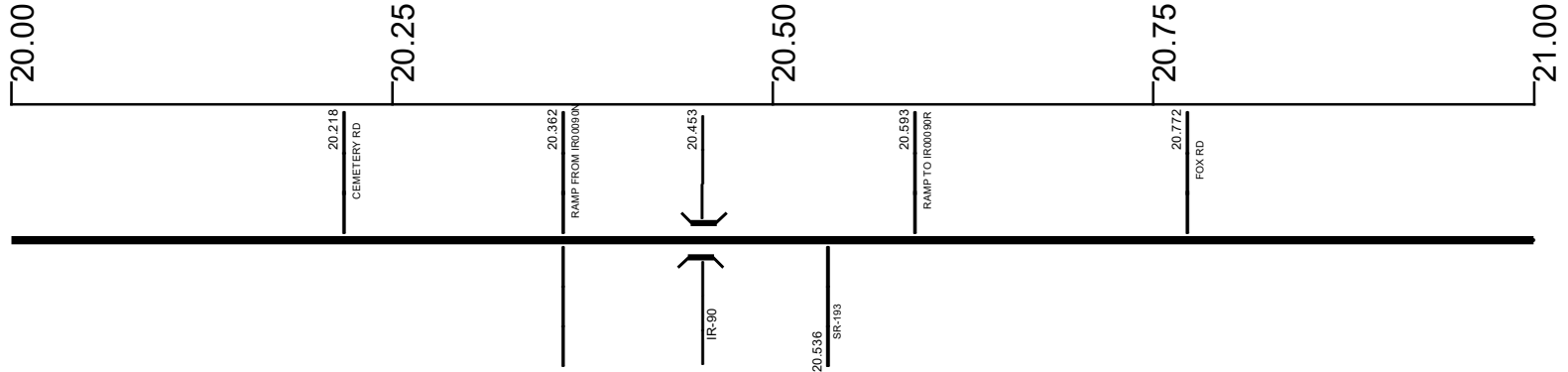

Surface Type & Width (Left / Right)

G (16'8") 19.688 - 20.249	G 24' 20.249 - 20.842	G 20' 20.842 - 28.503
------------------------------	--------------------------	--------------------------

Base Type (Left / Right)

T / L 19.688 - 20.249	I 20.249 - 20.842	L 20.842 - 26.133
--------------------------	----------------------	----------------------

Shoulder Type & Width (Left / Right)

2 (8'8") 19.688 - 20.249	2 (10'10") 20.249 - 28.503
-----------------------------	-------------------------------

Resurface Year

2020 20.249 - 21.741

Through Lanes

2 13.414 - 28.503

Street Name

SR 84 19.688 - 23.434

- Non-divided Highway
- Divided Highway
- Secondary Segment
- Corporation
- Bridge (on route)
- Underpass
- Overpass
- Railroad (at grade)
- Railroad (underpass)
- Railroad (overpass)
- Intersection

Created on: 6/24/2025

transportation.ohio.gov

Prepared by
The Ohio Department of Transportation
Office of Technical Services
Roadway Information

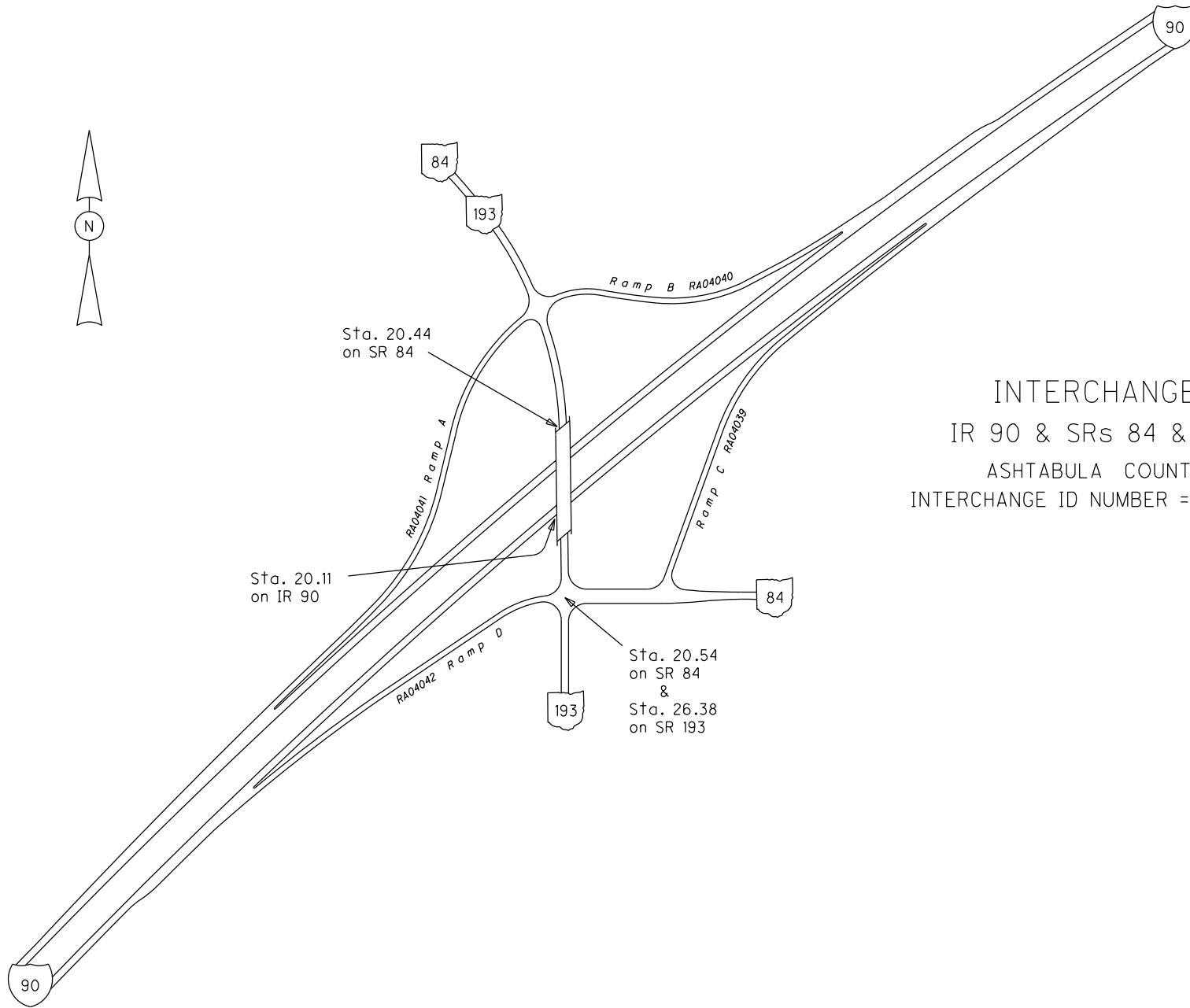

INTERCHANGE
IR 90 & SRs 84 & 193
ASHTABULA COUNTY
INTERCHANGE ID NUMBER = 002500

SATBSR00084**C

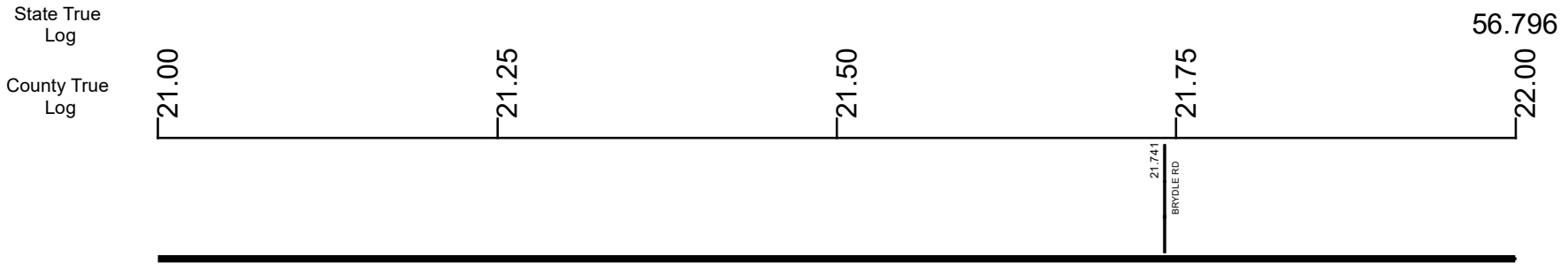

Surface Type & Width (Left / Right)

G 20'
20.842 - 28.503

Base Type (Left / Right)

L
20.842 - 26.133

Shoulder Type & Width (Left / Right)

2 (10'/10')
20.249 - 28.503

Resurface Year

2020	2022
20.249 - 21.741	21.741 - 28.503

Through Lanes

2
13.414 - 28.503

Street Name

SR 84
19.688 - 23.434

- | | | | |
|---------------------|-------------------|----------------------|--------------|
| Non-divided Highway | Bridge (on route) | Railroad (at grade) | Intersection |
| Divided Highway | Underpass | Railroad (underpass) | |
| Secondary Segment | Overpass | Railroad (overpass) | |
| Corporation | | | |

Created on: 6/24/2025

transportation.ohio.gov

Prepared by
The Ohio Department of Transportation
Office of Technical Services
Roadway Information

SATBSR00084**C

State True Log

57.796

County True Log

22.00

22.25

22.50

22.75

23.00



Surface Type & Width (Left / Right)

G 20'
20.842 - 28.503

Base Type (Left / Right)

L
20.842 - 26.133

Shoulder Type & Width (Left / Right)

2 (10'/10')
20.249 - 28.503

Resurface Year

2022
21.741 - 28.503

Through Lanes

2
13.414 - 28.503

Street Name

SR 84
19.688 - 23.434

- | | | | |
|---------------------|-------------------|----------------------|--------------|
| Non-divided Highway | Bridge (on route) | Railroad (at grade) | Intersection |
| Divided Highway | Underpass | Railroad (underpass) | |
| Secondary Segment | Overpass | Railroad (overpass) | |
| Corporation | | | |

Created on: 6/24/2025

transportation.ohio.gov

Prepared by
The Ohio Department of Transportation
Office of Technical Services
Roadway Information

SATBSR00084**C

State True Log

58.796

County True Log

23.00

23.25

23.50

23.75

24.00

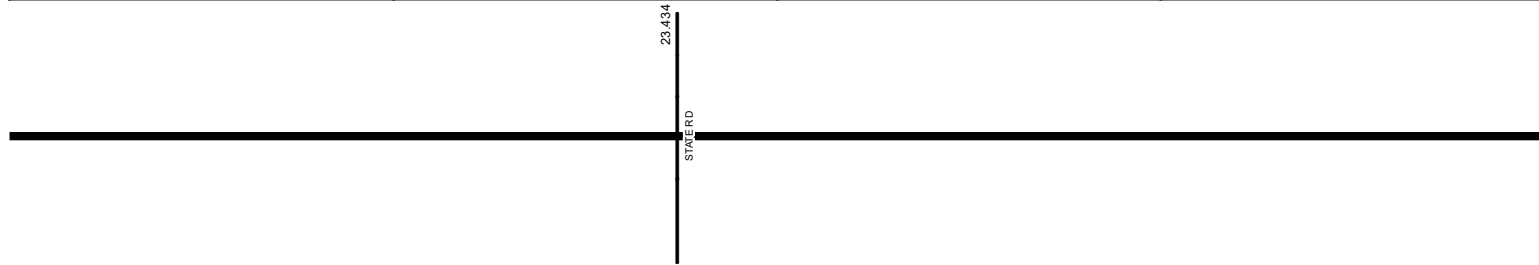

Surface Type & Width (Left / Right)

G 20'
20.842 - 28.503

Base Type (Left / Right)

L
20.842 - 26.133

Shoulder Type & Width (Left / Right)

2 (10'/10')
20.249 - 28.503

Resurface Year

2022

Through Lanes

2
13.414 - 28.503

Street Name

SR 84 19.688 - 23.434	BUSHNELL RD 23.434 - 28.503
--------------------------	--------------------------------

- Non-divided Highway
- Divided Highway
- Secondary Segment
- Corporation
- Bridge (on route)
- Underpass
- Overpass
- Railroad (at grade)
- Railroad (underpass)
- Railroad (overpass)
- Intersection

Created on: 6/24/2025



transportation.ohio.gov

Prepared by

The Ohio Department of Transportation
Office of Technical Services
Roadway Information

SATBSR00084**C

State True Log

59.796

County True Log

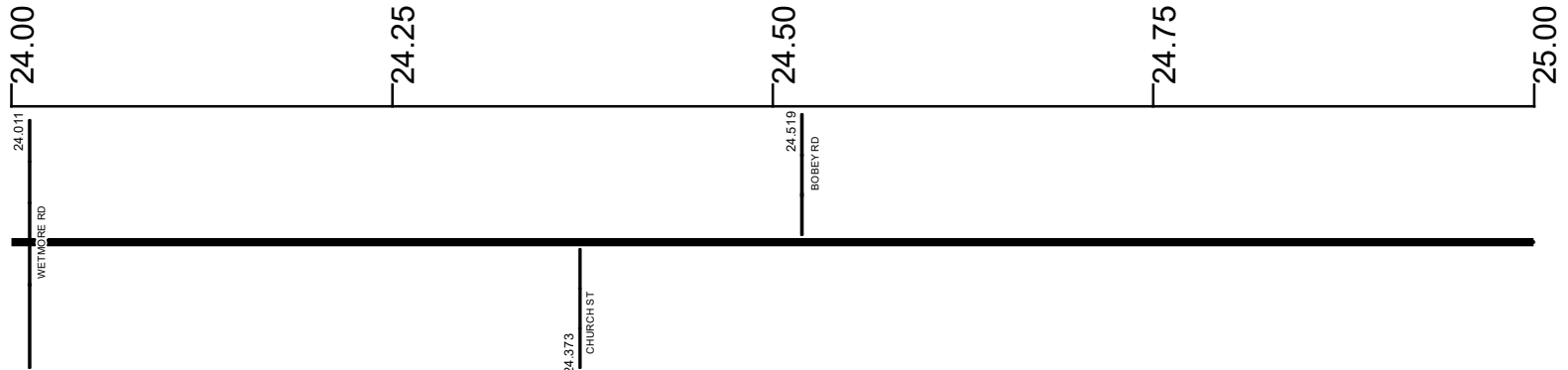

Surface Type & Width (Left / Right)

G 20'
20.842 - 28.503

Base Type (Left / Right)

L
20.842 - 26.133

Shoulder Type & Width (Left / Right)

2 (10'/10')
20.249 - 28.503

Resurface Year

2022

Through Lanes

2
13.414 - 28.503

Street Name

BUSHNELL RD
23.434 - 28.503

- | | | | |
|---------------------|-------------------|----------------------|--------------|
| Non-divided Highway | Bridge (on route) | Railroad (at grade) | Intersection |
| Divided Highway | Underpass | Railroad (underpass) | |
| Secondary Segment | Overpass | Railroad (overpass) | |
| Corporation | | | |

Created on: 6/24/2025



transportation.ohio.gov

Prepared by
The Ohio Department of Transportation
Office of Technical Services
Roadway Information

SATBSR00084**C

State True Log

60.796

County True Log

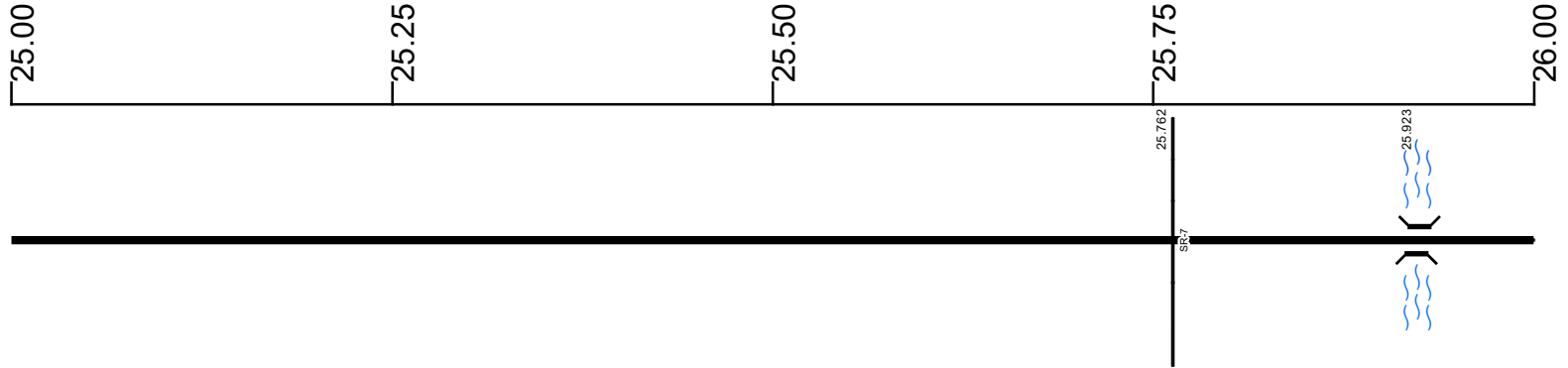

Surface Type & Width (Left / Right)

G 20'
20.842 - 28.503

Base Type (Left / Right)

L
20.842 - 26.133

Shoulder Type & Width (Left / Right)

2 (10'/10')
20.249 - 28.503

Resurface Year

2022

Through Lanes

2
13.414 - 28.503

Street Name

BUSHNELL RD
23.434 - 28.503

- | | | | |
|---------------------|-------------------|----------------------|--------------|
| Non-divided Highway | Bridge (on route) | Railroad (at grade) | Intersection |
| Divided Highway | Underpass | Railroad (underpass) | |
| Secondary Segment | Overpass | Railroad (overpass) | |
| Corporation | | | |

Created on: 6/24/2025

transportation.ohio.gov

Prepared by
The Ohio Department of Transportation
Office of Technical Services
Roadway Information

SATBSR00084**C

State True Log

61.796

County True Log



Surface Type & Width (Left / Right)

G 20'
20.842 - 28.503

Base Type (Left / Right)

L		I
20.842 - 26.133		26.133 - 28.503

Shoulder Type & Width (Left / Right)

2 (10'/10')
20.249 - 28.503

Resurface Year

2022

Through Lanes

2
13.414 - 28.503

Street Name

BUSHNELL RD
23.434 - 28.503

- | | | | |
|---------------------|-------------------|----------------------|--------------|
| Non-divided Highway | Bridge (on route) | Railroad (at grade) | Intersection |
| Divided Highway | Underpass | Railroad (underpass) | |
| Secondary Segment | Overpass | Railroad (overpass) | |
| Corporation | | | |

Created on: 6/24/2025

transportation.ohio.gov

Prepared by
The Ohio Department of Transportation
Office of Technical Services
Roadway Information

SATBSR00084**C

State True Log

62.796

County True Log

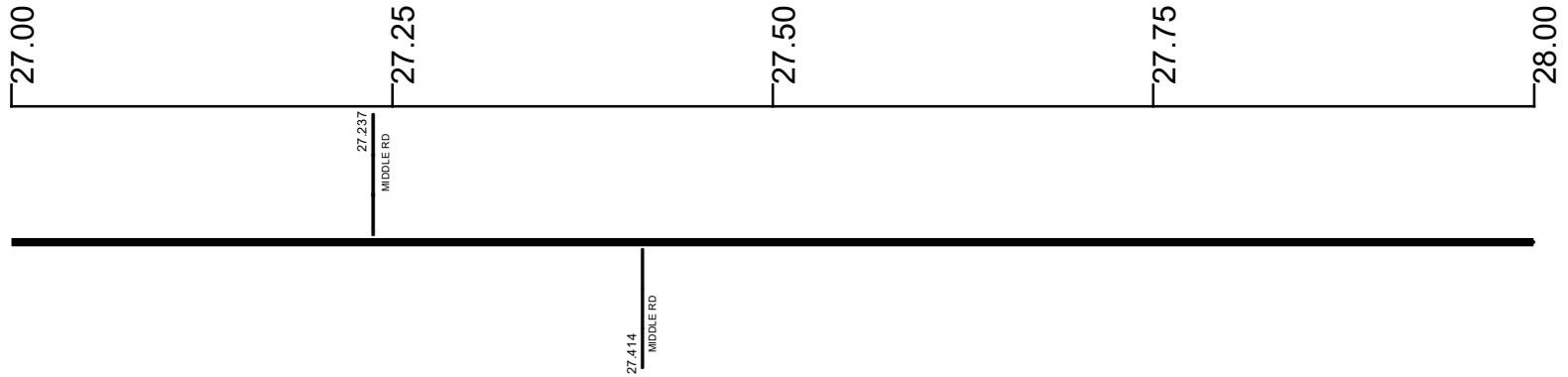

Surface Type & Width (Left / Right)

G 20'
20.842 - 28.503

Base Type (Left / Right)

I
26.133 - 28.503

Shoulder Type & Width (Left / Right)

2 (10'/10')
20.249 - 28.503

Resurface Year

2022
21.741 - 28.503

Through Lanes

2
13.414 - 28.503

Street Name

BUSHNELL RD
23.434 - 28.503

- | | | | |
|---------------------|-------------------|----------------------|--------------|
| Non-divided Highway | Bridge (on route) | Railroad (at grade) | Intersection |
| Divided Highway | Underpass | Railroad (underpass) | |
| Secondary Segment | Overpass | Railroad (overpass) | |
| Corporation | | | |

Created on: 6/24/2025

transportation.ohio.gov

Prepared by
The Ohio Department of Transportation
Office of Technical Services
Roadway Information

SATBSR00084**C

63.299

State True Log

County True Log

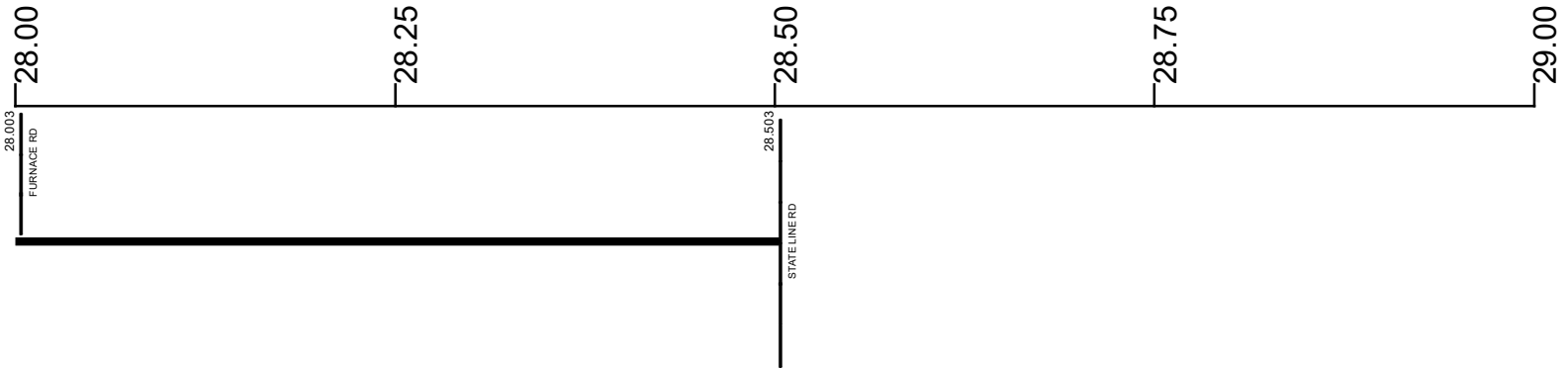

Surface Type & Width (Left / Right)

G 20'
20.842 - 28.503

Base Type (Left / Right)

I
26.133 - 28.503

Shoulder Type & Width (Left / Right)

2 (10'/10')
20.249 - 28.503

Resurface Year

2022
21.741 - 28.503

Through Lanes

2
13.414 - 28.503

Street Name

BUSHNELL RD
23.434 - 28.503

- Non-divided Highway
- Divided Highway
- Secondary Segment
- Corporation
- Bridge (on route)
- Underpass
- Overpass
- Railroad (at grade)
- Railroad (underpass)
- Railroad (overpass)
- Intersection

Created on: 6/24/2025



transportation.ohio.gov
Prepared by
The Ohio Department of Transportation
Office of Technical Services
Roadway Information

Historical Project List for SATBSR00084**C

Begin Measure	End Measure	Project ID Number	Construction Completion Date	Treatment Category	Treatment Type
0.000	2.596	100318	5-2018	Minor Rehabilitation	38-Fine Poly AC Overlay
0.000	11.962	22561	8-2006	Minor Rehabilitation	60-AC Overlay w/Rpr
2.134	2.235	96550	10-2019	Minor Rehabilitation	60-AC Overlay w/Rpr
2.596	2.734	96550	10-2019	Minor Rehabilitation	38-Fine Poly AC Overlay
2.734	3.824	96550	10-2019	Minor Rehabilitation	60-AC Overlay w/Rpr
3.824	11.983	100318	5-2018	Minor Rehabilitation	38-Fine Poly AC Overlay
14.091	14.184	94081	9-2023	Minor Rehabilitation	60-AC Overlay w/Rpr
14.091	19.678	76296	12-2011	Minor Rehabilitation	60-AC Overlay w/Rpr
14.195	15.281	100815	12-2019	Minor Rehabilitation	38-Fine Poly AC Overlay
15.281	19.688	100815	12-2019	Minor Rehabilitation	38-Fine Poly AC Overlay
19.678	28.503	25500	6-2009	Minor Rehabilitation	60-AC Overlay w/Rpr
19.688	20.249	102356	12-2018	Preventive Maintenance	30-Microsurfacing
20.249	20.544	98390	11-2020	Minor Rehabilitation	38-Fine Poly AC Overlay
20.544	21.741	98390	11-2020	Minor Rehabilitation	60-AC Overlay w/Rpr
21.741	28.503	96551	8-2023	Minor Rehabilitation	38-Fine Poly AC Overlay

Roadway Codes

Access Control Journalized

- F - Full Access Control
- L - Limited Access Control
- N - No Access Control

Access Control Operational

- 1 - Full Access Control
- 2 - Partial Access Control
- 3 - No Access Control

Base Type

- F - Crack and Seat
- H - Rubblize and Roll
- I - Aggregate Base 304 or Traffic Compacted
- K - Water Bound Macadam
- L - Bituminous Concrete Mix or Penetration Macadam
- N - Plain Concrete
- P - Reinforced Concrete
- R - Brick (Flexible)
- T - Brick (Rigid)

Direction of Travel

- B - Both (Two-way)
- F - One-way Cardinal
- T - One-way Non-cardinal

Facility Type

- 1 - One-way Roadway
- 2 - Two-way Roadway
- 4 - Ramp
- 5 - Non-mainline
- 6 - Non-inventory Direction
- 7 - Planned / Unbuilt

Historical Federal Aid Indicator

- N - Not a FAP Route
- Y - FAP Route

Functional Classification

- 01 - Interstate
- 02 - Principal Arterial (Freeways)
- 03 - Principal Arterial (Other)
- 04 - Minor Arterial
- 05 - Major Collector
- 06 - Minor Collector
- 07 - Local

Leave / Reenter Indicator

- Y - Route leaves/reenters at this point
- N - Route does not leave/reenter at this point

Median Type

- 1 - None
- 2 - Unprotected
- 3 - Curbed
- 4 - Positive Barrier (Unspecified)
- 5 - Positive Barrier (Flexible)
- 6 - Positive Barrier (Semi-rigid)
- 7 - Positive Barrier (Rigid)

NHS

- N - National Highway System
- H - Congressional Corridor
- 2 - Major Airport
- 3 - Major Port Facility
- 4 - Major Amtrak Station
- 5 - Major Rail / Truck Terminal
- 6 - Major Intercity Bus Terminal
- 7 - Major Public Transit / Multi-modal Passenger Terminal
- 8 - Major Pipeline Terminal
- 9 - Major Ferry Terminal

Priority System

- G - General
- P - Priority System
- U - Urban

Scenic Byway Code

- A - All American Road
- N - National Scenic Byway
- S - State Scenic Byway

Shoulder Type

- 1 - None
- 2 - Surfaced shoulder exists (bituminous concrete {AC})
- 3 - Surfaced shoulder exists (Portland Cement Concrete {PCC})
- 4 - Stabilized shoulder exists (gravel or other granular material)
- 5 - Combination shoulder exists (two or more surface types)
- 6 - Earth shoulder exists
- 7 - Barrier curb exists; no shoulder in front of curb

Surface Type

- A - Combination
- B - Brick
- C - Continuous Reinforced Concrete
- D - Reinforced Concrete
- E - Plain Concrete
- G - Bituminous Concrete
- I - Chipseal on Granular
- K - Open Graded Bituminous
- L - Chipseal or Micro
- M - Gravel
- U - Unimproved
- X - Right of Way Only