

SATBSR00534**C

State True Log 43.109

44.109

County True Log

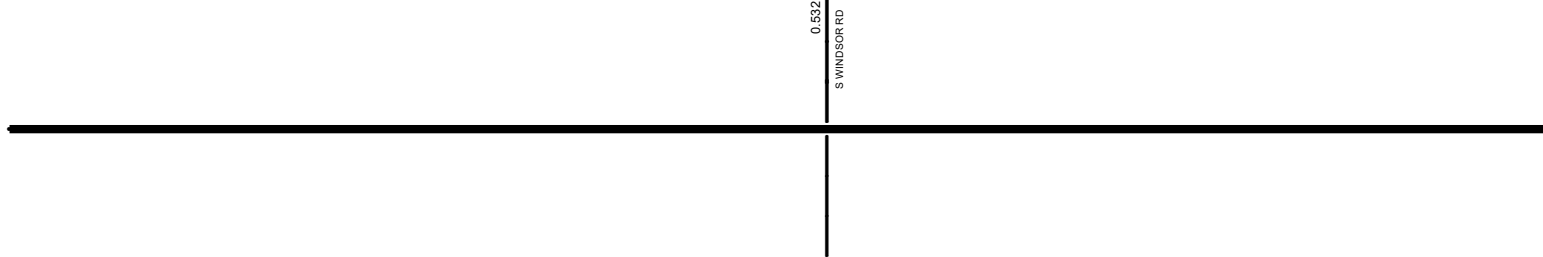

Surface Type & Width (Left / Right)

G (10'8")	G 24'
0 - 0.773	0.773 - 1.244

Base Type (Left / Right)

N / I	I
0 - 0.773	0.773 - 1.244

Shoulder Type & Width (Left / Right)

2 (3'3")	2 (4'4")
0 - 0.773	0.773 - 1.244

Through Lanes

	2
	0 - 7.676

Street Name

	SR 534
	0 - 7.676

- | | | | |
|---------------------|-------------------|----------------------|--------------|
| Non-divided Highway | Bridge (on route) | Railroad (at grade) | Intersection |
| Divided Highway | Underpass | Railroad (underpass) | |
| Secondary Segment | Overpass | Railroad (overpass) | |
| Corporation | | | |

Created on: 6/24/2025



transportation.ohio.gov
Prepared by
The Ohio Department of Transportation
Office of Technical Services
Roadway Information

SATBSR00534**C

State True
Log

45.109

County True
Log

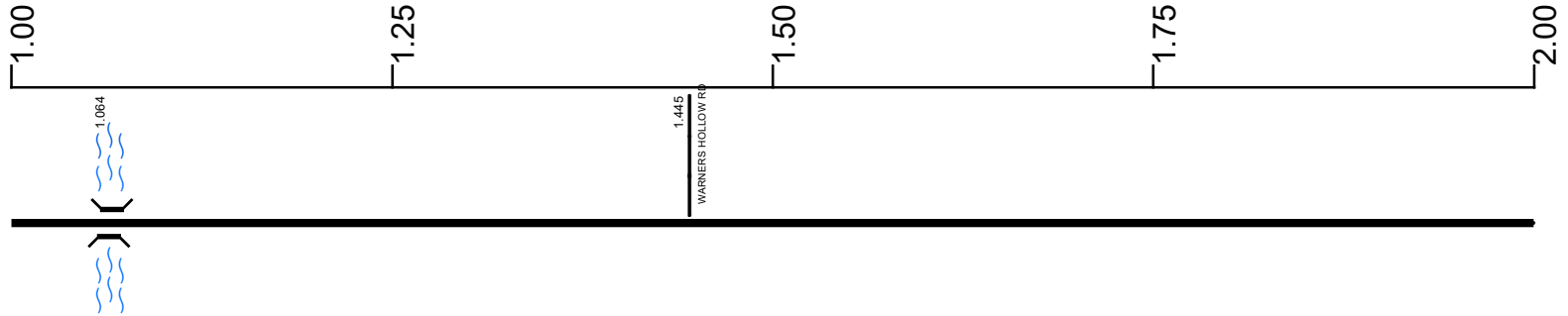

Surface Type & Width (Left / Right)

G 24' 0.773 - 1.244	G (10/8') 1.244 - 7.676
------------------------	----------------------------

Base Type (Left / Right)

I 0.773 - 1.244	N / I 1.244 - 2.429
--------------------	------------------------

Shoulder Type & Width (Left / Right)

2 (4 1/4') 0.773 - 1.244	2 (3/3') 1.244 - 7.676
-----------------------------	---------------------------

Through Lanes

	2 0 - 7.676
--	----------------

Street Name

	SR 534 0 - 7.676
--	---------------------

- | | | | |
|---------------------|-------------------|----------------------|--------------|
| Non-divided Highway | Bridge (on route) | Railroad (at grade) | Intersection |
| Divided Highway | Underpass | Railroad (underpass) | |
| Secondary Segment | Overpass | Railroad (overpass) | |
| Corporation | | | |

Created on: 6/24/2025

transportation.ohio.gov

Prepared by
The Ohio Department of Transportation
Office of Technical Services
Roadway Information

SATBSR00534**C

State True Log

46.109

County True Log

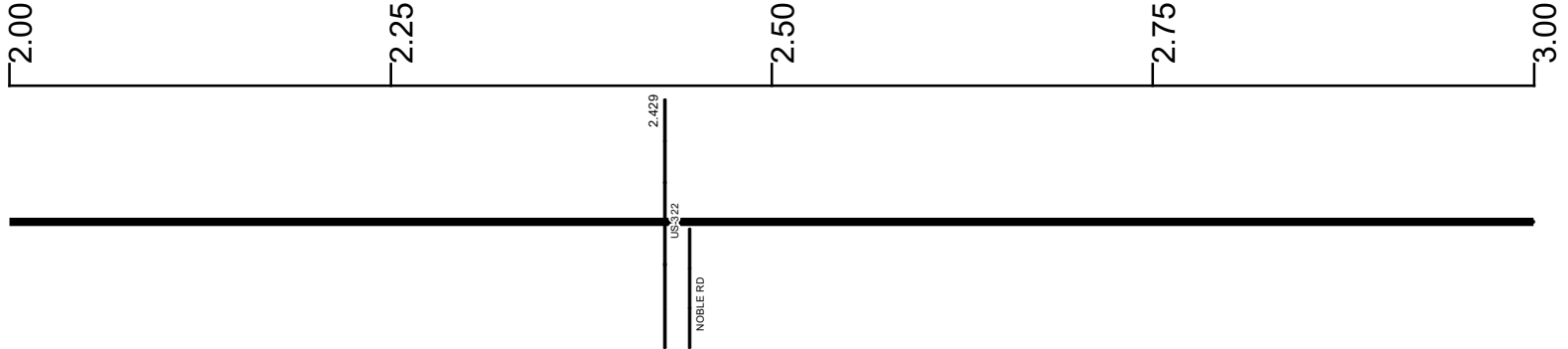

Surface Type & Width (Left / Right)

	G (10'/8')
	1.244 - 7.676

Base Type (Left / Right)

N / I	T / I
1.244 - 2.429	2.429 - 7.676

Shoulder Type & Width (Left / Right)

	2 (3'/3')
	1.244 - 7.676

Through Lanes

	2
	0 - 7.676

Street Name

	SR 534
	0 - 7.676

- | | | | |
|---------------------|-------------------|----------------------|--------------|
| Non-divided Highway | Bridge (on route) | Railroad (at grade) | Intersection |
| Divided Highway | Underpass | Railroad (underpass) | |
| Secondary Segment | Overpass | Railroad (overpass) | |
| Corporation | | | |

Created on: 6/24/2025

transportation.ohio.gov

Prepared by
The Ohio Department of Transportation
Office of Technical Services
Roadway Information

SATBSR00534**C

State True Log

47.109

County True Log

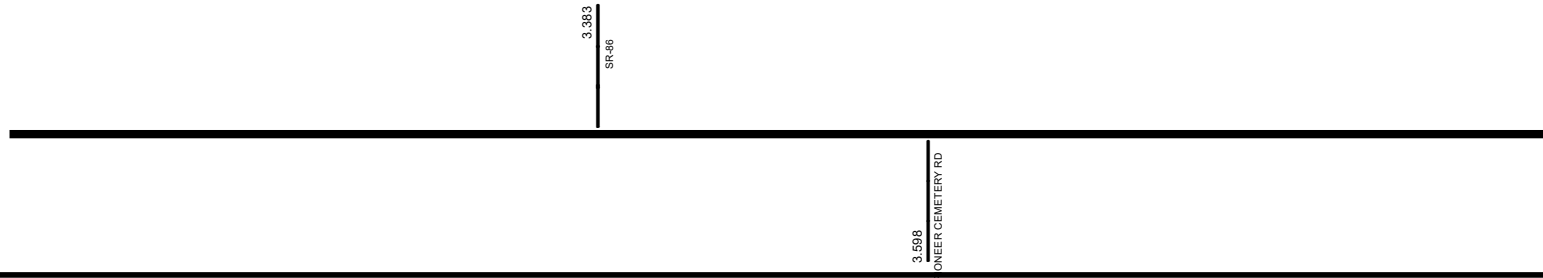

Surface Type & Width (Left / Right)	G (10/8') 1.244 - 7.676
Base Type (Left / Right)	T / I 2.429 - 7.676
Shoulder Type & Width (Left / Right)	2 (3/3') 1.244 - 7.676
Through Lanes	2 0 - 7.676
Street Name	SR 534 0 - 7.676

- | | | | |
|---------------------|-------------------|----------------------|--------------|
| Non-divided Highway | Bridge (on route) | Railroad (at grade) | Intersection |
| Divided Highway | Underpass | Railroad (underpass) | |
| Secondary Segment | Overpass | Railroad (overpass) | |
| Corporation | | | |

Created on: 6/24/2025

transportation.ohio.gov

Prepared by
The Ohio Department of Transportation
Office of Technical Services
Roadway Information

SATBSR00534**C

State True Log

48.109

County True Log

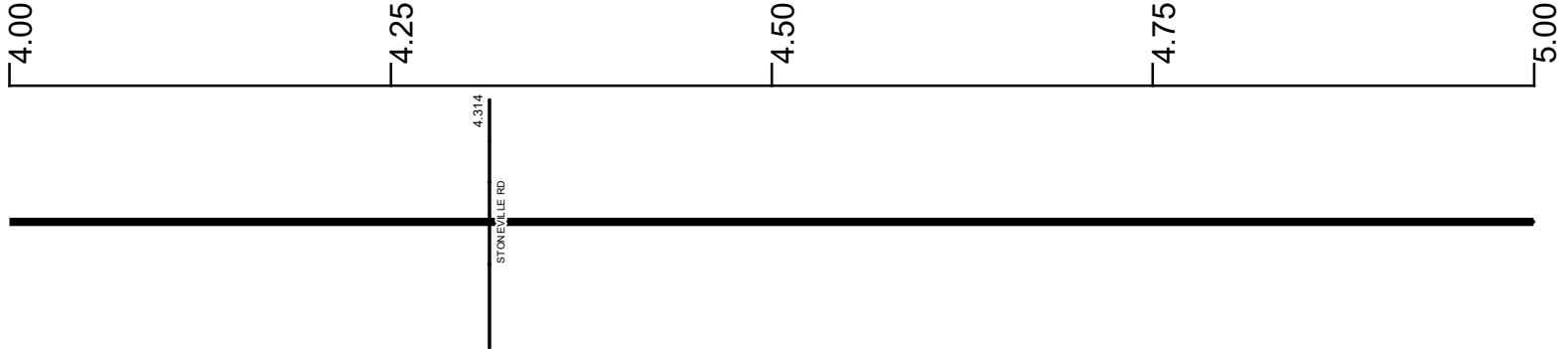

Surface Type & Width (Left / Right)

G (10/8')
1.244 - 7.676

Base Type (Left / Right)

T / I
2.429 - 7.676

Shoulder Type & Width (Left / Right)

2 (3/3')
1.244 - 7.676

Through Lanes

2
0 - 7.676

Street Name

SR 534
0 - 7.676

- | | | | |
|---------------------|-------------------|----------------------|--------------|
| Non-divided Highway | Bridge (on route) | Railroad (at grade) | Intersection |
| Divided Highway | Underpass | Railroad (underpass) | |
| Secondary Segment | Overpass | Railroad (overpass) | |
| Corporation | | | |

Created on: 6/24/2025



transportation.ohio.gov
Prepared by
The Ohio Department of Transportation
Office of Technical Services
Roadway Information

SATBSR00534**C

State True Log

49.109

County True Log



Surface Type & Width (Left / Right)

	G (10'/8')
	1.244 - 7.676

Base Type (Left / Right)

	T / I
	2.429 - 7.676

Shoulder Type & Width (Left / Right)

	2 (3'/3')
	1.244 - 7.676

Through Lanes

	2
	0 - 7.676

Street Name

	SR 534
	0 - 7.676

- | | | | |
|---------------------|-------------------|----------------------|--------------|
| Non-divided Highway | Bridge (on route) | Railroad (at grade) | Intersection |
| Divided Highway | Underpass | Railroad (underpass) | |
| Secondary Segment | Overpass | Railroad (overpass) | |
| Corporation | | | |

Created on: 6/24/2025



transportation.ohio.gov
Prepared by
The Ohio Department of Transportation
Office of Technical Services
Roadway Information

SATBSR00534**C

State True Log

50.109

County True Log

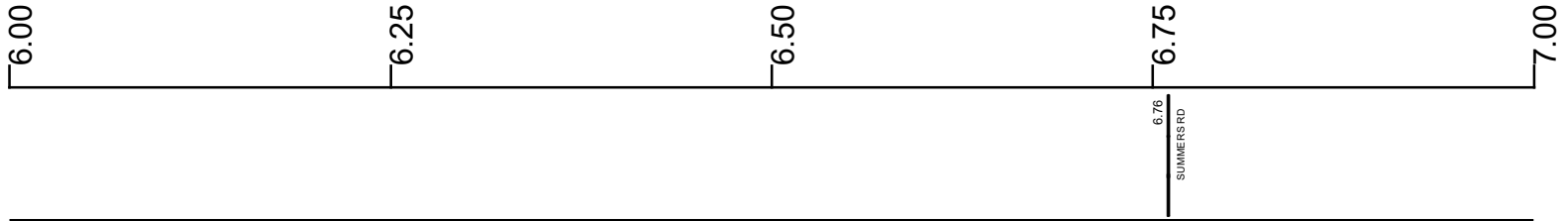

Surface Type & Width (Left / Right)

G (10/8')
1.244 - 7.676

Base Type (Left / Right)

T / I
2.429 - 7.676

Shoulder Type & Width (Left / Right)

2 (3/3)
1.244 - 7.676

Through Lanes

2
0 - 7.676

Street Name

SR 534
0 - 7.676

- | | | | |
|---------------------|-------------------|----------------------|--------------|
| Non-divided Highway | Bridge (on route) | Railroad (at grade) | Intersection |
| Divided Highway | Underpass | Railroad (underpass) | |
| Secondary Segment | Overpass | Railroad (overpass) | |
| Corporation | | | |

Created on: 6/24/2025

transportation.ohio.gov

Prepared by
The Ohio Department of Transportation
Office of Technical Services
Roadway Information

SATBSR00534**C

State True Log

51.109

County True Log

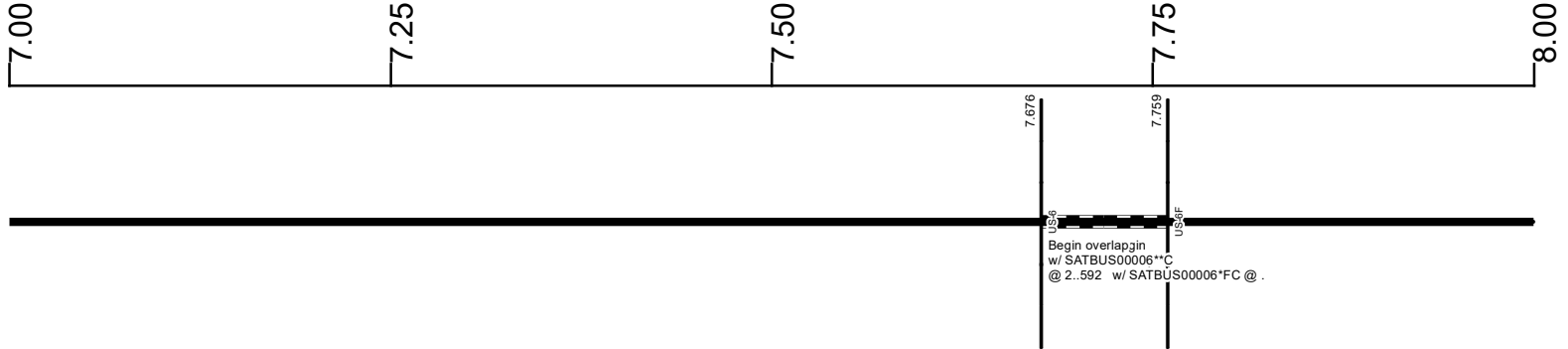

Surface Type & Width (Left / Right)

G (10'/8')
1.244 - 7.676

Base Type (Left / Right)

T / I
2.429 - 7.676

Shoulder Type & Width (Left / Right)

2 (3'/3')
1.244 - 7.676

Surface Type & Width (Left / Right)

G (10'/8')
7.759 - 10.49

Base Type (Left / Right)

T / I
7.759 - 10.49

Shoulder Type & Width (Left / Right)

2 (3'/3')
7.759 - 10.49

Through Lanes

2
0 - 7.676

Street Name

SR 534
0 - 7.676

Through Lanes

2
7.759 - 26.122

SR 534
7.759 - 15.279

- | | | | |
|--|---|---|---|
| <ul style="list-style-type: none"> Non-divided Highway Divided Highway Secondary Segment Corporation | <ul style="list-style-type: none"> Bridge (on route) Underpass Overpass | <ul style="list-style-type: none"> Railroad (at grade) Railroad (underpass) Railroad (overpass) | <ul style="list-style-type: none"> Intersection |
|--|---|---|---|

Created on: 6/24/2025



transportation.ohio.gov

Prepared by

The Ohio Department of Transportation
Office of Technical Services
Roadway Information

SATBSR00534**C

State True Log

52.109

County True Log

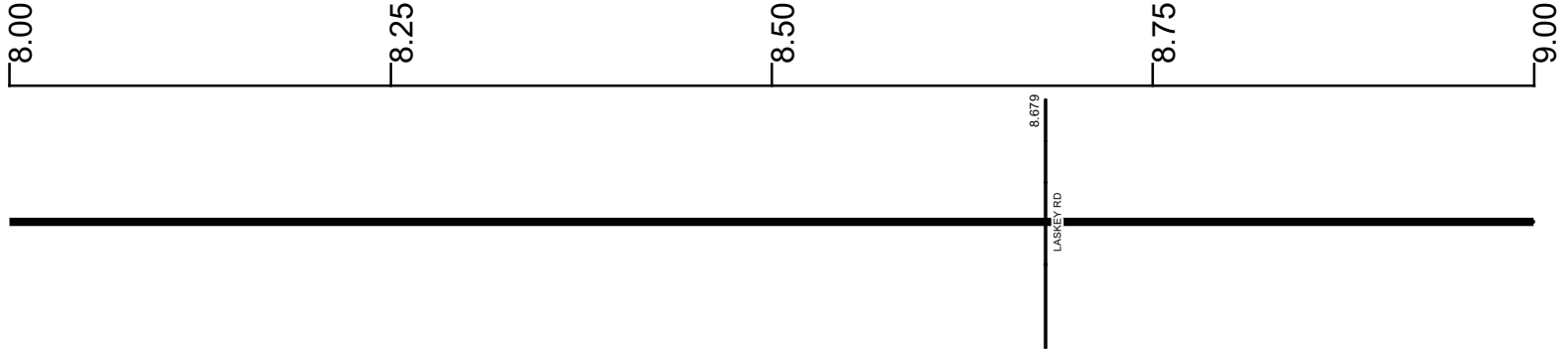

Surface Type & Width (Left / Right)

G (10/8')
7.759 - 10.49

Base Type (Left / Right)

T / I
7.759 - 10.49

Shoulder Type & Width (Left / Right)

2 (3/3')
7.759 - 10.49

Through Lanes

2
7.759 - 26.122

Street Name

SR 534
7.759 - 15.279

- | | | | |
|---------------------|-------------------|----------------------|--------------|
| Non-divided Highway | Bridge (on route) | Railroad (at grade) | Intersection |
| Divided Highway | Underpass | Railroad (underpass) | |
| Secondary Segment | Overpass | Railroad (overpass) | |
| Corporation | | | |

Created on: 6/24/2025

transportation.ohio.gov

Prepared by
The Ohio Department of Transportation
Office of Technical Services
Roadway Information

SATBSR00534**C

State True Log

53.109

County True Log



Surface Type & Width (Left / Right)

G (10'/8')
7.759 - 10.49

Base Type (Left / Right)

T / I
7.759 - 10.49

Shoulder Type & Width (Left / Right)

2 (3'/3')
7.759 - 10.49

Through Lanes

2
7.759 - 26.122

Street Name

SR 534
7.759 - 15.279

- | | | | |
|---------------------|-------------------|----------------------|--------------|
| Non-divided Highway | Bridge (on route) | Railroad (at grade) | Intersection |
| Divided Highway | Underpass | Railroad (underpass) | |
| Secondary Segment | Overpass | Railroad (overpass) | |
| Corporation | | | |

Created on: 6/24/2025

transportation.ohio.gov

Prepared by
The Ohio Department of Transportation
Office of Technical Services
Roadway Information

SATBSR00534**C

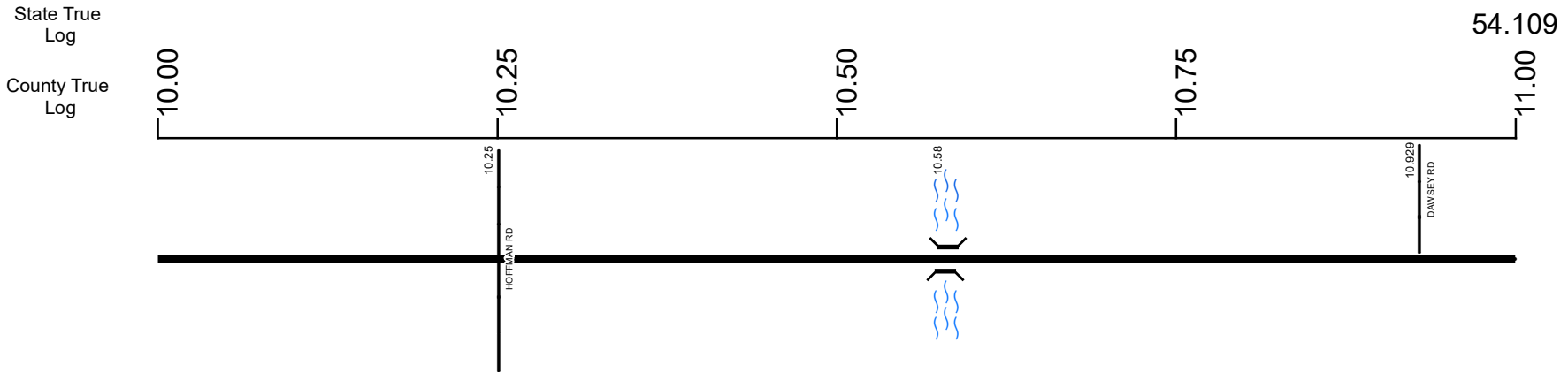

Surface Type & Width (Left / Right)		
G (10'/8')	G 20'	G (10'/8')
7.759 - 10.49	10.49 - 10.649	10.649 - 18.497
Base Type (Left / Right)		
T / I	L	T / I
7.759 - 10.49	10.49 - 10.649	10.649 - 18.497
Shoulder Type & Width (Left / Right)		
2 (3'/3')	2 (5'/5')	2 (3'/3')
7.759 - 10.49	10.49 - 10.649	10.649 - 18.497

Through Lanes	
2	7.759 - 26.122
Street Name	
SR 534	7.759 - 15.279

<ul style="list-style-type: none"> Non-divided Highway Divided Highway Secondary Segment Corporation 	<ul style="list-style-type: none"> Bridge (on route) Underpass Overpass 	<ul style="list-style-type: none"> Railroad (at grade) Railroad (underpass) Railroad (overpass) 	<ul style="list-style-type: none"> Intersection
--	---	---	---

Created on: 6/24/2025

transportation.ohio.gov

Prepared by
The Ohio Department of Transportation
Office of Technical Services
Roadway Information

SATBSR00534**C

State True Log

55.109

County True Log

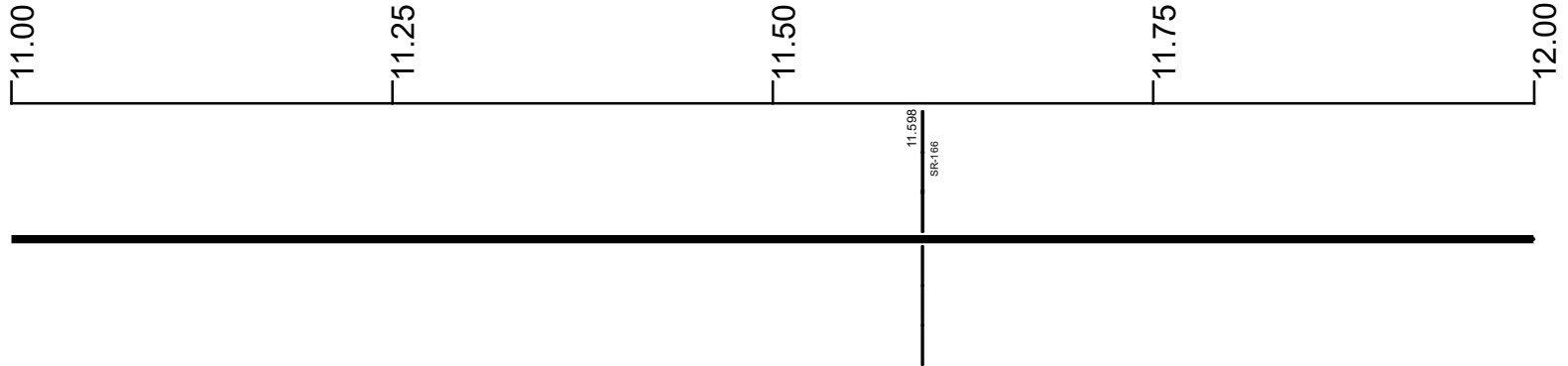

Surface Type & Width (Left / Right)

G (10/8')
10.649 - 18.497

Base Type (Left / Right)

T / I
10.649 - 18.497

Shoulder Type & Width (Left / Right)

2 (3/3)
10.649 - 18.497

Through Lanes

2
7.759 - 26.122

Street Name

SR 534
7.759 - 15.279

- | | | | |
|---------------------|-------------------|----------------------|--------------|
| Non-divided Highway | Bridge (on route) | Railroad (at grade) | Intersection |
| Divided Highway | Underpass | Railroad (underpass) | |
| Secondary Segment | Overpass | Railroad (overpass) | |
| Corporation | | | |

Created on: 6/24/2025

transportation.ohio.gov

Prepared by
The Ohio Department of Transportation
Office of Technical Services
Roadway Information

SATBSR00534**C

State True Log

56.109

County True Log

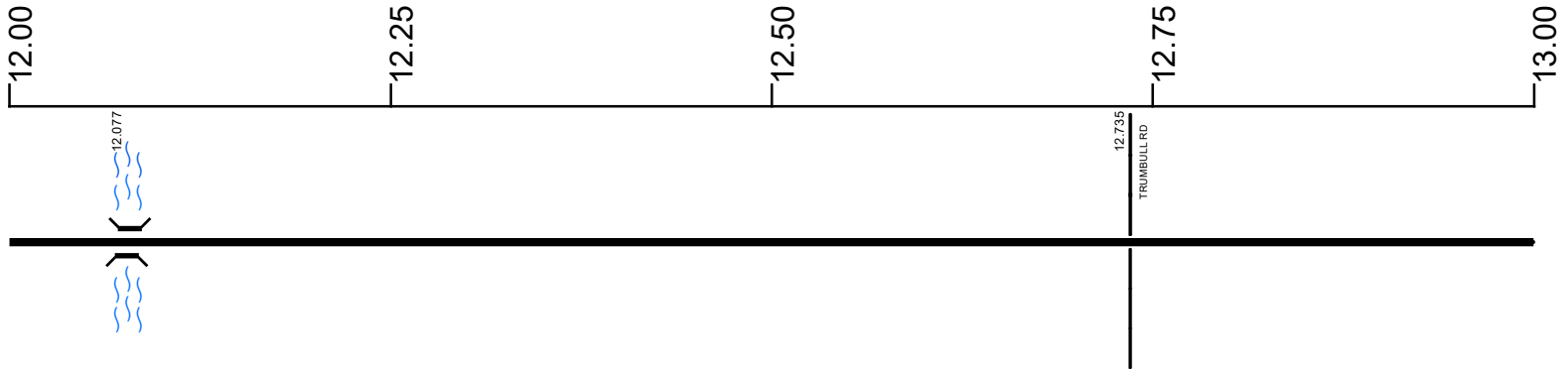

Surface Type & Width (Left / Right)

G (10/8')
10.649 - 18.497

Base Type (Left / Right)

T / I
10.649 - 18.497

Shoulder Type & Width (Left / Right)

2 (3/3')
10.649 - 18.497

Resurface Year

2023

12.055 - 12.11

Through Lanes

2
7.759 - 26.122

Street Name

SR 534
7.759 - 15.279

- | | | | |
|--|---|---|---|
| <ul style="list-style-type: none"> Non-divided Highway Divided Highway Secondary Segment Corporation | <ul style="list-style-type: none"> Bridge (on route) Underpass Overpass | <ul style="list-style-type: none"> Railroad (at grade) Railroad (underpass) Railroad (overpass) | <ul style="list-style-type: none"> Intersection |
|--|---|---|---|

Created on: 6/24/2025

transportation.ohio.gov

Prepared by
The Ohio Department of Transportation
Office of Technical Services
Roadway Information

SATBSR00534**C

State True Log

57.109

County True Log

13.00

13.25

13.50

13.75

14.00

13.536
BARRETT RD

Surface Type & Width (Left / Right)

G (10/8')
10.649 - 18.497

Base Type (Left / Right)

T / I
10.649 - 18.497

Shoulder Type & Width (Left / Right)









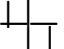

2 (3/3')
10.649 - 18.497

Through Lanes

2
7.759 - 26.122

Street Name

SR 534
7.759 - 15.279

- | | | | |
|---|---|--|--|
|  Non-divided Highway |  Bridge (on route) |  Railroad (at grade) |  Intersection |
|  Divided Highway |  Underpass |  Railroad (underpass) | |
|  Secondary Segment |  Overpass |  Railroad (overpass) | |
|  Corporation | | | |

Created on: 6/24/2025

SATBSR00534**C

State True Log
County True Log

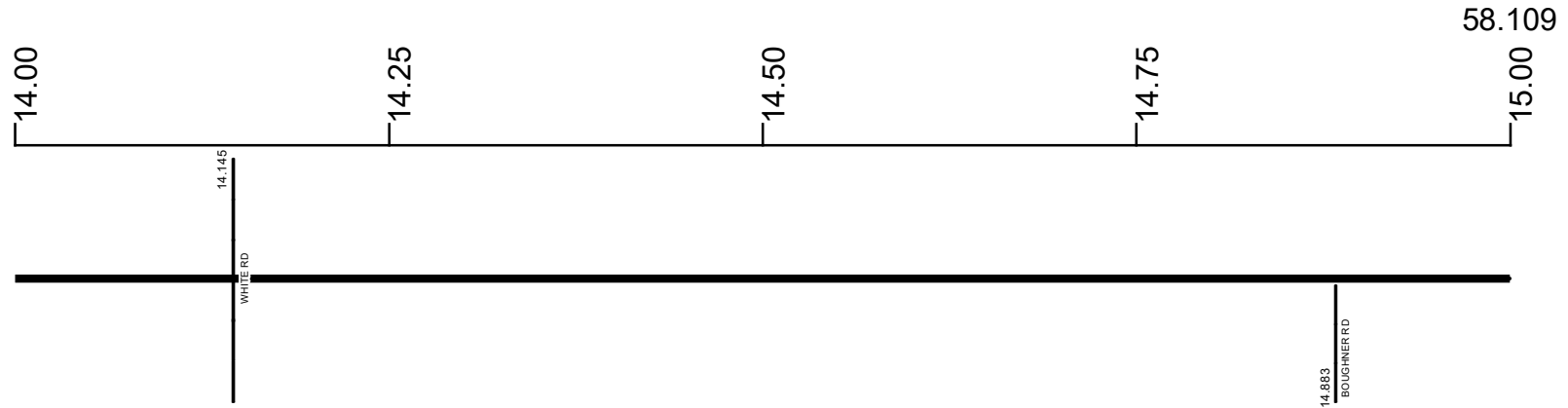

Surface Type & Width (Left / Right)

G (10/8')
10.649 - 18.497

Base Type (Left / Right)

T / I
10.649 - 18.497

Shoulder Type & Width (Left / Right)

2 (3/3')
10.649 - 18.497

Through Lanes

2
7.759 - 26.122

Street Name

SR 534
7.759 - 15.279

- | | | | |
|---------------------|-------------------|----------------------|--------------|
| Non-divided Highway | Bridge (on route) | Railroad (at grade) | Intersection |
| Divided Highway | Underpass | Railroad (underpass) | |
| Secondary Segment | Overpass | Railroad (overpass) | |
| Corporation | | | |

Created on: 6/24/2025



transportation.ohio.gov
Prepared by
The Ohio Department of Transportation
Office of Technical Services
Roadway Information

SATBSR00534**C

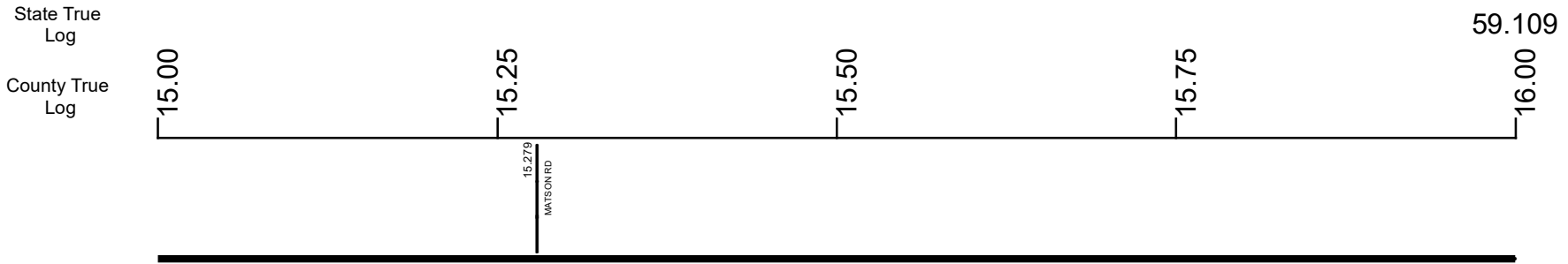

Surface Type & Width (Left / Right)

G (10'/8')
10.649 - 18.497

Base Type (Left / Right)

T / I
10.649 - 18.497

Shoulder Type & Width (Left / Right)

2 (3'/3')
10.649 - 18.497

Through Lanes

2
7.759 - 26.122

Street Name

	SR 534	
7.759 - 15.279	15.279 - 16.35	

- | | | | |
|---------------------|-------------------|----------------------|--------------|
| Non-divided Highway | Bridge (on route) | Railroad (at grade) | Intersection |
| Divided Highway | Underpass | Railroad (underpass) | |
| Secondary Segment | Overpass | Railroad (overpass) | |
| Corporation | | | |

Created on: 6/24/2025

transportation.ohio.gov

Prepared by
The Ohio Department of Transportation
Office of Technical Services
Roadway Information

SATBSR00534**C

State True Log

60.109

County True Log

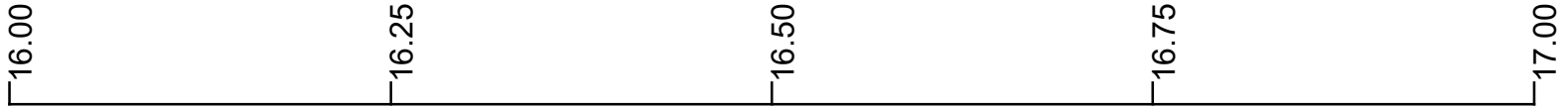

Surface Type & Width (Left / Right)

	G (10'8')
	10.649 - 18.497

Base Type (Left / Right)

	T / I
	10.649 - 18.497

Shoulder Type & Width (Left / Right)

	2 (3'3')
	10.649 - 18.497

Through Lanes

	2
	7.759 - 26.122

Street Name		
15.279 - 16.35	SR 534	16.35 - 20.331

- | | | | |
|---------------------|-------------------|----------------------|--------------|
| Non-divided Highway | Bridge (on route) | Railroad (at grade) | Intersection |
| Divided Highway | Underpass | Railroad (underpass) | |
| Secondary Segment | Overpass | Railroad (overpass) | |
| Corporation | | | |

Created on: 6/24/2025

transportation.ohio.gov

Prepared by
The Ohio Department of Transportation
Office of Technical Services
Roadway Information

SATBSR00534**C

State True Log
County True Log

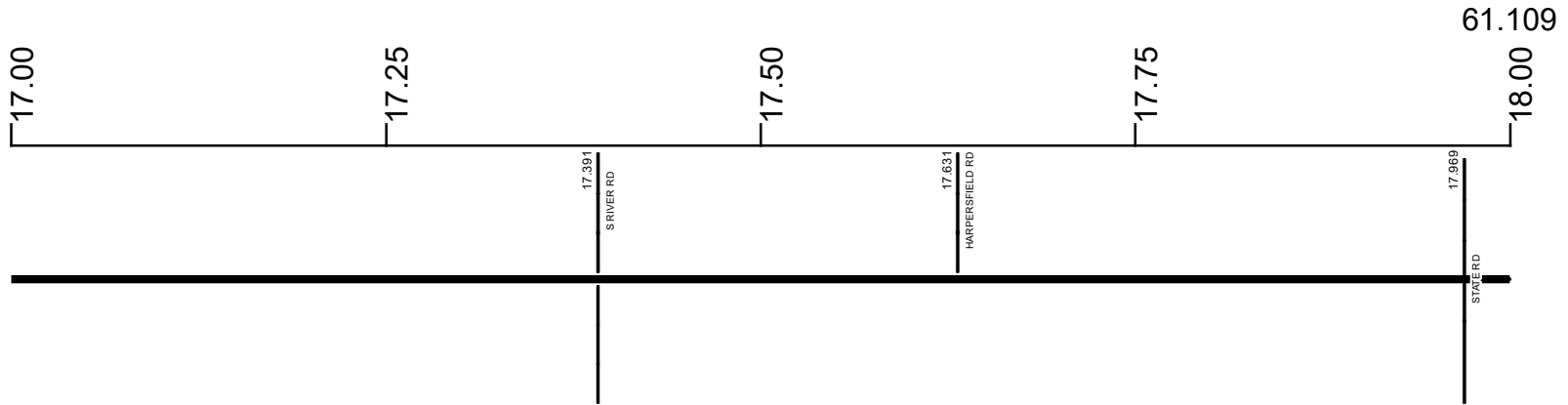

Surface Type & Width (Left / Right)

G (10'/8')
10.649 - 18.497

Base Type (Left / Right)

T / I
10.649 - 18.497

Shoulder Type & Width (Left / Right)

2 (3'/3')
10.649 - 18.497

Resurface Year

2021
17.031 - 18.497

Through Lanes

2
7.759 - 26.122

Street Name

SR 534
16.35 - 20.331

- | | | | |
|---------------------|-------------------|----------------------|--------------|
| Non-divided Highway | Bridge (on route) | Railroad (at grade) | Intersection |
| Divided Highway | Underpass | Railroad (underpass) | |
| Secondary Segment | Overpass | Railroad (overpass) | |
| Corporation | | | |

Created on: 6/24/2025



transportation.ohio.gov
Prepared by
The Ohio Department of Transportation
Office of Technical Services
Roadway Information

SATBSR00534**C

State True Log

62.109

County True Log

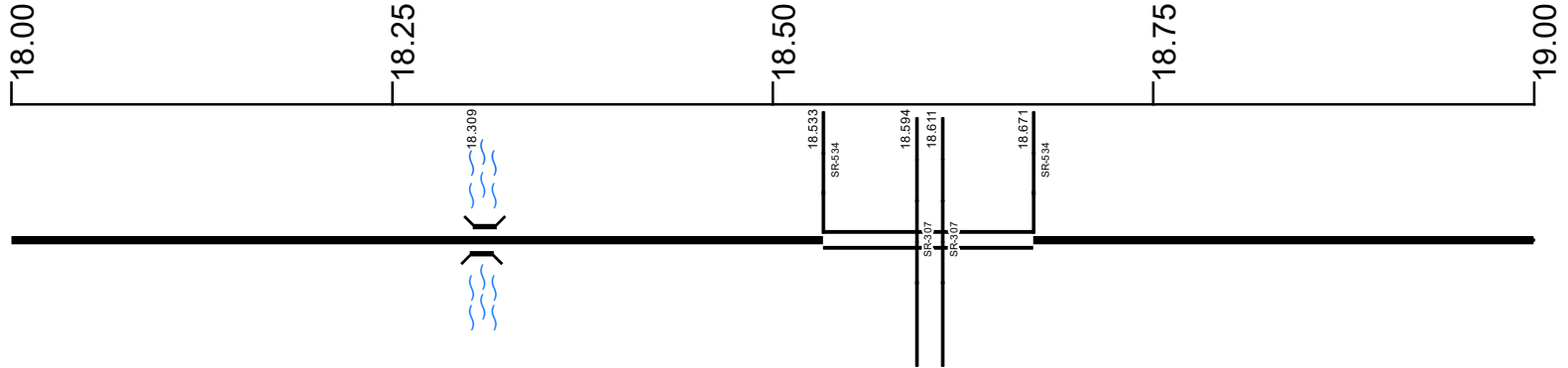

Surface Type & Width (Left / Right)

G (10'/8')	G (12'/11i)	G 32'	G (11'/12i)	G (10'/8')
10.649 - 18.497	18.497 - 18.533	18.533 - 18.671	18.671 - 18.709	18.709 - 19.73

Base Type (Left / Right)

T / I	I	T / I
10.649 - 18.497	18.497 - 18.709	18.709 - 19.922

Shoulder Type & Width (Left / Right)

2 (3'/3')	2 (6'/6')	1 (0'/0')	2 (6'/6i)	2 (3'/3')
10.649 - 18.497	18.497 - 18.533	18.533 - 18.671	18.671 - 18.709	18.709 - 19.73

Median Type and Width

3 (5')	3 (106')	3 (5')
--------	----------	--------

18.533 - 18.594 18.611 - 18.671

Resurface Year

2021	2024	2021
17.031 - 18.497	18.497 - 18.709	18.709 - 19.323

Through Lanes

2
7.759 - 26.122

Street Name

SR 534
16.35 - 20.331

- Non-divided Highway
- Divided Highway
- Secondary Segment
- Corporation
- Bridge (on route)
- Underpass
- Overpass
- Railroad (at grade)
- Railroad (underpass)
- Railroad (overpass)
- Intersection

Created on: 6/24/2025

transportation.ohio.gov

Prepared by
The Ohio Department of Transportation
Office of Technical Services
Roadway Information

SATBSR00534**C

State True Log

63.109

County True Log

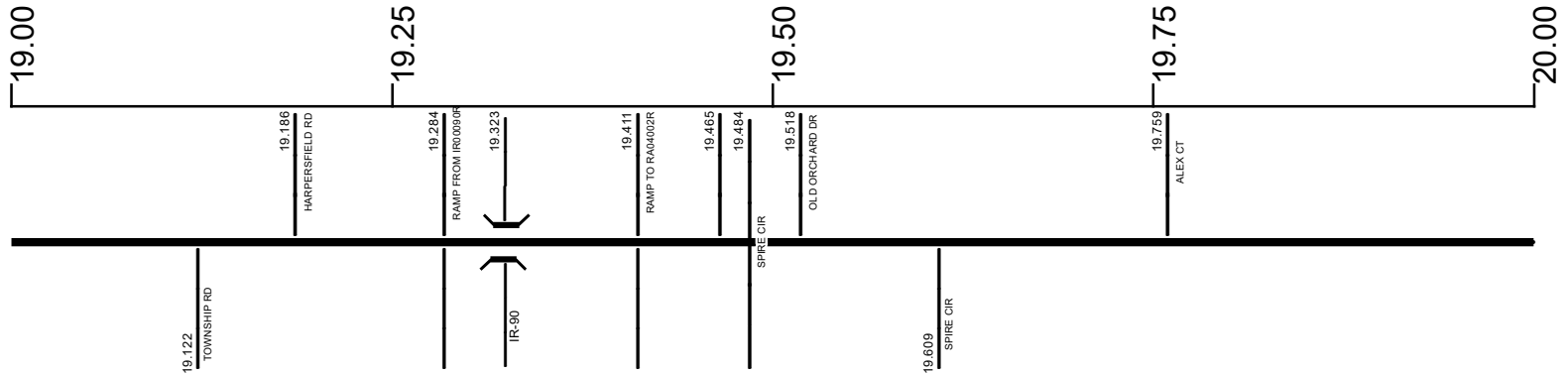

Surface Type & Width (Left / Right)

G (10'8")	G (10'/14")	G 24'
18.709 - 19.73	19.73 - 19.801	19.801 - 20.325

Base Type (Left / Right)

T / I	L
18.709 - 19.922	19.922 - 20.406

Shoulder Type & Width (Left / Right)

2 (3'/3')	2 (6'/6')
18.709 - 19.73	19.73 - 20.658

Resurface Year

2021
18.709 - 19.323

Through Lanes

2
7.759 - 26.122

Street Name

SR 534
16.35 - 20.331

- Non-divided Highway
- Divided Highway
- Secondary Segment
- Corporation
- Bridge (on route)
- Underpass
- Overpass
- Railroad (at grade)
- Railroad (underpass)
- Railroad (overpass)
- Intersection

Created on: 6/24/2025

transportation.ohio.gov

Prepared by
The Ohio Department of Transportation
Office of Technical Services
Roadway Information



INTERCHANGE
IR 90 & SR 534
ASHTABULA COUNTY
INTERCHANGE ID NUMBER = 002200

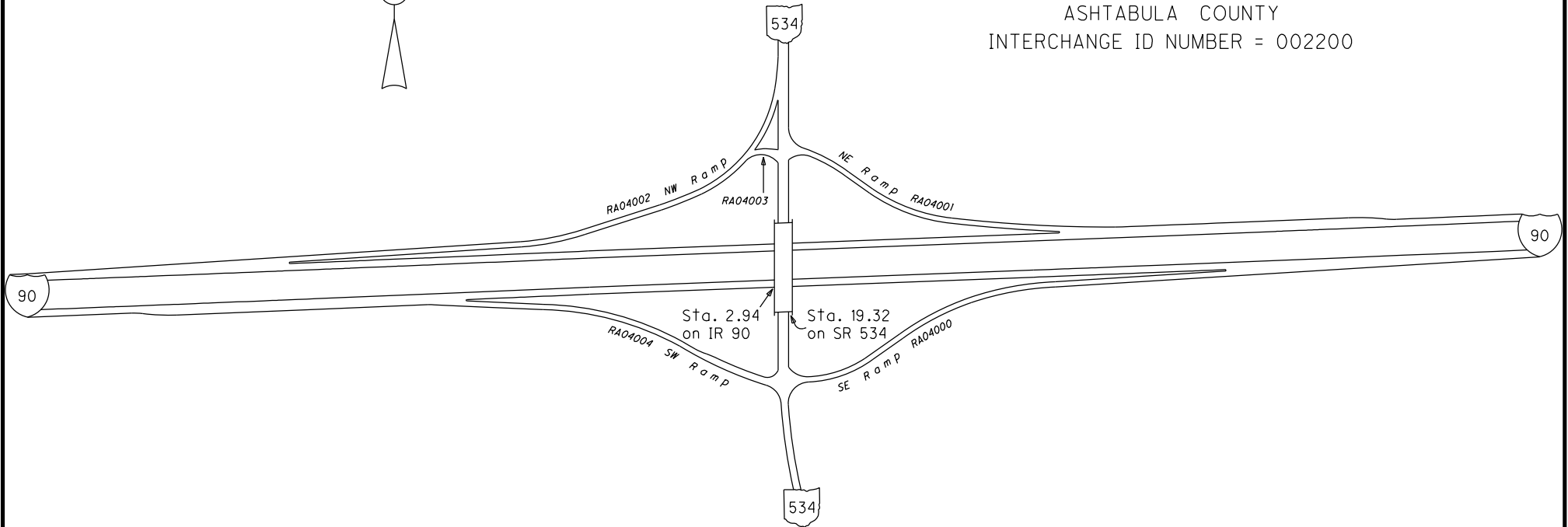

IR 90
SR 534
REVISED Jun 2025

SATBSR00534**C

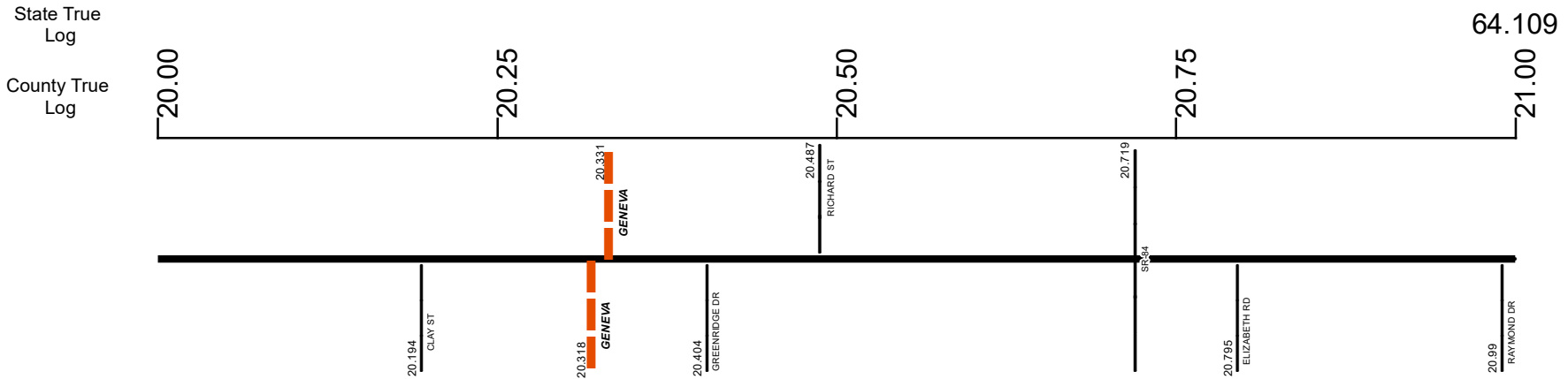

Surface Type & Width (Left / Right)

G 24'	G (10'/14')	G 24'	G 36'	G (10'/26')	G (16'/20')
19.801 - 20.325	20.325 - 20.547	20.547 - 20.658	20.658 - 20.689		20.719 - 21.199

Base Type (Left / Right)

L	T / I	L	T / L
19.922 - 20.406	20.406 - 20.547	20.547 - 20.689	20.689 - 21.199

Shoulder Type & Width (Left / Right)

2 (6'/6')	1 (0'/0')
19.73 - 20.658	20.658 - 22.515

Through Lanes

2
7.759 - 26.122

Street Name

SR 534	SOUTH BROADWAY
16.35 - 20.331	20.331 - 21.826

- Non-divided Highway
- Divided Highway
- Secondary Segment
- Corporation
- Bridge (on route)
- Underpass
- Overpass
- Railroad (at grade)
- Railroad (underpass)
- Railroad (overpass)
- Intersection

Created on: 6/24/2025

transportation.ohio.gov

Prepared by
The Ohio Department of Transportation
Office of Technical Services
Roadway Information

SATBSR00534**C

State True Log
County True Log

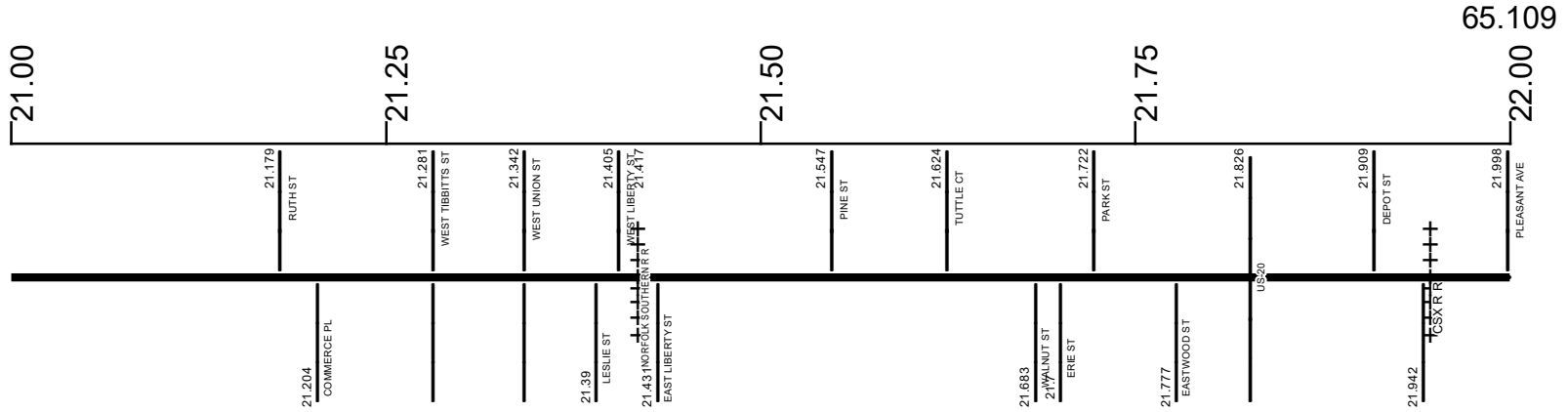

Surface Type & Width (Left / Right)

G (16'20")	G (30'6")	G 30'	G (30'12")	G 48'	G 30'
20.719 - 21.199	21.199 - 21.24	21.24 - 21.658	21.658 - 21.826	21.826 - 21.946	21.946 - 22.195

Base Type (Left / Right)

T / L	N / L	N	T	T / N	T
20.689 - 21.199	21.199 - 21.24	21.24 - 21.417	21.417 - 21.658	21.658 - 21.826	21.826 - 22.195

Shoulder Type & Width (Left / Right)

1 (0'0")
20.658 - 22.515

Resurface Year

2021

21.199 - 21.826

Through Lanes

2

7.759 - 26.122

Street Name

SOUTH BROADWAY	NORTH BROADWAY
20.331 - 21.826	21.826 - 25.696

- Non-divided Highway
- Divided Highway
- Secondary Segment
- Corporation
- Bridge (on route)
- Underpass
- Overpass
- Railroad (at grade)
- Railroad (underpass)
- Railroad (overpass)
- Intersection

Created on: 6/24/2025

transportation.ohio.gov

Prepared by
The Ohio Department of Transportation
Office of Technical Services
Roadway Information

SATBSR00534**C

State True Log
County True Log

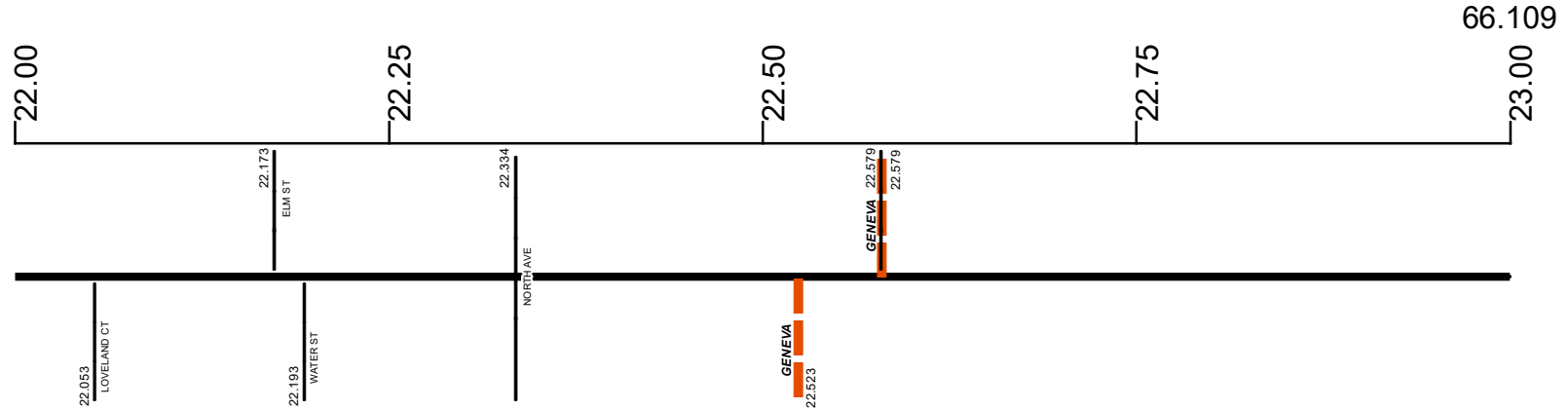

Surface Type & Width (Left / Right)

G 30'	G 24'	G (16'/8')
21.946 - 22.195	22.195 - 22.515	22.515 - 24.15

Base Type (Left / Right)

T	N	N / L
21.826 - 22.195	22.195 - 22.515	22.515 - 23.518

Shoulder Type & Width (Left / Right)

1 (0'/0')	2 (2'/2')
20.658 - 22.515	22.515 - 26.122

Through Lanes

2
7.759 - 26.122

Street Name

NORTH BROADWAY
21.826 - 25.696

- Non-divided Highway
- Divided Highway
- Secondary Segment
- Corporation
- Bridge (on route)
- Underpass
- Overpass
- Railroad (at grade)
- Railroad (underpass)
- Railroad (overpass)
- Intersection

Created on: 6/24/2025

transportation.ohio.gov

Prepared by
The Ohio Department of Transportation
Office of Technical Services
Roadway Information

SATBSR00534**C

State True Log

68.109

County True Log

24.00

24.25

24.50

24.75

25.00

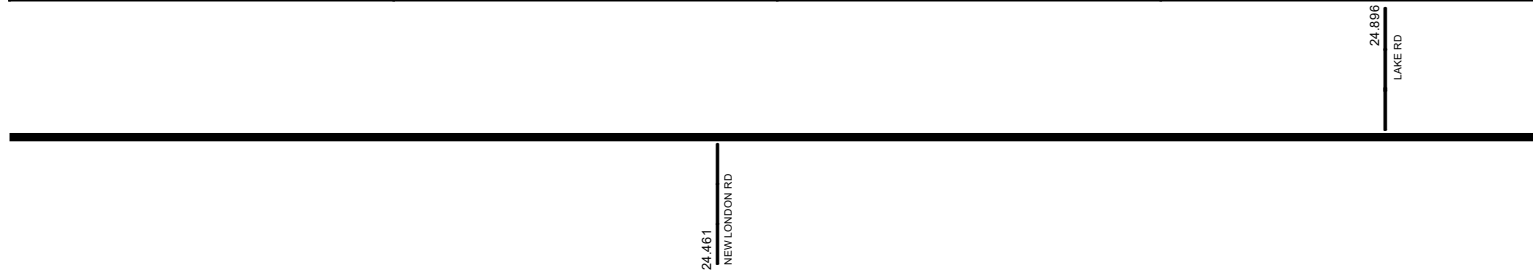

Surface Type & Width (Left / Right)

G (16'/8')	G 24'	G (16'/8')	G 24'
22.515 - 24.15	24.15 - 24.58	24.58 - 24.748	24.748 - 25.384

Base Type (Left / Right)

K / L	I	K / L	I
23.518 - 24.15	24.15 - 24.58	24.58 - 24.748	24.748 - 25.384

Shoulder Type & Width (Left / Right)

2 (2'/2')
22.515 - 26.122

Resurface Year

2022

23.518 - 25.24

Through Lanes

2

7.759 - 26.122

Street Name

NORTH BROADWAY

21.826 - 25.696

- Non-divided Highway
- Divided Highway
- Secondary Segment
- Corporation
- Bridge (on route)
- Underpass
- Overpass
- Railroad (at grade)
- Railroad (underpass)
- Railroad (overpass)
- Intersection

Created on: 6/24/2025

transportation.ohio.gov

Prepared by
The Ohio Department of Transportation
Office of Technical Services
Roadway Information

SATBSR00534**C

State True Log

69.109

County True Log

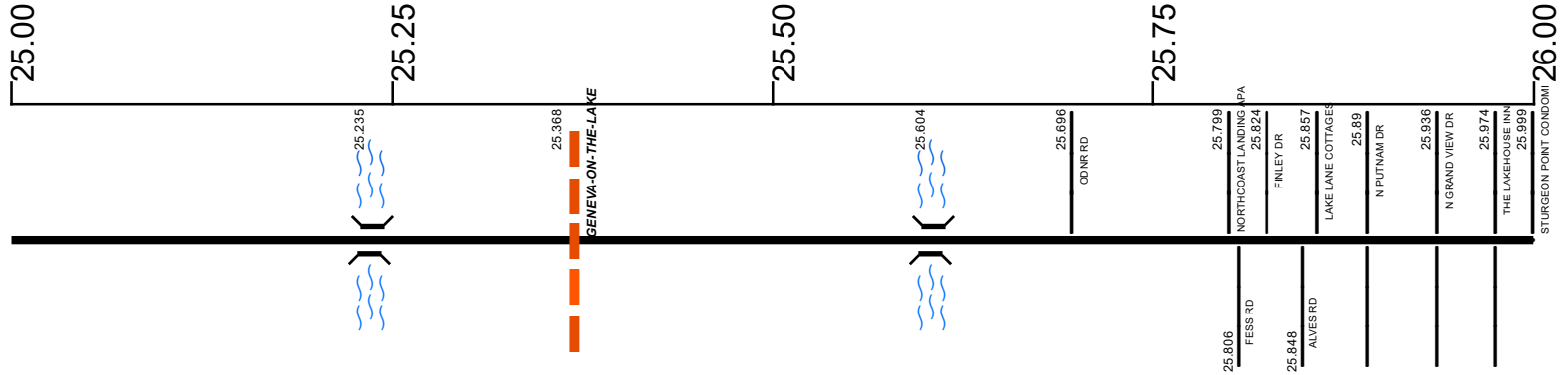

Surface Type & Width (Left / Right)

G 24'	G (16'8")
24.748 - 25.384	25.384 - 26.122

Base Type (Left / Right)

I	K / L
24.748 - 25.384	25.384 - 26.122

Shoulder Type & Width (Left / Right)

2 (2'2")	
22.515 - 26.122	

Resurface Year

2022
23.518 - 25.24

Through Lanes

2
7.759 - 26.122

Street Name

NORTH BROADWAY	LAKE RD
21.826 - 25.696	25.696 - 26.122

- Non-divided Highway
- Divided Highway
- Secondary Segment
- Corporation
- Bridge (on route)
- Underpass
- Overpass
- Railroad (at grade)
- Railroad (underpass)
- Railroad (overpass)
- Intersection

Created on: 6/24/2025



transportation.ohio.gov

Prepared by
The Ohio Department of Transportation
Office of Technical Services
Roadway Information

SATBSR00534**C

State True Log

69.231

County True Log



Surface Type & Width (Left / Right)

G (16'8")
25.384 - 26.122

Base Type (Left / Right)

K / L
25.384 - 26.122

Shoulder Type & Width (Left / Right)

2 (2'2")
22.515 - 26.122

Through Lanes

2
7.759 - 26.122

Street Name

LAKE RD
25.696 - 26.122

- | | | | |
|---------------------|-------------------|----------------------|--------------|
| Non-divided Highway | Bridge (on route) | Railroad (at grade) | Intersection |
| Divided Highway | Underpass | Railroad (underpass) | |
| Secondary Segment | Overpass | Railroad (overpass) | |
| Corporation | | | |

Created on: 6/24/2025



transportation.ohio.gov
 Prepared by
 The Ohio Department of Transportation
 Office of Technical Services
 Roadway Information

Historical Project List for SATBSR00534**C

Begin Measure	End Measure	Project ID Number	Construction Completion Date	Treatment Category	Treatment Type
0.000	7.676	100793	8-2019	Preventive Maintenance	25-Chip Seal
0.000	7.666	81571	7-2009	Minor Rehabilitation	60-AC Overlay w/Rpr
7.759	12.096	100793	8-2019	Preventive Maintenance	25-Chip Seal
7.759	13.496	84607	9-2013	Minor Rehabilitation	60-AC Overlay w/Rpr
12.206	12.535	19833	9-2003	Minor Rehabilitation	60-AC Overlay w/Rpr
13.396	15.348	19833	9-2003	Minor Rehabilitation	60-AC Overlay w/Rpr
13.576	19.725	86943	10-2015	Minor Rehabilitation	60-AC Overlay w/Rpr
16.420	19.201	19833	9-2003	Minor Rehabilitation	60-AC Overlay w/Rpr
17.031	19.318	101411	11-2021	Minor Rehabilitation	38-Fine Poly AC Overlay
19.725	20.330	99622	11-2017	Minor Rehabilitation	60-AC Overlay w/Rpr
19.725	20.623	19833	9-2003	Minor Rehabilitation	60-AC Overlay w/Rpr
21.194	21.821	101411	11-2021	Minor Rehabilitation	60-AC Overlay w/Rpr
21.295	22.572	19833	9-2003	Minor Rehabilitation	60-AC Overlay w/Rpr
22.182	22.501	84607	9-2013	Minor Rehabilitation	60-AC Overlay w/Rpr
22.501	25.220	84607	9-2013	Minor Rehabilitation	60-AC Overlay w/Rpr
23.513	25.230	109580	9-2022	Preventive Maintenance	25-Chip Seal
25.230	26.117	94112	7-2020	Minor Rehabilitation	60-AC Overlay w/Rpr

Roadway Codes

Access Control Journalized

- F - Full Access Control
- L - Limited Access Control
- N - No Access Control

Access Control Operational

- 1 - Full Access Control
- 2 - Partial Access Control
- 3 - No Access Control

Base Type

- F - Crack and Seat
- H - Rubblize and Roll
- I - Aggregate Base 304 or Traffic Compacted
- K - Water Bound Macadam
- L - Bituminous Concrete Mix or Penetration Macadam
- N - Plain Concrete
- P - Reinforced Concrete
- R - Brick (Flexible)
- T - Brick (Rigid)

Direction of Travel

- B - Both (Two-way)
- F - One-way Cardinal
- T - One-way Non-cardinal

Facility Type

- 1 - One-way Roadway
- 2 - Two-way Roadway
- 4 - Ramp
- 5 - Non-mainline
- 6 - Non-inventory Direction
- 7 - Planned / Unbuilt

Historical Federal Aid Indicator

- N - Not a FAP Route
- Y - FAP Route

Functional Classification

- 01 - Interstate
- 02 - Principal Arterial (Freeways)
- 03 - Principal Arterial (Other)
- 04 - Minor Arterial
- 05 - Major Collector
- 06 - Minor Collector
- 07 - Local

Leave / Reenter Indicator

- Y - Route leaves/reenters at this point
- N - Route does not leave/reenter at this point

Median Type

- 1 - None
- 2 - Unprotected
- 3 - Curbed
- 4 - Positive Barrier (Unspecified)
- 5 - Positive Barrier (Flexible)
- 6 - Positive Barrier (Semi-rigid)
- 7 - Positive Barrier (Rigid)

NHS

- N - National Highway System
- H - Congressional Corridor
- 2 - Major Airport
- 3 - Major Port Facility
- 4 - Major Amtrak Station
- 5 - Major Rail / Truck Terminal
- 6 - Major Intercity Bus Terminal
- 7 - Major Public Transit / Multi-modal Passenger Terminal
- 8 - Major Pipeline Terminal
- 9 - Major Ferry Terminal

Priority System

- G - General
- P - Priority System
- U - Urban

Scenic Byway Code

- A - All American Road
- N - National Scenic Byway
- S - State Scenic Byway

Shoulder Type

- 1 - None
- 2 - Surfaced shoulder exists (bituminous concrete {AC})
- 3 - Surfaced shoulder exists (Portland Cement Concrete {PCC})
- 4 - Stabilized shoulder exists (gravel or other granular material)
- 5 - Combination shoulder exists (two or more surface types)
- 6 - Earth shoulder exists
- 7 - Barrier curb exists; no shoulder in front of curb

Surface Type

- A - Combination
- B - Brick
- C - Continuous Reinforced Concrete
- D - Reinforced Concrete
- E - Plain Concrete
- G - Bituminous Concrete
- I - Chipseal on Granular
- K - Open Graded Bituminous
- L - Chipseal or Micro
- M - Gravel
- U - Unimproved
- X - Right of Way Only