

SATHSR00685**C

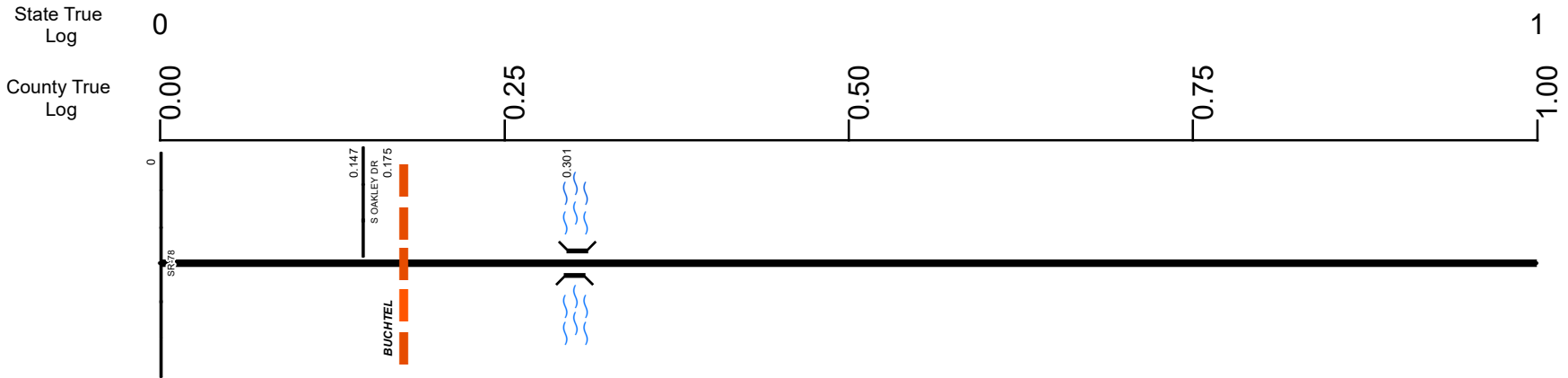

Surface Type & Width (Left / Right)	
G (16'4") 0 - 0.301	G 18' 0.301 - 4.538
Base Type (Left / Right)	
K / I 0 - 0.301	I 0.301 - 4.538
Shoulder Type & Width (Left / Right)	
2 (6'6") 0 - 0.301	2 (3'3") 0.301 - 4.538
Through Lanes	
2 0 - 5.199	
Street Name	
SR 685 0 - 5.199	

Non-divided Highway	Bridge (on route)	Railroad (at grade)	Intersection
Divided Highway	Underpass	Railroad (underpass)	
Secondary Segment	Overpass	Railroad (overpass)	
Corporation			

Created on: 6/24/2025

transportation.ohio.gov

Prepared by
The Ohio Department of Transportation
Office of Technical Services
Roadway Information

SATHSR00685**C

State True Log

County True Log

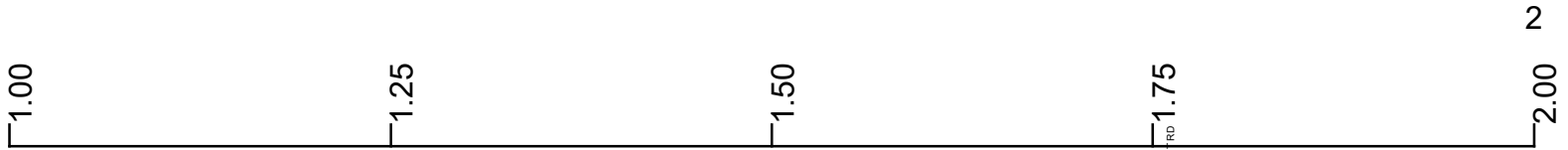

Surface Type & Width (Left / Right)	G 18'
	0.301 - 4.538
Base Type (Left / Right)	I
	0.301 - 4.538
Shoulder Type & Width (Left / Right)	2 (3/3')
	0.301 - 4.538
Through Lanes	2
	0 - 5.199
Street Name	SR 685
	0 - 5.199

Non-divided Highway	Bridge (on route)	Railroad (at grade)	Intersection
Divided Highway	Underpass	Railroad (underpass)	
Secondary Segment	Overpass	Railroad (overpass)	
Corporation			

Created on: 6/24/2025

transportation.ohio.gov
 Prepared by
 The Ohio Department of Transportation
 Office of Technical Services
 Roadway Information

SATHSR00685**C

State True Log

County True Log

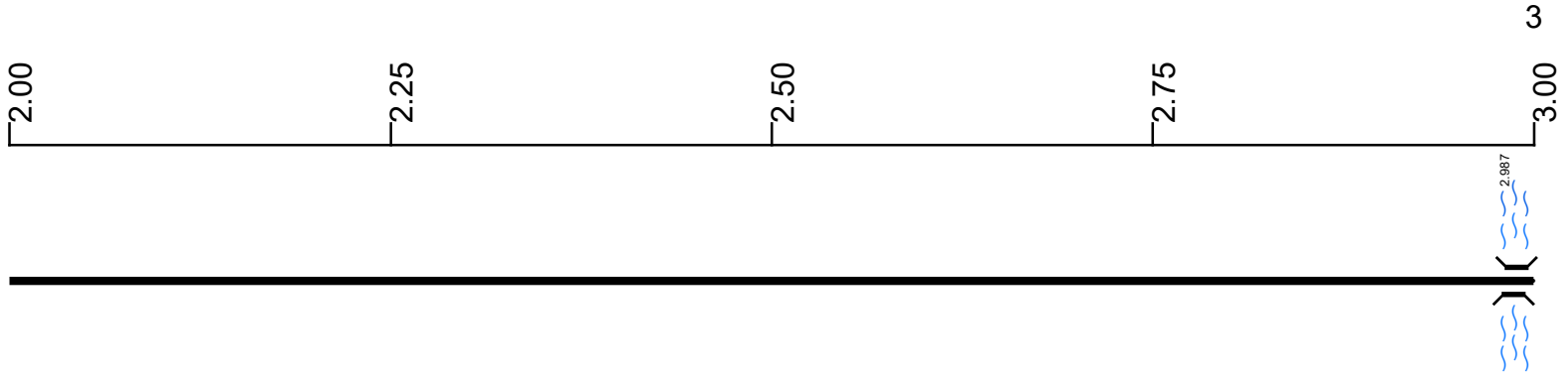

Surface Type & Width (Left / Right)

	G 18'
	0.301 - 4.538

Base Type (Left / Right)

	I
	0.301 - 4.538

Shoulder Type & Width (Left / Right)

	2 (3/3')
	0.301 - 4.538

Through Lanes

	2
	0 - 5.199

Street Name

	SR 685
	0 - 5.199

- | | | | |
|---------------------|-------------------|----------------------|--------------|
| Non-divided Highway | Bridge (on route) | Railroad (at grade) | Intersection |
| Divided Highway | Underpass | Railroad (underpass) | |
| Secondary Segment | Overpass | Railroad (overpass) | |
| Corporation | | | |

Created on: 6/24/2025

transportation.ohio.gov

Prepared by
The Ohio Department of Transportation
Office of Technical Services
Roadway Information

SATHSR00685**C

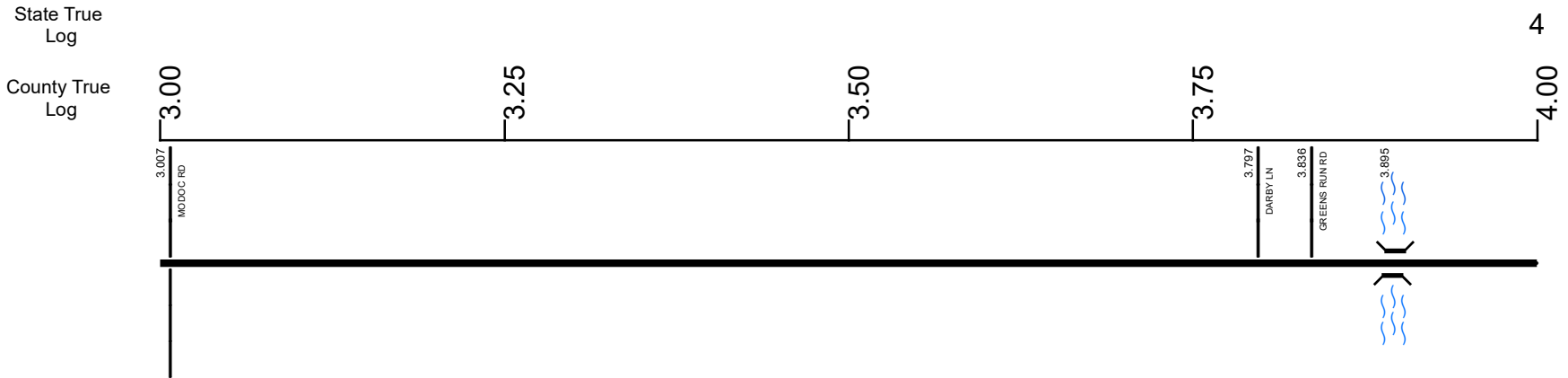

Surface Type & Width (Left / Right)	G 18'
	0.301 - 4.538
Base Type (Left / Right)	I
	0.301 - 4.538
Shoulder Type & Width (Left / Right)	2 (3/3')
	0.301 - 4.538
Through Lanes	2
	0 - 5.199
Street Name	SR 685
	0 - 5.199

Non-divided Highway	Bridge (on route)	Railroad (at grade)	Intersection
Divided Highway	Underpass	Railroad (underpass)	
Secondary Segment	Overpass	Railroad (overpass)	
Corporation			

Created on: 6/24/2025



transportation.ohio.gov

Prepared by
The Ohio Department of Transportation
Office of Technical Services
Roadway Information

SATHSR00685**C

State True Log

County True Log

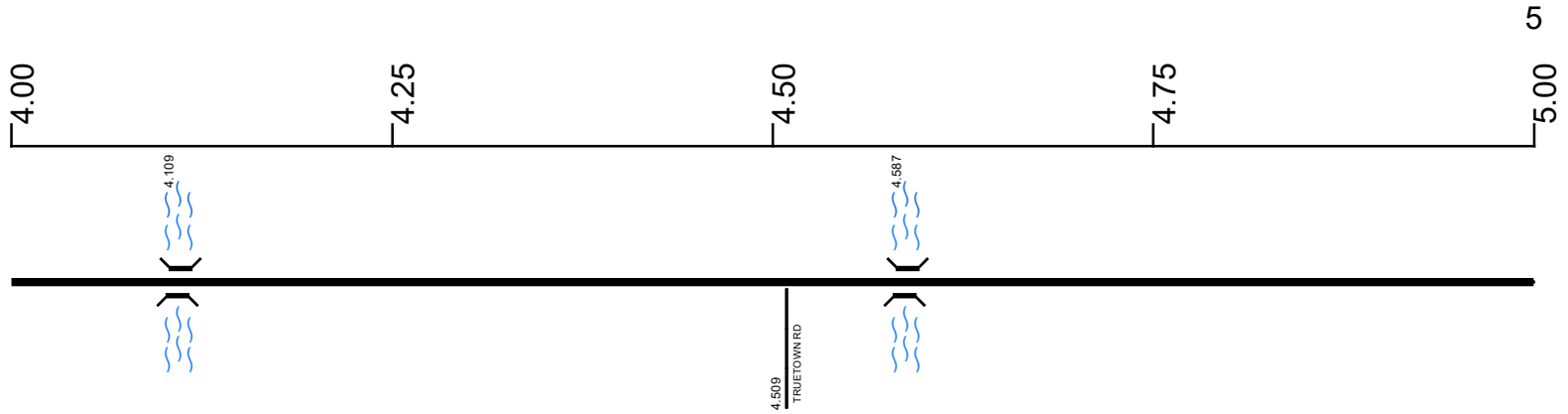

Surface Type & Width (Left / Right)

G 18'	G 20'
0.301 - 4.538	4.538 - 5.199

Base Type (Left / Right)

I	L
0.301 - 4.538	4.538 - 5.199

Shoulder Type & Width (Left / Right)

2 (3'/3')	2 (4'/4')
0.301 - 4.538	4.538 - 5.199

Through Lanes

2	
0 - 5.199	

Street Name

	SR 685
	0 - 5.199

- | | | | |
|---------------------|-------------------|----------------------|--------------|
| Non-divided Highway | Bridge (on route) | Railroad (at grade) | Intersection |
| Divided Highway | Underpass | Railroad (underpass) | |
| Secondary Segment | Overpass | Railroad (overpass) | |
| Corporation | | | |

Created on: 6/24/2025

transportation.ohio.gov

Prepared by
The Ohio Department of Transportation
Office of Technical Services
Roadway Information

SATHSR00685**C

State True Log

5.199

County True Log

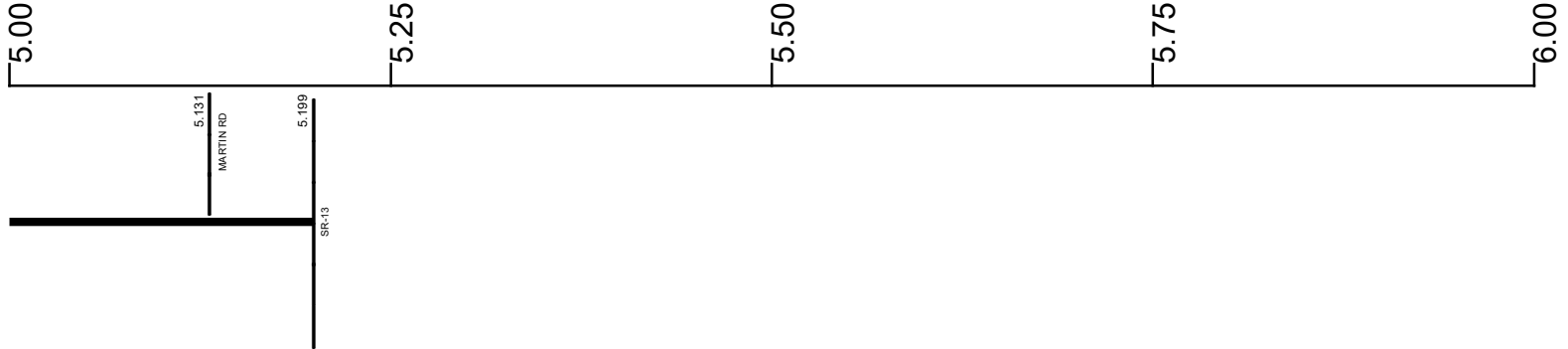

Surface Type & Width (Left / Right)

G 20'
4.538 - 5.199

Base Type (Left / Right)

L
4.538 - 5.199

Shoulder Type & Width (Left / Right)

2 (4'4")
4.538 - 5.199

Through Lanes

2
0 - 5.199

Street Name

SR 685
0 - 5.199

- Non-divided Highway
- Divided Highway
- Secondary Segment
- Corporation
- Bridge (on route)
- Underpass
- Overpass
- Railroad (at grade)
- Railroad (underpass)
- Railroad (overpass)
- Intersection

Created on: 6/24/2025



transportation.ohio.gov
Prepared by
The Ohio Department of Transportation
Office of Technical Services
Roadway Information

Historical Project List for SATHSR00685**C

Begin Measure	End Measure	Project ID Number	Construction Completion Date	Treatment Category	Treatment Type
0.000	5.199	91732	9-2020	Preventive Maintenance	25-Chip Seal
0.000	5.199	87274	6-2012	Minor Rehabilitation	50-AC Overlay w/o Rpr

Roadway Codes

Access Control Journalized

- F - Full Access Control
- L - Limited Access Control
- N - No Access Control

Access Control Operational

- 1 - Full Access Control
- 2 - Partial Access Control
- 3 - No Access Control

Base Type

- F - Crack and Seat
- H - Rubblize and Roll
- I - Aggregate Base 304 or Traffic Compacted
- K - Water Bound Macadam
- L - Bituminous Concrete Mix or Penetration Macadam
- N - Plain Concrete
- P - Reinforced Concrete
- R - Brick (Flexible)
- T - Brick (Rigid)

Direction of Travel

- B - Both (Two-way)
- F - One-way Cardinal
- T - One-way Non-cardinal

Facility Type

- 1 - One-way Roadway
- 2 - Two-way Roadway
- 4 - Ramp
- 5 - Non-mainline
- 6 - Non-inventory Direction
- 7 - Planned / Unbuilt

Historical Federal Aid Indicator

- N - Not a FAP Route
- Y - FAP Route

Functional Classification

- 01 - Interstate
- 02 - Principal Arterial (Freeways)
- 03 - Principal Arterial (Other)
- 04 - Minor Arterial
- 05 - Major Collector
- 06 - Minor Collector
- 07 - Local

Leave / Reenter Indicator

- Y - Route leaves/reenters at this point
- N - Route does not leave/reenter at this point

Median Type

- 1 - None
- 2 - Unprotected
- 3 - Curbed
- 4 - Positive Barrier (Unspecified)
- 5 - Positive Barrier (Flexible)
- 6 - Positive Barrier (Semi-rigid)
- 7 - Positive Barrier (Rigid)

NHS

- N - National Highway System
- H - Congressional Corridor
- 2 - Major Airport
- 3 - Major Port Facility
- 4 - Major Amtrak Station
- 5 - Major Rail / Truck Terminal
- 6 - Major Intercity Bus Terminal
- 7 - Major Public Transit / Multi-modal Passenger Terminal
- 8 - Major Pipeline Terminal
- 9 - Major Ferry Terminal

Priority System

- G - General
- P - Priority System
- U - Urban

Scenic Byway Code

- A - All American Road
- N - National Scenic Byway
- S - State Scenic Byway

Shoulder Type

- 1 - None
- 2 - Surfaced shoulder exists (bituminous concrete {AC})
- 3 - Surfaced shoulder exists (Portland Cement Concrete {PCC})
- 4 - Stabilized shoulder exists (gravel or other granular material)
- 5 - Combination shoulder exists (two or more surface types)
- 6 - Earth shoulder exists
- 7 - Barrier curb exists; no shoulder in front of curb

Surface Type

- A - Combination
- B - Brick
- C - Continuous Reinforced Concrete
- D - Reinforced Concrete
- E - Plain Concrete
- G - Bituminous Concrete
- I - Chipseal on Granular
- K - Open Graded Bituminous
- L - Chipseal or Micro
- M - Gravel
- U - Unimproved
- X - Right of Way Only