

SAUGSR00198**C



Begin overlap w/
SAUGSR00067**C @ .

- | | | | |
|---------------------|-------------------|----------------------|--------------|
| Non-divided Highway | Bridge (on route) | Railroad (at grade) | Intersection |
| Divided Highway | Underpass | Railroad (underpass) | |
| Secondary Segment | Overpass | Railroad (overpass) | |
| Corporation | | | |

Created on: 6/24/2025



transportation.ohio.gov
 Prepared by
 The Ohio Department of Transportation
 Office of Technical Services
 Roadway Information

SAUGSR00198**C

State True Log

County True Log

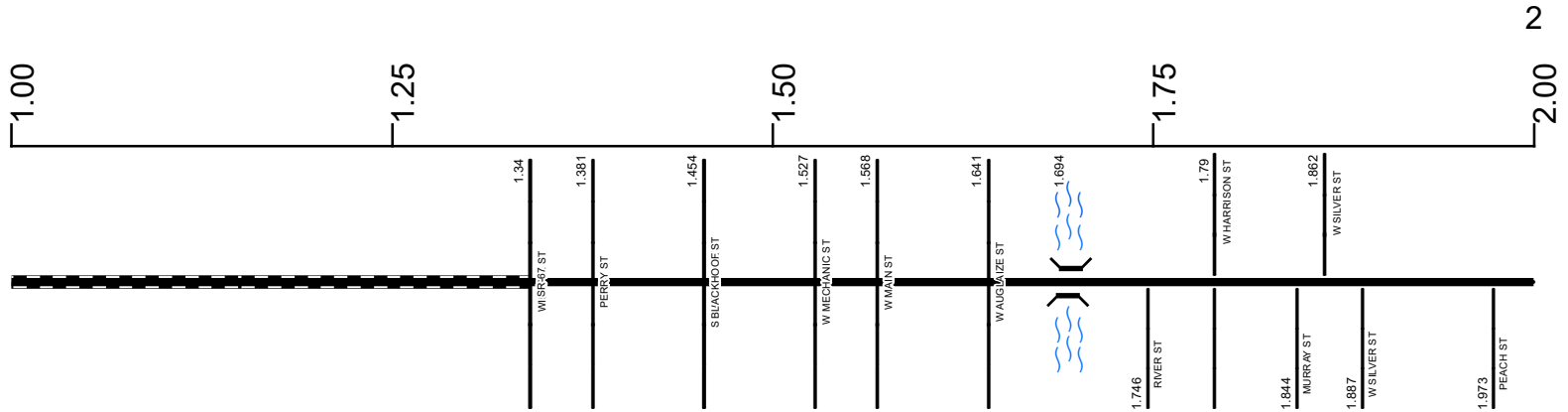

Surface Type & Width (Left / Right)

G 38'	G (24'/25')	G 34'
1.34 - 1.641	1.641 - 1.833	1.833 - 2.015

Base Type (Left / Right)

T	L	I
1.34 - 1.641	1.641 - 1.833	1.833 - 11.156

Shoulder Type & Width (Left / Right)

1 (0'/0')
1.34 - 2.349

Through Lanes

2
1.34 - 11.156

Street Name

W PEARL ST	S BLACKHOOF ST	N BLACKHOOF ST	DEFIANCE ST
1.34 - 1.454	1.454 - 1.641	1.641 - 1.746	1.746 - 2.827

- Non-divided Highway
- Divided Highway
- Secondary Segment
- Corporation
- Bridge (on route)
- Underpass
- Overpass
- Railroad (at grade)
- Railroad (underpass)
- Railroad (overpass)
- Intersection

Created on: 6/24/2025

transportation.ohio.gov

Prepared by
The Ohio Department of Transportation
Office of Technical Services
Roadway Information

SAUGSR00198**C

State True Log

County True Log

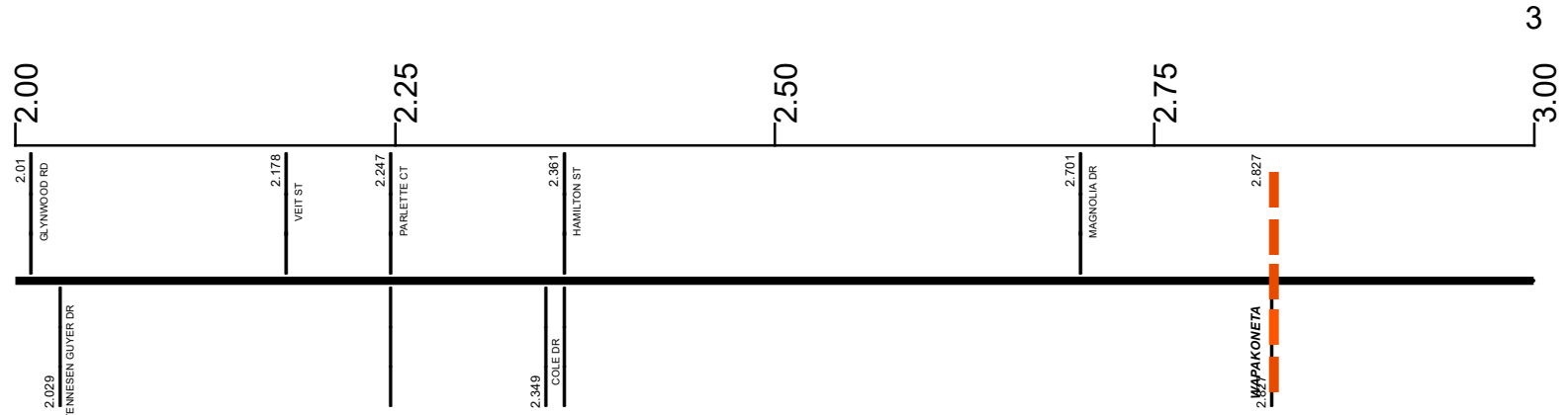

Surface Type & Width (Left / Right)			
G 34' (2.015 - 2.349)	G 24' (2.349 - 8.365)		
Base Type (Left / Right)			
I (1.833 - 11.156)			
Shoulder Type & Width (Left / Right)			
1 (0'/0') (1.34 - 2.349)	2 (6'/6') (2.349 - 2.75)	2 (4'/4') (2.75 - 8.365)	
Resurface Year			
<table border="1" style="margin-left: auto; margin-right: auto;"> <tr> <td style="width: 50%;">2020 (2.67 - 2.827)</td> <td style="width: 50%;">2024 (2.827 - 5.001)</td> </tr> </table>		2020 (2.67 - 2.827)	2024 (2.827 - 5.001)
2020 (2.67 - 2.827)	2024 (2.827 - 5.001)		
Through Lanes			
2 (1.34 - 11.156)			
Street Name			
DEFIANCE ST (1.746 - 2.827)	SR 198 (2.827 - 11.156)		

<ul style="list-style-type: none"> Non-divided Highway Divided Highway Secondary Segment Corporation 	<ul style="list-style-type: none"> Bridge (on route) Underpass Overpass 	<ul style="list-style-type: none"> Railroad (at grade) Railroad (underpass) Railroad (overpass) 	<ul style="list-style-type: none"> Intersection
--	---	---	---

Created on: 6/24/2025

transportation.ohio.gov

Prepared by
The Ohio Department of Transportation
Office of Technical Services
Roadway Information

SAUGSR00198**C

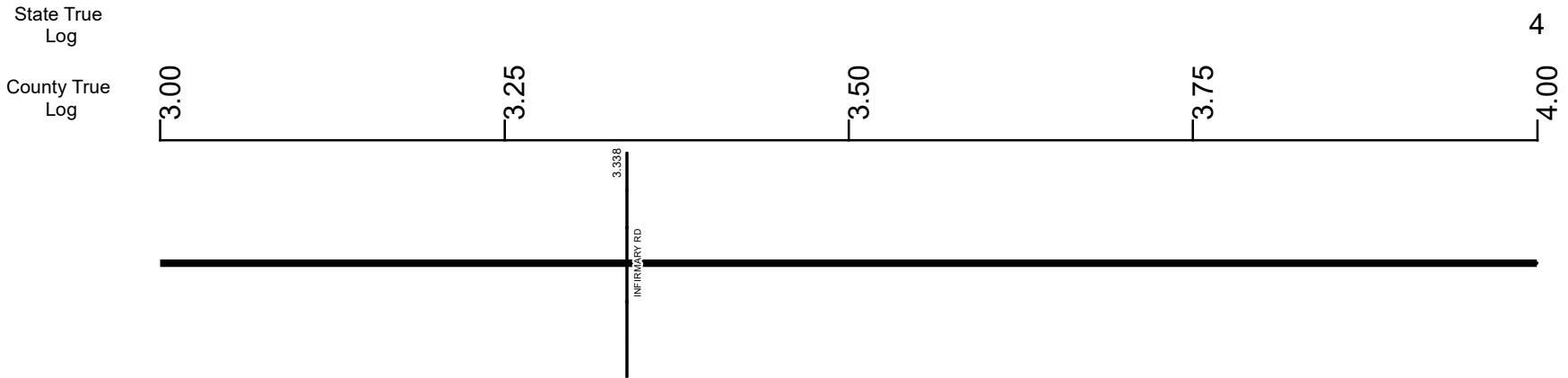

Surface Type & Width (Left / Right)	G 24'
	2.349 - 8.365
Base Type (Left / Right)	I
	1.833 - 11.156
Shoulder Type & Width (Left / Right)	2 (4/4')
	2.75 - 8.365
Resurface Year	2024
	2.827 - 5.001
Through Lanes	2
	1.34 - 11.156
Street Name	SR 198
	2.827 - 11.156

- Non-divided Highway
- Divided Highway
- Secondary Segment
- Corporation
- Bridge (on route)
- Underpass
- Overpass
- Railroad (at grade)
- Railroad (underpass)
- Railroad (overpass)
- Intersection

Created on: 6/24/2025



transportation.ohio.gov
 Prepared by
 The Ohio Department of Transportation
 Office of Technical Services
 Roadway Information

SAUGSR00198**C

State True Log

5

County True Log

4.00

4.25

4.50

4.75

5.00



Surface Type & Width (Left / Right)

G 24'
2.349 - 8.365

Base Type (Left / Right)

I
1.833 - 11.156

Shoulder Type & Width (Left / Right)

2 (4/4')
2.75 - 8.365

Resurface Year

2024
2.827 - 5.001

Through Lanes

2
1.34 - 11.156

Street Name

SR 198
2.827 - 11.156

- Non-divided Highway
 Bridge (on route)
 Railroad (at grade)
 Intersection
- Divided Highway
 Underpass
 Railroad (underpass)
- Secondary Segment
 Overpass
 Railroad (overpass)
- Corporation**

Created on: 6/24/2025



transportation.ohio.gov

Prepared by
The Ohio Department of Transportation
Office of Technical Services
Roadway Information

SAUGSR00198**C

State True Log

6

County True Log

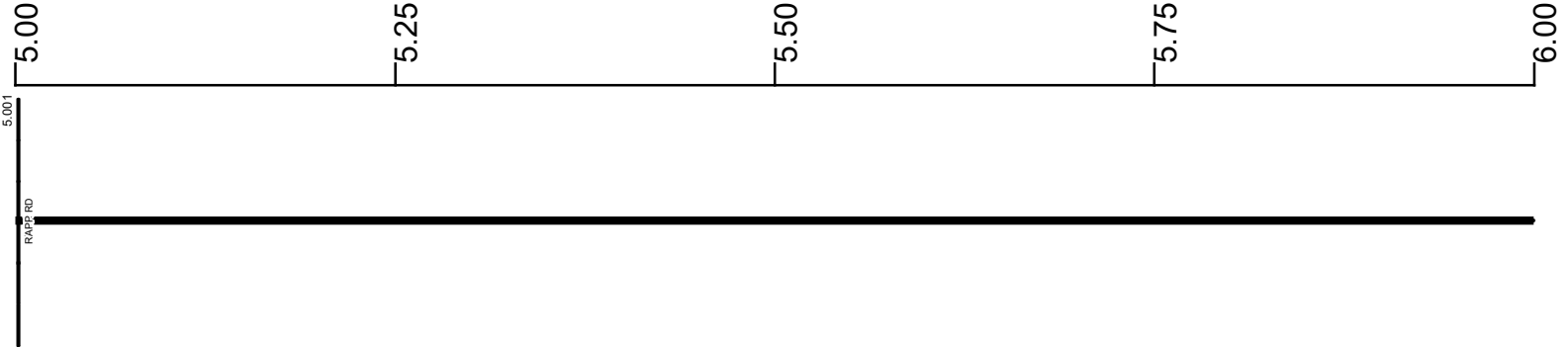

Surface Type & Width (Left / Right)

	G 24'
	2.349 - 8.365

Base Type (Left / Right)

	I
	1.833 - 11.156

Shoulder Type & Width (Left / Right)

	2 (4/4')
	2.75 - 8.365

Resurface Year

2024	2020
------	------

2.827 - 5.001
Through Lanes

	2
	1.34 - 11.156

Street Name

	SR 198
	2.827 - 11.156

- Non-divided Highway
- Divided Highway
- Secondary Segment
- Corporation
- Bridge (on route)
- Underpass
- Overpass
- Railroad (at grade)
- Railroad (underpass)
- Railroad (overpass)
- Intersection

Created on: 6/24/2025

transportation.ohio.gov

Prepared by
The Ohio Department of Transportation
Office of Technical Services
Roadway Information

SAUGSR00198**C

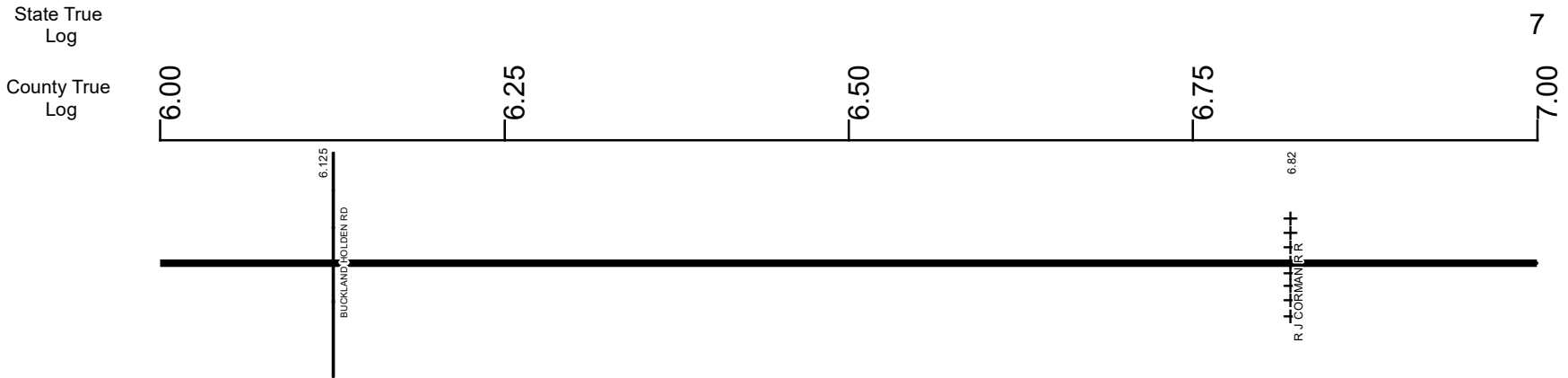

Surface Type & Width (Left / Right)	G 24'
	2.349 - 8.365
Base Type (Left / Right)	I
	1.833 - 11.156
Shoulder Type & Width (Left / Right)	2 (4/4')
	2.75 - 8.365
Resurface Year	2020
Through Lanes	5.001 - 7.9
	2
Street Name	1.34 - 11.156
	SR 198
	2.827 - 11.156

Non-divided Highway	Bridge (on route)	Railroad (at grade)	Intersection
Divided Highway	Underpass	Railroad (underpass)	
Secondary Segment	Overpass	Railroad (overpass)	
Corporation			

Created on: 6/24/2025



transportation.ohio.gov

Prepared by
The Ohio Department of Transportation
Office of Technical Services
Roadway Information

SAUGSR00198**C

State True Log

County True Log

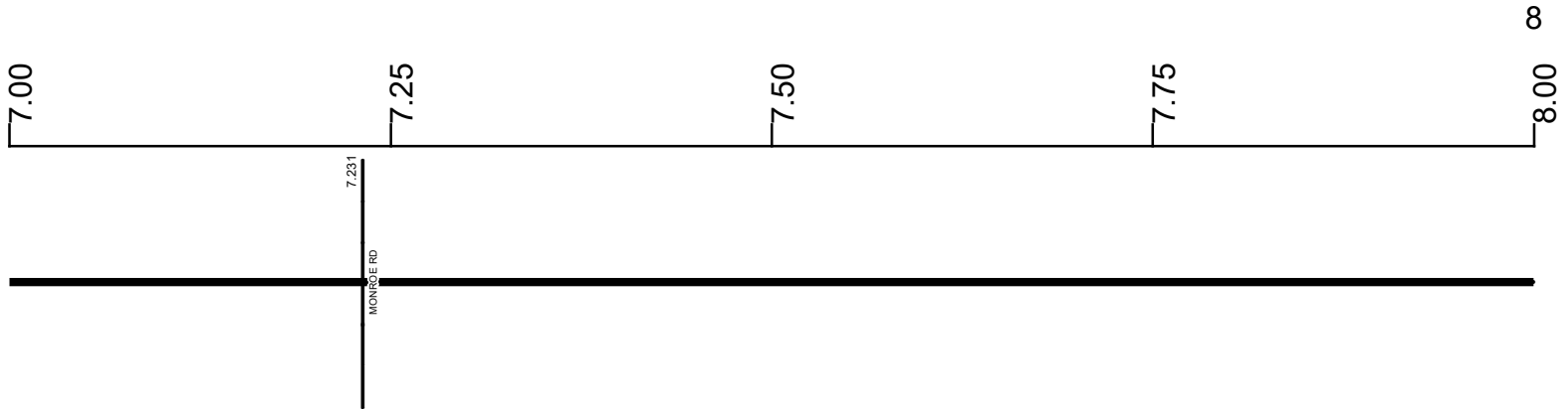

Surface Type & Width (Left / Right)

	G 24'
	2.349 - 8.365

Base Type (Left / Right)

	I
	1.833 - 11.156

Shoulder Type & Width (Left / Right)

	2 (4/4')
	2.75 - 8.365

Resurface Year

	2020
	5.001 - 7.9

Through Lanes

	2
	1.34 - 11.156

Street Name

	SR 198
	2.827 - 11.156

- | | | | |
|--|---|---|---|
| <ul style="list-style-type: none"> Non-divided Highway Divided Highway Secondary Segment Corporation | <ul style="list-style-type: none"> Bridge (on route) Underpass Overpass | <ul style="list-style-type: none"> Railroad (at grade) Railroad (underpass) Railroad (overpass) | <ul style="list-style-type: none"> Intersection |
|--|---|---|---|

Created on: 6/24/2025

transportation.ohio.gov

Prepared by
The Ohio Department of Transportation
Office of Technical Services
Roadway Information

SAUGSR00198**C

State True Log

County True Log

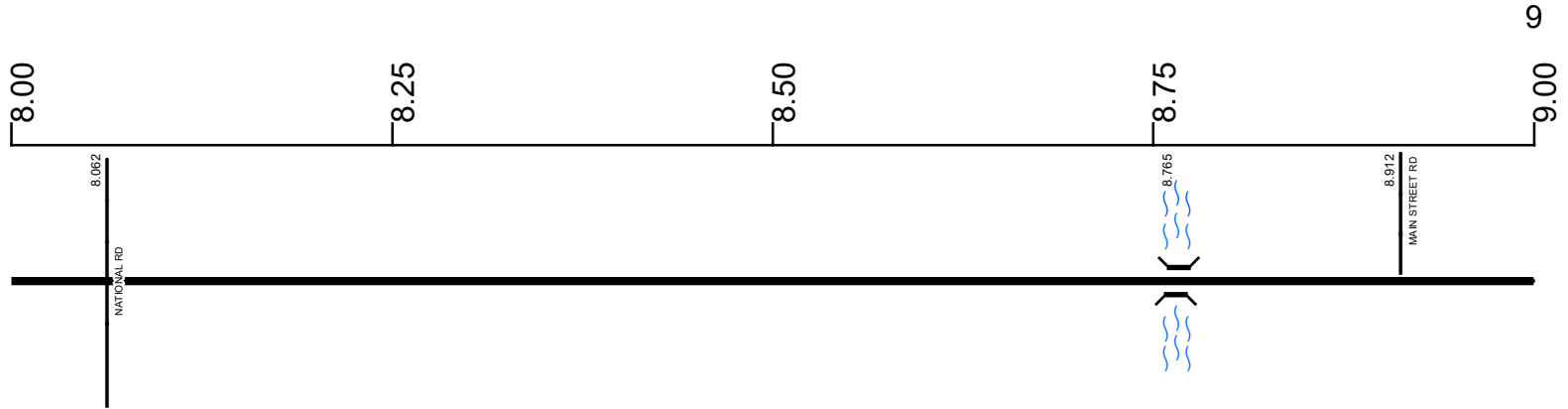

Surface Type & Width (Left / Right)

G 24'	G 20'
2.349 - 8.365	8.365 - 11.156

Base Type (Left / Right)

I
1.833 - 11.156

Shoulder Type & Width (Left / Right)

2 (4'/4')	2 (8'/8')
2.75 - 8.365	8.365 - 11.156

Through Lanes

2
1.34 - 11.156

Street Name

SR 198
2.827 - 11.156

- Non-divided Highway
- Divided Highway
- Secondary Segment
- Corporation
- Bridge (on route)
- Underpass
- Overpass
- Railroad (at grade)
- Railroad (underpass)
- Railroad (overpass)
- Intersection

Created on: 6/24/2025

transportation.ohio.gov

Prepared by
The Ohio Department of Transportation
Office of Technical Services
Roadway Information

SAUGSR00198**C

State True Log

10

County True Log

9.00

9.25

9.50

9.75

10.00

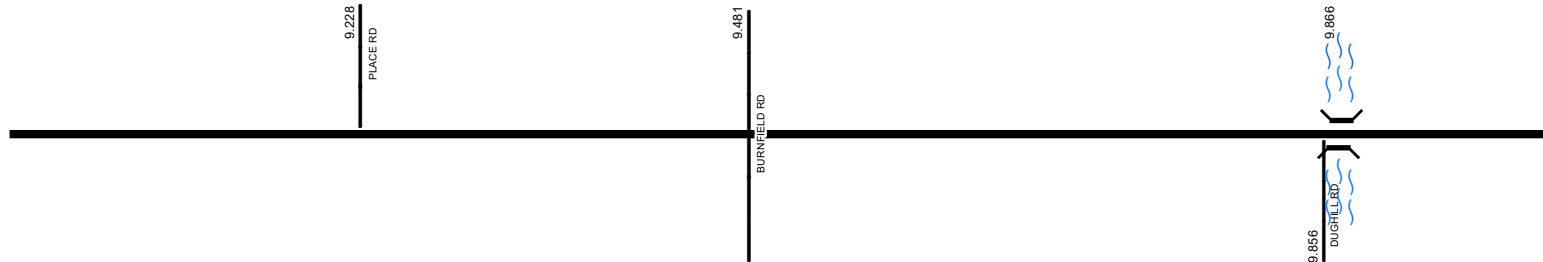

Surface Type & Width (Left / Right)

G 20'
8.365 - 11.156

Base Type (Left / Right)

I
1.833 - 11.156

Shoulder Type & Width (Left / Right)

2 (8/8)
8.365 - 11.156

Through Lanes

2
1.34 - 11.156

Street Name

SR 198
2.827 - 11.156

- Non-divided Highway
 Bridge (on route)
 Railroad (at grade)
 Intersection
- Divided Highway
 Underpass
 Railroad (underpass)
- Secondary Segment
 Overpass
 Railroad (overpass)
- Corporation**

Created on: 6/24/2025



transportation.ohio.gov

Prepared by
The Ohio Department of Transportation
Office of Technical Services
Roadway Information

SAUGSR00198**C

State True Log

11

County True Log

10.00

10.25

10.50

10.75

11.00



Surface Type & Width (Left / Right)

G 20'
8.365 - 11.156

Base Type (Left / Right)

I
1.833 - 11.156

Shoulder Type & Width (Left / Right)

2 (8/8)
8.365 - 11.156

Through Lanes

2
1.34 - 11.156

Street Name

SR 198
2.827 - 11.156

- | | | | |
|---------------------|-------------------|----------------------|--------------|
| Non-divided Highway | Bridge (on route) | Railroad (at grade) | Intersection |
| Divided Highway | Underpass | Railroad (underpass) | |
| Secondary Segment | Overpass | Railroad (overpass) | |
| Corporation | | | |

Created on: 6/24/2025



transportation.ohio.gov
 Prepared by
 The Ohio Department of Transportation
 Office of Technical Services
 Roadway Information

SAUGSR00198**C

State True Log

11.156

County True Log

11.00

11.25

11.50

11.75

12.00



Surface Type & Width (Left / Right)

G 20'
8.365 - 11.156

Base Type (Left / Right)
I
1.833 - 11.156

Shoulder Type & Width (Left / Right)
2 (8/8')
8.365 - 11.156

Through Lanes
2
1.34 - 11.156

Street Name
SR 198
2.827 - 11.156

- Non-divided Highway
- Divided Highway
- Secondary Segment
- Corporation
- Bridge (on route)
- Underpass
- Overpass
- Railroad (at grade)
- Railroad (underpass)
- Railroad (overpass)
- Intersection

Created on: 6/24/2025



transportation.ohio.gov
Prepared by
The Ohio Department of Transportation
Office of Technical Services
Roadway Information

Historical Project List for SAUGSR00198**C

Begin Measure	End Measure	Project ID Number	Construction Completion Date	Treatment Category	Treatment Type
2.830	8.082	105358	11-2020	Preventive Maintenance	25-Chip Seal
2.830	11.156	80868	10-2011	Minor Rehabilitation	60-AC Overlay w/Rpr
8.082	11.156	105280	10-2019	Preventive Maintenance	25-Chip Seal

Roadway Codes

Access Control Journalized

- F - Full Access Control
- L - Limited Access Control
- N - No Access Control

Access Control Operational

- 1 - Full Access Control
- 2 - Partial Access Control
- 3 - No Access Control

Base Type

- F - Crack and Seat
- H - Rubblize and Roll
- I - Aggregate Base 304 or Traffic Compacted
- K - Water Bound Macadam
- L - Bituminous Concrete Mix or Penetration Macadam
- N - Plain Concrete
- P - Reinforced Concrete
- R - Brick (Flexible)
- T - Brick (Rigid)

Direction of Travel

- B - Both (Two-way)
- F - One-way Cardinal
- T - One-way Non-cardinal

Facility Type

- 1 - One-way Roadway
- 2 - Two-way Roadway
- 4 - Ramp
- 5 - Non-mainline
- 6 - Non-inventory Direction
- 7 - Planned / Unbuilt

Historical Federal Aid Indicator

- N - Not a FAP Route
- Y - FAP Route

Functional Classification

- 01 - Interstate
- 02 - Principal Arterial (Freeways)
- 03 - Principal Arterial (Other)
- 04 - Minor Arterial
- 05 - Major Collector
- 06 - Minor Collector
- 07 - Local

Leave / Reenter Indicator

- Y - Route leaves/reenters at this point
- N - Route does not leave/reenter at this point

Median Type

- 1 - None
- 2 - Unprotected
- 3 - Curbed
- 4 - Positive Barrier (Unspecified)
- 5 - Positive Barrier (Flexible)
- 6 - Positive Barrier (Semi-rigid)
- 7 - Positive Barrier (Rigid)

NHS

- N - National Highway System
- H - Congressional Corridor
- 2 - Major Airport
- 3 - Major Port Facility
- 4 - Major Amtrak Station
- 5 - Major Rail / Truck Terminal
- 6 - Major Intercity Bus Terminal
- 7 - Major Public Transit / Multi-modal Passenger Terminal
- 8 - Major Pipeline Terminal
- 9 - Major Ferry Terminal

Priority System

- G - General
- P - Priority System
- U - Urban

Scenic Byway Code

- A - All American Road
- N - National Scenic Byway
- S - State Scenic Byway

Shoulder Type

- 1 - None
- 2 - Surfaced shoulder exists (bituminous concrete {AC})
- 3 - Surfaced shoulder exists (Portland Cement Concrete {PCC})
- 4 - Stabilized shoulder exists (gravel or other granular material)
- 5 - Combination shoulder exists (two or more surface types)
- 6 - Earth shoulder exists
- 7 - Barrier curb exists; no shoulder in front of curb

Surface Type

- A - Combination
- B - Brick
- C - Continuous Reinforced Concrete
- D - Reinforced Concrete
- E - Plain Concrete
- G - Bituminous Concrete
- I - Chipseal on Granular
- K - Open Graded Bituminous
- L - Chipseal or Micro
- M - Gravel
- U - Unimproved
- X - Right of Way Only