

SBELSR00147**C

State True Log 20.965

21.965

County True Log

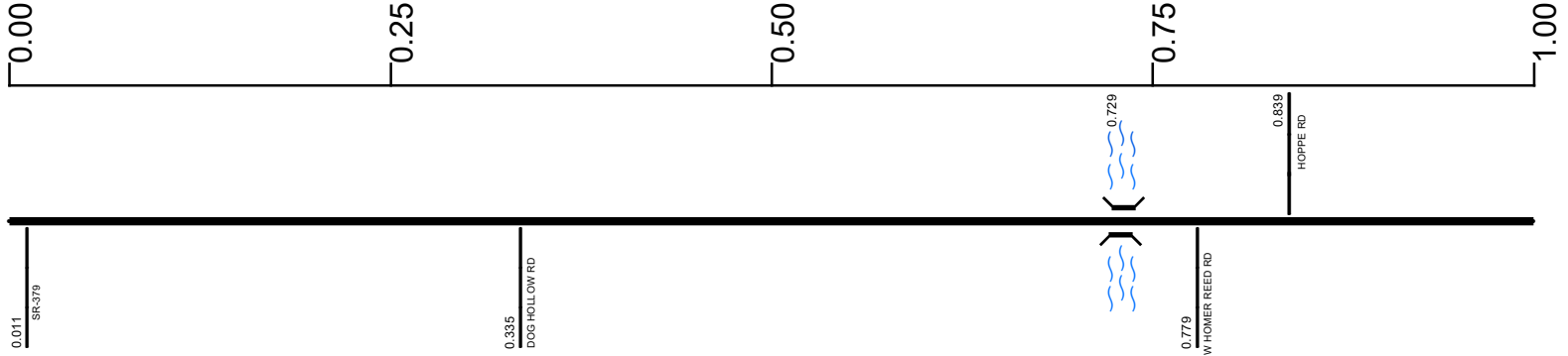

Surface Type & Width (Left / Right)

	G 18'
0 - 1.093	

Base Type (Left / Right)

L	I
0 - 0.446	0.446 - 1.093

Shoulder Type & Width (Left / Right)

	5 (0'/0')
0 - 1.093	

Resurface Year

	2022
--	------

Through Lanes

	2
--	---

Street Name

S LEATHERWOOD RD	MAIN ST
0 - 0.779	0.779 - 1.093

- | | | | |
|---------------------|-------------------|----------------------|--------------|
| Non-divided Highway | Bridge (on route) | Railroad (at grade) | Intersection |
| Divided Highway | Underpass | Railroad (underpass) | |
| Secondary Segment | Overpass | Railroad (overpass) | |
| Corporation | | | |

Created on: 6/24/2025

transportation.ohio.gov

Prepared by
The Ohio Department of Transportation
Office of Technical Services
Roadway Information

SBELSR00147**C

State True Log

22.965

County True Log

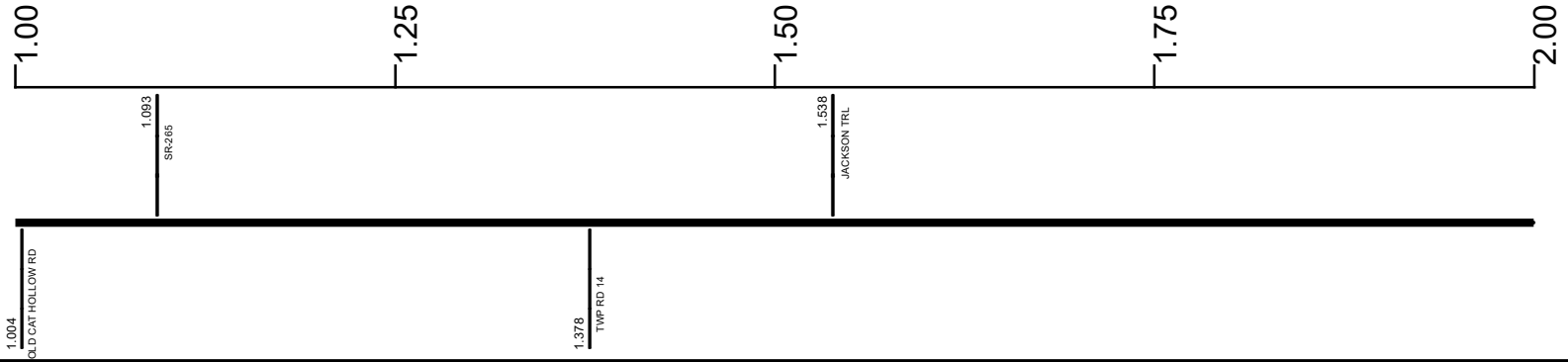

Surface Type & Width (Left / Right)

G 18'	G 20'	G (18 1/2')
0 - 1.093	1.093 - 1.488	1.488 - 4.159

Base Type (Left / Right)

I	L	I / L
0.446 - 1.093	1.093 - 1.488	1.488 - 4.159

Shoulder Type & Width (Left / Right)

5 (0'0")	5 (3'3")	5 (1'1")
0 - 1.093	1.093 - 1.297	1.297 - 4.468

Resurface Year

	2022	
	0 - 4.15	

Through Lanes

	2	
	0 - 19.5	

Street Name

MAIN ST	LEATHERWOOD PIKE	
0.779 - 1.093	1.093 - 4.15	

- Non-divided Highway
- Divided Highway
- Secondary Segment
- Corporation**
- Bridge (on route)
- Underpass
- Overpass
- Railroad (at grade)
- Railroad (underpass)
- Railroad (overpass)
- Intersection

Created on: 6/24/2025

transportation.ohio.gov

Prepared by
The Ohio Department of Transportation
Office of Technical Services
Roadway Information

SBELSR00147**C

State True Log

23.965

County True Log

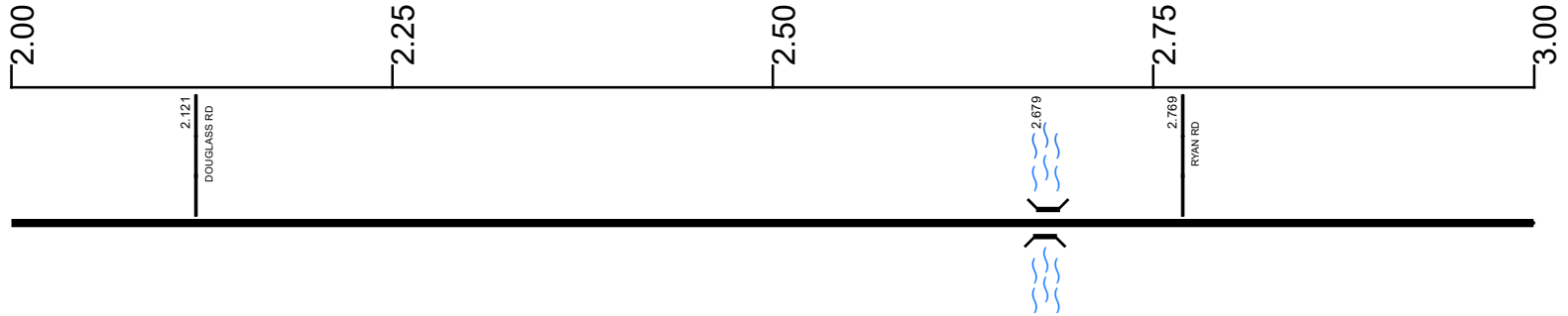

Surface Type & Width (Left / Right)

G (18'/2')
1.488 - 4.159

Base Type (Left / Right)

I / L
1.488 - 4.159

Shoulder Type & Width (Left / Right)

5 (1'/1')
1.297 - 4.468

Resurface Year

2022

Through Lanes

2

Street Name

LEATHERWOOD PIKE
1.093 - 4.15

- | | | | |
|---------------------|-------------------|----------------------|--------------|
| Non-divided Highway | Bridge (on route) | Railroad (at grade) | Intersection |
| Divided Highway | Underpass | Railroad (underpass) | |
| Secondary Segment | Overpass | Railroad (overpass) | |
| Corporation | | | |

Created on: 6/24/2025



transportation.ohio.gov

Prepared by
The Ohio Department of Transportation
Office of Technical Services
Roadway Information

SBELSR00147**C

State True Log

24.965

County True Log



Surface Type & Width (Left / Right)

G (18/2')
1.488 - 4.159

Base Type (Left / Right)

I / L
1.488 - 4.159

Shoulder Type & Width (Left / Right)

5 (1/1')
1.297 - 4.468

Resurface Year

2022

Through Lanes

2

Street Name

LEATHERWOOD PIKE
1.093 - 4.15

- | | | | |
|---------------------|-------------------|----------------------|--------------|
| Non-divided Highway | Bridge (on route) | Railroad (at grade) | Intersection |
| Divided Highway | Underpass | Railroad (underpass) | |
| Secondary Segment | Overpass | Railroad (overpass) | |
| Corporation | | | |

Created on: 6/24/2025

transportation.ohio.gov

Prepared by
The Ohio Department of Transportation
Office of Technical Services
Roadway Information

SBELSR00147**C

State True Log

25.965

County True Log

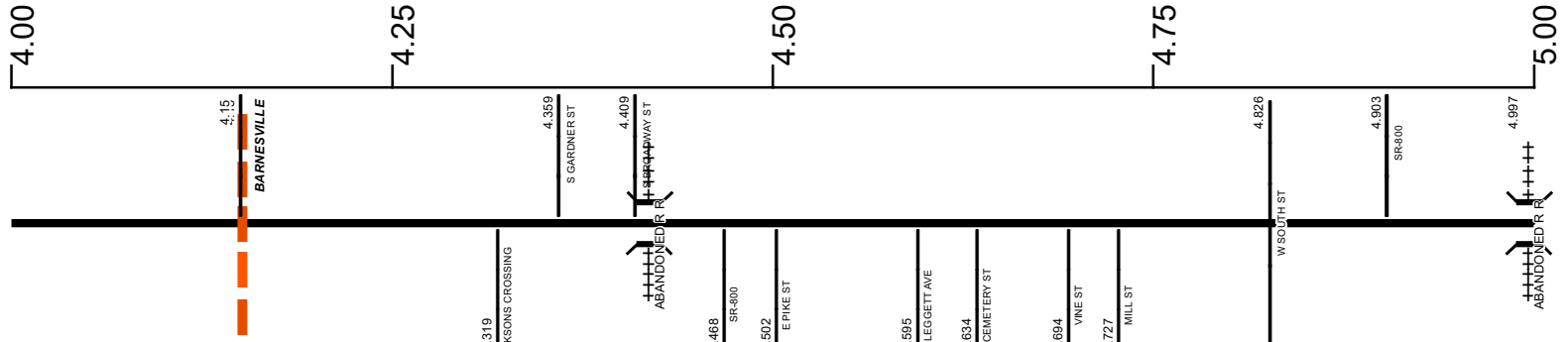

Surface Type & Width (Left / Right)

G (18'1/2')	G 18'	G 24'	G (32'6')	G 44'
1.488 - 4.159	4.159 - 4.468	4.468 - 4.737	4.737 - 4.903	4.903 - 5.116

Base Type (Left / Right)

I / L	K	R	R / N	R
1.488 - 4.159	4.159 - 4.468	4.468 - 4.737	4.737 - 4.903	4.903 - 5.758

Shoulder Type & Width (Left / Right)

5 (1'1')	1 (0'0')
1.297 - 4.468	4.468 - 6.264

Resurface Year

2022

0 - 4.15

Through Lanes

2

0 - 19.5

Street Name

LEATHERWOOD PIKE	LEATHERWOOD RD	W PIKE ST	S CHESTNUT ST	E MAIN ST
1.093 - 4.15	4.15 - 4.359	4.359 - 4.468	4.468 - 4.903	4.903 - 6.45

- Non-divided Highway
- Divided Highway
- Secondary Segment
- Corporation
- Bridge (on route)
- Underpass
- Overpass
- Railroad (at grade)
- Railroad (underpass)
- Railroad (overpass)
- Intersection

Created on: 6/24/2025

transportation.ohio.gov

Prepared by
The Ohio Department of Transportation
Office of Technical Services
Roadway Information

SBELSR00147**C

State True Log

26.965

County True Log

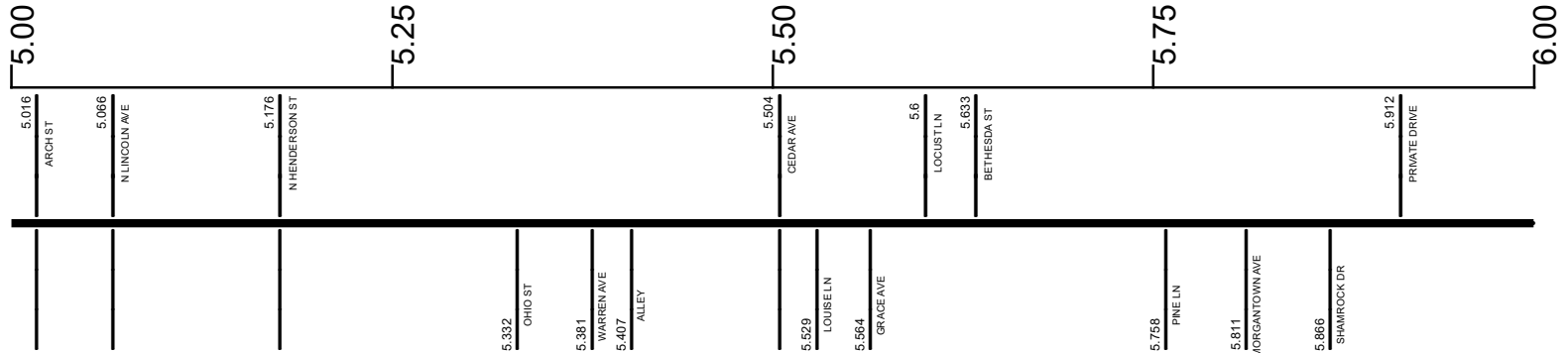

Surface Type & Width (Left / Right)

G 44'	G 30'	G 26'	G 24'	G (22'/15')
4.903 - 5.116	5.116 - 5.409	5.409 - 5.633	5.633 - 5.758	5.758 - 6.264

Base Type (Left / Right)

R	K / L
4.903 - 5.758	5.758 - 7.543

Shoulder Type & Width (Left / Right)

1 (0'/0')	
4.468 - 6.264	

Through Lanes

	2
	0 - 19.5

Street Name

	E MAIN ST
	4.903 - 6.45

- Non-divided Highway
- Divided Highway
- Secondary Segment
- Corporation
- Bridge (on route)
- Underpass
- Overpass
- Railroad (at grade)
- Railroad (underpass)
- Railroad (overpass)
- Intersection

Created on: 6/24/2025

transportation.ohio.gov

Prepared by
The Ohio Department of Transportation
Office of Technical Services
Roadway Information

SBELSR00147**C

State True Log

28.965

County True Log

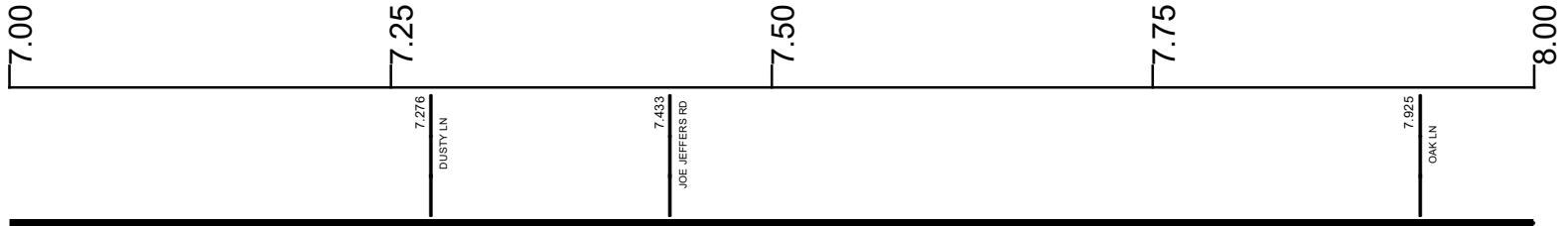

Surface Type & Width (Left / Right)

G (22'/2')	G 24'
6.264 - 7.543	7.543 - 11.628

Base Type (Left / Right)

K / L	I
5.758 - 7.543	7.543 - 11.339

Shoulder Type & Width (Left / Right)

5 (2'/2')
6.264 - 11.401

Through Lanes

2
0 - 19.5

Street Name

BARNESVILLE-BETHESDA RD
6.45 - 11.321

- | | | | |
|--|---|---|---|
| <ul style="list-style-type: none"> Non-divided Highway Divided Highway Secondary Segment Corporation | <ul style="list-style-type: none"> Bridge (on route) Underpass Overpass | <ul style="list-style-type: none"> Railroad (at grade) Railroad (underpass) Railroad (overpass) | <ul style="list-style-type: none"> Intersection |
|--|---|---|---|

Created on: 6/24/2025

transportation.ohio.gov

Prepared by
The Ohio Department of Transportation
Office of Technical Services
Roadway Information

SBELSR00147**C

State True Log

29.965

County True Log

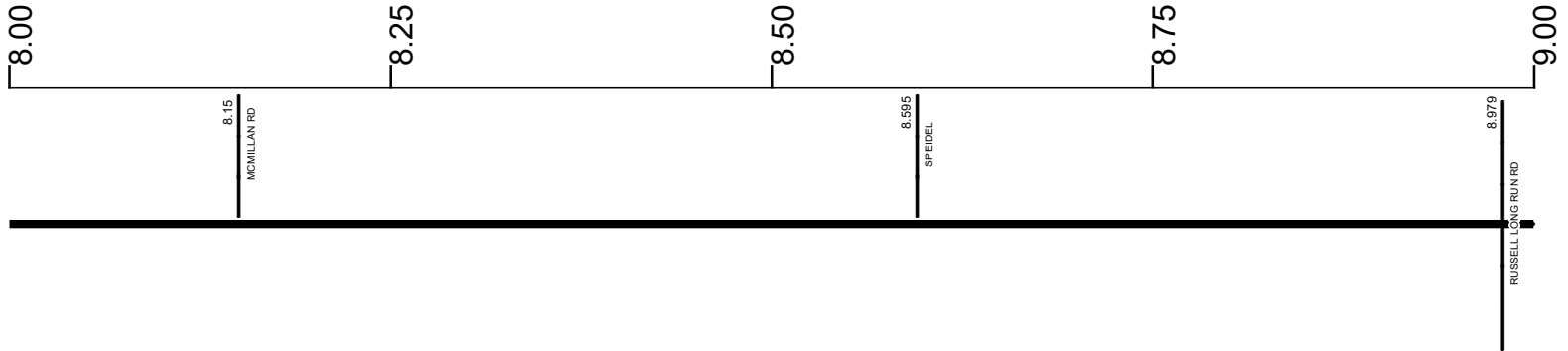

Surface Type & Width (Left / Right)

G 24'
7.543 - 11.628

Base Type (Left / Right)

I
7.543 - 11.339

Shoulder Type & Width (Left / Right)

5 (2/2)
6.264 - 11.401

Through Lanes

2
0 - 19.5

Street Name

BARNESVILLE-BETHESDA RD
6.45 - 11.321

- | | | | |
|---------------------|-------------------|----------------------|--------------|
| Non-divided Highway | Bridge (on route) | Railroad (at grade) | Intersection |
| Divided Highway | Underpass | Railroad (underpass) | |
| Secondary Segment | Overpass | Railroad (overpass) | |
| Corporation | | | |

Created on: 6/24/2025



Prepared by
The Ohio Department of Transportation
Office of Technical Services
Roadway Information

SBELSR00147**C

State True Log

30.965

County True Log

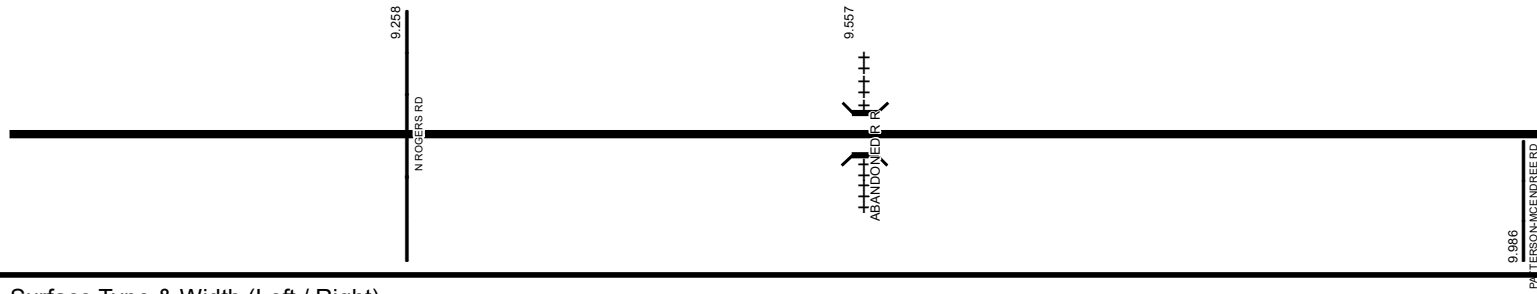

Surface Type & Width (Left / Right)	G 24'
	7.543 - 11.628
Base Type (Left / Right)	I
	7.543 - 11.339
Shoulder Type & Width (Left / Right)	5 (2/2')
	6.264 - 11.401
Through Lanes	2
	0 - 19.5
Street Name	BARNESVILLE-BETHESDA RD
	6.45 - 11.321

Non-divided Highway	Bridge (on route)	Railroad (at grade)	Intersection
Divided Highway	Underpass	Railroad (underpass)	
Secondary Segment	Overpass	Railroad (overpass)	
Corporation			

Created on: 6/24/2025

transportation.ohio.gov

Prepared by
The Ohio Department of Transportation
Office of Technical Services
Roadway Information

SBELSR00147**C

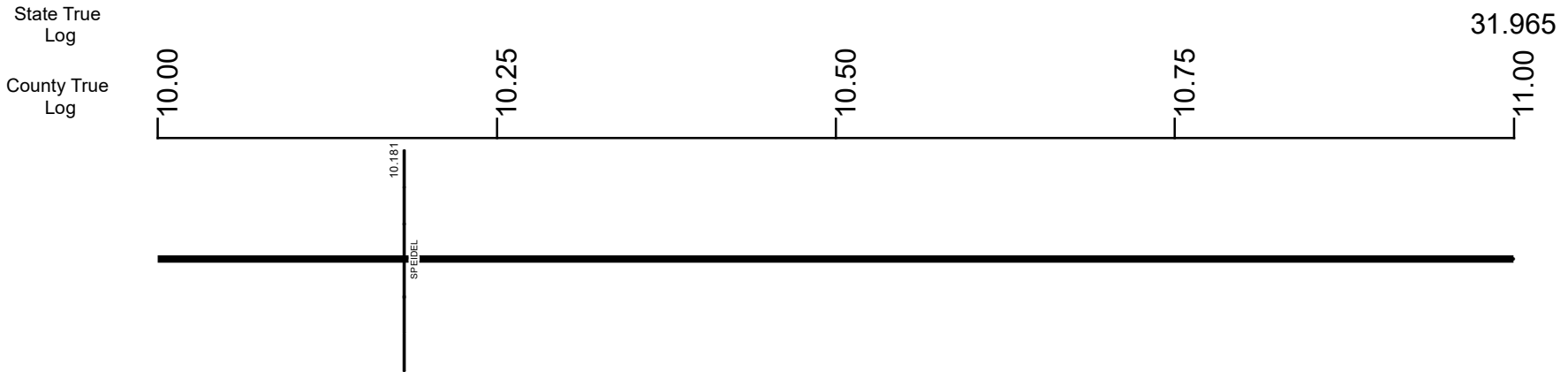

Surface Type & Width (Left / Right)

G 24'
7.543 - 11.628

Base Type (Left / Right)

I
7.543 - 11.339

Shoulder Type & Width (Left / Right)

5 (2/2)
6.264 - 11.401

Through Lanes

2
0 - 19.5

Street Name

BARNESVILLE-BETHESDA RD
6.45 - 11.321

- Non-divided Highway
 Bridge (on route)
 Railroad (at grade)
 Intersection
- Divided Highway
 Underpass
 Railroad (underpass)
- Secondary Segment
 Overpass
 Railroad (overpass)
- Corporation**

Created on: 6/24/2025



transportation.ohio.gov

Prepared by
The Ohio Department of Transportation
Office of Technical Services
Roadway Information

SBELSR00147**C

State True Log
County True Log

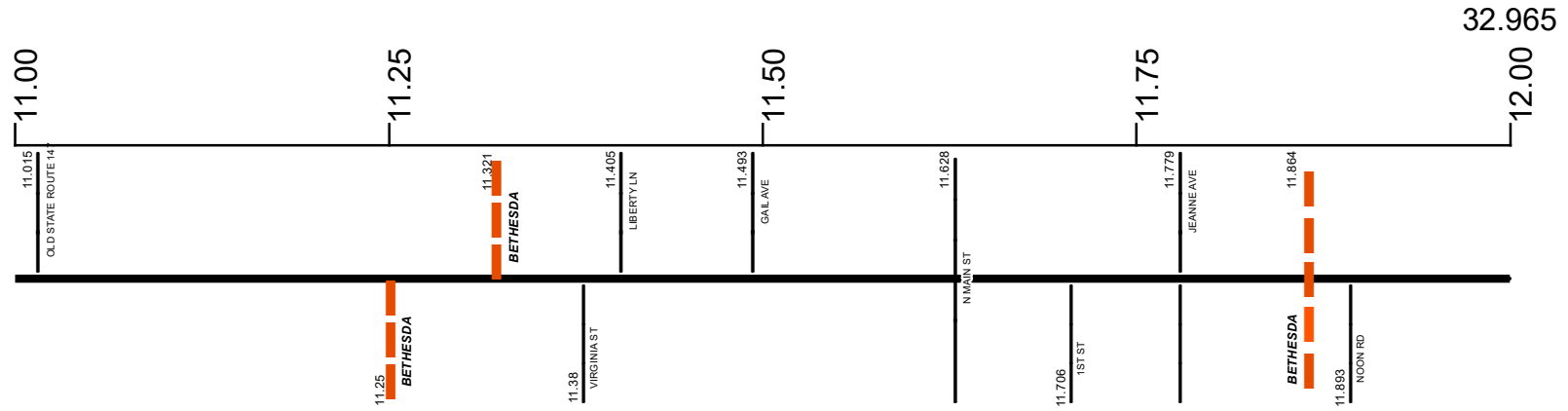

Surface Type & Width (Left / Right)

G 24'	G 20'
7.543 - 11.628	11.628 - 13.606

Base Type (Left / Right)

I	T	I
7.543 - 11.339	11.339 - 11.628	11.628 - 13.228

Shoulder Type & Width (Left / Right)

5 (2'/2')	1 (0'/0')	5 (2'/2')
6.264 - 11.401	11.401 - 11.628	11.628 - 13.228

Through Lanes

2
0 - 19.5

Street Name

BARNESVILLE-BETHESDA RD	MAPLE AVE	BELMONT RD	BETHESDA-BELMONT RD
6.45 - 11.321	11.321 - 11.628	11.628 - 11.832	11.832 - 13.258

- Non-divided Highway
- Divided Highway
- Secondary Segment
- Corporation
- Bridge (on route)
- Underpass
- Overpass
- Railroad (at grade)
- Railroad (underpass)
- Railroad (overpass)
- Intersection

Created on: 6/24/2025

transportation.ohio.gov

Prepared by
The Ohio Department of Transportation
Office of Technical Services
Roadway Information

SBELSR00147**C

State True Log

33.965

County True Log

12.00

12.25

12.50

12.75

13.00



Surface Type & Width (Left / Right)

G 20'
11.628 - 13.606

Base Type (Left / Right)

I
11.628 - 13.228

Shoulder Type & Width (Left / Right)

5 (2/2)
11.628 - 13.228

Through Lanes

2
0 - 19.5

Street Name

BETHESDA-BELMONT RD
11.832 - 13.258

- | | | | |
|--|---|---|---|
| <ul style="list-style-type: none"> Non-divided Highway Divided Highway Secondary Segment Corporation | <ul style="list-style-type: none"> Bridge (on route) Underpass Overpass | <ul style="list-style-type: none"> Railroad (at grade) Railroad (underpass) Railroad (overpass) | <ul style="list-style-type: none"> Intersection |
|--|---|---|---|

Created on: 6/24/2025

transportation.ohio.gov

Prepared by
The Ohio Department of Transportation
Office of Technical Services
Roadway Information

SBELSR00147**C

State True Log
County True Log

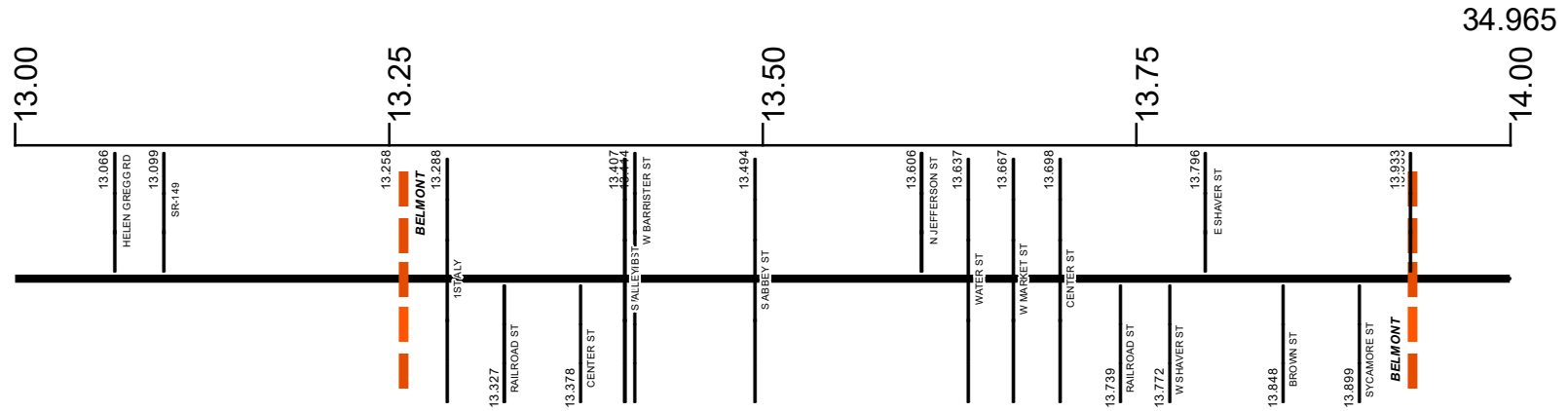

Surface Type & Width (Left / Right)

G 20'	G 30'	G (10'/11')	G 18'
11.628 - 13.606	13.606 - 13.761	13.761 - 13.933	13.933 - 19.5

Base Type (Left / Right)

I	N	T	R	I
11.628 - 13.228	13.228 - 13.606	13.606 - 13.761	13.761 - 13.933	13.933 - 19.5

Shoulder Type & Width (Left / Right)

5 (2'/2')	1 (0'/0')	1 (0'/0')	2 (1'/1')
11.628 - 13.228	13.228 - 13.933	13.228 - 13.933	13.933 - 19.5

Resurface Year

2021
13.23 - 19.5

Through Lanes

2
0 - 19.5

Street Name

BETHESDA-BELMONT RD	RAILROAD ST	S BRIDGE ST	W MAIN ST	S JEFFERSON ST	BELMONT-CENTERVILLE RD
11.832 - 13.258	13.258 - 13.327	13.327 - 13.407	13.407 - 13.606	13.606 - 13.933	13.933 - 19.5

- Non-divided Highway
- Divided Highway
- Secondary Segment
- Corporation
- Bridge (on route)
- Underpass
- Overpass
- Railroad (at grade)
- Railroad (underpass)
- Railroad (overpass)
- Intersection

Created on: 6/24/2025

transportation.ohio.gov

Prepared by
The Ohio Department of Transportation
Office of Technical Services
Roadway Information

SBELSR00147**C

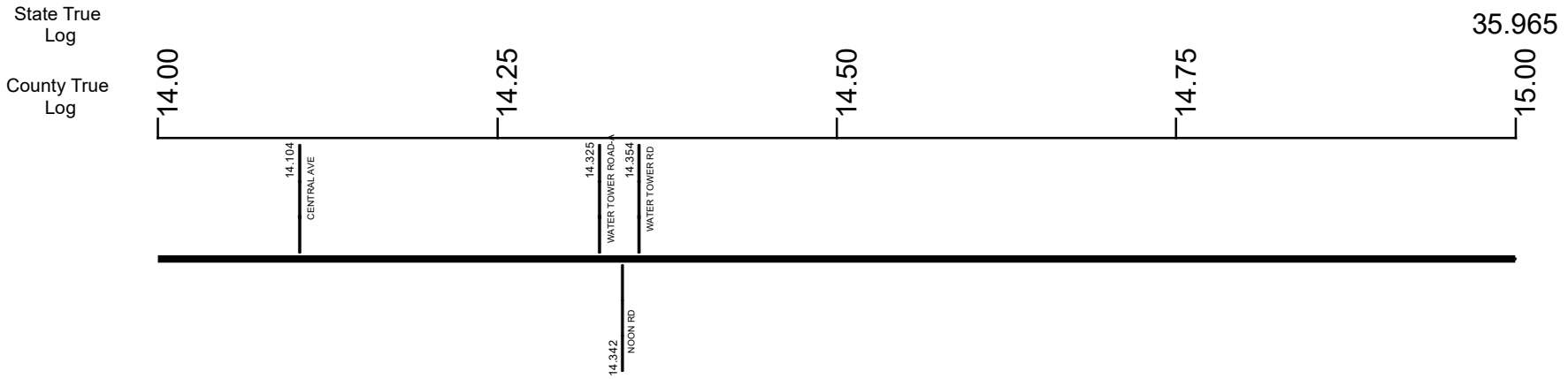

Surface Type & Width (Left / Right)	G 18'
	13.933 - 19.5
Base Type (Left / Right)	I
	13.933 - 19.5
Shoulder Type & Width (Left / Right)	2 (1/1')
	13.933 - 19.5
Resurface Year	2021
	13.23 - 19.5
Through Lanes	2
	0 - 19.5
Street Name	BELMONT-CENTERVILLE RD
	13.933 - 19.5

Non-divided Highway	Bridge (on route)	Railroad (at grade)	Intersection
Divided Highway	Underpass	Railroad (underpass)	
Secondary Segment	Overpass	Railroad (overpass)	
Corporation			

Created on: 6/24/2025



transportation.ohio.gov

Prepared by
The Ohio Department of Transportation
Office of Technical Services
Roadway Information

SBELSR00147**C

State True Log

36.965

County True Log



Surface Type & Width (Left / Right)	G 18' 13.933 - 19.5
Base Type (Left / Right)	I 13.933 - 19.5
Shoulder Type & Width (Left / Right)	2 (1/1') 13.933 - 19.5
Resurface Year	2021 13.23 - 19.5
Through Lanes	2 0 - 19.5
Street Name	BELMONT-CENTERVILLE RD 13.933 - 19.5

- | | | | |
|---------------------|-------------------|----------------------|--------------|
| Non-divided Highway | Bridge (on route) | Railroad (at grade) | Intersection |
| Divided Highway | Underpass | Railroad (underpass) | |
| Secondary Segment | Overpass | Railroad (overpass) | |
| Corporation | | | |

Created on: 6/24/2025

transportation.ohio.gov

Prepared by
The Ohio Department of Transportation
Office of Technical Services
Roadway Information

SBELSR00147**C

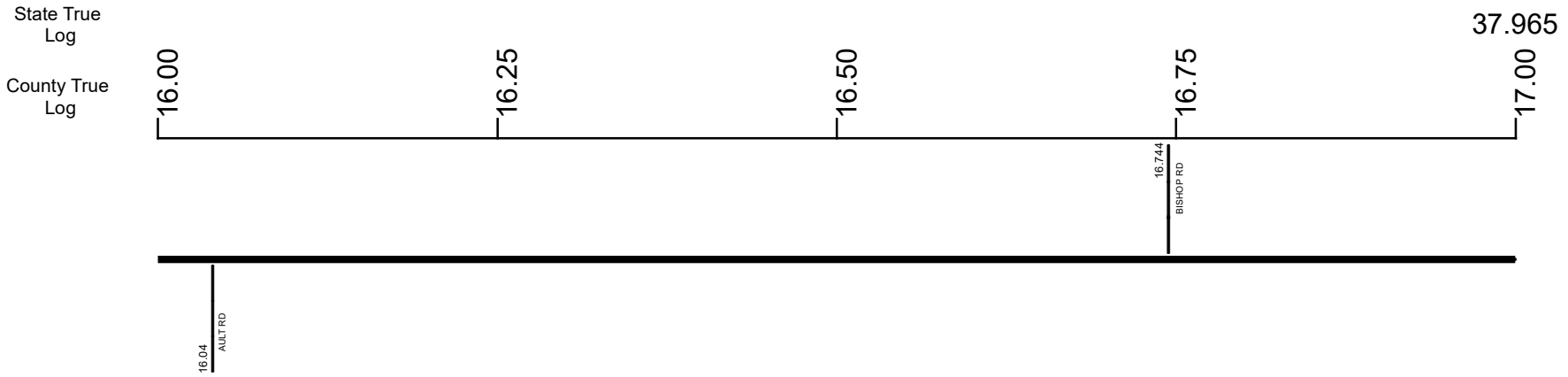

Surface Type & Width (Left / Right)	G 18'
	13.933 - 19.5
Base Type (Left / Right)	I
	13.933 - 19.5
Shoulder Type & Width (Left / Right)	2 (1'1")
	13.933 - 19.5
Resurface Year	2021
	13.23 - 19.5
Through Lanes	2
	0 - 19.5
Street Name	BELMONT-CENTERVILLE RD
	13.933 - 19.5

Non-divided Highway	Bridge (on route)	Railroad (at grade)	Intersection
Divided Highway	Underpass	Railroad (underpass)	
Secondary Segment	Overpass	Railroad (overpass)	
Corporation			

Created on: 6/24/2025



transportation.ohio.gov

Prepared by
The Ohio Department of Transportation
Office of Technical Services
Roadway Information

SBELSR00147**C

State True Log
County True Log

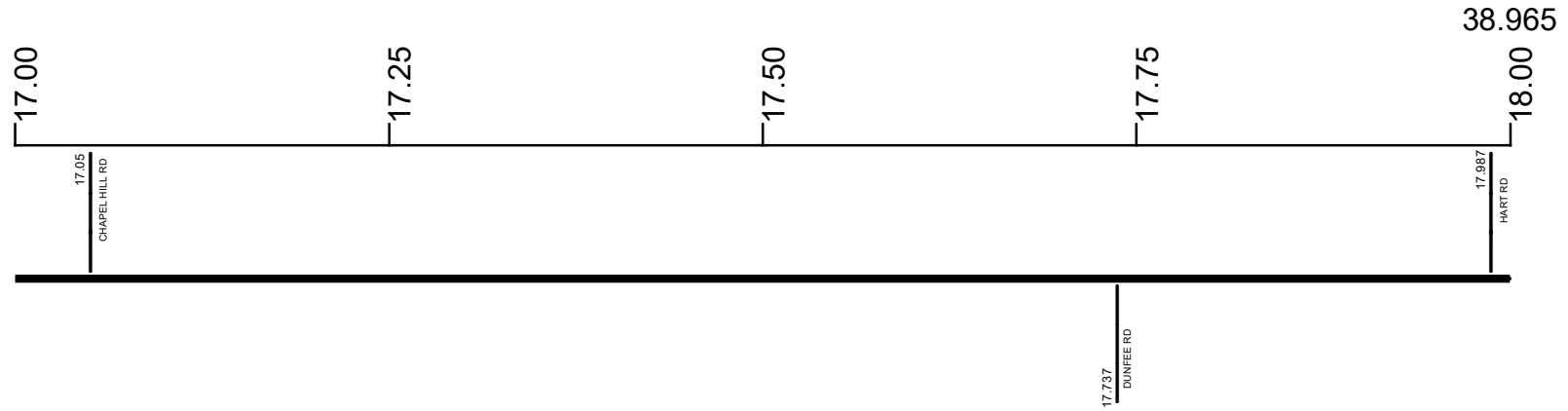

Surface Type & Width (Left / Right)

G 18'
13.933 - 19.5

Base Type (Left / Right)

I
13.933 - 19.5

Shoulder Type & Width (Left / Right)

2 (1/1')
13.933 - 19.5

Resurface Year

2021
13.23 - 19.5

Through Lanes

2
0 - 19.5

Street Name

BELMONT-CENTERVILLE RD
13.933 - 19.5

- Non-divided Highway
 Bridge (on route)
 Railroad (at grade)
 Intersection
- Divided Highway
 Underpass
 Railroad (underpass)
- Secondary Segment
 Overpass
 Railroad (overpass)
- Corporation**

Created on: 6/24/2025



transportation.ohio.gov

Prepared by
The Ohio Department of Transportation
Office of Technical Services
Roadway Information

SBELSR00147**C

State True Log

39.965

County True Log

18.00

18.25

18.50

18.75

19.00



Surface Type & Width (Left / Right)

G 18'
13.933 - 19.5

Base Type (Left / Right)

I
13.933 - 19.5

Shoulder Type & Width (Left / Right)

2 (1/1')
13.933 - 19.5

Resurface Year

2021
13.23 - 19.5

Through Lanes

2
0 - 19.5

Street Name

BELMONT-CENTERVILLE RD
13.933 - 19.5

- | | | | |
|---------------------|-------------------|----------------------|--------------|
| Non-divided Highway | Bridge (on route) | Railroad (at grade) | Intersection |
| Divided Highway | Underpass | Railroad (underpass) | |
| Secondary Segment | Overpass | Railroad (overpass) | |
| Corporation | | | |

Created on: 6/24/2025

transportation.ohio.gov

Prepared by
The Ohio Department of Transportation
Office of Technical Services
Roadway Information

SBELSR00147**C

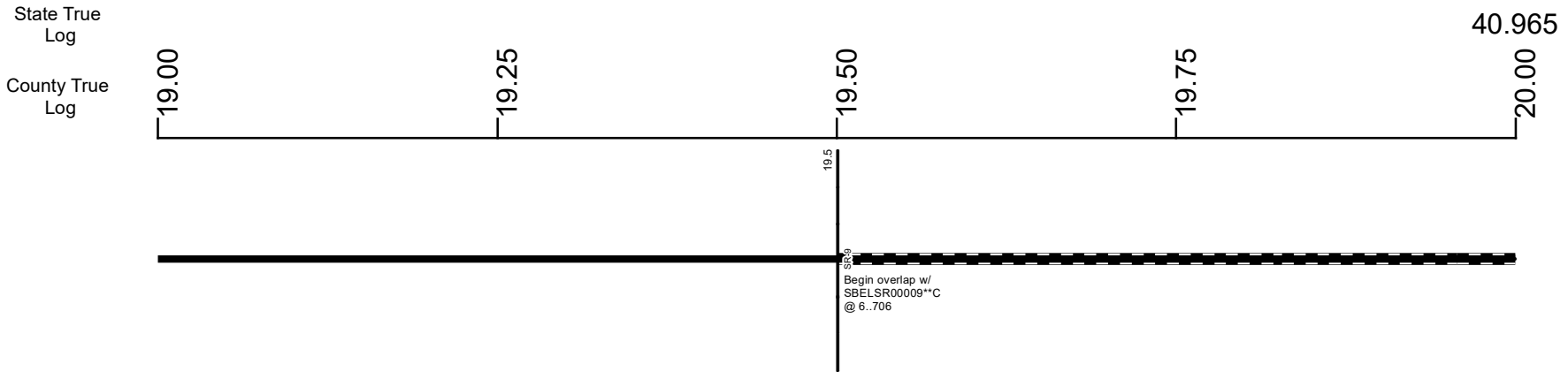

Surface Type & Width (Left / Right)	G 18'	13.933 - 19.5
Base Type (Left / Right)	I	13.933 - 19.5
Shoulder Type & Width (Left / Right)	2 (1/1')	13.933 - 19.5
Resurface Year	2021	13.23 - 19.5
Through Lanes	2	0 - 19.5
Street Name	BELMONT-CENTERVILLE RD	13.933 - 19.5

- | | | | |
|---------------------|-------------------|----------------------|--------------|
| Non-divided Highway | Bridge (on route) | Railroad (at grade) | Intersection |
| Divided Highway | Underpass | Railroad (underpass) | |
| Secondary Segment | Overpass | Railroad (overpass) | |
| Corporation | | | |

Created on: 6/24/2025



transportation.ohio.gov
 Prepared by
 The Ohio Department of Transportation
 Office of Technical Services
 Roadway Information

SBELSR00147**C

State True Log
County True Log

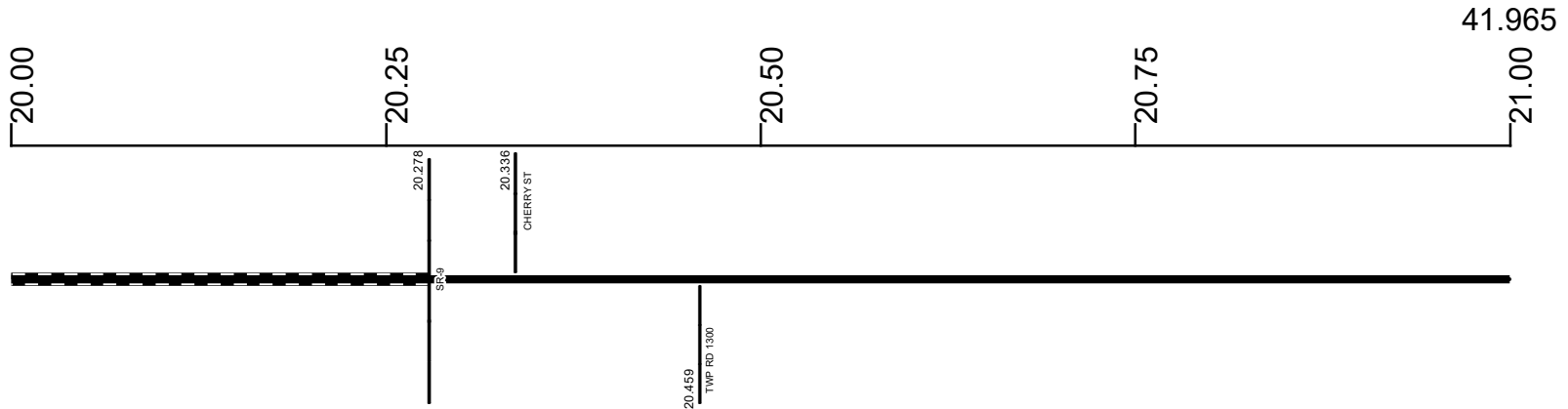

Surface Type & Width (Left / Right)

	G 18'
	20.278 - 25.279

Base Type (Left / Right)

	I
	20.278 - 23.321

Shoulder Type & Width (Left / Right)

	5 (1'/1')
	20.278 - 36.041

Through Lanes

	2
	20.278 - 37.36

Street Name

	MAIN ST		CENTERVILLE JACOBSBURG RD
	20.278 - 20.873		20.873 - 23.768

- | | | | |
|---------------------|-------------------|----------------------|--------------|
| Non-divided Highway | Bridge (on route) | Railroad (at grade) | Intersection |
| Divided Highway | Underpass | Railroad (underpass) | |
| Secondary Segment | Overpass | Railroad (overpass) | |
| Corporation | | | |

Created on: 6/24/2025

transportation.ohio.gov

Prepared by
The Ohio Department of Transportation
Office of Technical Services
Roadway Information

SBELSR00147**C

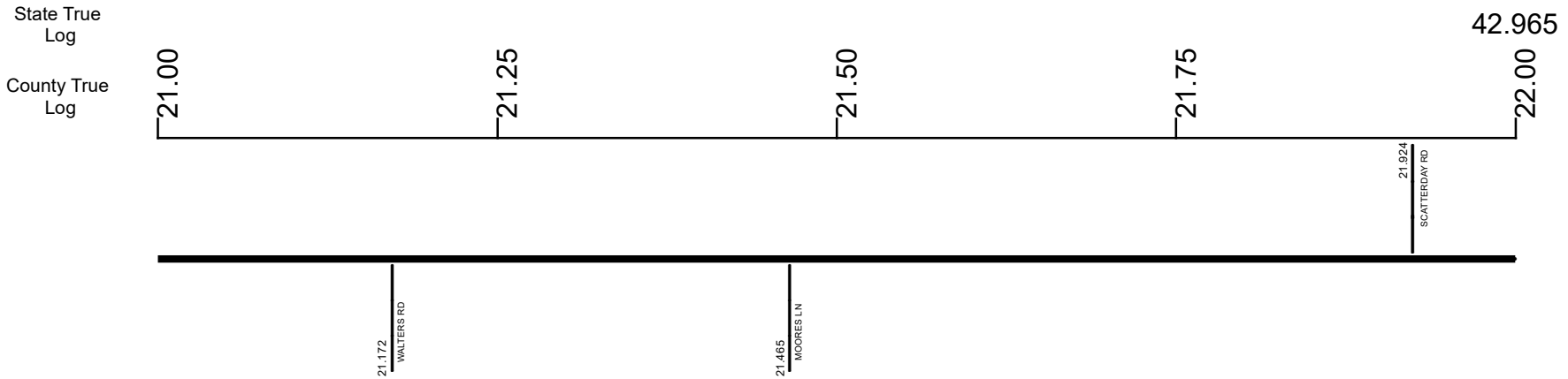

Surface Type & Width (Left / Right)	G 18'
	20.278 - 25.279
Base Type (Left / Right)	I
	20.278 - 23.321
Shoulder Type & Width (Left / Right)	5 (1/1')
	20.278 - 36.041
Through Lanes	2
	20.278 - 37.36
Street Name	CENTERVILLE-JACOBSBURG RD
	20.873 - 23.768

- Non-divided Highway
- Divided Highway
- Secondary Segment
- Corporation
- Bridge (on route)
- Underpass
- Overpass
- Railroad (at grade)
- Railroad (underpass)
- Railroad (overpass)
- Intersection

Created on: 6/24/2025

transportation.ohio.gov

Prepared by
The Ohio Department of Transportation
Office of Technical Services
Roadway Information

SBELSR00147**C

State True
Log

43.965

County True
Log

22.00

22.25

22.50

22.75

23.00



22.683
SHEPARD'S HILL RD

Surface Type & Width (Left / Right)

G 18'
20.278 - 25.279

Base Type (Left / Right)

I
20.278 - 23.321

Shoulder Type & Width (Left / Right)

5 (1/1')
20.278 - 36.041

Through Lanes

2
20.278 - 37.36

Street Name

CENTERVILLE-JACOBSBURG RD
20.873 - 23.768

- | | | | |
|---------------------|-------------------|----------------------|--------------|
| Non-divided Highway | Bridge (on route) | Railroad (at grade) | Intersection |
| Divided Highway | Underpass | Railroad (underpass) | |
| Secondary Segment | Overpass | Railroad (overpass) | |
| Corporation | | | |

Created on: 6/24/2025

transportation.ohio.gov

Prepared by
The Ohio Department of Transportation
Office of Technical Services
Roadway Information

SBELSR00147**C

State True Log

44.965

County True Log



Surface Type & Width (Left / Right)

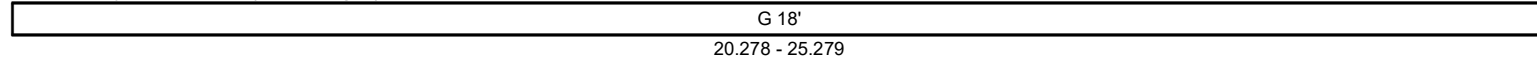

Base Type (Left / Right)

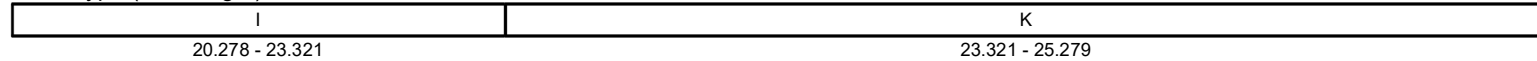

Shoulder Type & Width (Left / Right)

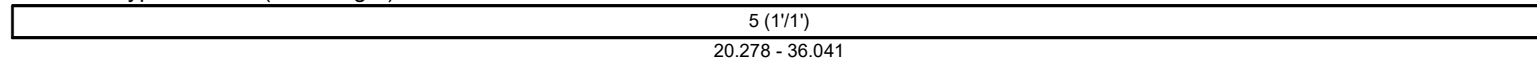

Through Lanes

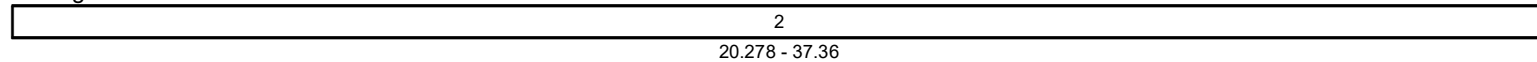

Street Name

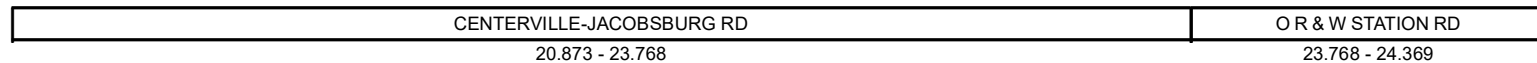

- | | | | |
|---------------------|-------------------|----------------------|--------------|
| Non-divided Highway | Bridge (on route) | Railroad (at grade) | Intersection |
| Divided Highway | Underpass | Railroad (underpass) | |
| Secondary Segment | Overpass | Railroad (overpass) | |
| Corporation | | | |

Created on: 6/24/2025



transportation.ohio.gov

Prepared by
The Ohio Department of Transportation
Office of Technical Services
Roadway Information

SBELSR00147**C

State True Log

45.965

County True Log

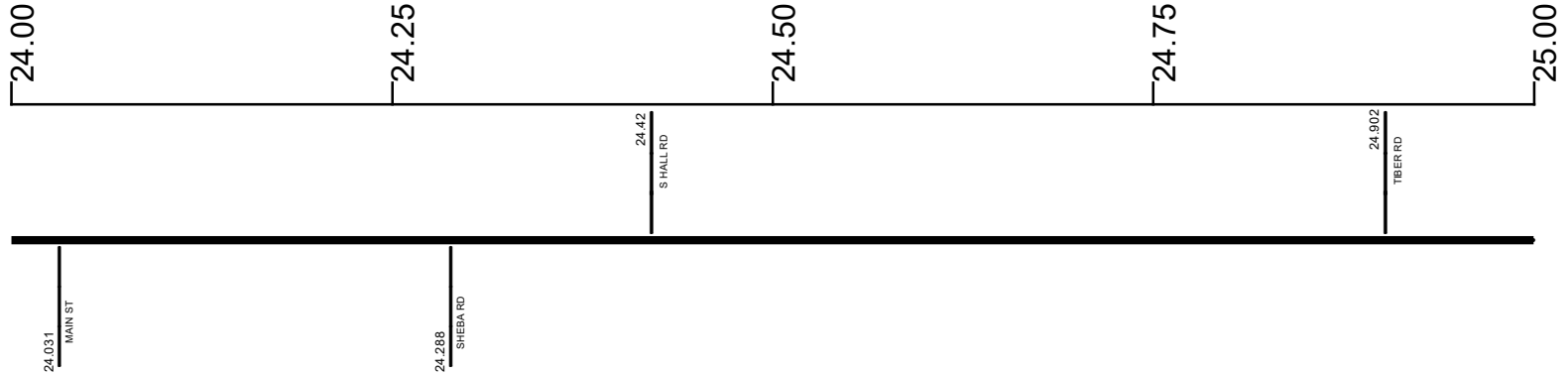

Surface Type & Width (Left / Right)

	G 18'
	20.278 - 25.279

Base Type (Left / Right)

	K
	23.321 - 25.279

Shoulder Type & Width (Left / Right)

	5 (1/1')
	20.278 - 36.041

Through Lanes

	2
	20.278 - 37.36

Street Name

O R & W STATION RD 23.768 - 24.369	JACOBSBURG-KEY RD 24.369 - 26.098
---------------------------------------	--------------------------------------

- | | | | |
|---------------------|-------------------|----------------------|--------------|
| Non-divided Highway | Bridge (on route) | Railroad (at grade) | Intersection |
| Divided Highway | Underpass | Railroad (underpass) | |
| Secondary Segment | Overpass | Railroad (overpass) | |
| Corporation | | | |

Created on: 6/24/2025

transportation.ohio.gov

Prepared by
The Ohio Department of Transportation
Office of Technical Services
Roadway Information

SBELSR00147**C

State True Log

46.965

County True Log

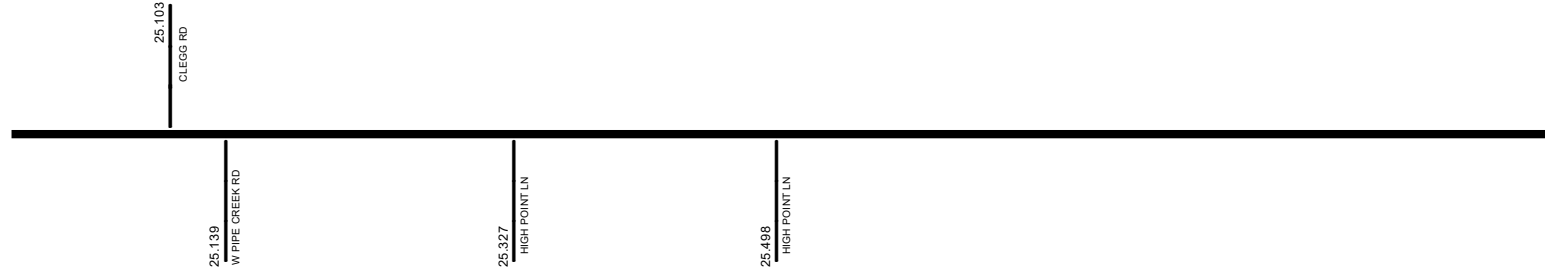

Surface Type & Width (Left / Right)

G 18' 20.278 - 25.279	G (16'2") 25.279 - 29.315
--------------------------	------------------------------

Base Type (Left / Right)

K 23.321 - 25.279	K / I 25.279 - 29.315
----------------------	--------------------------

Shoulder Type & Width (Left / Right)

5 (1'1") 20.278 - 36.041

Through Lanes

2 20.278 - 37.36

Street Name

JACOBSBURG-KEY RD 24.369 - 26.098

- Non-divided Highway
- Divided Highway
- Secondary Segment
- Corporation
- Bridge (on route)
- Underpass
- Overpass
- Railroad (at grade)
- Railroad (underpass)
- Railroad (overpass)
- Intersection

Created on: 6/24/2025

transportation.ohio.gov

Prepared by
The Ohio Department of Transportation
Office of Technical Services
Roadway Information

SBELSR00147**C

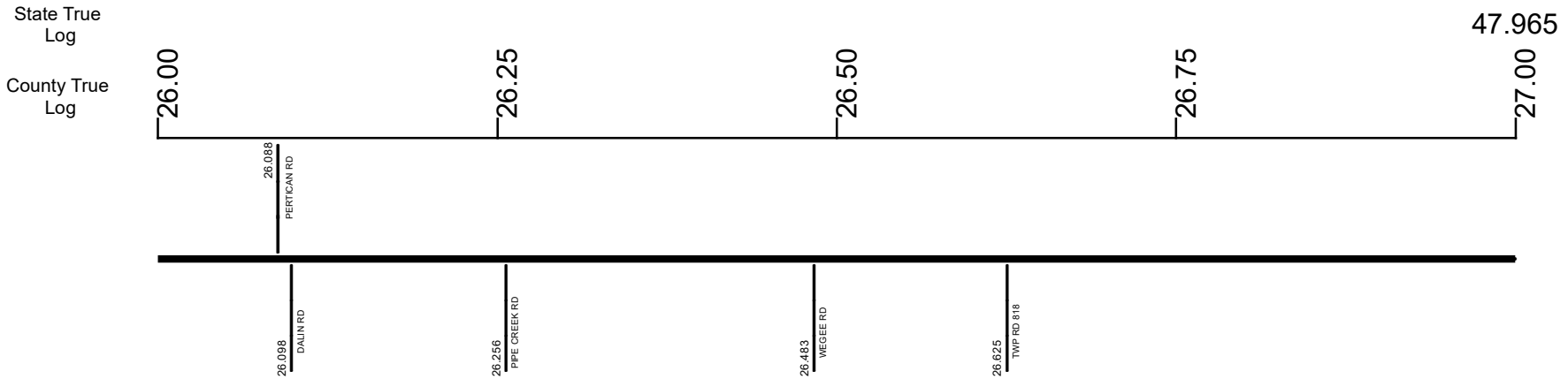

Surface Type & Width (Left / Right)

	G (16'2')
	25.279 - 29.315

Base Type (Left / Right)

	K / I
	25.279 - 29.315

Shoulder Type & Width (Left / Right)

	5 (1'1')
	20.278 - 36.041

Through Lanes

	2
	20.278 - 37.36

Street Name

JACOBSBURG-KEY RD 24.369 - 26.098	O R & W ST 26.098 - 26.553	KEY-BELLAIRE RD 26.553 - 34.941
--------------------------------------	-------------------------------	------------------------------------

- | | | | |
|---------------------|-------------------|----------------------|--------------|
| Non-divided Highway | Bridge (on route) | Railroad (at grade) | Intersection |
| Divided Highway | Underpass | Railroad (underpass) | |
| Secondary Segment | Overpass | Railroad (overpass) | |
| Corporation | | | |

Created on: 6/24/2025

transportation.ohio.gov

Prepared by
The Ohio Department of Transportation
Office of Technical Services
Roadway Information

SBELSR00147**C

State True
Log

48.965

County True
Log

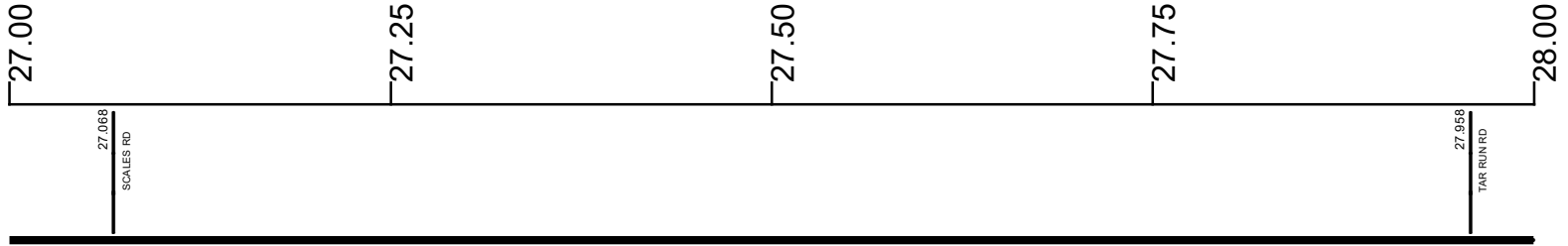

Surface Type & Width (Left / Right)

G (16'/2')
25.279 - 29.315

Base Type (Left / Right)

K / I
25.279 - 29.315

Shoulder Type & Width (Left / Right)

5 (1'/1')
20.278 - 36.041

Through Lanes

2
20.278 - 37.36

Street Name

KEY-BELLAIRE RD
26.553 - 34.941

- | | | | |
|---------------------|-------------------|----------------------|--------------|
| Non-divided Highway | Bridge (on route) | Railroad (at grade) | Intersection |
| Divided Highway | Underpass | Railroad (underpass) | |
| Secondary Segment | Overpass | Railroad (overpass) | |
| Corporation | | | |

Created on: 6/24/2025

transportation.ohio.gov

Prepared by
The Ohio Department of Transportation
Office of Technical Services
Roadway Information

SBELSR00147**C

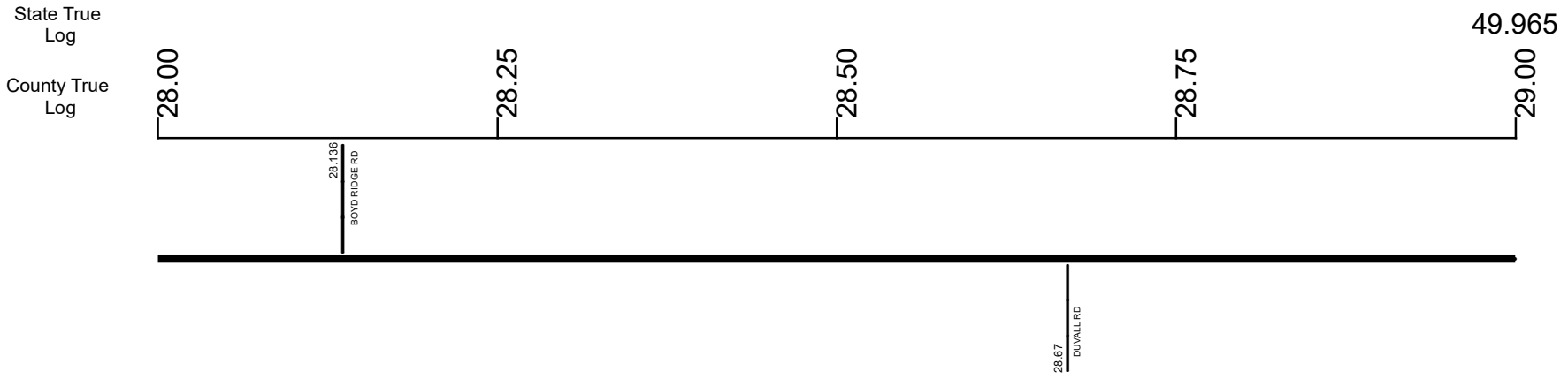

Surface Type & Width (Left / Right)	G (16'2')
	25.279 - 29.315
Base Type (Left / Right)	K / I
	25.279 - 29.315
Shoulder Type & Width (Left / Right)	5 (1'1')
	20.278 - 36.041
Through Lanes	2
	20.278 - 37.36
Street Name	KEY-BELLAIRE RD
	26.553 - 34.941

Non-divided Highway	Bridge (on route)	Railroad (at grade)	Intersection
Divided Highway	Underpass	Railroad (underpass)	
Secondary Segment	Overpass	Railroad (overpass)	
Corporation			

Created on: 6/24/2025

transportation.ohio.gov

Prepared by
The Ohio Department of Transportation
Office of Technical Services
Roadway Information

SBELSR00147**C

State True Log

50.965

County True Log

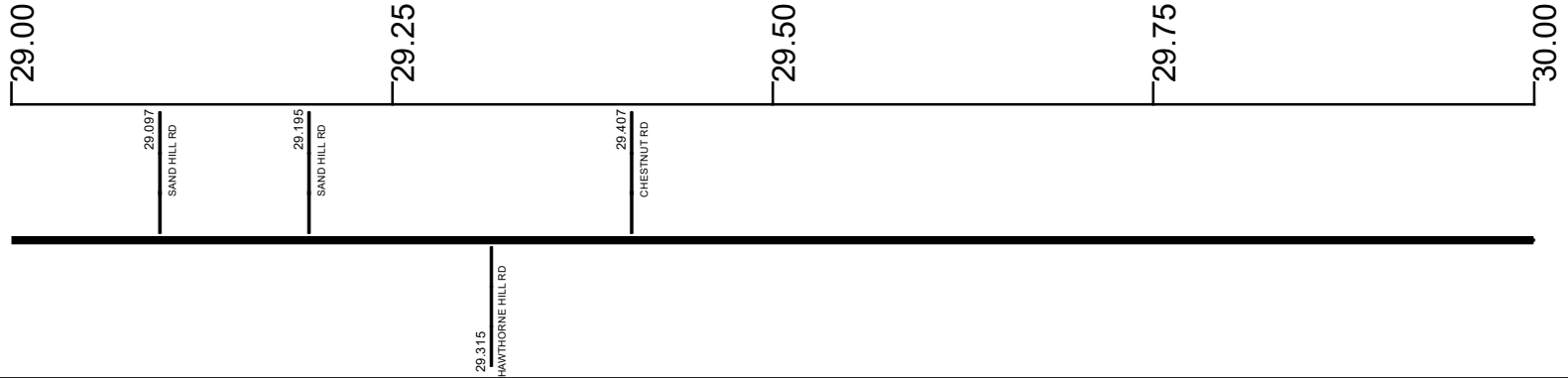

Surface Type & Width (Left / Right)

G (16'2")	G 18'
25.279 - 29.315	29.315 - 34.929

Base Type (Left / Right)

K / I	I
25.279 - 29.315	29.315 - 34.929

Shoulder Type & Width (Left / Right)

5 (1'1")
20.278 - 36.041

Through Lanes

2
20.278 - 37.36

Street Name

KEY-BELLAIRE RD
26.553 - 34.941

- Non-divided Highway
 Bridge (on route)
 Railroad (at grade)
 Intersection
- Divided Highway
 Underpass
 Railroad (underpass)
- Secondary Segment
 Overpass
 Railroad (overpass)
- Corporation**

Created on: 6/24/2025

transportation.ohio.gov

Prepared by
The Ohio Department of Transportation
Office of Technical Services
Roadway Information

SBELSR00147**C

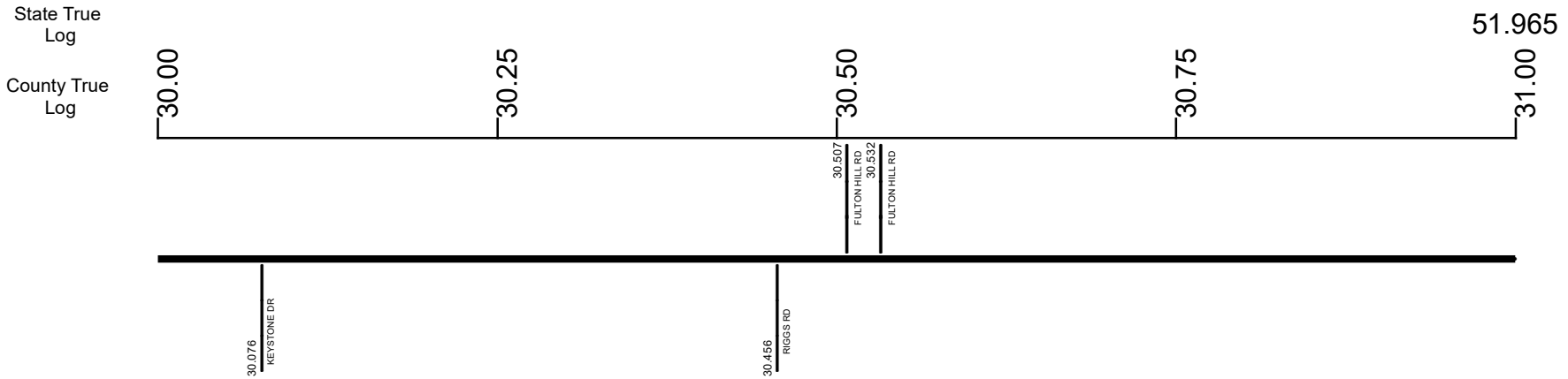

Surface Type & Width (Left / Right)	G 18'
	29.315 - 34.929
Base Type (Left / Right)	I
	29.315 - 34.929
Shoulder Type & Width (Left / Right)	5 (1/1')
	20.278 - 36.041
Through Lanes	2
	20.278 - 37.36
Street Name	KEY-BELLAIRE RD
	26.553 - 34.941

Non-divided Highway	Bridge (on route)	Railroad (at grade)	Intersection
Divided Highway	Underpass	Railroad (underpass)	
Secondary Segment	Overpass	Railroad (overpass)	
Corporation			

Created on: 6/24/2025

transportation.ohio.gov

Prepared by
The Ohio Department of Transportation
Office of Technical Services
Roadway Information

SBELSR00147**C

State True Log

52.965

County True Log

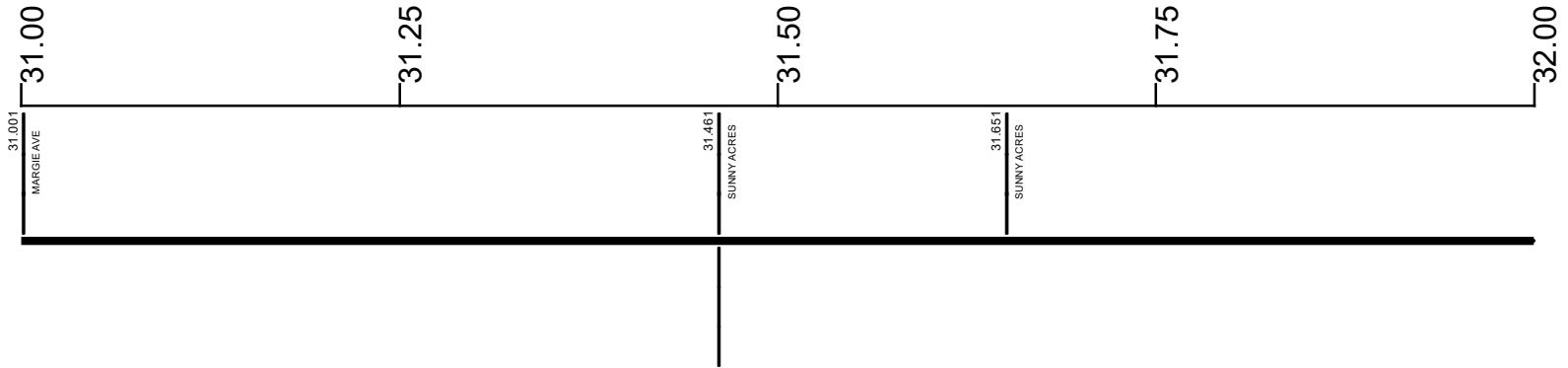

Surface Type & Width (Left / Right)

G 18'
29.315 - 34.929

Base Type (Left / Right)

I
29.315 - 34.929

Shoulder Type & Width (Left / Right)

5 (1/1')
20.278 - 36.041

Through Lanes

2
20.278 - 37.36

Street Name

KEY-BELLAIRE RD
26.553 - 34.941

- | | | | |
|---------------------|-------------------|----------------------|--------------|
| Non-divided Highway | Bridge (on route) | Railroad (at grade) | Intersection |
| Divided Highway | Underpass | Railroad (underpass) | |
| Secondary Segment | Overpass | Railroad (overpass) | |
| Corporation | | | |

Created on: 6/24/2025



transportation.ohio.gov

Prepared by
The Ohio Department of Transportation
Office of Technical Services
Roadway Information

SBELSR00147**C

State True Log
County True Log

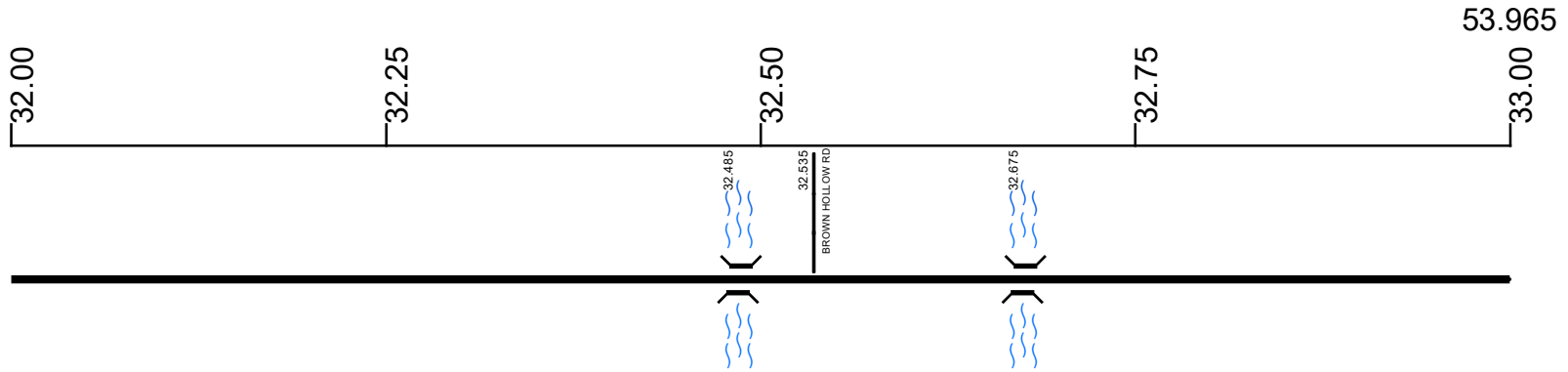

Surface Type & Width (Left / Right)

G 18'
29.315 - 34.929

Base Type (Left / Right)

I
29.315 - 34.929

Shoulder Type & Width (Left / Right)

5 (1/1')
20.278 - 36.041

Through Lanes

2
20.278 - 37.36

Street Name

KEY-BELLAIRE RD
26.553 - 34.941

- | | | | |
|---------------------|-------------------|----------------------|--------------|
| Non-divided Highway | Bridge (on route) | Railroad (at grade) | Intersection |
| Divided Highway | Underpass | Railroad (underpass) | |
| Secondary Segment | Overpass | Railroad (overpass) | |
| Corporation | | | |

Created on: 6/24/2025



transportation.ohio.gov
Prepared by
The Ohio Department of Transportation
Office of Technical Services
Roadway Information

SBELSR00147**C

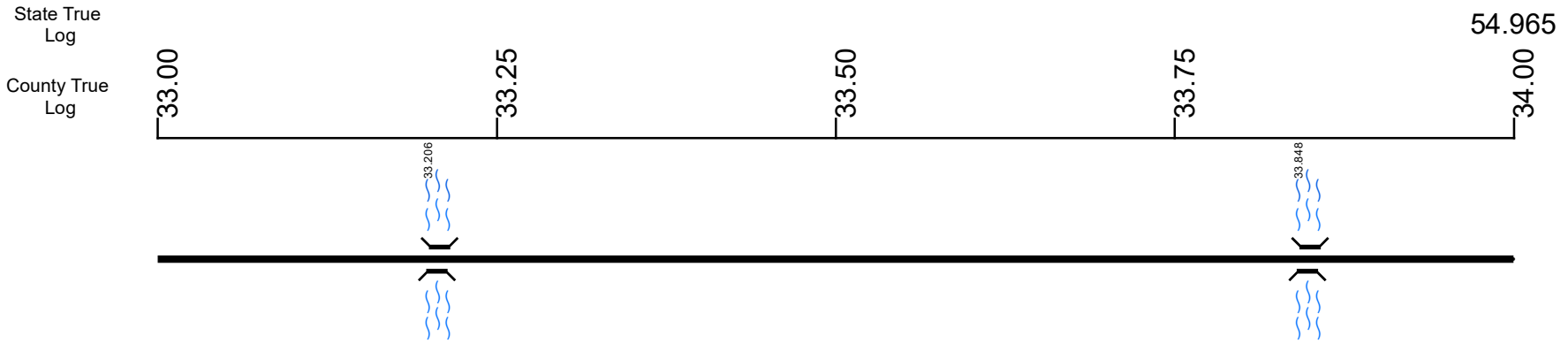

Surface Type & Width (Left / Right)	G 18'
	29.315 - 34.929
Base Type (Left / Right)	I
	29.315 - 34.929
Shoulder Type & Width (Left / Right)	5 (1/1')
	20.278 - 36.041
Through Lanes	2
	20.278 - 37.36
Street Name	KEY-BELLAIRE RD
	26.553 - 34.941

	Non-divided Highway		Bridge (on route)		Railroad (at grade)		Intersection
	Divided Highway		Underpass		Railroad (underpass)		
	Secondary Segment		Overpass		Railroad (overpass)		
	Corporation						

Created on: 6/24/2025

transportation.ohio.gov

Prepared by
The Ohio Department of Transportation
Office of Technical Services
Roadway Information

SBELSR00147**C

State True Log
County True Log

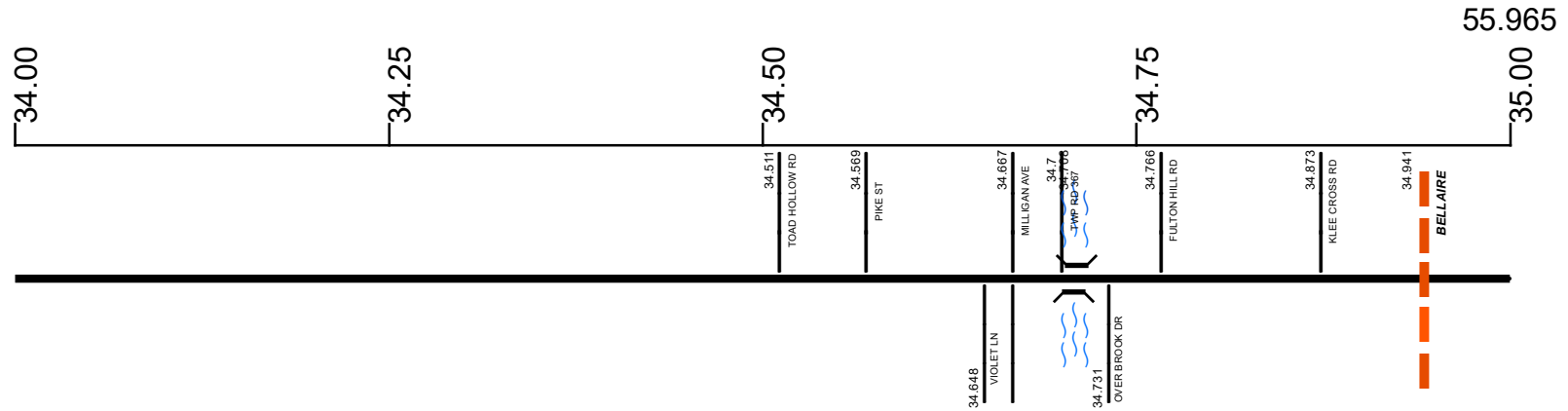

Surface Type & Width (Left / Right)	G 18'	G 20'
	29.315 - 34.929	34.929 - 36.041
Base Type (Left / Right)	I	N
	29.315 - 34.929	34.929 - 36.041
Shoulder Type & Width (Left / Right)	5 (1/1')	
	20.278 - 36.041	
Through Lanes	2	
	20.278 - 37.36	
Street Name	KEY-BELLAIRE RD	W 23RD ST
	26.553 - 34.941	34.941 - 36.041

Non-divided Highway	Bridge (on route)	Railroad (at grade)	Intersection
Divided Highway	Underpass	Railroad (underpass)	
Secondary Segment	Overpass	Railroad (overpass)	
Corporation			

Created on: 6/24/2025

transportation.ohio.gov

Prepared by
The Ohio Department of Transportation
Office of Technical Services
Roadway Information

SBELSR00147**C

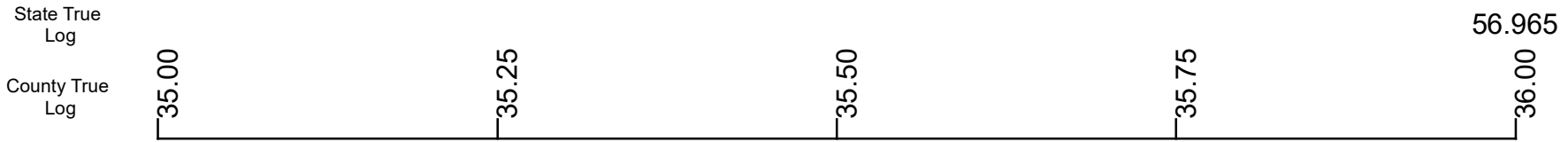

Surface Type & Width (Left / Right)	G 20'	34.929 - 36.041
Base Type (Left / Right)	N	34.929 - 36.041
Shoulder Type & Width (Left / Right)	5 (1/1')	20.278 - 36.041
Through Lanes	2	20.278 - 37.36
Street Name	W 23RD ST	34.941 - 36.041

Non-divided Highway	Bridge (on route)	Railroad (at grade)	Intersection
Divided Highway	Underpass	Railroad (underpass)	
Secondary Segment	Overpass	Railroad (overpass)	
Corporation			

Created on: 6/24/2025

transportation.ohio.gov
Prepared by
The Ohio Department of Transportation
Office of Technical Services
Roadway Information

SBELSR00147**C

State True Log

57.965

County True Log

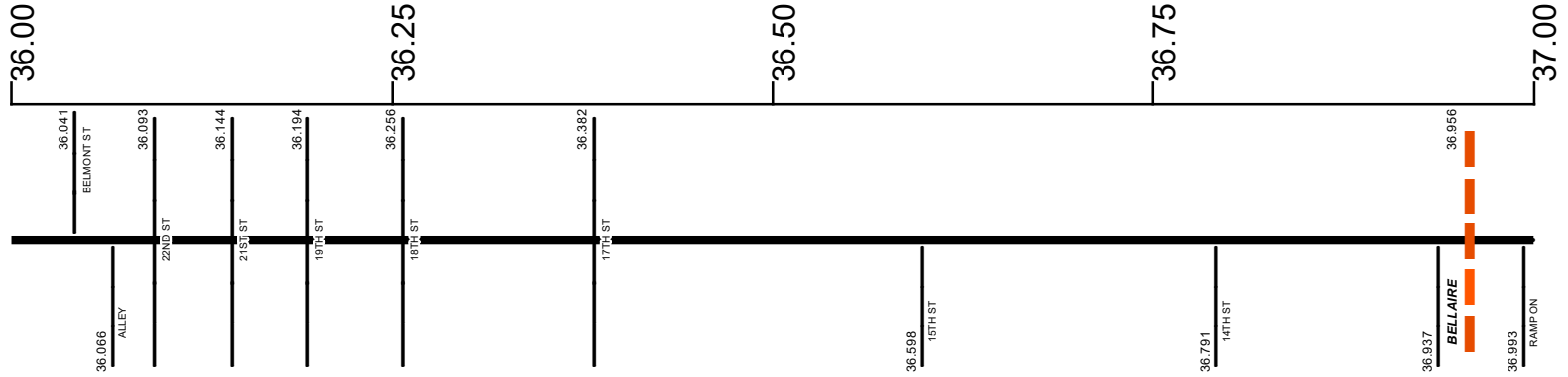

Surface Type & Width (Left / Right)

G 20'	G 30'
34.929 - 36.041	36.041 - 37.04

Base Type (Left / Right)

N	R
34.929 - 36.041	36.041 - 37.04

Shoulder Type & Width (Left / Right)

5 (1/1')	1 (0/0')
20.278 - 36.041	36.041 - 37.04

Through Lanes

	2
	20.278 - 37.36

Street Name

W 23RD ST	BELMONT ST	SR 147
34.941 - 36.041	36.041 - 36.937	36.937 - 37.36

- Non-divided Highway
- Divided Highway
- Secondary Segment
- Corporation
- Bridge (on route)
- Underpass
- Overpass
- Railroad (at grade)
- Railroad (underpass)
- Railroad (overpass)
- Intersection

Created on: 6/24/2025

transportation.ohio.gov

Prepared by
The Ohio Department of Transportation
Office of Technical Services
Roadway Information

SBELSR00147**C

State True
Log

58.325

County True
Log

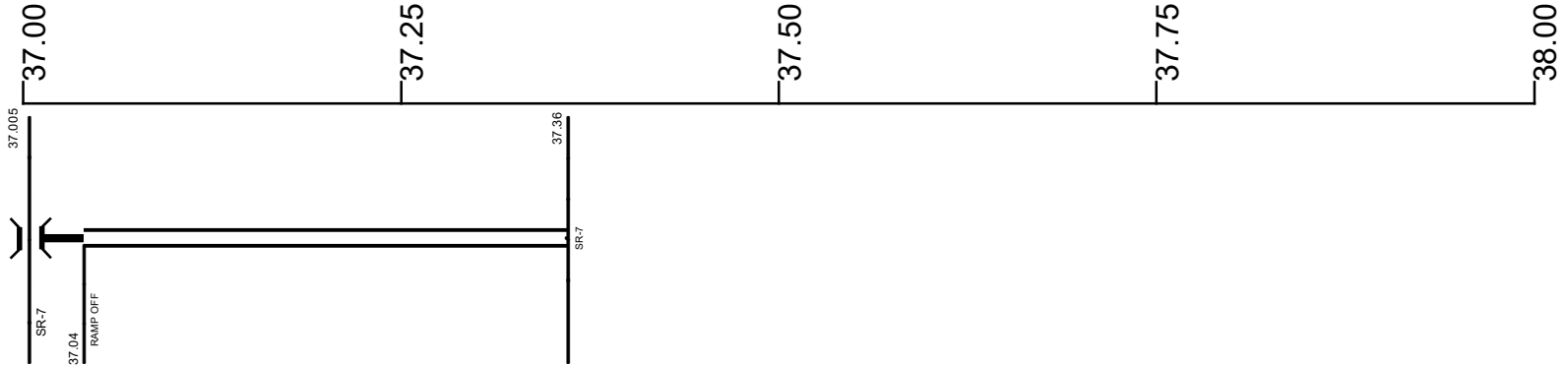

Surface Type & Width (Left / Right)

G 30'	D 32'
36.041 - 37.04	37.04 - 37.36

Base Type (Left / Right)

R

36.041 - 37.04

Shoulder Type & Width (Left / Right)

1 (0/0')	2 (6/14')
36.041 - 37.04	37.04 - 37.36

Median Type and Width

2 (99')
37.04 - 37.36

Through Lanes

2
20.278 - 37.36

Street Name

SR 147
36.937 - 37.36

<p> Non-divided Highway</p> <p> Divided Highway</p> <p> Secondary Segment</p> <p> Corporation</p>	<p> Bridge (on route)</p> <p> Underpass</p> <p> Overpass</p>	<p> Railroad (at grade)</p> <p> Railroad (underpass)</p> <p> Railroad (overpass)</p>	<p> Intersection</p>
---	--	--	----------------------

Created on: 6/24/2025

transportation.ohio.gov

Prepared by
The Ohio Department of Transportation
Office of Technical Services
Roadway Information

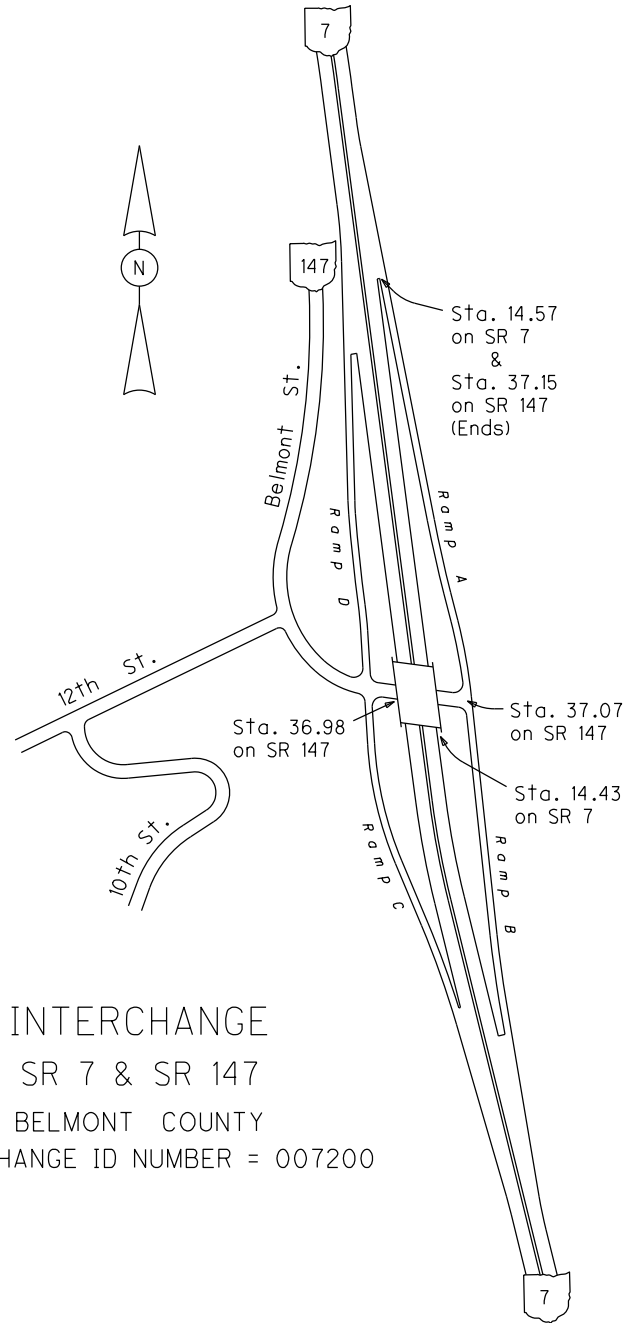

INTERCHANGE
 SR 7 & SR 147
 BELMONT COUNTY
 INTERCHANGE ID NUMBER = 007200

Historical Project List for SBELSR00147**C

Begin Measure	End Measure	Project ID Number	Construction Completion Date	Treatment Category	Treatment Type
0.000	4.159	105272	9-2022	Preventive Maintenance	25-Chip Seal
0.000	13.228	85106	12-2014	Minor Rehabilitation	60-AC Overlay w/Rpr
0.000	5.613	19408	8-2002	Minor Rehabilitation	60-AC Overlay w/Rpr
6.304	13.258	19408	8-2002	Minor Rehabilitation	60-AC Overlay w/Rpr
13.228	13.606	107487	11-2021	Minor Rehabilitation	60-AC Overlay w/Rpr
13.258	13.983	76410	7-2008	Minor Rehabilitation	60-AC Overlay w/Rpr
13.606	19.500	107487	11-2021	Minor Rehabilitation	60-AC Overlay w/Rpr
13.983	19.500	80419	7-2010	Minor Rehabilitation	60-AC Overlay w/Rpr
20.278	29.195	87278	5-2016	Minor Rehabilitation	60-AC Overlay w/Rpr
20.278	36.256	23991	9-2003	Minor Rehabilitation	60-AC Overlay w/Rpr
29.195	29.315	87278	5-2016	Minor Rehabilitation	60-AC Overlay w/Rpr
29.315	33.507	87278	5-2016	Minor Rehabilitation	60-AC Overlay w/Rpr
33.507	34.929	87278	5-2016	Minor Rehabilitation	60-AC Overlay w/Rpr
34.929	37.177	87296	11-2016	Minor Rehabilitation	50-AC Overlay w/o Rpr

Roadway Codes

Access Control Journalized

- F - Full Access Control
- L - Limited Access Control
- N - No Access Control

Access Control Operational

- 1 - Full Access Control
- 2 - Partial Access Control
- 3 - No Access Control

Base Type

- F - Crack and Seat
- H - Rubblize and Roll
- I - Aggregate Base 304 or Traffic Compacted
- K - Water Bound Macadam
- L - Bituminous Concrete Mix or Penetration Macadam
- N - Plain Concrete
- P - Reinforced Concrete
- R - Brick (Flexible)
- T - Brick (Rigid)

Direction of Travel

- B - Both (Two-way)
- F - One-way Cardinal
- T - One-way Non-cardinal

Facility Type

- 1 - One-way Roadway
- 2 - Two-way Roadway
- 4 - Ramp
- 5 - Non-mainline
- 6 - Non-inventory Direction
- 7 - Planned / Unbuilt

Historical Federal Aid Indicator

- N - Not a FAP Route
- Y - FAP Route

Functional Classification

- 01 - Interstate
- 02 - Principal Arterial (Freeways)
- 03 - Principal Arterial (Other)
- 04 - Minor Arterial
- 05 - Major Collector
- 06 - Minor Collector
- 07 - Local

Leave / Reenter Indicator

- Y - Route leaves/reenters at this point
- N - Route does not leave/reenter at this point

Median Type

- 1 - None
- 2 - Unprotected
- 3 - Curbed
- 4 - Positive Barrier (Unspecified)
- 5 - Positive Barrier (Flexible)
- 6 - Positive Barrier (Semi-rigid)
- 7 - Positive Barrier (Rigid)

NHS

- N - National Highway System
- H - Congressional Corridor
- 2 - Major Airport
- 3 - Major Port Facility
- 4 - Major Amtrak Station
- 5 - Major Rail / Truck Terminal
- 6 - Major Intercity Bus Terminal
- 7 - Major Public Transit / Multi-modal Passenger Terminal
- 8 - Major Pipeline Terminal
- 9 - Major Ferry Terminal

Priority System

- G - General
- P - Priority System
- U - Urban

Scenic Byway Code

- A - All American Road
- N - National Scenic Byway
- S - State Scenic Byway

Shoulder Type

- 1 - None
- 2 - Surfaced shoulder exists (bituminous concrete {AC})
- 3 - Surfaced shoulder exists (Portland Cement Concrete {PCC})
- 4 - Stabilized shoulder exists (gravel or other granular material)
- 5 - Combination shoulder exists (two or more surface types)
- 6 - Earth shoulder exists
- 7 - Barrier curb exists; no shoulder in front of curb

Surface Type

- A - Combination
- B - Brick
- C - Continuous Reinforced Concrete
- D - Reinforced Concrete
- E - Plain Concrete
- G - Bituminous Concrete
- I - Chipseal on Granular
- K - Open Graded Bituminous
- L - Chipseal or Micro
- M - Gravel
- U - Unimproved
- X - Right of Way Only