

SBELSR00149**C

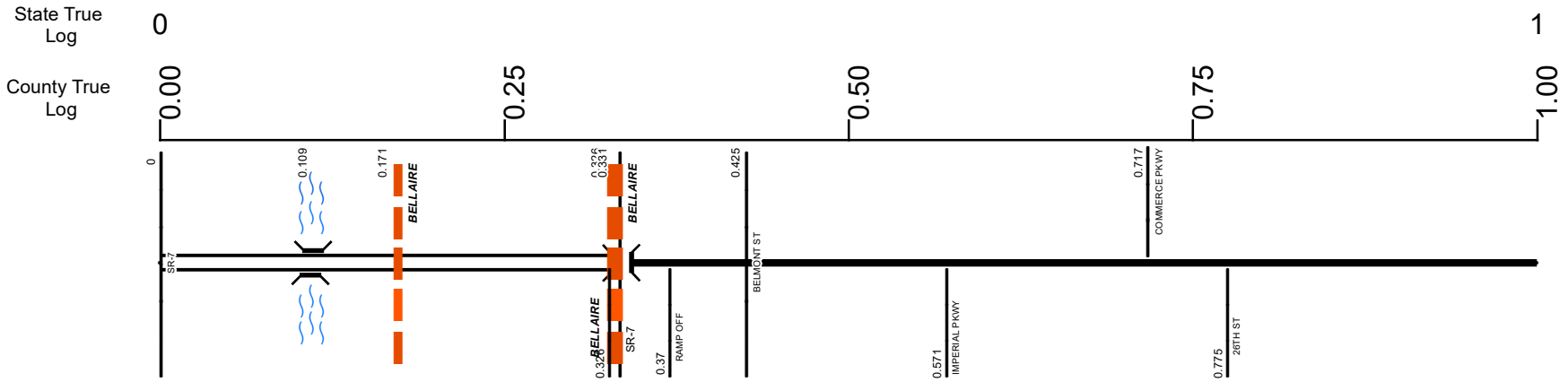

Surface Type & Width (Left / Right)			
D 32'	D 24'	G 24'	G 48'
0 - 0.326	0.326 - 0.37	0.37 - 0.425	0.425 - 0.816
			G 28'
			0.816 - 1.862
Base Type (Left / Right)			
L			
0.37 - 5.006			
Shoulder Type & Width (Left / Right)			
2 (8'/8')	5 (0'/0')	1 (0'/0')	
0 - 0.326	0.326 - 0.425	0.425 - 1.862	
Median Type and Width			
2 (9999')			
0 - 0.326			
Through Lanes			
2	4		2
0 - 0.425	0.425 - 0.816		0.816 - 14.285
Street Name			
OFF RAMP	E 26TH ST	W 26TH ST	
0 - 0.326	0.326 - 0.425	0.425 - 1.319	

<ul style="list-style-type: none"> Non-divided Highway Divided Highway Secondary Segment Corporation 	<ul style="list-style-type: none"> Bridge (on route) Underpass Overpass 	<ul style="list-style-type: none"> Railroad (at grade) Railroad (underpass) Railroad (overpass) 	<ul style="list-style-type: none"> Intersection
--	---	---	---

Created on: 6/24/2025

transportation.ohio.gov

Prepared by
 The Ohio Department of Transportation
 Office of Technical Services
 Roadway Information

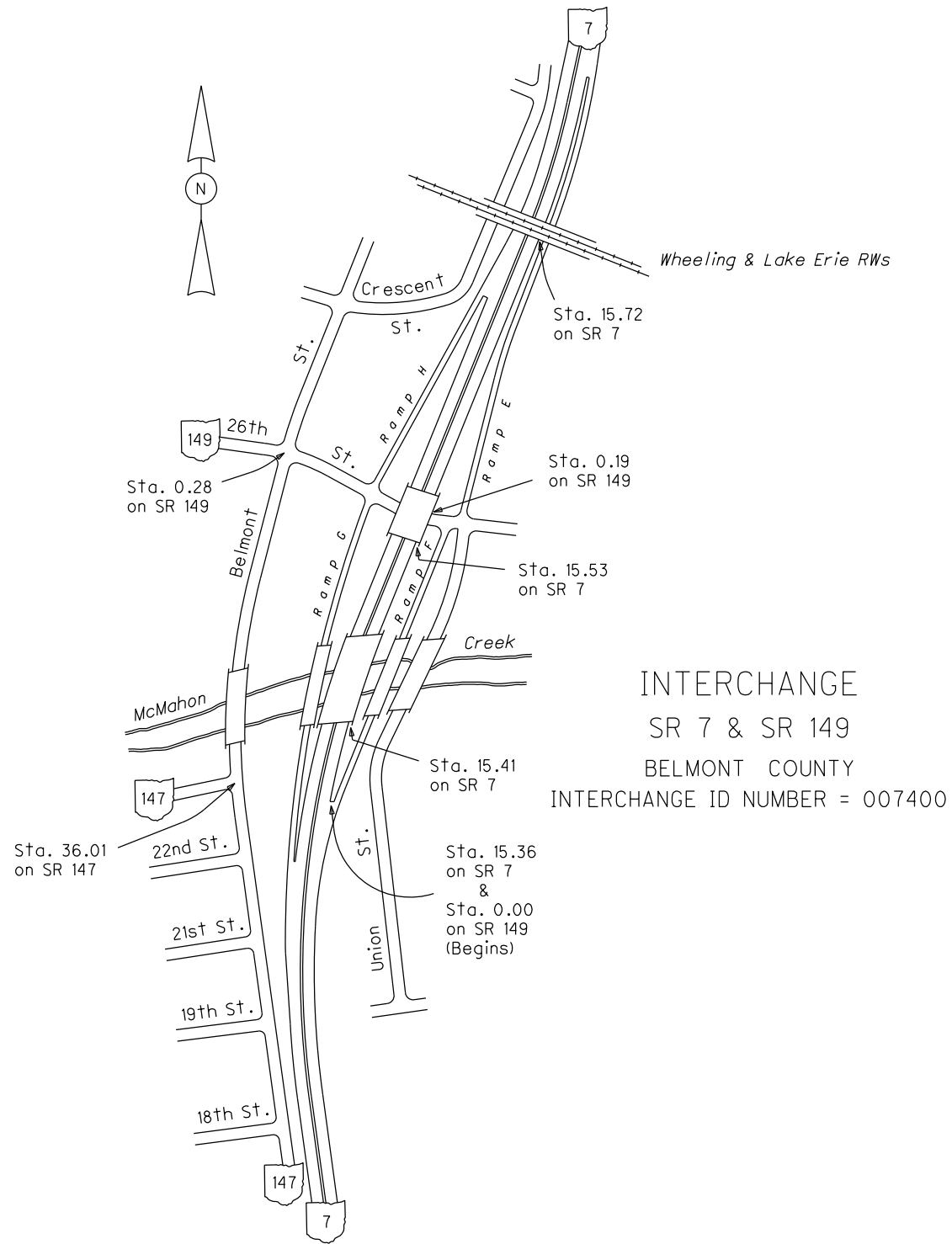

INTERCHANGE
 SR 7 & SR 149
 BELMONT COUNTY
 INTERCHANGE ID NUMBER = 007400

SBELSR00149**C

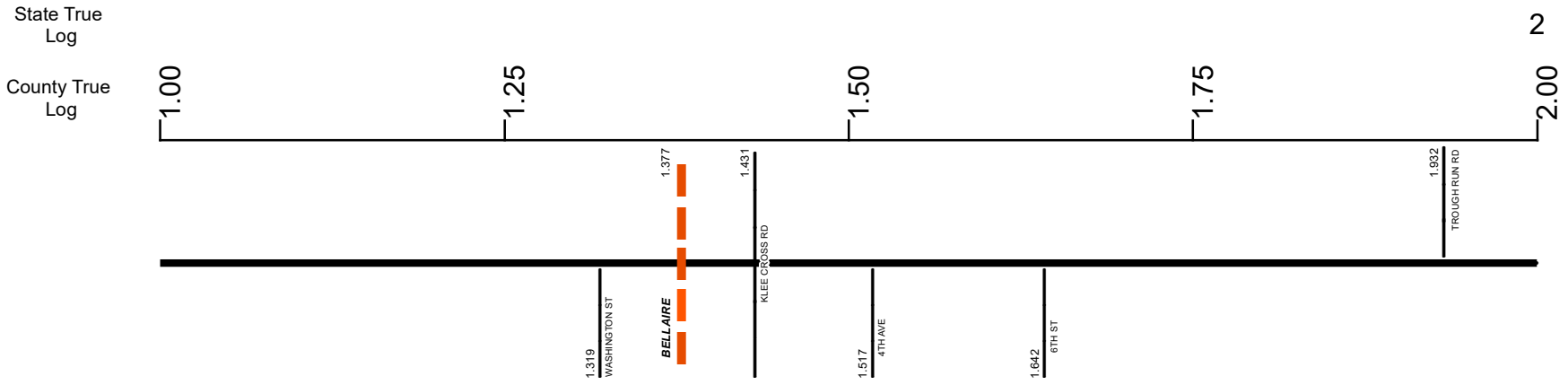

Surface Type & Width (Left / Right)

G 28' 0.816 - 1.862	G 24' 1.862 - 5.006
------------------------	------------------------

Base Type (Left / Right)

L 0.37 - 5.006

Shoulder Type & Width (Left / Right)

1 (0'/0') 0.425 - 1.862	2 (2'/4')	2 (2'/2')
----------------------------	-----------	-----------

Through Lanes

2 0.816 - 14.285

Street Name

W 26TH ST 0.425 - 1.319	W 26TH RD 1.319 - 1.411	NEFFS-BELLAIRE RD 1.411 - 4.347
----------------------------	----------------------------	------------------------------------

Non-divided Highway	Bridge (on route)	Railroad (at grade)	Intersection
Divided Highway	Underpass	Railroad (underpass)	
Secondary Segment	Overpass	Railroad (overpass)	
Corporation			

Created on: 6/24/2025

transportation.ohio.gov

Prepared by
The Ohio Department of Transportation
Office of Technical Services
Roadway Information

SBELSR00149**C

State True Log

County True Log

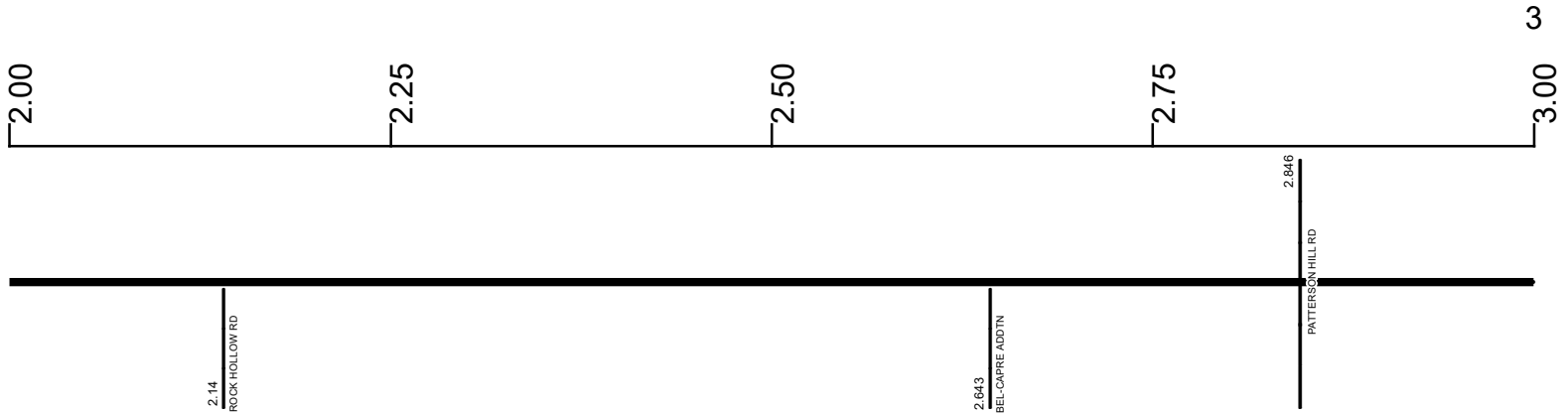

Surface Type & Width (Left / Right)	G 24' 1.862 - 5.006
Base Type (Left / Right)	L 0.37 - 5.006
Shoulder Type & Width (Left / Right)	2 (2'/2') 1.972 - 5.289
Through Lanes	2 0.816 - 14.285
Street Name	NEFFS-BELLAIRE RD 1.411 - 4.347

- | | | | |
|---------------------|-------------------|----------------------|--------------|
| Non-divided Highway | Bridge (on route) | Railroad (at grade) | Intersection |
| Divided Highway | Underpass | Railroad (underpass) | |
| Secondary Segment | Overpass | Railroad (overpass) | |
| Corporation | | | |

Created on: 6/24/2025

transportation.ohio.gov

Prepared by
The Ohio Department of Transportation
Office of Technical Services
Roadway Information

SBELSR00149**C

State True Log

4

County True Log

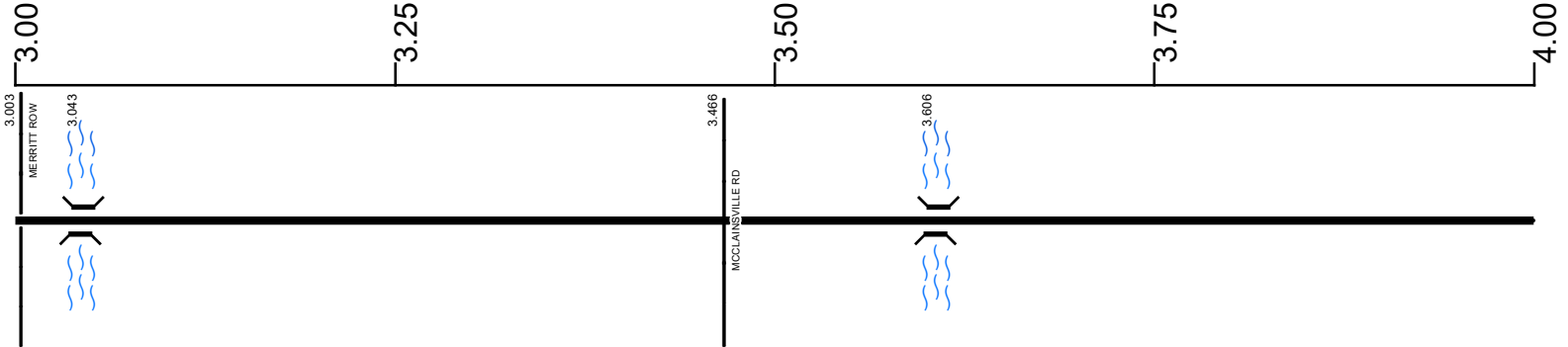

Surface Type & Width (Left / Right)

G 24'
1.862 - 5.006

Base Type (Left / Right)

L
0.37 - 5.006

Shoulder Type & Width (Left / Right)

2 (2 1/2)
1.972 - 5.289

Through Lanes

2
0.816 - 14.285

Street Name

NEFFS-BELLAIRE RD
1.411 - 4.347

- | | | | |
|---------------------|-------------------|----------------------|--------------|
| Non-divided Highway | Bridge (on route) | Railroad (at grade) | Intersection |
| Divided Highway | Underpass | Railroad (underpass) | |
| Secondary Segment | Overpass | Railroad (overpass) | |
| Corporation | | | |

Created on: 6/24/2025

SBELSR00149**C

State True Log

County True Log

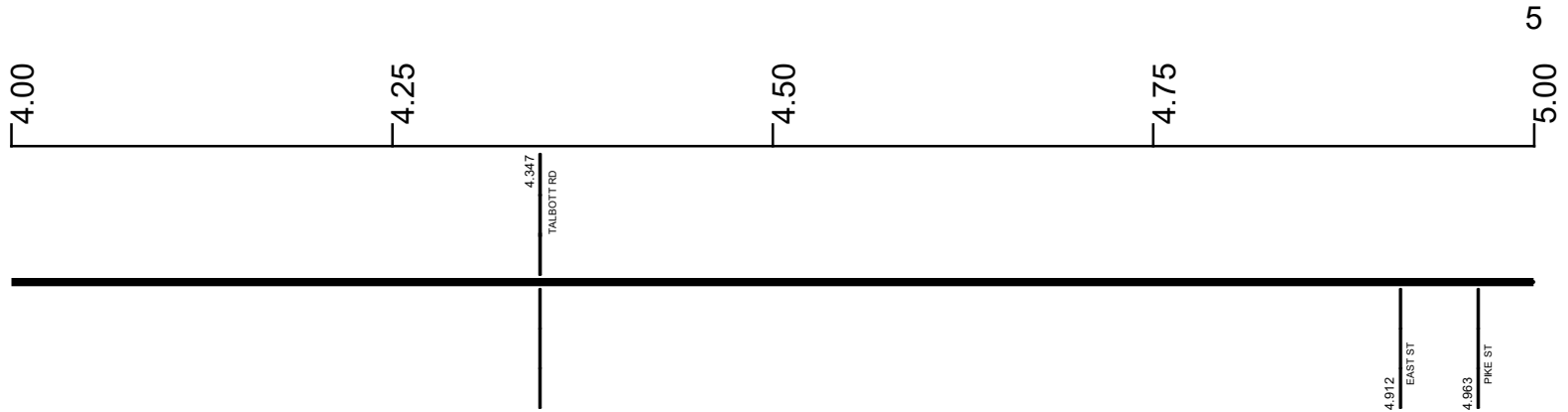

Surface Type & Width (Left / Right)

	G 24'
	1.862 - 5.006

Base Type (Left / Right)

	L
	0.37 - 5.006

Shoulder Type & Width (Left / Right)

	2 (2 1/2')
	1.972 - 5.289

Through Lanes

	2
	0.816 - 14.285

Street Name

NEFFS-BELLAIRE RD	ST JOE ST	PIKE ST
1.411 - 4.347	4.347 - 4.912	4.912 - 5.983

- | | | | |
|---------------------|-------------------|----------------------|--------------|
| Non-divided Highway | Bridge (on route) | Railroad (at grade) | Intersection |
| Divided Highway | Underpass | Railroad (underpass) | |
| Secondary Segment | Overpass | Railroad (overpass) | |
| Corporation | | | |

Created on: 6/24/2025

transportation.ohio.gov

Prepared by
The Ohio Department of Transportation
Office of Technical Services
Roadway Information

SBELSR00149**C

State True Log

6

County True Log

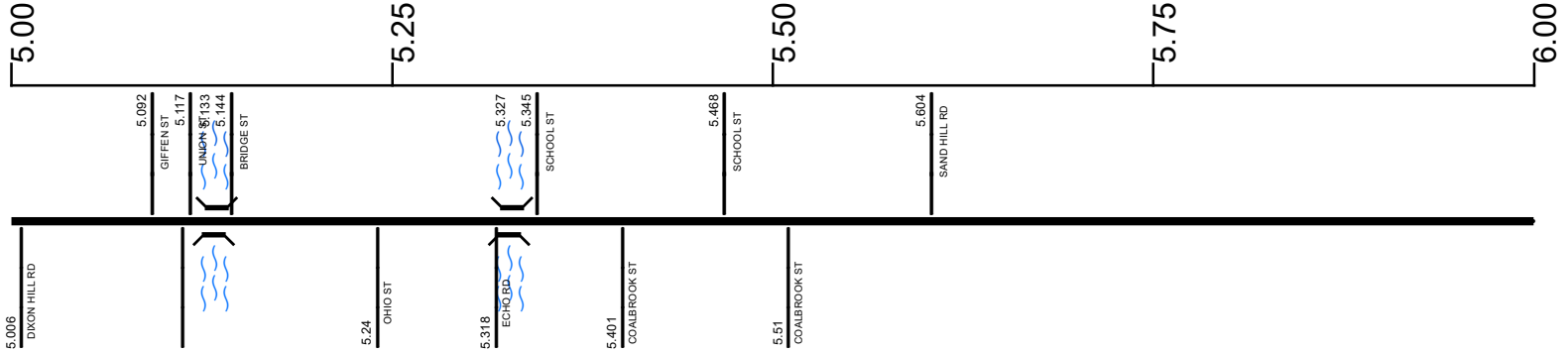

Surface Type & Width (Left / Right)

0.37 - 5.006	5.006 - 5.289	5.289 - 5.379	5.379 - 11.157
G 24'	G (16'4')	G 22'	G (16'4')

Base Type (Left / Right)

0.37 - 5.006	5.006 - 5.289	5.289 - 5.379	5.379 - 11.157
N / I	L	N / I	N / I

Shoulder Type & Width (Left / Right)

1.972 - 5.289	5.289 - 11.157
2 (2'2')	2 (1'1')

Through Lanes

0.816 - 14.285
2

Street Name

4.912 - 5.983	5.983 - 6.499
PIKE ST	STEWARTSVILLE-NEFFS RD

- Non-divided Highway
- Divided Highway
- Secondary Segment
- Corporation
- Bridge (on route)
- Underpass
- Overpass
- Railroad (at grade)
- Railroad (underpass)
- Railroad (overpass)
- Intersection

Created on: 6/24/2025



transportation.ohio.gov

Prepared by
The Ohio Department of Transportation
Office of Technical Services
Roadway Information

SBELSR00149**C

State True Log

7

County True Log

6.00

6.25

6.50

6.75

7.00

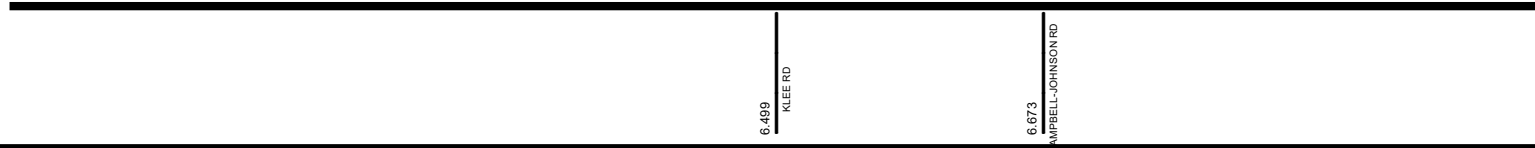

Surface Type & Width (Left / Right)

G (16'4')
5.379 - 10.936

Base Type (Left / Right)

N / I
5.379 - 11.157

Shoulder Type & Width (Left / Right)

2 (1'1")
5.289 - 11.157

Through Lanes

2
0.816 - 14.285

Street Name

STEWARTSVILLE-NEFFS RD 5.983 - 6.499	STATE HIGHWAY 149 6.499 - 8.119
---	------------------------------------

- | | | | |
|---------------------|-------------------|----------------------|--------------|
| Non-divided Highway | Bridge (on route) | Railroad (at grade) | Intersection |
| Divided Highway | Underpass | Railroad (underpass) | |
| Secondary Segment | Overpass | Railroad (overpass) | |
| Corporation | | | |

Created on: 6/24/2025

transportation.ohio.gov

Prepared by
The Ohio Department of Transportation
Office of Technical Services
Roadway Information

SBELSR00149**C

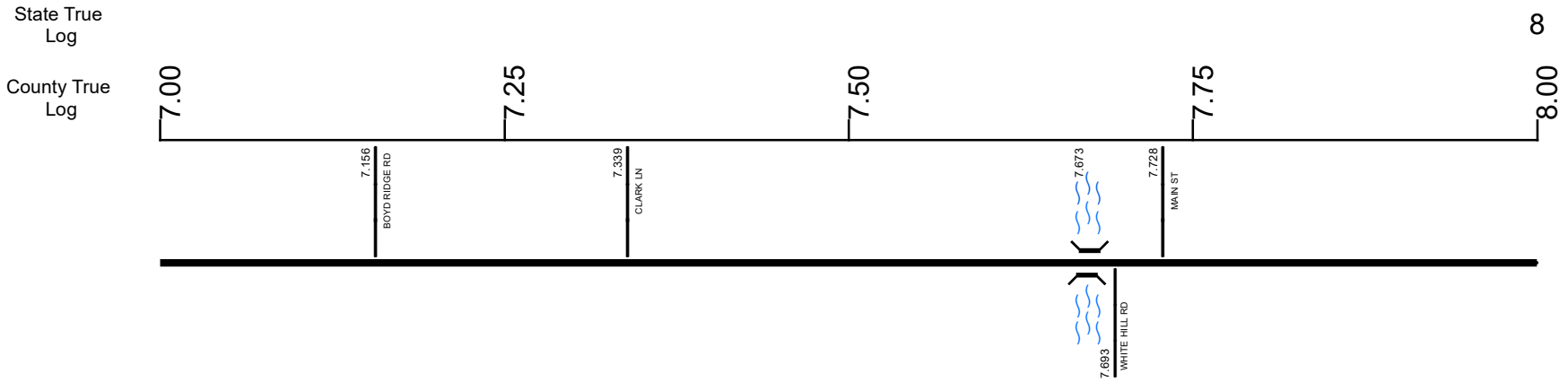

Surface Type & Width (Left / Right)	G (16'/4')
	5.379 - 10.936
Base Type (Left / Right)	N / I
	5.379 - 11.157
Shoulder Type & Width (Left / Right)	2 (1'/1')
	5.289 - 11.157
Through Lanes	2
	0.816 - 14.285
Street Name	STATE HIGHWAY 149
	6.499 - 8.119

	Non-divided Highway		Bridge (on route)		Railroad (at grade)		Intersection
	Divided Highway		Underpass		Railroad (underpass)		
	Secondary Segment		Overpass		Railroad (overpass)		
	Corporation						

Created on: 6/24/2025



transportation.ohio.gov
 Prepared by
 The Ohio Department of Transportation
 Office of Technical Services
 Roadway Information

SBELSR00149**C

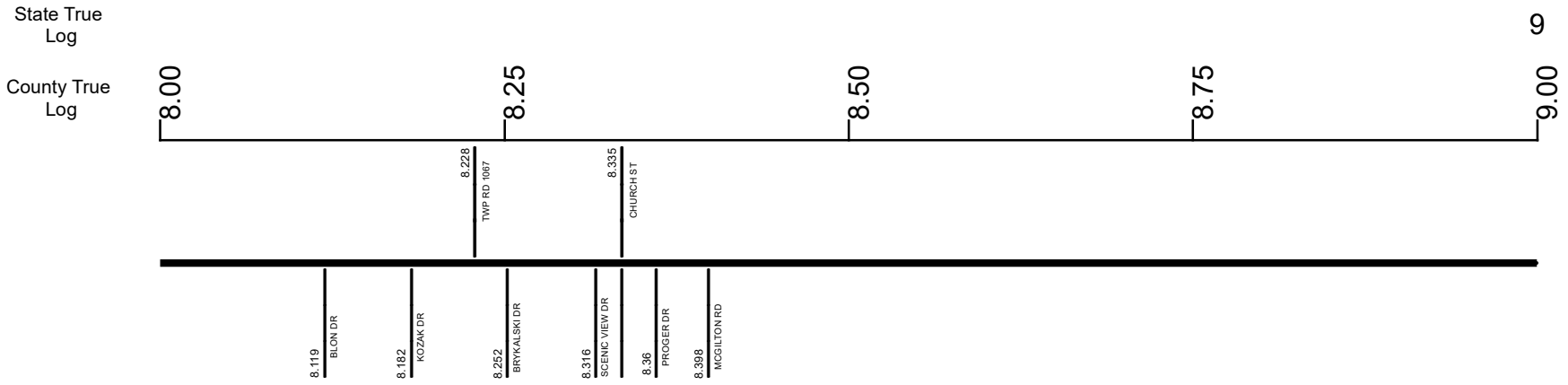

Surface Type & Width (Left / Right)	G (16'4')
	5.379 - 10.936
Base Type (Left / Right)	N / I
	5.379 - 11.157
Shoulder Type & Width (Left / Right)	2 (1'1')
	5.289 - 11.157
Through Lanes	2
	0.816 - 14.285
Street Name	GLENCOE-STEWARTSVILLE RD
STATE HIGHWAY 149	8.119 - 10.556
6.499 - 8.119	

<p> Non-divided Highway</p> <p> Divided Highway</p> <p> Secondary Segment</p> <p> Corporation</p>	<p> Bridge (on route)</p> <p> Underpass</p> <p> Overpass</p>	<p> Railroad (at grade)</p> <p> Railroad (underpass)</p> <p> Railroad (overpass)</p>	<p> Intersection</p>
---	--	--	----------------------

Created on: 6/24/2025

transportation.ohio.gov

Prepared by

The Ohio Department of Transportation

Office of Technical Services

Roadway Information

SBELSR00149**C

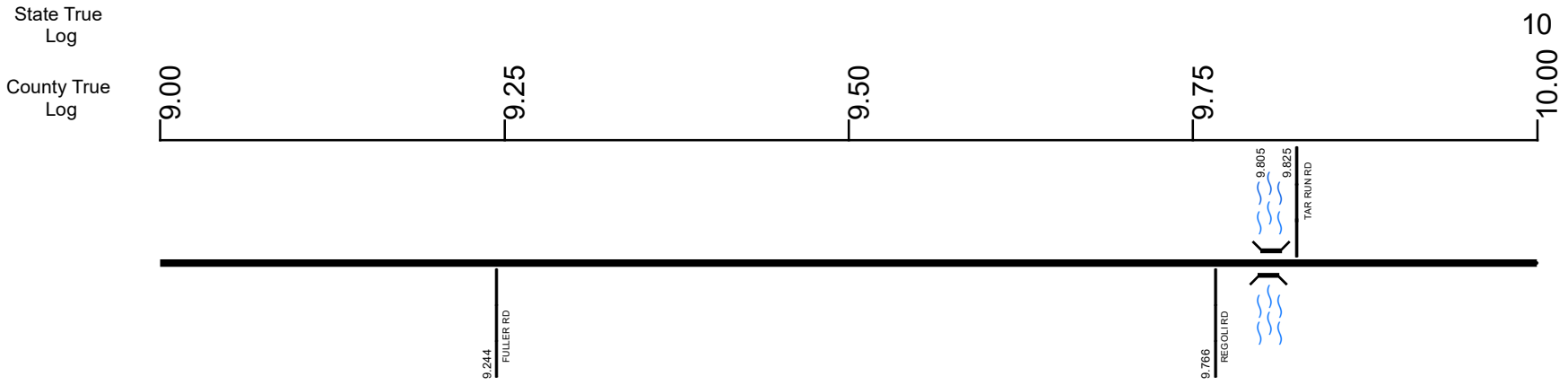

Surface Type & Width (Left / Right)	G (16'4')
	5.379 - 10.936
Base Type (Left / Right)	N / I
	5.379 - 11.157
Shoulder Type & Width (Left / Right)	2 (1'1')
	5.289 - 11.157
Through Lanes	2
	0.816 - 14.285
Street Name	GLENCOE-STEWARTSVILLE RD
	8.119 - 10.556

Non-divided Highway	Bridge (on route)	Railroad (at grade)	Intersection
Divided Highway	Underpass	Railroad (underpass)	
Secondary Segment	Overpass	Railroad (overpass)	
Corporation			

Created on: 6/24/2025

transportation.ohio.gov

Prepared by
The Ohio Department of Transportation
Office of Technical Services
Roadway Information

SBELSR00149**C

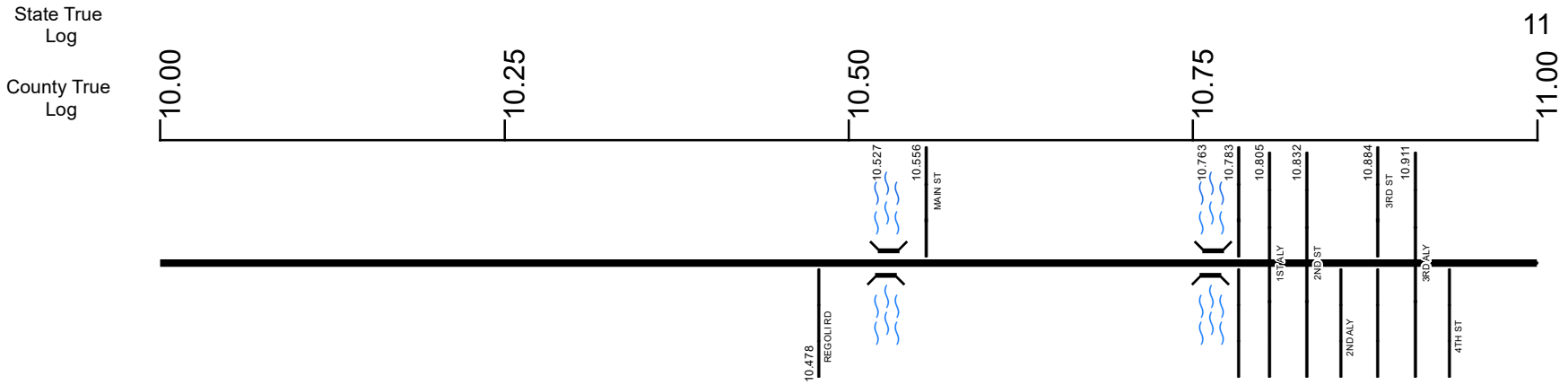

Surface Type & Width (Left / Right)	G (16'4") 5.379 - 10.936	G (16'2") 10.936 - 11.277
Base Type (Left / Right)	N / I 5.379 - 11.157	
Shoulder Type & Width (Left / Right)	2 (1'1") 5.289 - 11.157	
Through Lanes	2 0.816 - 14.285	
Street Name	GLENCOE-STEWARTSVILLE RD 8.119 - 10.556	MAIN ST 10.556 - 10.936
		4TH ST 10.936 - 11.017

- Non-divided Highway
- Divided Highway
- Secondary Segment
- Corporation
- Bridge (on route)
- Underpass
- Overpass
- Railroad (at grade)
- Railroad (underpass)
- Railroad (overpass)
- Intersection

Created on: 6/24/2025



transportation.ohio.gov
 Prepared by
 The Ohio Department of Transportation
 Office of Technical Services
 Roadway Information

SBELSR00149**C

State True Log
County True Log

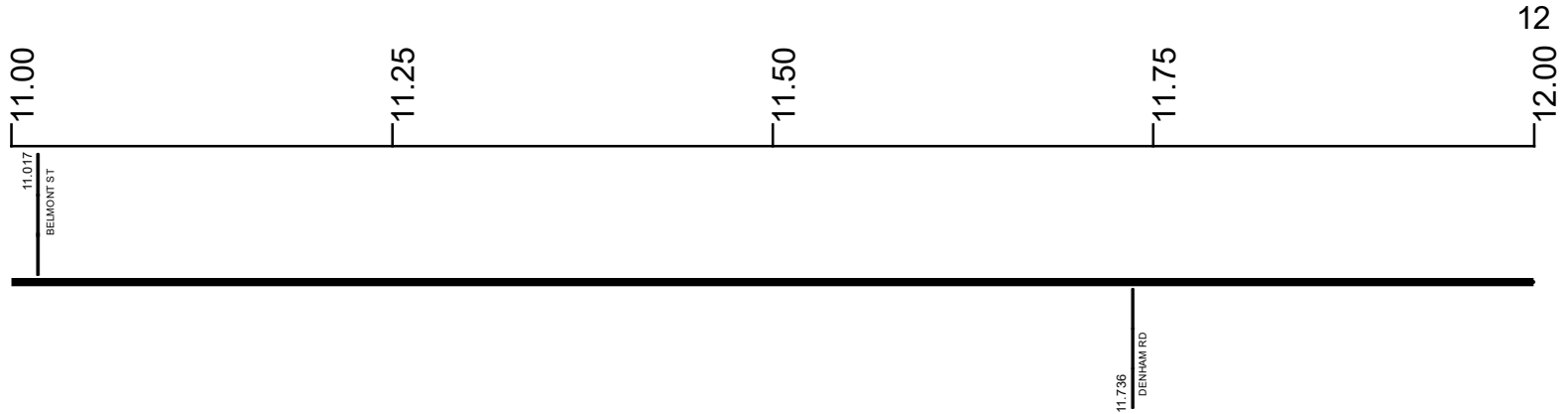

Surface Type & Width (Left / Right)

G (16'2") 10.936 - 11.277	G 20' 11.277 - 11.406	G (16'2") 11.406 - 14.285
------------------------------	--------------------------	------------------------------

Base Type (Left / Right)

N / I 5.379 - 11.157	N / L 11.157 - 14.285
-------------------------	--------------------------

Shoulder Type & Width (Left / Right)

2 (1'1") 5.289 - 11.157	5 (1'1") 11.157 - 14.285
----------------------------	-----------------------------

Resurface Year

2024 11.157 - 14.285

Through Lanes

2 0.816 - 14.285

Street Name

4TH ST 10.936 - 11.017	WARNOCK-GLENCOE RD 11.017 - 14.285
---------------------------	---------------------------------------

- Non-divided Highway
- Divided Highway
- Secondary Segment
- Corporation
- Bridge (on route)
- Underpass
- Overpass
- Railroad (at grade)
- Railroad (underpass)
- Railroad (overpass)
- Intersection

Created on: 6/24/2025

transportation.ohio.gov
Prepared by
The Ohio Department of Transportation
Office of Technical Services
Roadway Information

SBELSR00149**C

State True Log
County True Log

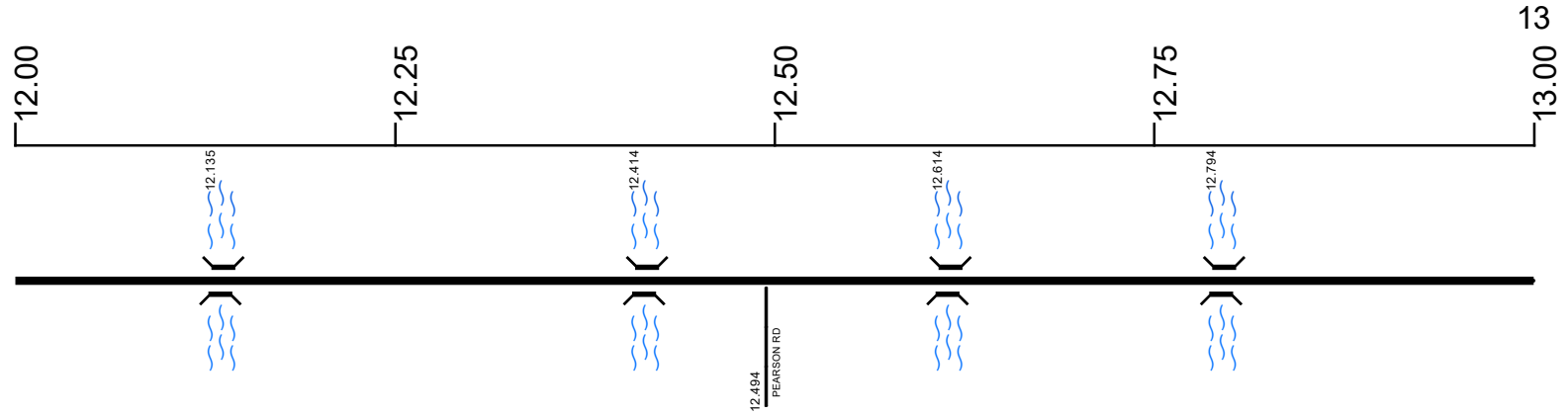

Surface Type & Width (Left / Right)

G (16/2')
11.406 - 14.285

Base Type (Left / Right)

N / L
11.157 - 14.285

Shoulder Type & Width (Left / Right)

5 (1/1')
11.157 - 14.285

Resurface Year

2024
11.157 - 14.285

Through Lanes

2
0.816 - 14.285

Street Name

WARNOCK-GLENCOE RD
11.017 - 14.285

- | | | | |
|---------------------|-------------------|----------------------|--------------|
| Non-divided Highway | Bridge (on route) | Railroad (at grade) | Intersection |
| Divided Highway | Underpass | Railroad (underpass) | |
| Secondary Segment | Overpass | Railroad (overpass) | |
| Corporation | | | |

Created on: 6/24/2025



transportation.ohio.gov
Prepared by
The Ohio Department of Transportation
Office of Technical Services
Roadway Information

SBELSR00149**C

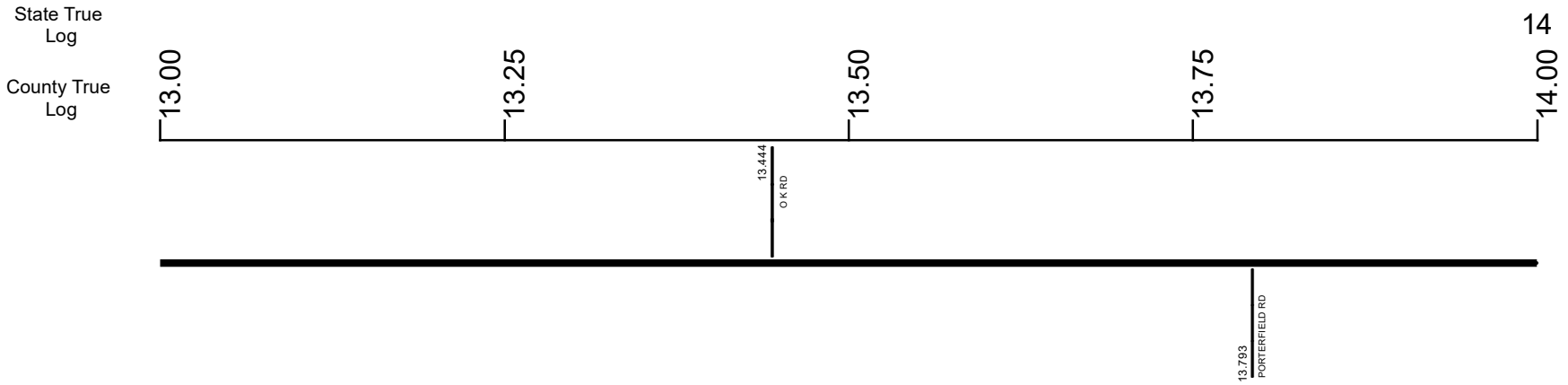

Surface Type & Width (Left / Right)	G (16/2')
	11.406 - 14.285
Base Type (Left / Right)	N / L
	11.157 - 14.285
Shoulder Type & Width (Left / Right)	5 (1/1')
	11.157 - 14.285
Resurface Year	2024
	11.157 - 14.285
Through Lanes	2
	0.816 - 14.285
Street Name	WARNOCK-GLENCOE RD
	11.017 - 14.285

Non-divided Highway	Bridge (on route)	Railroad (at grade)	Intersection
Divided Highway	Underpass	Railroad (underpass)	
Secondary Segment	Overpass	Railroad (overpass)	
Corporation			

Created on: 6/24/2025

transportation.ohio.gov

Prepared by
The Ohio Department of Transportation
Office of Technical Services
Roadway Information

SBELSR00149**C

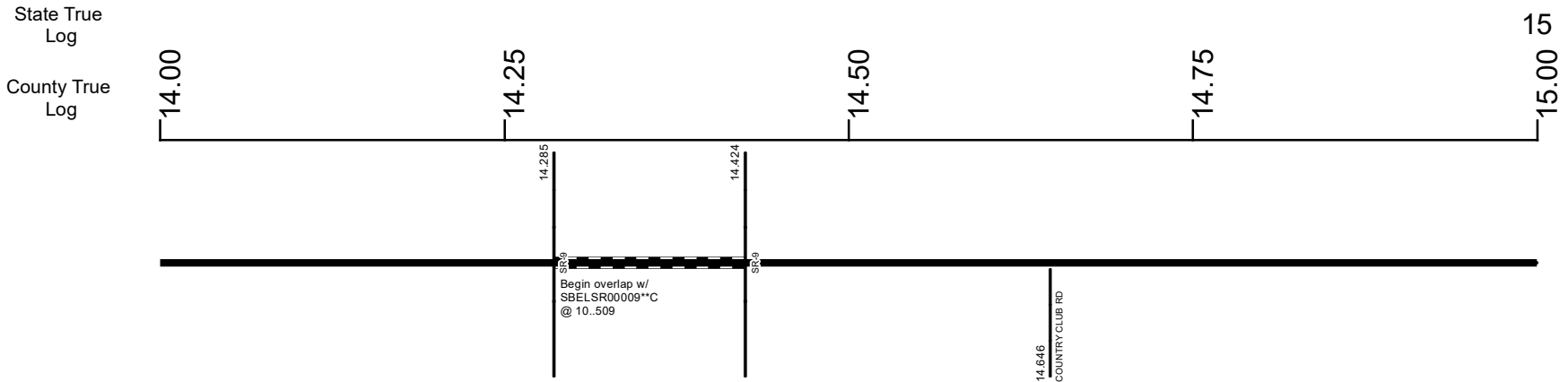

Surface Type & Width (Left / Right)
G (16'2')
11.406 - 14.285
Base Type (Left / Right)
N / L
11.157 - 14.285
Shoulder Type & Width (Left / Right)
5 (1'1')
11.157 - 14.285

Resurface Year
2024
11.157 - 14.285
Through Lanes
2
0.816 - 14.285
WARNOCK-GLENCOE RD
11.017 - 14.285

Surface Type & Width (Left / Right)
G (16'4')
14.424 - 15.859
Base Type (Left / Right)
N / L
14.424 - 15.859
Shoulder Type & Width (Left / Right)
5 (2'2')
14.424 - 20.775

Resurface Year	
2024	
14.424 - 20.709	
Through Lanes	
2	
14.424 - 21.02	
Street Name	
W BROOKLYN ST	BELMONT-WARNOCK RD
14.424 - 14.646	14.646 - 18.037

- Non-divided Highway
- Divided Highway
- Secondary Segment
- Corporation
- Bridge (on route)
- Underpass
- Overpass
- Railroad (at grade)
- Railroad (underpass)
- Railroad (overpass)
- Intersection

Created on: 6/24/2025



transportation.ohio.gov

Prepared by
The Ohio Department of Transportation
Office of Technical Services
Roadway Information

SBELSR00149**C

State True Log
County True Log

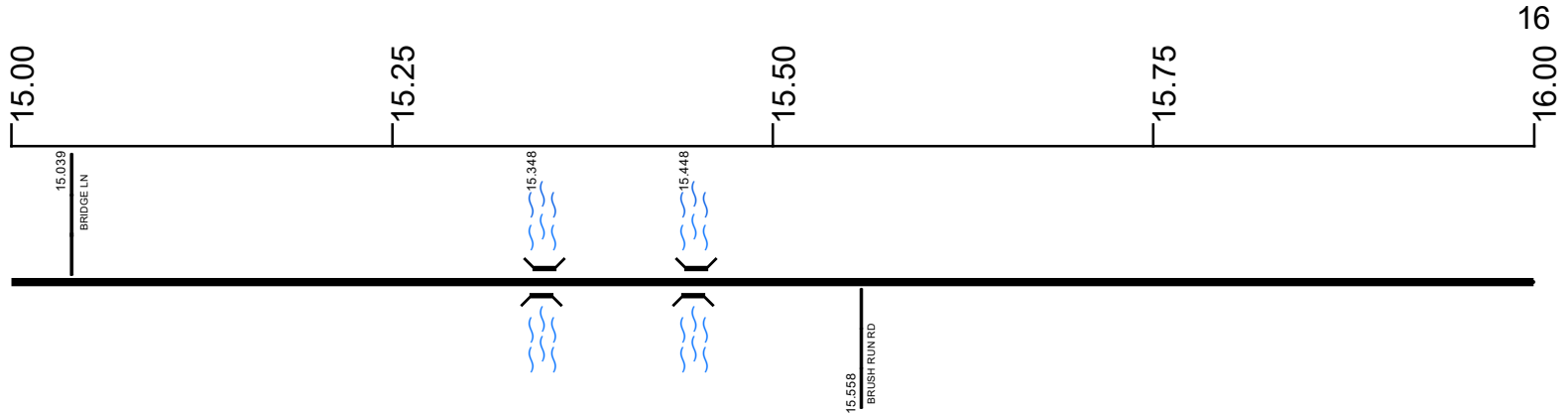

Surface Type & Width (Left / Right)

G (16'4")	G 20'
14.424 - 15.859	15.859 - 16.822

Base Type (Left / Right)

N / L	N
14.424 - 15.859	15.859 - 16.822

Shoulder Type & Width (Left / Right)

5 (2'2")	
14.424 - 20.775	

Resurface Year

2024	
14.424 - 20.709	

Through Lanes

2	
14.424 - 21.02	

Street Name

BELMONT-WARNOCK RD	
14.646 - 18.037	

- Non-divided Highway
- Divided Highway
- Secondary Segment
- Corporation
- Bridge (on route)
- Underpass
- Overpass
- Railroad (at grade)
- Railroad (underpass)
- Railroad (overpass)
- Intersection

Created on: 6/24/2025

transportation.ohio.gov

Prepared by
The Ohio Department of Transportation
Office of Technical Services
Roadway Information

SBELSR00149**C

State True Log
County True Log

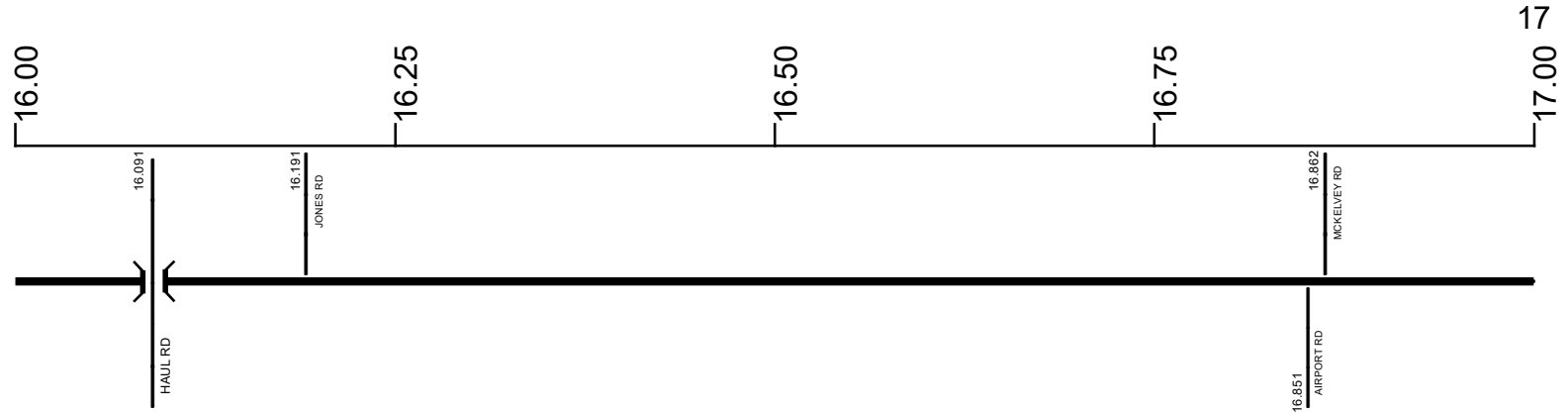

Surface Type & Width (Left / Right)

G 20'	D 20'	D 24'
15.859 - 16.822		16.842 - 18.592

Base Type (Left / Right)

N
15.859 - 16.822

Shoulder Type & Width (Left / Right)

5 (2/2')
14.424 - 20.775

Resurface Year

2024
14.424 - 20.709

Through Lanes

2
14.424 - 21.02

Street Name

BELMONT-WARNOCK RD
14.646 - 18.037

- | | | | |
|--|---|---|---|
| <ul style="list-style-type: none"> Non-divided Highway Divided Highway Secondary Segment Corporation | <ul style="list-style-type: none"> Bridge (on route) Underpass Overpass | <ul style="list-style-type: none"> Railroad (at grade) Railroad (underpass) Railroad (overpass) | <ul style="list-style-type: none"> Intersection |
|--|---|---|---|

Created on: 6/24/2025

transportation.ohio.gov

Prepared by
The Ohio Department of Transportation
Office of Technical Services
Roadway Information

SBELSR00149**C

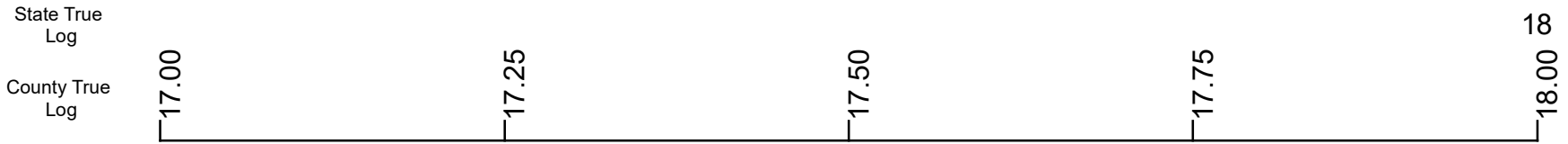

17.937
PLAINFIELD RD

Surface Type & Width (Left / Right)	D 24' 16.842 - 18.592
Shoulder Type & Width (Left / Right)	5 (2'/2') 14.424 - 20.775
Resurface Year	2024 14.424 - 20.709
Through Lanes	2 14.424 - 21.02
Street Name	BELMONT-WARNOCK RD 14.646 - 18.037

<ul style="list-style-type: none"> Non-divided Highway Divided Highway Secondary Segment Corporation 	<ul style="list-style-type: none"> Bridge (on route) Underpass Overpass 	<ul style="list-style-type: none"> Railroad (at grade) Railroad (underpass) Railroad (overpass) 	<ul style="list-style-type: none"> Intersection
---	---	---	---

Created on: 6/24/2025

transportation.ohio.gov

Prepared by
The Ohio Department of Transportation
Office of Technical Services
Roadway Information

SBELSR00149**C

State True Log

County True Log

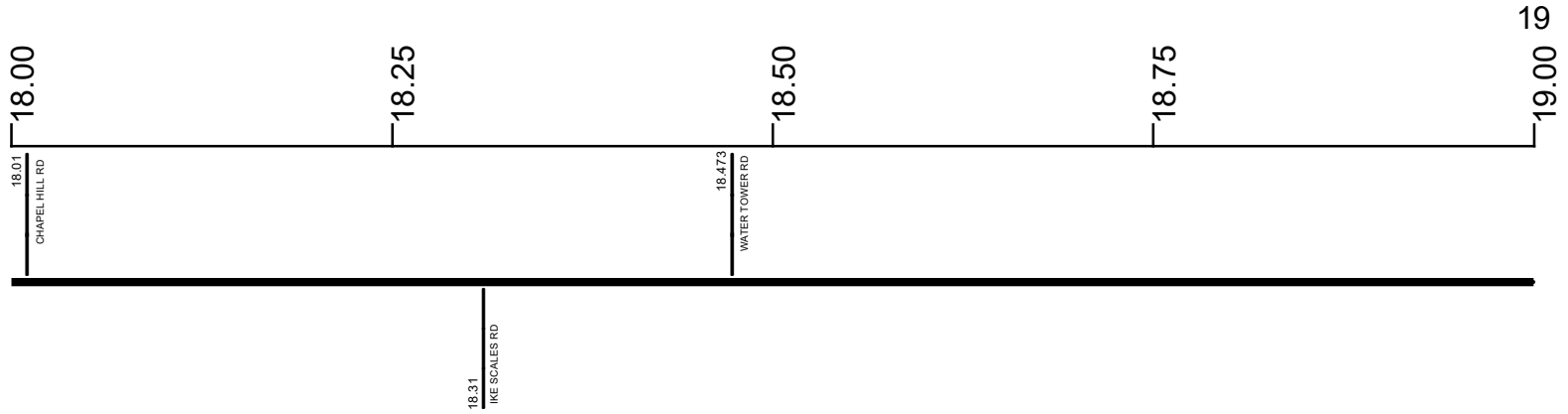

Surface Type & Width (Left / Right)

D 24' 16.842 - 18.592	G (16'¼') 18.592 - 21.02
--------------------------	-----------------------------

Base Type (Left / Right)

N / L 18.592 - 20.775

Shoulder Type & Width (Left / Right)

5 (2'½') 14.424 - 20.775

Resurface Year

2024 14.424 - 20.709

Through Lanes

2 14.424 - 21.02

Street Name

BELMONT-WARNOCK RD 14.646 - 18.037	LAMIRA 18.037 - 18.473	BELMONT-WARNOCK RD 18.473 - 19.012
---------------------------------------	---------------------------	---------------------------------------

- | | | | |
|---------------------|-------------------|----------------------|--------------|
| Non-divided Highway | Bridge (on route) | Railroad (at grade) | Intersection |
| Divided Highway | Underpass | Railroad (underpass) | |
| Secondary Segment | Overpass | Railroad (overpass) | |
| Corporation | | | |

Created on: 6/24/2025

transportation.ohio.gov

Prepared by
The Ohio Department of Transportation
Office of Technical Services
Roadway Information

SBELSR00149**C

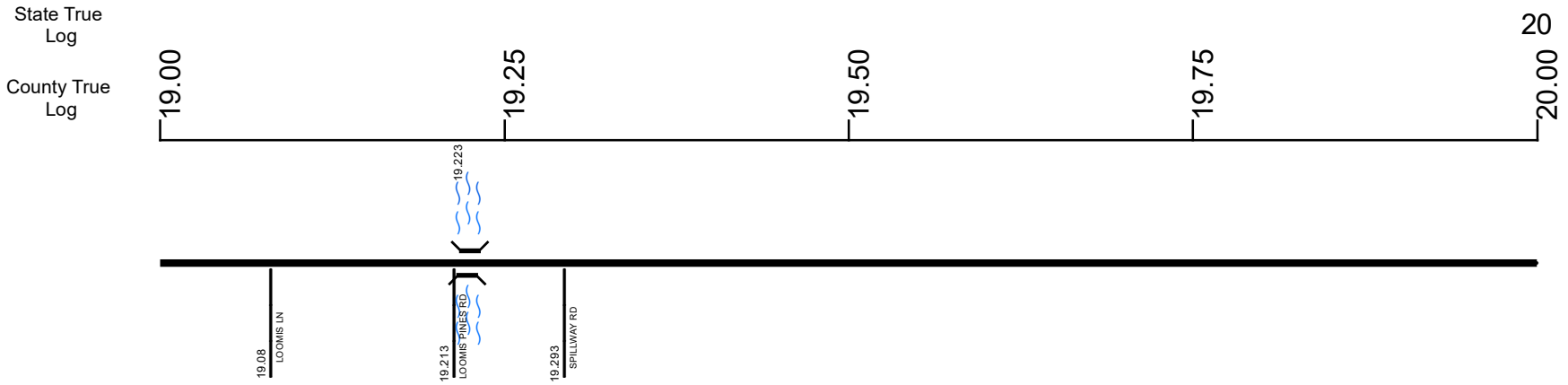

Surface Type & Width (Left / Right)	G (16'4') 18.592 - 21.02
Base Type (Left / Right)	N / L 18.592 - 20.775
Shoulder Type & Width (Left / Right)	5 (2'2') 14.424 - 20.775
Resurface Year	2024 14.424 - 20.709
Through Lanes	2 14.424 - 21.02
Street Name	BELMONT-WARNOCK RD MAIN ST 18.473 - 19.012 19.012 - 19.213 BELMONT-WARNOCK RD 19.213 - 20.778

Non-divided Highway	Bridge (on route)	Railroad (at grade)	Intersection
Divided Highway	Underpass	Railroad (underpass)	
Secondary Segment	Overpass	Railroad (overpass)	
Corporation			

Created on: 6/24/2025

transportation.ohio.gov

Prepared by
The Ohio Department of Transportation
Office of Technical Services
Roadway Information

SBELSR00149**C

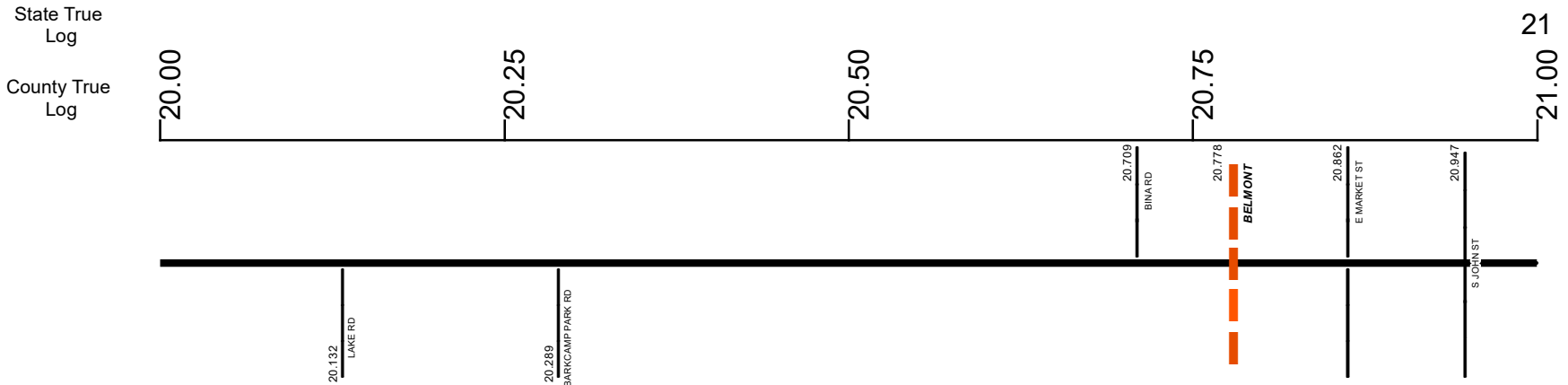

Surface Type & Width (Left / Right)	
G (16'4')	18.592 - 21.02
Base Type (Left / Right)	
N / L	N / R N / I
18.592 - 20.775	20.775 - 20.955 20.955 - 21.02
Shoulder Type & Width (Left / Right)	
5 (2'2')	2 (1'1')
14.424 - 20.775	20.775 - 21.02
Resurface Year	
2024	2021
14.424 - 20.709	20.786 - 21.02
Through Lanes	
2	
14.424 - 21.02	
Street Name	
BELMONT-WARNOCK RD	E MAIN ST
19.213 - 20.778	20.778 - 21.02

<ul style="list-style-type: none"> Non-divided Highway Divided Highway Secondary Segment Corporation 	<ul style="list-style-type: none"> Bridge (on route) Underpass Overpass 	<ul style="list-style-type: none"> Railroad (at grade) Railroad (underpass) Railroad (overpass) 	<ul style="list-style-type: none"> Intersection
---	---	---	---

Created on: 6/24/2025

transportation.ohio.gov

Prepared by
The Ohio Department of Transportation
Office of Technical Services
Roadway Information

SBELSR00149**C

State True Log
County True Log

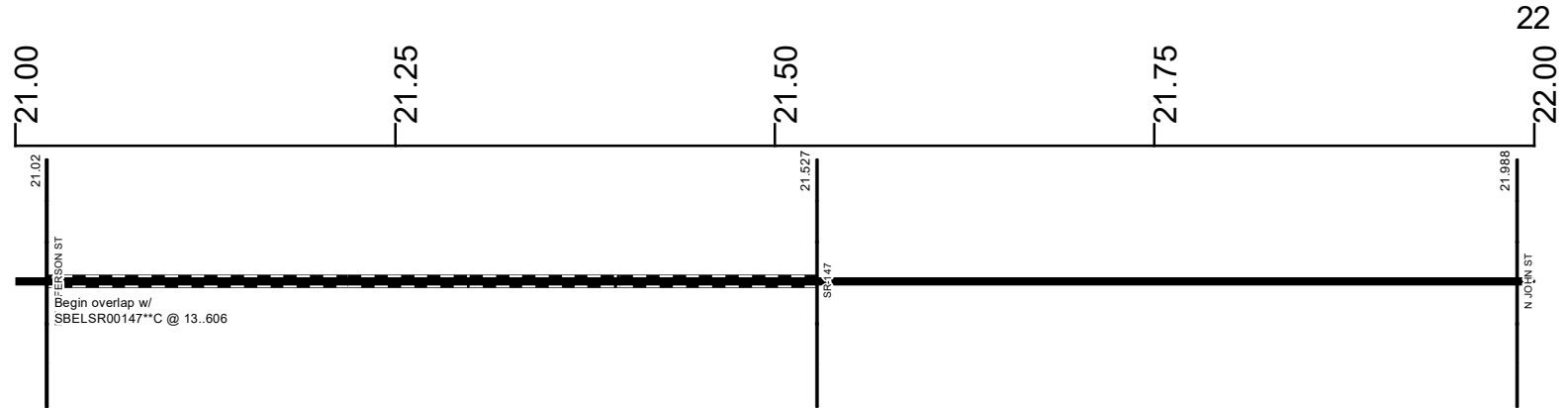

Surface Type & Width (Left / Right)
G (16'4')

Base Type (Left / Right)
N / 1
20.955 - 21.02

Shoulder Type & Width (Left / Right)
2 (1'1")
20.775 - 21.02

Resurface Year
2021
20.786 - 21.02

Through Lanes
2
14.424 - 21.02

E MAIN ST
20.778 - 21.02

Surface Type & Width (Left / Right)
G 24'
21.527 - 23.795

Base Type (Left / Right)
L
21.527 - 22.202

Shoulder Type & Width (Left / Right)
5 (2'2")
21.527 - 24.093

Resurface Year
2021
21.527 - 23.795

Through Lanes
2
21.527 - 24.554

Street Name
BELMONT-MORRISTOWN RD
21.527 - 24.554

Non-divided Highway	Bridge (on route)	Railroad (at grade)	Intersection
Divided Highway	Underpass	Railroad (underpass)	
Secondary Segment	Overpass	Railroad (overpass)	
Corporation			

Created on: 6/24/2025



transportation.ohio.gov

Prepared by
The Ohio Department of Transportation
Office of Technical Services
Roadway Information

SBELSR00149**C

State True Log
County True Log

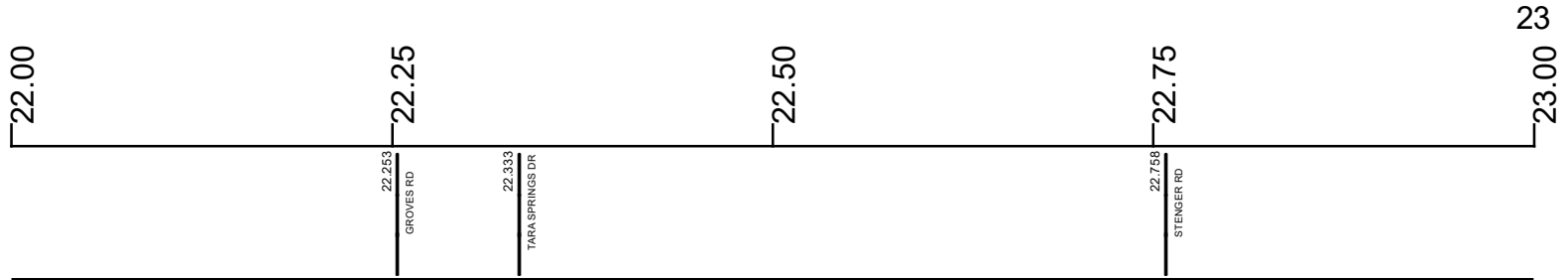

Surface Type & Width (Left / Right)

G 24'
21.527 - 23.795

Base Type (Left / Right)

L	I
21.527 - 22.202	22.202 - 24.093

Shoulder Type & Width (Left / Right)

5 (2/2)
21.527 - 24.093

Resurface Year

2021
21.527 - 23.795

Through Lanes

2
21.527 - 24.554

Street Name

BELMONT-MORRISTOWN RD
21.527 - 24.554

- | | | | |
|---------------------|-------------------|----------------------|--------------|
| Non-divided Highway | Bridge (on route) | Railroad (at grade) | Intersection |
| Divided Highway | Underpass | Railroad (underpass) | |
| Secondary Segment | Overpass | Railroad (overpass) | |
| Corporation | | | |

Created on: 6/24/2025

transportation.ohio.gov

Prepared by
The Ohio Department of Transportation
Office of Technical Services
Roadway Information

SBELSR00149**C

State True Log
County True Log

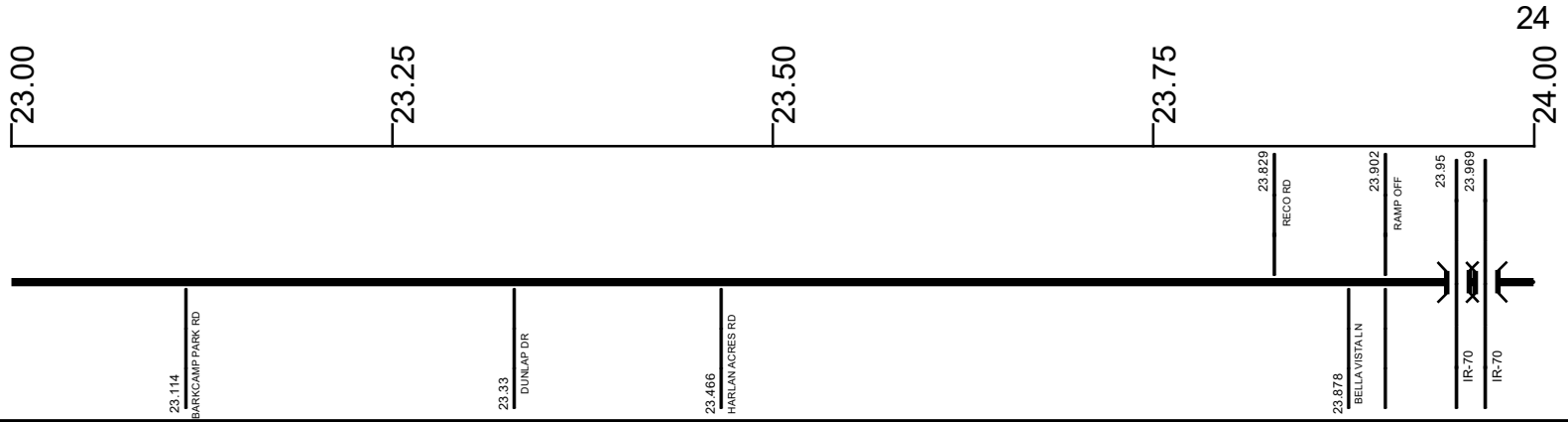

Surface Type & Width (Left / Right)			
	G 24'	E (24') / G (24')	G 24'
	21.527 - 23.795	23.795 - 23.898	23.898 - 24.093
Base Type (Left / Right)			
	I		
	22.202 - 24.093		
Shoulder Type & Width (Left / Right)			
	5 (2 1/2')		
	21.527 - 24.093		
Resurface Year			
	2021	2023	2021
	21.527 - 23.795	23.795 - 23.898	23.898 - 24.554
Through Lanes			
	2		
	21.527 - 24.554		
Street Name			
	BELMONT-MORRISTOWN RD		
	21.527 - 24.554		

Non-divided Highway	Bridge (on route)	Railroad (at grade)	Intersection
Divided Highway	Underpass	Railroad (underpass)	
Secondary Segment	Overpass	Railroad (overpass)	
Corporation			

Created on: 6/24/2025

transportation.ohio.gov

Prepared by
The Ohio Department of Transportation
Office of Technical Services
Roadway Information

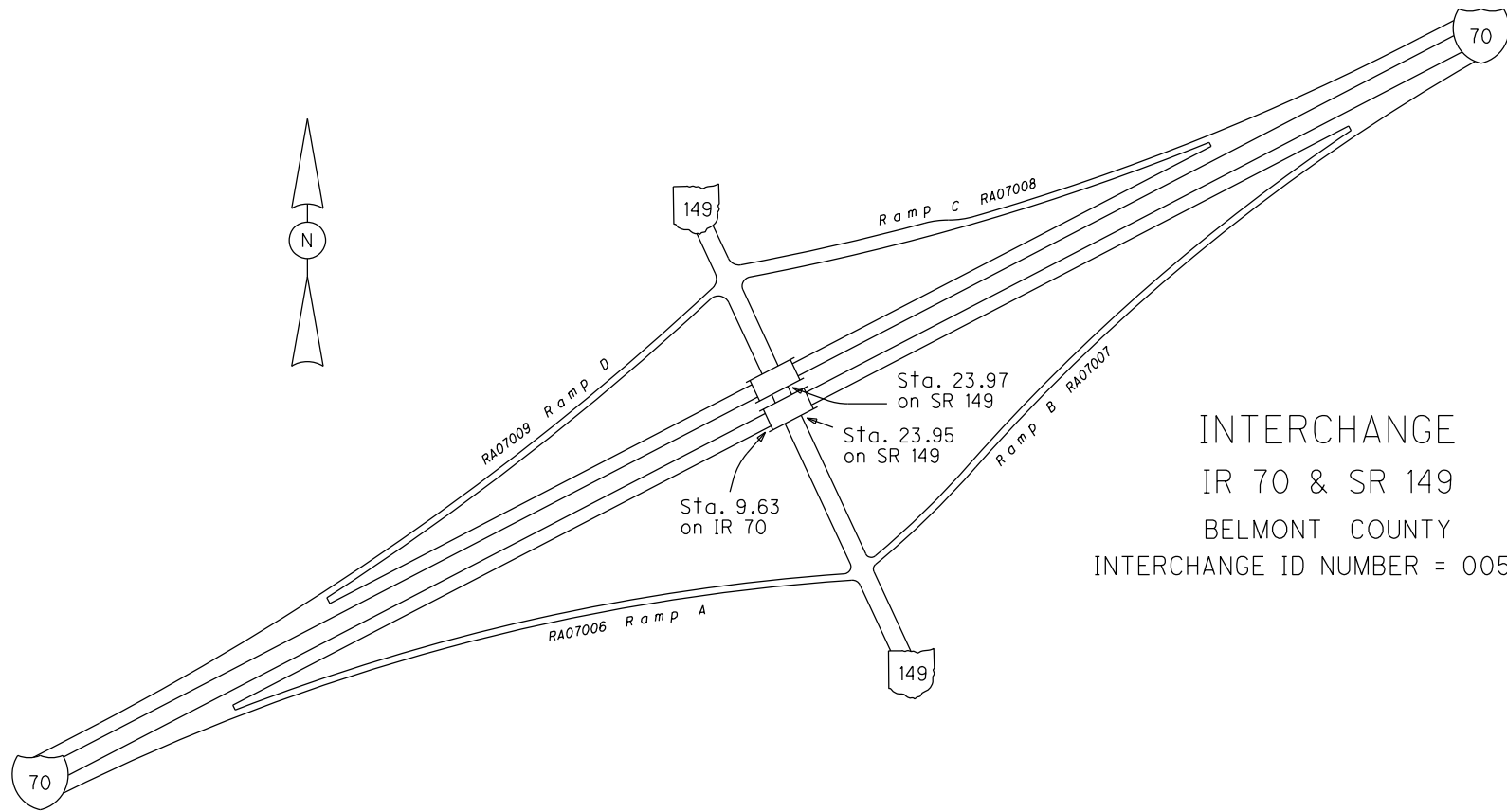

INTERCHANGE
 IR 70 & SR 149
 BELMONT COUNTY
 INTERCHANGE ID NUMBER = 005900

IR 70
 SR 149

REVISED Sep 2024

SBELSR00149**C

State True Log
County True Log

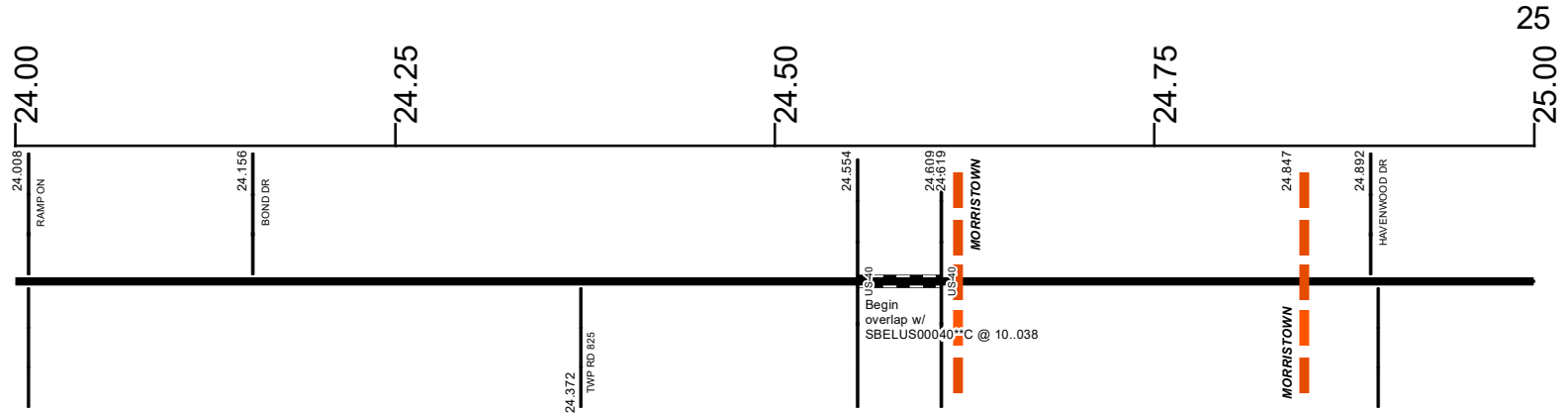

Surface Type & Width (Left / Right)

G 24'	G (18'/24')	G 24'
23.898 - 24.093	24.093 - 24.235	24.235 - 24.554

Base Type (Left / Right)

I	L / I	I
22.202 - 24.093	24.093 - 24.235	24.235 - 24.554

Shoulder Type & Width (Left / Right)

5 (2'/2')	5 (1'/1')	5 (2'/2')
21.527 - 24.093	24.093 - 24.235	24.235 - 24.554

Resurface Year

2021

Through Lanes

2

Street Name

BELMONT-MORRISTOWN RD
21.527 - 24.554

Surface Type & Width (Left / Right)

G 18'
24.609 - 31.016

Base Type (Left / Right)

K
24.609 - 31.016

Shoulder Type & Width (Left / Right)

5 (2'/2')
24.609 - 31.016

Through Lanes

2

Street Name

MORRISTOWN-FLUSHING RD
24.609 - 31.013

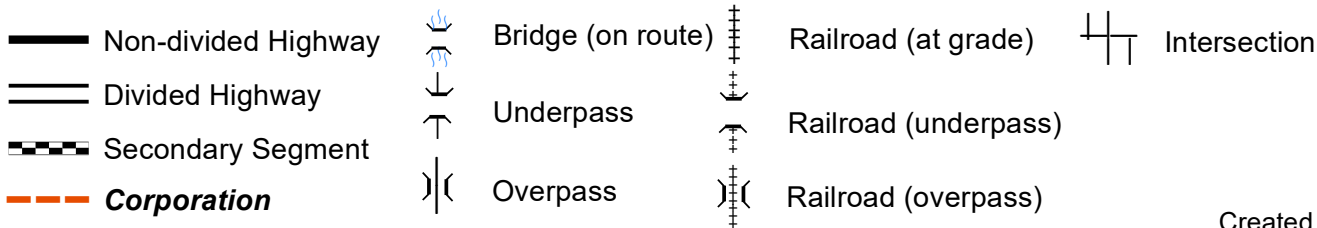



transportation.ohio.gov

Prepared by
The Ohio Department of Transportation
Office of Technical Services
Roadway Information

SBELSR00149**C

State True Log
County True Log

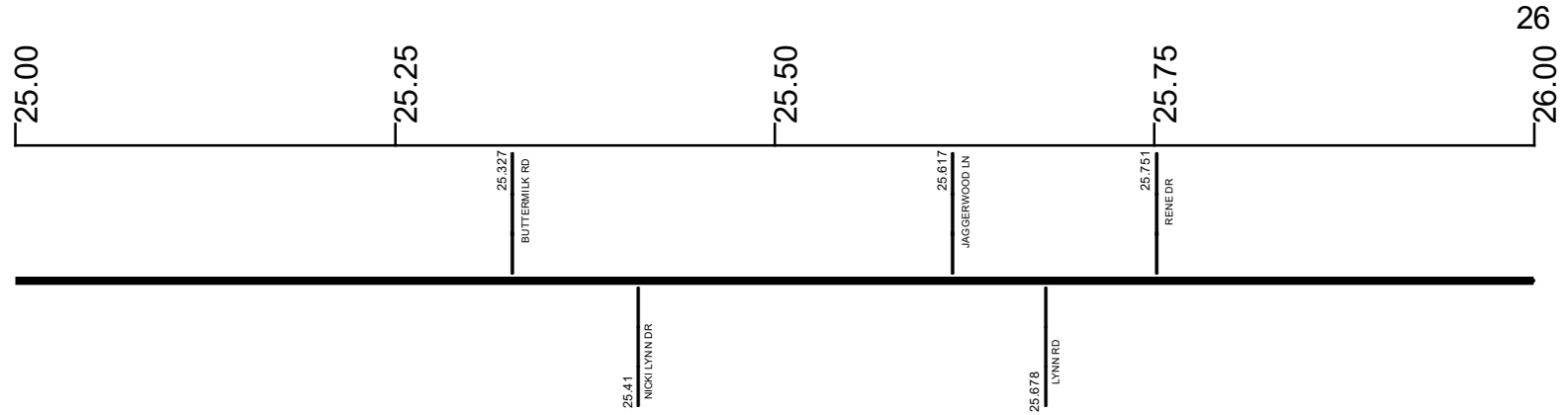

Surface Type & Width (Left / Right)	G 18'
	24.609 - 31.016
Base Type (Left / Right)	K
	24.609 - 31.016
Shoulder Type & Width (Left / Right)	5 (2/2')
	24.609 - 31.016
Through Lanes	2
	24.609 - 35.06
Street Name	MORRISTOWN-FLUSHING RD
	24.609 - 31.013

Non-divided Highway	Bridge (on route)	Railroad (at grade)	Intersection
Divided Highway	Underpass	Railroad (underpass)	
Secondary Segment	Overpass	Railroad (overpass)	
Corporation			

Created on: 6/24/2025

transportation.ohio.gov

Prepared by
The Ohio Department of Transportation
Office of Technical Services
Roadway Information

SBELSR00149**C

State True Log

County True Log

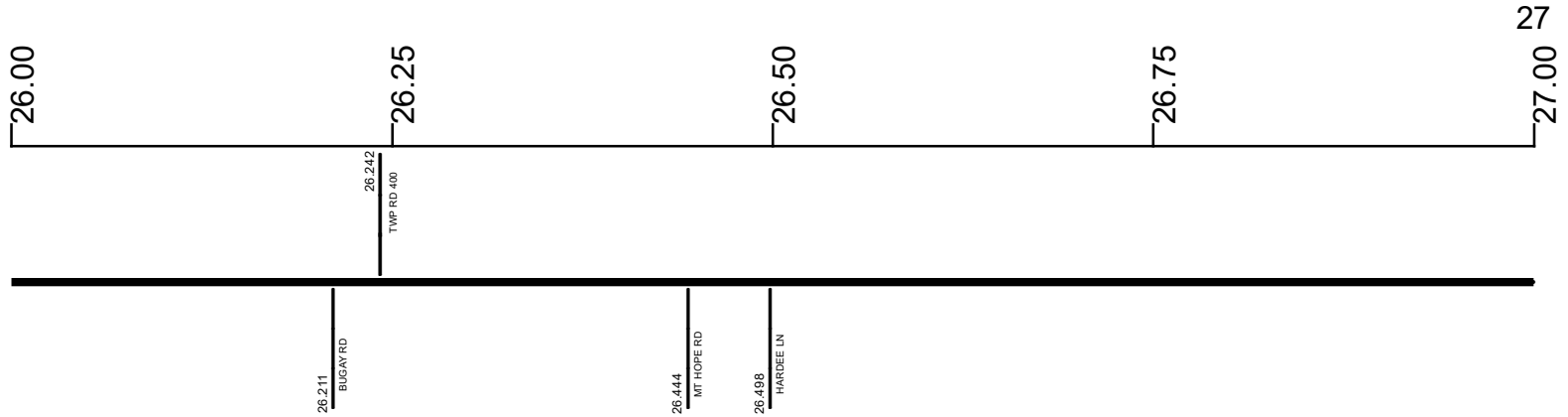

Surface Type & Width (Left / Right)

G 18'
24.609 - 31.016

Base Type (Left / Right)

K
24.609 - 31.016

Shoulder Type & Width (Left / Right)

5 (2/2)
24.609 - 31.016

Through Lanes

2
24.609 - 35.06

Street Name

MORRISTOWN-FLUSHING RD
24.609 - 31.013

- | | | | |
|---------------------|-------------------|----------------------|--------------|
| Non-divided Highway | Bridge (on route) | Railroad (at grade) | Intersection |
| Divided Highway | Underpass | Railroad (underpass) | |
| Secondary Segment | Overpass | Railroad (overpass) | |
| Corporation | | | |

Created on: 6/24/2025



transportation.ohio.gov
 Prepared by
 The Ohio Department of Transportation
 Office of Technical Services
 Roadway Information

SBELSR00149**C

State True Log
County True Log

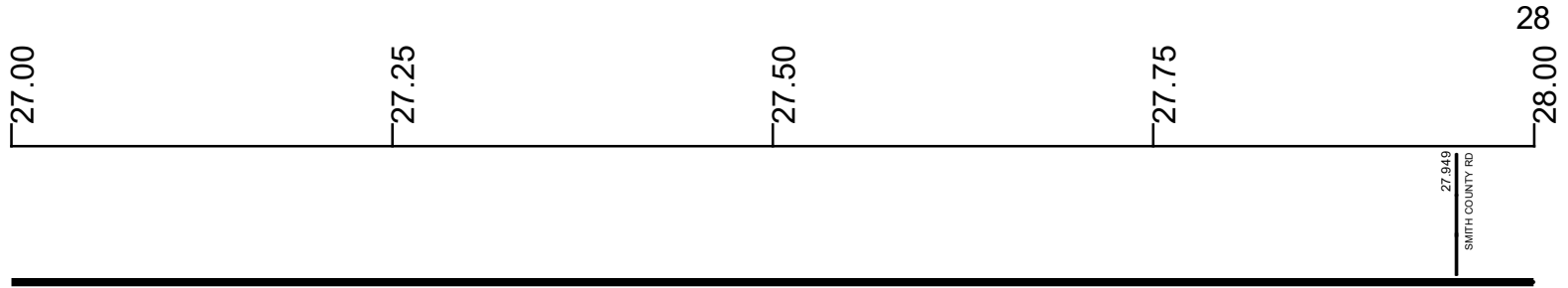

Surface Type & Width (Left / Right)

G 18'
24.609 - 31.016

Base Type (Left / Right)

K
24.609 - 31.016

Shoulder Type & Width (Left / Right)

5 (2/2)
24.609 - 31.016

Through Lanes

2
24.609 - 35.06

Street Name

MORRISTOWN-FLUSHING RD
24.609 - 31.013

- | | | | |
|---------------------|-------------------|----------------------|--------------|
| Non-divided Highway | Bridge (on route) | Railroad (at grade) | Intersection |
| Divided Highway | Underpass | Railroad (underpass) | |
| Secondary Segment | Overpass | Railroad (overpass) | |
| Corporation | | | |

Created on: 6/24/2025



transportation.ohio.gov
Prepared by
The Ohio Department of Transportation
Office of Technical Services
Roadway Information

SBELSR00149**C

State True Log
County True Log

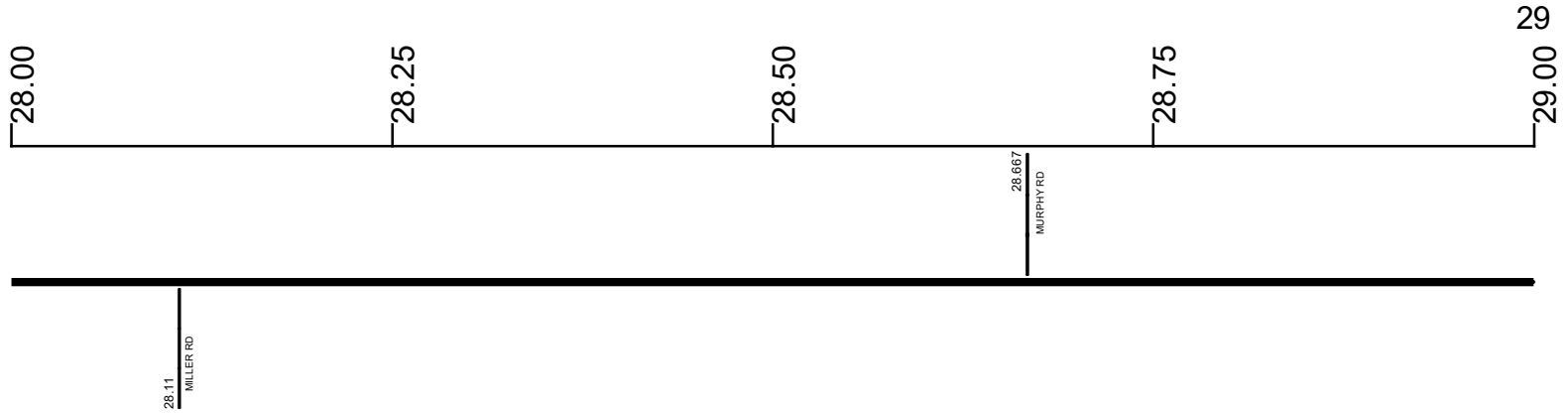

Surface Type & Width (Left / Right)	G 18'
	24.609 - 31.016
Base Type (Left / Right)	K
	24.609 - 31.016
Shoulder Type & Width (Left / Right)	5 (2/2')
	24.609 - 31.016
Through Lanes	2
	24.609 - 35.06
Street Name	MORRISTOWN-FLUSHING RD
	24.609 - 31.013

<ul style="list-style-type: none"> Non-divided Highway Divided Highway Secondary Segment Corporation 	<ul style="list-style-type: none"> Bridge (on route) Underpass Overpass 	<ul style="list-style-type: none"> Railroad (at grade) Railroad (underpass) Railroad (overpass) 	<ul style="list-style-type: none"> Intersection
--	---	---	---

Created on: 6/24/2025

transportation.ohio.gov

Prepared by
The Ohio Department of Transportation
Office of Technical Services
Roadway Information

SBELSR00149**C

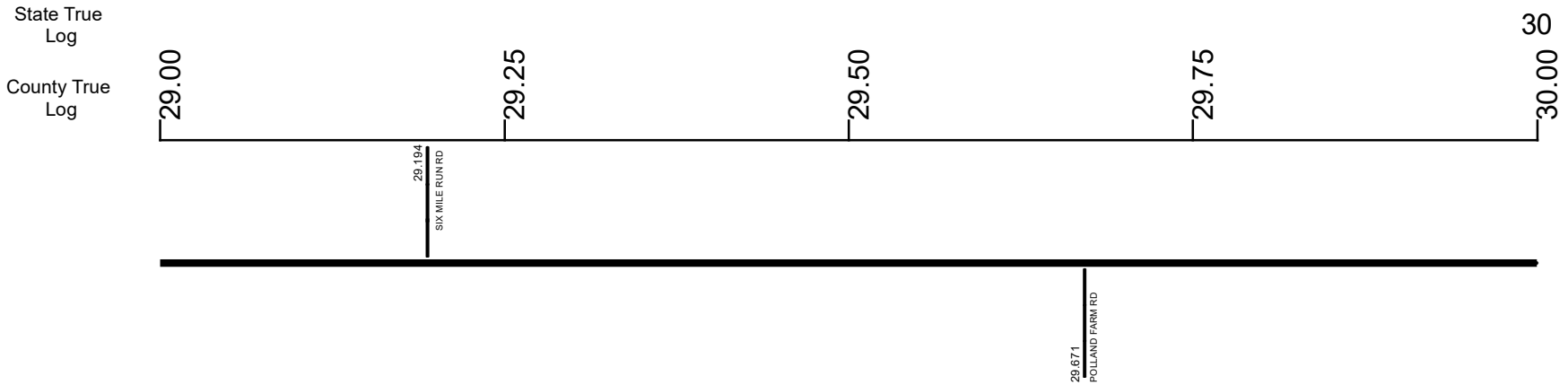

Surface Type & Width (Left / Right)	G 18'
	24.609 - 31.016
Base Type (Left / Right)	K
	24.609 - 31.016
Shoulder Type & Width (Left / Right)	5 (2/2')
	24.609 - 31.016
Through Lanes	2
	24.609 - 35.06
Street Name	MORRISTOWN-FLUSHING RD
	24.609 - 31.013

- Non-divided Highway
- Divided Highway
- Secondary Segment
- Corporation
- Bridge (on route)
- Underpass
- Overpass
- Railroad (at grade)
- Railroad (underpass)
- Railroad (overpass)
- Intersection

Created on: 6/24/2025

transportation.ohio.gov

Prepared by
The Ohio Department of Transportation
Office of Technical Services
Roadway Information

SBELSR00149**C

State True Log
County True Log

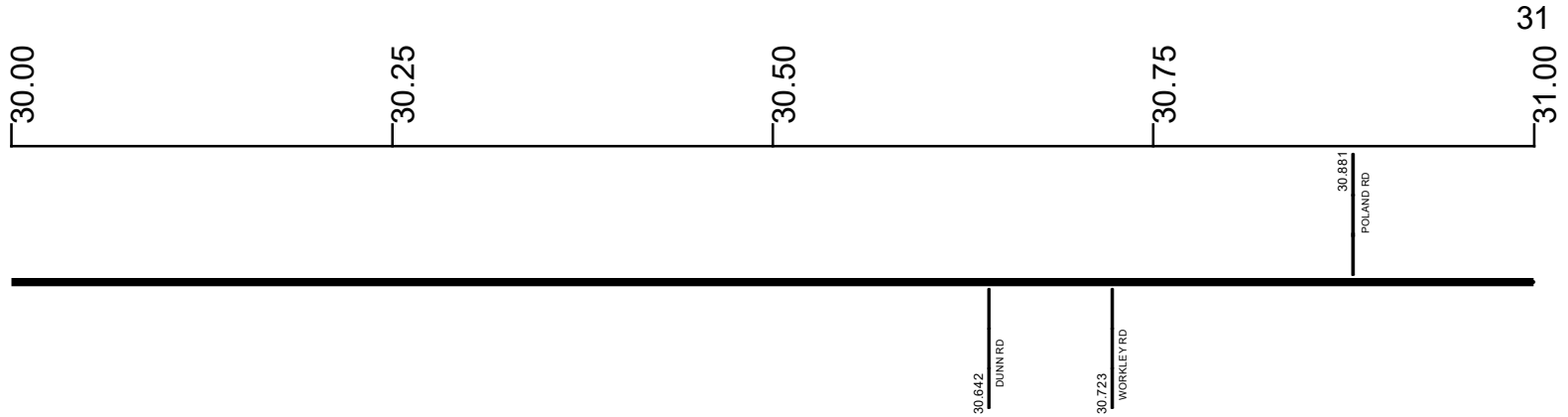

Surface Type & Width (Left / Right)	G 18'
	24.609 - 31.016
Base Type (Left / Right)	K
	24.609 - 31.016
Shoulder Type & Width (Left / Right)	5 (2/2')
	24.609 - 31.016
Through Lanes	2
	24.609 - 35.06
Street Name	MORRISTOWN-FLUSHING RD
	24.609 - 31.013

- | | | | |
|---------------------|-------------------|----------------------|--------------|
| Non-divided Highway | Bridge (on route) | Railroad (at grade) | Intersection |
| Divided Highway | Underpass | Railroad (underpass) | |
| Secondary Segment | Overpass | Railroad (overpass) | |
| Corporation | | | |

Created on: 6/24/2025

transportation.ohio.gov

Prepared by
The Ohio Department of Transportation
Office of Technical Services
Roadway Information

SBELSR00149**C

State True Log

County True Log

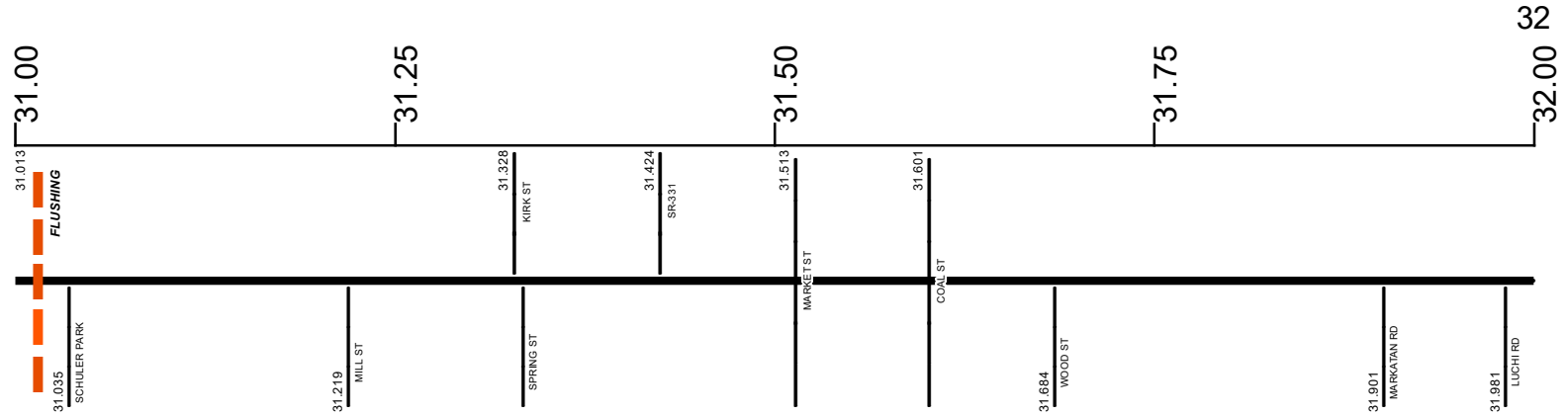

Surface Type & Width (Left / Right)

G 18'	G (16'/2')	G 24'	G (30'/16')	G 20'	G 16'	G 18'
31.016 - 31.209	31.209 - 31.424	31.424 - 31.603	31.603 - 31.752	31.752 - 31.9	31.9 - 32.807	

Base Type (Left / Right)

K	R / I	R	R / N	R
24.609 - 31.016	31.016 - 31.209	31.209 - 31.424	31.424 - 31.603	31.603 - 32.389

Shoulder Type & Width (Left / Right)

5 (2'/2')	5 (1'/1')	1 (0'/0')
24.609 - 31.016	31.016 - 31.209	31.209 - 32.389

Through Lanes

2
24.609 - 35.06

Street Name

MORRISTOWN-FLUSHING RD	MORRISTOWN ST	HIGH ST	E HIGH ST
24.609 - 31.013	31.013 - 31.424	31.424 - 31.747	31.747 - 32.794

- Non-divided Highway
- Divided Highway
- Secondary Segment
- Corporation
- Bridge (on route)
- Underpass
- Overpass
- Railroad (at grade)
- Railroad (underpass)
- Railroad (overpass)
- Intersection

Created on: 6/24/2025



transportation.ohio.gov
Prepared by
The Ohio Department of Transportation
Office of Technical Services
Roadway Information

SBELSR00149**C

State True Log
County True Log

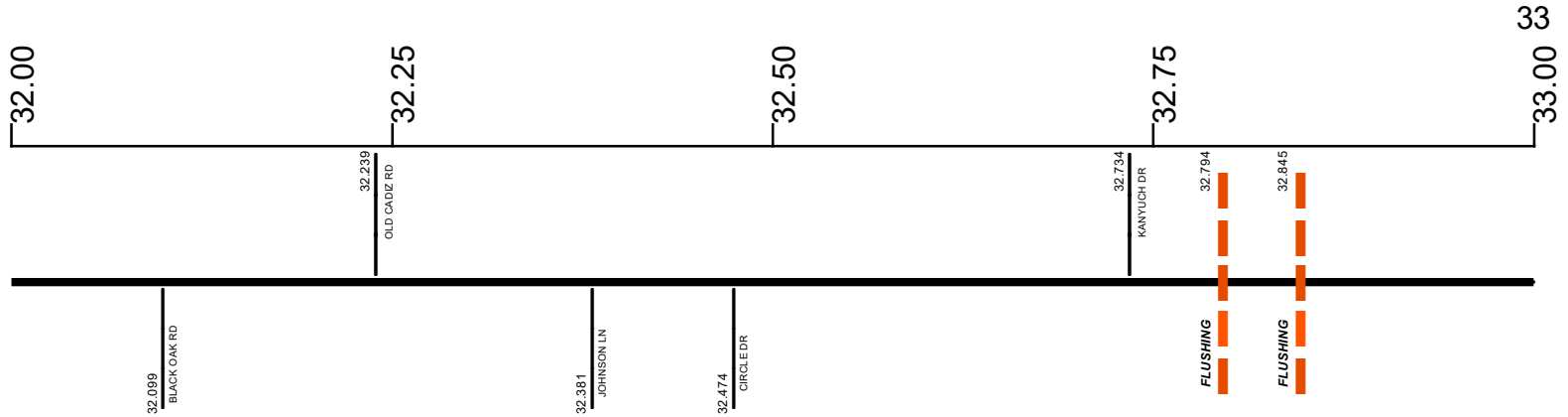

Surface Type & Width (Left / Right)

G 18'	G (9'/10')
31.9 - 32.807	32.807 - 35.06

Base Type (Left / Right)

R	I
31.603 - 32.389	32.389 - 35.06

Shoulder Type & Width (Left / Right)

1 (0'/0')	5 (1'/1')	5 (2'/2')
31.209 - 32.389	32.389 - 32.807	32.807 - 35.06

Resurface Year

2021
32.783 - 35.06

Through Lanes

2
24.609 - 35.06

Street Name

E HIGH ST	UNIONTOWN-FLUSHING RD
31.747 - 32.794	32.794 - 33.106

- Non-divided Highway
- Divided Highway
- Secondary Segment
- Corporation
- Bridge (on route)
- Underpass
- Overpass
- Railroad (at grade)
- Railroad (underpass)
- Railroad (overpass)
- Intersection

Created on: 6/24/2025

transportation.ohio.gov

Prepared by
The Ohio Department of Transportation
Office of Technical Services
Roadway Information

SBELSR00149**C

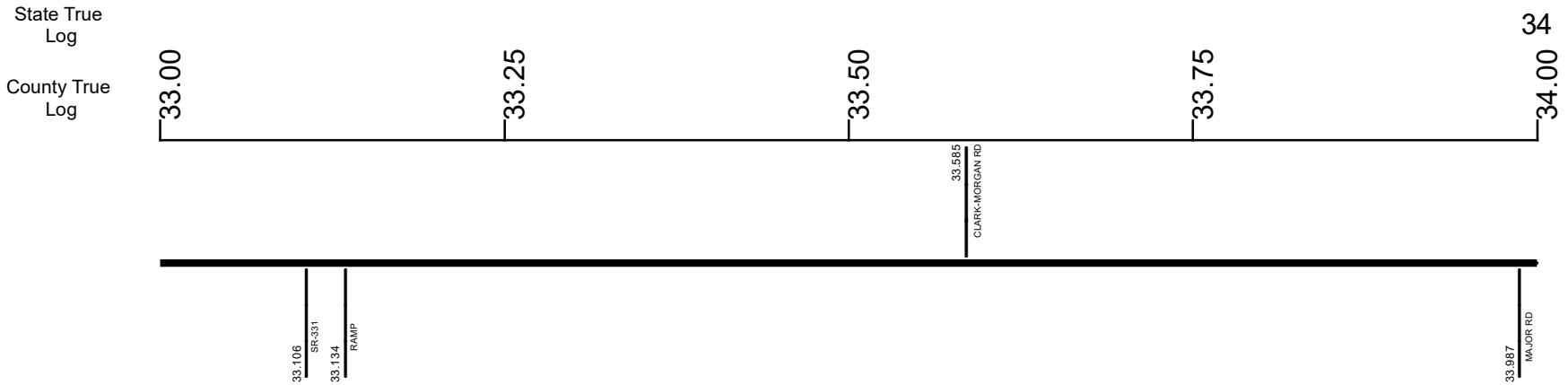

Surface Type & Width (Left / Right)	G (9'/10')
	32.807 - 35.06
Base Type (Left / Right)	I
	32.389 - 35.06
Shoulder Type & Width (Left / Right)	5 (2'/2')
	32.807 - 35.06
Resurface Year	2021
	32.783 - 35.06
Through Lanes	2
	24.609 - 35.06
Street Name	FLUSHING-NEW ATHENS RD
UNIONTOWN-FLUSHING RD	32.794 - 33.106
	33.106 - 35.06

Non-divided Highway	Bridge (on route)	Railroad (at grade)	Intersection
Divided Highway	Underpass	Railroad (underpass)	
Secondary Segment	Overpass	Railroad (overpass)	
Corporation			

Created on: 6/24/2025



transportation.ohio.gov
 Prepared by
 The Ohio Department of Transportation
 Office of Technical Services
 Roadway Information

SBELSR00149**C

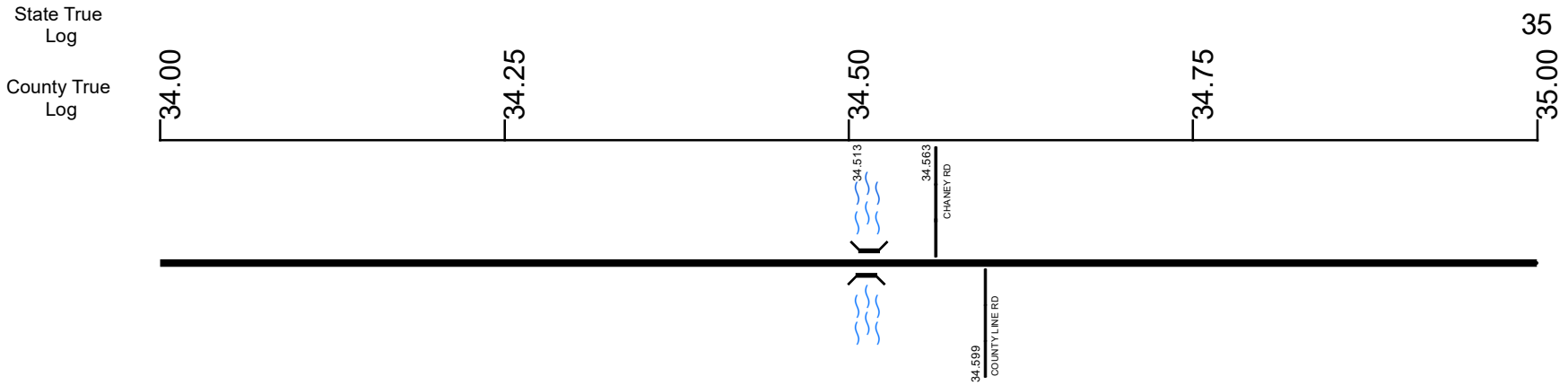

Surface Type & Width (Left / Right)	G (9'/10')
	32.807 - 35.06
Base Type (Left / Right)	I
	32.389 - 35.06
Shoulder Type & Width (Left / Right)	5 (2'/2')
	32.807 - 35.06
Resurface Year	2021
	32.783 - 35.06
Through Lanes	2
	24.609 - 35.06
Street Name	FLUSHING-NEW ATHENS RD
	33.106 - 35.06

	Non-divided Highway		Bridge (on route)		Railroad (at grade)		Intersection
	Divided Highway		Underpass		Railroad (underpass)		
	Secondary Segment		Overpass		Railroad (overpass)		
	Corporation						

Created on: 6/24/2025

transportation.ohio.gov

Prepared by
The Ohio Department of Transportation
Office of Technical Services
Roadway Information

SBELSR00149**C

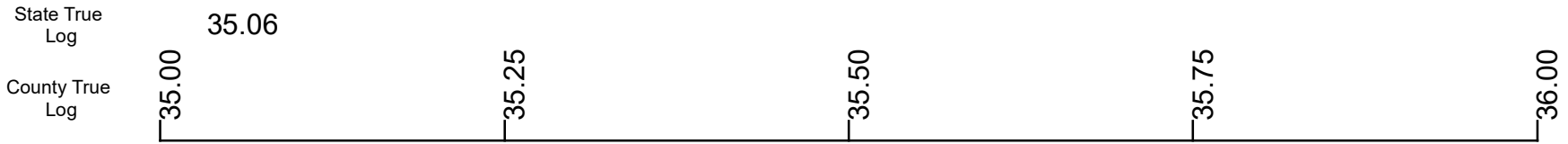

Surface Type & Width (Left / Right)
 G (9'/10')

32.807 - 35.06

Base Type (Left / Right)
 I

32.389 - 35.06

Shoulder Type & Width (Left / Right)
 5 (2'/2')

32.807 - 35.06

Resurface Year
 2021

32.783 - 35.06

Through Lanes
 2

24.609 - 35.06

Street Name
 FLUSHING-NEW ATHENS RD

33.106 - 35.06

Non-divided Highway	Bridge (on route)	Railroad (at grade)	Intersection
Divided Highway	Underpass	Railroad (underpass)	
Secondary Segment	Overpass	Railroad (overpass)	
Corporation			

Created on: 6/24/2025



transportation.ohio.gov

Prepared by
 The Ohio Department of Transportation
 Office of Technical Services
 Roadway Information

Historical Project List for SBELSR00149**C

Begin Measure	End Measure	Project ID Number	Construction Completion Date	Treatment Category	Treatment Type
0.285	0.425	87296	11-2016	Minor Rehabilitation	50-AC Overlay w/o Rpr
0.425	4.347	105179	11-2019	Preventive Maintenance	33-Thinlay Asphalt
1.892	11.157	84384	9-2013	Minor Rehabilitation	60-AC Overlay w/Rpr
4.347	5.604	105179	11-2019	Preventive Maintenance	33-Thinlay Asphalt
14.424	20.764	80419	7-2010	Minor Rehabilitation	60-AC Overlay w/Rpr
20.709	21.020	107487	11-2021	Minor Rehabilitation	60-AC Overlay w/Rpr
21.527	24.554	107487	11-2021	Minor Rehabilitation	60-AC Overlay w/Rpr
21.527	24.554	85007	11-2012	Minor Rehabilitation	60-AC Overlay w/Rpr
21.527	24.554	19408	8-2002	Minor Rehabilitation	60-AC Overlay w/Rpr
24.609	31.020	102336	9-2018	Preventive Maintenance	30-Microsurfacing
24.609	31.040	84378	11-2012	Minor Rehabilitation	60-AC Overlay w/Rpr
31.020	32.850	102475	6-2020	Minor Rehabilitation	60-AC Overlay w/Rpr
31.040	35.060	81695	12-2009	Minor Rehabilitation	60-AC Overlay w/Rpr
32.850	35.060	109905	11-2021	Minor Rehabilitation	60-AC Overlay w/Rpr

Roadway Codes

Access Control Journalized

- F - Full Access Control
- L - Limited Access Control
- N - No Access Control

Access Control Operational

- 1 - Full Access Control
- 2 - Partial Access Control
- 3 - No Access Control

Base Type

- F - Crack and Seat
- H - Rubblize and Roll
- I - Aggregate Base 304 or Traffic Compacted
- K - Water Bound Macadam
- L - Bituminous Concrete Mix or Penetration Macadam
- N - Plain Concrete
- P - Reinforced Concrete
- R - Brick (Flexible)
- T - Brick (Rigid)

Direction of Travel

- B - Both (Two-way)
- F - One-way Cardinal
- T - One-way Non-cardinal

Facility Type

- 1 - One-way Roadway
- 2 - Two-way Roadway
- 4 - Ramp
- 5 - Non-mainline
- 6 - Non-inventory Direction
- 7 - Planned / Unbuilt

Historical Federal Aid Indicator

- N - Not a FAP Route
- Y - FAP Route

Functional Classification

- 01 - Interstate
- 02 - Principal Arterial (Freeways)
- 03 - Principal Arterial (Other)
- 04 - Minor Arterial
- 05 - Major Collector
- 06 - Minor Collector
- 07 - Local

Leave / Reenter Indicator

- Y - Route leaves/reenters at this point
- N - Route does not leave/reenter at this point

Median Type

- 1 - None
- 2 - Unprotected
- 3 - Curbed
- 4 - Positive Barrier (Unspecified)
- 5 - Positive Barrier (Flexible)
- 6 - Positive Barrier (Semi-rigid)
- 7 - Positive Barrier (Rigid)

NHS

- N - National Highway System
- H - Congressional Corridor
- 2 - Major Airport
- 3 - Major Port Facility
- 4 - Major Amtrak Station
- 5 - Major Rail / Truck Terminal
- 6 - Major Intercity Bus Terminal
- 7 - Major Public Transit / Multi-modal Passenger Terminal
- 8 - Major Pipeline Terminal
- 9 - Major Ferry Terminal

Priority System

- G - General
- P - Priority System
- U - Urban

Scenic Byway Code

- A - All American Road
- N - National Scenic Byway
- S - State Scenic Byway

Shoulder Type

- 1 - None
- 2 - Surfaced shoulder exists (bituminous concrete {AC})
- 3 - Surfaced shoulder exists (Portland Cement Concrete {PCC})
- 4 - Stabilized shoulder exists (gravel or other granular material)
- 5 - Combination shoulder exists (two or more surface types)
- 6 - Earth shoulder exists
- 7 - Barrier curb exists; no shoulder in front of curb

Surface Type

- A - Combination
- B - Brick
- C - Continuous Reinforced Concrete
- D - Reinforced Concrete
- E - Plain Concrete
- G - Bituminous Concrete
- I - Chipseal on Granular
- K - Open Graded Bituminous
- L - Chipseal or Micro
- M - Gravel
- U - Unimproved
- X - Right of Way Only