

SBUTSR00122**C

State True Log 24.476

25.476

County True Log

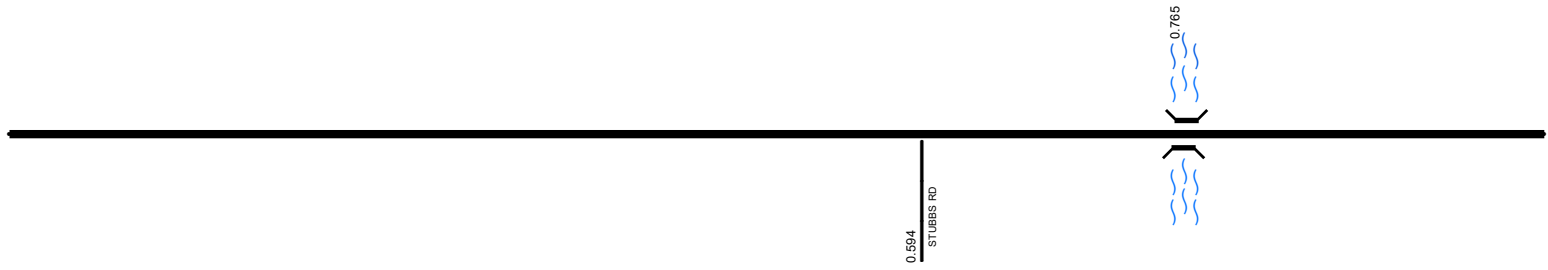

Surface Type & Width (Left / Right)	G (9/10') 0 - 3.859
Base Type (Left / Right)	I 0 - 3.859
Shoulder Type & Width (Left / Right)	2 (2/2) 0 - 3.859
Through Lanes	2 0 - 4.507
Street Name	MIDDLETOWN EATON RD 0 - 6.209

Non-divided Highway	Bridge (on route)	Railroad (at grade)	Intersection
Divided Highway	Underpass	Railroad (underpass)	
Secondary Segment	Overpass	Railroad (overpass)	
Corporation			

Created on: 6/24/2025

transportation.ohio.gov

Prepared by
The Ohio Department of Transportation
Office of Technical Services
Roadway Information

SBUTSR00122**C

State True Log

26.476

County True Log



Surface Type & Width (Left / Right)	G (9/10')	
	0 - 3.859	
Base Type (Left / Right)	I	
	0 - 3.859	
Shoulder Type & Width (Left / Right)	2 (2/2')	
	0 - 3.859	
Through Lanes	2	
	0 - 4.507	
Street Name	MIDDLETOWN EATON RD	
	0 - 6.209	

<ul style="list-style-type: none"> Non-divided Highway Divided Highway Secondary Segment Corporation 	<ul style="list-style-type: none"> Bridge (on route) Underpass Overpass 	<ul style="list-style-type: none"> Railroad (at grade) Railroad (underpass) Railroad (overpass) 	<ul style="list-style-type: none"> Intersection
--	---	---	---

Created on: 6/24/2025

transportation.ohio.gov

Prepared by
The Ohio Department of Transportation
Office of Technical Services
Roadway Information

SBUTSR00122**C

State True Log

27.476

County True Log

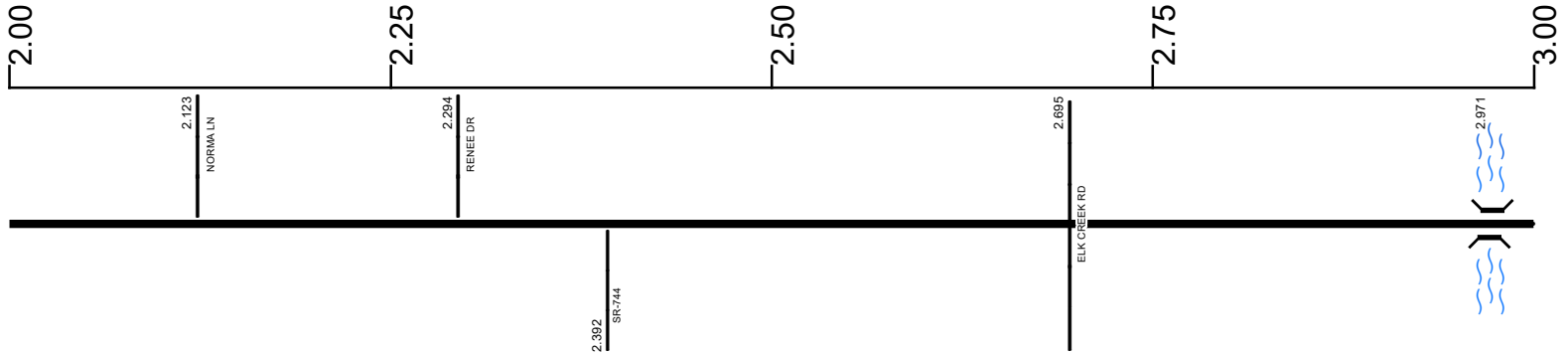

Surface Type & Width (Left / Right)

G (9'/10')
0 - 3.859

Base Type (Left / Right)

I
0 - 3.859

Shoulder Type & Width (Left / Right)

2 (2'/2')
0 - 3.859

Through Lanes

2
0 - 4.507

Street Name

MIDDLETOWN EATON RD
0 - 6.209

- | | | | |
|---------------------|-------------------|----------------------|--------------|
| Non-divided Highway | Bridge (on route) | Railroad (at grade) | Intersection |
| Divided Highway | Underpass | Railroad (underpass) | |
| Secondary Segment | Overpass | Railroad (overpass) | |
| Corporation | | | |

Created on: 6/24/2025

transportation.ohio.gov

Prepared by
The Ohio Department of Transportation
Office of Technical Services
Roadway Information

SBUTSR00122**C

State True
Log

28.476

County True
Log

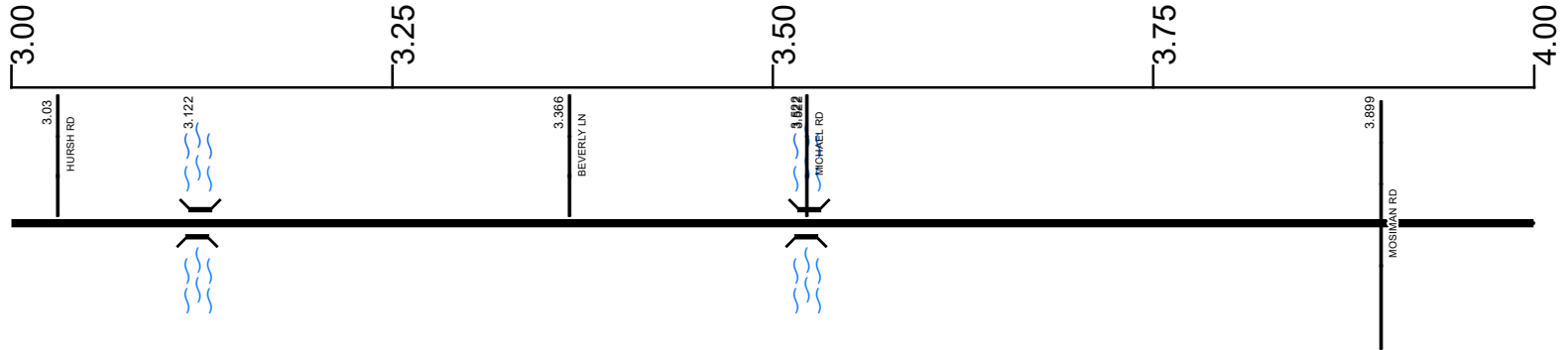

Surface Type & Width (Left / Right)

	G (9'/10')	G 24'
	0 - 3.859	3.859 - 4.507

Base Type (Left / Right)

	I	L
	0 - 3.859	3.859 - 4.623

Shoulder Type & Width (Left / Right)

	2 (2'/2')	2 (8'/8')
	0 - 3.859	3.859 - 4.507

Through Lanes

	2	
	0 - 4.507	

Street Name

	MIDDLETOWN EATON RD	
	0 - 6.209	

- Non-divided Highway
- Divided Highway
- Secondary Segment
- Corporation
- Bridge (on route)
- Underpass
- Overpass
- Railroad (at grade)
- Railroad (underpass)
- Railroad (overpass)
- Intersection

Created on: 6/24/2025

transportation.ohio.gov

Prepared by
 The Ohio Department of Transportation
 Office of Technical Services
 Roadway Information

SBUTSR00122**C

State True Log

29.476

County True Log

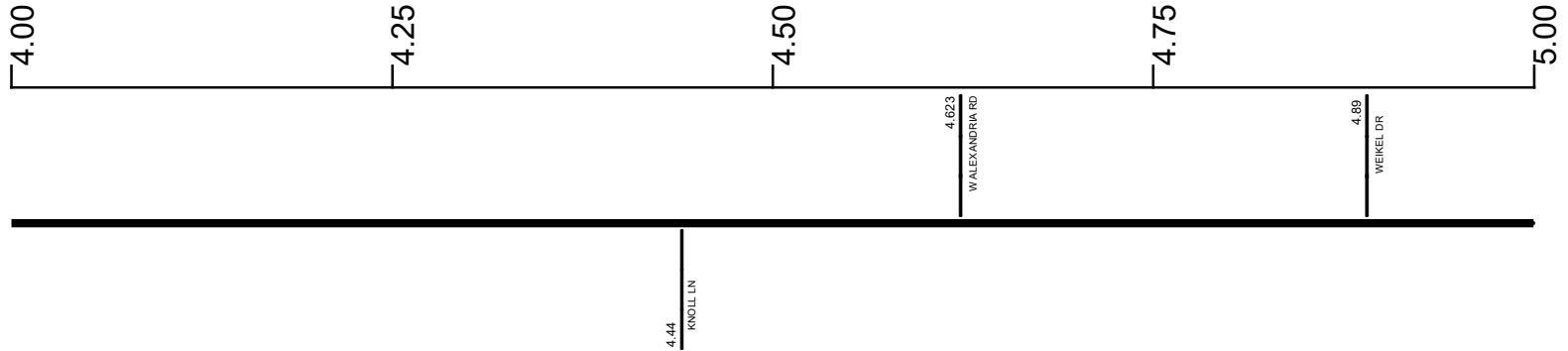

Surface Type & Width (Left / Right)

G 24' 3.859 - 4.507	G 36' 4.507 - 5.727
------------------------	------------------------

Base Type (Left / Right)

L 3.859 - 4.623	I 4.623 - 5.818
--------------------	--------------------

Shoulder Type & Width (Left / Right)

2 (8/8') 3.859 - 4.507	2 (6/6') 4.507 - 4.623	5 (6/6') 4.623 - 5.727
---------------------------	---------------------------	---------------------------

Through Lanes

2 0 - 4.507	3 4.507 - 5.727
----------------	--------------------

Street Name

MIDDLETOWN EATON RD 0 - 6.209

- | | | | |
|---------------------|-------------------|----------------------|--------------|
| Non-divided Highway | Bridge (on route) | Railroad (at grade) | Intersection |
| Divided Highway | Underpass | Railroad (underpass) | |
| Secondary Segment | Overpass | Railroad (overpass) | |
| Corporation | | | |

Created on: 6/24/2025

transportation.ohio.gov

Prepared by
The Ohio Department of Transportation
Office of Technical Services
Roadway Information

SBUTSR00122**C

State True Log

30.476

County True Log

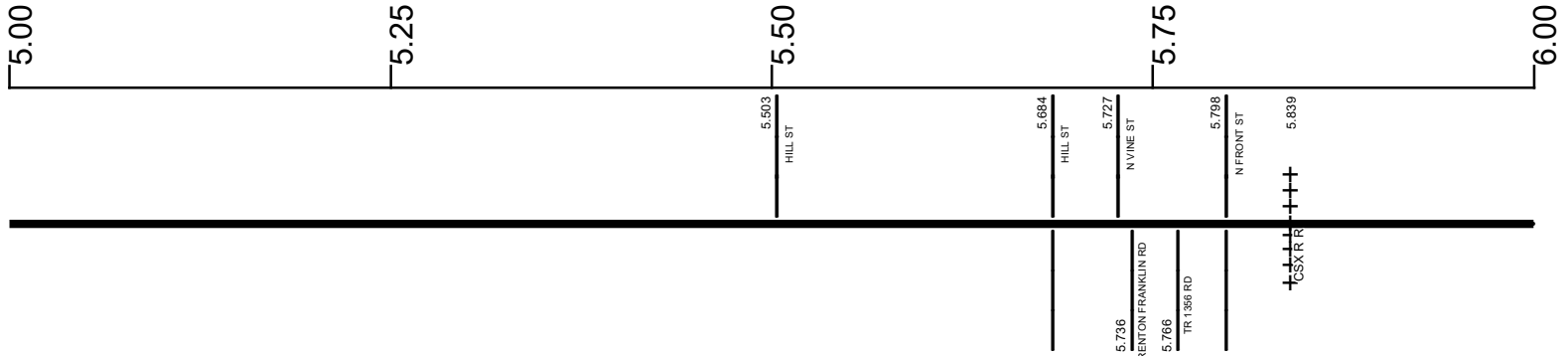

Surface Type & Width (Left / Right)

G 36'	G 20'	G 24'
4.507 - 5.727	5.727 - 5.818	5.818 - 6.132

Base Type (Left / Right)

I	P
4.623 - 5.818	5.818 - 6.132

Shoulder Type & Width (Left / Right)

5 (6'/6')	2 (14'/14')	2 (3'/3')
4.623 - 5.727	5.727 - 5.818	5.818 - 6.335

Through Lanes

3	2
4.507 - 5.727	5.727 - 7.032

Street Name

MIDDLETOWN EATON RD 0 - 6.209

- Non-divided Highway
- Divided Highway
- Secondary Segment
- Corporation
- Bridge (on route)
- Underpass
- Overpass
- Railroad (at grade)
- Railroad (underpass)
- Railroad (overpass)
- Intersection

Created on: 6/24/2025

transportation.ohio.gov

Prepared by
The Ohio Department of Transportation
Office of Technical Services
Roadway Information

SBUTSR00122**C

State True Log

31.476

County True Log

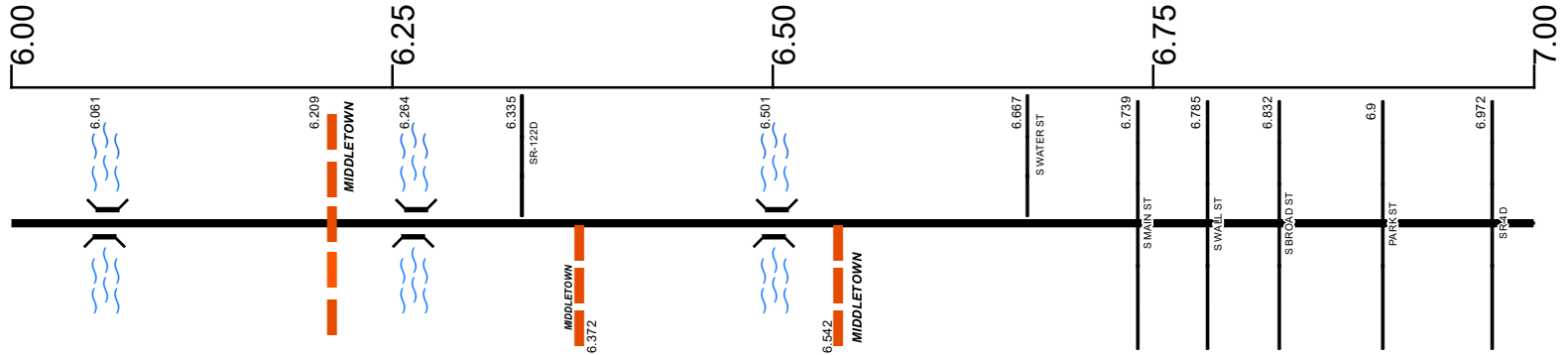

Surface Type & Width (Left / Right)

G 24'	D 24'	G 24'	G (14'/15')	G 32'	G (17'/18')
5.818 - 6.132	6.132 - 6.335	6.335 - 6.55	6.55 - 6.861	6.861 - 6.972	6.972 - 7.032

Base Type (Left / Right)

P	I	T	L
5.818 - 6.132	6.335 - 6.55	6.55 - 6.739	6.739 - 7.032

Shoulder Type & Width (Left / Right)

2 (3'/3')	5 (4'/4')	1 (0'/0')
5.818 - 6.335	6.335 - 6.55	6.55 - 7.032

Through Lanes

2
5.727 - 7.032

Street Name

MIDDLETOWN EATON RD	CENTRAL AVE	CARMODY BLVD	2ND AVE
0 - 6.209	6.209 - 6.335	6.335 - 6.542	6.542 - 7.032

Non-divided Highway	Bridge (on route)	Railroad (at grade)	Intersection
Divided Highway	Underpass	Railroad (underpass)	
Secondary Segment	Overpass	Railroad (overpass)	
Corporation			

Created on: 6/24/2025

transportation.ohio.gov

Prepared by
The Ohio Department of Transportation
Office of Technical Services
Roadway Information

SBUTSR00122**C

State True Log

32.476

County True Log

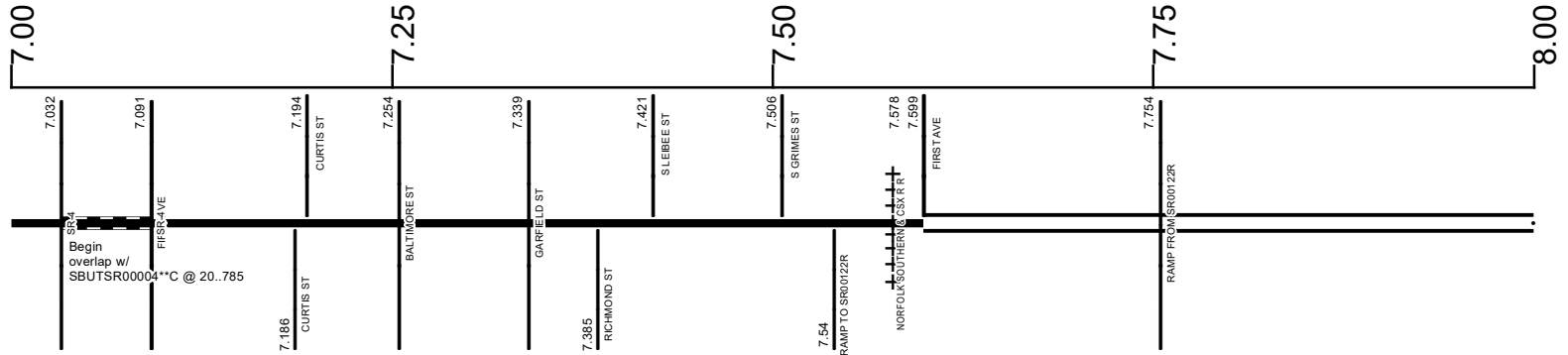

Surface Type & Width (Left / Right)

G (17'/18')	G 40'	G (17'/18')	G 26'	G (37'/27')	G 74'
6.972 - 7.032	7.091 - 7.413	7.413 - 7.558	7.558 - 7.599	7.599 - 7.699	7.699 - 8.667

Base Type (Left / Right)

L	T	L
6.739 - 7.032	7.091 - 7.558	7.558 - 11.441

Shoulder Type & Width (Left / Right)

1 (0'/0')	1 (0'/0')
6.55 - 7.032	7.091 - 11.094

Median Type and Width

3 (16')
7.599 - 9.661

Through Lanes

2	2	5	6
5.727 - 7.032	7.091 - 7.599	7.599 - 7.699	7.699 - 8.667

Street Name

2ND AVE	1ST AVE	UNIVERSITY BLVD
6.542 - 7.032	7.091 - 7.599	7.599 - 8.23

- Non-divided Highway
- Divided Highway
- Secondary Segment
- Corporation
- Bridge (on route)
- Underpass
- Overpass
- Railroad (at grade)
- Railroad (underpass)
- Railroad (overpass)
- Intersection

Created on: 6/24/2025

transportation.ohio.gov

Prepared by
The Ohio Department of Transportation
Office of Technical Services
Roadway Information

SBUTSR00122**C

State True Log

33.476

County True Log

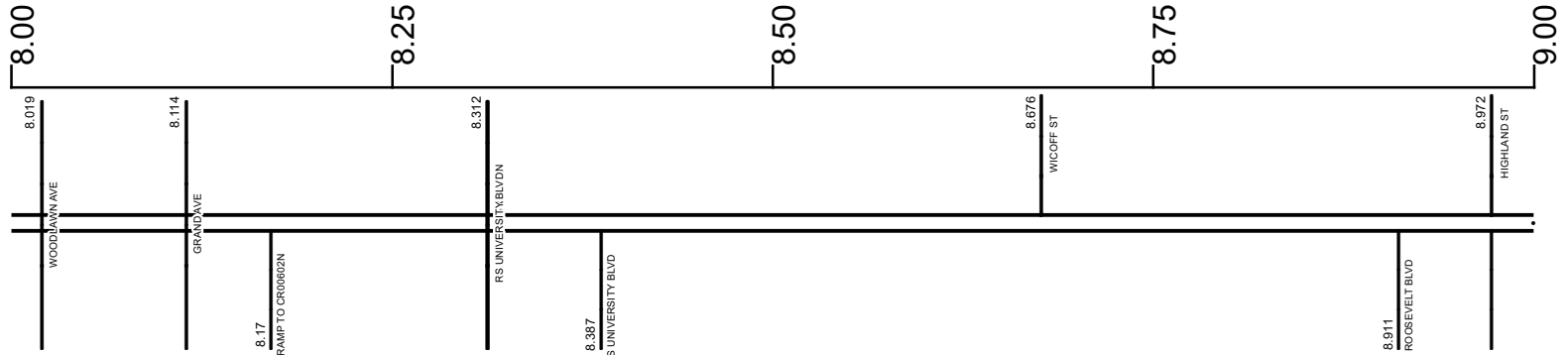

Surface Type & Width (Left / Right)

G 74'	G (27'/37')	G 50'
7.699 - 8.667	8.667 - 8.962	8.962 - 9.068

Base Type (Left / Right)

L
7.558 - 11.441

Shoulder Type & Width (Left / Right)

1 (0'/0')
7.091 - 11.094

Median Type and Width

3 (16')
7.599 - 9.661

Through Lanes

6	4
7.699 - 8.667	8.667 - 11.094

Street Name

UNIVERSITY BLVD	ROOSEVELT BLVD
7.599 - 8.23	8.23 - 11.441

- Non-divided Highway
- Divided Highway
- Secondary Segment
- Corporation
- Bridge (on route)
- Underpass
- Overpass
- Railroad (at grade)
- Railroad (underpass)
- Railroad (overpass)
- Intersection

Created on: 6/24/2025

transportation.ohio.gov

Prepared by
The Ohio Department of Transportation
Office of Technical Services
Roadway Information

SBUTSR00122**C

State True Log

34.476

County True Log

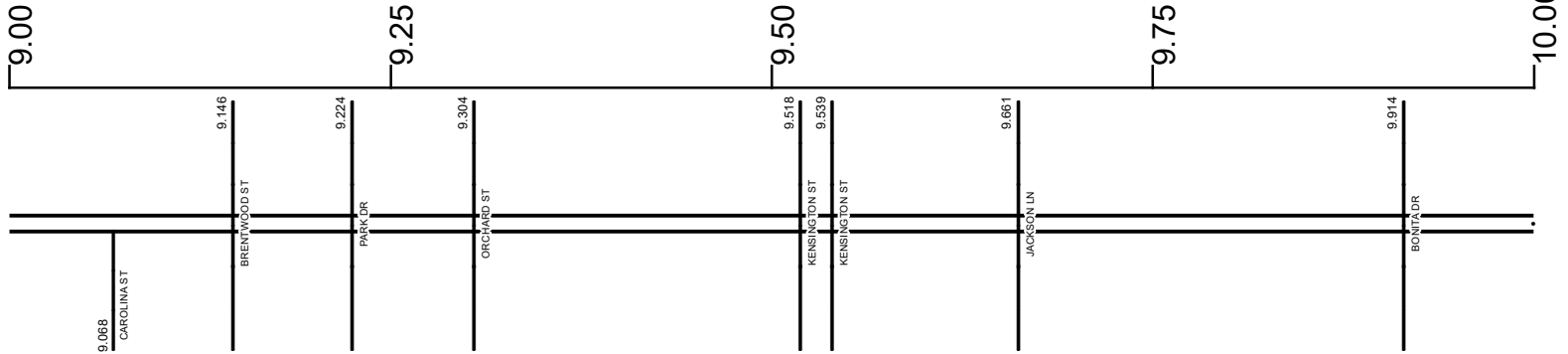

Surface Type & Width (Left / Right)

G 50'	G 58'
8.962 - 9.068	9.068 - 11.094

Base Type (Left / Right)

L	
7.558 - 11.441	

Shoulder Type & Width (Left / Right)

1 (0'/0')	
7.091 - 11.094	

Median Type and Width

3 (16')	3 (36')
7.599 - 9.661	9.661 - 11.094

Through Lanes

4	
8.667 - 11.094	

Street Name

ROOSEVELT BLVD	
8.23 - 11.441	

- Non-divided Highway
- Divided Highway
- Secondary Segment
- Corporation
- Bridge (on route)
- Underpass
- Overpass
- Railroad (at grade)
- Railroad (underpass)
- Railroad (overpass)
- Intersection

Created on: 6/24/2025

transportation.ohio.gov

Prepared by
The Ohio Department of Transportation
Office of Technical Services
Roadway Information

SBUTSR00122**C

State True Log

35.476

County True Log

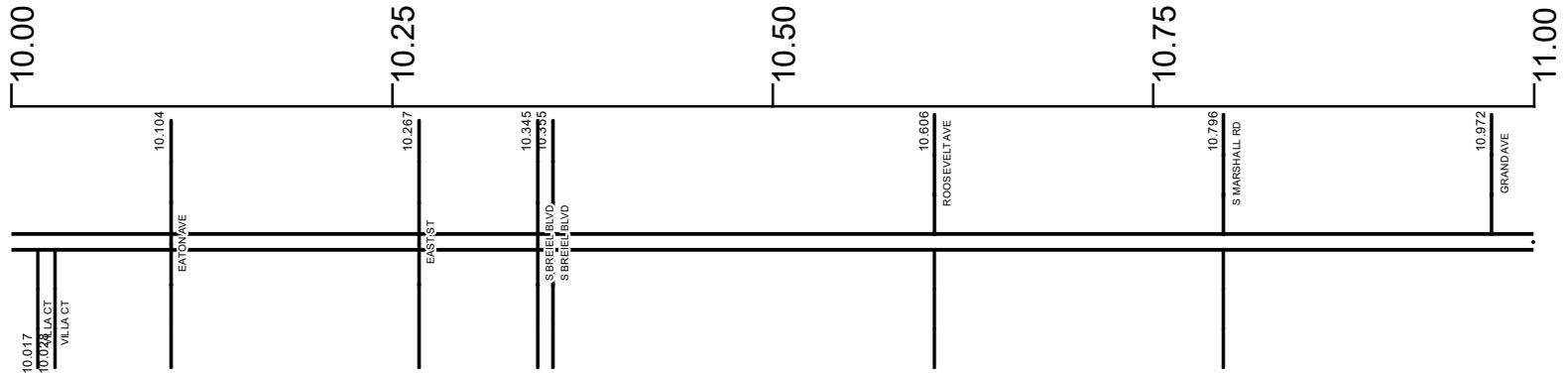

Surface Type & Width (Left / Right)

G 58'
9.068 - 11.094

Base Type (Left / Right)

L
7.558 - 11.441

Shoulder Type & Width (Left / Right)

1 (0/0')
7.091 - 11.094

Median Type and Width

3 (36')
9.661 - 11.094

Resurface Year

2021

10.267 - 10.418

Through Lanes

4
8.667 - 11.094

Street Name

ROOSEVELT BLVD
8.23 - 11.441

- | | | | |
|---------------------|-------------------|----------------------|--------------|
| Non-divided Highway | Bridge (on route) | Railroad (at grade) | Intersection |
| Divided Highway | Underpass | Railroad (underpass) | |
| Secondary Segment | Overpass | Railroad (overpass) | |
| Corporation | | | |

Created on: 6/24/2025

transportation.ohio.gov

Prepared by
The Ohio Department of Transportation
Office of Technical Services
Roadway Information

SBUTSR00122**C

35.917

State True
Log

County True
Log

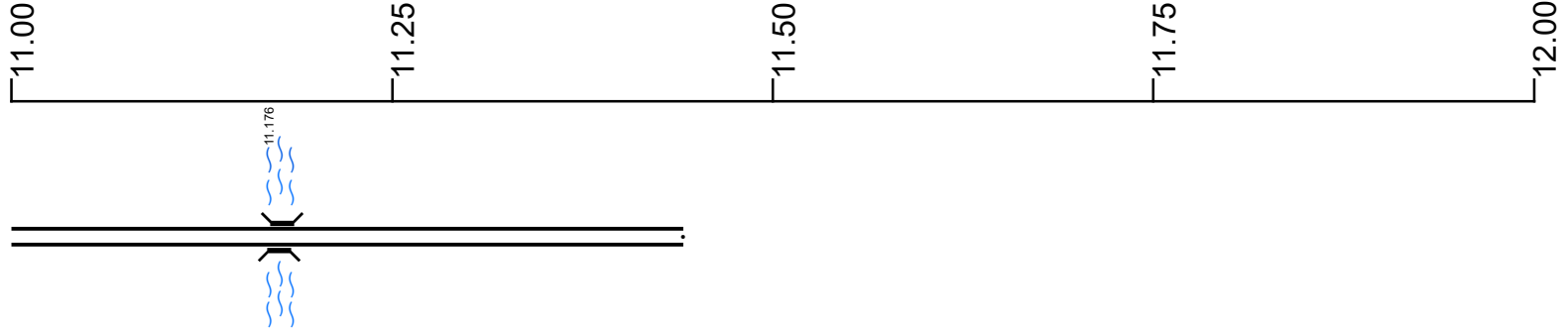

Surface Type & Width (Left / Right)

G 58'	G (36'/24')	G (36'/40')	G 80'
9.068 - 11.094	11.094 - 11.207	11.207 - 11.268	11.268 - 11.441

Base Type (Left / Right)

L
7.558 - 11.441

Shoulder Type & Width (Left / Right)

1 (0'/0')	2 (12'/12')	1 (12'/0')	1 (0'/0')
7.091 - 11.094	11.094 - 11.207	11.207 - 11.268	11.268 - 11.441

Median Type and Width

3 (36')	3 (20')	3 (31')
9.661 - 11.094	11.094 - 11.207	11.207 - 11.441

Through Lanes

4	5	6
8.667 - 11.094	11.094 - 11.207	11.207 - 11.441

Street Name

ROOSEVELT BLVD
8.23 - 11.441

<p> Non-divided Highway</p> <p> Divided Highway</p> <p> Secondary Segment</p> <p> Corporation</p>	<p> Bridge (on route)</p> <p> Underpass</p> <p> Overpass</p>	<p> Railroad (at grade)</p> <p> Railroad (underpass)</p> <p> Railroad (overpass)</p>	<p> Intersection</p>
---	--	--	----------------------

Created on: 6/24/2025

transportation.ohio.gov

Prepared by

The Ohio Department of Transportation

Office of Technical Services

Roadway Information

Historical Project List for SBUTSR00122**C

Begin Measure	End Measure	Project ID Number	Construction Completion Date	Treatment Category	Treatment Type
0.000	3.859	100560	10-2016	Minor Rehabilitation	50-AC Overlay w/o Rpr
0.000	3.859	20240	11-2005	Minor Rehabilitation	60-AC Overlay w/Rpr
3.859	5.736	87187	5-2016	Minor Rehabilitation	60-AC Overlay w/Rpr
5.634	6.061	77928	6-2010	Minor Rehabilitation	60-AC Overlay w/Rpr
6.173	6.254	110559	7-2023	Minor Rehabilitation	50-AC Overlay w/o Rpr
6.550	7.032	21932	12-2003	Minor Rehabilitation	60-AC Overlay w/Rpr
7.699	11.441	21932	12-2003	Minor Rehabilitation	60-AC Overlay w/Rpr

Roadway Codes

Access Control Journalized

- F - Full Access Control
- L - Limited Access Control
- N - No Access Control

Access Control Operational

- 1 - Full Access Control
- 2 - Partial Access Control
- 3 - No Access Control

Base Type

- F - Crack and Seat
- H - Rubblize and Roll
- I - Aggregate Base 304 or Traffic Compacted
- K - Water Bound Macadam
- L - Bituminous Concrete Mix or Penetration Macadam
- N - Plain Concrete
- P - Reinforced Concrete
- R - Brick (Flexible)
- T - Brick (Rigid)

Direction of Travel

- B - Both (Two-way)
- F - One-way Cardinal
- T - One-way Non-cardinal

Facility Type

- 1 - One-way Roadway
- 2 - Two-way Roadway
- 4 - Ramp
- 5 - Non-mainline
- 6 - Non-inventory Direction
- 7 - Planned / Unbuilt

Historical Federal Aid Indicator

- N - Not a FAP Route
- Y - FAP Route

Functional Classification

- 01 - Interstate
- 02 - Principal Arterial (Freeways)
- 03 - Principal Arterial (Other)
- 04 - Minor Arterial
- 05 - Major Collector
- 06 - Minor Collector
- 07 - Local

Leave / Reenter Indicator

- Y - Route leaves/reenters at this point
- N - Route does not leave/reenter at this point

Median Type

- 1 - None
- 2 - Unprotected
- 3 - Curbed
- 4 - Positive Barrier (Unspecified)
- 5 - Positive Barrier (Flexible)
- 6 - Positive Barrier (Semi-rigid)
- 7 - Positive Barrier (Rigid)

NHS

- N - National Highway System
- H - Congressional Corridor
- 2 - Major Airport
- 3 - Major Port Facility
- 4 - Major Amtrak Station
- 5 - Major Rail / Truck Terminal
- 6 - Major Intercity Bus Terminal
- 7 - Major Public Transit / Multi-modal Passenger Terminal
- 8 - Major Pipeline Terminal
- 9 - Major Ferry Terminal

Priority System

- G - General
- P - Priority System
- U - Urban

Scenic Byway Code

- A - All American Road
- N - National Scenic Byway
- S - State Scenic Byway

Shoulder Type

- 1 - None
- 2 - Surfaced shoulder exists (bituminous concrete {AC})
- 3 - Surfaced shoulder exists (Portland Cement Concrete {PCC})
- 4 - Stabilized shoulder exists (gravel or other granular material)
- 5 - Combination shoulder exists (two or more surface types)
- 6 - Earth shoulder exists
- 7 - Barrier curb exists; no shoulder in front of curb

Surface Type

- A - Combination
- B - Brick
- C - Continuous Reinforced Concrete
- D - Reinforced Concrete
- E - Plain Concrete
- G - Bituminous Concrete
- I - Chipseal on Granular
- K - Open Graded Bituminous
- L - Chipseal or Micro
- M - Gravel
- U - Unimproved
- X - Right of Way Only