

SCARSR00043**C

State True Log 21.671

22.671

County True Log

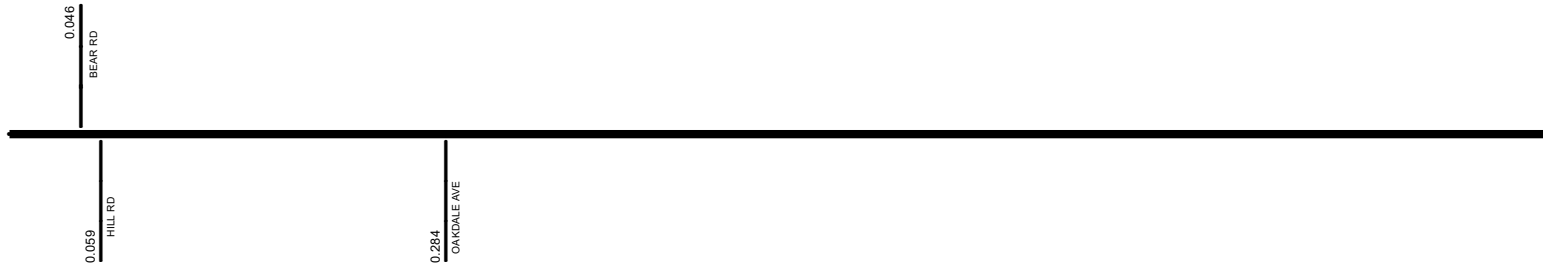

Surface Type & Width (Left / Right)

G (16'/5')
0 - 5.753

Base Type (Left / Right)

L / K
0 - 5.753

Shoulder Type & Width (Left / Right)

5 (1'/1')
0 - 7.31

Through Lanes

2
0 - 7.31

Street Name

STEUBENVILLE RD
0 - 7.31

- | | | | |
|---------------------|-------------------|----------------------|--------------|
| Non-divided Highway | Bridge (on route) | Railroad (at grade) | Intersection |
| Divided Highway | Underpass | Railroad (underpass) | |
| Secondary Segment | Overpass | Railroad (overpass) | |
| Corporation | | | |

Created on: 6/24/2025



transportation.ohio.gov
 Prepared by
 The Ohio Department of Transportation
 Office of Technical Services
 Roadway Information

SCARSR00043**C

State True Log

23.671

County True Log



Surface Type & Width (Left / Right)

G (16/5')
0 - 5.753

Base Type (Left / Right)

L / K
0 - 5.753

Shoulder Type & Width (Left / Right)

5 (1/1')
0 - 7.31

Through Lanes

2
0 - 7.31

Street Name

STEUBENVILLE RD
0 - 7.31

- | | | | |
|--|---|---|---|
| <ul style="list-style-type: none"> Non-divided Highway Divided Highway Secondary Segment Corporation | <ul style="list-style-type: none"> Bridge (on route) Underpass Overpass | <ul style="list-style-type: none"> Railroad (at grade) Railroad (underpass) Railroad (overpass) | <ul style="list-style-type: none"> Intersection |
|--|---|---|---|

Created on: 6/24/2025

transportation.ohio.gov

Prepared by
The Ohio Department of Transportation
Office of Technical Services
Roadway Information

SCARSR00043**C

State True Log

24.671

County True Log

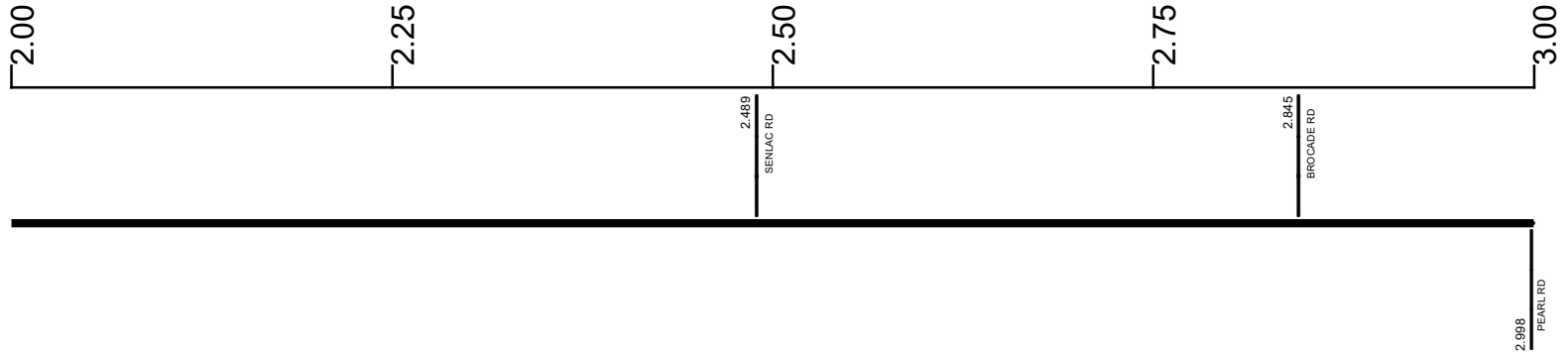

Surface Type & Width (Left / Right)

G (16'/5')
0 - 5.753

Base Type (Left / Right)

L / K
0 - 5.753

Shoulder Type & Width (Left / Right)

5 (1'/1')
0 - 7.31

Through Lanes

2
0 - 7.31

Street Name

STEUBENVILLE RD
0 - 7.31

- | | | | |
|---------------------|-------------------|----------------------|--------------|
| Non-divided Highway | Bridge (on route) | Railroad (at grade) | Intersection |
| Divided Highway | Underpass | Railroad (underpass) | |
| Secondary Segment | Overpass | Railroad (overpass) | |
| Corporation | | | |

Created on: 6/24/2025

transportation.ohio.gov

Prepared by
The Ohio Department of Transportation
Office of Technical Services
Roadway Information

SCARSR00043**C

State True Log

25.671

County True Log

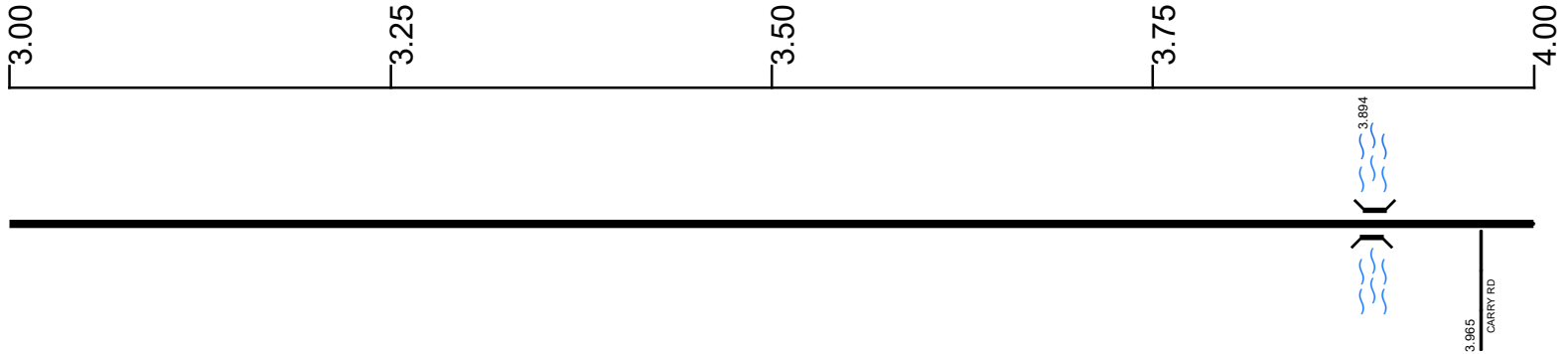

Surface Type & Width (Left / Right)

G (16'/5')
0 - 5.753

Base Type (Left / Right)

L / K
0 - 5.753

Shoulder Type & Width (Left / Right)

5 (1'/1')
0 - 7.31

Through Lanes

2
0 - 7.31

Street Name

STEUBENVILLE RD
0 - 7.31

- Non-divided Highway
- Divided Highway
- Secondary Segment
- Corporation
- Bridge (on route)
- Underpass
- Overpass
- Railroad (at grade)
- Railroad (underpass)
- Railroad (overpass)
- Intersection

Created on: 6/24/2025

transportation.ohio.gov
Prepared by
The Ohio Department of Transportation
Office of Technical Services
Roadway Information

SCARSR00043**C

State True Log

26.671

County True Log

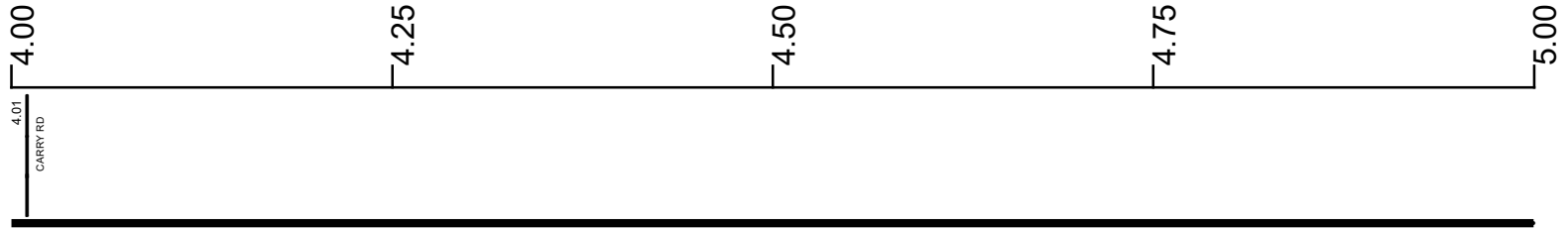

Surface Type & Width (Left / Right)

G (16'/5')
0 - 5.753

Base Type (Left / Right)

L / K
0 - 5.753

Shoulder Type & Width (Left / Right)

5 (1'/1')
0 - 7.31

Through Lanes

2
0 - 7.31

Street Name

STEUBENVILLE RD
0 - 7.31

- | | | | |
|--|---|---|---|
| <ul style="list-style-type: none"> Non-divided Highway Divided Highway Secondary Segment Corporation | <ul style="list-style-type: none"> Bridge (on route) Underpass Overpass | <ul style="list-style-type: none"> Railroad (at grade) Railroad (underpass) Railroad (overpass) | <ul style="list-style-type: none"> Intersection |
|--|---|---|---|

Created on: 6/24/2025

transportation.ohio.gov

Prepared by
The Ohio Department of Transportation
Office of Technical Services
Roadway Information

SCARSR00043**C

State True Log

27.671

County True Log



Surface Type & Width (Left / Right)

G (16'/5')	G 20'
0 - 5.753	5.753 - 7.31

Base Type (Left / Right)

L / K	T
0 - 5.753	5.753 - 7.31

Shoulder Type & Width (Left / Right)

5 (1'/1')	
0 - 7.31	

Through Lanes

2	
0 - 7.31	

Street Name

STEUBENVILLE RD	
0 - 7.31	

- Non-divided Highway
- Divided Highway
- Secondary Segment
- Corporation
- Bridge (on route)
- Underpass
- Overpass
- Railroad (at grade)
- Railroad (underpass)
- Railroad (overpass)
- Intersection

Created on: 6/24/2025

transportation.ohio.gov

Prepared by
The Ohio Department of Transportation
Office of Technical Services
Roadway Information

SCARSR00043**C

State True Log

28.671

County True Log

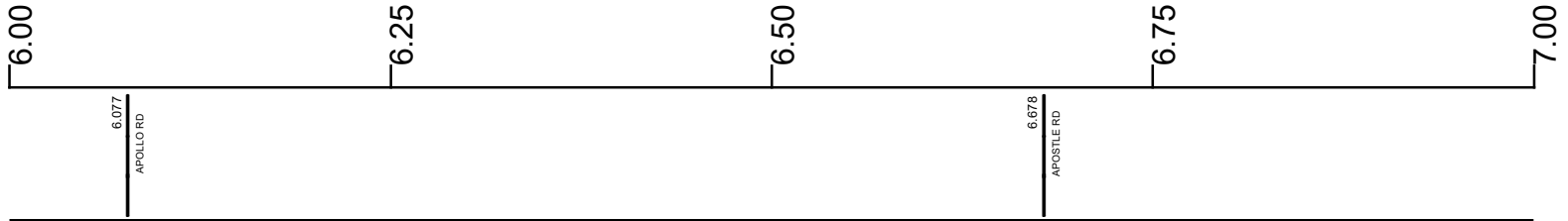

Surface Type & Width (Left / Right)

G 20'
5.753 - 7.31

Base Type (Left / Right)

T
5.753 - 7.31

Shoulder Type & Width (Left / Right)

5 (1/1')
0 - 7.31

Through Lanes

2
0 - 7.31

Street Name

STEUBENVILLE RD
0 - 7.31

- | | | | |
|---------------------|-------------------|----------------------|--------------|
| Non-divided Highway | Bridge (on route) | Railroad (at grade) | Intersection |
| Divided Highway | Underpass | Railroad (underpass) | |
| Secondary Segment | Overpass | Railroad (overpass) | |
| Corporation | | | |

Created on: 6/24/2025

transportation.ohio.gov

Prepared by
The Ohio Department of Transportation
Office of Technical Services
Roadway Information

SCARSR00043**C

State True Log

29.671

County True Log

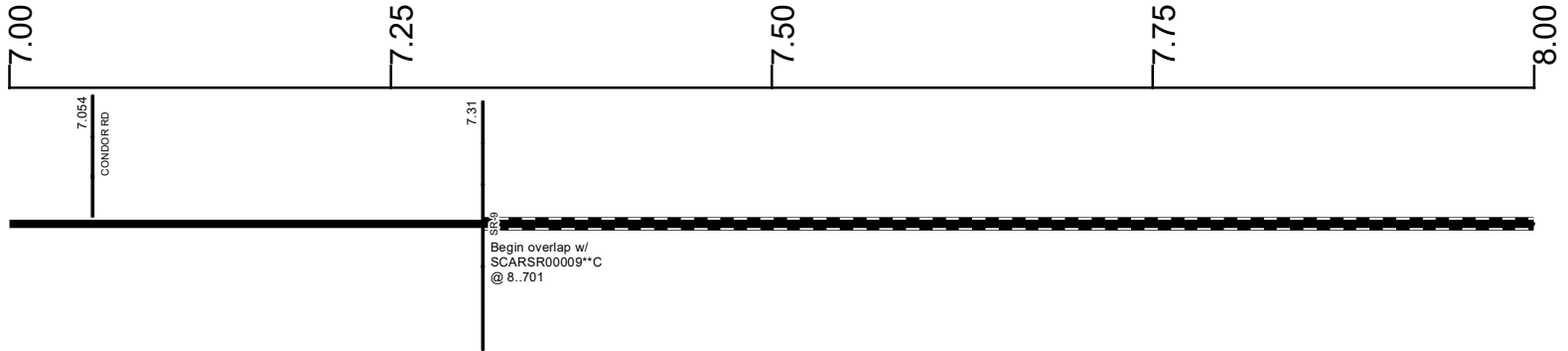

Surface Type & Width (Left / Right)

G 20'
5.753 - 7.31

Base Type (Left / Right)

T
5.753 - 7.31

Shoulder Type & Width (Left / Right)

5 (1'1')
0 - 7.31

Through Lanes

2
0 - 7.31

Street Name

STEUBENVILLE RD
0 - 7.31

- Non-divided Highway
 Bridge (on route)
 Railroad (at grade)
 Intersection
- Divided Highway
 Underpass
 Railroad (underpass)
- Secondary Segment
 Overpass
 Railroad (overpass)
- Corporation**

Created on: 6/24/2025

SCARSR00043**C

State True Log

30.671

County True Log

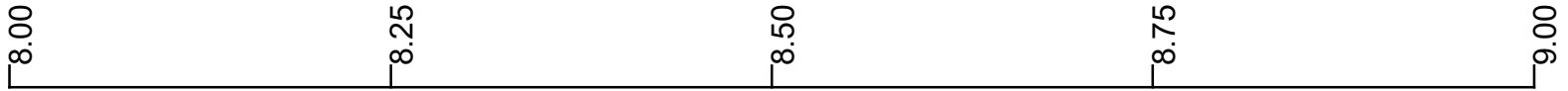

- | | | | |
|---------------------|-------------------|----------------------|--------------|
| Non-divided Highway | Bridge (on route) | Railroad (at grade) | Intersection |
| Divided Highway | Underpass | Railroad (underpass) | |
| Secondary Segment | Overpass | Railroad (overpass) | |
| Corporation | | | |

Created on: 6/24/2025

transportation.ohio.gov
 Prepared by
 The Ohio Department of Transportation
 Office of Technical Services
 Roadway Information

SCARSR00043**C

State True Log

31.671

County True Log



- | | | | |
|---------------------|-------------------|----------------------|--------------|
| Non-divided Highway | Bridge (on route) | Railroad (at grade) | Intersection |
| Divided Highway | Underpass | Railroad (underpass) | |
| Secondary Segment | Overpass | Railroad (overpass) | |
| Corporation | | | |

Created on: 6/24/2025

Prepared by
The Ohio Department of Transportation
Office of Technical Services
Roadway Information

SCARSR00043**C

State True
Log

32.671

County True
Log

10.00

10.25

10.50

10.75

11.00



Non-divided Highway	Bridge (on route)	Railroad (at grade)	Intersection
Divided Highway	Underpass	Railroad (underpass)	
Secondary Segment	Overpass	Railroad (overpass)	
Corporation			

Created on: 6/24/2025

Prepared by
The Ohio Department of Transportation
Office of Technical Services
Roadway Information

SCARSR00043**C

State True Log

33.671

County True Log

11:00

11:25

11:50

11:75

12:00



- | | | | |
|---------------------|-------------------|----------------------|--------------|
| Non-divided Highway | Bridge (on route) | Railroad (at grade) | Intersection |
| Divided Highway | Underpass | Railroad (underpass) | |
| Secondary Segment | Overpass | Railroad (overpass) | |
| Corporation | | | |

Created on: 6/24/2025

transportation.ohio.gov
 Prepared by
 The Ohio Department of Transportation
 Office of Technical Services
 Roadway Information

SCARSR00043**C

State True Log

34.671

County True Log

12.00

12.25

12.50

12.75

13.00



Begin overlap w/
SCARSR00039**C
@ 14.636

Non-divided Highway	Bridge (on route)	Railroad (at grade)	Intersection
Divided Highway	Underpass	Railroad (underpass)	
Secondary Segment	Overpass	Railroad (overpass)	
Corporation			

Created on: 6/24/2025

transportation.ohio.gov
Prepared by
The Ohio Department of Transportation
Office of Technical Services
Roadway Information

SCARSR00043**C

State True Log
County True Log

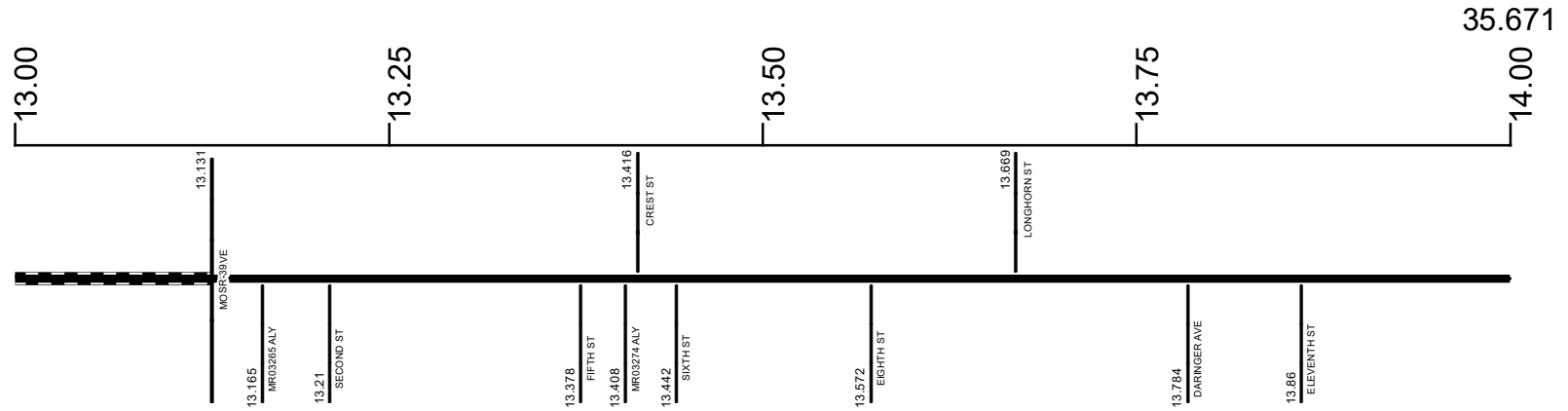

Surface Type & Width (Left / Right)	G (20'/16')
	13.131 - 14.127
Base Type (Left / Right)	T / L
	13.131 - 16.16
Shoulder Type & Width (Left / Right)	1 (0'/0')
	13.131 - 14.127
Resurface Year	2020
Through Lanes	13.131 - 16.16
	2
Street Name	13.131 - 26.651
	CANTON RD
	13.131 - 22.398

- Non-divided Highway
- Divided Highway
- Secondary Segment
- Corporation
- Bridge (on route)
- Underpass
- Overpass
- Railroad (at grade)
- Railroad (underpass)
- Railroad (overpass)
- Intersection

Created on: 6/24/2025

transportation.ohio.gov

Prepared by
The Ohio Department of Transportation
Office of Technical Services
Roadway Information

SCARSR00043**C

State True Log
County True Log

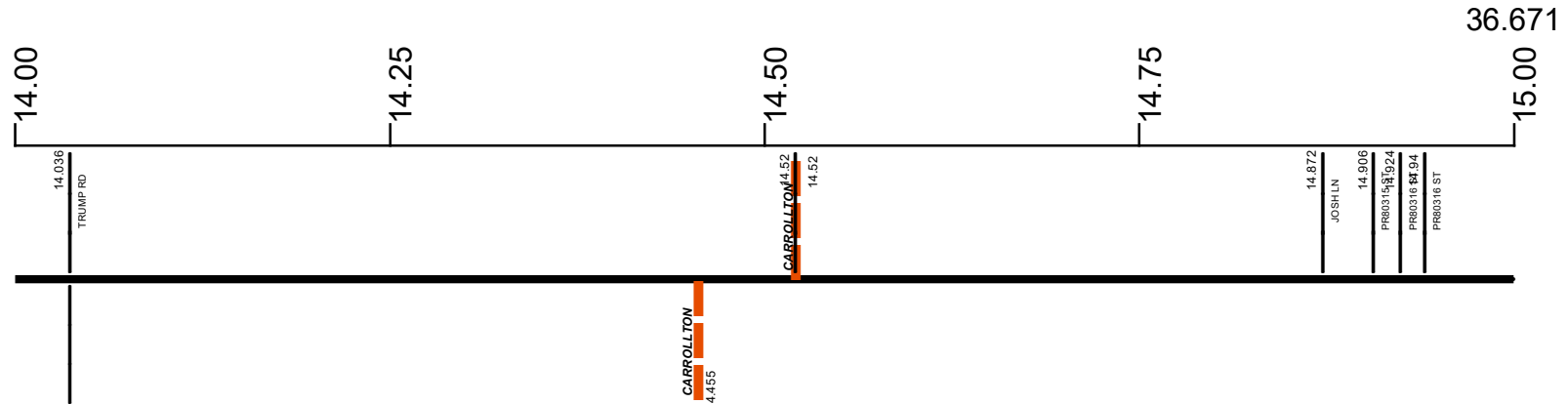

Surface Type & Width (Left / Right)

G (20'/16') 13.131 - 14.127	G (20'/4') 14.127 - 16.16
--------------------------------	------------------------------

Base Type (Left / Right)

T / L 13.131 - 16.16	
-------------------------	--

Shoulder Type & Width (Left / Right)

1 (0'/0') 13.131 - 14.127	5 (2'/6") 14.127 - 14.52	5 (2'/3") 14.52 - 15.084
------------------------------	-----------------------------	-----------------------------

Resurface Year

2020 13.131 - 16.16

Through Lanes

2 13.131 - 26.651

Street Name

CANTON RD 13.131 - 22.398

- Non-divided Highway
 Bridge (on route)
 Railroad (at grade)
 Intersection
- Divided Highway
 Underpass
 Railroad (underpass)
- Secondary Segment
 Overpass
 Railroad (overpass)
- Corporation**

Created on: 6/24/2025

transportation.ohio.gov

Prepared by
The Ohio Department of Transportation
Office of Technical Services
Roadway Information

SCARSR00043**C

State True Log

37.671

County True Log

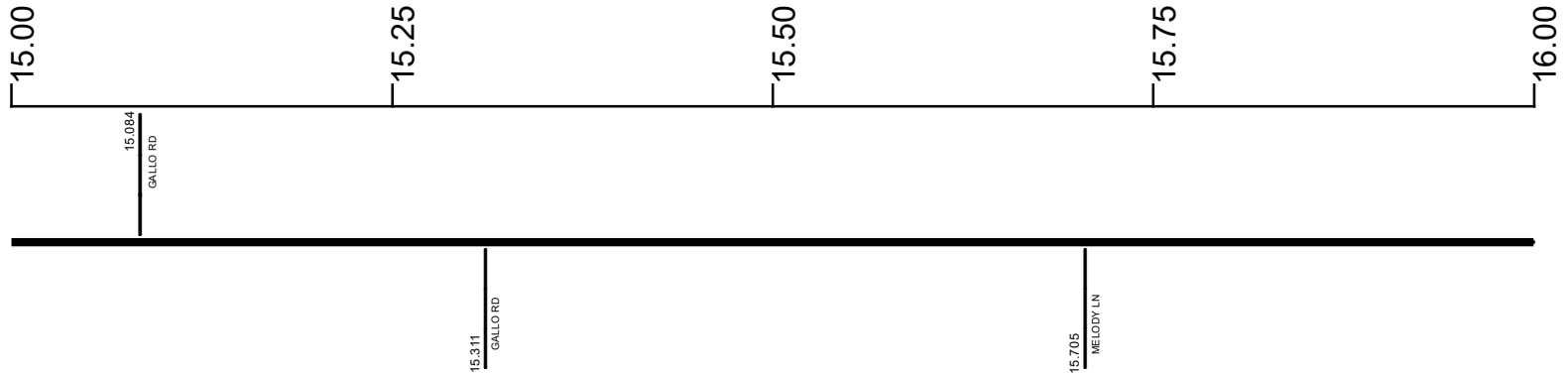

Surface Type & Width (Left / Right)

G (20'4')
14.127 - 16.16

Base Type (Left / Right)

T / L
13.131 - 16.16

Shoulder Type & Width (Left / Right)

5 (2'3')	5 (2'2')
14.52 - 15.084	15.084 - 26.651

Resurface Year

2020
13.131 - 16.16

Through Lanes

2
13.131 - 26.651

Street Name

CANTON RD
13.131 - 22.398

- | | | | |
|---------------------|-------------------|----------------------|--------------|
| Non-divided Highway | Bridge (on route) | Railroad (at grade) | Intersection |
| Divided Highway | Underpass | Railroad (underpass) | |
| Secondary Segment | Overpass | Railroad (overpass) | |
| Corporation | | | |

Created on: 6/24/2025

transportation.ohio.gov

Prepared by
The Ohio Department of Transportation
Office of Technical Services
Roadway Information

SCARSR00043**C

State True Log

38.671

County True Log

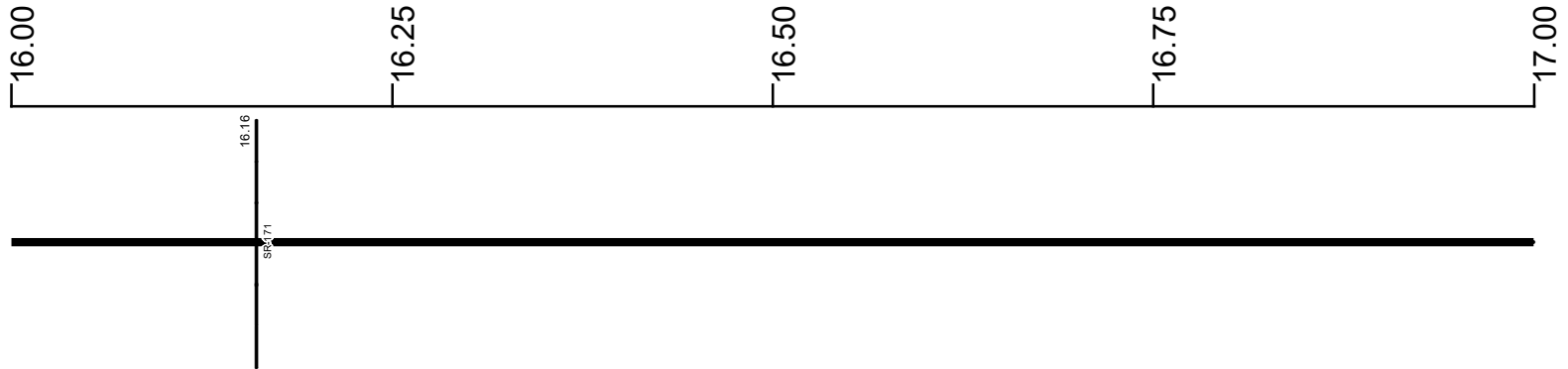

Surface Type & Width (Left / Right)

G (20'/4') 14.127 - 16.16	G 24' 16.16 - 18.09
------------------------------	------------------------

Base Type (Left / Right)

T / L 13.131 - 16.16	L 16.16 - 18.09
-------------------------	--------------------

Shoulder Type & Width (Left / Right)

	5 (2'/2') 15.084 - 26.651
--	------------------------------

Resurface Year

2020 13.131 - 16.16	2024 16.16 - 22.398
------------------------	------------------------

Through Lanes

	2 13.131 - 26.651
--	----------------------

Street Name

	CANTON RD 13.131 - 22.398
--	------------------------------

- | | | | |
|---------------------|-------------------|----------------------|--------------|
| Non-divided Highway | Bridge (on route) | Railroad (at grade) | Intersection |
| Divided Highway | Underpass | Railroad (underpass) | |
| Secondary Segment | Overpass | Railroad (overpass) | |
| Corporation | | | |

Created on: 6/24/2025

transportation.ohio.gov

Prepared by
The Ohio Department of Transportation
Office of Technical Services
Roadway Information

SCARSR00043**C

State True Log
County True Log

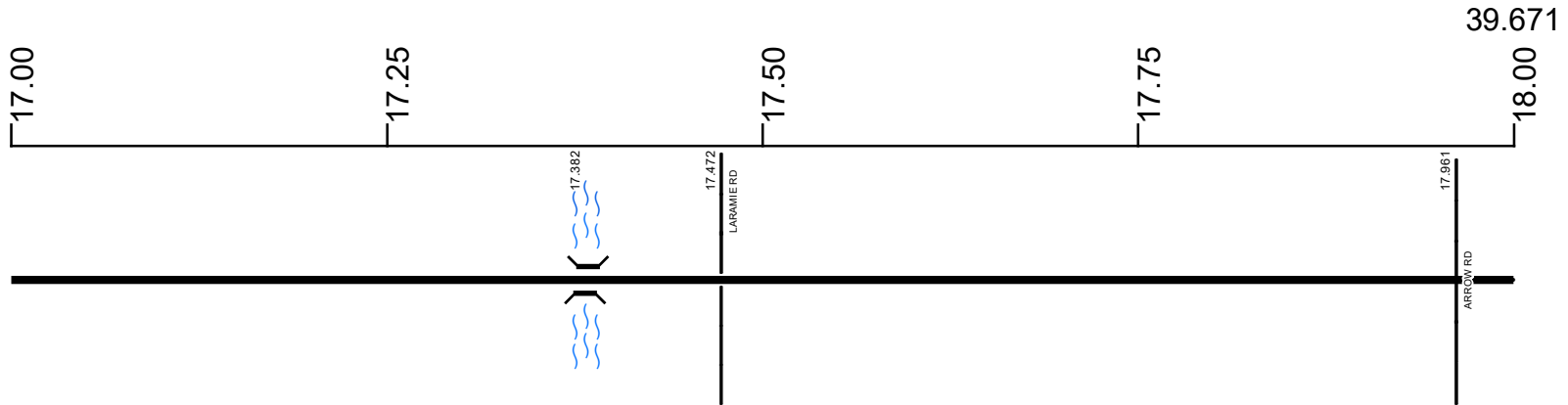

Surface Type & Width (Left / Right)	G 24'
	16.16 - 18.09
Base Type (Left / Right)	L
	16.16 - 18.09
Shoulder Type & Width (Left / Right)	5 (2/2')
	15.084 - 26.651
Resurface Year	2024
	16.16 - 22.398
Through Lanes	2
	13.131 - 26.651
Street Name	CANTON RD
	13.131 - 22.398

- Non-divided Highway
- Divided Highway
- Secondary Segment
- Corporation
- Bridge (on route)
- Underpass
- Overpass
- Railroad (at grade)
- Railroad (underpass)
- Railroad (overpass)
- Intersection

Created on: 6/24/2025



transportation.ohio.gov
Prepared by
The Ohio Department of Transportation
Office of Technical Services
Roadway Information

SCARSR00043**C

State True
Log

40.671

County True
Log

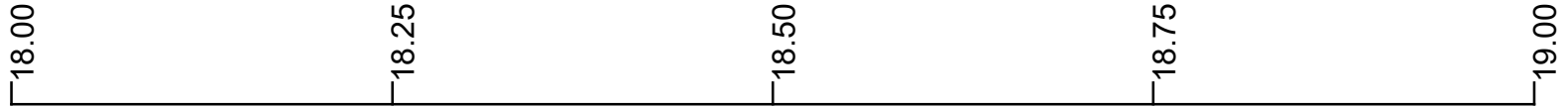

Surface Type & Width (Left / Right)

G 24'	G (19/5')	G 24'
16.16 - 18.09	18.09 - 18.409	18.409 - 19.175

Base Type (Left / Right)

L	R / L	L
16.16 - 18.09	18.09 - 18.409	18.409 - 19.175

Shoulder Type & Width (Left / Right)

	5 (2/2')
	15.084 - 26.651

Resurface Year

	2024
--	------

Through Lanes

	2
	13.131 - 26.651

Street Name

	CANTON RD
	13.131 - 22.398

- Non-divided Highway
 Bridge (on route)
 Railroad (at grade)
 Intersection
- Divided Highway
 Underpass
 Railroad (underpass)
- Secondary Segment
 Overpass
 Railroad (overpass)
- Corporation**

Created on: 6/24/2025

transportation.ohio.gov

Prepared by
The Ohio Department of Transportation
Office of Technical Services
Roadway Information

SCARSR00043**C

State True
Log

41.671

County True
Log

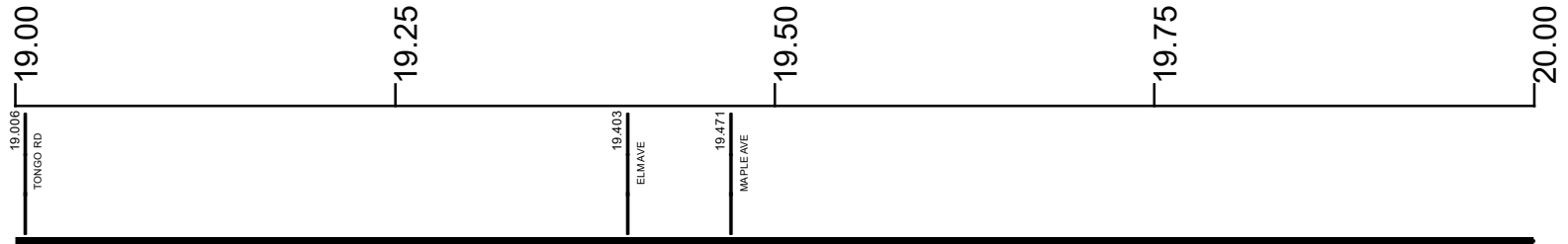

Surface Type & Width (Left / Right)

G 24'	G (19'5')	G 24'
18.409 - 19.175	19.175 - 19.393	19.393 - 21.976

Base Type (Left / Right)

L	R / L	L
18.409 - 19.175	19.175 - 19.393	19.393 - 21.976

Shoulder Type & Width (Left / Right)

5 (2'2')
15.084 - 26.651

Resurface Year

2024

Through Lanes

2
13.131 - 26.651

Street Name

CANTON RD
13.131 - 22.398

- Non-divided Highway
- Divided Highway
- Secondary Segment
- Corporation
- Bridge (on route)
- Underpass
- Overpass
- Railroad (at grade)
- Railroad (underpass)
- Railroad (overpass)
- Intersection

Created on: 6/24/2025

transportation.ohio.gov

Prepared by
The Ohio Department of Transportation
Office of Technical Services
Roadway Information

SCARSR00043**C

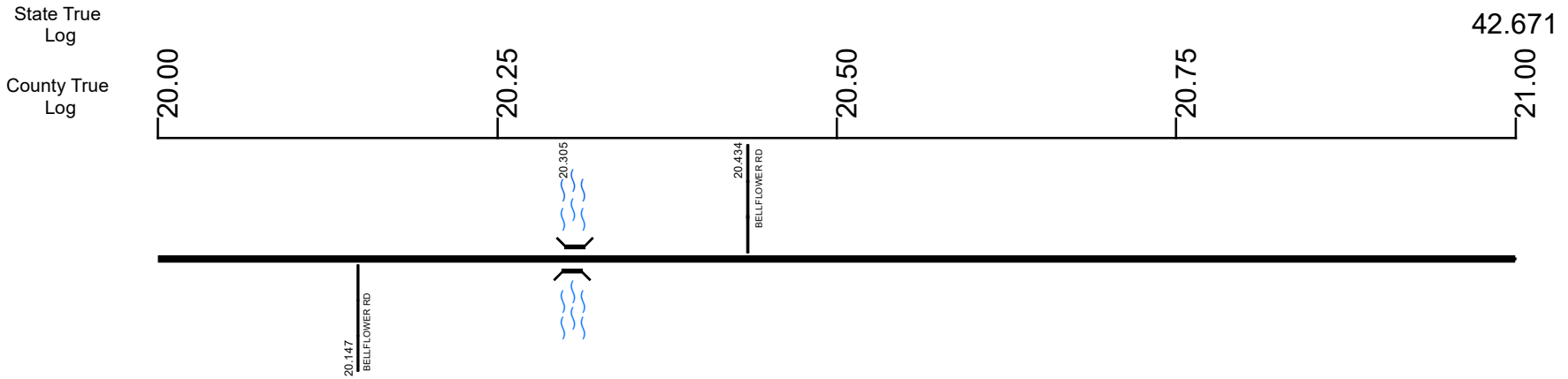

Surface Type & Width (Left / Right)	G 24'
	19.393 - 21.976
Base Type (Left / Right)	L
	19.393 - 21.976
Shoulder Type & Width (Left / Right)	5 (2/2')
	15.084 - 26.651
Resurface Year	2024
	16.16 - 22.398
Through Lanes	2
	13.131 - 26.651
Street Name	CANTON RD
	13.131 - 22.398

Non-divided Highway	Bridge (on route)	Railroad (at grade)	Intersection
Divided Highway	Underpass	Railroad (underpass)	
Secondary Segment	Overpass	Railroad (overpass)	
Corporation			

Created on: 6/24/2025



transportation.ohio.gov
 Prepared by
 The Ohio Department of Transportation
 Office of Technical Services
 Roadway Information

SCARSR00043**C

State True Log

43.671

County True Log

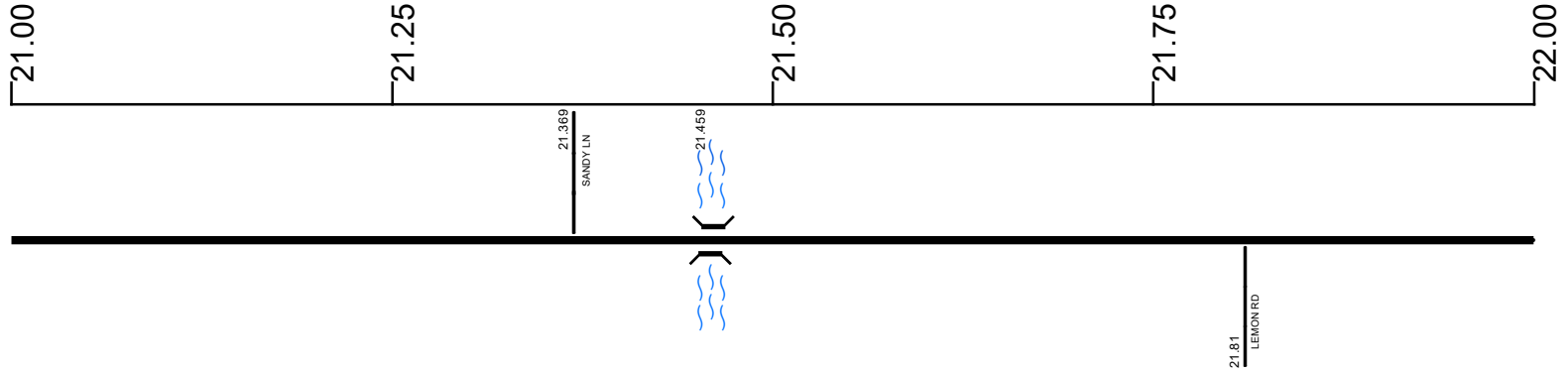

Surface Type & Width (Left / Right)

	G 24'	
	19.393 - 21.976	G (18'6")

Base Type (Left / Right)

	L	
	19.393 - 21.976	R / L

Shoulder Type & Width (Left / Right)

	5 (2'/2')	
	15.084 - 26.651	21.976 - 22.398

Resurface Year

	2024	
--	------	--

Through Lanes

	2	
	13.131 - 26.651	

Street Name

	CANTON RD	
	13.131 - 22.398	

- | | | | |
|---------------------|-------------------|----------------------|--------------|
| Non-divided Highway | Bridge (on route) | Railroad (at grade) | Intersection |
| Divided Highway | Underpass | Railroad (underpass) | |
| Secondary Segment | Overpass | Railroad (overpass) | |
| Corporation | | | |

Created on: 6/24/2025

transportation.ohio.gov

Prepared by
The Ohio Department of Transportation
Office of Technical Services
Roadway Information

SCARSR00043**C

State True Log
County True Log

44.671

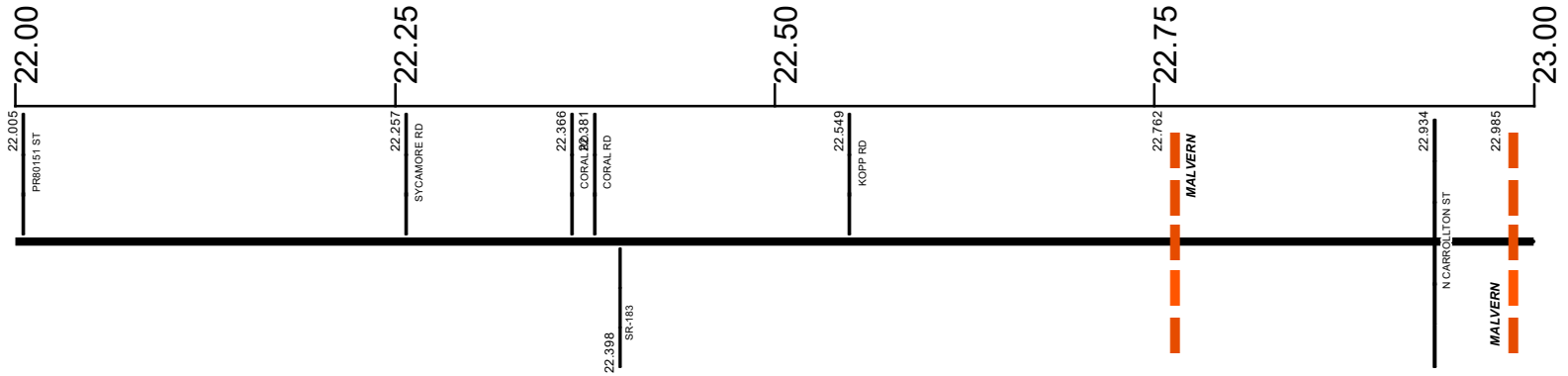

Surface Type & Width (Left / Right)	
G (18'6") 21.976 - 22.398	G (20'4") 22.398 - 24.019
Base Type (Left / Right)	
R / L 21.976 - 22.398	T / L 22.398 - 24.019
Shoulder Type & Width (Left / Right)	
5 (2'2") 15.084 - 26.651	
Resurface Year	
2024 16.16 - 22.398	
Through Lanes	
2 13.131 - 26.651	
Street Name	
CANTON RD 13.131 - 22.398	ALLIANCE RD 22.398 - 23.401

Non-divided Highway	Bridge (on route)	Railroad (at grade)	Intersection
Divided Highway	Underpass	Railroad (underpass)	
Secondary Segment	Overpass	Railroad (overpass)	
Corporation			

Created on: 6/24/2025

transportation.ohio.gov

Prepared by
The Ohio Department of Transportation
Office of Technical Services
Roadway Information

SCARSR00043**C

State True Log

45.671

County True Log

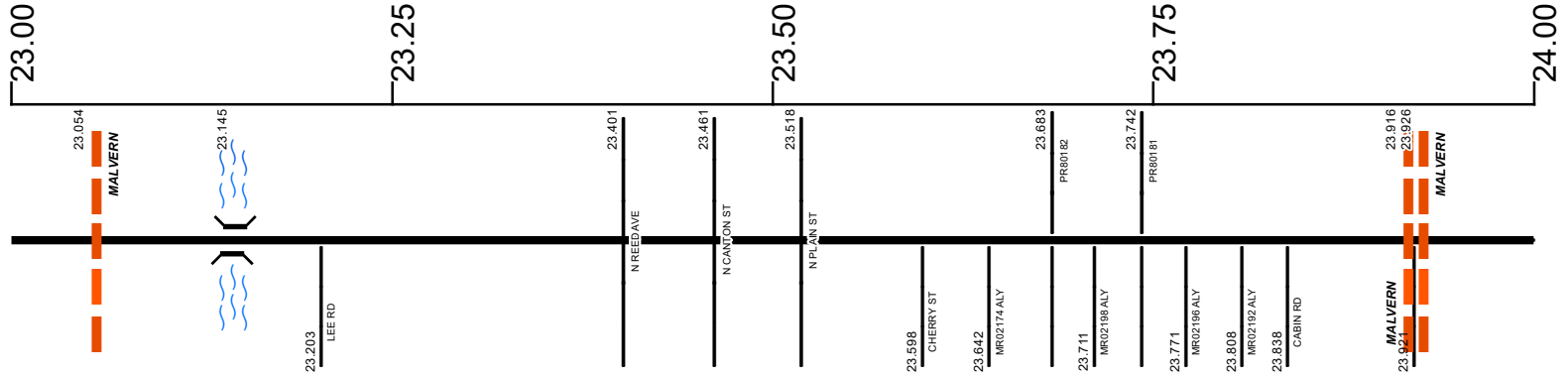

Surface Type & Width (Left / Right)

G (20'4')
22.398 - 24.019

Base Type (Left / Right)

T / L
22.398 - 24.019

Shoulder Type & Width (Left / Right)

5 (2'2')
15.084 - 26.651

Through Lanes

2
13.131 - 26.651

Street Name

ALLIANCE RD 22.398 - 23.401	W CANAL ST 23.401 - 23.838	ALLIANCE RD 23.838 - 26.651
--------------------------------	-------------------------------	--------------------------------

- Non-divided Highway
- Divided Highway
- Secondary Segment
- Corporation
- Bridge (on route)
- Underpass
- Overpass
- Railroad (at grade)
- Railroad (underpass)
- Railroad (overpass)
- Intersection

Created on: 6/24/2025

transportation.ohio.gov
Prepared by
The Ohio Department of Transportation
Office of Technical Services
Roadway Information

SCARSR00043**C

State True Log

46.671

County True Log

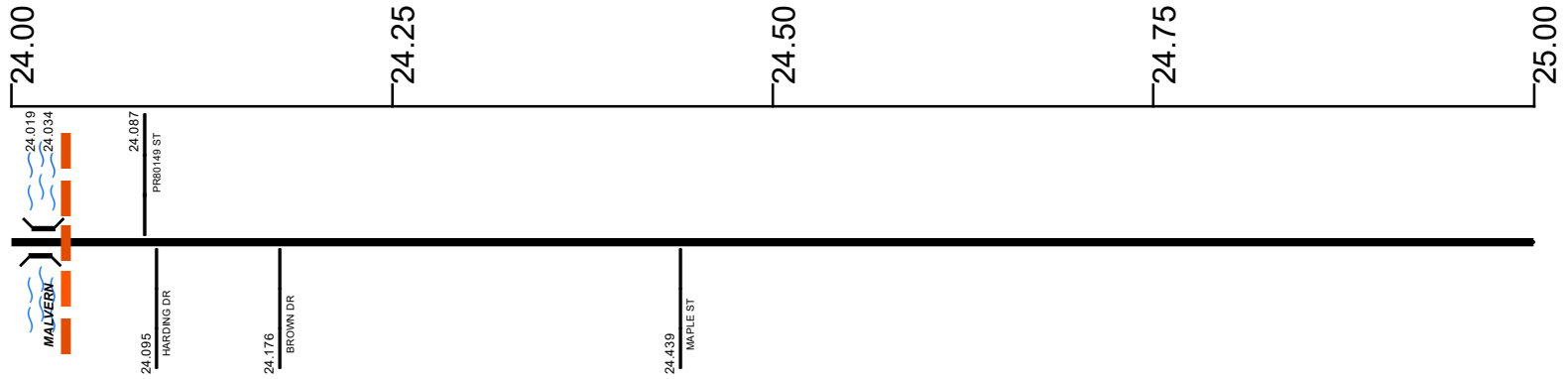

Surface Type & Width (Left / Right)

G (20'4')	G (18'6")
	24.019 - 26.651

Base Type (Left / Right)

T/L	R/L
22.398 - 24.019	24.019 - 26.651

Shoulder Type & Width (Left / Right)

	5 (2'2")
	15.084 - 26.651

Resurface Year

	2021
	24.081 - 26.651

Through Lanes

	2
	13.131 - 26.651

Street Name

	ALLIANCE RD
	23.838 - 26.651

- Non-divided Highway
- Divided Highway
- Secondary Segment
- Corporation
- Bridge (on route)
- Underpass
- Overpass
- Railroad (at grade)
- Railroad (underpass)
- Railroad (overpass)
- Intersection

Created on: 6/24/2025



transportation.ohio.gov
 Prepared by
 The Ohio Department of Transportation
 Office of Technical Services
 Roadway Information

SCARSR00043**C

State True Log

47.671

County True Log

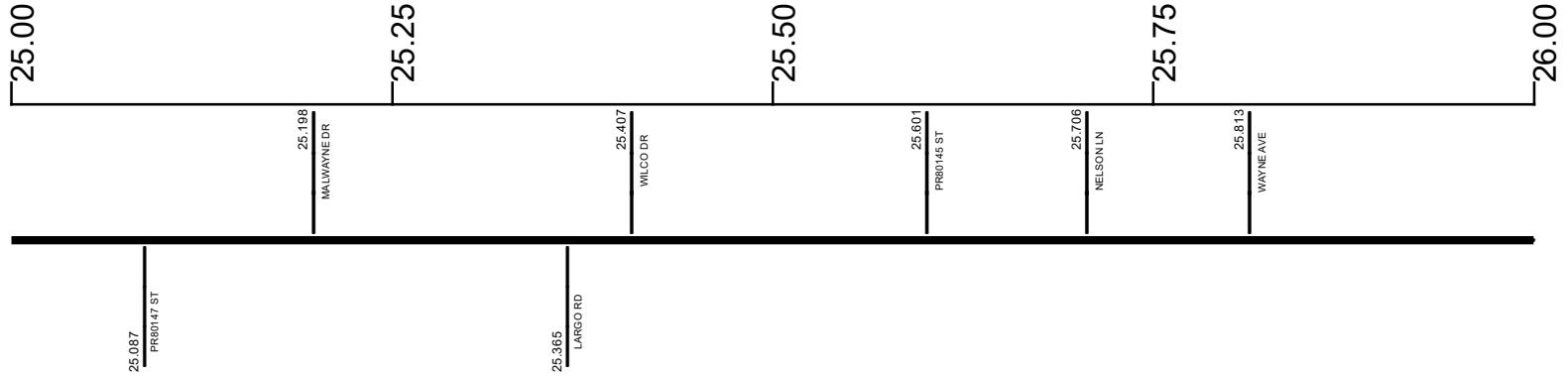

Surface Type & Width (Left / Right)	G (18/6')
	24.019 - 26.651
Base Type (Left / Right)	R / L
	24.019 - 26.651
Shoulder Type & Width (Left / Right)	5 (2/2')
	15.084 - 26.651
Resurface Year	2021
	24.081 - 26.651
Through Lanes	2
	13.131 - 26.651
Street Name	ALLIANCE RD
	23.838 - 26.651

- | | | | |
|--|---|---|---|
| <ul style="list-style-type: none"> Non-divided Highway Divided Highway Secondary Segment Corporation | <ul style="list-style-type: none"> Bridge (on route) Underpass Overpass | <ul style="list-style-type: none"> Railroad (at grade) Railroad (underpass) Railroad (overpass) | <ul style="list-style-type: none"> Intersection |
|--|---|---|---|

Created on: 6/24/2025

transportation.ohio.gov

Prepared by
The Ohio Department of Transportation
Office of Technical Services
Roadway Information

SCARSR00043**C

State True Log

48.322

County True Log

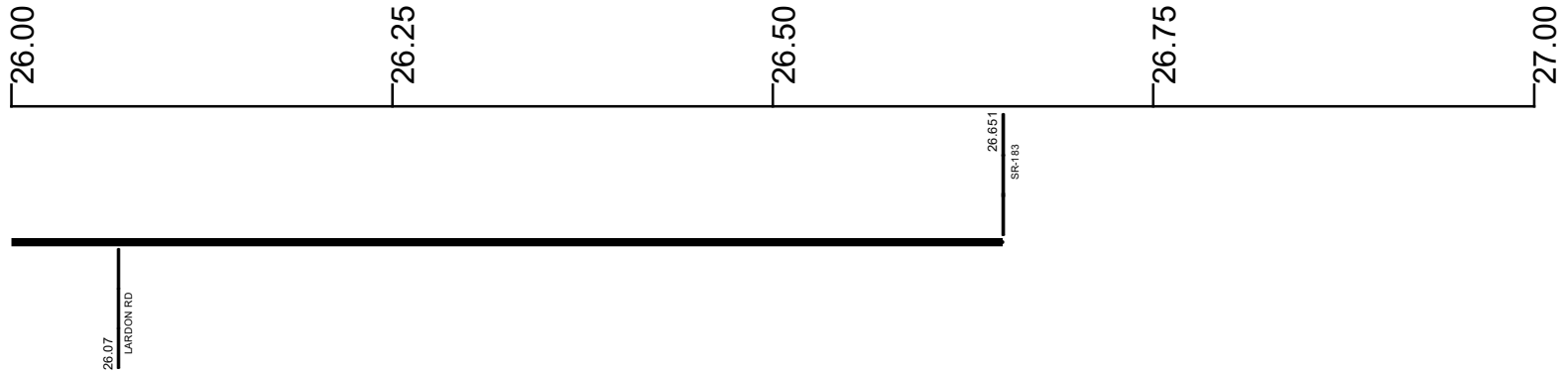

Surface Type & Width (Left / Right)

G (18'6")
24.019 - 26.651

Base Type (Left / Right)

R / L
24.019 - 26.651

Shoulder Type & Width (Left / Right)

5 (2'2")
15.084 - 26.651

Resurface Year

2021

Through Lanes

2
13.131 - 26.651

Street Name

ALLIANCE RD
23.838 - 26.651

- | | | | |
|---------------------|-------------------|----------------------|--------------|
| Non-divided Highway | Bridge (on route) | Railroad (at grade) | Intersection |
| Divided Highway | Underpass | Railroad (underpass) | |
| Secondary Segment | Overpass | Railroad (overpass) | |
| Corporation | | | |

Created on: 6/24/2025

transportation.ohio.gov

Prepared by
The Ohio Department of Transportation
Office of Technical Services
Roadway Information

Historical Project List for SCARSR00043**C

Begin Measure	End Measure	Project ID Number	Construction Completion Date	Treatment Category	Treatment Type
0.000	7.310	100509	4-2018	Minor Rehabilitation	60-AC Overlay w/Rpr
0.000	7.310	21119	5-2006	Minor Rehabilitation	60-AC Overlay w/Rpr
13.131	16.160	108344	5-2021	Minor Rehabilitation	38-Fine Poly AC Overlay
13.131	14.026	80420	9-2011	Minor Rehabilitation	60-AC Overlay w/Rpr
16.160	22.317	100602	10-2019	Preventive Maintenance	30-Microsurfacing
16.160	22.398	81693	8-2011	Minor Rehabilitation	60-AC Overlay w/Rpr
22.398	24.023	91838	9-2016	Minor Rehabilitation	60-AC Overlay w/Rpr
22.398	26.651	24732	6-2005	Minor Rehabilitation	60-AC Overlay w/Rpr
24.054	26.651	110393	10-2021	Minor Rehabilitation	60-AC Overlay w/Rpr
24.064	26.651	84367	10-2012	Minor Rehabilitation	38-Fine Poly AC Overlay

Roadway Codes

Access Control Journalized

- F - Full Access Control
- L - Limited Access Control
- N - No Access Control

Access Control Operational

- 1 - Full Access Control
- 2 - Partial Access Control
- 3 - No Access Control

Base Type

- F - Crack and Seat
- H - Rubblize and Roll
- I - Aggregate Base 304 or Traffic Compacted
- K - Water Bound Macadam
- L - Bituminous Concrete Mix or Penetration Macadam
- N - Plain Concrete
- P - Reinforced Concrete
- R - Brick (Flexible)
- T - Brick (Rigid)

Direction of Travel

- B - Both (Two-way)
- F - One-way Cardinal
- T - One-way Non-cardinal

Facility Type

- 1 - One-way Roadway
- 2 - Two-way Roadway
- 4 - Ramp
- 5 - Non-mainline
- 6 - Non-inventory Direction
- 7 - Planned / Unbuilt

Historical Federal Aid Indicator

- N - Not a FAP Route
- Y - FAP Route

Functional Classification

- 01 - Interstate
- 02 - Principal Arterial (Freeways)
- 03 - Principal Arterial (Other)
- 04 - Minor Arterial
- 05 - Major Collector
- 06 - Minor Collector
- 07 - Local

Leave / Reenter Indicator

- Y - Route leaves/reenters at this point
- N - Route does not leave/reenter at this point

Median Type

- 1 - None
- 2 - Unprotected
- 3 - Curbed
- 4 - Positive Barrier (Unspecified)
- 5 - Positive Barrier (Flexible)
- 6 - Positive Barrier (Semi-rigid)
- 7 - Positive Barrier (Rigid)

NHS

- N - National Highway System
- H - Congressional Corridor
- 2 - Major Airport
- 3 - Major Port Facility
- 4 - Major Amtrak Station
- 5 - Major Rail / Truck Terminal
- 6 - Major Intercity Bus Terminal
- 7 - Major Public Transit / Multi-modal Passenger Terminal
- 8 - Major Pipeline Terminal
- 9 - Major Ferry Terminal

Priority System

- G - General
- P - Priority System
- U - Urban

Scenic Byway Code

- A - All American Road
- N - National Scenic Byway
- S - State Scenic Byway

Shoulder Type

- 1 - None
- 2 - Surfaced shoulder exists (bituminous concrete {AC})
- 3 - Surfaced shoulder exists (Portland Cement Concrete {PCC})
- 4 - Stabilized shoulder exists (gravel or other granular material)
- 5 - Combination shoulder exists (two or more surface types)
- 6 - Earth shoulder exists
- 7 - Barrier curb exists; no shoulder in front of curb

Surface Type

- A - Combination
- B - Brick
- C - Continuous Reinforced Concrete
- D - Reinforced Concrete
- E - Plain Concrete
- G - Bituminous Concrete
- I - Chipseal on Granular
- K - Open Graded Bituminous
- L - Chipseal or Micro
- M - Gravel
- U - Unimproved
- X - Right of Way Only