

SCHPSR00245**C

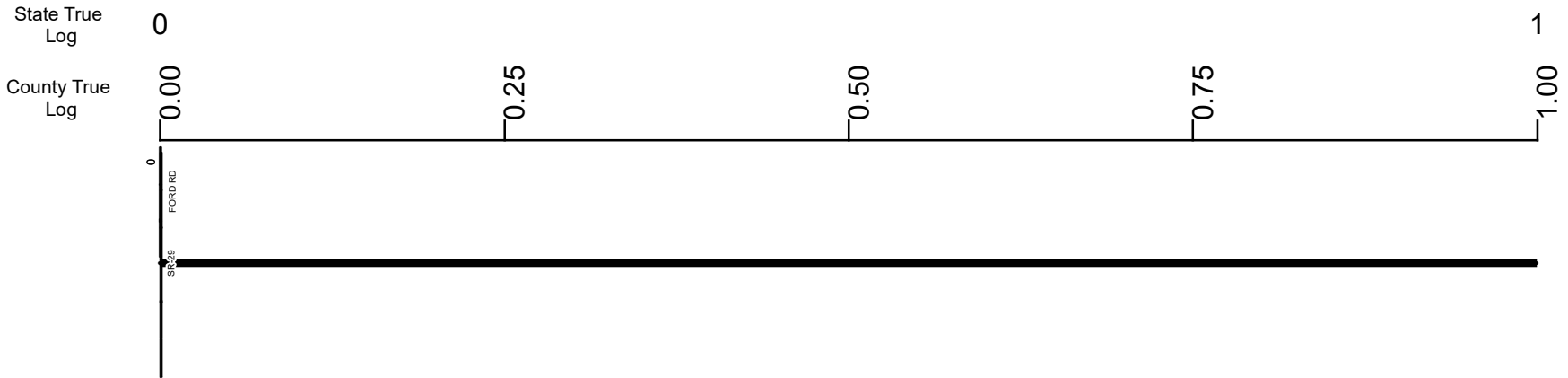

Surface Type & Width (Left / Right)	G (18'/2')
	0 - 6.157
Base Type (Left / Right)	I / L
	0 - 6.157
Shoulder Type & Width (Left / Right)	2 (4'/4')
	0 - 6.157
Through Lanes	2
	0 - 22.544
Street Name	SR 245
	0 - 20.018

- Non-divided Highway
- Divided Highway
- Secondary Segment
- Corporation
- Bridge (on route)
- Underpass
- Overpass
- Railroad (at grade)
- Railroad (underpass)
- Railroad (overpass)
- Intersection

Created on: 6/24/2025



transportation.ohio.gov
 Prepared by
 The Ohio Department of Transportation
 Office of Technical Services
 Roadway Information

SCHPSR00245**C

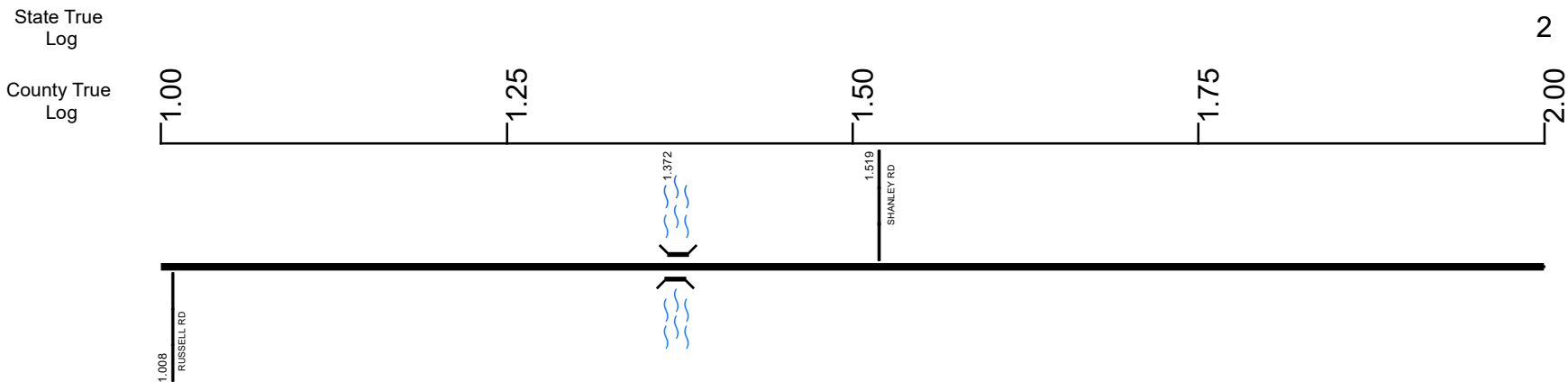

Surface Type & Width (Left / Right)	G (18/2')
	0 - 6.157
Base Type (Left / Right)	I / L
	0 - 6.157
Shoulder Type & Width (Left / Right)	2 (4/4')
	0 - 6.157
Through Lanes	2
	0 - 22.544
Street Name	SR 245
	0 - 20.018

- Non-divided Highway
- Divided Highway
- Secondary Segment
- Corporation
- Bridge (on route)
- Underpass
- Overpass
- Railroad (at grade)
- Railroad (underpass)
- Railroad (overpass)
- Intersection

Created on: 6/24/2025

transportation.ohio.gov

Prepared by
The Ohio Department of Transportation
Office of Technical Services
Roadway Information

SCHPSR00245**C

State True Log

3

County True Log

2.00

2.25

2.50

2.75

3.00

2.417
FRIEND RD

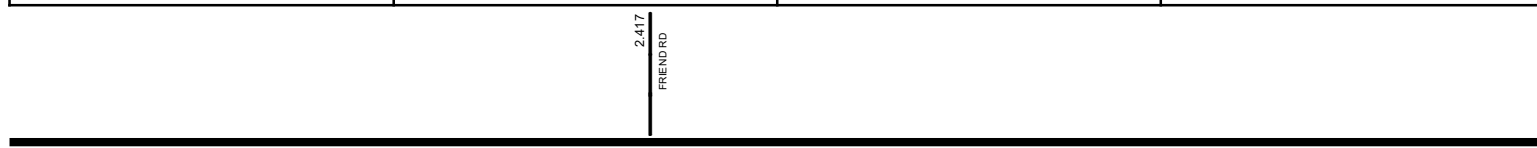

Surface Type & Width (Left / Right)

G (18'/2')
0 - 6.157

Base Type (Left / Right)

I / L
0 - 6.157

Shoulder Type & Width (Left / Right)

2 (4'/4')
0 - 6.157

Through Lanes

2
0 - 22.544

Street Name

SR 245
0 - 20.018

- Non-divided Highway
- Divided Highway
- Secondary Segment
- Corporation
- Bridge (on route)
- Underpass
- Overpass
- Railroad (at grade)
- Railroad (underpass)
- Railroad (overpass)
- Intersection

Created on: 6/24/2025

transportation.ohio.gov
Prepared by
The Ohio Department of Transportation
Office of Technical Services
Roadway Information

SCHPSR00245**C

State True Log

4

County True Log

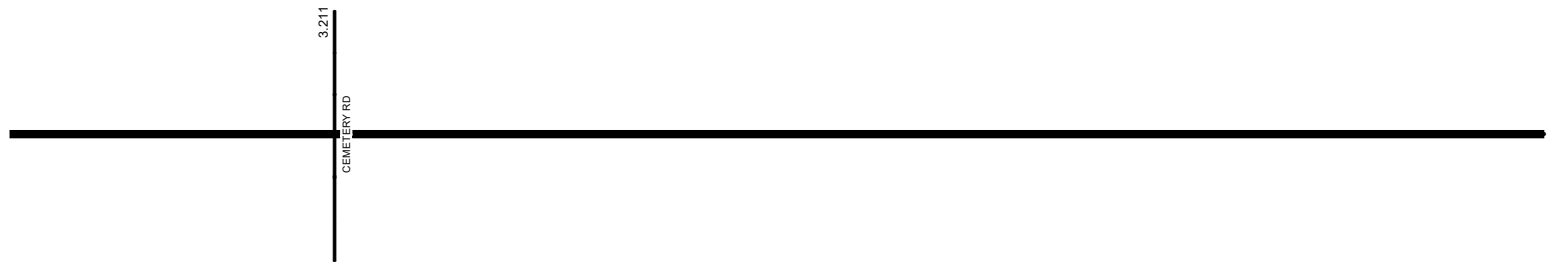

Surface Type & Width (Left / Right)

G (18'/2')
0 - 6.157

Base Type (Left / Right)

I / L
0 - 6.157

Shoulder Type & Width (Left / Right)

2 (4'/4')
0 - 6.157

Through Lanes

2
0 - 22.544

Street Name

SR 245
0 - 20.018

- Non-divided Highway
- Divided Highway
- Secondary Segment
- Corporation
- Bridge (on route)
- Underpass
- Overpass
- Railroad (at grade)
- Railroad (underpass)
- Railroad (overpass)
- Intersection

Created on: 6/24/2025

transportation.ohio.gov
Prepared by
The Ohio Department of Transportation
Office of Technical Services
Roadway Information

SCHPSR00245**C

State True Log

5

County True Log

4.00

4.25

4.50

4.75

5.00

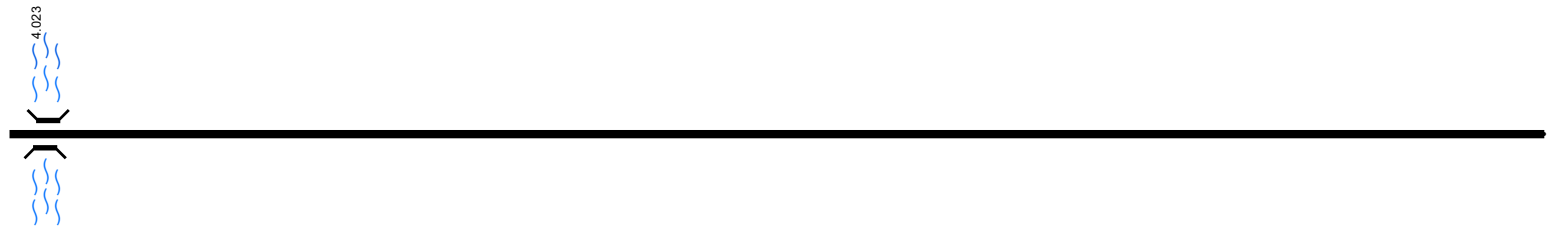

Surface Type & Width (Left / Right)

	G (18'/2')
	0 - 6.157

Base Type (Left / Right)

	I / L
	0 - 6.157

Shoulder Type & Width (Left / Right)

	2 (4'/4')
	0 - 6.157

Through Lanes

	2
	0 - 22.544

Street Name

	SR 245
	0 - 20.018

- | | | | |
|---------------------|-------------------|----------------------|--------------|
| Non-divided Highway | Bridge (on route) | Railroad (at grade) | Intersection |
| Divided Highway | Underpass | Railroad (underpass) | |
| Secondary Segment | Overpass | Railroad (overpass) | |
| Corporation | | | |

Created on: 6/24/2025

transportation.ohio.gov

Prepared by
The Ohio Department of Transportation
Office of Technical Services
Roadway Information

SCHPSR00245**C

State True Log

County True Log

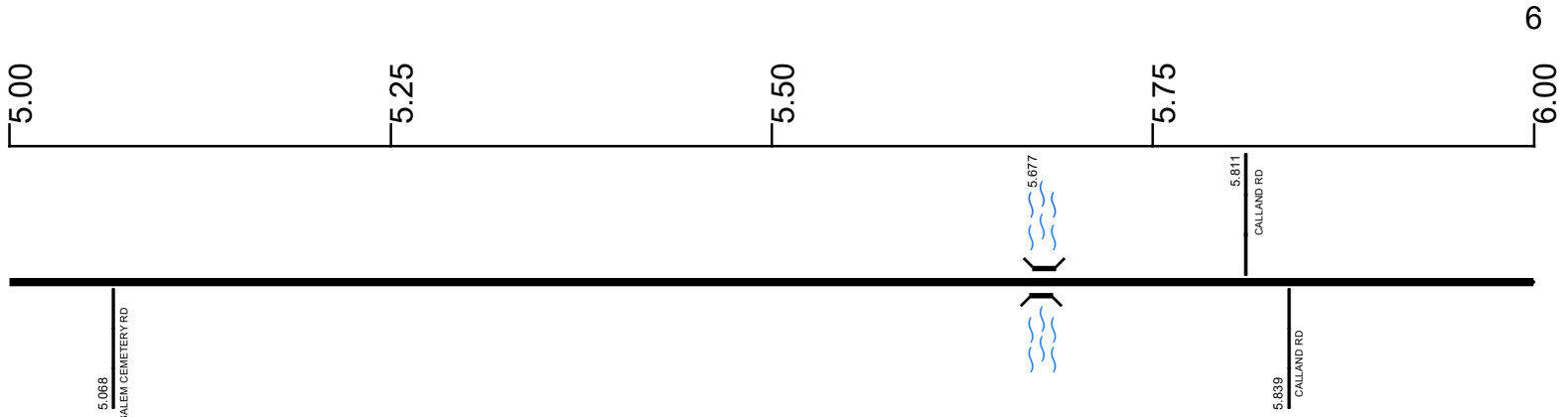

Surface Type & Width (Left / Right)	G (18'/2') 0 - 6.157
Base Type (Left / Right)	I / L 0 - 6.157
Shoulder Type & Width (Left / Right)	2 (4'/4') 0 - 6.157
Through Lanes	2 0 - 22.544
Street Name	SR 245 0 - 20.018

Non-divided Highway	Bridge (on route)	Railroad (at grade)	Intersection
Divided Highway	Underpass	Railroad (underpass)	
Secondary Segment	Overpass	Railroad (overpass)	
Corporation			

Created on: 6/24/2025

transportation.ohio.gov

Prepared by
The Ohio Department of Transportation
Office of Technical Services
Roadway Information

SCHPSR00245**C

State True Log

7

County True Log

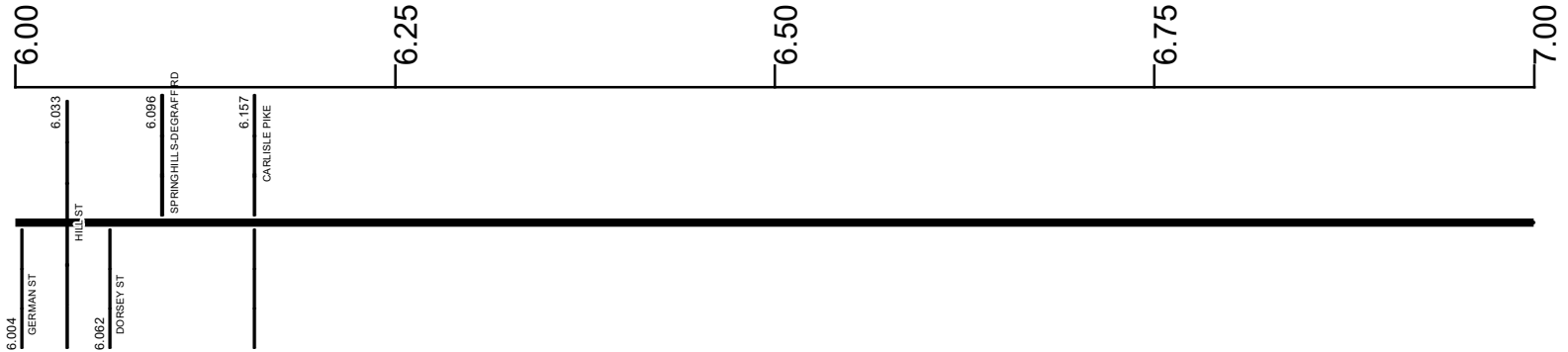

Surface Type & Width (Left / Right)

G (18'/2') 0 - 6.157	G 20' 6.157 - 11.447
-------------------------	-------------------------

Base Type (Left / Right)

I / L 0 - 6.157	I 6.157 - 17.06
--------------------	--------------------

Shoulder Type & Width (Left / Right)

2 (4'/4') 0 - 6.157	2 (6'/6') 6.157 - 10.715
------------------------	-----------------------------

Resurface Year

	2020 6.16 - 10.72
--	----------------------

Through Lanes

	2 0 - 22.544
--	-----------------

Street Name

	SR 245 0 - 20.018
--	----------------------

- Non-divided Highway
- Divided Highway
- Secondary Segment
- Corporation
- Bridge (on route)
- Underpass
- Overpass
- Railroad (at grade)
- Railroad (underpass)
- Railroad (overpass)
- Intersection

Created on: 6/24/2025

transportation.ohio.gov

Prepared by
The Ohio Department of Transportation
Office of Technical Services
Roadway Information

SCHPSR00245**C

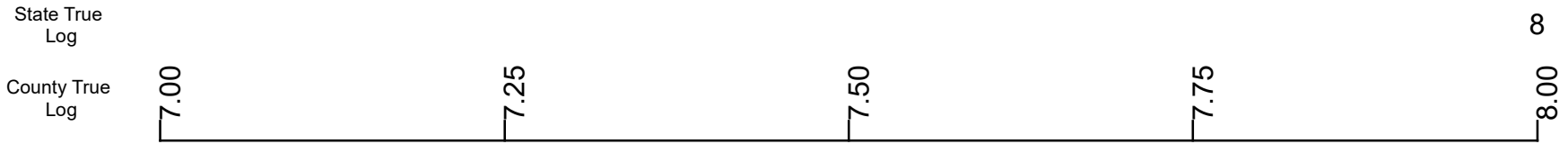

Surface Type & Width (Left / Right)	G 20'
	6.157 - 11.447
Base Type (Left / Right)	I
	6.157 - 17.06
Shoulder Type & Width (Left / Right)	2 (6/6)
	6.157 - 10.715
Resurface Year	2020
	6.16 - 10.72
Through Lanes	2
	0 - 22.544
Street Name	SR 245
	0 - 20.018

<ul style="list-style-type: none"> Non-divided Highway Divided Highway Secondary Segment Corporation 	<ul style="list-style-type: none"> Bridge (on route) Underpass Overpass 	<ul style="list-style-type: none"> Railroad (at grade) Railroad (underpass) Railroad (overpass) 	<ul style="list-style-type: none"> Intersection
-----------------------------------------------------------------------------------------------------------------------------------------------------------	-------------------------------------------------------------------------------------------------------------	-------------------------------------------------------------------------------------------------------------------------------------	-----------------------------------------------------------------

Created on: 6/24/2025

transportation.ohio.gov

Prepared by
The Ohio Department of Transportation
Office of Technical Services
Roadway Information

SCHPSR00245**C

State True Log

9

County True Log



Surface Type & Width (Left / Right)

G 20'
6.157 - 11.447

Base Type (Left / Right)

I
6.157 - 17.06

Shoulder Type & Width (Left / Right)

2 (6/6)
6.157 - 10.715

Resurface Year

2020

Through Lanes

2
0 - 22.544

Street Name

SR 245
0 - 20.018

- Non-divided Highway
- Divided Highway
- Secondary Segment
- Corporation
- Bridge (on route)
- Underpass
- Overpass
- Railroad (at grade)
- Railroad (underpass)
- Railroad (overpass)
- Intersection

Created on: 6/24/2025

transportation.ohio.gov
Prepared by
The Ohio Department of Transportation
Office of Technical Services
Roadway Information

SCHPSR00245**C

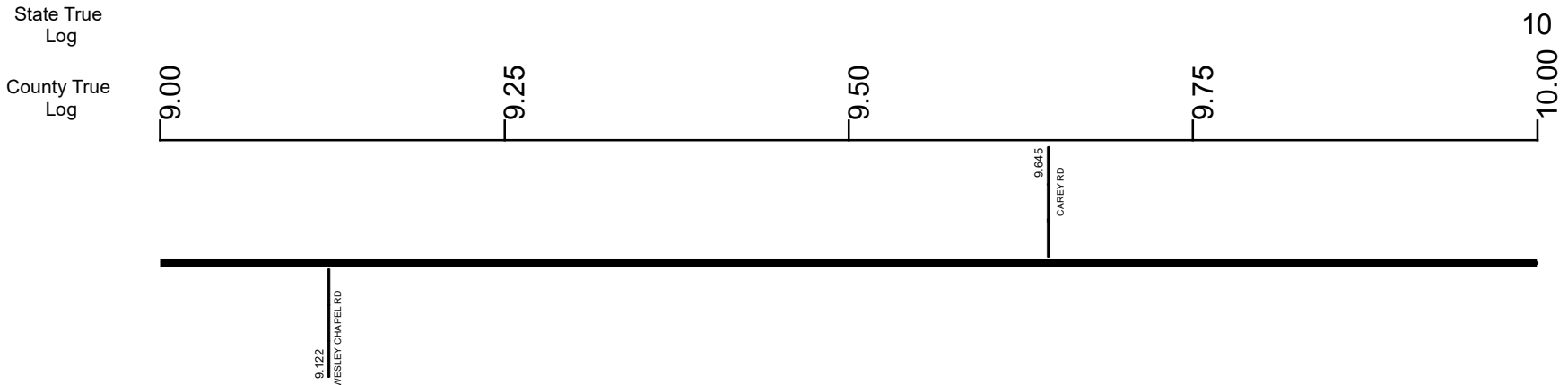

Surface Type & Width (Left / Right)	G 20' 6.157 - 11.447
Base Type (Left / Right)	I 6.157 - 17.06
Shoulder Type & Width (Left / Right)	2 (6/6) 6.157 - 10.715
Resurface Year	2020 6.16 - 10.72
Through Lanes	2 0 - 22.544
Street Name	SR 245 0 - 20.018

Non-divided Highway	Bridge (on route)	Railroad (at grade)	Intersection
Divided Highway	Underpass	Railroad (underpass)	
Secondary Segment	Overpass	Railroad (overpass)	
Corporation			

Created on: 6/24/2025



transportation.ohio.gov
Prepared by
The Ohio Department of Transportation
Office of Technical Services
Roadway Information

SCHPSR00245**C

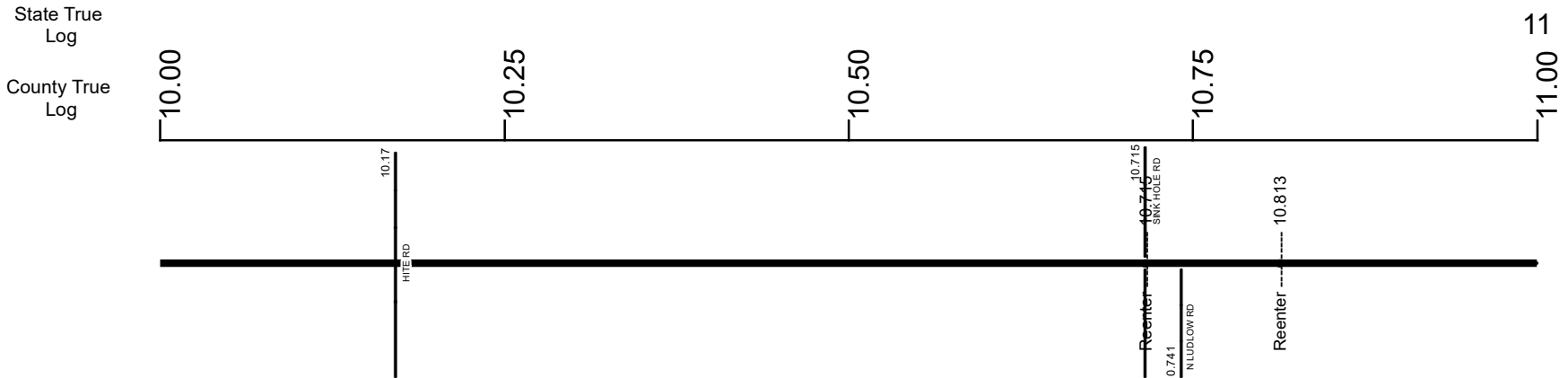

Surface Type & Width (Left / Right)	G 20'		
	6.157 - 11.447		
Base Type (Left / Right)	I		
	6.157 - 17.06		
Shoulder Type & Width (Left / Right)	2 (6'6")	2 (4'4")	2 (2'2")
	6.157 - 10.715	10.715 - 10.813	10.813 - 17.06
Resurface Year	2020		
	6.16 - 10.72		
Through Lanes	2		
	0 - 22.544		
Street Name	SR 245		
	0 - 20.018		

<ul style="list-style-type: none"> Non-divided Highway Divided Highway Secondary Segment Corporation 	<ul style="list-style-type: none"> Bridge (on route) Underpass Overpass 	<ul style="list-style-type: none"> Railroad (at grade) Railroad (underpass) Railroad (overpass) 	<ul style="list-style-type: none"> Intersection
----------------------------------------------------------------------------------------------------------------------------------------------------	-------------------------------------------------------------------------------------------------------------	-------------------------------------------------------------------------------------------------------------------------------------	-----------------------------------------------------------------

Created on: 6/24/2025

transportation.ohio.gov

Prepared by
The Ohio Department of Transportation
Office of Technical Services
Roadway Information

SCHPSR00245**C

State True Log
County True Log

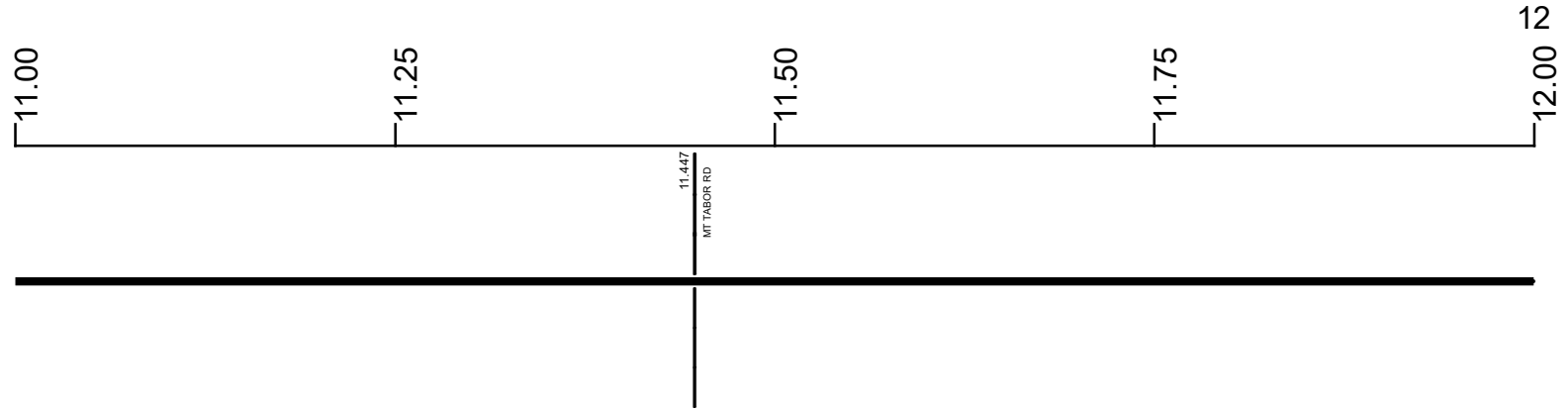

Surface Type & Width (Left / Right)

G 20'	G 18'
6.157 - 11.447	11.447 - 17.06

Base Type (Left / Right)

I	
6.157 - 17.06	

Shoulder Type & Width (Left / Right)

2 (2'/2')	
10.813 - 17.06	

Through Lanes

2	
0 - 22.544	

Street Name

SR 245	
0 - 20.018	

- Non-divided Highway
- Divided Highway
- Secondary Segment
- Corporation
- Bridge (on route)
- Underpass
- Overpass
- Railroad (at grade)
- Railroad (underpass)
- Railroad (overpass)
- Intersection

Created on: 6/24/2025

transportation.ohio.gov

Prepared by
The Ohio Department of Transportation
Office of Technical Services
Roadway Information

SCHPSR00245**C

State True Log
County True Log

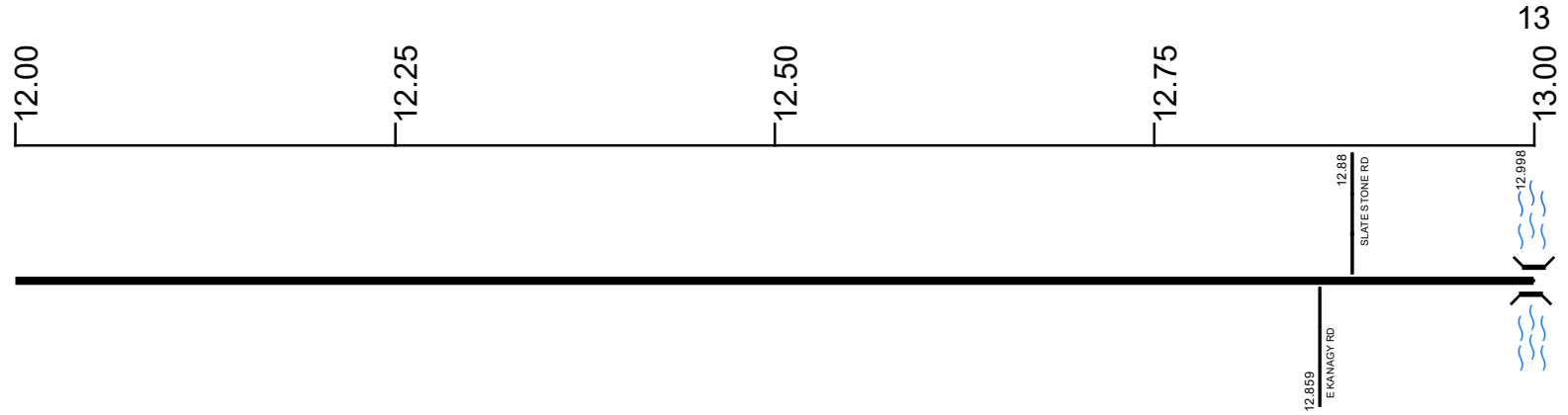

Surface Type & Width (Left / Right)	G 18'
	11.447 - 17.06
Base Type (Left / Right)	I
	6.157 - 17.06
Shoulder Type & Width (Left / Right)	2 (2/2')
	10.813 - 17.06
Through Lanes	2
	0 - 22.544
Street Name	SR 245
	0 - 20.018

Non-divided Highway	Bridge (on route)	Railroad (at grade)	Intersection
Divided Highway	Underpass	Railroad (underpass)	
Secondary Segment	Overpass	Railroad (overpass)	
Corporation			

Created on: 6/24/2025

transportation.ohio.gov

Prepared by
The Ohio Department of Transportation
Office of Technical Services
Roadway Information

SCHPSR00245**C

State True Log

County True Log

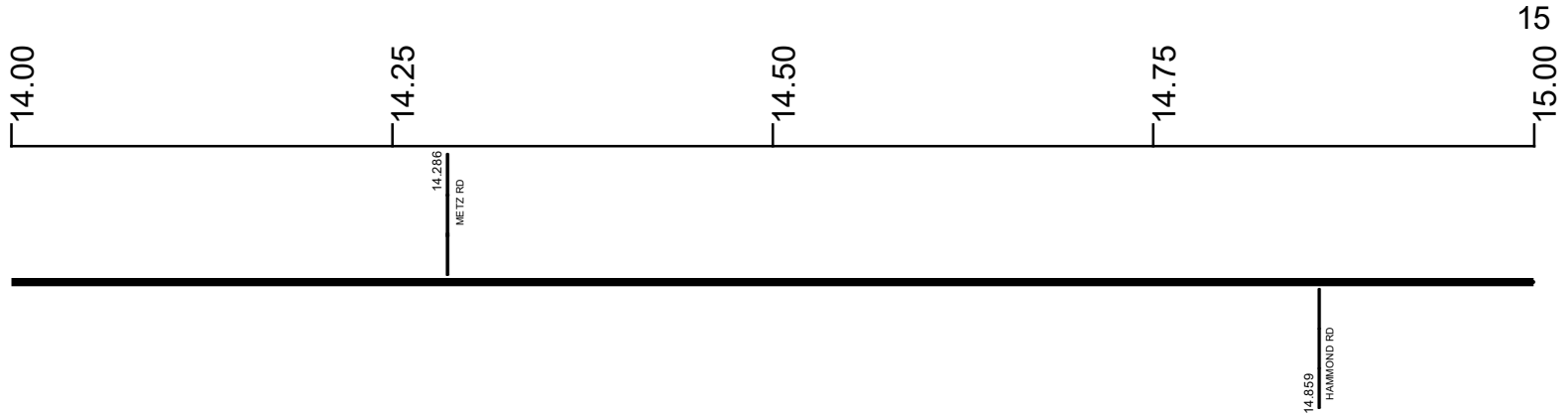

Surface Type & Width (Left / Right)

G 18'
11.447 - 17.06

Base Type (Left / Right)

I
6.157 - 17.06

Shoulder Type & Width (Left / Right)

2 (2'/2')
10.813 - 17.06

Through Lanes

2
0 - 22.544

Street Name

SR 245
0 - 20.018

- | | | | |
|---------------------|-------------------|----------------------|--------------|
| Non-divided Highway | Bridge (on route) | Railroad (at grade) | Intersection |
| Divided Highway | Underpass | Railroad (underpass) | |
| Secondary Segment | Overpass | Railroad (overpass) | |
| Corporation | | | |

Created on: 6/24/2025

SCHPSR00245**C

State True Log
County True Log

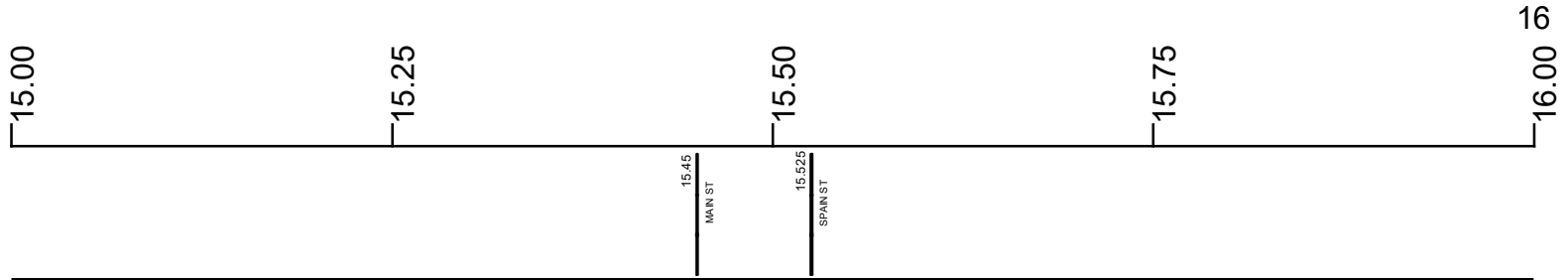

Surface Type & Width (Left / Right)

G 18'
11.447 - 17.06

Base Type (Left / Right)

I
6.157 - 17.06

Shoulder Type & Width (Left / Right)

2 (2/2')
10.813 - 17.06

Through Lanes

2
0 - 22.544

Street Name

SR 245
0 - 20.018

- Non-divided Highway
- Divided Highway
- Secondary Segment
- Corporation
- Bridge (on route)
- Underpass
- Overpass
- Railroad (at grade)
- Railroad (underpass)
- Railroad (overpass)
- Intersection

Created on: 6/24/2025

transportation.ohio.gov
Prepared by
The Ohio Department of Transportation
Office of Technical Services
Roadway Information

SCHPSR00245**C

State True Log

17

County True Log

16.00

16.25

16.50

16.75

17.00



Surface Type & Width (Left / Right)

G 18'
11.447 - 17.06

Base Type (Left / Right)

I
6.157 - 17.06

Shoulder Type & Width (Left / Right)

2 (2/2)
10.813 - 17.06

Through Lanes

2
0 - 22.544

Street Name

SR 245
0 - 20.018

- | | | | |
|---------------------|-------------------|----------------------|--------------|
| Non-divided Highway | Bridge (on route) | Railroad (at grade) | Intersection |
| Divided Highway | Underpass | Railroad (underpass) | |
| Secondary Segment | Overpass | Railroad (overpass) | |
| Corporation | | | |

Created on: 6/24/2025



transportation.ohio.gov
 Prepared by
 The Ohio Department of Transportation
 Office of Technical Services
 Roadway Information

SCHPSR00245**C

State True Log

County True Log

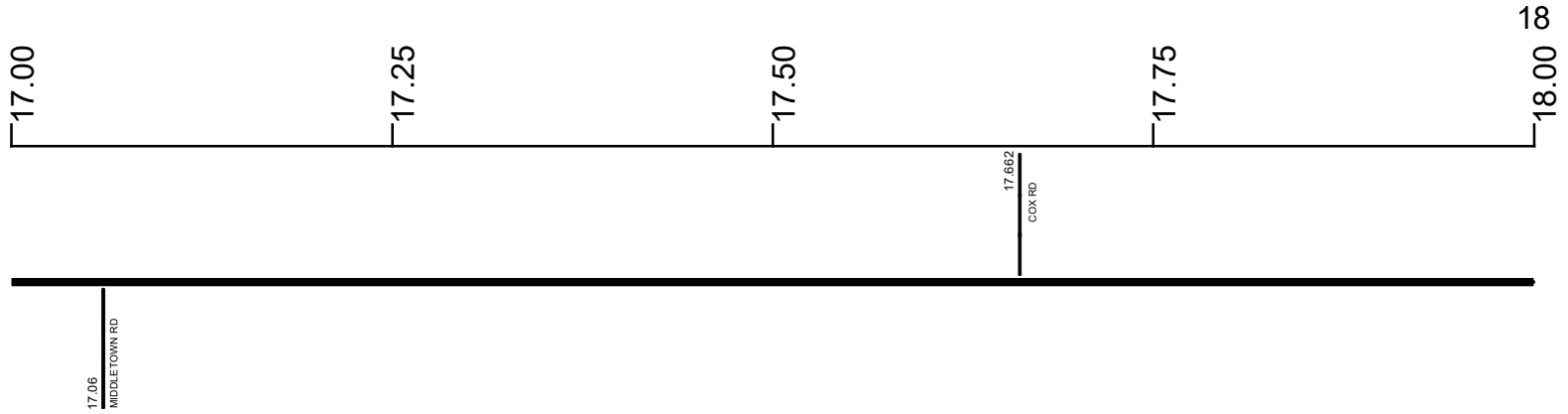

Surface Type & Width (Left / Right)

G 18'		G (20'4')
11.447 - 17.06		17.06 - 20.018

Base Type (Left / Right)

I		I / L
6.157 - 17.06		17.06 - 20.018

Shoulder Type & Width (Left / Right)

2 (2'2')		5 (2'2')
10.813 - 17.06		17.06 - 20.018

Through Lanes

	2	
	0 - 22.544	

Street Name

	SR 245	
	0 - 20.018	

- Non-divided Highway
 Bridge (on route)
 Railroad (at grade)
 Intersection
- Divided Highway
 Underpass
 Railroad (underpass)
- Secondary Segment
 Overpass
 Railroad (overpass)
- Corporation**

Created on: 6/24/2025

transportation.ohio.gov

Prepared by
The Ohio Department of Transportation
Office of Technical Services
Roadway Information

SCHPSR00245**C

State True Log

County True Log

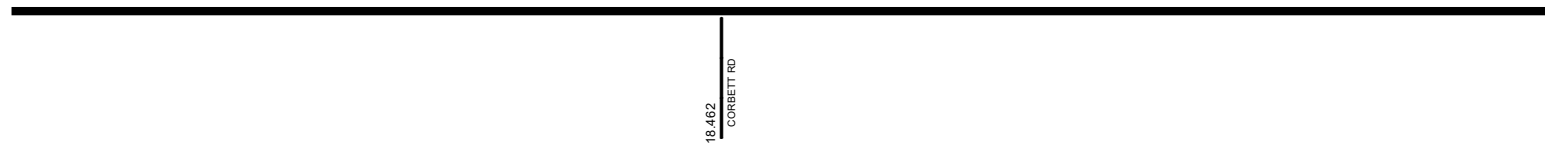
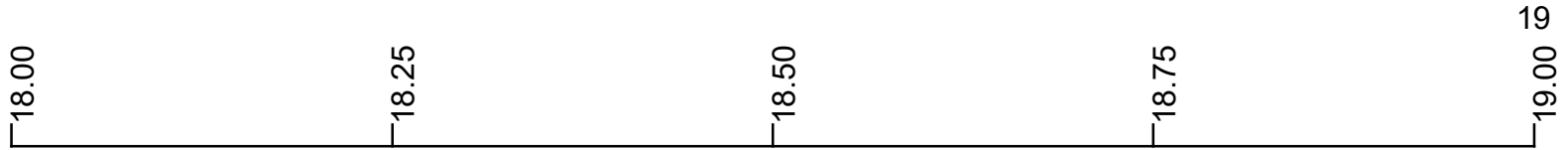

Surface Type & Width (Left / Right)

G (20/4')
17.06 - 20.018

Base Type (Left / Right)

I / L
17.06 - 20.018

Shoulder Type & Width (Left / Right)

5 (2/2')
17.06 - 20.018

Through Lanes

2
0 - 22.544

Street Name

SR 245
0 - 20.018

- | | | | |
|---------------------|-------------------|----------------------|--------------|
| Non-divided Highway | Bridge (on route) | Railroad (at grade) | Intersection |
| Divided Highway | Underpass | Railroad (underpass) | |
| Secondary Segment | Overpass | Railroad (overpass) | |
| Corporation | | | |

Created on: 6/24/2025

SCHPSR00245**C

State True Log

20

County True Log

19.00

19.25

19.50

19.75

20.00



Surface Type & Width (Left / Right)

G (20'4')
17.06 - 20.018

Base Type (Left / Right)

I / L
17.06 - 20.018

Shoulder Type & Width (Left / Right)

5 (2'2')
17.06 - 20.018

Through Lanes

2
0 - 22.544

Street Name

SR 245
0 - 20.018

- | | | | |
|---------------------|-------------------|----------------------|--------------|
| Non-divided Highway | Bridge (on route) | Railroad (at grade) | Intersection |
| Divided Highway | Underpass | Railroad (underpass) | |
| Secondary Segment | Overpass | Railroad (overpass) | |
| Corporation | | | |

Created on: 6/24/2025



transportation.ohio.gov
Prepared by
The Ohio Department of Transportation
Office of Technical Services
Roadway Information

SCHPSR00245**C

State True Log
County True Log

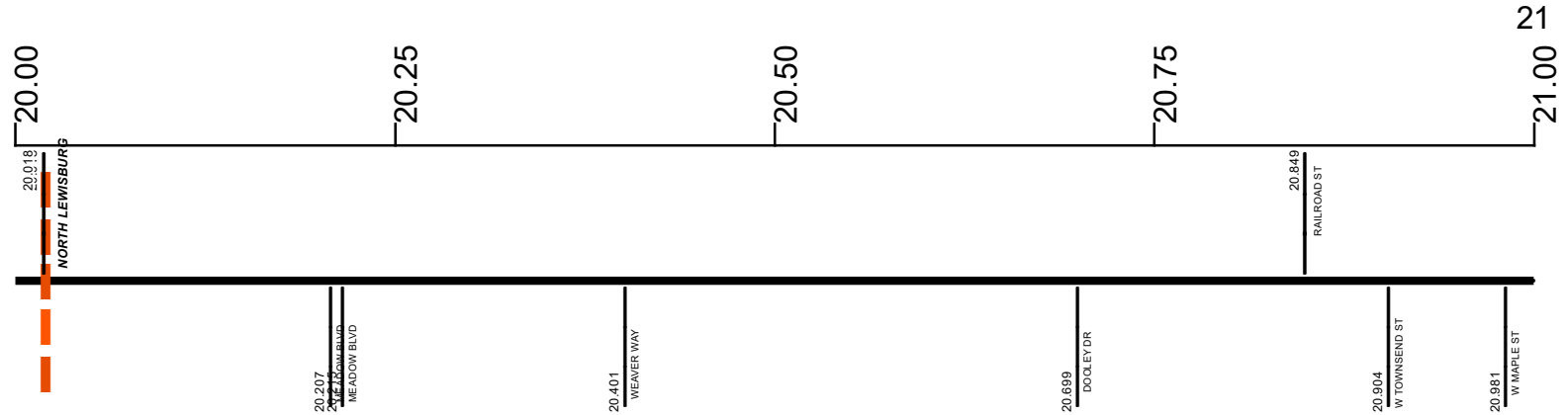

Surface Type & Width (Left / Right)

G (20'4')	G 28'	G 22'	G 30'
	20.018 - 20.728	20.728 - 20.978	

Base Type (Left / Right)

I / L	L	I
17.06 - 20.018	20.018 - 20.728	20.728 - 22.544

Shoulder Type & Width (Left / Right)

5 (2 1/2')	1 (0'0')	2 (2 1/2')	2 (5'5')
17.06 - 20.018	20.018 - 20.728	20.728 - 20.978	20.978 - 21.084

Through Lanes

2
0 - 22.544

Street Name

SR 245	MILL ST	MAPLE ST
0 - 20.018	20.018 - 20.978	20.978 - 21.583

- Non-divided Highway
- Divided Highway
- Secondary Segment
- Corporation
- Bridge (on route)
- Underpass
- Overpass
- Railroad (at grade)
- Railroad (underpass)
- Railroad (overpass)
- Intersection

Created on: 6/24/2025

transportation.ohio.gov

Prepared by
The Ohio Department of Transportation
Office of Technical Services
Roadway Information

SCHPSR00245**C

State True Log
County True Log

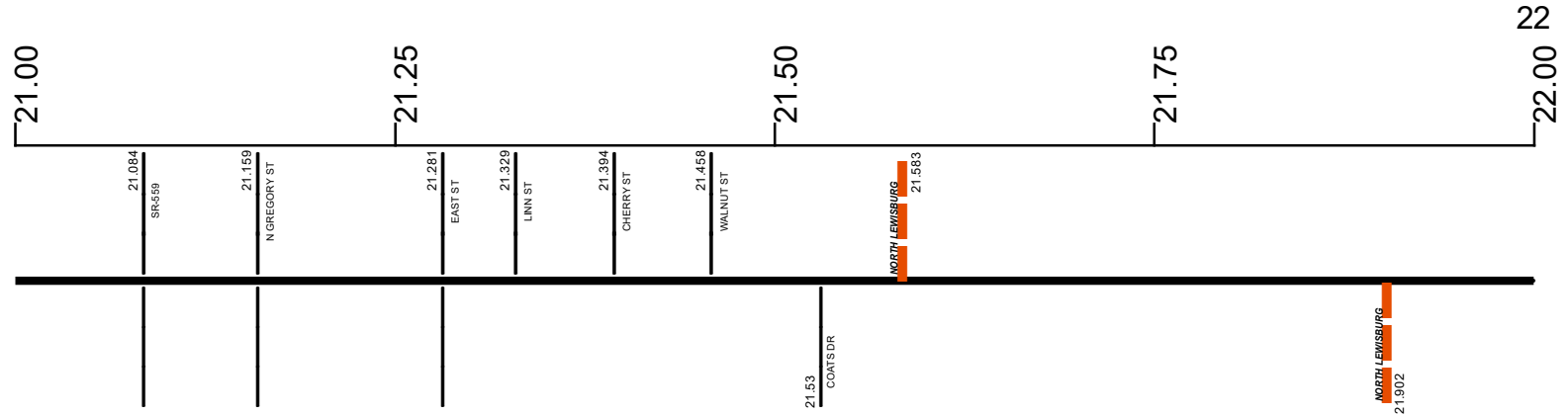

Surface Type & Width (Left / Right)

G 30'	G 24'	G 22'	G 20'
20.978 - 21.281	21.281 - 21.526	21.526 - 21.583	21.583 - 22.544

Base Type (Left / Right)

I
20.728 - 22.544

Shoulder Type & Width (Left / Right)

2 (5/5')	2 (3/3')	2 (2/2')	2 (8/8')
20.978 - 21.084	21.084 - 21.281	21.281 - 21.583	21.583 - 22.544

Through Lanes

2
0 - 22.544

Street Name

MAPLE ST	SR 245
20.978 - 21.583	21.583 - 22.544

- Non-divided Highway
- Divided Highway
- Secondary Segment
- Corporation
- Bridge (on route)
- Underpass
- Overpass
- Railroad (at grade)
- Railroad (underpass)
- Railroad (overpass)
- Intersection

Created on: 6/24/2025

transportation.ohio.gov

Prepared by
The Ohio Department of Transportation
Office of Technical Services
Roadway Information

SCHPSR00245**C

State True
Log

28.38

County True
Log

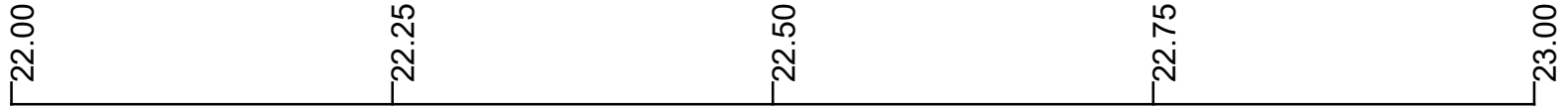

Surface Type & Width (Left / Right)

G 20'
21.583 - 22.544

Base Type (Left / Right)

I
20.728 - 22.544

Shoulder Type & Width (Left / Right)

2 (8/8')
21.583 - 22.544

Through Lanes

2
0 - 22.544

Street Name

SR 245
21.583 - 22.544

- | | | | |
|---------------------|-------------------|----------------------|--------------|
| Non-divided Highway | Bridge (on route) | Railroad (at grade) | Intersection |
| Divided Highway | Underpass | Railroad (underpass) | |
| Secondary Segment | Overpass | Railroad (overpass) | |
| Corporation | | | |

Created on: 6/24/2025



transportation.ohio.gov
 Prepared by
 The Ohio Department of Transportation
 Office of Technical Services
 Roadway Information

Historical Project List for SCHPSR00245**C

Begin Measure	End Measure	Project ID Number	Construction Completion Date	Treatment Category	Treatment Type
0.000	6.157	105369	12-2019	Preventive Maintenance	25-Chip Seal
0.000	6.167	83942	7-2013	Minor Rehabilitation	60-AC Overlay w/Rpr
6.157	10.715	103256	4-2021	Minor Rehabilitation	60-AC Overlay w/Rpr
6.157	10.715	86164	7-2011	Preventive Maintenance	30-Microsurfacing
10.715	10.813	105369	12-2019	Preventive Maintenance	25-Chip Seal
10.746	10.813	105229	9-2023	Preventive Maintenance	25-Chip Seal
10.813	17.060	105229	9-2023	Preventive Maintenance	25-Chip Seal
10.813	17.064	105369	12-2019	Preventive Maintenance	25-Chip Seal
10.813	17.064	19806	12-2004	Minor Rehabilitation	50-AC Overlay w/o Rpr
10.823	17.064	100330	9-2016	Preventive Maintenance	25-Chip Seal
17.064	20.024	101066	10-2018	Minor Rehabilitation	38-Fine Poly AC Overlay
17.064	20.524	23842	11-2003	Minor Rehabilitation	60-AC Overlay w/Rpr
20.054	21.600	92545	1-2015	Minor Rehabilitation	60-AC Overlay w/Rpr
21.600	22.513	83910	7-2014	Minor Rehabilitation	60-AC Overlay w/Rpr

Roadway Codes

Access Control Journalized

- F - Full Access Control
- L - Limited Access Control
- N - No Access Control

Access Control Operational

- 1 - Full Access Control
- 2 - Partial Access Control
- 3 - No Access Control

Base Type

- F - Crack and Seat
- H - Rubblize and Roll
- I - Aggregate Base 304 or Traffic Compacted
- K - Water Bound Macadam
- L - Bituminous Concrete Mix or Penetration Macadam
- N - Plain Concrete
- P - Reinforced Concrete
- R - Brick (Flexible)
- T - Brick (Rigid)

Direction of Travel

- B - Both (Two-way)
- F - One-way Cardinal
- T - One-way Non-cardinal

Facility Type

- 1 - One-way Roadway
- 2 - Two-way Roadway
- 4 - Ramp
- 5 - Non-mainline
- 6 - Non-inventory Direction
- 7 - Planned / Unbuilt

Historical Federal Aid Indicator

- N - Not a FAP Route
- Y - FAP Route

Functional Classification

- 01 - Interstate
- 02 - Principal Arterial (Freeways)
- 03 - Principal Arterial (Other)
- 04 - Minor Arterial
- 05 - Major Collector
- 06 - Minor Collector
- 07 - Local

Leave / Reenter Indicator

- Y - Route leaves/reenters at this point
- N - Route does not leave/reenter at this point

Median Type

- 1 - None
- 2 - Unprotected
- 3 - Curbed
- 4 - Positive Barrier (Unspecified)
- 5 - Positive Barrier (Flexible)
- 6 - Positive Barrier (Semi-rigid)
- 7 - Positive Barrier (Rigid)

NHS

- N - National Highway System
- H - Congressional Corridor
- 2 - Major Airport
- 3 - Major Port Facility
- 4 - Major Amtrak Station
- 5 - Major Rail / Truck Terminal
- 6 - Major Intercity Bus Terminal
- 7 - Major Public Transit / Multi-modal Passenger Terminal
- 8 - Major Pipeline Terminal
- 9 - Major Ferry Terminal

Priority System

- G - General
- P - Priority System
- U - Urban

Scenic Byway Code

- A - All American Road
- N - National Scenic Byway
- S - State Scenic Byway

Shoulder Type

- 1 - None
- 2 - Surfaced shoulder exists (bituminous concrete {AC})
- 3 - Surfaced shoulder exists (Portland Cement Concrete {PCC})
- 4 - Stabilized shoulder exists (gravel or other granular material)
- 5 - Combination shoulder exists (two or more surface types)
- 6 - Earth shoulder exists
- 7 - Barrier curb exists; no shoulder in front of curb

Surface Type

- A - Combination
- B - Brick
- C - Continuous Reinforced Concrete
- D - Reinforced Concrete
- E - Plain Concrete
- G - Bituminous Concrete
- I - Chipseal on Granular
- K - Open Graded Bituminous
- L - Chipseal or Micro
- M - Gravel
- U - Unimproved
- X - Right of Way Only