

SCLESR00125**C

State True Log 7.529

8.529

County True Log

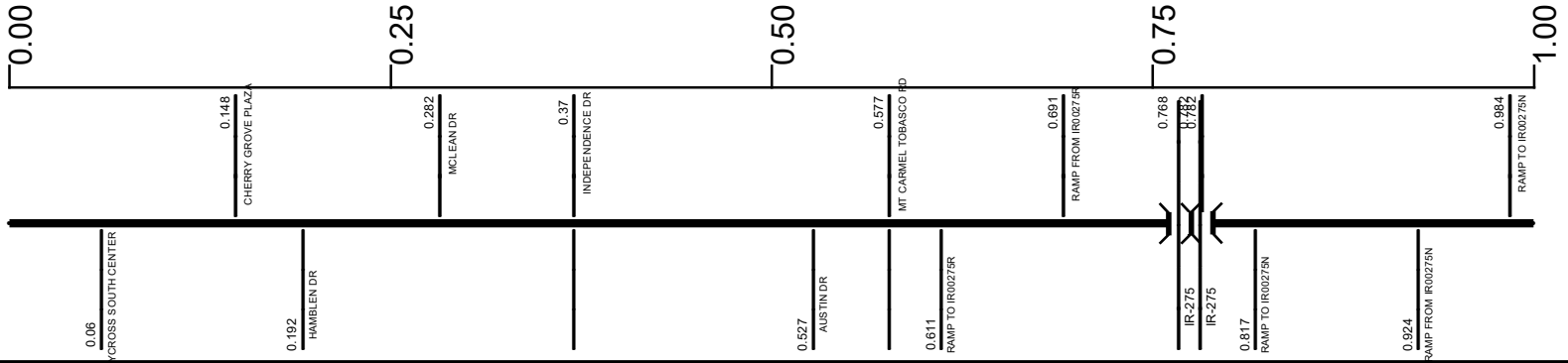

Surface Type & Width (Left / Right)

G (50'/20')	G 64'	G 50'
0 - 0.181	0.181 - 0.605	0.605 - 1.539

Base Type (Left / Right)

L / P	L
0 - 0.181	0.181 - 5.347

Shoulder Type & Width (Left / Right)

	1 (0'/0')	2 (12'/12')
0 - 0.605		0.605 - 1.539

Through Lanes

	4	
0 - 14.762		

Street Name

	SR 125	
0 - 5.211		

- Non-divided Highway
- Divided Highway
- Secondary Segment
- Corporation
- Bridge (on route)
- Underpass
- Overpass
- Railroad (at grade)
- Railroad (underpass)
- Railroad (overpass)
- Intersection

Created on: 6/24/2025

transportation.ohio.gov

Prepared by
The Ohio Department of Transportation
Office of Technical Services
Roadway Information

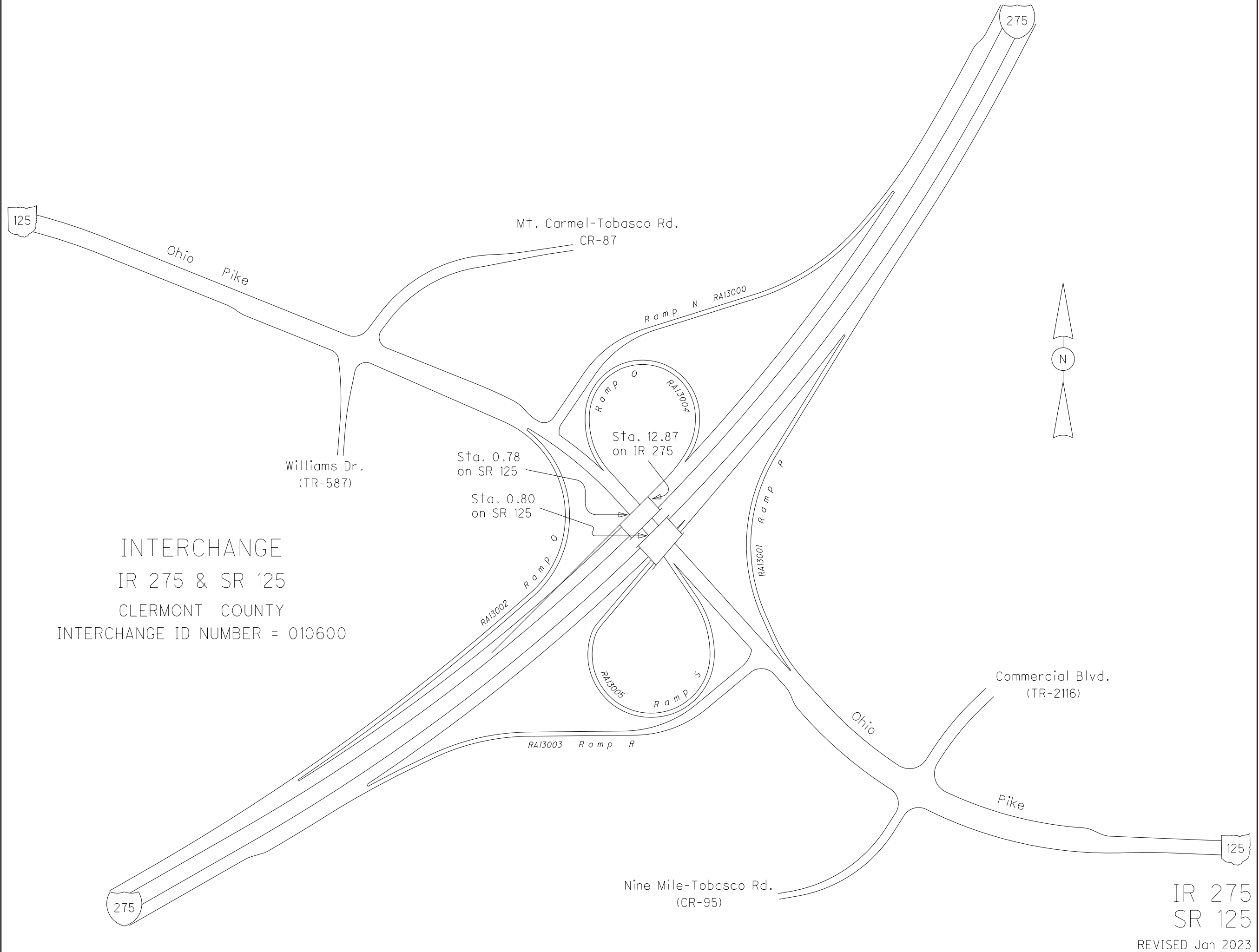

INTERCHANGE
IR 275 & SR 125
CLERMONT COUNTY
INTERCHANGE ID NUMBER = 010600

IR 275
SR 125
REVISED Jan 2023

SCLESR00125**C

State True Log

9.529

County True Log

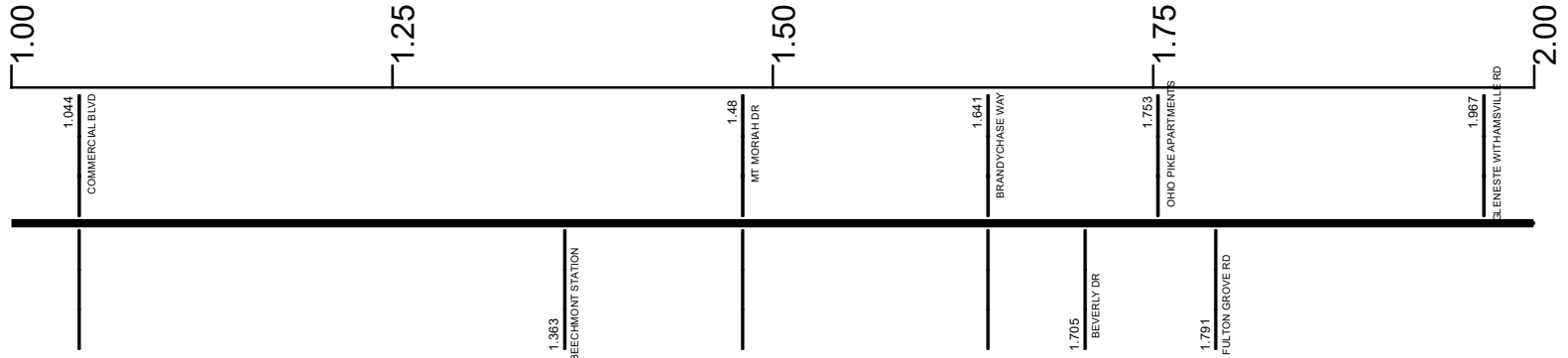

Surface Type & Width (Left / Right)

G 50'	G 54'
0.605 - 1.539	1.539 - 4.977

Base Type (Left / Right)

L
0.181 - 5.347

Shoulder Type & Width (Left / Right)

2 (12'/12')	1 (0'/0')
0.605 - 1.539	1.539 - 7.366

Through Lanes

4
0 - 14.762

Street Name

SR 125
0 - 5.211

- Non-divided Highway
- Divided Highway
- Secondary Segment
- Corporation
- Bridge (on route)
- Underpass
- Overpass
- Railroad (at grade)
- Railroad (underpass)
- Railroad (overpass)
- Intersection

Created on: 6/24/2025



transportation.ohio.gov
 Prepared by
 The Ohio Department of Transportation
 Office of Technical Services
 Roadway Information

SCLESR00125**C

State True Log

10.529

County True Log

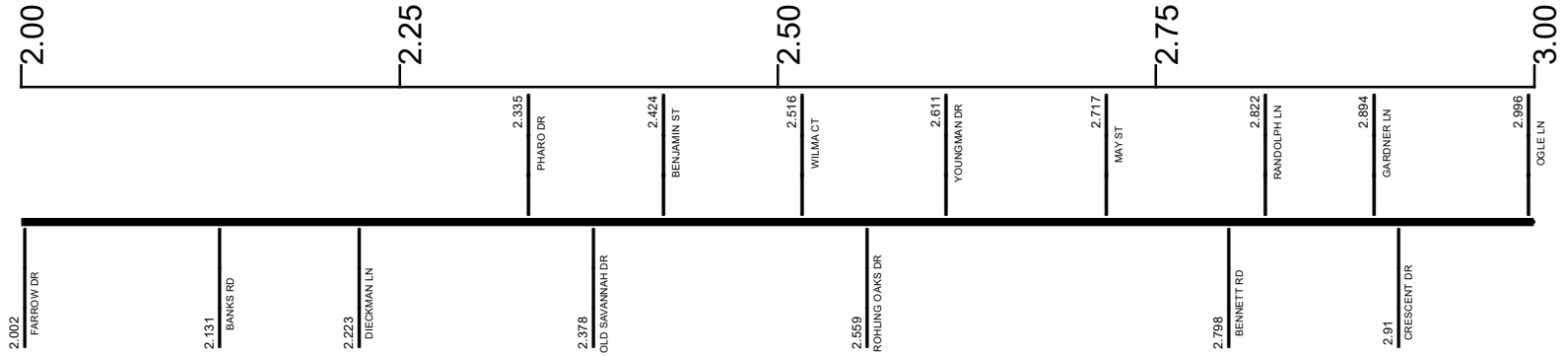

Surface Type & Width (Left / Right)

G 54'
1.539 - 4.977

Base Type (Left / Right)

L
0.181 - 5.347

Shoulder Type & Width (Left / Right)

1 (0'/0')
1.539 - 7.366

Through Lanes

4
0 - 14.762

Street Name

SR 125
0 - 5.211

- Non-divided Highway
- Divided Highway
- Secondary Segment
- Corporation
- Bridge (on route)
- Underpass
- Overpass
- Railroad (at grade)
- Railroad (underpass)
- Railroad (overpass)
- Intersection

Created on: 6/24/2025



transportation.ohio.gov
Prepared by
The Ohio Department of Transportation
Office of Technical Services
Roadway Information

SCLESR00125**C

State True Log

11.529

County True Log

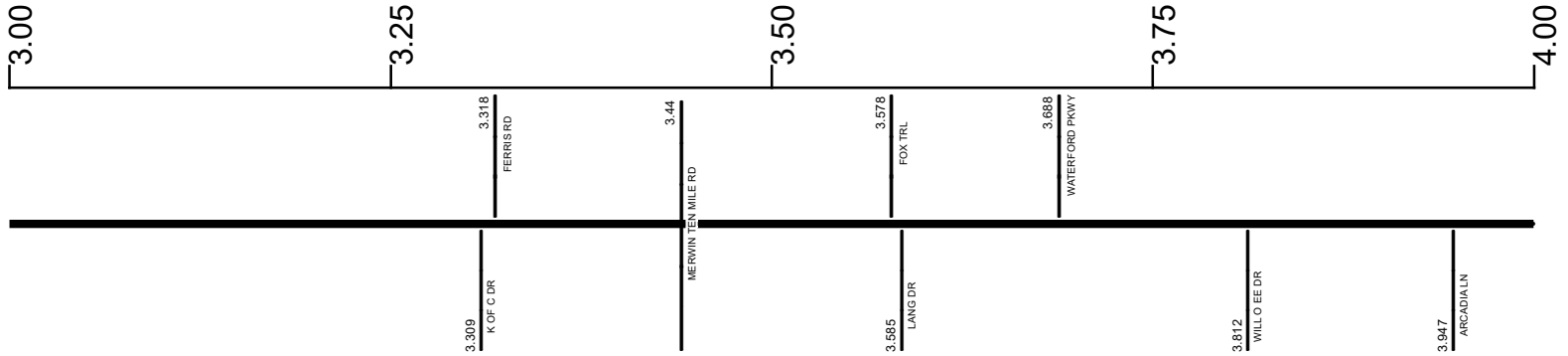

Surface Type & Width (Left / Right)

G 54'
1.539 - 4.977

Base Type (Left / Right)

L
0.181 - 5.347

Shoulder Type & Width (Left / Right)

1 (0'/0')
1.539 - 7.366

Through Lanes

4
0 - 14.762

Street Name

SR 125
0 - 5.211

- | | | | |
|---------------------|-------------------|----------------------|--------------|
| Non-divided Highway | Bridge (on route) | Railroad (at grade) | Intersection |
| Divided Highway | Underpass | Railroad (underpass) | |
| Secondary Segment | Overpass | Railroad (overpass) | |
| Corporation | | | |

Created on: 6/24/2025



transportation.ohio.gov

Prepared by
The Ohio Department of Transportation
Office of Technical Services
Roadway Information

SCLESR00125**C

State True Log

12.529

County True Log

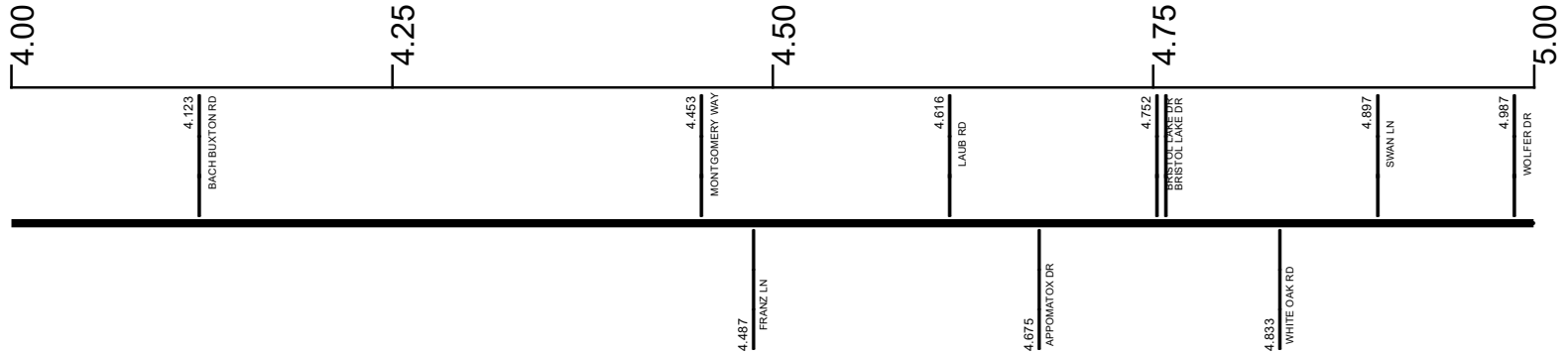

Surface Type & Width (Left / Right)

G 54'	G (28'/29')
1.539 - 4.977	4.977 - 5.347

Base Type (Left / Right)

L
0.181 - 5.347

Shoulder Type & Width (Left / Right)

1 (0'/0')
1.539 - 7.366

Through Lanes

4
0 - 14.762

Street Name

SR 125
0 - 5.211

- Non-divided Highway
- Divided Highway
- Secondary Segment
- Corporation
- Bridge (on route)
- Underpass
- Overpass
- Railroad (at grade)
- Railroad (underpass)
- Railroad (overpass)
- Intersection

Created on: 6/24/2025



transportation.ohio.gov
 Prepared by
 The Ohio Department of Transportation
 Office of Technical Services
 Roadway Information

SCLESR00125**C

State True Log

13.529

County True Log

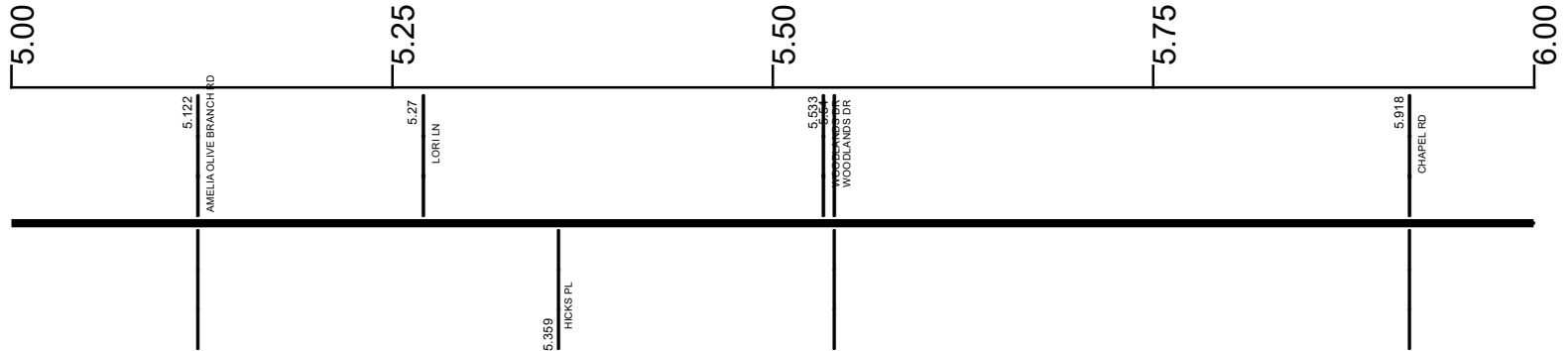

Surface Type & Width (Left / Right)

G (28'/29')	G 40'
4.977 - 5.347	5.347 - 6.932

Base Type (Left / Right)

L	P
0.181 - 5.347	5.347 - 6.932

Shoulder Type & Width (Left / Right)

1 (0'/0')
1.539 - 7.366

Resurface Year

2022
5.161 - 8.977

Through Lanes

4
0 - 14.762

Street Name

SR 125	W MAIN ST
0 - 5.211	5.211 - 6.157

- Non-divided Highway
- Divided Highway
- Secondary Segment
- Corporation
- Bridge (on route)
- Underpass
- Overpass
- Railroad (at grade)
- Railroad (underpass)
- Railroad (overpass)
- Intersection

Created on: 6/24/2025



transportation.ohio.gov
 Prepared by
 The Ohio Department of Transportation
 Office of Technical Services
 Roadway Information

SCLESR00125**C

State True Log

14.529

County True Log

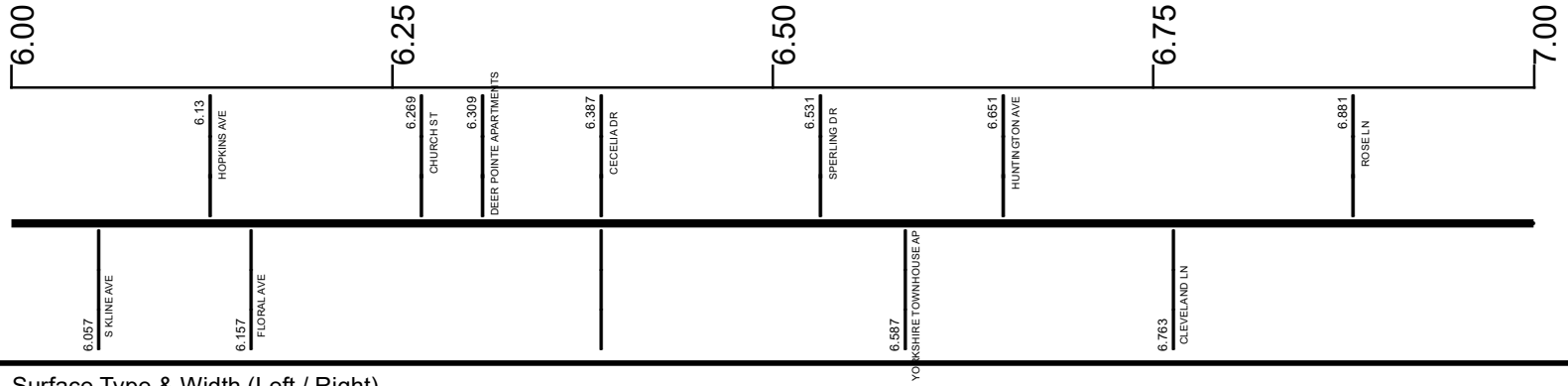

Surface Type & Width (Left / Right)

G 40'	G (40'/14')
5.347 - 6.932	6.932 - 7.013

Base Type (Left / Right)

P	P / L
5.347 - 6.932	6.932 - 7.013

Shoulder Type & Width (Left / Right)

1 (0'/0')
1.539 - 7.366

Resurface Year

2022
5.161 - 8.977

Through Lanes

4
0 - 14.762

Street Name

W MAIN ST	E MAIN ST	SR 125
5.211 - 6.157	6.157 - 6.763	6.763 - 14.013

- Non-divided Highway
- Divided Highway
- Secondary Segment
- Corporation
- Bridge (on route)
- Underpass
- Overpass
- Railroad (at grade)
- Railroad (underpass)
- Railroad (overpass)
- Intersection

Created on: 6/24/2025



transportation.ohio.gov
 Prepared by
 The Ohio Department of Transportation
 Office of Technical Services
 Roadway Information

SCLESR00125**C

State True Log

15.529

County True Log

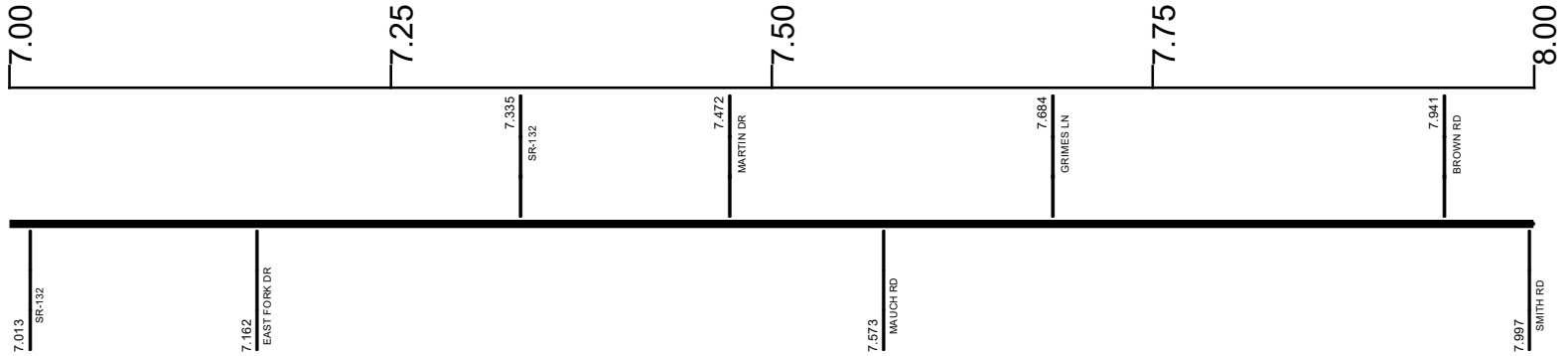

Surface Type & Width (Left / Right)

G (40'/14')	G (36'/18')	G (42'/18')	G (50'/10')	G (42'/18')
	7.013 - 7.366	7.366 - 7.702	7.702 - 7.941	7.941 - 8.547

Base Type (Left / Right)

P/L	I/K	I/L	I/K
6.932 - 7.013	7.013 - 7.702	7.702 - 7.941	7.941 - 8.547

Shoulder Type & Width (Left / Right)

1 (0'/0')	2 (8'/8')
1.539 - 7.366	7.366 - 14.015

Resurface Year

2022

Through Lanes

4

Street Name

SR 125
6.763 - 14.013

- Non-divided Highway
- Divided Highway
- Secondary Segment
- Corporation
- Bridge (on route)
- Underpass
- Overpass
- Railroad (at grade)
- Railroad (underpass)
- Railroad (overpass)
- Intersection

Created on: 6/24/2025

transportation.ohio.gov

Prepared by
The Ohio Department of Transportation
Office of Technical Services
Roadway Information

SCLESR00125**C

State True Log

16.529

County True Log

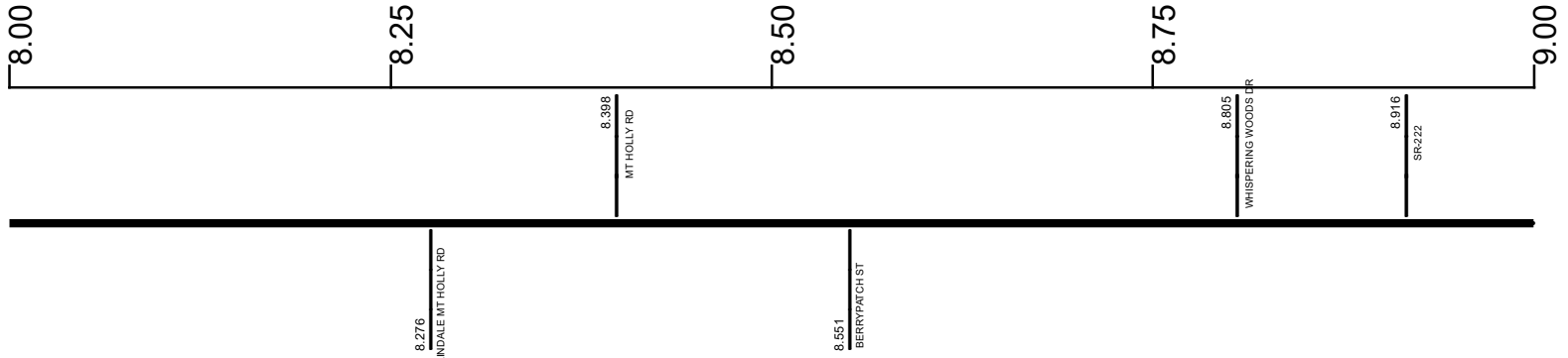

Surface Type & Width (Left / Right)

G (42'/18')	G (50'/10')	G 50'
7.941 - 8.547	8.547 - 8.987	

Base Type (Left / Right)

I / K	I / L	I
7.941 - 8.547	8.547 - 8.987	8.987 - 9.355

Shoulder Type & Width (Left / Right)

2 (8'/8')
7.366 - 14.015

Resurface Year

2022
5.161 - 8.977

Through Lanes

4
0 - 14.762

Street Name

SR 125
6.763 - 14.013

- Non-divided Highway
- Divided Highway
- Secondary Segment
- Corporation
- Bridge (on route)
- Underpass
- Overpass
- Railroad (at grade)
- Railroad (underpass)
- Railroad (overpass)
- Intersection

Created on: 6/24/2025



transportation.ohio.gov
 Prepared by
 The Ohio Department of Transportation
 Office of Technical Services
 Roadway Information

SCLESR00125**C

State True Log

17.529

County True Log

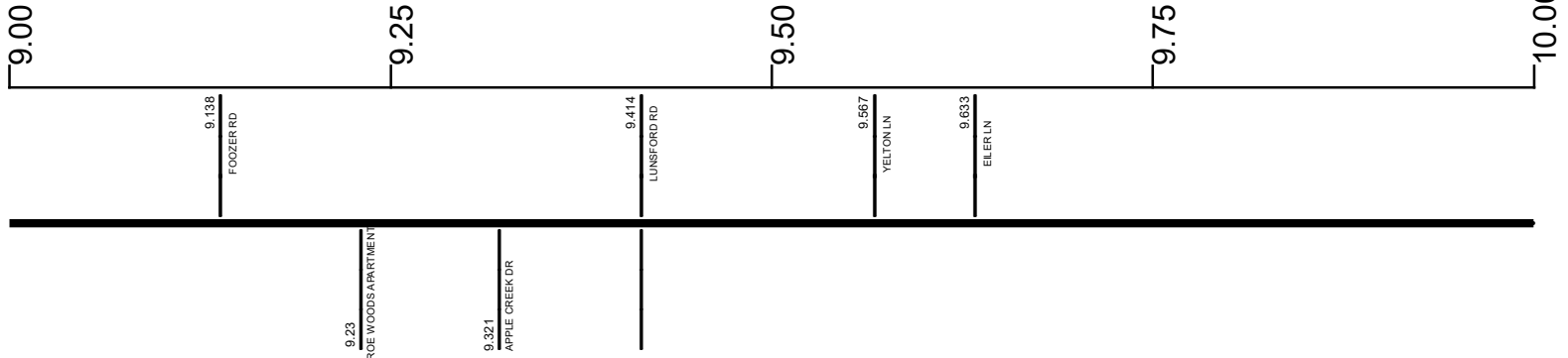

Surface Type & Width (Left / Right)

G 50'	G (42'/18')	G (32'/18')	G 50'
8.987 - 9.355	9.355 - 9.465	9.465 - 9.931	9.931 - 11.522

Base Type (Left / Right)

I	I / K	I
8.987 - 9.355	9.355 - 9.931	9.931 - 11.522

Shoulder Type & Width (Left / Right)

2 (8'/8')
7.366 - 14.015

Through Lanes

4
0 - 14.762

Street Name

SR 125
6.763 - 14.013

- Non-divided Highway
- Divided Highway
- Secondary Segment
- Corporation
- Bridge (on route)
- Underpass
- Overpass
- Railroad (at grade)
- Railroad (underpass)
- Railroad (overpass)
- Intersection

Created on: 6/24/2025



transportation.ohio.gov
 Prepared by
 The Ohio Department of Transportation
 Office of Technical Services
 Roadway Information

SCLESR00125**C

State True Log

18.529

County True Log

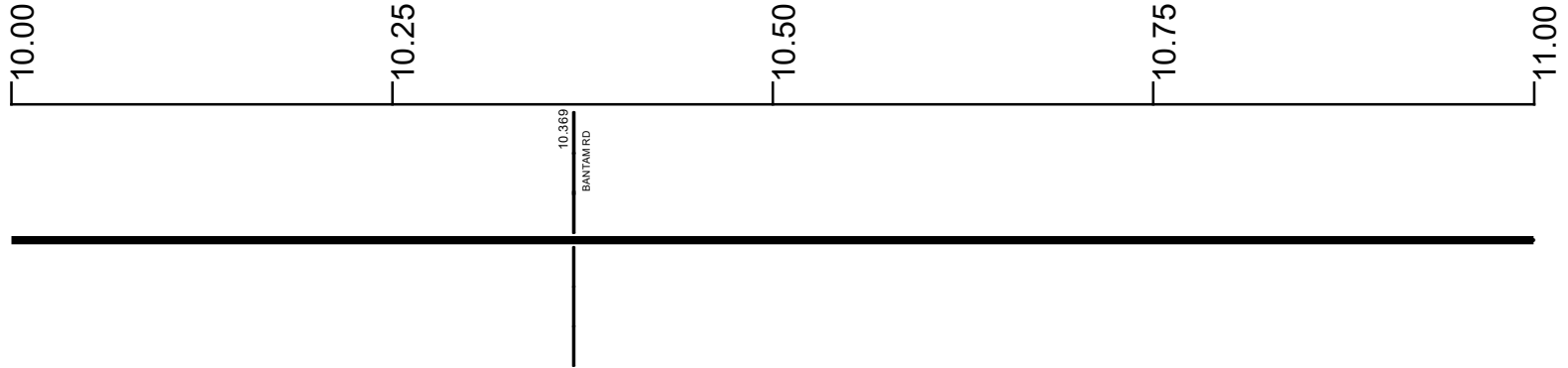

Surface Type & Width (Left / Right)

G 50'
9.931 - 11.522

Base Type (Left / Right)

I
9.931 - 11.522

Shoulder Type & Width (Left / Right)

2 (8/8)
7.366 - 14.015

Through Lanes

4
0 - 14.762

Street Name

SR 125
6.763 - 14.013

- | | | | |
|---------------------|-------------------|----------------------|--------------|
| Non-divided Highway | Bridge (on route) | Railroad (at grade) | Intersection |
| Divided Highway | Underpass | Railroad (underpass) | |
| Secondary Segment | Overpass | Railroad (overpass) | |
| Corporation | | | |

Created on: 6/24/2025

transportation.ohio.gov

Prepared by
The Ohio Department of Transportation
Office of Technical Services
Roadway Information

SCLESR00125**C

State True Log

19.529

County True Log

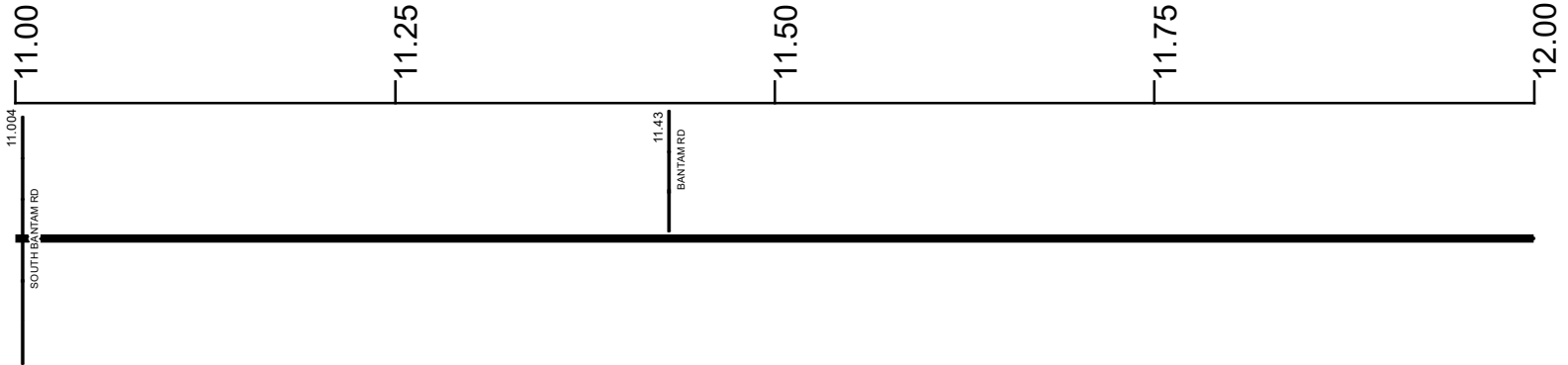

Surface Type & Width (Left / Right)

G 50'	G (32'/18')
9.931 - 11.522	11.522 - 12.209

Base Type (Left / Right)

I	I / K
9.931 - 11.522	11.522 - 12.209

Shoulder Type & Width (Left / Right)

	2 (8/8)
	7.366 - 14.015

Through Lanes

	4
	0 - 14.762

Street Name

	SR 125
	6.763 - 14.013

- | | | | |
|---------------------|-------------------|----------------------|--------------|
| Non-divided Highway | Bridge (on route) | Railroad (at grade) | Intersection |
| Divided Highway | Underpass | Railroad (underpass) | |
| Secondary Segment | Overpass | Railroad (overpass) | |
| Corporation | | | |

Created on: 6/24/2025

transportation.ohio.gov

Prepared by
The Ohio Department of Transportation
Office of Technical Services
Roadway Information

SCLESR00125**C

State True Log

20.529

County True Log

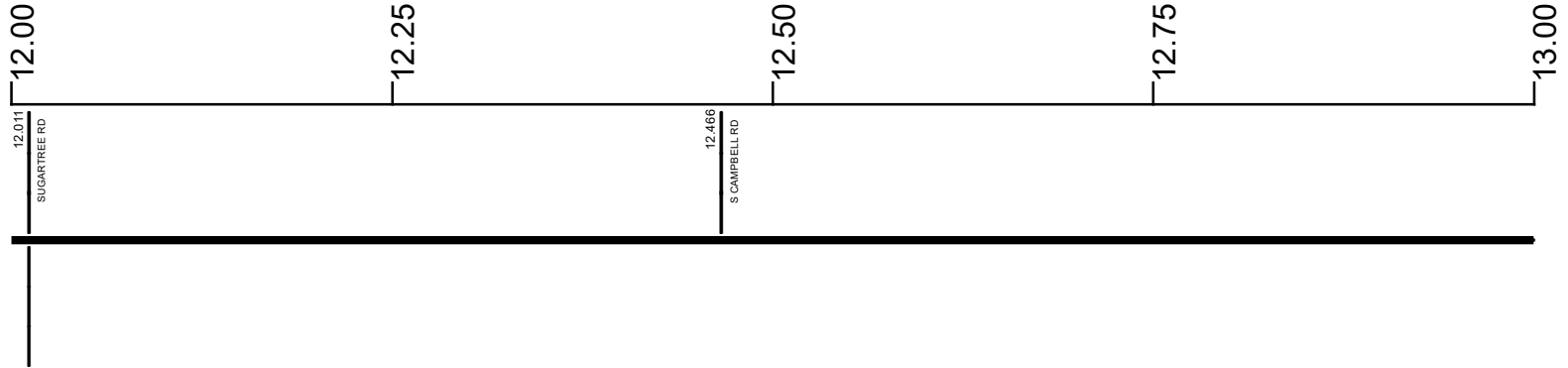

Surface Type & Width (Left / Right)

G (32'/18')	G 50'	G (32'/18')
11.522 - 12.209	12.209 - 12.765	12.765 - 13.289

Base Type (Left / Right)

I / K	I	I / K
11.522 - 12.209	12.209 - 12.765	12.765 - 13.289

Shoulder Type & Width (Left / Right)

2 (8'/8')
7.366 - 14.015

Through Lanes

4
0 - 14.762

Street Name

SR 125
6.763 - 14.013

<ul style="list-style-type: none"> Non-divided Highway Divided Highway Secondary Segment Corporation 	<ul style="list-style-type: none"> Bridge (on route) Underpass Overpass 	<ul style="list-style-type: none"> Railroad (at grade) Railroad (underpass) Railroad (overpass) 	<ul style="list-style-type: none"> Intersection
--	---	---	---

Created on: 6/24/2025

transportation.ohio.gov

Prepared by
The Ohio Department of Transportation
Office of Technical Services
Roadway Information

SCLESR00125**C

State True Log
County True Log

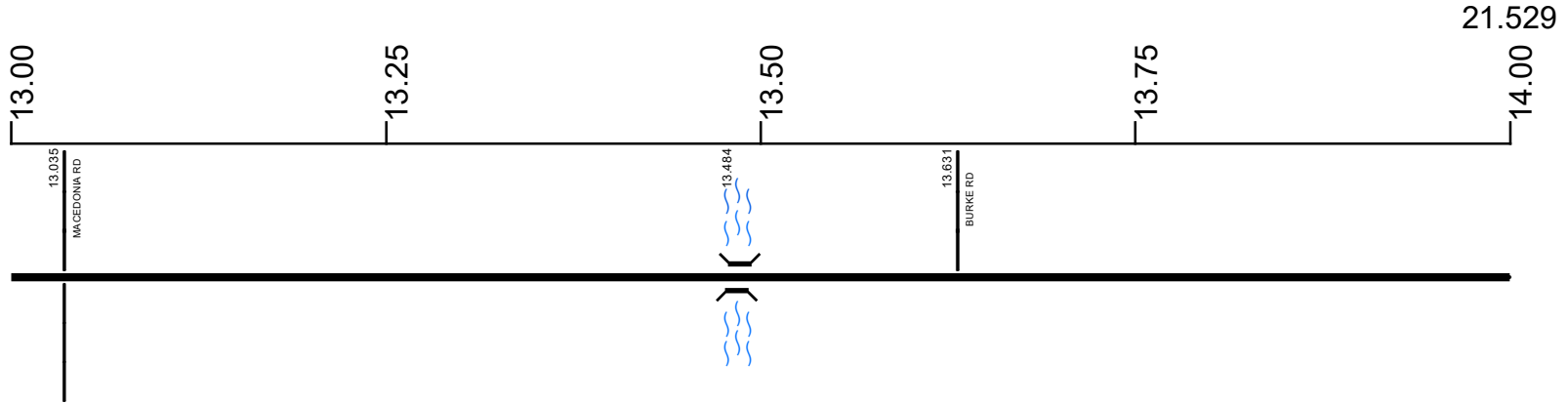

Surface Type & Width (Left / Right)

G (32'/18')	G 50'
12.765 - 13.289	13.289 - 14.015

Base Type (Left / Right)

I / K	I
12.765 - 13.289	13.289 - 14.278

Shoulder Type & Width (Left / Right)

2 (8'/8')
7.366 - 14.015

Through Lanes

4
0 - 14.762

Street Name

SR 125
6.763 - 14.013

- Non-divided Highway
 Bridge (on route)
 Railroad (at grade)
 Intersection
- Divided Highway
 Underpass
 Railroad (underpass)
- Secondary Segment
 Overpass
 Railroad (overpass)
- Corporation**

Created on: 6/24/2025

transportation.ohio.gov

Prepared by
The Ohio Department of Transportation
Office of Technical Services
Roadway Information

SCLESR00125**C

State True Log

22.529

County True Log

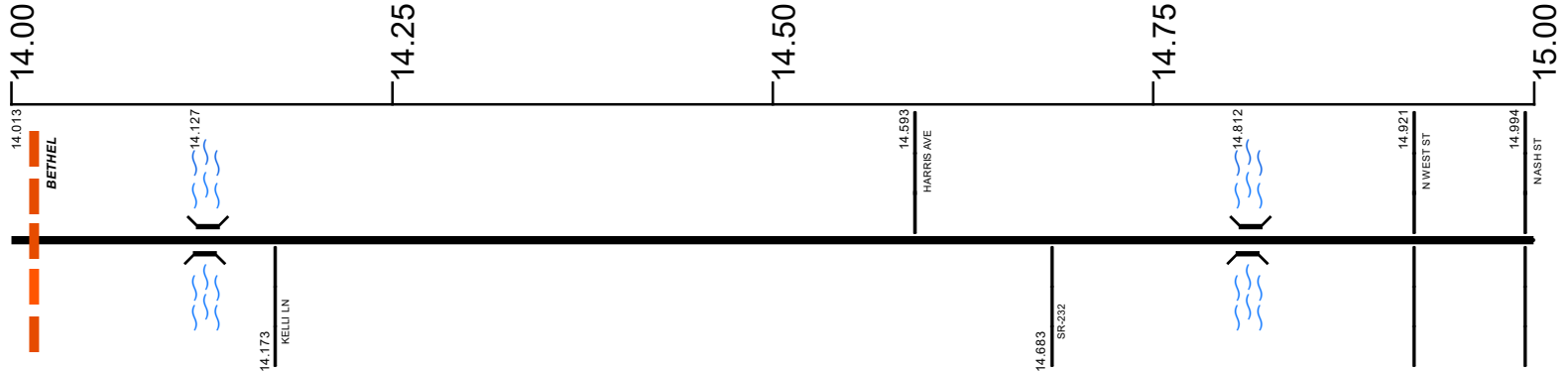

Surface Type & Width (Left / Right)

G 50'	G 60'
	14.015 - 15.143

Base Type (Left / Right)

I	I / K	K
13.289 - 14.278	14.278 - 14.762	14.762 - 15.668

Shoulder Type & Width (Left / Right)

2 (8'8")	1 (0'0")
7.366 - 14.015	14.015 - 15.668

Resurface Year

2020
14.015 - 15.143

Through Lanes

4	2
0 - 14.762	14.762 - 14.994
	14.994 - 15.668

Street Name

SR 125	W PLANE ST
6.763 - 14.013	14.013 - 15.214

- Non-divided Highway
- Divided Highway
- Secondary Segment
- Corporation
- Bridge (on route)
- Underpass
- Overpass
- Railroad (at grade)
- Railroad (underpass)
- Railroad (overpass)
- Intersection

Created on: 6/24/2025



transportation.ohio.gov

Prepared by
The Ohio Department of Transportation
Office of Technical Services
Roadway Information

SCLESR00125**C

State True Log

23.529

County True Log

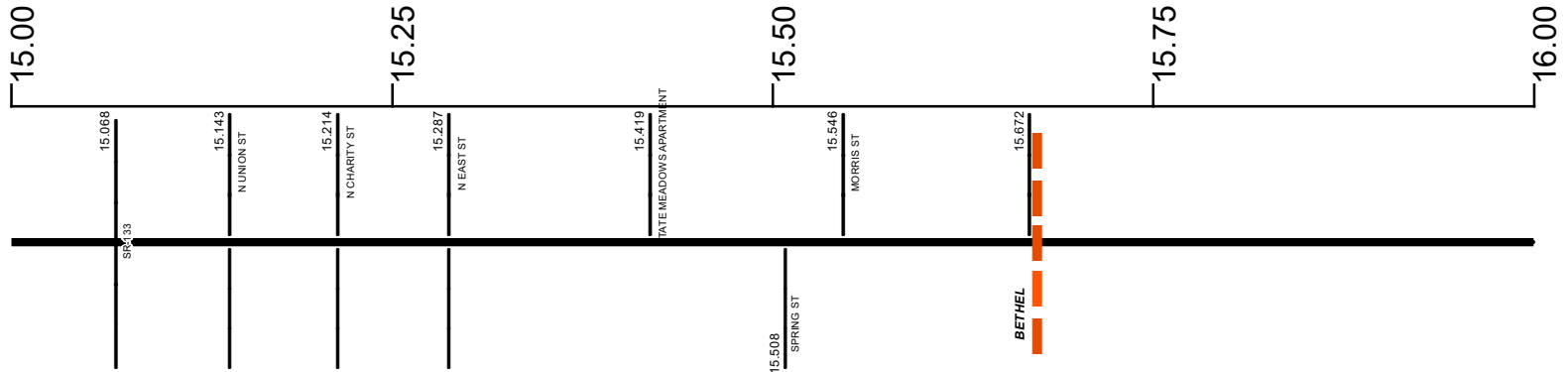

Surface Type & Width (Left / Right)

G 60'	G 42'	G (20'/21')	G 24'
14.015 - 15.143	15.143 - 15.297	15.297 - 15.668	15.668 - 18.204

Base Type (Left / Right)

K	L
14.762 - 15.668	15.668 - 18.204

Shoulder Type & Width (Left / Right)

1 (0'/0')	2 (2'/2')
14.015 - 15.668	15.668 - 18.204

Resurface Year

2020	2023
14.015 - 15.143	15.143 - 18.204

Through Lanes

4	2
14.994 - 15.668	15.668 - 18.204

Street Name

W PLANE ST	E PLANE ST	SR 125
14.013 - 15.214	15.214 - 15.668	15.668 - 18.204

- Non-divided Highway
- Divided Highway
- Secondary Segment
- Corporation
- Bridge (on route)
- Underpass
- Overpass
- Railroad (at grade)
- Railroad (underpass)
- Railroad (overpass)
- Intersection

Created on: 6/24/2025



transportation.ohio.gov
 Prepared by
 The Ohio Department of Transportation
 Office of Technical Services
 Roadway Information

SCLESR00125**C

State True Log

24.529

County True Log

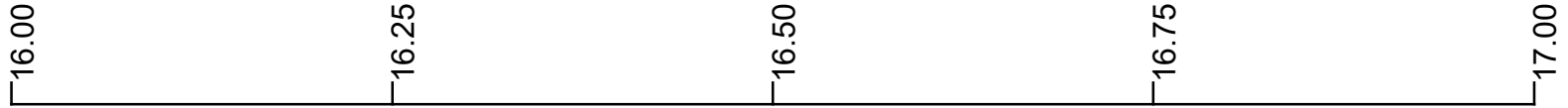

Surface Type & Width (Left / Right)

G 24'
15.668 - 18.204

Base Type (Left / Right)

L
15.668 - 18.204

Shoulder Type & Width (Left / Right)

2 (2'/2')
15.668 - 18.204

Resurface Year

2023

Through Lanes

2
15.668 - 18.204

Street Name

SR 125
15.668 - 18.204

- Non-divided Highway
- Divided Highway
- Secondary Segment
- Corporation
- Bridge (on route)
- Underpass
- Overpass
- Railroad (at grade)
- Railroad (underpass)
- Railroad (overpass)
- Intersection

Created on: 6/24/2025

transportation.ohio.gov
Prepared by
The Ohio Department of Transportation
Office of Technical Services
Roadway Information

SCLESR00125**C

State True Log

25.529

County True Log

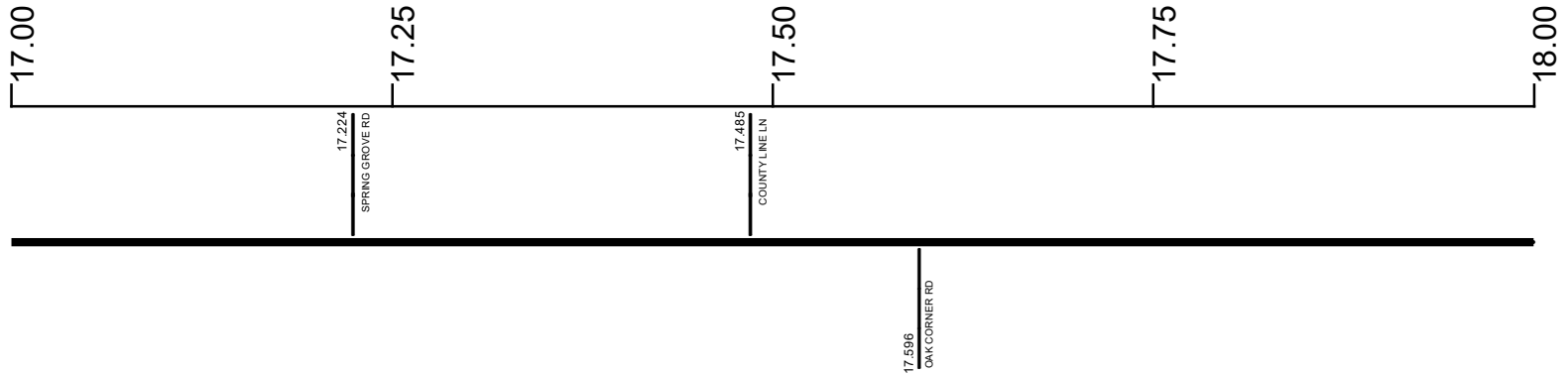

Surface Type & Width (Left / Right)

G 24'
15.668 - 18.204

Base Type (Left / Right)

L
15.668 - 18.204

Shoulder Type & Width (Left / Right)

2 (2'/2')
15.668 - 18.204

Resurface Year

2023
15.143 - 18.204

Through Lanes

2
15.668 - 18.204

Street Name

SR 125
15.668 - 18.204

- Non-divided Highway
 Bridge (on route)
 Railroad (at grade)
 Intersection
- Divided Highway
 Underpass
 Railroad (underpass)
- Secondary Segment
 Overpass
 Railroad (overpass)
- Corporation**

Created on: 6/24/2025

Prepared by
The Ohio Department of Transportation
Office of Technical Services
Roadway Information

SCLESR00125**C

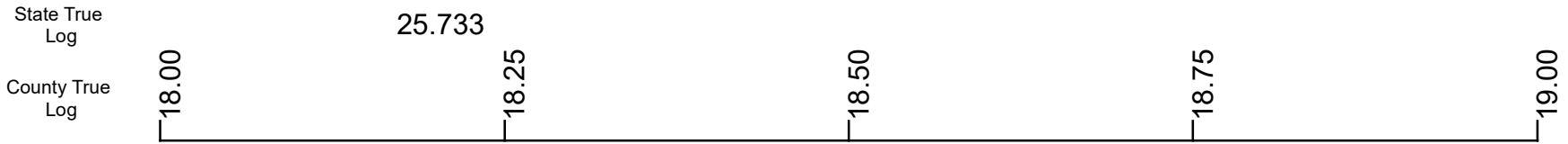

- Surface Type & Width (Left / Right)
G 24'
 15.668 - 18.204
- Base Type (Left / Right)
L
 15.668 - 18.204
- Shoulder Type & Width (Left / Right)
2 (2 1/2')
 15.668 - 18.204
- Resurface Year
2023
 15.143 - 18.204
- Through Lanes
2
 15.668 - 18.204
- Street Name
SR 125
 15.668 - 18.204

<ul style="list-style-type: none"> Non-divided Highway Divided Highway Secondary Segment Corporation 	<ul style="list-style-type: none"> Bridge (on route) Underpass Overpass 	<ul style="list-style-type: none"> Railroad (at grade) Railroad (underpass) Railroad (overpass) 	<ul style="list-style-type: none"> Intersection
---	---	---	---

Created on: 6/24/2025

transportation.ohio.gov

Prepared by
 The Ohio Department of Transportation
 Office of Technical Services
 Roadway Information

Historical Project List for SCLESR00125**C

Begin Measure	End Measure	Project ID Number	Construction Completion Date	Treatment Category	Treatment Type
0.302	0.606	24029	12-2002	Minor Rehabilitation	50-AC Overlay w/o Rpr
0.415	1.156	81425	12-2014	Minor Rehabilitation	50-AC Overlay w/o Rpr
1.156	7.407	83812	11-2010	Minor Rehabilitation	60-AC Overlay w/Rpr
1.318	4.977	102536	11-2019	Preventive Maintenance	31-DbI Appl Micro
4.977	5.161	102536	11-2019	Preventive Maintenance	31-DbI Appl Micro
5.161	5.357	112408	7-2023	Minor Rehabilitation	60-AC Overlay w/Rpr
5.357	6.942	112408	7-2023	Minor Rehabilitation	60-AC Overlay w/Rpr
6.942	7.134	112408	7-2023	Minor Rehabilitation	60-AC Overlay w/Rpr
7.134	7.397	112408	7-2023	Minor Rehabilitation	60-AC Overlay w/Rpr
7.397	8.977	112408	7-2023	Minor Rehabilitation	60-AC Overlay w/Rpr
8.977	14.106	84478	8-2014	Minor Rehabilitation	38-Fine Poly AC Overlay
14.015	15.143	104693	11-2020	Preventive Maintenance	33-Thinlay Asphalt
14.762	15.668	22848	6-2006	Minor Rehabilitation	60-AC Overlay w/Rpr
15.668	18.204	25373	7-2008	Minor Rehabilitation	38-Fine Poly AC Overlay
15.668	18.204	21816	5-2003	Preventive Maintenance	30-Microsurfacing

Roadway Codes

Access Control Journalized

- F - Full Access Control
- L - Limited Access Control
- N - No Access Control

Access Control Operational

- 1 - Full Access Control
- 2 - Partial Access Control
- 3 - No Access Control

Base Type

- F - Crack and Seat
- H - Rubblize and Roll
- I - Aggregate Base 304 or Traffic Compacted
- K - Water Bound Macadam
- L - Bituminous Concrete Mix or Penetration Macadam
- N - Plain Concrete
- P - Reinforced Concrete
- R - Brick (Flexible)
- T - Brick (Rigid)

Direction of Travel

- B - Both (Two-way)
- F - One-way Cardinal
- T - One-way Non-cardinal

Facility Type

- 1 - One-way Roadway
- 2 - Two-way Roadway
- 4 - Ramp
- 5 - Non-mainline
- 6 - Non-inventory Direction
- 7 - Planned / Unbuilt

Historical Federal Aid Indicator

- N - Not a FAP Route
- Y - FAP Route

Functional Classification

- 01 - Interstate
- 02 - Principal Arterial (Freeways)
- 03 - Principal Arterial (Other)
- 04 - Minor Arterial
- 05 - Major Collector
- 06 - Minor Collector
- 07 - Local

Leave / Reenter Indicator

- Y - Route leaves/reenters at this point
- N - Route does not leave/reenter at this point

Median Type

- 1 - None
- 2 - Unprotected
- 3 - Curbed
- 4 - Positive Barrier (Unspecified)
- 5 - Positive Barrier (Flexible)
- 6 - Positive Barrier (Semi-rigid)
- 7 - Positive Barrier (Rigid)

NHS

- N - National Highway System
- H - Congressional Corridor
- 2 - Major Airport
- 3 - Major Port Facility
- 4 - Major Amtrak Station
- 5 - Major Rail / Truck Terminal
- 6 - Major Intercity Bus Terminal
- 7 - Major Public Transit / Multi-modal Passenger Terminal
- 8 - Major Pipeline Terminal
- 9 - Major Ferry Terminal

Priority System

- G - General
- P - Priority System
- U - Urban

Scenic Byway Code

- A - All American Road
- N - National Scenic Byway
- S - State Scenic Byway

Shoulder Type

- 1 - None
- 2 - Surfaced shoulder exists (bituminous concrete {AC})
- 3 - Surfaced shoulder exists (Portland Cement Concrete {PCC})
- 4 - Stabilized shoulder exists (gravel or other granular material)
- 5 - Combination shoulder exists (two or more surface types)
- 6 - Earth shoulder exists
- 7 - Barrier curb exists; no shoulder in front of curb

Surface Type

- A - Combination
- B - Brick
- C - Continuous Reinforced Concrete
- D - Reinforced Concrete
- E - Plain Concrete
- G - Bituminous Concrete
- I - Chipseal on Granular
- K - Open Graded Bituminous
- L - Chipseal or Micro
- M - Gravel
- U - Unimproved
- X - Right of Way Only