

# SCOLSR00009\*\*C

State True Log 75.665

76.665

County True Log

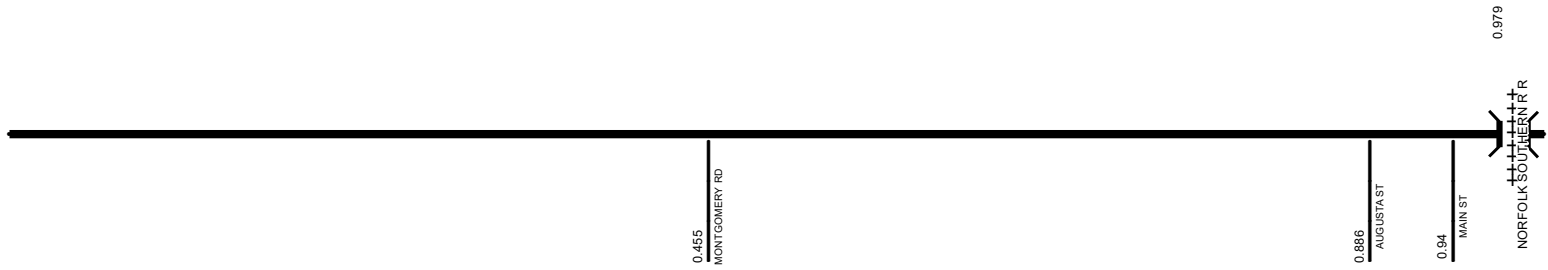

|                                      |                           |
|--------------------------------------|---------------------------|
| Surface Type & Width (Left / Right)  |                           |
| G 20'                                | G 24'                     |
| 0 - 0.95                             | 0.95 - 1.009              |
| Base Type (Left / Right)             |                           |
| I                                    | K L                       |
| 0 - 0.564                            | 0.564 - 0.95 0.95 - 1.009 |
| Shoulder Type & Width (Left / Right) |                           |
| 2 (3/3')                             | 2 (1/1')                  |
| 0 - 0.95                             | 0.95 - 1.009              |
| Resurface Year                       |                           |
| 2020                                 |                           |
| 0 - 1.009                            |                           |
| Through Lanes                        |                           |
| 2                                    |                           |
| 0 - 1.009                            |                           |
| Street Name                          |                           |
| SR 9                                 |                           |
| 0 - 1.009                            |                           |

|  |   |   |   |
|--|---|---|---|
| <ul style="list-style-type: none"> <li> Non-divided Highway</li> <li> Divided Highway</li> <li> Secondary Segment</li> <li> Corporation</li> </ul> | <ul style="list-style-type: none"> <li> Bridge (on route)</li> <li> Underpass</li> <li> Overpass</li> </ul> | <ul style="list-style-type: none"> <li> Railroad (at grade)</li> <li> Railroad (underpass)</li> <li> Railroad (overpass)</li> </ul> | <ul style="list-style-type: none"> <li> Intersection</li> </ul> |
|--|---|---|---|

Created on: 6/24/2025

transportation.ohio.gov

Prepared by  
The Ohio Department of Transportation  
Office of Technical Services  
Roadway Information

# SCOLSR00009\*\*C

State True Log

77.665

County True Log

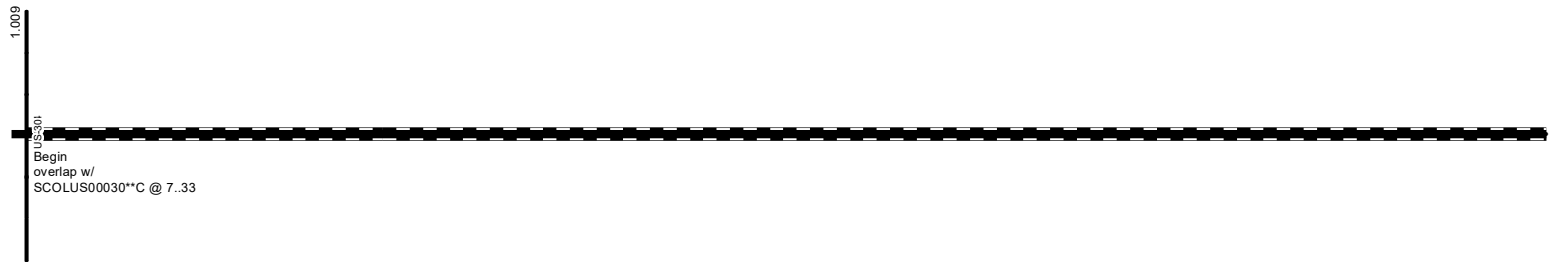
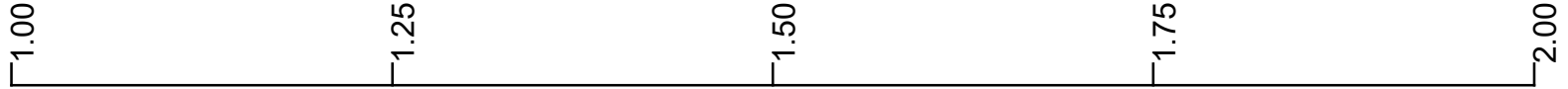

Surface Type & Width (Left / Right)

G 24'  
0.95 - 1.009

Base Type (Left / Right)

0.95 - 1.009

Shoulder Type & Width (Left / Right)

2 (11')  
0.95 - 1.009

Resurface Year

2020  
0 - 1.009

Through Lanes

2  
0 - 1.009

Street Name

SR 9  
0 - 1.009

|                     |                   |                      |              |
|---------------------|-------------------|----------------------|--------------|
| Non-divided Highway | Bridge (on route) | Railroad (at grade)  | Intersection |
| Divided Highway     | Underpass         | Railroad (underpass) |              |
| Secondary Segment   | Overpass          | Railroad (overpass)  |              |
| Corporation         |                   |                      |              |

Created on: 6/24/2025



transportation.ohio.gov  
Prepared by  
The Ohio Department of Transportation  
Office of Technical Services  
Roadway Information

# SCOLSR00009\*\*C

State True Log

78.665

County True Log

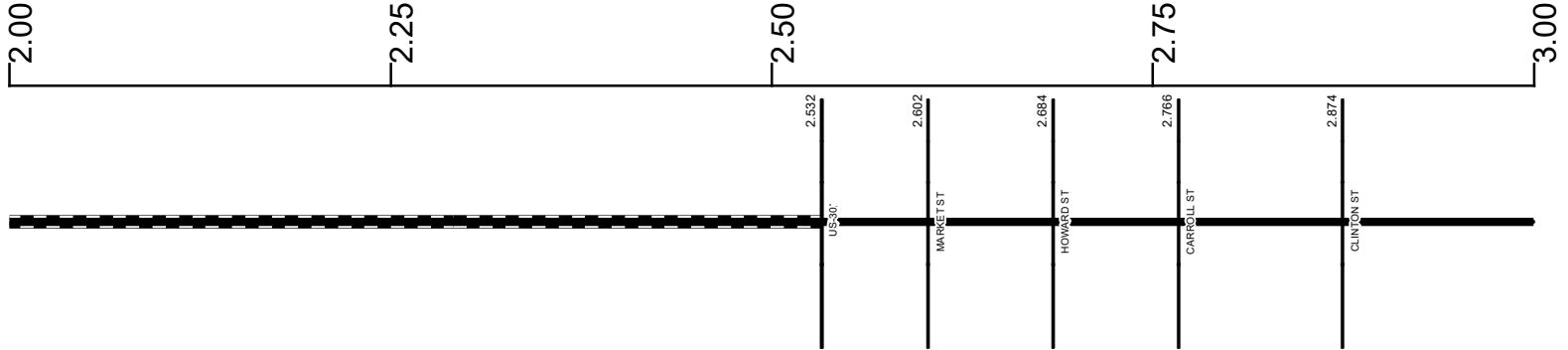

**Surface Type & Width (Left / Right)**

G (16'/8')  
2.532 - 9.918

**Base Type (Left / Right)**

N / L  
2.532 - 9.918

**Shoulder Type & Width (Left / Right)**

2 (3'/3')  
2.532 - 12.96

**Through Lanes**

2  
2.532 - 16.636

**Street Name**

1ST ST  
2.532 - 3.188

- Non-divided Highway
- Divided Highway
- Secondary Segment
- Corporation
- Bridge (on route)
- Underpass
- Overpass
- Railroad (at grade)
- Railroad (underpass)
- Railroad (overpass)
- Intersection

Created on: 6/24/2025

transportation.ohio.gov

Prepared by  
The Ohio Department of Transportation  
Office of Technical Services  
Roadway Information

# SCOLSR00009\*\*C

State True Log

79.665

County True Log

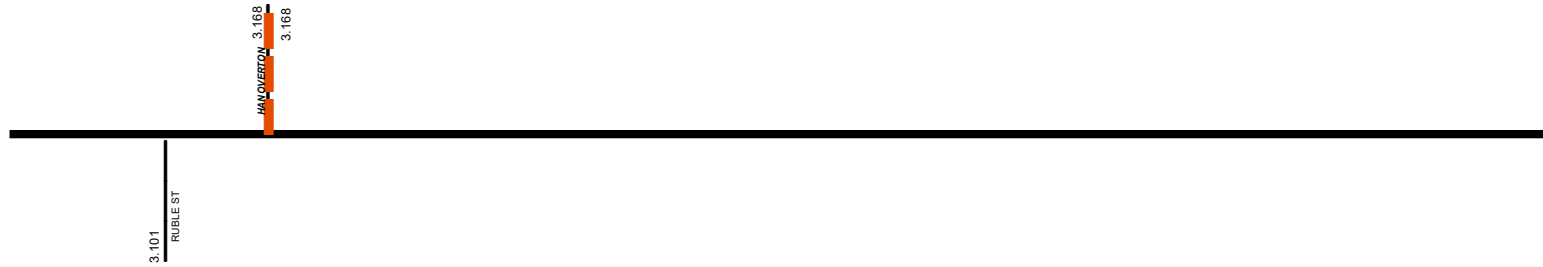

|                                      |                |
|--------------------------------------|----------------|
| Surface Type & Width (Left / Right)  | G (16/8')      |
|                                      | 2.532 - 9.918  |
| Base Type (Left / Right)             | N / L          |
|                                      | 2.532 - 9.918  |
| Shoulder Type & Width (Left / Right) | 2 (3/3')       |
|                                      | 2.532 - 12.96  |
| Through Lanes                        | 2              |
|                                      | 2.532 - 16.636 |
| Street Name                          | 1ST ST         |
|                                      | 2.532 - 3.188  |
|                                      | SR 9           |
|                                      | 3.188 - 7.01   |

|                     |                   |                      |              |
|---------------------|-------------------|----------------------|--------------|
| Non-divided Highway | Bridge (on route) | Railroad (at grade)  | Intersection |
| Divided Highway     | Underpass         | Railroad (underpass) |              |
| Secondary Segment   | Overpass          | Railroad (overpass)  |              |
| Corporation         |                   |                      |              |

Created on: 6/24/2025

transportation.ohio.gov  
 Prepared by  
 The Ohio Department of Transportation  
 Office of Technical Services  
 Roadway Information

# SCOLSR00009\*\*C

State True Log

80.665

County True Log

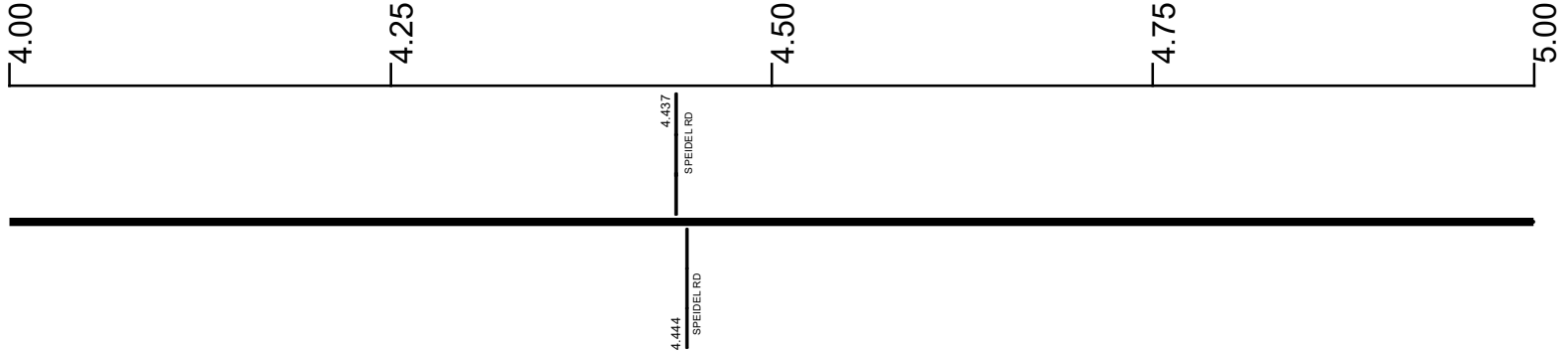

Surface Type & Width (Left / Right)

G (16'/8')  
2.532 - 9.918

Base Type (Left / Right)

N / L  
2.532 - 9.918

Shoulder Type & Width (Left / Right)

2 (3'/3')  
2.532 - 12.96

Through Lanes

2  
2.532 - 16.636

Street Name

SR 9  
3.188 - 7.01

- |                     |                   |                      |              |
|---------------------|-------------------|----------------------|--------------|
| Non-divided Highway | Bridge (on route) | Railroad (at grade)  | Intersection |
| Divided Highway     | Underpass         | Railroad (underpass) |              |
| Secondary Segment   | Overpass          | Railroad (overpass)  |              |
| <b>Corporation</b>  |                   |                      |              |

Created on: 6/24/2025



transportation.ohio.gov  
 Prepared by  
 The Ohio Department of Transportation  
 Office of Technical Services  
 Roadway Information

# SCOLSR00009\*\*C

State True Log

81.665

County True Log



Surface Type & Width (Left / Right)

|  |               |
|--|---------------|
|  | G (16'/8')    |
|  | 2.532 - 9.918 |

Base Type (Left / Right)

|  |               |
|--|---------------|
|  | N / L         |
|  | 2.532 - 9.918 |

Shoulder Type & Width (Left / Right)

|  |               |
|--|---------------|
|  | 2 (3'/3')     |
|  | 2.532 - 12.96 |

Through Lanes

|  |                |
|--|----------------|
|  | 2              |
|  | 2.532 - 16.636 |

Street Name

|  |              |
|--|--------------|
|  | SR 9         |
|  | 3.188 - 7.01 |

- |  |   |   |   |
|--|---|---|---|
| <ul style="list-style-type: none"> <li> Non-divided Highway</li> <li> Divided Highway</li> <li> Secondary Segment</li> <li> Corporation</li> </ul> | <ul style="list-style-type: none"> <li> Bridge (on route)</li> <li> Underpass</li> <li> Overpass</li> </ul> | <ul style="list-style-type: none"> <li> Railroad (at grade)</li> <li> Railroad (underpass)</li> <li> Railroad (overpass)</li> </ul> | <ul style="list-style-type: none"> <li> Intersection</li> </ul> |
|--|---|---|---|

Created on: 6/24/2025

transportation.ohio.gov

Prepared by  
The Ohio Department of Transportation  
Office of Technical Services  
Roadway Information

# SCOLSR00009\*\*C

State True Log

82.665

County True Log



|                                      |                |
|--------------------------------------|----------------|
| Surface Type & Width (Left / Right)  | G (16'8')      |
|                                      | 2.532 - 9.918  |
| Base Type (Left / Right)             | N / L          |
|                                      | 2.532 - 9.918  |
| Shoulder Type & Width (Left / Right) | 2 (3'3')       |
|                                      | 2.532 - 12.96  |
| Through Lanes                        | 2              |
|                                      | 2.532 - 16.636 |
| Street Name                          | SR 9           |
|                                      | 3.188 - 7.01   |

|                     |                   |                      |              |
|---------------------|-------------------|----------------------|--------------|
| Non-divided Highway | Bridge (on route) | Railroad (at grade)  | Intersection |
| Divided Highway     | Underpass         | Railroad (underpass) |              |
| Secondary Segment   | Overpass          | Railroad (overpass)  |              |
| Corporation         |                   |                      |              |

Created on: 6/24/2025

transportation.ohio.gov

Prepared by  
The Ohio Department of Transportation  
Office of Technical Services  
Roadway Information

# SCOLSR00009\*\*C

State True Log

83.665

County True Log

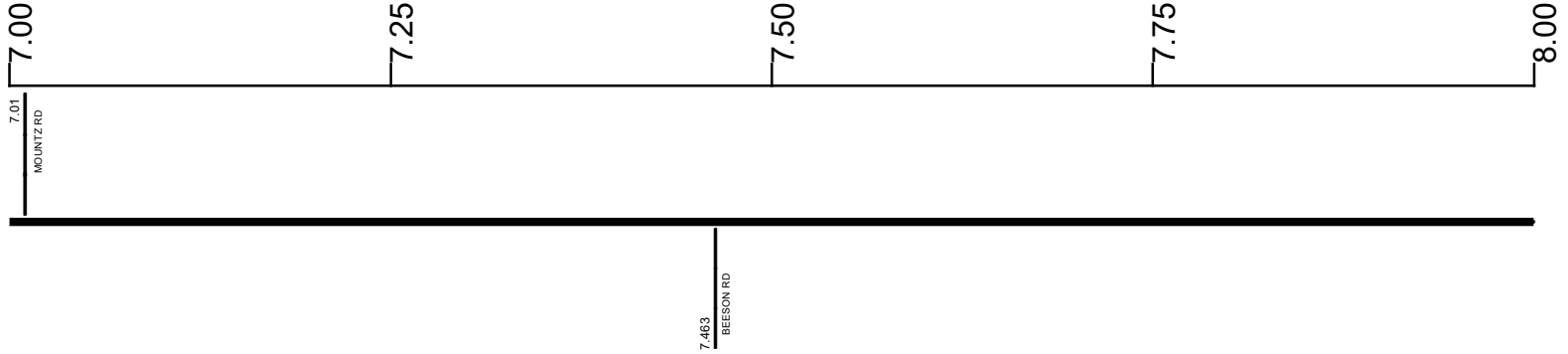

Surface Type & Width (Left / Right)

G (16'/8')  
2.532 - 9.918

Base Type (Left / Right)

N / L  
2.532 - 9.918

Shoulder Type & Width (Left / Right)

2 (3'/3')  
2.532 - 12.96

Through Lanes

2  
2.532 - 16.636

Street Name

|              |               |
|--------------|---------------|
| SR 9         | NEW GARDEN RD |
| 3.188 - 7.01 | 7.01 - 11.867 |

- |  |   |   |   |
|--|---|---|---|
| <ul style="list-style-type: none"> <li> Non-divided Highway</li> <li> Divided Highway</li> <li> Secondary Segment</li> <li> Corporation</li> </ul> | <ul style="list-style-type: none"> <li> Bridge (on route)</li> <li> Underpass</li> <li> Overpass</li> </ul> | <ul style="list-style-type: none"> <li> Railroad (at grade)</li> <li> Railroad (underpass)</li> <li> Railroad (overpass)</li> </ul> | <ul style="list-style-type: none"> <li> Intersection</li> </ul> |
|--|---|---|---|

Created on: 6/24/2025

transportation.ohio.gov

Prepared by  
The Ohio Department of Transportation  
Office of Technical Services  
Roadway Information

# SCOLSR00009\*\*C

State True Log

84.665

County True Log

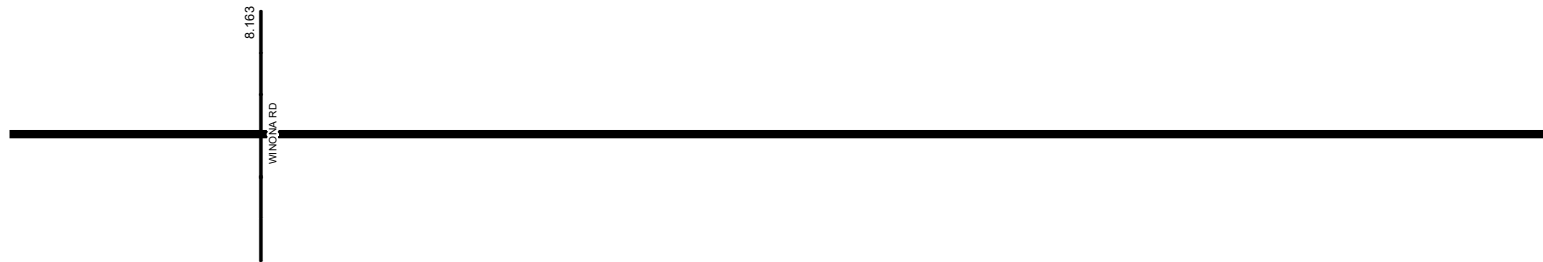

|                                      |                                |
|--------------------------------------|--------------------------------|
| Surface Type & Width (Left / Right)  | G (16/8')<br>2.532 - 9.918     |
| Base Type (Left / Right)             | N / L<br>2.532 - 9.918         |
| Shoulder Type & Width (Left / Right) | 2 (3/3')<br>2.532 - 12.96      |
| Through Lanes                        | 2<br>2.532 - 16.636            |
| Street Name                          | NEW GARDEN RD<br>7.01 - 11.867 |

|                     |                   |                      |              |
|---------------------|-------------------|----------------------|--------------|
| Non-divided Highway | Bridge (on route) | Railroad (at grade)  | Intersection |
| Divided Highway     | Underpass         | Railroad (underpass) |              |
| Secondary Segment   | Overpass          | Railroad (overpass)  |              |
| Corporation         |                   |                      |              |

Created on: 6/24/2025

transportation.ohio.gov

Prepared by  
The Ohio Department of Transportation  
Office of Technical Services  
Roadway Information

# SCOLSR00009\*\*C

State True Log

85.665

County True Log

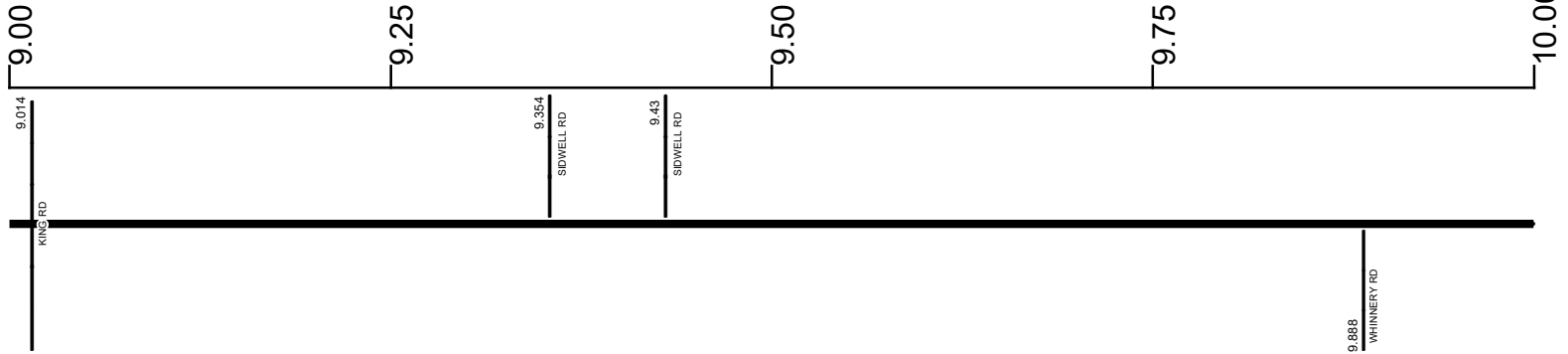

**Surface Type & Width (Left / Right)**

|  |               |               |
|--|---------------|---------------|
|  | G (16'/8')    | G (11'/13')   |
|  | 2.532 - 9.918 | 9.918 - 12.93 |

**Base Type (Left / Right)**

|  |               |               |
|--|---------------|---------------|
|  | N / L         | T / K         |
|  | 2.532 - 9.918 | 9.918 - 12.93 |

**Shoulder Type & Width (Left / Right)**

|  |               |
|--|---------------|
|  | 2 (3'/3')     |
|  | 2.532 - 12.96 |

**Through Lanes**

|  |                |
|--|----------------|
|  | 2              |
|  | 2.532 - 16.636 |

**Street Name**

|  |               |
|--|---------------|
|  | NEW GARDEN RD |
|  | 7.01 - 11.867 |

- |  |   |   |   |
|--|---|---|---|
| <ul style="list-style-type: none"> <li> Non-divided Highway</li> <li> Divided Highway</li> <li> Secondary Segment</li> <li> Corporation</li> </ul> | <ul style="list-style-type: none"> <li> Bridge (on route)</li> <li> Underpass</li> <li> Overpass</li> </ul> | <ul style="list-style-type: none"> <li> Railroad (at grade)</li> <li> Railroad (underpass)</li> <li> Railroad (overpass)</li> </ul> | <ul style="list-style-type: none"> <li> Intersection</li> </ul> |
|--|---|---|---|

Created on: 6/24/2025

transportation.ohio.gov

Prepared by  
The Ohio Department of Transportation  
Office of Technical Services  
Roadway Information

# SCOLSR00009\*\*C

State True Log

86.665

County True Log

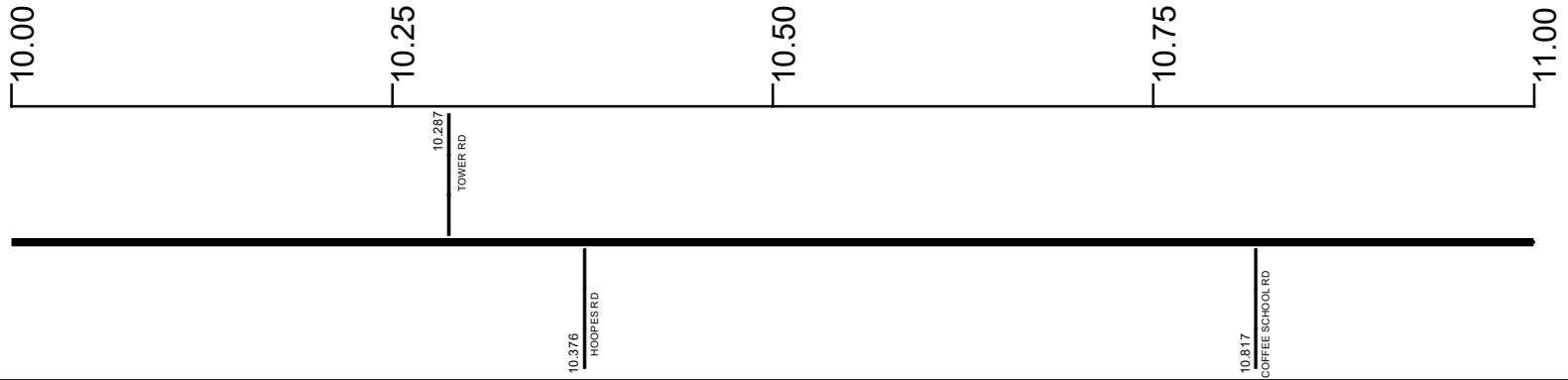

Surface Type & Width (Left / Right)

G (11'/13')  
9.918 - 12.93

Base Type (Left / Right)

T / K  
9.918 - 12.93

Shoulder Type & Width (Left / Right)

2 (3'/3')  
2.532 - 12.96

Through Lanes

2  
2.532 - 16.636

Street Name

NEW GARDEN RD  
7.01 - 11.867

- |                     |                   |                      |              |
|---------------------|-------------------|----------------------|--------------|
| Non-divided Highway | Bridge (on route) | Railroad (at grade)  | Intersection |
| Divided Highway     | Underpass         | Railroad (underpass) |              |
| Secondary Segment   | Overpass          | Railroad (overpass)  |              |
| Corporation         |                   |                      |              |

Created on: 6/24/2025



transportation.ohio.gov

Prepared by  
The Ohio Department of Transportation  
Office of Technical Services  
Roadway Information

# SCOLSR00009\*\*C

State True Log

87.665

County True Log

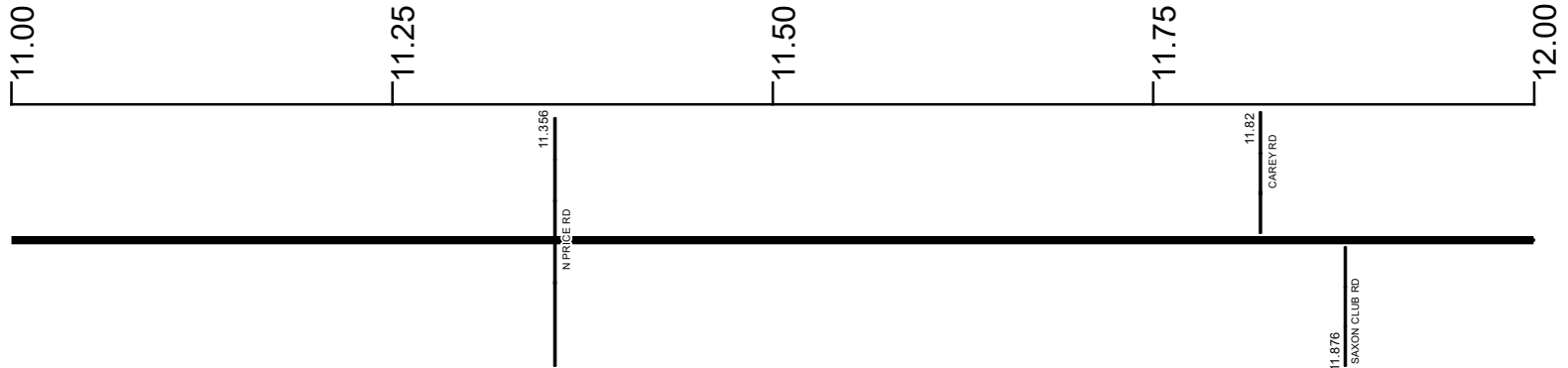

Surface Type & Width (Left / Right)

|  |               |
|--|---------------|
|  | G (11'13')    |
|  | 9.918 - 12.93 |

Base Type (Left / Right)

|  |               |
|--|---------------|
|  | T / K         |
|  | 9.918 - 12.93 |

Shoulder Type & Width (Left / Right)











|  |               |
|--|---------------|
|  | 2 (3'3')      |
|  | 2.532 - 12.96 |

Through Lanes

|  |                |
|--|----------------|
|  | 2              |
|  | 2.532 - 16.636 |

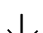
Street Name

|  |               |                 |
|--|---------------|-----------------|
|  | NEW GARDEN RD | NEWGARDEN AVE   |
|  | 7.01 - 11.867 | 11.867 - 13.946 |

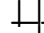
-  Non-divided Highway
-  Divided Highway
-  Secondary Segment
-  Corporation
-  Bridge (on route)
-  Underpass
-  Overpass
-  Railroad (at grade)
-  Railroad (underpass)
-  Railroad (overpass)
-  Intersection

Created on: 6/24/2025



transportation.ohio.gov  
 Prepared by  
 The Ohio Department of Transportation  
 Office of Technical Services  
 Roadway Information

# SCOLSR00009\*\*C

State True Log  
County True Log

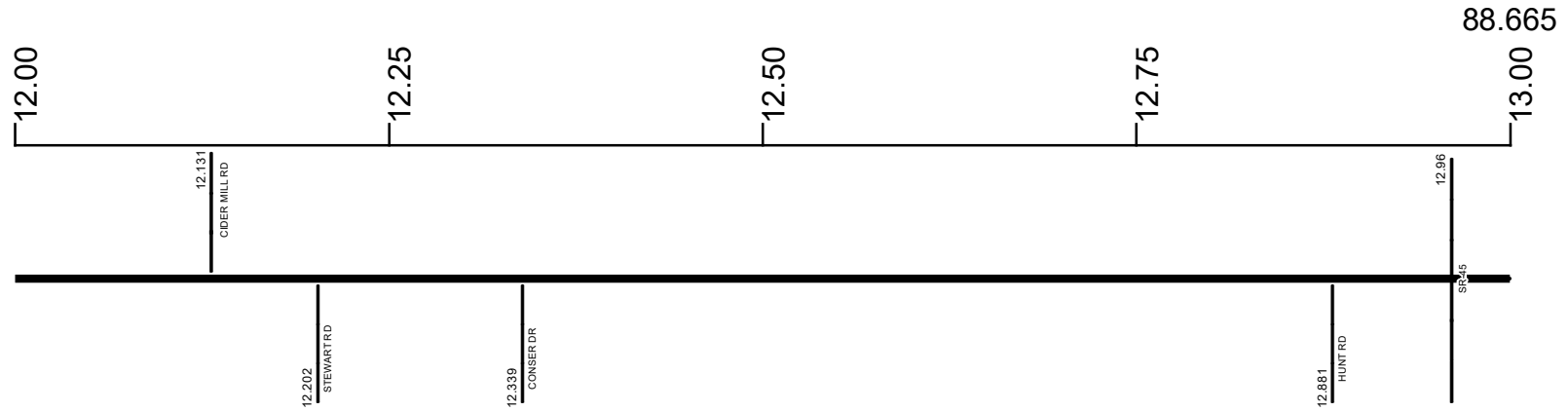

|                                      |                 |                |
|--------------------------------------|-----------------|----------------|
| Surface Type & Width (Left / Right)  | G (11'/13')     | G 24'          |
|                                      | 9.918 - 12.93   | 12.93 - 13.078 |
| Base Type (Left / Right)             | T / K           | L              |
|                                      | 9.918 - 12.93   | 12.93 - 13.078 |
| Shoulder Type & Width (Left / Right) | 2 (3'/3')       | 2 (2'/2')      |
|                                      | 2.532 - 12.96   | 12.96 - 13.078 |
| Through Lanes                        | 2               |                |
|                                      | 2.532 - 16.636  |                |
| Street Name                          | NEWGARDEN AVE   |                |
|                                      | 11.867 - 13.946 |                |

- Non-divided Highway
- Divided Highway
- Secondary Segment
- Corporation
- Bridge (on route)
- Underpass
- Overpass
- Railroad (at grade)
- Railroad (underpass)
- Railroad (overpass)
- Intersection

Created on: 6/24/2025



transportation.ohio.gov  
Prepared by  
The Ohio Department of Transportation  
Office of Technical Services  
Roadway Information

# SCOLSR00009\*\*C

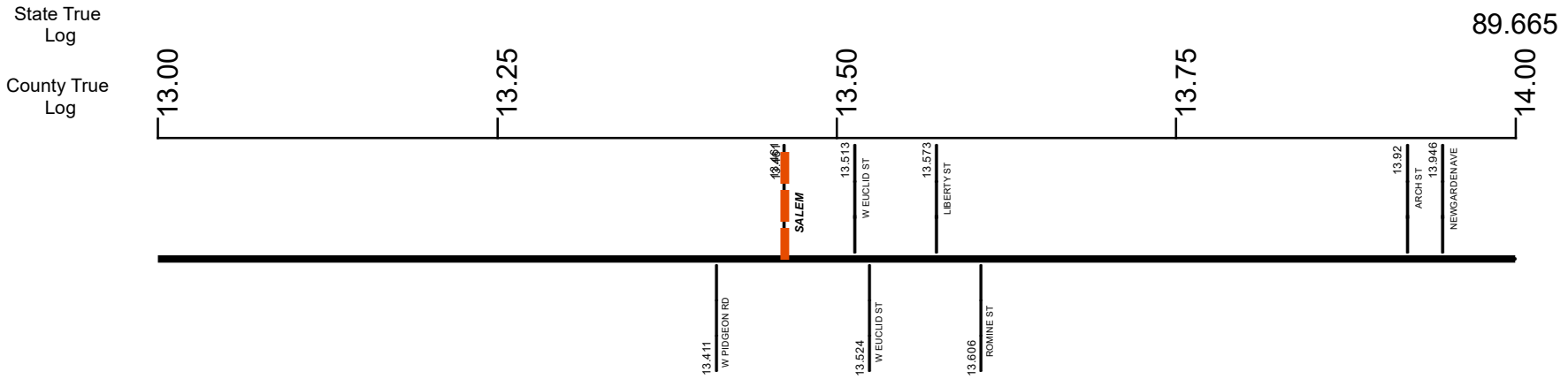

### Surface Type & Width (Left / Right)

|                |                 |                 |                 |
|----------------|-----------------|-----------------|-----------------|
| G 24'          | G (11'/13')     | G 30'           | G 38'           |
| 12.93 - 13.078 | 13.078 - 13.446 | 13.446 - 13.956 | 13.956 - 14.251 |

### Base Type (Left / Right)

|                |                 |                 |
|----------------|-----------------|-----------------|
| L              | T / K           | R               |
| 12.93 - 13.078 | 13.078 - 13.446 | 13.446 - 14.613 |

### Shoulder Type & Width (Left / Right)

|                |                 |                 |
|----------------|-----------------|-----------------|
| 2 (2'/2')      | 2 (3'/3')       | 1 (0'/0')       |
| 12.96 - 13.078 | 13.078 - 13.446 | 13.446 - 15.744 |

### Resurface Year

|               |
|---------------|
| 2023          |
| 13.06 - 13.55 |

### Through Lanes

|                |
|----------------|
| 2              |
| 2.532 - 16.636 |

### Street Name

|                 |                 |
|-----------------|-----------------|
| NEWGARDEN AVE   | MULLINS ST      |
| 11.867 - 13.946 | 13.946 - 14.228 |

- Non-divided Highway
- Divided Highway
- Secondary Segment
- Corporation
- Bridge (on route)
- Underpass
- Overpass
- Railroad (at grade)
- Railroad (underpass)
- Railroad (overpass)
- Intersection

Created on: 6/24/2025

transportation.ohio.gov

Prepared by  
The Ohio Department of Transportation  
Office of Technical Services  
Roadway Information

# SCOLSR00009\*\*C

State True Log

90.665

County True Log

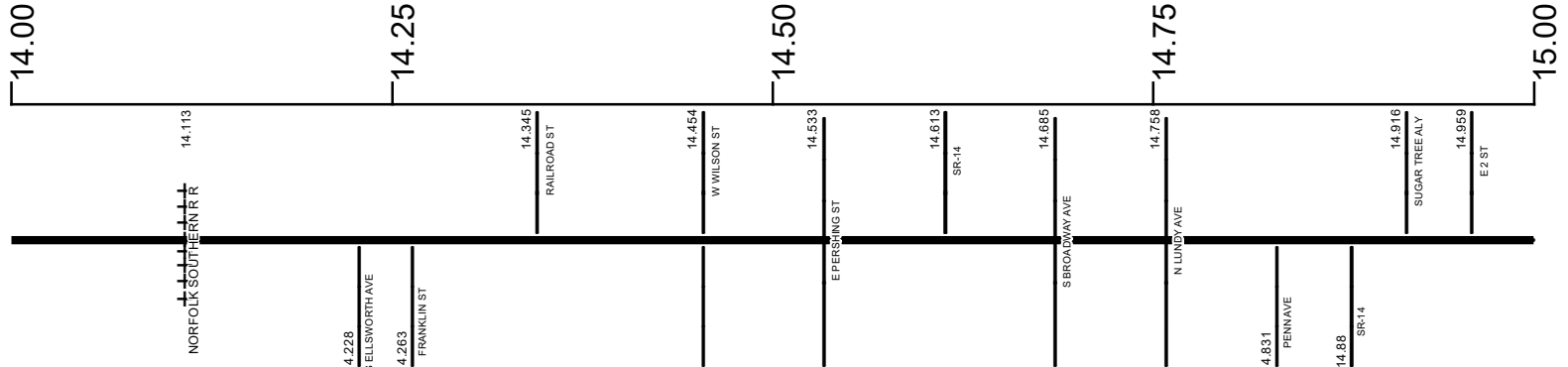

Surface Type & Width (Left / Right)

|                 |                 |                |                |       |
|-----------------|-----------------|----------------|----------------|-------|
| G 38'           | G 42'           | G 40'          | G 36'          | G 32' |
| 13.956 - 14.251 | 14.251 - 14.613 | 14.613 - 14.88 | 14.88 - 14.959 |       |

Base Type (Left / Right)

|                 |                |                |
|-----------------|----------------|----------------|
| R               | P              | T              |
| 13.446 - 14.613 | 14.613 - 14.88 | 14.88 - 15.554 |

Shoulder Type & Width (Left / Right)

|                 |
|-----------------|
| 1 (0'/0')       |
| 13.446 - 15.744 |

Through Lanes

|                |
|----------------|
| 2              |
| 2.532 - 16.636 |

Street Name

|                 |                 |                |                |
|-----------------|-----------------|----------------|----------------|
| MULLINS ST      | S ELLSWORTH AVE | E STATE ST     | N LINCOLN AVE  |
| 13.946 - 14.228 | 14.228 - 14.613 | 14.613 - 14.88 | 14.88 - 16.636 |

- Non-divided Highway
- Divided Highway
- Secondary Segment
- Corporation
- Bridge (on route)
- Underpass
- Overpass
- Railroad (at grade)
- Railroad (underpass)
- Railroad (overpass)
- Intersection

Created on: 6/24/2025



transportation.ohio.gov

Prepared by  
The Ohio Department of Transportation  
Office of Technical Services  
Roadway Information

# SCOLSR00009\*\*C

State True Log

91.665

County True Log

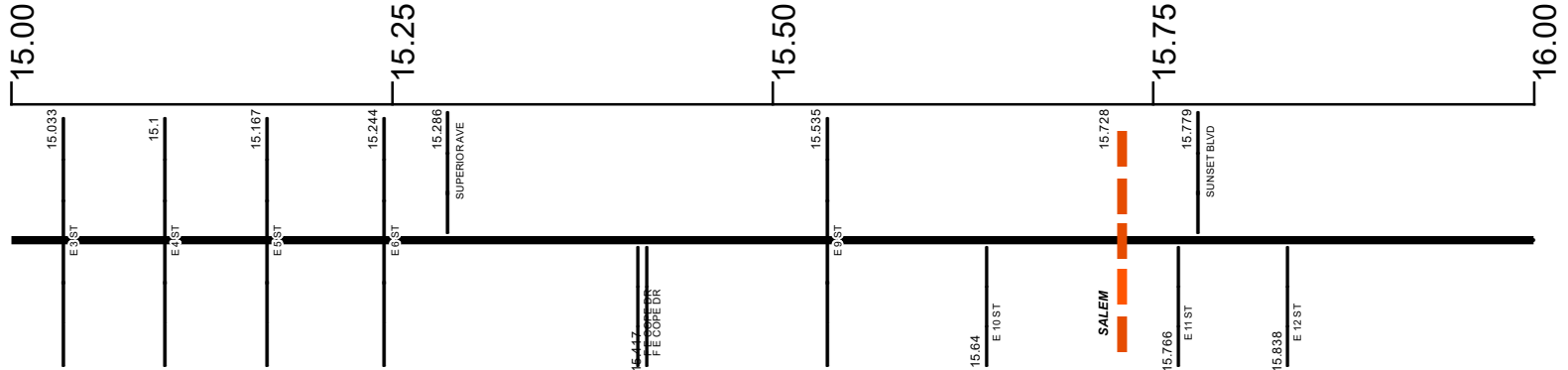

**Surface Type & Width (Left / Right)**

|                 |                 |                 |
|-----------------|-----------------|-----------------|
| G 32'           | G (16'8')       | G (14'10')      |
| 14.959 - 15.554 | 15.554 - 15.744 | 15.744 - 16.636 |

**Base Type (Left / Right)**

|                |                 |                 |
|----------------|-----------------|-----------------|
| T              | T / L           | R / L           |
| 14.88 - 15.554 | 15.554 - 15.744 | 15.744 - 16.636 |

**Shoulder Type & Width (Left / Right)**

|                 |                 |
|-----------------|-----------------|
| 1 (0'0')        | 5 (2'1/2')      |
| 13.446 - 15.744 | 15.744 - 16.636 |

**Through Lanes**

|                |
|----------------|
| 2              |
| 2.532 - 16.636 |

**Street Name**

|                |
|----------------|
| N LINCOLN AVE  |
| 14.88 - 16.636 |

- Non-divided Highway
- Divided Highway
- Secondary Segment
- Corporation
- Bridge (on route)
- Underpass
- Overpass
- Railroad (at grade)
- Railroad (underpass)
- Railroad (overpass)
- Intersection

Created on: 6/24/2025

transportation.ohio.gov

Prepared by  
The Ohio Department of Transportation  
Office of Technical Services  
Roadway Information

# SCOLSR00009\*\*C

92.301

State True Log

County True Log

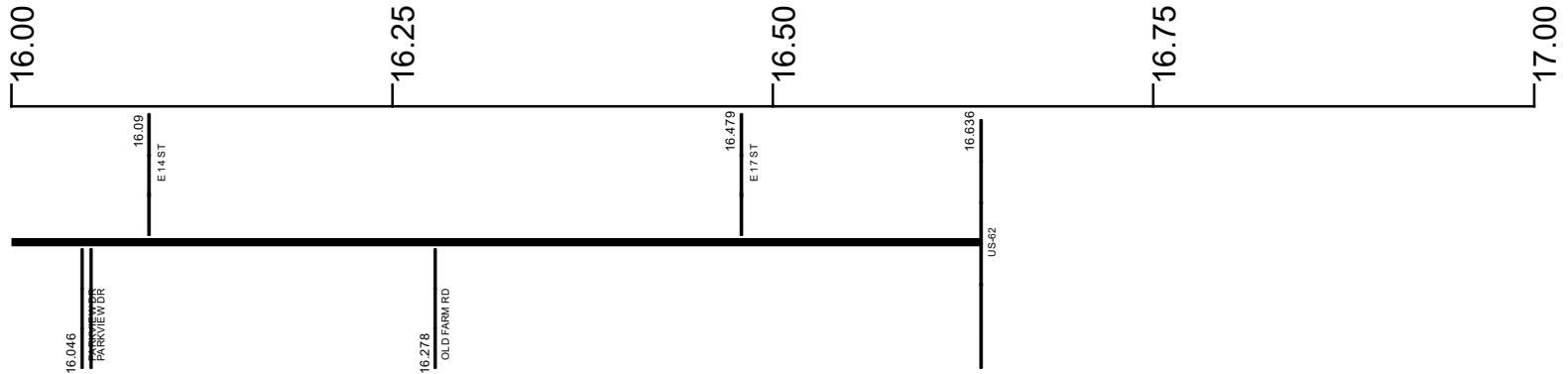

Surface Type & Width (Left / Right)

G (14'/10')  
15.744 - 16.636

Base Type (Left / Right)

R / L  
15.744 - 16.636

Shoulder Type & Width (Left / Right)

5 (2'/2')  
15.744 - 16.636

Through Lanes

2  
2.532 - 16.636

Street Name

N LINCOLN AVE  
14.88 - 16.636

- Non-divided Highway
- Divided Highway
- Secondary Segment
- Corporation
- Bridge (on route)
- Underpass
- Overpass
- Railroad (at grade)
- Railroad (underpass)
- Railroad (overpass)
- Intersection

Created on: 6/24/2025

transportation.ohio.gov  
Prepared by  
The Ohio Department of Transportation  
Office of Technical Services  
Roadway Information

## Historical Project List for SCOLSR00009\*\*C

| Begin Measure | End Measure | Project ID Number | Construction Completion Date | Treatment Category     | Treatment Type        |
|---------------|-------------|-------------------|------------------------------|------------------------|-----------------------|
| 0.000         | 1.009       | 102457            | 12-2021                      | Minor Rehabilitation   | 60-AC Overlay w/Rpr   |
| 0.000         | 1.009       | 78199             | 9-2006                       | Minor Rehabilitation   | 60-AC Overlay w/Rpr   |
| 2.532         | 12.027      | 102401            | 11-2019                      | Preventive Maintenance | 33-Thinlay Asphalt    |
| 2.532         | 13.449      | 81586             | 8-2008                       | Minor Rehabilitation   | 60-AC Overlay w/Rpr   |
| 12.027        | 12.192      | 102401            | 11-2019                      | Preventive Maintenance | 33-Thinlay Asphalt    |
| 12.192        | 12.960      | 102401            | 11-2019                      | Preventive Maintenance | 33-Thinlay Asphalt    |
| 12.960        | 13.449      | 107545            | 10-2023                      | Minor Rehabilitation   | 60-AC Overlay w/Rpr   |
| 13.449        | 13.967      | 90893             | 8-2014                       | Minor Rehabilitation   | 50-AC Overlay w/o Rpr |
| 14.251        | 14.613      | 90893             | 8-2014                       | Minor Rehabilitation   | 50-AC Overlay w/o Rpr |
| 15.033        | 15.535      | 90893             | 8-2014                       | Minor Rehabilitation   | 50-AC Overlay w/o Rpr |
| 15.735        | 16.636      | 25545             | 7-2011                       | Minor Rehabilitation   | 60-AC Overlay w/Rpr   |
| 15.745        | 16.636      | 107545            | 10-2023                      | Minor Rehabilitation   | 60-AC Overlay w/Rpr   |

# Roadway Codes

## Access Control Journalized

- F - Full Access Control
- L - Limited Access Control
- N - No Access Control

## Access Control Operational

- 1 - Full Access Control
- 2 - Partial Access Control
- 3 - No Access Control

## Base Type

- F - Crack and Seat
- H - Rubblize and Roll
- I - Aggregate Base 304 or Traffic Compacted
- K - Water Bound Macadam
- L - Bituminous Concrete Mix or Penetration Macadam
- N - Plain Concrete
- P - Reinforced Concrete
- R - Brick (Flexible)
- T - Brick (Rigid)

## Direction of Travel

- B - Both (Two-way)
- F - One-way Cardinal
- T - One-way Non-cardinal

## Facility Type

- 1 - One-way Roadway
- 2 - Two-way Roadway
- 4 - Ramp
- 5 - Non-mainline
- 6 - Non-inventory Direction
- 7 - Planned / Unbuilt

## Historical Federal Aid Indicator

- N - Not a FAP Route
- Y - FAP Route

## Functional Classification

- 01 - Interstate
- 02 - Principal Arterial (Freeways)
- 03 - Principal Arterial (Other)
- 04 - Minor Arterial
- 05 - Major Collector
- 06 - Minor Collector
- 07 - Local

## Leave / Reenter Indicator

- Y - Route leaves/reenters at this point
- N - Route does not leave/reenter at this point

## Median Type

- 1 - None
- 2 - Unprotected
- 3 - Curbed
- 4 - Positive Barrier (Unspecified)
- 5 - Positive Barrier (Flexible)
- 6 - Positive Barrier (Semi-rigid)
- 7 - Positive Barrier (Rigid)

## NHS

- N - National Highway System
- H - Congressional Corridor
- 2 - Major Airport
- 3 - Major Port Facility
- 4 - Major Amtrak Station
- 5 - Major Rail / Truck Terminal
- 6 - Major Intercity Bus Terminal
- 7 - Major Public Transit / Multi-modal Passenger Terminal
- 8 - Major Pipeline Terminal
- 9 - Major Ferry Terminal

## Priority System

- G - General
- P - Priority System
- U - Urban

## Scenic Byway Code

- A - All American Road
- N - National Scenic Byway
- S - State Scenic Byway

## Shoulder Type

- 1 - None
- 2 - Surfaced shoulder exists (bituminous concrete {AC})
- 3 - Surfaced shoulder exists (Portland Cement Concrete {PCC})
- 4 - Stabilized shoulder exists (gravel or other granular material)
- 5 - Combination shoulder exists (two or more surface types)
- 6 - Earth shoulder exists
- 7 - Barrier curb exists; no shoulder in front of curb

## Surface Type

- A - Combination
- B - Brick
- C - Continuous Reinforced Concrete
- D - Reinforced Concrete
- E - Plain Concrete
- G - Bituminous Concrete
- I - Chipseal on Granular
- K - Open Graded Bituminous
- L - Chipseal or Micro
- M - Gravel
- U - Unimproved
- X - Right of Way Only