

SCOLSR00045**C

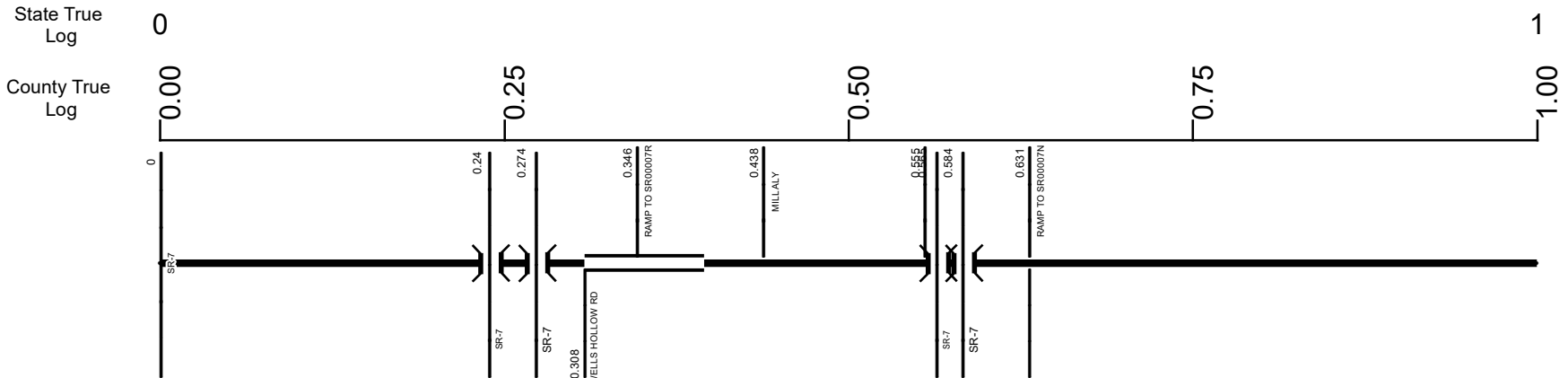

Surface Type & Width (Left / Right)

0 - 0.308	G 32'	0.308 - 0.366	G 26'	0.366 - 9.095
-----------	-------	---------------	-------	---------------

Base Type (Left / Right)

0 - 0.347	P	0.347 - 0.366	T	0.366 - 9.095	N
-----------	---	---------------	---	---------------	---

Shoulder Type & Width (Left / Right)

0 - 0.308	2 (4'4')	0.308 - 9.095	1 (0'0')
-----------	----------	---------------	----------

Median Type and Width

0.308 - 0.366	3 (6')	0.366 - 0.395	6 (12')
---------------	--------	---------------	---------

Through Lanes

0 - 0.308	1	0.308 - 9.095	2
-----------	---	---------------	---

Street Name

0 - 0.395	SR 45	0.395 - 0.555	WELLS AVE	0.555 - 1.06	LISBON RD
-----------	-------	---------------	-----------	--------------	-----------

- Non-divided Highway
- Divided Highway
- Secondary Segment
- Corporation
- Bridge (on route)
- Underpass
- Overpass
- Railroad (at grade)
- Railroad (underpass)
- Railroad (overpass)
- Intersection



transportation.ohio.gov
 Prepared by
 The Ohio Department of Transportation
 Office of Technical Services
 Roadway Information

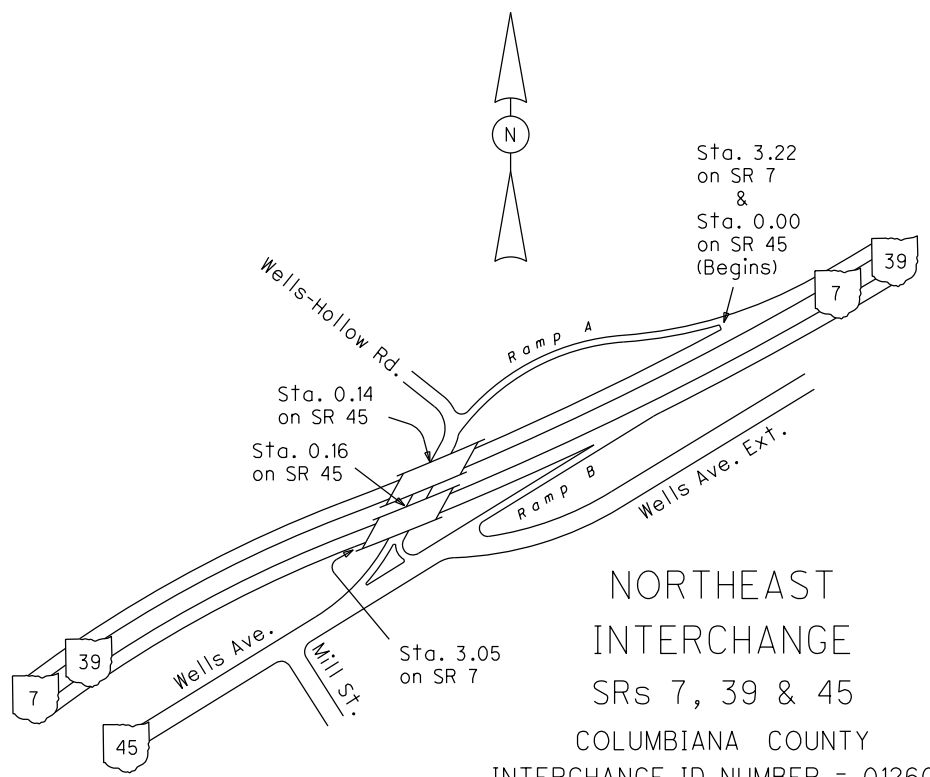

NORTHEAST
 INTERCHANGE
 SRs 7, 39 & 45
 COLUMBIANA COUNTY
 INTERCHANGE ID NUMBER = 012600

SCOLSR00045**C

State True Log

County True Log

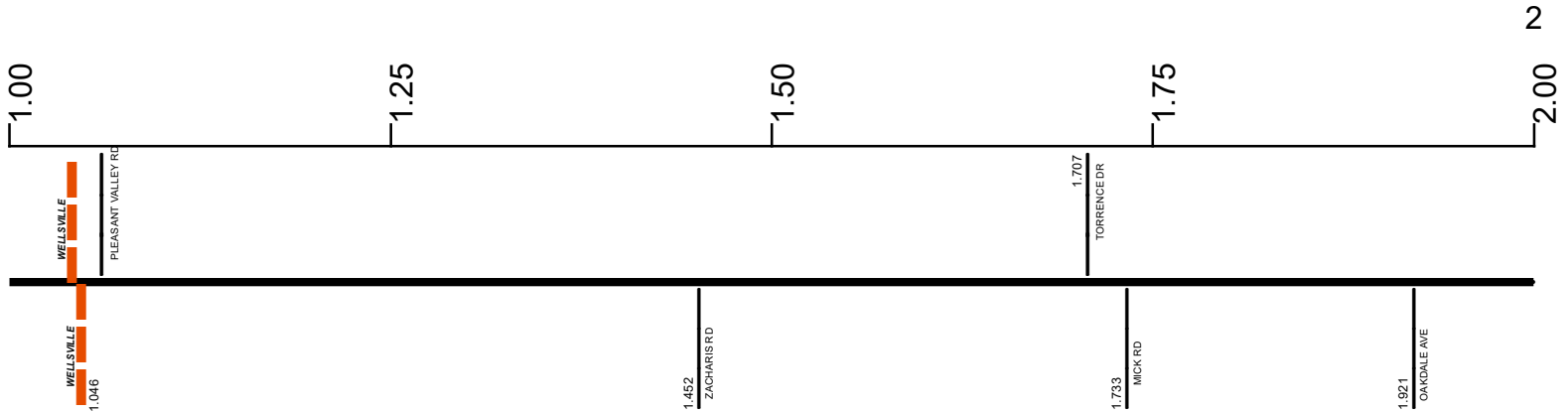

Surface Type & Width (Left / Right)	G 26' 0.366 - 9.095
Base Type (Left / Right)	N 0.366 - 9.095
Shoulder Type & Width (Left / Right)	1 (0'/0') 0.308 - 9.095
Through Lanes	2 0.308 - 9.095
Street Name	LISBON RD HILLCREST RD 0.555 - 1.06 1.06 - 2.892

<ul style="list-style-type: none"> Non-divided Highway Divided Highway Secondary Segment Corporation 	<ul style="list-style-type: none"> Bridge (on route) Underpass Overpass 	<ul style="list-style-type: none"> Railroad (at grade) Railroad (underpass) Railroad (overpass) 	<ul style="list-style-type: none"> Intersection
----------------------------------------------------------------------------------------------------------------------------------------------------	-------------------------------------------------------------------------------------------------------------	-------------------------------------------------------------------------------------------------------------------------------------	-----------------------------------------------------------------

Created on: 6/24/2025

transportation.ohio.gov

Prepared by
The Ohio Department of Transportation
Office of Technical Services
Roadway Information

SCOLSR00045**C

State True Log

County True Log

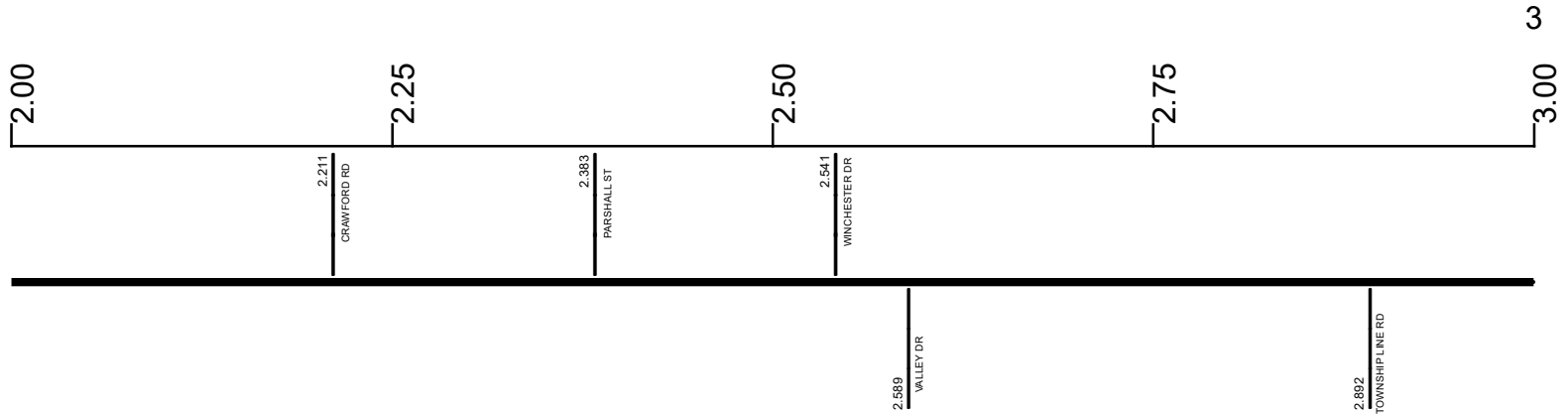

Surface Type & Width (Left / Right)

G 26'
0.366 - 9.095

Base Type (Left / Right)

N
0.366 - 9.095

Shoulder Type & Width (Left / Right)

1 (0/0)
0.308 - 9.095

Through Lanes

2
0.308 - 9.095

Street Name

HILLCREST RD 1.06 - 2.892	SR 45 2.892 - 9.095
------------------------------	------------------------

- Non-divided Highway
- Divided Highway
- Secondary Segment
- Corporation
- Bridge (on route)
- Underpass
- Overpass
- Railroad (at grade)
- Railroad (underpass)
- Railroad (overpass)
- Intersection

Created on: 6/24/2025



transportation.ohio.gov
Prepared by
The Ohio Department of Transportation
Office of Technical Services
Roadway Information

SCOLSR00045**C

State True Log

4

County True Log

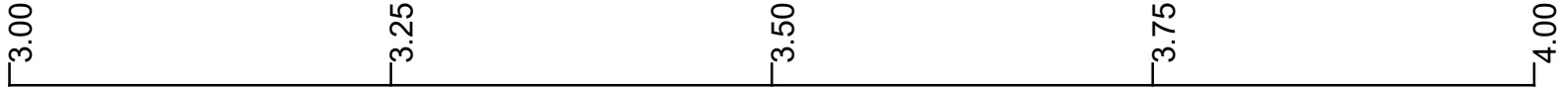

Surface Type & Width (Left / Right)	G 26' 0.366 - 9.095
Base Type (Left / Right)	N 0.366 - 9.095
Shoulder Type & Width (Left / Right)	1 (0'/0') 0.308 - 9.095
Through Lanes	2 0.308 - 9.095
Street Name	SR 45 2.892 - 9.095

Non-divided Highway	Bridge (on route)	Railroad (at grade)	Intersection
Divided Highway	Underpass	Railroad (underpass)	
Secondary Segment	Overpass	Railroad (overpass)	
Corporation			

Created on: 6/24/2025

transportation.ohio.gov
Prepared by
The Ohio Department of Transportation
Office of Technical Services
Roadway Information

SCOLSR00045**C

State True Log

County True Log

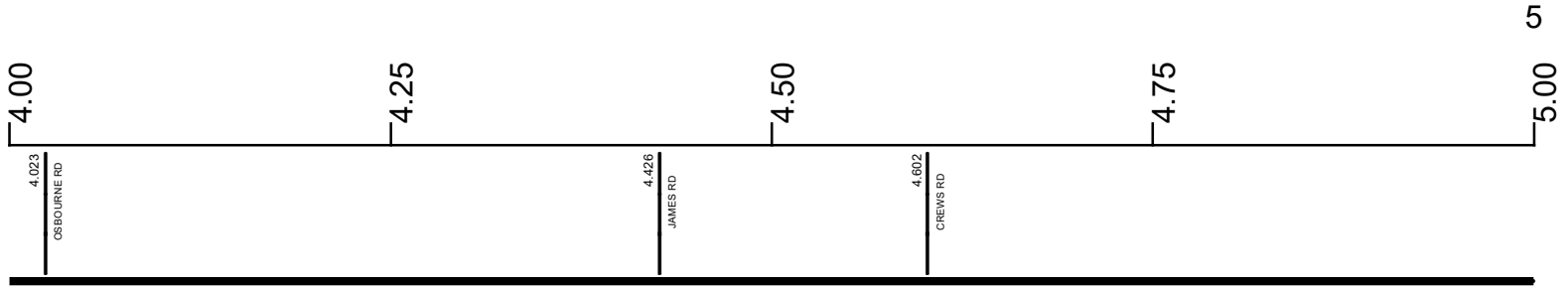

Surface Type & Width (Left / Right)

G 26'
0.366 - 9.095

Base Type (Left / Right)

N
0.366 - 9.095

Shoulder Type & Width (Left / Right)

1 (0'/0')
0.308 - 9.095

Through Lanes

2
0.308 - 9.095

Street Name

SR 45
2.892 - 9.095

- Non-divided Highway
- Divided Highway
- Secondary Segment
- Corporation
- Bridge (on route)
- Underpass
- Overpass
- Railroad (at grade)
- Railroad (underpass)
- Railroad (overpass)
- Intersection

Created on: 6/24/2025

transportation.ohio.gov
Prepared by
The Ohio Department of Transportation
Office of Technical Services
Roadway Information

SCOLSR00045**C

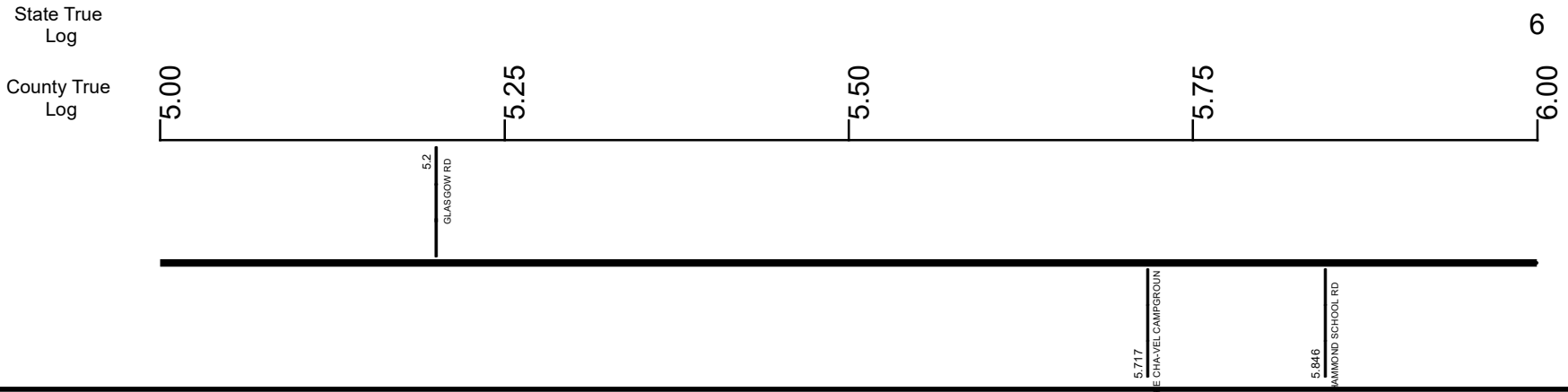

Surface Type & Width (Left / Right)	G 26' 0.366 - 9.095
Base Type (Left / Right)	N 0.366 - 9.095
Shoulder Type & Width (Left / Right)	1 (0'/0') 0.308 - 9.095
Through Lanes	2 0.308 - 9.095
Street Name	SR 45 2.892 - 9.095

<ul style="list-style-type: none"> Non-divided Highway Divided Highway Secondary Segment Corporation 	<ul style="list-style-type: none"> Bridge (on route) Underpass Overpass 	<ul style="list-style-type: none"> Railroad (at grade) Railroad (underpass) Railroad (overpass) 	<ul style="list-style-type: none"> Intersection
----------------------------------------------------------------------------------------------------------------------------------------------------	-------------------------------------------------------------------------------------------------------------	-------------------------------------------------------------------------------------------------------------------------------------	-----------------------------------------------------------------

Created on: 6/24/2025

transportation.ohio.gov

Prepared by

The Ohio Department of Transportation

Office of Technical Services

Roadway Information

SCOLSR00045**C

State True Log

7

County True Log

6.00

6.25

6.50

6.75

7.00



Surface Type & Width (Left / Right)

G 26'
0.366 - 9.095

Base Type (Left / Right)

N
0.366 - 9.095

Shoulder Type & Width (Left / Right)









1 (0'/0')
0.308 - 9.095

Through Lanes

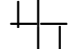
2
0.308 - 9.095

Street Name

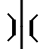
SR 45
2.892 - 9.095

- | | | | |
|---------------------------------------------------------------------------------------------------------|-------------------------------------------------------------------------------------------------------|----------------------------------------------------------------------------------------------------------|----------------------------------------------------------------------------------------------------|
|  Non-divided Highway |  Bridge (on route) |  Railroad (at grade) |  Intersection |
|  Divided Highway |  Underpass |  Railroad (underpass) | |
|  Secondary Segment |  Overpass |  Railroad (overpass) | |
|  Corporation | | | |

Created on: 6/24/2025



transportation.ohio.gov
 Prepared by
 The Ohio Department of Transportation
 Office of Technical Services
 Roadway Information

SCOLSR00045**C

State True
Log

8

County True
Log

7.00

7.25

7.50

7.75

8.00



Surface Type & Width (Left / Right)

G 26'
0.366 - 9.095

Base Type (Left / Right)

N
0.366 - 9.095

Shoulder Type & Width (Left / Right)

1 (0'/0')
0.308 - 9.095

Through Lanes

2
0.308 - 9.095

Street Name

SR 45
2.892 - 9.095

- | | | | |
|---------------------|-------------------|----------------------|--------------|
| Non-divided Highway | Bridge (on route) | Railroad (at grade) | Intersection |
| Divided Highway | Underpass | Railroad (underpass) | |
| Secondary Segment | Overpass | Railroad (overpass) | |
| Corporation | | | |

Created on: 6/24/2025



transportation.ohio.gov
 Prepared by
 The Ohio Department of Transportation
 Office of Technical Services
 Roadway Information

SCOLSR00045**C

State True Log

County True Log

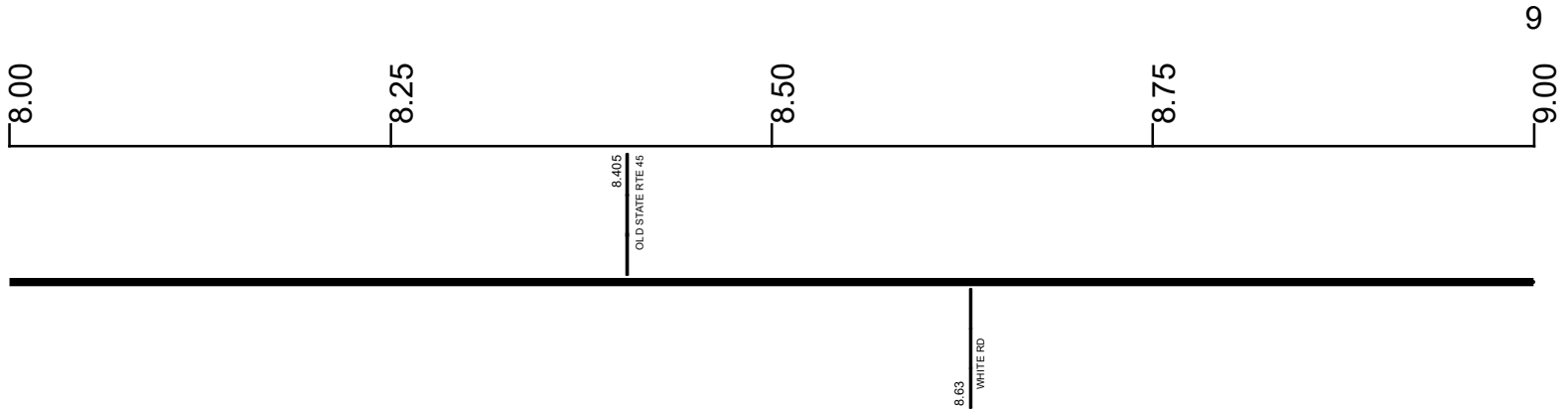

Surface Type & Width (Left / Right)

G 26'
0.366 - 9.095

Base Type (Left / Right)

N
0.366 - 9.095

Shoulder Type & Width (Left / Right)

1 (0/0)
0.308 - 9.095

Through Lanes

2
0.308 - 9.095

Street Name

SR 45
2.892 - 9.095

- Non-divided Highway
 Bridge (on route)
 Railroad (at grade)
 Intersection
- Divided Highway
 Underpass
 Railroad (underpass)
- Secondary Segment
 Overpass
 Railroad (overpass)
- Corporation**

Created on: 6/24/2025



transportation.ohio.gov

Prepared by
The Ohio Department of Transportation
Office of Technical Services
Roadway Information

SCOLSR00045**C

State True Log

County True Log

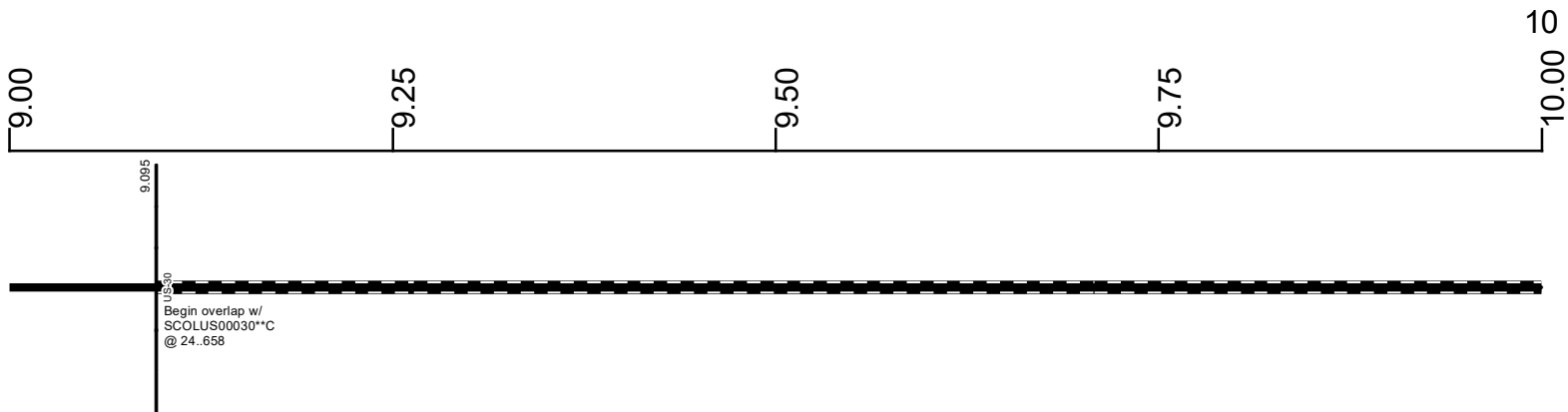

Surface Type & Width (Left / Right)

G 26'
0.366 - 9.095

Base Type (Left / Right)

N
0.366 - 9.095

Shoulder Type & Width (Left / Right)

1 (0'/0')
0.308 - 9.095

Through Lanes

2
0.308 - 9.095

Street Name

SR 45
2.892 - 9.095

- Non-divided Highway
- Divided Highway
- Secondary Segment
- Corporation
- Bridge (on route)
- Underpass
- Overpass
- Railroad (at grade)
- Railroad (underpass)
- Railroad (overpass)
- Intersection

Created on: 6/24/2025



transportation.ohio.gov
Prepared by
The Ohio Department of Transportation
Office of Technical Services
Roadway Information

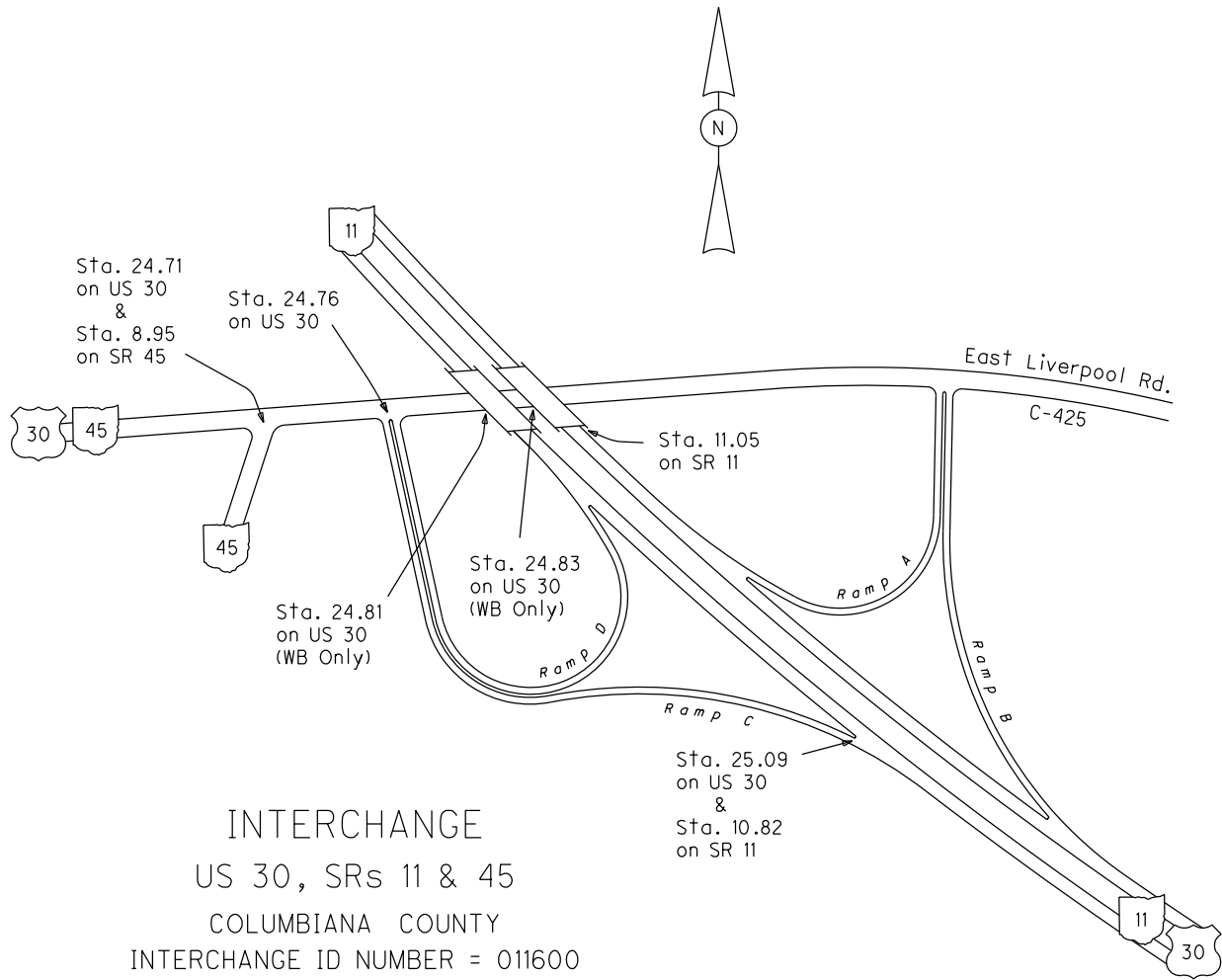

INTERCHANGE
 US 30, SRs 11 & 45
 COLUMBIANA COUNTY
 INTERCHANGE ID NUMBER = 011600

US 30 SHEET 5 OF 8
 US 30 SHEET 6 OF 8
 SR 11 SHEET 3 OF 6

REVISED Jan 2004

SCOLSR00045**C

State True
Log

11

County True
Log

10.00

10.25

10.50

10.75

11.00



- | | | | |
|---------------------|-------------------|----------------------|--------------|
| Non-divided Highway | Bridge (on route) | Railroad (at grade) | Intersection |
| Divided Highway | Underpass | Railroad (underpass) | |
| Secondary Segment | Overpass | Railroad (overpass) | |
| Corporation | | | |

Created on: 6/24/2025



transportation.ohio.gov
Prepared by
The Ohio Department of Transportation
Office of Technical Services
Roadway Information

SCOLSR00045**C

State True Log

County True Log



- | | | | |
|---------------------|-------------------|----------------------|--------------|
| Non-divided Highway | Bridge (on route) | Railroad (at grade) | Intersection |
| Divided Highway | Underpass | Railroad (underpass) | |
| Secondary Segment | Overpass | Railroad (overpass) | |
| Corporation | | | |

Created on: 6/24/2025

transportation.ohio.gov
 Prepared by
 The Ohio Department of Transportation
 Office of Technical Services
 Roadway Information

SCOLSR00045**C

State True
Log

County True
Log

12.00

12.25

12.50

12.75

13
13.00



Non-divided Highway	Bridge (on route)	Railroad (at grade)	Intersection
Divided Highway	Underpass	Railroad (underpass)	
Secondary Segment	Overpass	Railroad (overpass)	
Corporation			

Created on: 6/24/2025

transportation.ohio.gov

Prepared by
The Ohio Department of Transportation
Office of Technical Services
Roadway Information

SCOLSR00045**C

State True
Log

County True
Log

13.00

13.25

13.50

13.75

14

14.00



- | | | | |
|---------------------|-------------------|----------------------|--------------|
| Non-divided Highway | Bridge (on route) | Railroad (at grade) | Intersection |
| Divided Highway | Underpass | Railroad (underpass) | |
| Secondary Segment | Overpass | Railroad (overpass) | |
| Corporation | | | |

Created on: 6/24/2025



transportation.ohio.gov
Prepared by
The Ohio Department of Transportation
Office of Technical Services
Roadway Information

SCOLSR00045**C

State True
Log

15

County True
Log

14.00

14.25

14.50

14.75

15.00



Non-divided Highway	Bridge (on route)	Railroad (at grade)	Intersection
Divided Highway	Underpass	Railroad (underpass)	
Secondary Segment	Overpass	Railroad (overpass)	
Corporation			

Created on: 6/24/2025

transportation.ohio.gov

Prepared by
The Ohio Department of Transportation
Office of Technical Services
Roadway Information

SCOLSR00045**C

State True Log
County True Log

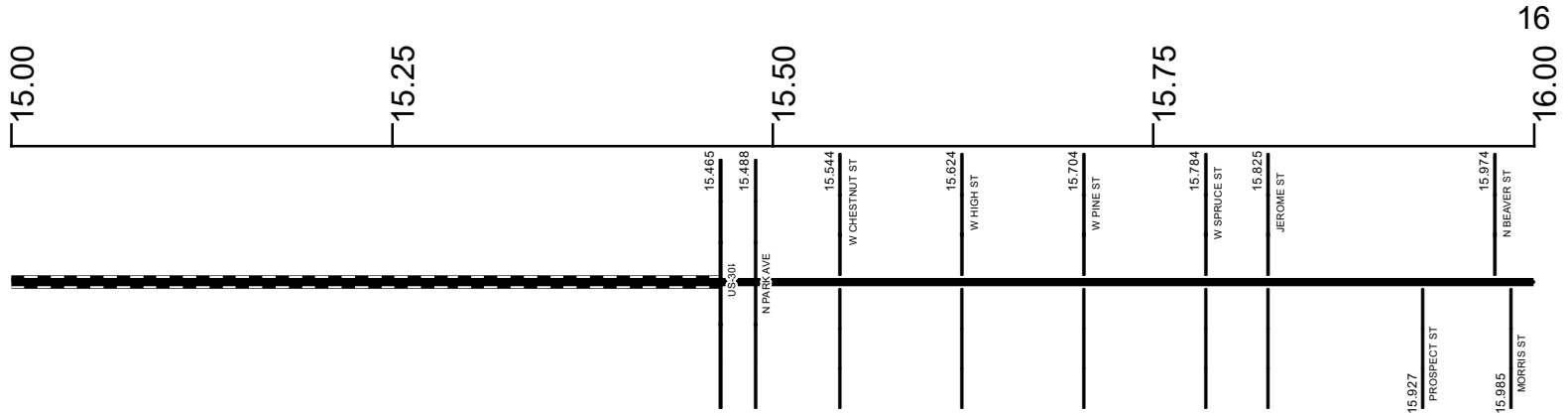

Surface Type & Width (Left / Right)

G 26'
15.465 - 17.03

Base Type (Left / Right)

N
15.465 - 17.03

Shoulder Type & Width (Left / Right)

1 (0'0')
15.465 - 17.03

Through Lanes

2
15.465 - 27.017

Street Name

N MARKET ST
15.465 - 16.277

- Non-divided Highway
- Divided Highway
- Secondary Segment
- Corporation
- Bridge (on route)
- Underpass
- Overpass
- Railroad (at grade)
- Railroad (underpass)
- Railroad (overpass)
- Intersection

Created on: 6/24/2025

transportation.ohio.gov
Prepared by
The Ohio Department of Transportation
Office of Technical Services
Roadway Information

SCOLSR00045**C

State True Log
County True Log

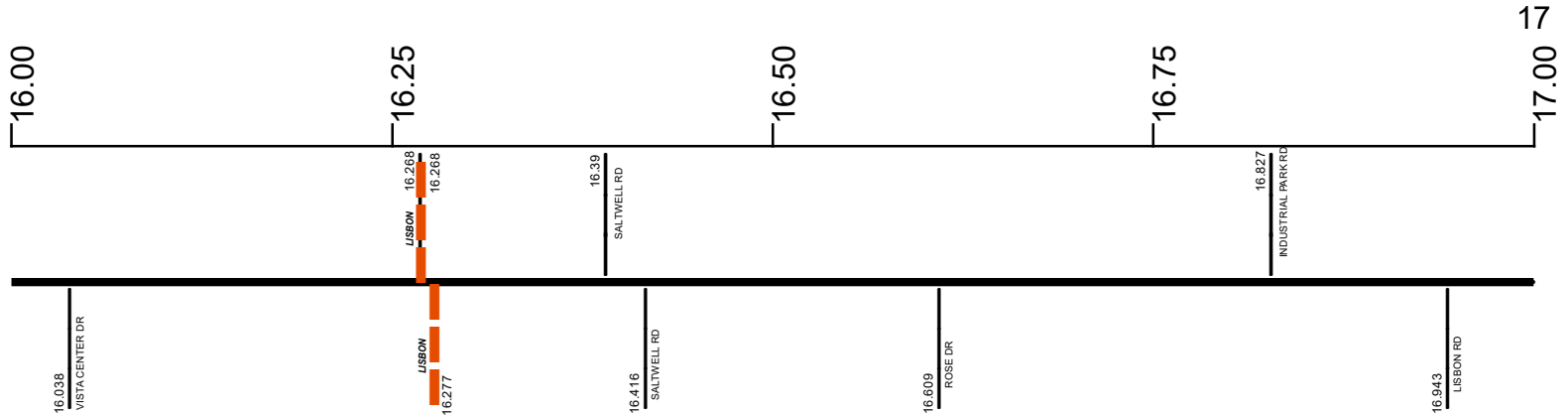

Surface Type & Width (Left / Right)

G 26'
15.465 - 17.03

Base Type (Left / Right)

N
15.465 - 17.03

Shoulder Type & Width (Left / Right)

1 (0'/0')
15.465 - 17.03

Through Lanes

2
15.465 - 27.017

Street Name

N MARKET ST 15.465 - 16.277	SR 45 16.277 - 23.401
--------------------------------	--------------------------

- Non-divided Highway
- Divided Highway
- Secondary Segment
- Corporation
- Bridge (on route)
- Underpass
- Overpass
- Railroad (at grade)
- Railroad (underpass)
- Railroad (overpass)
- Intersection

Created on: 6/24/2025



transportation.ohio.gov
Prepared by
The Ohio Department of Transportation
Office of Technical Services
Roadway Information

SCOLSR00045**C

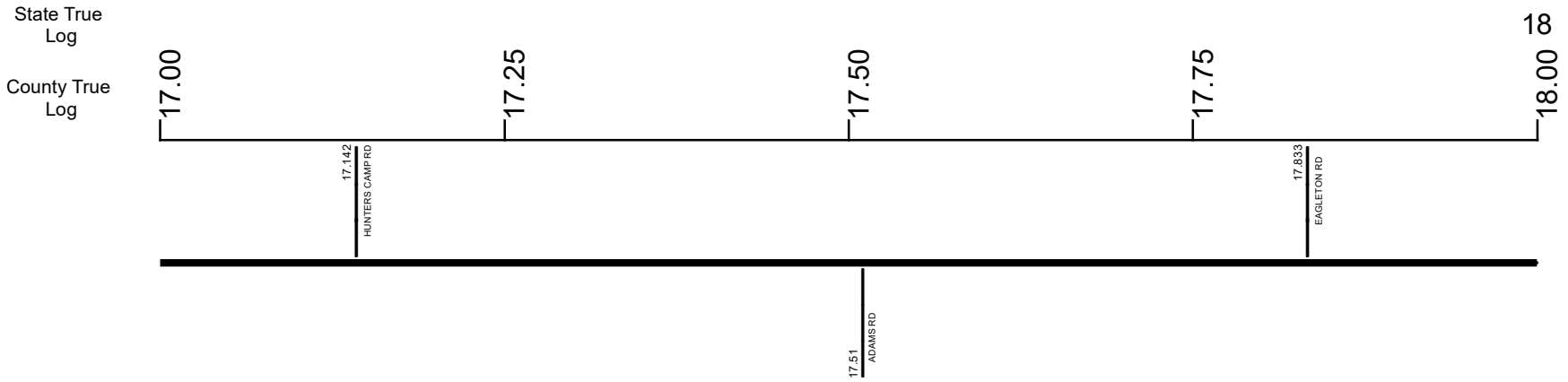

Surface Type & Width (Left / Right)

G 26'	G 22'
15.465 - 17.03	17.03 - 19.744

Base Type (Left / Right)

N	K
15.465 - 17.03	17.03 - 19.744

Shoulder Type & Width (Left / Right)

1 (0'/0')	5 (1'/1')
15.465 - 17.03	17.03 - 19.744

Through Lanes

2
15.465 - 27.017

Street Name

SR 45
16.277 - 23.401

Non-divided Highway	Bridge (on route)	Railroad (at grade)	Intersection
Divided Highway	Underpass	Railroad (underpass)	
Secondary Segment	Overpass	Railroad (overpass)	
Corporation			

Created on: 6/24/2025



transportation.ohio.gov
Prepared by
The Ohio Department of Transportation
Office of Technical Services
Roadway Information

SCOLSR00045**C

State True Log

19

County True Log

18.00

18.25

18.50

18.75

19.00



Surface Type & Width (Left / Right)

G 22'
17.03 - 19.744

Base Type (Left / Right)

K
17.03 - 19.744

Shoulder Type & Width (Left / Right)

5 (1/1')
17.03 - 19.744

Through Lanes

2
15.465 - 27.017

Street Name

SR 45
16.277 - 23.401

- | | | | |
|---------------------|-------------------|----------------------|--------------|
| Non-divided Highway | Bridge (on route) | Railroad (at grade) | Intersection |
| Divided Highway | Underpass | Railroad (underpass) | |
| Secondary Segment | Overpass | Railroad (overpass) | |
| Corporation | | | |

Created on: 6/24/2025



transportation.ohio.gov
 Prepared by
 The Ohio Department of Transportation
 Office of Technical Services
 Roadway Information

SCOLSR00045**C

State True Log
County True Log

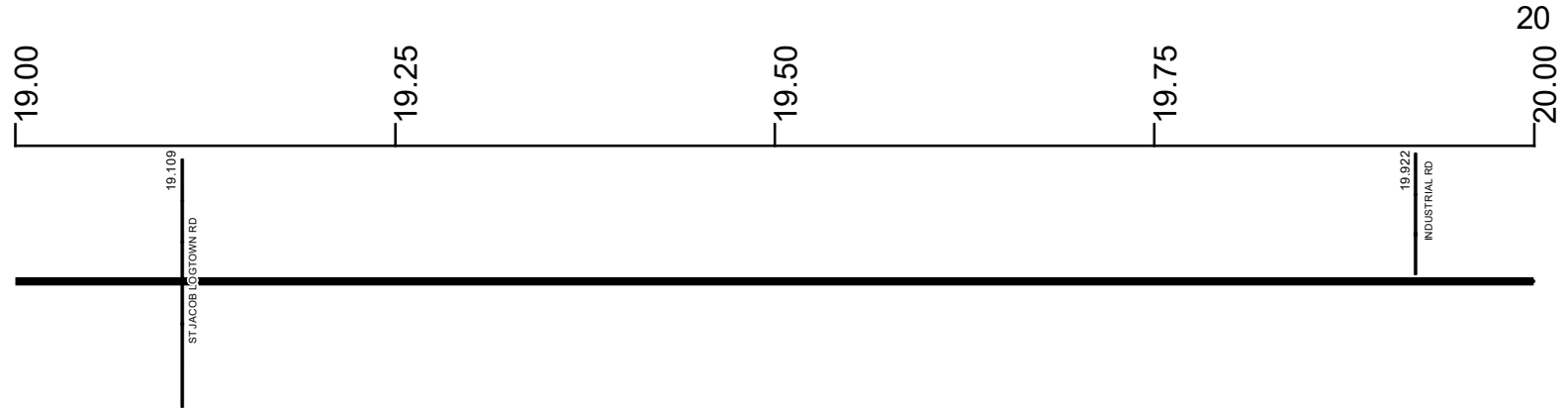

Surface Type & Width (Left / Right)

G 22'	G 24'
17.03 - 19.744	19.744 - 21.353

Base Type (Left / Right)

K	P
17.03 - 19.744	19.744 - 21.353

Shoulder Type & Width (Left / Right)

5 (1'1')	5 (2'2')
17.03 - 19.744	19.744 - 21.353

Resurface Year

2023
19.63 - 22.03

Through Lanes

2
15.465 - 27.017

Street Name

SR 45
16.277 - 23.401

- Non-divided Highway
 Bridge (on route)
 Railroad (at grade)
 Intersection
- Divided Highway
 Underpass
 Railroad (underpass)
- Secondary Segment
 Overpass
 Railroad (overpass)
- Corporation**

Created on: 6/24/2025

transportation.ohio.gov

Prepared by
The Ohio Department of Transportation
Office of Technical Services
Roadway Information

SCOLSR00045**C

State True
Log

22

County True
Log

21.00

21.25

21.50

21.75

22.00



Surface Type & Width (Left / Right)

G 24' 19.744 - 21.353	G (20'4') 21.353 - 23.116
--------------------------	------------------------------

Base Type (Left / Right)

P 19.744 - 21.353	N / L 21.353 - 23.116
----------------------	--------------------------

Shoulder Type & Width (Left / Right)

5 (2'2') 19.744 - 21.353	5 (1'1') 21.353 - 23.924
-----------------------------	-----------------------------

Resurface Year

2023 19.63 - 22.03

Through Lanes

2 15.465 - 27.017

Street Name

SR 45 16.277 - 23.401

- Non-divided Highway
 Bridge (on route)
 Railroad (at grade)
 Intersection
- Divided Highway
 Underpass
 Railroad (underpass)
- Secondary Segment
 Overpass
 Railroad (overpass)
- Corporation**

Created on: 6/24/2025



transportation.ohio.gov

Prepared by
The Ohio Department of Transportation
Office of Technical Services
Roadway Information

SCOLSR00045**C

State True Log
County True Log

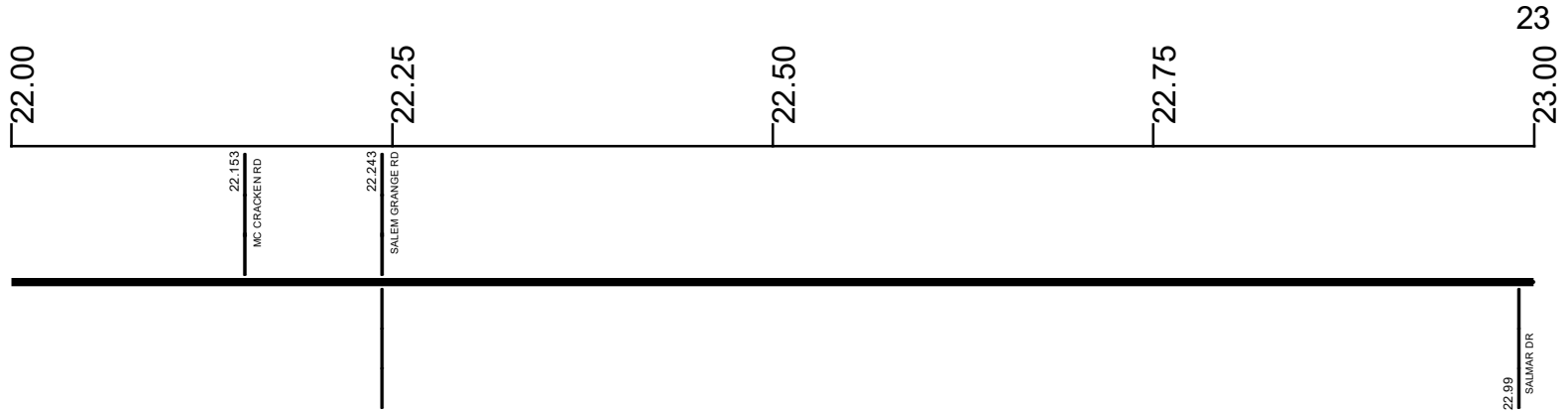

Surface Type & Width (Left / Right)

G (20'4')
21.353 - 23.116

Base Type (Left / Right)

N / L
21.353 - 23.116

Shoulder Type & Width (Left / Right)

5 (1'1')
21.353 - 23.924

Resurface Year

2023

19.63 - 22.03

Resurface Year

2020

22.143 - 27.017

Through Lanes

2
15.465 - 27.017

Street Name

SR 45
16.277 - 23.401

- Non-divided Highway
 Bridge (on route)
 Railroad (at grade)
 Intersection
- Divided Highway
 Underpass
 Railroad (underpass)
- Secondary Segment
 Overpass
 Railroad (overpass)
- Corporation**

Created on: 6/24/2025



transportation.ohio.gov

Prepared by
The Ohio Department of Transportation
Office of Technical Services
Roadway Information

SCOLSR00045**C

State True Log
County True Log

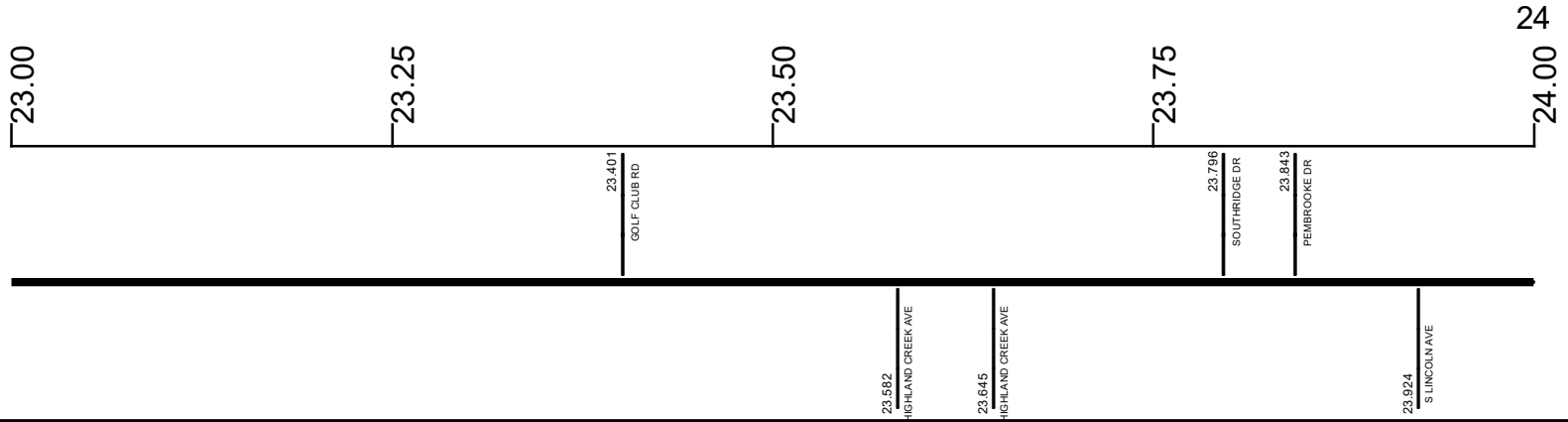

Surface Type & Width (Left / Right)

G (20'/4')	G (22'/2')	G (20'/4')
21.353 - 23.116	23.116 - 23.924	23.924 - 24.611

Base Type (Left / Right)

N / L	K / L	K / I
21.353 - 23.116	23.116 - 23.924	23.924 - 24.611

Shoulder Type & Width (Left / Right)

	5 (1'/1')	5 (2'/2')
	21.353 - 23.924	23.924 - 24.611

Resurface Year

	2020	
	22.143 - 27.017	

Through Lanes

	2	
	15.465 - 27.017	

Street Name

SR 45	S LINCOLN AVE	E PIDGEON RD
16.277 - 23.401	23.401 - 23.924	23.924 - 24.732

- Non-divided Highway
- Divided Highway
- Secondary Segment
- Corporation
- Bridge (on route)
- Underpass
- Overpass
- Railroad (at grade)
- Railroad (underpass)
- Railroad (overpass)
- Intersection

Created on: 6/24/2025

transportation.ohio.gov

Prepared by
The Ohio Department of Transportation
Office of Technical Services
Roadway Information

SCOLSR00045**C

State True Log
County True Log

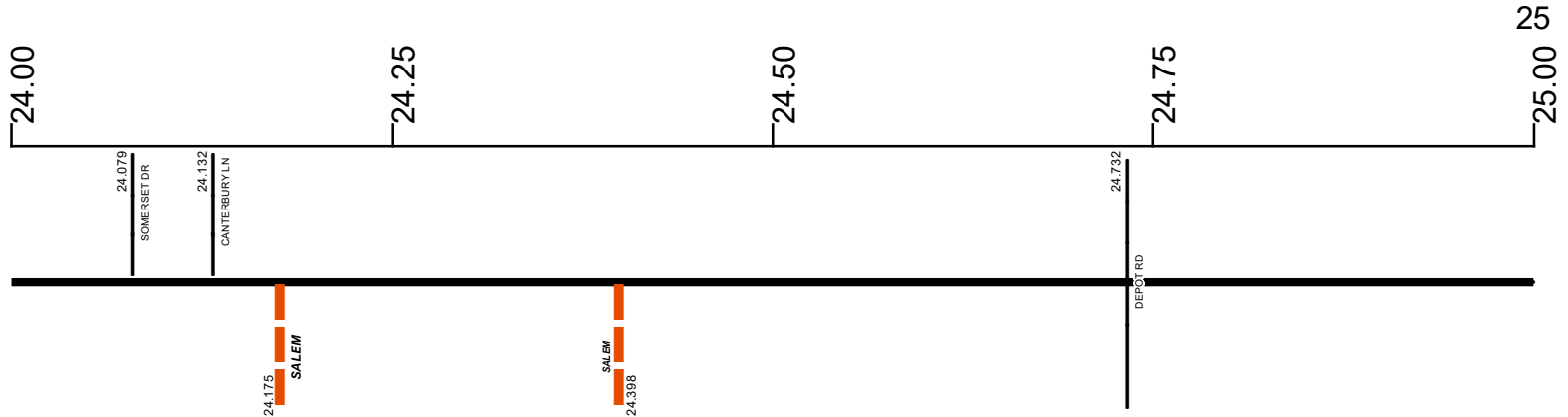

Surface Type & Width (Left / Right)

G (20'4")	G 56'	G (20'4")
23.924 - 24.611	24.611 - 24.831	24.831 - 25.1

Base Type (Left / Right)

K / I	L	K / I
23.924 - 24.611	24.611 - 24.831	24.831 - 25.1

Shoulder Type & Width (Left / Right)

5 (2'2")	1 (0'0")	5 (2'2")
23.924 - 24.611	24.611 - 24.831	24.831 - 25.714

Resurface Year

2020
22.143 - 27.017

Through Lanes

2
15.465 - 27.017

Street Name

E PIDGEON RD	W PIDGEON RD
23.924 - 24.732	24.732 - 25.302

- Non-divided Highway
- Divided Highway
- Secondary Segment
- Corporation
- Bridge (on route)
- Underpass
- Overpass
- Railroad (at grade)
- Railroad (underpass)
- Railroad (overpass)
- Intersection

Created on: 6/24/2025

transportation.ohio.gov

Prepared by
The Ohio Department of Transportation
Office of Technical Services
Roadway Information

SCOLSR00045**C

State True Log
County True Log

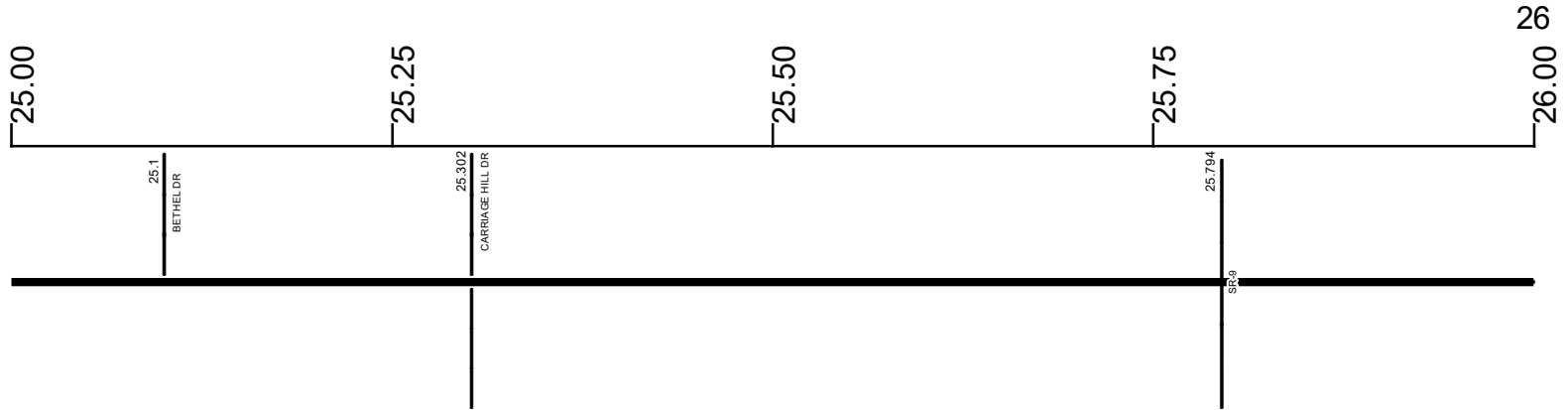

Surface Type & Width (Left / Right)

G (20'4')	G 24'	G 36'	G 24'
24.831 - 25.1	25.1 - 25.714	25.714 - 25.904	25.904 - 26.371

Base Type (Left / Right)

K / I	L
24.831 - 25.1	25.1 - 27.017

Shoulder Type & Width (Left / Right)

5 (2'2')	2 (10'/10')	5 (2'2')
24.831 - 25.714	25.714 - 25.904	25.904 - 26.371

Resurface Year

2020

22.143 - 27.017

Through Lanes

2

15.465 - 27.017

Street Name

W PIDGEON RD	SR 45
24.732 - 25.302	25.302 - 27.017

- Non-divided Highway
- Divided Highway
- Secondary Segment
- Corporation
- Bridge (on route)
- Underpass
- Overpass
- Railroad (at grade)
- Railroad (underpass)
- Railroad (overpass)
- Intersection

Created on: 6/24/2025

transportation.ohio.gov

Prepared by
The Ohio Department of Transportation
Office of Technical Services
Roadway Information

SCOLSR00045**C

State True Log
County True Log

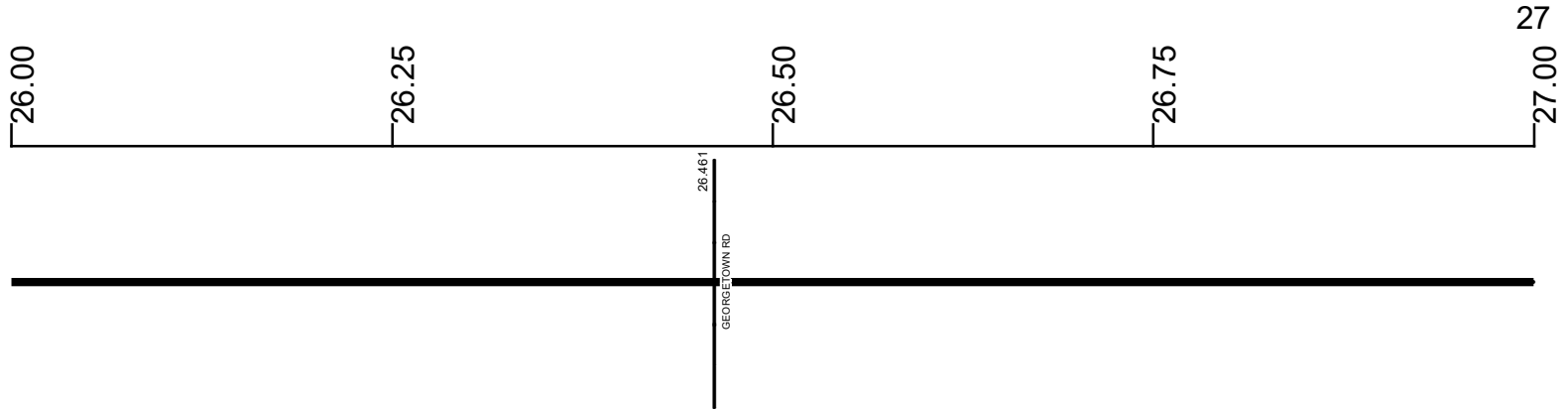

Surface Type & Width (Left / Right)

G 24'	G 36'	G 24'	G 36'
25.904 - 26.371	26.371 - 26.55	26.55 - 26.918	26.918 - 27.017

Base Type (Left / Right)

L
25.1 - 27.017

Shoulder Type & Width (Left / Right)

5 (2 1/2')	5 (3 1/3')	5 (2 1/2')	5 (5 1/5')
25.904 - 26.371	26.371 - 26.55	26.55 - 26.918	26.918 - 27.017

Resurface Year

2020
22.143 - 27.017

Through Lanes

2
15.465 - 27.017

Street Name

SR 45
25.302 - 27.017

- Non-divided Highway
- Divided Highway
- Secondary Segment
- Corporation
- Bridge (on route)
- Underpass
- Overpass
- Railroad (at grade)
- Railroad (underpass)
- Railroad (overpass)
- Intersection

Created on: 6/24/2025



transportation.ohio.gov
Prepared by
The Ohio Department of Transportation
Office of Technical Services
Roadway Information

SCOLSR00045**C

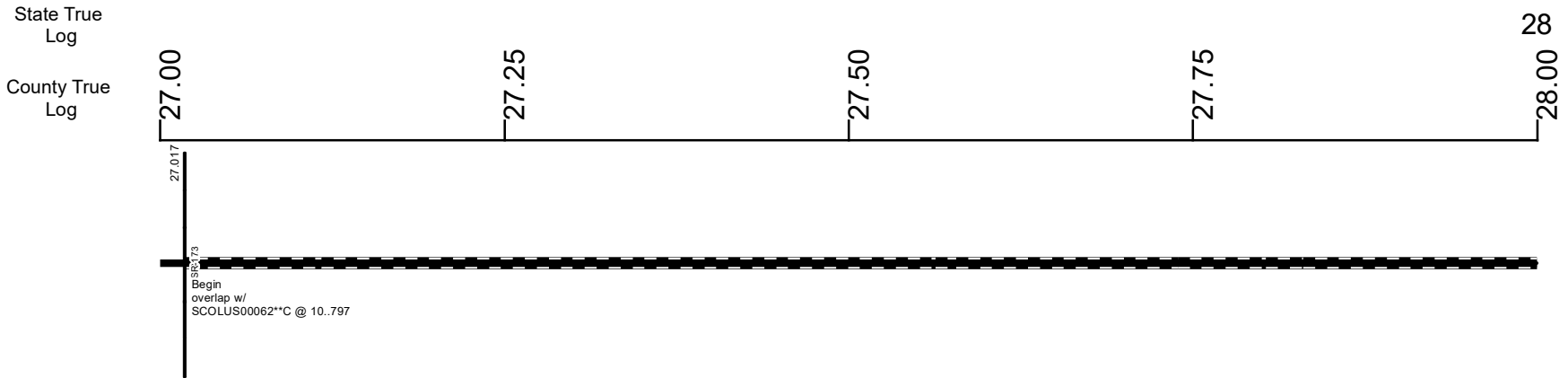

Surface Type & Width (Left / Right)

G(36)

Base Type (Left / Right)

L

25.1 - 27.017

Shoulder Type & Width (Left / Right)

5(5/5)

26.918 - 27.017

Resurface Year

2020

22.143 - 27.017

Through Lanes

2

15.465 - 27.017

Street Name

SR 45

25.302 - 27.017

Non-divided Highway	Bridge (on route)	Railroad (at grade)	Intersection
Divided Highway	Underpass	Railroad (underpass)	
Secondary Segment	Overpass	Railroad (overpass)	
Corporation			

Created on: 6/24/2025

transportation.ohio.gov
 Prepared by
 The Ohio Department of Transportation
 Office of Technical Services
 Roadway Information

SCOLSR00045**C

State True
Log

County True
Log



- | | | | |
|---------------------|-------------------|----------------------|--------------|
| Non-divided Highway | Bridge (on route) | Railroad (at grade) | Intersection |
| Divided Highway | Underpass | Railroad (underpass) | |
| Secondary Segment | Overpass | Railroad (overpass) | |
| Corporation | | | |

Created on: 6/24/2025



transportation.ohio.gov
Prepared by
The Ohio Department of Transportation
Office of Technical Services
Roadway Information

SCOLSR00045**C

State True Log
County True Log

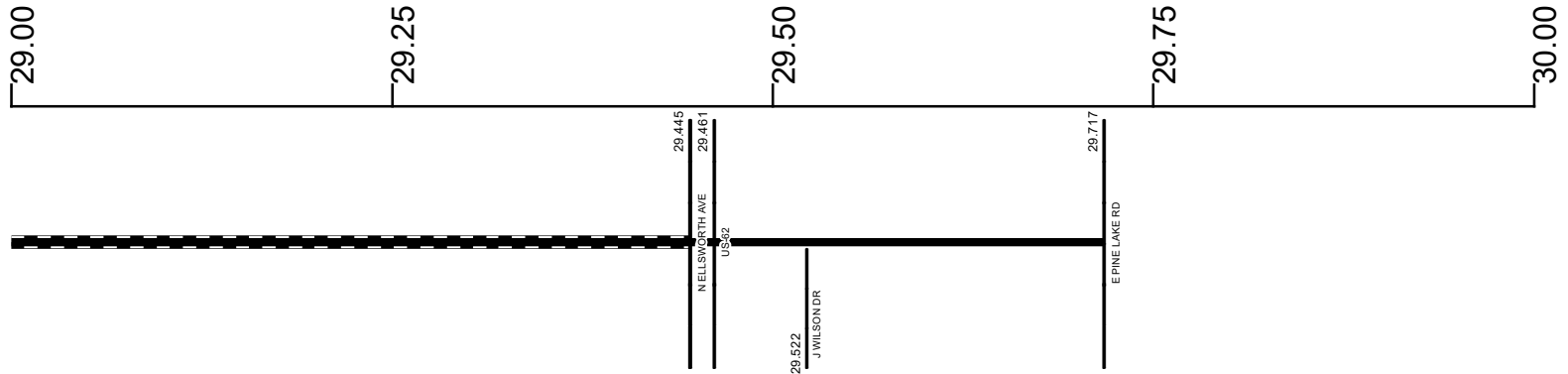

Surface Type & Width (Left / Right)

G (20'/16')	G (20'/4')
29.445 - 29.584	29.584 - 29.717

Base Type (Left / Right)

K / L
29.445 - 29.717

Shoulder Type & Width (Left / Right)

2 (8'/8')	2 (1'/1')
29.445 - 29.584	29.584 - 29.717

Through Lanes

2
29.445 - 29.717

Street Name

N ELLSWORTH AVE
29.445 - 29.717

- Non-divided Highway
- Divided Highway
- Secondary Segment
- Corporation
- Bridge (on route)
- Underpass
- Overpass
- Railroad (at grade)
- Railroad (underpass)
- Railroad (overpass)
- Intersection

Created on: 6/24/2025



transportation.ohio.gov
Prepared by
The Ohio Department of Transportation
Office of Technical Services
Roadway Information

INTERCHANGE
US 62, SRs 14T & 45
COLUMBIANA COUNTY
INTERCHANGE ID NUMBER = 012200

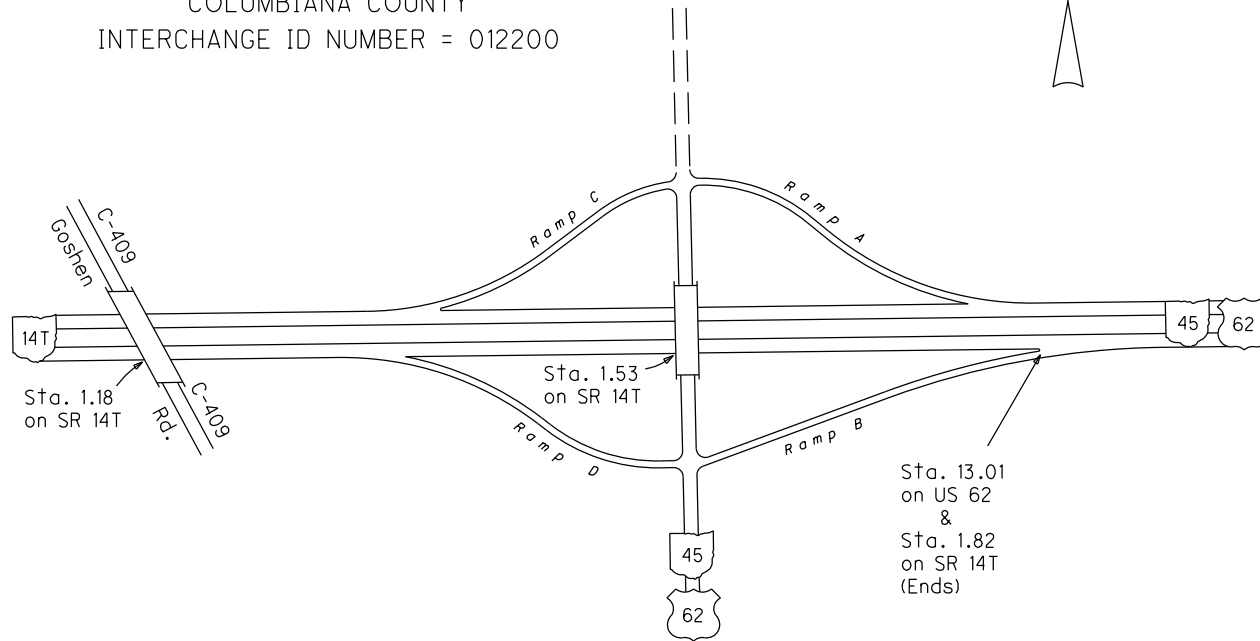

Historical Project List for SCOLSR00045**C

Begin Measure	End Measure	Project ID Number	Construction Completion Date	Treatment Category	Treatment Type
0.320	9.095	24741	10-2004	Minor Rehabilitation	60-AC Overlay w/Rpr
0.355	1.060	87314	10-2016	Minor Rehabilitation	50-AC Overlay w/o Rpr
1.060	9.095	87314	10-2016	Minor Rehabilitation	60-AC Overlay w/Rpr
15.465	16.537	85108	11-2015	Minor Rehabilitation	60-AC Overlay w/Rpr
16.163	16.983	12182	7-2003	Major Rehabilitation	100-New Flexible Pvmt
16.537	17.043	85108	11-2015	Minor Rehabilitation	60-AC Overlay w/Rpr
17.043	19.109	91964	4-2017	Minor Rehabilitation	60-AC Overlay w/Rpr
17.043	20.162	76422	11-2006	Minor Rehabilitation	60-AC Overlay w/Rpr
19.109	19.744	91964	4-2017	Minor Rehabilitation	60-AC Overlay w/Rpr
19.744	22.143	107545	10-2023	Minor Rehabilitation	60-AC Overlay w/Rpr
19.744	22.153	84367	10-2012	Minor Rehabilitation	38-Fine Poly AC Overlay
22.143	22.243	102457	12-2021	Minor Rehabilitation	60-AC Overlay w/Rpr
22.153	27.017	84162	12-2010	Minor Rehabilitation	60-AC Overlay w/Rpr
22.243	23.390	102457	12-2021	Minor Rehabilitation	60-AC Overlay w/Rpr
23.390	27.017	102457	12-2021	Minor Rehabilitation	60-AC Overlay w/Rpr
29.445	29.717	91964	4-2017	Minor Rehabilitation	50-AC Overlay w/o Rpr

Roadway Codes

Access Control Journalized

- F - Full Access Control
- L - Limited Access Control
- N - No Access Control

Access Control Operational

- 1 - Full Access Control
- 2 - Partial Access Control
- 3 - No Access Control

Base Type

- F - Crack and Seat
- H - Rubblize and Roll
- I - Aggregate Base 304 or Traffic Compacted
- K - Water Bound Macadam
- L - Bituminous Concrete Mix or Penetration Macadam
- N - Plain Concrete
- P - Reinforced Concrete
- R - Brick (Flexible)
- T - Brick (Rigid)

Direction of Travel

- B - Both (Two-way)
- F - One-way Cardinal
- T - One-way Non-cardinal

Facility Type

- 1 - One-way Roadway
- 2 - Two-way Roadway
- 4 - Ramp
- 5 - Non-mainline
- 6 - Non-inventory Direction
- 7 - Planned / Unbuilt

Historical Federal Aid Indicator

- N - Not a FAP Route
- Y - FAP Route

Functional Classification

- 01 - Interstate
- 02 - Principal Arterial (Freeways)
- 03 - Principal Arterial (Other)
- 04 - Minor Arterial
- 05 - Major Collector
- 06 - Minor Collector
- 07 - Local

Leave / Reenter Indicator

- Y - Route leaves/reenters at this point
- N - Route does not leave/reenter at this point

Median Type

- 1 - None
- 2 - Unprotected
- 3 - Curbed
- 4 - Positive Barrier (Unspecified)
- 5 - Positive Barrier (Flexible)
- 6 - Positive Barrier (Semi-rigid)
- 7 - Positive Barrier (Rigid)

NHS

- N - National Highway System
- H - Congressional Corridor
- 2 - Major Airport
- 3 - Major Port Facility
- 4 - Major Amtrak Station
- 5 - Major Rail / Truck Terminal
- 6 - Major Intercity Bus Terminal
- 7 - Major Public Transit / Multi-modal Passenger Terminal
- 8 - Major Pipeline Terminal
- 9 - Major Ferry Terminal

Priority System

- G - General
- P - Priority System
- U - Urban

Scenic Byway Code

- A - All American Road
- N - National Scenic Byway
- S - State Scenic Byway

Shoulder Type

- 1 - None
- 2 - Surfaced shoulder exists (bituminous concrete {AC})
- 3 - Surfaced shoulder exists (Portland Cement Concrete {PCC})
- 4 - Stabilized shoulder exists (gravel or other granular material)
- 5 - Combination shoulder exists (two or more surface types)
- 6 - Earth shoulder exists
- 7 - Barrier curb exists; no shoulder in front of curb

Surface Type

- A - Combination
- B - Brick
- C - Continuous Reinforced Concrete
- D - Reinforced Concrete
- E - Plain Concrete
- G - Bituminous Concrete
- I - Chipseal on Granular
- K - Open Graded Bituminous
- L - Chipseal or Micro
- M - Gravel
- U - Unimproved
- X - Right of Way Only