

SCOLSR00046**C

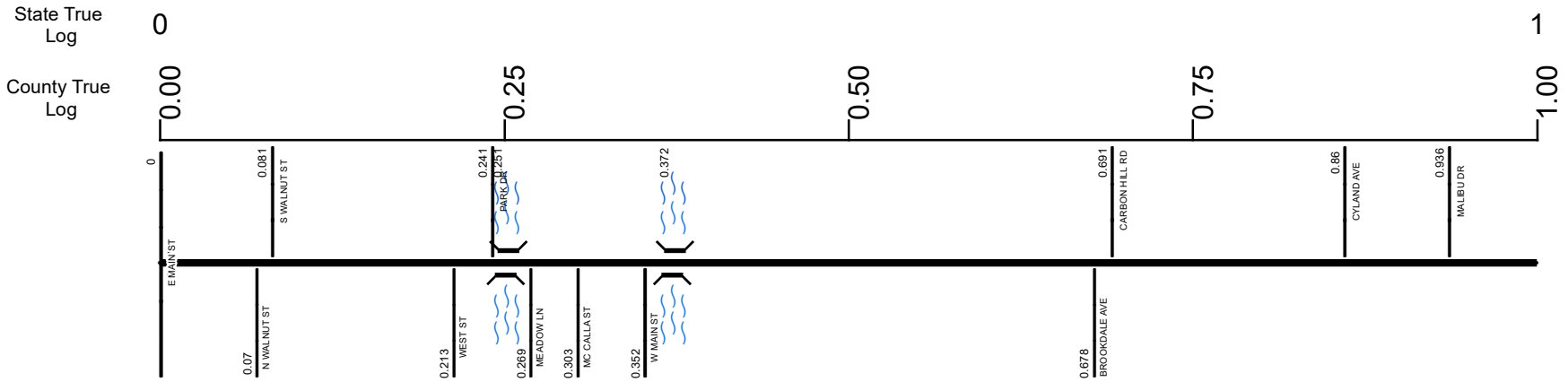

Surface Type & Width (Left / Right)				
G 40'	G 30'	G 20'	G (18'/6')	G (11'/13')
0 - 0.02	0.02 - 0.401	0.401 - 0.691	0.691 - 0.91	0.91 - 1.371
Base Type (Left / Right)				
R	N	K	T / I	
0 - 0.02	0.02 - 0.401	0.401 - 0.691	0.691 - 1.581	
Shoulder Type & Width (Left / Right)				
1 (0'/0')		2 (2'/2')	5 (1'/1')	2 (2'/2')
0 - 0.401		0.401 - 0.691	0.691 - 0.91	0.91 - 1.371
Through Lanes				
2				
0 - 6.811				
Street Name				
W MAIN ST		BACON AVE		
0 - 0.352		0.352 - 3.153		

Non-divided Highway	Bridge (on route)	Railroad (at grade)	Intersection
Divided Highway	Underpass	Railroad (underpass)	
Secondary Segment	Overpass	Railroad (overpass)	
Corporation			

Created on: 6/24/2025



transportation.ohio.gov
 Prepared by
 The Ohio Department of Transportation
 Office of Technical Services
 Roadway Information

SCOLSR00046**C

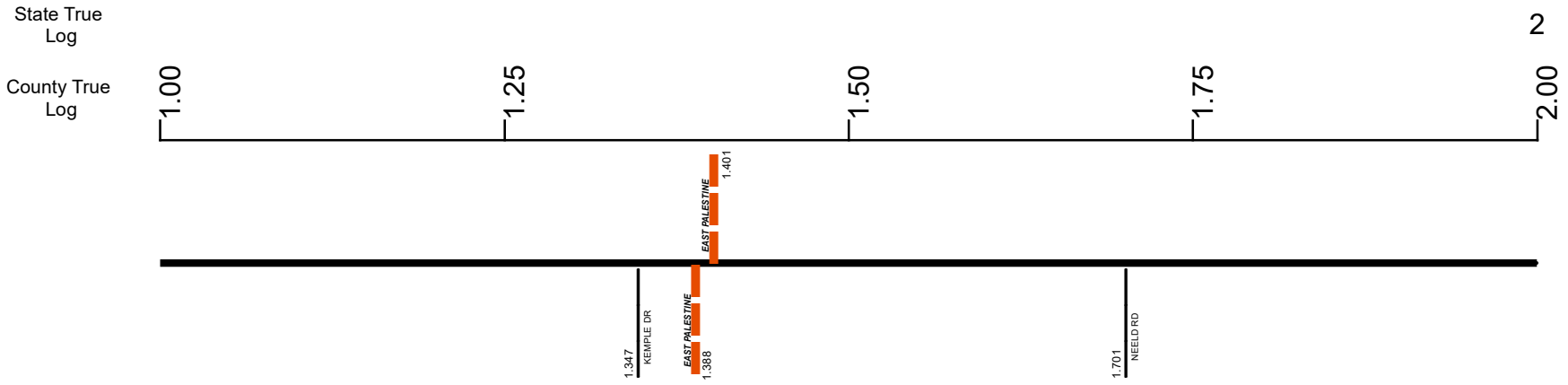

Surface Type & Width (Left / Right)	
G (11'13') 0.91 - 1.371	G 22' 1.371 - 1.581
G (18'4') 1.581 - 2.559	
Base Type (Left / Right)	
T / I 0.691 - 1.581	K / L 1.581 - 2.559
Shoulder Type & Width (Left / Right)	
2 (2'2') 0.91 - 1.371	5 (1'1') 1.371 - 2.559
Through Lanes	
2 0 - 6.811	
Street Name	
BACON AVE 0.352 - 3.153	

- Non-divided Highway
- Divided Highway
- Secondary Segment
- Corporation**
- Bridge (on route)
- Underpass
- Overpass
- Railroad (at grade)
- Railroad (underpass)
- Railroad (overpass)
- Intersection

Created on: 6/24/2025

transportation.ohio.gov

Prepared by
The Ohio Department of Transportation
Office of Technical Services
Roadway Information

SCOLSR00046**C

State True Log

County True Log

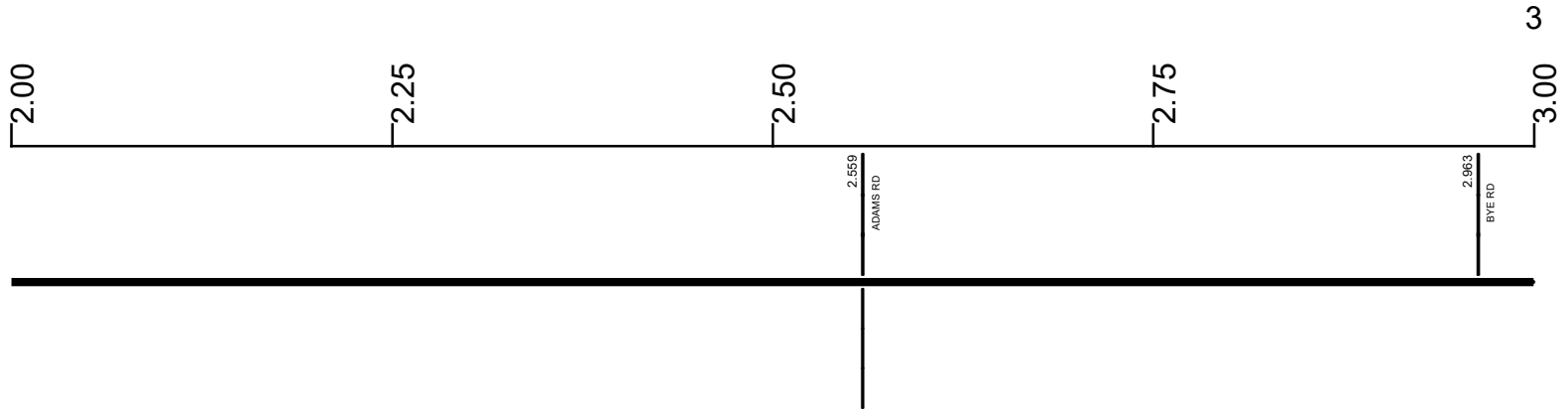

Surface Type & Width (Left / Right)

G (18'4')	G 24'
1.581 - 2.559	2.559 - 4.089

Base Type (Left / Right)

K / L	I
1.581 - 2.559	2.559 - 4.089

Shoulder Type & Width (Left / Right)

5 (1'1')	4 (0'0')
1.371 - 2.559	2.559 - 4.292

Through Lanes

2	
0 - 6.811	

Street Name

	BACON AVE
	0.352 - 3.153

- Non-divided Highway
- Divided Highway
- Secondary Segment
- Corporation
- Bridge (on route)
- Underpass
- Overpass
- Railroad (at grade)
- Railroad (underpass)
- Railroad (overpass)
- Intersection

Created on: 6/24/2025

transportation.ohio.gov

Prepared by
The Ohio Department of Transportation
Office of Technical Services
Roadway Information

SCOLSR00046**C

State True Log

4

County True Log

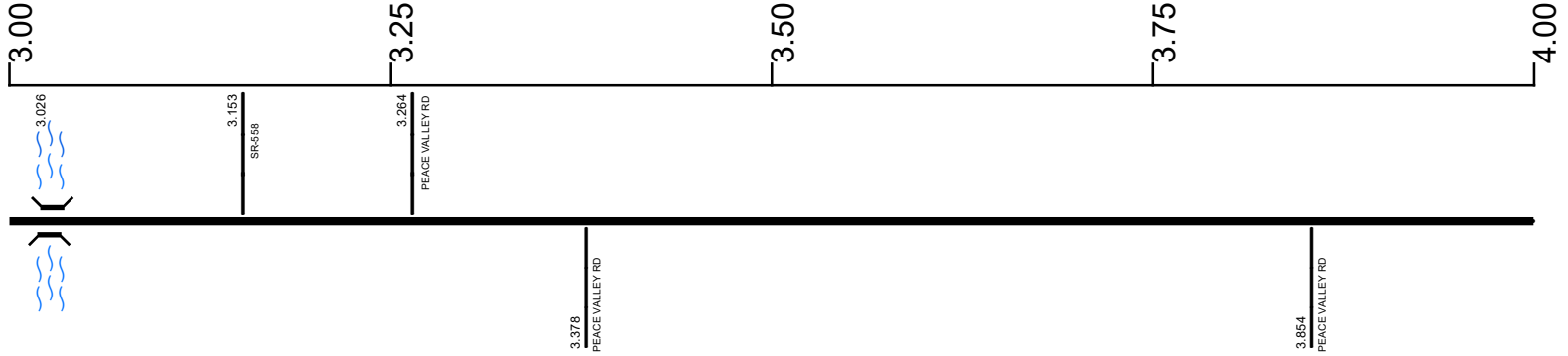

Surface Type & Width (Left / Right)

	G 24'
	2.559 - 4.089

Base Type (Left / Right)

	I
	2.559 - 4.089

Shoulder Type & Width (Left / Right)

	4 (0'/0')
	2.559 - 4.292

Through Lanes

	2
	0 - 6.811

Street Name

BACON AVE	SR 46
0.352 - 3.153	3.153 - 4.089

- Non-divided Highway
- Divided Highway
- Secondary Segment
- Corporation**
- Bridge (on route)
- Underpass
- Overpass
- Railroad (at grade)
- Railroad (underpass)
- Railroad (overpass)
- Intersection

Created on: 6/24/2025

transportation.ohio.gov

Prepared by
The Ohio Department of Transportation
Office of Technical Services
Roadway Information

SCOLSR00046**C

State True Log

County True Log

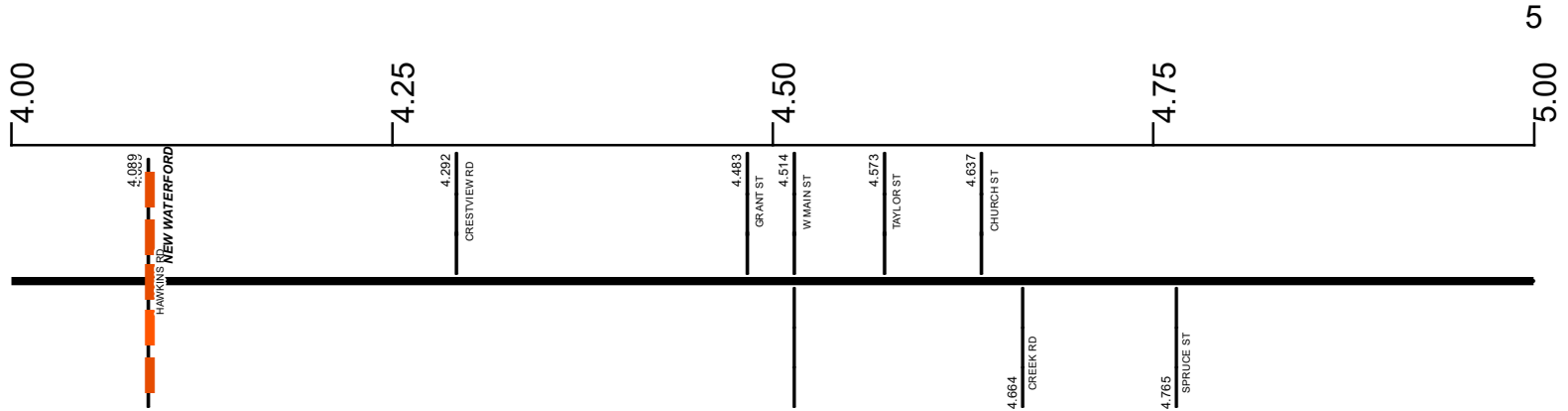

Surface Type & Width (Left / Right)

G 24'	G (18'/6')	G (18'/8')	G (18'/19')	G 24'	G (18'/6')
2.559 - 4.089	4.089 - 4.292	4.292 - 4.446	4.446 - 4.514	4.514 - 4.646	4.646 - 5.02

Base Type (Left / Right)

I	N / L	R / L	R	N	N / L
2.559 - 4.089	4.089 - 4.292	4.292 - 4.446	4.446 - 4.514	4.514 - 4.646	4.646 - 6.811

Shoulder Type & Width (Left / Right)

4 (0'/0')	2 (0'/2')	1 (0'/0')	5 (0'/1')	2 (1'/1')
2.559 - 4.292	4.292 - 4.446	4.446 - 4.514	4.514 - 4.646	4.646 - 5.02

Through Lanes

2
0 - 6.811

Street Name

SR 46	S STATE ST	N STATE ST
3.153 - 4.089	4.089 - 4.514	4.514 - 5.265

- Non-divided Highway
- Divided Highway
- Secondary Segment
- Corporation
- Bridge (on route)
- Underpass
- Overpass
- Railroad (at grade)
- Railroad (underpass)
- Railroad (overpass)
- Intersection

Created on: 6/24/2025



transportation.ohio.gov
 Prepared by
 The Ohio Department of Transportation
 Office of Technical Services
 Roadway Information

SCOLSR00046**C

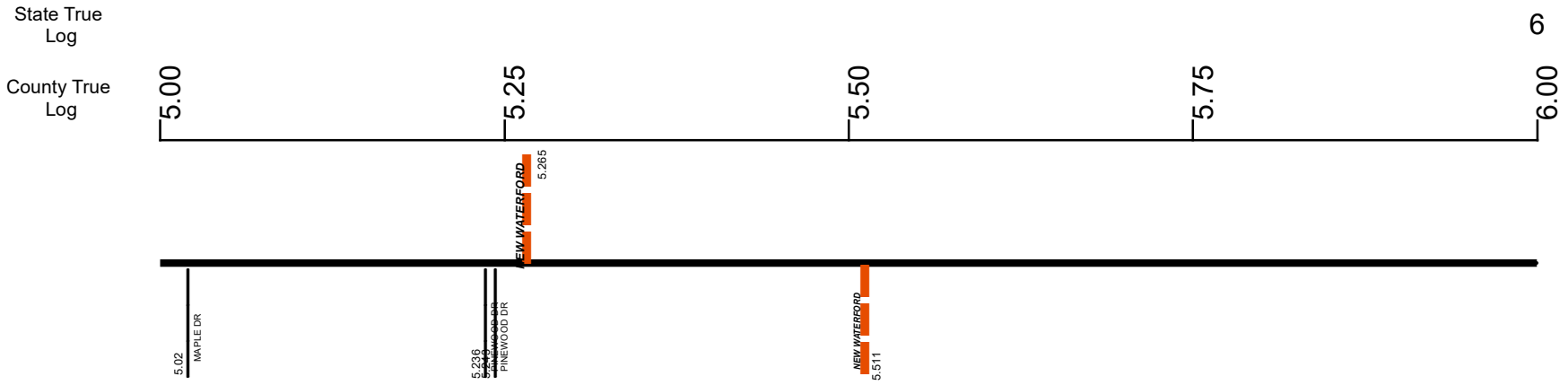

Surface Type & Width (Left / Right)

G (16'6")	G (16'8")
4.646 - 5.02	5.02 - 6.811

Base Type (Left / Right)

	N / L
	4.646 - 6.811

Shoulder Type & Width (Left / Right)

2 (1'1")	4 (0'0")
4.646 - 5.02	5.02 - 6.811

Through Lanes

2
0 - 6.811

Street Name

N STATE ST	SR 46
4.514 - 5.265	5.265 - 6.811

Non-divided Highway	Bridge (on route)	Railroad (at grade)	Intersection
Divided Highway	Underpass	Railroad (underpass)	
Secondary Segment	Overpass	Railroad (overpass)	
Corporation			

Created on: 6/24/2025

transportation.ohio.gov

Prepared by
The Ohio Department of Transportation
Office of Technical Services
Roadway Information

SCOLSR00046**C

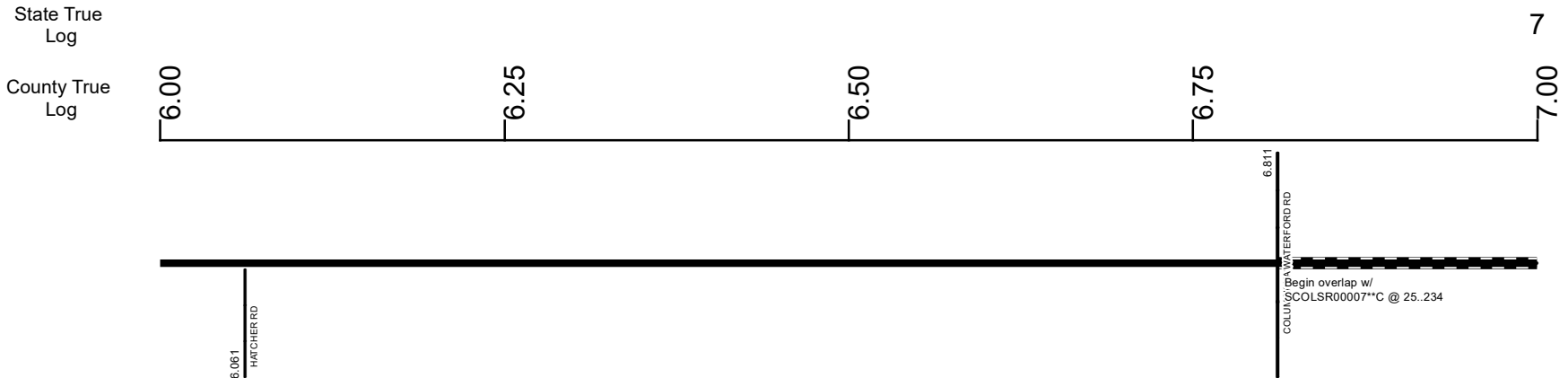

Surface Type & Width (Left / Right)

	G (16'8')
	5.02 - 6.811

Base Type (Left / Right)

	N / L
	4.646 - 6.811

Shoulder Type & Width (Left / Right)

	4 (0'0')
	5.02 - 6.811

Through Lanes

	2
	0 - 6.811

Street Name

	SR 46
	5.265 - 6.811

- | | | | |
|---------------------|-------------------|----------------------|--------------|
| Non-divided Highway | Bridge (on route) | Railroad (at grade) | Intersection |
| Divided Highway | Underpass | Railroad (underpass) | |
| Secondary Segment | Overpass | Railroad (overpass) | |
| Corporation | | | |

Created on: 6/24/2025

transportation.ohio.gov

Prepared by
The Ohio Department of Transportation
Office of Technical Services
Roadway Information

SCOLSR00046**C

State True Log

County True Log

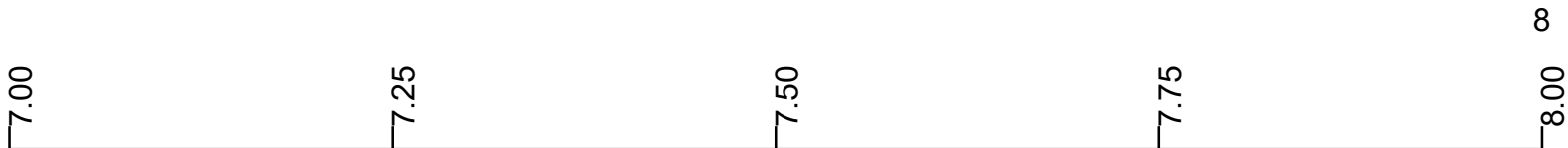

- | | | | |
|---------------------|-------------------|----------------------|--------------|
| Non-divided Highway | Bridge (on route) | Railroad (at grade) | Intersection |
| Divided Highway | Underpass | Railroad (underpass) | |
| Secondary Segment | Overpass | Railroad (overpass) | |
| Corporation | | | |

Created on: 6/24/2025

transportation.ohio.gov
 Prepared by
 The Ohio Department of Transportation
 Office of Technical Services
 Roadway Information

SCOLSR00046**C

State True Log

9

County True Log

8:00

8:25

8:50

8:75

9:00



Begin overlap w/
SCOLSR00014**C
@ 11.697

Non-divided Highway	Bridge (on route)	Railroad (at grade)	Intersection
Divided Highway	Underpass	Railroad (underpass)	
Secondary Segment	Overpass	Railroad (overpass)	
Corporation			

Created on: 6/24/2025

transportation.ohio.gov

Prepared by
The Ohio Department of Transportation
Office of Technical Services
Roadway Information

SCOLSR00046**C

State True
Log

10

County True
Log

9.00

9.25

9.50

9.75

10.00



- | | | | |
|---------------------|-------------------|----------------------|--------------|
| Non-divided Highway | Bridge (on route) | Railroad (at grade) | Intersection |
| Divided Highway | Underpass | Railroad (underpass) | |
| Secondary Segment | Overpass | Railroad (overpass) | |
| Corporation | | | |

Created on: 6/24/2025

transportation.ohio.gov

Prepared by
The Ohio Department of Transportation
Office of Technical Services
Roadway Information

SCOLSR00046**C

State True
Log

11

County True
Log

10.00

10.25

10.50

10.75

11.00



Non-divided Highway	Bridge (on route)	Railroad (at grade)	Intersection
Divided Highway	Underpass	Railroad (underpass)	
Secondary Segment	Overpass	Railroad (overpass)	
Corporation			

Created on: 6/24/2025



transportation.ohio.gov
Prepared by
The Ohio Department of Transportation
Office of Technical Services
Roadway Information

SCOLSR00046**C

State True Log

11.135

County True Log

11:00

11:25

11:50

11:75

12:00



- Non-divided Highway
- Divided Highway
- Secondary Segment
- Corporation**
- Bridge (on route)
- Underpass
- Overpass
- Railroad (at grade)
- Railroad (underpass)
- Railroad (overpass)
- Intersection

Created on: 6/24/2025



transportation.ohio.gov
 Prepared by
 The Ohio Department of Transportation
 Office of Technical Services
 Roadway Information

Historical Project List for SCOLSR00046**C

Begin Measure	End Measure	Project ID Number	Construction Completion Date	Treatment Category	Treatment Type
0.000	1.370	84016	10-2012	Minor Rehabilitation	60-AC Overlay w/Rpr
1.370	4.090	96786	9-2019	Minor Rehabilitation	60-AC Overlay w/Rpr
1.370	6.820	76417	5-2007	Minor Rehabilitation	60-AC Overlay w/Rpr
4.090	6.820	96786	9-2019	Minor Rehabilitation	60-AC Overlay w/Rpr

Roadway Codes

Access Control Journalized

- F - Full Access Control
- L - Limited Access Control
- N - No Access Control

Access Control Operational

- 1 - Full Access Control
- 2 - Partial Access Control
- 3 - No Access Control

Base Type

- F - Crack and Seat
- H - Rubblize and Roll
- I - Aggregate Base 304 or Traffic Compacted
- K - Water Bound Macadam
- L - Bituminous Concrete Mix or Penetration Macadam
- N - Plain Concrete
- P - Reinforced Concrete
- R - Brick (Flexible)
- T - Brick (Rigid)

Direction of Travel

- B - Both (Two-way)
- F - One-way Cardinal
- T - One-way Non-cardinal

Facility Type

- 1 - One-way Roadway
- 2 - Two-way Roadway
- 4 - Ramp
- 5 - Non-mainline
- 6 - Non-inventory Direction
- 7 - Planned / Unbuilt

Historical Federal Aid Indicator

- N - Not a FAP Route
- Y - FAP Route

Functional Classification

- 01 - Interstate
- 02 - Principal Arterial (Freeways)
- 03 - Principal Arterial (Other)
- 04 - Minor Arterial
- 05 - Major Collector
- 06 - Minor Collector
- 07 - Local

Leave / Reenter Indicator

- Y - Route leaves/reenters at this point
- N - Route does not leave/reenter at this point

Median Type

- 1 - None
- 2 - Unprotected
- 3 - Curbed
- 4 - Positive Barrier (Unspecified)
- 5 - Positive Barrier (Flexible)
- 6 - Positive Barrier (Semi-rigid)
- 7 - Positive Barrier (Rigid)

NHS

- N - National Highway System
- H - Congressional Corridor
- 2 - Major Airport
- 3 - Major Port Facility
- 4 - Major Amtrak Station
- 5 - Major Rail / Truck Terminal
- 6 - Major Intercity Bus Terminal
- 7 - Major Public Transit / Multi-modal Passenger Terminal
- 8 - Major Pipeline Terminal
- 9 - Major Ferry Terminal

Priority System

- G - General
- P - Priority System
- U - Urban

Scenic Byway Code

- A - All American Road
- N - National Scenic Byway
- S - State Scenic Byway

Shoulder Type

- 1 - None
- 2 - Surfaced shoulder exists (bituminous concrete {AC})
- 3 - Surfaced shoulder exists (Portland Cement Concrete {PCC})
- 4 - Stabilized shoulder exists (gravel or other granular material)
- 5 - Combination shoulder exists (two or more surface types)
- 6 - Earth shoulder exists
- 7 - Barrier curb exists; no shoulder in front of curb

Surface Type

- A - Combination
- B - Brick
- C - Continuous Reinforced Concrete
- D - Reinforced Concrete
- E - Plain Concrete
- G - Bituminous Concrete
- I - Chipseal on Granular
- K - Open Graded Bituminous
- L - Chipseal or Micro
- M - Gravel
- U - Unimproved
- X - Right of Way Only