

SCOLSR00165**C

State True Log 25.903

26.903

County True Log

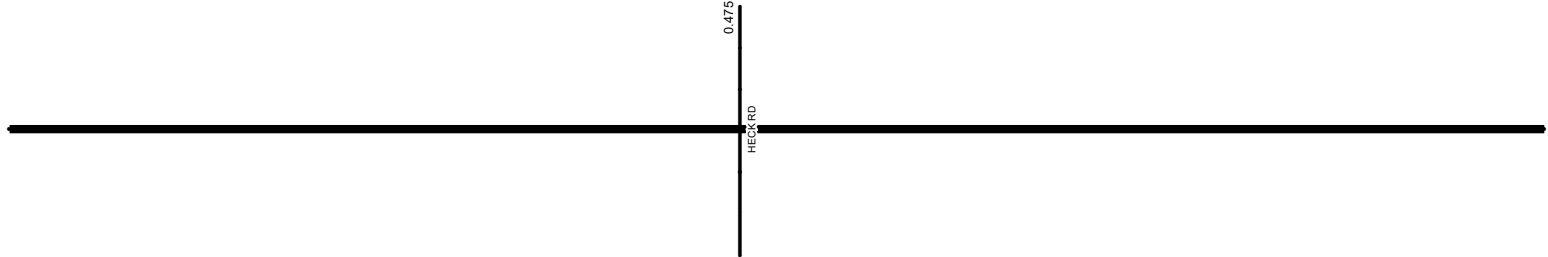

Surface Type & Width (Left / Right)	G (9/10')	
	0 - 2.731	
Base Type (Left / Right)	I	
	0 - 2.731	
Shoulder Type & Width (Left / Right)	2 (2/2')	
	0 - 2.731	
Through Lanes	2	
	0 - 2.731	
Street Name	SR 165	
	0 - 2.731	

<ul style="list-style-type: none"> Non-divided Highway Divided Highway Secondary Segment Corporation 	<ul style="list-style-type: none"> Bridge (on route) Underpass Overpass 	<ul style="list-style-type: none"> Railroad (at grade) Railroad (underpass) Railroad (overpass) 	<ul style="list-style-type: none"> Intersection
--	---	---	---

Created on: 6/24/2025

transportation.ohio.gov

Prepared by
The Ohio Department of Transportation
Office of Technical Services
Roadway Information

SCOLSR00165**C

State True Log

27.903

County True Log

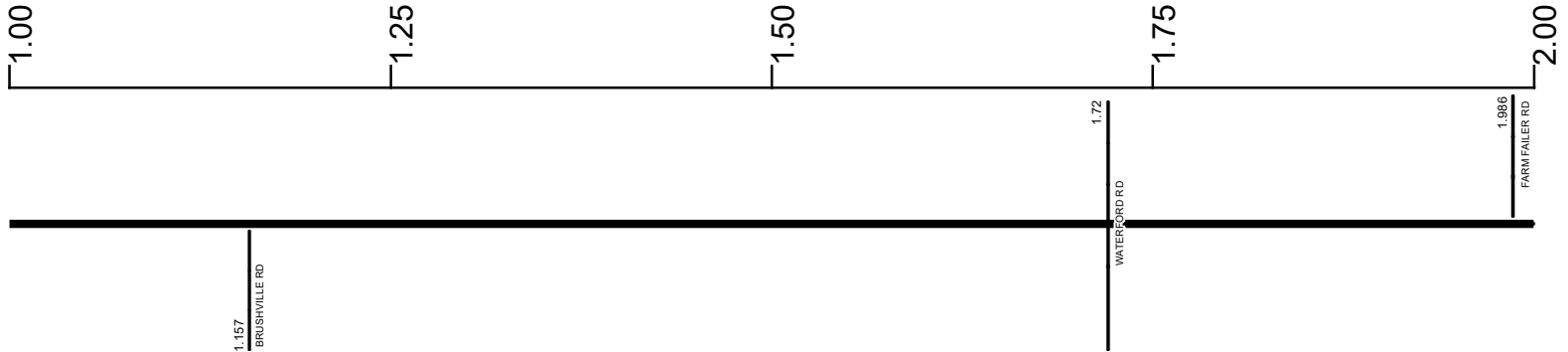

Surface Type & Width (Left / Right)

G (9/10')
0 - 2.731

Base Type (Left / Right)

I
0 - 2.731

Shoulder Type & Width (Left / Right)

2 (2/2)
0 - 2.731

Through Lanes

2
0 - 2.731

Street Name

SR 165
0 - 2.731

- Non-divided Highway
- Divided Highway
- Secondary Segment
- Corporation
- Bridge (on route)
- Underpass
- Overpass
- Railroad (at grade)
- Railroad (underpass)
- Railroad (overpass)
- Intersection

Created on: 6/24/2025

transportation.ohio.gov
Prepared by
The Ohio Department of Transportation
Office of Technical Services
Roadway Information

SCOLSR00165**C

State True Log

28.903

County True Log

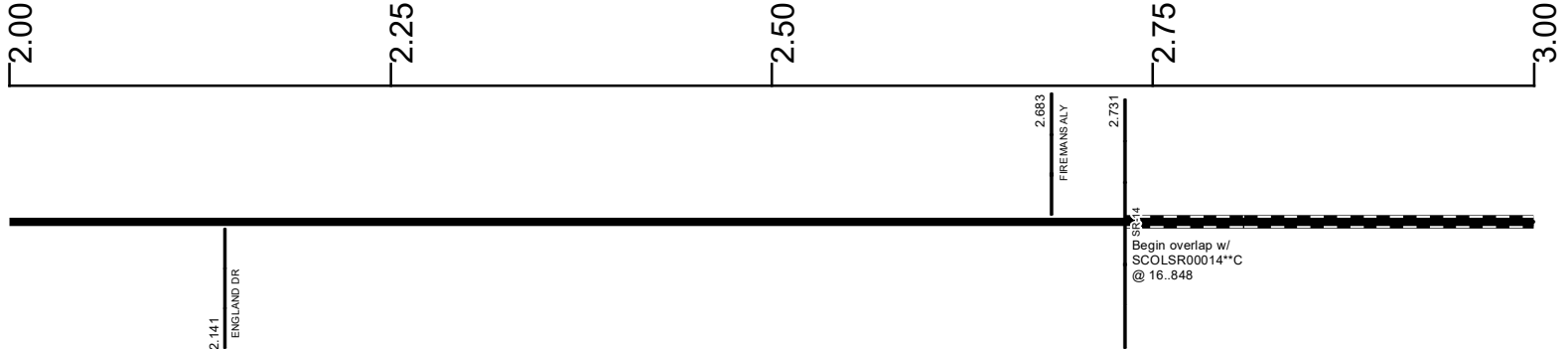

Surface Type & Width (Left / Right)

G (9'/10')
0 - 2.731

Base Type (Left / Right)

I
0 - 2.731

Shoulder Type & Width (Left / Right)

2 (2'/2')
0 - 2.731

Through Lanes

2
0 - 2.731

Street Name

SR 165
0 - 2.731

- | | | | |
|--|---|---|---|
| <ul style="list-style-type: none"> Non-divided Highway Divided Highway Secondary Segment Corporation | <ul style="list-style-type: none"> Bridge (on route) Underpass Overpass | <ul style="list-style-type: none"> Railroad (at grade) Railroad (underpass) Railroad (overpass) | <ul style="list-style-type: none"> Intersection |
|--|---|---|---|

Created on: 6/24/2025

transportation.ohio.gov

Prepared by
The Ohio Department of Transportation
Office of Technical Services
Roadway Information

SCOLSR00165**C

State True Log

29.903

County True Log

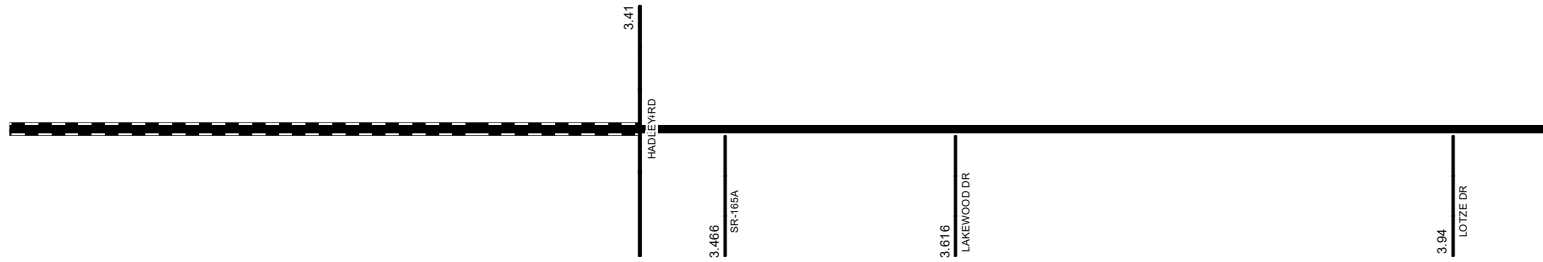

Surface Type & Width (Left / Right)	G 20'	
	3.41 - 4.24	
Base Type (Left / Right)	N	
	3.41 - 4.24	
Shoulder Type & Width (Left / Right)	2 (6'/6')	2 (3'/3')
	3.41 - 3.717	3.717 - 4.24
Through Lanes	2	
	3.41 - 6.363	
Street Name	N MARKET ST	
	3.41 - 5.252	

Non-divided Highway	Bridge (on route)	Railroad (at grade)	Intersection
Divided Highway	Underpass	Railroad (underpass)	
Secondary Segment	Overpass	Railroad (overpass)	
Corporation			

Created on: 6/24/2025



transportation.ohio.gov
 Prepared by
 The Ohio Department of Transportation
 Office of Technical Services
 Roadway Information

SCOLSR00165**C

State True Log

30.903

County True Log

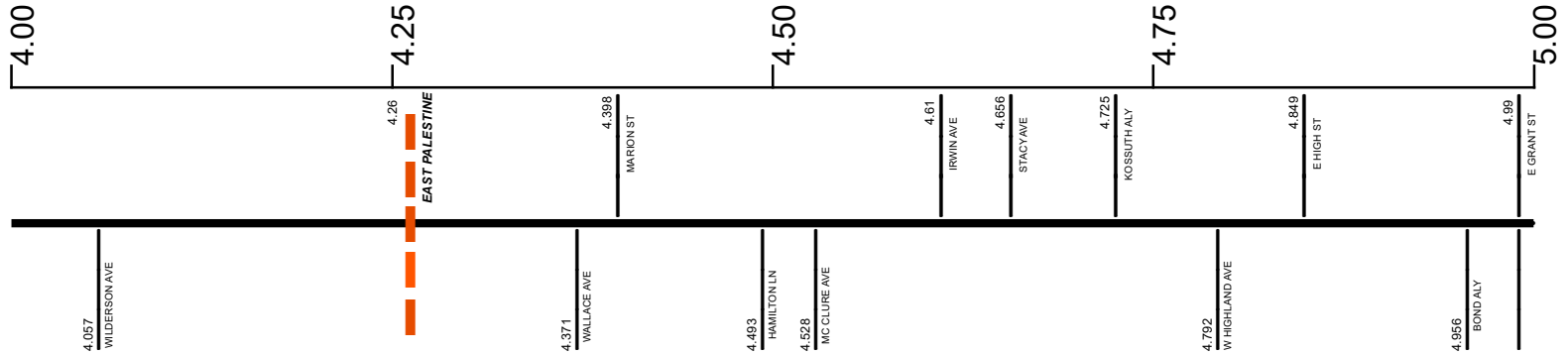

Surface Type & Width (Left / Right)

G 20'	G (4'/20')	G (14'/15')
3.41 - 4.24	4.24 - 4.792	4.792 - 5.129

Base Type (Left / Right)

N	L / N	P
3.41 - 4.24	4.24 - 4.792	4.792 - 5.129

Shoulder Type & Width (Left / Right)

2 (3'/3')	2 (4'/4')	2 (6'/6')	2 (3'/3')	1 (0'/0')
3.717 - 4.24	4.24 - 4.38	4.38 - 4.484	4.484 - 4.792	4.792 - 5.94

Through Lanes

2
3.41 - 6.363

Street Name

N MARKET ST
3.41 - 5.252

- Non-divided Highway
- Divided Highway
- Secondary Segment
- Corporation
- Bridge (on route)
- Underpass
- Overpass
- Railroad (at grade)
- Railroad (underpass)
- Railroad (overpass)
- Intersection

Created on: 6/24/2025

SCOLSR00165**C

State True Log

31.903

County True Log

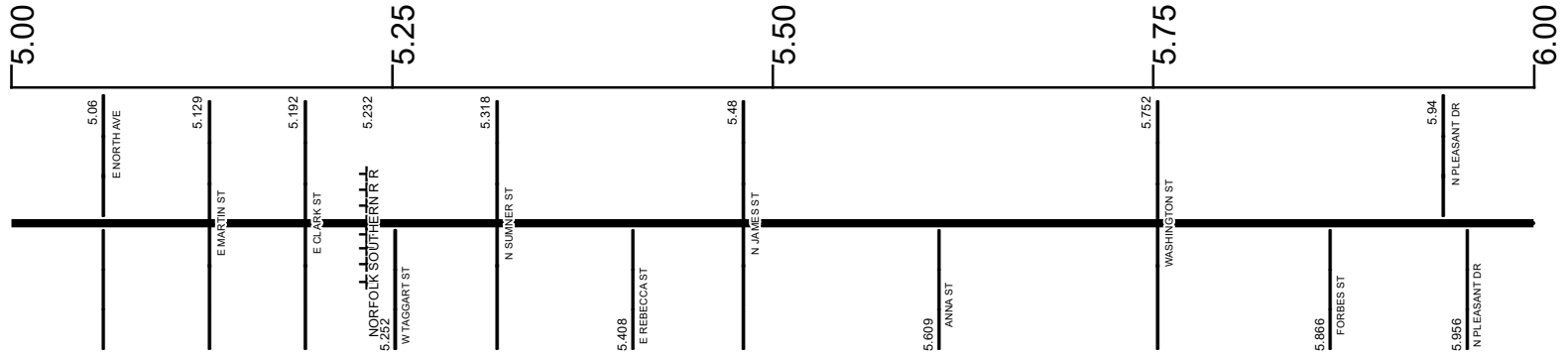

Surface Type & Width (Left / Right)

G (14'/15')	G 36'	G 24' G (20'/4')
4.792 - 5.129	5.129 - 5.94	5.94 - 5.975

Base Type (Left / Right)

P	T	T / L
4.792 - 5.129	5.129 - 5.975	5.975 - 6.092

Shoulder Type & Width (Left / Right)

1 (0'/0')	2 (3'/3')
4.792 - 5.94	5.94 - 6.092

Through Lanes

2
3.41 - 6.363

Street Name

N MARKET ST	E TAGGART ST
3.41 - 5.252	5.252 - 6.363

- Non-divided Highway
- Divided Highway
- Secondary Segment
- Corporation
- Bridge (on route)
- Underpass
- Overpass
- Railroad (at grade)
- Railroad (underpass)
- Railroad (overpass)
- Intersection

Created on: 6/24/2025



transportation.ohio.gov
 Prepared by
 The Ohio Department of Transportation
 Office of Technical Services
 Roadway Information

SCOLSR00165**C

State True Log

32.266

County True Log



6.136
EAST PALESTINE



Surface Type & Width (Left / Right)

G (20'4')	G 24'
5.975 - 6.092	6.092 - 6.363

Base Type (Left / Right)

T / L	T
5.975 - 6.092	6.092 - 6.363

Shoulder Type & Width (Left / Right)

2 (3'3')	2 (1'1')
5.94 - 6.092	6.092 - 6.363

Through Lanes

2
3.41 - 6.363

Street Name

E TAGGART ST
5.252 - 6.363

- Non-divided Highway
- Divided Highway
- Secondary Segment
- Corporation
- Bridge (on route)
- Underpass
- Overpass
- Railroad (at grade)
- Railroad (underpass)
- Railroad (overpass)
- Intersection

Created on: 6/24/2025

transportation.ohio.gov
Prepared by
The Ohio Department of Transportation
Office of Technical Services
Roadway Information

Historical Project List for SCOLSR00165**C

Begin Measure	End Measure	Project ID Number	Construction Completion Date	Treatment Category	Treatment Type
0.000	2.750	102342	10-2018	Minor Rehabilitation	38-Fine Poly AC Overlay
0.000	2.750	25573	12-2008	Minor Rehabilitation	60-AC Overlay w/Rpr
3.370	4.240	91841	8-2017	Minor Rehabilitation	60-AC Overlay w/Rpr
4.240	6.360	91841	8-2017	Minor Rehabilitation	50-AC Overlay w/o Rpr
4.240	6.130	80623	11-2006	Minor Rehabilitation	60-AC Overlay w/Rpr

Roadway Codes

Access Control Journalized

- F - Full Access Control
- L - Limited Access Control
- N - No Access Control

Access Control Operational

- 1 - Full Access Control
- 2 - Partial Access Control
- 3 - No Access Control

Base Type

- F - Crack and Seat
- H - Rubblize and Roll
- I - Aggregate Base 304 or Traffic Compacted
- K - Water Bound Macadam
- L - Bituminous Concrete Mix or Penetration Macadam
- N - Plain Concrete
- P - Reinforced Concrete
- R - Brick (Flexible)
- T - Brick (Rigid)

Direction of Travel

- B - Both (Two-way)
- F - One-way Cardinal
- T - One-way Non-cardinal

Facility Type

- 1 - One-way Roadway
- 2 - Two-way Roadway
- 4 - Ramp
- 5 - Non-mainline
- 6 - Non-inventory Direction
- 7 - Planned / Unbuilt

Historical Federal Aid Indicator

- N - Not a FAP Route
- Y - FAP Route

Functional Classification

- 01 - Interstate
- 02 - Principal Arterial (Freeways)
- 03 - Principal Arterial (Other)
- 04 - Minor Arterial
- 05 - Major Collector
- 06 - Minor Collector
- 07 - Local

Leave / Reenter Indicator

- Y - Route leaves/reenters at this point
- N - Route does not leave/reenter at this point

Median Type

- 1 - None
- 2 - Unprotected
- 3 - Curbed
- 4 - Positive Barrier (Unspecified)
- 5 - Positive Barrier (Flexible)
- 6 - Positive Barrier (Semi-rigid)
- 7 - Positive Barrier (Rigid)

NHS

- N - National Highway System
- H - Congressional Corridor
- 2 - Major Airport
- 3 - Major Port Facility
- 4 - Major Amtrak Station
- 5 - Major Rail / Truck Terminal
- 6 - Major Intercity Bus Terminal
- 7 - Major Public Transit / Multi-modal Passenger Terminal
- 8 - Major Pipeline Terminal
- 9 - Major Ferry Terminal

Priority System

- G - General
- P - Priority System
- U - Urban

Scenic Byway Code

- A - All American Road
- N - National Scenic Byway
- S - State Scenic Byway

Shoulder Type

- 1 - None
- 2 - Surfaced shoulder exists (bituminous concrete {AC})
- 3 - Surfaced shoulder exists (Portland Cement Concrete {PCC})
- 4 - Stabilized shoulder exists (gravel or other granular material)
- 5 - Combination shoulder exists (two or more surface types)
- 6 - Earth shoulder exists
- 7 - Barrier curb exists; no shoulder in front of curb

Surface Type

- A - Combination
- B - Brick
- C - Continuous Reinforced Concrete
- D - Reinforced Concrete
- E - Plain Concrete
- G - Bituminous Concrete
- I - Chipseal on Granular
- K - Open Graded Bituminous
- L - Chipseal or Micro
- M - Gravel
- U - Unimproved
- X - Right of Way Only