

SCOLSR00170**C

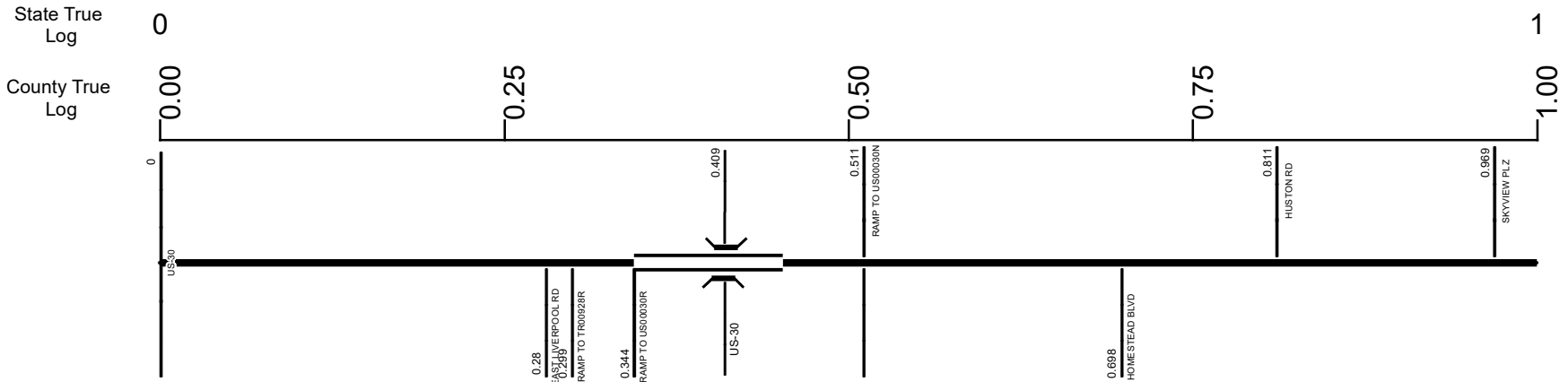

Surface Type & Width (Left / Right)						
	G 36'	G 48'	G 56'	G (20'/41')	G (30'/31')	G (20'/41')
0 - 0.28	0.28 - 0.344	0.344 - 0.452	0.452 - 0.609	0.609 - 0.831	0.831 - 0.89	0.89 - 1.444
Base Type (Left / Right)						
P			L	N / L	L	N / L
0 - 0.452			0.452 - 0.609	0.609 - 0.831	0.831 - 0.89	0.89 - 1.444
Shoulder Type & Width (Left / Right)						
5 (3'/3')		2 (8'/8')		2 (10'/10')		1 (0'/0')
0 - 0.28		0.28 - 0.344		0.344 - 0.609		0.609 - 1.444
Median Type and Width						
3 (3')						
0.344 - 0.452						
Through Lanes						
1		3		4		
0 - 0.28		0.28 - 0.344		0.344 - 1.713		
Street Name						
SR 170		EAST LIVERPOOL RD		SR 170		
0 - 0.28		0.28 - 0.344		0.344 - 11.499		

Non-divided Highway	Bridge (on route)	Railroad (at grade)	Intersection
Divided Highway	Underpass	Railroad (underpass)	
Secondary Segment	Overpass	Railroad (overpass)	
Corporation			

Created on: 6/24/2025



transportation.ohio.gov
 Prepared by
 The Ohio Department of Transportation
 Office of Technical Services
 Roadway Information

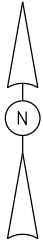
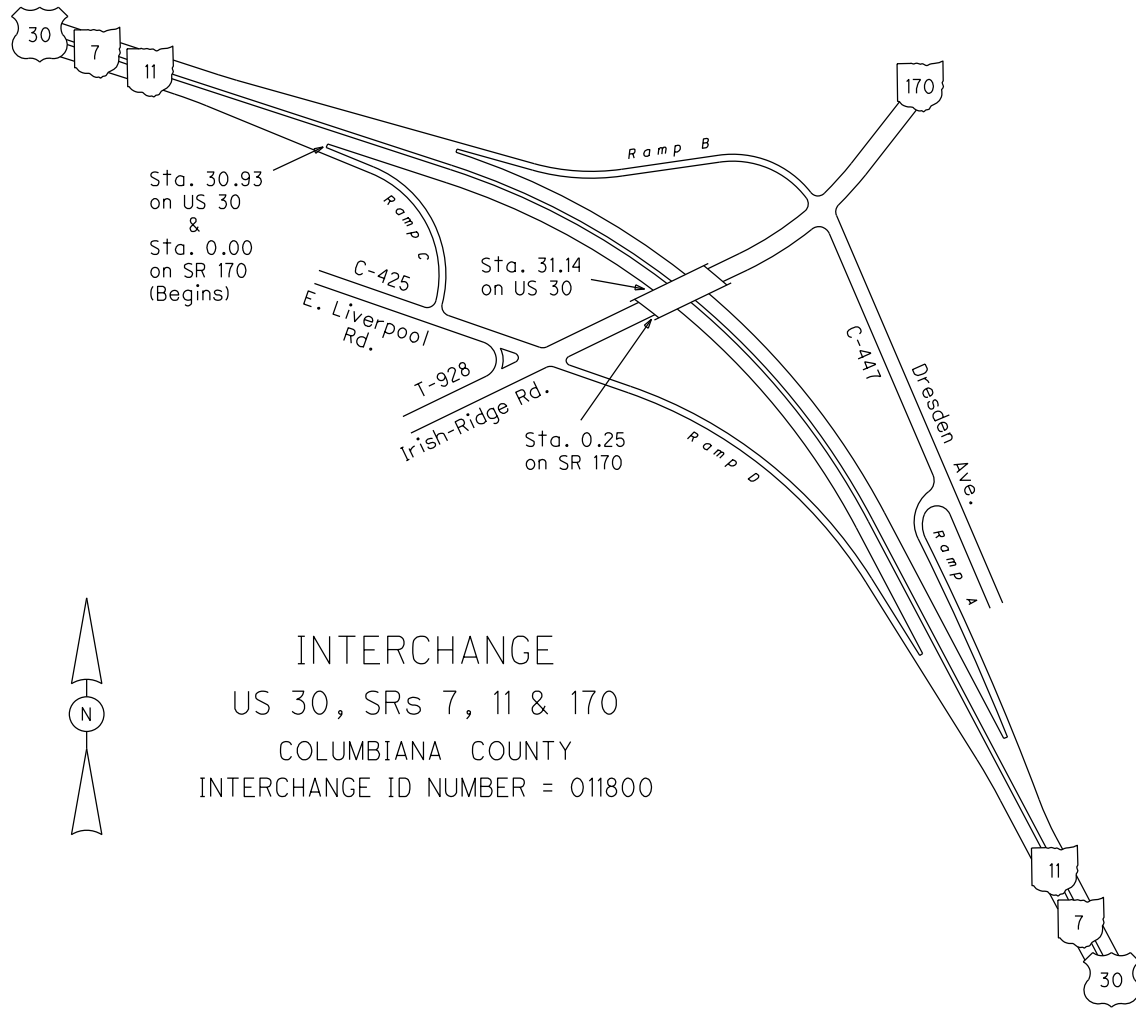

INTERCHANGE
 US 30, SRs 7, 11 & 170
 COLUMBIANA COUNTY
 INTERCHANGE ID NUMBER = 011800

SCOLSR00170**C

State True Log

2

County True Log

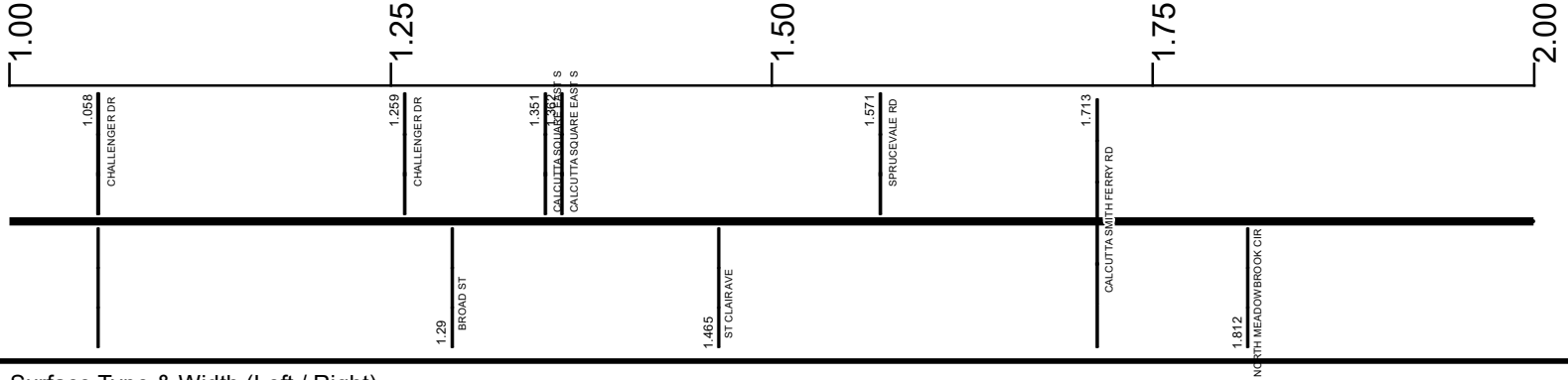

Surface Type & Width (Left / Right)

G (20'/41')	G (30'/31')	G 38'	G (18'/2')
0.89 - 1.444	1.444 - 1.713	1.713 - 1.873	1.873 - 10.81

Base Type (Left / Right)

N / L	L	N / L
0.89 - 1.444	1.444 - 1.873	1.873 - 10.81

Shoulder Type & Width (Left / Right)

1 (0'/0')	1 (0'/2')	5 (2'/2')
0.609 - 1.444	1.444 - 1.873	1.873 - 10.81

Through Lanes

4	2
0.344 - 1.713	1.713 - 11.499

Street Name

SR 170
0.344 - 11.499

- Non-divided Highway
- Divided Highway
- Secondary Segment
- Corporation
- Bridge (on route)
- Underpass
- Overpass
- Railroad (at grade)
- Railroad (underpass)
- Railroad (overpass)
- Intersection

Created on: 6/24/2025

transportation.ohio.gov

Prepared by
The Ohio Department of Transportation
Office of Technical Services
Roadway Information

SCOLSR00170**C

State True Log

County True Log

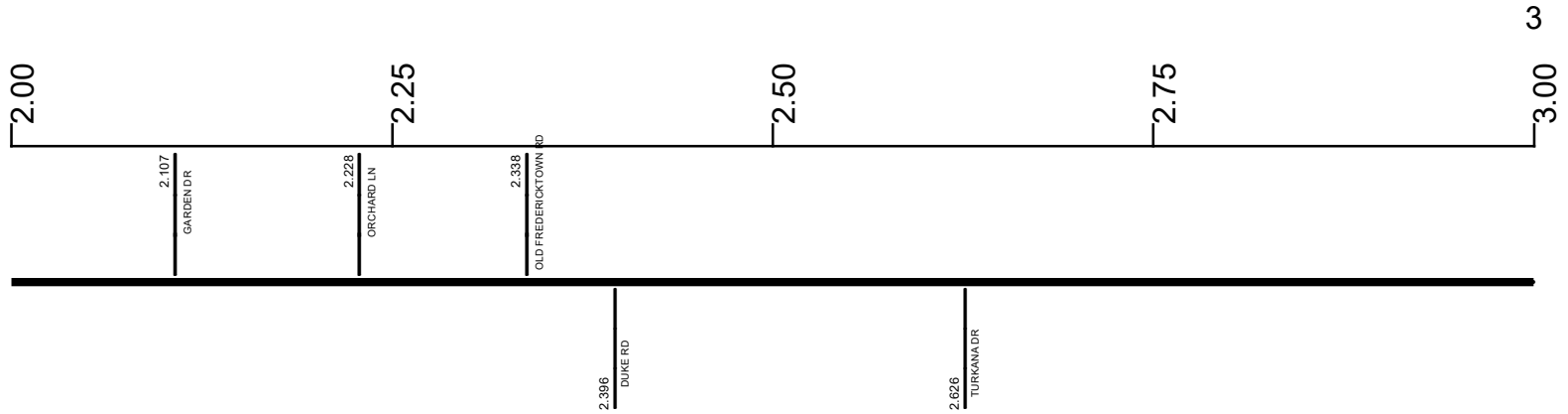

Surface Type & Width (Left / Right)

G (18'/2')
1.873 - 10.81

Base Type (Left / Right)

N / L
1.873 - 10.81

Shoulder Type & Width (Left / Right)

5 (2'/2')
1.873 - 10.81

Through Lanes

2
1.713 - 11.499

Street Name

SR 170
0.344 - 11.499

- Non-divided Highway
- Divided Highway
- Secondary Segment
- Corporation
- Bridge (on route)
- Underpass
- Overpass
- Railroad (at grade)
- Railroad (underpass)
- Railroad (overpass)
- Intersection

Created on: 6/24/2025

transportation.ohio.gov
Prepared by
The Ohio Department of Transportation
Office of Technical Services
Roadway Information

SCOLSR00170**C

State True Log

4

County True Log



Surface Type & Width (Left / Right)

	G (18/2')
	1.873 - 10.81

Base Type (Left / Right)

	N / L
	1.873 - 10.81

Shoulder Type & Width (Left / Right)

	5 (2/2')
	1.873 - 10.81

Through Lanes

	2
	1.713 - 11.499

Street Name

	SR 170
	0.344 - 11.499

- Non-divided Highway
- Divided Highway
- Secondary Segment
- Corporation
- Bridge (on route)
- Underpass
- Overpass
- Railroad (at grade)
- Railroad (underpass)
- Railroad (overpass)
- Intersection

Created on: 6/24/2025

transportation.ohio.gov

Prepared by
The Ohio Department of Transportation
Office of Technical Services
Roadway Information

SCOLSR00170**C

State True Log

5

County True Log

4.00

4.25

4.50

4.75

5.00

4.999
OLD FREDERICKTOWN RD

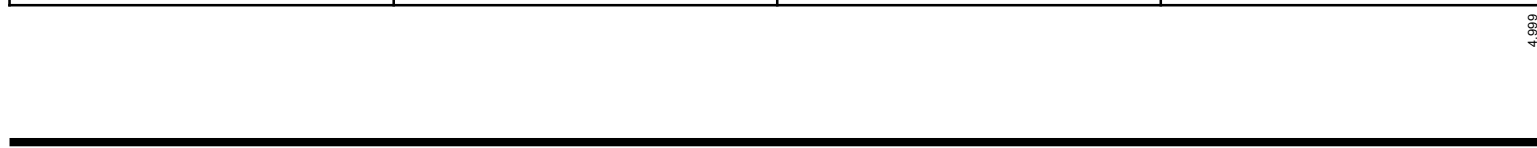

Surface Type & Width (Left / Right)

	G (18/2')
	1.873 - 10.81

Base Type (Left / Right)

	N / L
	1.873 - 10.81

Shoulder Type & Width (Left / Right)

	5 (2/2')
	1.873 - 10.81

Through Lanes

	2
	1.713 - 11.499

Street Name

	SR 170
	0.344 - 11.499

- | | | | |
|---------------------|-------------------|----------------------|--------------|
| Non-divided Highway | Bridge (on route) | Railroad (at grade) | Intersection |
| Divided Highway | Underpass | Railroad (underpass) | |
| Secondary Segment | Overpass | Railroad (overpass) | |
| Corporation | | | |

Created on: 6/24/2025

transportation.ohio.gov

Prepared by
The Ohio Department of Transportation
Office of Technical Services
Roadway Information

SCOLSR00170**C

State True Log

6

County True Log

5.00

5.25

5.50

5.75

6.00

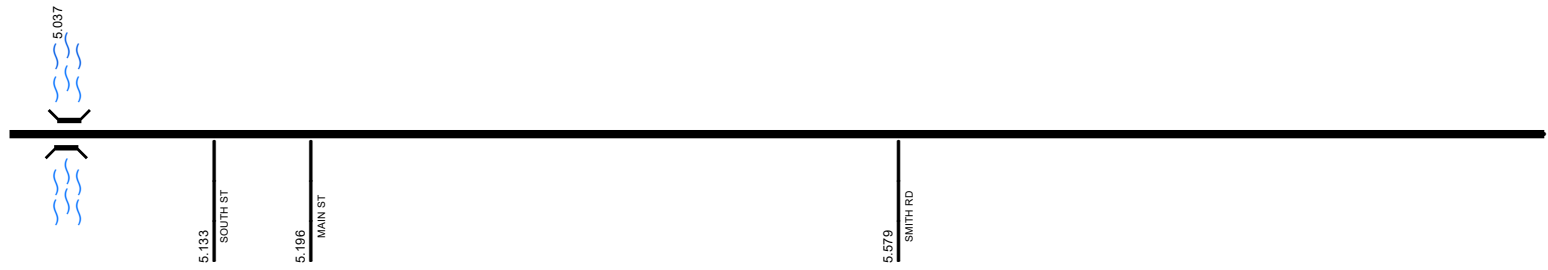

Surface Type & Width (Left / Right)	G (18/2')
	1.873 - 10.81
Base Type (Left / Right)	N / L
	1.873 - 10.81
Shoulder Type & Width (Left / Right)	5 (2/2')
	1.873 - 10.81
Through Lanes	2
	1.713 - 11.499
Street Name	SR 170
	0.344 - 11.499

Non-divided Highway	Bridge (on route)	Railroad (at grade)	Intersection
Divided Highway	Underpass	Railroad (underpass)	
Secondary Segment	Overpass	Railroad (overpass)	
Corporation			

Created on: 6/24/2025



transportation.ohio.gov
 Prepared by
 The Ohio Department of Transportation
 Office of Technical Services
 Roadway Information

SCOLSR00170**C

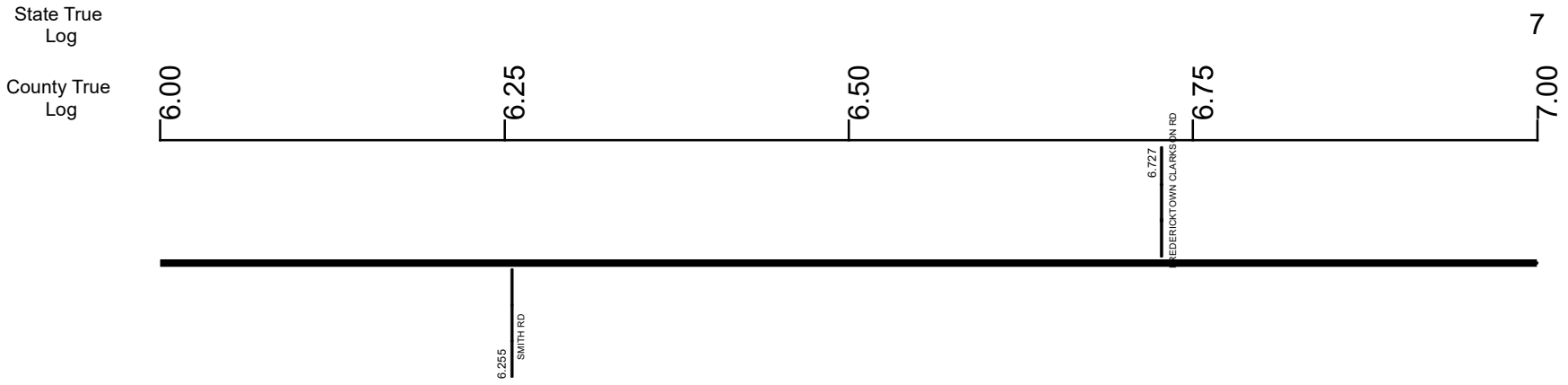

Surface Type & Width (Left / Right)	G (18/2')
	1.873 - 10.81
Base Type (Left / Right)	N / L
	1.873 - 10.81
Shoulder Type & Width (Left / Right)	5 (2/2')
	1.873 - 10.81
Through Lanes	2
	1.713 - 11.499
Street Name	SR 170
	0.344 - 11.499

Non-divided Highway	Bridge (on route)	Railroad (at grade)	Intersection
Divided Highway	Underpass	Railroad (underpass)	
Secondary Segment	Overpass	Railroad (overpass)	
Corporation			

Created on: 6/24/2025



transportation.ohio.gov

Prepared by
The Ohio Department of Transportation
Office of Technical Services
Roadway Information

SCOLSR00170**C

State True Log

8

County True Log

7.00

7.25

7.50

7.75

8.00



Surface Type & Width (Left / Right)

	G (18/2')
	1.873 - 10.81

Base Type (Left / Right)

	N / L
	1.873 - 10.81

Shoulder Type & Width (Left / Right)

	5 (2/2')
	1.873 - 10.81

Through Lanes

	2
	1.713 - 11.499

Street Name

	SR 170
	0.344 - 11.499

- | | | | |
|---------------------|-------------------|----------------------|--------------|
| Non-divided Highway | Bridge (on route) | Railroad (at grade) | Intersection |
| Divided Highway | Underpass | Railroad (underpass) | |
| Secondary Segment | Overpass | Railroad (overpass) | |
| Corporation | | | |

Created on: 6/24/2025

transportation.ohio.gov

Prepared by
The Ohio Department of Transportation
Office of Technical Services
Roadway Information

SCOLSR00170**C

State True Log

9

County True Log

8.00

8.25

8.50

8.75

9.00

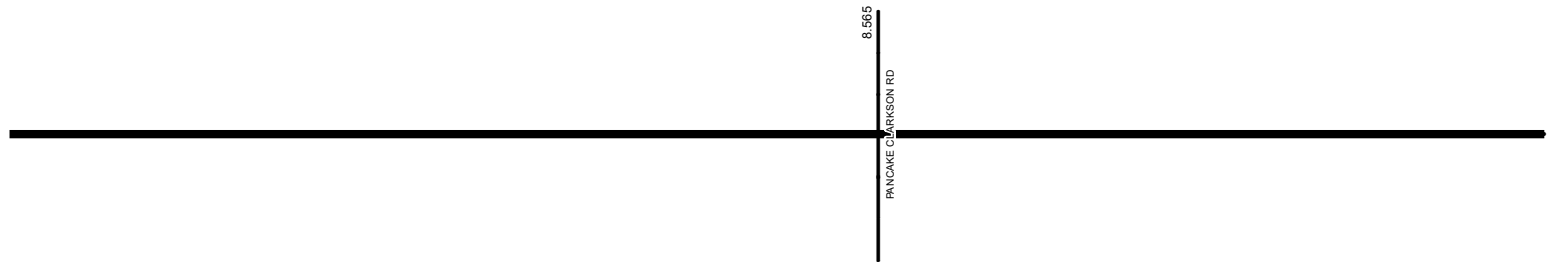

Surface Type & Width (Left / Right)

G (18/2')
1.873 - 10.81

Base Type (Left / Right)

N / L
1.873 - 10.81

Shoulder Type & Width (Left / Right)

5 (2/2')
1.873 - 10.81

Through Lanes

2
1.713 - 11.499

Street Name

SR 170
0.344 - 11.499

Non-divided Highway	Bridge (on route)	Railroad (at grade)	Intersection
Divided Highway	Underpass	Railroad (underpass)	
Secondary Segment	Overpass	Railroad (overpass)	
Corporation			

Created on: 6/24/2025



transportation.ohio.gov
 Prepared by
 The Ohio Department of Transportation
 Office of Technical Services
 Roadway Information

SCOLSR00170**C

State True Log

County True Log

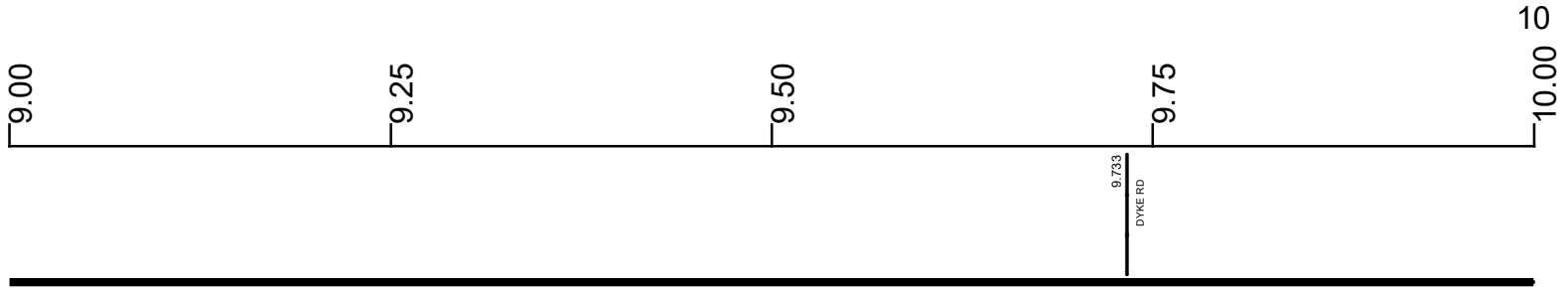

Surface Type & Width (Left / Right)

G (18/2')
1.873 - 10.81

Base Type (Left / Right)

N / L
1.873 - 10.81

Shoulder Type & Width (Left / Right)

5 (2/2')
1.873 - 10.81

Through Lanes

2
1.713 - 11.499

Street Name

SR 170
0.344 - 11.499

- | | | | |
|---------------------|-------------------|----------------------|--------------|
| Non-divided Highway | Bridge (on route) | Railroad (at grade) | Intersection |
| Divided Highway | Underpass | Railroad (underpass) | |
| Secondary Segment | Overpass | Railroad (overpass) | |
| Corporation | | | |

Created on: 6/24/2025

 transportation.ohio.gov
 Prepared by
 The Ohio Department of Transportation
 Office of Technical Services
 Roadway Information

SCOLSR00170**C

State True Log
County True Log

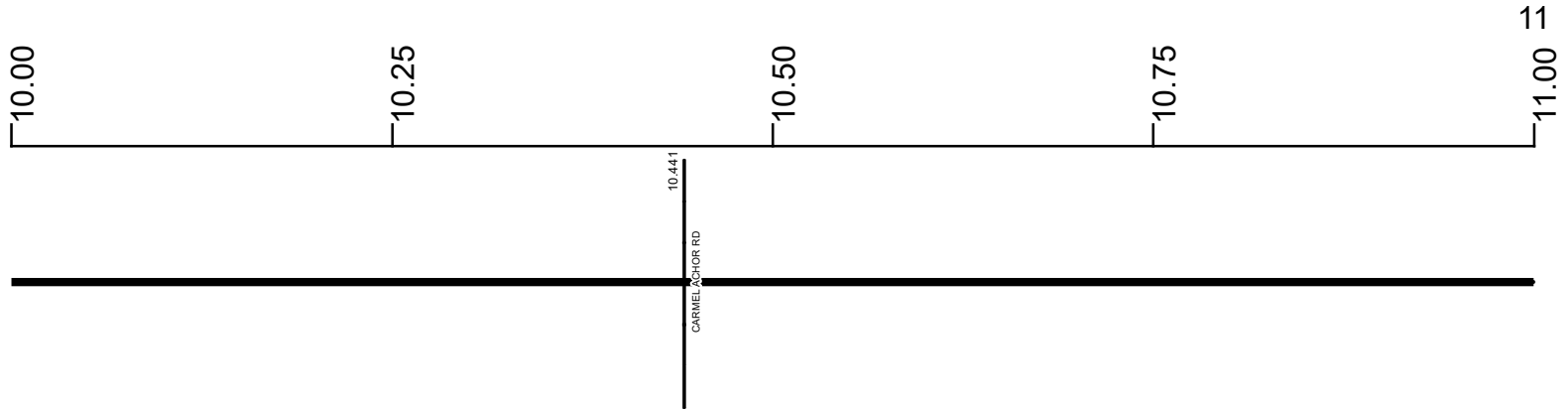

Surface Type & Width (Left / Right)

G (18'2')	G (10'/11')
1.873 - 10.81	10.81 - 11.278

Base Type (Left / Right)

N / L	N
1.873 - 10.81	10.81 - 11.278

Shoulder Type & Width (Left / Right)

5 (2'2')	5 (1'1')
1.873 - 10.81	10.81 - 11.278

Through Lanes

2
1.713 - 11.499

Street Name

SR 170
0.344 - 11.499

- Non-divided Highway
- Divided Highway
- Secondary Segment
- Corporation
- Bridge (on route)
- Underpass
- Overpass
- Railroad (at grade)
- Railroad (underpass)
- Railroad (overpass)
- Intersection

Created on: 6/24/2025



transportation.ohio.gov
Prepared by
The Ohio Department of Transportation
Office of Technical Services
Roadway Information

SCOLSR00170**C

State True Log
County True Log

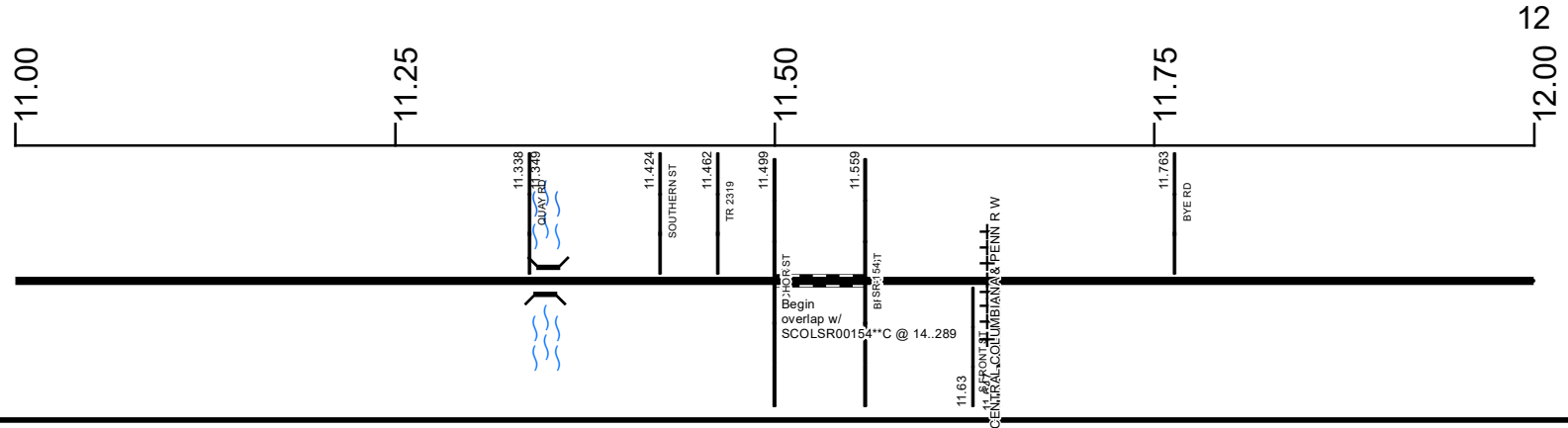

Surface Type & Width (Left / Right)

G (10'/11')	G (18'/4')
10.81 - 11.278	11.278 - 11.499

Base Type (Left / Right)

N	N / L
10.81 - 11.278	11.278 - 11.499

Shoulder Type & Width (Left / Right)

5 (1'/1')	5 (2'/2')
10.81 - 11.278	11.278 - 11.499

Through Lanes

2
1.713 - 11.499

Street Name

SR 170
0.344 - 11.499

Surface Type & Width (Left / Right)

G 20'
11.559 - 13.7

Base Type (Left / Right)

K
11.559 - 13.7

Shoulder Type & Width (Left / Right)

5 (2'/2')
11.559 - 14.396

Through Lanes

2
11.559 - 15.088

BROWN ST	SR 170
11.559 - 11.647	11.647 - 14.539

- Non-divided Highway
- Divided Highway
- Secondary Segment
- Corporation
- Bridge (on route)
- Underpass
- Overpass
- Railroad (at grade)
- Railroad (underpass)
- Railroad (overpass)
- Intersection

Created on: 6/24/2025



transportation.ohio.gov
Prepared by
The Ohio Department of Transportation
Office of Technical Services
Roadway Information

SCOLSR00170**C

State True Log

County True Log

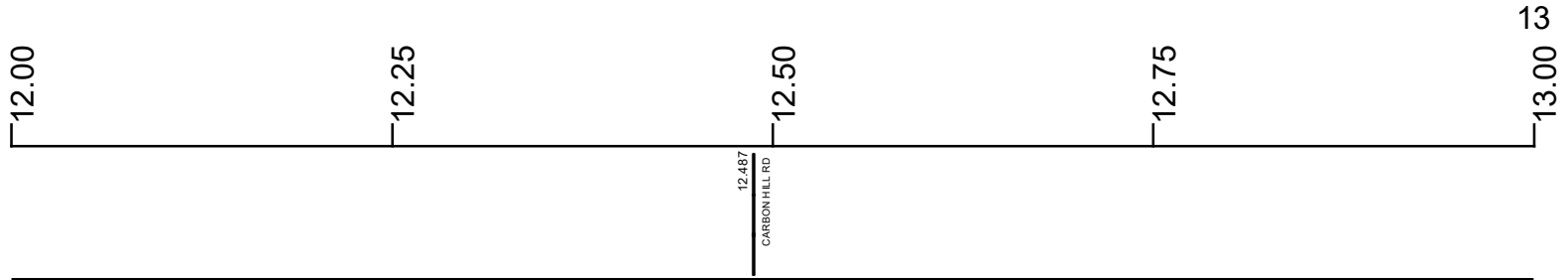

Surface Type & Width (Left / Right)

G 20'
11.559 - 13.7

Base Type (Left / Right)

K
11.559 - 13.7

Shoulder Type & Width (Left / Right)

5 (2/2)
11.559 - 14.396

Through Lanes

2
11.559 - 15.088

Street Name

SR 170
11.647 - 14.539

- | | | | |
|---------------------|-------------------|----------------------|--------------|
| Non-divided Highway | Bridge (on route) | Railroad (at grade) | Intersection |
| Divided Highway | Underpass | Railroad (underpass) | |
| Secondary Segment | Overpass | Railroad (overpass) | |
| Corporation | | | |

Created on: 6/24/2025



transportation.ohio.gov
Prepared by
The Ohio Department of Transportation
Office of Technical Services
Roadway Information

SCOLSR00170**C

State True Log

14

County True Log

13.00

13.25

13.50

13.75

14.00



Surface Type & Width (Left / Right)

G 20' 11.559 - 13.7	G (16'/4') 13.7 - 14.515
------------------------	-----------------------------

Base Type (Left / Right)

K 11.559 - 13.7	N / K 13.7 - 14.515
--------------------	------------------------

Shoulder Type & Width (Left / Right)

5 (2'/2') 11.559 - 14.396

Through Lanes

2 11.559 - 15.088

Street Name

SR 170 11.647 - 14.539

- Non-divided Highway
 Bridge (on route)
 Railroad (at grade)
 Intersection
- Divided Highway
 Underpass
 Railroad (underpass)
- Secondary Segment
 Overpass
 Railroad (overpass)
- Corporation**

Created on: 6/24/2025



transportation.ohio.gov

Prepared by
The Ohio Department of Transportation
Office of Technical Services
Roadway Information

SCOLSR00170**C

State True Log
County True Log

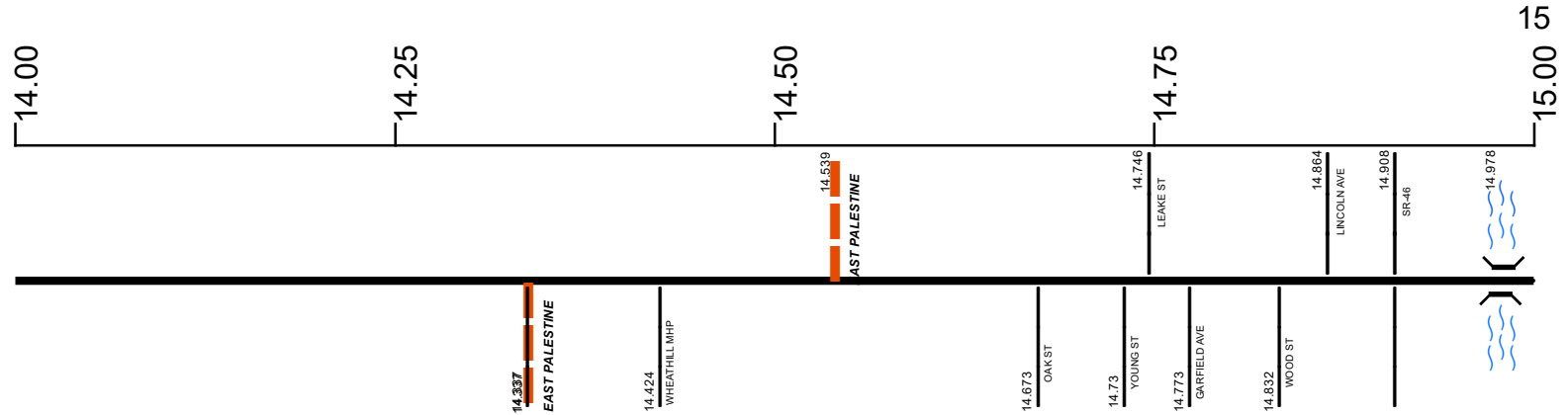

Surface Type & Width (Left / Right)

G (16'4")	G 20'	G 26'	G 38'	G 42'
13.7 - 14.515	14.515 - 14.574	14.574 - 14.773	14.773 - 14.865	14.865 - 15.088

Base Type (Left / Right)

N / K	R
13.7 - 14.515	14.515 - 15.088

Shoulder Type & Width (Left / Right)

5 (2'2")	2 (2'2")	1 (0'0")
11.559 - 14.396	14.396 - 14.574	14.574 - 15.088

Through Lanes

2
11.559 - 15.088

Street Name

SR 170	S MARKET ST	N MARKET ST
11.647 - 14.539	14.539 - 14.908	14.908 - 15.088

- Non-divided Highway
- Divided Highway
- Secondary Segment
- Corporation
- Bridge (on route)
- Underpass
- Overpass
- Railroad (at grade)
- Railroad (underpass)
- Railroad (overpass)
- Intersection

Created on: 6/24/2025



transportation.ohio.gov
Prepared by
The Ohio Department of Transportation
Office of Technical Services
Roadway Information

SCOLSR00170**C

State True Log
County True Log

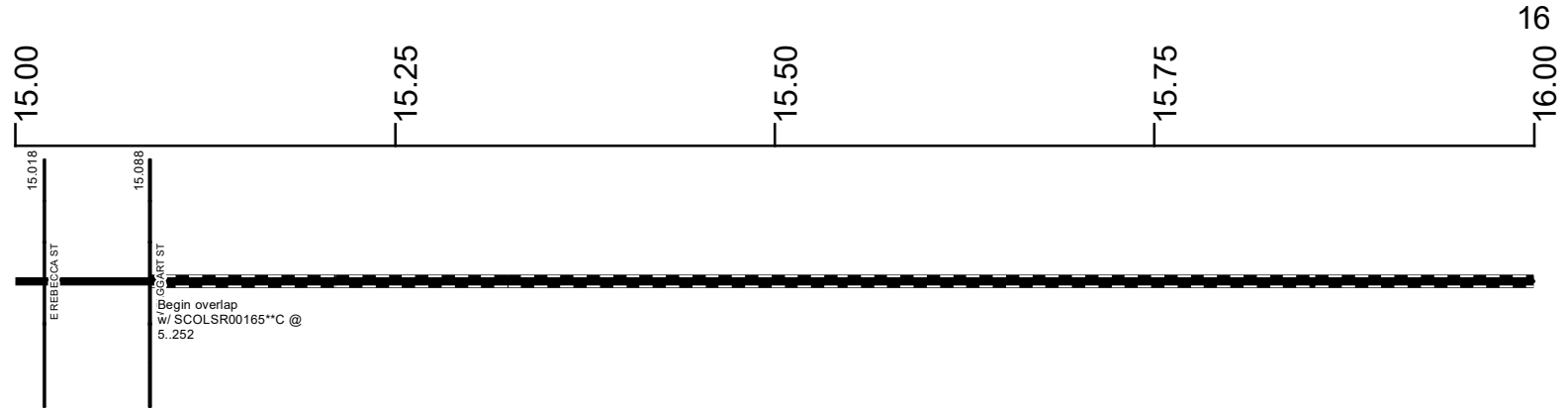

Surface Type & Width (Left / Right)

G 42'
14.865 - 15.088

Base Type (Left / Right)

R
14.515 - 15.088

Shoulder Type & Width (Left / Right)

1 (0'/0')
14.574 - 15.088

Through Lanes

2
11.559 - 15.088

Street Name

N MARKET ST
14.908 - 15.088

- | | | | |
|---------------------|-------------------|----------------------|--------------|
| Non-divided Highway | Bridge (on route) | Railroad (at grade) | Intersection |
| Divided Highway | Underpass | Railroad (underpass) | |
| Secondary Segment | Overpass | Railroad (overpass) | |
| Corporation | | | |

Created on: 6/24/2025



transportation.ohio.gov
Prepared by
The Ohio Department of Transportation
Office of Technical Services
Roadway Information

SCOLSR00170**C

State True Log

County True Log

16.00

16.25

16.50

16.75

17
17.00



Begin overlap w/
SCOLSR0014**C
@ 17.527

- | | | | |
|---------------------|-------------------|----------------------|--------------|
| Non-divided Highway | Bridge (on route) | Railroad (at grade) | Intersection |
| Divided Highway | Underpass | Railroad (underpass) | |
| Secondary Segment | Overpass | Railroad (overpass) | |
| Corporation | | | |

Created on: 6/24/2025

transportation.ohio.gov

Prepared by
The Ohio Department of Transportation
Office of Technical Services
Roadway Information

SCOLSR00170**C

State True Log
County True Log

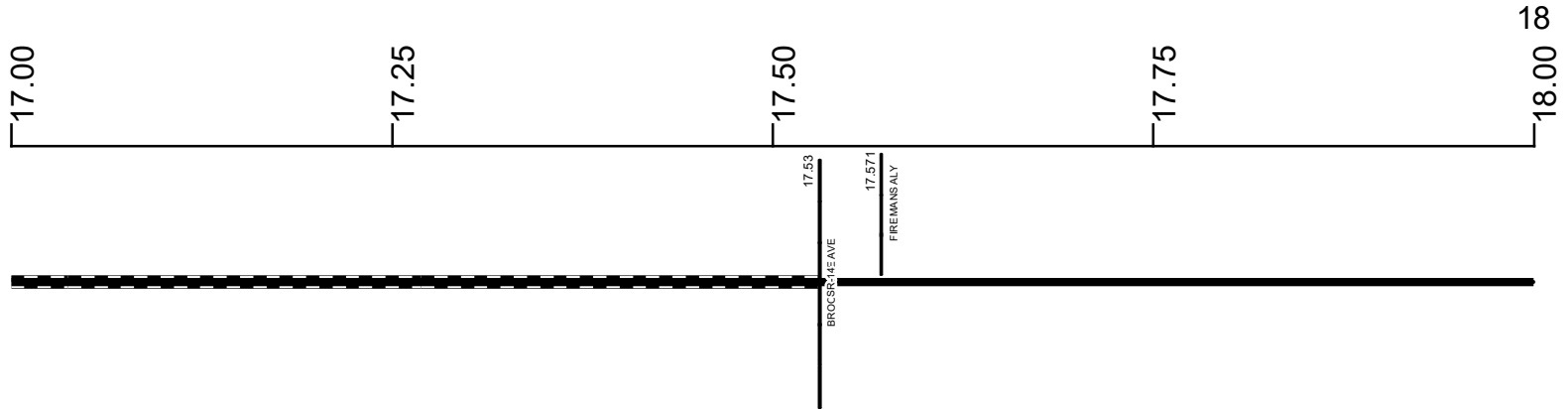

Surface Type & Width (Left / Right)

G (18'/4')
17.53 - 18.677

Base Type (Left / Right)

I / K
17.53 - 18.677

Shoulder Type & Width (Left / Right)

5 (17'1')
17.53 - 18.677

Through Lanes

2
17.53 - 20.436

Street Name

SR 170
17.53 - 20.436

- Non-divided Highway
- Divided Highway
- Secondary Segment
- Corporation
- Bridge (on route)
- Underpass
- Overpass
- Railroad (at grade)
- Railroad (underpass)
- Railroad (overpass)
- Intersection

Created on: 6/24/2025

transportation.ohio.gov
Prepared by
The Ohio Department of Transportation
Office of Technical Services
Roadway Information

SCOLSR00170**C

State True Log

County True Log

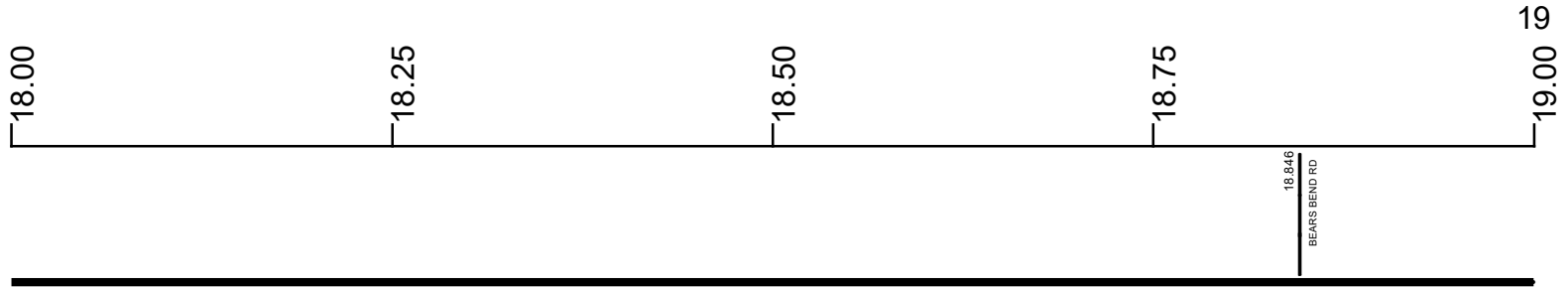

Surface Type & Width (Left / Right)

G (18'4") 17.53 - 18.677	G 24' 18.677 - 19.172
-----------------------------	--------------------------

Base Type (Left / Right)

I / K 17.53 - 18.677	L 18.677 - 19.172
-------------------------	----------------------

Shoulder Type & Width (Left / Right)

5 (1'1") 17.53 - 18.677	5 (4'4") 18.677 - 19.172
----------------------------	-----------------------------

Through Lanes

2 17.53 - 20.436

Street Name

SR 170 17.53 - 20.436

- Non-divided Highway
- Divided Highway
- Secondary Segment
- Corporation
- Bridge (on route)
- Underpass
- Overpass
- Railroad (at grade)
- Railroad (underpass)
- Railroad (overpass)
- Intersection

Created on: 6/24/2025

transportation.ohio.gov
Prepared by
The Ohio Department of Transportation
Office of Technical Services
Roadway Information

SCOLSR00170**C

State True Log
County True Log

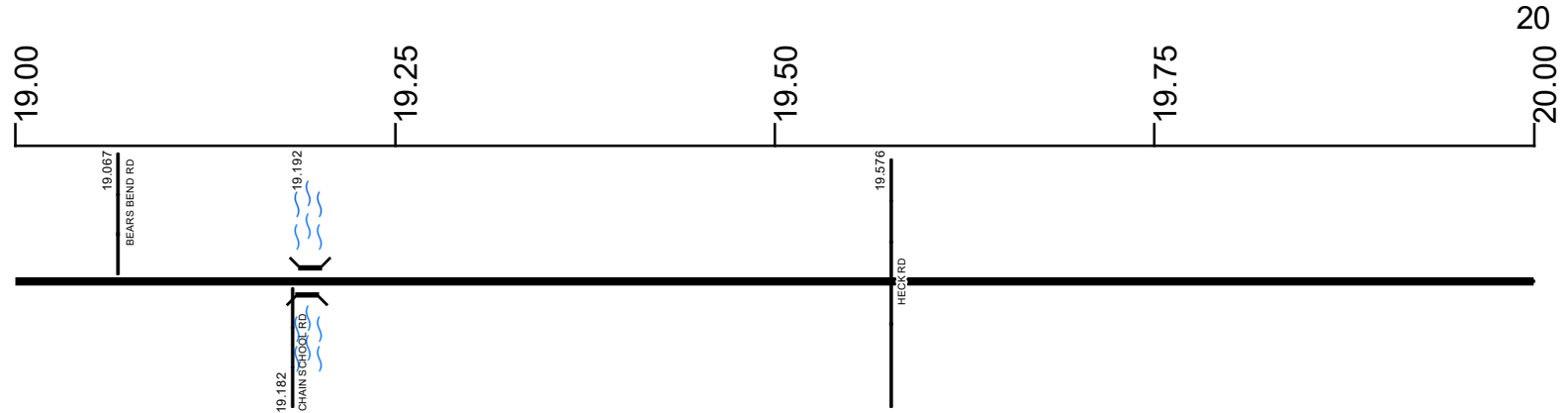

Surface Type & Width (Left / Right)

G 24' 18.677 - 19.172	G 22' 19.172 - 20.131
--------------------------	--------------------------

Base Type (Left / Right)

L 18.677 - 19.172	K 19.172 - 20.131
----------------------	----------------------

Shoulder Type & Width (Left / Right)

5 (4/4') 18.677 - 19.172	5 (1/1') 19.172 - 20.436
-----------------------------	-----------------------------

Through Lanes

	2 17.53 - 20.436
--	---------------------

Street Name

	SR 170 17.53 - 20.436
--	--------------------------

- Non-divided Highway
- Divided Highway
- Secondary Segment
- Corporation
- Bridge (on route)
- Underpass
- Overpass
- Railroad (at grade)
- Railroad (underpass)
- Railroad (overpass)
- Intersection

Created on: 6/24/2025

transportation.ohio.gov

Prepared by
The Ohio Department of Transportation
Office of Technical Services
Roadway Information

SCOLSR00170**C

20.436

State True Log

County True Log



Surface Type & Width (Left / Right)

G 22'	G (18'3')
19.172 - 20.131	20.131 - 20.436

Base Type (Left / Right)

K	K / I
19.172 - 20.131	20.131 - 20.436

Shoulder Type & Width (Left / Right)

5 (1'1')
19.172 - 20.436

Through Lanes

2
17.53 - 20.436

Street Name

SR 170
17.53 - 20.436

- Non-divided Highway
- Divided Highway
- Secondary Segment
- Corporation
- Bridge (on route)
- Underpass
- Overpass
- Railroad (at grade)
- Railroad (underpass)
- Railroad (overpass)
- Intersection

Created on: 6/24/2025

transportation.ohio.gov
 Prepared by
 The Ohio Department of Transportation
 Office of Technical Services
 Roadway Information

Historical Project List for SCOLSR00170**C

Begin Measure	End Measure	Project ID Number	Construction Completion Date	Treatment Category	Treatment Type
0.139	1.455	19118	6-2002	Minor Rehabilitation	60-AC Overlay w/Rpr
0.280	1.873	91842	5-2021	Minor Rehabilitation	60-AC Overlay w/Rpr
1.455	11.499	76422	11-2006	Minor Rehabilitation	60-AC Overlay w/Rpr
1.873	2.713	97622	11-2019	Minor Rehabilitation	38-Fine Poly AC Overlay
2.713	11.499	97622	11-2019	Minor Rehabilitation	38-Fine Poly AC Overlay
11.559	14.396	112913	5-2023	Minor Rehabilitation	60-AC Overlay w/Rpr
11.559	14.347	90229	1-2012	Minor Rehabilitation	60-AC Overlay w/Rpr
14.347	15.088	84016	10-2012	Minor Rehabilitation	60-AC Overlay w/Rpr
17.530	20.436	91841	8-2017	Minor Rehabilitation	60-AC Overlay w/Rpr
17.530	20.436	80992	11-2007	Minor Rehabilitation	38-Fine Poly AC Overlay

Roadway Codes

Access Control Journalized

- F - Full Access Control
- L - Limited Access Control
- N - No Access Control

Access Control Operational

- 1 - Full Access Control
- 2 - Partial Access Control
- 3 - No Access Control

Base Type

- F - Crack and Seat
- H - Rubblize and Roll
- I - Aggregate Base 304 or Traffic Compacted
- K - Water Bound Macadam
- L - Bituminous Concrete Mix or Penetration Macadam
- N - Plain Concrete
- P - Reinforced Concrete
- R - Brick (Flexible)
- T - Brick (Rigid)

Direction of Travel

- B - Both (Two-way)
- F - One-way Cardinal
- T - One-way Non-cardinal

Facility Type

- 1 - One-way Roadway
- 2 - Two-way Roadway
- 4 - Ramp
- 5 - Non-mainline
- 6 - Non-inventory Direction
- 7 - Planned / Unbuilt

Historical Federal Aid Indicator

- N - Not a FAP Route
- Y - FAP Route

Functional Classification

- 01 - Interstate
- 02 - Principal Arterial (Freeways)
- 03 - Principal Arterial (Other)
- 04 - Minor Arterial
- 05 - Major Collector
- 06 - Minor Collector
- 07 - Local

Leave / Reenter Indicator

- Y - Route leaves/reenters at this point
- N - Route does not leave/reenter at this point

Median Type

- 1 - None
- 2 - Unprotected
- 3 - Curbed
- 4 - Positive Barrier (Unspecified)
- 5 - Positive Barrier (Flexible)
- 6 - Positive Barrier (Semi-rigid)
- 7 - Positive Barrier (Rigid)

NHS

- N - National Highway System
- H - Congressional Corridor
- 2 - Major Airport
- 3 - Major Port Facility
- 4 - Major Amtrak Station
- 5 - Major Rail / Truck Terminal
- 6 - Major Intercity Bus Terminal
- 7 - Major Public Transit / Multi-modal Passenger Terminal
- 8 - Major Pipeline Terminal
- 9 - Major Ferry Terminal

Priority System

- G - General
- P - Priority System
- U - Urban

Scenic Byway Code

- A - All American Road
- N - National Scenic Byway
- S - State Scenic Byway

Shoulder Type

- 1 - None
- 2 - Surfaced shoulder exists (bituminous concrete {AC})
- 3 - Surfaced shoulder exists (Portland Cement Concrete {PCC})
- 4 - Stabilized shoulder exists (gravel or other granular material)
- 5 - Combination shoulder exists (two or more surface types)
- 6 - Earth shoulder exists
- 7 - Barrier curb exists; no shoulder in front of curb

Surface Type

- A - Combination
- B - Brick
- C - Continuous Reinforced Concrete
- D - Reinforced Concrete
- E - Plain Concrete
- G - Bituminous Concrete
- I - Chipseal on Granular
- K - Open Graded Bituminous
- L - Chipseal or Micro
- M - Gravel
- U - Unimproved
- X - Right of Way Only