

SCOLSR00644**C

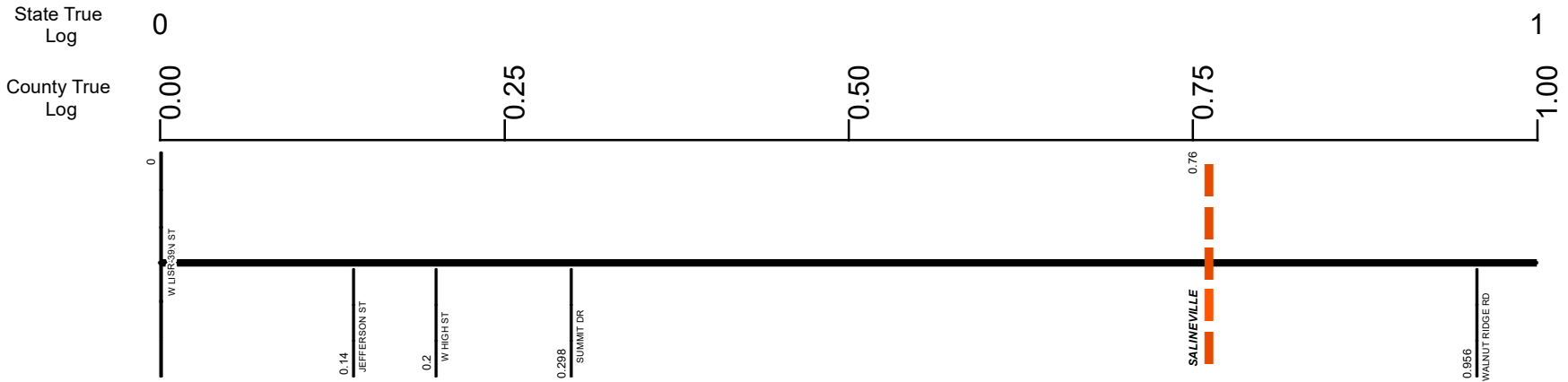

Surface Type & Width (Left / Right)

G 24'	G (16'6")	G (16'4")
0 - 0.08	0.08 - 0.777	0.777 - 4.946

Base Type (Left / Right)

R	N / L	
0 - 0.08	0.08 - 4.946	

Shoulder Type & Width (Left / Right)

1 (0'0")	5 (2'2")	4 (0'0")
0 - 0.08	0.08 - 0.777	0.777 - 4.643

Resurface Year

	2022	
	0 - 0.777	

Through Lanes

	2	
	0 - 11.163	

Street Name

W MAIN ST	HANOVER RD	SUMMITVILLE RD	SR 644
0 - 0.075	0.075 - 0.2	0.2 - 0.76	0.76 - 11.163

- Non-divided Highway
- Divided Highway
- Secondary Segment
- Corporation
- Bridge (on route)
- Underpass
- Overpass
- Railroad (at grade)
- Railroad (underpass)
- Railroad (overpass)
- Intersection

Created on: 6/24/2025

transportation.ohio.gov

Prepared by
The Ohio Department of Transportation
Office of Technical Services
Roadway Information

SCOLSR00644**C

State True Log

2

County True Log

1.00

1.25

1.50

1.75

2.00

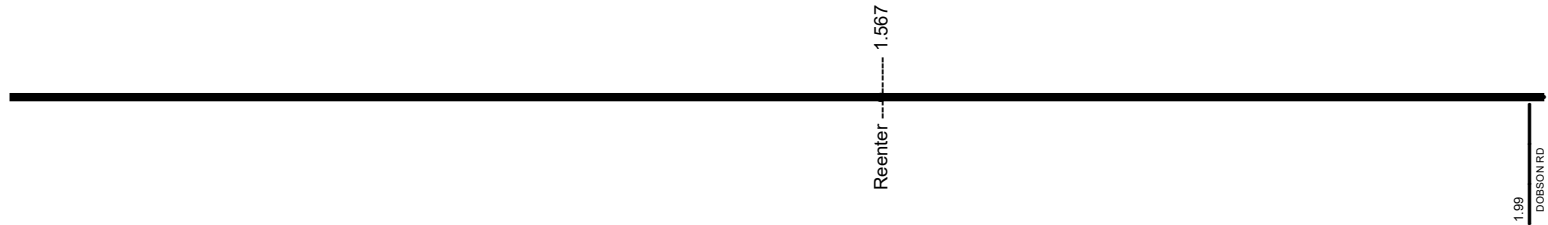

Surface Type & Width (Left / Right)

G (16'4')
0.777 - 4.946

Base Type (Left / Right)

N / L
0.08 - 4.946

Shoulder Type & Width (Left / Right)

4 (0'0')
0.777 - 4.643

Resurface Year

2022
1.567 - 3.943

Through Lanes

2
0 - 11.163

Street Name

SR 644
0.76 - 11.163

- Non-divided Highway
 Bridge (on route)
 Railroad (at grade)
 Intersection
- Divided Highway
 Underpass
 Railroad (underpass)
- Secondary Segment
 Overpass
 Railroad (overpass)
- Corporation**

Created on: 6/24/2025



transportation.ohio.gov

Prepared by
The Ohio Department of Transportation
Office of Technical Services
Roadway Information

SCOLSR00644**C

State True Log

3

County True Log



Surface Type & Width (Left / Right)

G (16'/4')
0.777 - 4.946

Base Type (Left / Right)

N / L
0.08 - 4.946

Shoulder Type & Width (Left / Right)

4 (0'/0')
0.777 - 4.643

Resurface Year

2022
1.567 - 3.943

Through Lanes

2
0 - 11.163

Street Name

SR 644
0.76 - 11.163

- Non-divided Highway
- Divided Highway
- Secondary Segment
- Corporation
- Bridge (on route)
- Underpass
- Overpass
- Railroad (at grade)
- Railroad (underpass)
- Railroad (overpass)
- Intersection

Created on: 6/24/2025

transportation.ohio.gov

Prepared by
The Ohio Department of Transportation
Office of Technical Services
Roadway Information

SCOLSR00644**C

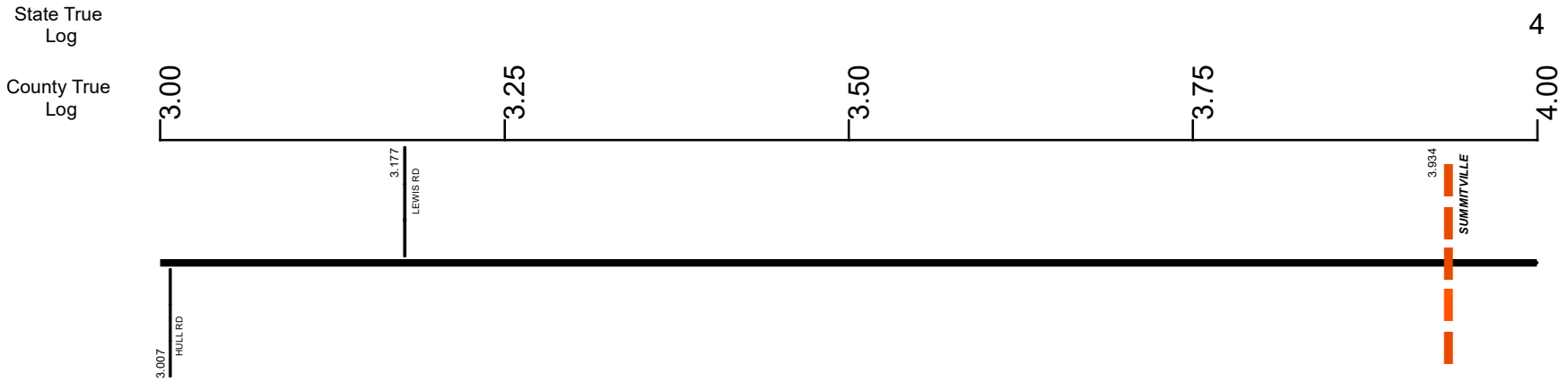

Surface Type & Width (Left / Right)	G (16'/4')	
	0.777 - 4.946	
Base Type (Left / Right)	N / L	
	0.08 - 4.946	
Shoulder Type & Width (Left / Right)	4 (0'/0')	
	0.777 - 4.643	
Resurface Year	2022	2024
Through Lanes	1.567 - 3.943	3.943 - 11.163
	2	
	0 - 11.163	
Street Name	SR 644	
	0.76 - 11.163	

- Non-divided Highway
- Divided Highway
- Secondary Segment
- Corporation
- Bridge (on route)
- Underpass
- Overpass
- Railroad (at grade)
- Railroad (underpass)
- Railroad (overpass)
- Intersection

Created on: 6/24/2025



transportation.ohio.gov
Prepared by
The Ohio Department of Transportation
Office of Technical Services
Roadway Information

SCOLSR00644**C

State True Log

County True Log

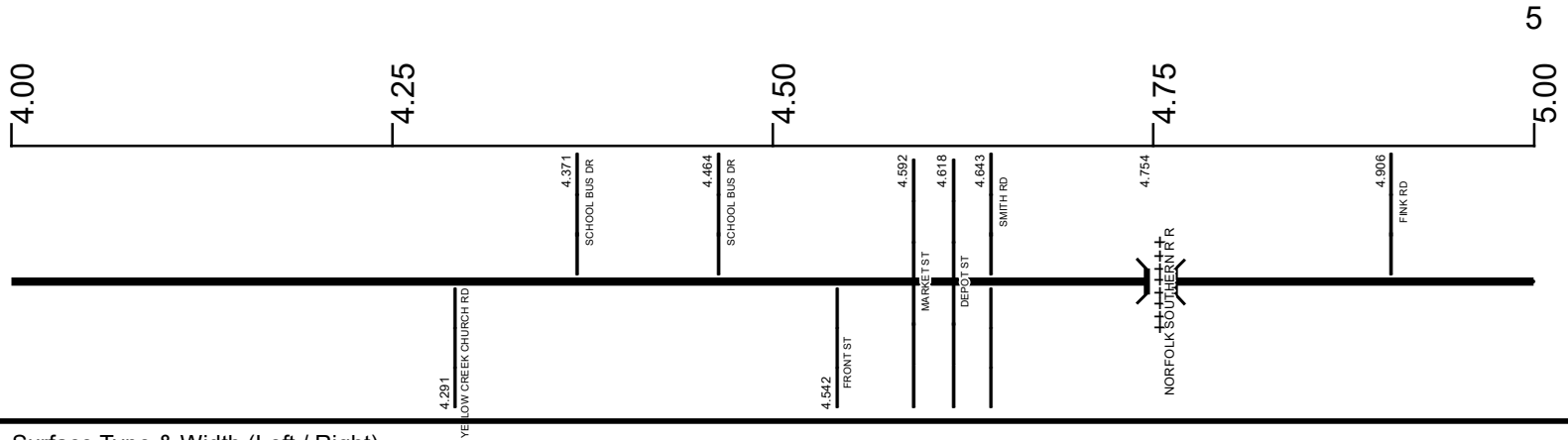

Surface Type & Width (Left / Right)

G (16'4")	G 20'
0.777 - 4.946	4.946 - 10.844

Base Type (Left / Right)

N / L	N
0.08 - 4.946	4.946 - 9.997

Shoulder Type & Width (Left / Right)

4 (0'0")	5 (2'2")	4 (0'0")
0.777 - 4.643	4.643 - 4.946	4.946 - 5.217

Resurface Year

2024	
3.943 - 11.163	

Through Lanes

2	
0 - 11.163	

Street Name

SR 644	
0.76 - 11.163	

- Non-divided Highway
- Divided Highway
- Secondary Segment
- Corporation
- Bridge (on route)
- Underpass
- Overpass
- Railroad (at grade)
- Railroad (underpass)
- Railroad (overpass)
- Intersection

Created on: 6/24/2025

transportation.ohio.gov

Prepared by
The Ohio Department of Transportation
Office of Technical Services
Roadway Information

SCOLSR00644**C

State True Log

County True Log

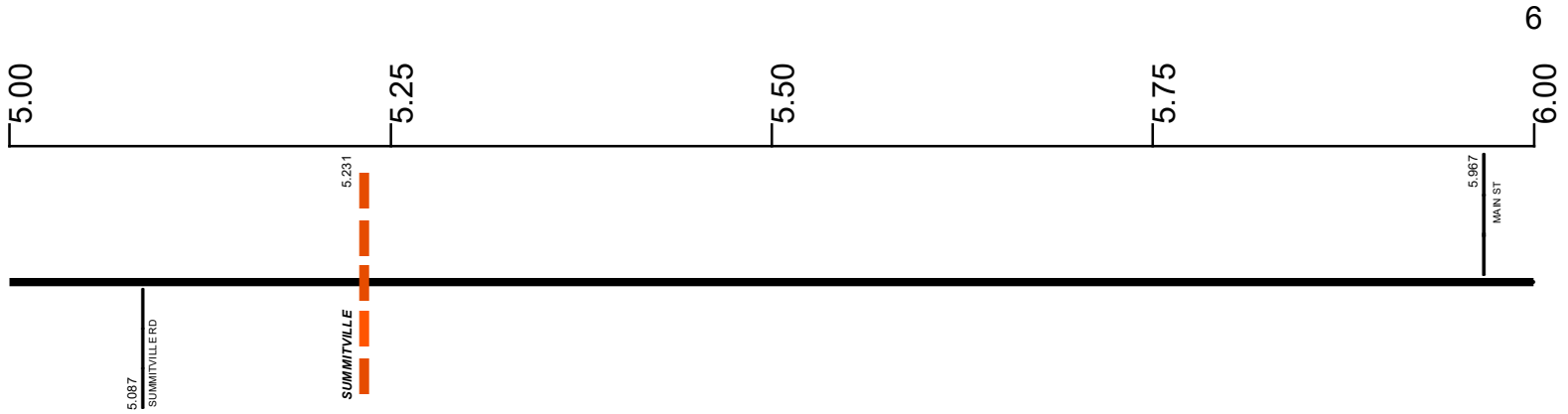

Surface Type & Width (Left / Right)		
G 20'		
4.946 - 10.844		
Base Type (Left / Right)		
N		
4.946 - 9.997		
Shoulder Type & Width (Left / Right)		
4 (0'/0')	5 (1'1")	4 (0'/0')
4.946 - 5.217	5.217 - 5.597	5.597 - 9.432
Resurface Year		
2024		
3.943 - 11.163		
Through Lanes		
2		
0 - 11.163		
Street Name		
SR 644		
0.76 - 11.163		

Non-divided Highway	Bridge (on route)	Railroad (at grade)	Intersection
Divided Highway	Underpass	Railroad (underpass)	
Secondary Segment	Overpass	Railroad (overpass)	
Corporation			

Created on: 6/24/2025



transportation.ohio.gov
 Prepared by
 The Ohio Department of Transportation
 Office of Technical Services
 Roadway Information

SCOLSR00644**C

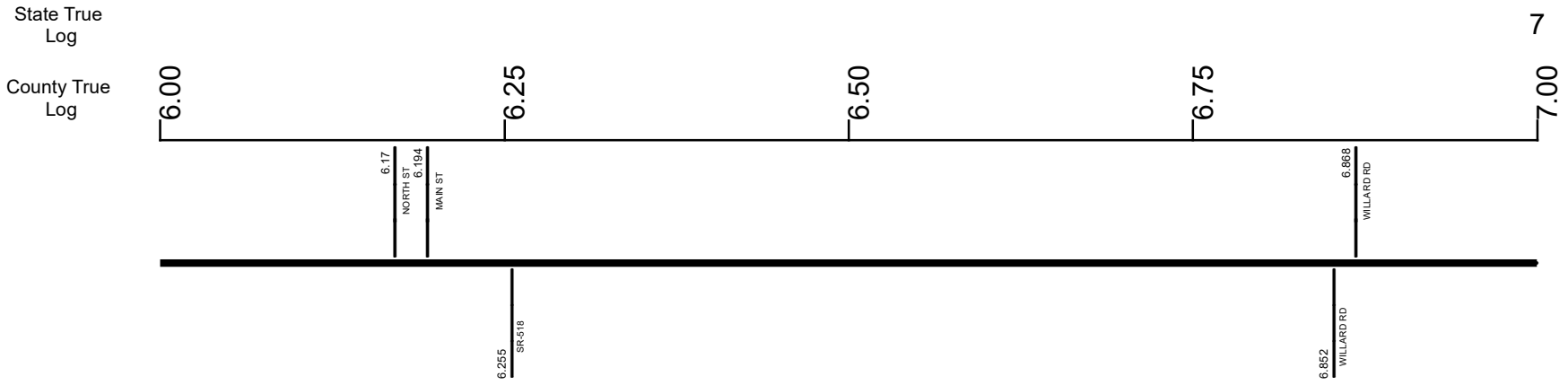

Surface Type & Width (Left / Right)	G 20' 4.946 - 10.844
Base Type (Left / Right)	N 4.946 - 9.997
Shoulder Type & Width (Left / Right)	4 (0'/0') 5.597 - 9.432
Resurface Year	2024
Through Lanes	2 3.943 - 11.163
Street Name	SR 644 0.76 - 11.163

Non-divided Highway	Bridge (on route)	Railroad (at grade)	Intersection
Divided Highway	Underpass	Railroad (underpass)	
Secondary Segment	Overpass	Railroad (overpass)	
Corporation			

Created on: 6/24/2025



transportation.ohio.gov

Prepared by
The Ohio Department of Transportation
Office of Technical Services
Roadway Information

SCOLSR00644**C

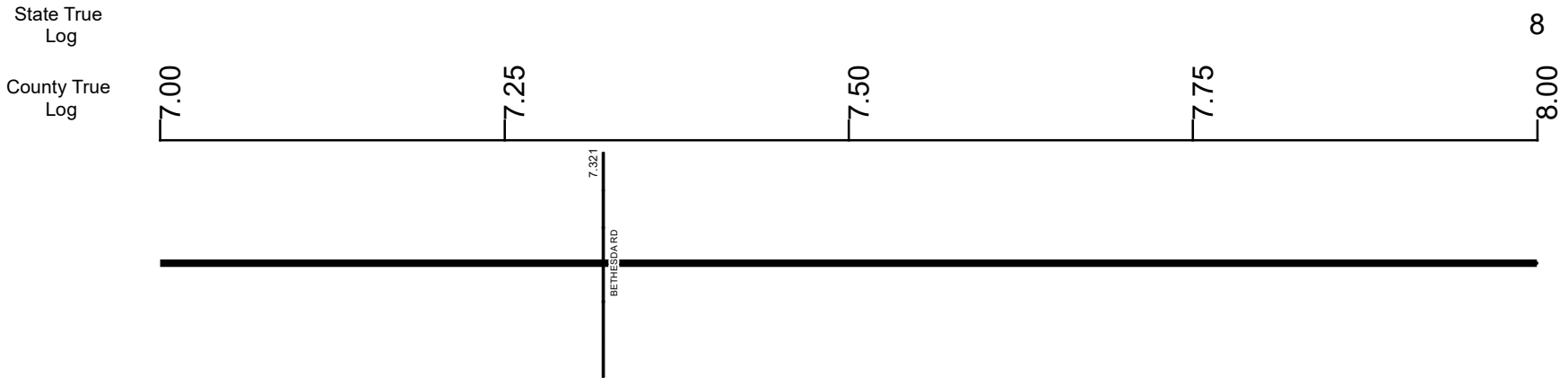

Surface Type & Width (Left / Right)	G 20' 4.946 - 10.844
Base Type (Left / Right)	N 4.946 - 9.997
Shoulder Type & Width (Left / Right)	4 (0'/0') 5.597 - 9.432
Resurface Year	2024 3.943 - 11.163
Through Lanes	2 0 - 11.163
Street Name	SR 644 0.76 - 11.163

- Non-divided Highway
- Divided Highway
- Secondary Segment
- Corporation
- Bridge (on route)
- Underpass
- Overpass
- Railroad (at grade)
- Railroad (underpass)
- Railroad (overpass)
- Intersection

Created on: 6/24/2025



transportation.ohio.gov
Prepared by
The Ohio Department of Transportation
Office of Technical Services
Roadway Information

SCOLSR00644**C

State True Log

County True Log

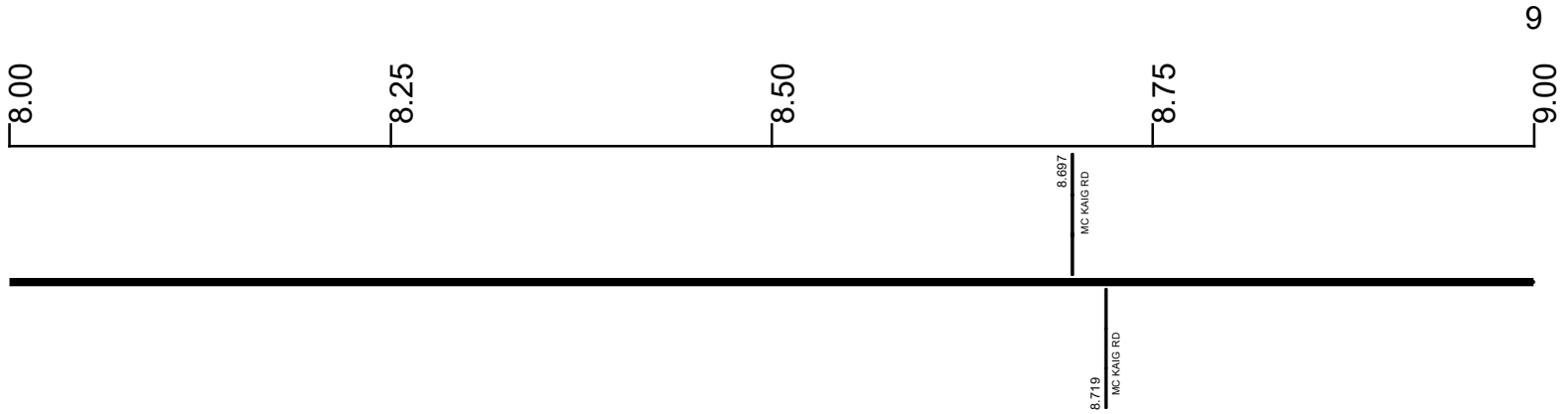

Surface Type & Width (Left / Right)

G 20'
4.946 - 10.844

Base Type (Left / Right)

N
4.946 - 9.997

Shoulder Type & Width (Left / Right)

4 (0'/0')
5.597 - 9.432

Resurface Year

2024
3.943 - 11.163

Through Lanes

2
0 - 11.163

Street Name

SR 644
0.76 - 11.163

- Non-divided Highway
- Divided Highway
- Secondary Segment
- Corporation
- Bridge (on route)
- Underpass
- Overpass
- Railroad (at grade)
- Railroad (underpass)
- Railroad (overpass)
- Intersection

Created on: 6/24/2025

transportation.ohio.gov
Prepared by
The Ohio Department of Transportation
Office of Technical Services
Roadway Information

SCOLSR00644**C

State True Log

10

County True Log

9.00

9.25

9.50

9.75

10.00



Surface Type & Width (Left / Right)

G 20'	
4.946 - 10.844	

Base Type (Left / Right)

N	
4.946 - 9.997	9.997 - 10.338

Shoulder Type & Width (Left / Right)

4 (0'/0')	2 (1'/1')	4 (0'/0')	2 (1'/1')
5.597 - 9.432	9.432 - 9.785	9.785 - 9.957	9.957 - 10.288

Resurface Year

2024	
3.943 - 11.163	

Through Lanes

2	
0 - 11.163	

Street Name

SR 644	
0.76 - 11.163	

- Non-divided Highway
 Bridge (on route)
 Railroad (at grade)
 Intersection
- Divided Highway
 Underpass
 Railroad (underpass)
- Secondary Segment
 Overpass
 Railroad (overpass)
- Corporation**

Created on: 6/24/2025

transportation.ohio.gov

Prepared by
The Ohio Department of Transportation
Office of Technical Services
Roadway Information

SCOLSR00644**C

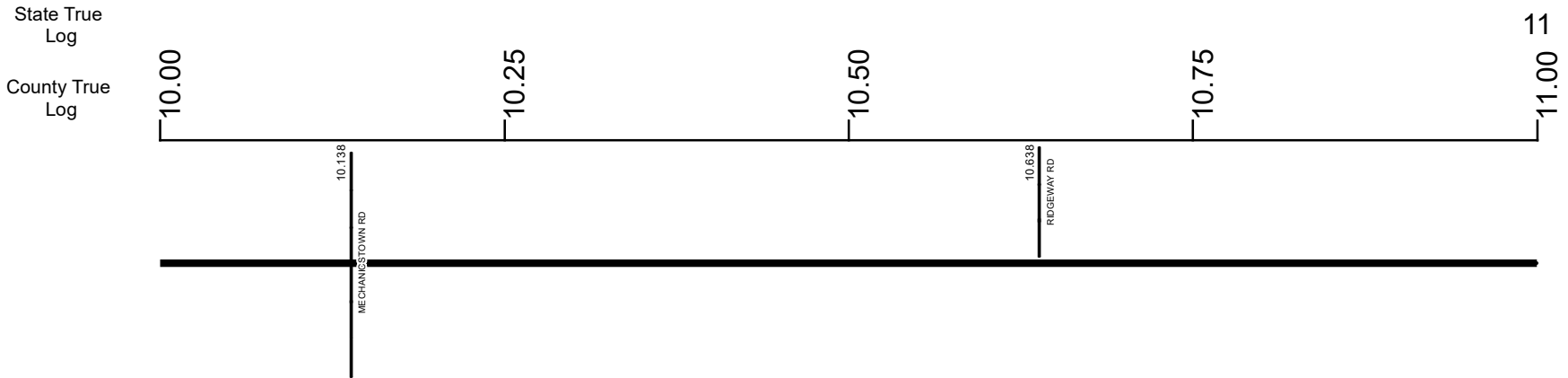

Surface Type & Width (Left / Right)		
G 20'		G (16'4')
4.946 - 10.844		10.844 - 11.163
Base Type (Left / Right)		
L	N	R / L
9.997 - 10.338	10.338 - 10.844	10.844 - 11.163
Shoulder Type & Width (Left / Right)		
2 (1'1')	4 (0'0')	5 (0'2')
9.957 - 10.288	10.288 - 10.844	10.844 - 11.163
Resurface Year		
2024		
Through Lanes		
2		
0 - 11.163		
Street Name		
SR 644		
0.76 - 11.163		

<ul style="list-style-type: none"> Non-divided Highway Divided Highway Secondary Segment Corporation 	<ul style="list-style-type: none"> Bridge (on route) Underpass Overpass 	<ul style="list-style-type: none"> Railroad (at grade) Railroad (underpass) Railroad (overpass) 	<ul style="list-style-type: none"> Intersection
--	---	---	---

Created on: 6/24/2025

transportation.ohio.gov

Prepared by
The Ohio Department of Transportation
Office of Technical Services
Roadway Information

SCOLSR00644**C

State True Log

11.586

County True Log

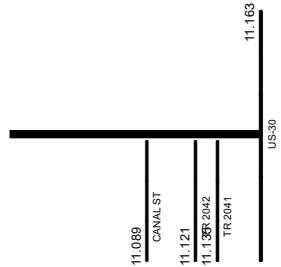
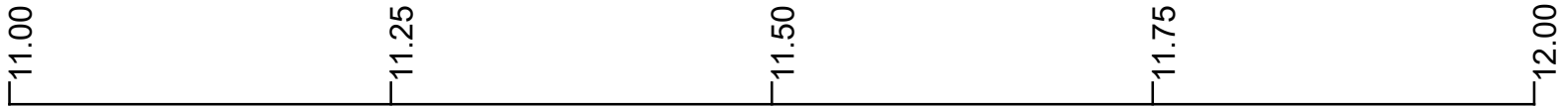

Surface Type & Width (Left / Right)

G (16'4")
10.844 - 11.163

Base Type (Left / Right)
R / L
10.844 - 11.163

Shoulder Type & Width (Left / Right)
5 (0'2")
10.844 - 11.163

Resurface Year
2024
3.943 - 11.163

Through Lanes
2
0 - 11.163

Street Name
SR 644
0.76 - 11.163

- | | | | |
|---------------------|-------------------|----------------------|--------------|
| Non-divided Highway | Bridge (on route) | Railroad (at grade) | Intersection |
| Divided Highway | Underpass | Railroad (underpass) | |
| Corporation | Overpass | Railroad (overpass) | |

Created on: 6/24/2025

Prepared by
The Ohio Department of Transportation
Office of Technical Services
Roadway Information

Historical Project List for SCOLSR00644**C

Begin Measure	End Measure	Project ID Number	Construction Completion Date	Treatment Category	Treatment Type
0.000	0.777	107496	11-2022	Minor Rehabilitation	60-AC Overlay w/Rpr
0.000	0.777	84163	12-2009	Minor Rehabilitation	60-AC Overlay w/Rpr
0.777	1.567	87299	1-2016	Minor Rehabilitation	60-AC Overlay w/Rpr
0.777	1.567	19118	6-2002	Minor Rehabilitation	60-AC Overlay w/Rpr
1.567	3.943	107496	11-2022	Minor Rehabilitation	60-AC Overlay w/Rpr
1.567	3.953	81677	11-2009	Minor Rehabilitation	38-Fine Poly AC Overlay
1.567	11.163	19118	6-2002	Minor Rehabilitation	60-AC Overlay w/Rpr
10.027	10.338	15206	11-2001	Minor Rehabilitation	50-AC Overlay w/o Rpr

Roadway Codes

Access Control Journalized

- F - Full Access Control
- L - Limited Access Control
- N - No Access Control

Access Control Operational

- 1 - Full Access Control
- 2 - Partial Access Control
- 3 - No Access Control

Base Type

- F - Crack and Seat
- H - Rubblize and Roll
- I - Aggregate Base 304 or Traffic Compacted
- K - Water Bound Macadam
- L - Bituminous Concrete Mix or Penetration Macadam
- N - Plain Concrete
- P - Reinforced Concrete
- R - Brick (Flexible)
- T - Brick (Rigid)

Direction of Travel

- B - Both (Two-way)
- F - One-way Cardinal
- T - One-way Non-cardinal

Facility Type

- 1 - One-way Roadway
- 2 - Two-way Roadway
- 4 - Ramp
- 5 - Non-mainline
- 6 - Non-inventory Direction
- 7 - Planned / Unbuilt

Historical Federal Aid Indicator

- N - Not a FAP Route
- Y - FAP Route

Functional Classification

- 01 - Interstate
- 02 - Principal Arterial (Freeways)
- 03 - Principal Arterial (Other)
- 04 - Minor Arterial
- 05 - Major Collector
- 06 - Minor Collector
- 07 - Local

Leave / Reenter Indicator

- Y - Route leaves/reenters at this point
- N - Route does not leave/reenter at this point

Median Type

- 1 - None
- 2 - Unprotected
- 3 - Curbed
- 4 - Positive Barrier (Unspecified)
- 5 - Positive Barrier (Flexible)
- 6 - Positive Barrier (Semi-rigid)
- 7 - Positive Barrier (Rigid)

NHS

- N - National Highway System
- H - Congressional Corridor
- 2 - Major Airport
- 3 - Major Port Facility
- 4 - Major Amtrak Station
- 5 - Major Rail / Truck Terminal
- 6 - Major Intercity Bus Terminal
- 7 - Major Public Transit / Multi-modal Passenger Terminal
- 8 - Major Pipeline Terminal
- 9 - Major Ferry Terminal

Priority System

- G - General
- P - Priority System
- U - Urban

Scenic Byway Code

- A - All American Road
- N - National Scenic Byway
- S - State Scenic Byway

Shoulder Type

- 1 - None
- 2 - Surfaced shoulder exists (bituminous concrete {AC})
- 3 - Surfaced shoulder exists (Portland Cement Concrete {PCC})
- 4 - Stabilized shoulder exists (gravel or other granular material)
- 5 - Combination shoulder exists (two or more surface types)
- 6 - Earth shoulder exists
- 7 - Barrier curb exists; no shoulder in front of curb

Surface Type

- A - Combination
- B - Brick
- C - Continuous Reinforced Concrete
- D - Reinforced Concrete
- E - Plain Concrete
- G - Bituminous Concrete
- I - Chipseal on Granular
- K - Open Graded Bituminous
- L - Chipseal or Micro
- M - Gravel
- U - Unimproved
- X - Right of Way Only