

# SCRASR00096\*\*C

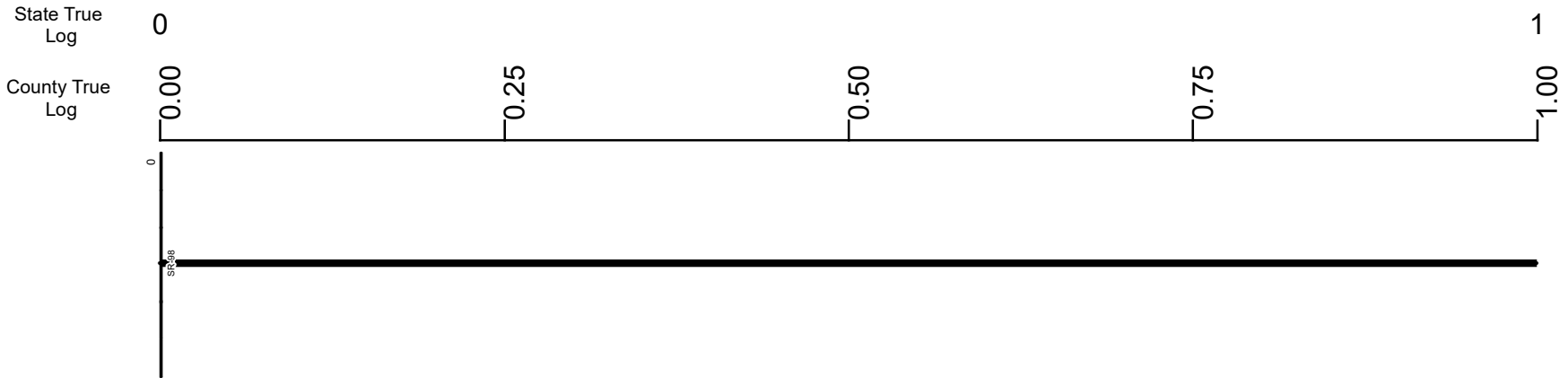

Surface Type & Width (Left / Right)	G 22' 0 - 3.662
Base Type (Left / Right)	1 / L 0 - 3.662
Shoulder Type & Width (Left / Right)	2 (2'/2) 0 - 3.662
Resurface Year	2023 0 - 3.662
Through Lanes	2 0 - 11.417
Street Name	SR 96 0 - 11.417

- Non-divided Highway
- Divided Highway
- Secondary Segment
- Corporation
- Bridge (on route)
- Underpass
- Overpass
- Railroad (at grade)
- Railroad (underpass)
- Railroad (overpass)
- Intersection

Created on: 6/24/2025



transportation.ohio.gov  
 Prepared by  
 The Ohio Department of Transportation  
 Office of Technical Services  
 Roadway Information

# SCRASR00096\*\*C

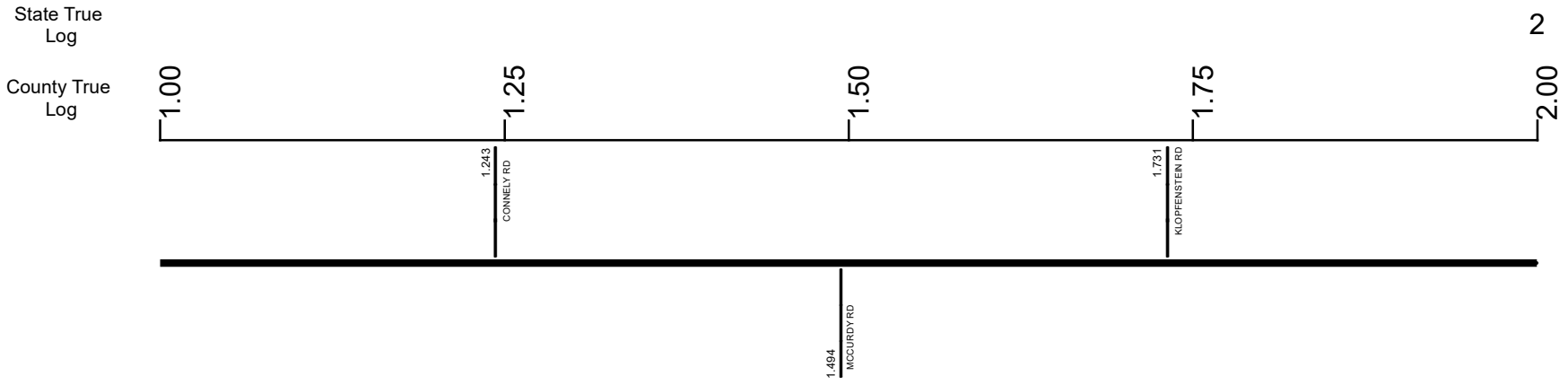

Surface Type & Width (Left / Right)	G 22' 0 - 3.662
Base Type (Left / Right)	I / L 0 - 3.662
Shoulder Type & Width (Left / Right)	2 (2'/2) 0 - 3.662
Resurface Year	2023 0 - 3.662
Through Lanes	2 0 - 11.417
Street Name	SR 96 0 - 11.417

Non-divided Highway	Bridge (on route)	Railroad (at grade)	Intersection
Divided Highway	Underpass	Railroad (underpass)	
Secondary Segment	Overpass	Railroad (overpass)	
<b>Corporation</b>			

Created on: 6/24/2025



transportation.ohio.gov

Prepared by  
The Ohio Department of Transportation  
Office of Technical Services  
Roadway Information

# SCRASR00096\*\*C

State True Log

County True Log

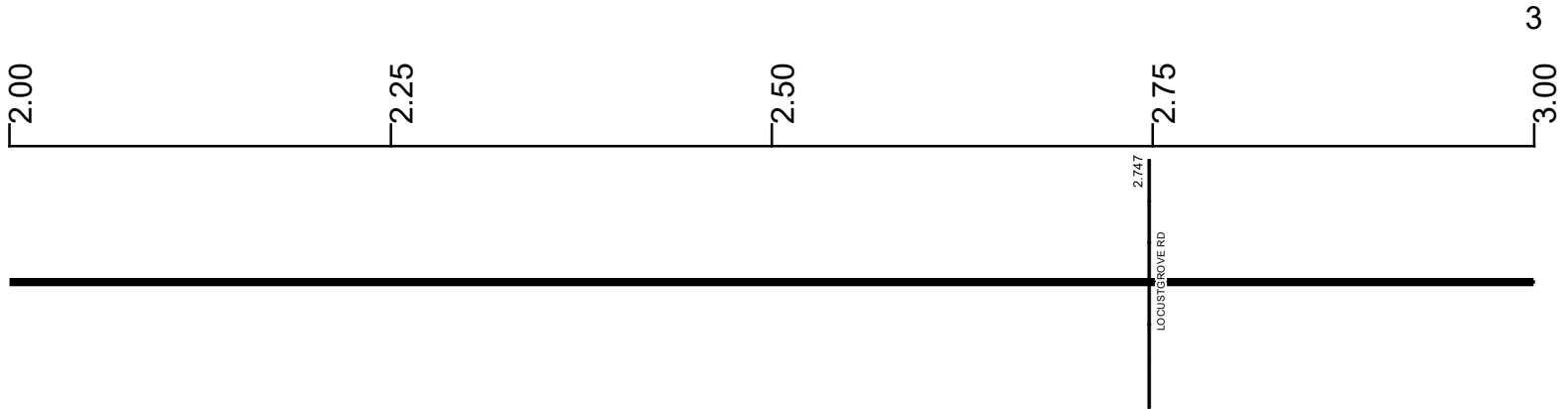

Surface Type & Width (Left / Right)

G 22'  
0 - 3.662

Base Type (Left / Right)

I / L  
0 - 3.662

Shoulder Type & Width (Left / Right)

2 (2'/2)  
0 - 3.662

Resurface Year

2023  
0 - 3.662

Through Lanes

2  
0 - 11.417

Street Name

SR 96  
0 - 11.417

- Non-divided Highway
  Bridge (on route)
  Railroad (at grade)
  Intersection
- Divided Highway
  Underpass
  Railroad (underpass)
- Secondary Segment
  Overpass
  Railroad (overpass)
- Corporation**

Created on: 6/24/2025



transportation.ohio.gov

Prepared by  
The Ohio Department of Transportation  
Office of Technical Services  
Roadway Information

# SCRASR00096\*\*C

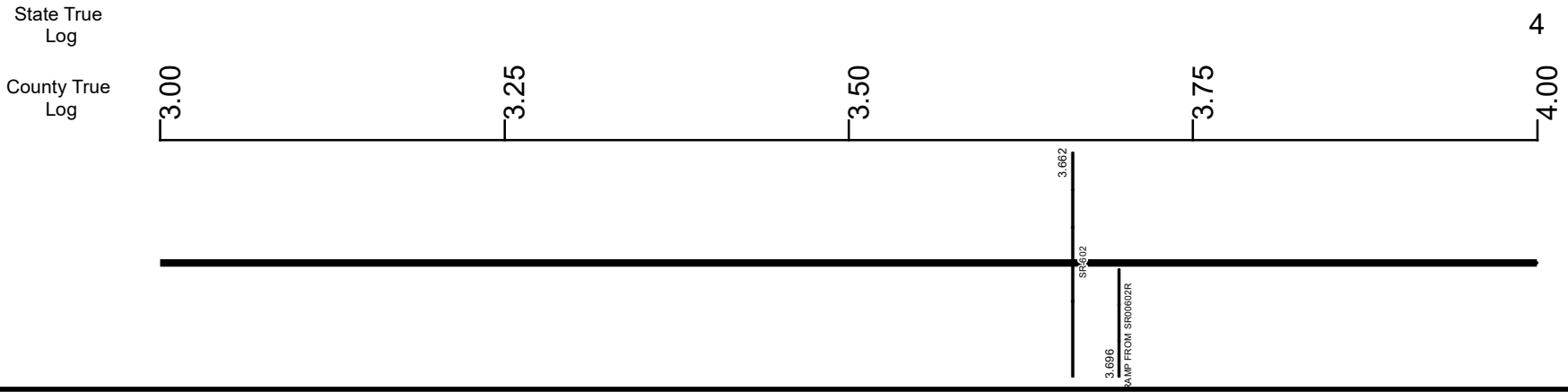

Surface Type & Width (Left / Right)	
G 22'	G 20'
0 - 3.662	3.662 - 8.39
Base Type (Left / Right)	
I / L	I
0 - 3.662	3.662 - 8.39
Shoulder Type & Width (Left / Right)	
2 (2 1/2')	2 (8/8')      2 (4/4')
0 - 3.662	3.662 - 3.711      3.711 - 7.025
Resurface Year	
2023	
0 - 3.662	
Through Lanes	
2	
0 - 11.417	
Street Name	
SR 96	
0 - 11.417	

<ul style="list-style-type: none"> <li> Non-divided Highway</li> <li> Divided Highway</li> <li> Secondary Segment</li> <li> Corporation</li> </ul>	<ul style="list-style-type: none"> <li> Bridge (on route)</li> <li> Underpass</li> <li> Overpass</li> </ul>	<ul style="list-style-type: none"> <li> Railroad (at grade)</li> <li> Railroad (underpass)</li> <li> Railroad (overpass)</li> </ul>	<ul style="list-style-type: none"> <li> Intersection</li> </ul>
--	---	---	---

Created on: 6/24/2025

transportation.ohio.gov

Prepared by  
The Ohio Department of Transportation  
Office of Technical Services  
Roadway Information

# SCRASR00096\*\*C

State True Log

5

County True Log

4.00

4.25

4.50

4.75

5.00

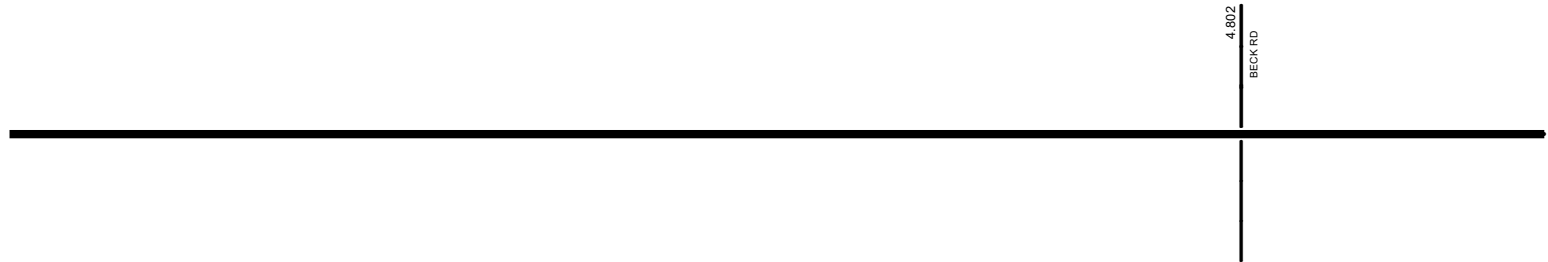

Surface Type & Width (Left / Right)

	G 20'
	3.662 - 8.39

Base Type (Left / Right)

	I
	3.662 - 8.39

Shoulder Type & Width (Left / Right)

	2 (4/4')
	3.711 - 7.025

Through Lanes

	2
	0 - 11.417

Street Name

	SR 96
	0 - 11.417

- |                     |                   |                      |              |
|---------------------|-------------------|----------------------|--------------|
| Non-divided Highway | Bridge (on route) | Railroad (at grade)  | Intersection |
| Divided Highway     | Underpass         | Railroad (underpass) |              |
| Secondary Segment   | Overpass          | Railroad (overpass)  |              |
| Corporation         |                   |                      |              |

Created on: 6/24/2025

transportation.ohio.gov

Prepared by  
The Ohio Department of Transportation  
Office of Technical Services  
Roadway Information

# SCRASR00096\*\*C

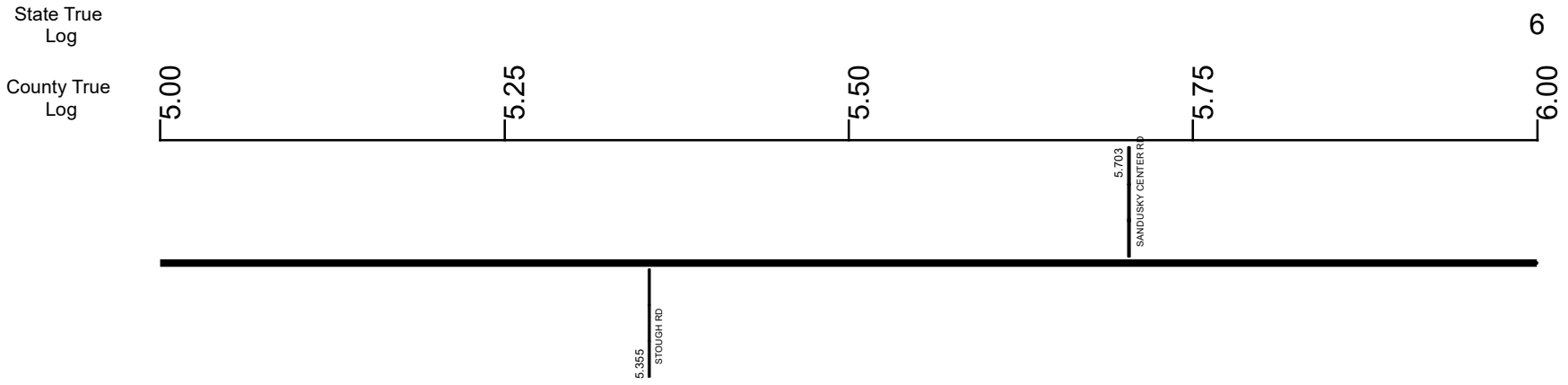

Surface Type & Width (Left / Right)	G 20'
	3.662 - 8.39
Base Type (Left / Right)	I
	3.662 - 8.39
Shoulder Type & Width (Left / Right)	2 (4/4')
	3.711 - 7.025
Through Lanes	2
	0 - 11.417
Street Name	SR 96
	0 - 11.417

- Non-divided Highway
- Divided Highway
- Secondary Segment
- Corporation
- Bridge (on route)
- Underpass
- Overpass
- Railroad (at grade)
- Railroad (underpass)
- Railroad (overpass)
- Intersection

Created on: 6/24/2025

transportation.ohio.gov

Prepared by  
The Ohio Department of Transportation  
Office of Technical Services  
Roadway Information

# SCRASR00096\*\*C

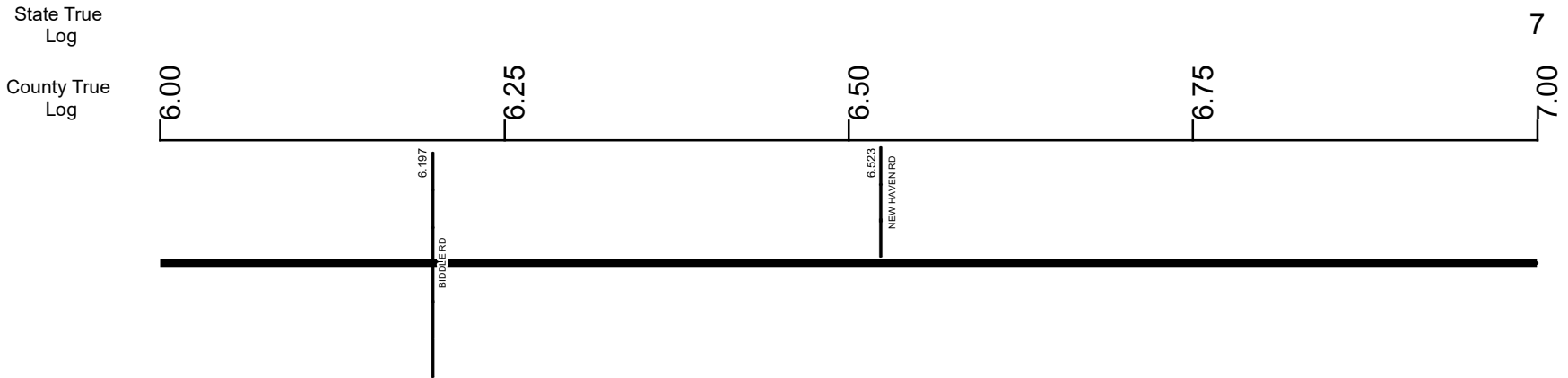

Surface Type & Width (Left / Right)	G 20'
	3.662 - 8.39
Base Type (Left / Right)	I
	3.662 - 8.39
Shoulder Type & Width (Left / Right)	2 (4/4')
	3.711 - 7.025
Through Lanes	2
	0 - 11.417
Street Name	SR 96
	0 - 11.417

Non-divided Highway	Bridge (on route)	Railroad (at grade)	Intersection
Divided Highway	Underpass	Railroad (underpass)	
Secondary Segment	Overpass	Railroad (overpass)	
Corporation			

Created on: 6/24/2025



transportation.ohio.gov  
 Prepared by  
 The Ohio Department of Transportation  
 Office of Technical Services  
 Roadway Information

# SCRASR00096\*\*C

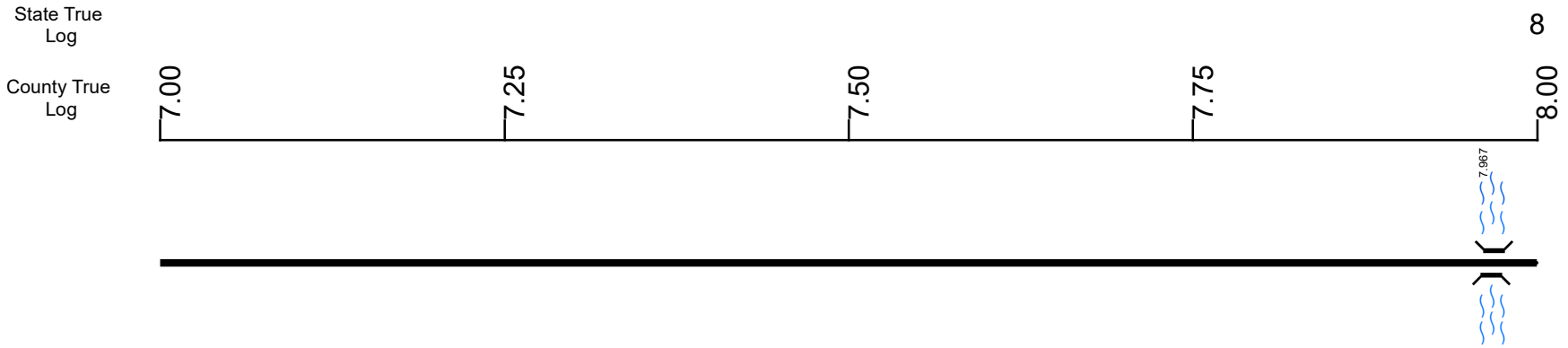

**Surface Type & Width (Left / Right)**

	G 20'
	3.662 - 8.39

**Base Type (Left / Right)**

	I
	3.662 - 8.39

**Shoulder Type & Width (Left / Right)**

2 (4/4')	2 (8/8')	
3.711 - 7.025	7.025 - 8.39	

**Through Lanes**

	2
	0 - 11.417

**Street Name**

	SR 96
	0 - 11.417

- |                     |                   |                      |              |
|---------------------|-------------------|----------------------|--------------|
| Non-divided Highway | Bridge (on route) | Railroad (at grade)  | Intersection |
| Divided Highway     | Underpass         | Railroad (underpass) |              |
| Secondary Segment   | Overpass          | Railroad (overpass)  |              |
| Corporation         |                   |                      |              |

Created on: 6/24/2025

transportation.ohio.gov

Prepared by  
The Ohio Department of Transportation  
Office of Technical Services  
Roadway Information

# SCRASR00096\*\*C

State True Log

9

County True Log

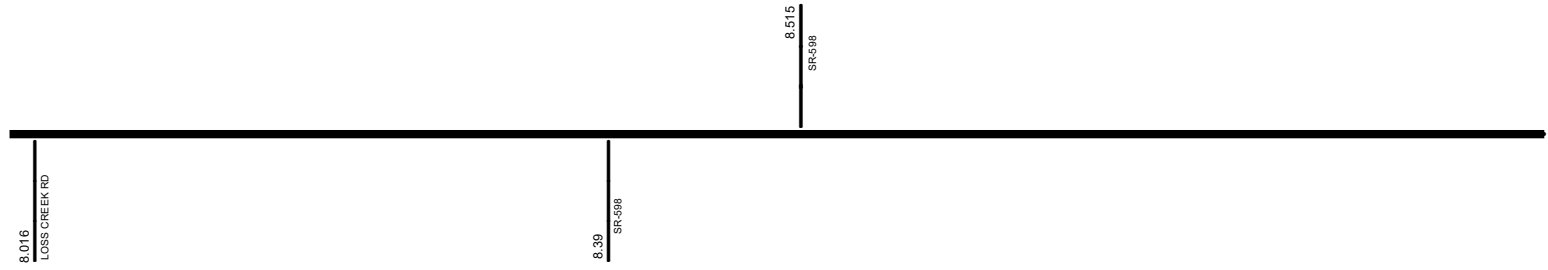

**Surface Type & Width (Left / Right)**

G 20'	G 18'	G (18'/2')
3.662 - 8.39	8.39 - 8.515	8.515 - 9.196

**Base Type (Left / Right)**

I	K	I / L
3.662 - 8.39	8.39 - 8.515	8.515 - 9.196

**Shoulder Type & Width (Left / Right)**

2 (8'/8')	2 (4'/4')
7.025 - 8.39	8.39 - 9.326

**Through Lanes**

2
0 - 11.417

**Street Name**

SR 96
0 - 11.417

- Non-divided Highway
- Divided Highway
- Secondary Segment
- Corporation
- Bridge (on route)
- Underpass
- Overpass
- Railroad (at grade)
- Railroad (underpass)
- Railroad (overpass)
- Intersection

Created on: 6/24/2025

transportation.ohio.gov

Prepared by  
The Ohio Department of Transportation  
Office of Technical Services  
Roadway Information

# SCRASR00096\*\*C

State True Log

County True Log

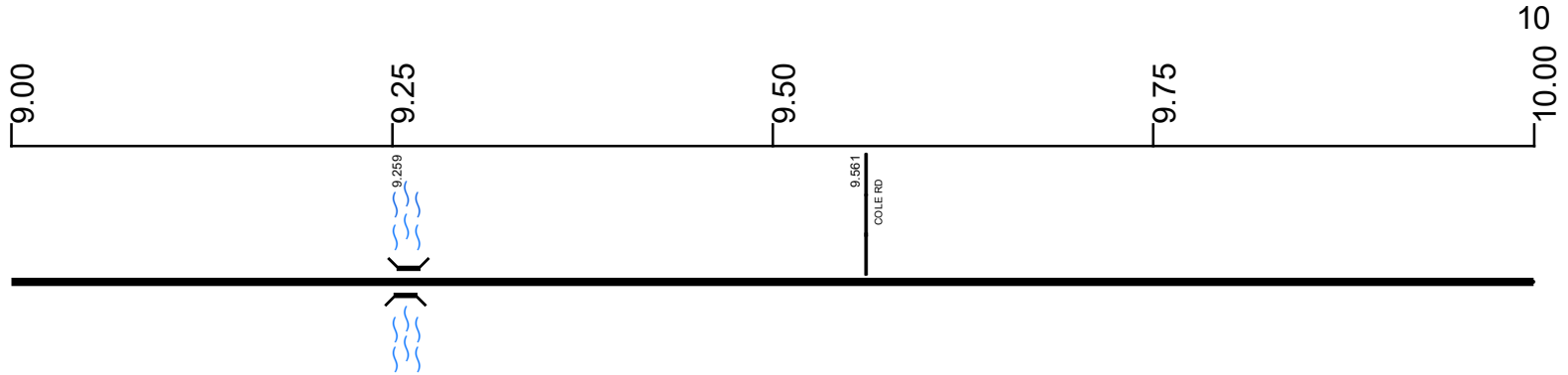

**Surface Type & Width (Left / Right)**

G (18'2") 8.515 - 9.196	G 22' 9.196 - 9.326	G (18'2") 9.326 - 11.417
----------------------------	------------------------	-----------------------------

**Base Type (Left / Right)**

I / L 8.515 - 9.196	I 9.196 - 9.326	I / L 9.326 - 11.417
------------------------	--------------------	-------------------------

**Shoulder Type & Width (Left / Right)**

2 (4'4") 8.39 - 9.326	2 (5'5") 9.326 - 11.417
--------------------------	----------------------------

**Through Lanes**

	2 0 - 11.417
--	-----------------

**Street Name**

	SR 96 0 - 11.417
--	---------------------

- Non-divided Highway
- Divided Highway
- Secondary Segment
- Corporation
- Bridge (on route)
- Underpass
- Overpass
- Railroad (at grade)
- Railroad (underpass)
- Railroad (overpass)
- Intersection

Created on: 6/24/2025

transportation.ohio.gov

Prepared by  
The Ohio Department of Transportation  
Office of Technical Services  
Roadway Information

# SCRASR00096\*\*C

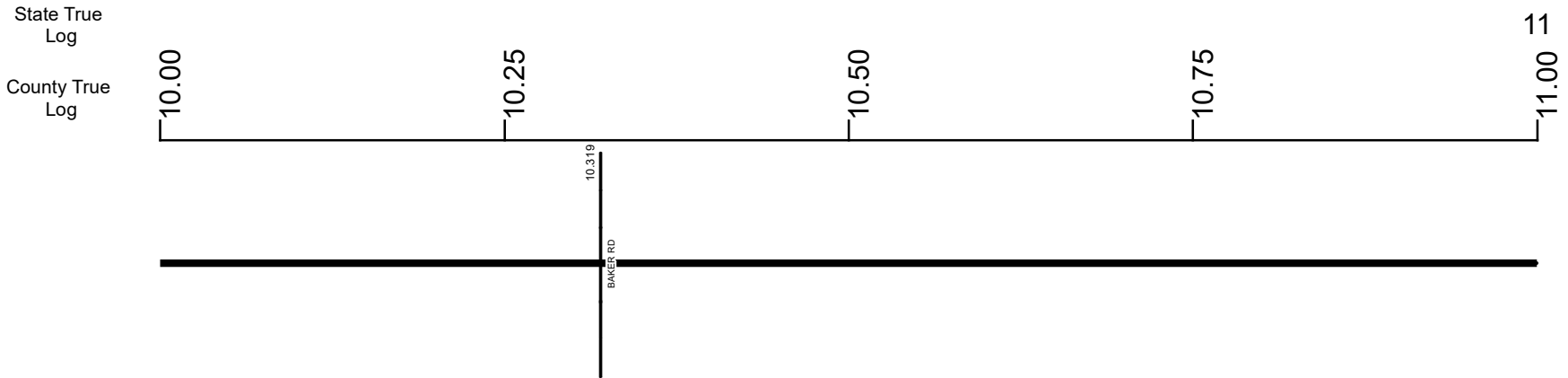

Surface Type & Width (Left / Right)	G (18/2')
	9.326 - 11.417
Base Type (Left / Right)	I / L
	9.326 - 11.417
Shoulder Type & Width (Left / Right)	2 (5/5')
	9.326 - 11.417
Through Lanes	2
	0 - 11.417
Street Name	SR 96
	0 - 11.417

- |  |   |   |   |
|--|---|---|---|
| <ul style="list-style-type: none"> <li> Non-divided Highway</li> <li> Divided Highway</li> <li> Secondary Segment</li> <li> Corporation</li> </ul> | <ul style="list-style-type: none"> <li> Bridge (on route)</li> <li> Underpass</li> <li> Overpass</li> </ul> | <ul style="list-style-type: none"> <li> Railroad (at grade)</li> <li> Railroad (underpass)</li> <li> Railroad (overpass)</li> </ul> | <ul style="list-style-type: none"> <li> Intersection</li> </ul> |
|--|---|---|---|

Created on: 6/24/2025

transportation.ohio.gov

Prepared by  
The Ohio Department of Transportation  
Office of Technical Services  
Roadway Information

# SCRASR00096\*\*C

11.417

State True Log

County True Log

11.00

11.25

11.50

11.75

12.00



Surface Type & Width (Left / Right)

G (18'2')  
9.326 - 11.417

Base Type (Left / Right)

I / L  
9.326 - 11.417

Shoulder Type & Width (Left / Right)

2 (5'5')  
9.326 - 11.417

Through Lanes

2  
0 - 11.417

Street Name

SR 96  
0 - 11.417

- Non-divided Highway
  Bridge (on route)
  Railroad (at grade)
  Intersection
- Divided Highway
  Underpass
  Railroad (underpass)
- Secondary Segment
  Overpass
  Railroad (overpass)
- Corporation**

Created on: 6/24/2025

transportation.ohio.gov  
Prepared by  
The Ohio Department of Transportation  
Office of Technical Services  
Roadway Information

## Historical Project List for SCRASR00096\*\*C

Begin Measure	End Measure	Project ID Number	Construction Completion Date	Treatment Category	Treatment Type
0.000	3.660	105452	9-2023	Major Rehabilitation	150-Full Depth Reclamation
0.000	3.620	83437	11-2013	Preventive Maintenance	25-Chip Seal
3.660	11.417	98403	9-2017	Preventive Maintenance	25-Chip Seal
3.660	8.390	83414	9-2010	Minor Rehabilitation	60-AC Overlay w/Rpr
8.390	8.515	25664	10-2011	Minor Rehabilitation	60-AC Overlay w/Rpr
8.515	11.417	83414	9-2010	Minor Rehabilitation	60-AC Overlay w/Rpr

# Roadway Codes

## Access Control Journalized

- F - Full Access Control
- L - Limited Access Control
- N - No Access Control

## Access Control Operational

- 1 - Full Access Control
- 2 - Partial Access Control
- 3 - No Access Control

## Base Type

- F - Crack and Seat
- H - Rubblize and Roll
- I - Aggregate Base 304 or Traffic Compacted
- K - Water Bound Macadam
- L - Bituminous Concrete Mix or Penetration Macadam
- N - Plain Concrete
- P - Reinforced Concrete
- R - Brick (Flexible)
- T - Brick (Rigid)

## Direction of Travel

- B - Both (Two-way)
- F - One-way Cardinal
- T - One-way Non-cardinal

## Facility Type

- 1 - One-way Roadway
- 2 - Two-way Roadway
- 4 - Ramp
- 5 - Non-mainline
- 6 - Non-inventory Direction
- 7 - Planned / Unbuilt

## Historical Federal Aid Indicator

- N - Not a FAP Route
- Y - FAP Route

## Functional Classification

- 01 - Interstate
- 02 - Principal Arterial (Freeways)
- 03 - Principal Arterial (Other)
- 04 - Minor Arterial
- 05 - Major Collector
- 06 - Minor Collector
- 07 - Local

## Leave / Reenter Indicator

- Y - Route leaves/reenters at this point
- N - Route does not leave/reenter at this point

## Median Type

- 1 - None
- 2 - Unprotected
- 3 - Curbed
- 4 - Positive Barrier (Unspecified)
- 5 - Positive Barrier (Flexible)
- 6 - Positive Barrier (Semi-rigid)
- 7 - Positive Barrier (Rigid)

## NHS

- N - National Highway System
- H - Congressional Corridor
- 2 - Major Airport
- 3 - Major Port Facility
- 4 - Major Amtrak Station
- 5 - Major Rail / Truck Terminal
- 6 - Major Intercity Bus Terminal
- 7 - Major Public Transit / Multi-modal Passenger Terminal
- 8 - Major Pipeline Terminal
- 9 - Major Ferry Terminal

## Priority System

- G - General
- P - Priority System
- U - Urban

## Scenic Byway Code

- A - All American Road
- N - National Scenic Byway
- S - State Scenic Byway

## Shoulder Type

- 1 - None
- 2 - Surfaced shoulder exists (bituminous concrete {AC})
- 3 - Surfaced shoulder exists (Portland Cement Concrete {PCC})
- 4 - Stabilized shoulder exists (gravel or other granular material)
- 5 - Combination shoulder exists (two or more surface types)
- 6 - Earth shoulder exists
- 7 - Barrier curb exists; no shoulder in front of curb

## Surface Type

- A - Combination
- B - Brick
- C - Continuous Reinforced Concrete
- D - Reinforced Concrete
- E - Plain Concrete
- G - Bituminous Concrete
- I - Chipseal on Granular
- K - Open Graded Bituminous
- L - Chipseal or Micro
- M - Gravel
- U - Unimproved
- X - Right of Way Only