

SCUYSR00291**C

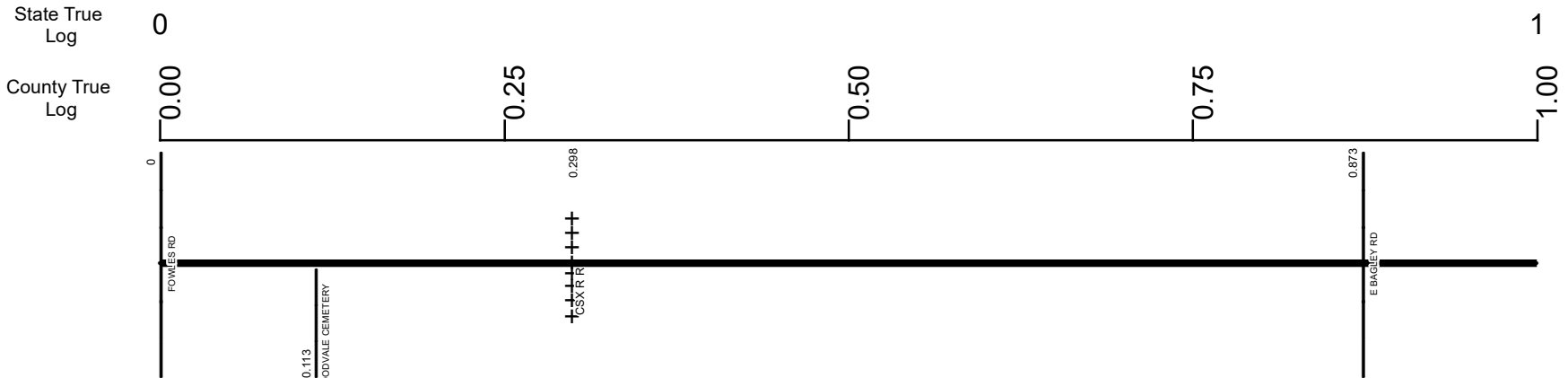

Surface Type & Width (Left / Right)

G 24'	D 24'	D 62'
0 - 0.685	0.685 - 0.813	0.813 - 1.506

Base Type (Left / Right)

I
0 - 0.685

Shoulder Type & Width (Left / Right)

5 (4/4')	1 (0/0')
0 - 0.813	0.813 - 2.048

Through Lanes

2	4
0 - 0.813	0.813 - 2.048

Street Name

	ENGLE RD	
	0 - 4.145	

- | | | | |
|--|---|---|---|
| <ul style="list-style-type: none"> Non-divided Highway Divided Highway Secondary Segment Corporation | <ul style="list-style-type: none"> Bridge (on route) Underpass Overpass | <ul style="list-style-type: none"> Railroad (at grade) Railroad (underpass) Railroad (overpass) | <ul style="list-style-type: none"> Intersection |
|--|---|---|---|

Created on: 6/24/2025

transportation.ohio.gov

Prepared by
The Ohio Department of Transportation
Office of Technical Services
Roadway Information

SCUYSR00291**C

State True Log

County True Log

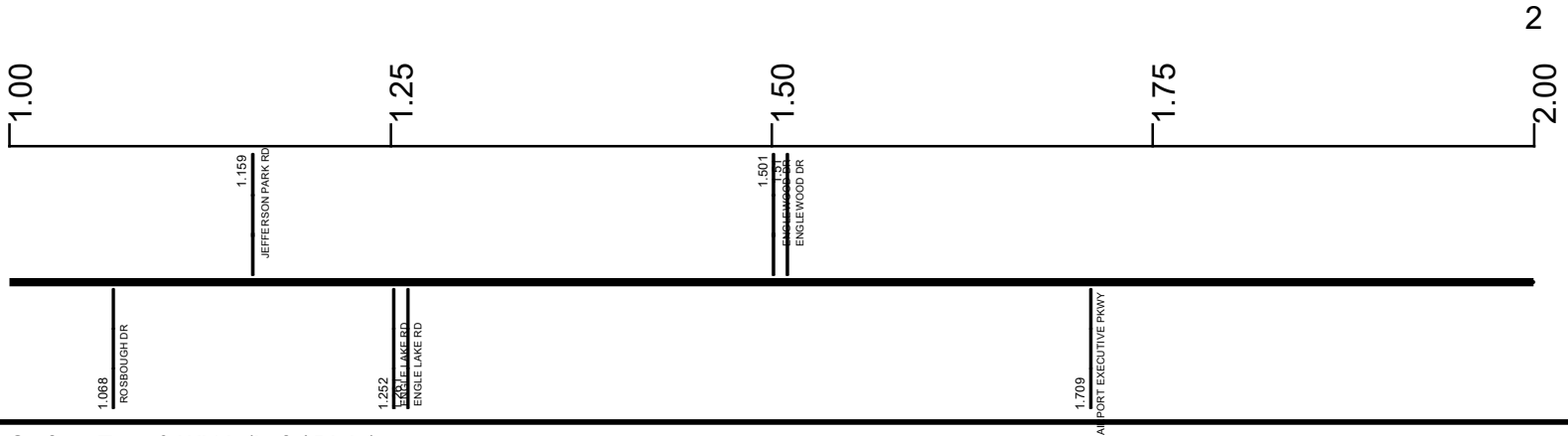

Surface Type & Width (Left / Right)

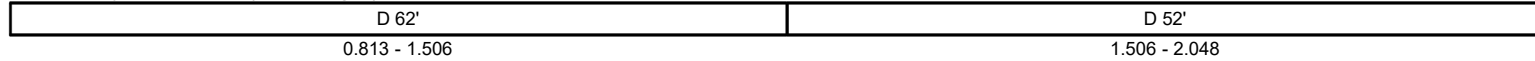

Shoulder Type & Width (Left / Right)

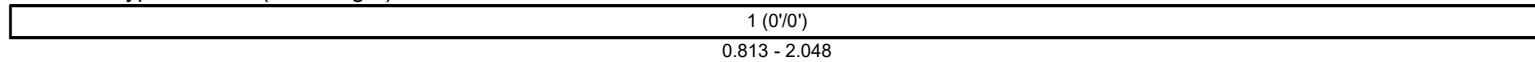

Through Lanes

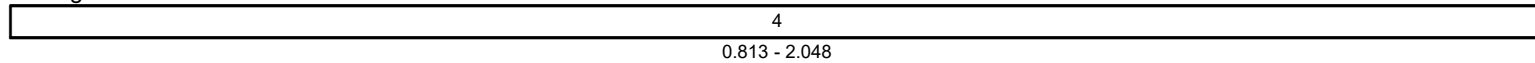

Street Name

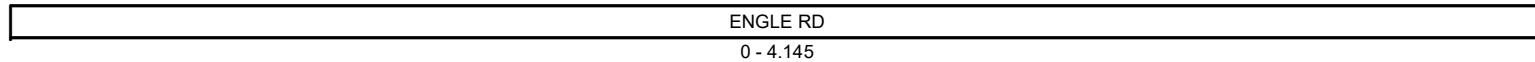

- Non-divided Highway
- Divided Highway
- Secondary Segment
- Corporation
- Bridge (on route)
- Underpass
- Overpass
- Railroad (at grade)
- Railroad (underpass)
- Railroad (overpass)
- Intersection

Created on: 6/24/2025



transportation.ohio.gov
 Prepared by
 The Ohio Department of Transportation
 Office of Technical Services
 Roadway Information

SCUYSR00291**C

State True Log
County True Log

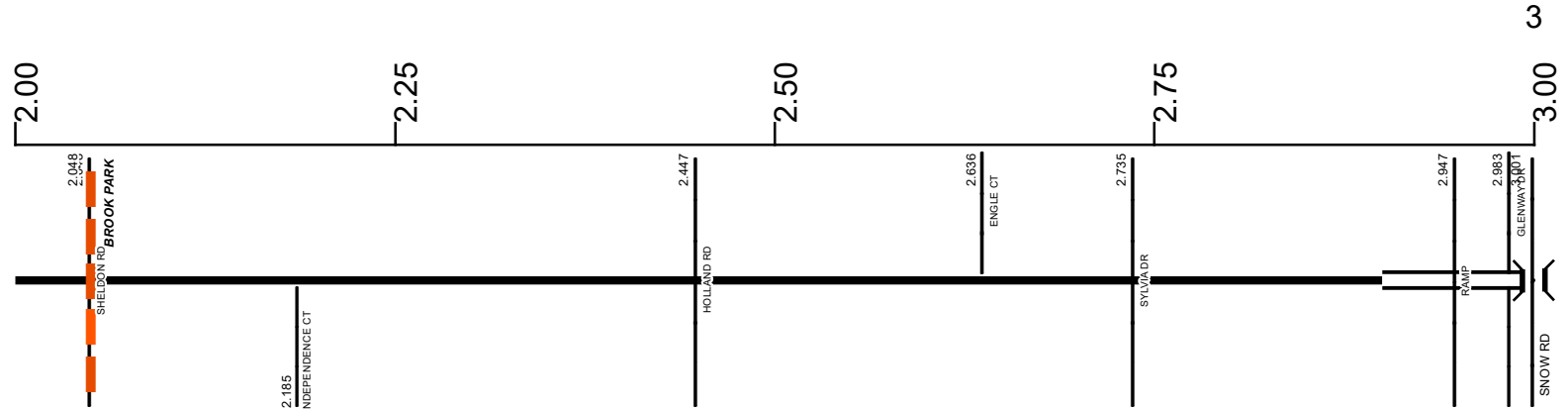

Surface Type & Width (Left / Right)

D 52'	G 24'	G 56'
1.506 - 2.048	2.048 - 2.9	2.9 - 3.056

Base Type (Left / Right)

I	P
2.048 - 2.85	2.85 - 4.145

Shoulder Type & Width (Left / Right)

1 (0'/0')	2 (4'/4')	2 (8'/8')
0.813 - 2.048	2.048 - 2.9	2.9 - 3.029

Median Type and Width

3 (4')
2.9 - 3.029

Through Lanes

4	2	4
0.813 - 2.048	2.048 - 2.9	2.9 - 4.145

Street Name

ENGLE RD
0 - 4.145

- Non-divided Highway
- Divided Highway
- Secondary Segment
- Corporation
- Bridge (on route)
- Underpass
- Overpass
- Railroad (at grade)
- Railroad (underpass)
- Railroad (overpass)
- Intersection

Created on: 6/24/2025



transportation.ohio.gov
Prepared by
The Ohio Department of Transportation
Office of Technical Services
Roadway Information

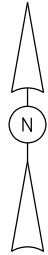

INTERCHANGES
IR 71, SR 291, Five
Points Rd. & Snow Rd.
CUYAHOGA COUNTY
INTERCHANGE ID NUMBER = 013800

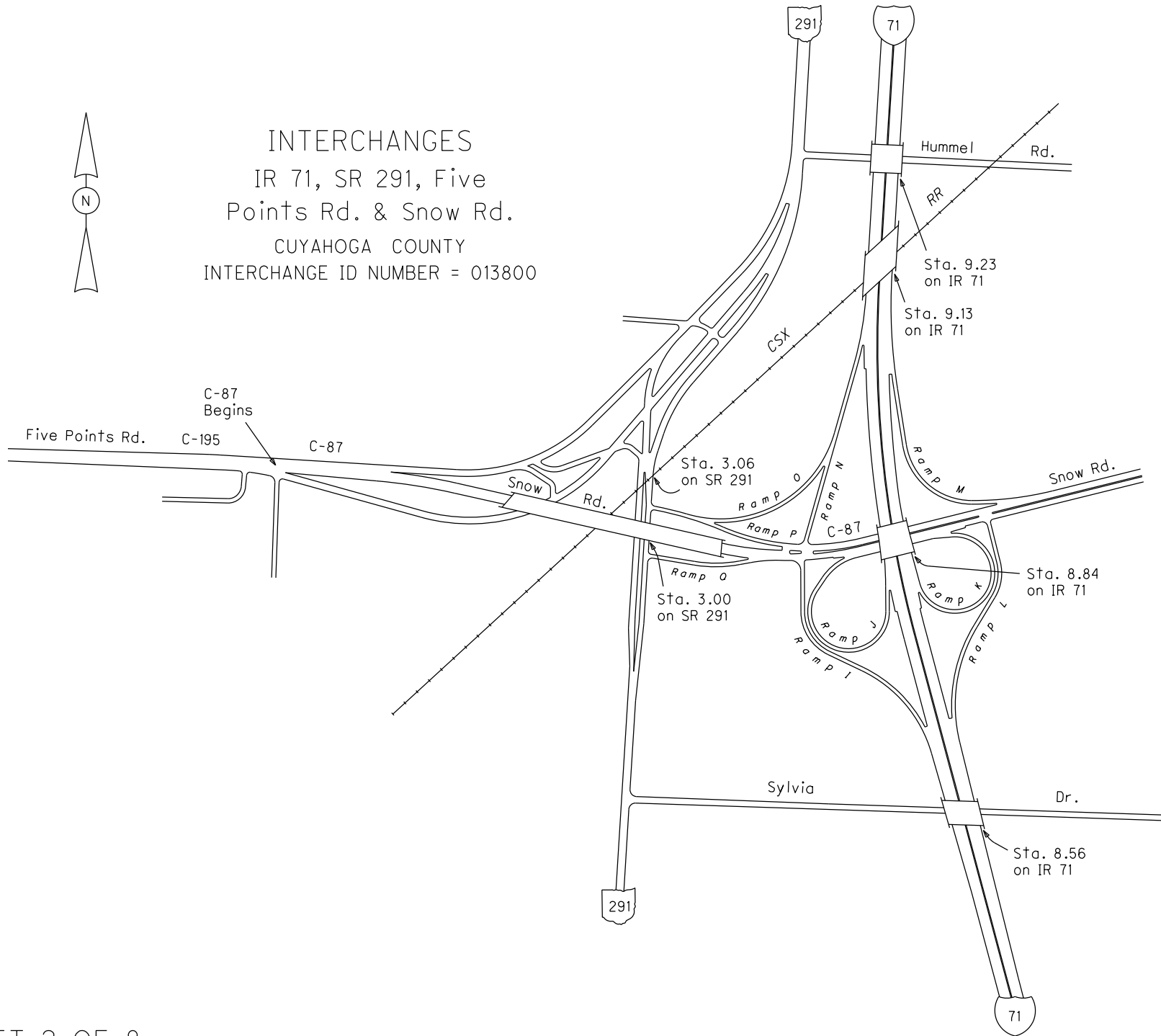

SCUYSR00291**C

State True Log

4

County True Log

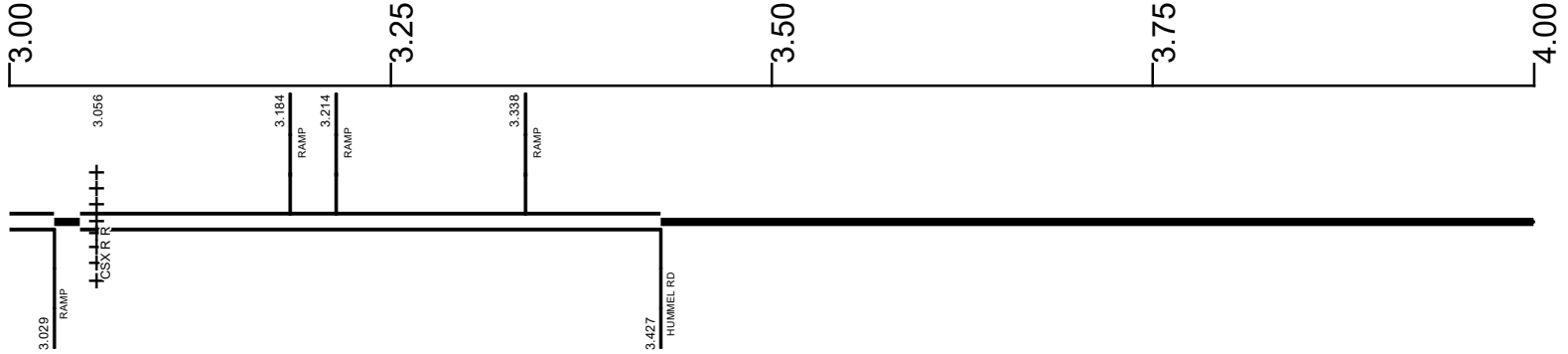

Surface Type & Width (Left / Right)

G 56'	G 52'	G 64'
2.9 - 3.056	3.056 - 3.427	3.427 - 4.145

Base Type (Left / Right)

P
2.85 - 4.145

Shoulder Type & Width (Left / Right)

2 (8/8') 2 (4' 1/4')	2 (8/8')	1 (0'/0')
2.9 - 3.029	3.046 - 3.427	3.427 - 4.145

Median Type and Width

3 (4')	3 (4')
2.9 - 3.029	3.046 - 3.427

Through Lanes

4
2.9 - 4.145

Street Name

ENGLE RD
0 - 4.145

- Non-divided Highway
- Divided Highway
- Secondary Segment
- Corporation
- Bridge (on route)
- Underpass
- Overpass
- Railroad (at grade)
- Railroad (underpass)
- Railroad (overpass)
- Intersection

Created on: 6/24/2025

transportation.ohio.gov

Prepared by
The Ohio Department of Transportation
Office of Technical Services
Roadway Information

SCUYSR00291**C

State True Log

4.145

County True Log

4.00

4.25

4.50

4.75

5.00

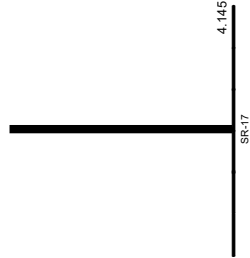

Surface Type & Width (Left / Right)

G 64'
3.427 - 4.145

Base Type (Left / Right)

P
2.85 - 4.145

Shoulder Type & Width (Left / Right)

1 (0/0)
3.427 - 4.145

Through Lanes

4
2.9 - 4.145

Street Name

ENGLE RD
0 - 4.145

- Non-divided Highway
- Divided Highway
- Secondary Segment
- Corporation
- Bridge (on route)
- Underpass
- Overpass
- Railroad (at grade)
- Railroad (underpass)
- Railroad (overpass)
- Intersection

Created on: 6/24/2025



transportation.ohio.gov
Prepared by
The Ohio Department of Transportation
Office of Technical Services
Roadway Information

Historical Project List for SCUYSR00291**C

Begin Measure	End Measure	Project ID Number	Construction Completion Date	Treatment Category	Treatment Type
0.873	2.048	22231	5-2003	Major Rehabilitation	110-New Rigid Pvmt
0.873	2.048	9283	2-2001	Major Rehabilitation	110-New Rigid Pvmt
2.048	4.145	85361	6-2015	Minor Rehabilitation	60-AC Overlay w/Rpr

Roadway Codes

Access Control Journalized

- F - Full Access Control
- L - Limited Access Control
- N - No Access Control

Access Control Operational

- 1 - Full Access Control
- 2 - Partial Access Control
- 3 - No Access Control

Base Type

- F - Crack and Seat
- H - Rubblize and Roll
- I - Aggregate Base 304 or Traffic Compacted
- K - Water Bound Macadam
- L - Bituminous Concrete Mix or Penetration Macadam
- N - Plain Concrete
- P - Reinforced Concrete
- R - Brick (Flexible)
- T - Brick (Rigid)

Direction of Travel

- B - Both (Two-way)
- F - One-way Cardinal
- T - One-way Non-cardinal

Facility Type

- 1 - One-way Roadway
- 2 - Two-way Roadway
- 4 - Ramp
- 5 - Non-mainline
- 6 - Non-inventory Direction
- 7 - Planned / Unbuilt

Historical Federal Aid Indicator

- N - Not a FAP Route
- Y - FAP Route

Functional Classification

- 01 - Interstate
- 02 - Principal Arterial (Freeways)
- 03 - Principal Arterial (Other)
- 04 - Minor Arterial
- 05 - Major Collector
- 06 - Minor Collector
- 07 - Local

Leave / Reenter Indicator

- Y - Route leaves/reenters at this point
- N - Route does not leave/reenter at this point

Median Type

- 1 - None
- 2 - Unprotected
- 3 - Curbed
- 4 - Positive Barrier (Unspecified)
- 5 - Positive Barrier (Flexible)
- 6 - Positive Barrier (Semi-rigid)
- 7 - Positive Barrier (Rigid)

NHS

- N - National Highway System
- H - Congressional Corridor
- 2 - Major Airport
- 3 - Major Port Facility
- 4 - Major Amtrak Station
- 5 - Major Rail / Truck Terminal
- 6 - Major Intercity Bus Terminal
- 7 - Major Public Transit / Multi-modal Passenger Terminal
- 8 - Major Pipeline Terminal
- 9 - Major Ferry Terminal

Priority System

- G - General
- P - Priority System
- U - Urban

Scenic Byway Code

- A - All American Road
- N - National Scenic Byway
- S - State Scenic Byway

Shoulder Type

- 1 - None
- 2 - Surfaced shoulder exists (bituminous concrete {AC})
- 3 - Surfaced shoulder exists (Portland Cement Concrete {PCC})
- 4 - Stabilized shoulder exists (gravel or other granular material)
- 5 - Combination shoulder exists (two or more surface types)
- 6 - Earth shoulder exists
- 7 - Barrier curb exists; no shoulder in front of curb

Surface Type

- A - Combination
- B - Brick
- C - Continuous Reinforced Concrete
- D - Reinforced Concrete
- E - Plain Concrete
- G - Bituminous Concrete
- I - Chipseal on Granular
- K - Open Graded Bituminous
- L - Chipseal or Micro
- M - Gravel
- U - Unimproved
- X - Right of Way Only