

SDARSR00503**C

State True Log 31.229

32.229

County True Log

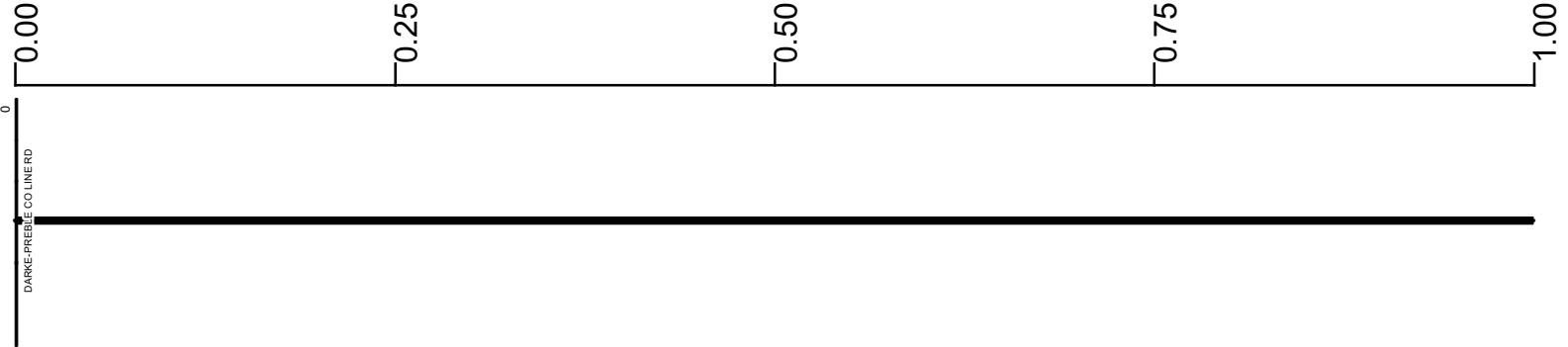

Surface Type & Width (Left / Right)

G 20'
0 - 1.368

Base Type (Left / Right)

I
0 - 9.302

Shoulder Type & Width (Left / Right)

2 (4/4')
0 - 1.368

Resurface Year

2021
0 - 9.302

Through Lanes

2
0 - 1.368

Street Name

SR 503
0 - 1.398

- | | | | |
|---------------------|-------------------|----------------------|--------------|
| Non-divided Highway | Bridge (on route) | Railroad (at grade) | Intersection |
| Divided Highway | Underpass | Railroad (underpass) | |
| Secondary Segment | Overpass | Railroad (overpass) | |
| Corporation | | | |

Created on: 6/27/2025

transportation.ohio.gov

Prepared by
The Ohio Department of Transportation
Office of Technical Services
Roadway Information

SDARSR00503**C

State True Log

33.229

County True Log

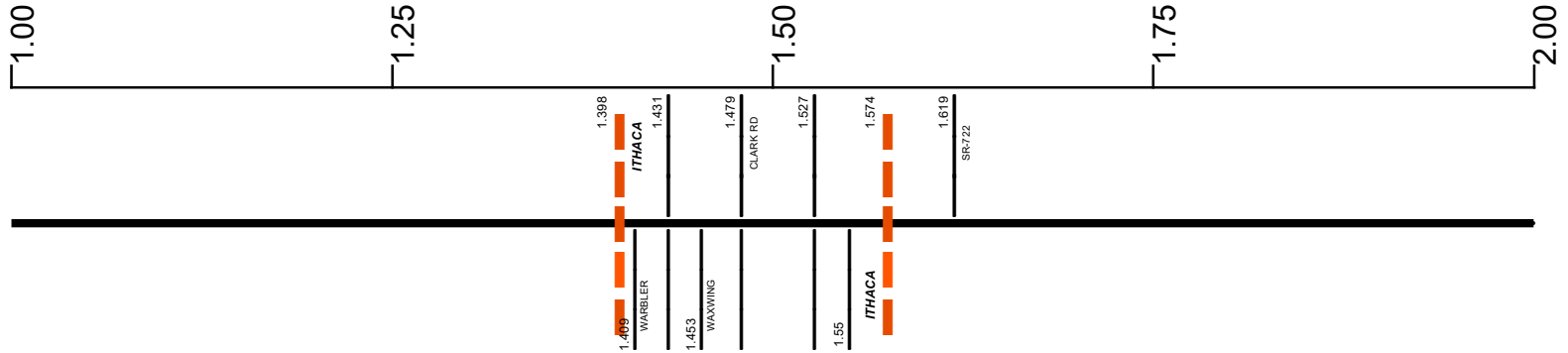

Surface Type & Width (Left / Right)

G 20'	G 40'	G (9'/10')
0 - 1.368	1.368 - 1.579	1.579 - 3.82

Base Type (Left / Right)

I
0 - 9.302

Shoulder Type & Width (Left / Right)

2 (4'/4')	1 (0'/0')	2 (2'/2')
0 - 1.368	1.368 - 1.579	1.579 - 6.483

Resurface Year

2021
0 - 9.302

Through Lanes

2	4	2
0 - 1.368	1.368 - 1.579	1.579 - 9.302

Street Name

SR 503	S MAIN ST	N MAIN ST	SR 503
0 - 1.398	1.398 - 1.479	1.479 - 1.574	1.574 - 9.302

- Non-divided Highway
- Divided Highway
- Secondary Segment
- Corporation
- Bridge (on route)
- Underpass
- Overpass
- Railroad (at grade)
- Railroad (underpass)
- Railroad (overpass)
- Intersection

Created on: 6/27/2025

transportation.ohio.gov

Prepared by
The Ohio Department of Transportation
Office of Technical Services
Roadway Information

SDARSR00503**C

State True Log

34.229

County True Log

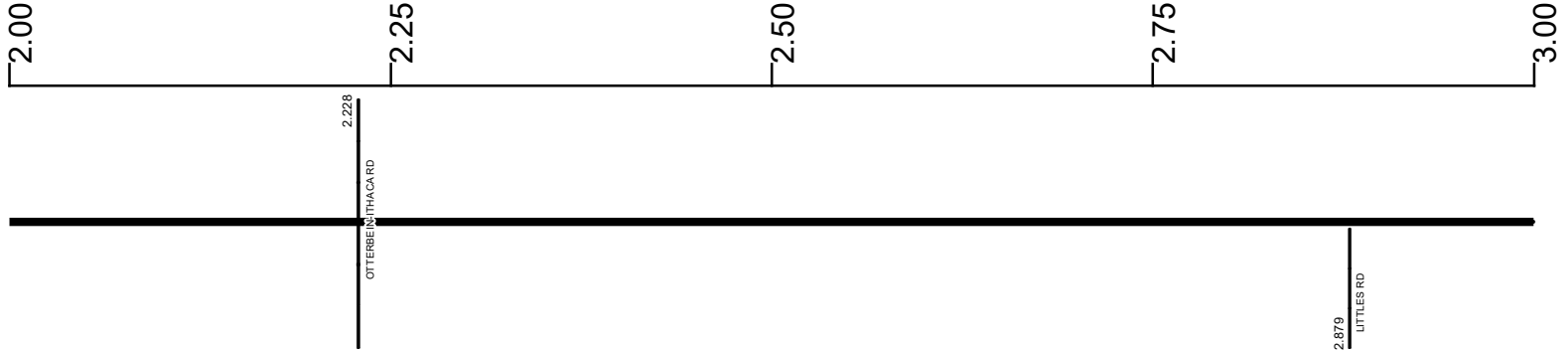

Surface Type & Width (Left / Right)

G (9'/10')
1.579 - 3.82

Base Type (Left / Right)

I
0 - 9.302

Shoulder Type & Width (Left / Right)

2 (2'/2')
1.579 - 6.483

Resurface Year

2021
0 - 9.302

Through Lanes

2
1.579 - 9.302

Street Name

SR 503
1.574 - 9.302

- Non-divided Highway
 Bridge (on route)
 Railroad (at grade)
 Intersection
- Divided Highway
 Underpass
 Railroad (underpass)
- Secondary Segment
 Overpass
 Railroad (overpass)
- Corporation**

Created on: 6/27/2025

transportation.ohio.gov

Prepared by
The Ohio Department of Transportation
Office of Technical Services
Roadway Information

SDARSR00503**C

State True Log

35.229

County True Log

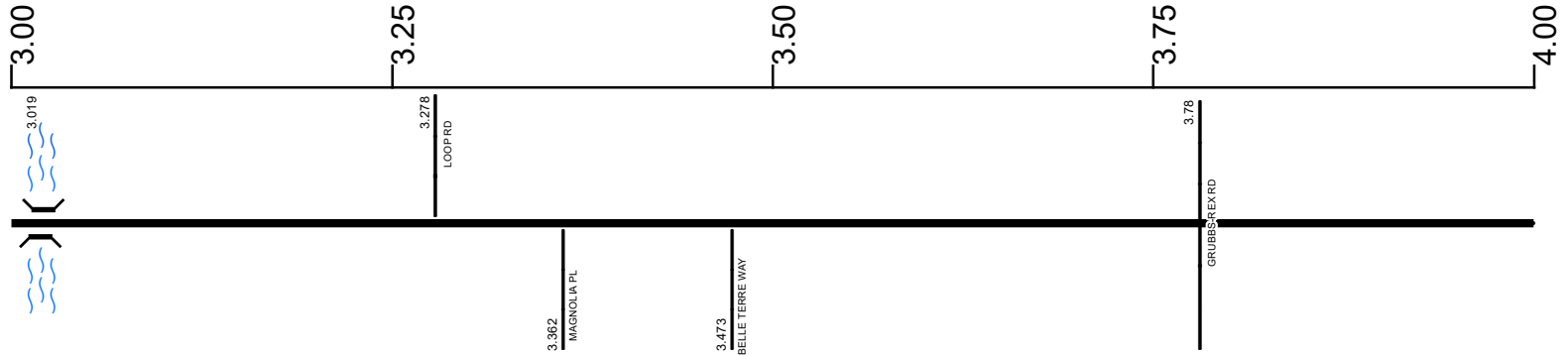

Surface Type & Width (Left / Right)

G (9/10')	G 18'
1.579 - 3.82	3.82 - 6.483

Base Type (Left / Right)

I	
0 - 9.302	

Shoulder Type & Width (Left / Right)

2 (2/2')	
1.579 - 6.483	

Resurface Year

2021	
0 - 9.302	

Through Lanes

2	
1.579 - 9.302	

Street Name

SR 503	
1.574 - 9.302	

<p> Non-divided Highway</p> <p> Divided Highway</p> <p> Secondary Segment</p> <p> Corporation</p>	<p> Bridge (on route)</p> <p> Underpass</p> <p> Overpass</p>	<p> Railroad (at grade)</p> <p> Railroad (underpass)</p> <p> Railroad (overpass)</p>	<p> Intersection</p>
---	--	--	----------------------

Created on: 6/27/2025

transportation.ohio.gov

Prepared by

The Ohio Department of Transportation

Office of Technical Services

Roadway Information

SDARSR00503**C

State True Log

36.229

County True Log

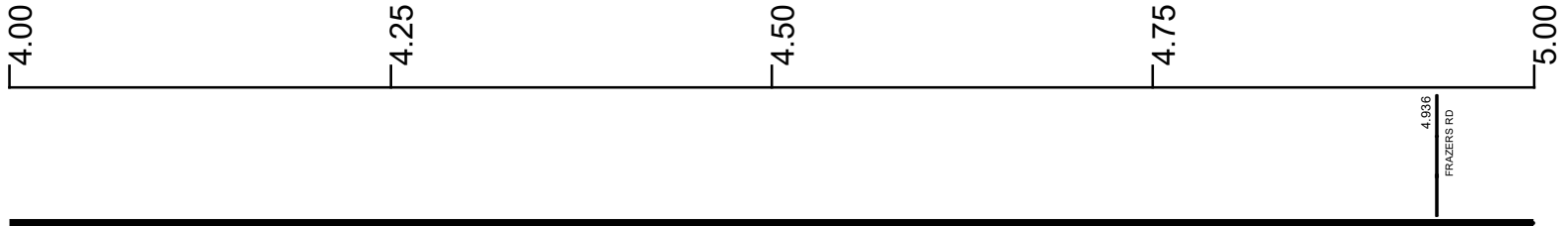

Surface Type & Width (Left / Right)

G 18'
3.82 - 6.483

Base Type (Left / Right)

I
0 - 9.302

Shoulder Type & Width (Left / Right)

2 (2/2)
1.579 - 6.483

Resurface Year

2021
0 - 9.302

Through Lanes

2
1.579 - 9.302

Street Name

SR 503
1.574 - 9.302

- | | | | |
|---------------------|-------------------|----------------------|--------------|
| Non-divided Highway | Bridge (on route) | Railroad (at grade) | Intersection |
| Divided Highway | Underpass | Railroad (underpass) | |
| Secondary Segment | Overpass | Railroad (overpass) | |
| Corporation | | | |

Created on: 6/27/2025

transportation.ohio.gov

Prepared by
The Ohio Department of Transportation
Office of Technical Services
Roadway Information

SDARSR00503**C

State True Log

37.229

County True Log

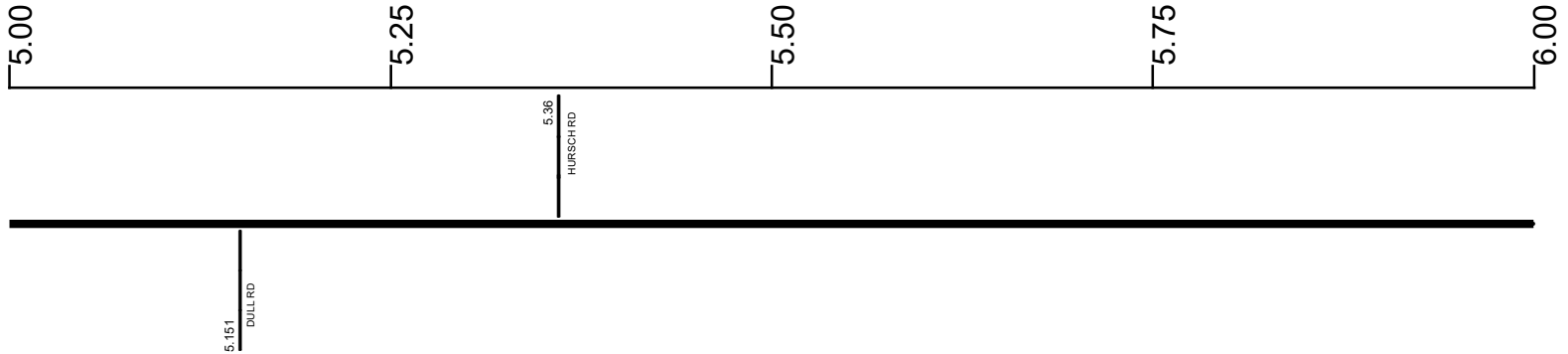

Surface Type & Width (Left / Right)

G 18'
3.82 - 6.483

Base Type (Left / Right)

I
0 - 9.302

Shoulder Type & Width (Left / Right)

2 (2/2)
1.579 - 6.483

Resurface Year

2021
0 - 9.302

Through Lanes

2
1.579 - 9.302

Street Name

SR 503
1.574 - 9.302

- Non-divided Highway
- Divided Highway
- Secondary Segment
- Corporation
- Bridge (on route)
- Underpass
- Overpass
- Railroad (at grade)
- Railroad (underpass)
- Railroad (overpass)
- Intersection

Created on: 6/27/2025

transportation.ohio.gov

Prepared by
The Ohio Department of Transportation
Office of Technical Services
Roadway Information

SDARSR00503**C

State True Log

38.229

County True Log

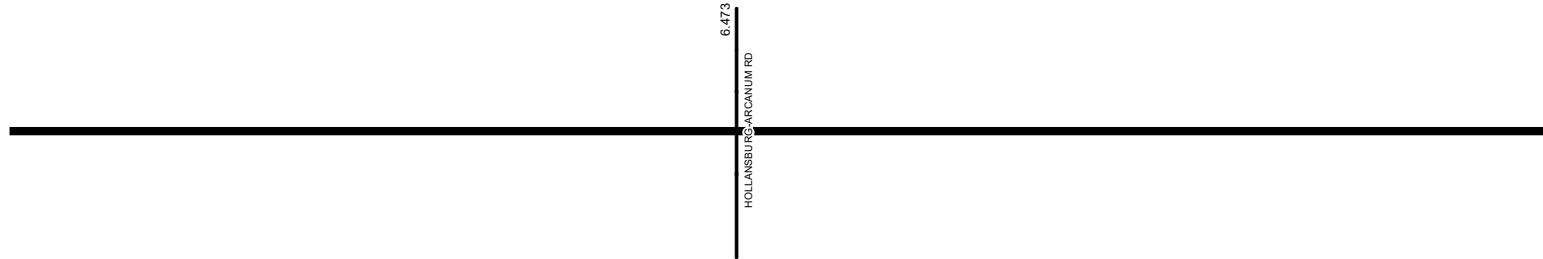

Surface Type & Width (Left / Right)

G 18' 3.82 - 6.483	G (9/10') 6.483 - 7.707
-----------------------	----------------------------

Base Type (Left / Right)

I 0 - 9.302	
----------------	--

Shoulder Type & Width (Left / Right)

2 (2 1/2') 1.579 - 6.483	2 (1 1/2') 6.483 - 7.707
-----------------------------	-----------------------------

Resurface Year

2021 0 - 9.302	
-------------------	--

Through Lanes

2 1.579 - 9.302	
--------------------	--

Street Name

SR 503 1.574 - 9.302	
-------------------------	--

- | | | | |
|--|---|---|---|
| <ul style="list-style-type: none"> Non-divided Highway Divided Highway Secondary Segment Corporation | <ul style="list-style-type: none"> Bridge (on route) Underpass Overpass | <ul style="list-style-type: none"> Railroad (at grade) Railroad (underpass) Railroad (overpass) | <ul style="list-style-type: none"> Intersection |
|--|---|---|---|

Created on: 6/27/2025

transportation.ohio.gov

Prepared by
The Ohio Department of Transportation
Office of Technical Services
Roadway Information

SDARSR00503**C

State True Log

39.229

County True Log

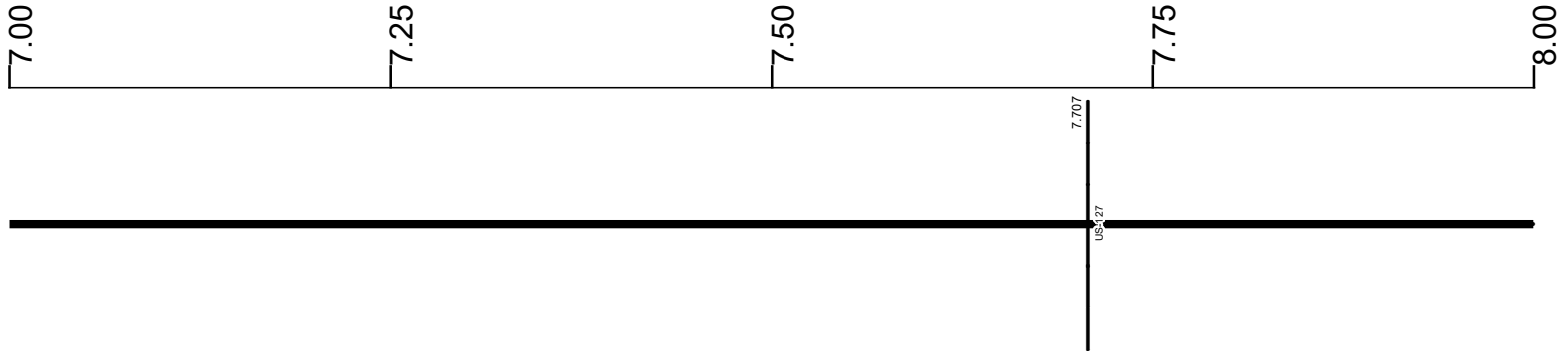

Surface Type & Width (Left / Right)

G (9'10") 6.483 - 7.707	G 20' 7.707 - 9.302
----------------------------	------------------------

Base Type (Left / Right)

I 0 - 9.302	
----------------	--

Shoulder Type & Width (Left / Right)

2 (1 1/2') 6.483 - 7.707	2 (8/8') 7.707 - 9.302
-----------------------------	---------------------------

Resurface Year

2021 0 - 9.302	
-------------------	--

Through Lanes

2 1.579 - 9.302	
--------------------	--

Street Name

SR 503 1.574 - 9.302	
-------------------------	--

- | | | | |
|--|---|---|---|
| <ul style="list-style-type: none"> Non-divided Highway Divided Highway Secondary Segment Corporation | <ul style="list-style-type: none"> Bridge (on route) Underpass Overpass | <ul style="list-style-type: none"> Railroad (at grade) Railroad (underpass) Railroad (overpass) | <ul style="list-style-type: none"> Intersection |
|--|---|---|---|

Created on: 6/27/2025

transportation.ohio.gov

Prepared by
The Ohio Department of Transportation
Office of Technical Services
Roadway Information

SDARSR00503**C

State True Log

40.229

County True Log

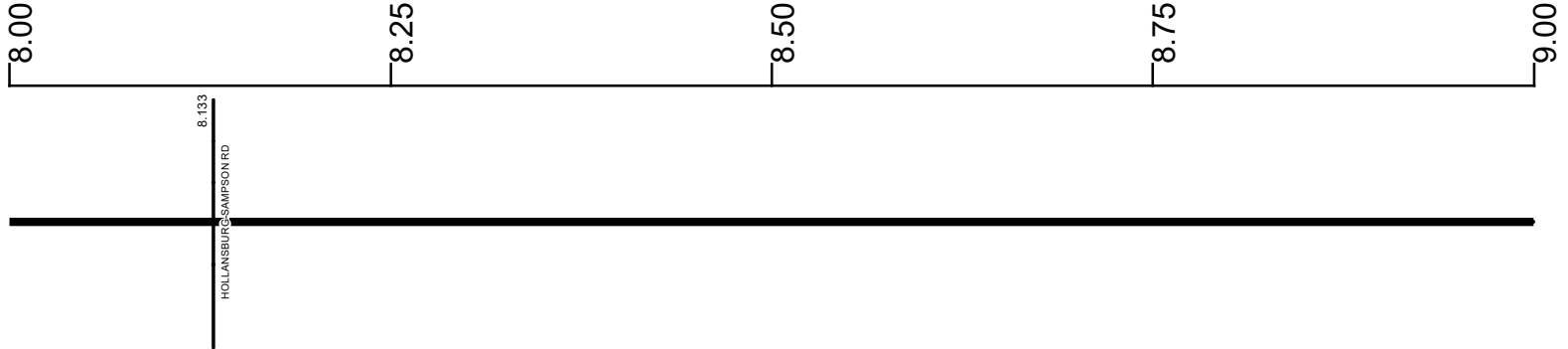

Surface Type & Width (Left / Right)

G 20'
7.707 - 9.302

Base Type (Left / Right)

I
0 - 9.302

Shoulder Type & Width (Left / Right)

2 (8/8)
7.707 - 9.302

Resurface Year

2021
0 - 9.302

Through Lanes

2
1.579 - 9.302

Street Name

SR 503
1.574 - 9.302

- Non-divided Highway
- Divided Highway
- Secondary Segment
- Corporation
- Bridge (on route)
- Underpass
- Overpass
- Railroad (at grade)
- Railroad (underpass)
- Railroad (overpass)
- Intersection

Created on: 6/27/2025

transportation.ohio.gov

Prepared by
The Ohio Department of Transportation
Office of Technical Services
Roadway Information

SDARSR00503**C

State True Log

40.531

County True Log

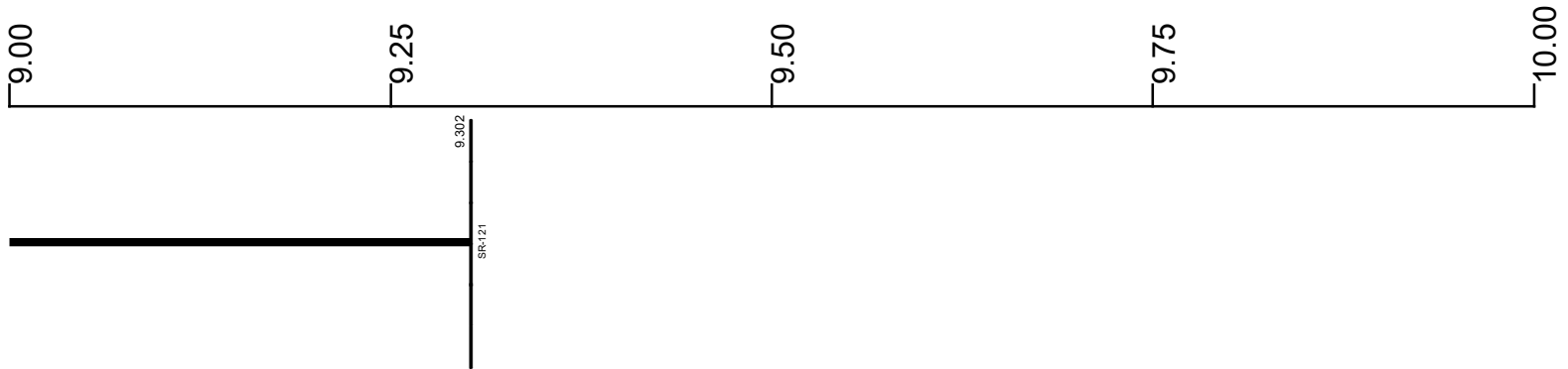

Surface Type & Width (Left / Right)

G 20'
7.707 - 9.302

Base Type (Left / Right)

I
0 - 9.302

Shoulder Type & Width (Left / Right)

2 (8'8")
7.707 - 9.302

Resurface Year

2021
0 - 9.302

Through Lanes

2
1.579 - 9.302

Street Name

SR 503
1.574 - 9.302

- | | | | |
|--|---|---|---|
| <ul style="list-style-type: none"> Non-divided Highway Divided Highway Secondary Segment Corporation | <ul style="list-style-type: none"> Bridge (on route) Underpass Overpass | <ul style="list-style-type: none"> Railroad (at grade) Railroad (underpass) Railroad (overpass) | <ul style="list-style-type: none"> Intersection |
|--|---|---|---|

Created on: 6/27/2025

transportation.ohio.gov

Prepared by
The Ohio Department of Transportation
Office of Technical Services
Roadway Information

Historical Project List for SDARSR00503**C

Begin Measure	End Measure	Project ID Number	Construction Completion Date	Treatment Category	Treatment Type
0.000	0.800	107451	8-2022	Minor Rehabilitation	60-AC Overlay w/Rpr
0.000	9.290	80879	11-2009	Minor Rehabilitation	60-AC Overlay w/Rpr
0.800	7.700	107451	8-2022	Minor Rehabilitation	60-AC Overlay w/Rpr
7.700	9.290	107451	8-2022	Minor Rehabilitation	60-AC Overlay w/Rpr

Roadway Codes

Access Control Journalized

- F - Full Access Control
- L - Limited Access Control
- N - No Access Control

Access Control Operational

- 1 - Full Access Control
- 2 - Partial Access Control
- 3 - No Access Control

Base Type

- F - Crack and Seat
- H - Rubblize and Roll
- I - Aggregate Base 304 or Traffic Compacted
- K - Water Bound Macadam
- L - Bituminous Concrete Mix or Penetration Macadam
- N - Plain Concrete
- P - Reinforced Concrete
- R - Brick (Flexible)
- T - Brick (Rigid)

Direction of Travel

- B - Both (Two-way)
- F - One-way Cardinal
- T - One-way Non-cardinal

Facility Type

- 1 - One-way Roadway
- 2 - Two-way Roadway
- 4 - Ramp
- 5 - Non-mainline
- 6 - Non-inventory Direction
- 7 - Planned / Unbuilt

Historical Federal Aid Indicator

- N - Not a FAP Route
- Y - FAP Route

Functional Classification

- 01 - Interstate
- 02 - Principal Arterial (Freeways)
- 03 - Principal Arterial (Other)
- 04 - Minor Arterial
- 05 - Major Collector
- 06 - Minor Collector
- 07 - Local

Leave / Reenter Indicator

- Y - Route leaves/reenters at this point
- N - Route does not leave/reenter at this point

Median Type

- 1 - None
- 2 - Unprotected
- 3 - Curbed
- 4 - Positive Barrier (Unspecified)
- 5 - Positive Barrier (Flexible)
- 6 - Positive Barrier (Semi-rigid)
- 7 - Positive Barrier (Rigid)

NHS

- N - National Highway System
- H - Congressional Corridor
- 2 - Major Airport
- 3 - Major Port Facility
- 4 - Major Amtrak Station
- 5 - Major Rail / Truck Terminal
- 6 - Major Intercity Bus Terminal
- 7 - Major Public Transit / Multi-modal Passenger Terminal
- 8 - Major Pipeline Terminal
- 9 - Major Ferry Terminal

Priority System

- G - General
- P - Priority System
- U - Urban

Scenic Byway Code

- A - All American Road
- N - National Scenic Byway
- S - State Scenic Byway

Shoulder Type

- 1 - None
- 2 - Surfaced shoulder exists (bituminous concrete {AC})
- 3 - Surfaced shoulder exists (Portland Cement Concrete {PCC})
- 4 - Stabilized shoulder exists (gravel or other granular material)
- 5 - Combination shoulder exists (two or more surface types)
- 6 - Earth shoulder exists
- 7 - Barrier curb exists; no shoulder in front of curb

Surface Type

- A - Combination
- B - Brick
- C - Continuous Reinforced Concrete
- D - Reinforced Concrete
- E - Plain Concrete
- G - Bituminous Concrete
- I - Chipseal on Granular
- K - Open Graded Bituminous
- L - Chipseal or Micro
- M - Gravel
- U - Unimproved
- X - Right of Way Only