

SDELSR00257**C

State True Log 2.945

3.945

County True Log

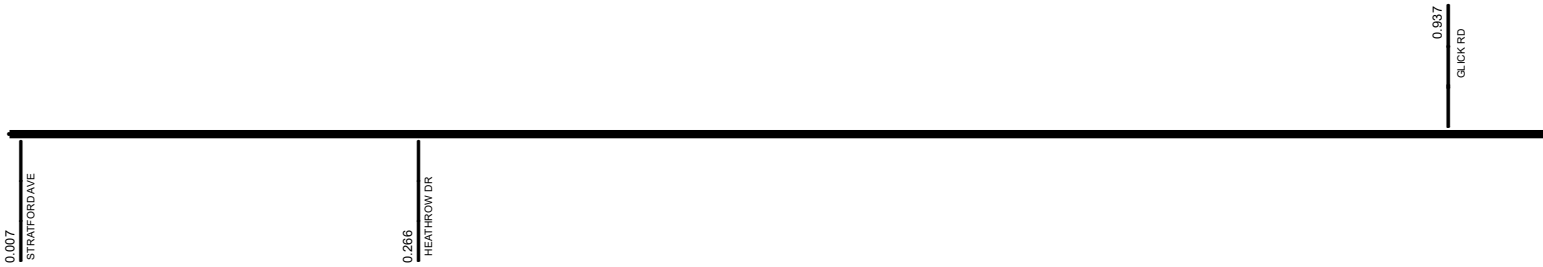

Surface Type & Width (Left / Right)

| | | |
|-------------|---------------|---------------|
| G (22'/23') | G 50' | G 70' |
| 0 - 0.774 | 0.774 - 0.884 | 0.884 - 1.113 |

Base Type (Left / Right)

| | |
|-----------|---------------|
| K | L |
| 0 - 0.884 | 0.884 - 1.452 |

Shoulder Type & Width (Left / Right)

| | | |
|-----------|---------------|---------------|
| 2 (4'/5') | 2 (6'/6') | 2 (8'/8') |
| 0 - 0.774 | 0.774 - 0.884 | 0.884 - 1.113 |

Through Lanes

| |
|-----------|
| 4 |
| 0 - 1.491 |

Street Name

| |
|--------------|
| RIVERSIDE DR |
| 0 - 7.763 |

- | | | | |
|--|---|---|---|
| <ul style="list-style-type: none"> Non-divided Highway Divided Highway Secondary Segment Corporation | <ul style="list-style-type: none"> Bridge (on route) Underpass Overpass | <ul style="list-style-type: none"> Railroad (at grade) Railroad (underpass) Railroad (overpass) | <ul style="list-style-type: none"> Intersection |
|--|---|---|---|

Created on: 6/27/2025

transportation.ohio.gov

Prepared by
The Ohio Department of Transportation
Office of Technical Services
Roadway Information

SDELSR00257**C

State True Log

4.945

County True Log

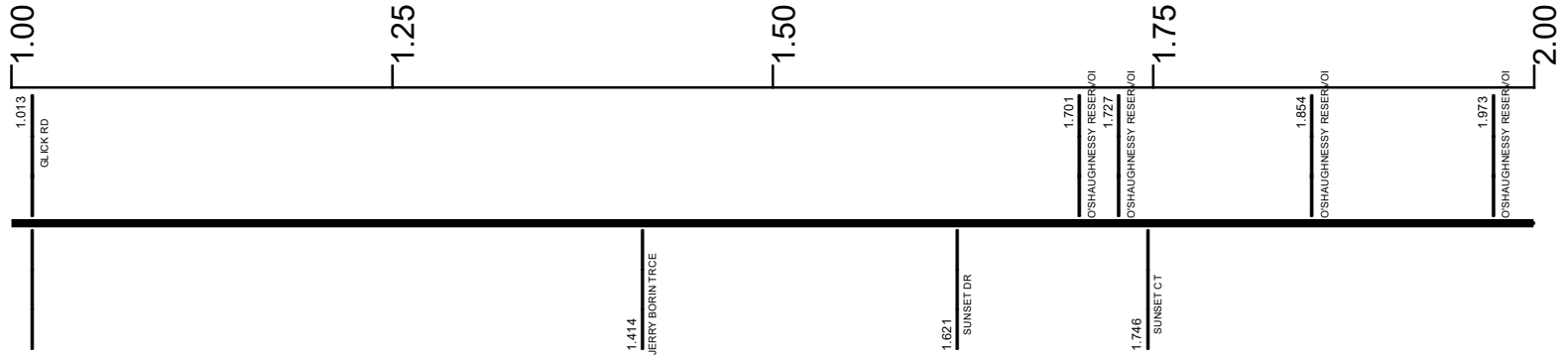

Surface Type & Width (Left / Right)

| | | | |
|---------------|---------------|---------------|---------------|
| G 70' | G 48' | G 36' | G 20' |
| 0.884 - 1.113 | 1.113 - 1.332 | 1.332 - 1.452 | 1.452 - 2.946 |

Base Type (Left / Right)

| | |
|---------------|---------------|
| L | K |
| 0.884 - 1.452 | 1.452 - 2.946 |

Shoulder Type & Width (Left / Right)

| | | | |
|---------------|---------------|---------------|---------------|
| 2 (8/8') | 1 (0/0') | 2 (4/0') | 2 (4/4') |
| 0.884 - 1.113 | 1.113 - 1.452 | 1.452 - 1.491 | 1.491 - 2.946 |

Resurface Year

| | |
|--|---------------|
| | 2020 |
| | 1.521 - 4.091 |

Through Lanes

| | |
|-----------|---------------|
| 4 | 2 |
| 0 - 1.491 | 1.491 - 7.763 |

Street Name

| |
|--------------|
| RIVERSIDE DR |
| 0 - 7.763 |

- Non-divided Highway
- Divided Highway
- Secondary Segment
- Corporation
- Bridge (on route)
- Underpass
- Overpass
- Railroad (at grade)
- Railroad (underpass)
- Railroad (overpass)
- Intersection

Created on: 6/27/2025

transportation.ohio.gov

Prepared by
The Ohio Department of Transportation
Office of Technical Services
Roadway Information

SDELSR00257**C

State True Log

County True Log

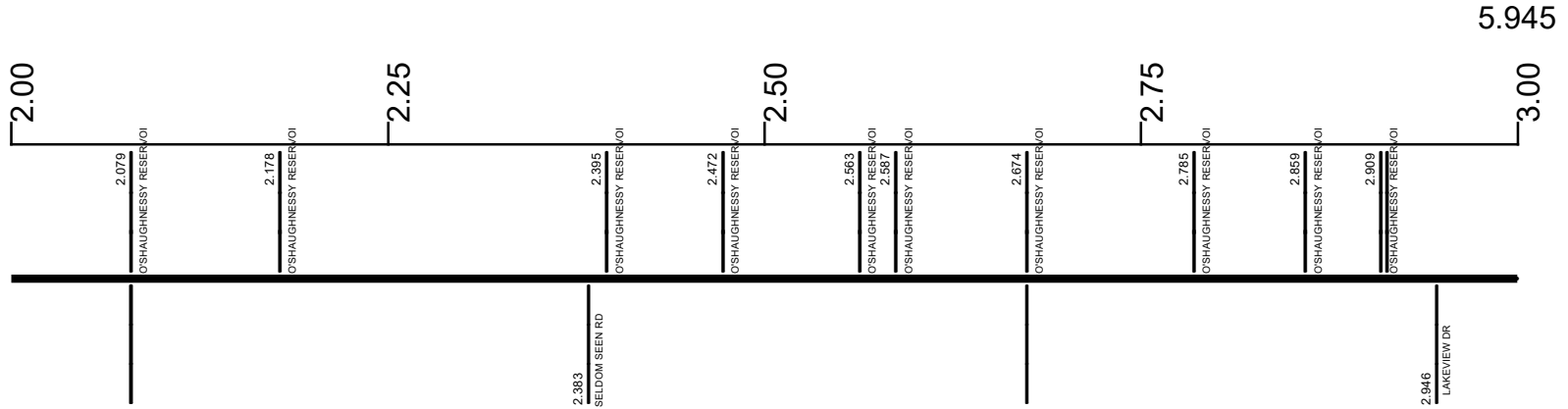

Surface Type & Width (Left / Right)

| | |
|---------------|---------------|
| G 20' | G 24' |
| 1.452 - 2.946 | 2.946 - 3.755 |

Base Type (Left / Right)

| | |
|---------------|---------------|
| K | L |
| 1.452 - 2.946 | 2.946 - 3.755 |

Shoulder Type & Width (Left / Right)

| | |
|---------------|---------------|
| 2 (4'4") | 2 (10'/10") |
| 1.491 - 2.946 | 2.946 - 3.755 |

Resurface Year

| |
|------|
| 2020 |
|------|

Through Lanes

| |
|---|
| 2 |
|---|

Street Name

| |
|---------------------------|
| RIVERSIDE DR 0 - 7.763 |
|---------------------------|

- Non-divided Highway
- Divided Highway
- Secondary Segment
- Corporation
- Bridge (on route)
- Underpass
- Overpass
- Railroad (at grade)
- Railroad (underpass)
- Railroad (overpass)
- Intersection

Created on: 6/27/2025

transportation.ohio.gov

Prepared by
The Ohio Department of Transportation
Office of Technical Services
Roadway Information

SDELSR00257**C

State True Log

6.945

County True Log



Surface Type & Width (Left / Right)

| | |
|---------------|--------------|
| G 24' | G 20' |
| 2.946 - 3.755 | 3.755 - 4.16 |

Base Type (Left / Right)

| | |
|---------------|--------------|
| L | K |
| 2.946 - 3.755 | 3.755 - 4.16 |

Shoulder Type & Width (Left / Right)

| | |
|---------------|--------------|
| 2 (10'/10') | 2 (4'/4') |
| 2.946 - 3.755 | 3.755 - 4.16 |

Resurface Year

| |
|------|
| 2020 |
|------|

Through Lanes

| |
|---|
| 2 |
|---|

Street Name

| |
|---------------------------|
| RIVERSIDE DR 0 - 7.763 |
|---------------------------|

- | | | | |
|--|---|---|---|
| <ul style="list-style-type: none"> Non-divided Highway Divided Highway Secondary Segment Corporation | <ul style="list-style-type: none"> Bridge (on route) Underpass Overpass | <ul style="list-style-type: none"> Railroad (at grade) Railroad (underpass) Railroad (overpass) | <ul style="list-style-type: none"> Intersection |
|--|---|---|---|

Created on: 6/27/2025

transportation.ohio.gov

Prepared by
The Ohio Department of Transportation
Office of Technical Services
Roadway Information

SDELSR00257**C

State True Log

7.945

County True Log

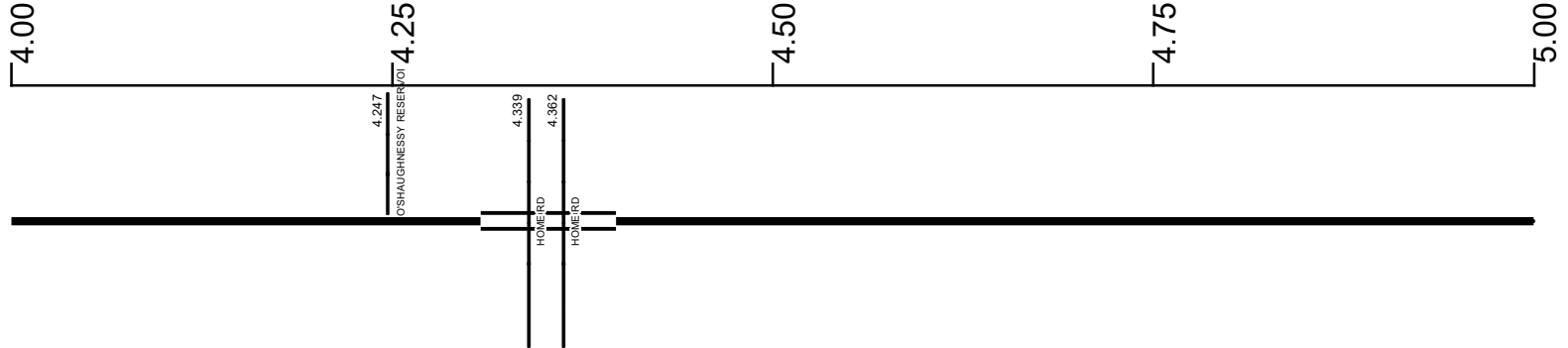

Surface Type & Width (Left / Right)

| | | | | | | |
|--------------|--------------|---------------|---------------|---------------|---------------|---------------|
| G 20' | G 24' | G 48' | G 24' | G 20' | G 24' | G 20' |
| 3.755 - 4.16 | 4.16 - 4.259 | 4.259 - 4.436 | 4.436 - 4.544 | 4.544 - 4.819 | 4.819 - 4.947 | 4.947 - 6.075 |

Base Type (Left / Right)

| | | | | |
|--------------|--------------|---------------|---------------|---------------|
| K | L | K | I | K |
| 3.755 - 4.16 | 4.16 - 4.544 | 4.544 - 4.819 | 4.819 - 4.947 | 4.947 - 6.075 |

Shoulder Type & Width (Left / Right)

| | | | | |
|--------------|--------------|---------------|---------------|---------------|
| 2 (4/4') | 2 (8/8') | 2 (4/4') | 2 (8/8') | 2 (4/4') |
| 3.755 - 4.16 | 4.16 - 4.544 | 4.544 - 4.819 | 4.819 - 4.947 | 4.947 - 6.075 |

Median Type and Width

| |
|---------------|
| 3 (9999') |
| 4.308 - 4.397 |

Resurface Year

| |
|---------------|
| 2020 |
| 1.521 - 4.091 |

Resurface Year

| |
|---------------|
| 2020 |
| 4.544 - 7.763 |

Through Lanes

| |
|---------------|
| 2 |
| 1.491 - 7.763 |

Street Name

| |
|--------------|
| RIVERSIDE DR |
| 0 - 7.763 |

- Non-divided Highway
- Divided Highway
- Secondary Segment
- Corporation
- Bridge (on route)
- Underpass
- Overpass
- Railroad (at grade)
- Railroad (underpass)
- Railroad (overpass)
- Intersection

Created on: 6/27/2025

transportation.ohio.gov

Prepared by
The Ohio Department of Transportation
Office of Technical Services
Roadway Information

SDELSR00257**C

State True Log

8.945

County True Log



Surface Type & Width (Left / Right)

G 20'
4.947 - 6.075

Base Type (Left / Right)

K
4.947 - 6.075

Shoulder Type & Width (Left / Right)

2 (4/4')
4.947 - 6.075

Resurface Year

2020
4.544 - 7.763

Through Lanes

2
1.491 - 7.763

Street Name

RIVERSIDE DR
0 - 7.763

- | | | | |
|---------------------|-------------------|----------------------|--------------|
| Non-divided Highway | Bridge (on route) | Railroad (at grade) | Intersection |
| Divided Highway | Underpass | Railroad (underpass) | |
| Secondary Segment | Overpass | Railroad (overpass) | |
| Corporation | | | |

Created on: 6/27/2025



transportation.ohio.gov
 Prepared by
 The Ohio Department of Transportation
 Office of Technical Services
 Roadway Information

SDELSR00257**C

State True Log

9.945

County True Log

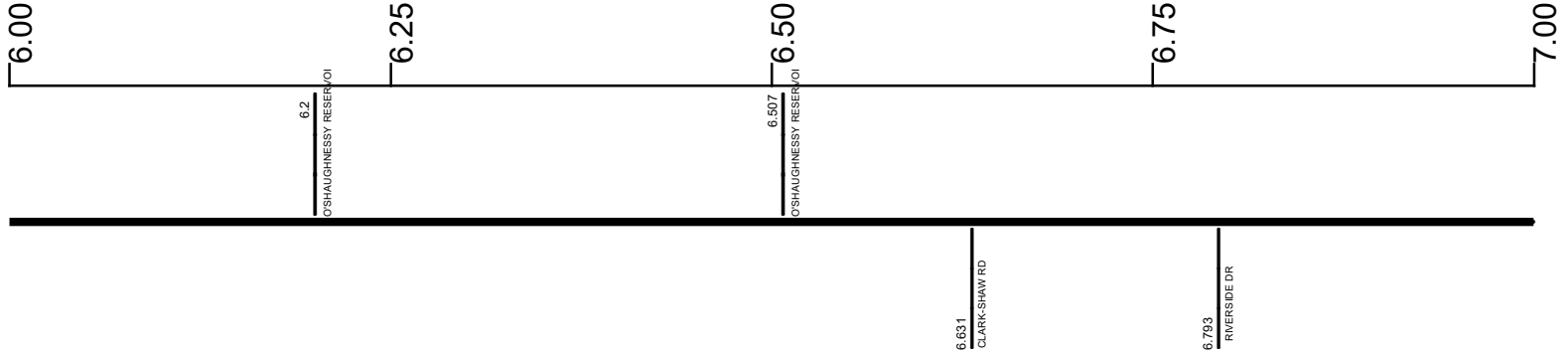

Surface Type & Width (Left / Right)

| | | |
|---------------|---------------|---------------|
| G 20' | G 24' | G 20' |
| 4.947 - 6.075 | 6.075 - 6.209 | 6.209 - 7.763 |

Base Type (Left / Right)

| | | |
|---------------|---------------|---------------|
| K | I | K |
| 4.947 - 6.075 | 6.075 - 6.209 | 6.209 - 7.763 |

Shoulder Type & Width (Left / Right)

| | | |
|---------------|---------------|---------------|
| 2 (4/4') | 2 (8/8') | 2 (4/4') |
| 4.947 - 6.075 | 6.075 - 6.209 | 6.209 - 7.533 |

Resurface Year

2020

Through Lanes

2

Street Name

RIVERSIDE DR
0 - 7.763

- Non-divided Highway
- Divided Highway
- Secondary Segment
- Corporation
- Bridge (on route)
- Underpass
- Overpass
- Railroad (at grade)
- Railroad (underpass)
- Railroad (overpass)
- Intersection

Created on: 6/27/2025

transportation.ohio.gov

Prepared by
The Ohio Department of Transportation
Office of Technical Services
Roadway Information

SDELSR00257**C

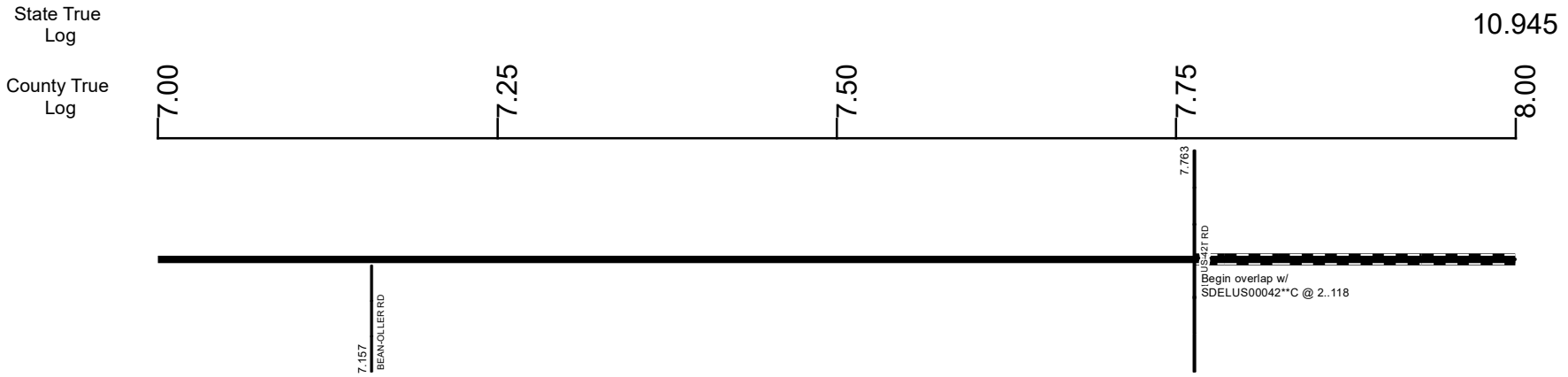

Surface Type & Width (Left / Right)

G 20'
6.209 - 7.763

Base Type (Left / Right)

K
6.209 - 7.763

Shoulder Type & Width (Left / Right)

| | |
|---------------------------|---------------------------|
| 2 (4'4") 6.209 - 7.533 | 2 (6'6") 7.533 - 7.763 |
|---------------------------|---------------------------|

Resurface Year

2020
4.544 - 7.763

Through Lanes

2
1.491 - 7.763

Street Name

RIVERSIDE DR
0 - 7.763

- | | | | |
|---------------------|-------------------|----------------------|--------------|
| Non-divided Highway | Bridge (on route) | Railroad (at grade) | Intersection |
| Divided Highway | Underpass | Railroad (underpass) | |
| Secondary Segment | Overpass | Railroad (overpass) | |
| Corporation | | | |

Created on: 6/27/2025

transportation.ohio.gov

Prepared by
The Ohio Department of Transportation
Office of Technical Services
Roadway Information

SDELSR00257**C

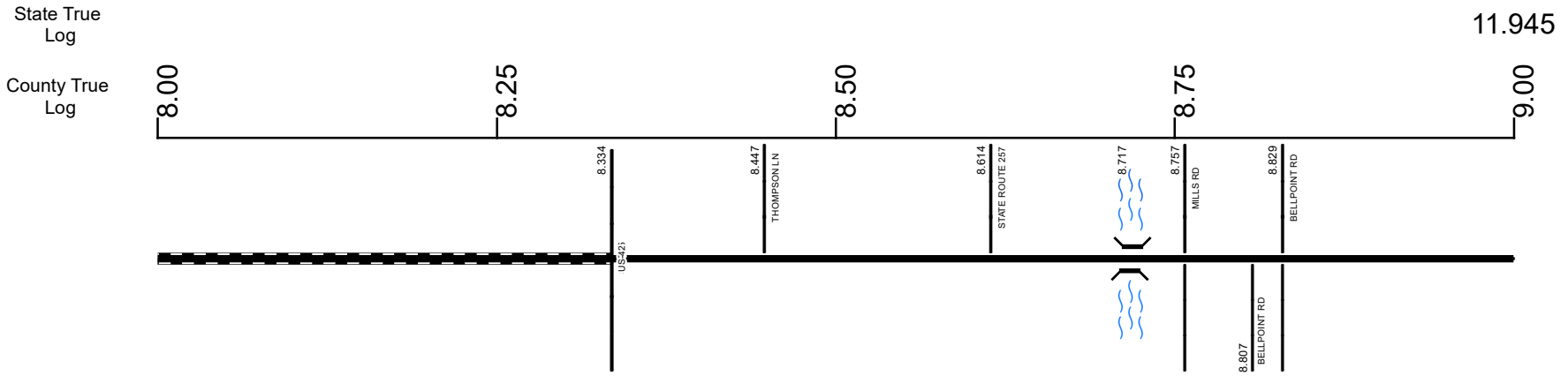

| Surface Type & Width (Left / Right) | |
|--------------------------------------|--|
| G 20' | G (9'/10') |
| 8.334 - 8.788 | 8.788 - 14.244 |
| Base Type (Left / Right) | |
| K | I |
| 8.334 - 8.788 | 8.788 - 22.636 |
| Shoulder Type & Width (Left / Right) | |
| 2 (8/8') | 2 (2/2') |
| 8.334 - 8.788 | 8.788 - 22.636 |
| Through Lanes | |
| 2 | |
| 8.334 - 22.636 | |
| Street Name | |
| SR 257 | MAIN ST SR 257 |
| 8.334 - 8.829 | 8.829 - 8.865 8.873 - 8.915 8.915 - 14.244 |

| | | | |
|--|---|---|---|
| <ul style="list-style-type: none"> Non-divided Highway Divided Highway Secondary Segment Corporation | <ul style="list-style-type: none"> Bridge (on route) Underpass Overpass | <ul style="list-style-type: none"> Railroad (at grade) Railroad (underpass) Railroad (overpass) | <ul style="list-style-type: none"> Intersection |
|--|---|---|---|

Created on: 6/27/2025

transportation.ohio.gov

Prepared by
The Ohio Department of Transportation
Office of Technical Services
Roadway Information

SDELSR00257**C

State True Log

12.945

County True Log

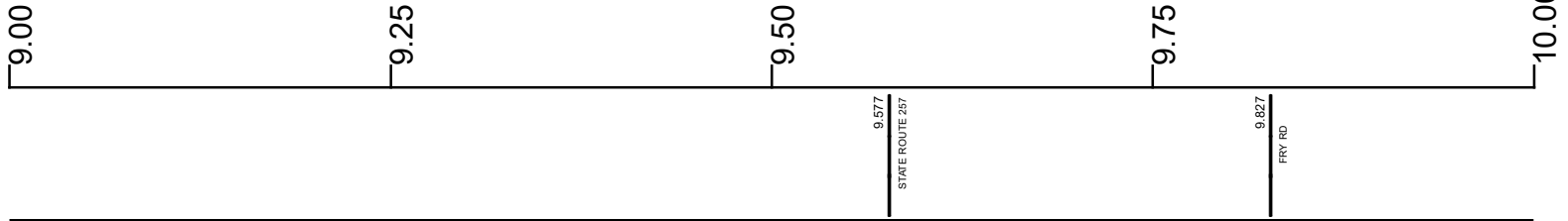

Surface Type & Width (Left / Right)

G (9'/10')
8.788 - 14.244

Base Type (Left / Right)

I
8.788 - 22.636

Shoulder Type & Width (Left / Right)

2 (2'/2')
8.788 - 22.636

Through Lanes

2
8.334 - 22.636

Street Name

SR 257
8.915 - 14.244

- | | | | |
|---------------------|-------------------|----------------------|--------------|
| Non-divided Highway | Bridge (on route) | Railroad (at grade) | Intersection |
| Divided Highway | Underpass | Railroad (underpass) | |
| Secondary Segment | Overpass | Railroad (overpass) | |
| Corporation | | | |

Created on: 6/27/2025

transportation.ohio.gov

Prepared by
The Ohio Department of Transportation
Office of Technical Services
Roadway Information

SDELSR00257**C

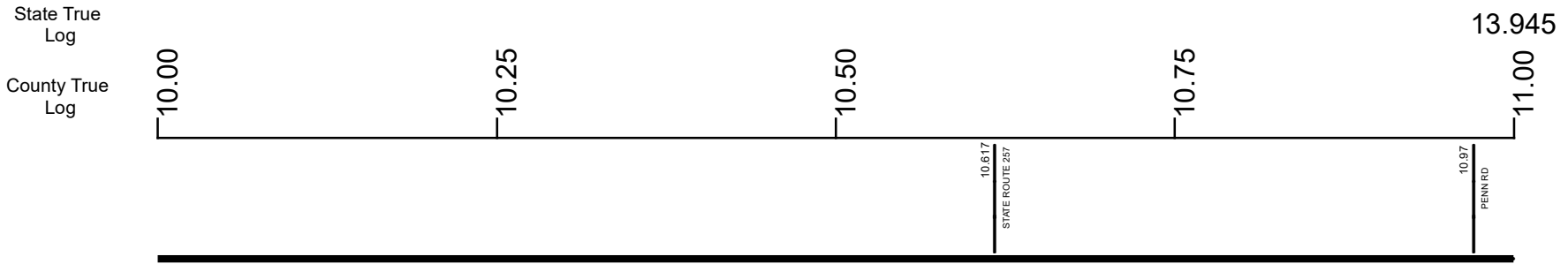

Surface Type & Width (Left / Right)

G (9'/10')
8.788 - 14.244

Base Type (Left / Right)

I
8.788 - 22.636

Shoulder Type & Width (Left / Right)

2 (2'/2')
8.788 - 22.636

Through Lanes

2
8.334 - 22.636

Street Name

SR 257
8.915 - 14.244

- Non-divided Highway
 Bridge (on route)
 Railroad (at grade)
 Intersection
- Divided Highway
 Underpass
 Railroad (underpass)
- Secondary Segment
 Overpass
 Railroad (overpass)
- Corporation**

Created on: 6/27/2025



transportation.ohio.gov

Prepared by
The Ohio Department of Transportation
Office of Technical Services
Roadway Information

SDELSR00257**C

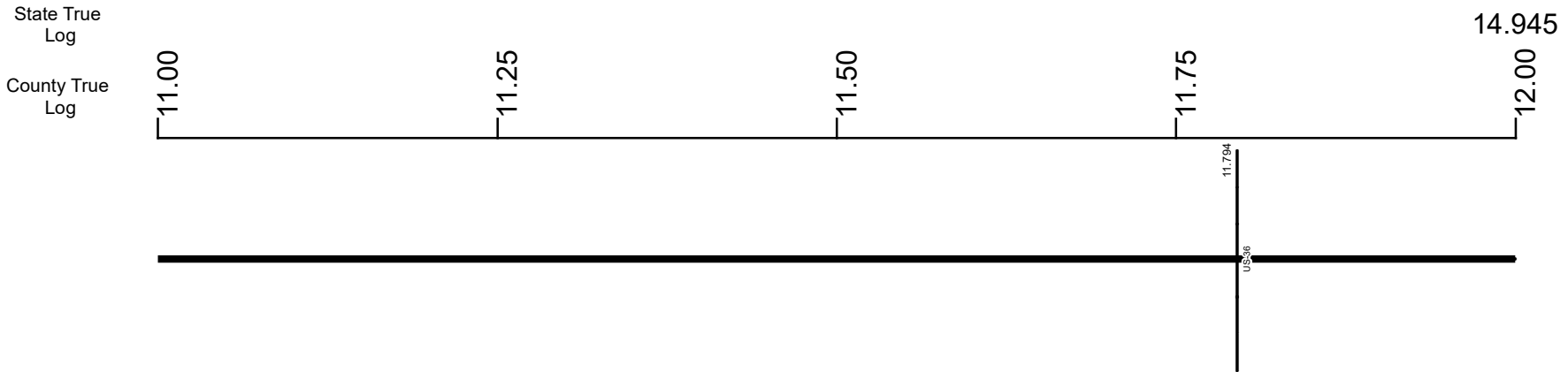

| | |
|--------------------------------------|----------------|
| Surface Type & Width (Left / Right) | G (9'/10') |
| | 8.788 - 14.244 |
| Base Type (Left / Right) | I |
| | 8.788 - 22.636 |
| Shoulder Type & Width (Left / Right) | 2 (2'/2') |
| | 8.788 - 22.636 |
| Through Lanes | 2 |
| | 8.334 - 22.636 |
| Street Name | SR 257 |
| | 8.915 - 14.244 |

| | | | |
|---------------------|-------------------|----------------------|--------------|
| Non-divided Highway | Bridge (on route) | Railroad (at grade) | Intersection |
| Divided Highway | Underpass | Railroad (underpass) | |
| Secondary Segment | Overpass | Railroad (overpass) | |
| Corporation | | | |

Created on: 6/27/2025

transportation.ohio.gov

Prepared by
The Ohio Department of Transportation
Office of Technical Services
Roadway Information

SDELSR00257**C

State True
Log

15.945

County True
Log

12.00

12.25

12.50

12.75

13.00



Surface Type & Width (Left / Right)

| |
|----------------|
| G (9/10') |
| 8.788 - 14.244 |

Base Type (Left / Right)

| |
|----------------|
| I |
| 8.788 - 22.636 |

Shoulder Type & Width (Left / Right)

| |
|----------------|
| 2 (2/2') |
| 8.788 - 22.636 |

Through Lanes

| |
|----------------|
| 2 |
| 8.334 - 22.636 |

Street Name

| |
|----------------|
| SR 257 |
| 8.915 - 14.244 |

- | | | | |
|---------------------|-------------------|----------------------|--------------|
| Non-divided Highway | Bridge (on route) | Railroad (at grade) | Intersection |
| Divided Highway | Underpass | Railroad (underpass) | |
| Secondary Segment | Overpass | Railroad (overpass) | |
| Corporation | | | |

Created on: 6/27/2025

transportation.ohio.gov

Prepared by
The Ohio Department of Transportation
Office of Technical Services
Roadway Information

SDELSR00257**C

State True Log
County True Log

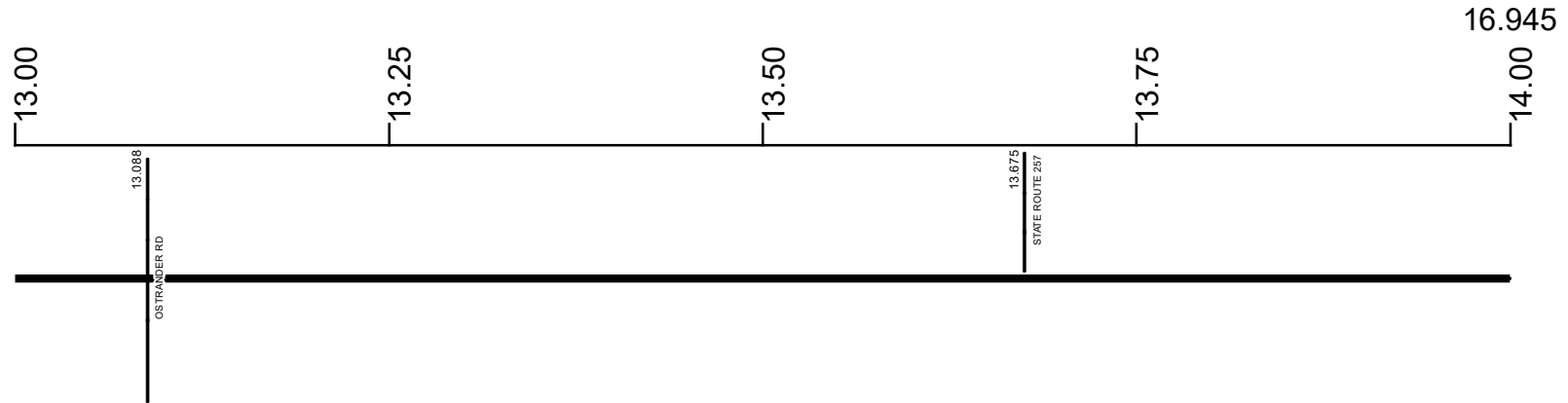

Surface Type & Width (Left / Right)

| | |
|--|----------------|
| | G (9'/10') |
| | 8.788 - 14.244 |

Base Type (Left / Right)

| | |
|--|----------------|
| | I |
| | 8.788 - 22.636 |

Shoulder Type & Width (Left / Right)

| | |
|--|----------------|
| | 2 (2'/2') |
| | 8.788 - 22.636 |

Through Lanes

| | |
|--|----------------|
| | 2 |
| | 8.334 - 22.636 |

Street Name

| | |
|--|----------------|
| | SR 257 |
| | 8.915 - 14.244 |

- | | | | |
|---------------------|-------------------|----------------------|--------------|
| Non-divided Highway | Bridge (on route) | Railroad (at grade) | Intersection |
| Divided Highway | Underpass | Railroad (underpass) | |
| Secondary Segment | Overpass | Railroad (overpass) | |
| Corporation | | | |

Created on: 6/27/2025

transportation.ohio.gov

Prepared by
The Ohio Department of Transportation
Office of Technical Services
Roadway Information

SDELSR00257**C

State True Log

17.945

County True Log

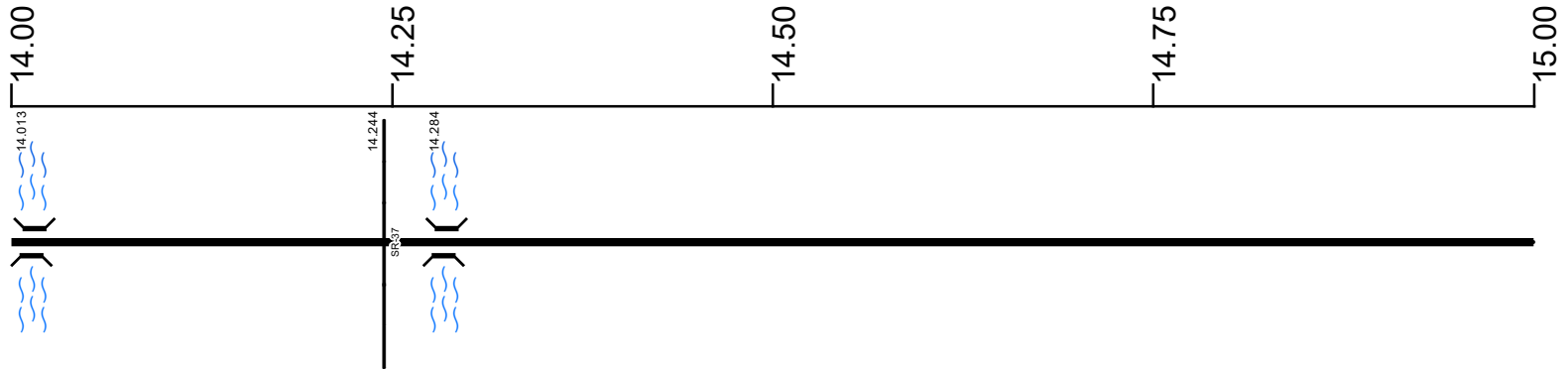

Surface Type & Width (Left / Right)

| | |
|------------------------------|--------------------------|
| G (9'/10') 8.788 - 14.244 | G 18' 14.244 - 22.636 |
|------------------------------|--------------------------|

Base Type (Left / Right)

| | |
|---------------------|--|
| I 8.788 - 22.636 | |
|---------------------|--|

Shoulder Type & Width (Left / Right)

| | |
|-----------------------------|--|
| 2 (2'/2') 8.788 - 22.636 | |
|-----------------------------|--|

Through Lanes

| | |
|---------------------|--|
| 2 8.334 - 22.636 | |
|---------------------|--|

Street Name

| | | |
|----------------|--------|-----------------|
| 8.915 - 14.244 | SR 257 | 14.244 - 22.636 |
|----------------|--------|-----------------|

- | | | | |
|---------------------|-------------------|----------------------|--------------|
| Non-divided Highway | Bridge (on route) | Railroad (at grade) | Intersection |
| Divided Highway | Underpass | Railroad (underpass) | |
| Secondary Segment | Overpass | Railroad (overpass) | |
| Corporation | | | |

Created on: 6/27/2025

transportation.ohio.gov

Prepared by
The Ohio Department of Transportation
Office of Technical Services
Roadway Information

SDELSR00257**C

State True Log

18.945

County True Log



Surface Type & Width (Left / Right)

| | |
|--|-----------------|
| | G 18' |
| | 14.244 - 22.636 |

Base Type (Left / Right)

| | |
|--|----------------|
| | I |
| | 8.788 - 22.636 |

Shoulder Type & Width (Left / Right)

| | |
|--|----------------|
| | 2 (2'/2') |
| | 8.788 - 22.636 |

Through Lanes

| | |
|--|----------------|
| | 2 |
| | 8.334 - 22.636 |

Street Name

| | |
|--|-----------------|
| | SR 257 |
| | 14.244 - 22.636 |

- | | | | |
|---------------------|-------------------|----------------------|--------------|
| Non-divided Highway | Bridge (on route) | Railroad (at grade) | Intersection |
| Divided Highway | Underpass | Railroad (underpass) | |
| Secondary Segment | Overpass | Railroad (overpass) | |
| Corporation | | | |

Created on: 6/27/2025

transportation.ohio.gov

Prepared by
The Ohio Department of Transportation
Office of Technical Services
Roadway Information

SDELSR00257**C

State True Log

19.945

County True Log

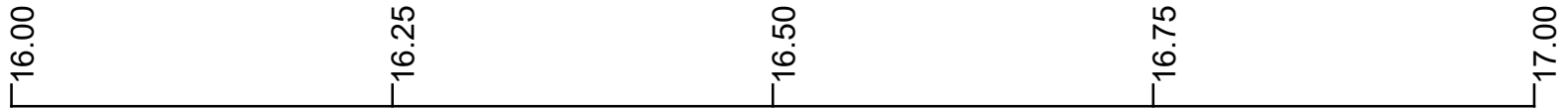

Surface Type & Width (Left / Right)

G 18'
14.244 - 22.636

Base Type (Left / Right)

I
8.788 - 22.636

Shoulder Type & Width (Left / Right)

2 (2/2)
8.788 - 22.636

Through Lanes

2
8.334 - 22.636

Street Name

SR 257
14.244 - 22.636

- | | | | |
|---------------------|-------------------|----------------------|--------------|
| Non-divided Highway | Bridge (on route) | Railroad (at grade) | Intersection |
| Divided Highway | Underpass | Railroad (underpass) | |
| Secondary Segment | Overpass | Railroad (overpass) | |
| Corporation | | | |

Created on: 6/27/2025

transportation.ohio.gov

Prepared by
The Ohio Department of Transportation
Office of Technical Services
Roadway Information

SDELSR00257**C

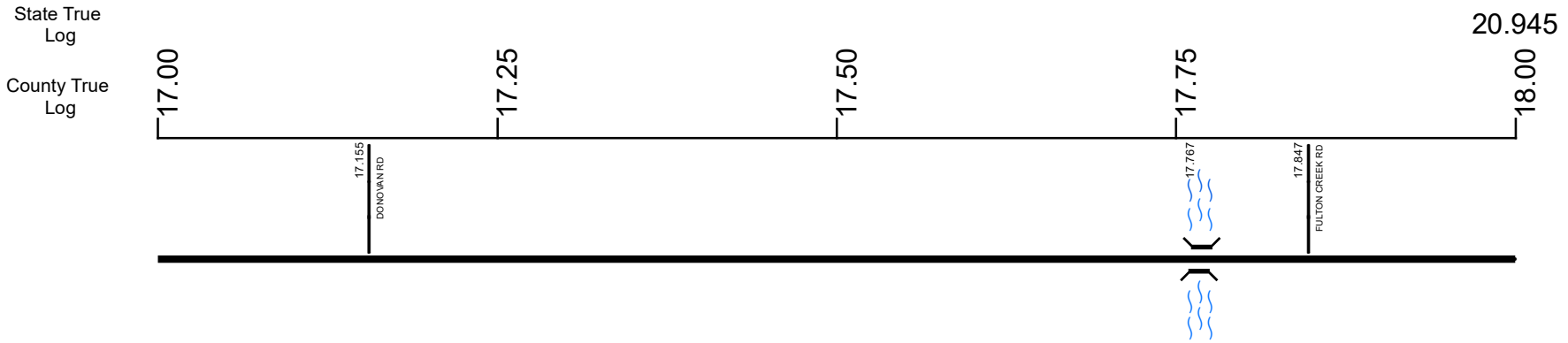

Surface Type & Width (Left / Right)

G 18'
14.244 - 22.636

Base Type (Left / Right)

I
8.788 - 22.636

Shoulder Type & Width (Left / Right)

2 (2'/2')
8.788 - 22.636

Through Lanes

2
8.334 - 22.636

Street Name

SR 257
14.244 - 22.636

- Non-divided Highway
 Bridge (on route)
 Railroad (at grade)
 Intersection
- Divided Highway
 Underpass
 Railroad (underpass)
- Secondary Segment
 Overpass
 Railroad (overpass)
- Corporation**

Created on: 6/27/2025



transportation.ohio.gov

Prepared by
 The Ohio Department of Transportation
 Office of Technical Services
 Roadway Information

SDELSR00257**C

State True Log

21.945

County True Log

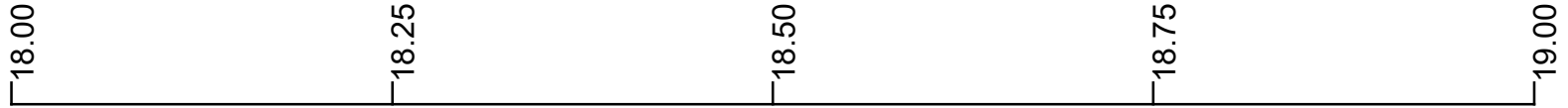

Surface Type & Width (Left / Right)

G 18'
14.244 - 22.636

Base Type (Left / Right)

I
8.788 - 22.636

Shoulder Type & Width (Left / Right)

2 (2/2)
8.788 - 22.636

Through Lanes

2
8.334 - 22.636

Street Name

SR 257
14.244 - 22.636

- | | | | |
|---------------------|-------------------|----------------------|--------------|
| Non-divided Highway | Bridge (on route) | Railroad (at grade) | Intersection |
| Divided Highway | Underpass | Railroad (underpass) | |
| Secondary Segment | Overpass | Railroad (overpass) | |
| Corporation | | | |

Created on: 6/27/2025



transportation.ohio.gov

Prepared by

The Ohio Department of Transportation
Office of Technical Services
Roadway Information

SDELSR00257**C

State True Log
County True Log

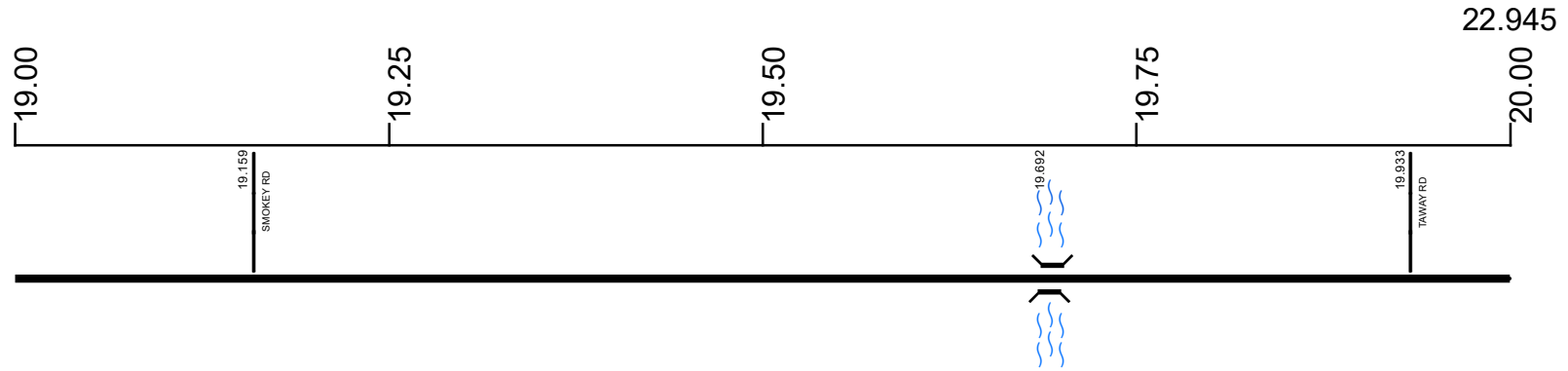

Surface Type & Width (Left / Right)

G 18'
14.244 - 22.636

Base Type (Left / Right)

I
8.788 - 22.636

Shoulder Type & Width (Left / Right)

2 (2'/2')
8.788 - 22.636

Through Lanes

2
8.334 - 22.636

Street Name

SR 257
14.244 - 22.636

- | | | | |
|---------------------|-------------------|----------------------|--------------|
| Non-divided Highway | Bridge (on route) | Railroad (at grade) | Intersection |
| Divided Highway | Underpass | Railroad (underpass) | |
| Secondary Segment | Overpass | Railroad (overpass) | |
| Corporation | | | |

Created on: 6/27/2025



transportation.ohio.gov
Prepared by
The Ohio Department of Transportation
Office of Technical Services
Roadway Information

SDELSR00257**C

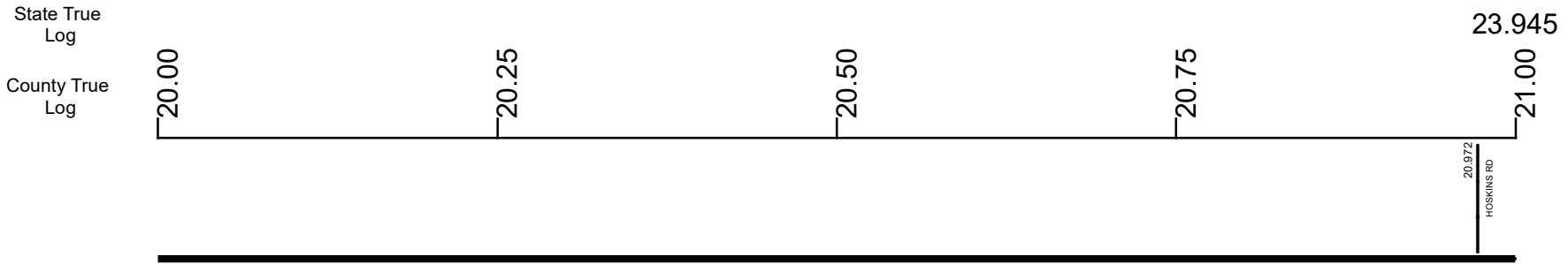

Surface Type & Width (Left / Right)

G 18'
14.244 - 22.636

Base Type (Left / Right)

I
8.788 - 22.636

Shoulder Type & Width (Left / Right)

2 (2'/2)
8.788 - 22.636

Through Lanes

2
8.334 - 22.636

Street Name

SR 257
14.244 - 22.636

- Non-divided Highway
 Bridge (on route)
 Railroad (at grade)
 Intersection
- Divided Highway
 Underpass
 Railroad (underpass)
- Secondary Segment
 Overpass
 Railroad (overpass)
- Corporation**

Created on: 6/27/2025



transportation.ohio.gov
 Prepared by
 The Ohio Department of Transportation
 Office of Technical Services
 Roadway Information

SDELSR00257**C

State True Log

24.945

County True Log



Surface Type & Width (Left / Right)

G 18'
14.244 - 22.636

Base Type (Left / Right)

I
8.788 - 22.636

Shoulder Type & Width (Left / Right)

2 (2'/2)
8.788 - 22.636

Through Lanes

2
8.334 - 22.636

Street Name

SR 257
14.244 - 22.636

- | | | | |
|---------------------|-------------------|----------------------|--------------|
| Non-divided Highway | Bridge (on route) | Railroad (at grade) | Intersection |
| Divided Highway | Underpass | Railroad (underpass) | |
| Secondary Segment | Overpass | Railroad (overpass) | |
| Corporation | | | |

Created on: 6/27/2025



transportation.ohio.gov

Prepared by
The Ohio Department of Transportation
Office of Technical Services
Roadway Information

SDELSR00257**C

25.581

State True Log

County True Log

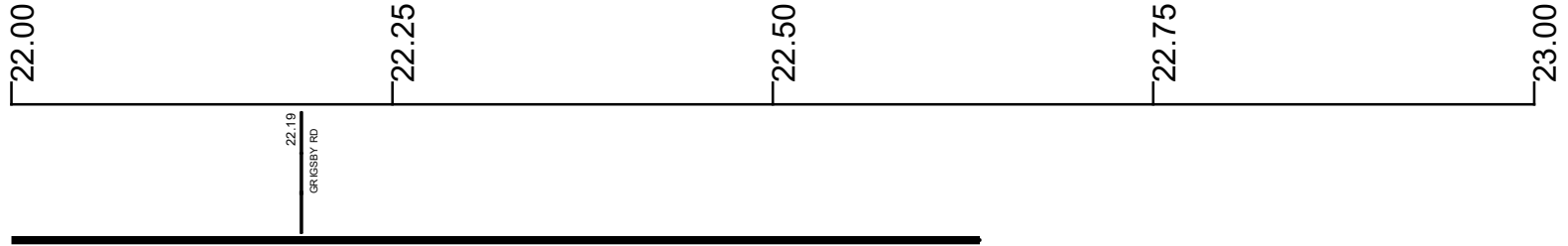

Surface Type & Width (Left / Right)

G 18'
14.244 - 22.636

Base Type (Left / Right)

I
8.788 - 22.636

Shoulder Type & Width (Left / Right)

2 (2 1/2')
8.788 - 22.636

Through Lanes

2
8.334 - 22.636

Street Name

SR 257
14.244 - 22.636

- | | | | |
|---------------------|-------------------|----------------------|--------------|
| Non-divided Highway | Bridge (on route) | Railroad (at grade) | Intersection |
| Divided Highway | Underpass | Railroad (underpass) | |
| Secondary Segment | Overpass | Railroad (overpass) | |
| Corporation | | | |

Created on: 6/27/2025

Historical Project List for SDELSR00257**C

| Begin Measure | End Measure | Project ID Number | Construction Completion Date | Treatment Category | Treatment Type |
|---------------|-------------|-------------------|------------------------------|----------------------|-------------------------|
| 0.000 | 0.993 | 25808 | 8-2011 | Minor Rehabilitation | 60-AC Overlay w/Rpr |
| 1.481 | 7.763 | 24472 | 6-2003 | Minor Rehabilitation | 60-AC Overlay w/Rpr |
| 1.491 | 7.763 | 107793 | 9-2020 | Minor Rehabilitation | 60-AC Overlay w/Rpr |
| 8.334 | 14.214 | 105543 | 8-2019 | Minor Rehabilitation | 38-Fine Poly AC Overlay |
| 8.334 | 22.636 | 87340 | 9-2010 | Minor Rehabilitation | 60-AC Overlay w/Rpr |

Roadway Codes

Access Control Journalized

- F - Full Access Control
- L - Limited Access Control
- N - No Access Control

Access Control Operational

- 1 - Full Access Control
- 2 - Partial Access Control
- 3 - No Access Control

Base Type

- F - Crack and Seat
- H - Rubblize and Roll
- I - Aggregate Base 304 or Traffic Compacted
- K - Water Bound Macadam
- L - Bituminous Concrete Mix or Penetration Macadam
- N - Plain Concrete
- P - Reinforced Concrete
- R - Brick (Flexible)
- T - Brick (Rigid)

Direction of Travel

- B - Both (Two-way)
- F - One-way Cardinal
- T - One-way Non-cardinal

Facility Type

- 1 - One-way Roadway
- 2 - Two-way Roadway
- 4 - Ramp
- 5 - Non-mainline
- 6 - Non-inventory Direction
- 7 - Planned / Unbuilt

Historical Federal Aid Indicator

- N - Not a FAP Route
- Y - FAP Route

Functional Classification

- 01 - Interstate
- 02 - Principal Arterial (Freeways)
- 03 - Principal Arterial (Other)
- 04 - Minor Arterial
- 05 - Major Collector
- 06 - Minor Collector
- 07 - Local

Leave / Reenter Indicator

- Y - Route leaves/reenters at this point
- N - Route does not leave/reenter at this point

Median Type

- 1 - None
- 2 - Unprotected
- 3 - Curbed
- 4 - Positive Barrier (Unspecified)
- 5 - Positive Barrier (Flexible)
- 6 - Positive Barrier (Semi-rigid)
- 7 - Positive Barrier (Rigid)

NHS

- N - National Highway System
- H - Congressional Corridor
- 2 - Major Airport
- 3 - Major Port Facility
- 4 - Major Amtrak Station
- 5 - Major Rail / Truck Terminal
- 6 - Major Intercity Bus Terminal
- 7 - Major Public Transit / Multi-modal Passenger Terminal
- 8 - Major Pipeline Terminal
- 9 - Major Ferry Terminal

Priority System

- G - General
- P - Priority System
- U - Urban

Scenic Byway Code

- A - All American Road
- N - National Scenic Byway
- S - State Scenic Byway

Shoulder Type

- 1 - None
- 2 - Surfaced shoulder exists (bituminous concrete {AC})
- 3 - Surfaced shoulder exists (Portland Cement Concrete {PCC})
- 4 - Stabilized shoulder exists (gravel or other granular material)
- 5 - Combination shoulder exists (two or more surface types)
- 6 - Earth shoulder exists
- 7 - Barrier curb exists; no shoulder in front of curb

Surface Type

- A - Combination
- B - Brick
- C - Continuous Reinforced Concrete
- D - Reinforced Concrete
- E - Plain Concrete
- G - Bituminous Concrete
- I - Chipseal on Granular
- K - Open Graded Bituminous
- L - Chipseal or Micro
- M - Gravel
- U - Unimproved
- X - Right of Way Only