

SERISR00099**C

State True Log 17.831

18.831

County True Log

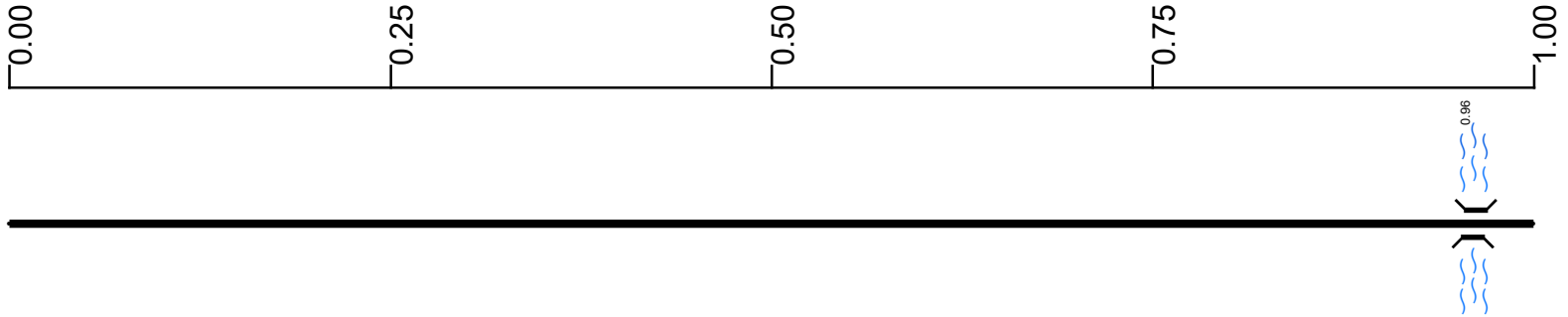

Surface Type & Width (Left / Right)

	G (11'/9')
	0 - 2.52

Base Type (Left / Right)

	K / I
	0 - 2.52

Shoulder Type & Width (Left / Right)

	2 (10'/10')
	0 - 4.54

Resurface Year

	2021
	0 - 4.54

Through Lanes

	2
	0 - 4.733

Street Name

	SR 99
	0 - 4.733

- | | | | |
|---------------------|-------------------|----------------------|--------------|
| Non-divided Highway | Bridge (on route) | Railroad (at grade) | Intersection |
| Divided Highway | Underpass | Railroad (underpass) | |
| Secondary Segment | Overpass | Railroad (overpass) | |
| Corporation | | | |

Created on: 6/27/2025

transportation.ohio.gov

Prepared by
The Ohio Department of Transportation
Office of Technical Services
Roadway Information

SERISR00099**C

State True Log

19.831

County True Log



1.199

NORFOLK SOUTHERN R R

Surface Type & Width (Left / Right)

	G (11'/9')
	0 - 2.52

Base Type (Left / Right)

	K / I
	0 - 2.52

Shoulder Type & Width (Left / Right)

	2 (10'/10')
	0 - 4.54

Resurface Year

	2021
	0 - 4.54

Through Lanes

	2
	0 - 4.733

Street Name

	SR 99
	0 - 4.733

- | | | | |
|--|---|---|---|
| <ul style="list-style-type: none"> Non-divided Highway Divided Highway Secondary Segment Corporation | <ul style="list-style-type: none"> Bridge (on route) Underpass Overpass | <ul style="list-style-type: none"> Railroad (at grade) Railroad (underpass) Railroad (overpass) | <ul style="list-style-type: none"> Intersection |
|--|---|---|---|

Created on: 6/27/2025

transportation.ohio.gov

Prepared by
The Ohio Department of Transportation
Office of Technical Services
Roadway Information

SERISR00099**C

State True Log

20.831

County True Log

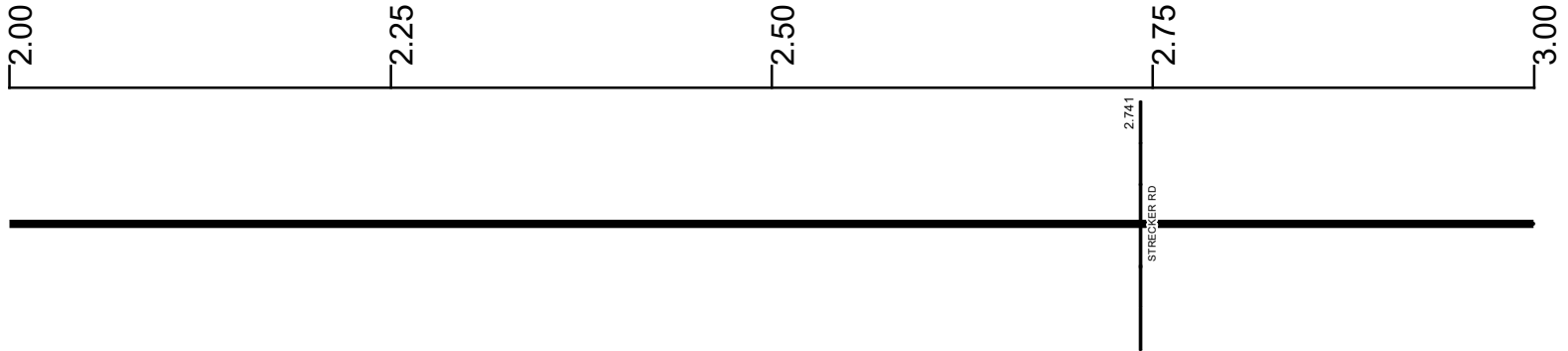

Surface Type & Width (Left / Right)

G (11'/9') 0 - 2.52	G 20' 2.52 - 4.54
------------------------	----------------------

Base Type (Left / Right)

K / I 0 - 2.52	K 2.52 - 4.54
-------------------	------------------

Shoulder Type & Width (Left / Right)

2 (10'/10') 0 - 4.54

Resurface Year

2021 0 - 4.54

Through Lanes

2 0 - 4.733

Street Name

SR 99 0 - 4.733

- | | | | |
|--|---|---|---|
| <ul style="list-style-type: none"> Non-divided Highway Divided Highway Secondary Segment Corporation | <ul style="list-style-type: none"> Bridge (on route) Underpass Overpass | <ul style="list-style-type: none"> Railroad (at grade) Railroad (underpass) Railroad (overpass) | <ul style="list-style-type: none"> Intersection |
|--|---|---|---|

Created on: 6/27/2025

transportation.ohio.gov

Prepared by
The Ohio Department of Transportation
Office of Technical Services
Roadway Information

SERISR00099**C

State True Log

21.831

County True Log

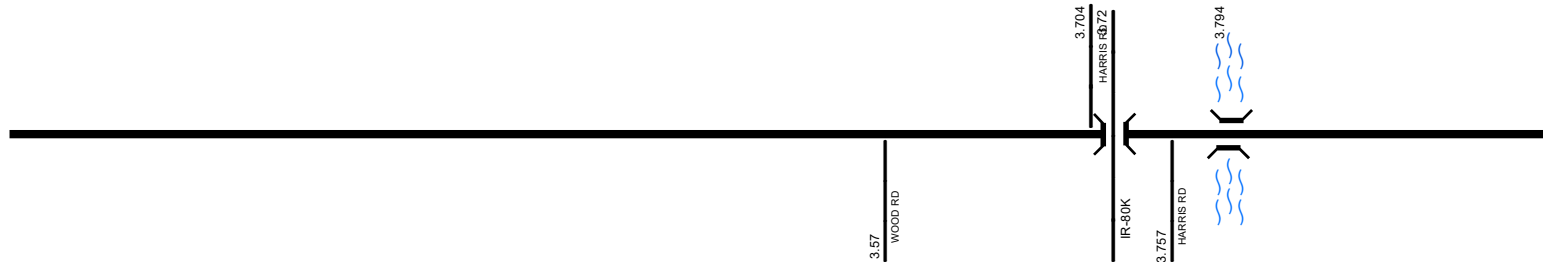
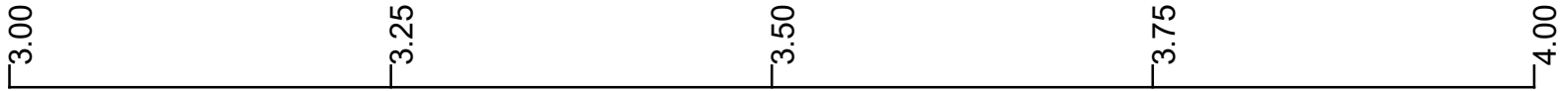

Surface Type & Width (Left / Right)	G 20' 2.52 - 4.54
Base Type (Left / Right)	K 2.52 - 4.54
Shoulder Type & Width (Left / Right)	2 (10'/10') 0 - 4.54
Resurface Year	2021 0 - 4.54
Through Lanes	2 0 - 4.733
Street Name	SR 99 0 - 4.733

Non-divided Highway	Bridge (on route)	Railroad (at grade)	Intersection
Divided Highway	Underpass	Railroad (underpass)	
Secondary Segment	Overpass	Railroad (overpass)	
Corporation			

Created on: 6/27/2025

transportation.ohio.gov

Prepared by
The Ohio Department of Transportation
Office of Technical Services
Roadway Information

SERISR00099**C

State True Log

22.564

County True Log

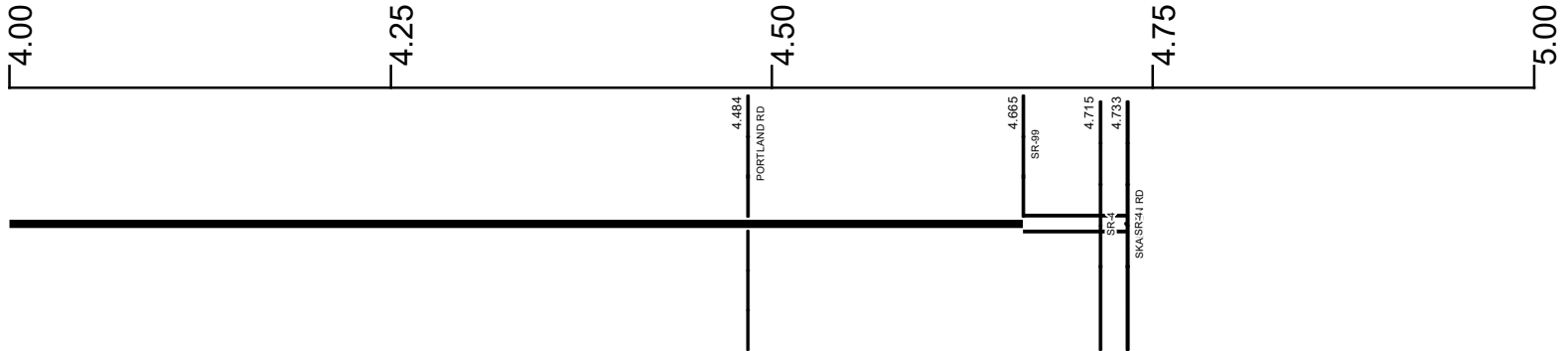

Surface Type & Width (Left / Right)

G 20'	G 24'	G 28' G 38'
2.52 - 4.54	4.54 - 4.665	4.665 - 4.715

Base Type (Left / Right)

K	L
2.52 - 4.54	4.54 - 4.733

Shoulder Type & Width (Left / Right)

2 (10'/10')	2 (4'/4')	1 (0'/0')
0 - 4.54	4.54 - 4.665	4.665 - 4.733

Median Type and Width

3 (7')	3 (84')
4.665 - 4.715	

Resurface Year

2021	2024
0 - 4.54	4.54 - 4.733

Through Lanes

2	
0 - 4.733	

Street Name

SR 99	
0 - 4.733	

- | | | | |
|--|---|---|---|
| <ul style="list-style-type: none"> Non-divided Highway Divided Highway Secondary Segment Corporation | <ul style="list-style-type: none"> Bridge (on route) Underpass Overpass | <ul style="list-style-type: none"> Railroad (at grade) Railroad (underpass) Railroad (overpass) | <ul style="list-style-type: none"> Intersection |
|--|---|---|---|

Created on: 6/27/2025

transportation.ohio.gov

Prepared by
The Ohio Department of Transportation
Office of Technical Services
Roadway Information

Historical Project List for SERISR00099**C

Begin Measure	End Measure	Project ID Number	Construction Completion Date	Treatment Category	Treatment Type
0.000	4.550	111437	9-2021	Minor Rehabilitation	38-Fine Poly AC Overlay
0.000	4.727	88763	9-2014	Minor Rehabilitation	60-AC Overlay w/Rpr

Roadway Codes

Access Control Journalized

- F - Full Access Control
- L - Limited Access Control
- N - No Access Control

Access Control Operational

- 1 - Full Access Control
- 2 - Partial Access Control
- 3 - No Access Control

Base Type

- F - Crack and Seat
- H - Rubblize and Roll
- I - Aggregate Base 304 or Traffic Compacted
- K - Water Bound Macadam
- L - Bituminous Concrete Mix or Penetration Macadam
- N - Plain Concrete
- P - Reinforced Concrete
- R - Brick (Flexible)
- T - Brick (Rigid)

Direction of Travel

- B - Both (Two-way)
- F - One-way Cardinal
- T - One-way Non-cardinal

Facility Type

- 1 - One-way Roadway
- 2 - Two-way Roadway
- 4 - Ramp
- 5 - Non-mainline
- 6 - Non-inventory Direction
- 7 - Planned / Unbuilt

Historical Federal Aid Indicator

- N - Not a FAP Route
- Y - FAP Route

Functional Classification

- 01 - Interstate
- 02 - Principal Arterial (Freeways)
- 03 - Principal Arterial (Other)
- 04 - Minor Arterial
- 05 - Major Collector
- 06 - Minor Collector
- 07 - Local

Leave / Reenter Indicator

- Y - Route leaves/reenters at this point
- N - Route does not leave/reenter at this point

Median Type

- 1 - None
- 2 - Unprotected
- 3 - Curbed
- 4 - Positive Barrier (Unspecified)
- 5 - Positive Barrier (Flexible)
- 6 - Positive Barrier (Semi-rigid)
- 7 - Positive Barrier (Rigid)

NHS

- N - National Highway System
- H - Congressional Corridor
- 2 - Major Airport
- 3 - Major Port Facility
- 4 - Major Amtrak Station
- 5 - Major Rail / Truck Terminal
- 6 - Major Intercity Bus Terminal
- 7 - Major Public Transit / Multi-modal Passenger Terminal
- 8 - Major Pipeline Terminal
- 9 - Major Ferry Terminal

Priority System

- G - General
- P - Priority System
- U - Urban

Scenic Byway Code

- A - All American Road
- N - National Scenic Byway
- S - State Scenic Byway

Shoulder Type

- 1 - None
- 2 - Surfaced shoulder exists (bituminous concrete {AC})
- 3 - Surfaced shoulder exists (Portland Cement Concrete {PCC})
- 4 - Stabilized shoulder exists (gravel or other granular material)
- 5 - Combination shoulder exists (two or more surface types)
- 6 - Earth shoulder exists
- 7 - Barrier curb exists; no shoulder in front of curb

Surface Type

- A - Combination
- B - Brick
- C - Continuous Reinforced Concrete
- D - Reinforced Concrete
- E - Plain Concrete
- G - Bituminous Concrete
- I - Chipseal on Granular
- K - Open Graded Bituminous
- L - Chipseal or Micro
- M - Gravel
- U - Unimproved
- X - Right of Way Only