

SERISR00101**C

State True Log 26.677

27.677

County True Log



Surface Type & Width (Left / Right)

G 20'
0 - 2.722

Base Type (Left / Right)

N
0 - 3.173

Shoulder Type & Width (Left / Right)

2 (4/4')
0 - 2.465

Through Lanes

2
0 - 6.288

Street Name

SR 101
0 - 2.465

- Non-divided Highway
 Bridge (on route)
 Railroad (at grade)
 Intersection
- Divided Highway
 Underpass
 Railroad (underpass)
- Secondary Segment
 Overpass
 Railroad (overpass)
- Corporation**

Created on: 6/27/2025



transportation.ohio.gov
 Prepared by
 The Ohio Department of Transportation
 Office of Technical Services
 Roadway Information

SERISR00101**C

State True Log

28.677

County True Log

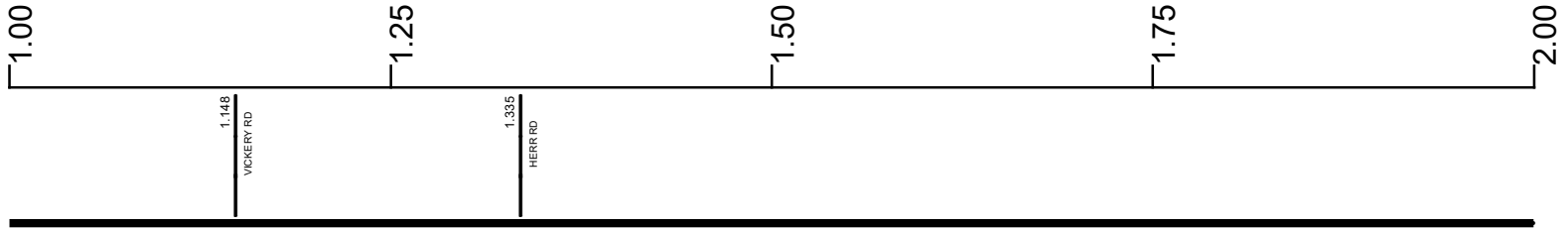

Surface Type & Width (Left / Right)

G 20'
0 - 2.722

Base Type (Left / Right)

N
0 - 3.173

Shoulder Type & Width (Left / Right)

2 (4/4')
0 - 2.465

Through Lanes

2
0 - 6.288

Street Name

SR 101
0 - 2.465

- Non-divided Highway
 Bridge (on route)
 Railroad (at grade)
 Intersection
- Divided Highway
 Underpass
 Railroad (underpass)
- Secondary Segment
 Overpass
 Railroad (overpass)
- Corporation**

Created on: 6/27/2025



transportation.ohio.gov

Prepared by
The Ohio Department of Transportation
Office of Technical Services
Roadway Information

SERISR00101**C

State True Log

29.677

County True Log

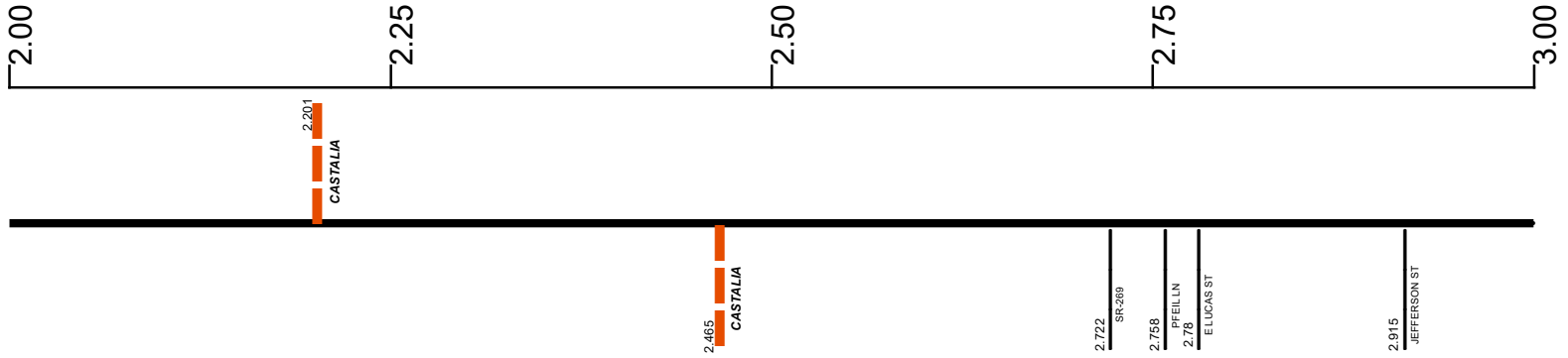

Surface Type & Width (Left / Right)

G 20'	G 24'
0 - 2.722	2.722 - 3.173

Base Type (Left / Right)

N	
0 - 3.173	

Shoulder Type & Width (Left / Right)

2 (4'4')	5 (1'1')	1 (0'0')
0 - 2.465	2.465 - 2.722	2.722 - 3.403

Through Lanes

2	
0 - 6.288	

Street Name

SR 101	SANDUSKY-CLYDE RD	S WASHINGTON ST
0 - 2.465	2.465 - 2.722	2.722 - 3.922

- Non-divided Highway
- Divided Highway
- Secondary Segment
- Corporation
- Bridge (on route)
- Underpass
- Overpass
- Railroad (at grade)
- Railroad (underpass)
- Railroad (overpass)
- Intersection

Created on: 6/27/2025

transportation.ohio.gov

Prepared by
The Ohio Department of Transportation
Office of Technical Services
Roadway Information

SERISR00101**C

State True Log

30.677

County True Log

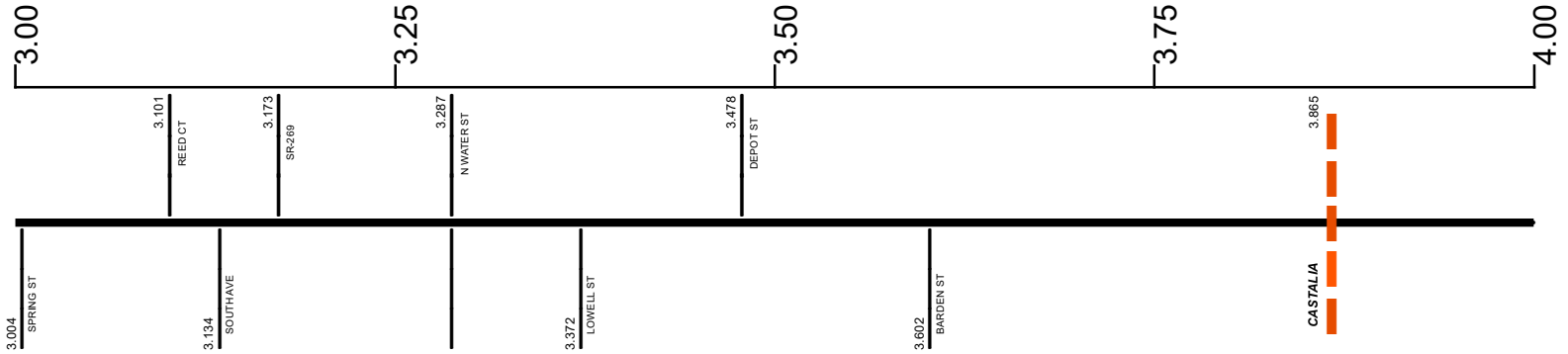

Surface Type & Width (Left / Right)

G 24'	G 36'	G 20'
2.722 - 3.173	3.173 - 3.403	3.403 - 5.97

Base Type (Left / Right)

N	P	N
0 - 3.173	3.173 - 3.403	3.403 - 6.104

Shoulder Type & Width (Left / Right)

1 (0'/0')	2 (5'/5')	5 (4'/4')
2.722 - 3.403	3.403 - 3.922	3.922 - 6.104

Through Lanes

2
0 - 6.288

Street Name

S WASHINGTON ST	TIFFIN AVE
2.722 - 3.922	3.922 - 6.186

- Non-divided Highway
- Divided Highway
- Secondary Segment
- Corporation
- Bridge (on route)
- Underpass
- Overpass
- Railroad (at grade)
- Railroad (underpass)
- Railroad (overpass)
- Intersection

Created on: 6/27/2025

transportation.ohio.gov

Prepared by
The Ohio Department of Transportation
Office of Technical Services
Roadway Information

SERISR00101**C

State True Log

31.677

County True Log

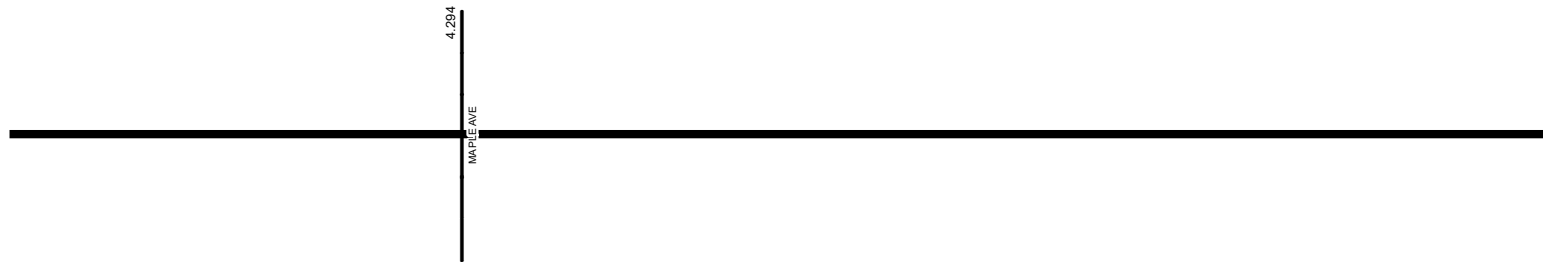

Surface Type & Width (Left / Right)

	G 20'
	3.403 - 5.97

Base Type (Left / Right)

	N
	3.403 - 6.104

Shoulder Type & Width (Left / Right)

	5 (4/4')
	3.922 - 6.104

Through Lanes

	2
	0 - 6.288

Street Name

	TIFFIN AVE
	3.922 - 6.186

- | | | | |
|--|---|---|---|
| <ul style="list-style-type: none"> Non-divided Highway Divided Highway Secondary Segment Corporation | <ul style="list-style-type: none"> Bridge (on route) Underpass Overpass | <ul style="list-style-type: none"> Railroad (at grade) Railroad (underpass) Railroad (overpass) | <ul style="list-style-type: none"> Intersection |
|--|---|---|---|

Created on: 6/27/2025

transportation.ohio.gov

Prepared by
The Ohio Department of Transportation
Office of Technical Services
Roadway Information

SERISR00101**C

State True Log

32.677

County True Log



Surface Type & Width (Left / Right)

	G 20'	G 18'
	3.403 - 5.97	5.97 - 6.104

Base Type (Left / Right)

	N	
	3.403 - 6.104	

Shoulder Type & Width (Left / Right)

	5 (4/4')	
	3.922 - 6.104	

Through Lanes

	2	
	0 - 6.288	

Street Name

	TIFFIN AVE	
	3.922 - 6.186	

- | | | | |
|--|---|---|---|
| <ul style="list-style-type: none"> Non-divided Highway Divided Highway Secondary Segment Corporation | <ul style="list-style-type: none"> Bridge (on route) Underpass Overpass | <ul style="list-style-type: none"> Railroad (at grade) Railroad (underpass) Railroad (overpass) | <ul style="list-style-type: none"> Intersection |
|--|---|---|---|

Created on: 6/27/2025

transportation.ohio.gov

Prepared by
The Ohio Department of Transportation
Office of Technical Services
Roadway Information

SERISR00101**C

State True
Log

33.677

County True
Log

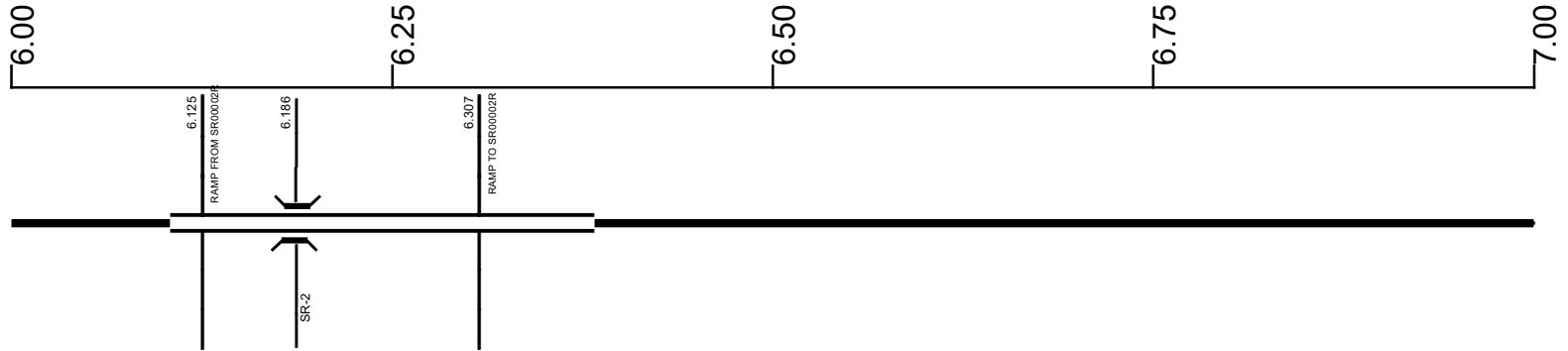

Surface Type & Width (Left / Right)

G 18' 5.97 - 6.104	G 48' 6.104 - 6.383	G (38'/18') 6.383 - 7.057
-----------------------	------------------------	------------------------------

Base Type (Left / Right)

N 3.403 - 6.104	P 6.104 - 6.383	I / N 6.383 - 7.057
--------------------	--------------------	------------------------

Shoulder Type & Width (Left / Right)

5 (4'/4') 3.922 - 6.104	2 (7'/7') 6.104 - 6.383	2 (6'/6') 6.383 - 7.057
----------------------------	----------------------------	----------------------------

Median Type and Width

3 (3') 6.104 - 6.383

Through Lanes

2 0 - 6.288	4 6.288 - 7.057
----------------	--------------------

Street Name

TIFFIN AVE 3.922 - 6.186	SR 101 6.186 - 8.085
-----------------------------	-------------------------

- | | | | |
|--|---|---|---|
| <ul style="list-style-type: none"> Non-divided Highway Divided Highway Secondary Segment Corporation | <ul style="list-style-type: none"> Bridge (on route) Underpass Overpass | <ul style="list-style-type: none"> Railroad (at grade) Railroad (underpass) Railroad (overpass) | <ul style="list-style-type: none"> Intersection |
|--|---|---|---|

Created on: 6/27/2025

transportation.ohio.gov

Prepared by
The Ohio Department of Transportation
Office of Technical Services
Roadway Information

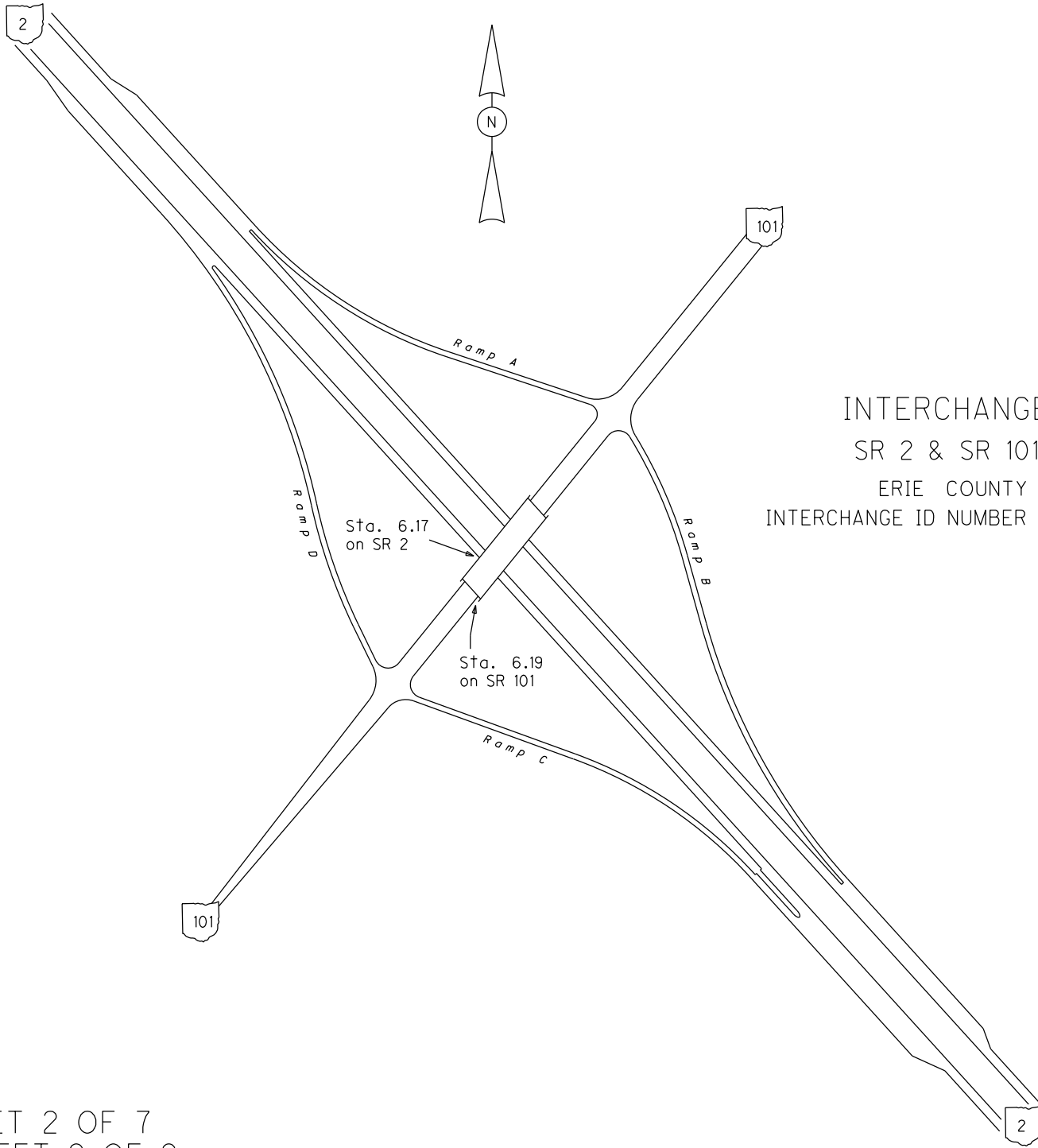

INTERCHANGE
SR 2 & SR 101
ERIE COUNTY
INTERCHANGE ID NUMBER = 024100

SERISR00101**C

State True Log

34.677

County True Log

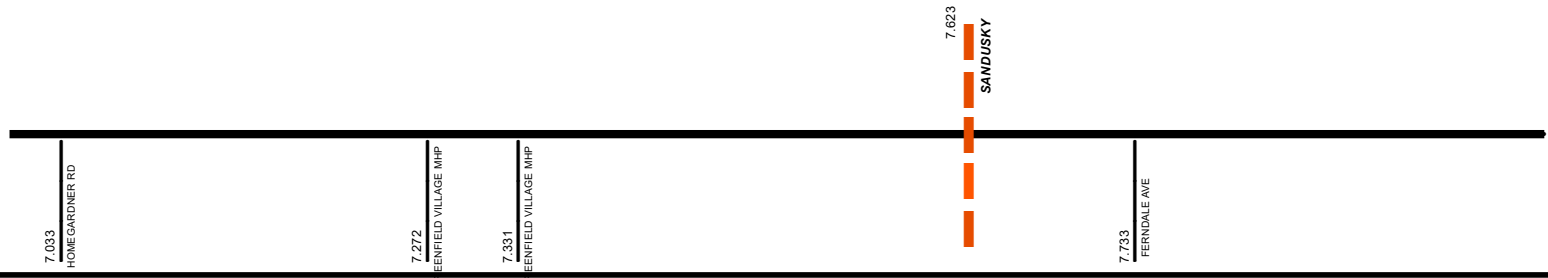

Surface Type & Width (Left / Right)

G (38'/18')	G 20'	G 24'
6.383 - 7.057	7.057 - 7.38	7.38 - 8.085

Base Type (Left / Right)

I / N	N	L
6.383 - 7.057	7.057 - 7.38	7.38 - 8.085

Shoulder Type & Width (Left / Right)

2 (6'/6')	5 (4'/4')	2 (10'/10')
6.383 - 7.057	7.057 - 7.38	7.38 - 8.085

Through Lanes

4	2
6.288 - 7.057	7.057 - 8.085

Street Name

	SR 101	
	6.186 - 8.085	

Non-divided Highway	Bridge (on route)	Railroad (at grade)	Intersection
Divided Highway	Underpass	Railroad (underpass)	
Secondary Segment	Overpass	Railroad (overpass)	
Corporation			

Created on: 6/27/2025

transportation.ohio.gov

Prepared by
The Ohio Department of Transportation
Office of Technical Services
Roadway Information

SERISR00101**C

State True Log

34.762

County True Log

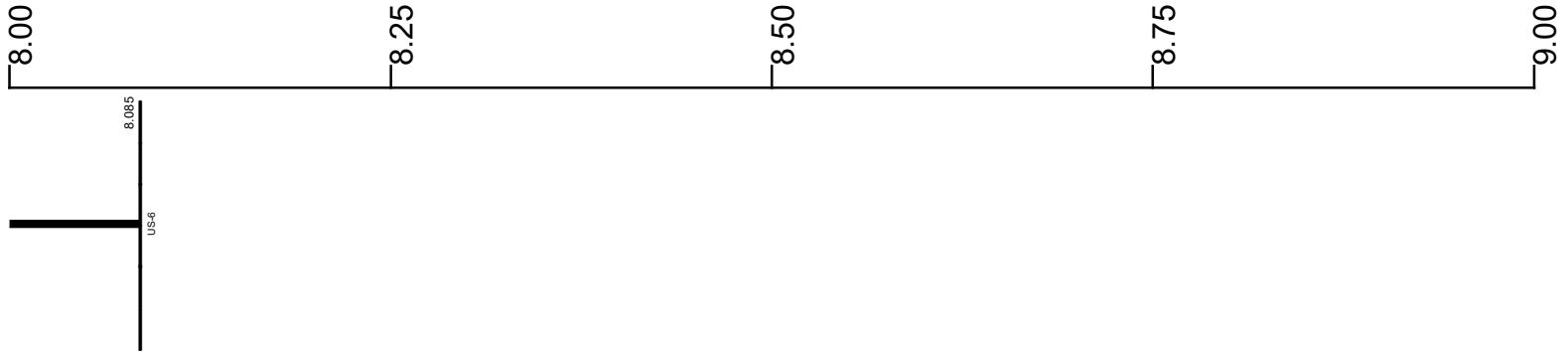

Surface Type & Width (Left / Right)

G 24'
7.38 - 8.085

Base Type (Left / Right)

L
7.38 - 8.085

Shoulder Type & Width (Left / Right)

2 (10'/10')
7.38 - 8.085

Through Lanes

2
7.057 - 8.085

Street Name

SR 101
6.186 - 8.085

- | | | | |
|---------------------|-------------------|----------------------|--------------|
| Non-divided Highway | Bridge (on route) | Railroad (at grade) | Intersection |
| Divided Highway | Underpass | Railroad (underpass) | |
| Secondary Segment | Overpass | Railroad (overpass) | |
| Corporation | | | |

Created on: 6/27/2025



transportation.ohio.gov
 Prepared by
 The Ohio Department of Transportation
 Office of Technical Services
 Roadway Information

Historical Project List for SERISR00101**C

Begin Measure	End Measure	Project ID Number	Construction Completion Date	Treatment Category	Treatment Type
0.000	3.173	80181	7-2008	Minor Rehabilitation	60-AC Overlay w/Rpr
3.173	7.366	80182	8-2010	Minor Rehabilitation	60-AC Overlay w/Rpr

Roadway Codes

Access Control Journalized

- F - Full Access Control
- L - Limited Access Control
- N - No Access Control

Access Control Operational

- 1 - Full Access Control
- 2 - Partial Access Control
- 3 - No Access Control

Base Type

- F - Crack and Seat
- H - Rubblize and Roll
- I - Aggregate Base 304 or Traffic Compacted
- K - Water Bound Macadam
- L - Bituminous Concrete Mix or Penetration Macadam
- N - Plain Concrete
- P - Reinforced Concrete
- R - Brick (Flexible)
- T - Brick (Rigid)

Direction of Travel

- B - Both (Two-way)
- F - One-way Cardinal
- T - One-way Non-cardinal

Facility Type

- 1 - One-way Roadway
- 2 - Two-way Roadway
- 4 - Ramp
- 5 - Non-mainline
- 6 - Non-inventory Direction
- 7 - Planned / Unbuilt

Historical Federal Aid Indicator

- N - Not a FAP Route
- Y - FAP Route

Functional Classification

- 01 - Interstate
- 02 - Principal Arterial (Freeways)
- 03 - Principal Arterial (Other)
- 04 - Minor Arterial
- 05 - Major Collector
- 06 - Minor Collector
- 07 - Local

Leave / Reenter Indicator

- Y - Route leaves/reenters at this point
- N - Route does not leave/reenter at this point

Median Type

- 1 - None
- 2 - Unprotected
- 3 - Curbed
- 4 - Positive Barrier (Unspecified)
- 5 - Positive Barrier (Flexible)
- 6 - Positive Barrier (Semi-rigid)
- 7 - Positive Barrier (Rigid)

NHS

- N - National Highway System
- H - Congressional Corridor
- 2 - Major Airport
- 3 - Major Port Facility
- 4 - Major Amtrak Station
- 5 - Major Rail / Truck Terminal
- 6 - Major Intercity Bus Terminal
- 7 - Major Public Transit / Multi-modal Passenger Terminal
- 8 - Major Pipeline Terminal
- 9 - Major Ferry Terminal

Priority System

- G - General
- P - Priority System
- U - Urban

Scenic Byway Code

- A - All American Road
- N - National Scenic Byway
- S - State Scenic Byway

Shoulder Type

- 1 - None
- 2 - Surfaced shoulder exists (bituminous concrete {AC})
- 3 - Surfaced shoulder exists (Portland Cement Concrete {PCC})
- 4 - Stabilized shoulder exists (gravel or other granular material)
- 5 - Combination shoulder exists (two or more surface types)
- 6 - Earth shoulder exists
- 7 - Barrier curb exists; no shoulder in front of curb

Surface Type

- A - Combination
- B - Brick
- C - Continuous Reinforced Concrete
- D - Reinforced Concrete
- E - Plain Concrete
- G - Bituminous Concrete
- I - Chipseal on Granular
- K - Open Graded Bituminous
- L - Chipseal or Micro
- M - Gravel
- U - Unimproved
- X - Right of Way Only