

# SFRAUS00033\*\*C

State True Log 106.243

107.243

County True Log

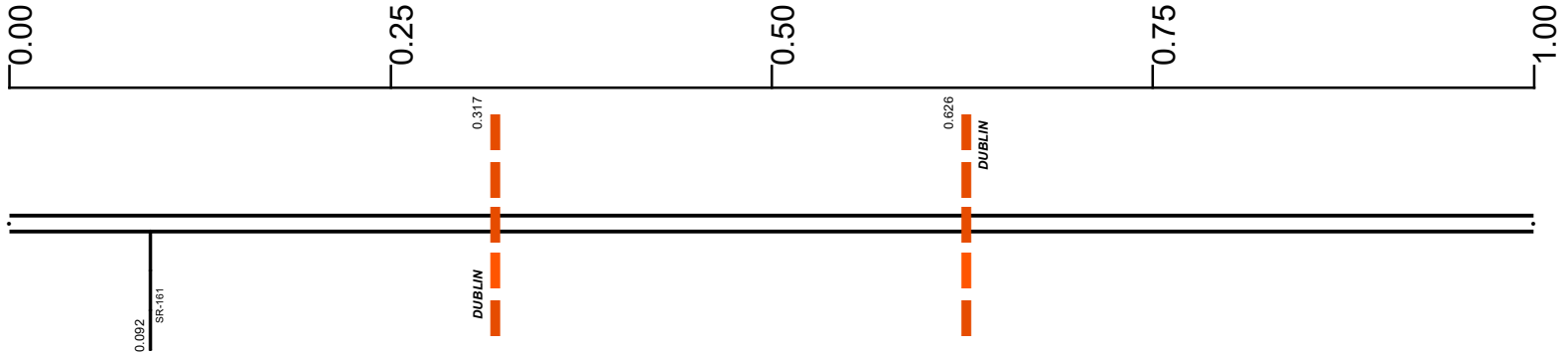

Surface Type & Width (Left / Right)

G 48'  
0 - 3.02

Base Type (Left / Right)

L	L / K
0 - 0.342	0.342 - 2.364

Shoulder Type & Width (Left / Right)

5 (12'/12')  
0 - 3.02

Median Type and Width

5 ( 48' )  
0 - 2.877

Through Lanes

4  
0 - 3.883

Street Name

US 33  
0 - 3.116

- Non-divided Highway
- Divided Highway
- Secondary Segment
- Corporation
- Bridge (on route)
- Underpass
- Overpass
- Railroad (at grade)
- Railroad (underpass)
- Railroad (overpass)
- Intersection

Created on: 6/23/2025



transportation.ohio.gov  
Prepared by  
The Ohio Department of Transportation  
Office of Technical Services  
Roadway Information

# SFRAUS00033\*\*C

State True Log

108.243

County True Log

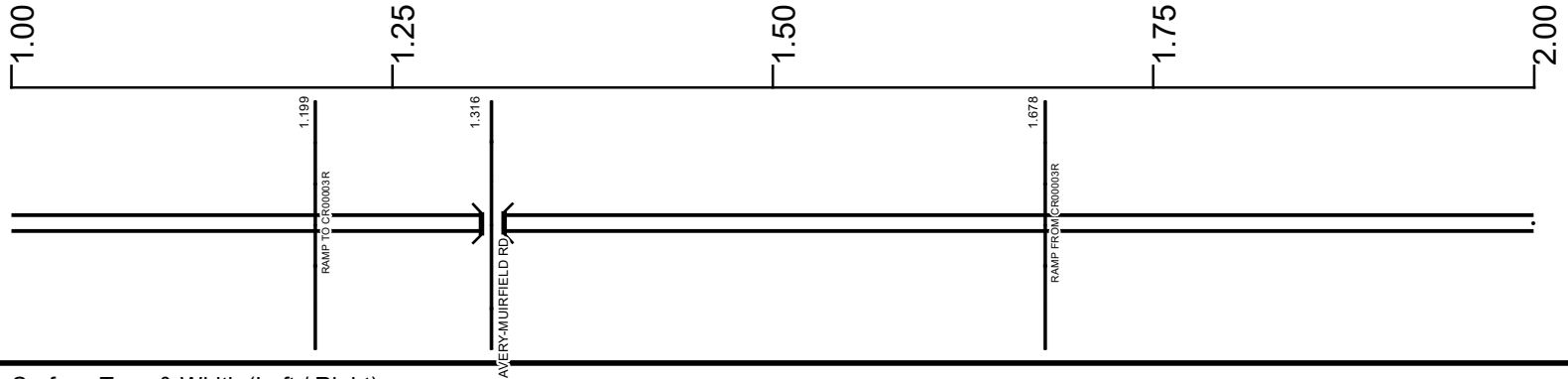

Surface Type & Width (Left / Right)

G 48'  
0 - 3.02

Base Type (Left / Right)

L / K  
0.342 - 2.364

Shoulder Type & Width (Left / Right)

5 (12'/12')  
0 - 3.02

Median Type and Width

5 ( 48' )  
0 - 2.877

Through Lanes

4  
0 - 3.883

Street Name

US 33  
0 - 3.116

- Non-divided Highway
- Divided Highway
- Secondary Segment
- Corporation
- Bridge (on route)
- Underpass
- Overpass
- Railroad (at grade)
- Railroad (underpass)
- Railroad (overpass)
- Intersection

Created on: 6/23/2025

transportation.ohio.gov

Prepared by  
The Ohio Department of Transportation  
Office of Technical Services  
Roadway Information

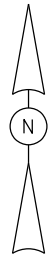

INTERCHANGE  
US 33, SR 161 & Avery Rd.  
FRANKLIN COUNTY  
INTERCHANGE ID NUMBER = 032200

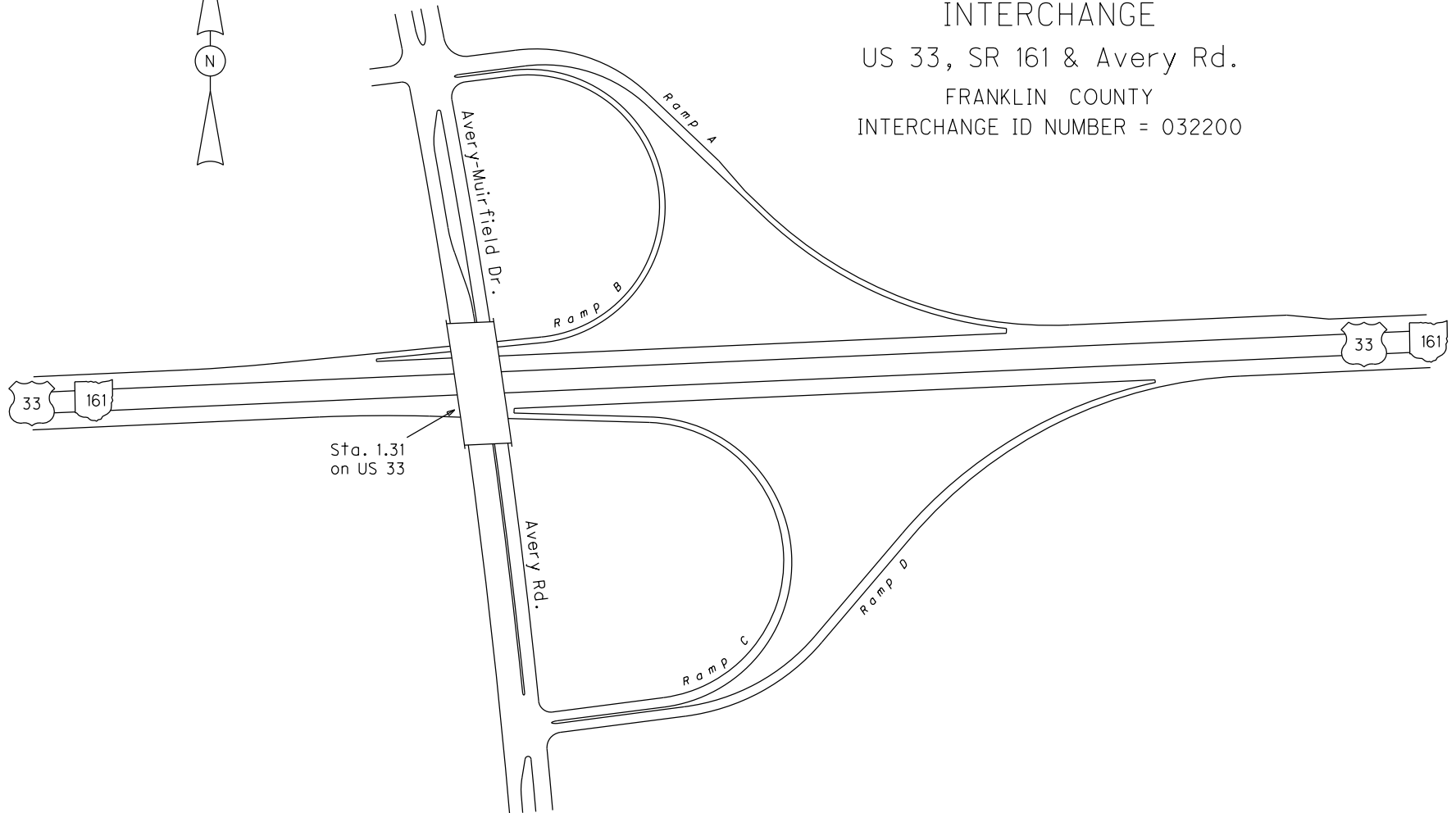

# SFRAUS00033\*\*C

State True Log

109.243

County True Log

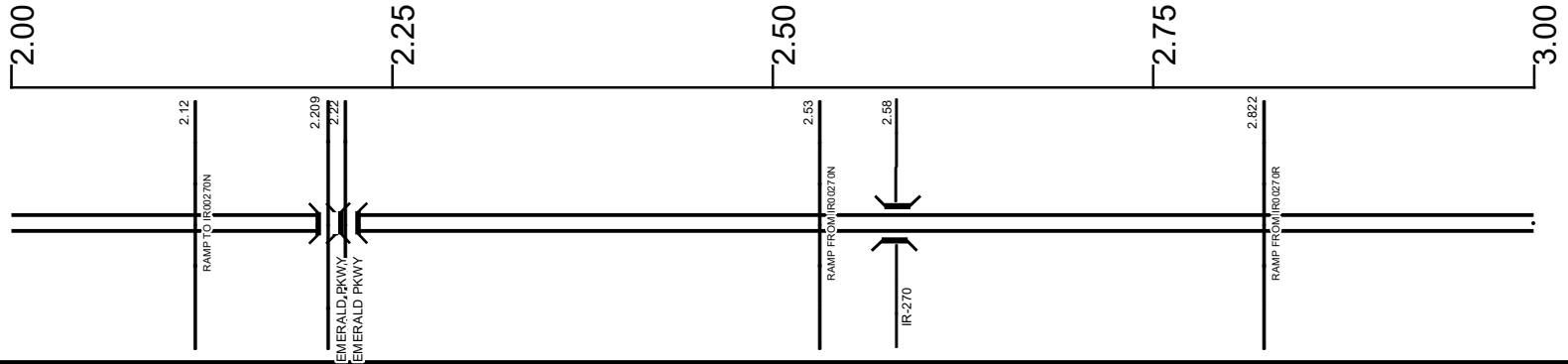

**Surface Type & Width (Left / Right)**

G 48'	
0 - 3.02	

**Base Type (Left / Right)**

L / K	L	L / K
0.342 - 2.364	2.364 - 2.877	2.877 - 3.116

**Shoulder Type & Width (Left / Right)**

5 (12'/12')	
0 - 3.02	

**Median Type and Width**

5 (48')	2 (48')
0 - 2.877	2.877 - 3.02

**Through Lanes**

4
0 - 3.883

**Street Name**

US 33
0 - 3.116

- Non-divided Highway
- Divided Highway
- Secondary Segment
- Corporation
- Bridge (on route)
- Underpass
- Overpass
- Railroad (at grade)
- Railroad (underpass)
- Railroad (overpass)
- Intersection

Created on: 6/23/2025

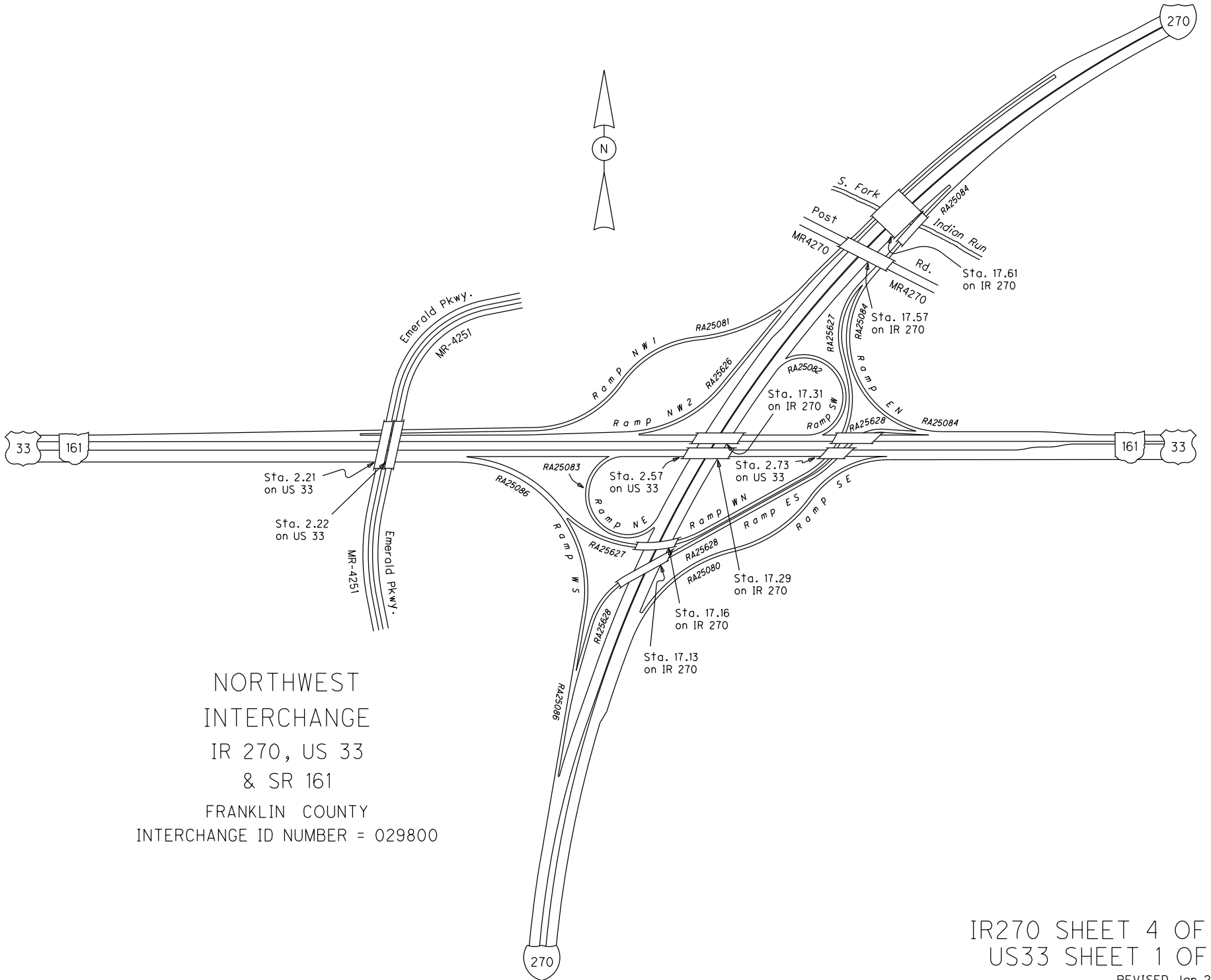

NORTHWEST  
INTERCHANGE  
IR 270, US 33  
& SR 161  
FRANKLIN COUNTY  
INTERCHANGE ID NUMBER = 029800

# SFRAUS00033\*\*C

State True Log

110.243

County True Log

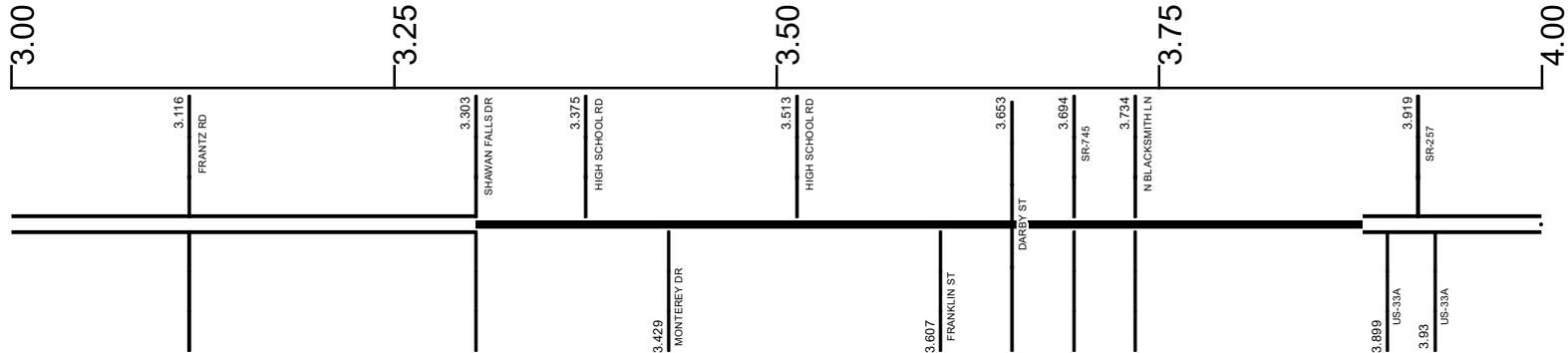

### Surface Type & Width (Left / Right)

G 48'	G (24'/48')	G (49'/24')	G (32'/24')	G (36'/8')	G (36'/12')	G 16'	G (36'/12')
0 - 3.02	3.02 - 3.116	3.116 - 3.303	3.303 - 3.597	3.597 - 3.694	3.694 - 3.883	3.883 - 3.919	3.919 - 4.001

### Base Type (Left / Right)

L / K	K / L	I / K	K / L	L
2.877 - 3.116	3.116 - 3.283	3.283 - 3.597	3.597 - 3.883	3.883 - 4.202

### Shoulder Type & Width (Left / Right)

5 (12'/12')	2 (14'/14')	2 (7'/11')	2 (11'/11')	2 (6'/6')	1 (0'/0')
0 - 3.02	3.02 - 3.116	3.116 - 3.303	3.303 - 3.365	3.365 - 3.597	3.597 - 4.001

### Median Type and Width

2 (48')	2 (20')	2 (27')
2.877 - 3.02	3.02 - 3.116	3.116 - 3.303

### Median Type and Width

3 (200')	3 (3')
3.883 - 3.919	3.919 - 4.055

### Through Lanes

4	3	4
0 - 3.883	3.883 - 3.919	3.919 - 4.152

### Street Name

US 33	W BRIDGE ST	E BRIDGE ST	RIVERSIDE DR
0 - 3.116	3.116 - 3.694	3.694 - 3.919	3.919 - 11.877

- Non-divided Highway
- Divided Highway
- Secondary Segment
- Corporation
- Bridge (on route)
- Underpass
- Overpass
- Railroad (at grade)
- Railroad (underpass)
- Railroad (overpass)
- Intersection

Created on: 6/23/2025



transportation.ohio.gov  
 Prepared by  
 The Ohio Department of Transportation  
 Office of Technical Services  
 Roadway Information

INTERCHANGE  
 US 33, SR 161 & SR 257  
 FRANKLIN COUNTY  
 INTERCHANGE ID NUMBER = 032300

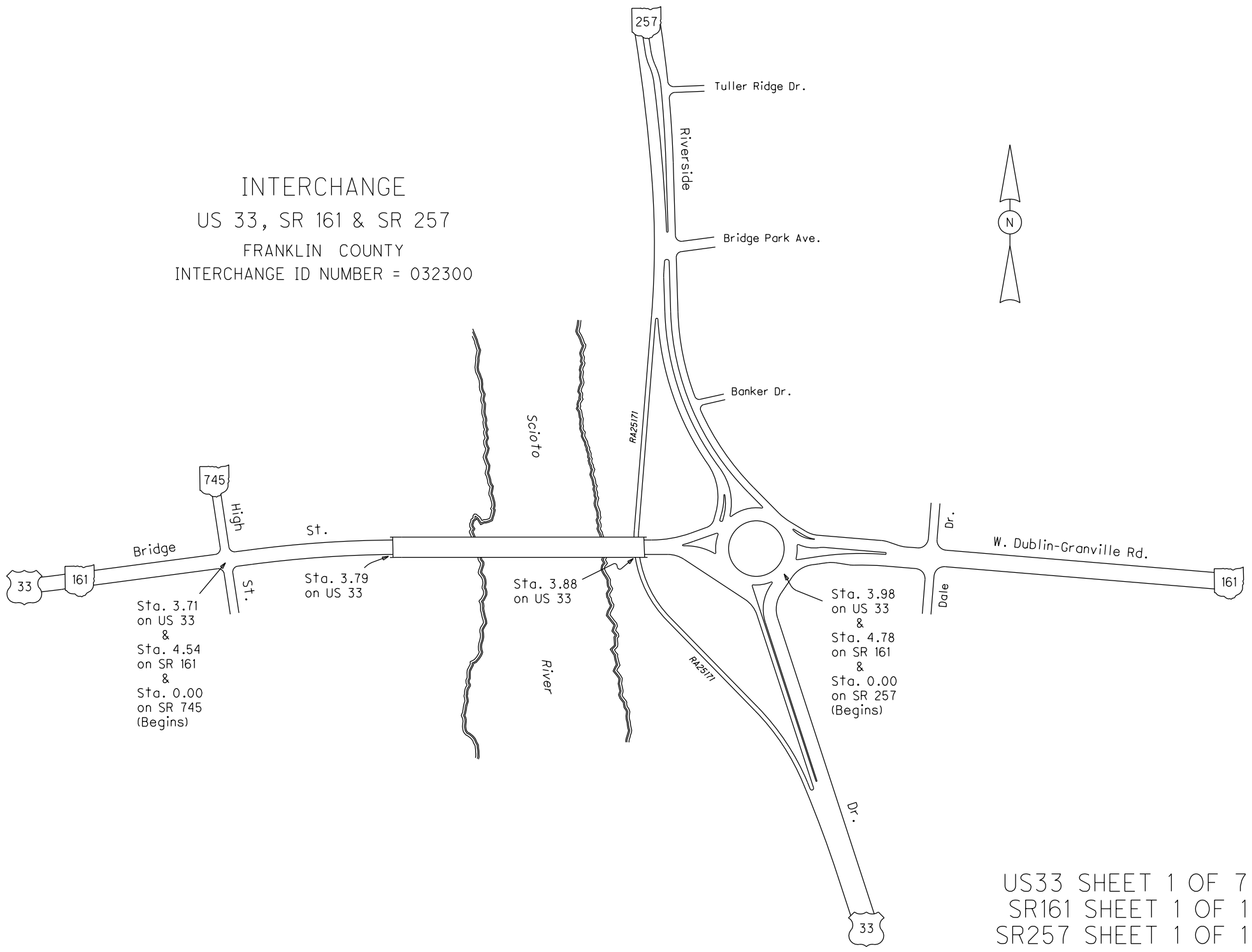
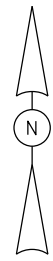

Sta. 3.71  
 on US 33  
 &  
 Sta. 4.54  
 on SR 161  
 &  
 Sta. 0.00  
 on SR 745  
 (Begins)

Sta. 3.79  
 on US 33

Sta. 3.88  
 on US 33

Sta. 3.98  
 on US 33  
 &  
 Sta. 4.78  
 on SR 161  
 &  
 Sta. 0.00  
 on SR 257  
 (Begins)

# SFRAUS00033\*\*C

State True Log

111.243

County True Log

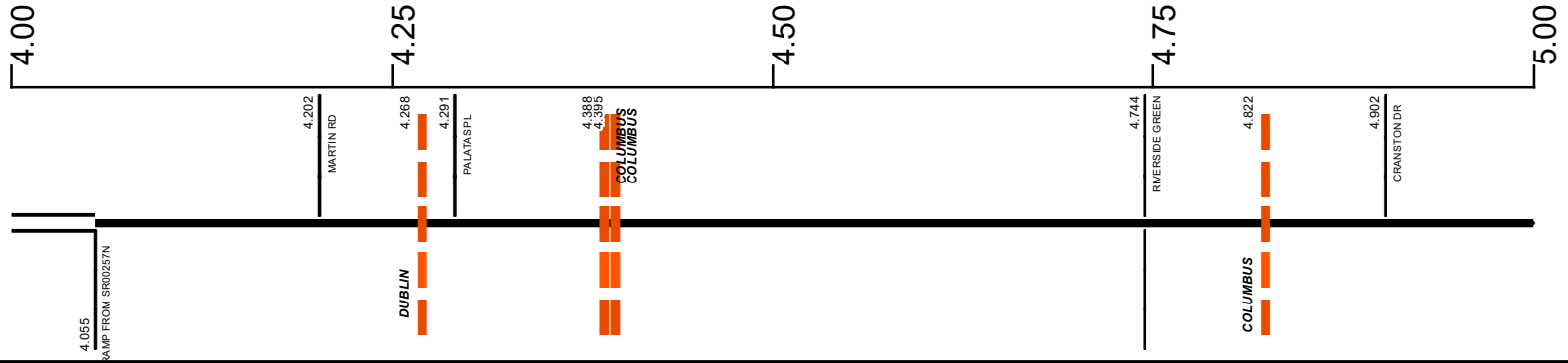

### Surface Type & Width (Left / Right)

G (36'/12')	G 48'	G (20'/10')
4.001 - 4.152		4.152 - 8.749

### Base Type (Left / Right)

L	L / K
3.883 - 4.202	4.202 - 8.749

### Shoulder Type & Width (Left / Right)

1 (0'/0')	2 (2'/2')	2 (8'/8')
3.597 - 4.001	4.001 - 4.152	4.152 - 8.749

### Median Type and Width

3 (3')
3.919 - 4.055

### Resurface Year

2020
4.343 - 8.739

### Through Lanes

4	2
3.919 - 4.152	4.152 - 8.917

### Street Name

RIVERSIDE DR
3.919 - 11.877

- Non-divided Highway
- Divided Highway
- Secondary Segment
- Corporation
- Bridge (on route)
- Underpass
- Overpass
- Railroad (at grade)
- Railroad (underpass)
- Railroad (overpass)
- Intersection

Created on: 6/23/2025



transportation.ohio.gov

Prepared by  
The Ohio Department of Transportation  
Office of Technical Services  
Roadway Information

# SFRAUS00033\*\*C

State True Log

112.243

County True Log

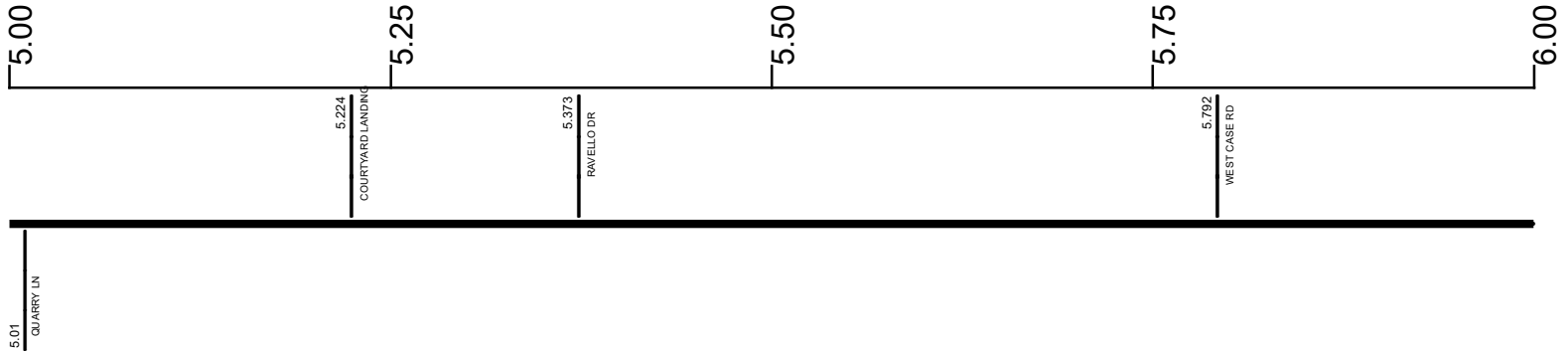

Surface Type & Width (Left / Right)

G (20'/10')  
4.152 - 8.749

Base Type (Left / Right)

L / K  
4.202 - 8.749

Shoulder Type & Width (Left / Right)

2 (8'/8')  
4.152 - 8.749

Resurface Year

2020  
4.343 - 8.739

Through Lanes

2  
4.152 - 8.917

Street Name

RIVERSIDE DR  
3.919 - 11.877

- Non-divided Highway
  Bridge (on route)
  Railroad (at grade)
  Intersection
- Divided Highway
  Underpass
  Railroad (underpass)
- Secondary Segment
  Overpass
  Railroad (overpass)
- Corporation**

Created on: 6/23/2025

Prepared by  
The Ohio Department of Transportation  
Office of Technical Services  
Roadway Information

# SFRAUS00033\*\*C

State True Log

113.243

County True Log

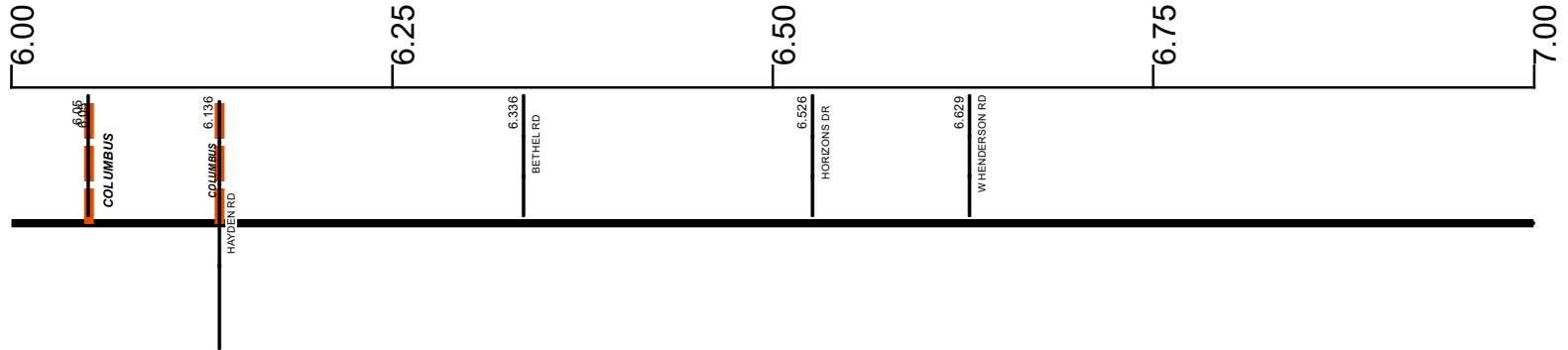

Surface Type & Width (Left / Right)

G (20'/10')  
4.152 - 8.749

Base Type (Left / Right)

L / K  
4.202 - 8.749

Shoulder Type & Width (Left / Right)

2 (8'/8')  
4.152 - 8.749

Resurface Year

2020  
4.343 - 8.739

Through Lanes

2  
4.152 - 8.917

Street Name

RIVERSIDE DR  
3.919 - 11.877

- Non-divided Highway
- Divided Highway
- Secondary Segment
- Corporation
- Bridge (on route)
- Underpass
- Overpass
- Railroad (at grade)
- Railroad (underpass)
- Railroad (overpass)
- Intersection

Created on: 6/23/2025



transportation.ohio.gov  
Prepared by  
The Ohio Department of Transportation  
Office of Technical Services  
Roadway Information

# SFRAUS00033\*\*C

State True Log

114.243

County True Log

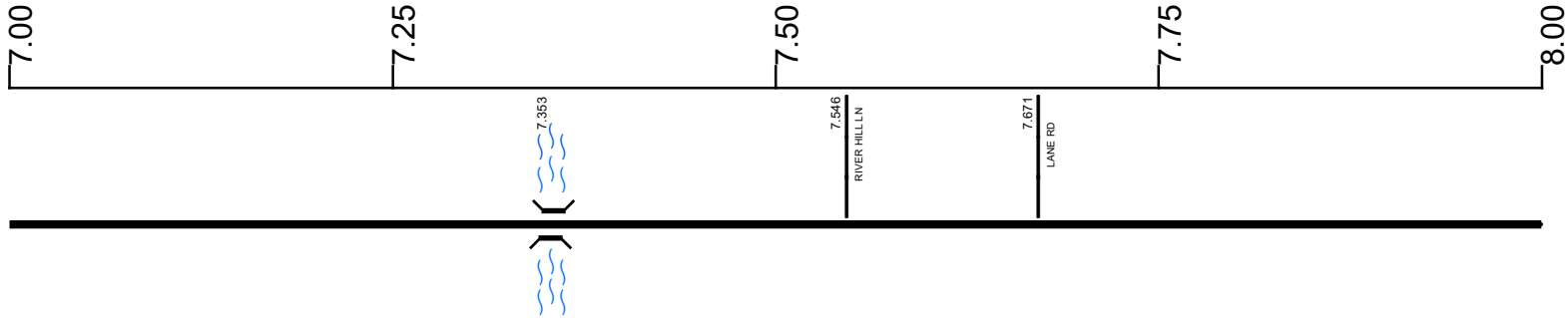

Surface Type & Width (Left / Right)

G (20'/10')  
4.152 - 8.749

Base Type (Left / Right)

L / K  
4.202 - 8.749

Shoulder Type & Width (Left / Right)

2 (8'/8')  
4.152 - 8.749

Resurface Year

2020  
4.343 - 8.739

Through Lanes

2  
4.152 - 8.917

Street Name

RIVERSIDE DR  
3.919 - 11.877

- Non-divided Highway
- Divided Highway
- Secondary Segment
- Corporation
- Bridge (on route)
- Underpass
- Overpass
- Railroad (at grade)
- Railroad (underpass)
- Railroad (overpass)
- Intersection

Created on: 6/23/2025

transportation.ohio.gov  
Prepared by  
The Ohio Department of Transportation  
Office of Technical Services  
Roadway Information

# SFRAUS00033\*\*C

State True Log

115.243

County True Log

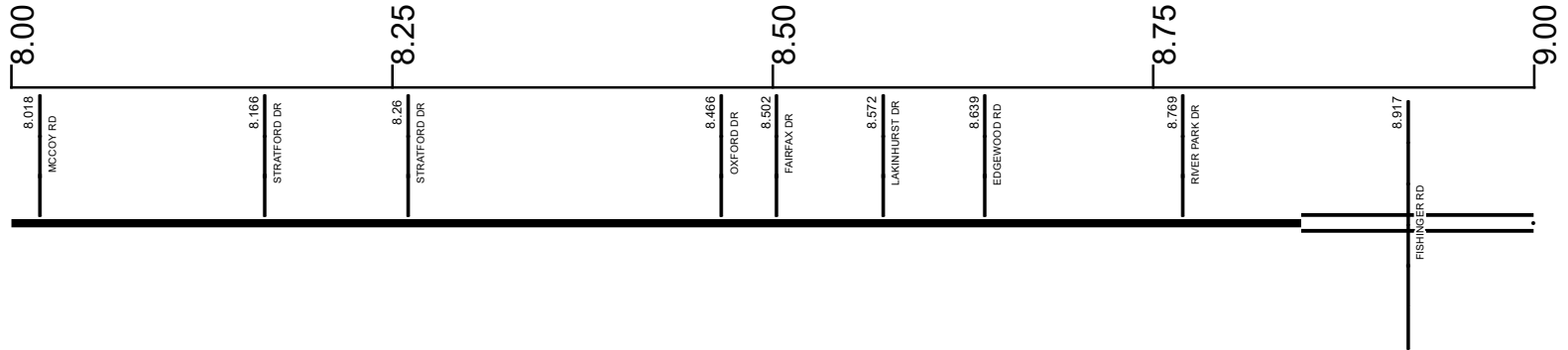

**Surface Type & Width (Left / Right)**

G (20'/10')	G 44'
4.152 - 8.749	8.749 - 9.079

**Base Type (Left / Right)**

L / K	L
4.202 - 8.749	8.749 - 9.079

**Shoulder Type & Width (Left / Right)**

2 (8/8')	2 (4/4')
4.152 - 8.749	8.749 - 9.079

**Median Type and Width**

3 (5')
8.847 - 9.019

**Resurface Year**

2020
4.343 - 8.739

**Through Lanes**

2	4
4.152 - 8.917	8.917 - 14.934

**Street Name**

RIVERSIDE DR
3.919 - 11.877

- Non-divided Highway
- Divided Highway
- Secondary Segment
- Corporation
- Bridge (on route)
- Underpass
- Overpass
- Railroad (at grade)
- Railroad (underpass)
- Railroad (overpass)
- Intersection

Created on: 6/23/2025



transportation.ohio.gov  
 Prepared by  
 The Ohio Department of Transportation  
 Office of Technical Services  
 Roadway Information

# SFRAUS00033\*\*C

State True Log

116.243

County True Log

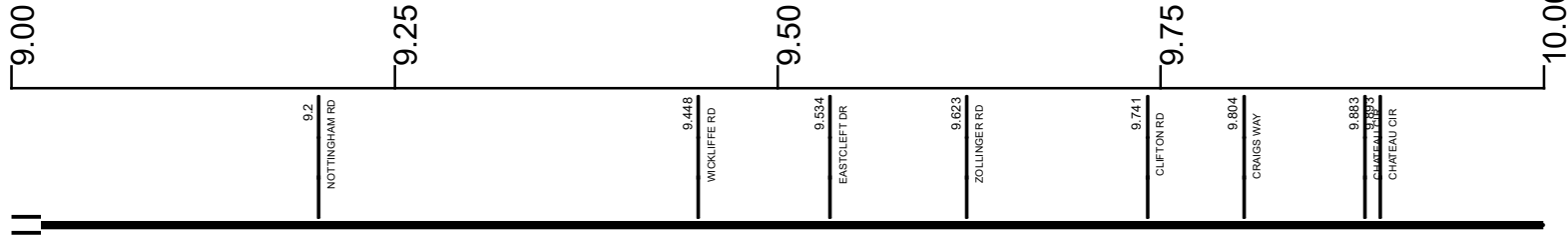

**Surface Type & Width (Left / Right)**

G 44'	G (34'/6')
8.749 - 9.079	9.079 - 11.342

**Base Type (Left / Right)**

L	L / N
8.749 - 9.079	9.079 - 11.342

**Shoulder Type & Width (Left / Right)**

2 (4'1/4')	2 (8'1/8')
8.749 - 9.079	9.079 - 11.342

**Median Type and Width**

3 (5')  
8.847 - 9.019

**Through Lanes**

4
8.917 - 14.934

**Street Name**

RIVERSIDE DR
3.919 - 11.877

- Non-divided Highway
- Divided Highway
- Secondary Segment
- Corporation
- Bridge (on route)
- Underpass
- Overpass
- Railroad (at grade)
- Railroad (underpass)
- Railroad (overpass)
- Intersection

Created on: 6/23/2025



transportation.ohio.gov  
Prepared by  
The Ohio Department of Transportation  
Office of Technical Services  
Roadway Information

# SFRAUS00033\*\*C

State True Log  
County True Log

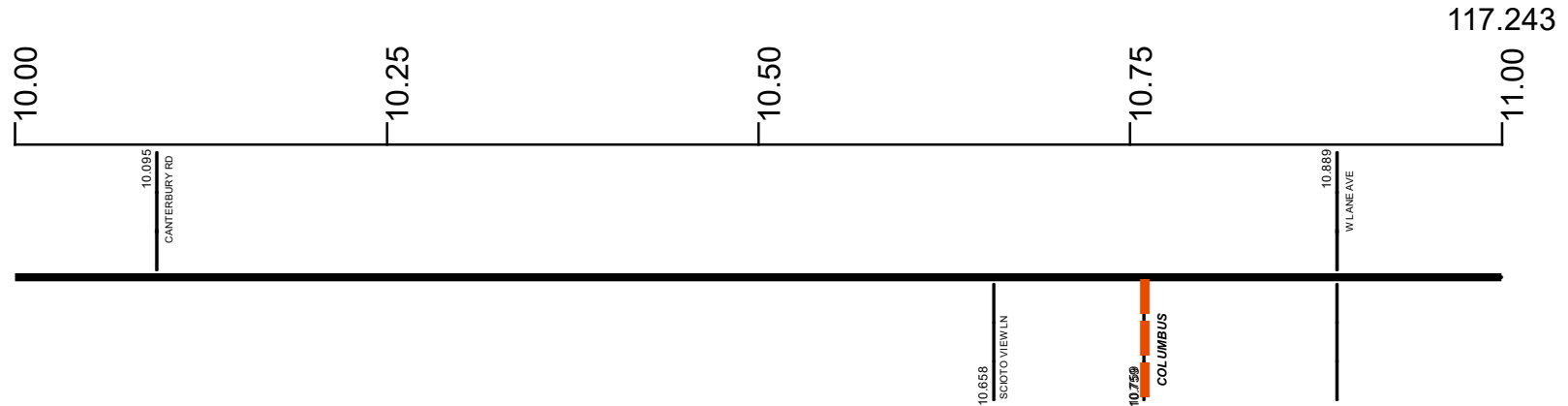

Surface Type & Width (Left / Right)

G (34'/6')  
9.079 - 11.342

Base Type (Left / Right)

L / N  
9.079 - 11.342

Shoulder Type & Width (Left / Right)

2 (8'/8')  
9.079 - 11.342

Through Lanes

4  
8.917 - 14.934

Street Name

RIVERSIDE DR  
3.919 - 11.877

- Non-divided Highway
- Divided Highway
- Secondary Segment
- Corporation
- Bridge (on route)
- Underpass
- Overpass
- Railroad (at grade)
- Railroad (underpass)
- Railroad (overpass)
- Intersection

Created on: 6/23/2025



transportation.ohio.gov  
Prepared by  
The Ohio Department of Transportation  
Office of Technical Services  
Roadway Information

# SFRAUS00033\*\*C

State True Log  
County True Log

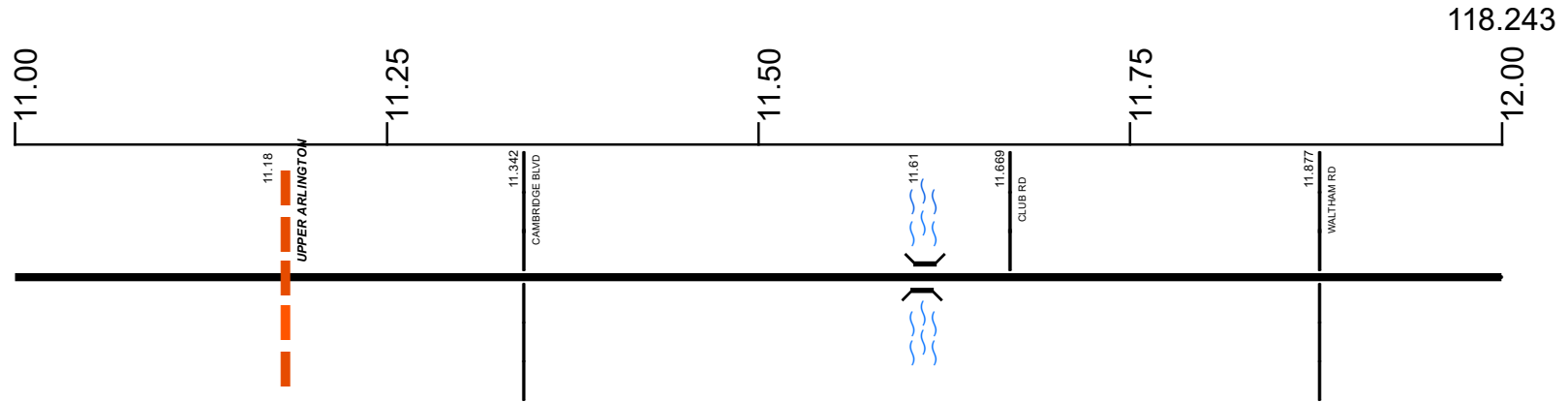

**Surface Type & Width (Left / Right)**

G (34'/6')	G (44'/18')	G (44'/16')	G (44'/20')
9.079 - 11.342	11.342 - 11.392	11.392 - 11.54	11.54 - 13.931

**Base Type (Left / Right)**

L / N	P / L
9.079 - 11.342	11.342 - 13.931

**Shoulder Type & Width (Left / Right)**

2 (8'/8')	1 (0'/0')
9.079 - 11.342	11.342 - 15.217

**Through Lanes**

4
8.917 - 14.934

**Street Name**

RIVERSIDE DR	DUBLIN RD
3.919 - 11.877	11.877 - 15.421

- Non-divided Highway
- Divided Highway
- Secondary Segment
- Corporation
- Bridge (on route)
- Underpass
- Overpass
- Railroad (at grade)
- Railroad (underpass)
- Railroad (overpass)
- Intersection

Created on: 6/23/2025



transportation.ohio.gov  
Prepared by  
The Ohio Department of Transportation  
Office of Technical Services  
Roadway Information

# SFRAUS00033\*\*C

State True Log  
County True Log

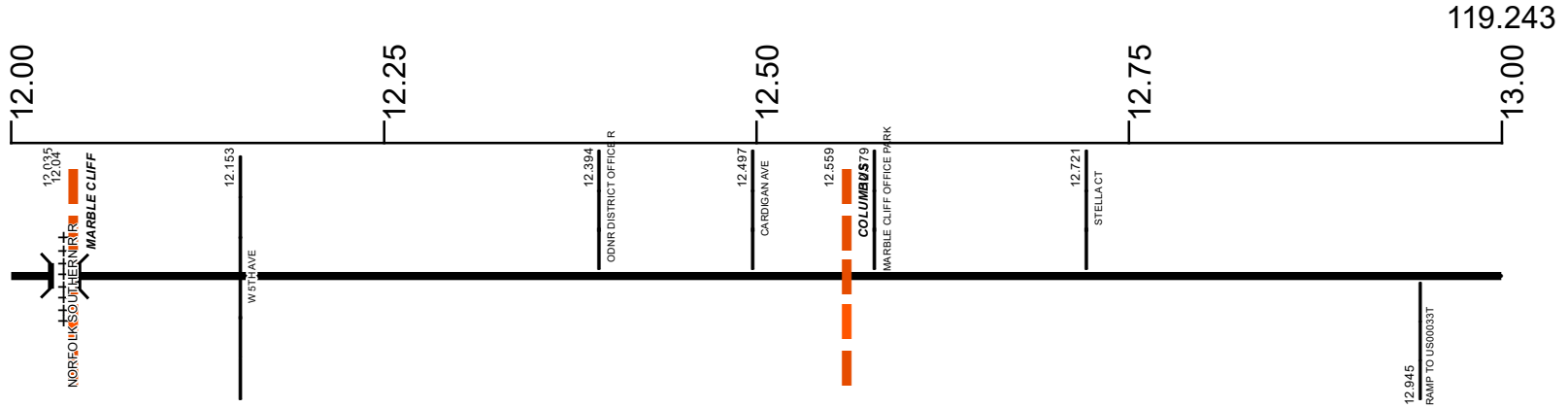

Surface Type & Width (Left / Right)

G (44'/20')  
11.54 - 13.931

Base Type (Left / Right)

P / L  
11.342 - 13.931

Shoulder Type & Width (Left / Right)

1 (0'/0')  
11.342 - 15.217

Through Lanes

4  
8.917 - 14.934

Street Name

DUBLIN RD  
11.877 - 15.421

- Non-divided Highway
- Divided Highway
- Secondary Segment
- Corporation
- Bridge (on route)
- Underpass
- Overpass
- Railroad (at grade)
- Railroad (underpass)
- Railroad (overpass)
- Intersection

Created on: 6/23/2025



transportation.ohio.gov  
Prepared by  
The Ohio Department of Transportation  
Office of Technical Services  
Roadway Information

# SFRAUS00033\*\*C

State True Log  
County True Log

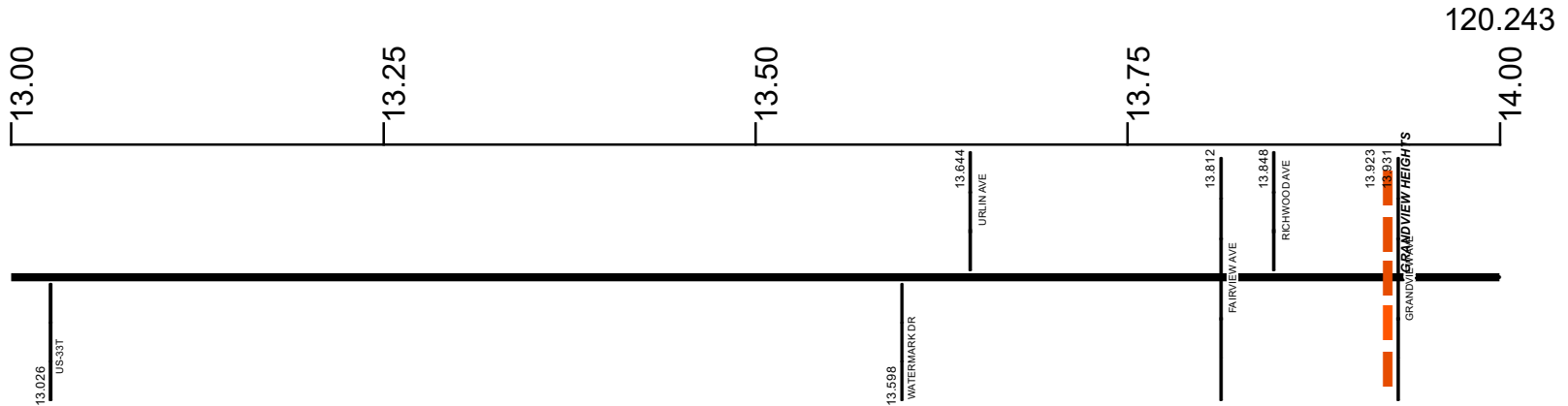

Surface Type & Width (Left / Right)

G (44'/20')	G 48'
11.54 - 13.931	13.931 - 14.615

Base Type (Left / Right)

P / L	P
11.342 - 13.931	13.931 - 14.615

Shoulder Type & Width (Left / Right)

1 (0'/0')
11.342 - 15.217

Through Lanes

4
8.917 - 14.934

Street Name

DUBLIN RD
11.877 - 15.421

- Non-divided Highway
- Divided Highway
- Secondary Segment
- Corporation
- Bridge (on route)
- Underpass
- Overpass
- Railroad (at grade)
- Railroad (underpass)
- Railroad (overpass)
- Intersection

Created on: 6/23/2025



transportation.ohio.gov  
Prepared by  
The Ohio Department of Transportation  
Office of Technical Services  
Roadway Information

# SFRAUS00033\*\*C

State True Log  
County True Log

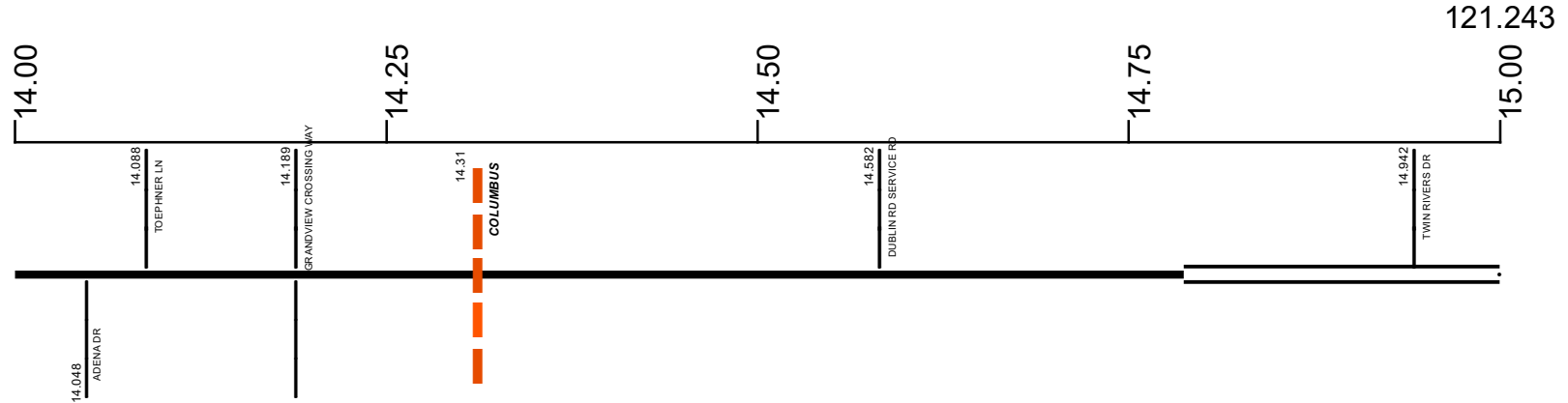

### Surface Type & Width (Left / Right)

G 48'	G 56'	G (34'/35')
13.931 - 14.615	14.615 - 14.934	14.934 - 15.217

### Base Type (Left / Right)

P	N
13.931 - 14.615	14.615 - 15.559

### Shoulder Type & Width (Left / Right)

1 (0'/0')
11.342 - 15.217

### Median Type and Width

2 (8')
14.787 - 15.421

### Through Lanes

4	5
8.917 - 14.934	14.934 - 15.217

### Street Name

DUBLIN RD
11.877 - 15.421

- Non-divided Highway
- Divided Highway
- Secondary Segment
- Corporation
- Bridge (on route)
- Underpass
- Overpass
- Railroad (at grade)
- Railroad (underpass)
- Railroad (overpass)
- Intersection

Created on: 6/23/2025



transportation.ohio.gov  
Prepared by  
The Ohio Department of Transportation  
Office of Technical Services  
Roadway Information

# SFRAUS00033\*\*C

State True Log

122.243

County True Log

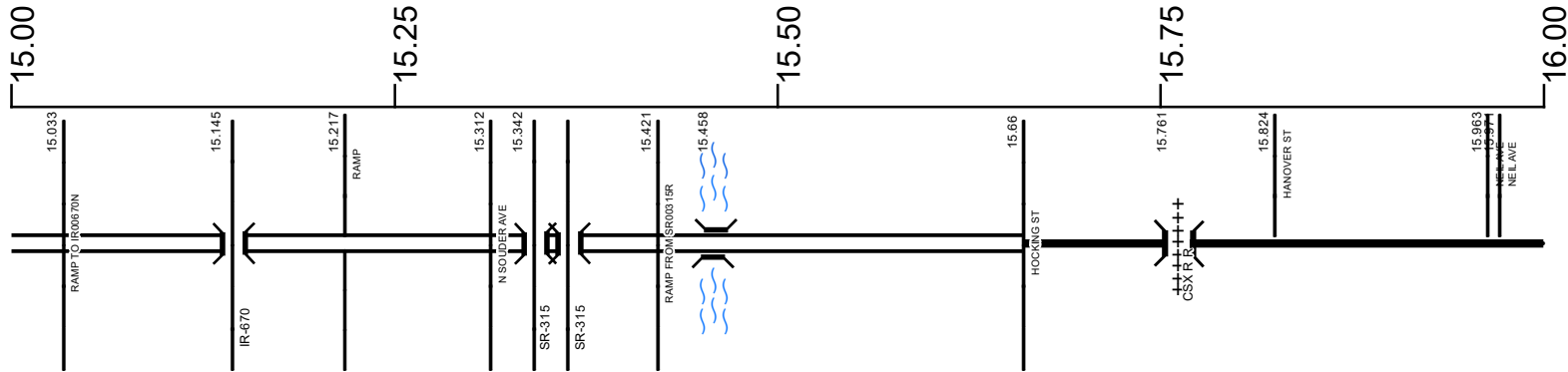

### Surface Type & Width (Left / Right)

G (34'/35')	G 88'	G 40'
14.934 - 15.217	15.217 - 15.559	15.559 - 16.121

### Base Type (Left / Right)

N	P
14.615 - 15.559	15.559 - 16.121

### Shoulder Type & Width (Left / Right)

1 (0'/0')	2 (0'/0')	1 (0'/0')
11.342 - 15.217	15.217 - 15.66	15.66 - 16.589

### Median Type and Width

2 (8')	2 (4')
14.787 - 15.421	15.421 - 15.66

### Through Lanes

5	6	4
14.934 - 15.217	15.217 - 15.559	15.559 - 16.589

### Street Name

DUBLIN RD	W LONG ST
11.877 - 15.421	15.421 - 16.446

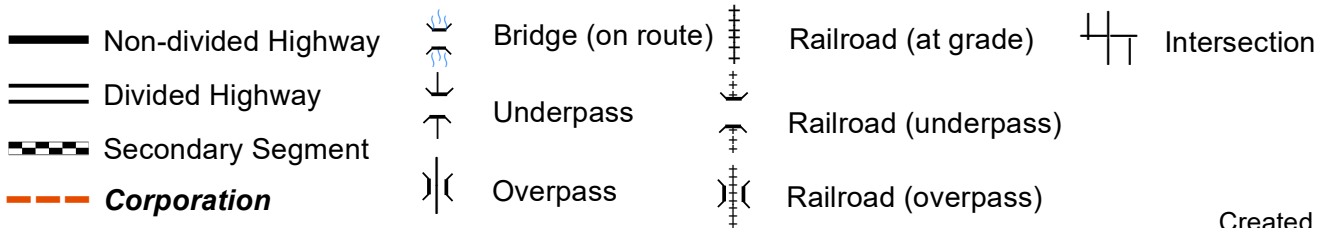

transportation.ohio.gov

Prepared by

The Ohio Department of Transportation  
Office of Technical Services  
Roadway Information

Created on: 6/23/2025

INTERCHANGE  
 IR 670, US 33,  
 US 33-T & SR 315  
 FRANKLIN COUNTY  
 INTERCHANGE ID NUMBER = 031400

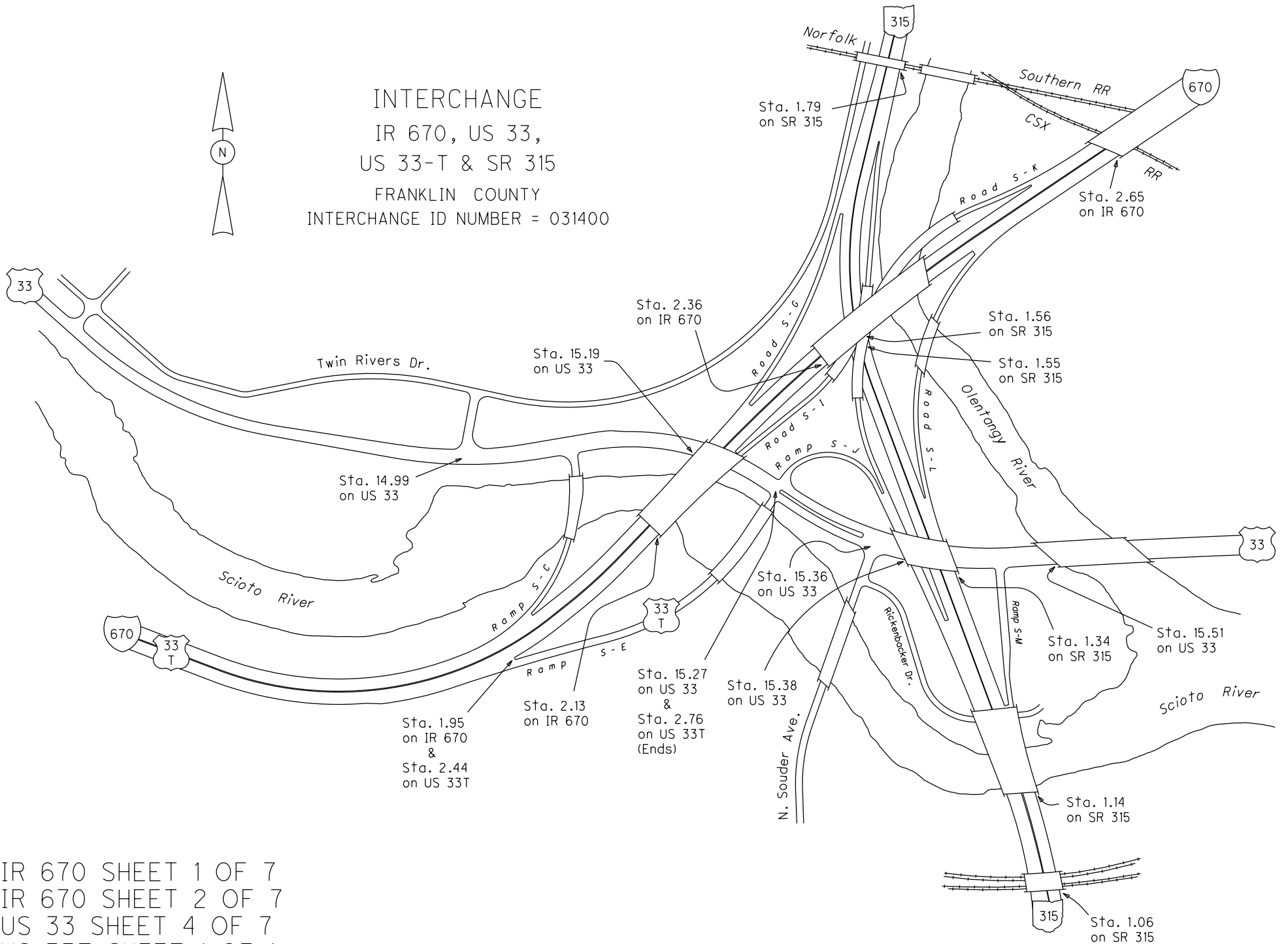

IR 670 SHEET 1 OF 7  
 IR 670 SHEET 2 OF 7  
 US 33 SHEET 4 OF 7  
 US 33T SHEET 1 OF 1  
 SR 315 SHEET 1 OF 4

# SFRAUS00033\*\*C

State True Log

123.243

County True Log

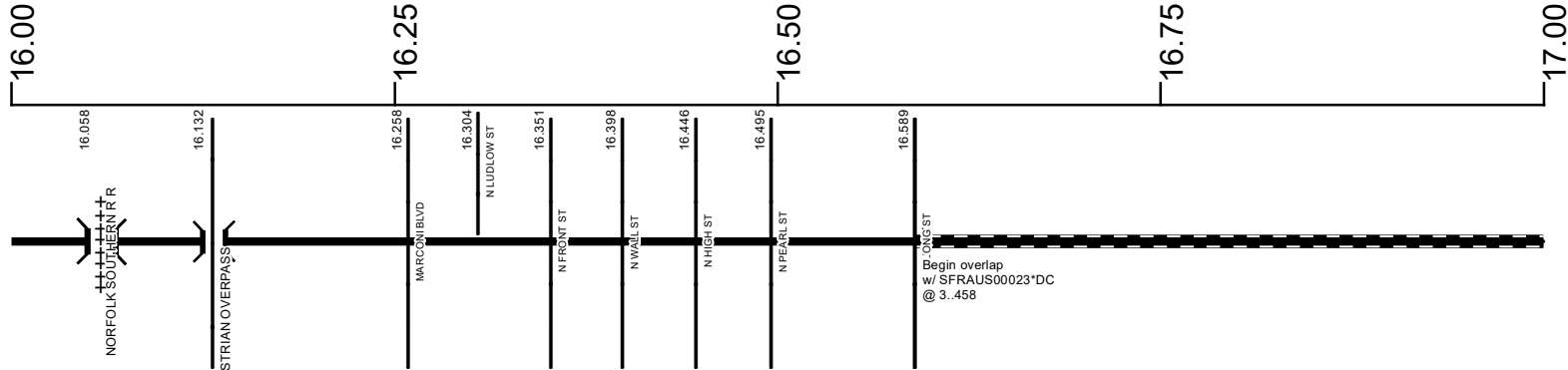

### Surface Type & Width (Left / Right)

G 40'	G (27'/28')	G 52'
15.559 - 16.121	16.121 - 16.258	16.258 - 16.589

### Base Type (Left / Right)

P	L	R
15.559 - 16.121	16.121 - 16.258	16.258 - 16.589

### Shoulder Type & Width (Left / Right)

1 (0'/0')
15.66 - 16.589

### Through Lanes

4
15.559 - 16.589

### Street Name

W LONG ST	E LONG ST
15.421 - 16.446	16.446 - 16.589

- Non-divided Highway
- Divided Highway
- Secondary Segment
- Corporation
- Bridge (on route)
- Underpass
- Overpass
- Railroad (at grade)
- Railroad (underpass)
- Railroad (overpass)
- Intersection

Created on: 6/23/2025



transportation.ohio.gov  
 Prepared by  
 The Ohio Department of Transportation  
 Office of Technical Services  
 Roadway Information

# SFRAUS00033\*\*C

State True Log  
County True Log

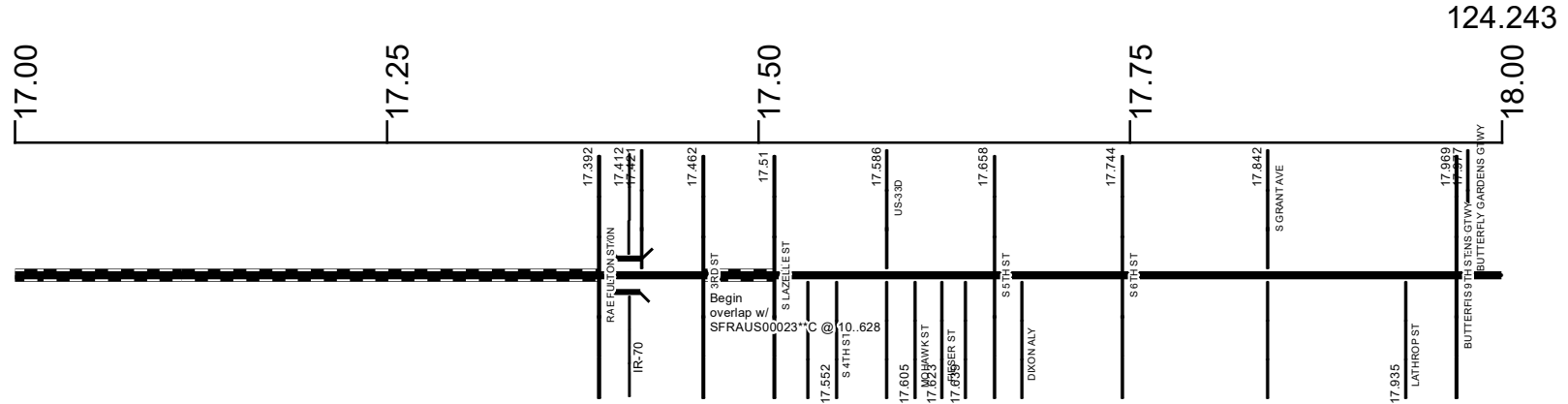

### Surface Type & Width (Left / Right)

G 52'	G 42'
17.392 - 17.462	17.51 - 18.088

Base Type (Left / Right)	Base Type (Left / Right)
R	R
17.392 - 17.462	17.559 - 18.088

### Shoulder Type & Width (Left / Right)

1 (0'/0')	1 (0'/0')
17.392 - 17.462	17.51 - 21.356

Through Lanes	Through Lanes
4	4
17.392 - 17.462	17.51 - 31.145

Street Name	Street Name
S 3RD ST	E LIVINGSTON AVE
17.392 - 17.462	17.51 - 20.631

Non-divided Highway	Bridge (on route)	Railroad (at grade)	Intersection
Divided Highway	Underpass	Railroad (underpass)	
Secondary Segment	Overpass	Railroad (overpass)	
Corporation			

Created on: 6/23/2025



transportation.ohio.gov  
Prepared by  
The Ohio Department of Transportation  
Office of Technical Services  
Roadway Information

INTERCHANGE  
 IRs 70, 71, USs 23,  
 33, 23-D & 33-D  
 FRANKLIN COUNTY  
 INTERCHANGE ID NUMBER = 026700

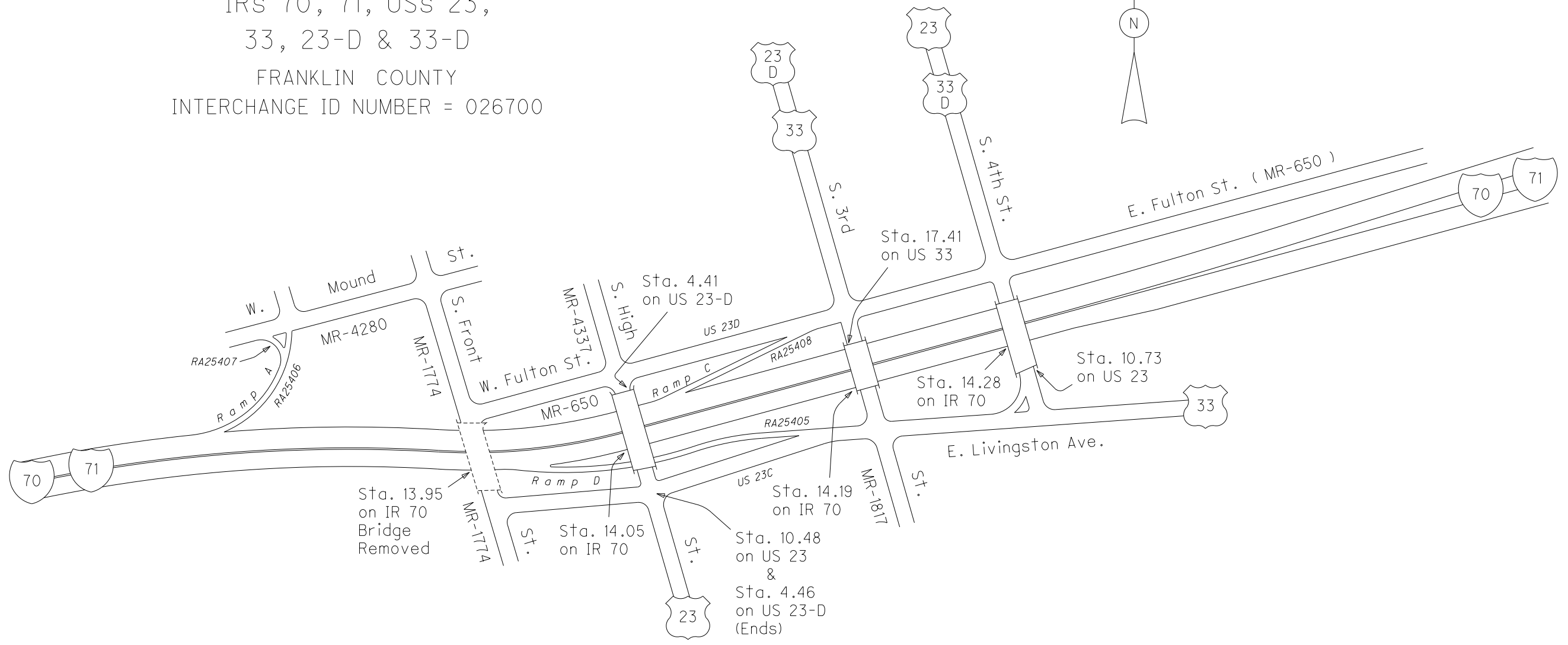
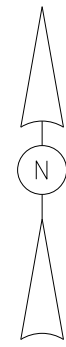

IR 70  
 US 23  
 US 23D  
 US 33  
 REVISED Feb 2024

# SFRAUS00033\*\*C

State True Log

125.243

County True Log

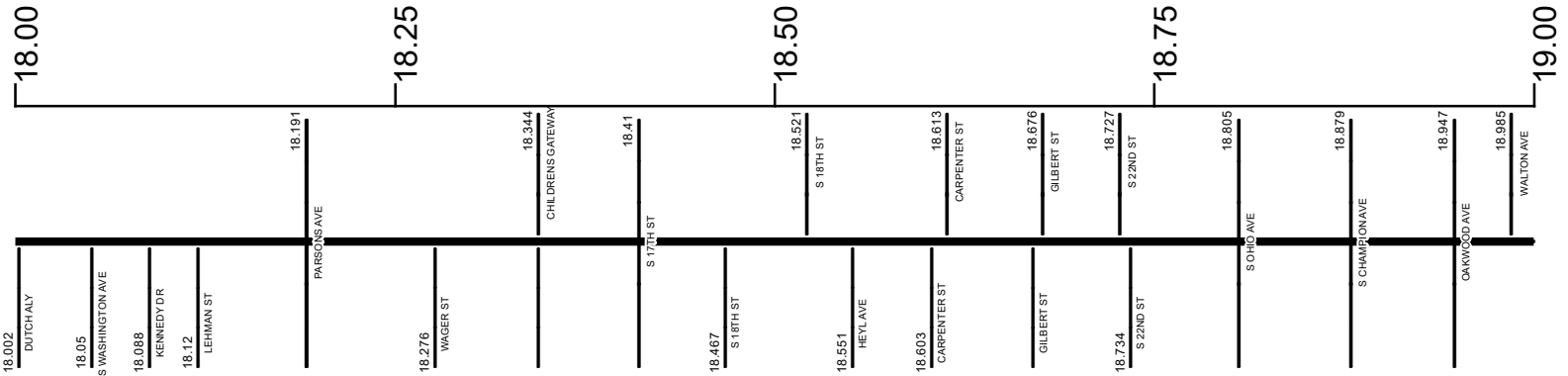

**Surface Type & Width (Left / Right)**

G 42'	G 64'	G 60'	G 42'
17.51 - 18.088	18.088 - 18.344	18.344 - 18.521	18.521 - 20.172

**Base Type (Left / Right)**

R	I	R
17.559 - 18.088	18.088 - 18.676	18.676 - 20.172

**Shoulder Type & Width (Left / Right)**

1 (0'/0')	
17.51 - 21.356	

**Through Lanes**

4
17.51 - 31.145

**Street Name**

E LIVINGSTON AVE
17.51 - 20.631

- Non-divided Highway
- Divided Highway
- Secondary Segment
- Corporation
- Bridge (on route)
- Underpass
- Overpass
- Railroad (at grade)
- Railroad (underpass)
- Railroad (overpass)
- Intersection

Created on: 6/23/2025



transportation.ohio.gov  
 Prepared by  
 The Ohio Department of Transportation  
 Office of Technical Services  
 Roadway Information

# SFRAUS00033\*\*C

State True Log

126.243

County True Log

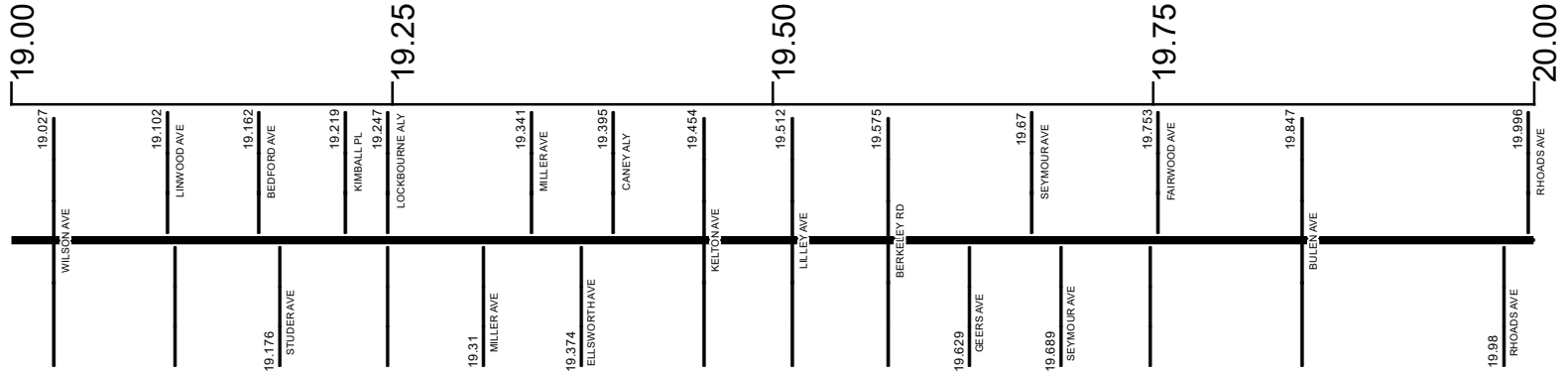

Surface Type & Width (Left / Right)

G 42'  
18.521 - 20.172

Base Type (Left / Right)

R  
18.676 - 20.172

Shoulder Type & Width (Left / Right)

1 (0'/0')  
17.51 - 21.356

Through Lanes

4  
17.51 - 31.145

Street Name

E LIVINGSTON AVE  
17.51 - 20.631

- Non-divided Highway
- Divided Highway
- Secondary Segment
- Corporation
- Bridge (on route)
- Underpass
- Overpass
- Railroad (at grade)
- Railroad (underpass)
- Railroad (overpass)
- Intersection

Created on: 6/23/2025

transportation.ohio.gov  
Prepared by  
The Ohio Department of Transportation  
Office of Technical Services  
Roadway Information

# SFRAUS00033\*\*C

State True Log

127.243

County True Log

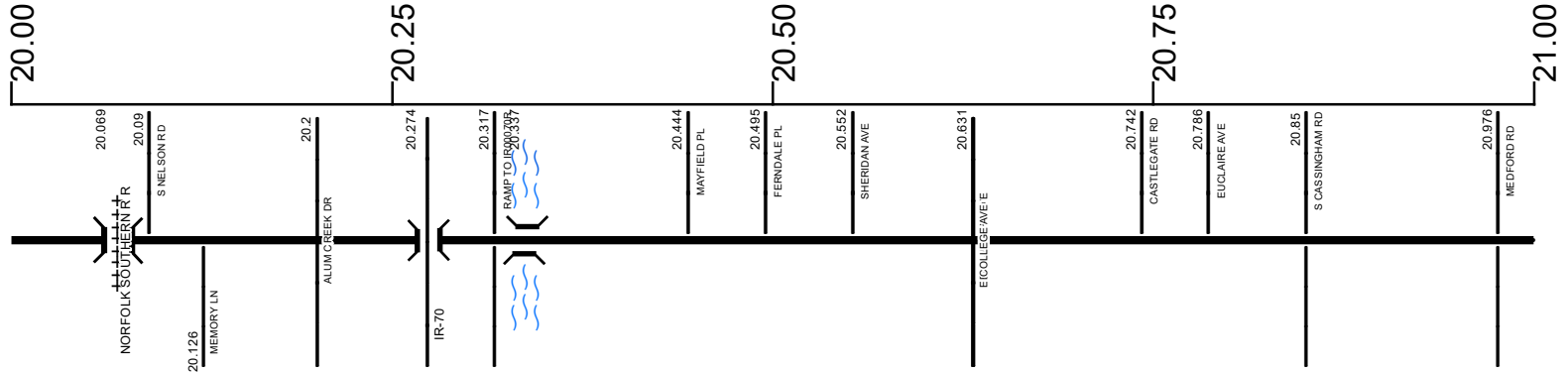

### Surface Type & Width (Left / Right)

G 42'	G 44'	G (26'/27')	G 40'	G 46'
18.521 - 20.172	20.172 - 20.306	20.306 - 20.424	20.424 - 20.631	20.631 - 21.336

### Base Type (Left / Right)

R	L	R	P
18.676 - 20.172	20.172 - 20.424	20.424 - 20.631	20.631 - 31.145

### Shoulder Type & Width (Left / Right)

1 (0'/0')
17.51 - 21.356

### Through Lanes

4
17.51 - 31.145

### Street Name

E LIVINGSTON AVE	COLLEGE AVE
17.51 - 20.631	20.631 - 22.328

- Non-divided Highway
- Divided Highway
- Secondary Segment
- Corporation
- Bridge (on route)
- Underpass
- Overpass
- Railroad (at grade)
- Railroad (underpass)
- Railroad (overpass)
- Intersection

Created on: 6/23/2025



transportation.ohio.gov

Prepared by  
The Ohio Department of Transportation  
Office of Technical Services  
Roadway Information

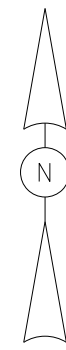
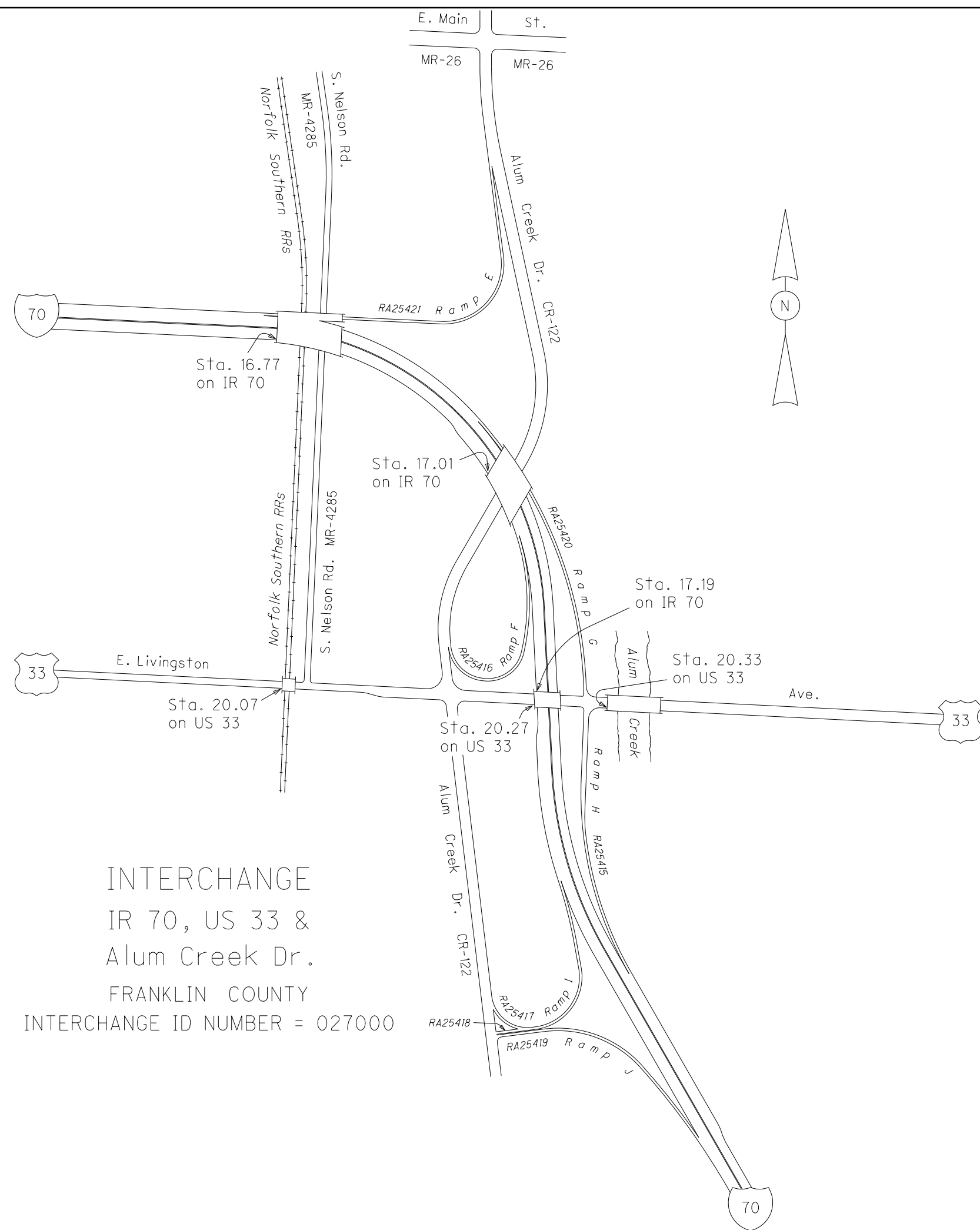

INTERCHANGE  
 IR 70, US 33 &  
 Alum Creek Dr.  
 FRANKLIN COUNTY  
 INTERCHANGE ID NUMBER = 027000

# SFRAUS00033\*\*C

State True Log  
County True Log

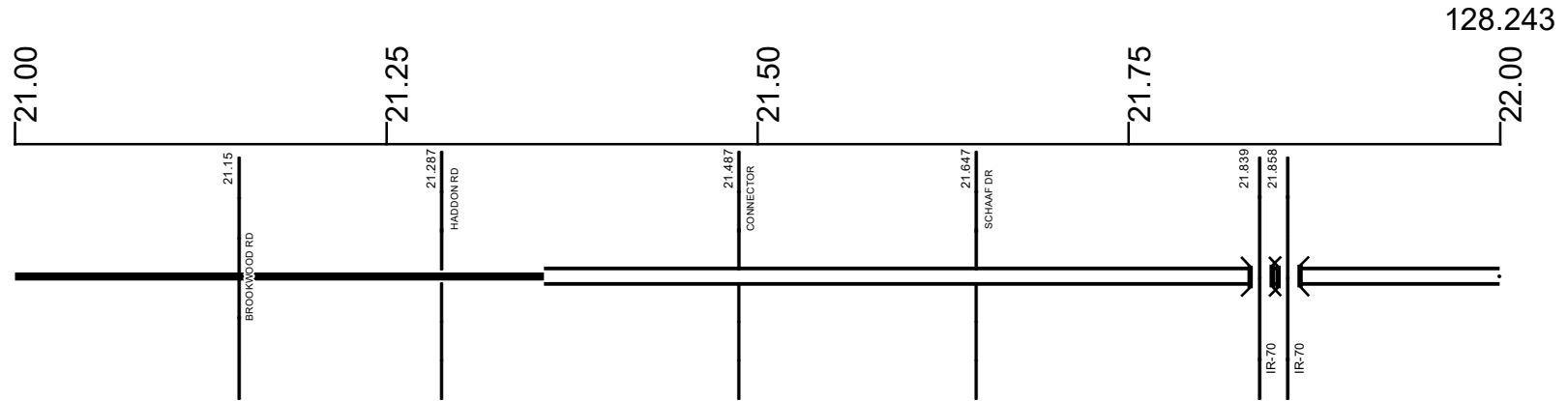

**Surface Type & Width (Left / Right)**

G 46'	G 40'	G 48'
20.631 - 21.336		21.356 - 24.554

**Base Type (Left / Right)**

P
20.631 - 31.145

**Shoulder Type & Width (Left / Right)**

1 (0'/0')	1 (14'/12')	2 (14'/12')
17.51 - 21.356	21.356 - 21.375	21.375 - 26.057

**Median Type and Width**

2 ( 48' )
21.356 - 25.669

**Through Lanes**

4
17.51 - 31.145

**Street Name**

COLLEGE AVE
20.631 - 22.328

- Non-divided Highway
- Divided Highway
- Secondary Segment
- Corporation
- Bridge (on route)
- Underpass
- Overpass
- Railroad (at grade)
- Railroad (underpass)
- Railroad (overpass)
- Intersection

Created on: 6/23/2025



transportation.ohio.gov  
Prepared by  
The Ohio Department of Transportation  
Office of Technical Services  
Roadway Information

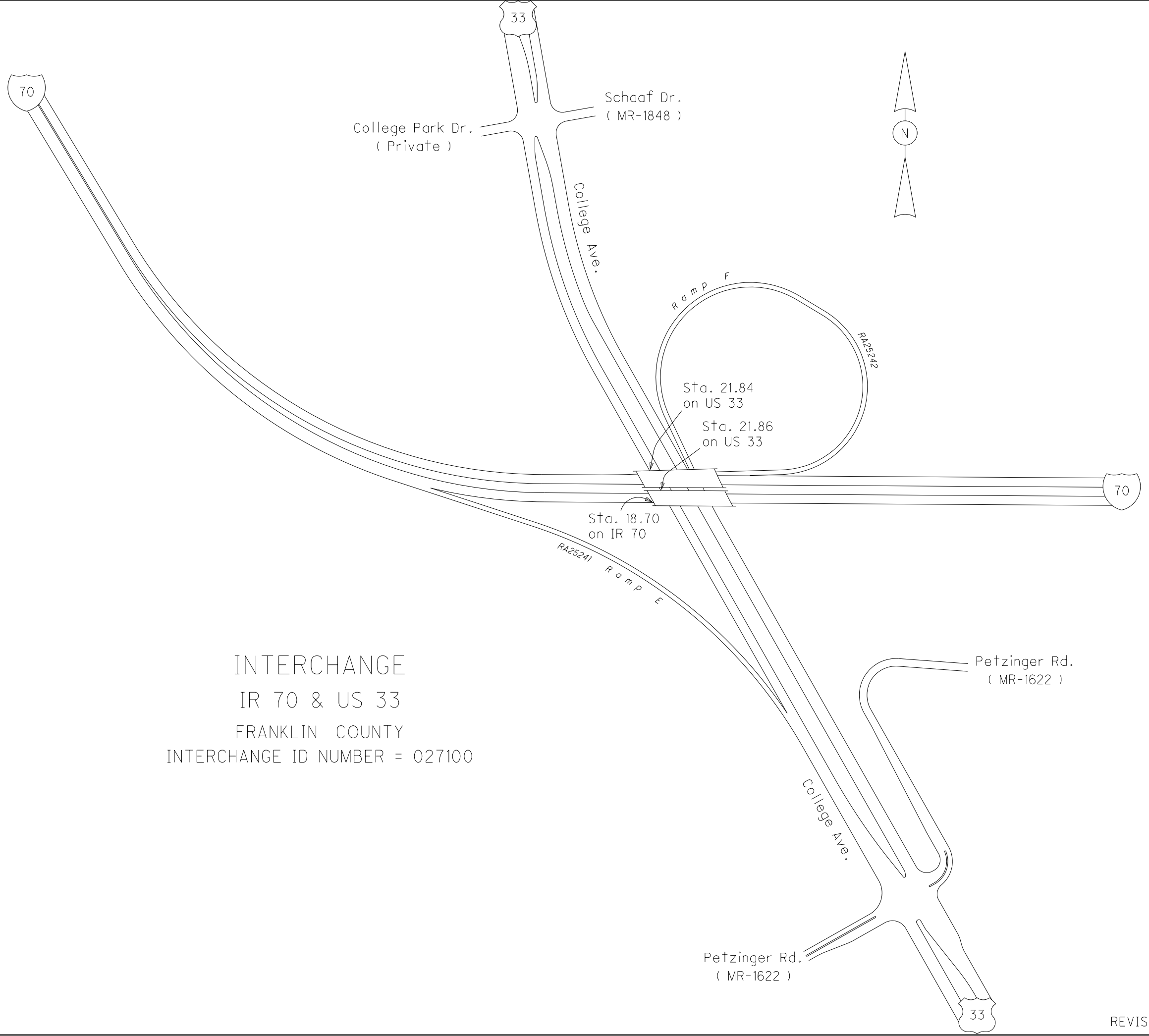

INTERCHANGE  
IR 70 & US 33  
FRANKLIN COUNTY  
INTERCHANGE ID NUMBER = 027100

IR 70  
US 33  
REVISED Feb 2024

# SFRAUS00033\*\*C

State True Log

129.243

County True Log

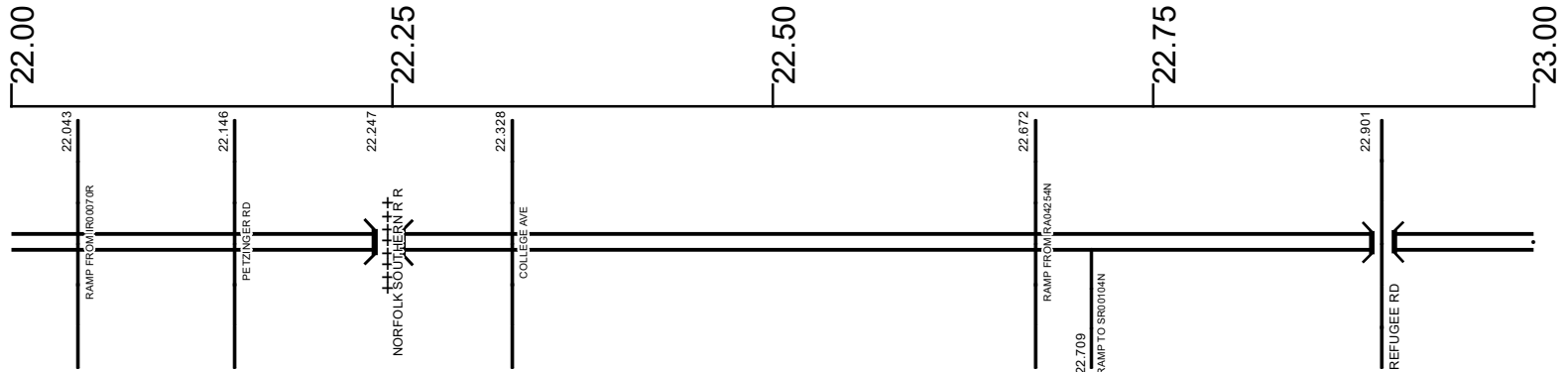

Surface Type & Width (Left / Right)

G 48'  
21.356 - 24.554

Base Type (Left / Right)

P  
20.631 - 31.145

Shoulder Type & Width (Left / Right)

2 (14'/12')  
21.375 - 26.057

Median Type and Width

2 ( 48' )  
21.356 - 25.669

Resurface Year

2023

22.93 - 24.27

Through Lanes

4  
17.51 - 31.145

Street Name

COLLEGE AVE 20.631 - 22.328	US 33 22.328 - 31.145
--------------------------------	--------------------------

- Non-divided Highway
- Divided Highway
- Secondary Segment
- Corporation
- Bridge (on route)
- Underpass
- Overpass
- Railroad (at grade)
- Railroad (underpass)
- Railroad (overpass)
- Intersection

Created on: 6/23/2025



transportation.ohio.gov  
Prepared by  
The Ohio Department of Transportation  
Office of Technical Services  
Roadway Information

INTERCHANGE  
 US 33, SR 104 & Refugee Rd.  
 FRANKLIN COUNTY  
 INTERCHANGE ID NUMBER = 032400

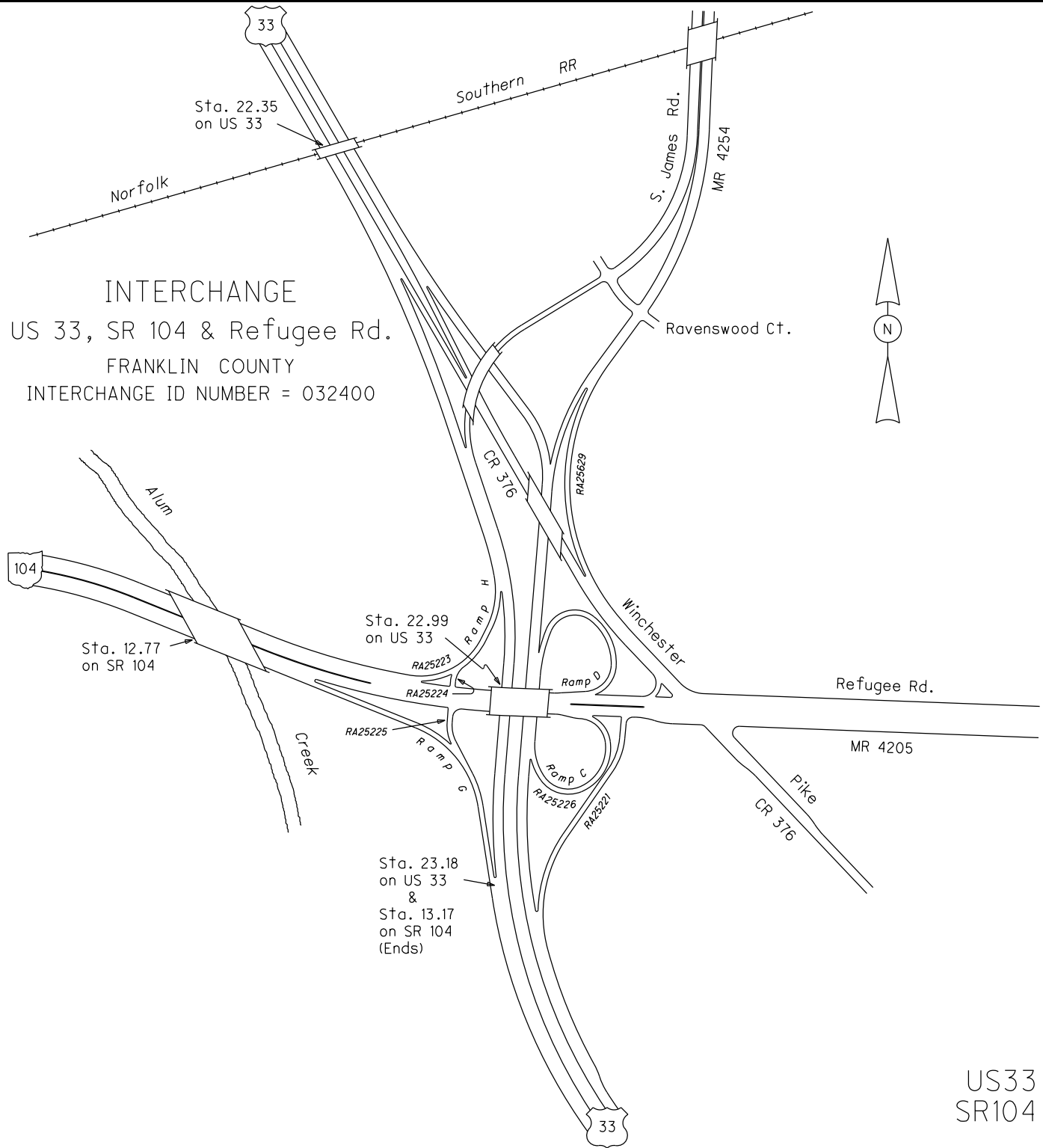

# SFRAUS00033\*\*C

State True Log

130.243

County True Log

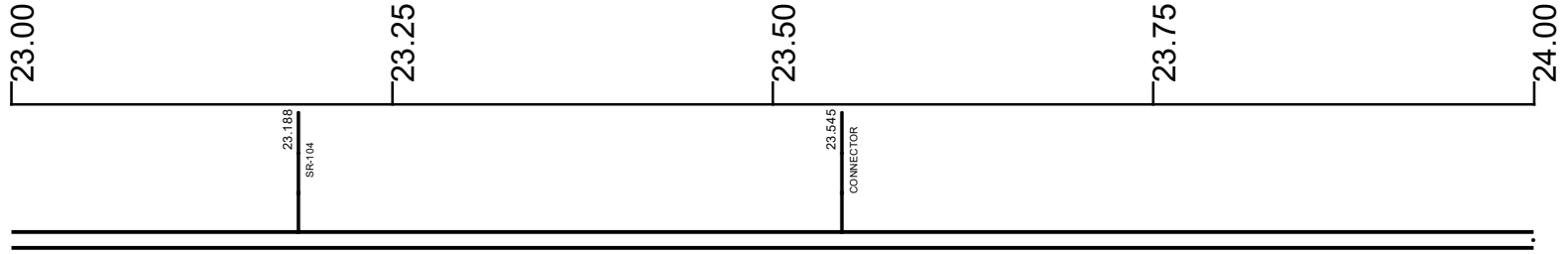

Surface Type & Width (Left / Right)

G 48'  
21.356 - 24.554

Base Type (Left / Right)

P  
20.631 - 31.145

Shoulder Type & Width (Left / Right)

2 (14'/12')  
21.375 - 26.057

Median Type and Width

2 ( 48' )  
21.356 - 25.669

Resurface Year









2023  
22.93 - 24.27

Through Lanes

4  
17.51 - 31.145

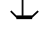
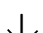
Street Name

US 33  
22.328 - 31.145

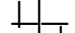
-  Non-divided Highway
-  Divided Highway
-  Secondary Segment
-  Corporation
-  Bridge (on route)
-  Underpass
-  Overpass
-  Railroad (at grade)
-  Railroad (underpass)
-  Railroad (overpass)
-  Intersection

Created on: 6/23/2025



transportation.ohio.gov  
Prepared by  
The Ohio Department of Transportation  
Office of Technical Services  
Roadway Information

# SFRAUS00033\*\*C

State True Log  
County True Log

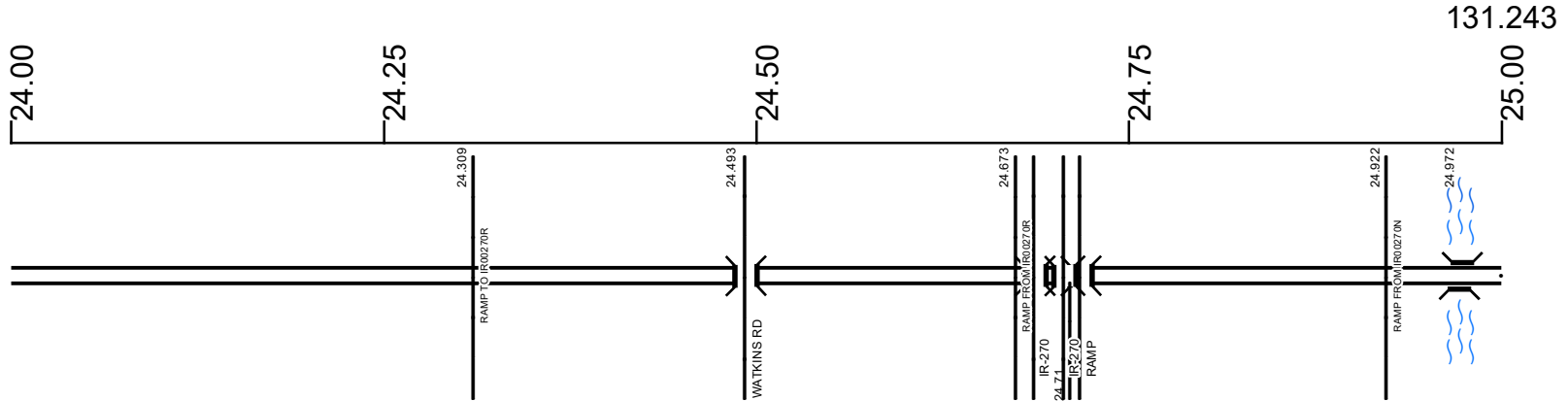

Surface Type & Width (Left / Right)	G 48'	G (24'/36')	G 72'
	21.356 - 24.554	24.554 - 24.922	24.922 - 25.609
Base Type (Left / Right)	P		
	20.631 - 31.145		
Shoulder Type & Width (Left / Right)	2 (14'/12')		
	21.375 - 26.057		
Median Type and Width	2 ( 48' )		
	21.356 - 25.669		
Resurface Year	2023		
	22.93 - 24.27		
Through Lanes	4		
	17.51 - 31.145		
Street Name	US 33		
	22.328 - 31.145		

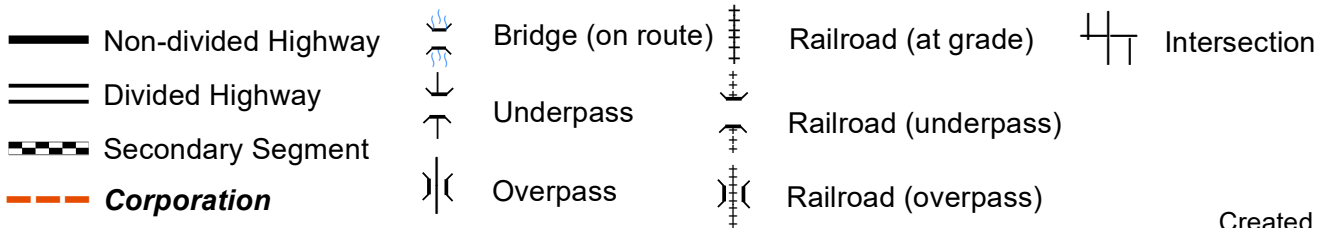

Created on: 6/23/2025



transportation.ohio.gov  
Prepared by  
The Ohio Department of Transportation  
Office of Technical Services  
Roadway Information

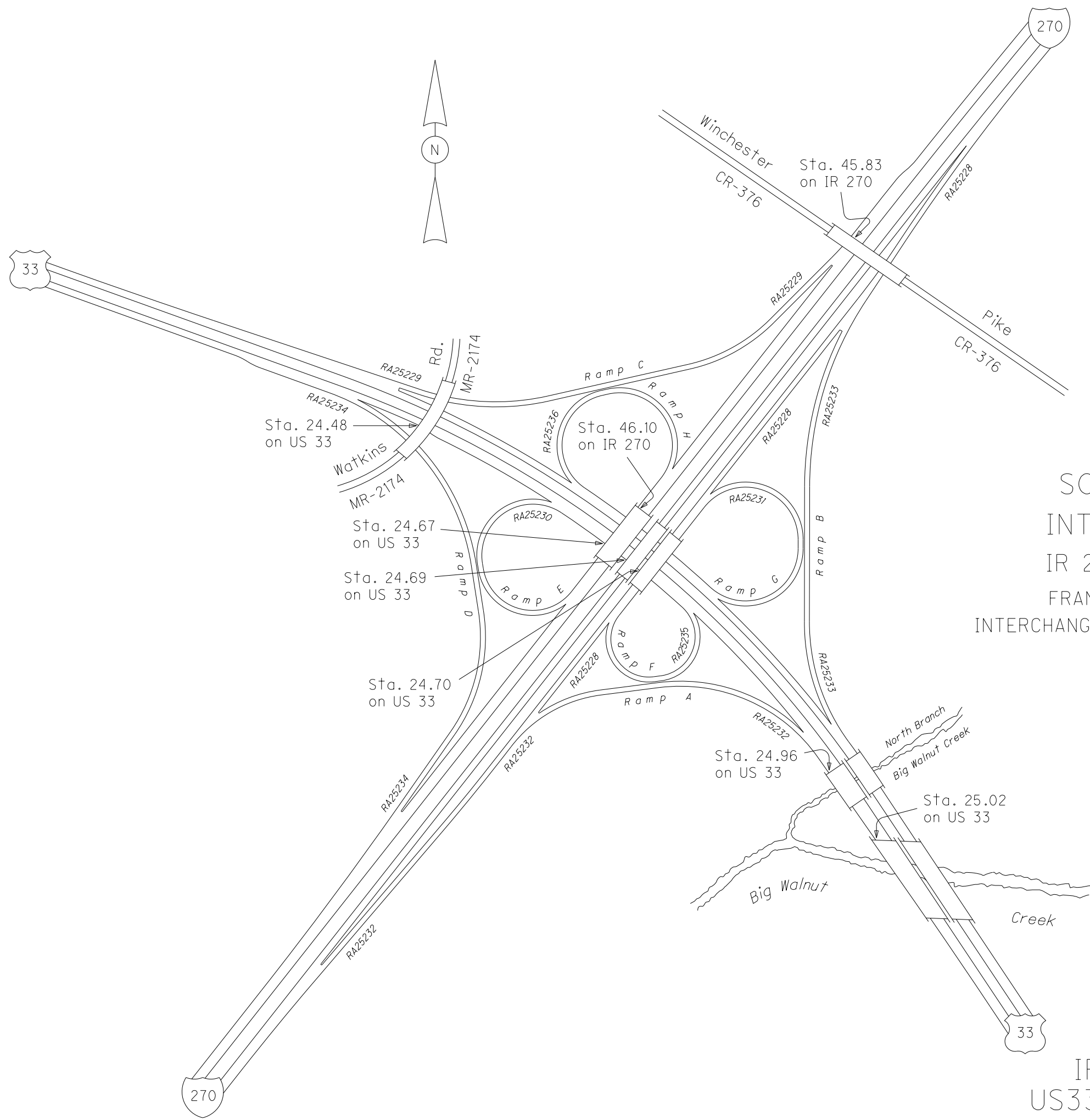

SOUTHEAST  
 INTERCHANGE  
 IR 270 & US 33  
 FRANKLIN COUNTY  
 INTERCHANGE ID NUMBER = 031100

IR270 SHEET 10 OF 11  
 US33 (SE) SHEET 5 OF 7

REVISED Jan 2022

# SFRAUS00033\*\*C

State True Log  
County True Log

132.243

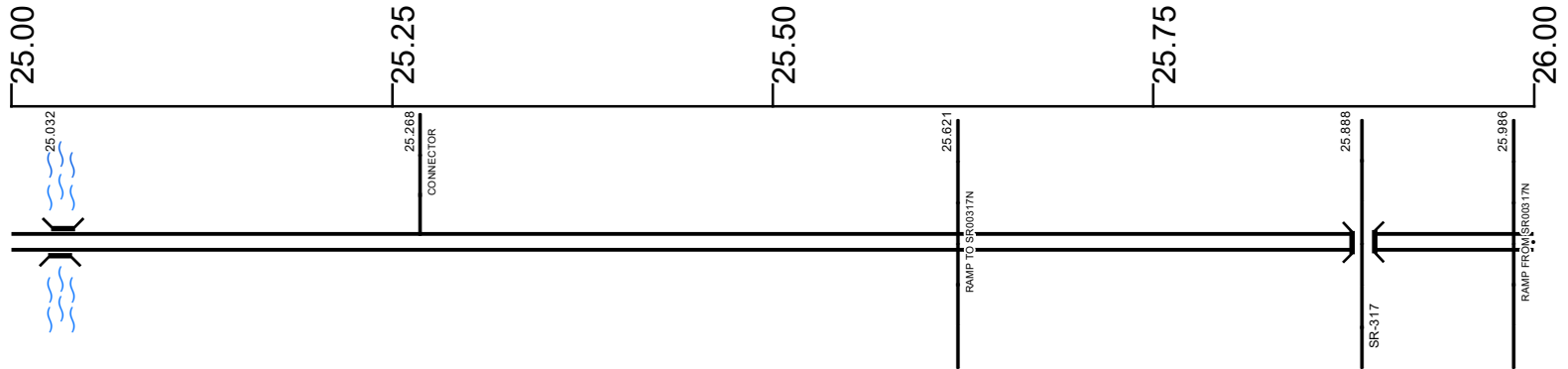

**Surface Type & Width (Left / Right)**

G 72'	G (24'/36')	G 48'
24.922 - 25.609	25.609 - 25.669	25.669 - 27.79

**Base Type (Left / Right)**

P
20.631 - 31.145

**Shoulder Type & Width (Left / Right)**

2 (14'/12')
21.375 - 26.057

**Median Type and Width**

2 (48')	2 (60')
21.356 - 25.669	25.669 - 26.057

**Through Lanes**

4
17.51 - 31.145

**Street Name**

US 33
22.328 - 31.145

- Non-divided Highway
- Divided Highway
- Secondary Segment
- Corporation
- Bridge (on route)
- Underpass
- Overpass
- Railroad (at grade)
- Railroad (underpass)
- Railroad (overpass)
- Intersection

Created on: 6/23/2025



transportation.ohio.gov  
Prepared by  
The Ohio Department of Transportation  
Office of Technical Services  
Roadway Information

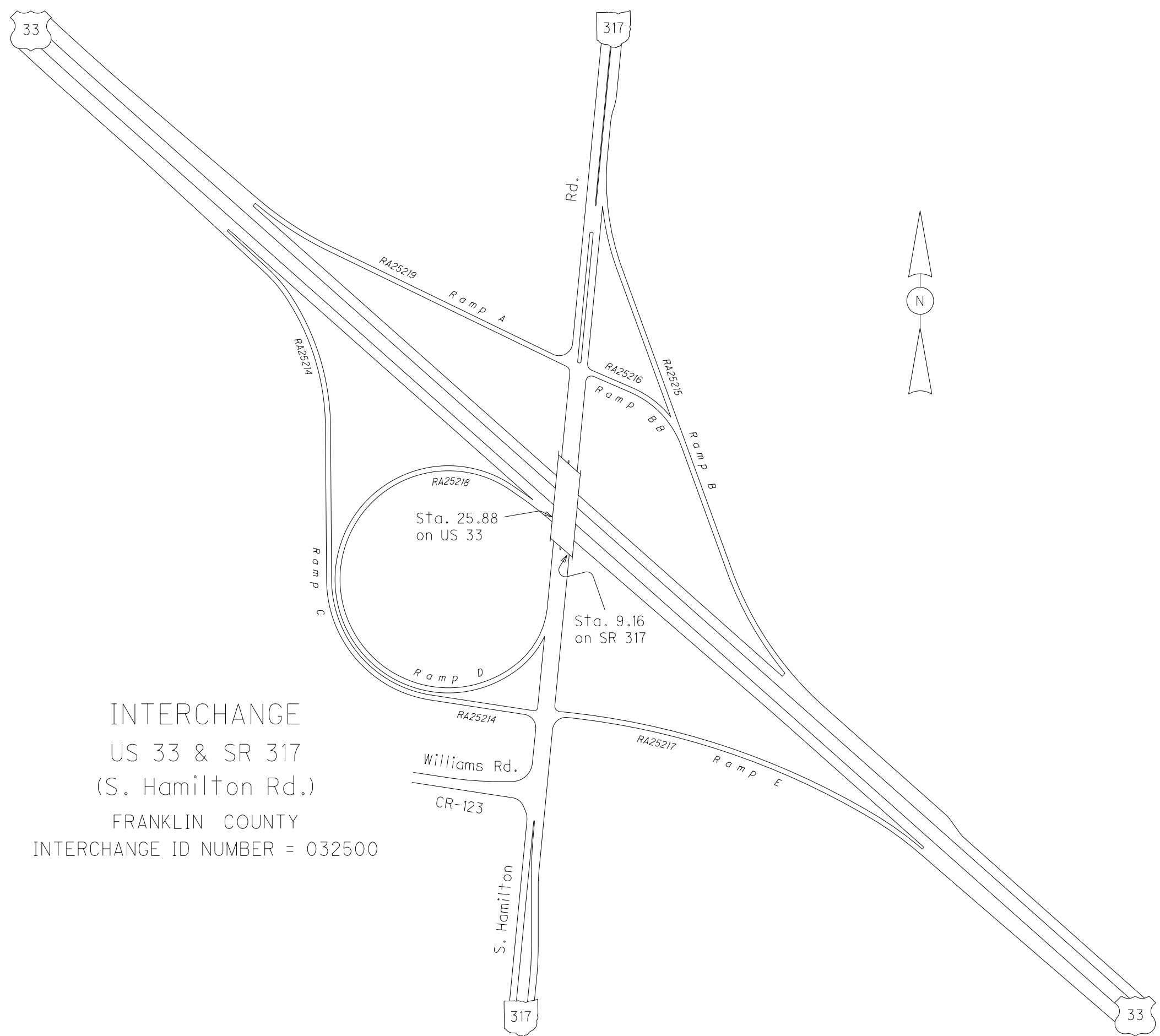

INTERCHANGE  
 US 33 & SR 317  
 (S. Hamilton Rd.)  
 FRANKLIN COUNTY  
 INTERCHANGE ID NUMBER = 032500

# SFRAUS00033\*\*C

State True Log  
County True Log

133.243

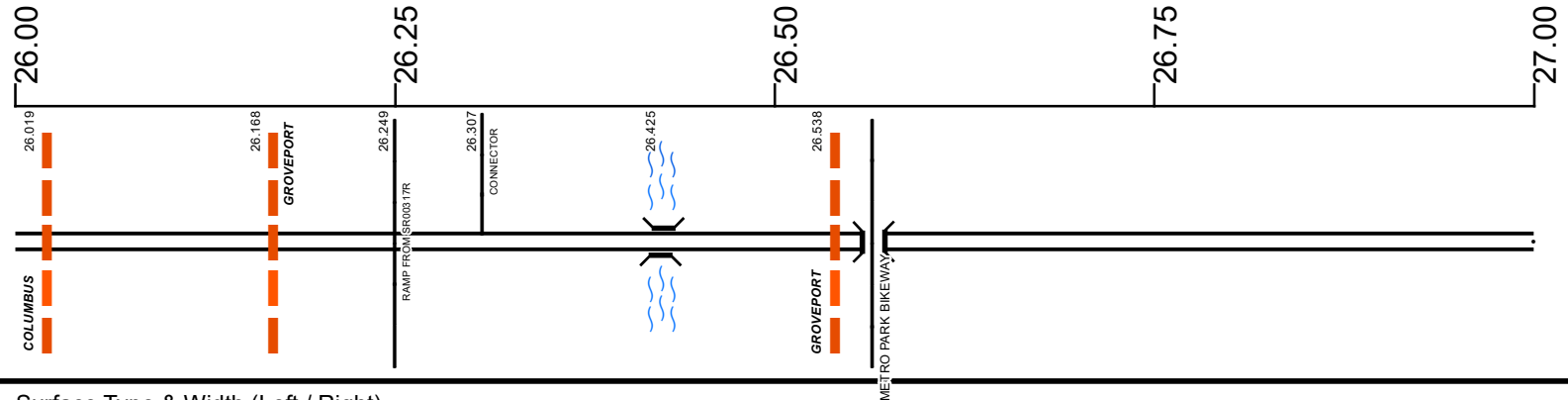

Surface Type & Width (Left / Right)	G 48'	25.669 - 27.79
Base Type (Left / Right)	P	20.631 - 31.145
Shoulder Type & Width (Left / Right)	2 (14'/12')	5 (12'/12')
	21.375 - 26.057	26.057 - 27.79
Median Type and Width	2 (60')	2 (52')
	25.669 - 26.057	26.057 - 27.79
Through Lanes	4	17.51 - 31.145
Street Name	US 33	22.328 - 31.145

Non-divided Highway	Bridge (on route)	Railroad (at grade)	Intersection
Divided Highway	Underpass	Railroad (underpass)	
Secondary Segment	Overpass	Railroad (overpass)	
Corporation			

Created on: 6/23/2025

transportation.ohio.gov  
Prepared by  
The Ohio Department of Transportation  
Office of Technical Services  
Roadway Information

# SFRAUS00033\*\*C

State True Log

134.243

County True Log

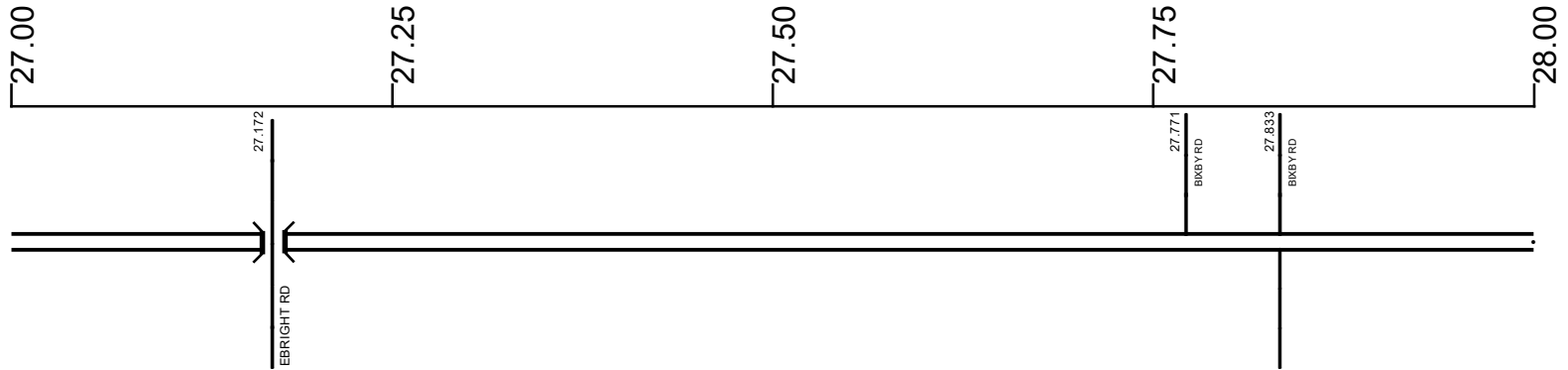

**Surface Type & Width (Left / Right)**

G 48'	G (48'/60')	G 48'
25.669 - 27.79	27.79 - 27.919	27.919 - 31.145

**Base Type (Left / Right)**

P
20.631 - 31.145

**Shoulder Type & Width (Left / Right)**

5 (12'/12')	2 (14'/14')	5 (12'/12')
26.057 - 27.79	27.79 - 27.919	27.919 - 31.145

**Median Type and Width**

2 ( 52' )	2 ( 4' )	2 ( 52' )
26.057 - 27.79	27.79 - 27.919	27.919 - 31.145

**Through Lanes**

4
17.51 - 31.145

**Street Name**

US 33
22.328 - 31.145

- Non-divided Highway
- Divided Highway
- Secondary Segment
- Corporation
- Bridge (on route)
- Underpass
- Overpass
- Railroad (at grade)
- Railroad (underpass)
- Railroad (overpass)
- Intersection

Created on: 6/23/2025



transportation.ohio.gov  
 Prepared by  
 The Ohio Department of Transportation  
 Office of Technical Services  
 Roadway Information

# SFRAUS00033\*\*C

State True Log

135.243

County True Log

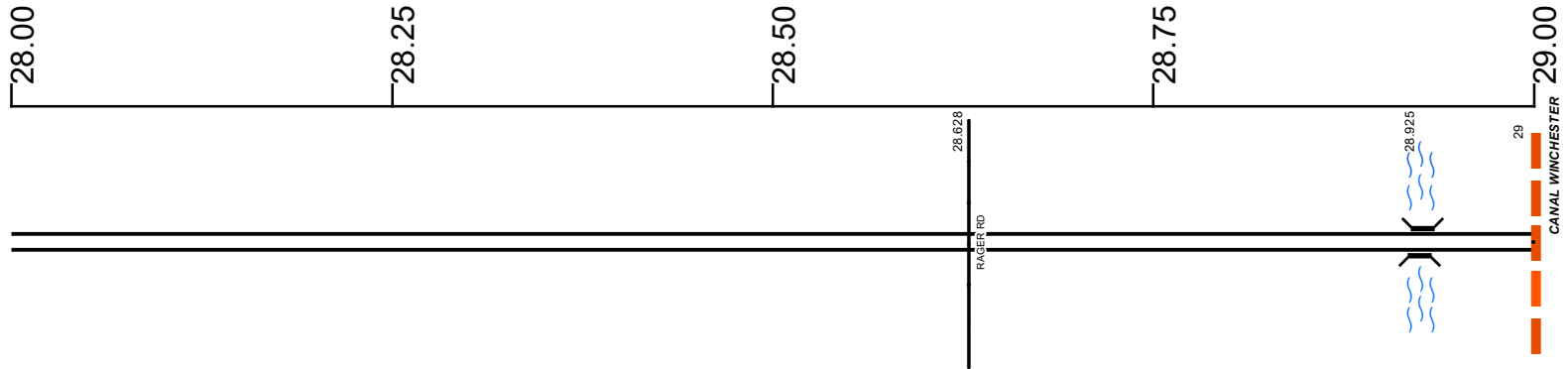

Surface Type & Width (Left / Right)

G 48'  
27.919 - 31.145

Base Type (Left / Right)

P  
20.631 - 31.145

Shoulder Type & Width (Left / Right)

5 (12'/12')  
27.919 - 31.145

Median Type and Width

2 ( 52' )  
27.919 - 31.145

Through Lanes

4  
17.51 - 31.145

Street Name

US 33  
22.328 - 31.145

- Non-divided Highway
- Divided Highway
- Secondary Segment
- Corporation
- Bridge (on route)
- Underpass
- Overpass
- Railroad (at grade)
- Railroad (underpass)
- Railroad (overpass)
- Intersection

Created on: 6/23/2025

transportation.ohio.gov  
Prepared by  
The Ohio Department of Transportation  
Office of Technical Services  
Roadway Information

# SFRAUS00033\*\*C

State True Log

136.243

County True Log

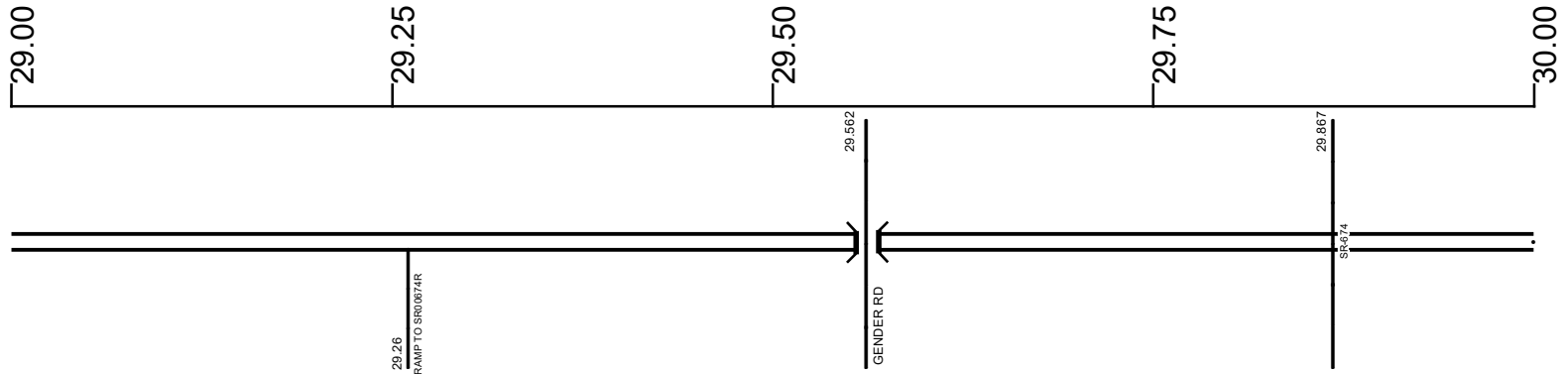

Surface Type & Width (Left / Right)

G 48'  
27.919 - 31.145

Base Type (Left / Right)

P  
20.631 - 31.145

Shoulder Type & Width (Left / Right)

5 (12'/12')  
27.919 - 31.145

Median Type and Width

2 ( 52' )  
27.919 - 31.145

Through Lanes

4  
17.51 - 31.145

Street Name

US 33  
22.328 - 31.145

- Non-divided Highway
- Divided Highway
- Secondary Segment
- Corporation
- Bridge (on route)
- Underpass
- Overpass
- Railroad (at grade)
- Railroad (underpass)
- Railroad (overpass)
- Intersection

Created on: 6/23/2025



transportation.ohio.gov  
Prepared by  
The Ohio Department of Transportation  
Office of Technical Services  
Roadway Information

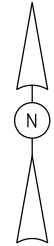
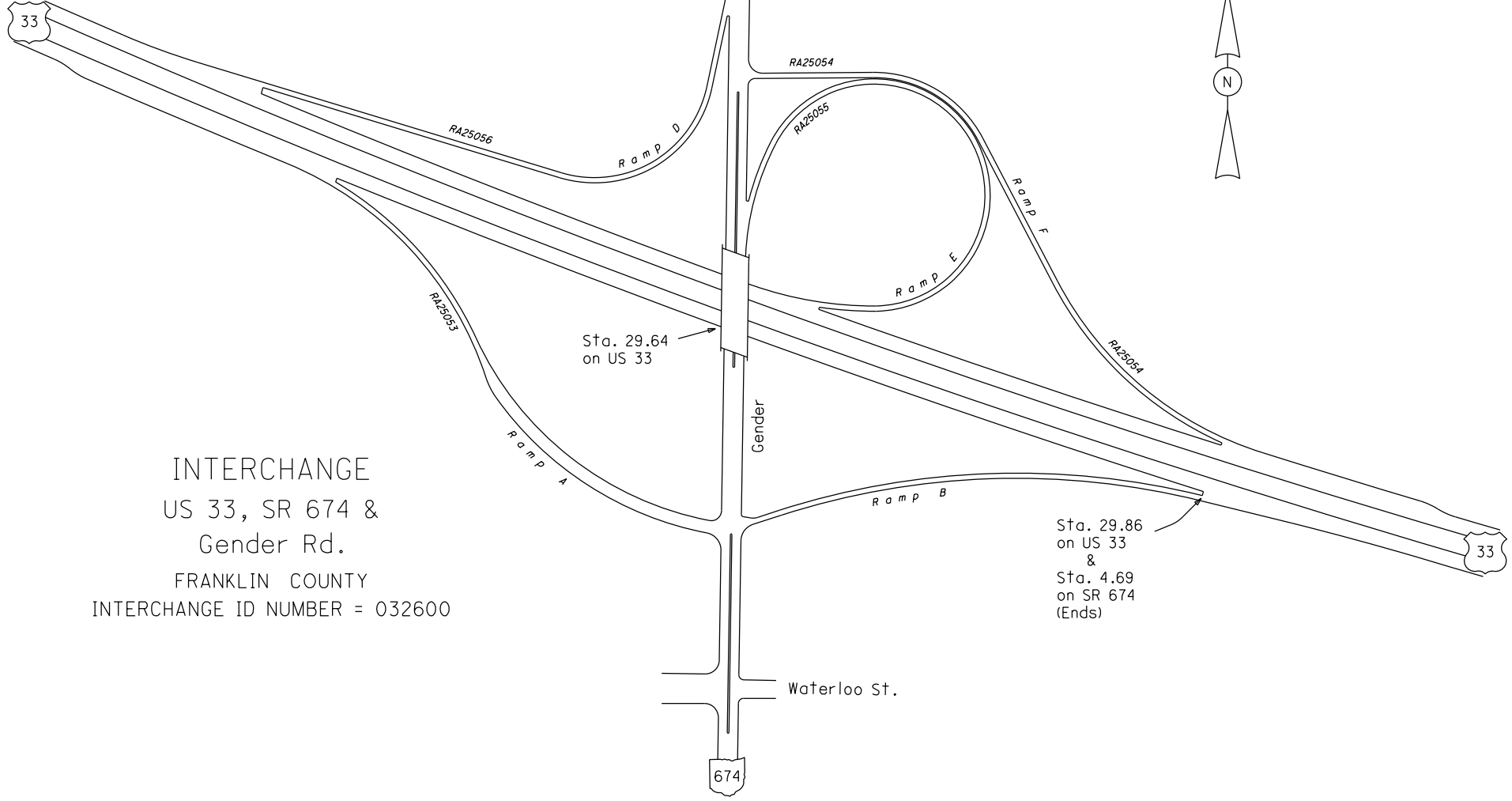

INTERCHANGE  
 US 33, SR 674 &  
 Gender Rd.  
 FRANKLIN COUNTY  
 INTERCHANGE ID NUMBER = 032600

Sta. 29.86  
 on US 33  
 &  
 Sta. 4.69  
 on SR 674  
 (Ends)

# SFRAUS00033\*\*C

State True Log

137.243

County True Log

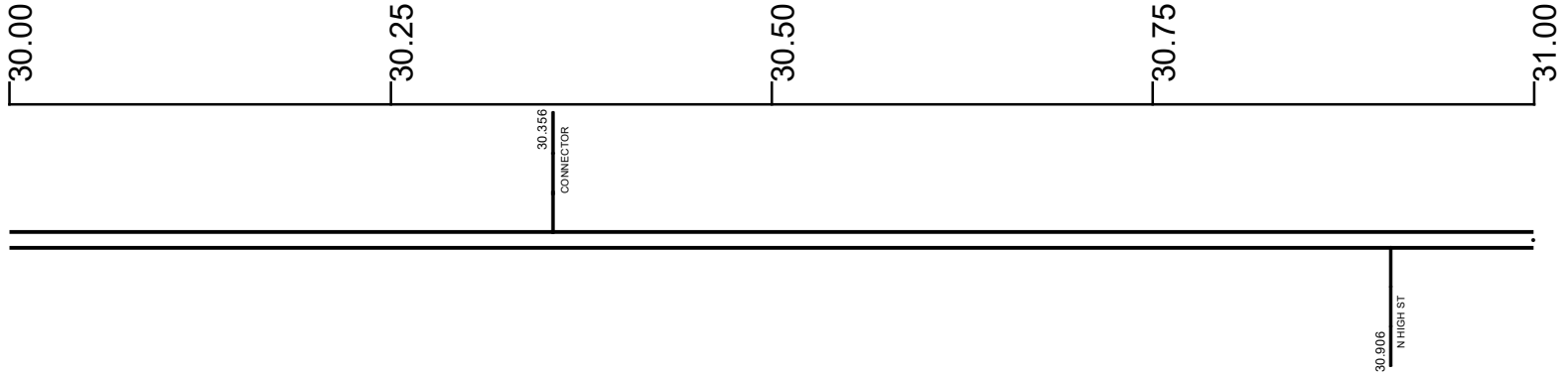

Surface Type & Width (Left / Right)

G 48'  
27.919 - 31.145

Base Type (Left / Right)

P  
20.631 - 31.145

Shoulder Type & Width (Left / Right)

5 (12'/12')  
27.919 - 31.145

Median Type and Width

2 ( 52' )  
27.919 - 31.145

Through Lanes

4  
17.51 - 31.145

Street Name

US 33  
22.328 - 31.145

- Non-divided Highway
- Divided Highway
- Secondary Segment
- Corporation
- Bridge (on route)
- Underpass
- Overpass
- Railroad (at grade)
- Railroad (underpass)
- Railroad (overpass)
- Intersection

Created on: 6/23/2025

transportation.ohio.gov  
Prepared by  
The Ohio Department of Transportation  
Office of Technical Services  
Roadway Information

# SFRAUS00033\*\*C

State True Log

137.388

County True Log

31.00

31.25

31.50

31.75

32.00

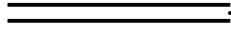

Surface Type & Width (Left / Right)

G 48'  
27.919 - 31.145

Base Type (Left / Right)

P  
20.631 - 31.145

Shoulder Type & Width (Left / Right)

5 (12'/12')  
27.919 - 31.145

Median Type and Width

2 ( 52' )  
27.919 - 31.145

Through Lanes

4  
17.51 - 31.145

Street Name

US 33  
22.328 - 31.145

- Non-divided Highway
- Divided Highway
- Secondary Segment
- Corporation
- Bridge (on route)
- Underpass
- Overpass
- Railroad (at grade)
- Railroad (underpass)
- Railroad (overpass)
- Intersection

Created on: 6/23/2025

transportation.ohio.gov  
Prepared by  
The Ohio Department of Transportation  
Office of Technical Services  
Roadway Information

## Historical Project List for SFRAUS00033\*\*C

Begin Measure	End Measure	Project ID Number	Construction Completion Date	Treatment Category	Treatment Type
0.000	0.992	94145	5-2018	Minor Rehabilitation	50-AC Overlay w/o Rpr
0.769	3.103	88310	11-2019	Minor Rehabilitation	60-AC Overlay w/Rpr
3.889	4.257	25808	8-2011	Minor Rehabilitation	60-AC Overlay w/Rpr
4.257	11.340	25593	7-2007	Minor Rehabilitation	60-AC Overlay w/Rpr
4.338	4.348	107773	10-2020	Minor Rehabilitation	50-AC Overlay w/o Rpr
4.348	4.418	107773	10-2020	Minor Rehabilitation	50-AC Overlay w/o Rpr
4.418	4.848	107773	10-2020	Minor Rehabilitation	50-AC Overlay w/o Rpr
4.848	8.736	107773	10-2020	Minor Rehabilitation	60-AC Overlay w/Rpr
8.736	9.146	101097	4-2020	New Construction	200-New Pavement
9.146	9.306	101097	4-2020	Minor Rehabilitation	50-AC Overlay w/o Rpr
9.306	11.330	93136	10-2019	Minor Rehabilitation	50-AC Overlay w/o Rpr
11.340	12.583	79318	11-2012	Minor Rehabilitation	60-AC Overlay w/Rpr
12.583	14.296	79316	5-2013	Minor Rehabilitation	60-AC Overlay w/Rpr
14.296	16.258	86651	9-2019	Minor Rehabilitation	50-AC Overlay w/o Rpr
17.944	18.795	86311	4-2013	Major Rehabilitation	100-New Flexible Pvmt
20.631	21.820	24653	9-2006	Minor Rehabilitation	60-AC Overlay w/Rpr
21.820	26.067	24653	9-2006	Minor Rehabilitation	60-AC Overlay w/Rpr
22.850	24.188	112584	8-2023	Minor Rehabilitation	60-AC Overlay w/Rpr
24.188	26.092	98111	7-2020	Minor Rehabilitation	60-AC Overlay w/Rpr
26.067	31.145	79662	12-2016	Minor Rehabilitation	60-AC Overlay w/Rpr
29.990	30.199	76689	11-2004	Minor Rehabilitation	60-AC Overlay w/Rpr

# Roadway Codes

## Access Control Journalized

- F - Full Access Control
- L - Limited Access Control
- N - No Access Control

## Access Control Operational

- 1 - Full Access Control
- 2 - Partial Access Control
- 3 - No Access Control

## Base Type

- F - Crack and Seat
- H - Rubblize and Roll
- I - Aggregate Base 304 or Traffic Compacted
- K - Water Bound Macadam
- L - Bituminous Concrete Mix or Penetration Macadam
- N - Plain Concrete
- P - Reinforced Concrete
- R - Brick (Flexible)
- T - Brick (Rigid)

## Direction of Travel

- B - Both (Two-way)
- F - One-way Cardinal
- T - One-way Non-cardinal

## Facility Type

- 1 - One-way Roadway
- 2 - Two-way Roadway
- 4 - Ramp
- 5 - Non-mainline
- 6 - Non-inventory Direction
- 7 - Planned / Unbuilt

## Historical Federal Aid Indicator

- N - Not a FAP Route
- Y - FAP Route

## Functional Classification

- 01 - Interstate
- 02 - Principal Arterial (Freeways)
- 03 - Principal Arterial (Other)
- 04 - Minor Arterial
- 05 - Major Collector
- 06 - Minor Collector
- 07 - Local

## Leave / Reenter Indicator

- Y - Route leaves/reenters at this point
- N - Route does not leave/reenter at this point

## Median Type

- 1 - None
- 2 - Unprotected
- 3 - Curbed
- 4 - Positive Barrier (Unspecified)
- 5 - Positive Barrier (Flexible)
- 6 - Positive Barrier (Semi-rigid)
- 7 - Positive Barrier (Rigid)

## NHS

- N - National Highway System
- H - Congressional Corridor
- 2 - Major Airport
- 3 - Major Port Facility
- 4 - Major Amtrak Station
- 5 - Major Rail / Truck Terminal
- 6 - Major Intercity Bus Terminal
- 7 - Major Public Transit / Multi-modal Passenger Terminal
- 8 - Major Pipeline Terminal
- 9 - Major Ferry Terminal

## Priority System

- G - General
- P - Priority System
- U - Urban

## Scenic Byway Code

- A - All American Road
- N - National Scenic Byway
- S - State Scenic Byway

## Shoulder Type

- 1 - None
- 2 - Surfaced shoulder exists (bituminous concrete {AC})
- 3 - Surfaced shoulder exists (Portland Cement Concrete {PCC})
- 4 - Stabilized shoulder exists (gravel or other granular material)
- 5 - Combination shoulder exists (two or more surface types)
- 6 - Earth shoulder exists
- 7 - Barrier curb exists; no shoulder in front of curb

## Surface Type

- A - Combination
- B - Brick
- C - Continuous Reinforced Concrete
- D - Reinforced Concrete
- E - Plain Concrete
- G - Bituminous Concrete
- I - Chipseal on Granular
- K - Open Graded Bituminous
- L - Chipseal or Micro
- M - Gravel
- U - Unimproved
- X - Right of Way Only