

SGALSR00775**C

State True Log 23.959

24.959

County True Log

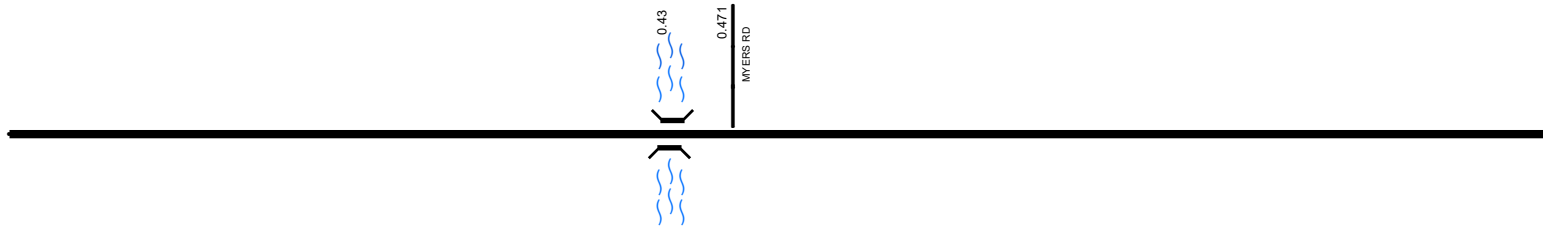

Surface Type & Width (Left / Right)

G 20'
0 - 3.749

Base Type (Left / Right)

I
0 - 3.148

Shoulder Type & Width (Left / Right)

4 (0/0)
0 - 3.749

Resurface Year

2023
0 - 11.372

Through Lanes

2
0 - 11.372

Street Name

SR 775
0 - 11.372

- | | | | |
|---------------------|-------------------|----------------------|--------------|
| Non-divided Highway | Bridge (on route) | Railroad (at grade) | Intersection |
| Divided Highway | Underpass | Railroad (underpass) | |
| Secondary Segment | Overpass | Railroad (overpass) | |
| Corporation | | | |

Created on: 6/27/2025

transportation.ohio.gov

Prepared by
The Ohio Department of Transportation
Office of Technical Services
Roadway Information

SGALSR00775**C

State True Log

25.959

County True Log

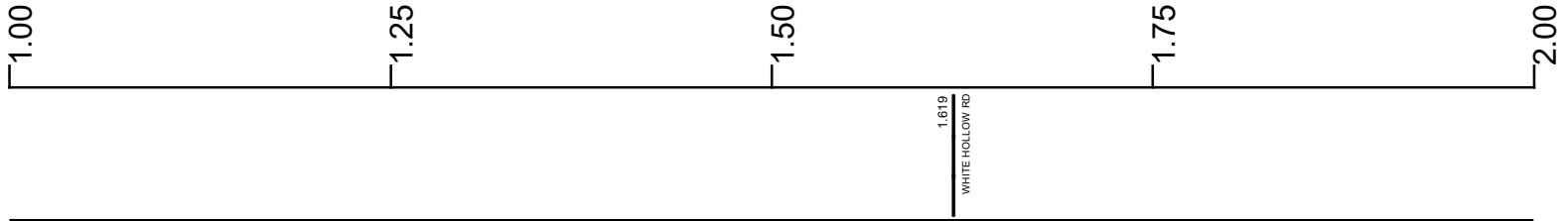

Surface Type & Width (Left / Right)

G 20'
0 - 3.749

Base Type (Left / Right)

I
0 - 3.148

Shoulder Type & Width (Left / Right)

4 (0/0)
0 - 3.749

Resurface Year

2023
0 - 11.372

Through Lanes

2
0 - 11.372

Street Name

SR 775
0 - 11.372

- Non-divided Highway
 Bridge (on route)
 Railroad (at grade)
 Intersection
- Divided Highway
 Underpass
 Railroad (underpass)
- Secondary Segment
 Overpass
 Railroad (overpass)
- Corporation**

Created on: 6/27/2025



transportation.ohio.gov

Prepared by
The Ohio Department of Transportation
Office of Technical Services
Roadway Information

SGALSR00775**C

State True Log

26.959

County True Log

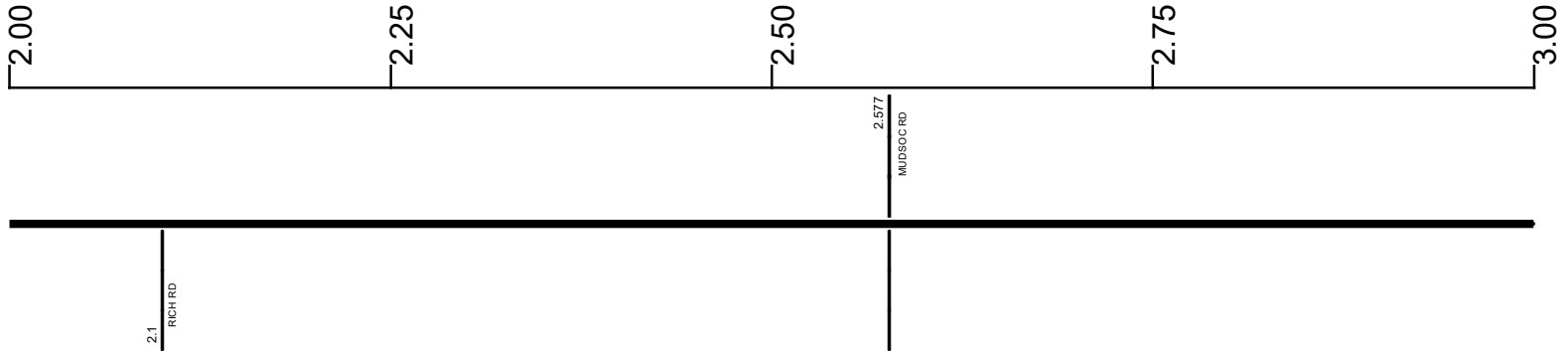

Surface Type & Width (Left / Right)

G 20'
0 - 3.749

Base Type (Left / Right)

I
0 - 3.148

Shoulder Type & Width (Left / Right)

4 (0/0)
0 - 3.749

Resurface Year

2023
0 - 11.372

Through Lanes

2
0 - 11.372

Street Name

SR 775
0 - 11.372

- Non-divided Highway
- Divided Highway
- Secondary Segment
- Corporation
- Bridge (on route)
- Underpass
- Overpass
- Railroad (at grade)
- Railroad (underpass)
- Railroad (overpass)
- Intersection

Created on: 6/27/2025

transportation.ohio.gov

Prepared by
The Ohio Department of Transportation
Office of Technical Services
Roadway Information

SGALSR00775**C

State True Log

27.959

County True Log

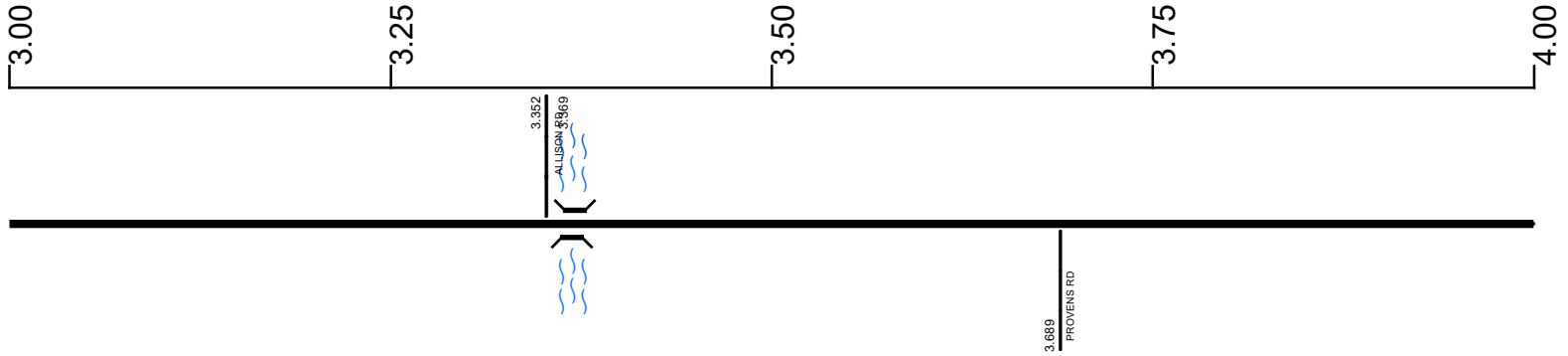

Surface Type & Width (Left / Right)

G 20'	G (10'/11')	G 20'
0 - 3.749	3.749 - 3.799	3.799 - 4.852

Base Type (Left / Right)

I	K	L K I
0 - 3.148	3.148 - 3.749	3.749 - 3.799 3.799 - 3.829 3.829 - 10.555

Shoulder Type & Width (Left / Right)

4 (0'/0')	2 (4'/4')	4 (0'/0')
0 - 3.749	3.749 - 3.799	3.799 - 4.852

Resurface Year

	2023	
--	------	--

Through Lanes

	2	
--	---	--

Street Name

	SR 775	
--	--------	--

0 - 11.372

Non-divided Highway	Bridge (on route)	Railroad (at grade)	Intersection
Divided Highway	Underpass	Railroad (underpass)	
Secondary Segment	Overpass	Railroad (overpass)	
Corporation			

Created on: 6/27/2025

transportation.ohio.gov

Prepared by
The Ohio Department of Transportation
Office of Technical Services
Roadway Information

SGALSR00775**C

State True Log

28.959

County True Log



4.257
MC COMBES RD

4.749
HANNAH TRACE RD

Surface Type & Width (Left / Right)	G 20' 3.799 - 4.852	G 18' 4.852 - 9.003
Base Type (Left / Right)	I 3.829 - 10.555	
Shoulder Type & Width (Left / Right)	4 (0'/0') 3.799 - 4.852	2 (2'/2') 4.852 - 9.003
Resurface Year	2023 0 - 11.372	
Through Lanes	2 0 - 11.372	
Street Name	SR 775 0 - 11.372	

Non-divided Highway	Bridge (on route)	Railroad (at grade)	Intersection
Divided Highway	Underpass	Railroad (underpass)	
Secondary Segment	Overpass	Railroad (overpass)	
Corporation			

Created on: 6/27/2025

transportation.ohio.gov

Prepared by
The Ohio Department of Transportation
Office of Technical Services
Roadway Information

SGALSR00775**C

State True Log

29.959

County True Log

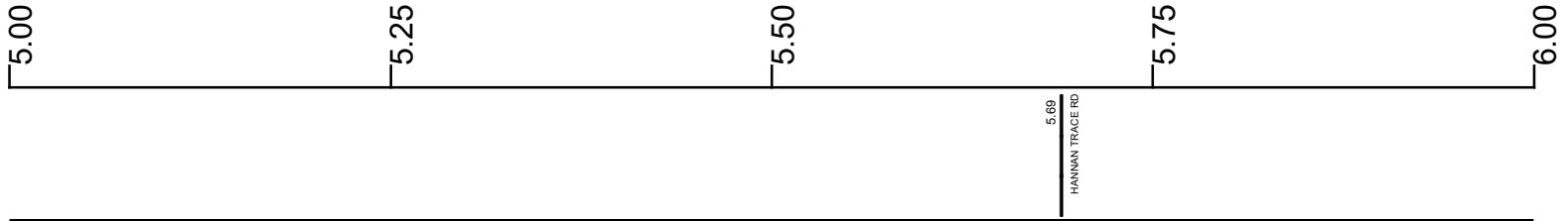

Surface Type & Width (Left / Right)

G 18'
4.852 - 9.003

Base Type (Left / Right)

I
3.829 - 10.555

Shoulder Type & Width (Left / Right)

2 (2'/2)
4.852 - 9.003

Resurface Year

2023

Through Lanes

0 - 11.372
2

Street Name

SR 775
0 - 11.372

- Non-divided Highway
 Bridge (on route)
 Railroad (at grade)
 Intersection
- Divided Highway
 Underpass
 Railroad (underpass)
- Secondary Segment
 Overpass
 Railroad (overpass)
- Corporation**

Created on: 6/27/2025



transportation.ohio.gov

Prepared by
The Ohio Department of Transportation
Office of Technical Services
Roadway Information

SGALSR00775**C

State True Log

30.959

County True Log



Surface Type & Width (Left / Right)	G 18' 4.852 - 9.003
Base Type (Left / Right)	I 3.829 - 10.555
Shoulder Type & Width (Left / Right)	2 (2'/2') 4.852 - 9.003
Resurface Year	2023
Through Lanes	0 - 11.372
	2 0 - 11.372
Street Name	SR 775 0 - 11.372

Non-divided Highway	Bridge (on route)	Railroad (at grade)	Intersection
Divided Highway	Underpass	Railroad (underpass)	
Secondary Segment	Overpass	Railroad (overpass)	
Corporation			

Created on: 6/27/2025

transportation.ohio.gov

Prepared by
The Ohio Department of Transportation
Office of Technical Services
Roadway Information

SGALSR00775**C

State True Log

31.959

County True Log

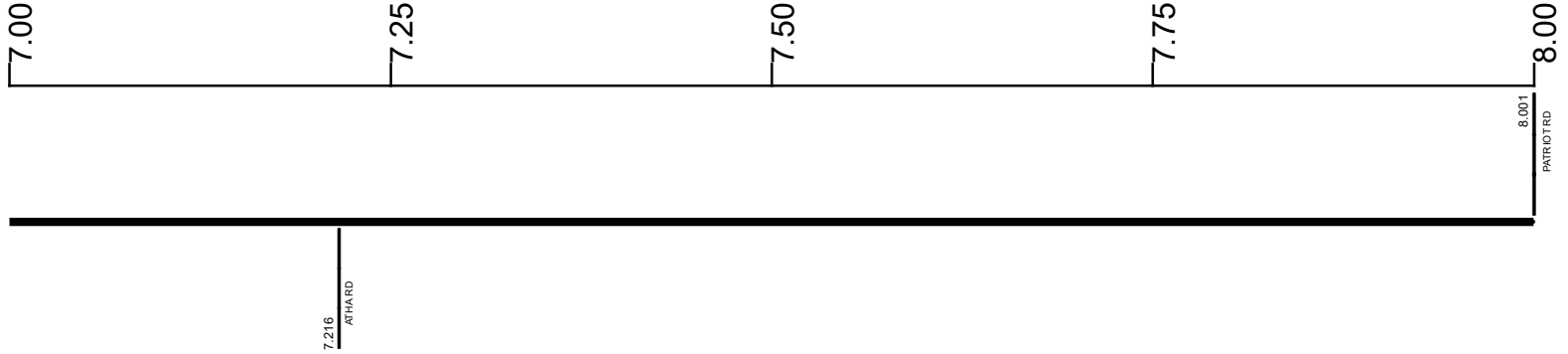

Surface Type & Width (Left / Right)

G 18'
4.852 - 9.003

Base Type (Left / Right)

I
3.829 - 10.555

Shoulder Type & Width (Left / Right)

2 (2/2)
4.852 - 9.003

Resurface Year

2023

Through Lanes

2
0 - 11.372

Street Name

SR 775
0 - 11.372

- Non-divided Highway
 Bridge (on route)
 Railroad (at grade)
 Intersection
- Divided Highway
 Underpass
 Railroad (underpass)
- Secondary Segment
 Overpass
 Railroad (overpass)
- Corporation**

Created on: 6/27/2025



transportation.ohio.gov

Prepared by
The Ohio Department of Transportation
Office of Technical Services
Roadway Information

SGALSR00775**C

State True Log

32.959

County True Log



Surface Type & Width (Left / Right)

G 18'
4.852 - 9.003

Base Type (Left / Right)

I
3.829 - 10.555

Shoulder Type & Width (Left / Right)

2 (2'/2')
4.852 - 9.003

Resurface Year

2023

Through Lanes

0 - 11.372
2

Street Name

SR 775
0 - 11.372

- Non-divided Highway
 Bridge (on route)
 Railroad (at grade)
 Intersection
- Divided Highway
 Underpass
 Railroad (underpass)
- Secondary Segment
 Overpass
 Railroad (overpass)
- Corporation**

Created on: 6/27/2025



transportation.ohio.gov

Prepared by
The Ohio Department of Transportation
Office of Technical Services
Roadway Information

SGALSR00775**C

State True Log

33.959

County True Log

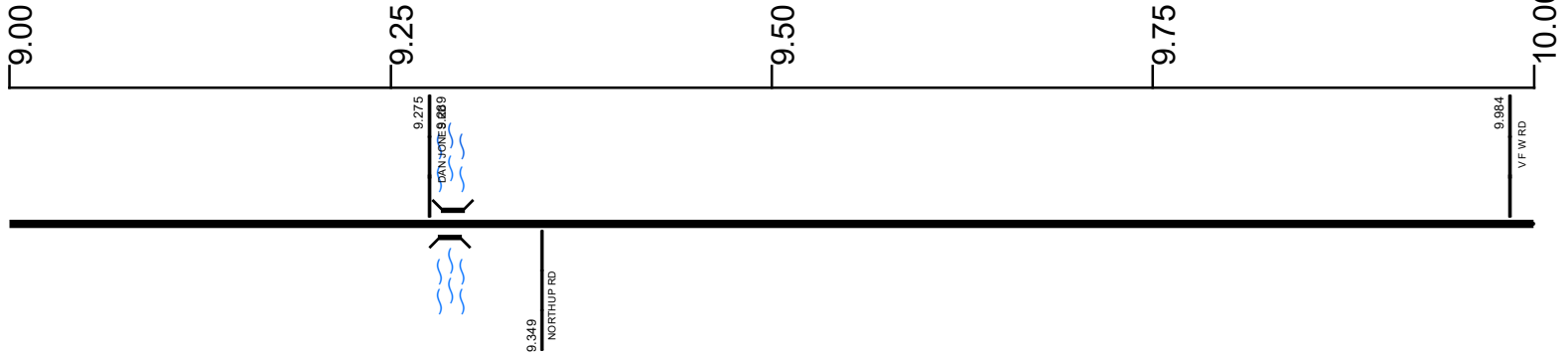

Surface Type & Width (Left / Right)

G 18'	G 20'	G 18'
9.003 - 9.349	9.349 - 10.555	

Base Type (Left / Right)

	I	
	3.829 - 10.555	

Shoulder Type & Width (Left / Right)

2 (2'/2')	2 (6'/6')	2 (2'/2')
4.852 - 9.003	9.003 - 9.349	9.349 - 10.555

Resurface Year

	2023	
	0 - 11.372	

Through Lanes

	2	
	0 - 11.372	

Street Name

	SR 775	
	0 - 11.372	

Non-divided Highway	Bridge (on route)	Railroad (at grade)	Intersection
Divided Highway	Underpass	Railroad (underpass)	
Secondary Segment	Overpass	Railroad (overpass)	
Corporation			

Created on: 6/27/2025

transportation.ohio.gov

Prepared by
The Ohio Department of Transportation
Office of Technical Services
Roadway Information

SGALSR00775**C

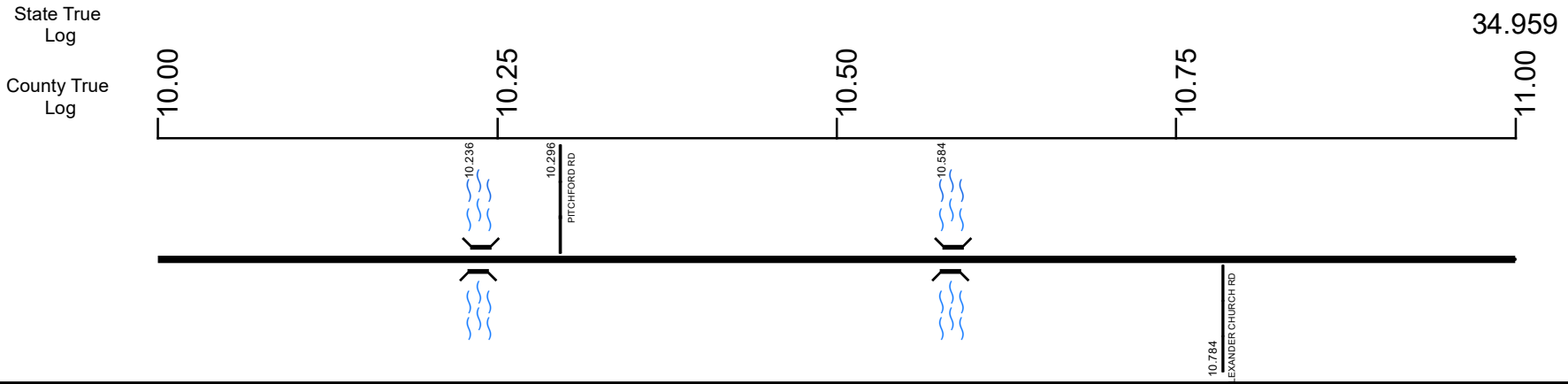

Surface Type & Width (Left / Right)

G 18'	G 20'	G 18'	G 20'	G 18'	G 20'	G 18'
9.349 - 10.555	10.555 - 10.594	10.594 - 10.803	10.833 - 10.894	10.945 - 11.372		

Base Type (Left / Right)

I	L	I	L	I	L	I
3.829 - 10.555	10.555 - 10.594	10.594 - 10.803	10.833 - 10.894	10.945 - 11.372		

Shoulder Type & Width (Left / Right)

2 (2/2')	2 (4/4')	2 (2/2')	2 (4/4')	2 (2/2')	2 (4/4')	2 (2/2')
9.349 - 10.555	10.555 - 10.594	10.594 - 10.803	10.833 - 10.894	10.945 - 11.372		

Resurface Year

2023	0 - 11.372
------	------------

Through Lanes

2	0 - 11.372
---	------------

Street Name

SR 775	0 - 11.372
--------	------------

- Non-divided Highway
- Divided Highway
- Secondary Segment
- Corporation
- Bridge (on route)
- Underpass
- Overpass
- Railroad (at grade)
- Railroad (underpass)
- Railroad (overpass)
- Intersection

Created on: 6/27/2025

transportation.ohio.gov

Prepared by
The Ohio Department of Transportation
Office of Technical Services
Roadway Information

SGALSR00775**C

State True Log

35.331

County True Log

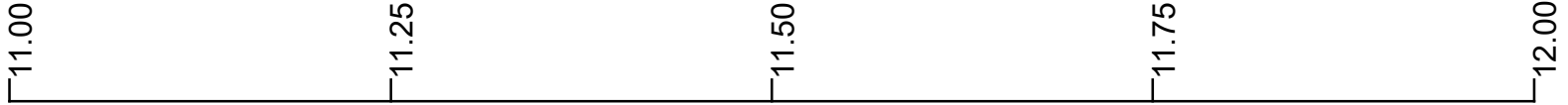

Surface Type & Width (Left / Right)

G 18'
10.945 - 11.372

Base Type (Left / Right)

I
10.945 - 11.372

Shoulder Type & Width (Left / Right)

2 (2 1/2)
10.945 - 11.372

Resurface Year

2023
0 - 11.372

Through Lanes

2
0 - 11.372

Street Name

SR 775
0 - 11.372

- | | | | |
|---------------------|-------------------|----------------------|--------------|
| Non-divided Highway | Bridge (on route) | Railroad (at grade) | Intersection |
| Divided Highway | Underpass | Railroad (underpass) | |
| Secondary Segment | Overpass | Railroad (overpass) | |
| Corporation | | | |

Created on: 6/27/2025



transportation.ohio.gov
 Prepared by
 The Ohio Department of Transportation
 Office of Technical Services
 Roadway Information

Historical Project List for SGALSR00775**C

Begin Measure	End Measure	Project ID Number	Construction Completion Date	Treatment Category	Treatment Type
0.000	11.372	102592	10-2023	Minor Rehabilitation	60-AC Overlay w/Rpr
0.000	4.850	24890	7-2009	Minor Rehabilitation	50-AC Overlay w/o Rpr
4.750	11.372	82863	5-2012	Minor Rehabilitation	50-AC Overlay w/o Rpr

Roadway Codes

Access Control Journalized

- F - Full Access Control
- L - Limited Access Control
- N - No Access Control

Access Control Operational

- 1 - Full Access Control
- 2 - Partial Access Control
- 3 - No Access Control

Base Type

- F - Crack and Seat
- H - Rubblize and Roll
- I - Aggregate Base 304 or Traffic Compacted
- K - Water Bound Macadam
- L - Bituminous Concrete Mix or Penetration Macadam
- N - Plain Concrete
- P - Reinforced Concrete
- R - Brick (Flexible)
- T - Brick (Rigid)

Direction of Travel

- B - Both (Two-way)
- F - One-way Cardinal
- T - One-way Non-cardinal

Facility Type

- 1 - One-way Roadway
- 2 - Two-way Roadway
- 4 - Ramp
- 5 - Non-mainline
- 6 - Non-inventory Direction
- 7 - Planned / Unbuilt

Historical Federal Aid Indicator

- N - Not a FAP Route
- Y - FAP Route

Functional Classification

- 01 - Interstate
- 02 - Principal Arterial (Freeways)
- 03 - Principal Arterial (Other)
- 04 - Minor Arterial
- 05 - Major Collector
- 06 - Minor Collector
- 07 - Local

Leave / Reenter Indicator

- Y - Route leaves/reenters at this point
- N - Route does not leave/reenter at this point

Median Type

- 1 - None
- 2 - Unprotected
- 3 - Curbed
- 4 - Positive Barrier (Unspecified)
- 5 - Positive Barrier (Flexible)
- 6 - Positive Barrier (Semi-rigid)
- 7 - Positive Barrier (Rigid)

NHS

- N - National Highway System
- H - Congressional Corridor
- 2 - Major Airport
- 3 - Major Port Facility
- 4 - Major Amtrak Station
- 5 - Major Rail / Truck Terminal
- 6 - Major Intercity Bus Terminal
- 7 - Major Public Transit / Multi-modal Passenger Terminal
- 8 - Major Pipeline Terminal
- 9 - Major Ferry Terminal

Priority System

- G - General
- P - Priority System
- U - Urban

Scenic Byway Code

- A - All American Road
- N - National Scenic Byway
- S - State Scenic Byway

Shoulder Type

- 1 - None
- 2 - Surfaced shoulder exists (bituminous concrete {AC})
- 3 - Surfaced shoulder exists (Portland Cement Concrete {PCC})
- 4 - Stabilized shoulder exists (gravel or other granular material)
- 5 - Combination shoulder exists (two or more surface types)
- 6 - Earth shoulder exists
- 7 - Barrier curb exists; no shoulder in front of curb

Surface Type

- A - Combination
- B - Brick
- C - Continuous Reinforced Concrete
- D - Reinforced Concrete
- E - Plain Concrete
- G - Bituminous Concrete
- I - Chipseal on Granular
- K - Open Graded Bituminous
- L - Chipseal or Micro
- M - Gravel
- U - Unimproved
- X - Right of Way Only