

SGEASR00087**C

State True Log 17.298

18.298

County True Log

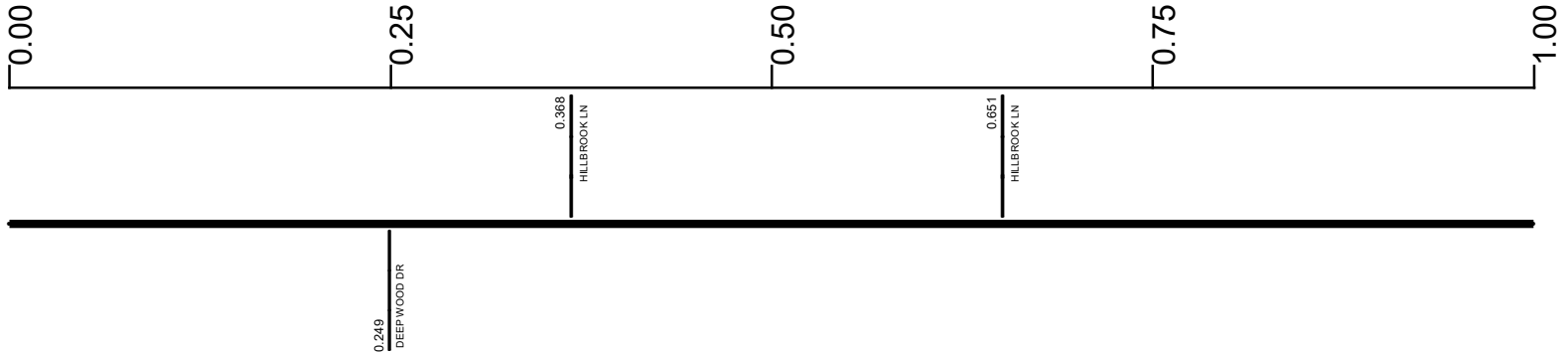

Surface Type & Width (Left / Right)

G 24'
0 - 2.73

Base Type (Left / Right)

K / L
0 - 3.784

Shoulder Type & Width (Left / Right)

2 (2'/2)
0 - 2.73

Resurface Year

2024
0 - 2.73

Through Lanes

2
0 - 17.047

Street Name

KINSMAN RD
0 - 12.576

- | | | | |
|---------------------|-------------------|----------------------|--------------|
| Non-divided Highway | Bridge (on route) | Railroad (at grade) | Intersection |
| Divided Highway | Underpass | Railroad (underpass) | |
| Secondary Segment | Overpass | Railroad (overpass) | |
| Corporation | | | |

Created on: 6/27/2025

transportation.ohio.gov

Prepared by
The Ohio Department of Transportation
Office of Technical Services
Roadway Information

SGEASR00087**C

State True Log

19.298

County True Log

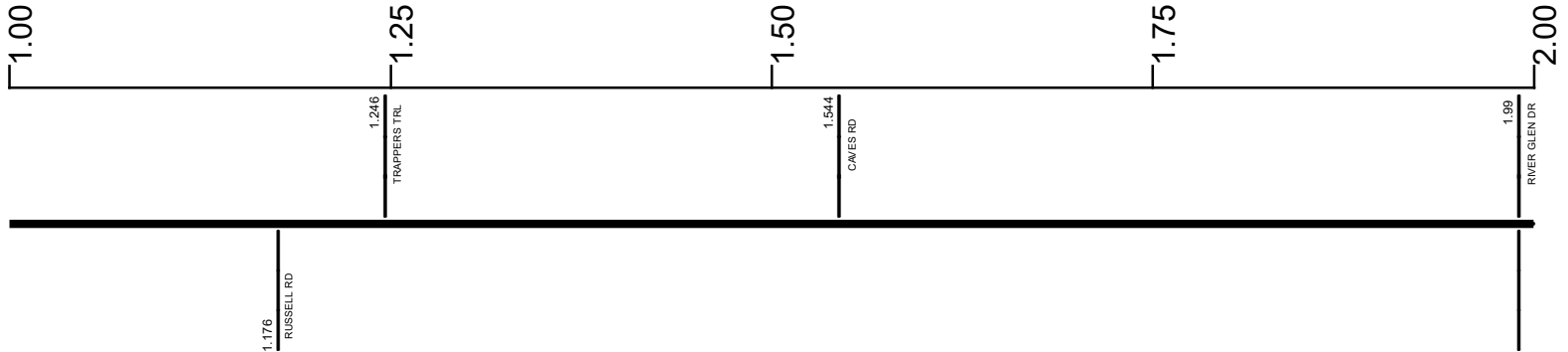

Surface Type & Width (Left / Right)

G 24'
0 - 2.73

Base Type (Left / Right)

K / L
0 - 3.784

Shoulder Type & Width (Left / Right)

2 (2'/2')
0 - 2.73

Resurface Year

2024
0 - 2.73

Through Lanes

2
0 - 17.047

Street Name

KINSMAN RD
0 - 12.576

- | | | | |
|---------------------|-------------------|----------------------|--------------|
| Non-divided Highway | Bridge (on route) | Railroad (at grade) | Intersection |
| Divided Highway | Underpass | Railroad (underpass) | |
| Secondary Segment | Overpass | Railroad (overpass) | |
| Corporation | | | |

Created on: 6/27/2025

transportation.ohio.gov

Prepared by
The Ohio Department of Transportation
Office of Technical Services
Roadway Information

SGEASR00087**C

State True Log

20.298

County True Log

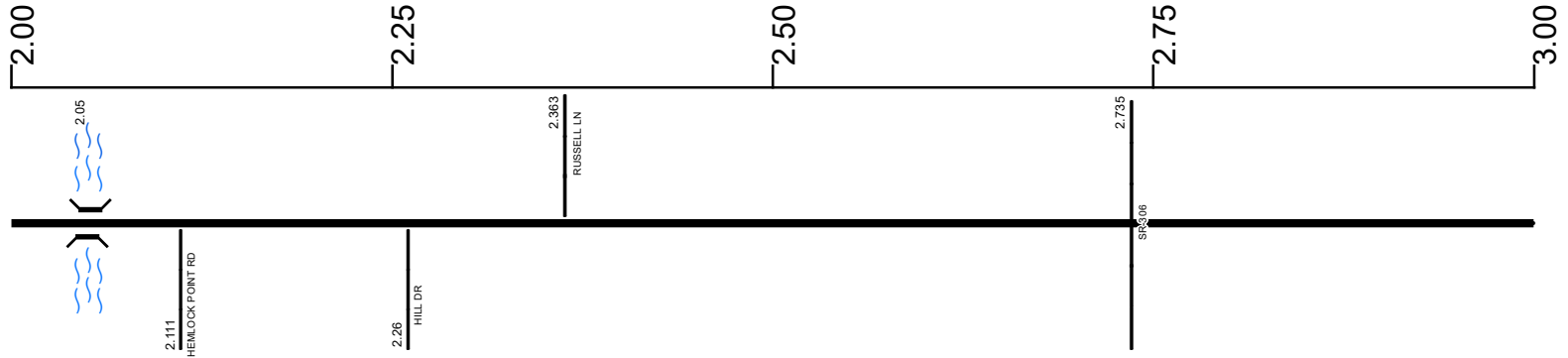

Surface Type & Width (Left / Right)

G 24'	G (16/6')
0 - 2.73	2.73 - 3.784

Base Type (Left / Right)

K / L	
0 - 3.784	

Shoulder Type & Width (Left / Right)

2 (2/2')	2 (3/3')
0 - 2.73	2.73 - 3.784

Resurface Year

2024	
0 - 2.73	

Through Lanes

2	
0 - 17.047	

Street Name

KINSMAN RD	
0 - 12.576	

- Non-divided Highway
- Divided Highway
- Secondary Segment
- Corporation
- Bridge (on route)
- Underpass
- Overpass
- Railroad (at grade)
- Railroad (underpass)
- Railroad (overpass)
- Intersection

Created on: 6/27/2025

transportation.ohio.gov

Prepared by
The Ohio Department of Transportation
Office of Technical Services
Roadway Information

SGEASR00087**C

State True Log

21.298

County True Log

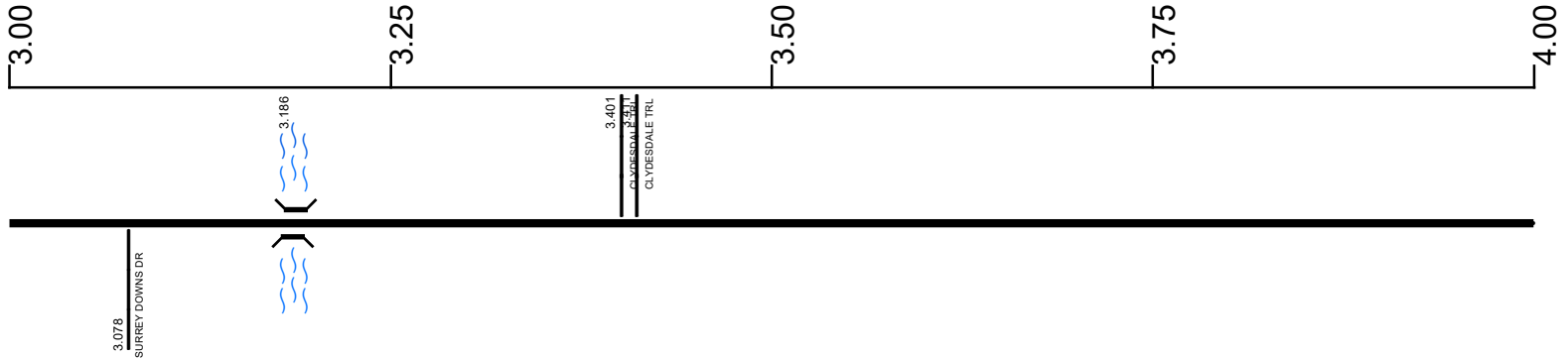

Surface Type & Width (Left / Right)

G (16'/6')	G 22'
2.73 - 3.784	3.784 - 4.288

Base Type (Left / Right)

K / L	L
0 - 3.784	3.784 - 4.288

Shoulder Type & Width (Left / Right)

2 (3'/3')	2 (6'/6')
2.73 - 3.784	3.784 - 10.496

Through Lanes

	2
	0 - 17.047

Street Name

	KINSMAN RD
	0 - 12.576

- Non-divided Highway
- Divided Highway
- Secondary Segment
- Corporation
- Bridge (on route)
- Underpass
- Overpass
- Railroad (at grade)
- Railroad (underpass)
- Railroad (overpass)
- Intersection

Created on: 6/27/2025

transportation.ohio.gov

Prepared by
The Ohio Department of Transportation
Office of Technical Services
Roadway Information

SGEASR00087**C

State True Log

22.298

County True Log

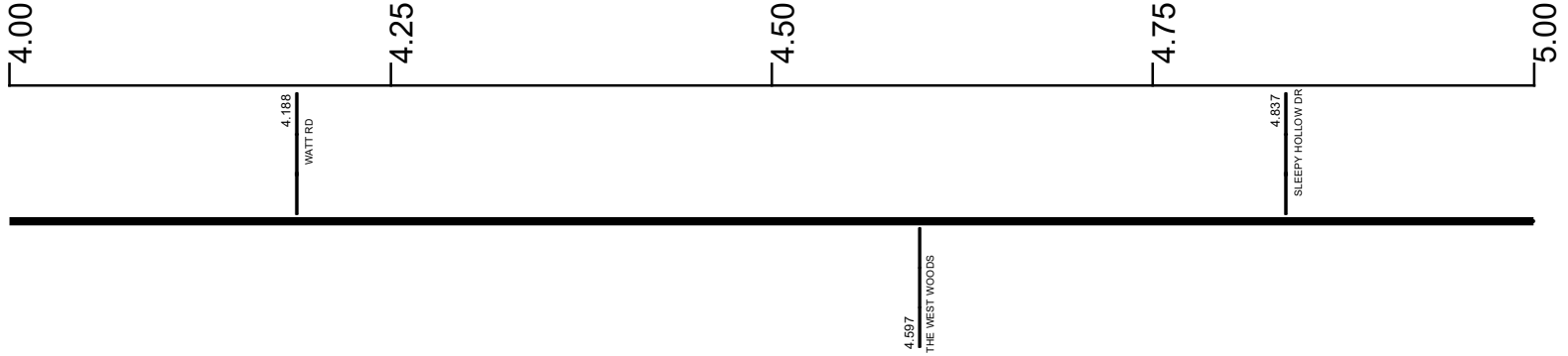

Surface Type & Width (Left / Right)

G 22' 3.784 - 4.288	G (16'6") 4.288 - 7.85
------------------------	---------------------------

Base Type (Left / Right)

L 3.784 - 4.288	K / L 4.288 - 8.592
--------------------	------------------------

Shoulder Type & Width (Left / Right)

2 (6'6") 3.784 - 10.496

Through Lanes

2 0 - 17.047

Street Name

KINSMAN RD 0 - 12.576

- | | | | |
|---------------------|-------------------|----------------------|--------------|
| Non-divided Highway | Bridge (on route) | Railroad (at grade) | Intersection |
| Divided Highway | Underpass | Railroad (underpass) | |
| Secondary Segment | Overpass | Railroad (overpass) | |
| Corporation | | | |

Created on: 6/27/2025

transportation.ohio.gov

Prepared by
The Ohio Department of Transportation
Office of Technical Services
Roadway Information

SGEASR00087**C

State True Log

23.298

County True Log

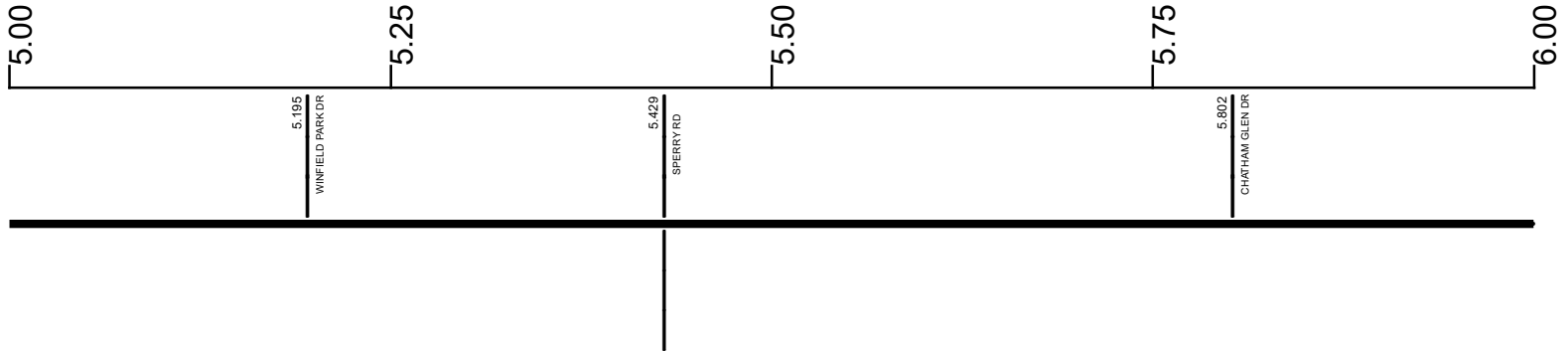

Surface Type & Width (Left / Right)

	G (16'/6')
	4.288 - 7.85

Base Type (Left / Right)

	K / L
	4.288 - 8.592

Shoulder Type & Width (Left / Right)

	2 (6'/6')
	3.784 - 10.496

Through Lanes

	2
	0 - 17.047

Street Name

	KINSMAN RD
	0 - 12.576

- | | | | |
|---------------------|-------------------|----------------------|--------------|
| Non-divided Highway | Bridge (on route) | Railroad (at grade) | Intersection |
| Divided Highway | Underpass | Railroad (underpass) | |
| Secondary Segment | Overpass | Railroad (overpass) | |
| Corporation | | | |

Created on: 6/27/2025

transportation.ohio.gov

Prepared by
The Ohio Department of Transportation
Office of Technical Services
Roadway Information

SGEASR00087**C

State True Log

24.298

County True Log

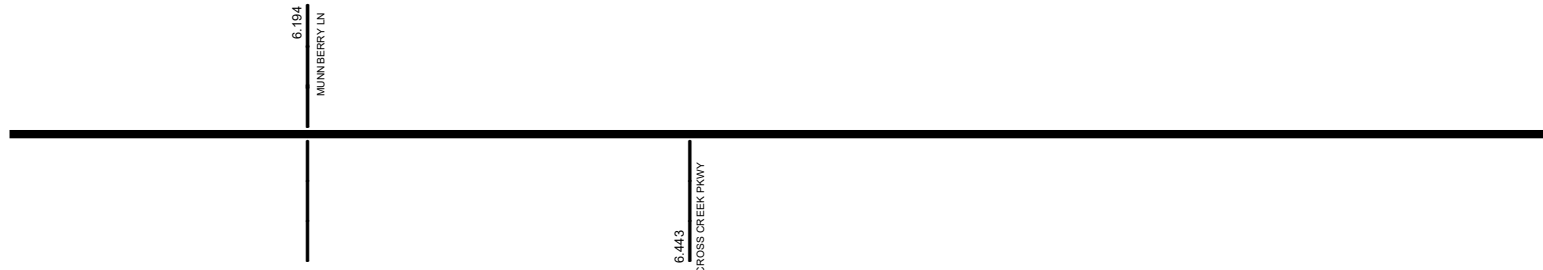

Surface Type & Width (Left / Right)

	G (16'/6')
	4.288 - 7.85

Base Type (Left / Right)

	K / L
	4.288 - 8.592

Shoulder Type & Width (Left / Right)

	2 (6'/6')
	3.784 - 10.496

Through Lanes

	2
	0 - 17.047

Street Name

	KINSMAN RD
	0 - 12.576

- | | | | |
|---------------------|-------------------|----------------------|--------------|
| Non-divided Highway | Bridge (on route) | Railroad (at grade) | Intersection |
| Divided Highway | Underpass | Railroad (underpass) | |
| Secondary Segment | Overpass | Railroad (overpass) | |
| Corporation | | | |

Created on: 6/27/2025

transportation.ohio.gov

Prepared by
The Ohio Department of Transportation
Office of Technical Services
Roadway Information

SGEASR00087**C

State True Log

25.298

County True Log

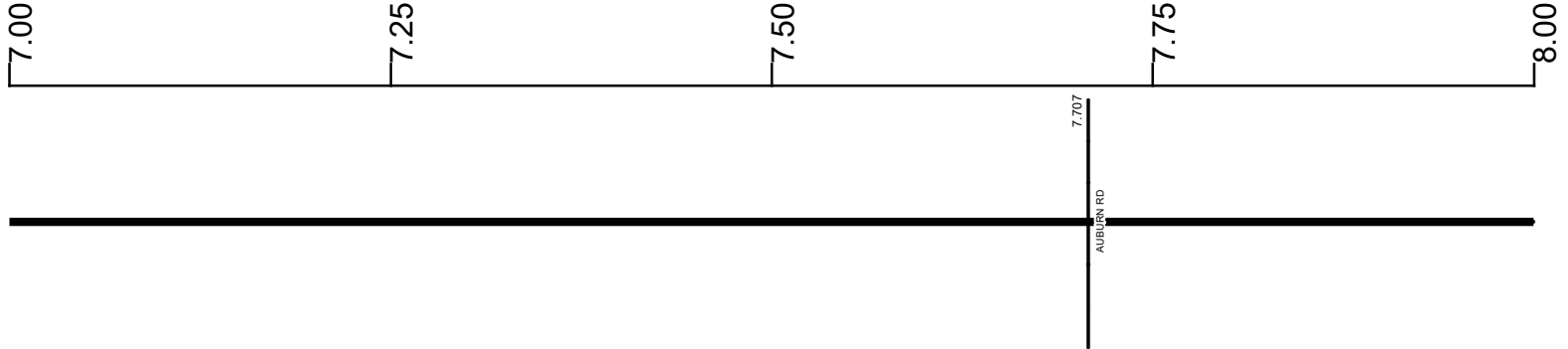

Surface Type & Width (Left / Right)

G (16'/6') 4.288 - 7.85	G 24' 7.85 - 13.013
----------------------------	------------------------

Base Type (Left / Right)

K / L 4.288 - 8.592	
------------------------	--

Shoulder Type & Width (Left / Right)

2 (6'/6') 3.784 - 10.496	
-----------------------------	--

Resurface Year

2023 7.85 - 12.576

Through Lanes

2 0 - 17.047

Street Name

KINSMAN RD 0 - 12.576

- Non-divided Highway
 Bridge (on route)
 Railroad (at grade)
 Intersection
- Divided Highway
 Underpass
 Railroad (underpass)
- Secondary Segment
 Overpass
 Railroad (overpass)
- Corporation**

Created on: 6/27/2025

transportation.ohio.gov

Prepared by
The Ohio Department of Transportation
Office of Technical Services
Roadway Information

SGEASR00087**C

State True Log

26.298

County True Log

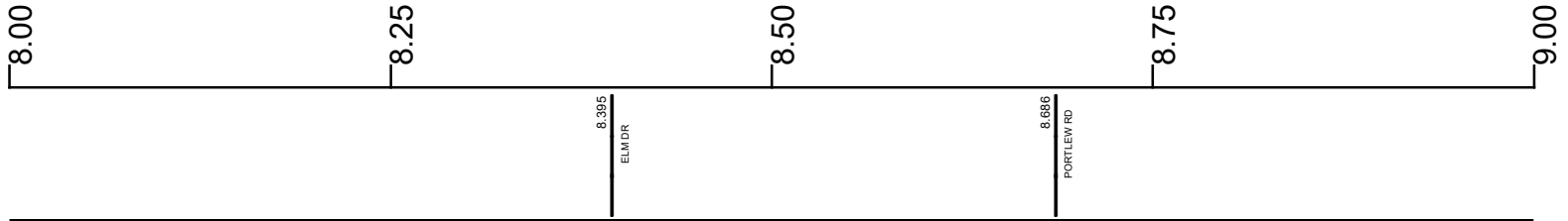

Surface Type & Width (Left / Right)

G 24'
7.85 - 13.013

Base Type (Left / Right)

K / L 4.288 - 8.592	L 8.592 - 9.902
------------------------	--------------------

Shoulder Type & Width (Left / Right)

2 (6/6)
3.784 - 10.496

Resurface Year

2023
7.85 - 12.576

Through Lanes

2
0 - 17.047

Street Name

KINSMAN RD
0 - 12.576

- | | | | |
|---------------------|-------------------|----------------------|--------------|
| Non-divided Highway | Bridge (on route) | Railroad (at grade) | Intersection |
| Divided Highway | Underpass | Railroad (underpass) | |
| Secondary Segment | Overpass | Railroad (overpass) | |
| Corporation | | | |

Created on: 6/27/2025

transportation.ohio.gov

Prepared by
The Ohio Department of Transportation
Office of Technical Services
Roadway Information

SGEASR00087**C

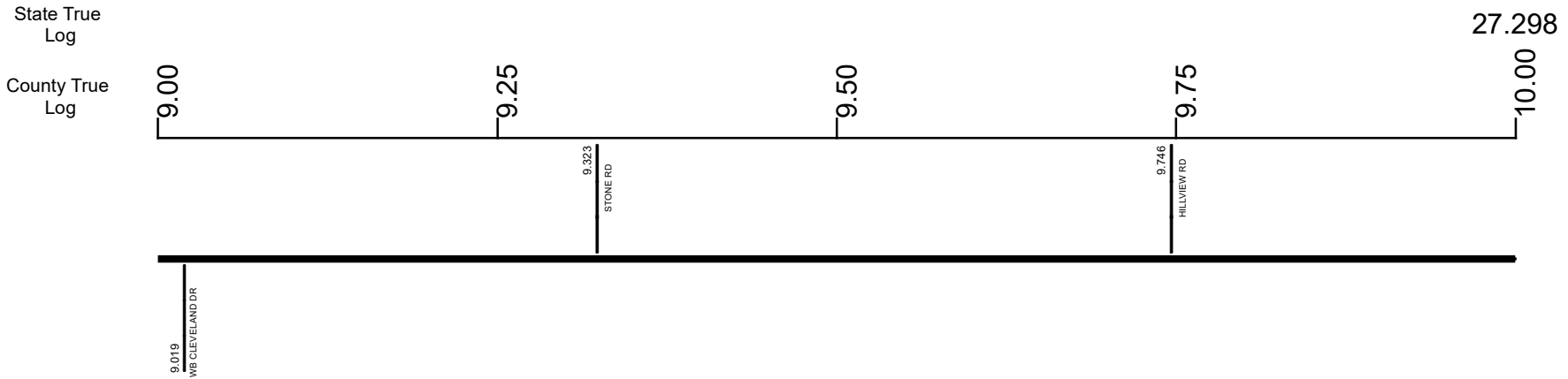

Surface Type & Width (Left / Right)	G 24'	
	7.85 - 13.013	
Base Type (Left / Right)	L	K / L
	8.592 - 9.902	9.902 - 11.271
Shoulder Type & Width (Left / Right)	2 (6/6')	
	3.784 - 10.496	
Resurface Year	2023	
	7.85 - 12.576	
Through Lanes	2	
	0 - 17.047	
Street Name	KINSMAN RD	
	0 - 12.576	

- Non-divided Highway
- Divided Highway
- Secondary Segment
- Corporation
- Bridge (on route)
- Underpass
- Overpass
- Railroad (at grade)
- Railroad (underpass)
- Railroad (overpass)
- Intersection

Created on: 6/27/2025

transportation.ohio.gov

Prepared by
The Ohio Department of Transportation
Office of Technical Services
Roadway Information

SGEASR00087**C

State True Log

28.298

County True Log

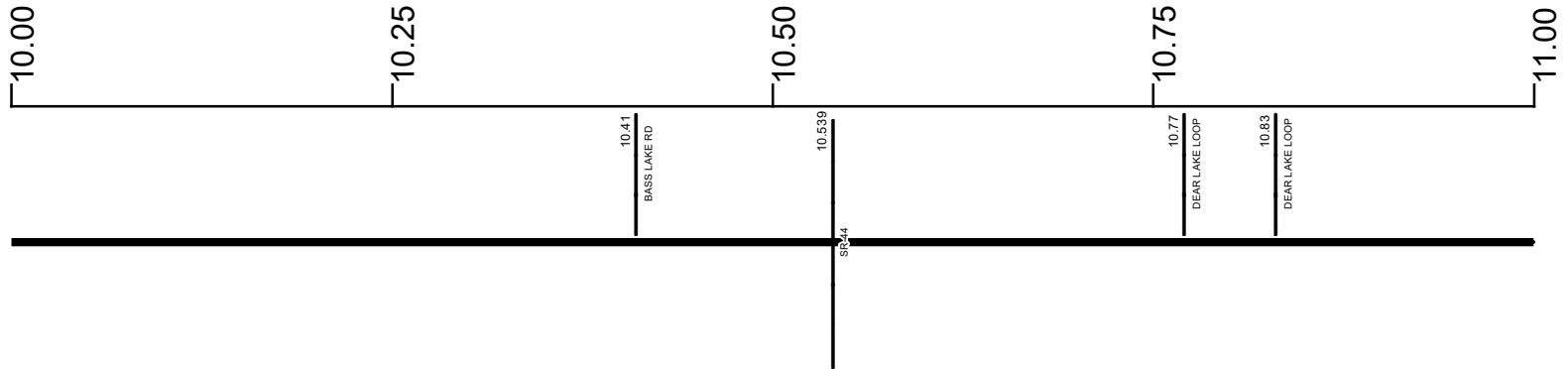

Surface Type & Width (Left / Right)

G 24'
7.85 - 13.013

Base Type (Left / Right)

K / L
9.902 - 11.271

Shoulder Type & Width (Left / Right)

2 (6'/6')	2 (4'/4')	2 (6'/6')
3.784 - 10.496	10.496 - 10.59	10.59 - 12.576

Resurface Year

2023
7.85 - 12.576

Through Lanes

2
0 - 17.047

Street Name

KINSMAN RD
0 - 12.576

- | | | | |
|---------------------|-------------------|----------------------|--------------|
| Non-divided Highway | Bridge (on route) | Railroad (at grade) | Intersection |
| Divided Highway | Underpass | Railroad (underpass) | |
| Secondary Segment | Overpass | Railroad (overpass) | |
| Corporation | | | |

Created on: 6/27/2025

transportation.ohio.gov

Prepared by
The Ohio Department of Transportation
Office of Technical Services
Roadway Information

SGEASR00087**C

State True Log

29.298

County True Log

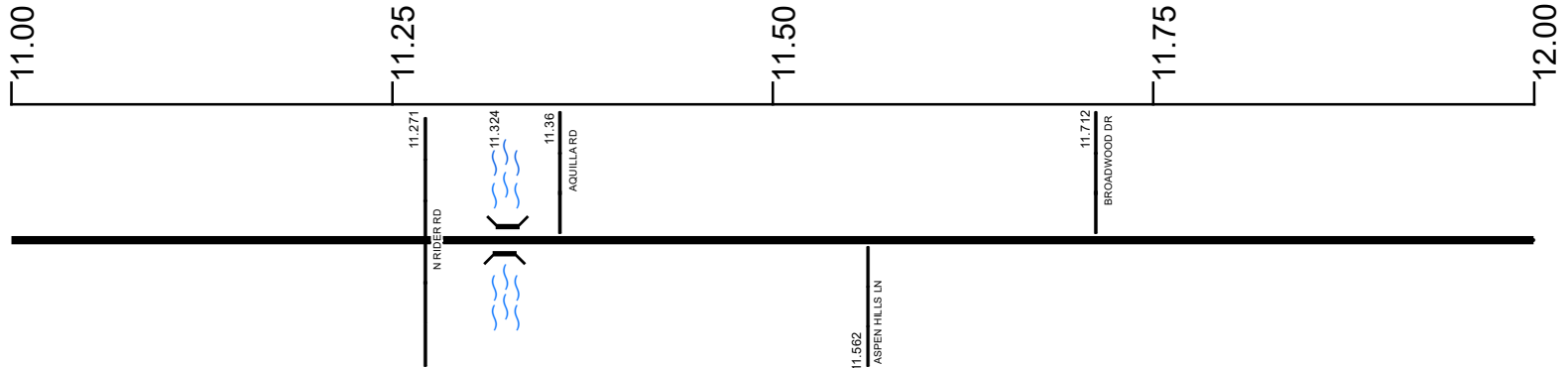

Surface Type & Width (Left / Right)

G 24'
7.85 - 13.013

Base Type (Left / Right)

K/L	L	K/L
9.902 - 11.271	11.271 - 11.501	11.501 - 12.576

Shoulder Type & Width (Left / Right)

2 (6/6)
10.59 - 12.576

Resurface Year

2023
7.85 - 12.576

Through Lanes

2
0 - 17.047

Street Name

KINSMAN RD
0 - 12.576

- | | | | |
|---------------------|-------------------|----------------------|--------------|
| Non-divided Highway | Bridge (on route) | Railroad (at grade) | Intersection |
| Divided Highway | Underpass | Railroad (underpass) | |
| Secondary Segment | Overpass | Railroad (overpass) | |
| Corporation | | | |

Created on: 6/27/2025

transportation.ohio.gov

Prepared by
The Ohio Department of Transportation
Office of Technical Services
Roadway Information

SGEASR00087**C

State True Log
County True Log

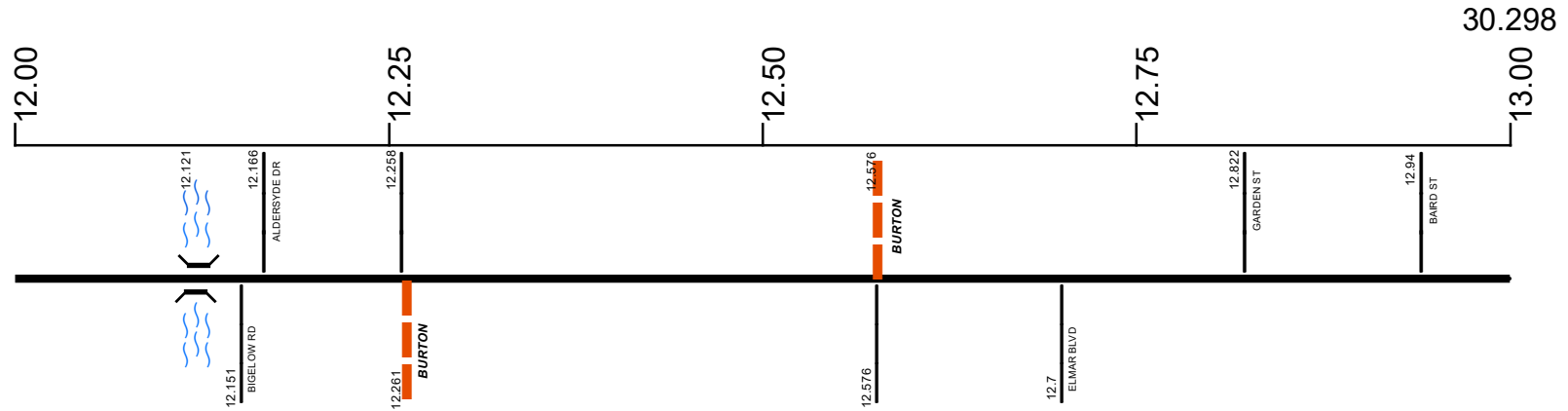

Surface Type & Width (Left / Right)

G 24'	
7.85 - 13.013	

Base Type (Left / Right)

K / L	P
11.501 - 12.576	12.576 - 13.568

Shoulder Type & Width (Left / Right)

2 (6'6")	1 (0'0")
10.59 - 12.576	12.576 - 13.568

Resurface Year

2023	2022
7.85 - 12.576	12.576 - 13.56

Through Lanes

2	
0 - 17.047	

Street Name

KINSMAN RD	W CENTER ST
0 - 12.576	12.576 - 13.013

- Non-divided Highway
- Divided Highway
- Secondary Segment
- Corporation
- Bridge (on route)
- Underpass
- Overpass
- Railroad (at grade)
- Railroad (underpass)
- Railroad (overpass)
- Intersection

Created on: 6/27/2025

transportation.ohio.gov

Prepared by
The Ohio Department of Transportation
Office of Technical Services
Roadway Information

SGEASR00087**C

State True Log

31.298

County True Log

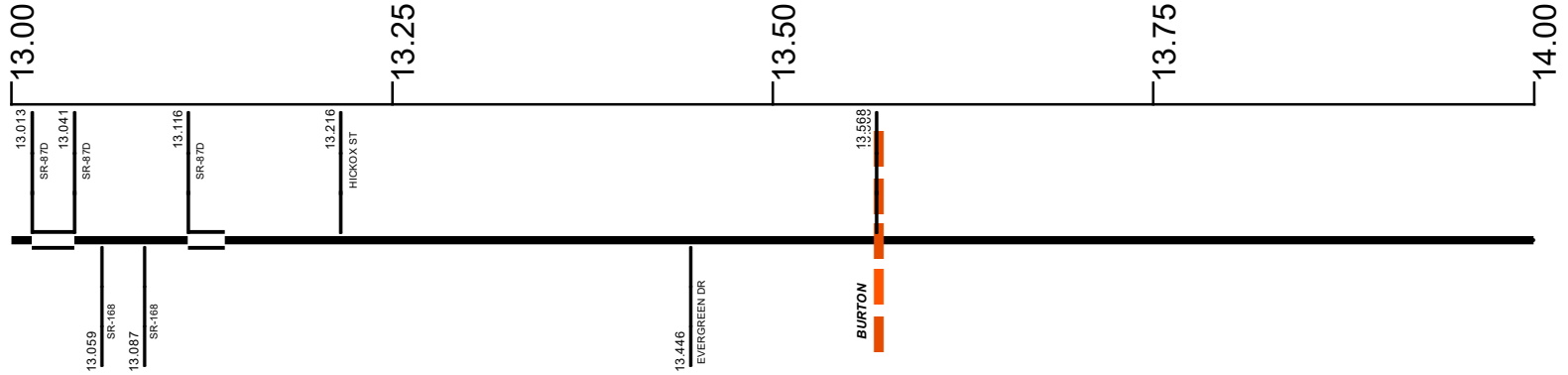

Surface Type & Width (Left / Right)

G 24' G (13'/14')	G 24'	G (18'/4')
13.013 - 13.116	13.116 - 13.568	13.568 - 14.183

Base Type (Left / Right)

P	P / L
12.576 - 13.568	13.568 - 14.183

Shoulder Type & Width (Left / Right)

1 (0'/0')	2 (6'/6')
12.576 - 13.568	13.568 - 14.425

Median Type and Width

3 (30')	3 (30')
13.013 - 13.041	13.116 - 13.14

Resurface Year

2022
12.576 - 13.56

Through Lanes

2
0 - 17.047

Street Name

E CENTER ST	E CENTER ST	KINSMAN RD
13.013 - 13.041	13.116 - 13.568	13.568 - 15.999

- Non-divided Highway
- Divided Highway
- Secondary Segment
- Corporation
- Bridge (on route)
- Underpass
- Overpass
- Railroad (at grade)
- Railroad (underpass)
- Railroad (overpass)
- Intersection

Created on: 6/27/2025

transportation.ohio.gov

Prepared by
The Ohio Department of Transportation
Office of Technical Services
Roadway Information

SGEASR00087**C

State True
Log

32.298

County True
Log

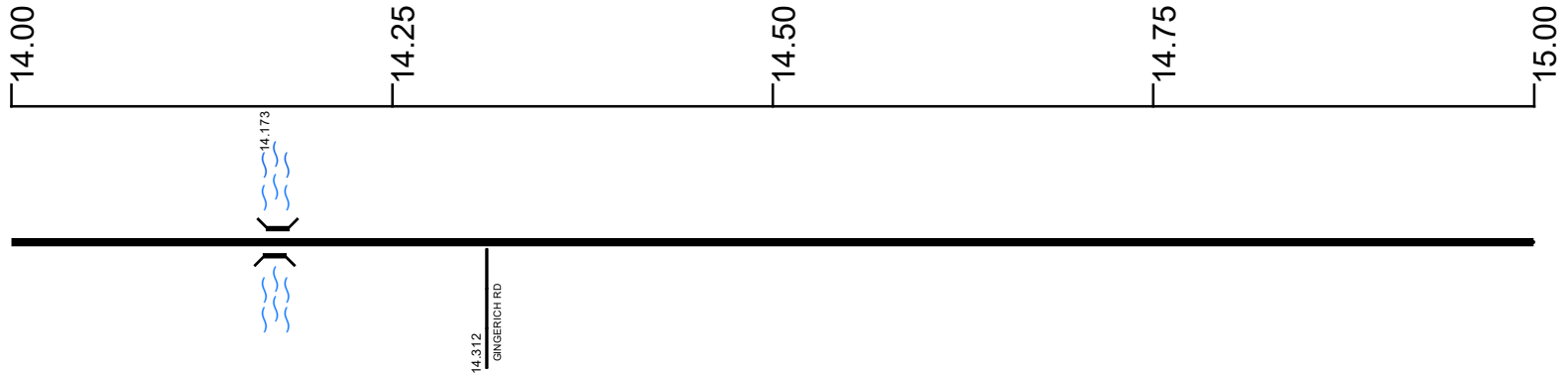

Surface Type & Width (Left / Right)

G (18'4")	G 22'	G (18'2")
13.568 - 14.183	14.183 - 14.425	14.425 - 16.032

Base Type (Left / Right)

P / L	K	P / I
13.568 - 14.183	14.183 - 14.425	14.425 - 16.032

Shoulder Type & Width (Left / Right)

2 (6'6")	2 (5'5")
13.568 - 14.425	14.425 - 16.032

Through Lanes

2
0 - 17.047

Street Name

KINSMAN RD
13.568 - 15.999

- Non-divided Highway
- Divided Highway
- Secondary Segment
- Corporation
- Bridge (on route)
- Underpass
- Overpass
- Railroad (at grade)
- Railroad (underpass)
- Railroad (overpass)
- Intersection

Created on: 6/27/2025

transportation.ohio.gov

Prepared by
The Ohio Department of Transportation
Office of Technical Services
Roadway Information

SGEASR00087**C

State True Log
County True Log

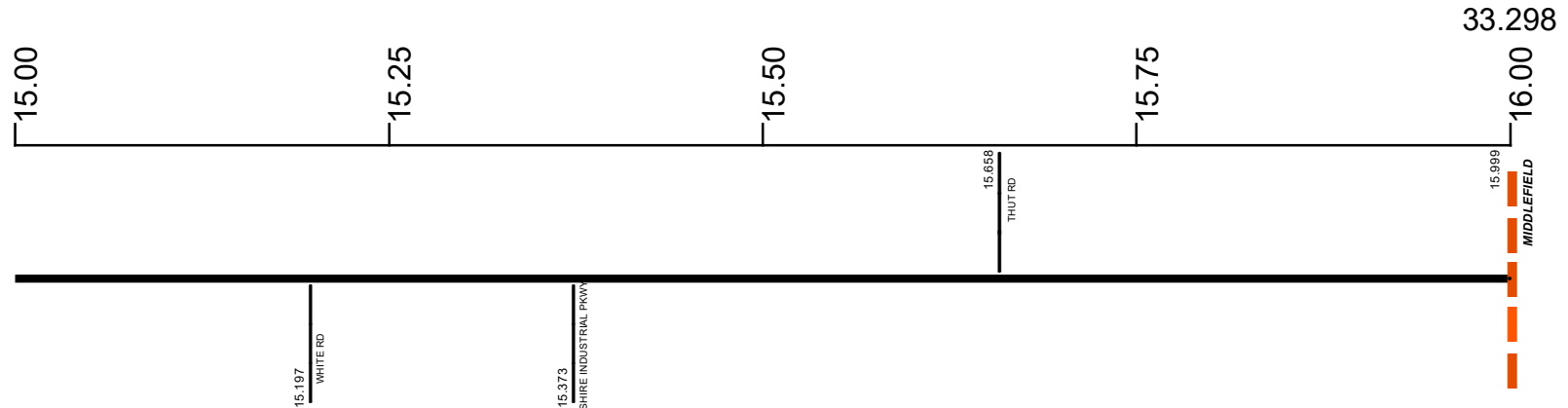

Surface Type & Width (Left / Right)	G (18/2')
	14.425 - 16.032
Base Type (Left / Right)	P / I
	14.425 - 16.032
Shoulder Type & Width (Left / Right)	2 (5/5)
	14.425 - 16.032
Through Lanes	2
	0 - 17.047
Street Name	KINSMAN RD
	13.568 - 15.999

Resurface Year
2022
15.93 - 20.684

- | | | | |
|---------------------|-------------------|----------------------|--------------|
| Non-divided Highway | Bridge (on route) | Railroad (at grade) | Intersection |
| Divided Highway | Underpass | Railroad (underpass) | |
| Secondary Segment | Overpass | Railroad (overpass) | |
| Corporation | | | |

Created on: 6/27/2025

transportation.ohio.gov

Prepared by
The Ohio Department of Transportation
Office of Technical Services
Roadway Information

SGEASR00087**C

State True Log

34.298

County True Log

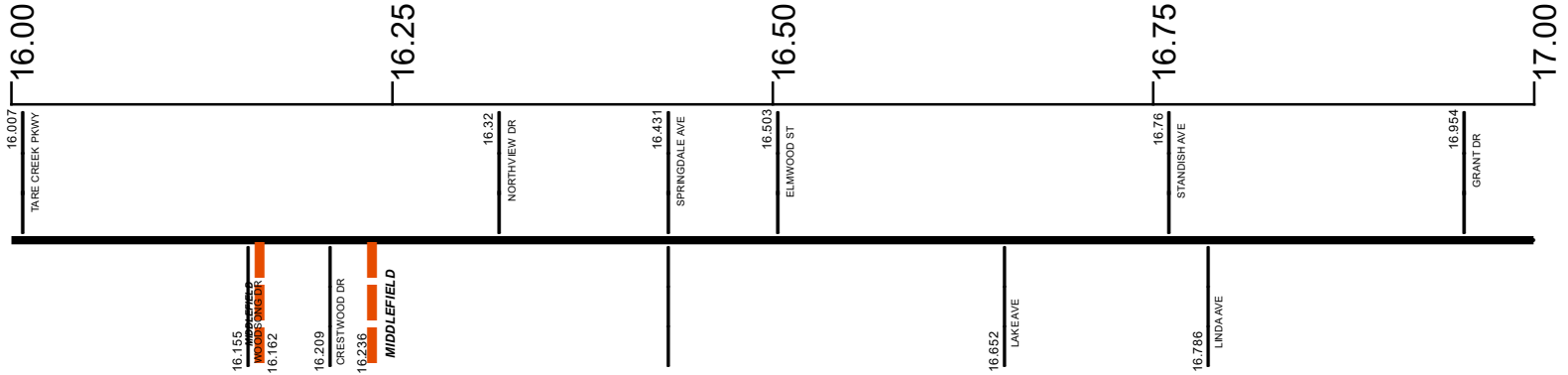

Surface Type & Width (Left / Right)

G (18'2")	G (18'6")	G (24'12")	G 24'
14.425 - 16.032	16.032 - 16.281	16.281 - 16.622	16.622 - 17.047

Base Type (Left / Right)

P / I	P / L	P	P
14.425 - 16.032	16.032 - 16.622	16.622 - 17.047	

Shoulder Type & Width (Left / Right)

2 (5'5")	2 (4'4")	1 (0'0")	1 (0'0")
14.425 - 16.032	16.032 - 16.281	16.281 - 17.181	

Resurface Year

		2022	
--	--	------	--

15.93 - 20.684

Through Lanes

		2	
--	--	---	--

0 - 17.047

Street Name

		W HIGH ST	
--	--	-----------	--

15.999 - 17.064

- Non-divided Highway
- Divided Highway
- Secondary Segment
- Corporation
- Bridge (on route)
- Underpass
- Overpass
- Railroad (at grade)
- Railroad (underpass)
- Railroad (overpass)
- Intersection

Created on: 6/27/2025

transportation.ohio.gov

Prepared by
The Ohio Department of Transportation
Office of Technical Services
Roadway Information

SGEASR00087**C

State True Log

35.298

County True Log

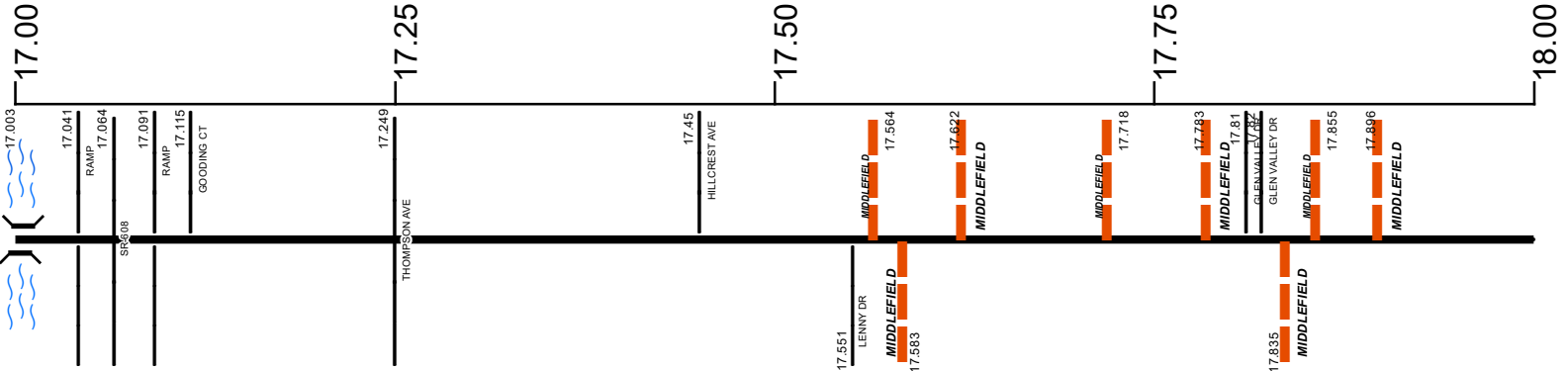

Surface Type & Width (Left / Right)

G 24'	G (32'/16')	G 28'	G (10'/12')	G 20'
-------	-------------	-------	-------------	-------

Base Type (Left / Right)

P	N / P	P	P / K
---	-------	---	-------

Shoulder Type & Width (Left / Right)

1 (0'/0')	2 (4'/4')	5 (2'/2')
-----------	-----------	-----------

Resurface Year

2022

Through Lanes

2	4	2
---	---	---

Street Name

W HIGH ST	E HIGH ST	KINSMAN RD	KINSMAN RD	E HIGH ST	E HIGH ST
-----------	-----------	------------	------------	-----------	-----------

- Non-divided Highway
- Divided Highway
- Secondary Segment
- Corporation
- Bridge (on route)
- Underpass
- Overpass
- Railroad (at grade)
- Railroad (underpass)
- Railroad (overpass)
- Intersection

Created on: 6/27/2025

transportation.ohio.gov

Prepared by
The Ohio Department of Transportation
Office of Technical Services
Roadway Information

SGEASR00087**C

State True Log
County True Log

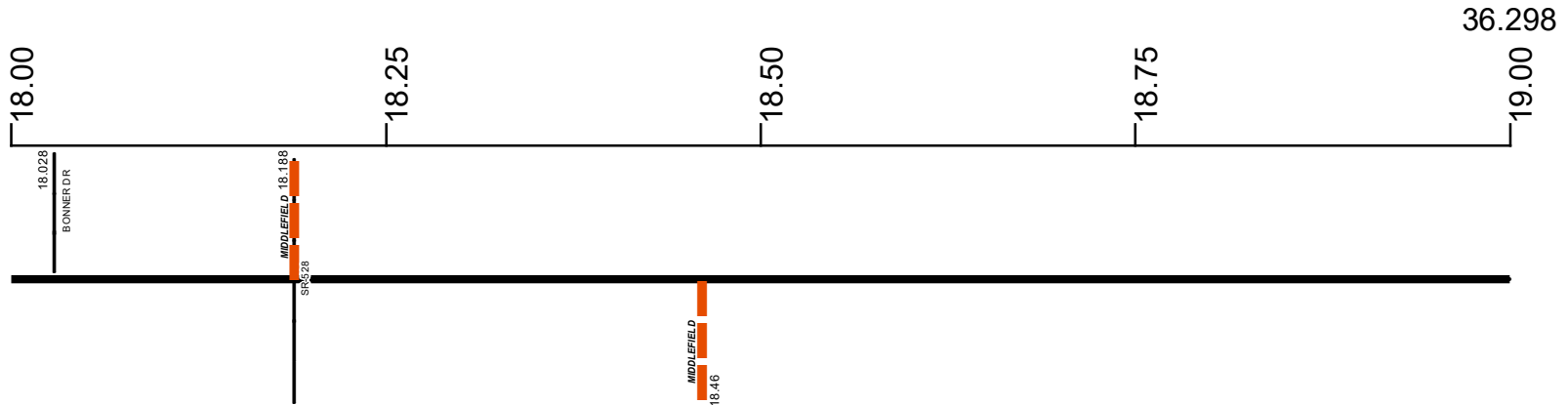

Surface Type & Width (Left / Right)

G 20'
17.582 - 19.711

Base Type (Left / Right)

P / K
17.562 - 20.684

Shoulder Type & Width (Left / Right)

5 (2/2)
17.501 - 19.711

Resurface Year

2022
15.93 - 20.684

Through Lanes

2
17.181 - 20.684

Street Name

E HIGH ST 17.896 - 18.188	KINSMAN RD 18.188 - 20.684
------------------------------	-------------------------------

- | | | | |
|---------------------|-------------------|----------------------|--------------|
| Non-divided Highway | Bridge (on route) | Railroad (at grade) | Intersection |
| Divided Highway | Underpass | Railroad (underpass) | |
| Secondary Segment | Overpass | Railroad (overpass) | |
| Corporation | | | |

Created on: 6/27/2025

transportation.ohio.gov

Prepared by
The Ohio Department of Transportation
Office of Technical Services
Roadway Information

SGEASR00087**C

State True Log

37.298

County True Log

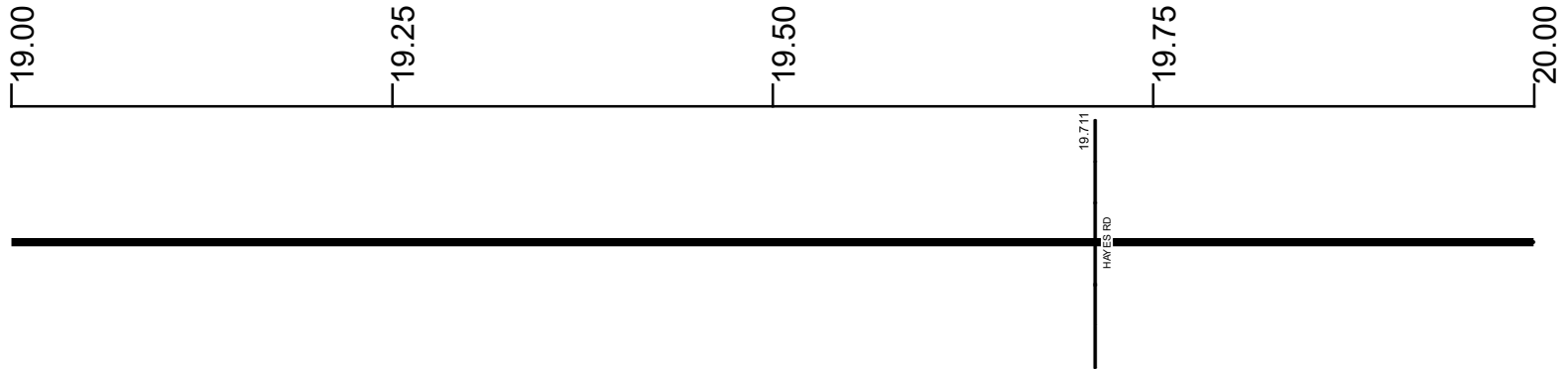

Surface Type & Width (Left / Right)

G 20'	G 22'
17.582 - 19.711	19.711 - 20.684

Base Type (Left / Right)

P / K	
17.562 - 20.684	

Shoulder Type & Width (Left / Right)

5 (2'/2')	2 (8/8')
17.501 - 19.711	19.711 - 20.684

Resurface Year

2022
15.93 - 20.684

Through Lanes

2
17.181 - 20.684

Street Name

KINSMAN RD
18.188 - 20.684

- Non-divided Highway
 Bridge (on route)
 Railroad (at grade)
 Intersection
- Divided Highway
 Underpass
 Railroad (underpass)
- Secondary Segment
 Overpass
 Railroad (overpass)
- Corporation**

Created on: 6/27/2025

transportation.ohio.gov

Prepared by

The Ohio Department of Transportation

Office of Technical Services

Roadway Information

SGEASR00087**C

State True Log

37.982

County True Log



20.684
BUNDY/SEBURG RD

Surface Type & Width (Left / Right)

G 22'
19.711 - 20.684

Base Type (Left / Right)

P / K
17.562 - 20.684

Shoulder Type & Width (Left / Right)

2 (8'8")
19.711 - 20.684

Resurface Year

2022
15.93 - 20.684

Through Lanes

2
17.181 - 20.684

Street Name

KINSMAN RD
18.188 - 20.684

- | | | | |
|---------------------|-------------------|----------------------|--------------|
| Non-divided Highway | Bridge (on route) | Railroad (at grade) | Intersection |
| Divided Highway | Underpass | Railroad (underpass) | |
| Secondary Segment | Overpass | Railroad (overpass) | |
| Corporation | | | |

Created on: 6/27/2025

transportation.ohio.gov

Prepared by
The Ohio Department of Transportation
Office of Technical Services
Roadway Information

Historical Project List for SGEASR00087**C

Begin Measure	End Measure	Project ID Number	Construction Completion Date	Treatment Category	Treatment Type
0.000	2.735	21746	7-2003	Minor Rehabilitation	50-AC Overlay w/o Rpr
2.735	7.707	83634	10-2015	Minor Rehabilitation	60-AC Overlay w/Rpr
7.707	12.576	83635	12-2023	Minor Rehabilitation	60-AC Overlay w/Rpr
12.576	13.087	99706	5-2023	Minor Rehabilitation	60-AC Overlay w/Rpr
13.087	13.568	99706	5-2023	Minor Rehabilitation	60-AC Overlay w/Rpr
13.134	13.568	88251	5-2013	Minor Rehabilitation	60-AC Overlay w/Rpr
13.568	15.922	92602	5-2017	Minor Rehabilitation	38-Fine Poly AC Overlay
15.962	19.721	108104	8-2023	Minor Rehabilitation	60-AC Overlay w/Rpr
19.721	20.684	110164	9-2022	Major Rehabilitation	100-New Flexible Pvmt

Roadway Codes

Access Control Journalized

- F - Full Access Control
- L - Limited Access Control
- N - No Access Control

Access Control Operational

- 1 - Full Access Control
- 2 - Partial Access Control
- 3 - No Access Control

Base Type

- F - Crack and Seat
- H - Rubblize and Roll
- I - Aggregate Base 304 or Traffic Compacted
- K - Water Bound Macadam
- L - Bituminous Concrete Mix or Penetration Macadam
- N - Plain Concrete
- P - Reinforced Concrete
- R - Brick (Flexible)
- T - Brick (Rigid)

Direction of Travel

- B - Both (Two-way)
- F - One-way Cardinal
- T - One-way Non-cardinal

Facility Type

- 1 - One-way Roadway
- 2 - Two-way Roadway
- 4 - Ramp
- 5 - Non-mainline
- 6 - Non-inventory Direction
- 7 - Planned / Unbuilt

Historical Federal Aid Indicator

- N - Not a FAP Route
- Y - FAP Route

Functional Classification

- 01 - Interstate
- 02 - Principal Arterial (Freeways)
- 03 - Principal Arterial (Other)
- 04 - Minor Arterial
- 05 - Major Collector
- 06 - Minor Collector
- 07 - Local

Leave / Reenter Indicator

- Y - Route leaves/reenters at this point
- N - Route does not leave/reenter at this point

Median Type

- 1 - None
- 2 - Unprotected
- 3 - Curbed
- 4 - Positive Barrier (Unspecified)
- 5 - Positive Barrier (Flexible)
- 6 - Positive Barrier (Semi-rigid)
- 7 - Positive Barrier (Rigid)

NHS

- N - National Highway System
- H - Congressional Corridor
- 2 - Major Airport
- 3 - Major Port Facility
- 4 - Major Amtrak Station
- 5 - Major Rail / Truck Terminal
- 6 - Major Intercity Bus Terminal
- 7 - Major Public Transit / Multi-modal Passenger Terminal
- 8 - Major Pipeline Terminal
- 9 - Major Ferry Terminal

Priority System

- G - General
- P - Priority System
- U - Urban

Scenic Byway Code

- A - All American Road
- N - National Scenic Byway
- S - State Scenic Byway

Shoulder Type

- 1 - None
- 2 - Surfaced shoulder exists (bituminous concrete {AC})
- 3 - Surfaced shoulder exists (Portland Cement Concrete {PCC})
- 4 - Stabilized shoulder exists (gravel or other granular material)
- 5 - Combination shoulder exists (two or more surface types)
- 6 - Earth shoulder exists
- 7 - Barrier curb exists; no shoulder in front of curb

Surface Type

- A - Combination
- B - Brick
- C - Continuous Reinforced Concrete
- D - Reinforced Concrete
- E - Plain Concrete
- G - Bituminous Concrete
- I - Chipseal on Granular
- K - Open Graded Bituminous
- L - Chipseal or Micro
- M - Gravel
- U - Unimproved
- X - Right of Way Only