

SGEASR00088**C

State True Log 16.43

17.43

County True Log



Surface Type & Width (Left / Right)

G (19/3')
0 - 1.594

Base Type (Left / Right)

K / L
0 - 1.594

Shoulder Type & Width (Left / Right)

2 (4/4')
0 - 1.594

Through Lanes

2
0 - 2.089

Street Name

MCCALL RD
0 - 2.057

- | | | | |
|---------------------|-------------------|----------------------|--------------|
| Non-divided Highway | Bridge (on route) | Railroad (at grade) | Intersection |
| Divided Highway | Underpass | Railroad (underpass) | |
| Secondary Segment | Overpass | Railroad (overpass) | |
| Corporation | | | |

Created on: 6/27/2025

transportation.ohio.gov

Prepared by
The Ohio Department of Transportation
Office of Technical Services
Roadway Information

SGEASR00088**C

State True Log

18.43

County True Log

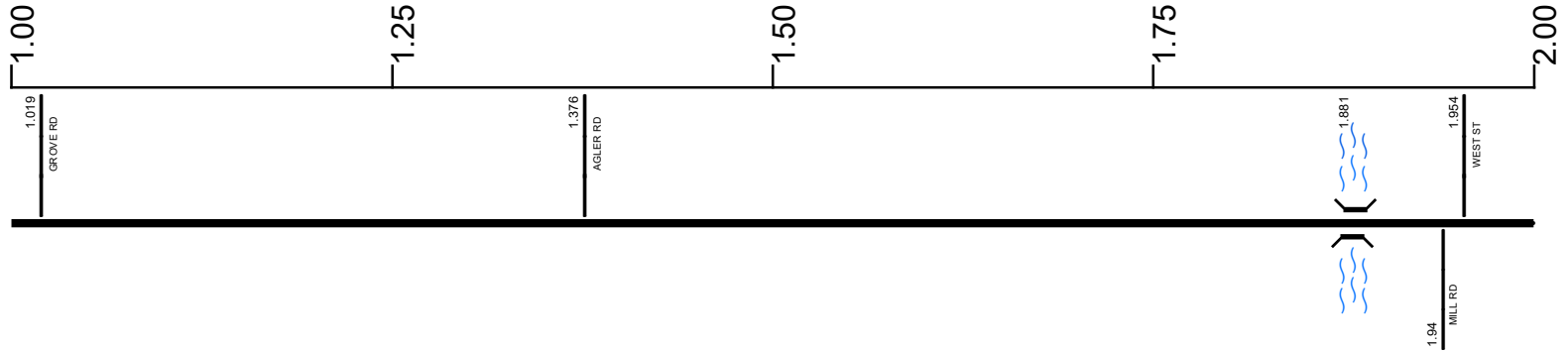

Surface Type & Width (Left / Right)

G (19/3')	G 22'
0 - 1.594	1.594 - 2.089

Base Type (Left / Right)

K / L	K
0 - 1.594	1.594 - 2.089

Shoulder Type & Width (Left / Right)

2 (4/4')	2 (3/3')
0 - 1.594	1.594 - 2.089

Through Lanes

	2
	0 - 2.089

Street Name

	MCCALL RD
	0 - 2.057

- Non-divided Highway
- Divided Highway
- Secondary Segment
- Corporation
- Bridge (on route)
- Underpass
- Overpass
- Railroad (at grade)
- Railroad (underpass)
- Railroad (overpass)
- Intersection

Created on: 6/27/2025

transportation.ohio.gov

Prepared by
The Ohio Department of Transportation
Office of Technical Services
Roadway Information

SGEASR00088**C

State True Log

19.43

County True Log

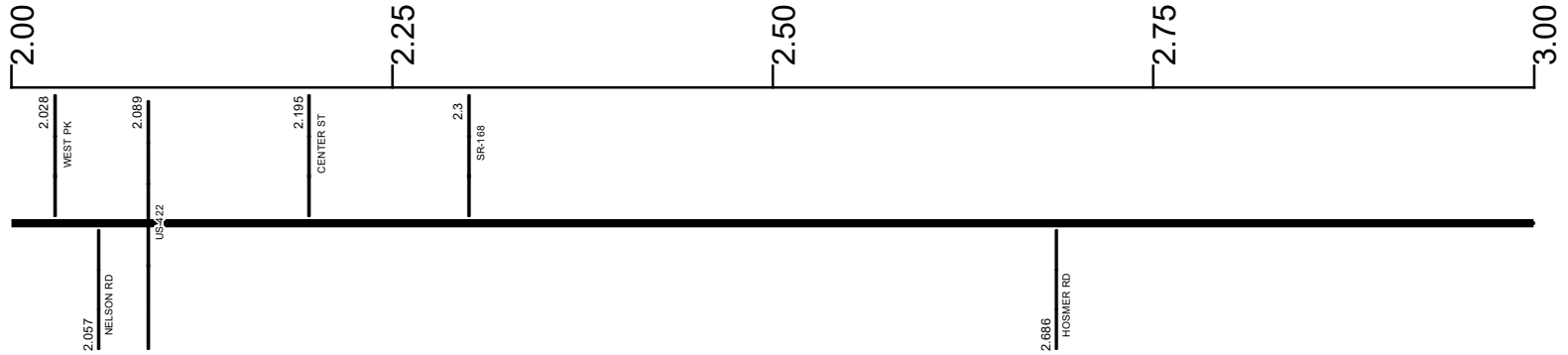

Surface Type & Width (Left / Right)

G 22'	G 40'	G (18'6")
1.594 - 2.089	2.089 - 2.738	2.738 - 3.039

Base Type (Left / Right)

K	K / L	
1.594 - 2.089	2.089 - 3.039	

Shoulder Type & Width (Left / Right)

2 (3'3")	1 (0'0")	2 (10'10")
1.594 - 2.089	2.089 - 2.738	2.738 - 3.399

Through Lanes

2	4	2
0 - 2.089	2.089 - 2.738	2.738 - 6.38

Street Name

MCCALL RD	MADISON RD	
0 - 2.057 2.057 - 2.089	2.089 - 3.399	

- Non-divided Highway
- Divided Highway
- Secondary Segment
- Corporation
- Bridge (on route)
- Underpass
- Overpass
- Railroad (at grade)
- Railroad (underpass)
- Railroad (overpass)
- Intersection

Created on: 6/27/2025

transportation.ohio.gov

Prepared by
The Ohio Department of Transportation
Office of Technical Services
Roadway Information

SGEASR00088**C

State True Log

20.43

County True Log

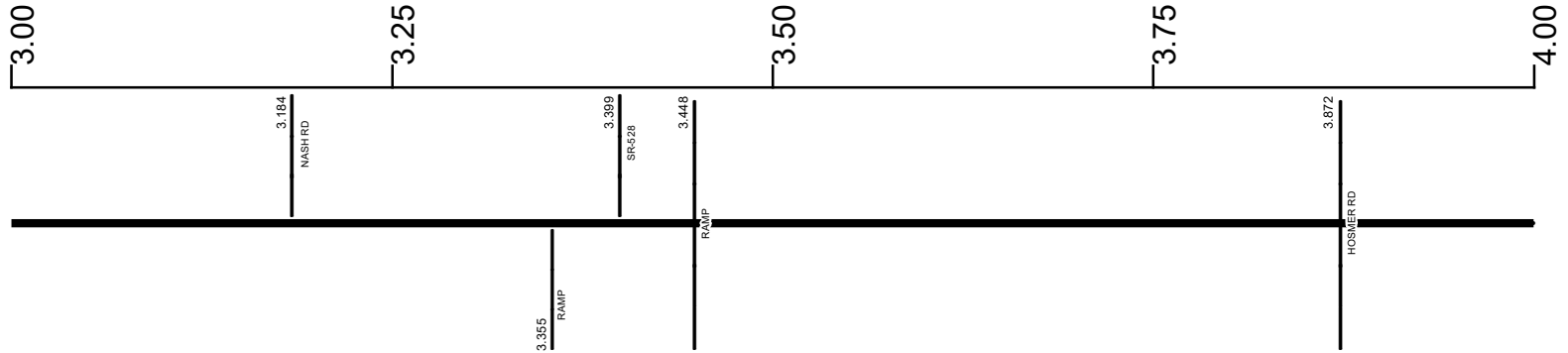

Surface Type & Width (Left / Right)

G (18'6")	G 24'	G (9'10")
2.738 - 3.039	3.039 - 3.399	3.399 - 6.38

Base Type (Left / Right)

K / L	L	K
2.089 - 3.039	3.039 - 3.399	3.399 - 6.38

Shoulder Type & Width (Left / Right)

2 (10'10")	2 (4'4")
2.738 - 3.399	3.399 - 6.38

Resurface Year

2023
3.399 - 6.38

Through Lanes

2
2.738 - 6.38

Street Name

MADISON RD	NASH RD
2.089 - 3.399	3.399 - 6.38

- Non-divided Highway
- Divided Highway
- Secondary Segment
- Corporation
- Bridge (on route)
- Underpass
- Overpass
- Railroad (at grade)
- Railroad (underpass)
- Railroad (overpass)
- Intersection

Created on: 6/27/2025

transportation.ohio.gov

Prepared by
The Ohio Department of Transportation
Office of Technical Services
Roadway Information

SGEASR00088**C

State True Log

21.43

County True Log

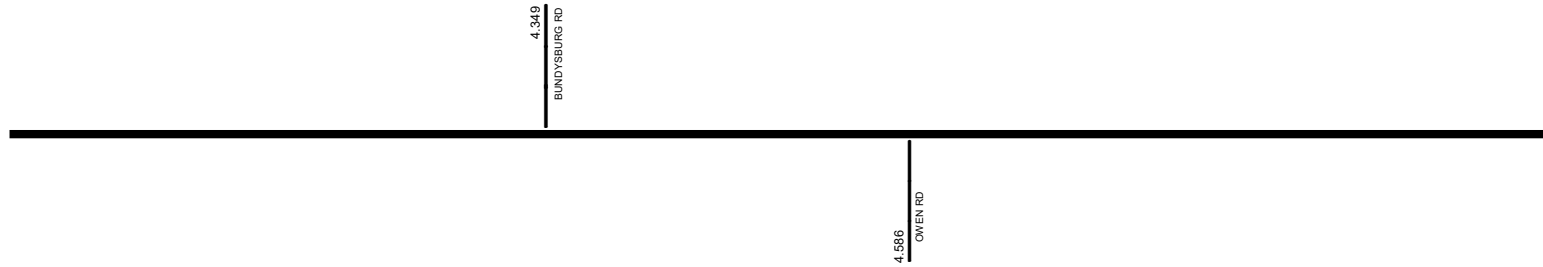

Surface Type & Width (Left / Right)

G (9'/10')
3.399 - 6.38

Base Type (Left / Right)

K
3.399 - 6.38

Shoulder Type & Width (Left / Right)

2 (4'/4')
3.399 - 6.38

Resurface Year

2023

Through Lanes

2
2.738 - 6.38

Street Name

NASH RD
3.399 - 6.38

- | | | | |
|---------------------|-------------------|----------------------|--------------|
| Non-divided Highway | Bridge (on route) | Railroad (at grade) | Intersection |
| Divided Highway | Underpass | Railroad (underpass) | |
| Secondary Segment | Overpass | Railroad (overpass) | |
| Corporation | | | |

Created on: 6/27/2025

transportation.ohio.gov

Prepared by
The Ohio Department of Transportation
Office of Technical Services
Roadway Information

SGEASR00088**C

State True Log

22.43

County True Log

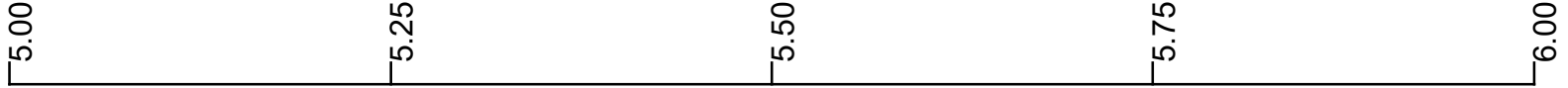

Surface Type & Width (Left / Right)

G (9'/10')
3.399 - 6.38

Base Type (Left / Right)

K
3.399 - 6.38

Shoulder Type & Width (Left / Right)

2 (4'/4')
3.399 - 6.38

Resurface Year

2023
3.399 - 6.38

Through Lanes

2
2.738 - 6.38

Street Name

NASH RD
3.399 - 6.38

- | | | | |
|---------------------|-------------------|----------------------|--------------|
| Non-divided Highway | Bridge (on route) | Railroad (at grade) | Intersection |
| Divided Highway | Underpass | Railroad (underpass) | |
| Secondary Segment | Overpass | Railroad (overpass) | |
| Corporation | | | |

Created on: 6/27/2025

transportation.ohio.gov

Prepared by
The Ohio Department of Transportation
Office of Technical Services
Roadway Information

SGEASR00088**C

State True
Log

22.81

County True
Log

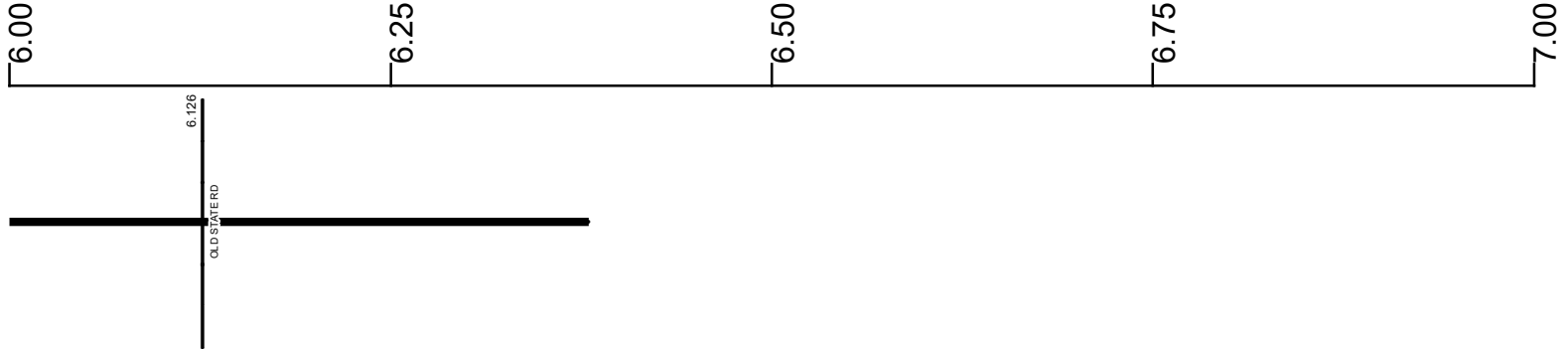

Surface Type & Width (Left / Right)

G (9'/10')
3.399 - 6.38

Base Type (Left / Right)

K
3.399 - 6.38

Shoulder Type & Width (Left / Right)

2 (4'/4')
3.399 - 6.38

Resurface Year

2023
3.399 - 6.38

Through Lanes

2
2.738 - 6.38

Street Name

NASH RD
3.399 - 6.38

- | | | | |
|---------------------|-------------------|----------------------|--------------|
| Non-divided Highway | Bridge (on route) | Railroad (at grade) | Intersection |
| Divided Highway | Underpass | Railroad (underpass) | |
| Secondary Segment | Overpass | Railroad (overpass) | |
| Corporation | | | |

Created on: 6/27/2025



transportation.ohio.gov
 Prepared by
 The Ohio Department of Transportation
 Office of Technical Services
 Roadway Information

Historical Project List for SGEASR00088**C

Begin Measure	End Measure	Project ID Number	Construction Completion Date	Treatment Category	Treatment Type
0.000	2.089	92603	7-2017	Minor Rehabilitation	38-Fine Poly AC Overlay
0.000	3.399	21753	9-2007	Minor Rehabilitation	60-AC Overlay w/Rpr
2.089	3.399	90908	5-2017	Preventive Maintenance	31-DbI Appl Micro
3.399	3.842	103289	5-2021	Minor Rehabilitation	38-Fine Poly AC Overlay
3.842	6.380	81267	11-2010	Minor Rehabilitation	60-AC Overlay w/Rpr

Roadway Codes

Access Control Journalized

- F - Full Access Control
- L - Limited Access Control
- N - No Access Control

Access Control Operational

- 1 - Full Access Control
- 2 - Partial Access Control
- 3 - No Access Control

Base Type

- F - Crack and Seat
- H - Rubblize and Roll
- I - Aggregate Base 304 or Traffic Compacted
- K - Water Bound Macadam
- L - Bituminous Concrete Mix or Penetration Macadam
- N - Plain Concrete
- P - Reinforced Concrete
- R - Brick (Flexible)
- T - Brick (Rigid)

Direction of Travel

- B - Both (Two-way)
- F - One-way Cardinal
- T - One-way Non-cardinal

Facility Type

- 1 - One-way Roadway
- 2 - Two-way Roadway
- 4 - Ramp
- 5 - Non-mainline
- 6 - Non-inventory Direction
- 7 - Planned / Unbuilt

Historical Federal Aid Indicator

- N - Not a FAP Route
- Y - FAP Route

Functional Classification

- 01 - Interstate
- 02 - Principal Arterial (Freeways)
- 03 - Principal Arterial (Other)
- 04 - Minor Arterial
- 05 - Major Collector
- 06 - Minor Collector
- 07 - Local

Leave / Reenter Indicator

- Y - Route leaves/reenters at this point
- N - Route does not leave/reenter at this point

Median Type

- 1 - None
- 2 - Unprotected
- 3 - Curbed
- 4 - Positive Barrier (Unspecified)
- 5 - Positive Barrier (Flexible)
- 6 - Positive Barrier (Semi-rigid)
- 7 - Positive Barrier (Rigid)

NHS

- N - National Highway System
- H - Congressional Corridor
- 2 - Major Airport
- 3 - Major Port Facility
- 4 - Major Amtrak Station
- 5 - Major Rail / Truck Terminal
- 6 - Major Intercity Bus Terminal
- 7 - Major Public Transit / Multi-modal Passenger Terminal
- 8 - Major Pipeline Terminal
- 9 - Major Ferry Terminal

Priority System

- G - General
- P - Priority System
- U - Urban

Scenic Byway Code

- A - All American Road
- N - National Scenic Byway
- S - State Scenic Byway

Shoulder Type

- 1 - None
- 2 - Surfaced shoulder exists (bituminous concrete {AC})
- 3 - Surfaced shoulder exists (Portland Cement Concrete {PCC})
- 4 - Stabilized shoulder exists (gravel or other granular material)
- 5 - Combination shoulder exists (two or more surface types)
- 6 - Earth shoulder exists
- 7 - Barrier curb exists; no shoulder in front of curb

Surface Type

- A - Combination
- B - Brick
- C - Continuous Reinforced Concrete
- D - Reinforced Concrete
- E - Plain Concrete
- G - Bituminous Concrete
- I - Chipseal on Granular
- K - Open Graded Bituminous
- L - Chipseal or Micro
- M - Gravel
- U - Unimproved
- X - Right of Way Only