

SGEASR00528**C



Begin overlap w/
SGEASR00088**C
@ 2..089

- | | | | |
|---------------------|-------------------|----------------------|--------------|
| Non-divided Highway | Bridge (on route) | Railroad (at grade) | Intersection |
| Divided Highway | Underpass | Railroad (underpass) | |
| Secondary Segment | Overpass | Railroad (overpass) | |
| Corporation | | | |

Created on: 6/27/2025



transportation.ohio.gov

Prepared by
The Ohio Department of Transportation
Office of Technical Services
Roadway Information

SGEASR00528**C

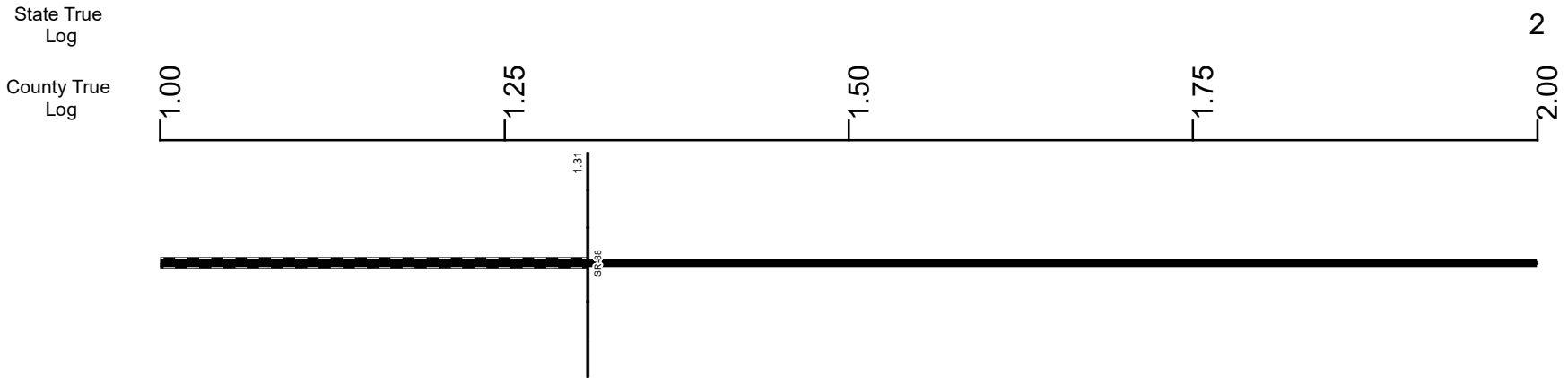

Surface Type & Width (Left / Right)

G 24'
1.31 - 4.423

Base Type (Left / Right)

L
1.31 - 14.037

Shoulder Type & Width (Left / Right)

2 (10'/10')
1.31 - 4.423

Through Lanes

2
1.31 - 24.063

Street Name

MADISON RD
1.31 - 22.331

- | | | | |
|--|---|---|---|
| <ul style="list-style-type: none"> Non-divided Highway Divided Highway Secondary Segment Corporation | <ul style="list-style-type: none"> Bridge (on route) Underpass Overpass | <ul style="list-style-type: none"> Railroad (at grade) Railroad (underpass) Railroad (overpass) | <ul style="list-style-type: none"> Intersection |
|--|---|---|---|

Created on: 6/27/2025

transportation.ohio.gov

Prepared by
The Ohio Department of Transportation
Office of Technical Services
Roadway Information

SGEASR00528**C

State True Log

3

County True Log

2.00

2.25

2.50

2.75

3.00



Surface Type & Width (Left / Right)

G 24'
1.31 - 4.423

Base Type (Left / Right)

L
1.31 - 14.037

Shoulder Type & Width (Left / Right)

2 (10'/10')
1.31 - 4.423

Through Lanes

2
1.31 - 24.063

Street Name

MADISON RD
1.31 - 22.331

- | | | | |
|---------------------|-------------------|----------------------|--------------|
| Non-divided Highway | Bridge (on route) | Railroad (at grade) | Intersection |
| Divided Highway | Underpass | Railroad (underpass) | |
| Secondary Segment | Overpass | Railroad (overpass) | |
| Corporation | | | |

Created on: 6/27/2025



transportation.ohio.gov
 Prepared by
 The Ohio Department of Transportation
 Office of Technical Services
 Roadway Information

SGEASR00528**C

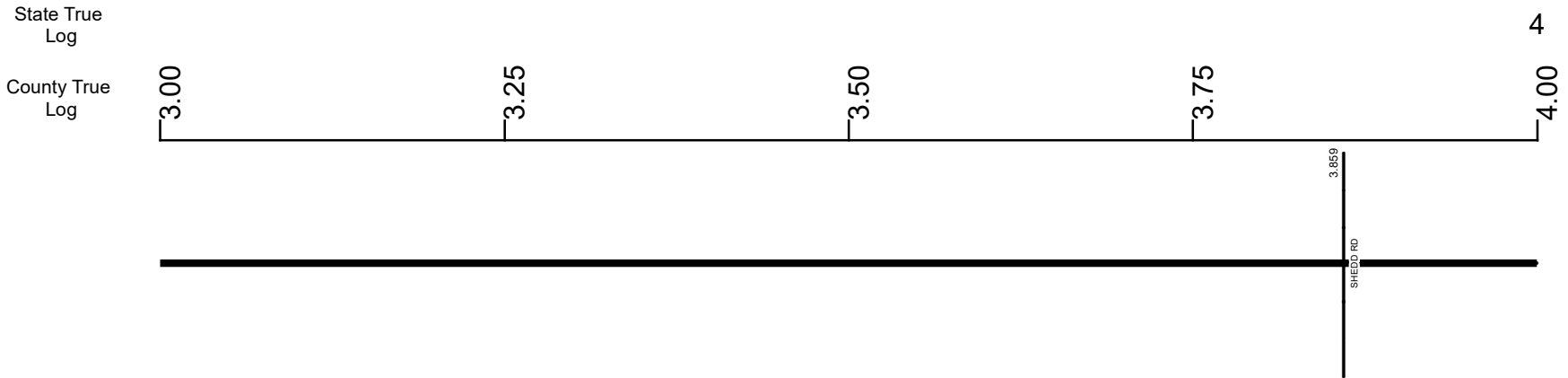

Surface Type & Width (Left / Right)	G 24'
	1.31 - 4.423
Base Type (Left / Right)	L
	1.31 - 14.037
Shoulder Type & Width (Left / Right)	2 (10'/10')
	1.31 - 4.423
Through Lanes	2
	1.31 - 24.063
Street Name	MADISON RD
	1.31 - 22.331

- Non-divided Highway
- Divided Highway
- Secondary Segment
- Corporation
- Bridge (on route)
- Underpass
- Overpass
- Railroad (at grade)
- Railroad (underpass)
- Railroad (overpass)
- Intersection

Created on: 6/27/2025



transportation.ohio.gov

Prepared by
The Ohio Department of Transportation
Office of Technical Services
Roadway Information

SGEASR00528**C

State True Log

5

County True Log

4.00

4.25

4.50

4.75

5.00

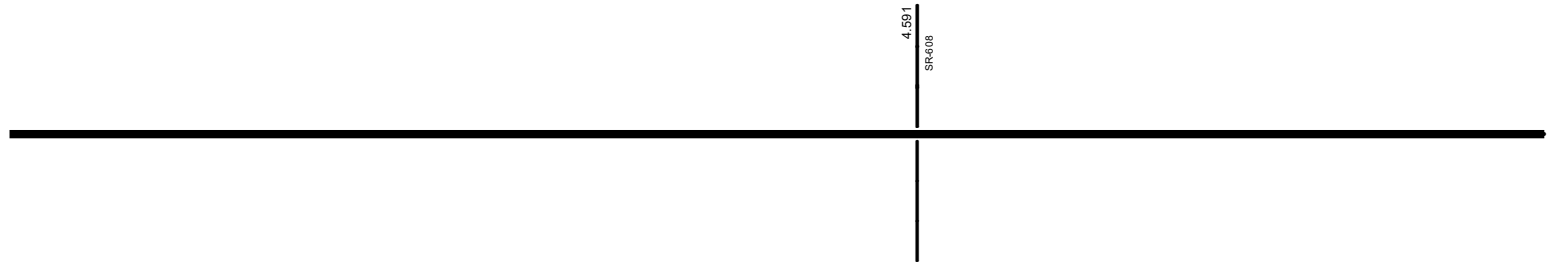

Surface Type & Width (Left / Right)

G 24'	G 36'	G 24'
1.31 - 4.423	4.423 - 4.733	4.733 - 14.037

Base Type (Left / Right)

L
1.31 - 14.037

Shoulder Type & Width (Left / Right)

2 (10'/10')	2 (4'/4')	2 (10'/10')
1.31 - 4.423	4.423 - 4.733	4.733 - 6.362

Through Lanes

2
1.31 - 24.063

Street Name

MADISON RD
1.31 - 22.331

- Non-divided Highway
 Bridge (on route)
 Railroad (at grade)
 Intersection
- Divided Highway
 Underpass
 Railroad (underpass)
- Secondary Segment
 Overpass
 Railroad (overpass)
- Corporation**

Created on: 6/27/2025

transportation.ohio.gov

Prepared by
The Ohio Department of Transportation
Office of Technical Services
Roadway Information

SGEASR00528**C

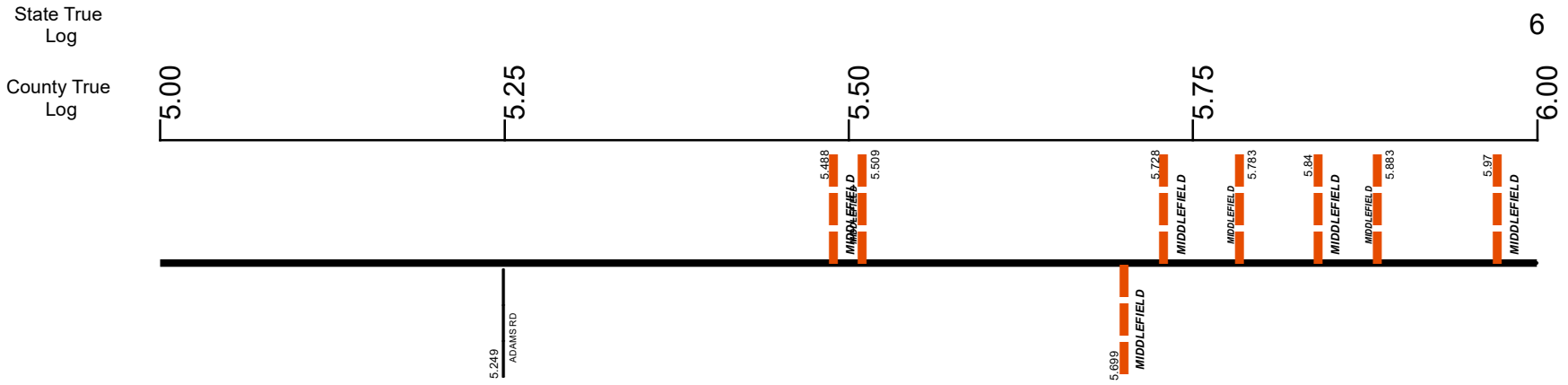

Surface Type & Width (Left / Right)	G 24' 4.733 - 14.037
Base Type (Left / Right)	L 1.31 - 14.037
Shoulder Type & Width (Left / Right)	2 (10'/10') 4.733 - 6.362
Through Lanes	2 1.31 - 24.063
Street Name	MADISON RD 1.31 - 22.331

Non-divided Highway	Bridge (on route)	Railroad (at grade)	Intersection
Divided Highway	Underpass	Railroad (underpass)	
Secondary Segment	Overpass	Railroad (overpass)	
Corporation			

Created on: 6/27/2025



transportation.ohio.gov

Prepared by
The Ohio Department of Transportation
Office of Technical Services
Roadway Information

SGEASR00528**C

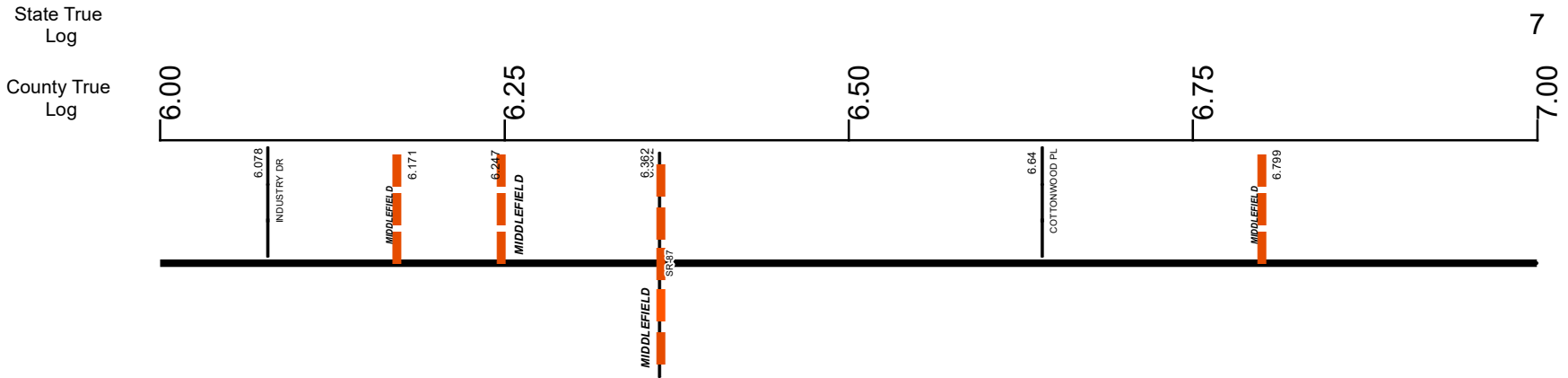

Surface Type & Width (Left / Right)	G 24'
	4.733 - 14.037
Base Type (Left / Right)	L
	1.31 - 14.037
Shoulder Type & Width (Left / Right)	
2 (10'/10')	5 (8'/8')
4.733 - 6.362	6.362 - 7.48
Through Lanes	2
	1.31 - 24.063
Street Name	MADISON RD
	1.31 - 22.331

Non-divided Highway	Bridge (on route)	Railroad (at grade)	Intersection
Divided Highway	Underpass	Railroad (underpass)	
Secondary Segment	Overpass	Railroad (overpass)	
Corporation			

Created on: 6/27/2025

transportation.ohio.gov

Prepared by
The Ohio Department of Transportation
Office of Technical Services
Roadway Information

SGEASR00528**C

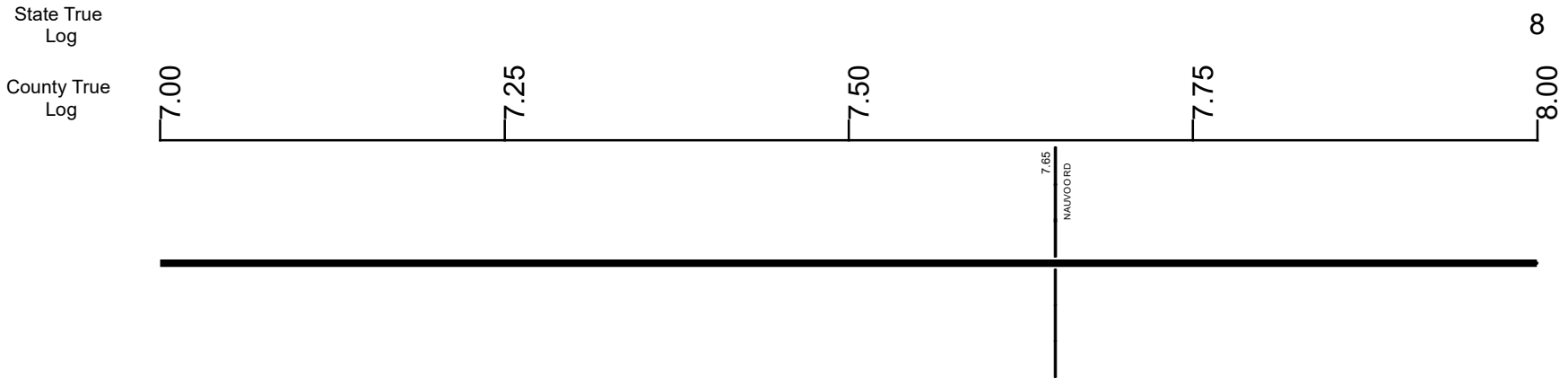

Surface Type & Width (Left / Right)

G 24'
4.733 - 14.037

Base Type (Left / Right)

L
1.31 - 14.037

Shoulder Type & Width (Left / Right)

5 (8/8') 6.362 - 7.48	2 (10/10') 7.48 - 7.52	5 (8/8') 7.52 - 8.564
--------------------------	---------------------------	--------------------------

Through Lanes

2
1.31 - 24.063

Street Name

MADISON RD
1.31 - 22.331

- | | | | |
|---------------------|-------------------|----------------------|--------------|
| Non-divided Highway | Bridge (on route) | Railroad (at grade) | Intersection |
| Divided Highway | Underpass | Railroad (underpass) | |
| Secondary Segment | Overpass | Railroad (overpass) | |
| Corporation | | | |

Created on: 6/27/2025

transportation.ohio.gov

Prepared by
The Ohio Department of Transportation
Office of Technical Services
Roadway Information

SGEASR00528**C

State True Log

9

County True Log

8.00

8.25

8.50

8.75

9.00



Surface Type & Width (Left / Right)

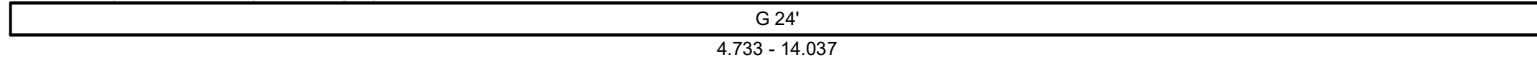

Base Type (Left / Right)

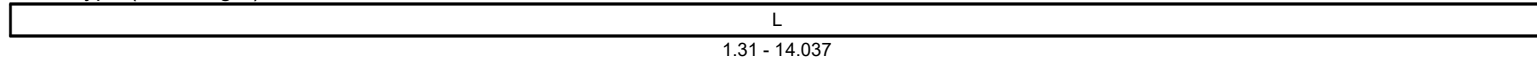

Shoulder Type & Width (Left / Right)

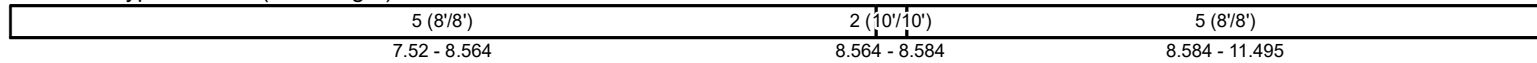

Through Lanes

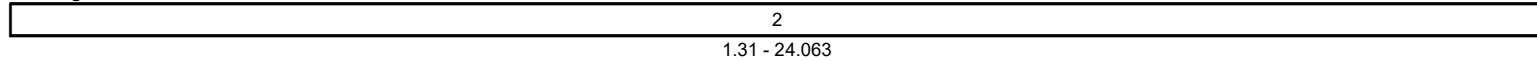

Street Name

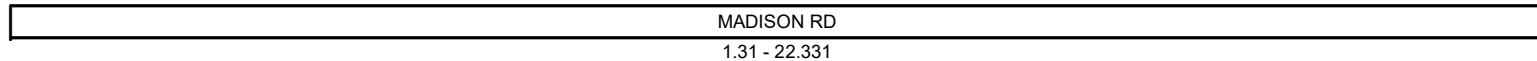

- | | | | |
|---------------------|-------------------|----------------------|--------------|
| Non-divided Highway | Bridge (on route) | Railroad (at grade) | Intersection |
| Divided Highway | Underpass | Railroad (underpass) | |
| Secondary Segment | Overpass | Railroad (overpass) | |
| Corporation | | | |

Created on: 6/27/2025



transportation.ohio.gov
 Prepared by
 The Ohio Department of Transportation
 Office of Technical Services
 Roadway Information

SGEASR00528**C

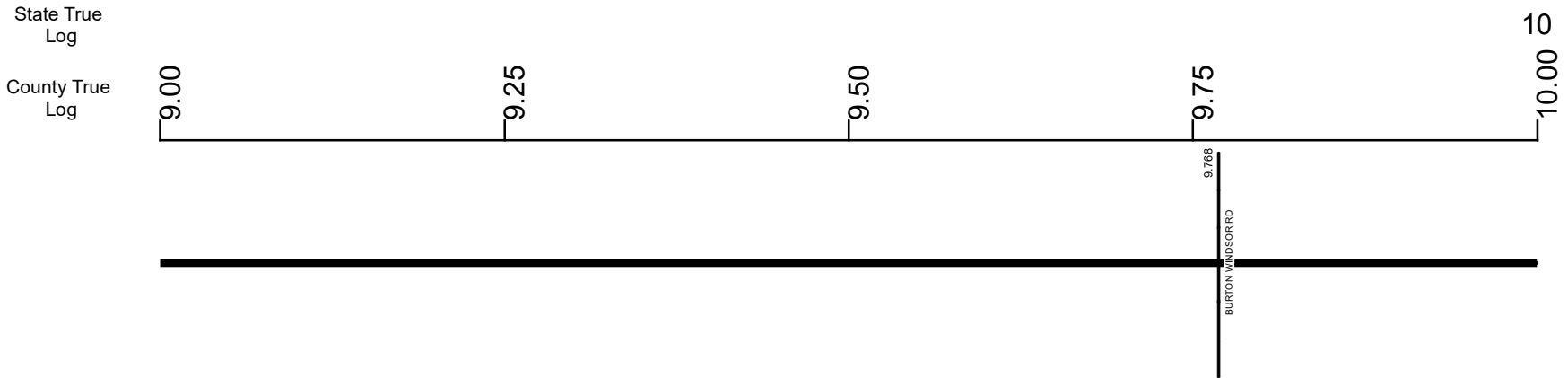

Surface Type & Width (Left / Right)	G 24'
	4.733 - 14.037
Base Type (Left / Right)	L
	1.31 - 14.037
Shoulder Type & Width (Left / Right)	5 (8/8')
	8.584 - 11.495
Through Lanes	2
	1.31 - 24.063
Street Name	MADISON RD
	1.31 - 22.331

- | | | | |
|---------------------|-------------------|----------------------|--------------|
| Non-divided Highway | Bridge (on route) | Railroad (at grade) | Intersection |
| Divided Highway | Underpass | Railroad (underpass) | |
| Secondary Segment | Overpass | Railroad (overpass) | |
| Corporation | | | |

Created on: 6/27/2025

transportation.ohio.gov

Prepared by
The Ohio Department of Transportation
Office of Technical Services
Roadway Information

SGEASR00528**C

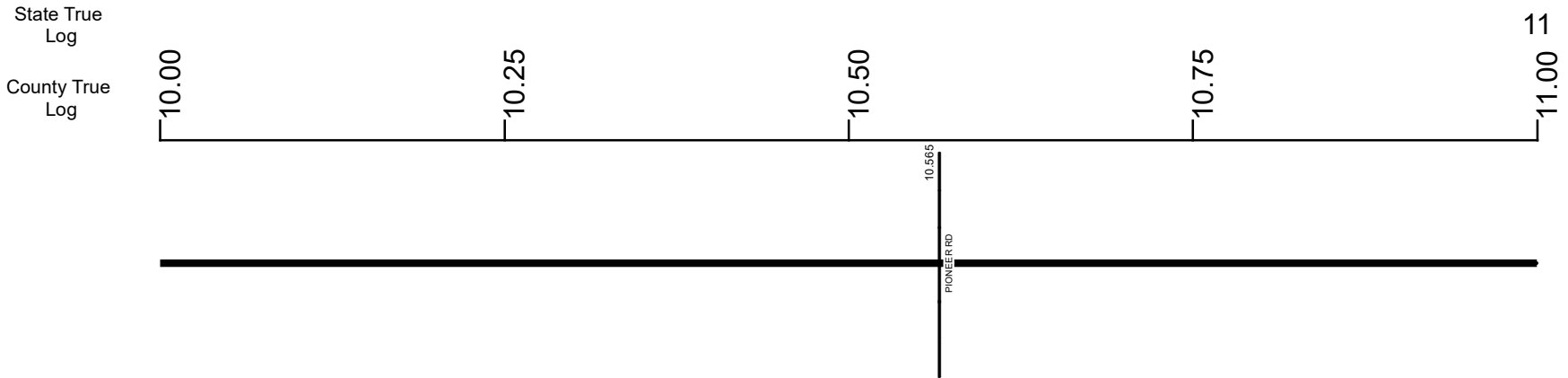

Surface Type & Width (Left / Right)	G 24'
	4.733 - 14.037
Base Type (Left / Right)	L
	1.31 - 14.037
Shoulder Type & Width (Left / Right)	5 (8/8')
	8.584 - 11.495
Through Lanes	2
	1.31 - 24.063
Street Name	MADISON RD
	1.31 - 22.331

Non-divided Highway	Bridge (on route)	Railroad (at grade)	Intersection
Divided Highway	Underpass	Railroad (underpass)	
Secondary Segment	Overpass	Railroad (overpass)	
Corporation			

Created on: 6/27/2025

transportation.ohio.gov

Prepared by
The Ohio Department of Transportation
Office of Technical Services
Roadway Information

SGEASR00528**C

State True Log
County True Log

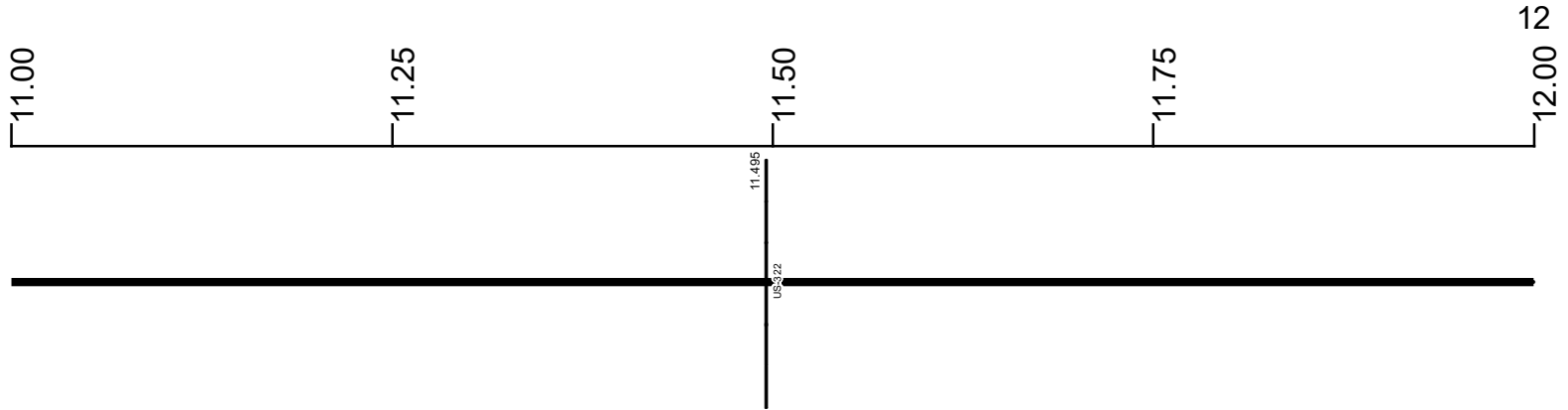

Surface Type & Width (Left / Right)

	G 24'
	4.733 - 14.037

Base Type (Left / Right)

	L
	1.31 - 14.037

Shoulder Type & Width (Left / Right)

5 (8'8")	2 (2'2")
8.584 - 11.495	11.495 - 14.524

Resurface Year

	2022
	11.495 - 14.524

Through Lanes

	2
	1.31 - 24.063

Street Name

	MADISON RD
	1.31 - 22.331

- | | | | |
|---------------------|-------------------|----------------------|--------------|
| Non-divided Highway | Bridge (on route) | Railroad (at grade) | Intersection |
| Divided Highway | Underpass | Railroad (underpass) | |
| Secondary Segment | Overpass | Railroad (overpass) | |
| Corporation | | | |

Created on: 6/27/2025

transportation.ohio.gov

Prepared by
The Ohio Department of Transportation
Office of Technical Services
Roadway Information

SGEASR00528**C

State True Log
County True Log

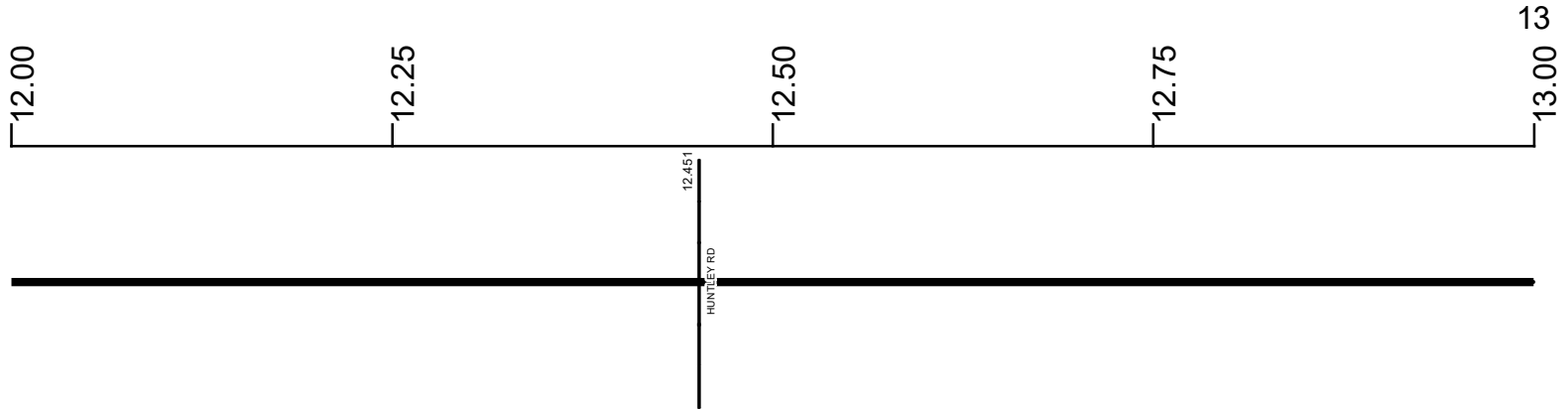

Surface Type & Width (Left / Right)

G 24'
4.733 - 14.037

Base Type (Left / Right)

L
1.31 - 14.037

Shoulder Type & Width (Left / Right)

2 (2'/2')
11.495 - 14.524

Resurface Year

2022
11.495 - 14.524

Through Lanes

2
1.31 - 24.063

Street Name

MADISON RD
1.31 - 22.331

- | | | | |
|---------------------|-------------------|----------------------|--------------|
| Non-divided Highway | Bridge (on route) | Railroad (at grade) | Intersection |
| Divided Highway | Underpass | Railroad (underpass) | |
| Secondary Segment | Overpass | Railroad (overpass) | |
| Corporation | | | |

Created on: 6/27/2025



transportation.ohio.gov
 Prepared by
 The Ohio Department of Transportation
 Office of Technical Services
 Roadway Information

SGEASR00528**C

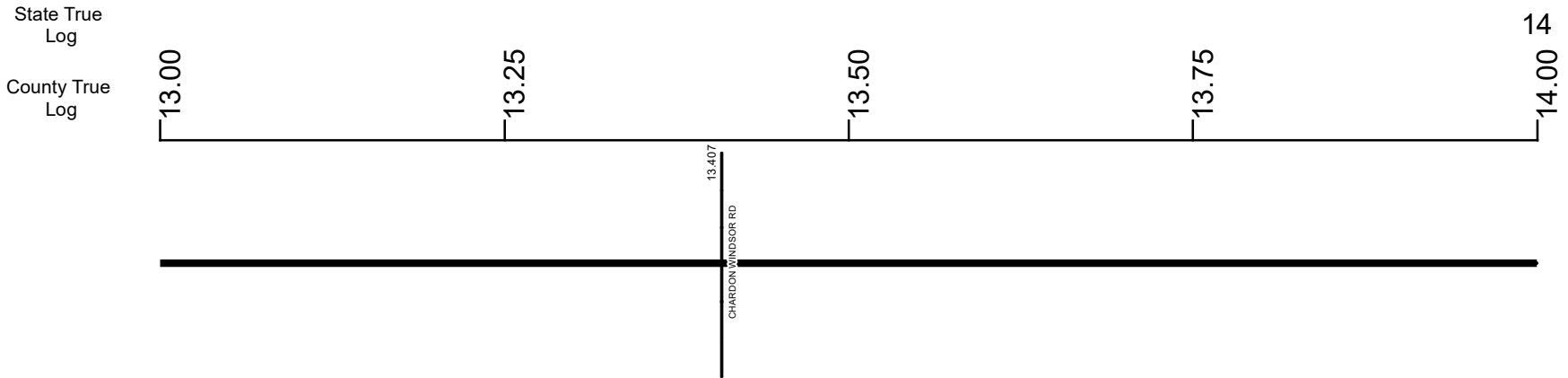

Surface Type & Width (Left / Right)	G 24' 4.733 - 14.037
Base Type (Left / Right)	L 1.31 - 14.037
Shoulder Type & Width (Left / Right)	2 (2/2) 11.495 - 14.524
Resurface Year	2022 11.495 - 14.524
Through Lanes	2 1.31 - 24.063
Street Name	MADISON RD 1.31 - 22.331

- | | | | |
|---------------------|-------------------|----------------------|--------------|
| Non-divided Highway | Bridge (on route) | Railroad (at grade) | Intersection |
| Divided Highway | Underpass | Railroad (underpass) | |
| Secondary Segment | Overpass | Railroad (overpass) | |
| Corporation | | | |

Created on: 6/27/2025

transportation.ohio.gov

Prepared by
The Ohio Department of Transportation
Office of Technical Services
Roadway Information

SGEASR00528**C

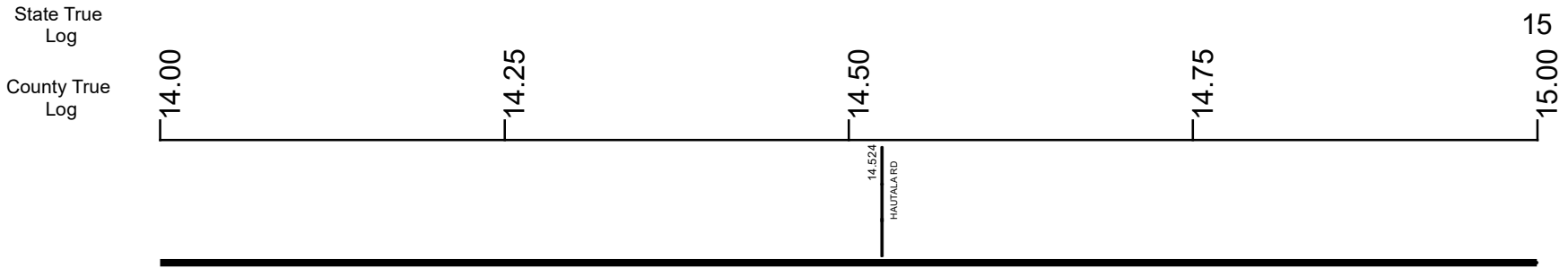

Surface Type & Width (Left / Right)

G 24'		G 20'	
4.733 - 14.037		14.037 - 20.525	

Base Type (Left / Right)

L		I	
1.31 - 14.037		14.037 - 20.525	

Shoulder Type & Width (Left / Right)

2 (2'/2')	2 (5'/5')
11.495 - 14.524	14.524 - 20.525

Resurface Year

2022
11.495 - 14.524

Through Lanes

2
1.31 - 24.063

Street Name

MADISON RD
1.31 - 22.331

- Non-divided Highway
- Divided Highway
- Secondary Segment
- Corporation
- Bridge (on route)
- Underpass
- Overpass
- Railroad (at grade)
- Railroad (underpass)
- Railroad (overpass)
- Intersection

Created on: 6/27/2025

transportation.ohio.gov

Prepared by
The Ohio Department of Transportation
Office of Technical Services
Roadway Information

SGEASR00528**C

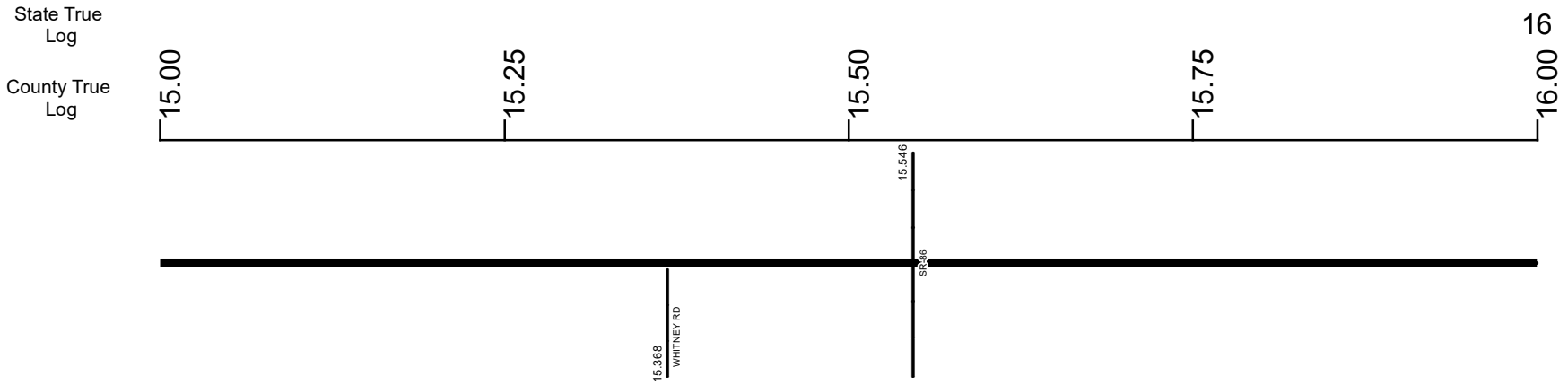

Surface Type & Width (Left / Right)	G 20'
	14.037 - 20.525
Base Type (Left / Right)	I
	14.037 - 20.525
Shoulder Type & Width (Left / Right)	2 (5/5')
	14.524 - 20.525
Through Lanes	2
	1.31 - 24.063
Street Name	MADISON RD
	1.31 - 22.331

- | | | | |
|---------------------|-------------------|----------------------|--------------|
| Non-divided Highway | Bridge (on route) | Railroad (at grade) | Intersection |
| Divided Highway | Underpass | Railroad (underpass) | |
| Secondary Segment | Overpass | Railroad (overpass) | |
| Corporation | | | |

Created on: 6/27/2025

transportation.ohio.gov

Prepared by
The Ohio Department of Transportation
Office of Technical Services
Roadway Information

SGEASR00528**C

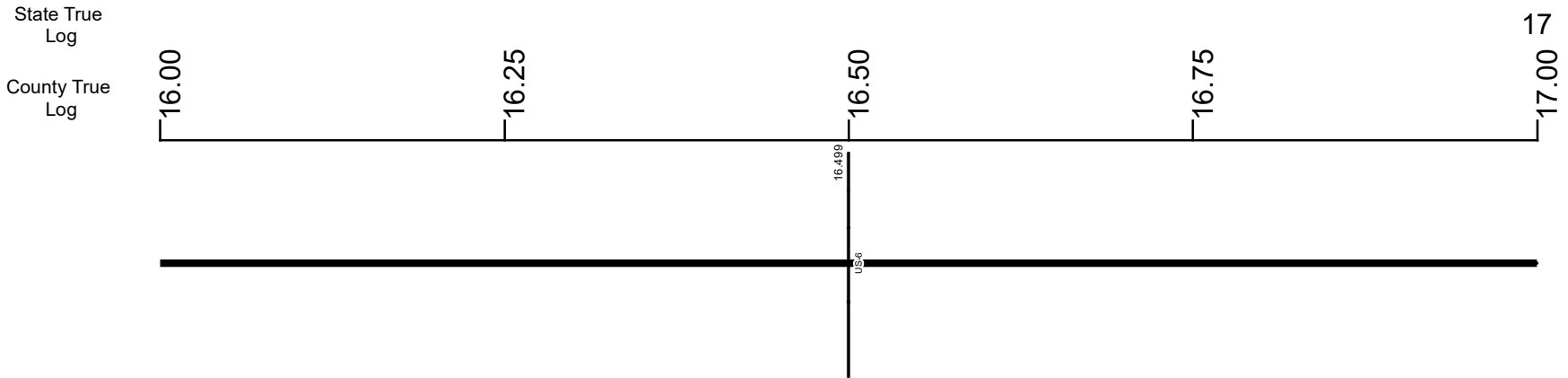

Surface Type & Width (Left / Right)	G 20'
	14.037 - 20.525
Base Type (Left / Right)	I
	14.037 - 20.525
Shoulder Type & Width (Left / Right)	2 (5/5')
	14.524 - 20.525
Through Lanes	2
	1.31 - 24.063
Street Name	MADISON RD
	1.31 - 22.331

Non-divided Highway	Bridge (on route)	Railroad (at grade)	Intersection
Divided Highway	Underpass	Railroad (underpass)	
Secondary Segment	Overpass	Railroad (overpass)	
Corporation			

Created on: 6/27/2025

transportation.ohio.gov

Prepared by
The Ohio Department of Transportation
Office of Technical Services
Roadway Information

SGEASR00528**C

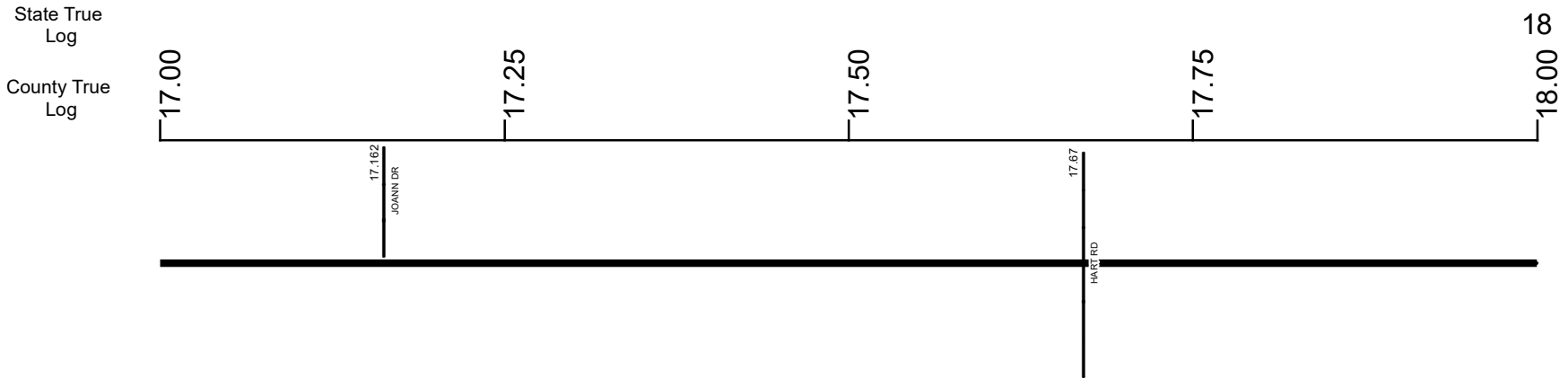

Surface Type & Width (Left / Right)	G 20'
	14.037 - 20.525
Base Type (Left / Right)	I
	14.037 - 20.525
Shoulder Type & Width (Left / Right)	2 (5/5)
	14.524 - 20.525
Through Lanes	2
	1.31 - 24.063
Street Name	MADISON RD
	1.31 - 22.331

- | | | | |
|---------------------|-------------------|----------------------|--------------|
| Non-divided Highway | Bridge (on route) | Railroad (at grade) | Intersection |
| Divided Highway | Underpass | Railroad (underpass) | |
| Secondary Segment | Overpass | Railroad (overpass) | |
| Corporation | | | |

Created on: 6/27/2025

transportation.ohio.gov

Prepared by
The Ohio Department of Transportation
Office of Technical Services
Roadway Information

SGEASR00528**C

State True Log
County True Log

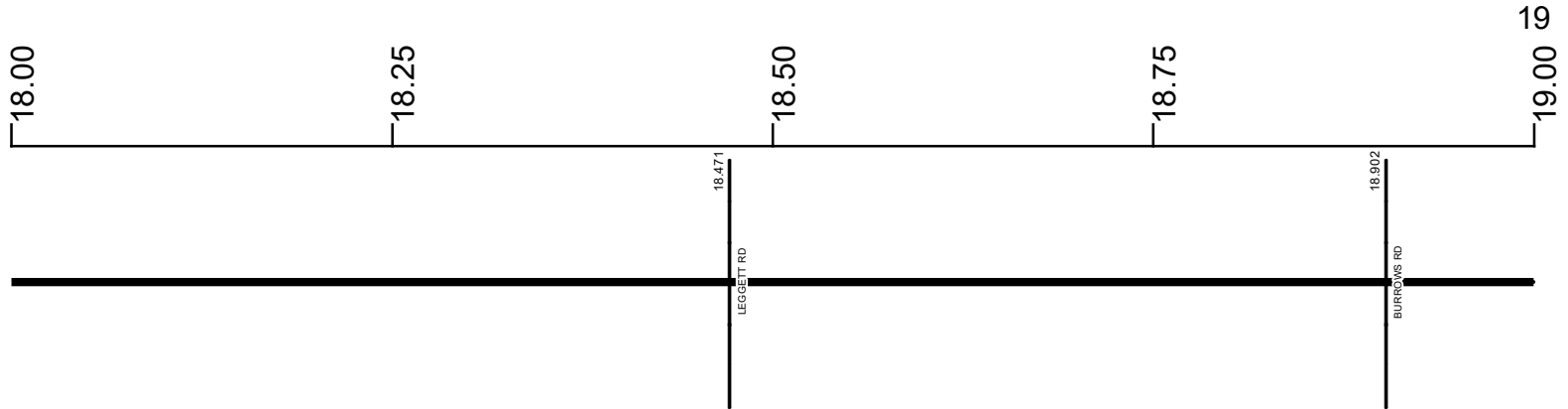

Surface Type & Width (Left / Right)

G 20'
14.037 - 20.525

Base Type (Left / Right)

I
14.037 - 20.525

Shoulder Type & Width (Left / Right)

2 (5/5)
14.524 - 20.525

Through Lanes

2
1.31 - 24.063

Street Name

MADISON RD
1.31 - 22.331

- | | | | |
|---------------------|-------------------|----------------------|--------------|
| Non-divided Highway | Bridge (on route) | Railroad (at grade) | Intersection |
| Divided Highway | Underpass | Railroad (underpass) | |
| Secondary Segment | Overpass | Railroad (overpass) | |
| Corporation | | | |

Created on: 6/27/2025



transportation.ohio.gov
 Prepared by
 The Ohio Department of Transportation
 Office of Technical Services
 Roadway Information

SGEASR00528**C

State True Log
County True Log

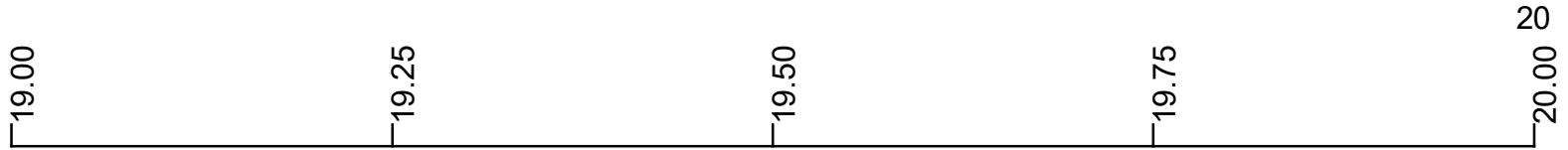

Surface Type & Width (Left / Right)

G 20'
14.037 - 20.525

Base Type (Left / Right)

I
14.037 - 20.525

Shoulder Type & Width (Left / Right)

2 (5/5)
14.524 - 20.525

Through Lanes

2
1.31 - 24.063

Street Name

MADISON RD
1.31 - 22.331

- | | | | |
|---------------------|-------------------|----------------------|--------------|
| Non-divided Highway | Bridge (on route) | Railroad (at grade) | Intersection |
| Divided Highway | Underpass | Railroad (underpass) | |
| Secondary Segment | Overpass | Railroad (overpass) | |
| Corporation | | | |

Created on: 6/27/2025



transportation.ohio.gov
Prepared by
The Ohio Department of Transportation
Office of Technical Services
Roadway Information

SGEASR00528**C

State True Log
County True Log

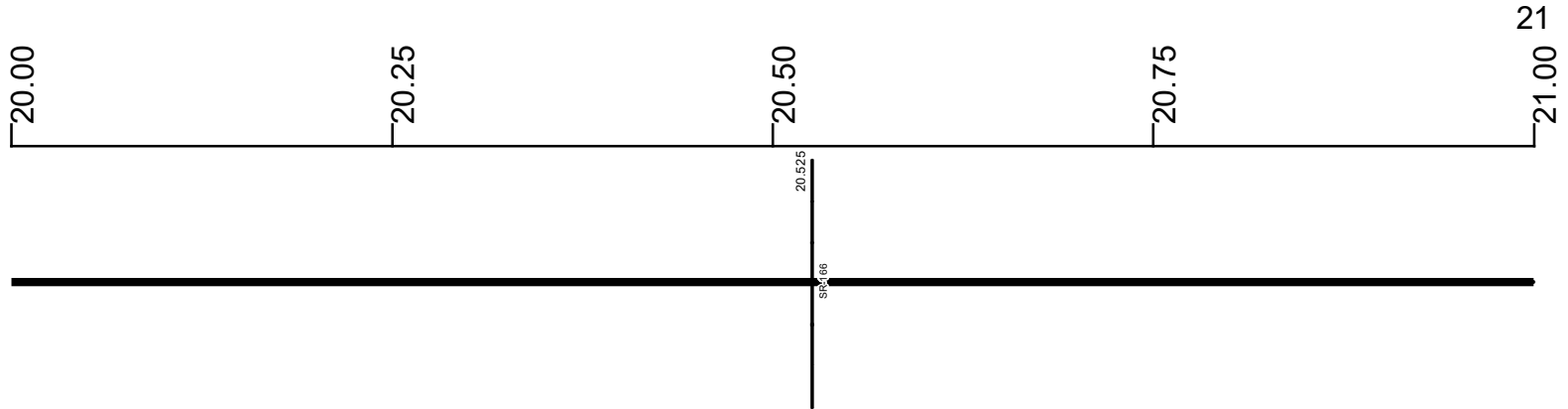

Surface Type & Width (Left / Right)

G 20'	G 22'
14.037 - 20.525	20.525 - 21.578

Base Type (Left / Right)

I	K
14.037 - 20.525	20.525 - 21.578

Shoulder Type & Width (Left / Right)

2 (5/5')	2 (1/1')
14.524 - 20.525	20.525 - 21.578

Through Lanes

	2
	1.31 - 24.063

Street Name

	MADISON RD
	1.31 - 22.331

- Non-divided Highway
 Bridge (on route)
 Railroad (at grade)
 Intersection
- Divided Highway
 Underpass
 Railroad (underpass)
- Secondary Segment
 Overpass
 Railroad (overpass)
- Corporation**

Created on: 6/27/2025

transportation.ohio.gov

Prepared by
The Ohio Department of Transportation
Office of Technical Services
Roadway Information

SGEASR00528**C

State True
Log

22

County True
Log

21.00

21.25

21.50

21.75

22.00



Surface Type & Width (Left / Right)

G 22'	G 24'	G 22'
20.525 - 21.578	21.578 - 21.9	21.9 - 22.221

Base Type (Left / Right)

K	L	K
20.525 - 21.578	21.578 - 21.9	21.9 - 22.366

Shoulder Type & Width (Left / Right)

2 (1'1')	2 (4'4')	2 (1'1')
20.525 - 21.578	21.578 - 21.9	21.9 - 22.221

Through Lanes

2
1.31 - 24.063

Street Name

MADISON RD
1.31 - 22.331

- Non-divided Highway
 Bridge (on route)
 Railroad (at grade)
 Intersection
- Divided Highway
 Underpass
 Railroad (underpass)
- Secondary Segment
 Overpass
 Railroad (overpass)
- Corporation**

Created on: 6/27/2025

transportation.ohio.gov

Prepared by
The Ohio Department of Transportation
Office of Technical Services
Roadway Information

SGEASR00528**C

State True Log
County True Log

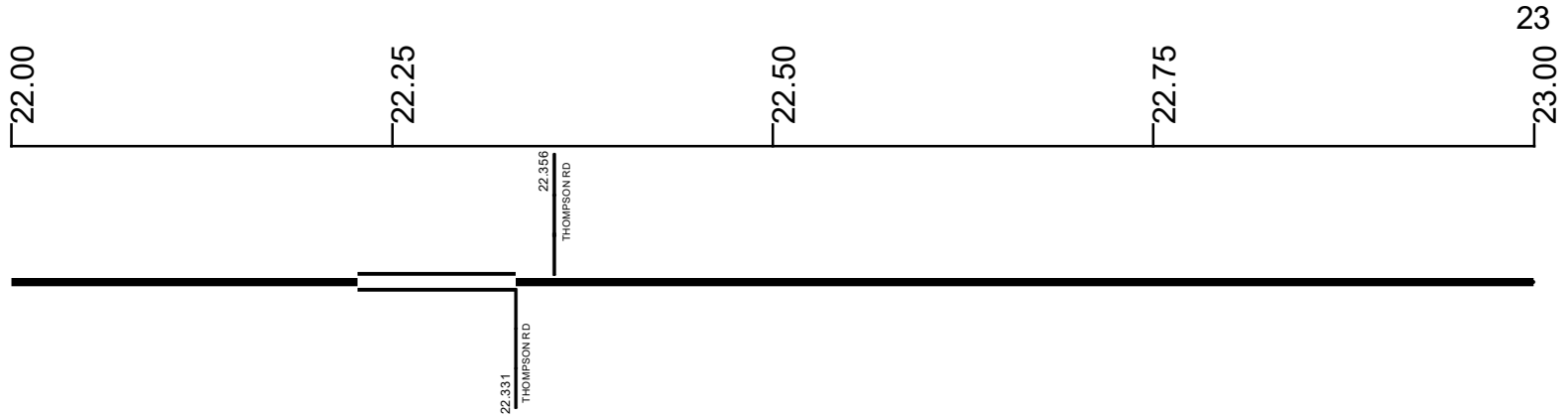

Surface Type & Width (Left / Right)	
G 22' 21.9 - 22.221	G 34' 22.221 - 22.366
G (10'12") 22.366 - 24.063	
Base Type (Left / Right)	
K 21.9 - 22.366	
N / K 22.366 - 24.063	
Shoulder Type & Width (Left / Right)	
2 (1'1") 21.9 - 22.221	5 (1'1") 22.221 - 22.227
5 (3'3") 22.227 - 22.366	2 (3'3") 22.366 - 24.063
Median Type and Width	
4 (200') 22.227 - 22.331	
Through Lanes	
2 1.31 - 24.063	
Street Name	
MADISON RD 1.31 - 22.331	THOMPSON RD 22.331 - 22.356
MADISON RD 22.356 - 24.063	

Non-divided Highway	Bridge (on route)	Railroad (at grade)	Intersection
Divided Highway	Underpass	Railroad (underpass)	
Secondary Segment	Overpass	Railroad (overpass)	
Corporation			

Created on: 6/27/2025

transportation.ohio.gov

Prepared by
The Ohio Department of Transportation
Office of Technical Services
Roadway Information

SGEASR00528**C

State True Log
County True Log

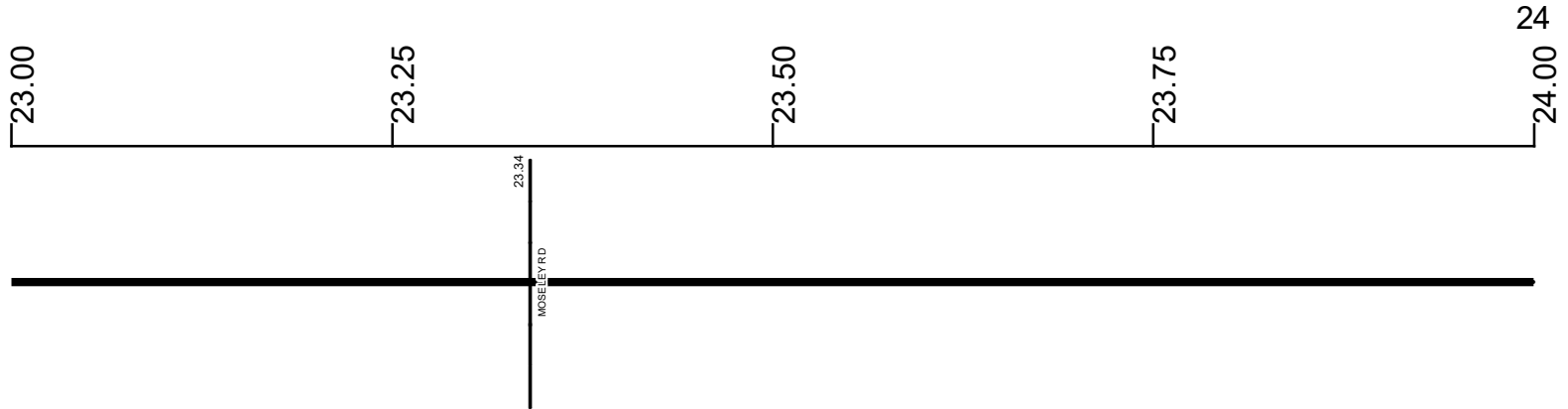

Surface Type & Width (Left / Right)

G (10/12')
22.366 - 24.063

Base Type (Left / Right)

N / K
22.366 - 24.063

Shoulder Type & Width (Left / Right)

2 (3/3')
22.366 - 24.063

Through Lanes

2
1.31 - 24.063

Street Name

MADISON RD
22.356 - 24.063

- | | | | |
|---------------------|-------------------|----------------------|--------------|
| Non-divided Highway | Bridge (on route) | Railroad (at grade) | Intersection |
| Divided Highway | Underpass | Railroad (underpass) | |
| Secondary Segment | Overpass | Railroad (overpass) | |
| Corporation | | | |

Created on: 6/27/2025



transportation.ohio.gov
Prepared by
The Ohio Department of Transportation
Office of Technical Services
Roadway Information

SGEASR00528**C

State True Log

24.063

County True Log

24.00

24.25

24.50

24.75

25.00



Surface Type & Width (Left / Right)

G (10/12')

22.366 - 24.063

Base Type (Left / Right)

N / K

22.366 - 24.063

Shoulder Type & Width (Left / Right)

2 (3/3')

22.366 - 24.063

Through Lanes

2

1.31 - 24.063

Street Name

MADISON RD

22.356 - 24.063

- Non-divided Highway
 Bridge (on route)
 Railroad (at grade)
 Intersection
- Divided Highway
 Underpass
 Railroad (underpass)
- Secondary Segment
 Overpass
 Railroad (overpass)
- Corporation**

Created on: 6/27/2025



transportation.ohio.gov
 Prepared by
 The Ohio Department of Transportation
 Office of Technical Services
 Roadway Information

Historical Project List for SGEASR00528**C

Begin Measure	End Measure	Project ID Number	Construction Completion Date	Treatment Category	Treatment Type
1.310	6.362	90908	5-2017	Minor Rehabilitation	38-Fine Poly AC Overlay
1.310	6.362	21753	9-2007	Minor Rehabilitation	60-AC Overlay w/Rpr
6.362	11.495	84280	3-2012	Minor Rehabilitation	60-AC Overlay w/Rpr
11.495	14.520	103305	10-2022	Minor Rehabilitation	38-Fine Poly AC Overlay
11.495	16.499	85216	1-2015	Minor Rehabilitation	60-AC Overlay w/Rpr
16.499	24.063	85217	11-2018	Minor Rehabilitation	60-AC Overlay w/Rpr

Roadway Codes

Access Control Journalized

- F - Full Access Control
- L - Limited Access Control
- N - No Access Control

Access Control Operational

- 1 - Full Access Control
- 2 - Partial Access Control
- 3 - No Access Control

Base Type

- F - Crack and Seat
- H - Rubblize and Roll
- I - Aggregate Base 304 or Traffic Compacted
- K - Water Bound Macadam
- L - Bituminous Concrete Mix or Penetration Macadam
- N - Plain Concrete
- P - Reinforced Concrete
- R - Brick (Flexible)
- T - Brick (Rigid)

Direction of Travel

- B - Both (Two-way)
- F - One-way Cardinal
- T - One-way Non-cardinal

Facility Type

- 1 - One-way Roadway
- 2 - Two-way Roadway
- 4 - Ramp
- 5 - Non-mainline
- 6 - Non-inventory Direction
- 7 - Planned / Unbuilt

Historical Federal Aid Indicator

- N - Not a FAP Route
- Y - FAP Route

Functional Classification

- 01 - Interstate
- 02 - Principal Arterial (Freeways)
- 03 - Principal Arterial (Other)
- 04 - Minor Arterial
- 05 - Major Collector
- 06 - Minor Collector
- 07 - Local

Leave / Reenter Indicator

- Y - Route leaves/reenters at this point
- N - Route does not leave/reenter at this point

Median Type

- 1 - None
- 2 - Unprotected
- 3 - Curbed
- 4 - Positive Barrier (Unspecified)
- 5 - Positive Barrier (Flexible)
- 6 - Positive Barrier (Semi-rigid)
- 7 - Positive Barrier (Rigid)

NHS

- N - National Highway System
- H - Congressional Corridor
- 2 - Major Airport
- 3 - Major Port Facility
- 4 - Major Amtrak Station
- 5 - Major Rail / Truck Terminal
- 6 - Major Intercity Bus Terminal
- 7 - Major Public Transit / Multi-modal Passenger Terminal
- 8 - Major Pipeline Terminal
- 9 - Major Ferry Terminal

Priority System

- G - General
- P - Priority System
- U - Urban

Scenic Byway Code

- A - All American Road
- N - National Scenic Byway
- S - State Scenic Byway

Shoulder Type

- 1 - None
- 2 - Surfaced shoulder exists (bituminous concrete {AC})
- 3 - Surfaced shoulder exists (Portland Cement Concrete {PCC})
- 4 - Stabilized shoulder exists (gravel or other granular material)
- 5 - Combination shoulder exists (two or more surface types)
- 6 - Earth shoulder exists
- 7 - Barrier curb exists; no shoulder in front of curb

Surface Type

- A - Combination
- B - Brick
- C - Continuous Reinforced Concrete
- D - Reinforced Concrete
- E - Plain Concrete
- G - Bituminous Concrete
- I - Chipseal on Granular
- K - Open Graded Bituminous
- L - Chipseal or Micro
- M - Gravel
- U - Unimproved
- X - Right of Way Only