

# SHAMSR00264\*\*C

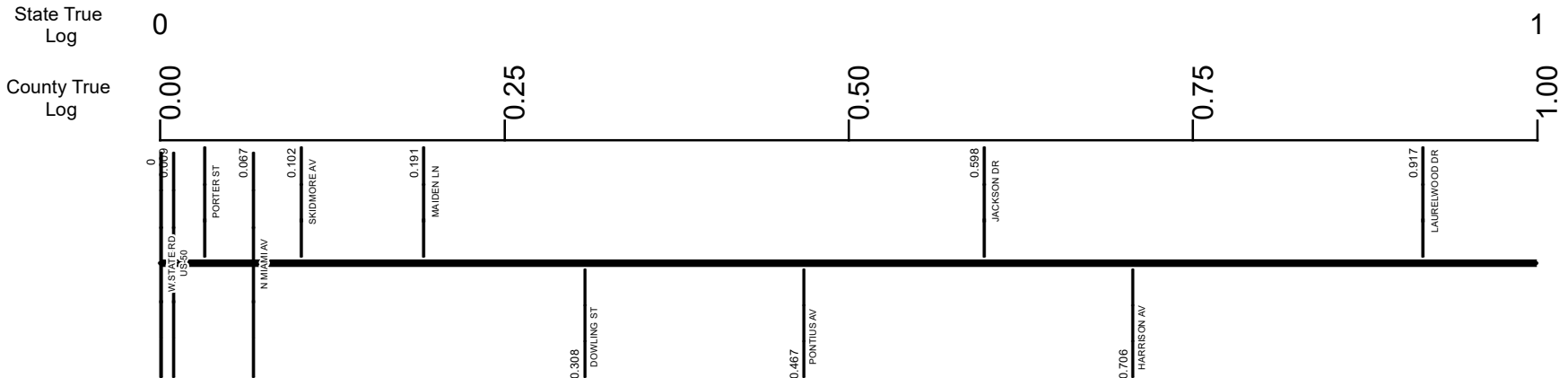

**Surface Type & Width (Left / Right)**

G 42'	G 20'
0 - 0.09	0.09 - 5.81

**Base Type (Left / Right)**

P	K	N
0 - 0.09	0.09 - 0.905	0.905 - 5.81

**Shoulder Type & Width (Left / Right)**

1 (0'/0')	2 (2'/2')	2 (1'/2')
0 - 0.09	0.09 - 0.905	0.905 - 1.145

**Resurface Year**

	2021
	0 - 1.084

**Through Lanes**

4	2
0 - 0.09	0.09 - 6.874

**Street Name**

W STATE RD	E STATE RD
0 - 0.067	0.067 - 1.077

- Non-divided Highway
- Divided Highway
- Secondary Segment
- Corporation
- Bridge (on route)
- Underpass
- Overpass
- Railroad (at grade)
- Railroad (underpass)
- Railroad (overpass)
- Intersection

Created on: 6/30/2025

transportation.ohio.gov

Prepared by  
The Ohio Department of Transportation  
Office of Technical Services  
Roadway Information

# SHAMSR00264\*\*C

State True Log

County True Log

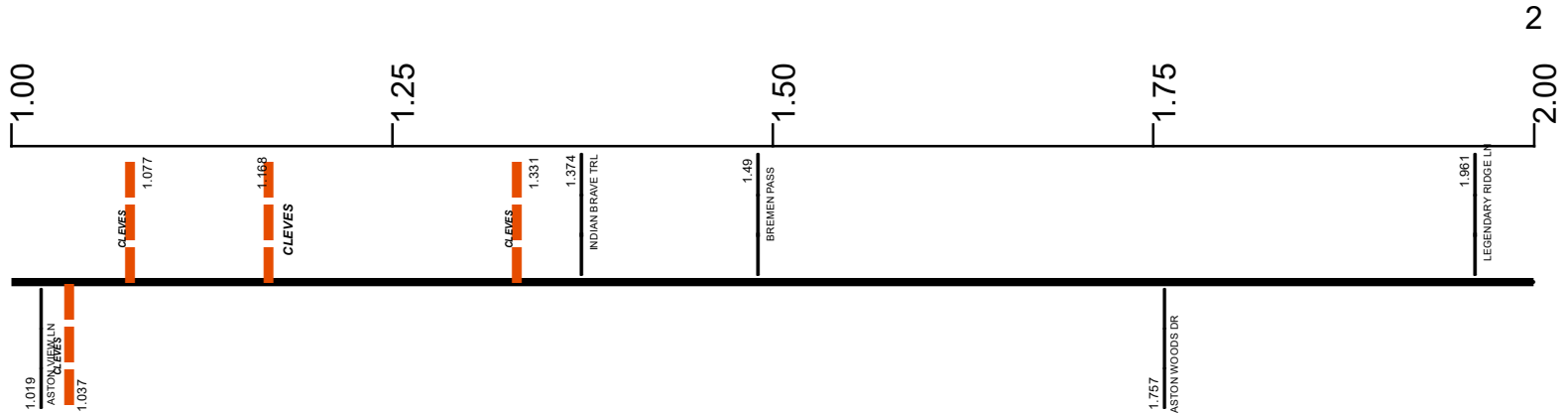

**Surface Type & Width (Left / Right)**

G 20'  
0.09 - 5.81

**Base Type (Left / Right)**

N  
0.905 - 5.81

**Shoulder Type & Width (Left / Right)**

2 (1/2')	2 (3/3')
0.905 - 1.145	1.145 - 5.81

**Resurface Year**

2021  
0 - 1.084

**Through Lanes**

2  
0.09 - 6.874

**Street Name**

E STATE RD	BRIDGETOWN RD	
0.067 - 1.077	1.077 - 8.003	

- Non-divided Highway
- Divided Highway
- Secondary Segment
- Corporation
- Bridge (on route)
- Underpass
- Overpass
- Railroad (at grade)
- Railroad (underpass)
- Railroad (overpass)
- Intersection

Created on: 6/30/2025

transportation.ohio.gov

Prepared by  
The Ohio Department of Transportation  
Office of Technical Services  
Roadway Information

# SHAMSR00264\*\*C

State True Log

County True Log

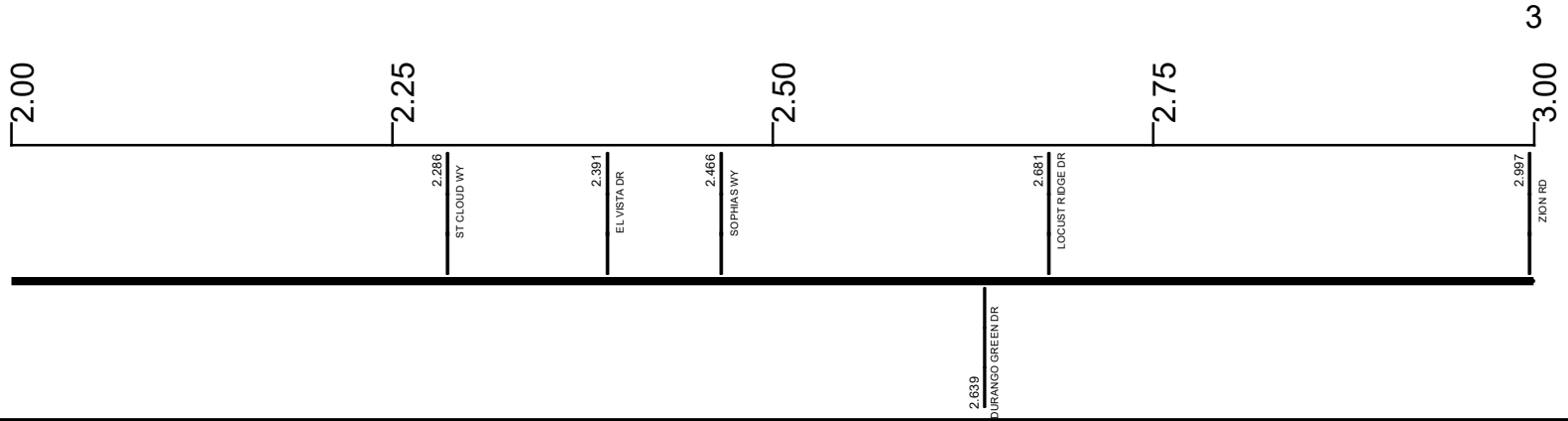

Surface Type & Width (Left / Right)

G 20'  
0.09 - 5.81

Base Type (Left / Right)

N  
0.905 - 5.81

Shoulder Type & Width (Left / Right)

2 (3/3)  
1.145 - 5.81

Resurface Year

2022  
2.313 - 2.32

Through Lanes

2  
0.09 - 6.874

Street Name

BRIDGETOWN RD  
1.077 - 8.003

- |                     |                   |                      |              |
|---------------------|-------------------|----------------------|--------------|
| Non-divided Highway | Bridge (on route) | Railroad (at grade)  | Intersection |
| Divided Highway     | Underpass         | Railroad (underpass) |              |
| Secondary Segment   | Overpass          | Railroad (overpass)  |              |
| Corporation         |                   |                      |              |

Created on: 6/30/2025



transportation.ohio.gov  
Prepared by  
The Ohio Department of Transportation  
Office of Technical Services  
Roadway Information

# SHAMSR00264\*\*C

State True Log

4

County True Log

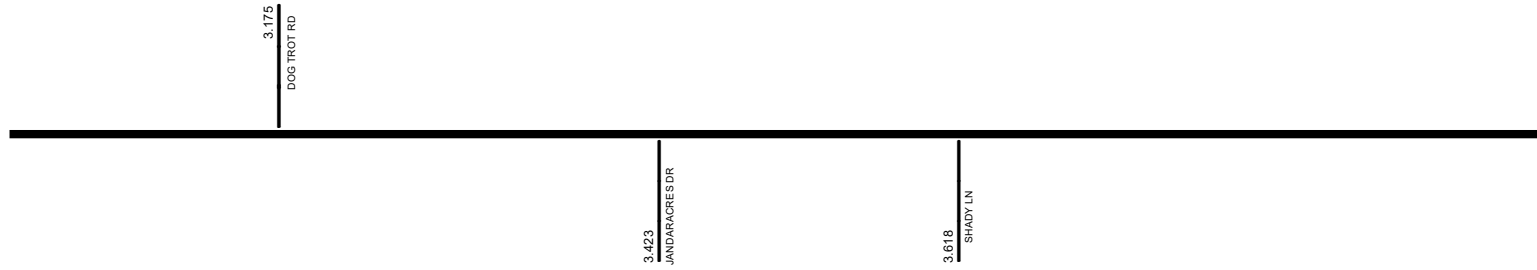

Surface Type & Width (Left / Right)	G 20' 0.09 - 5.81
Base Type (Left / Right)	N 0.905 - 5.81
Shoulder Type & Width (Left / Right)	2 (3/3) 1.145 - 5.81
Through Lanes	2 0.09 - 6.874
Street Name	BRIDGETOWN RD 1.077 - 8.003

- Non-divided Highway
- Divided Highway
- Secondary Segment
- Corporation
- Bridge (on route)
- Underpass
- Overpass
- Railroad (at grade)
- Railroad (underpass)
- Railroad (overpass)
- Intersection

Created on: 6/30/2025

transportation.ohio.gov  
Prepared by  
The Ohio Department of Transportation  
Office of Technical Services  
Roadway Information

# SHAMSR00264\*\*C

State True Log

County True Log

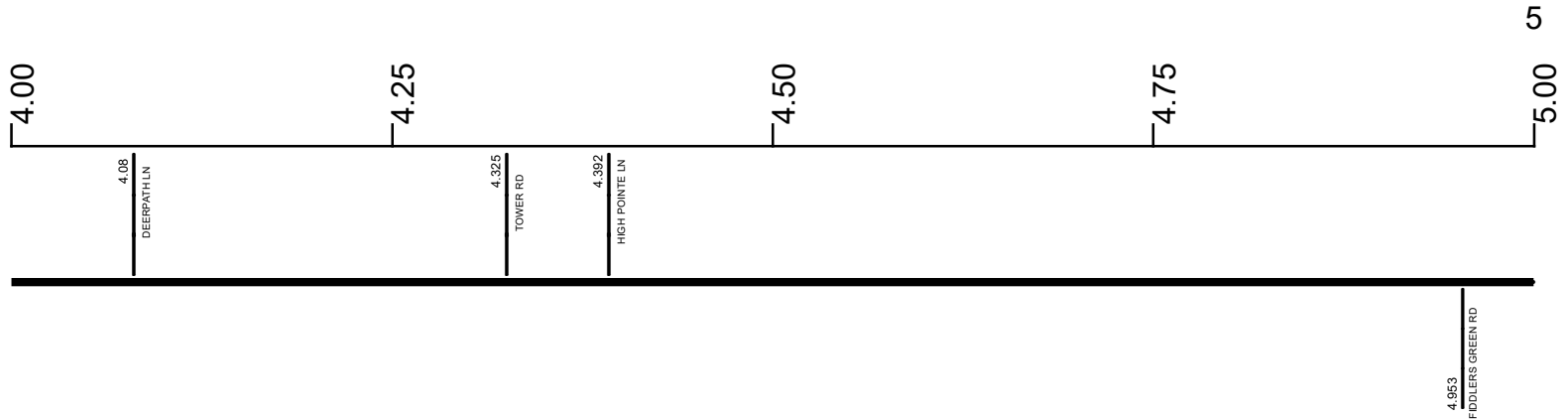

Surface Type & Width (Left / Right)

G 20'  
0.09 - 5.81

Base Type (Left / Right)

N  
0.905 - 5.81

Shoulder Type & Width (Left / Right)

2 (3/3)  
1.145 - 5.81

Resurface Year  
2022  
4.915 - 4.918

Through Lanes

2  
0.09 - 6.874

Street Name

BRIDGETOWN RD  
1.077 - 8.003

- |                     |                   |                      |              |
|---------------------|-------------------|----------------------|--------------|
| Non-divided Highway | Bridge (on route) | Railroad (at grade)  | Intersection |
| Divided Highway     | Underpass         | Railroad (underpass) |              |
| Secondary Segment   | Overpass          | Railroad (overpass)  |              |
| Corporation         |                   |                      |              |

Created on: 6/30/2025



transportation.ohio.gov  
Prepared by  
The Ohio Department of Transportation  
Office of Technical Services  
Roadway Information

# SHAMSR00264\*\*C

State True Log

6

County True Log

5.00

5.25

5.50

5.75

6.00

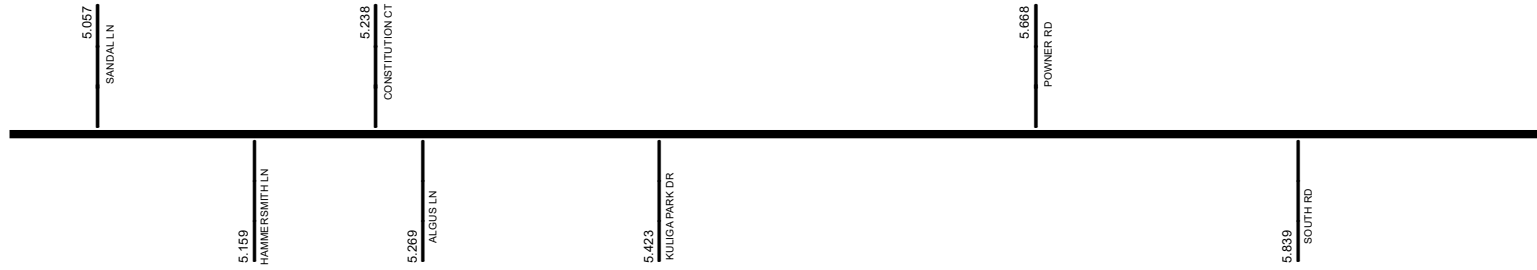

**Surface Type & Width (Left / Right)**

G 20'	G (20'/24')	G (20'/12')
0.09 - 5.81	5.81 - 5.939	5.939 - 6.018

**Base Type (Left / Right)**

N	N / L
0.905 - 5.81	5.81 - 6.018

**Shoulder Type & Width (Left / Right)**

2 (3'/3')	1 (0'/0')
1.145 - 5.81	5.81 - 6.018

**Through Lanes**

	2	
	0.09 - 6.874	

**Street Name**

	BRIDGETOWN RD	
	1.077 - 8.003	

- Non-divided Highway
- Divided Highway
- Secondary Segment
- Corporation
- Bridge (on route)
- Underpass
- Overpass
- Railroad (at grade)
- Railroad (underpass)
- Railroad (overpass)
- Intersection

Created on: 6/30/2025

transportation.ohio.gov

Prepared by  
The Ohio Department of Transportation  
Office of Technical Services  
Roadway Information

# SHAMSR00264\*\*C

State True Log

County True Log

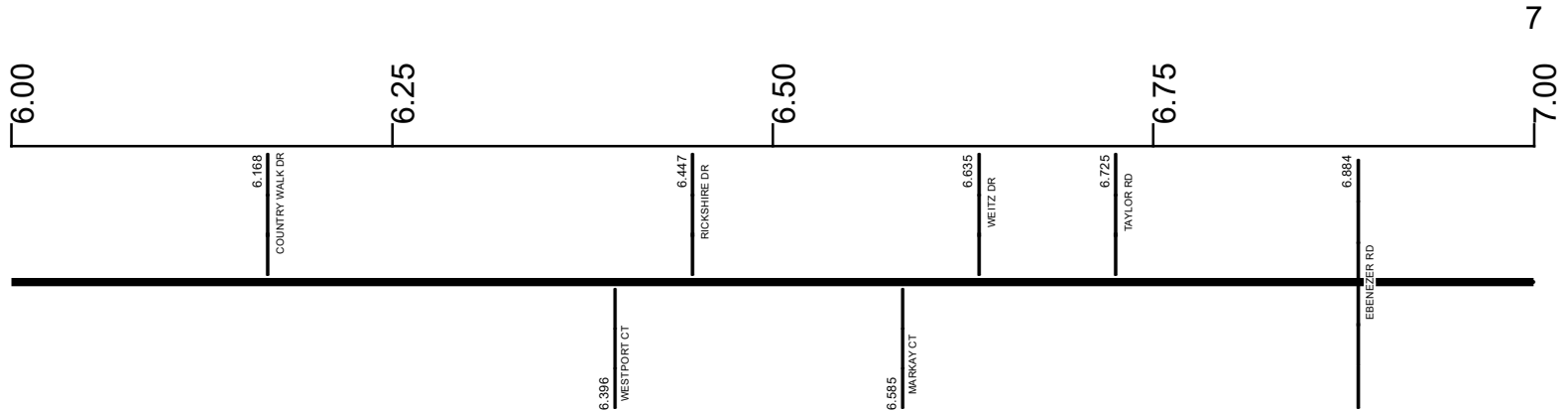

**Surface Type & Width (Left / Right)**

G (20'/12')	G 20'	G 40'
5.939 - 6.018	6.018 - 6.874	6.874 - 8.003

**Base Type (Left / Right)**

N/L	N
5.81 - 6.018	6.018 - 8.003

**Shoulder Type & Width (Left / Right)**

1 (0'/0')	2 (3'/3')	1 (0'/0')
5.81 - 6.018	6.018 - 6.874	6.874 - 14.638

**Through Lanes**

2	4
0.09 - 6.874	6.874 - 14.308

**Street Name**

BRIDGETOWN RD
1.077 - 8.003

- Non-divided Highway
- Divided Highway
- Secondary Segment
- Corporation
- Bridge (on route)
- Underpass
- Overpass
- Railroad (at grade)
- Railroad (underpass)
- Railroad (overpass)
- Intersection

Created on: 6/30/2025

transportation.ohio.gov

Prepared by  
The Ohio Department of Transportation  
Office of Technical Services  
Roadway Information

# SHAMSR00264\*\*C

State True Log

County True Log

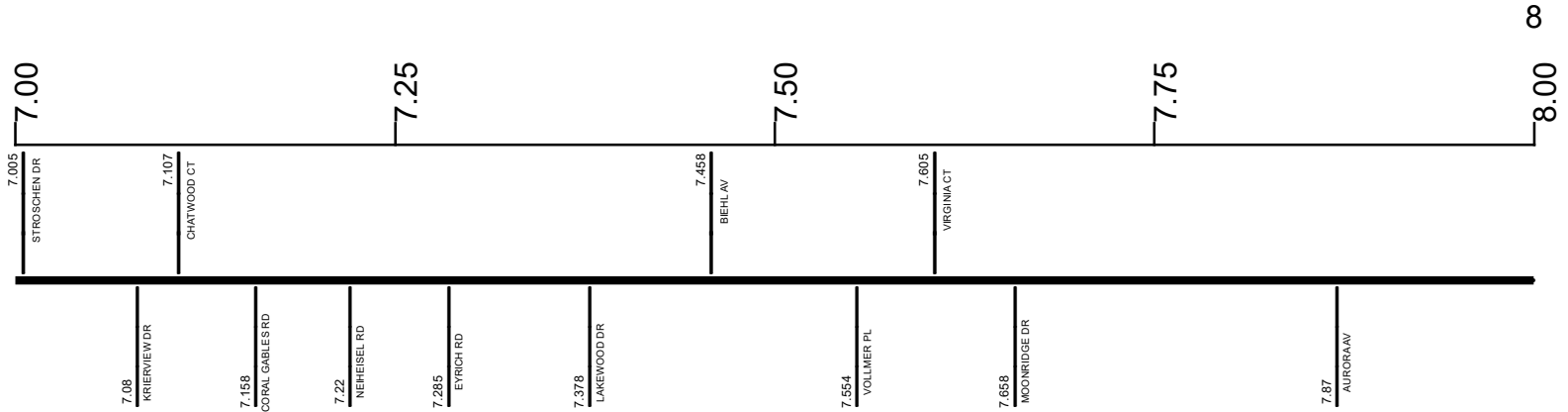

Surface Type & Width (Left / Right)

G 40'  
6.874 - 8.003

Base Type (Left / Right)

N  
6.018 - 8.003

Shoulder Type & Width (Left / Right)

1 (0/0)  
6.874 - 14.638

Through Lanes

4  
6.874 - 14.308

Street Name

BRIDGETOWN RD  
1.077 - 8.003

- |                     |                   |                      |              |
|---------------------|-------------------|----------------------|--------------|
| Non-divided Highway | Bridge (on route) | Railroad (at grade)  | Intersection |
| Divided Highway     | Underpass         | Railroad (underpass) |              |
| Secondary Segment   | Overpass          | Railroad (overpass)  |              |
| Corporation         |                   |                      |              |

Created on: 6/30/2025



transportation.ohio.gov  
 Prepared by  
 The Ohio Department of Transportation  
 Office of Technical Services  
 Roadway Information

# SHAMSR00264\*\*C

State True Log

County True Log

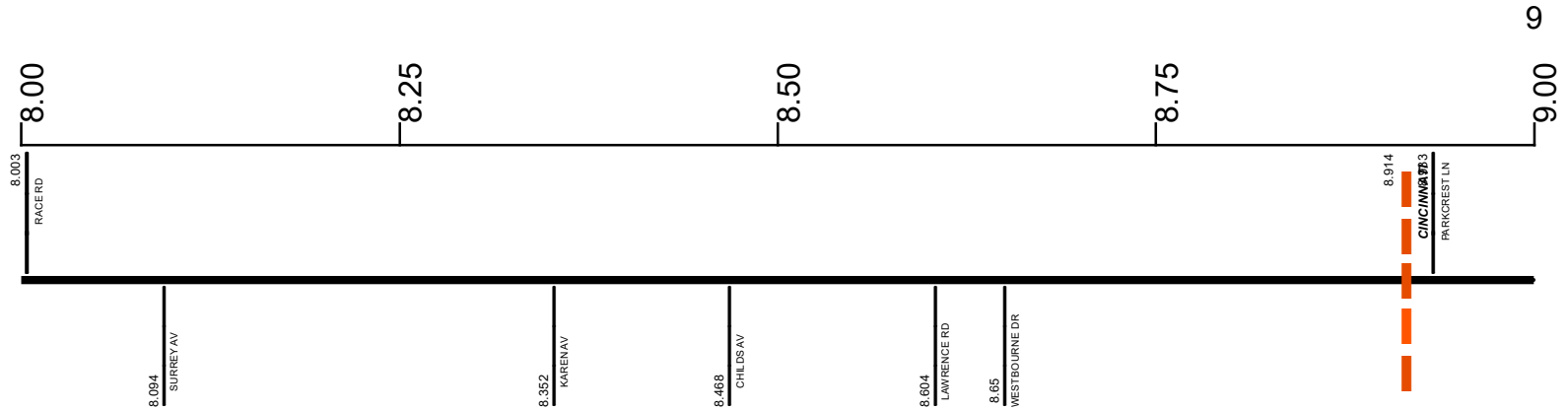

**Surface Type & Width (Left / Right)**

G 40'	G (30'/29')	G 70'	G (30'/29')
8.003 - 8.513		8.513 - 8.708	8.708 - 9.401

**Base Type (Left / Right)**

N	P / I
6.018 - 8.003	8.003 - 9.401

**Shoulder Type & Width (Left / Right)**

1 (0'/0')
6.874 - 14.638

**Through Lanes**

4
6.874 - 14.308

**Street Name**

BRIDGETOWN RD	GLENWAY AVE
1.077 - 8.003	8.003 - 10.435

- Non-divided Highway
- Divided Highway
- Secondary Segment
- Corporation
- Bridge (on route)
- Underpass
- Overpass
- Railroad (at grade)
- Railroad (underpass)
- Railroad (overpass)
- Intersection

Created on: 6/30/2025



transportation.ohio.gov  
Prepared by  
The Ohio Department of Transportation  
Office of Technical Services  
Roadway Information

# SHAMSR00264\*\*C

State True Log

County True Log

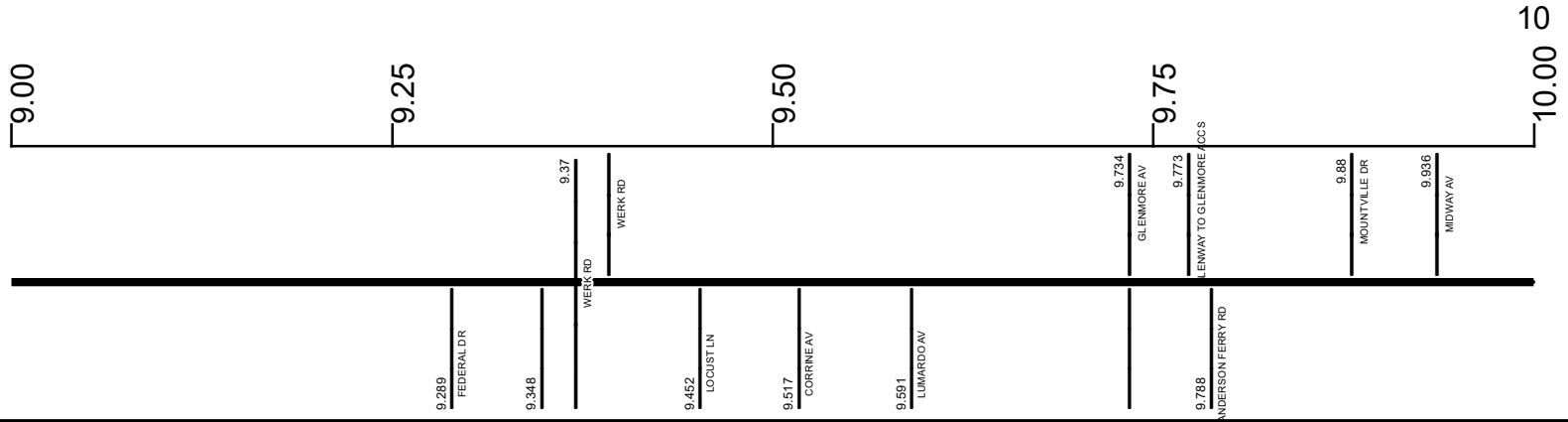

**Surface Type & Width (Left / Right)**

G (30'/29') 8.708 - 9.401	G (30'/18') 9.401 - 10.616
------------------------------	-------------------------------

**Base Type (Left / Right)**

P / I 8.003 - 9.401	P / N 9.401 - 10.616
------------------------	-------------------------

**Shoulder Type & Width (Left / Right)**

1 (0'/0') 6.874 - 14.638
-----------------------------

**Through Lanes**

4 6.874 - 14.308
---------------------

**Street Name**

GLENWAY AVE 8.003 - 10.435
-------------------------------

- Non-divided Highway
- Divided Highway
- Secondary Segment
- Corporation
- Bridge (on route)
- Underpass
- Overpass
- Railroad (at grade)
- Railroad (underpass)
- Railroad (overpass)
- Intersection

Created on: 6/30/2025

transportation.ohio.gov

Prepared by  
The Ohio Department of Transportation  
Office of Technical Services  
Roadway Information

# SHAMSR00264\*\*C

State True Log  
County True Log

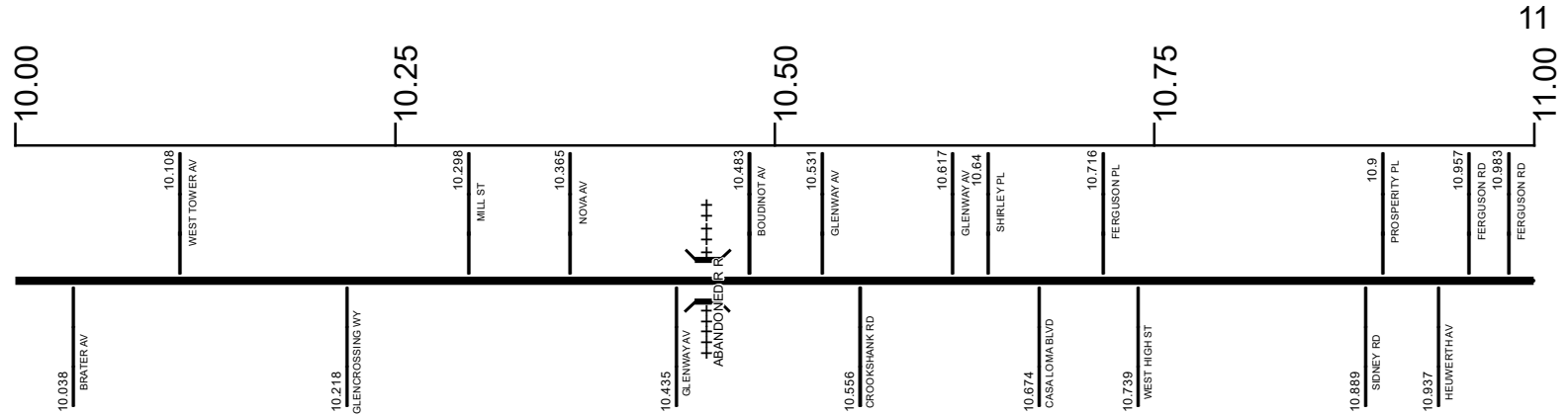

**Surface Type & Width (Left / Right)**

G (30'/18")	G (22'/23")
9.401 - 10.616	10.616 - 12.53

**Base Type (Left / Right)**

P / N	P
9.401 - 10.616	10.616 - 14.517

**Shoulder Type & Width (Left / Right)**

1 (0'/0')
6.874 - 14.638

**Through Lanes**

4
6.874 - 14.308

**Street Name**

GLENWAY AVE	GLENHILLS WAY	BOUDINOT AVE	GLENWAY AVE
8.003 - 10.435	10.435 - 10.483	10.483 - 10.556	10.556 - 14.289

- Non-divided Highway
- Divided Highway
- Secondary Segment
- Corporation
- Bridge (on route)
- Underpass
- Overpass
- Railroad (at grade)
- Railroad (underpass)
- Railroad (overpass)
- Intersection

Created on: 6/30/2025

transportation.ohio.gov

Prepared by  
The Ohio Department of Transportation  
Office of Technical Services  
Roadway Information

# SHAMSR00264\*\*C

State True Log  
County True Log

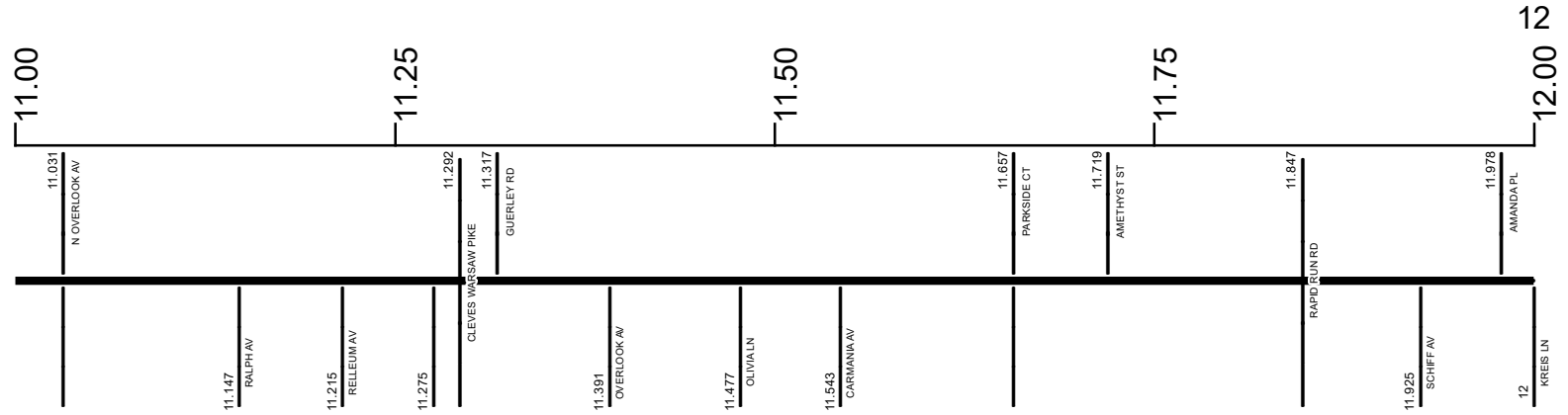

**Surface Type & Width (Left / Right)**

G (22'/23')  
10.616 - 12.53

**Base Type (Left / Right)**

P  
10.616 - 14.517

**Shoulder Type & Width (Left / Right)**

1 (0'/0')  
6.874 - 14.638

**Through Lanes**

4  
6.874 - 14.308

**Street Name**

GLENWAY AVE  
10.556 - 14.289

- |                     |                   |                      |              |
|---------------------|-------------------|----------------------|--------------|
| Non-divided Highway | Bridge (on route) | Railroad (at grade)  | Intersection |
| Divided Highway     | Underpass         | Railroad (underpass) |              |
| Secondary Segment   | Overpass          | Railroad (overpass)  |              |
| Corporation         |                   |                      |              |

Created on: 6/30/2025



transportation.ohio.gov

Prepared by  
The Ohio Department of Transportation  
Office of Technical Services  
Roadway Information

# SHAMSR00264\*\*C

State True Log  
County True Log

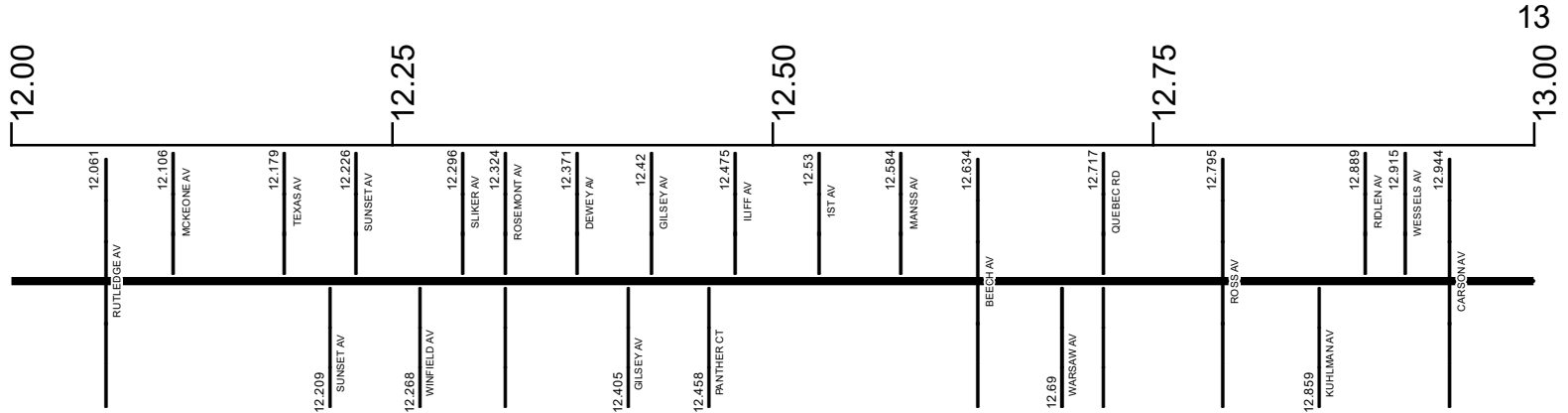

Surface Type & Width (Left / Right)	G (22'/23')
	10.616 - 12.53
	G 40'
	12.53 - 14.308
Base Type (Left / Right)	P
	10.616 - 14.517
Shoulder Type & Width (Left / Right)	1 (0'/0')
	6.874 - 14.638
Through Lanes	4
	6.874 - 14.308
Street Name	GLENWAY AVE
	10.556 - 14.289

<ul style="list-style-type: none"> <li> Non-divided Highway</li> <li> Divided Highway</li> <li> Secondary Segment</li> <li> Corporation</li> </ul>	<ul style="list-style-type: none"> <li> Bridge (on route)</li> <li> Underpass</li> <li> Overpass</li> </ul>	<ul style="list-style-type: none"> <li> Railroad (at grade)</li> <li> Railroad (underpass)</li> <li> Railroad (overpass)</li> </ul>	<ul style="list-style-type: none"> <li> Intersection</li> </ul>
--	---	---	---

Created on: 6/30/2025

transportation.ohio.gov

Prepared by  
The Ohio Department of Transportation  
Office of Technical Services  
Roadway Information

# SHAMSR00264\*\*C

State True Log

14

County True Log

13.00

13.25

13.50

13.75

14.00

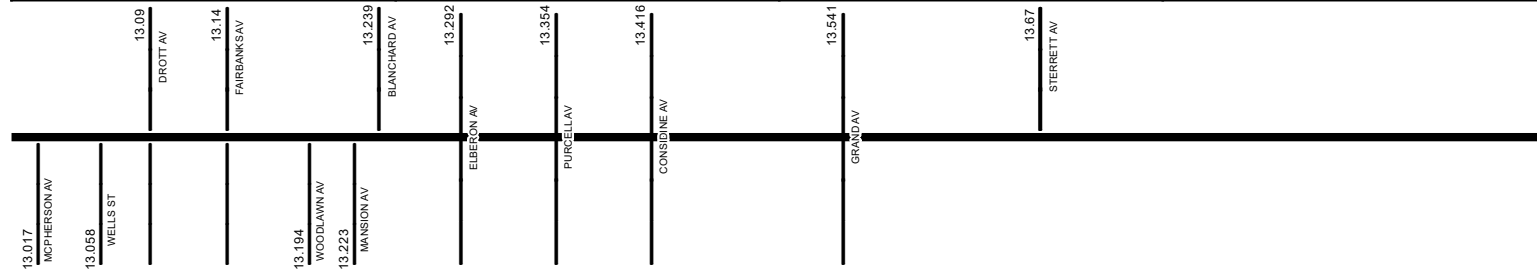

Surface Type & Width (Left / Right)

G 40'  
12.53 - 14.308

Base Type (Left / Right)

P  
10.616 - 14.517

Shoulder Type & Width (Left / Right)

1 (0'/0')  
6.874 - 14.638

Through Lanes

4  
6.874 - 14.308

Street Name

GLENWAY AVE  
10.556 - 14.289

- Non-divided Highway
  Bridge (on route)
  Railroad (at grade)
  Intersection
- Divided Highway
  Underpass
  Railroad (underpass)
- Secondary Segment
  Overpass
  Railroad (overpass)
- Corporation**

Created on: 6/30/2025



transportation.ohio.gov

Prepared by  
The Ohio Department of Transportation  
Office of Technical Services  
Roadway Information

# SHAMSR00264\*\*C

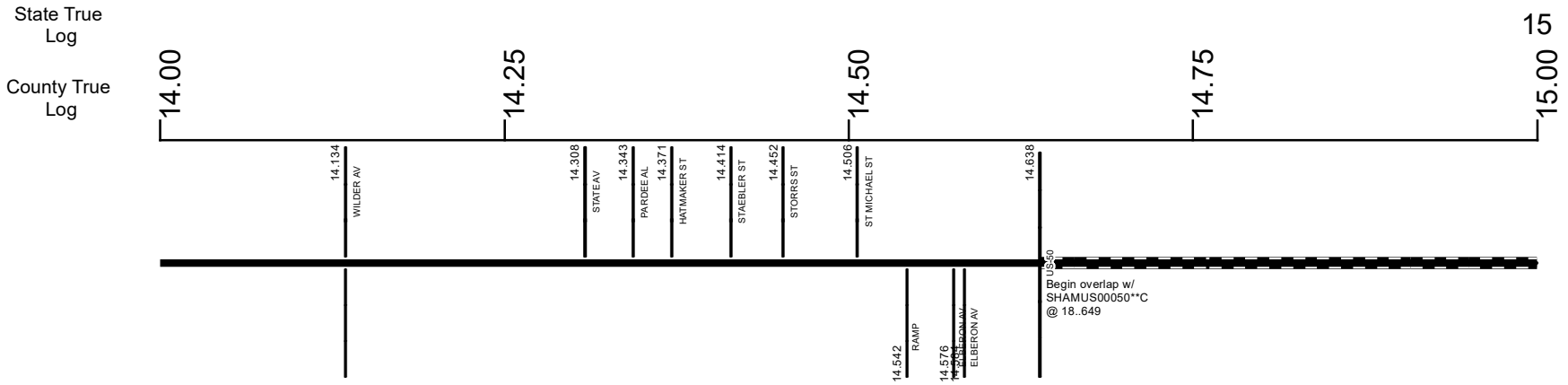

**Surface Type & Width (Left / Right)**

G 40'	G 36'	D 36'
12.53 - 14.308	14.308 - 14.517	14.517 - 14.638

**Base Type (Left / Right)**

P
10.616 - 14.517

**Shoulder Type & Width (Left / Right)**

1 (0'/0')
6.874 - 14.638

**Through Lanes**

4	2
6.874 - 14.308	14.308 - 14.638

**Street Name**

GLENWAY AVE	W 8TH ST	STATE AVE
10.556 - 14.289	14.289 - 14.308	14.308 - 14.638

Non-divided Highway	Bridge (on route)	Railroad (at grade)	Intersection
Divided Highway	Underpass	Railroad (underpass)	
Secondary Segment	Overpass	Railroad (overpass)	
Corporation			

Created on: 6/30/2025



transportation.ohio.gov  
Prepared by  
The Ohio Department of Transportation  
Office of Technical Services  
Roadway Information

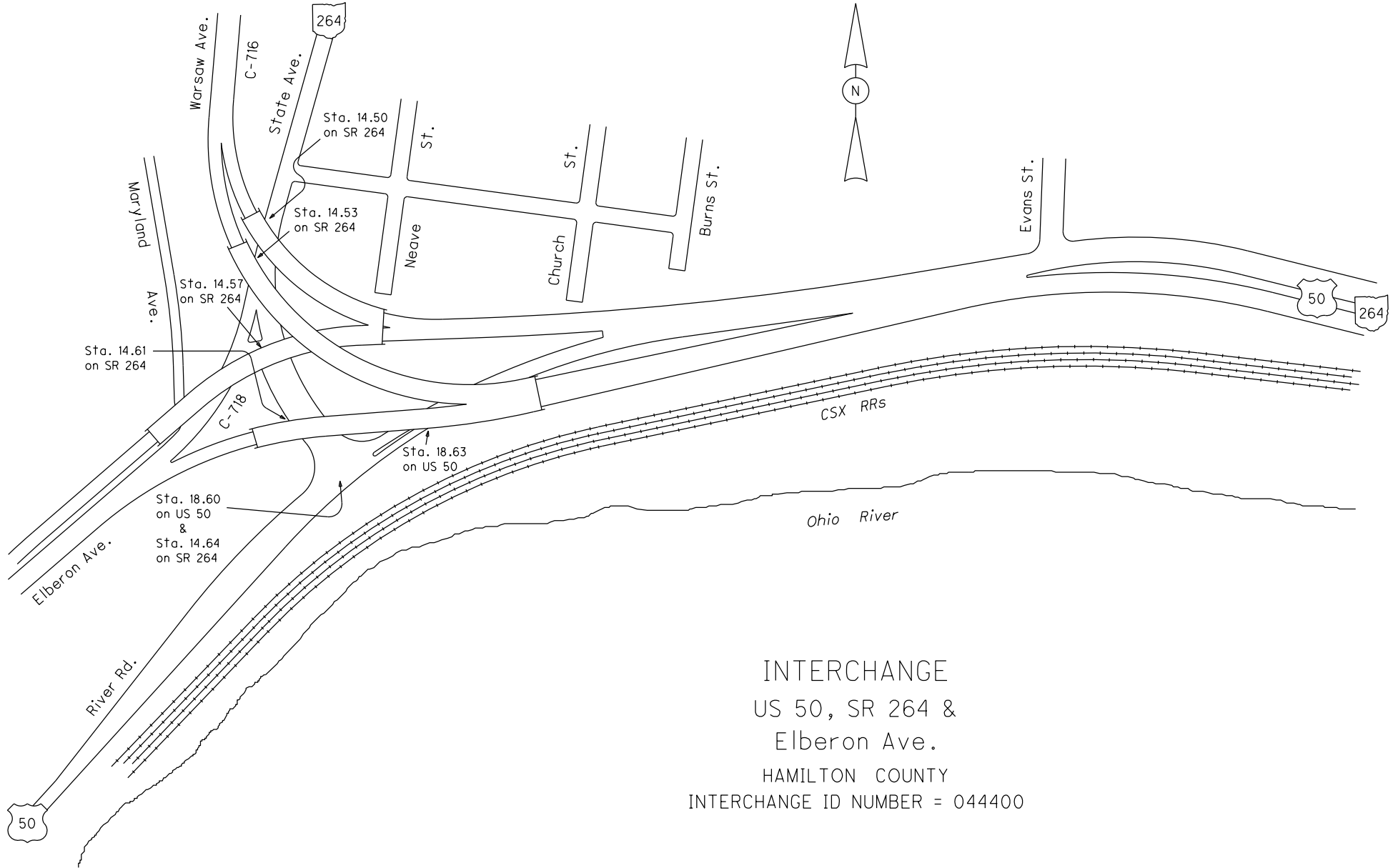

INTERCHANGE  
 US 50, SR 264 &  
 Elberon Ave.  
 HAMILTON COUNTY  
 INTERCHANGE ID NUMBER = 044400

US50 SHEET 5 OF 13  
 SR264 SHEET 3 OF 4

REVISED Jan 2014

# SHAMSR00264\*\*C

State True Log  
County True Log

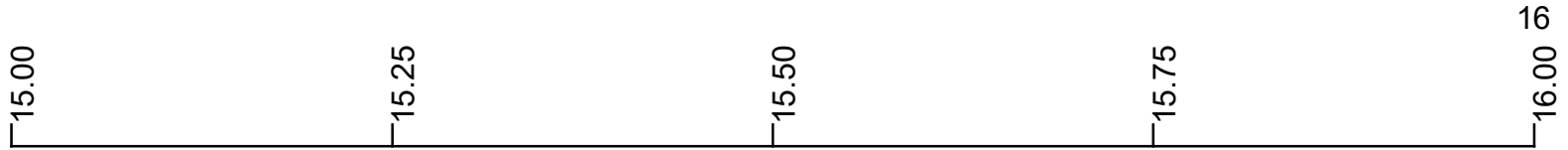

- |                     |                   |                      |              |
|---------------------|-------------------|----------------------|--------------|
| Non-divided Highway | Bridge (on route) | Railroad (at grade)  | Intersection |
| Divided Highway     | Underpass         | Railroad (underpass) |              |
| Secondary Segment   | Overpass          | Railroad (overpass)  |              |
| <b>Corporation</b>  |                   |                      |              |

Created on: 6/30/2025



transportation.ohio.gov  
Prepared by  
The Ohio Department of Transportation  
Office of Technical Services  
Roadway Information

# SHAMSR00264\*\*C

State True Log  
County True Log

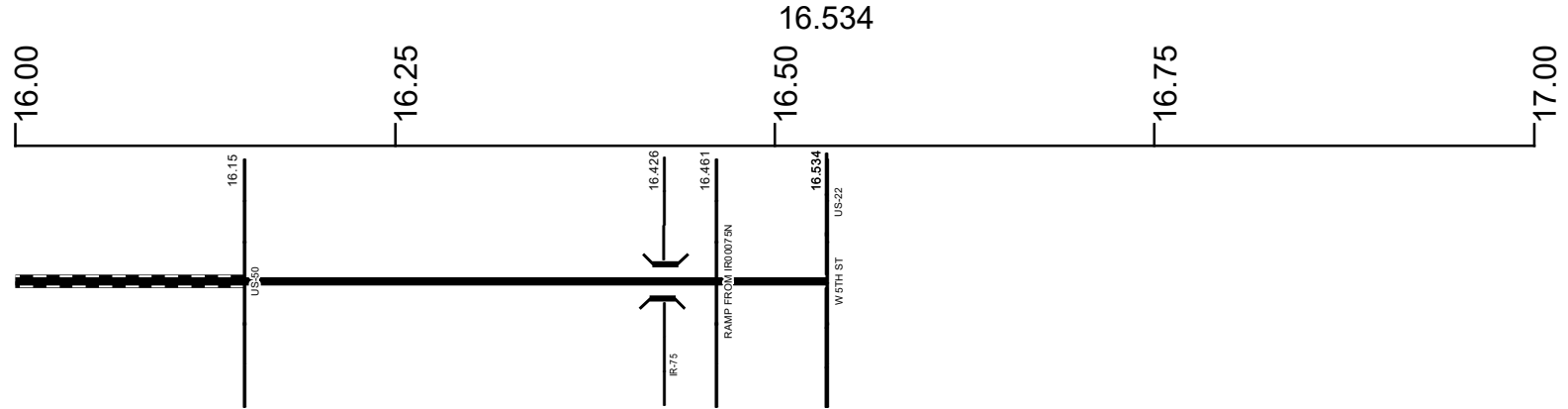

Surface Type & Width (Left / Right)	
G 20'	G (14'/15')
16.15 - 16.219	16.219 - 16.534
Base Type (Left / Right)	
P	
16.219 - 16.534	
Shoulder Type & Width (Left / Right)	
1 (0'/8')	
16.15 - 16.534	
Through Lanes	
2	
16.15 - 16.534	
Street Name	
W 6TH EB ST TO W 5TH ST RAMP	W 5TH ST
16.15 - 16.461	16.461 - 16.534

- |  |   |   |   |
|--|---|---|---|
| <ul style="list-style-type: none"> <li> Non-divided Highway</li> <li> Divided Highway</li> <li> Secondary Segment</li> <li> Corporation</li> </ul> | <ul style="list-style-type: none"> <li> Bridge (on route)</li> <li> Underpass</li> <li> Overpass</li> </ul> | <ul style="list-style-type: none"> <li> Railroad (at grade)</li> <li> Railroad (underpass)</li> <li> Railroad (overpass)</li> </ul> | <ul style="list-style-type: none"> <li> Intersection</li> </ul> |
|--|---|---|---|

Created on: 6/30/2025

transportation.ohio.gov

Prepared by  
The Ohio Department of Transportation  
Office of Technical Services  
Roadway Information

INTERCHANGES  
US 50, SR 264, Harriet  
St., Freeman Ave. & Linn St.  
HAMILTON COUNTY  
INTERCHANGE ID NUMBER = 044500

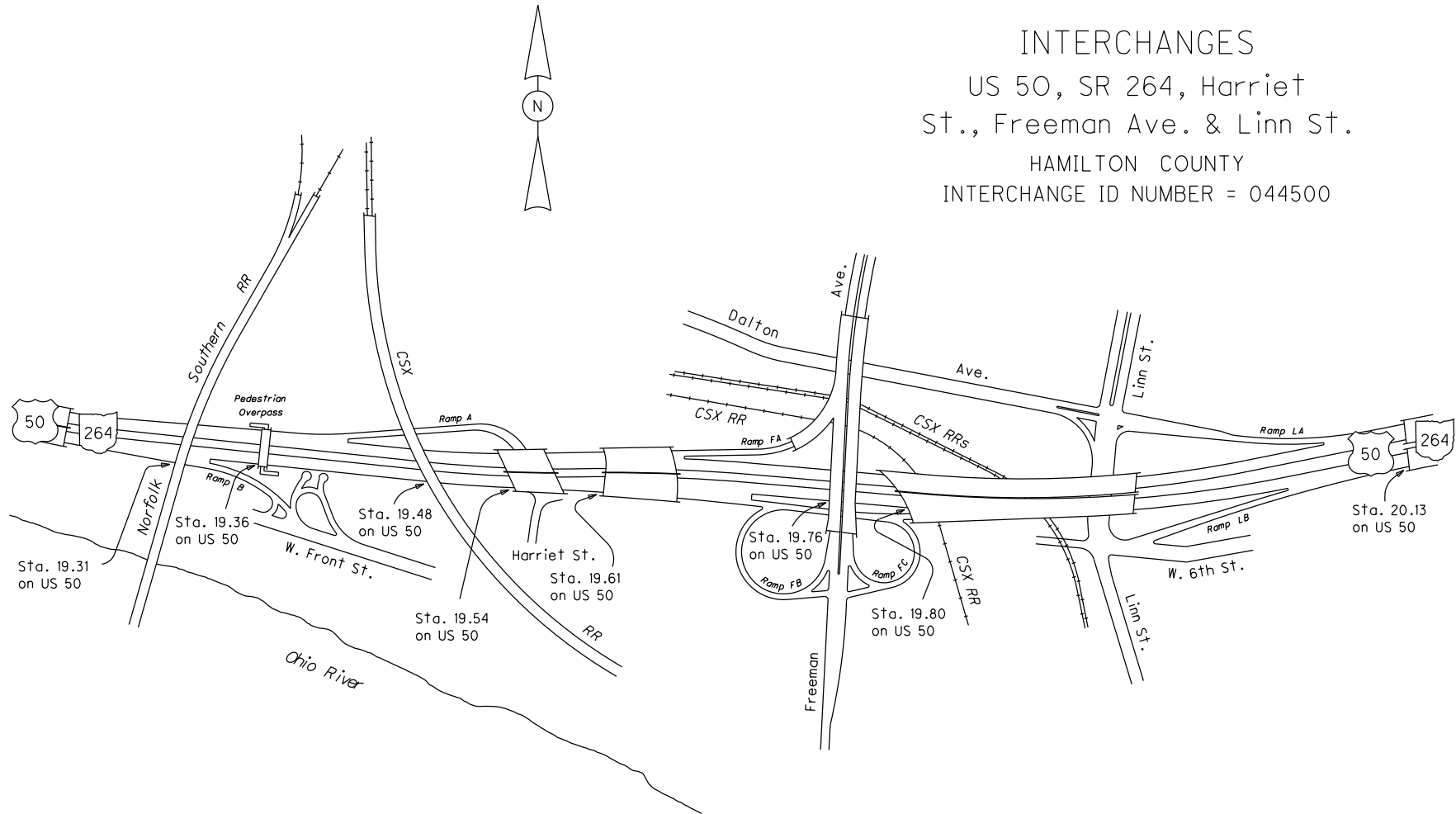

## Historical Project List for SHAMSR00264\*\*C

Begin Measure	End Measure	Project ID Number	Construction Completion Date	Treatment Category	Treatment Type
0.000	1.141	113065	7-2022	Minor Rehabilitation	60-AC Overlay w/Rpr
1.141	7.958	83518	3-2012	Minor Rehabilitation	60-AC Overlay w/Rpr
1.151	6.822	105205	12-2023	Minor Rehabilitation	50-AC Overlay w/o Rpr
6.706	7.103	88790	6-2019	Minor Rehabilitation	50-AC Overlay w/o Rpr
6.822	7.999	105205	12-2023	Minor Rehabilitation	60-AC Overlay w/Rpr
7.010	7.958	78120	8-2006	Preventive Maintenance	41-Thin AC Overlay w/o Rpr
7.999	8.900	105205	12-2023	Minor Rehabilitation	50-AC Overlay w/o Rpr
8.039	8.909	83518	3-2012	Minor Rehabilitation	60-AC Overlay w/Rpr
8.509	8.646	89905	1-2018	New Construction	200-New Pavement
8.909	10.612	96693	10-2017	Minor Rehabilitation	50-AC Overlay w/o Rpr
8.909	9.366	22832	9-2005	Minor Rehabilitation	60-AC Overlay w/Rpr
10.612	12.695	75876	11-2007	Minor Rehabilitation	60-AC Overlay w/Rpr
12.630	13.617	22832	9-2005	Minor Rehabilitation	60-AC Overlay w/Rpr
13.658	14.306	94266	5-2017	Minor Rehabilitation	50-AC Overlay w/o Rpr

# Roadway Codes

## Access Control Journalized

- F - Full Access Control
- L - Limited Access Control
- N - No Access Control

## Access Control Operational

- 1 - Full Access Control
- 2 - Partial Access Control
- 3 - No Access Control

## Base Type

- F - Crack and Seat
- H - Rubblize and Roll
- I - Aggregate Base 304 or Traffic Compacted
- K - Water Bound Macadam
- L - Bituminous Concrete Mix or Penetration Macadam
- N - Plain Concrete
- P - Reinforced Concrete
- R - Brick (Flexible)
- T - Brick (Rigid)

## Direction of Travel

- B - Both (Two-way)
- F - One-way Cardinal
- T - One-way Non-cardinal

## Facility Type

- 1 - One-way Roadway
- 2 - Two-way Roadway
- 4 - Ramp
- 5 - Non-mainline
- 6 - Non-inventory Direction
- 7 - Planned / Unbuilt

## Historical Federal Aid Indicator

- N - Not a FAP Route
- Y - FAP Route

## Functional Classification

- 01 - Interstate
- 02 - Principal Arterial (Freeways)
- 03 - Principal Arterial (Other)
- 04 - Minor Arterial
- 05 - Major Collector
- 06 - Minor Collector
- 07 - Local

## Leave / Reenter Indicator

- Y - Route leaves/reenters at this point
- N - Route does not leave/reenter at this point

## Median Type

- 1 - None
- 2 - Unprotected
- 3 - Curbed
- 4 - Positive Barrier (Unspecified)
- 5 - Positive Barrier (Flexible)
- 6 - Positive Barrier (Semi-rigid)
- 7 - Positive Barrier (Rigid)

## NHS

- N - National Highway System
- H - Congressional Corridor
- 2 - Major Airport
- 3 - Major Port Facility
- 4 - Major Amtrak Station
- 5 - Major Rail / Truck Terminal
- 6 - Major Intercity Bus Terminal
- 7 - Major Public Transit / Multi-modal Passenger Terminal
- 8 - Major Pipeline Terminal
- 9 - Major Ferry Terminal

## Priority System

- G - General
- P - Priority System
- U - Urban

## Scenic Byway Code

- A - All American Road
- N - National Scenic Byway
- S - State Scenic Byway

## Shoulder Type

- 1 - None
- 2 - Surfaced shoulder exists (bituminous concrete {AC})
- 3 - Surfaced shoulder exists (Portland Cement Concrete {PCC})
- 4 - Stabilized shoulder exists (gravel or other granular material)
- 5 - Combination shoulder exists (two or more surface types)
- 6 - Earth shoulder exists
- 7 - Barrier curb exists; no shoulder in front of curb

## Surface Type

- A - Combination
- B - Brick
- C - Continuous Reinforced Concrete
- D - Reinforced Concrete
- E - Plain Concrete
- G - Bituminous Concrete
- I - Chipseal on Granular
- K - Open Graded Bituminous
- L - Chipseal or Micro
- M - Gravel
- U - Unimproved
- X - Right of Way Only