

# SHIGSR00134\*\*C

State True Log 0.342

1.342

County True Log



Surface Type & Width (Left / Right)

G 20'  
0 - 13.973

Base Type (Left / Right)

I  
0 - 8.622

Shoulder Type & Width (Left / Right)

2 (3/3)  
0 - 13.973

Resurface Year

2022  
0 - 5.18

Through Lanes

2  
0 - 13.973

Street Name

SR 134  
0 - 13.973

- |                     |                   |                      |              |
|---------------------|-------------------|----------------------|--------------|
| Non-divided Highway | Bridge (on route) | Railroad (at grade)  | Intersection |
| Divided Highway     | Underpass         | Railroad (underpass) |              |
| Secondary Segment   | Overpass          | Railroad (overpass)  |              |
| Corporation         |                   |                      |              |

Created on: 6/30/2025

transportation.ohio.gov

Prepared by  
The Ohio Department of Transportation  
Office of Technical Services  
Roadway Information

# SHIGSR00134\*\*C

State True Log

2.342

County True Log

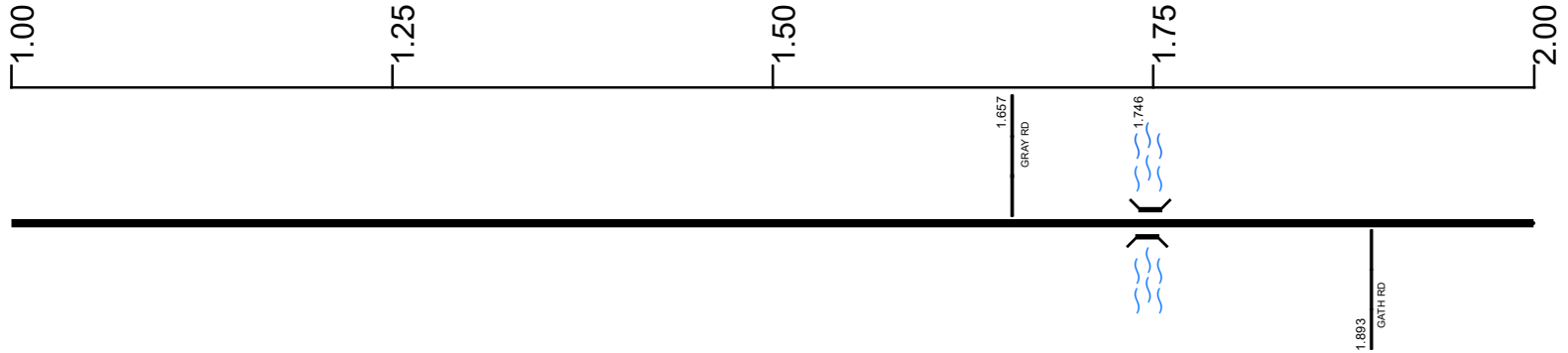

Surface Type & Width (Left / Right)

G 20'  
0 - 13.973

Base Type (Left / Right)

I  
0 - 8.622

Shoulder Type & Width (Left / Right)

2 (3/3)  
0 - 13.973

Resurface Year

2022  
0 - 5.18

Through Lanes

2  
0 - 13.973

Street Name

SR 134  
0 - 13.973

- |                     |                   |                      |              |
|---------------------|-------------------|----------------------|--------------|
| Non-divided Highway | Bridge (on route) | Railroad (at grade)  | Intersection |
| Divided Highway     | Underpass         | Railroad (underpass) |              |
| Secondary Segment   | Overpass          | Railroad (overpass)  |              |
| Corporation         |                   |                      |              |

Created on: 6/30/2025

transportation.ohio.gov

Prepared by  
The Ohio Department of Transportation  
Office of Technical Services  
Roadway Information

# SHIGSR00134\*\*C

State True Log

3.342

County True Log

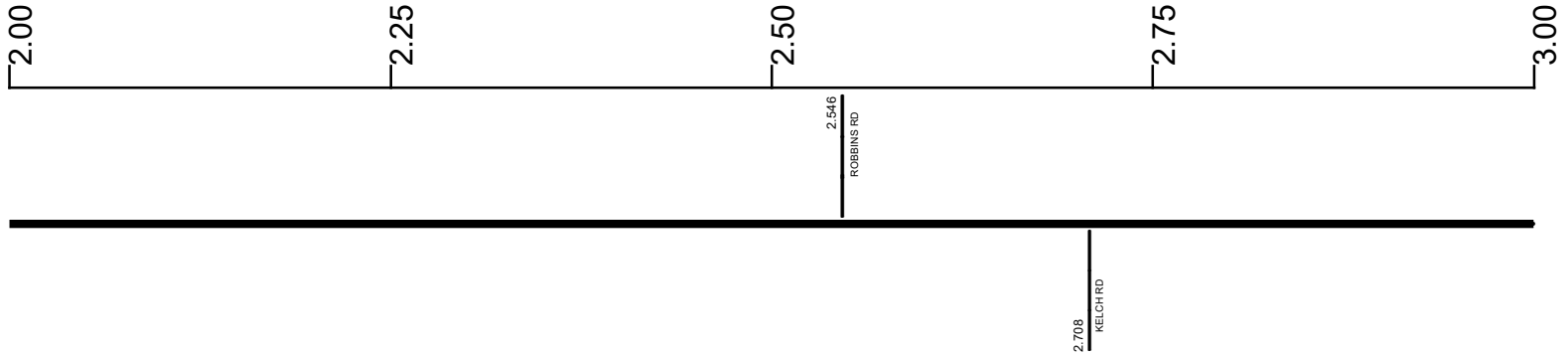

Surface Type & Width (Left / Right)

G 20'  
0 - 13.973

Base Type (Left / Right)

I  
0 - 8.622

Shoulder Type & Width (Left / Right)

2 (3/3)  
0 - 13.973

Resurface Year

2022  
0 - 5.18

Through Lanes

2  
0 - 13.973

Street Name

SR 134  
0 - 13.973

- |                     |                   |                      |              |
|---------------------|-------------------|----------------------|--------------|
| Non-divided Highway | Bridge (on route) | Railroad (at grade)  | Intersection |
| Divided Highway     | Underpass         | Railroad (underpass) |              |
| Secondary Segment   | Overpass          | Railroad (overpass)  |              |
| Corporation         |                   |                      |              |

Created on: 6/30/2025

transportation.ohio.gov

Prepared by  
The Ohio Department of Transportation  
Office of Technical Services  
Roadway Information

# SHIGSR00134\*\*C

State True Log

4.342

County True Log

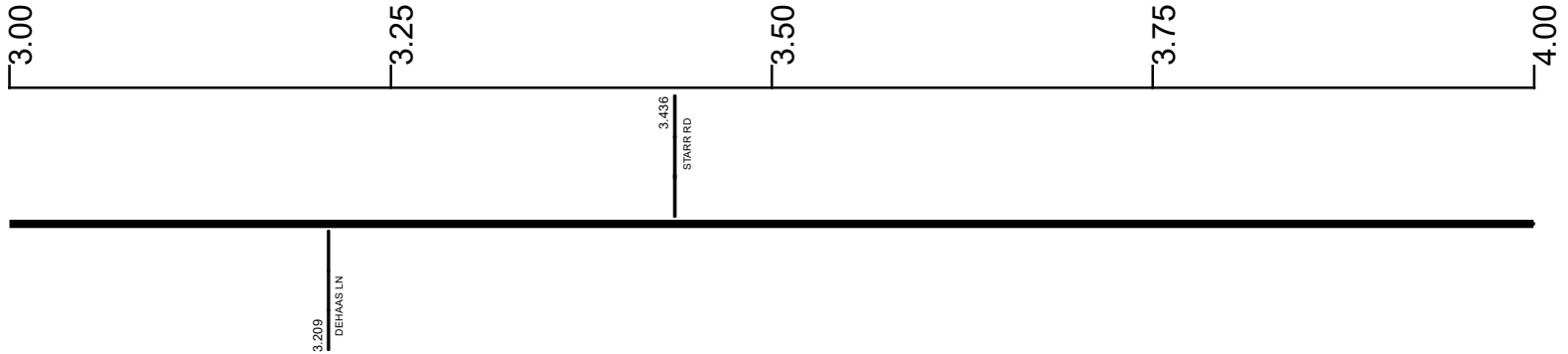

Surface Type & Width (Left / Right)

G 20'  
0 - 13.973

Base Type (Left / Right)

I  
0 - 8.622

Shoulder Type & Width (Left / Right)

2 (3/3)  
0 - 13.973

Resurface Year

2022  
0 - 5.18

Through Lanes

2  
0 - 13.973

Street Name

SR 134  
0 - 13.973

- |                     |                   |                      |              |
|---------------------|-------------------|----------------------|--------------|
| Non-divided Highway | Bridge (on route) | Railroad (at grade)  | Intersection |
| Divided Highway     | Underpass         | Railroad (underpass) |              |
| Secondary Segment   | Overpass          | Railroad (overpass)  |              |
| Corporation         |                   |                      |              |

Created on: 6/30/2025

transportation.ohio.gov

Prepared by  
The Ohio Department of Transportation  
Office of Technical Services  
Roadway Information

# SHIGSR00134\*\*C

State True Log

5.342

County True Log

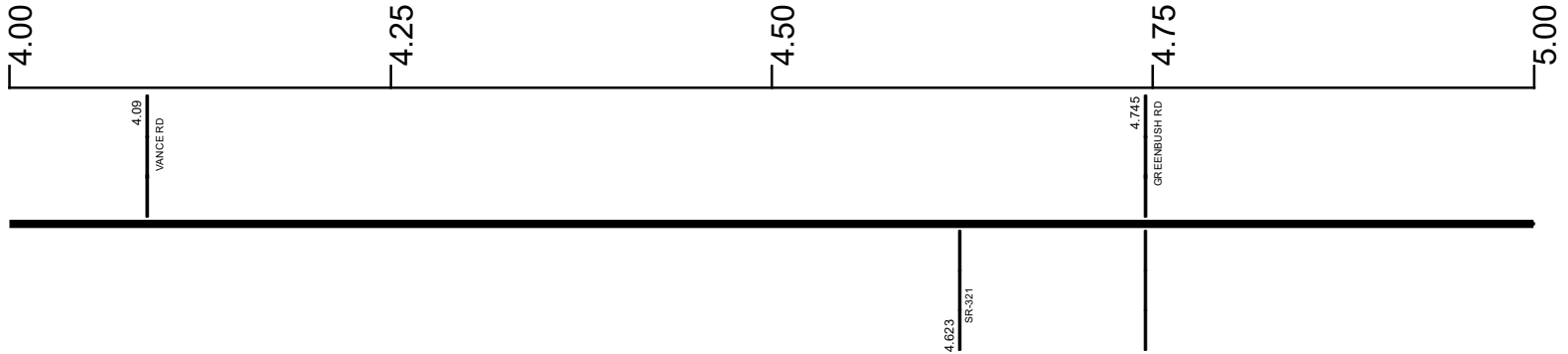

Surface Type & Width (Left / Right)

G 20'  
0 - 13.973

Base Type (Left / Right)

I  
0 - 8.622

Shoulder Type & Width (Left / Right)

2 (3/3)  
0 - 13.973

Resurface Year

2022  
0 - 5.18

Through Lanes

2  
0 - 13.973

Street Name

SR 134  
0 - 13.973

- |                     |                   |                      |              |
|---------------------|-------------------|----------------------|--------------|
| Non-divided Highway | Bridge (on route) | Railroad (at grade)  | Intersection |
| Divided Highway     | Underpass         | Railroad (underpass) |              |
| Secondary Segment   | Overpass          | Railroad (overpass)  |              |
| Corporation         |                   |                      |              |

Created on: 6/30/2025

transportation.ohio.gov

Prepared by  
The Ohio Department of Transportation  
Office of Technical Services  
Roadway Information

# SHIGSR00134\*\*C

State True Log

6.342

County True Log



Surface Type & Width (Left / Right)

G 20'  
0 - 13.973

Base Type (Left / Right)

I  
0 - 8.622

Shoulder Type & Width (Left / Right)

2 (3/3)  
0 - 13.973

Resurface Year

2022  
0 - 5.18

Resurface Year

2021  
5.185 - 13.973

Through Lanes

2  
0 - 13.973

Street Name

SR 134  
0 - 13.973

- |                     |                   |                      |              |
|---------------------|-------------------|----------------------|--------------|
| Non-divided Highway | Bridge (on route) | Railroad (at grade)  | Intersection |
| Divided Highway     | Underpass         | Railroad (underpass) |              |
| Secondary Segment   | Overpass          | Railroad (overpass)  |              |
| <b>Corporation</b>  |                   |                      |              |

Created on: 6/30/2025

transportation.ohio.gov

Prepared by  
The Ohio Department of Transportation  
Office of Technical Services  
Roadway Information

# SHIGSR00134\*\*C

State True Log

7.342

County True Log

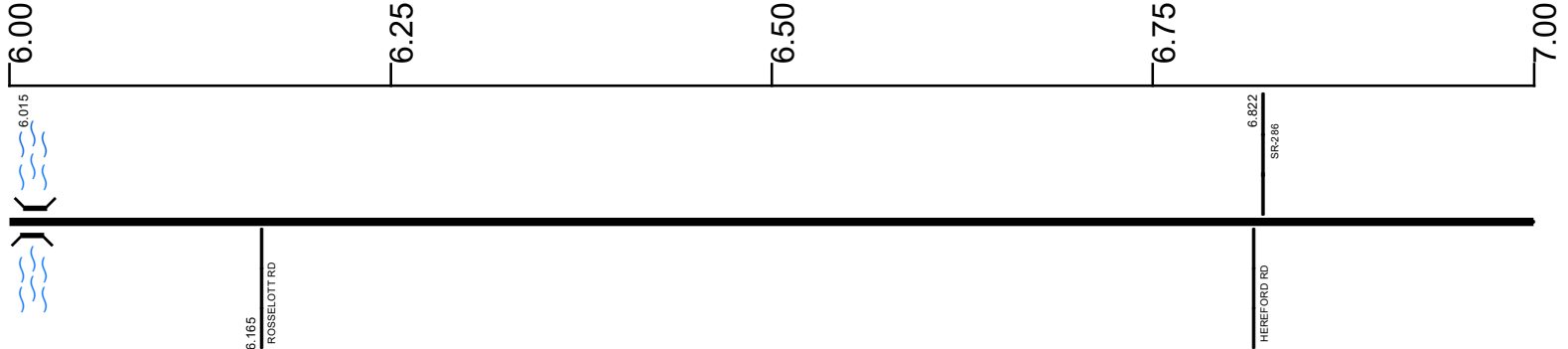

Surface Type & Width (Left / Right)

G 20'  
0 - 13.973

Base Type (Left / Right)

I  
0 - 8.622

Shoulder Type & Width (Left / Right)

2 (3/3)  
0 - 13.973

Resurface Year

2021

Through Lanes

2  
0 - 13.973

Street Name

SR 134  
0 - 13.973

- Non-divided Highway
  Bridge (on route)
  Railroad (at grade)
  Intersection
- Divided Highway
  Underpass
  Railroad (underpass)
- Secondary Segment
  Overpass
  Railroad (overpass)
- Corporation**

Created on: 6/30/2025

transportation.ohio.gov

Prepared by  
The Ohio Department of Transportation  
Office of Technical Services  
Roadway Information

# SHIGSR00134\*\*C

State True Log

8.342

County True Log



Surface Type & Width (Left / Right)

G 20'  
0 - 13.973

Base Type (Left / Right)

I  
0 - 8.622

Shoulder Type & Width (Left / Right)

2 (3/3)  
0 - 13.973

Resurface Year

2021  
5.185 - 13.973

Through Lanes

2  
0 - 13.973

Street Name

SR 134  
0 - 13.973

- |                     |                   |                      |              |
|---------------------|-------------------|----------------------|--------------|
| Non-divided Highway | Bridge (on route) | Railroad (at grade)  | Intersection |
| Divided Highway     | Underpass         | Railroad (underpass) |              |
| Secondary Segment   | Overpass          | Railroad (overpass)  |              |
| Corporation         |                   |                      |              |

Created on: 6/30/2025

transportation.ohio.gov

Prepared by  
The Ohio Department of Transportation  
Office of Technical Services  
Roadway Information



# SHIGSR00134\*\*C

State True Log

10.342

County True Log

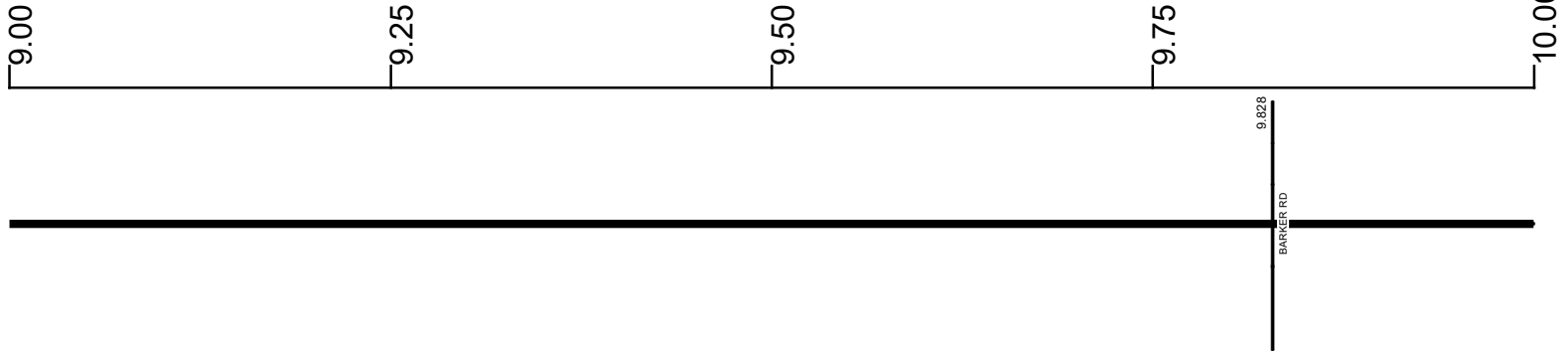

Surface Type & Width (Left / Right)

G 20'	
0 - 13.973	

Base Type (Left / Right)

K	I
8.622 - 9.857	9.857 - 10.18

Shoulder Type & Width (Left / Right)

2 (3/3)	
0 - 13.973	

Resurface Year

2021	
------	--

Through Lanes

2	
0 - 13.973	

Street Name

SR 134	
0 - 13.973	

- |  |   |   |   |
|--|---|---|---|
| <ul style="list-style-type: none"> <li> Non-divided Highway</li> <li> Divided Highway</li> <li> Secondary Segment</li> <li> Corporation</li> </ul> | <ul style="list-style-type: none"> <li> Bridge (on route)</li> <li> Underpass</li> <li> Overpass</li> </ul> | <ul style="list-style-type: none"> <li> Railroad (at grade)</li> <li> Railroad (underpass)</li> <li> Railroad (overpass)</li> </ul> | <ul style="list-style-type: none"> <li> Intersection</li> </ul> |
|--|---|---|---|

Created on: 6/30/2025

transportation.ohio.gov

Prepared by  
The Ohio Department of Transportation  
Office of Technical Services  
Roadway Information



# SHIGSR00134\*\*C

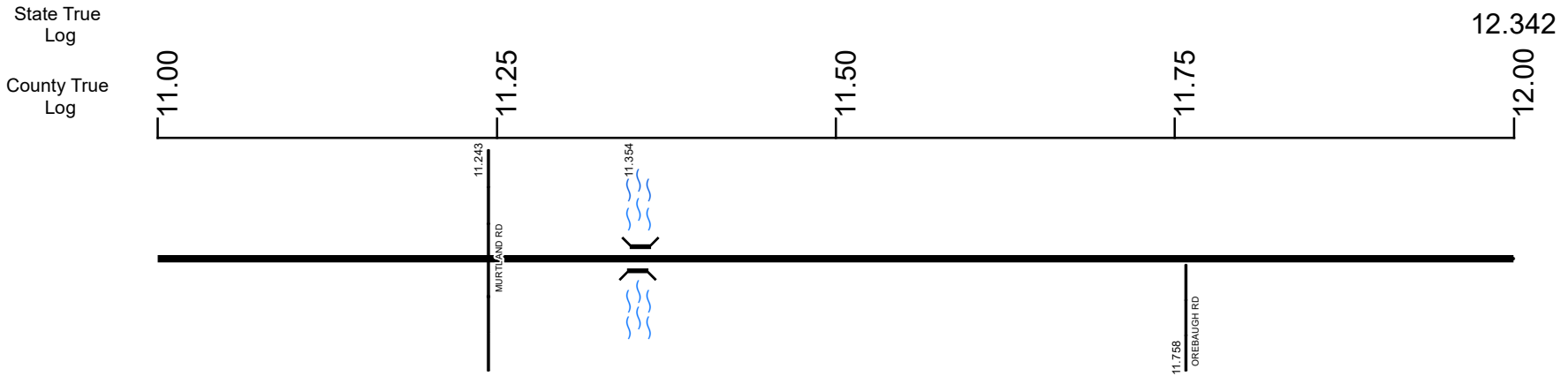

Surface Type & Width (Left / Right)	G 20' 0 - 13.973
Base Type (Left / Right)	K 10.18 - 13.973
Shoulder Type & Width (Left / Right)	2 (3/3) 0 - 13.973
Resurface Year	2021 5.185 - 13.973
Through Lanes	2 0 - 13.973
Street Name	SR 134 0 - 13.973

Non-divided Highway	Bridge (on route)	Railroad (at grade)	Intersection
Divided Highway	Underpass	Railroad (underpass)	
Secondary Segment	Overpass	Railroad (overpass)	
Corporation			

Created on: 6/30/2025



transportation.ohio.gov

Prepared by  
The Ohio Department of Transportation  
Office of Technical Services  
Roadway Information

# SHIGSR00134\*\*C

State True Log

13.342

County True Log

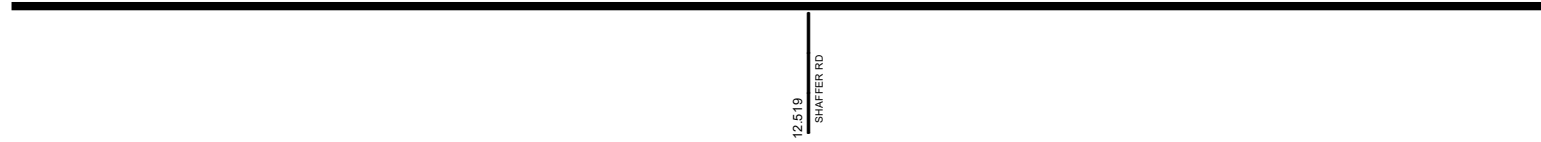

Surface Type & Width (Left / Right)	G 20' 0 - 13.973
Base Type (Left / Right)	K 10.18 - 13.973
Shoulder Type & Width (Left / Right)	2 (3/3) 0 - 13.973
Resurface Year	2021 5.185 - 13.973
Through Lanes	2 0 - 13.973
Street Name	SR 134 0 - 13.973

- |                     |                   |                      |              |
|---------------------|-------------------|----------------------|--------------|
| Non-divided Highway | Bridge (on route) | Railroad (at grade)  | Intersection |
| Divided Highway     | Underpass         | Railroad (underpass) |              |
| Secondary Segment   | Overpass          | Railroad (overpass)  |              |
| Corporation         |                   |                      |              |

Created on: 6/30/2025

transportation.ohio.gov

Prepared by  
The Ohio Department of Transportation  
Office of Technical Services  
Roadway Information

# SHIGSR00134\*\*C

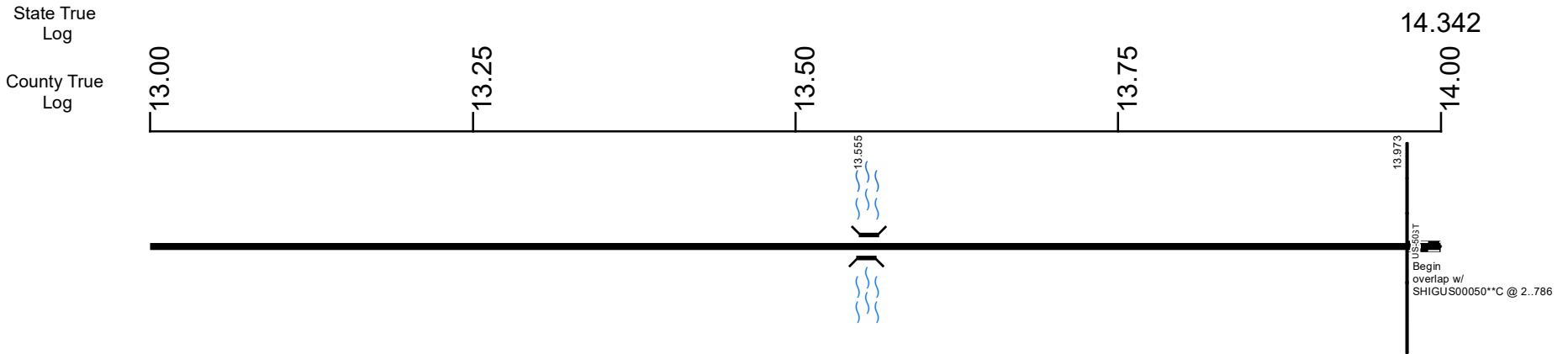

Surface Type & Width (Left / Right)	G 20'
	0 - 13.973
Base Type (Left / Right)	K
	10.18 - 13.973
Shoulder Type & Width (Left / Right)	2 (3/3')
	0 - 13.973
Resurface Year	2021
	5.185 - 13.973
Through Lanes	2
	0 - 13.973
Street Name	SR 134
	0 - 13.973

- Non-divided Highway
- Divided Highway
- Secondary Segment
- Corporation
- Bridge (on route)
- Underpass
- Overpass
- Railroad (at grade)
- Railroad (underpass)
- Railroad (overpass)
- Intersection

Created on: 6/30/2025

transportation.ohio.gov

Prepared by  
The Ohio Department of Transportation  
Office of Technical Services  
Roadway Information

# SHIGSR00134\*\*C

State True Log  
County True Log

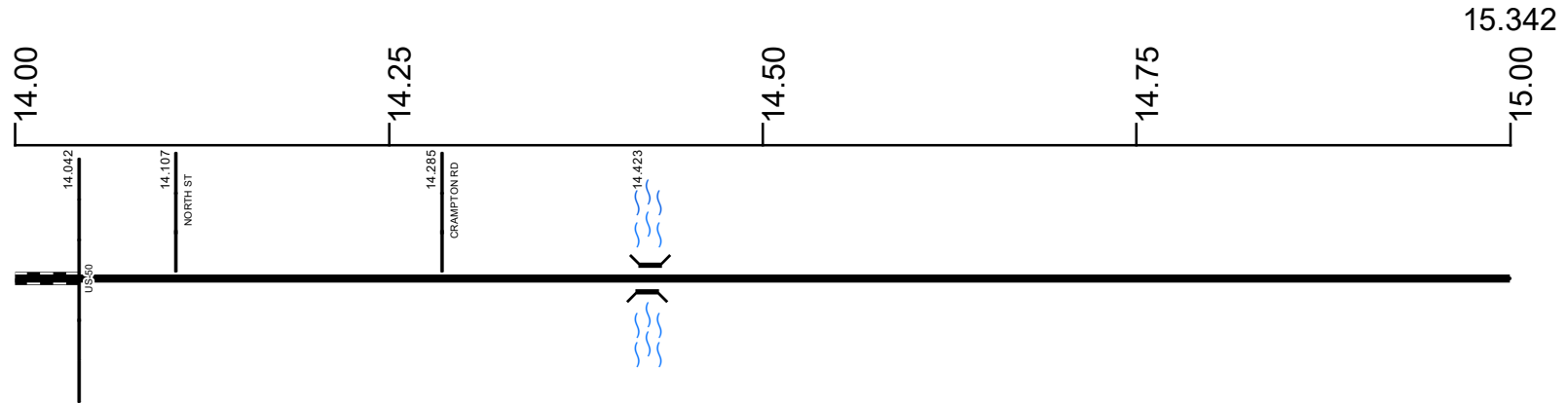

**Surface Type & Width (Left / Right)**

G 20'	G 18'
14.042 - 14.69	14.69 - 16.76

**Base Type (Left / Right)**

I	
14.042 - 17.079	

**Shoulder Type & Width (Left / Right)**

2 (6/6')	
14.042 - 16.76	

**Resurface Year**

2021	
14.042 - 18.755	

**Through Lanes**

2	
14.042 - 17.079	

**Street Name**

WATER ST	SR 134	
14.042 - 14.107	14.107 - 16.92	

- Non-divided Highway
- Divided Highway
- Secondary Segment
- Corporation
- Bridge (on route)
- Underpass
- Overpass
- Railroad (at grade)
- Railroad (underpass)
- Railroad (overpass)
- Intersection

Created on: 6/30/2025

transportation.ohio.gov

Prepared by  
The Ohio Department of Transportation  
Office of Technical Services  
Roadway Information

# SHIGSR00134\*\*C

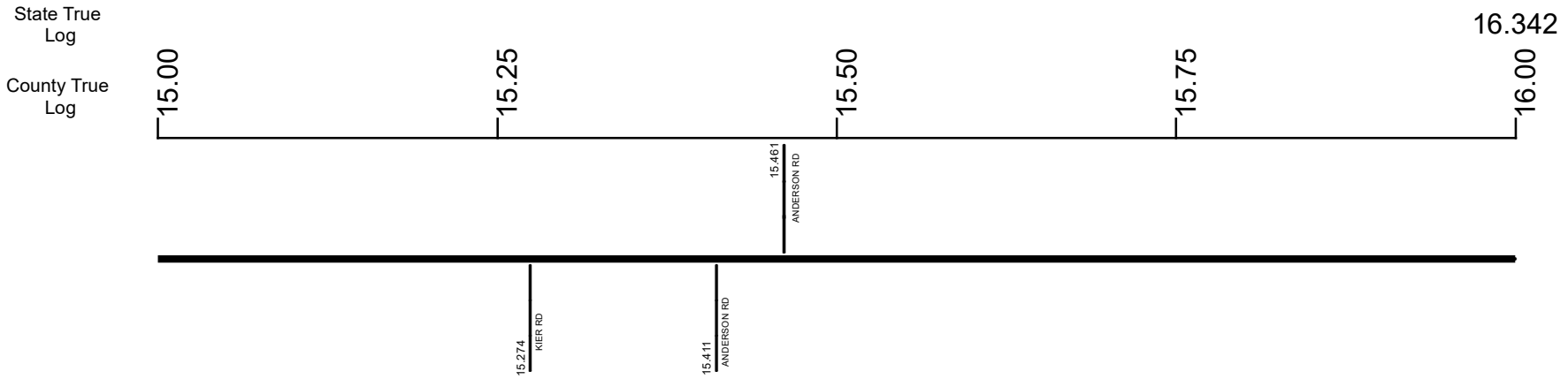

Surface Type & Width (Left / Right)	G 18'
	14.69 - 16.76
Base Type (Left / Right)	I
	14.042 - 17.079
Shoulder Type & Width (Left / Right)	2 (6/6')
	14.042 - 16.76
Resurface Year	2021
Through Lanes	2
	14.042 - 18.755
Street Name	SR 134
	14.107 - 16.92

Non-divided Highway	Bridge (on route)	Railroad (at grade)	Intersection
Divided Highway	Underpass	Railroad (underpass)	
Secondary Segment	Overpass	Railroad (overpass)	
<b>Corporation</b>			

Created on: 6/30/2025

transportation.ohio.gov

Prepared by  
The Ohio Department of Transportation  
Office of Technical Services  
Roadway Information

# SHIGSR00134\*\*C

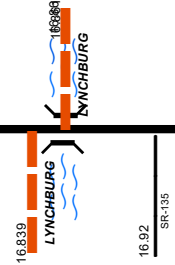
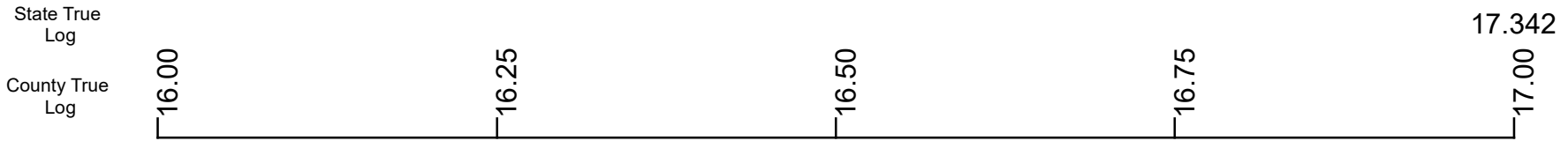

Surface Type & Width (Left / Right)			
	G 18' 14.69 - 16.76	G 20' 16.76 - 17.079	
Base Type (Left / Right)			
	I 14.042 - 17.079		
Shoulder Type & Width (Left / Right)			
	2 (6'/6') 14.042 - 16.76	2 (4'/4') 16.76 - 16.87	2 (6'/6') 16.87 - 17.079
Resurface Year			
	2021 14.042 - 18.755		
Through Lanes			
	2 14.042 - 17.079		
Street Name			
	SR 134 14.107 - 16.92	MAIN ST 16.92 - 17.169	

<ul style="list-style-type: none"> <li> Non-divided Highway</li> <li> Divided Highway</li> <li> Secondary Segment</li> <li> Corporation</li> </ul>	<ul style="list-style-type: none"> <li> Bridge (on route)</li> <li> Underpass</li> <li> Overpass</li> </ul>	<ul style="list-style-type: none"> <li> Railroad (at grade)</li> <li> Railroad (underpass)</li> <li> Railroad (overpass)</li> </ul>	<ul style="list-style-type: none"> <li> Intersection</li> </ul>
--	---	---	---

Created on: 6/30/2025

transportation.ohio.gov

Prepared by  
The Ohio Department of Transportation  
Office of Technical Services  
Roadway Information

# SHIGSR00134\*\*C

State True Log

18.342

County True Log

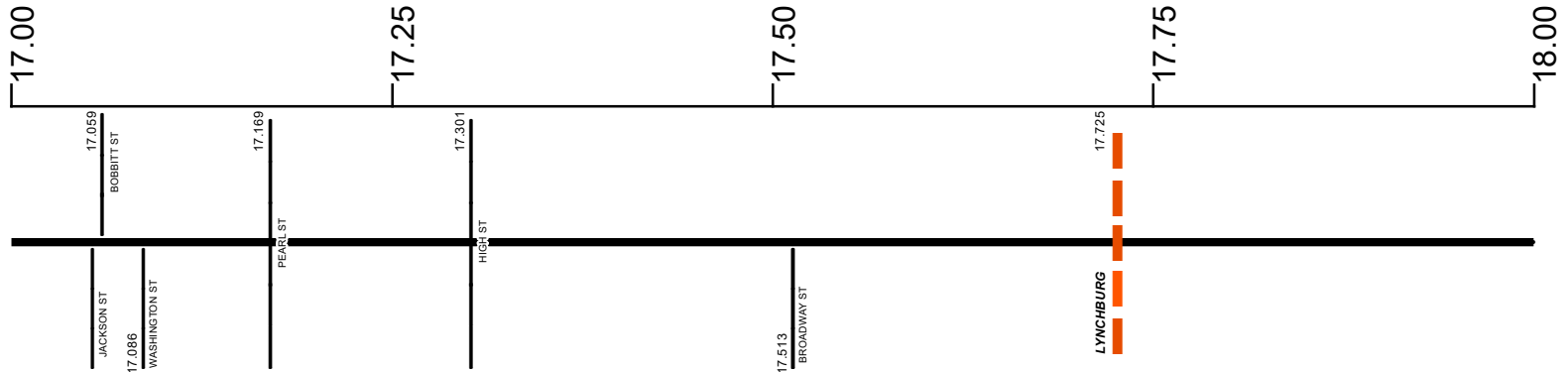

**Surface Type & Width (Left / Right)**

G 20'	G 46'	G 20'	G 18'
16.76 - 17.079	17.079 - 17.257	17.257 - 17.723	17.723 - 18.755

**Base Type (Left / Right)**

I	T	I	
14.042 - 17.079	17.079 - 17.257	17.257 - 18.755	

**Shoulder Type & Width (Left / Right)**

2 (6'/6')	1 (0'/0')	2 (3'/3')	2 (4'/5')
16.87 - 17.079	17.079 - 17.257	17.257 - 17.723	17.723 - 18.755

**Resurface Year**

		2021	
		14.042 - 18.755	

**Through Lanes**

2	3	2	
14.042 - 17.079	17.079 - 17.257	17.257 - 18.755	

**Street Name**

	MAIN ST		SR 134
16.92 - 17.169	17.169 - 17.725		17.725 - 18.755

- Non-divided Highway
- Divided Highway
- Secondary Segment
- Corporation
- Bridge (on route)
- Underpass
- Overpass
- Railroad (at grade)
- Railroad (underpass)
- Railroad (overpass)
- Intersection

Created on: 6/30/2025

transportation.ohio.gov

Prepared by  
The Ohio Department of Transportation  
Office of Technical Services  
Roadway Information

# SHIGSR00134\*\*C

State True Log

19.097

County True Log

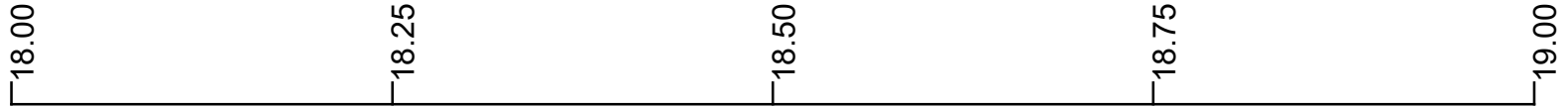

**Surface Type & Width (Left / Right)**

G 18'  
17.723 - 18.755

**Base Type (Left / Right)**

I  
17.257 - 18.755

**Shoulder Type & Width (Left / Right)**

2 (4'/5')  
17.723 - 18.755

**Resurface Year**

2021  
14.042 - 18.755

**Through Lanes**

2  
17.257 - 18.755

**Street Name**

SR 134  
17.725 - 18.755

- |                     |                   |                      |              |
|---------------------|-------------------|----------------------|--------------|
| Non-divided Highway | Bridge (on route) | Railroad (at grade)  | Intersection |
| Divided Highway     | Underpass         | Railroad (underpass) |              |
| Secondary Segment   | Overpass          | Railroad (overpass)  |              |
| Corporation         |                   |                      |              |

Created on: 6/30/2025

transportation.ohio.gov

Prepared by  
The Ohio Department of Transportation  
Office of Technical Services  
Roadway Information

## Historical Project List for SHIGSR00134\*\*C

Begin Measure	End Measure	Project ID Number	Construction Completion Date	Treatment Category	Treatment Type
0.000	5.185	96294	11-2022	Minor Rehabilitation	60-AC Overlay w/Rpr
0.000	5.255	25590	10-2008	Minor Rehabilitation	60-AC Overlay w/Rpr
5.185	11.233	110364	10-2021	Minor Rehabilitation	38-Fine Poly AC Overlay
5.255	12.272	25539	9-2009	Minor Rehabilitation	60-AC Overlay w/Rpr
11.233	13.934	110363	10-2021	Minor Rehabilitation	60-AC Overlay w/Rpr
12.272	13.934	25439	10-2005	Minor Rehabilitation	50-AC Overlay w/o Rpr
14.042	18.755	110363	10-2021	Minor Rehabilitation	60-AC Overlay w/Rpr
14.042	18.755	25439	10-2005	Minor Rehabilitation	50-AC Overlay w/o Rpr

# Roadway Codes

## Access Control Journalized

- F - Full Access Control
- L - Limited Access Control
- N - No Access Control

## Access Control Operational

- 1 - Full Access Control
- 2 - Partial Access Control
- 3 - No Access Control

## Base Type

- F - Crack and Seat
- H - Rubblize and Roll
- I - Aggregate Base 304 or Traffic Compacted
- K - Water Bound Macadam
- L - Bituminous Concrete Mix or Penetration Macadam
- N - Plain Concrete
- P - Reinforced Concrete
- R - Brick (Flexible)
- T - Brick (Rigid)

## Direction of Travel

- B - Both (Two-way)
- F - One-way Cardinal
- T - One-way Non-cardinal

## Facility Type

- 1 - One-way Roadway
- 2 - Two-way Roadway
- 4 - Ramp
- 5 - Non-mainline
- 6 - Non-inventory Direction
- 7 - Planned / Unbuilt

## Historical Federal Aid Indicator

- N - Not a FAP Route
- Y - FAP Route

## Functional Classification

- 01 - Interstate
- 02 - Principal Arterial (Freeways)
- 03 - Principal Arterial (Other)
- 04 - Minor Arterial
- 05 - Major Collector
- 06 - Minor Collector
- 07 - Local

## Leave / Reenter Indicator

- Y - Route leaves/reenters at this point
- N - Route does not leave/reenter at this point

## Median Type

- 1 - None
- 2 - Unprotected
- 3 - Curbed
- 4 - Positive Barrier (Unspecified)
- 5 - Positive Barrier (Flexible)
- 6 - Positive Barrier (Semi-rigid)
- 7 - Positive Barrier (Rigid)

## NHS

- N - National Highway System
- H - Congressional Corridor
- 2 - Major Airport
- 3 - Major Port Facility
- 4 - Major Amtrak Station
- 5 - Major Rail / Truck Terminal
- 6 - Major Intercity Bus Terminal
- 7 - Major Public Transit / Multi-modal Passenger Terminal
- 8 - Major Pipeline Terminal
- 9 - Major Ferry Terminal

## Priority System

- G - General
- P - Priority System
- U - Urban

## Scenic Byway Code

- A - All American Road
- N - National Scenic Byway
- S - State Scenic Byway

## Shoulder Type

- 1 - None
- 2 - Surfaced shoulder exists (bituminous concrete {AC})
- 3 - Surfaced shoulder exists (Portland Cement Concrete {PCC})
- 4 - Stabilized shoulder exists (gravel or other granular material)
- 5 - Combination shoulder exists (two or more surface types)
- 6 - Earth shoulder exists
- 7 - Barrier curb exists; no shoulder in front of curb

## Surface Type

- A - Combination
- B - Brick
- C - Continuous Reinforced Concrete
- D - Reinforced Concrete
- E - Plain Concrete
- G - Bituminous Concrete
- I - Chipseal on Granular
- K - Open Graded Bituminous
- L - Chipseal or Micro
- M - Gravel
- U - Unimproved
- X - Right of Way Only