

SHOCSR00278**C

State True Log 13.011

14.011

County True Log

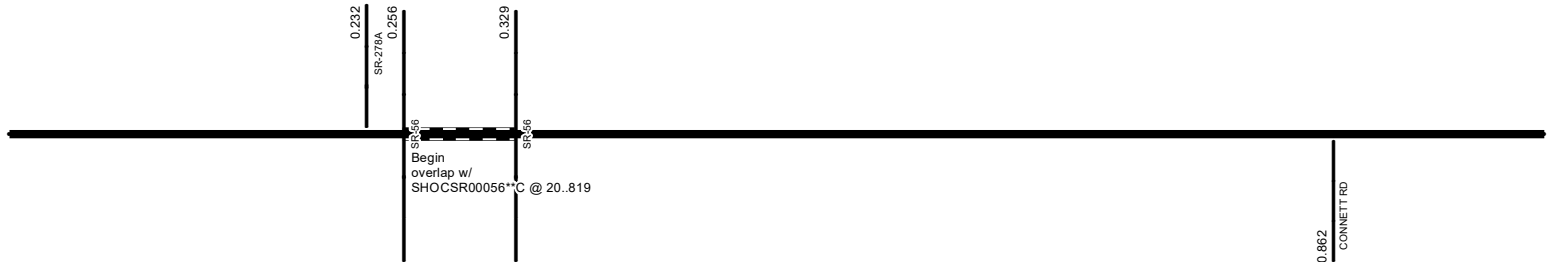

Surface Type & Width (Left / Right)

G 20'

0 - 0.256

Base Type (Left / Right)

I

0 - 0.256

Shoulder Type & Width (Left / Right)

2 (2'/2')

0 - 0.256

Through Lanes

2

0 - 0.256

SR 278

0 - 0.256

Surface Type & Width (Left / Right)

G 20'

0.329 - 5.373

Base Type (Left / Right)

I

0.329 - 7.256

Shoulder Type & Width (Left / Right)

2 (2'/2')

0.329 - 5.949

Through Lanes

2

0.329 - 10.749

Street Name

SR 278

0.329 - 7.769

- | | | | |
|---------------------|-------------------|----------------------|--------------|
| Non-divided Highway | Bridge (on route) | Railroad (at grade) | Intersection |
| Divided Highway | Underpass | Railroad (underpass) | |
| Secondary Segment | Overpass | Railroad (overpass) | |
| Corporation | | | |

Created on: 7/1/2025

transportation.ohio.gov

Prepared by
The Ohio Department of Transportation
Office of Technical Services
Roadway Information

SHOCSR00278**C

State True Log

15.011

County True Log



Surface Type & Width (Left / Right)

G 20'
0.329 - 5.373

Base Type (Left / Right)

I
0.329 - 7.256

Shoulder Type & Width (Left / Right)

2 (2'/2')
0.329 - 5.949

Through Lanes

2
0.329 - 10.749

Street Name

SR 278
0.329 - 7.769

- | | | | |
|--|---|---|---|
| <ul style="list-style-type: none"> Non-divided Highway Divided Highway Secondary Segment Corporation | <ul style="list-style-type: none"> Bridge (on route) Underpass Overpass | <ul style="list-style-type: none"> Railroad (at grade) Railroad (underpass) Railroad (overpass) | <ul style="list-style-type: none"> Intersection |
|--|---|---|---|

Created on: 7/1/2025

transportation.ohio.gov

Prepared by
The Ohio Department of Transportation
Office of Technical Services
Roadway Information

SHOCSR00278**C

State True Log

16.011

County True Log

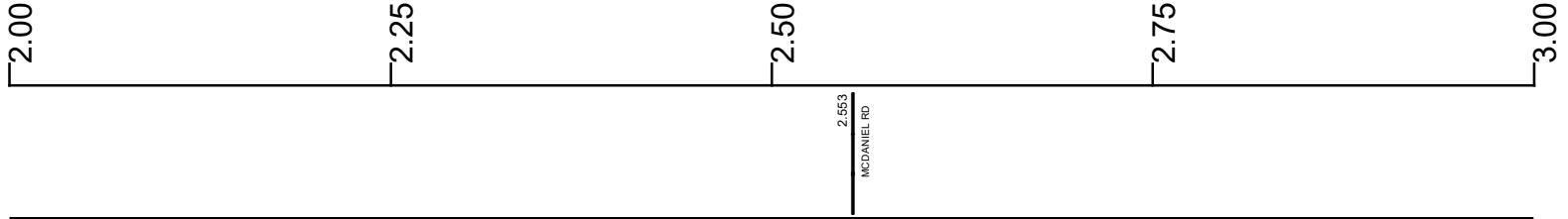

Surface Type & Width (Left / Right)

G 20'
0.329 - 5.373

Base Type (Left / Right)

I
0.329 - 7.256

Shoulder Type & Width (Left / Right)

2 (2'/2)
0.329 - 5.949

Through Lanes

2
0.329 - 10.749

Street Name

SR 278
0.329 - 7.769

- | | | | |
|---------------------|-------------------|----------------------|--------------|
| Non-divided Highway | Bridge (on route) | Railroad (at grade) | Intersection |
| Divided Highway | Underpass | Railroad (underpass) | |
| Secondary Segment | Overpass | Railroad (overpass) | |
| Corporation | | | |

Created on: 7/1/2025

transportation.ohio.gov

Prepared by
The Ohio Department of Transportation
Office of Technical Services
Roadway Information

SHOCSR00278**C

State True Log

17.011

County True Log



Surface Type & Width (Left / Right)

G 20'
0.329 - 5.373

Base Type (Left / Right)

I
0.329 - 7.256

Shoulder Type & Width (Left / Right)

2 (2/2)
0.329 - 5.949

Through Lanes

2
0.329 - 10.749

Street Name

SR 278
0.329 - 7.769

- | | | | |
|---------------------|-------------------|----------------------|--------------|
| Non-divided Highway | Bridge (on route) | Railroad (at grade) | Intersection |
| Divided Highway | Underpass | Railroad (underpass) | |
| Secondary Segment | Overpass | Railroad (overpass) | |
| Corporation | | | |

Created on: 7/1/2025

transportation.ohio.gov

Prepared by
The Ohio Department of Transportation
Office of Technical Services
Roadway Information

SHOCSR00278**C

State True Log

18.011

County True Log

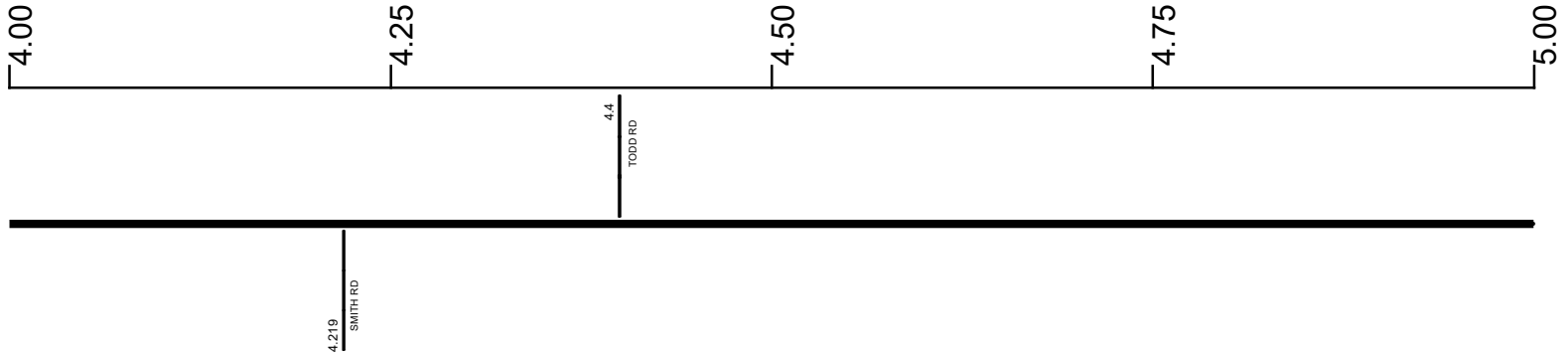

Surface Type & Width (Left / Right)

	G 20'
	0.329 - 5.373

Base Type (Left / Right)

	I
	0.329 - 7.256

Shoulder Type & Width (Left / Right)

	2 (2'/2')
	0.329 - 5.949

Through Lanes

	2
	0.329 - 10.749

Street Name

	SR 278
	0.329 - 7.769

- | | | | |
|--|---|---|---|
| <ul style="list-style-type: none"> Non-divided Highway Divided Highway Secondary Segment Corporation | <ul style="list-style-type: none"> Bridge (on route) Underpass Overpass | <ul style="list-style-type: none"> Railroad (at grade) Railroad (underpass) Railroad (overpass) | <ul style="list-style-type: none"> Intersection |
|--|---|---|---|

Created on: 7/1/2025

transportation.ohio.gov

Prepared by
The Ohio Department of Transportation
Office of Technical Services
Roadway Information

SHOCSR00278**C

State True Log

19.011

County True Log

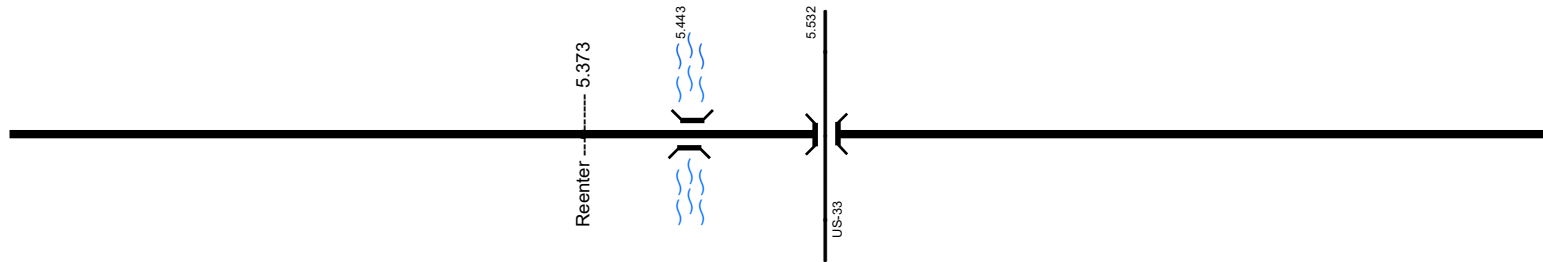

Surface Type & Width (Left / Right)

G 20' 0.329 - 5.373	G 18' 5.373 - 6.994
------------------------	------------------------

Base Type (Left / Right)

I 0.329 - 7.256	
--------------------	--

Shoulder Type & Width (Left / Right)

2 (2'2") 0.329 - 5.949	2 (8'8") 5.949 - 6.5
---------------------------	-------------------------

Through Lanes

2 0.329 - 10.749	
---------------------	--

Street Name

SR 278 0.329 - 7.769	
-------------------------	--

- | | | | |
|---------------------|-------------------|----------------------|--------------|
| Non-divided Highway | Bridge (on route) | Railroad (at grade) | Intersection |
| Divided Highway | Underpass | Railroad (underpass) | |
| Secondary Segment | Overpass | Railroad (overpass) | |
| Corporation | | | |

Created on: 7/1/2025

transportation.ohio.gov

Prepared by
The Ohio Department of Transportation
Office of Technical Services
Roadway Information

SHOCSR00278**C

State True Log

20.011

County True Log



Surface Type & Width (Left / Right)

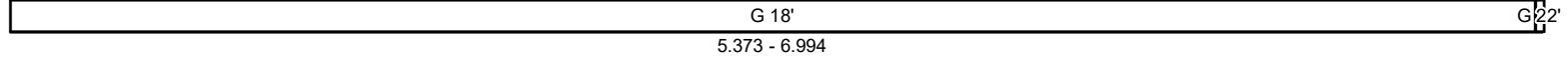

Base Type (Left / Right)

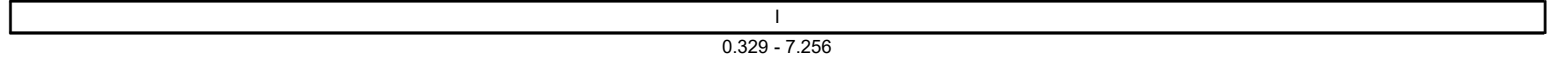

Shoulder Type & Width (Left / Right)

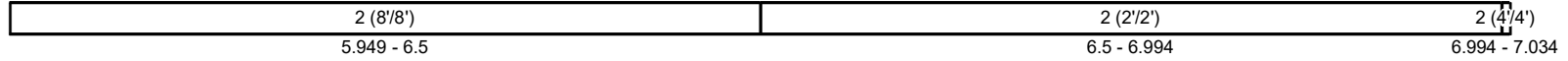

Through Lanes

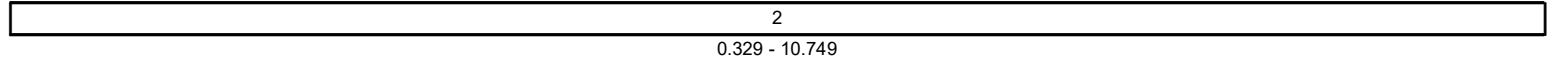

Street Name

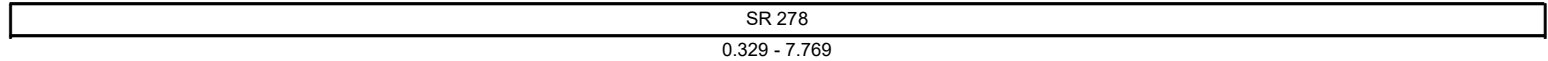

- | | | | |
|---------------------|-------------------|----------------------|--------------|
| Non-divided Highway | Bridge (on route) | Railroad (at grade) | Intersection |
| Divided Highway | Underpass | Railroad (underpass) | |
| Secondary Segment | Overpass | Railroad (overpass) | |
| Corporation | | | |

Created on: 7/1/2025



transportation.ohio.gov

Prepared by
The Ohio Department of Transportation
Office of Technical Services
Roadway Information

SHOCSR00278**C

State True Log

21.011

County True Log

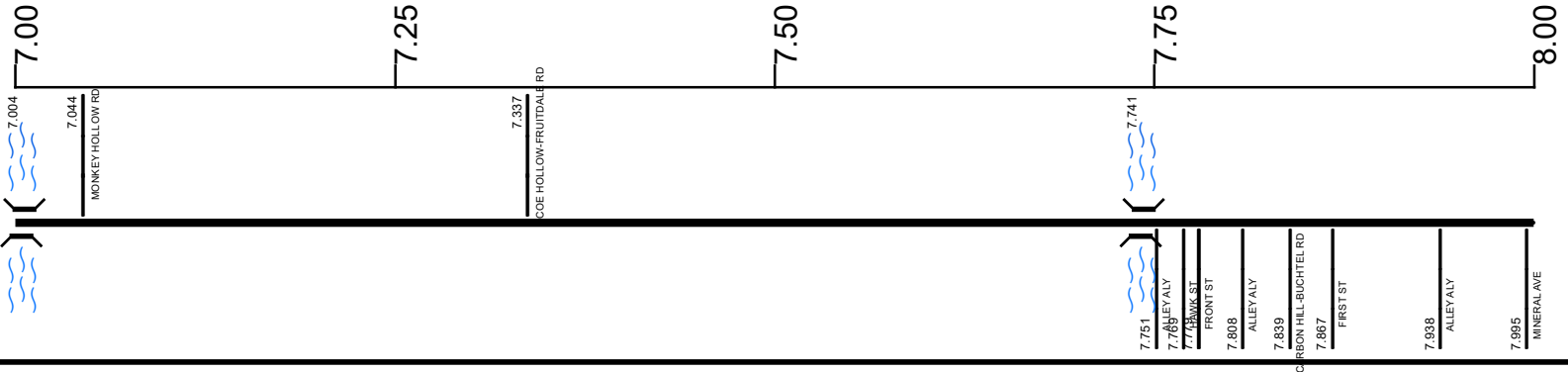

Surface Type & Width (Left / Right)

G 22'	G 18'	G 22'	G 18'
6.994 - 7.034	7.034 - 7.256	7.256 - 7.798	7.798 - 10.749

Base Type (Left / Right)

I	L	I	I
0.329 - 7.256	7.256 - 7.798	7.798 - 8.767	

Shoulder Type & Width (Left / Right)

2 (4'4")	2 (2'2")	2 (4'4")	2 (2'2")
6.994 - 7.034	7.034 - 7.256	7.256 - 7.798	7.798 - 10.749

Through Lanes

2	2	2	2
0.329 - 7.256	7.256 - 7.798	7.798 - 8.767	8.767 - 10.749

Street Name

SR 278	1ST ST	SR 278	SR 278
0.329 - 7.769	7.769 - 7.867	7.867 - 10.749	

- Non-divided Highway
- Divided Highway
- Secondary Segment
- Corporation
- Bridge (on route)
- Underpass
- Overpass
- Railroad (at grade)
- Railroad (underpass)
- Railroad (overpass)
- Intersection

Created on: 7/1/2025



transportation.ohio.gov

Prepared by
The Ohio Department of Transportation
Office of Technical Services
Roadway Information

SHOCSR00278**C

State True Log

22.011

County True Log

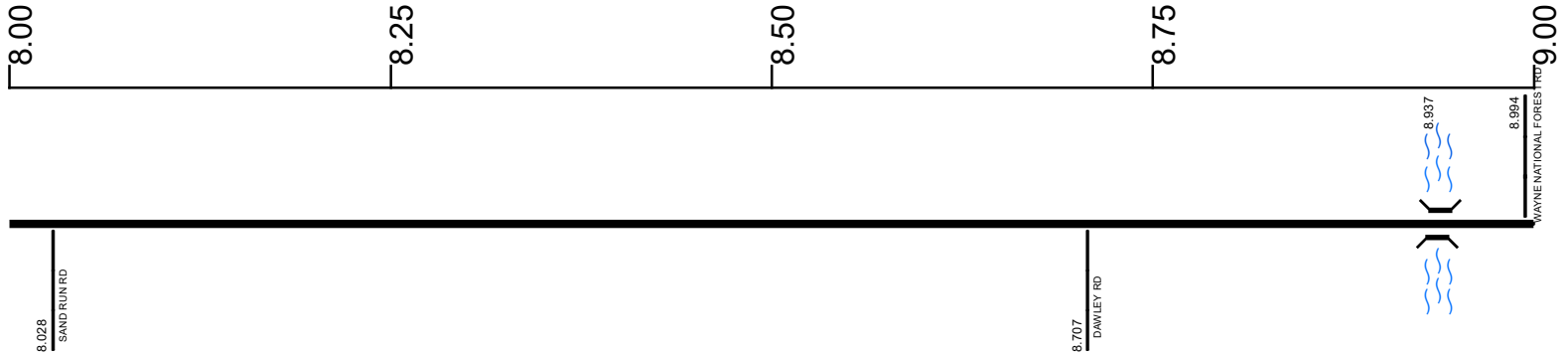

Surface Type & Width (Left / Right)

	G 18'
	7.798 - 10.749

Base Type (Left / Right)

I	K
7.798 - 8.767	8.767 - 9.157

Shoulder Type & Width (Left / Right)

	2 (2/2')
	7.798 - 10.749

Through Lanes

	2
	0.329 - 10.749

Street Name

	SR 278
	7.867 - 10.749

- | | | | |
|---------------------|-------------------|----------------------|--------------|
| Non-divided Highway | Bridge (on route) | Railroad (at grade) | Intersection |
| Divided Highway | Underpass | Railroad (underpass) | |
| Secondary Segment | Overpass | Railroad (overpass) | |
| Corporation | | | |

Created on: 7/1/2025

transportation.ohio.gov

Prepared by
The Ohio Department of Transportation
Office of Technical Services
Roadway Information

SHOCSR00278**C

State True Log

23.011

County True Log

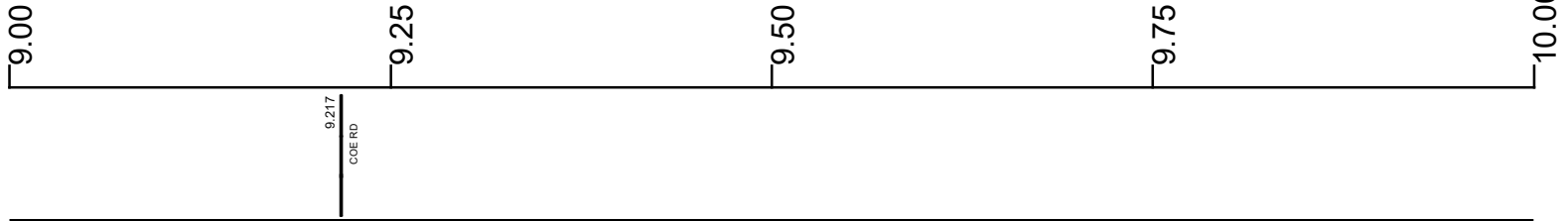

Surface Type & Width (Left / Right)

	G 18'
7.798 - 10.749	

Base Type (Left / Right)

K	I
8.767 - 9.157	9.157 - 10.749

Shoulder Type & Width (Left / Right)

	2 (2'/2')
7.798 - 10.749	

Through Lanes

	2
0.329 - 10.749	

Street Name

	SR 278
7.867 - 10.749	

- | | | | |
|---------------------|-------------------|----------------------|--------------|
| Non-divided Highway | Bridge (on route) | Railroad (at grade) | Intersection |
| Divided Highway | Underpass | Railroad (underpass) | |
| Secondary Segment | Overpass | Railroad (overpass) | |
| Corporation | | | |

Created on: 7/1/2025

transportation.ohio.gov

Prepared by
The Ohio Department of Transportation
Office of Technical Services
Roadway Information

SHOCSR00278**C

State True Log

27.606

County True Log

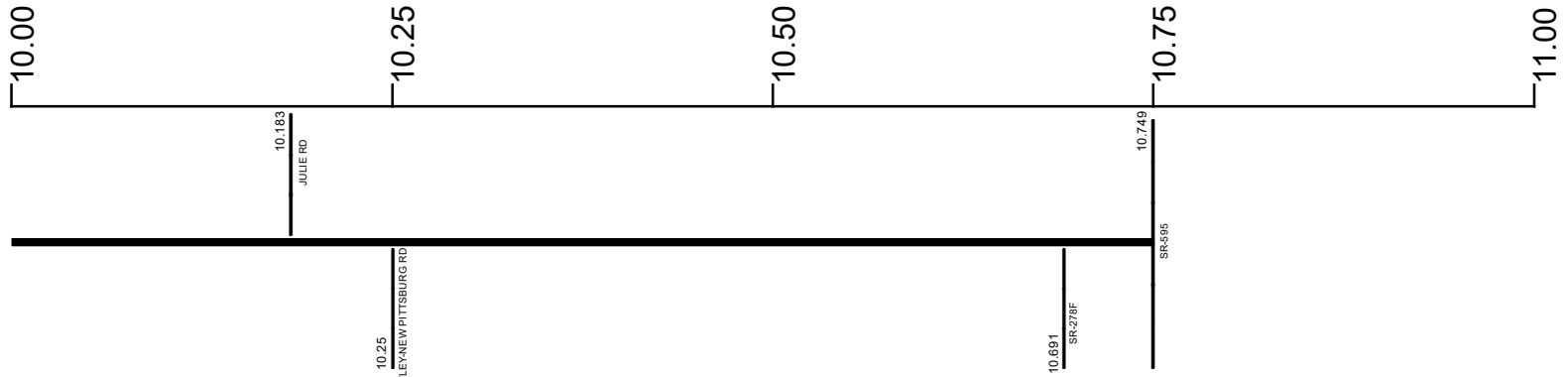

Surface Type & Width (Left / Right)	G 18'
	7.798 - 10.749
Base Type (Left / Right)	I
	9.157 - 10.749
Shoulder Type & Width (Left / Right)	2 (2'2')
	7.798 - 10.749
Through Lanes	2
	0.329 - 10.749
Street Name	SR 278
	7.867 - 10.749

- | | | | |
|--|---|---|---|
| <ul style="list-style-type: none"> Non-divided Highway Divided Highway Secondary Segment Corporation | <ul style="list-style-type: none"> Bridge (on route) Underpass Overpass | <ul style="list-style-type: none"> Railroad (at grade) Railroad (underpass) Railroad (overpass) | <ul style="list-style-type: none"> Intersection |
|--|---|---|---|

Created on: 7/1/2025

transportation.ohio.gov

Prepared by
The Ohio Department of Transportation
Office of Technical Services
Roadway Information

Historical Project List for SHOCSR00278**C

Begin Measure	End Measure	Project ID Number	Construction Completion Date	Treatment Category	Treatment Type
0.000	0.256	81440	9-2011	Minor Rehabilitation	50-AC Overlay w/o Rpr
0.000	0.256	22699	7-2003	Minor Rehabilitation	50-AC Overlay w/o Rpr
0.329	5.373	84508	7-2015	Minor Rehabilitation	50-AC Overlay w/o Rpr
0.329	5.373	22699	7-2003	Minor Rehabilitation	50-AC Overlay w/o Rpr
5.373	5.602	84514	8-2016	Minor Rehabilitation	50-AC Overlay w/o Rpr
5.602	10.749	84514	8-2016	Minor Rehabilitation	38-Fine Poly AC Overlay
5.651	10.749	82652	7-2008	Minor Rehabilitation	38-Fine Poly AC Overlay

Roadway Codes

Access Control Journalized

- F - Full Access Control
- L - Limited Access Control
- N - No Access Control

Access Control Operational

- 1 - Full Access Control
- 2 - Partial Access Control
- 3 - No Access Control

Base Type

- F - Crack and Seat
- H - Rubblize and Roll
- I - Aggregate Base 304 or Traffic Compacted
- K - Water Bound Macadam
- L - Bituminous Concrete Mix or Penetration Macadam
- N - Plain Concrete
- P - Reinforced Concrete
- R - Brick (Flexible)
- T - Brick (Rigid)

Direction of Travel

- B - Both (Two-way)
- F - One-way Cardinal
- T - One-way Non-cardinal

Facility Type

- 1 - One-way Roadway
- 2 - Two-way Roadway
- 4 - Ramp
- 5 - Non-mainline
- 6 - Non-inventory Direction
- 7 - Planned / Unbuilt

Historical Federal Aid Indicator

- N - Not a FAP Route
- Y - FAP Route

Functional Classification

- 01 - Interstate
- 02 - Principal Arterial (Freeways)
- 03 - Principal Arterial (Other)
- 04 - Minor Arterial
- 05 - Major Collector
- 06 - Minor Collector
- 07 - Local

Leave / Reenter Indicator

- Y - Route leaves/reenters at this point
- N - Route does not leave/reenter at this point

Median Type

- 1 - None
- 2 - Unprotected
- 3 - Curbed
- 4 - Positive Barrier (Unspecified)
- 5 - Positive Barrier (Flexible)
- 6 - Positive Barrier (Semi-rigid)
- 7 - Positive Barrier (Rigid)

NHS

- N - National Highway System
- H - Congressional Corridor
- 2 - Major Airport
- 3 - Major Port Facility
- 4 - Major Amtrak Station
- 5 - Major Rail / Truck Terminal
- 6 - Major Intercity Bus Terminal
- 7 - Major Public Transit / Multi-modal Passenger Terminal
- 8 - Major Pipeline Terminal
- 9 - Major Ferry Terminal

Priority System

- G - General
- P - Priority System
- U - Urban

Scenic Byway Code

- A - All American Road
- N - National Scenic Byway
- S - State Scenic Byway

Shoulder Type

- 1 - None
- 2 - Surfaced shoulder exists (bituminous concrete {AC})
- 3 - Surfaced shoulder exists (Portland Cement Concrete {PCC})
- 4 - Stabilized shoulder exists (gravel or other granular material)
- 5 - Combination shoulder exists (two or more surface types)
- 6 - Earth shoulder exists
- 7 - Barrier curb exists; no shoulder in front of curb

Surface Type

- A - Combination
- B - Brick
- C - Continuous Reinforced Concrete
- D - Reinforced Concrete
- E - Plain Concrete
- G - Bituminous Concrete
- I - Chipseal on Granular
- K - Open Graded Bituminous
- L - Chipseal or Micro
- M - Gravel
- U - Unimproved
- X - Right of Way Only