

# SHOCSR00328\*\*C

State True Log 11.097

12.097

County True Log



Begin overlap w/  
SHOCSR00056\*\*C  
@ 14..951

- |   |   |   |   |
|---|---|---|---|
| <ul style="list-style-type: none"> <li> Non-divided Highway</li> <li> Divided Highway</li> <li> Secondary Segment</li> <li> <b>Corporation</b></li> </ul> | <ul style="list-style-type: none"> <li> Bridge (on route)</li> <li> Underpass</li> <li> Overpass</li> </ul> | <ul style="list-style-type: none"> <li> Railroad (at grade)</li> <li> Railroad (underpass)</li> <li> Railroad (overpass)</li> </ul> | <ul style="list-style-type: none"> <li> Intersection</li> </ul> |
|---|---|---|---|

Created on: 7/1/2025

transportation.ohio.gov

Prepared by  
The Ohio Department of Transportation  
Office of Technical Services  
Roadway Information

# SHOCSR00328\*\*C

State True Log

13.097

County True Log

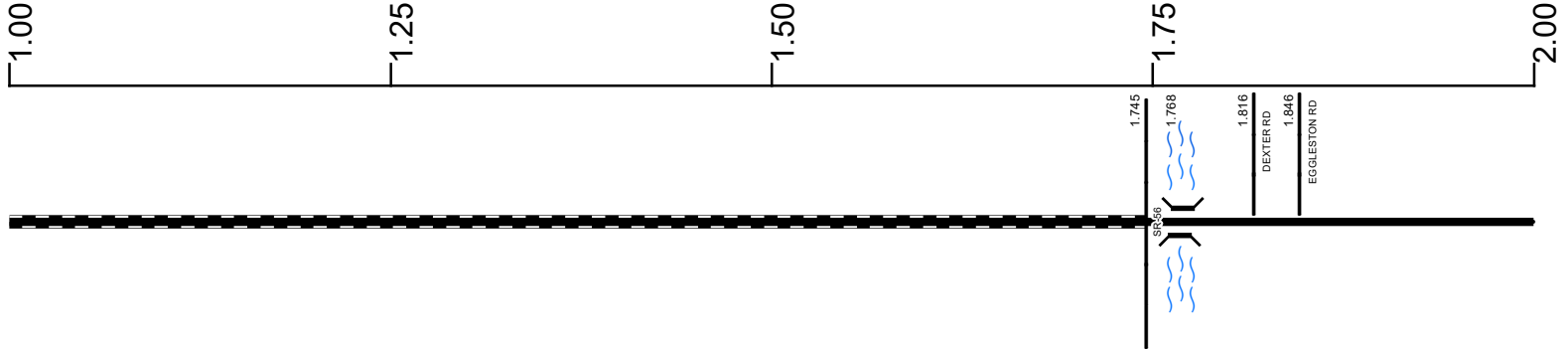

**Surface Type & Width (Left / Right)**

G (9'/10')  
1.745 - 4.056

**Base Type (Left / Right)**

I  
1.745 - 4.056

**Shoulder Type & Width (Left / Right)**

2 (1 1/2')  
1.745 - 4.056

**Through Lanes**

2  
1.745 - 11.639

**Street Name**

SR 328  
1.745 - 6.171

- |  |   |   |   |
|--|---|---|---|
| <ul style="list-style-type: none"> <li> Non-divided Highway</li> <li> Divided Highway</li> <li> Secondary Segment</li> <li> Corporation</li> </ul> | <ul style="list-style-type: none"> <li> Bridge (on route)</li> <li> Underpass</li> <li> Overpass</li> </ul> | <ul style="list-style-type: none"> <li> Railroad (at grade)</li> <li> Railroad (underpass)</li> <li> Railroad (overpass)</li> </ul> | <ul style="list-style-type: none"> <li> Intersection</li> </ul> |
|--|---|---|---|

Created on: 7/1/2025

transportation.ohio.gov

Prepared by  
The Ohio Department of Transportation  
Office of Technical Services  
Roadway Information

# SHOCSR00328\*\*C

State True Log

14.097

County True Log



Surface Type & Width (Left / Right)

G (9/10')  
1.745 - 4.056

Base Type (Left / Right)

I  
1.745 - 4.056

Shoulder Type & Width (Left / Right)

2 (1/2')  
1.745 - 4.056

Through Lanes

2  
1.745 - 11.639

Street Name

SR 328  
1.745 - 6.171

- |                     |                   |                      |              |
|---------------------|-------------------|----------------------|--------------|
| Non-divided Highway | Bridge (on route) | Railroad (at grade)  | Intersection |
| Divided Highway     | Underpass         | Railroad (underpass) |              |
| Secondary Segment   | Overpass          | Railroad (overpass)  |              |
| Corporation         |                   |                      |              |

Created on: 7/1/2025

transportation.ohio.gov

Prepared by  
The Ohio Department of Transportation  
Office of Technical Services  
Roadway Information

# SHOCSR00328\*\*C

State True Log

15.097

County True Log



Surface Type & Width (Left / Right)

G (9'/10')  
1.745 - 4.056

Base Type (Left / Right)

I  
1.745 - 4.056

Shoulder Type & Width (Left / Right)

2 (1/2')  
1.745 - 4.056

Through Lanes

2  
1.745 - 11.639

Street Name

SR 328  
1.745 - 6.171

- |                     |                   |                      |              |
|---------------------|-------------------|----------------------|--------------|
| Non-divided Highway | Bridge (on route) | Railroad (at grade)  | Intersection |
| Divided Highway     | Underpass         | Railroad (underpass) |              |
| Secondary Segment   | Overpass          | Railroad (overpass)  |              |
| <b>Corporation</b>  |                   |                      |              |

Created on: 7/1/2025

transportation.ohio.gov

Prepared by  
The Ohio Department of Transportation  
Office of Technical Services  
Roadway Information

# SHOCSR00328\*\*C

State True Log

16.097

County True Log

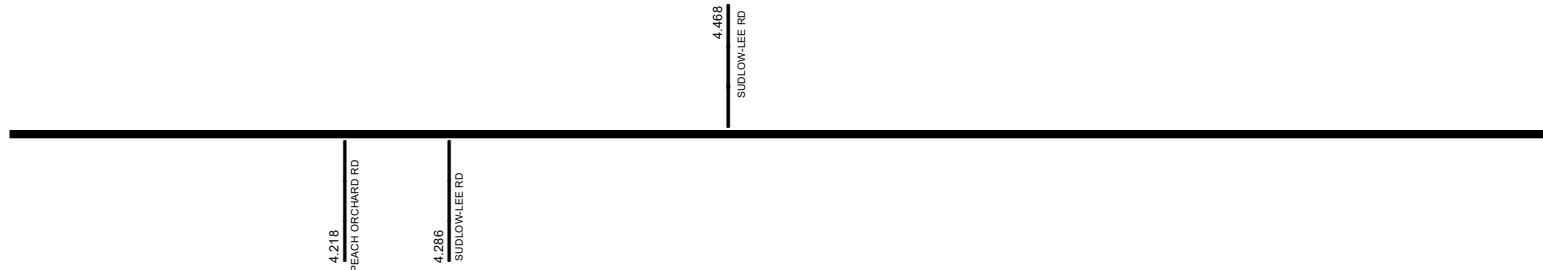

**Surface Type & Width (Left / Right)**

G (9'/10')	G 22'	G (9'/10')
1.745 - 4.056	4.056 - 4.366	4.366 - 10.467

**Base Type (Left / Right)**

I	L	I
1.745 - 4.056	4.056 - 4.366	4.366 - 5.716

**Shoulder Type & Width (Left / Right)**

2 (1'1/2')	2 (4'4')	2 (1'1/2')
1.745 - 4.056	4.056 - 4.366	4.366 - 10.467

**Through Lanes**

	2
1.745 - 11.639	

**Street Name**

	SR 328
1.745 - 6.171	

<p> Non-divided Highway</p> <p> Divided Highway</p> <p> Secondary Segment</p> <p> <b>Corporation</b></p>	<p> Bridge (on route)</p> <p> Underpass</p> <p> Overpass</p>	<p> Railroad (at grade)</p> <p> Railroad (underpass)</p> <p> Railroad (overpass)</p>	<p> Intersection</p>
--	--	--	----------------------

Created on: 7/1/2025

transportation.ohio.gov

Prepared by

The Ohio Department of Transportation

Office of Technical Services

Roadway Information

# SHOCSR00328\*\*C

State True Log

17.097

County True Log

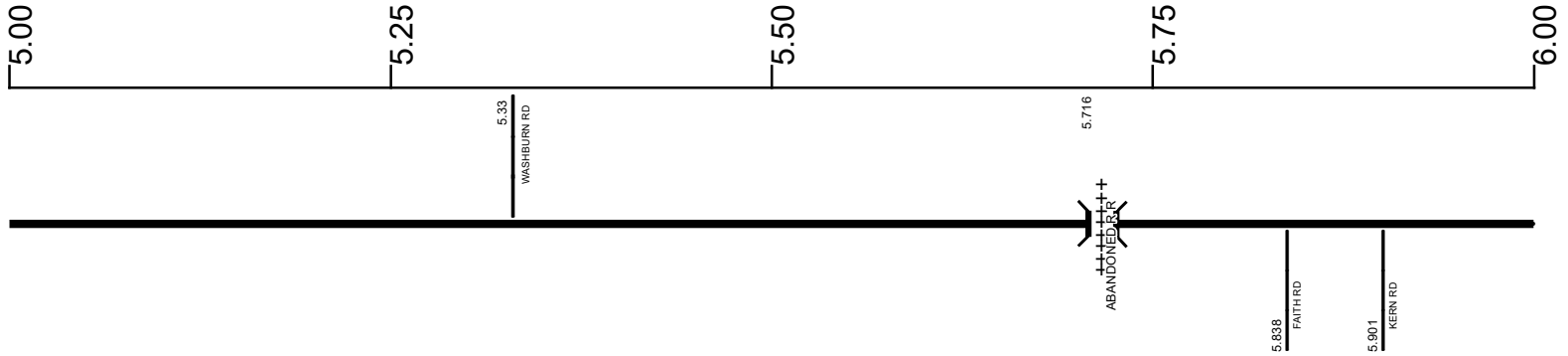

Surface Type & Width (Left / Right)

	G (9'/10')
	4.366 - 10.467

Base Type (Left / Right)

I	K
4.366 - 5.716	5.716 - 6.25

Shoulder Type & Width (Left / Right)

	2 (1/2')
	4.366 - 10.467

Through Lanes

	2
	1.745 - 11.639

Street Name

	SR 328
	1.745 - 6.171

- |  |   |   |   |
|--|---|---|---|
| <ul style="list-style-type: none"> <li> Non-divided Highway</li> <li> Divided Highway</li> <li> Secondary Segment</li> <li> Corporation</li> </ul> | <ul style="list-style-type: none"> <li> Bridge (on route)</li> <li> Underpass</li> <li> Overpass</li> </ul> | <ul style="list-style-type: none"> <li> Railroad (at grade)</li> <li> Railroad (underpass)</li> <li> Railroad (overpass)</li> </ul> | <ul style="list-style-type: none"> <li> Intersection</li> </ul> |
|--|---|---|---|

Created on: 7/1/2025

transportation.ohio.gov

Prepared by  
The Ohio Department of Transportation  
Office of Technical Services  
Roadway Information

# SHOCSR00328\*\*C

State True Log

18.097

County True Log

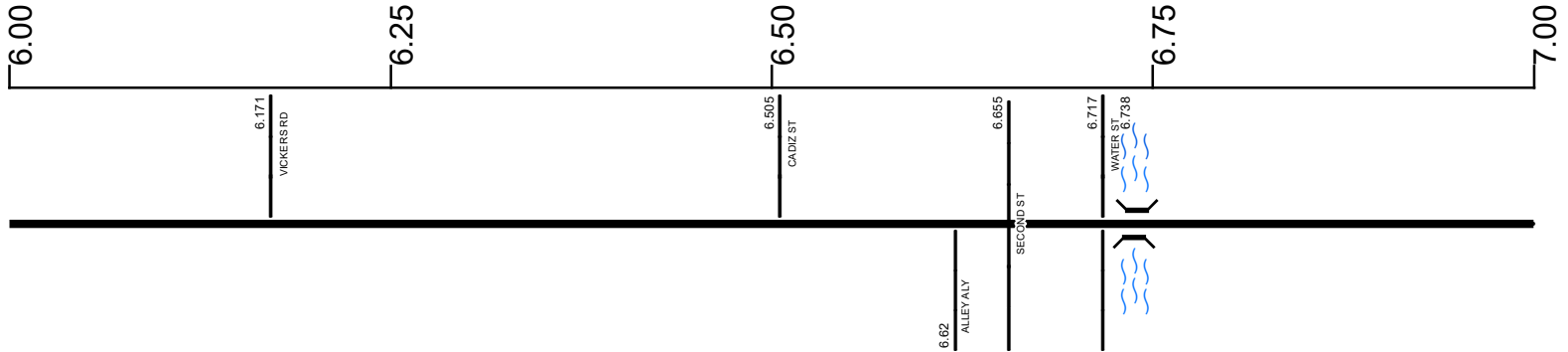

**Surface Type & Width (Left / Right)**

G (9'/10')
4.366 - 10.467

**Base Type (Left / Right)**

K	I
5.716 - 6.25	6.25 - 10.467

**Shoulder Type & Width (Left / Right)**

2 (1/2')
4.366 - 10.467

**Through Lanes**

2
1.745 - 11.639

**Street Name**

SR 328	MAIN ST	SR 328
1.745 - 6.171	6.171 - 6.862	6.862 - 11.639

- Non-divided Highway
- Divided Highway
- Secondary Segment
- Corporation
- Bridge (on route)
- Underpass
- Overpass
- Railroad (at grade)
- Railroad (underpass)
- Railroad (overpass)
- Intersection

Created on: 7/1/2025

transportation.ohio.gov

Prepared by  
The Ohio Department of Transportation  
Office of Technical Services  
Roadway Information

# SHOCSR00328\*\*C

State True Log

19.097

County True Log

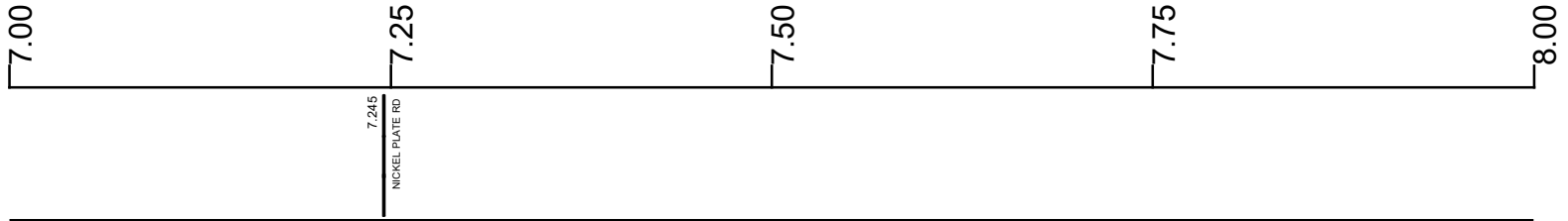

Surface Type & Width (Left / Right)

	G (9'/10')
	4.366 - 10.467

Base Type (Left / Right)

	I
	6.25 - 10.467

Shoulder Type & Width (Left / Right)

	2 (1/2')
	4.366 - 10.467

Through Lanes

	2
	1.745 - 11.639

Street Name

	SR 328
	6.862 - 11.639

- |  |   |   |   |
|--|---|---|---|
| <ul style="list-style-type: none"> <li> Non-divided Highway</li> <li> Divided Highway</li> <li> Secondary Segment</li> <li> Corporation</li> </ul> | <ul style="list-style-type: none"> <li> Bridge (on route)</li> <li> Underpass</li> <li> Overpass</li> </ul> | <ul style="list-style-type: none"> <li> Railroad (at grade)</li> <li> Railroad (underpass)</li> <li> Railroad (overpass)</li> </ul> | <ul style="list-style-type: none"> <li> Intersection</li> </ul> |
|--|---|---|---|

Created on: 7/1/2025

transportation.ohio.gov

Prepared by  
The Ohio Department of Transportation  
Office of Technical Services  
Roadway Information

# SHOCSR00328\*\*C

State True Log

20.097

County True Log



Surface Type & Width (Left / Right)	G (9'/10')
	4.366 - 10.467
Base Type (Left / Right)	I
	6.25 - 10.467
Shoulder Type & Width (Left / Right)	2 (1/2')
	4.366 - 10.467
Through Lanes	2
	1.745 - 11.639
Street Name	SR 328
	6.862 - 11.639

Non-divided Highway	Bridge (on route)	Railroad (at grade)	Intersection
Divided Highway	Underpass	Railroad (underpass)	
Secondary Segment	Overpass	Railroad (overpass)	
Corporation			

Created on: 7/1/2025

transportation.ohio.gov

Prepared by  
The Ohio Department of Transportation  
Office of Technical Services  
Roadway Information

# SHOCSR00328\*\*C

State True Log

21.097

County True Log

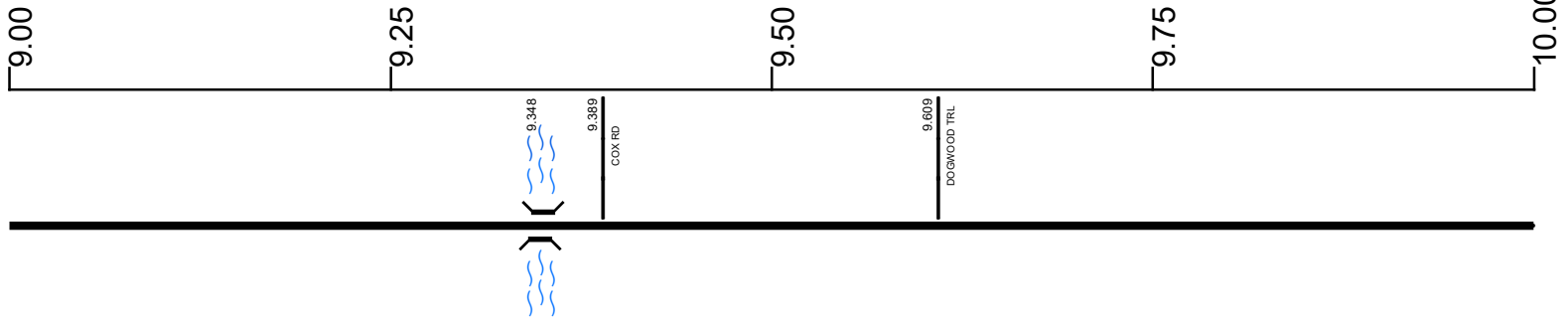

Surface Type & Width (Left / Right)

G (9'/10')  
4.366 - 10.467

Base Type (Left / Right)

I  
6.25 - 10.467

Shoulder Type & Width (Left / Right)

2 (1/2')  
4.366 - 10.467

Through Lanes

2  
1.745 - 11.639

Street Name

SR 328  
6.862 - 11.639

- |                     |                   |                      |              |
|---------------------|-------------------|----------------------|--------------|
| Non-divided Highway | Bridge (on route) | Railroad (at grade)  | Intersection |
| Divided Highway     | Underpass         | Railroad (underpass) |              |
| Secondary Segment   | Overpass          | Railroad (overpass)  |              |
| Corporation         |                   |                      |              |

Created on: 7/1/2025

transportation.ohio.gov

Prepared by  
The Ohio Department of Transportation  
Office of Technical Services  
Roadway Information

# SHOCSR00328\*\*C

State True Log

22.097

County True Log

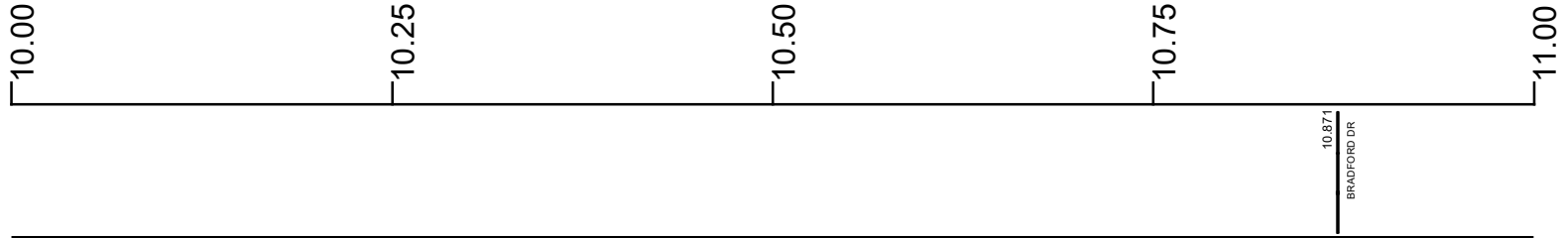

**Surface Type & Width (Left / Right)**

G (9'/10')	G 24'	G 26'	G (19'/17')
4.366 - 10.467	10.467 - 10.695	10.695 - 10.809	10.809 - 11.114

**Base Type (Left / Right)**

I	L	N / L
6.25 - 10.467	10.467 - 10.809	10.809 - 11.141

**Shoulder Type & Width (Left / Right)**

2 (1'2')	2 (4'4')	5 (4'4')
4.366 - 10.467	10.467 - 10.695	10.695 - 11.279

**Through Lanes**

2	1.745 - 11.639
---	----------------

**Street Name**

SR 328	6.862 - 11.639
--------	----------------

- |  |   |   |   |
|--|---|---|---|
| <ul style="list-style-type: none"> <li> Non-divided Highway</li> <li> Divided Highway</li> <li> Secondary Segment</li> <li> Corporation</li> </ul> | <ul style="list-style-type: none"> <li> Bridge (on route)</li> <li> Underpass</li> <li> Overpass</li> </ul> | <ul style="list-style-type: none"> <li> Railroad (at grade)</li> <li> Railroad (underpass)</li> <li> Railroad (overpass)</li> </ul> | <ul style="list-style-type: none"> <li> Intersection</li> </ul> |
|--|---|---|---|

Created on: 7/1/2025

transportation.ohio.gov

Prepared by  
The Ohio Department of Transportation  
Office of Technical Services  
Roadway Information

# SHOCSR00328\*\*C

22.736

State True Log

County True Log

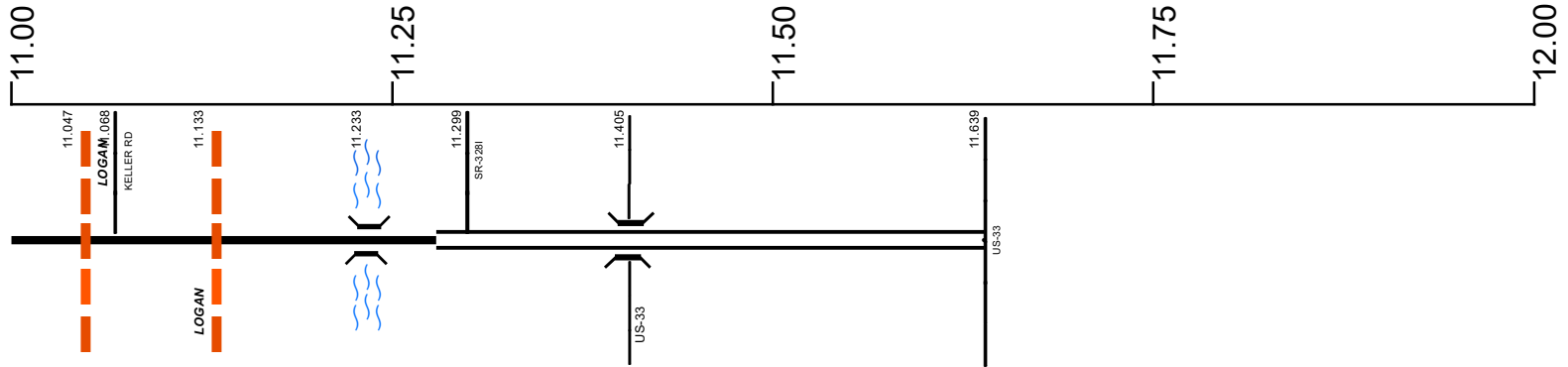

### Surface Type & Width (Left / Right)

G (19'/17')	G (24'3')	G 24'	G 32'
10.809 - 11.114	11.114 - 11.141	11.141 - 11.299	11.299 - 11.639

### Base Type (Left / Right)

N / L	N	N / P	P
10.809 - 11.141	11.141 - 11.299	11.299 - 11.533	11.533 - 11.639

### Shoulder Type & Width (Left / Right)

5 (4'4')	5 (0'0')	5 (3'6')
10.695 - 11.279	11.279 - 11.299	11.299 - 11.639

### Median Type and Width

3 (6')	2 (30')
11.279 - 11.299	11.299 - 11.639

### Through Lanes

2
1.745 - 11.639

### Street Name

SR 328
6.862 - 11.639

- Non-divided Highway
- Divided Highway
- Secondary Segment
- Corporation
- Bridge (on route)
- Underpass
- Overpass
- Railroad (at grade)
- Railroad (underpass)
- Railroad (overpass)
- Intersection

Created on: 7/1/2025



transportation.ohio.gov  
 Prepared by  
 The Ohio Department of Transportation  
 Office of Technical Services  
 Roadway Information

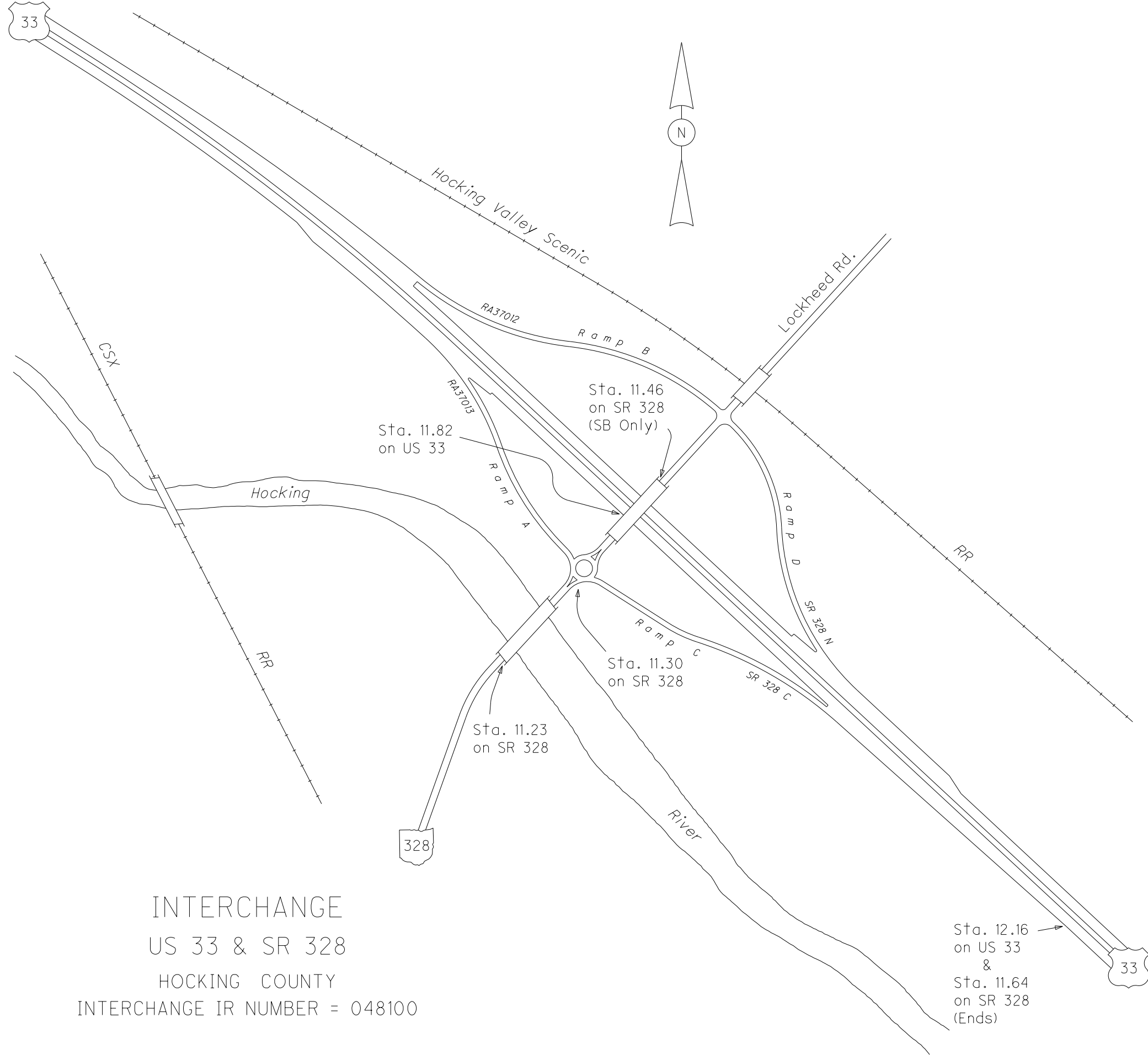

INTERCHANGE  
 US 33 & SR 328  
 HOCKING COUNTY  
 INTERCHANGE IR NUMBER = 048100

Sta. 12.16  
 on US 33  
 &  
 Sta. 11.64  
 on SR 328  
 (Ends)

## Historical Project List for SHOCSR00328\*\*C

Begin Measure	End Measure	Project ID Number	Construction Completion Date	Treatment Category	Treatment Type
1.745	5.883	102559	11-2020	Minor Rehabilitation	60-AC Overlay w/Rpr
1.745	11.449	24803	9-2006	Minor Rehabilitation	50-AC Overlay w/o Rpr
5.883	11.085	84538	8-2018	Minor Rehabilitation	60-AC Overlay w/Rpr
10.725	11.102	81354	10-2008	Minor Rehabilitation	60-AC Overlay w/Rpr
11.111	11.248	90947	12-2014	Minor Rehabilitation	50-AC Overlay w/o Rpr

# Roadway Codes

## Access Control Journalized

- F - Full Access Control
- L - Limited Access Control
- N - No Access Control

## Access Control Operational

- 1 - Full Access Control
- 2 - Partial Access Control
- 3 - No Access Control

## Base Type

- F - Crack and Seat
- H - Rubblize and Roll
- I - Aggregate Base 304 or Traffic Compacted
- K - Water Bound Macadam
- L - Bituminous Concrete Mix or Penetration Macadam
- N - Plain Concrete
- P - Reinforced Concrete
- R - Brick (Flexible)
- T - Brick (Rigid)

## Direction of Travel

- B - Both (Two-way)
- F - One-way Cardinal
- T - One-way Non-cardinal

## Facility Type

- 1 - One-way Roadway
- 2 - Two-way Roadway
- 4 - Ramp
- 5 - Non-mainline
- 6 - Non-inventory Direction
- 7 - Planned / Unbuilt

## Historical Federal Aid Indicator

- N - Not a FAP Route
- Y - FAP Route

## Functional Classification

- 01 - Interstate
- 02 - Principal Arterial (Freeways)
- 03 - Principal Arterial (Other)
- 04 - Minor Arterial
- 05 - Major Collector
- 06 - Minor Collector
- 07 - Local

## Leave / Reenter Indicator

- Y - Route leaves/reenters at this point
- N - Route does not leave/reenter at this point

## Median Type

- 1 - None
- 2 - Unprotected
- 3 - Curbed
- 4 - Positive Barrier (Unspecified)
- 5 - Positive Barrier (Flexible)
- 6 - Positive Barrier (Semi-rigid)
- 7 - Positive Barrier (Rigid)

## NHS

- N - National Highway System
- H - Congressional Corridor
- 2 - Major Airport
- 3 - Major Port Facility
- 4 - Major Amtrak Station
- 5 - Major Rail / Truck Terminal
- 6 - Major Intercity Bus Terminal
- 7 - Major Public Transit / Multi-modal Passenger Terminal
- 8 - Major Pipeline Terminal
- 9 - Major Ferry Terminal

## Priority System

- G - General
- P - Priority System
- U - Urban

## Scenic Byway Code

- A - All American Road
- N - National Scenic Byway
- S - State Scenic Byway

## Shoulder Type

- 1 - None
- 2 - Surfaced shoulder exists (bituminous concrete {AC})
- 3 - Surfaced shoulder exists (Portland Cement Concrete {PCC})
- 4 - Stabilized shoulder exists (gravel or other granular material)
- 5 - Combination shoulder exists (two or more surface types)
- 6 - Earth shoulder exists
- 7 - Barrier curb exists; no shoulder in front of curb

## Surface Type

- A - Combination
- B - Brick
- C - Continuous Reinforced Concrete
- D - Reinforced Concrete
- E - Plain Concrete
- G - Bituminous Concrete
- I - Chipseal on Granular
- K - Open Graded Bituminous
- L - Chipseal or Micro
- M - Gravel
- U - Unimproved
- X - Right of Way Only