

# SJACSR00139\*\*C

State True Log 18.023

19.023

County True Log



Surface Type & Width (Left / Right)	G 20' 0 - 14.661
Base Type (Left / Right)	I 0 - 14.45
Shoulder Type & Width (Left / Right)	2 (3/3) 0 - 14.431
Through Lanes	2 0 - 15.593
Street Name	SR 139 0 - 14.434

<ul style="list-style-type: none"> <li> Non-divided Highway</li> <li> Divided Highway</li> <li> Secondary Segment</li> <li> Corporation</li> </ul>	<ul style="list-style-type: none"> <li> Bridge (on route)</li> <li> Underpass</li> <li> Overpass</li> </ul>	<ul style="list-style-type: none"> <li> Railroad (at grade)</li> <li> Railroad (underpass)</li> <li> Railroad (overpass)</li> </ul>	<ul style="list-style-type: none"> <li> Intersection</li> </ul>
--	---	---	---

Created on: 7/1/2025

transportation.ohio.gov

Prepared by  
The Ohio Department of Transportation  
Office of Technical Services  
Roadway Information

# SJACSR00139\*\*C

State True Log

20.023

County True Log

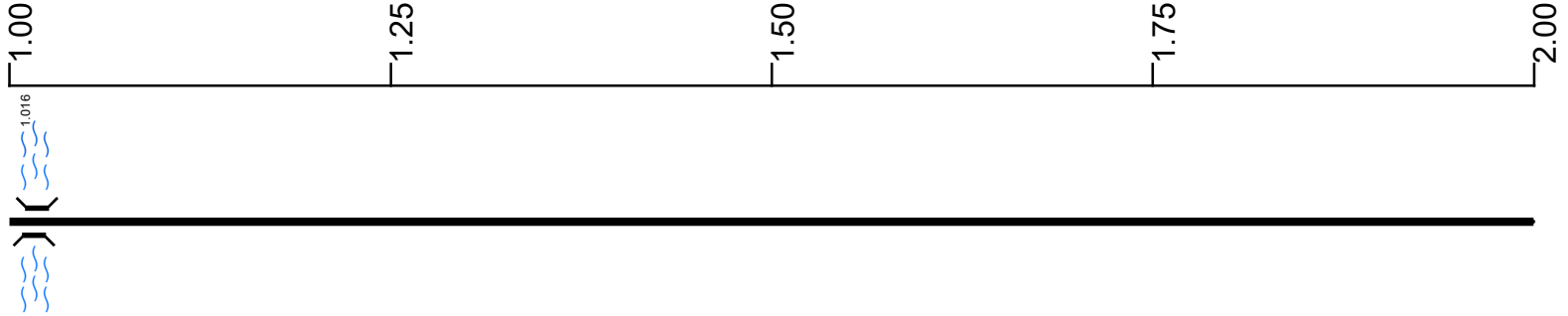

Surface Type & Width (Left / Right)

G 20'  
0 - 14.661

Base Type (Left / Right)

I  
0 - 14.45

Shoulder Type & Width (Left / Right)

2 (3/3)  
0 - 14.431

Through Lanes

2  
0 - 15.593

Street Name

SR 139  
0 - 14.434

- |                     |                   |                      |              |
|---------------------|-------------------|----------------------|--------------|
| Non-divided Highway | Bridge (on route) | Railroad (at grade)  | Intersection |
| Divided Highway     | Underpass         | Railroad (underpass) |              |
| Secondary Segment   | Overpass          | Railroad (overpass)  |              |
| Corporation         |                   |                      |              |

Created on: 7/1/2025

transportation.ohio.gov

Prepared by  
The Ohio Department of Transportation  
Office of Technical Services  
Roadway Information

# SJACSR00139\*\*C

State True Log

21.023

County True Log

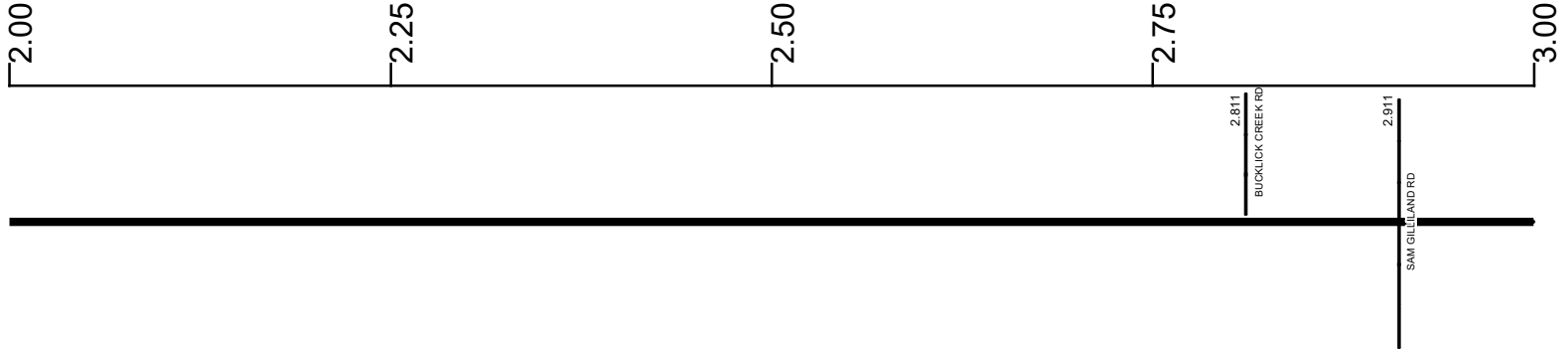

Surface Type & Width (Left / Right)

G 20'  
0 - 14.661

Base Type (Left / Right)

I  
0 - 14.45

Shoulder Type & Width (Left / Right)

2 (3/3)  
0 - 14.431

Through Lanes

2  
0 - 15.593

Street Name

SR 139  
0 - 14.434

- |                     |                   |                      |              |
|---------------------|-------------------|----------------------|--------------|
| Non-divided Highway | Bridge (on route) | Railroad (at grade)  | Intersection |
| Divided Highway     | Underpass         | Railroad (underpass) |              |
| Secondary Segment   | Overpass          | Railroad (overpass)  |              |
| Corporation         |                   |                      |              |

Created on: 7/1/2025

transportation.ohio.gov

Prepared by  
The Ohio Department of Transportation  
Office of Technical Services  
Roadway Information

# SJACSR00139\*\*C

State True Log

22.023

County True Log



Surface Type & Width (Left / Right)	G 20' 0 - 14.661
Base Type (Left / Right)	I 0 - 14.45
Shoulder Type & Width (Left / Right)	2 (3/3) 0 - 14.431
Through Lanes	2 0 - 15.593
Street Name	SR 139 0 - 14.434

- |                     |                   |                      |              |
|---------------------|-------------------|----------------------|--------------|
| Non-divided Highway | Bridge (on route) | Railroad (at grade)  | Intersection |
| Divided Highway     | Underpass         | Railroad (underpass) |              |
| Secondary Segment   | Overpass          | Railroad (overpass)  |              |
| Corporation         |                   |                      |              |

Created on: 7/1/2025

transportation.ohio.gov

Prepared by  
The Ohio Department of Transportation  
Office of Technical Services  
Roadway Information

# SJACSR00139\*\*C

State True Log

23.023

County True Log

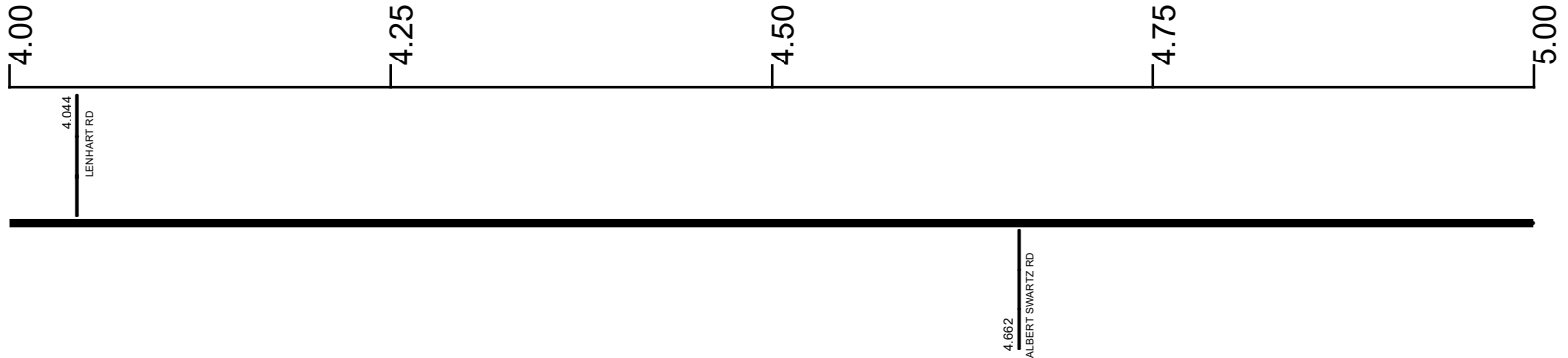

Surface Type & Width (Left / Right)

G 20'  
0 - 14.661

Base Type (Left / Right)

I  
0 - 14.45

Shoulder Type & Width (Left / Right)

2 (3/3)  
0 - 14.431

Through Lanes

2  
0 - 15.593

Street Name

SR 139  
0 - 14.434

- |                     |                   |                      |              |
|---------------------|-------------------|----------------------|--------------|
| Non-divided Highway | Bridge (on route) | Railroad (at grade)  | Intersection |
| Divided Highway     | Underpass         | Railroad (underpass) |              |
| Secondary Segment   | Overpass          | Railroad (overpass)  |              |
| Corporation         |                   |                      |              |

Created on: 7/1/2025

transportation.ohio.gov

Prepared by  
The Ohio Department of Transportation  
Office of Technical Services  
Roadway Information

# SJACSR00139\*\*C

State True Log

24.023

County True Log

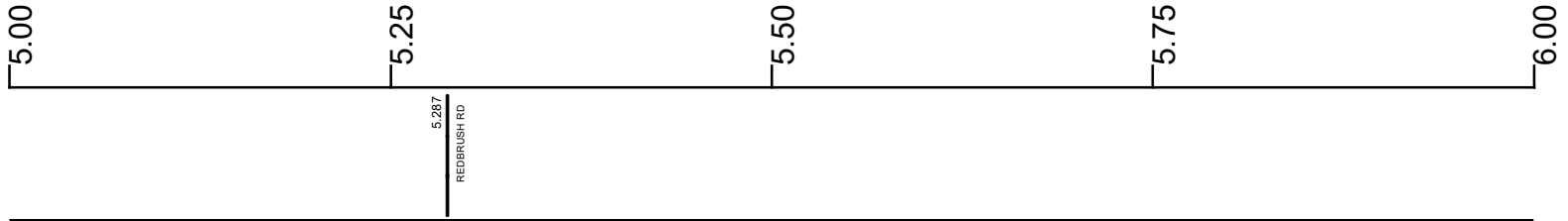

Surface Type & Width (Left / Right)

G 20'  
0 - 14.661

Base Type (Left / Right)

I  
0 - 14.45

Shoulder Type & Width (Left / Right)

2 (3/3)  
0 - 14.431

Through Lanes

2  
0 - 15.593

Street Name

SR 139  
0 - 14.434

- |                     |                   |                      |              |
|---------------------|-------------------|----------------------|--------------|
| Non-divided Highway | Bridge (on route) | Railroad (at grade)  | Intersection |
| Divided Highway     | Underpass         | Railroad (underpass) |              |
| Secondary Segment   | Overpass          | Railroad (overpass)  |              |
| Corporation         |                   |                      |              |

Created on: 7/1/2025

transportation.ohio.gov

Prepared by  
The Ohio Department of Transportation  
Office of Technical Services  
Roadway Information

# SJACSR00139\*\*C

State True Log

25.023

County True Log



Surface Type & Width (Left / Right)	G 20' 0 - 14.661
Base Type (Left / Right)	I 0 - 14.45
Shoulder Type & Width (Left / Right)	2 (3/3) 0 - 14.431
Through Lanes	2 0 - 15.593
Street Name	SR 139 0 - 14.434

Non-divided Highway	Bridge (on route)	Railroad (at grade)	Intersection
Divided Highway	Underpass	Railroad (underpass)	
Secondary Segment	Overpass	Railroad (overpass)	
Corporation			

Created on: 7/1/2025

transportation.ohio.gov

Prepared by  
The Ohio Department of Transportation  
Office of Technical Services  
Roadway Information

# SJACSR00139\*\*C

State True Log

26.023

County True Log

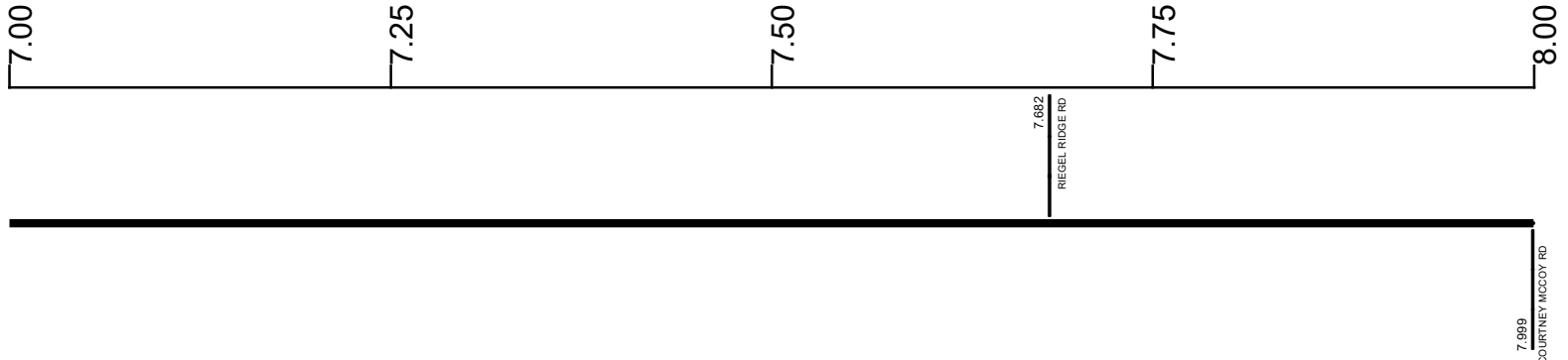

Surface Type & Width (Left / Right)

G 20'  
0 - 14.661

Base Type (Left / Right)

I  
0 - 14.45

Shoulder Type & Width (Left / Right)

2 (3/3)  
0 - 14.431

Through Lanes

2  
0 - 15.593

Street Name

SR 139  
0 - 14.434

- |                     |                   |                      |              |
|---------------------|-------------------|----------------------|--------------|
| Non-divided Highway | Bridge (on route) | Railroad (at grade)  | Intersection |
| Divided Highway     | Underpass         | Railroad (underpass) |              |
| Secondary Segment   | Overpass          | Railroad (overpass)  |              |
| Corporation         |                   |                      |              |

Created on: 7/1/2025

transportation.ohio.gov

Prepared by  
The Ohio Department of Transportation  
Office of Technical Services  
Roadway Information

# SJACSR00139\*\*C

State True Log

27.023

County True Log



Surface Type & Width (Left / Right)

G 20'  
0 - 14.661

Base Type (Left / Right)

I  
0 - 14.45

Shoulder Type & Width (Left / Right)

2 (3/3)  
0 - 14.431

Through Lanes

2  
0 - 15.593

Street Name

SR 139  
0 - 14.434

- |                     |                   |                      |              |
|---------------------|-------------------|----------------------|--------------|
| Non-divided Highway | Bridge (on route) | Railroad (at grade)  | Intersection |
| Divided Highway     | Underpass         | Railroad (underpass) |              |
| Secondary Segment   | Overpass          | Railroad (overpass)  |              |
| Corporation         |                   |                      |              |

Created on: 7/1/2025

transportation.ohio.gov

Prepared by  
The Ohio Department of Transportation  
Office of Technical Services  
Roadway Information

# SJACSR00139\*\*C

State True Log

28.023

County True Log

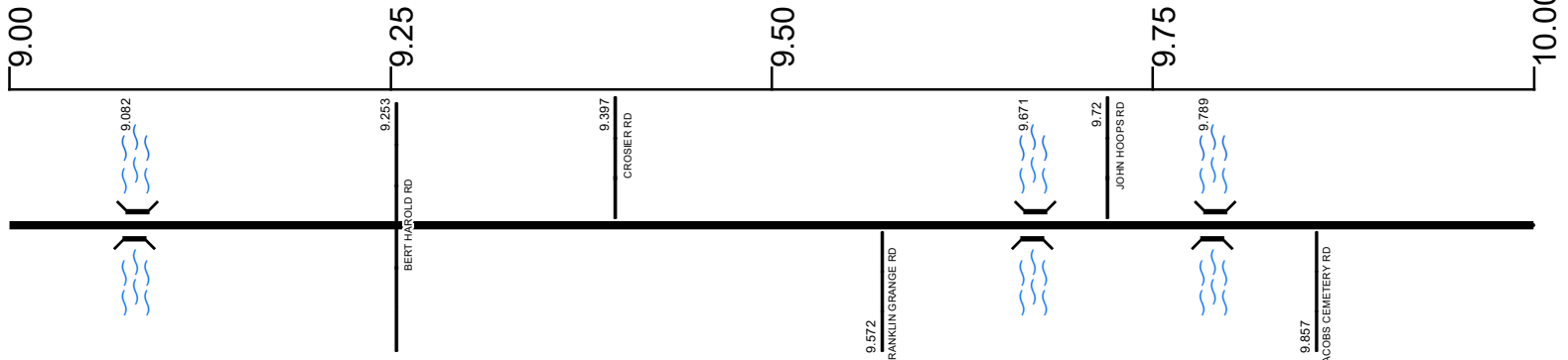

Surface Type & Width (Left / Right)	G 20' 0 - 14.661
Base Type (Left / Right)	I 0 - 14.45
Shoulder Type & Width (Left / Right)	2 (3/3) 0 - 14.431
Through Lanes	2 0 - 15.593
Street Name	SR 139 0 - 14.434

- |                     |                   |                      |              |
|---------------------|-------------------|----------------------|--------------|
| Non-divided Highway | Bridge (on route) | Railroad (at grade)  | Intersection |
| Divided Highway     | Underpass         | Railroad (underpass) |              |
| Secondary Segment   | Overpass          | Railroad (overpass)  |              |
| Corporation         |                   |                      |              |

Created on: 7/1/2025

transportation.ohio.gov

Prepared by  
The Ohio Department of Transportation  
Office of Technical Services  
Roadway Information

# SJACSR00139\*\*C

State True Log

29.023

County True Log

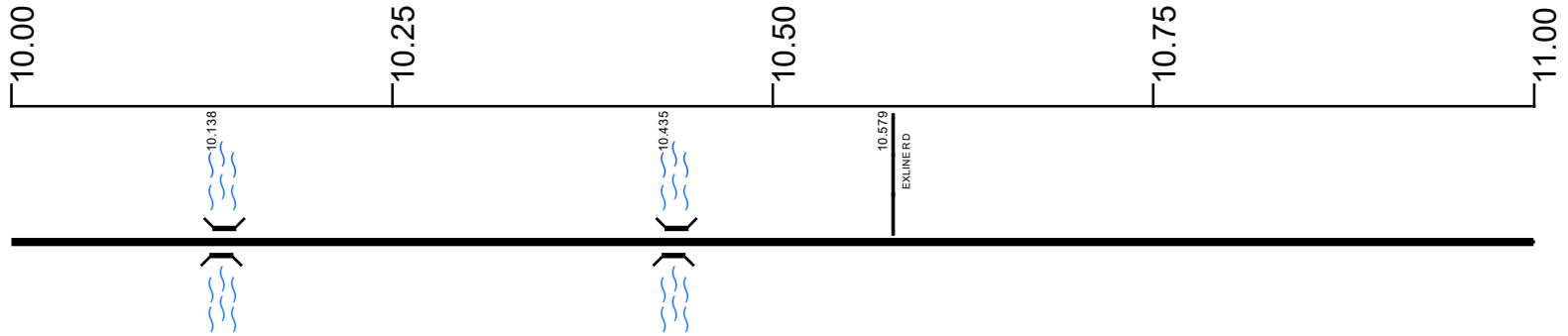

Surface Type & Width (Left / Right)

	G 20'
	0 - 14.661

Base Type (Left / Right)

	I
	0 - 14.45

Shoulder Type & Width (Left / Right)

	2 (3/3)
	0 - 14.431

Through Lanes

	2
	0 - 15.593

Street Name

	SR 139
	0 - 14.434

- |                     |                   |                      |              |
|---------------------|-------------------|----------------------|--------------|
| Non-divided Highway | Bridge (on route) | Railroad (at grade)  | Intersection |
| Divided Highway     | Underpass         | Railroad (underpass) |              |
| Secondary Segment   | Overpass          | Railroad (overpass)  |              |
| Corporation         |                   |                      |              |

Created on: 7/1/2025

transportation.ohio.gov

Prepared by  
The Ohio Department of Transportation  
Office of Technical Services  
Roadway Information

# SJACSR00139\*\*C

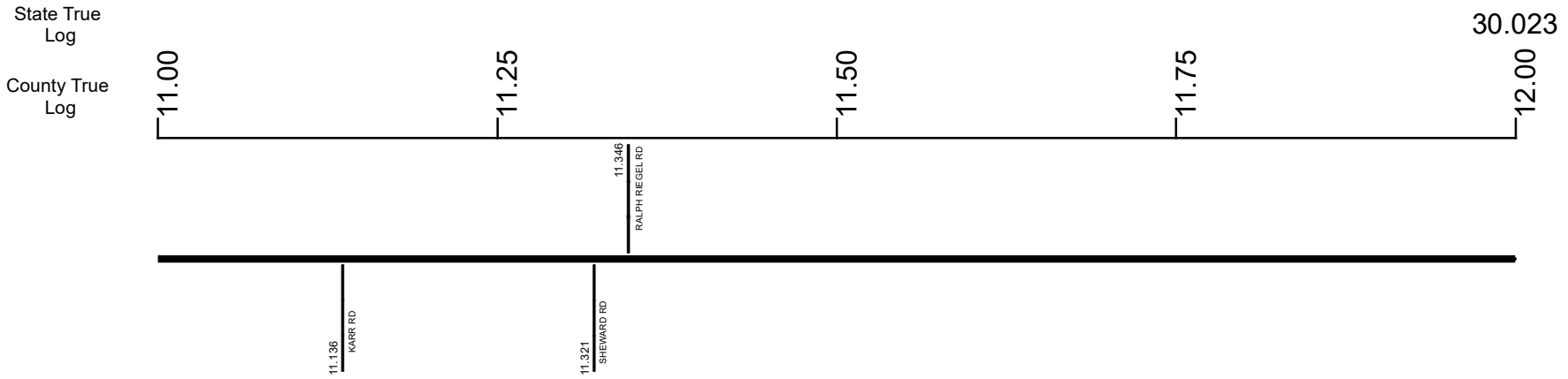

Surface Type & Width (Left / Right)	G 20' 0 - 14.661
Base Type (Left / Right)	I 0 - 14.45
Shoulder Type & Width (Left / Right)	2 (3/3) 0 - 14.431
Through Lanes	2 0 - 15.593
Street Name	SR 139 0 - 14.434

- Non-divided Highway
- Divided Highway
- Secondary Segment
- Corporation
- Bridge (on route)
- Underpass
- Overpass
- Railroad (at grade)
- Railroad (underpass)
- Railroad (overpass)
- Intersection

Created on: 7/1/2025

transportation.ohio.gov

Prepared by  
The Ohio Department of Transportation  
Office of Technical Services  
Roadway Information

# SJACSR00139\*\*C

State True Log  
County True Log

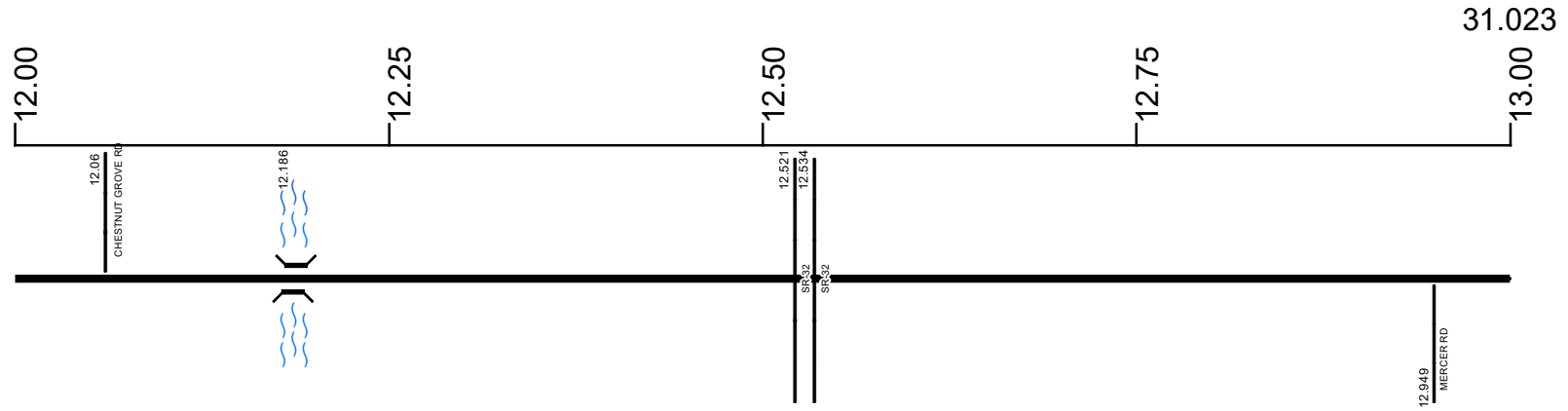

Surface Type & Width (Left / Right)

G 20'  
0 - 14.661

Base Type (Left / Right)

I  
0 - 14.45

Shoulder Type & Width (Left / Right)

2 (3/3)  
0 - 14.431

Through Lanes

2  
0 - 15.593

Street Name

SR 139  
0 - 14.434

- |                     |                   |                      |              |
|---------------------|-------------------|----------------------|--------------|
| Non-divided Highway | Bridge (on route) | Railroad (at grade)  | Intersection |
| Divided Highway     | Underpass         | Railroad (underpass) |              |
| Secondary Segment   | Overpass          | Railroad (overpass)  |              |
| Corporation         |                   |                      |              |

Created on: 7/1/2025



transportation.ohio.gov  
Prepared by  
The Ohio Department of Transportation  
Office of Technical Services  
Roadway Information

# SJACSR00139\*\*C

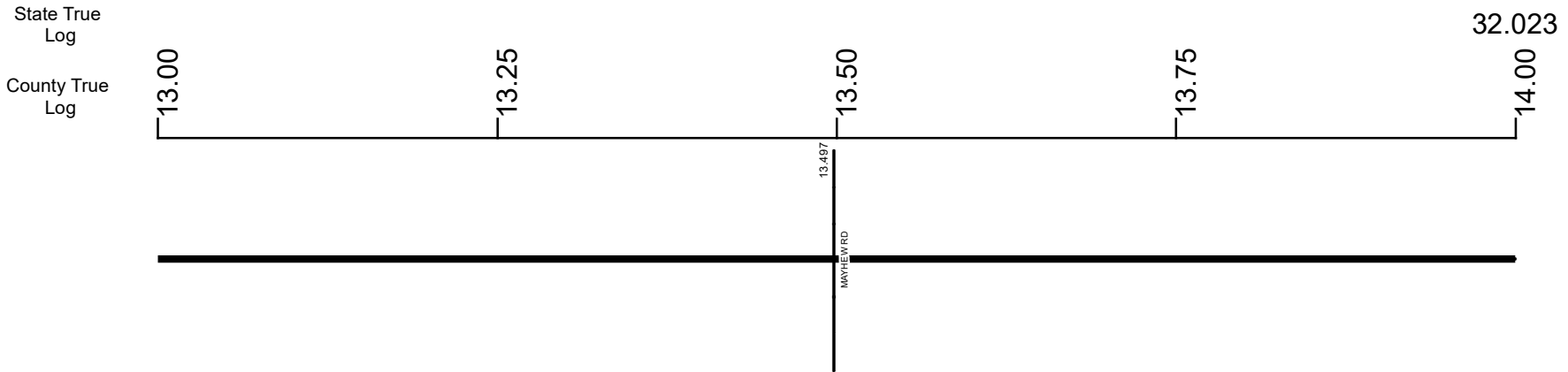

Surface Type & Width (Left / Right)

G 20'  
0 - 14.661

Base Type (Left / Right)

I  
0 - 14.45

Shoulder Type & Width (Left / Right)

2 (3/3)  
0 - 14.431

Through Lanes

2  
0 - 15.593

Street Name

SR 139  
0 - 14.434

- Non-divided Highway
- Divided Highway
- Secondary Segment
- Corporation
- Bridge (on route)
- Underpass
- Overpass
- Railroad (at grade)
- Railroad (underpass)
- Railroad (overpass)
- Intersection

Created on: 7/1/2025

transportation.ohio.gov  
Prepared by  
The Ohio Department of Transportation  
Office of Technical Services  
Roadway Information

# SJACSR00139\*\*C

State True Log

33.023

County True Log

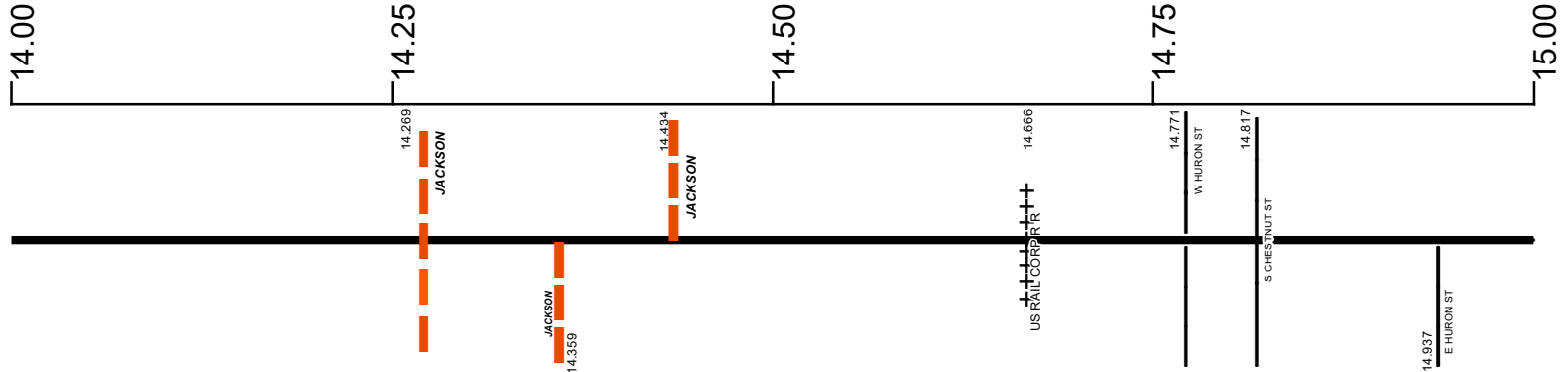

**Surface Type & Width (Left / Right)**

G 20'	G 26'
0 - 14.661	14.661 - 15.186

**Base Type (Left / Right)**

I	R	T
0 - 14.45	14.45 - 14.937	14.937 - 15.481

**Shoulder Type & Width (Left / Right)**

2 (3'/3')	2 (2'/2')	2 (4'/4')	1 (0'/0')
0 - 14.431	14.431 - 14.45	14.45 - 14.661	14.661 - 15.593

**Resurface Year**

2021
14.303 - 15.276

**Through Lanes**

2
0 - 15.593

**Street Name**

SR 139	S BENNETT AVE	W HURON ST	VAUGHN ST
0 - 14.434	14.434 - 14.771	14.771 - 14.937	14.937 - 15.186

- Non-divided Highway
- Divided Highway
- Secondary Segment
- Corporation
- Bridge (on route)
- Underpass
- Overpass
- Railroad (at grade)
- Railroad (underpass)
- Railroad (overpass)
- Intersection

Created on: 7/1/2025

transportation.ohio.gov

Prepared by  
The Ohio Department of Transportation  
Office of Technical Services  
Roadway Information

# SJACSR00139\*\*C

State True Log

33.865

County True Log

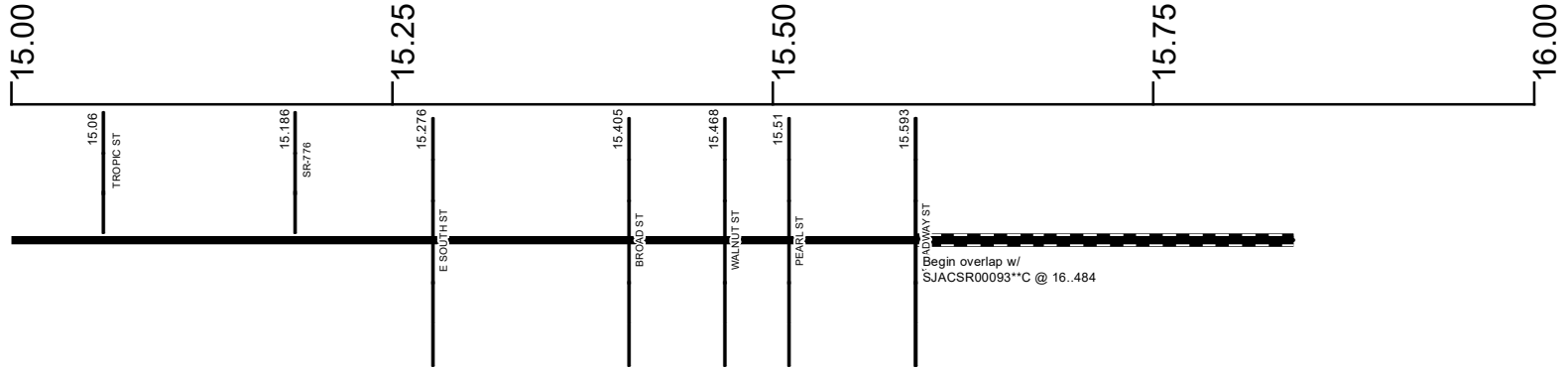

**Surface Type & Width (Left / Right)**

G 26'	G 30'	G 40'	G 50'
14.661 - 15.186	15.186 - 15.276	15.276 - 15.468	15.468 - 15.593

**Base Type (Left / Right)**

T	R
14.937 - 15.481	15.481 - 15.593

**Shoulder Type & Width (Left / Right)**

1 (0'/0')
14.661 - 15.593

**Resurface Year**

2021	2022
14.303 - 15.276	15.276 - 15.593

**Through Lanes**

2
0 - 15.593

**Street Name**

VAUGHN ST	E SOUTH ST	BROADWAY ST
14.937 - 15.186	15.186 - 15.276	15.276 - 15.593

- Non-divided Highway
- Divided Highway
- Secondary Segment
- Corporation
- Bridge (on route)
- Underpass
- Overpass
- Railroad (at grade)
- Railroad (underpass)
- Railroad (overpass)
- Intersection

Created on: 7/1/2025

transportation.ohio.gov

Prepared by

The Ohio Department of Transportation

Office of Technical Services

Roadway Information

## Historical Project List for SJACSR00139\*\*C

Begin Measure	End Measure	Project ID Number	Construction Completion Date	Treatment Category	Treatment Type
0.000	14.303	83872	10-2014	Minor Rehabilitation	60-AC Overlay w/Rpr
0.000	14.433	78164	9-2009	Preventive Maintenance	25-Chip Seal
14.303	15.276	109840	11-2021	Minor Rehabilitation	50-AC Overlay w/o Rpr
14.433	15.266	25487	7-2011	Minor Rehabilitation	60-AC Overlay w/Rpr
15.276	15.593	100500	7-2023	Minor Rehabilitation	50-AC Overlay w/o Rpr

# Roadway Codes

## Access Control Journalized

- F - Full Access Control
- L - Limited Access Control
- N - No Access Control

## Access Control Operational

- 1 - Full Access Control
- 2 - Partial Access Control
- 3 - No Access Control

## Base Type

- F - Crack and Seat
- H - Rubblize and Roll
- I - Aggregate Base 304 or Traffic Compacted
- K - Water Bound Macadam
- L - Bituminous Concrete Mix or Penetration Macadam
- N - Plain Concrete
- P - Reinforced Concrete
- R - Brick (Flexible)
- T - Brick (Rigid)

## Direction of Travel

- B - Both (Two-way)
- F - One-way Cardinal
- T - One-way Non-cardinal

## Facility Type

- 1 - One-way Roadway
- 2 - Two-way Roadway
- 4 - Ramp
- 5 - Non-mainline
- 6 - Non-inventory Direction
- 7 - Planned / Unbuilt

## Historical Federal Aid Indicator

- N - Not a FAP Route
- Y - FAP Route

## Functional Classification

- 01 - Interstate
- 02 - Principal Arterial (Freeways)
- 03 - Principal Arterial (Other)
- 04 - Minor Arterial
- 05 - Major Collector
- 06 - Minor Collector
- 07 - Local

## Leave / Reenter Indicator

- Y - Route leaves/reenters at this point
- N - Route does not leave/reenter at this point

## Median Type

- 1 - None
- 2 - Unprotected
- 3 - Curbed
- 4 - Positive Barrier (Unspecified)
- 5 - Positive Barrier (Flexible)
- 6 - Positive Barrier (Semi-rigid)
- 7 - Positive Barrier (Rigid)

## NHS

- N - National Highway System
- H - Congressional Corridor
- 2 - Major Airport
- 3 - Major Port Facility
- 4 - Major Amtrak Station
- 5 - Major Rail / Truck Terminal
- 6 - Major Intercity Bus Terminal
- 7 - Major Public Transit / Multi-modal Passenger Terminal
- 8 - Major Pipeline Terminal
- 9 - Major Ferry Terminal

## Priority System

- G - General
- P - Priority System
- U - Urban

## Scenic Byway Code

- A - All American Road
- N - National Scenic Byway
- S - State Scenic Byway

## Shoulder Type

- 1 - None
- 2 - Surfaced shoulder exists (bituminous concrete {AC})
- 3 - Surfaced shoulder exists (Portland Cement Concrete {PCC})
- 4 - Stabilized shoulder exists (gravel or other granular material)
- 5 - Combination shoulder exists (two or more surface types)
- 6 - Earth shoulder exists
- 7 - Barrier curb exists; no shoulder in front of curb

## Surface Type

- A - Combination
- B - Brick
- C - Continuous Reinforced Concrete
- D - Reinforced Concrete
- E - Plain Concrete
- G - Bituminous Concrete
- I - Chipseal on Granular
- K - Open Graded Bituminous
- L - Chipseal or Micro
- M - Gravel
- U - Unimproved
- X - Right of Way Only