

SLORSR00611**C

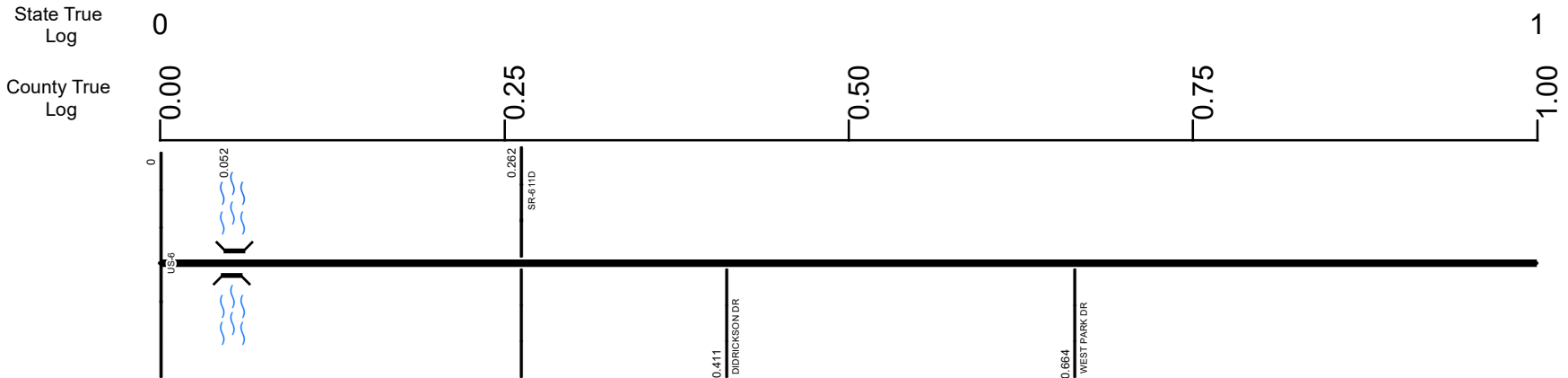

Surface Type & Width (Left / Right)	
G 24' 0 - 0.183	G 52' 0.183 - 1.9
Base Type (Left / Right)	
N 0 - 3.384	
Shoulder Type & Width (Left / Right)	
1 (0'/0') 0 - 5.71	
Resurface Year	
2024 0.183 - 4.28	
Through Lanes	
2 0 - 0.183	4 0.183 - 1.9
Street Name	
W 21ST ST 0 - 3.088	

- | | | | |
|--|---|---|---|
| <ul style="list-style-type: none"> Non-divided Highway Divided Highway Secondary Segment Corporation | <ul style="list-style-type: none"> Bridge (on route) Underpass Overpass | <ul style="list-style-type: none"> Railroad (at grade) Railroad (underpass) Railroad (overpass) | <ul style="list-style-type: none"> Intersection |
|--|---|---|---|

Created on: 7/1/2025

transportation.ohio.gov

Prepared by
The Ohio Department of Transportation
Office of Technical Services
Roadway Information

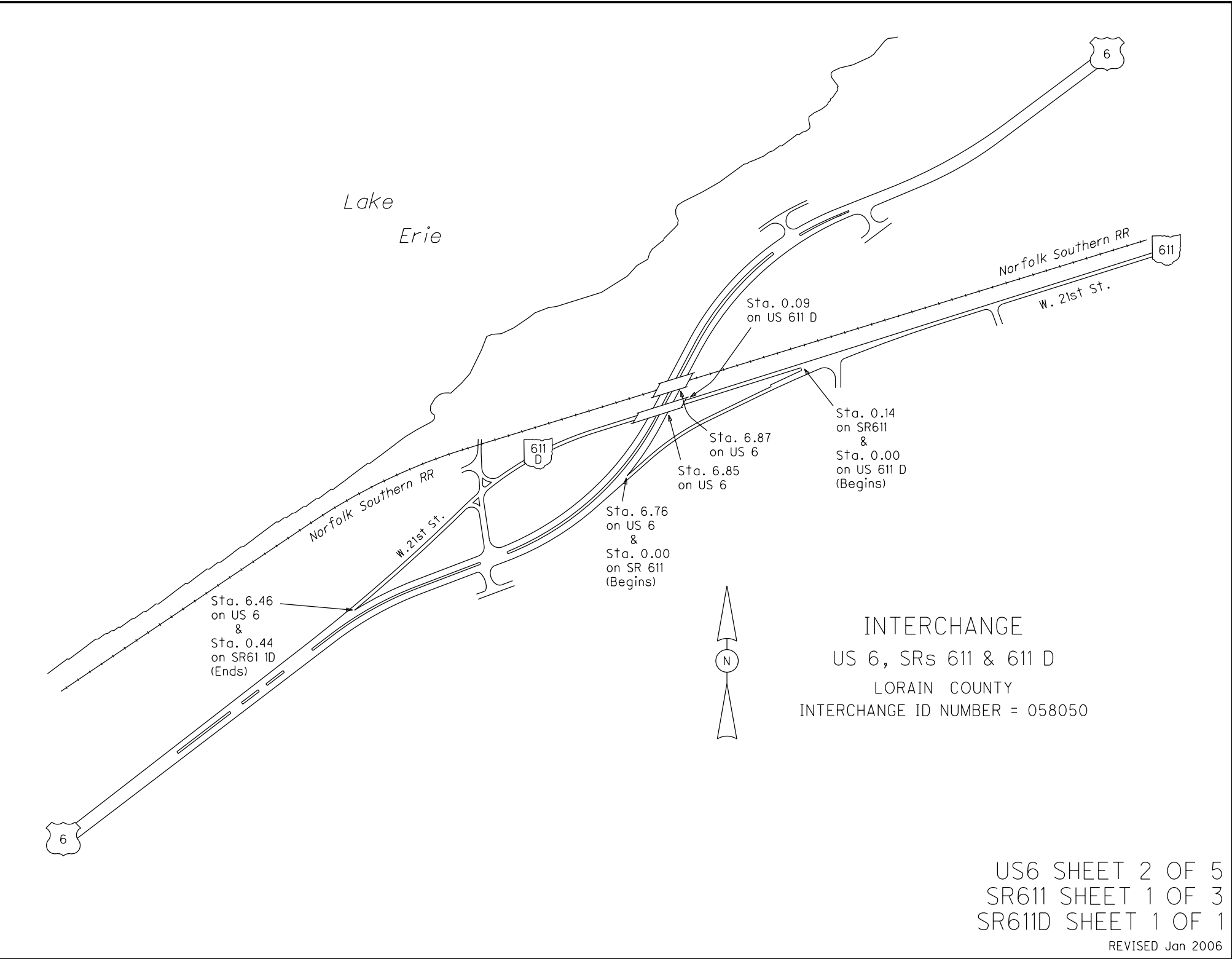

INTERCHANGE
 US 6, SRs 611 & 611 D
 LORAIN COUNTY
 INTERCHANGE ID NUMBER = 058050

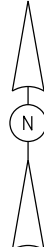

US6 SHEET 2 OF 5
 SR611 SHEET 1 OF 3
 SR611D SHEET 1 OF 1

REVISED Jan 2006

SLORSR00611**C

State True Log

County True Log

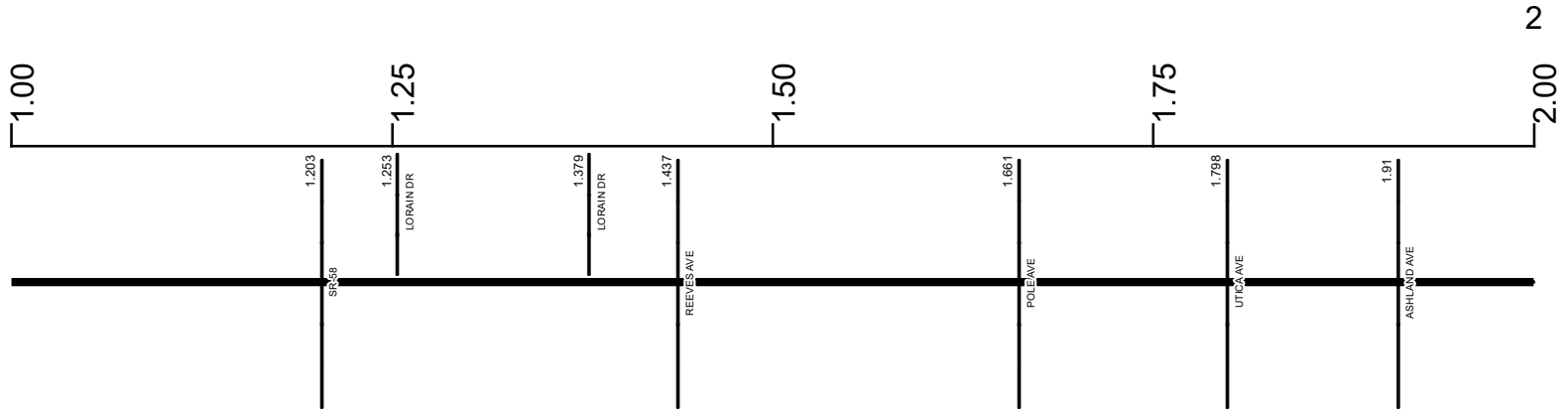

Surface Type & Width (Left / Right)

G 52'	G 40'
0.183 - 1.9	1.9 - 3.384

Base Type (Left / Right)

N
0 - 3.384

Shoulder Type & Width (Left / Right)

1 (0/0')
0 - 5.71

Resurface Year

2024

Through Lanes

4	3
0.183 - 1.9	1.9 - 2.093

Street Name

W 21ST ST	
0 - 3.088	

- Non-divided Highway
 Bridge (on route)
 Railroad (at grade)
 Intersection
- Divided Highway
 Underpass
 Railroad (underpass)
- Secondary Segment
 Overpass
 Railroad (overpass)
- Corporation**

Created on: 7/1/2025

transportation.ohio.gov

Prepared by
The Ohio Department of Transportation
Office of Technical Services
Roadway Information

SLORSR00611**C

State True Log

County True Log

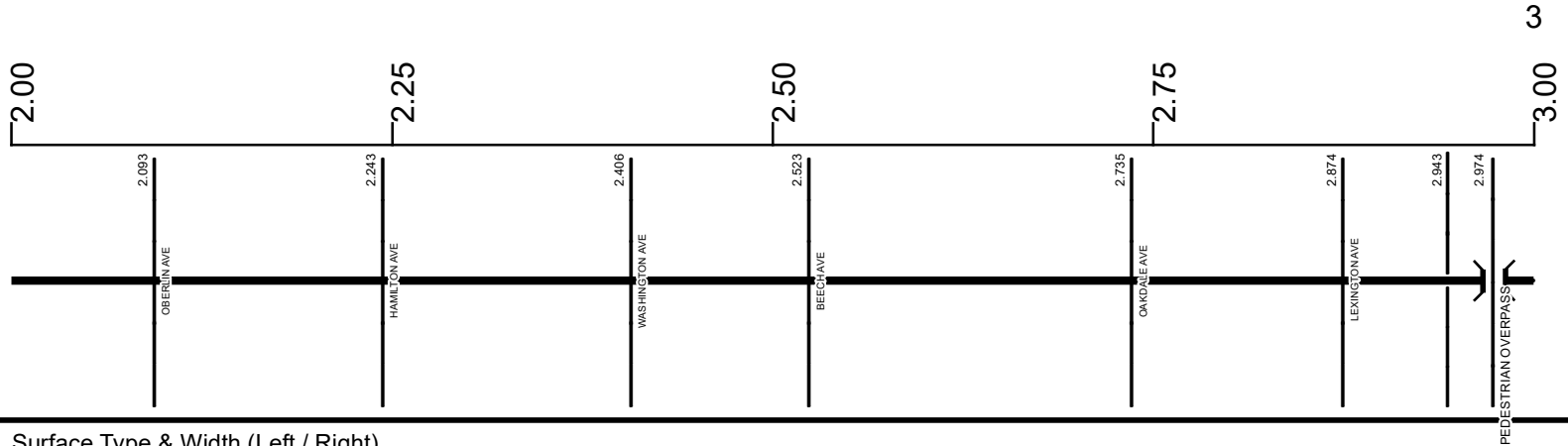

Surface Type & Width (Left / Right)

G 40'
1.9 - 3.384

Base Type (Left / Right)

N
0 - 3.384

Shoulder Type & Width (Left / Right)

1 (0/0)
0 - 5.71

Resurface Year

2024
0.183 - 4.28

Through Lanes

3	2
1.9 - 2.093	2.093 - 3.203

Street Name

W 21ST ST
0 - 3.088

- Non-divided Highway
- Divided Highway
- Secondary Segment
- Corporation
- Bridge (on route)
- Underpass
- Overpass
- Railroad (at grade)
- Railroad (underpass)
- Railroad (overpass)
- Intersection

Created on: 7/1/2025



transportation.ohio.gov
Prepared by
The Ohio Department of Transportation
Office of Technical Services
Roadway Information

SLORSR00611**C

State True Log

4

County True Log

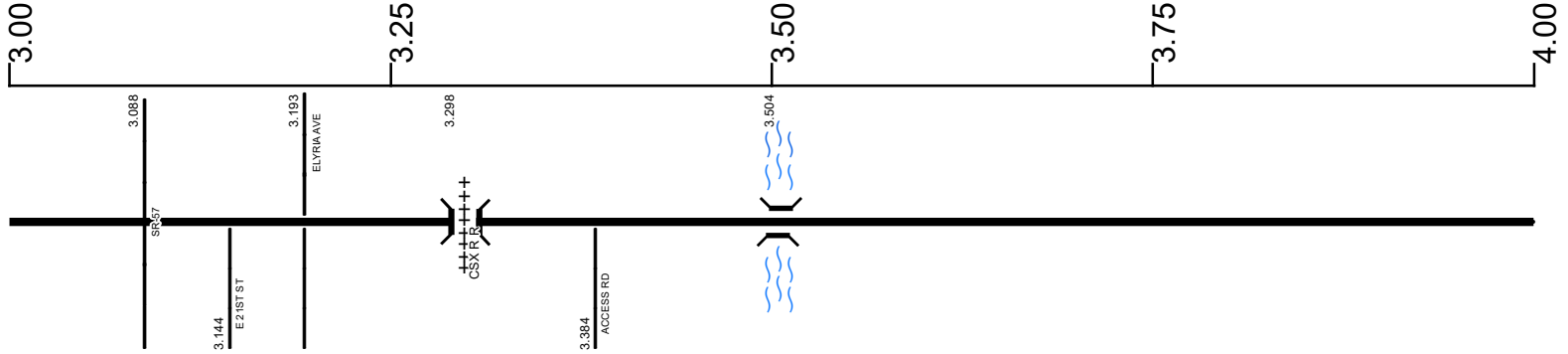

Surface Type & Width (Left / Right)

G 40'	G 42'	D 44'	G 42'
1.9 - 3.384	3.384 - 3.504	3.504 - 3.823	3.823 - 4.28

Base Type (Left / Right)

N	P	Base Type (Left / Right)	N
0 - 3.384	3.384 - 3.504		3.823 - 4.28

Shoulder Type & Width (Left / Right)

1 (0/0)
0 - 5.71

Resurface Year

2024
0.183 - 4.28

Through Lanes

2	4
2.093 - 3.203	3.203 - 4.305

Street Name

W 21ST ST	E 21ST ST	HENDERSON DR
0 - 3.088	3.088 - 3.193	3.193 - 4.305

- Non-divided Highway
- Divided Highway
- Secondary Segment
- Corporation
- Bridge (on route)
- Underpass
- Overpass
- Railroad (at grade)
- Railroad (underpass)
- Railroad (overpass)
- Intersection

Created on: 7/1/2025

transportation.ohio.gov

Prepared by
The Ohio Department of Transportation
Office of Technical Services
Roadway Information

SLORSR00611**C

State True Log

County True Log

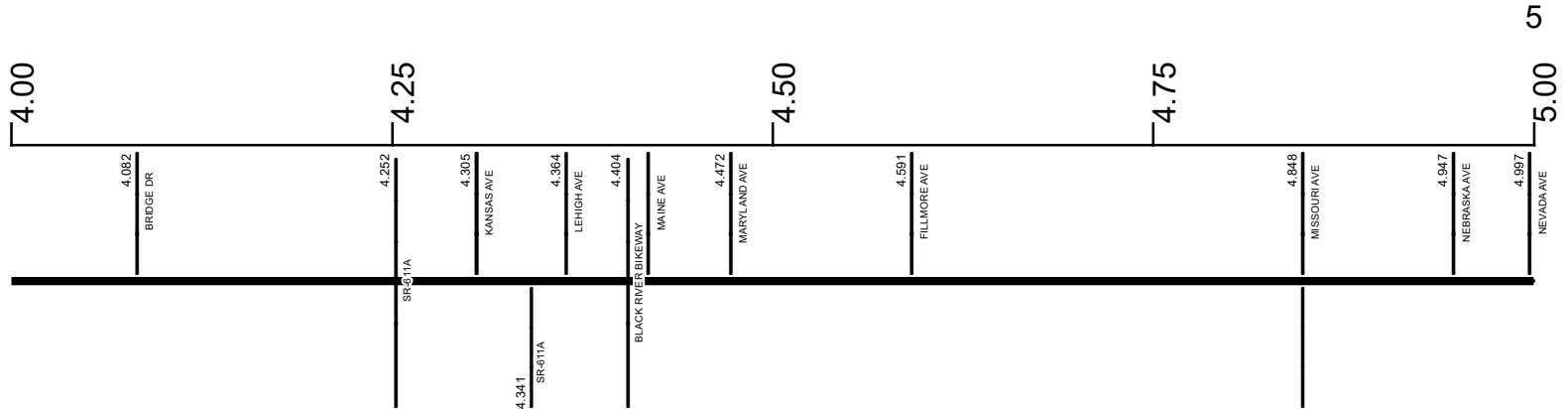

Surface Type & Width (Left / Right)

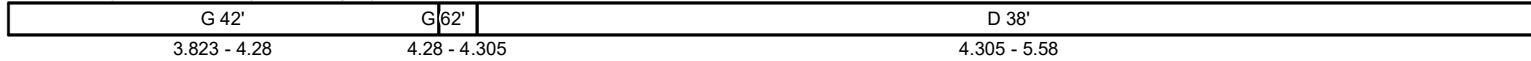

Base Type (Left / Right)

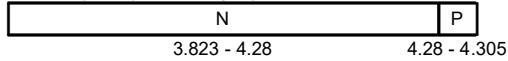

Shoulder Type & Width (Left / Right)

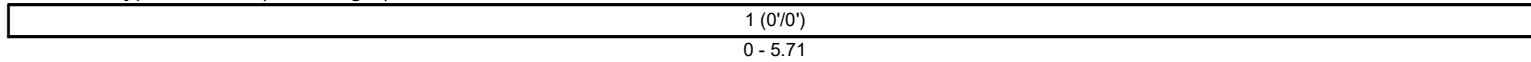

Resurface Year

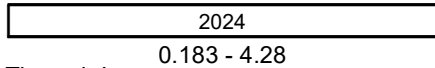

Through Lanes

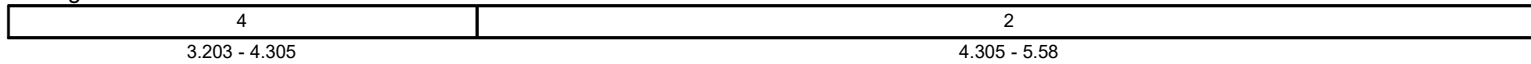

Street Name

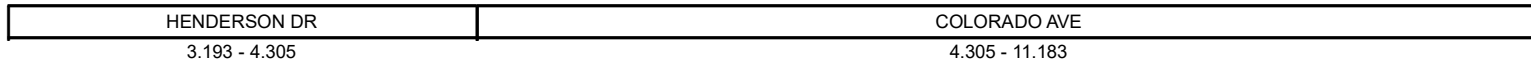

- Non-divided Highway
- Divided Highway
- Secondary Segment
- Corporation
- Bridge (on route)
- Underpass
- Overpass
- Railroad (at grade)
- Railroad (underpass)
- Railroad (overpass)
- Intersection

Created on: 7/1/2025

transportation.ohio.gov

Prepared by
The Ohio Department of Transportation
Office of Technical Services
Roadway Information

SLORSR00611**C

State True Log

County True Log

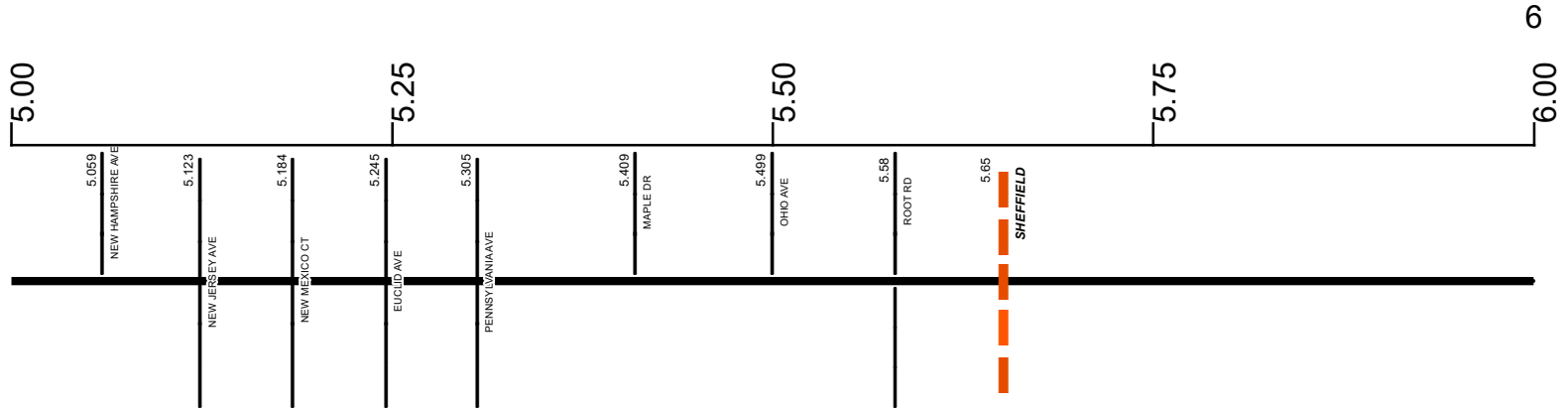

Surface Type & Width (Left / Right)

D 38'	D 50'	G 36'	G (20'/16')
4.305 - 5.58	5.58 - 5.71	5.71 - 5.76	5.76 - 8.443

Base Type (Left / Right)

P	P / L
5.71 - 5.76	5.76 - 8.443

Shoulder Type & Width (Left / Right)

1 (0'/0')	2 (4'/4')	5 (4'/4')
0 - 5.71	5.71 - 5.76	5.76 - 8.482

Resurface Year

2020
5.69 - 8.452

Through Lanes

2	4	2
4.305 - 5.58	5.58 - 5.71	5.71 - 8.482

Street Name

COLORADO AVE
4.305 - 11.183

- Non-divided Highway
- Divided Highway
- Secondary Segment
- Corporation
- Bridge (on route)
- Underpass
- Overpass
- Railroad (at grade)
- Railroad (underpass)
- Railroad (overpass)
- Intersection

Created on: 7/1/2025



transportation.ohio.gov
 Prepared by
 The Ohio Department of Transportation
 Office of Technical Services
 Roadway Information

SLORSR00611**C

State True Log

County True Log

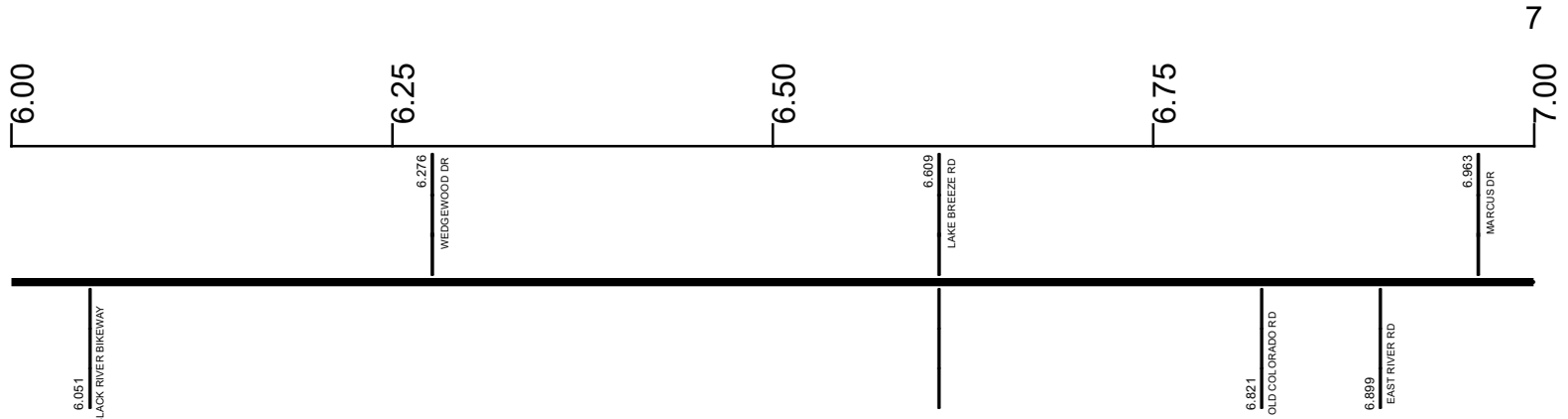

Surface Type & Width (Left / Right)

G (20'/16')
5.76 - 8.443

Base Type (Left / Right)

P / L
5.76 - 8.443

Shoulder Type & Width (Left / Right)

5 (4'/4')
5.76 - 8.482

Resurface Year

2020
5.69 - 8.452

Through Lanes

2
5.71 - 8.482

Street Name

COLORADO AVE
4.305 - 11.183

- | | | | |
|---------------------|-------------------|----------------------|--------------|
| Non-divided Highway | Bridge (on route) | Railroad (at grade) | Intersection |
| Divided Highway | Underpass | Railroad (underpass) | |
| Secondary Segment | Overpass | Railroad (overpass) | |
| Corporation | | | |

Created on: 7/1/2025



transportation.ohio.gov
Prepared by
The Ohio Department of Transportation
Office of Technical Services
Roadway Information

SLORSR00611**C

State True Log

County True Log

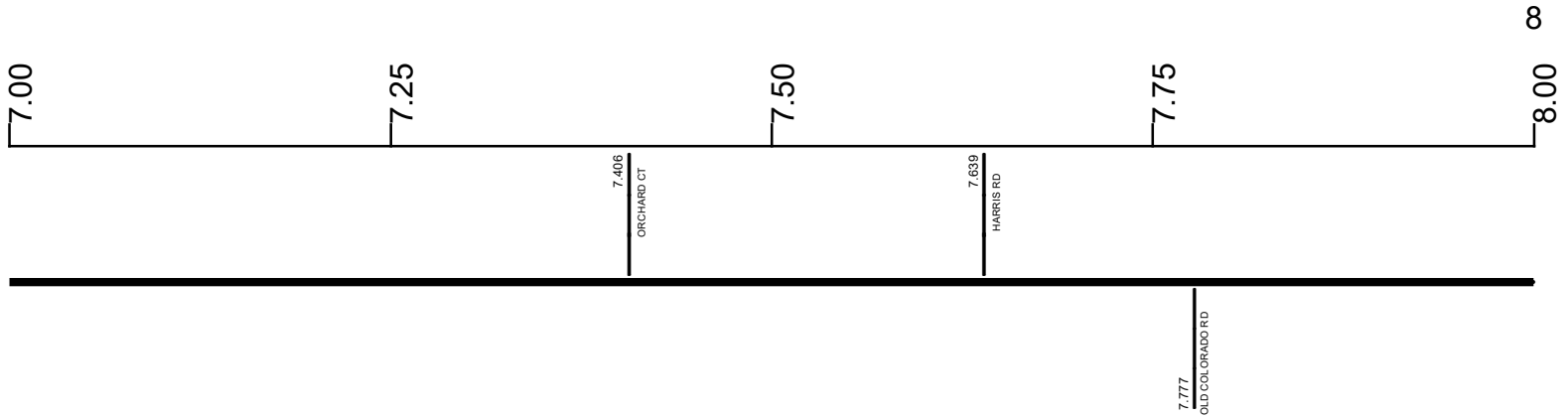

Surface Type & Width (Left / Right)

G (20'/16')
5.76 - 8.443

Base Type (Left / Right)

P / L
5.76 - 8.443

Shoulder Type & Width (Left / Right)

5 (4'/4')
5.76 - 8.482

Resurface Year

2020
5.69 - 8.452

Through Lanes

2
5.71 - 8.482

Street Name

COLORADO AVE
4.305 - 11.183

- Non-divided Highway
 Bridge (on route)
 Railroad (at grade)
 Intersection
- Divided Highway
 Underpass
 Railroad (underpass)
- Secondary Segment
 Overpass
 Railroad (overpass)
- Corporation**

Created on: 7/1/2025

transportation.ohio.gov

Prepared by
The Ohio Department of Transportation
Office of Technical Services
Roadway Information

SLORSR00611**C

State True Log

County True Log

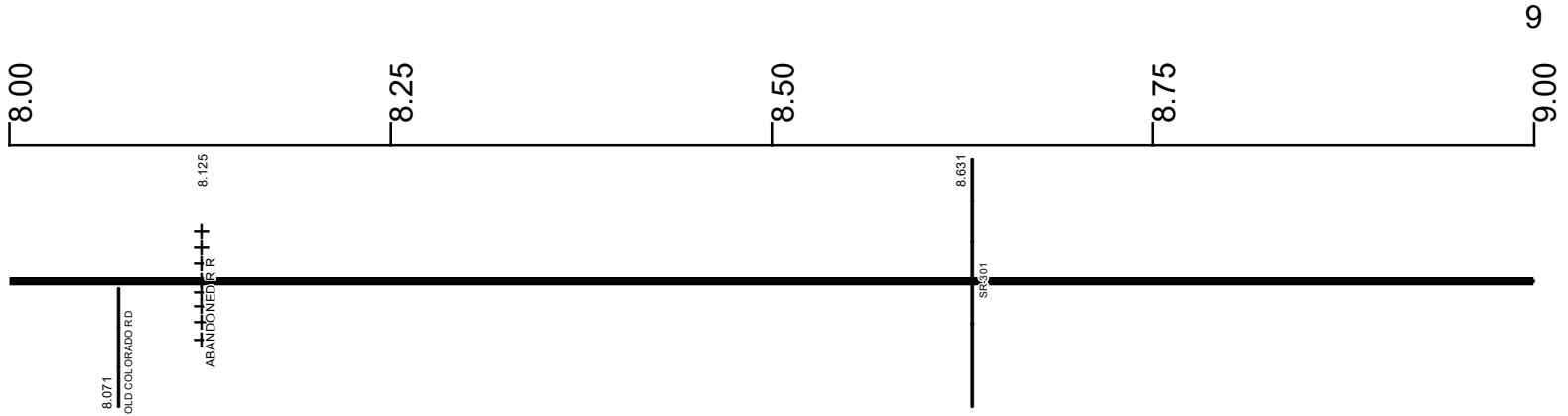

Surface Type & Width (Left / Right)	
G (20'/16')	D (20'/16')
5.76 - 8.443	8.461 - 8.482
D 64'	
8.482 - 9.683	
Base Type (Left / Right)	
P / L	
5.76 - 8.443	
Shoulder Type & Width (Left / Right)	
5 (4'/4')	1 (0'/0')
5.76 - 8.482	8.482 - 9.683
Resurface Year	Resurface Year
2020	2020
5.69 - 8.452	8.482 - 9.096
Through Lanes	
2	4
5.71 - 8.482	8.482 - 10.03
Street Name	
COLORADO AVE	
4.305 - 11.183	

- Non-divided Highway
- Divided Highway
- Secondary Segment
- Corporation
- Bridge (on route)
- Underpass
- Overpass
- Railroad (at grade)
- Railroad (underpass)
- Railroad (overpass)
- Intersection

Created on: 7/1/2025

SLORSR00611**C

State True Log
County True Log

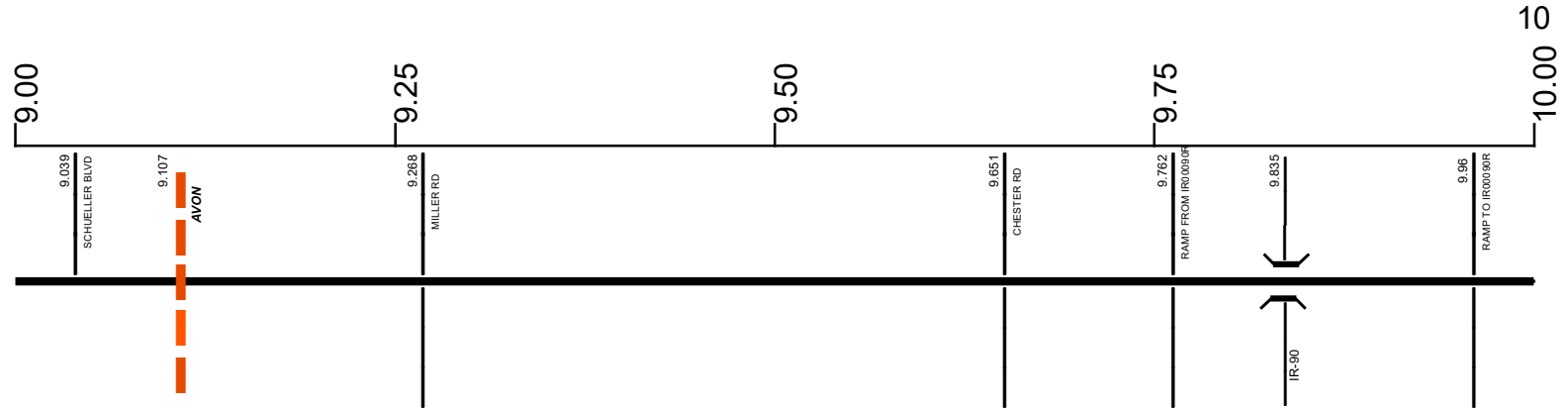

Surface Type & Width (Left / Right)

D 64'	D 48'	G 48'	D 48'
8.482 - 9.683	9.683 - 9.762		9.783 - 10.03

Shoulder Type & Width (Left / Right)

1 (0'0')	5 (6'6')
8.482 - 9.683	9.683 - 10.03

Resurface Year

2020

 8.482 - 9.096
 Through Lanes

4
8.482 - 10.03

Street Name

COLORADO AVE
4.305 - 11.183

Non-divided Highway	Bridge (on route)	Railroad (at grade)	Intersection
Divided Highway	Underpass	Railroad (underpass)	
Secondary Segment	Overpass	Railroad (overpass)	
Corporation			

Created on: 7/1/2025

transportation.ohio.gov

Prepared by
The Ohio Department of Transportation
Office of Technical Services
Roadway Information

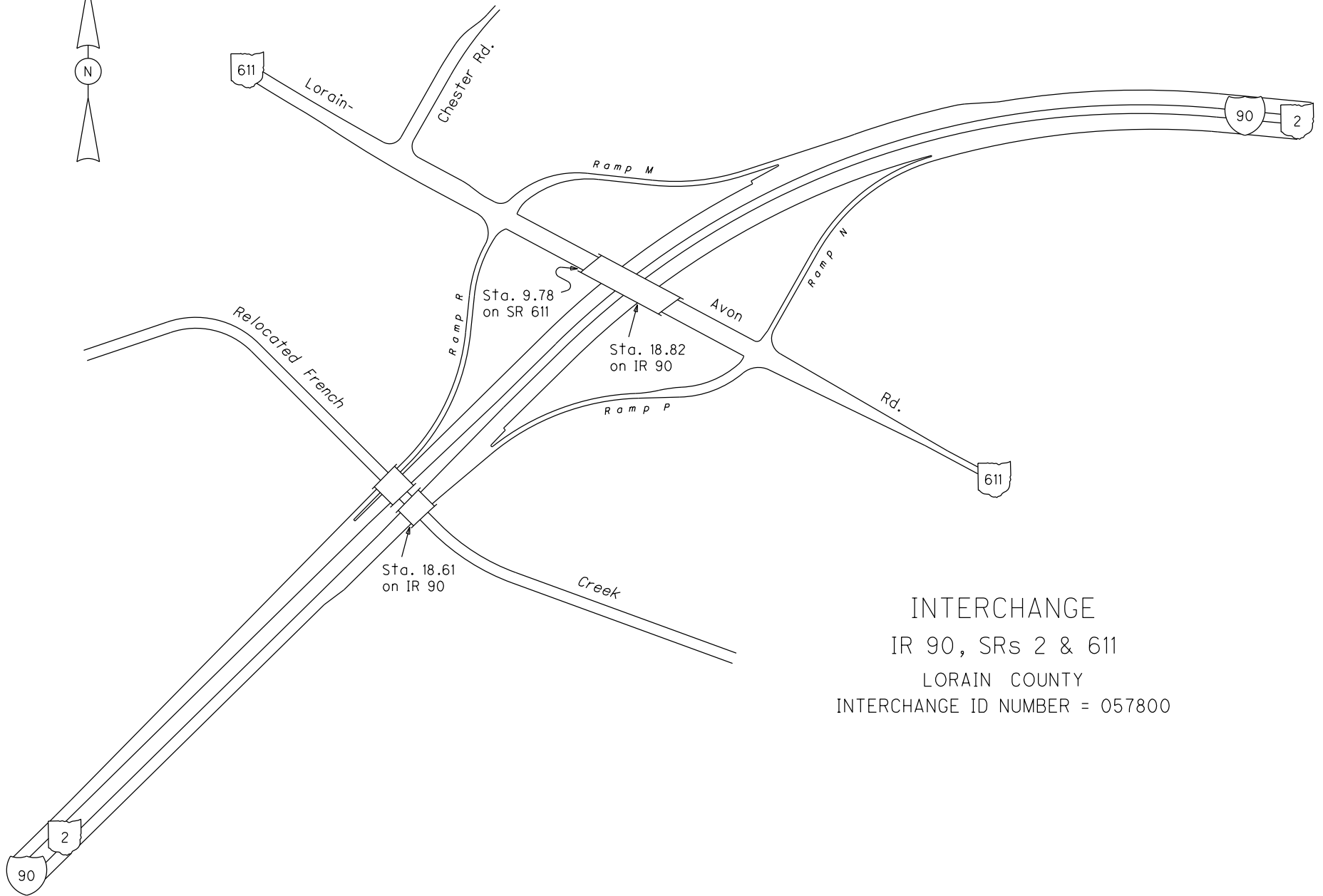
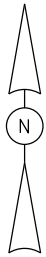

INTERCHANGE
IR 90, SRs 2 & 611
LORAIN COUNTY
INTERCHANGE ID NUMBER = 057800

SLORSR00611**C

State True Log
County True Log

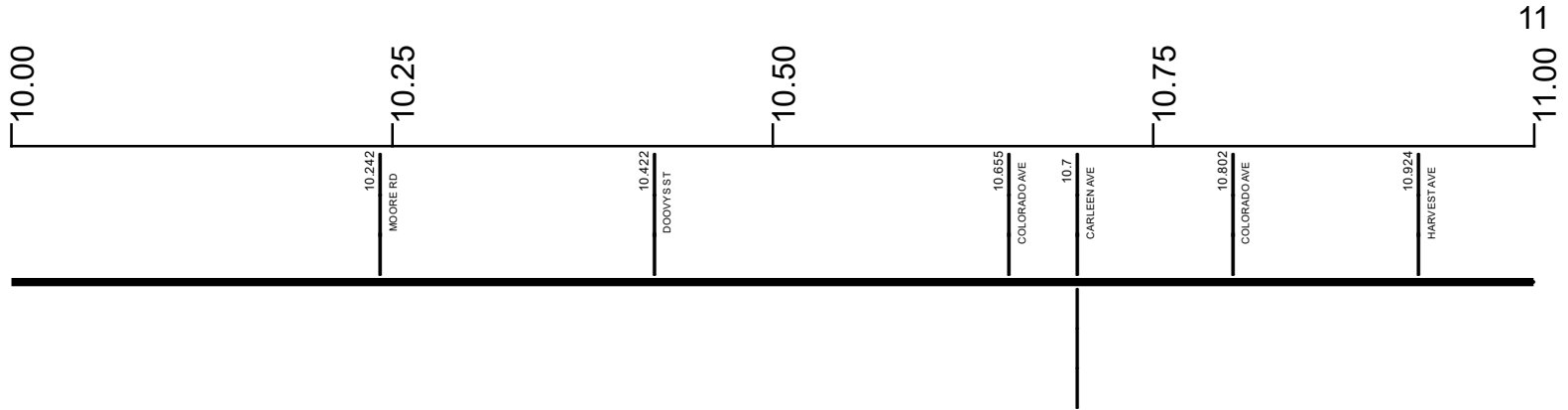

Surface Type & Width (Left / Right)

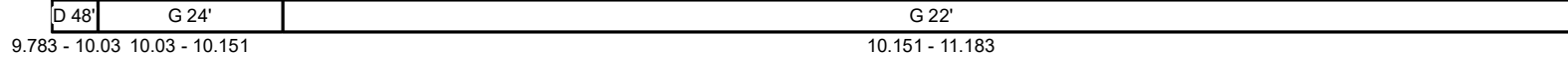

Base Type (Left / Right)

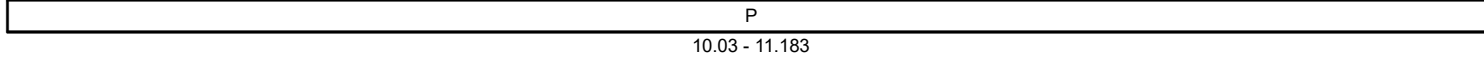

Shoulder Type & Width (Left / Right)

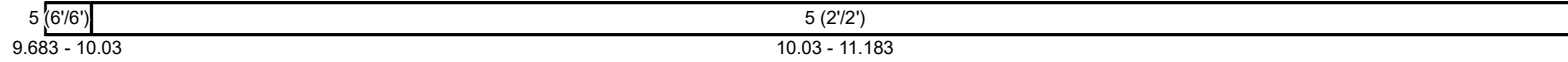

Through Lanes

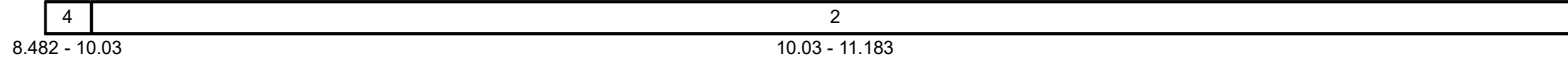

Street Name

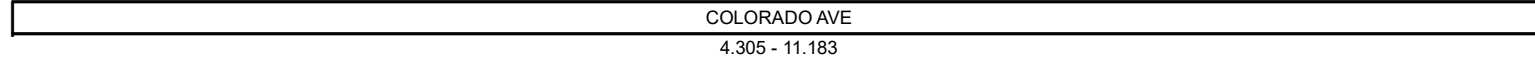

- Non-divided Highway
- Divided Highway
- Secondary Segment
- Corporation
- Bridge (on route)
- Underpass
- Overpass
- Railroad (at grade)
- Railroad (underpass)
- Railroad (overpass)
- Intersection

Created on: 7/1/2025

transportation.ohio.gov
Prepared by
The Ohio Department of Transportation
Office of Technical Services
Roadway Information

SLORSR00611**C

State True Log

11.183

County True Log

11.00

11.25

11.50

11.75

12.00



Surface Type & Width (Left / Right)

G 22'
10.151 - 11.183

Base Type (Left / Right)
P
10.03 - 11.183

Shoulder Type & Width (Left / Right)
5 (2 1/2')
10.03 - 11.183

Through Lanes
2
10.03 - 11.183

Street Name
COLORADO AVE
4.305 - 11.183

- Non-divided Highway
- Divided Highway
- Secondary Segment
- Corporation
- Bridge (on route)
- Underpass
- Overpass
- Railroad (at grade)
- Railroad (underpass)
- Railroad (overpass)
- Intersection

Created on: 7/1/2025

transportation.ohio.gov
Prepared by
The Ohio Department of Transportation
Office of Technical Services
Roadway Information

Historical Project List for SLORSR00611**C

Begin Measure	End Measure	Project ID Number	Construction Completion Date	Treatment Category	Treatment Type
0.052	4.072	21930	10-2002	Minor Rehabilitation	60-AC Overlay w/Rpr
5.630	8.433	22080	12-2011	Minor Rehabilitation	60-AC Overlay w/Rpr
5.690	8.452	98273	10-2021	Minor Rehabilitation	38-Fine Poly AC Overlay
8.482	9.096	101387	12-2021	Minor Rehabilitation	40-CPR
9.643	11.163	83447	12-2015	Minor Rehabilitation	60-AC Overlay w/Rpr

Roadway Codes

Access Control Journalized

- F - Full Access Control
- L - Limited Access Control
- N - No Access Control

Access Control Operational

- 1 - Full Access Control
- 2 - Partial Access Control
- 3 - No Access Control

Base Type

- F - Crack and Seat
- H - Rubblize and Roll
- I - Aggregate Base 304 or Traffic Compacted
- K - Water Bound Macadam
- L - Bituminous Concrete Mix or Penetration Macadam
- N - Plain Concrete
- P - Reinforced Concrete
- R - Brick (Flexible)
- T - Brick (Rigid)

Direction of Travel

- B - Both (Two-way)
- F - One-way Cardinal
- T - One-way Non-cardinal

Facility Type

- 1 - One-way Roadway
- 2 - Two-way Roadway
- 4 - Ramp
- 5 - Non-mainline
- 6 - Non-inventory Direction
- 7 - Planned / Unbuilt

Historical Federal Aid Indicator

- N - Not a FAP Route
- Y - FAP Route

Functional Classification

- 01 - Interstate
- 02 - Principal Arterial (Freeways)
- 03 - Principal Arterial (Other)
- 04 - Minor Arterial
- 05 - Major Collector
- 06 - Minor Collector
- 07 - Local

Leave / Reenter Indicator

- Y - Route leaves/reenters at this point
- N - Route does not leave/reenter at this point

Median Type

- 1 - None
- 2 - Unprotected
- 3 - Curbed
- 4 - Positive Barrier (Unspecified)
- 5 - Positive Barrier (Flexible)
- 6 - Positive Barrier (Semi-rigid)
- 7 - Positive Barrier (Rigid)

NHS

- N - National Highway System
- H - Congressional Corridor
- 2 - Major Airport
- 3 - Major Port Facility
- 4 - Major Amtrak Station
- 5 - Major Rail / Truck Terminal
- 6 - Major Intercity Bus Terminal
- 7 - Major Public Transit / Multi-modal Passenger Terminal
- 8 - Major Pipeline Terminal
- 9 - Major Ferry Terminal

Priority System

- G - General
- P - Priority System
- U - Urban

Scenic Byway Code

- A - All American Road
- N - National Scenic Byway
- S - State Scenic Byway

Shoulder Type

- 1 - None
- 2 - Surfaced shoulder exists (bituminous concrete {AC})
- 3 - Surfaced shoulder exists (Portland Cement Concrete {PCC})
- 4 - Stabilized shoulder exists (gravel or other granular material)
- 5 - Combination shoulder exists (two or more surface types)
- 6 - Earth shoulder exists
- 7 - Barrier curb exists; no shoulder in front of curb

Surface Type

- A - Combination
- B - Brick
- C - Continuous Reinforced Concrete
- D - Reinforced Concrete
- E - Plain Concrete
- G - Bituminous Concrete
- I - Chipseal on Granular
- K - Open Graded Bituminous
- L - Chipseal or Micro
- M - Gravel
- U - Unimproved
- X - Right of Way Only