

SLUCSR00025**C

State True Log 23.239

24.239

County True Log



- | | | | |
|---------------------|-------------------|----------------------|--------------|
| Non-divided Highway | Bridge (on route) | Railroad (at grade) | Intersection |
| Divided Highway | Underpass | Railroad (underpass) | |
| Secondary Segment | Overpass | Railroad (overpass) | |
| Corporation | | | |

Created on: 7/1/2025

transportation.ohio.gov
Prepared by
The Ohio Department of Transportation
Office of Technical Services
Roadway Information

SLUCSR00025**C

State True Log

25.239

County True Log



- | | | | |
|---------------------|-------------------|----------------------|--------------|
| Non-divided Highway | Bridge (on route) | Railroad (at grade) | Intersection |
| Divided Highway | Underpass | Railroad (underpass) | |
| Secondary Segment | Overpass | Railroad (overpass) | |
| Corporation | | | |

Created on: 7/1/2025

Prepared by
The Ohio Department of Transportation
Office of Technical Services
Roadway Information

SLUCSR00025**C

State True Log

26.239

County True Log

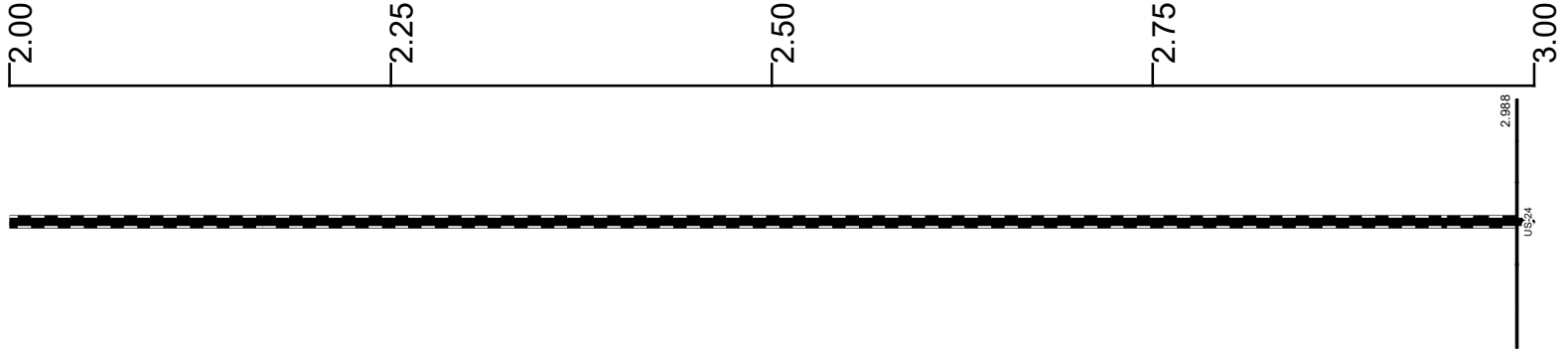

G 60'

2.988 - 3.35

N

2.988 - 6.617

1 (0/0')

2.988 - 10.036

Resurface Year

2023

2.988 - 5.314

Through Lanes

4

2.988 - 3.35

Street Name

ANTHONY WAYNE TRL

2.988 - 8.949

- Non-divided Highway
- Divided Highway
- Secondary Segment
- Corporation
- Bridge (on route)
- Underpass
- Overpass
- Railroad (at grade)
- Railroad (underpass)
- Railroad (overpass)
- Intersection

Created on: 7/1/2025



transportation.ohio.gov

Prepared by

The Ohio Department of Transportation
Office of Technical Services
Roadway Information

SLUCSR00025**C

State True Log

27.239

County True Log

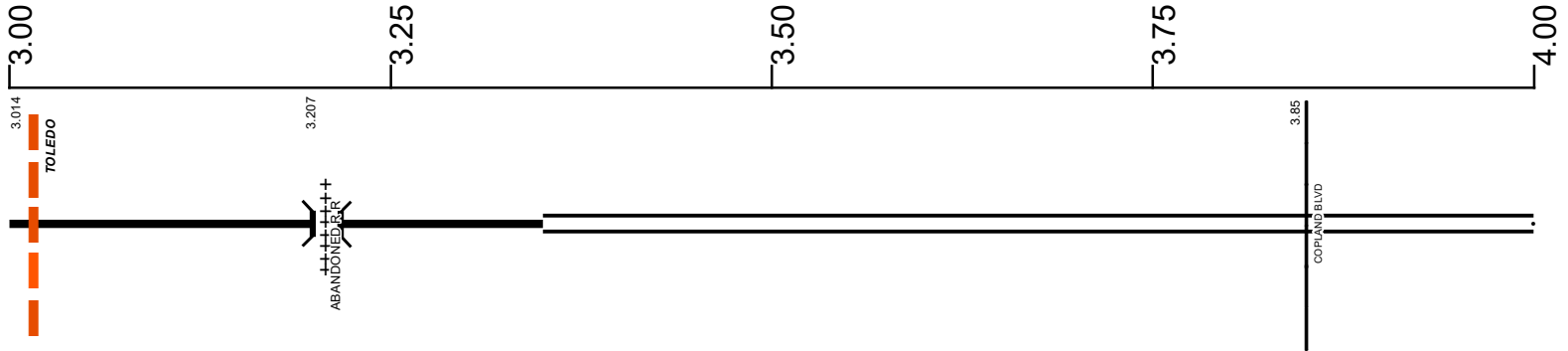

Surface Type & Width (Left / Right)

G 60'	G 72'
2.988 - 3.35	3.35 - 8.22

Base Type (Left / Right)

N
2.988 - 6.617

Shoulder Type & Width (Left / Right)

1 (0'/0')
2.988 - 10.036

Median Type and Width

2 (40')
3.35 - 8.22

Resurface Year

2023
2.988 - 5.314

Through Lanes

4	6
2.988 - 3.35	3.35 - 8.22

Street Name

ANTHONY WAYNE TRL
2.988 - 8.949

- Non-divided Highway
- Divided Highway
- Secondary Segment
- Corporation
- Bridge (on route)
- Underpass
- Overpass
- Railroad (at grade)
- Railroad (underpass)
- Railroad (overpass)
- Intersection

Created on: 7/1/2025

transportation.ohio.gov
 Prepared by
 The Ohio Department of Transportation
 Office of Technical Services
 Roadway Information

SLUCSR00025**C

State True Log

28.239

County True Log

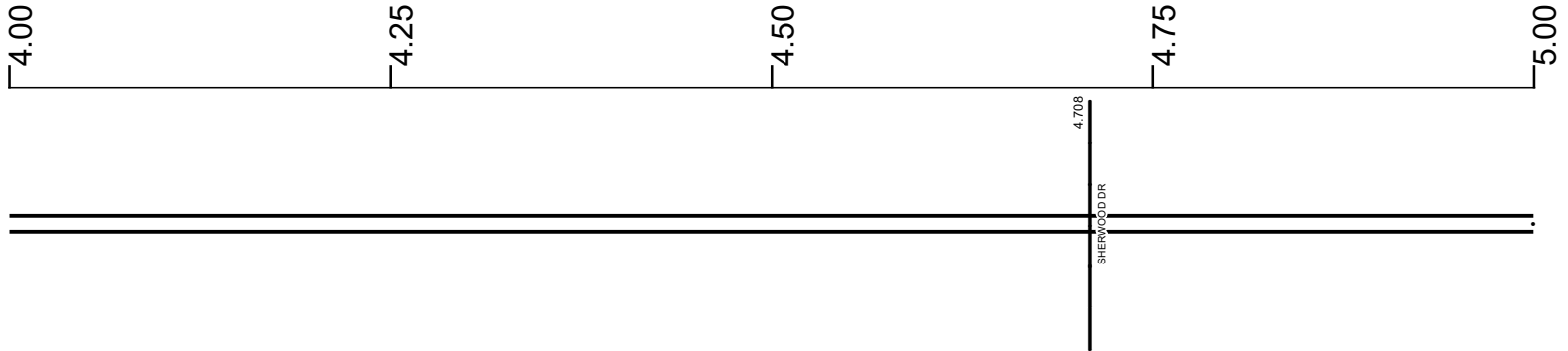

Surface Type & Width (Left / Right)

G 72'
3.35 - 8.22

Base Type (Left / Right)

N
2.988 - 6.617

Shoulder Type & Width (Left / Right)

1 (0/0)
2.988 - 10.036

Median Type and Width

2 (40')
3.35 - 8.22

Resurface Year

2023
2.988 - 5.314

Through Lanes

6
3.35 - 8.22

Street Name

ANTHONY WAYNE TRL
2.988 - 8.949

- | | | | |
|---------------------|-------------------|----------------------|--------------|
| Non-divided Highway | Bridge (on route) | Railroad (at grade) | Intersection |
| Divided Highway | Underpass | Railroad (underpass) | |
| Secondary Segment | Overpass | Railroad (overpass) | |
| Corporation | | | |

Created on: 7/1/2025

transportation.ohio.gov

Prepared by
The Ohio Department of Transportation
Office of Technical Services
Roadway Information

SLUCSR00025**C

State True Log

29.239

County True Log

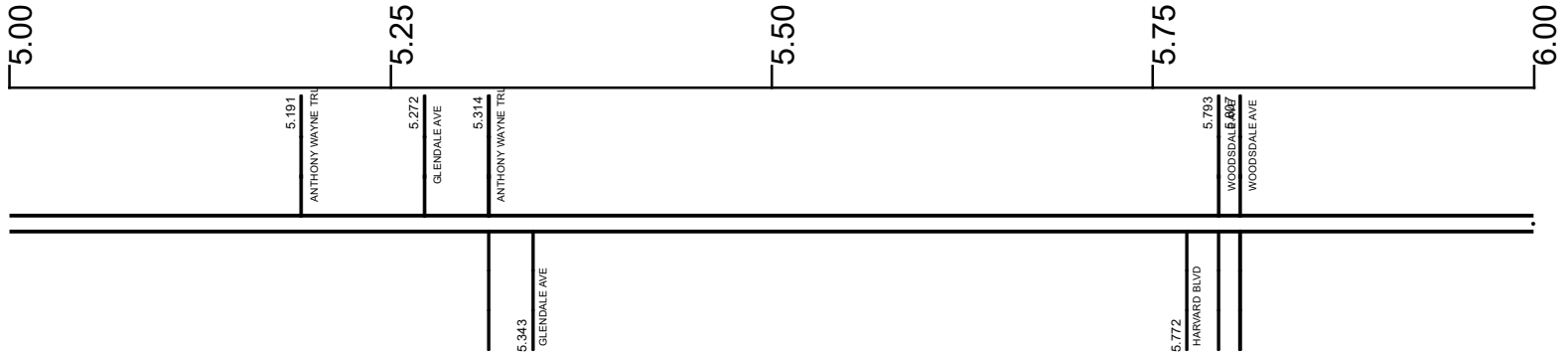

Surface Type & Width (Left / Right)

G 72'
3.35 - 8.22

Base Type (Left / Right)

N
2.988 - 6.617

Shoulder Type & Width (Left / Right)

1 (0'/0')
2.988 - 10.036

Median Type and Width

2 (40')
3.35 - 8.22

Resurface Year

2023
2.988 - 5.314

Through Lanes

6
3.35 - 8.22

Street Name

ANTHONY WAYNE TRL
2.988 - 8.949

- | | | | |
|---------------------|-------------------|----------------------|--------------|
| Non-divided Highway | Bridge (on route) | Railroad (at grade) | Intersection |
| Divided Highway | Underpass | Railroad (underpass) | |
| Secondary Segment | Overpass | Railroad (overpass) | |
| Corporation | | | |

Created on: 7/1/2025

transportation.ohio.gov

Prepared by
The Ohio Department of Transportation
Office of Technical Services
Roadway Information

SLUCSR00025**C

State True Log

30.239

County True Log

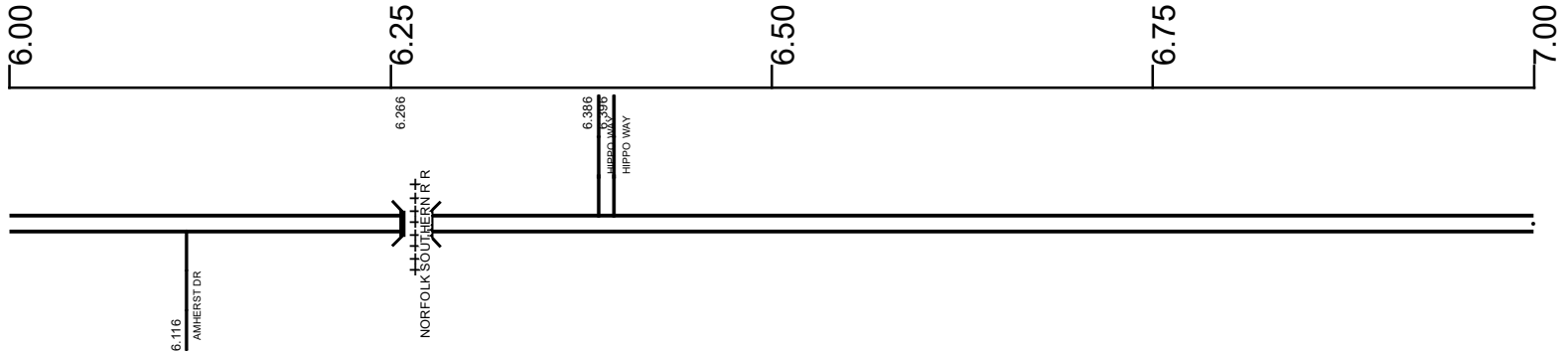

Surface Type & Width (Left / Right)

	G 72'
	3.35 - 8.22

Base Type (Left / Right)

N	K	N
2.988 - 6.617	6.617 - 6.848	6.848 - 7.039

Shoulder Type & Width (Left / Right)

	1 (0'/0')
	2.988 - 10.036

Median Type and Width

	2 (40')
	3.35 - 8.22

Through Lanes

	6
	3.35 - 8.22

Street Name

	ANTHONY WAYNE TRL
	2.988 - 8.949

- | | | | |
|---------------------|-------------------|----------------------|--------------|
| Non-divided Highway | Bridge (on route) | Railroad (at grade) | Intersection |
| Divided Highway | Underpass | Railroad (underpass) | |
| Secondary Segment | Overpass | Railroad (overpass) | |
| Corporation | | | |

Created on: 7/1/2025

transportation.ohio.gov

Prepared by
The Ohio Department of Transportation
Office of Technical Services
Roadway Information

SLUCSR00025**C

State True Log

31.239

County True Log

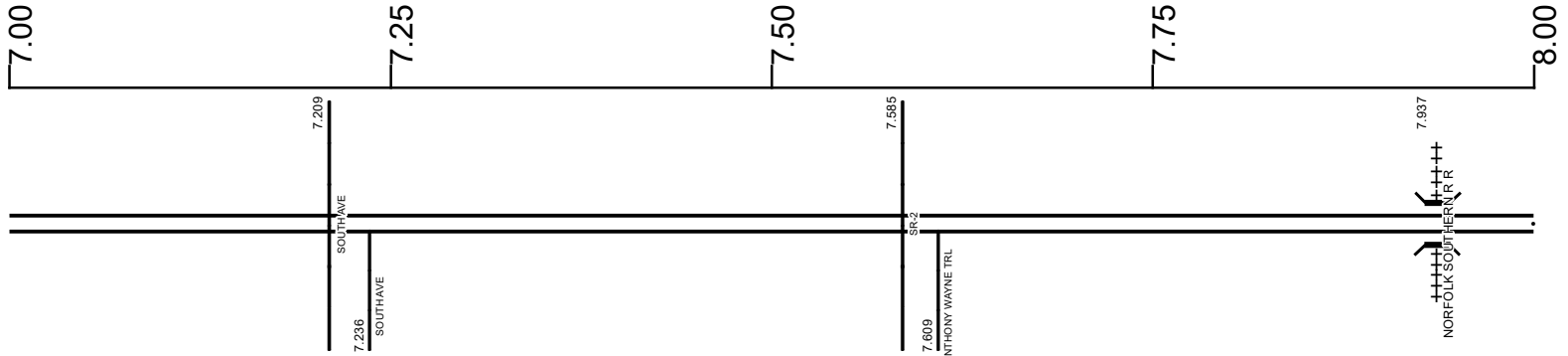

Surface Type & Width (Left / Right)

G 72'
3.35 - 8.22

Base Type (Left / Right)

N	L	K
6.848 - 7.039	7.039 - 7.839	7.839 - 8.22

Shoulder Type & Width (Left / Right)

1 (0'/0')
2.988 - 10.036

Median Type and Width

2 (40')
3.35 - 8.22

Through Lanes

6
3.35 - 8.22

Street Name

ANTHONY WAYNE TRL
2.988 - 8.949

- Non-divided Highway
- Divided Highway
- Secondary Segment
- Corporation
- Bridge (on route)
- Underpass
- Overpass
- Railroad (at grade)
- Railroad (underpass)
- Railroad (overpass)
- Intersection

Created on: 7/1/2025

transportation.ohio.gov

Prepared by
The Ohio Department of Transportation
Office of Technical Services
Roadway Information

SLUCSR00025**C

State True Log

32.239

County True Log

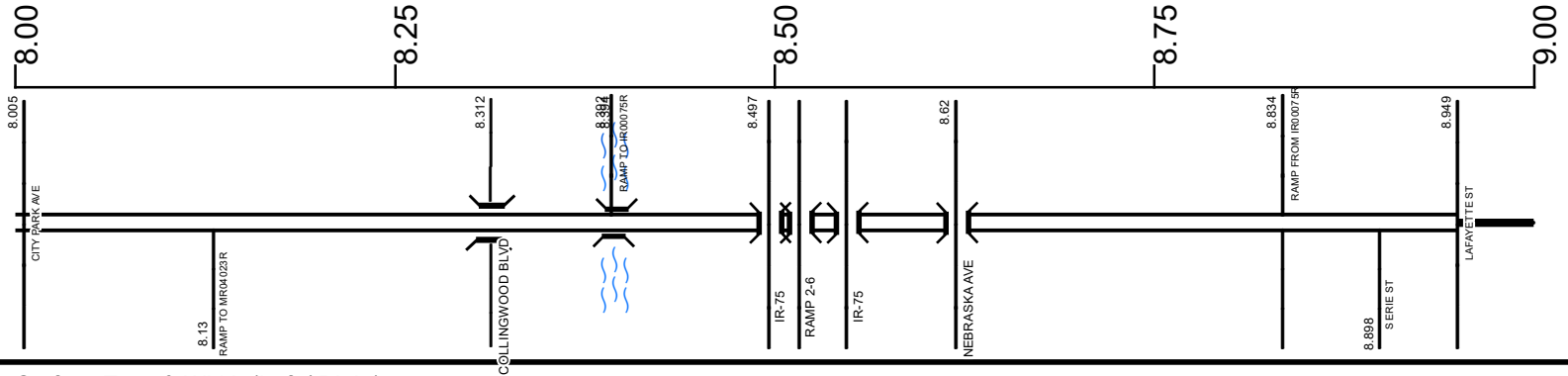

Surface Type & Width (Left / Right)

G 72'	D 48'	G 48'	D 48'	G 48'	D 48'	G 48'
3.35 - 8.22	8.22 - 8.36	8.36 - 8.462	8.462 - 8.733	8.733 - 8.928	8.949 - 9.264	

Base Type (Left / Right)

K
7.839 - 8.22

Base Type (Left / Right)

T
8.949 - 9.264

Shoulder Type & Width (Left / Right)

1 (0'/0')
2.988 - 10.036

Median Type and Width

2 (40')	2 (20')
3.35 - 8.22	8.22 - 8.949

Through Lanes

6	4
3.35 - 8.22	8.22 - 9.822

Street Name

ANTHONY WAYNE TRL	SERIE ST
2.988 - 8.949	8.949 - 9.057

- Non-divided Highway
- Divided Highway
- Secondary Segment
- Corporation
- Bridge (on route)
- Underpass
- Overpass
- Railroad (at grade)
- Railroad (underpass)
- Railroad (overpass)
- Intersection

Created on: 7/1/2025



transportation.ohio.gov
 Prepared by
 The Ohio Department of Transportation
 Office of Technical Services
 Roadway Information

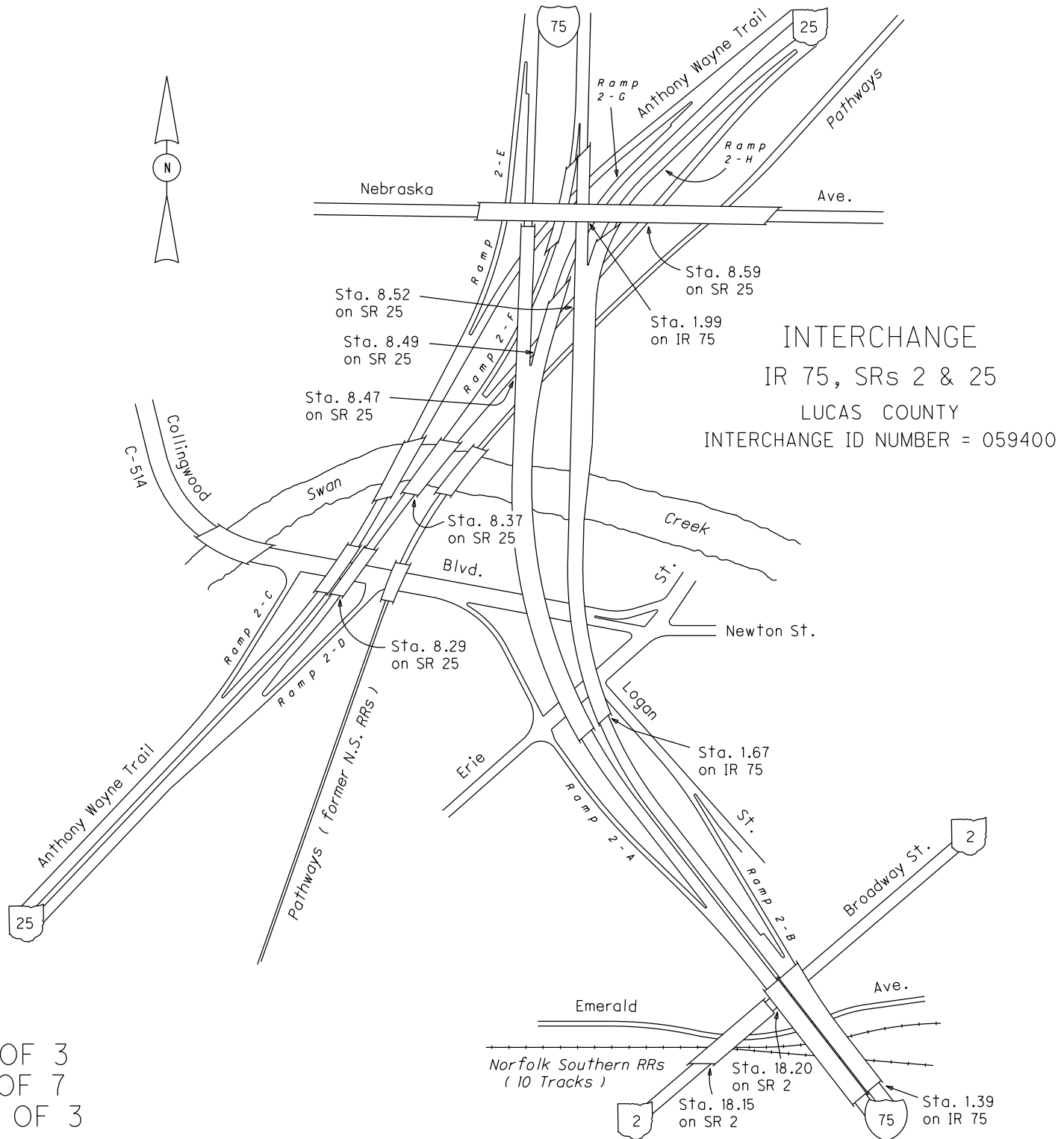

INTERCHANGE
IR 75, SRs 2 & 25
LUCAS COUNTY
INTERCHANGE ID NUMBER = 059400

IR75 SHEET 1 OF 3
SR2 SHEET 4 OF 7
SR25 SHEET 2 OF 3
REVISED Jan 2007

SLUCSR00025**C

State True Log

33.239

County True Log

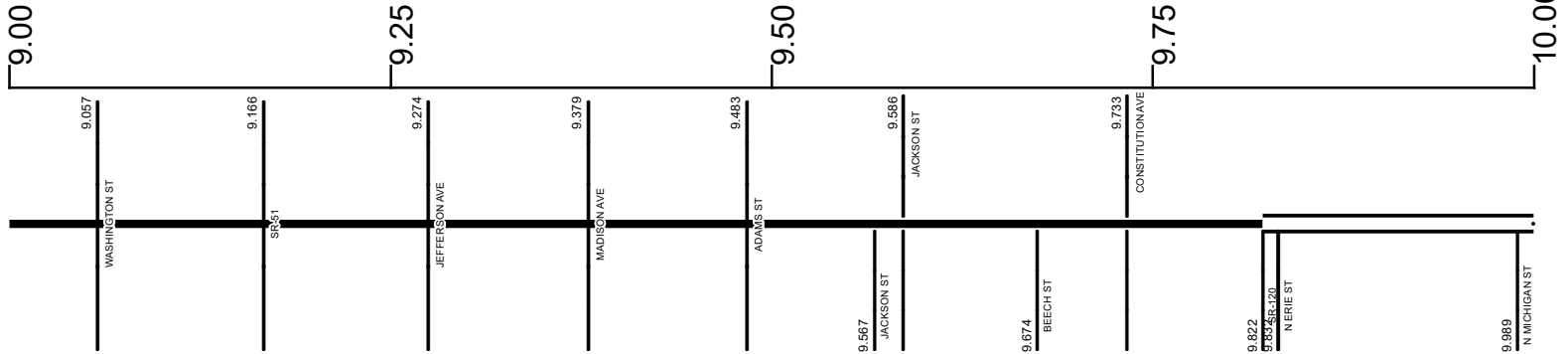

Surface Type & Width (Left / Right)

G 48'	G (36') / E (12')	G (36'/12')	G (36') / E (12')	G 48'	G 76'
8.949 - 9.264	9.264 - 9.282	9.282 - 9.491	9.491 - 9.576	9.576 - 9.822	9.822 - 10.036

Base Type (Left / Right)

T
8.949 - 9.264

Base Type (Left / Right)

T	L
9.576 - 9.822	9.822 - 11.887

Shoulder Type & Width (Left / Right)

1 (0'/0')
2.988 - 10.036

Median Type and Width

3 (10')
9.822 - 11.285

Through Lanes

4	6
8.22 - 9.822	9.822 - 10.036

Street Name

S ERIE ST	N ERIE ST	CHERRY ST
8.949 - 9.057	9.057 - 9.832	9.832 - 10.036

- Non-divided Highway
- Divided Highway
- Secondary Segment
- Corporation
- Bridge (on route)
- Underpass
- Overpass
- Railroad (at grade)
- Railroad (underpass)
- Railroad (overpass)
- Intersection

Created on: 7/1/2025

transportation.ohio.gov

Prepared by
The Ohio Department of Transportation
Office of Technical Services
Roadway Information

SLUCSR00025**C

State True Log

34.239

County True Log

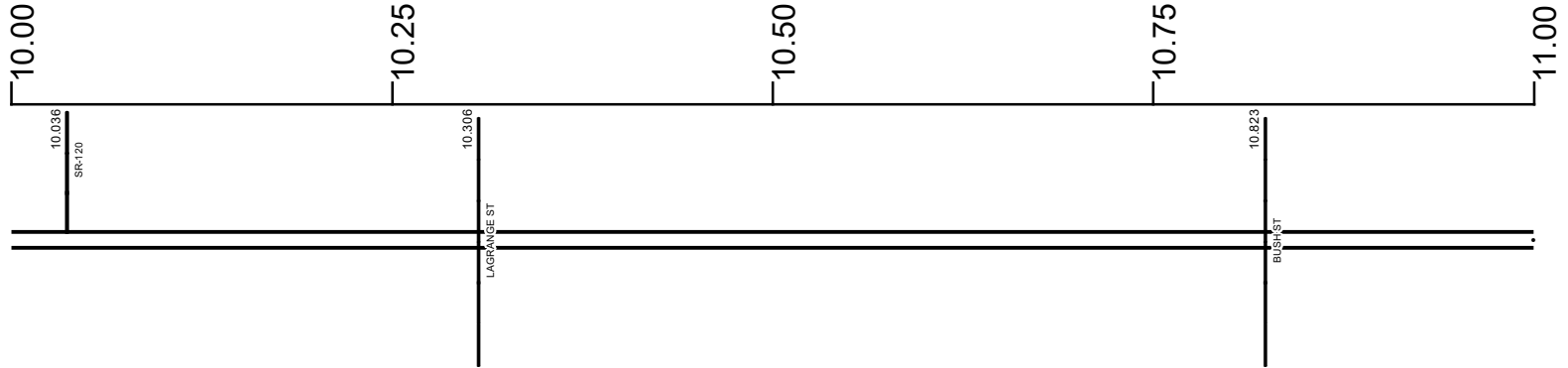

Surface Type & Width (Left / Right)

G 76'	G 48'
9.822 - 10.036	10.036 - 11.802

Base Type (Left / Right)

L	L
9.822 - 11.887	

Shoulder Type & Width (Left / Right)

1 (0'/0')	2 (12'/12')
2.988 - 10.036	10.036 - 11.285

Median Type and Width

3 (10')	3 (10')
9.822 - 11.285	

Through Lanes

6	4
9.822 - 10.036	10.036 - 11.802

Street Name

CHERRY ST	GREENBELT PKWY
9.832 - 10.036	10.036 - 11.422

<p> Non-divided Highway</p> <p> Divided Highway</p> <p> Secondary Segment</p> <p> Corporation</p>	<p> Bridge (on route)</p> <p> Underpass</p> <p> Overpass</p>	<p> Railroad (at grade)</p> <p> Railroad (underpass)</p> <p> Railroad (overpass)</p>	<p> Intersection</p>
---	--	--	----------------------

Created on: 7/1/2025

transportation.ohio.gov

Prepared by

The Ohio Department of Transportation

Office of Technical Services

Roadway Information

SLUCSR00025**C

State True Log

35.126

County True Log

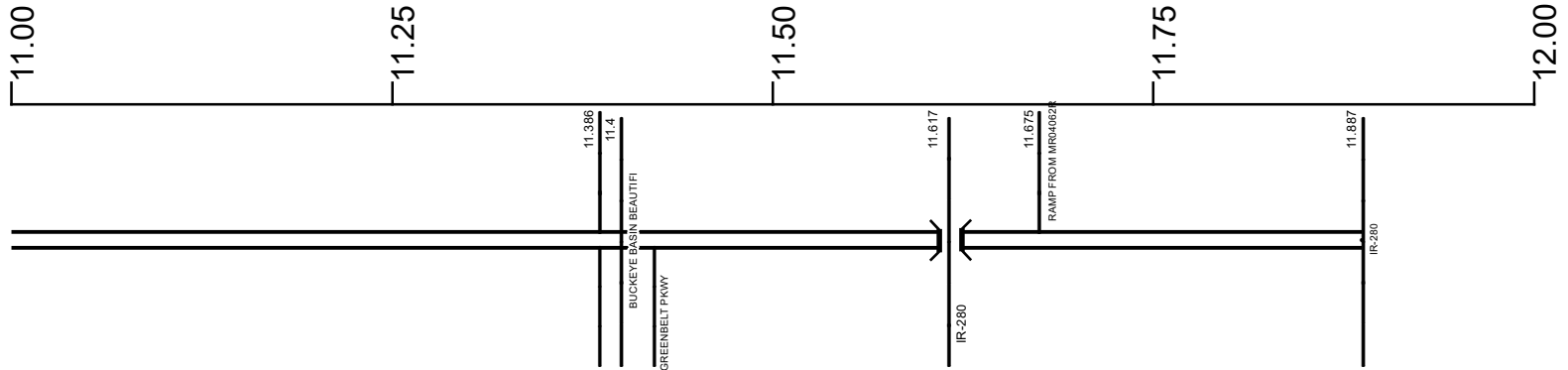

Surface Type & Width (Left / Right)

G 48'	G 32'
10.036 - 11.802	11.802 - 11.887

Base Type (Left / Right)

L
9.822 - 11.887

Shoulder Type & Width (Left / Right)

2 (12'/12')	2 (14'/14')	2 (10'/10')
10.036 - 11.285	11.285 - 11.802	11.802 - 11.887

Median Type and Width

3 (10')	2 (40')	2 (9999')
9.822 - 11.285	11.285 - 11.802	11.802 - 11.887

Through Lanes

4	2
10.036 - 11.802	11.802 - 11.887

Street Name

GREENBELT PKWY	GREENBELT PKWY TO I 280 N
10.036 - 11.422	11.422 - 11.887

- Non-divided Highway
 Bridge (on route)
 Railroad (at grade)
 Intersection
- Divided Highway
 Underpass
 Railroad (underpass)
- Secondary Segment
 Overpass
 Railroad (overpass)
- Corporation

Created on: 7/1/2025

transportation.ohio.gov

Prepared by
The Ohio Department of Transportation
Office of Technical Services
Roadway Information

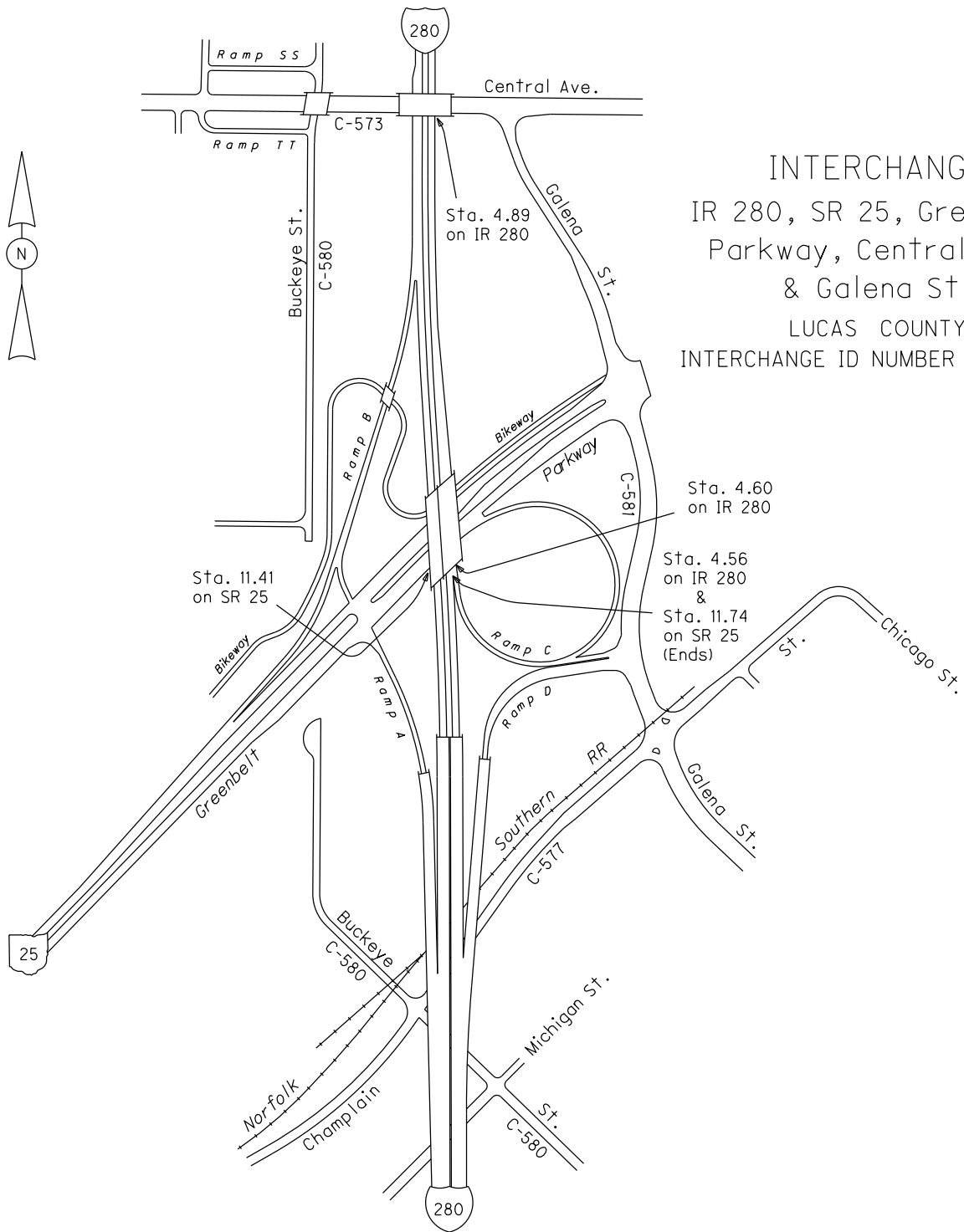

INTERCHANGE
 IR 280, SR 25, Greenbelt
 Parkway, Central Ave.
 & Galena St.
 LUCAS COUNTY
 INTERCHANGE ID NUMBER = 060700

Historical Project List for SLUCSR00025**C

Begin Measure	End Measure	Project ID Number	Construction Completion Date	Treatment Category	Treatment Type
3.018	5.272	103508	11-2023	Major Rehabilitation	100-New Flexible Pvmt
5.272	7.009	103507	6-2019	Minor Rehabilitation	60-AC Overlay w/Rpr
7.040	7.840	96344	5-2017	Major Rehabilitation	100-New Flexible Pvmt
8.949	9.832	95816	8-2019	Minor Rehabilitation	60-AC Overlay w/Rpr
9.832	10.036	106161	8-2019	Minor Rehabilitation	60-AC Overlay w/Rpr

Roadway Codes

Access Control Journalized

- F - Full Access Control
- L - Limited Access Control
- N - No Access Control

Access Control Operational

- 1 - Full Access Control
- 2 - Partial Access Control
- 3 - No Access Control

Base Type

- F - Crack and Seat
- H - Rubblize and Roll
- I - Aggregate Base 304 or Traffic Compacted
- K - Water Bound Macadam
- L - Bituminous Concrete Mix or Penetration Macadam
- N - Plain Concrete
- P - Reinforced Concrete
- R - Brick (Flexible)
- T - Brick (Rigid)

Direction of Travel

- B - Both (Two-way)
- F - One-way Cardinal
- T - One-way Non-cardinal

Facility Type

- 1 - One-way Roadway
- 2 - Two-way Roadway
- 4 - Ramp
- 5 - Non-mainline
- 6 - Non-inventory Direction
- 7 - Planned / Unbuilt

Historical Federal Aid Indicator

- N - Not a FAP Route
- Y - FAP Route

Functional Classification

- 01 - Interstate
- 02 - Principal Arterial (Freeways)
- 03 - Principal Arterial (Other)
- 04 - Minor Arterial
- 05 - Major Collector
- 06 - Minor Collector
- 07 - Local

Leave / Reenter Indicator

- Y - Route leaves/reenters at this point
- N - Route does not leave/reenter at this point

Median Type

- 1 - None
- 2 - Unprotected
- 3 - Curbed
- 4 - Positive Barrier (Unspecified)
- 5 - Positive Barrier (Flexible)
- 6 - Positive Barrier (Semi-rigid)
- 7 - Positive Barrier (Rigid)

NHS

- N - National Highway System
- H - Congressional Corridor
- 2 - Major Airport
- 3 - Major Port Facility
- 4 - Major Amtrak Station
- 5 - Major Rail / Truck Terminal
- 6 - Major Intercity Bus Terminal
- 7 - Major Public Transit / Multi-modal Passenger Terminal
- 8 - Major Pipeline Terminal
- 9 - Major Ferry Terminal

Priority System

- G - General
- P - Priority System
- U - Urban

Scenic Byway Code

- A - All American Road
- N - National Scenic Byway
- S - State Scenic Byway

Shoulder Type

- 1 - None
- 2 - Surfaced shoulder exists (bituminous concrete {AC})
- 3 - Surfaced shoulder exists (Portland Cement Concrete {PCC})
- 4 - Stabilized shoulder exists (gravel or other granular material)
- 5 - Combination shoulder exists (two or more surface types)
- 6 - Earth shoulder exists
- 7 - Barrier curb exists; no shoulder in front of curb

Surface Type

- A - Combination
- B - Brick
- C - Continuous Reinforced Concrete
- D - Reinforced Concrete
- E - Plain Concrete
- G - Bituminous Concrete
- I - Chipseal on Granular
- K - Open Graded Bituminous
- L - Chipseal or Micro
- M - Gravel
- U - Unimproved
- X - Right of Way Only