

SMAHSR00045**C

State True Log 29.717

30.717

County True Log

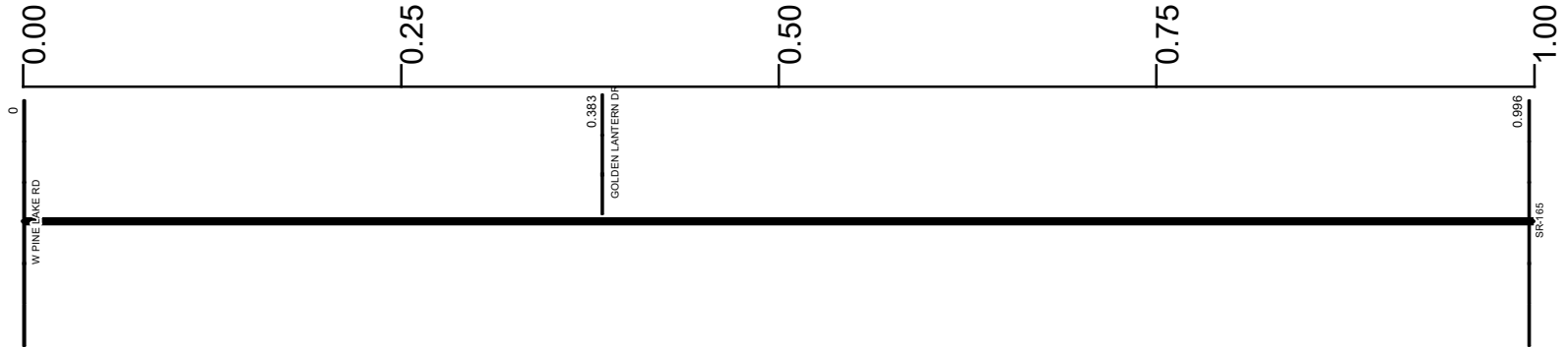

Surface Type & Width (Left / Right)

G (6/18')
0 - 4.8

Base Type (Left / Right)

N / K
0 - 4.8

Shoulder Type & Width (Left / Right)

2 (5/5)
0 - 4.8

Resurface Year

2020
0 - 11.776

Through Lanes

2
0 - 11.776

Street Name

S SALEM WARREN RD
0 - 11.776

- | | | | |
|---------------------|-------------------|----------------------|--------------|
| Non-divided Highway | Bridge (on route) | Railroad (at grade) | Intersection |
| Divided Highway | Underpass | Railroad (underpass) | |
| Secondary Segment | Overpass | Railroad (overpass) | |
| Corporation | | | |

Created on: 7/2/2025

transportation.ohio.gov

Prepared by
The Ohio Department of Transportation
Office of Technical Services
Roadway Information

SMAHSR00045**C

State True Log

31.717

County True Log

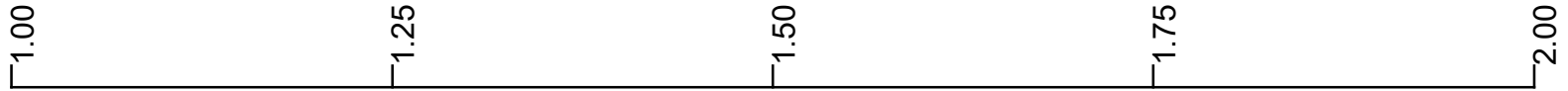

1.982
W MIDDLETOWN RD

Surface Type & Width (Left / Right)

G (6/18')
0 - 4.8

Base Type (Left / Right)

N / K
0 - 4.8

Shoulder Type & Width (Left / Right)

2 (5/5)
0 - 4.8

Resurface Year

2020
0 - 11.776

Through Lanes

2
0 - 11.776

Street Name

S SALEM WARREN RD
0 - 11.776

- | | | | |
|---------------------|-------------------|----------------------|--------------|
| Non-divided Highway | Bridge (on route) | Railroad (at grade) | Intersection |
| Divided Highway | Underpass | Railroad (underpass) | |
| Secondary Segment | Overpass | Railroad (overpass) | |
| Corporation | | | |

Created on: 7/2/2025



Prepared by
The Ohio Department of Transportation
Office of Technical Services
Roadway Information

SMAHSR00045**C

State True Log

32.717

County True Log

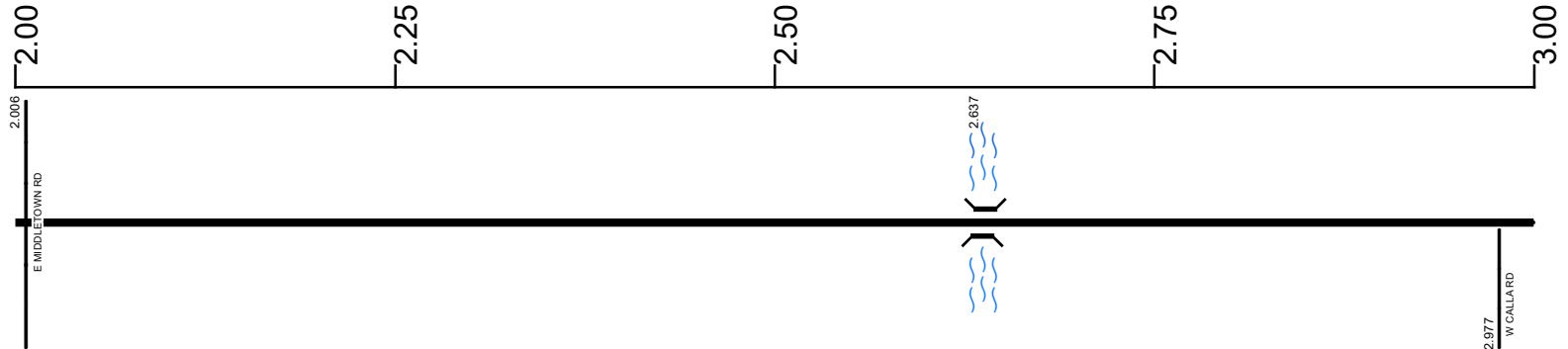

Surface Type & Width (Left / Right)

G (6/18')
0 - 4.8

Base Type (Left / Right)

N / K
0 - 4.8

Shoulder Type & Width (Left / Right)

2 (5/5)
0 - 4.8

Resurface Year

2020
0 - 11.776

Through Lanes

2
0 - 11.776

Street Name

S SALEM WARREN RD
0 - 11.776

- | | | | |
|---------------------|-------------------|----------------------|--------------|
| Non-divided Highway | Bridge (on route) | Railroad (at grade) | Intersection |
| Divided Highway | Underpass | Railroad (underpass) | |
| Secondary Segment | Overpass | Railroad (overpass) | |
| Corporation | | | |

Created on: 7/2/2025



transportation.ohio.gov

Prepared by
The Ohio Department of Transportation
Office of Technical Services
Roadway Information

SMAHSR00045**C

State True Log

33.717

County True Log

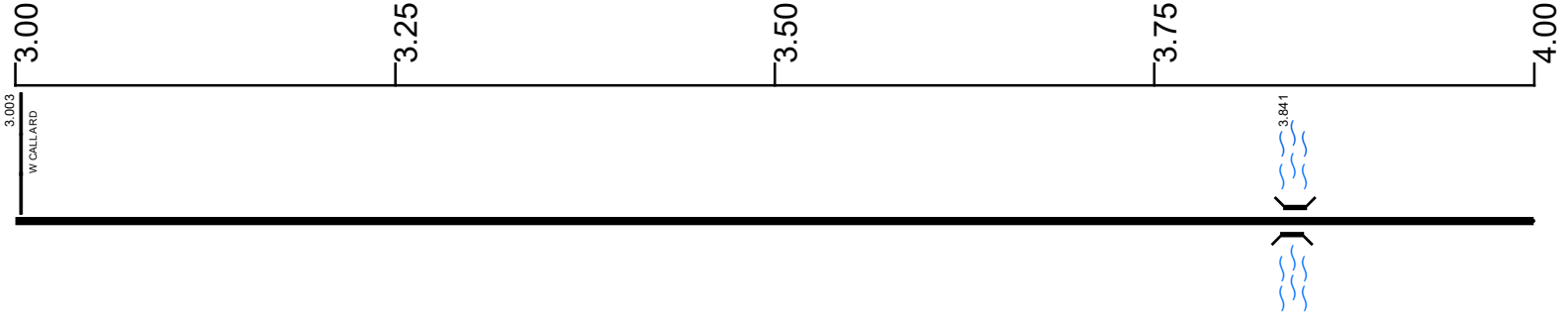

Surface Type & Width (Left / Right)

G (6'/18')
0 - 4.8

Base Type (Left / Right)

N / K
0 - 4.8

Shoulder Type & Width (Left / Right)

2 (5'/5')
0 - 4.8

Resurface Year

2020
0 - 11.776

Through Lanes

2
0 - 11.776

Street Name

S SALEM WARREN RD
0 - 11.776

- | | | | |
|---------------------|-------------------|----------------------|--------------|
| Non-divided Highway | Bridge (on route) | Railroad (at grade) | Intersection |
| Divided Highway | Underpass | Railroad (underpass) | |
| Secondary Segment | Overpass | Railroad (overpass) | |
| Corporation | | | |

Created on: 7/2/2025



transportation.ohio.gov

Prepared by
The Ohio Department of Transportation
Office of Technical Services
Roadway Information

SMAHSR00045**C

State True Log

34.717

County True Log



Surface Type & Width (Left / Right)

G (6'/18')	G 24'
0 - 4.8	4.8 - 5.168

Base Type (Left / Right)

N / K	L
0 - 4.8	4.8 - 5.168

Shoulder Type & Width (Left / Right)

2 (5'/5')	2 (4'/4')
0 - 4.8	4.8 - 5.168

Resurface Year

2020
0 - 11.776

Through Lanes

2
0 - 11.776

Street Name

S SALEM WARREN RD
0 - 11.776

- | | | | |
|--|---|---|---|
| <ul style="list-style-type: none"> Non-divided Highway Divided Highway Secondary Segment Corporation | <ul style="list-style-type: none"> Bridge (on route) Underpass Overpass | <ul style="list-style-type: none"> Railroad (at grade) Railroad (underpass) Railroad (overpass) | <ul style="list-style-type: none"> Intersection |
|--|---|---|---|

Created on: 7/2/2025

transportation.ohio.gov

Prepared by
The Ohio Department of Transportation
Office of Technical Services
Roadway Information

SMAHSR00045**C

State True Log

35.717

County True Log

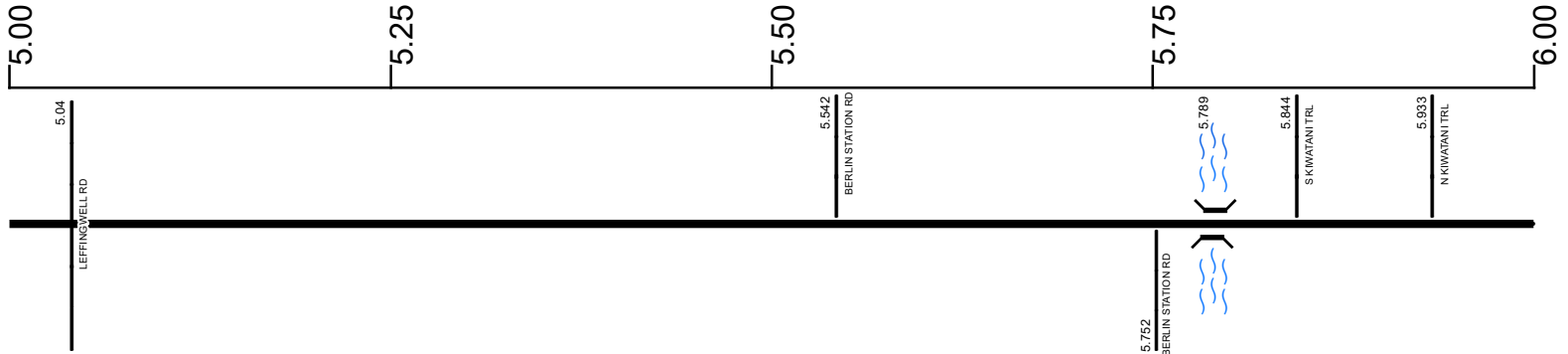

Surface Type & Width (Left / Right)

G 24' 4.8 - 5.168	G (6'/18') 5.168 - 6.545
----------------------	-----------------------------

Base Type (Left / Right)

L 4.8 - 5.168	N / K 5.168 - 6.545
------------------	------------------------

Shoulder Type & Width (Left / Right)

2 (4'/4') 4.8 - 5.168	2 (5'/5') 5.168 - 6.545
--------------------------	----------------------------

Resurface Year

	2020 0 - 11.776
--	--------------------

Through Lanes

	2 0 - 11.776
--	-----------------

Street Name

	S SALEM WARREN RD 0 - 11.776
--	---------------------------------

- Non-divided Highway
- Divided Highway
- Secondary Segment
- Corporation
- Bridge (on route)
- Underpass
- Overpass
- Railroad (at grade)
- Railroad (underpass)
- Railroad (overpass)
- Intersection

Created on: 7/2/2025

transportation.ohio.gov

Prepared by
The Ohio Department of Transportation
Office of Technical Services
Roadway Information

SMAHSR00045**C

State True Log

36.717

County True Log

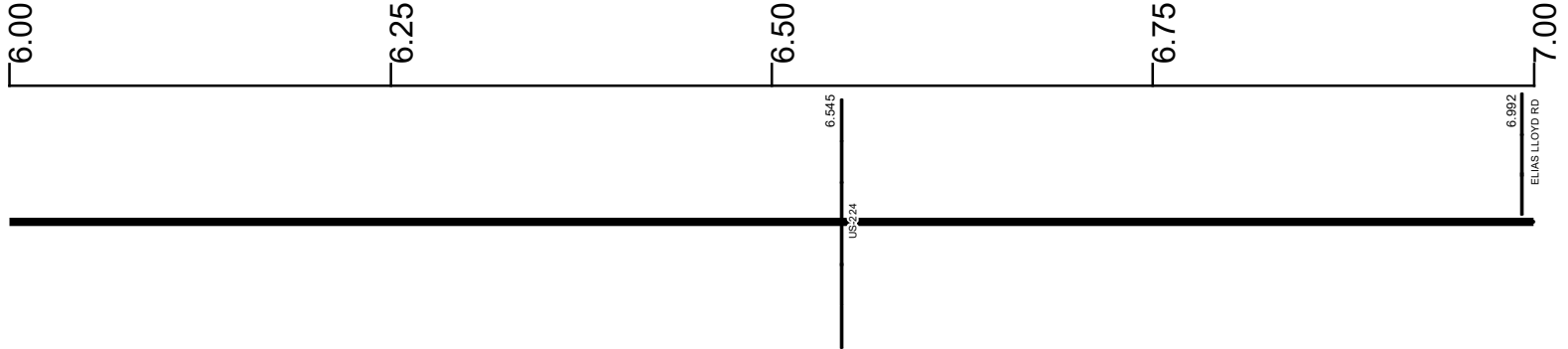

Surface Type & Width (Left / Right)

G (6'/18')	G (20'/4')
5.168 - 6.545	6.545 - 9.647

Base Type (Left / Right)

N / K	K / L
5.168 - 6.545	6.545 - 9.647

Shoulder Type & Width (Left / Right)

2 (5'/5')	2 (2'/2')
5.168 - 6.545	6.545 - 11.776

Resurface Year

2020

0 - 11.776

Through Lanes

2

0 - 11.776

Street Name

S SALEM WARREN RD

0 - 11.776

- | | | | |
|--|---|---|---|
| <ul style="list-style-type: none"> Non-divided Highway Divided Highway Secondary Segment Corporation | <ul style="list-style-type: none"> Bridge (on route) Underpass Overpass | <ul style="list-style-type: none"> Railroad (at grade) Railroad (underpass) Railroad (overpass) | <ul style="list-style-type: none"> Intersection |
|--|---|---|---|

Created on: 7/2/2025



Prepared by
The Ohio Department of Transportation
Office of Technical Services
Roadway Information

SMAHSR00045**C

State True Log

37.717

County True Log

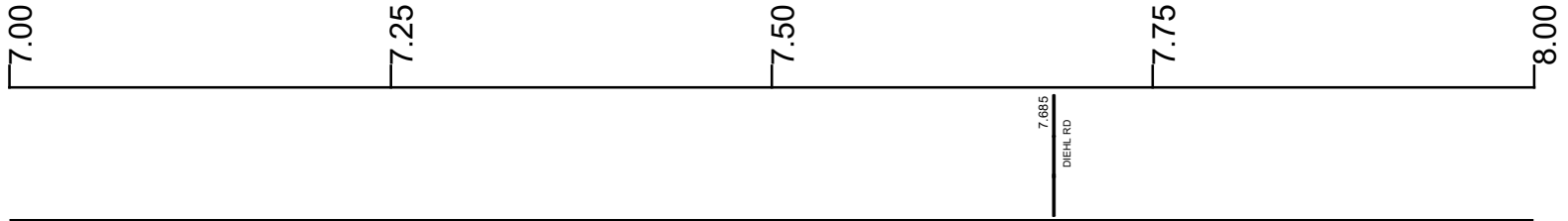

Surface Type & Width (Left / Right)

G (20'/4')
6.545 - 9.647

Base Type (Left / Right)

K / L
6.545 - 9.647

Shoulder Type & Width (Left / Right)

2 (2'/2')
6.545 - 11.776

Resurface Year

2020
0 - 11.776

Through Lanes

2
0 - 11.776

Street Name

S SALEM WARREN RD
0 - 11.776

- | | | | |
|---------------------|-------------------|----------------------|--------------|
| Non-divided Highway | Bridge (on route) | Railroad (at grade) | Intersection |
| Divided Highway | Underpass | Railroad (underpass) | |
| Secondary Segment | Overpass | Railroad (overpass) | |
| Corporation | | | |

Created on: 7/2/2025

transportation.ohio.gov

Prepared by
The Ohio Department of Transportation
Office of Technical Services
Roadway Information

SMAHSR00045**C

State True Log

38.717

County True Log

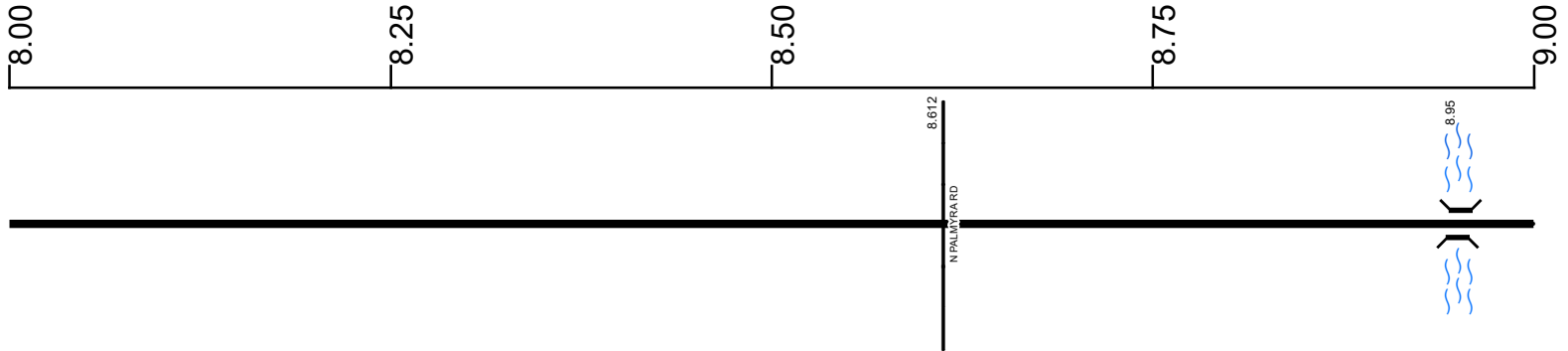

Surface Type & Width (Left / Right)

G (20'4')
6.545 - 9.647

Base Type (Left / Right)

K / L
6.545 - 9.647

Shoulder Type & Width (Left / Right)

2 (2'2')
6.545 - 11.776

Resurface Year

2020
0 - 11.776

Through Lanes

2
0 - 11.776

Street Name

S SALEM WARREN RD
0 - 11.776

- | | | | |
|---------------------|-------------------|----------------------|--------------|
| Non-divided Highway | Bridge (on route) | Railroad (at grade) | Intersection |
| Divided Highway | Underpass | Railroad (underpass) | |
| Secondary Segment | Overpass | Railroad (overpass) | |
| Corporation | | | |

Created on: 7/2/2025



transportation.ohio.gov

Prepared by
The Ohio Department of Transportation
Office of Technical Services
Roadway Information

SMAHSR00045**C

State True Log

39.717

County True Log



Surface Type & Width (Left / Right)

G (20'4')	G (6'18')
6.545 - 9.647	9.647 - 11.776

Base Type (Left / Right)

K / L	N / K
6.545 - 9.647	9.647 - 11.776

Shoulder Type & Width (Left / Right)

2 (2'2')
6.545 - 11.776

Resurface Year

2020
0 - 11.776

Through Lanes

2
0 - 11.776

Street Name

S SALEM WARREN RD
0 - 11.776

- Non-divided Highway
- Divided Highway
- Secondary Segment
- Corporation
- Bridge (on route)
- Underpass
- Overpass
- Railroad (at grade)
- Railroad (underpass)
- Railroad (overpass)
- Intersection

Created on: 7/2/2025

transportation.ohio.gov

Prepared by
The Ohio Department of Transportation
Office of Technical Services
Roadway Information

SMAHSR00045**C

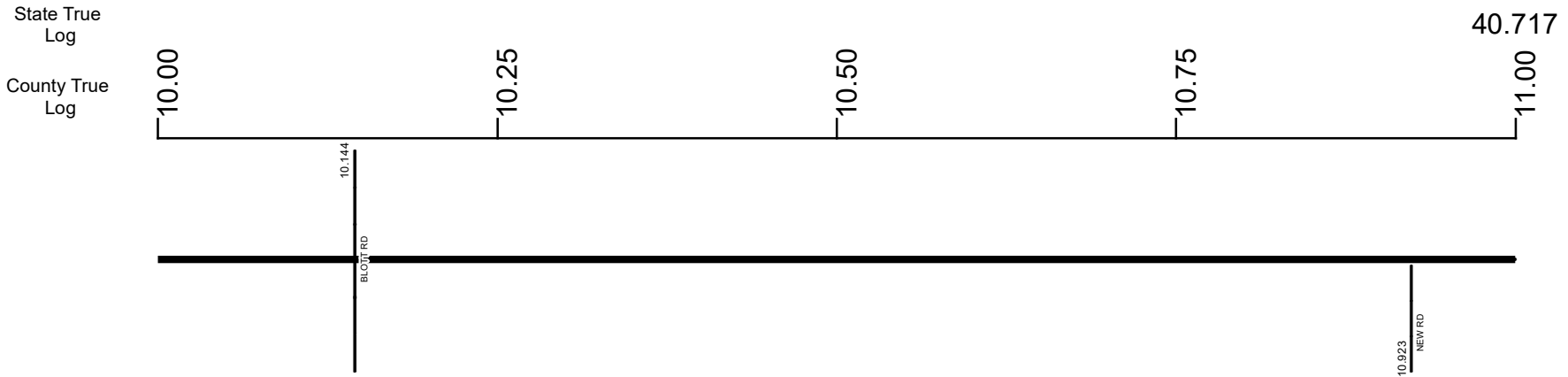

Surface Type & Width (Left / Right)	G (6'/18')
	9.647 - 11.776
Base Type (Left / Right)	N / K
	9.647 - 11.776
Shoulder Type & Width (Left / Right)	2 (2'/2')
	6.545 - 11.776
Resurface Year	2020
	0 - 11.776
Through Lanes	2
	0 - 11.776
Street Name	S SALEM WARREN RD
	0 - 11.776

Non-divided Highway	Bridge (on route)	Railroad (at grade)	Intersection
Divided Highway	Underpass	Railroad (underpass)	
Secondary Segment	Overpass	Railroad (overpass)	
Corporation			

Created on: 7/2/2025

transportation.ohio.gov

Prepared by
The Ohio Department of Transportation
Office of Technical Services
Roadway Information

SMAHSR00045**C

State True Log

41.717

County True Log

11.00

11.25

11.50

11.75

12.00

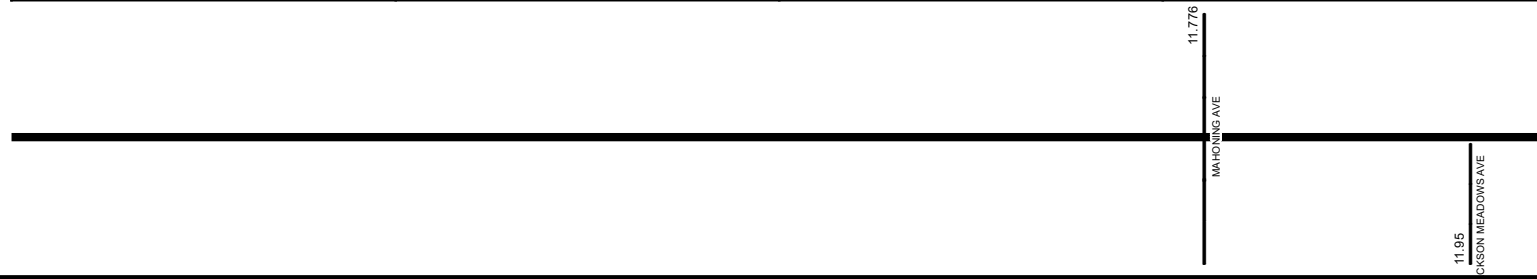

Surface Type & Width (Left / Right)

G (6'/18')	G (20'/28')
9.647 - 11.776	11.776 - 12.277

Base Type (Left / Right)

N / K	K / L
9.647 - 11.776	11.776 - 12.277

Shoulder Type & Width (Left / Right)

2 (2'/2')	1 (0'/0')
6.545 - 11.776	11.776 - 12.277

Resurface Year

2020

0 - 11.776

Through Lanes

2	4
0 - 11.776	11.776 - 14.142

Street Name

S SALEM WARREN RD	N SALEM WARREN RD
0 - 11.776	11.776 - 14.142

- Non-divided Highway
 Bridge (on route)
 Railroad (at grade)
 Intersection
- Divided Highway
 Underpass
 Railroad (underpass)
- Secondary Segment
 Overpass
 Railroad (overpass)
- Corporation**

Created on: 7/2/2025

transportation.ohio.gov

Prepared by
The Ohio Department of Transportation
Office of Technical Services
Roadway Information

SMAHSR00045**C

State True Log
County True Log

42.717

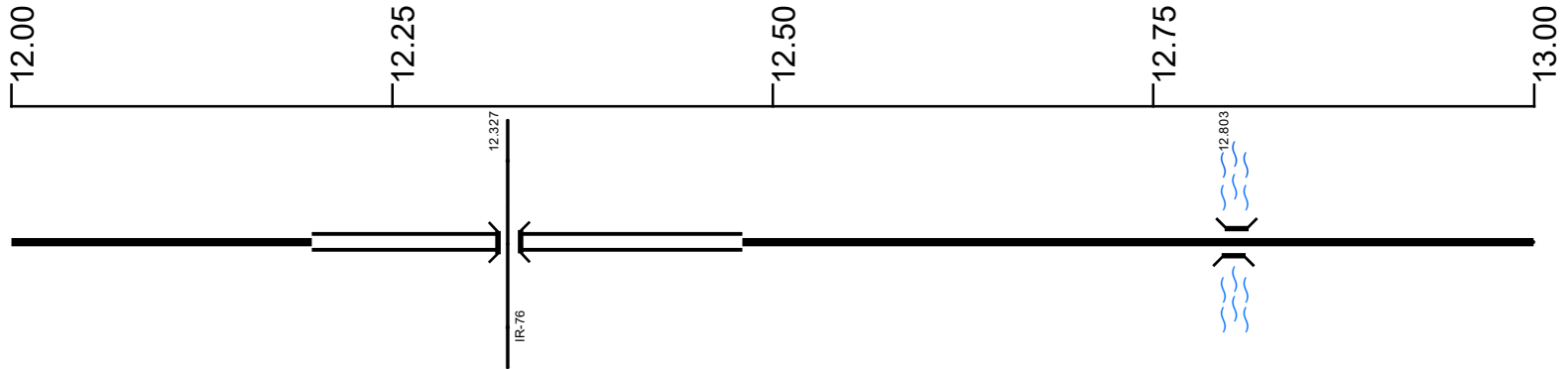

Surface Type & Width (Left / Right)

G (20'/28')	G 50'	G (30'/20')
11.776 - 12.277	12.277 - 12.48	12.48 - 13.021

Base Type (Left / Right)

K / L	L / K
11.776 - 12.277	12.277 - 13.021

Shoulder Type & Width (Left / Right)

1 (0'/0')	5 (8'/8')	2 (8'/8')	2 (10'/10')
11.776 - 12.277	12.277 - 12.426	12.426 - 12.48	12.48 - 14.142

Median Type and Width

3 (4')
12.197 - 12.48

Through Lanes

4
11.776 - 14.142

Street Name

N SALEM WARREN RD
11.776 - 14.142

- | | | | |
|---------------------|-------------------|----------------------|--------------|
| Non-divided Highway | Bridge (on route) | Railroad (at grade) | Intersection |
| Divided Highway | Underpass | Railroad (underpass) | |
| Secondary Segment | Overpass | Railroad (overpass) | |
| Corporation | | | |

Created on: 7/2/2025

transportation.ohio.gov

Prepared by
The Ohio Department of Transportation
Office of Technical Services
Roadway Information

SMAHSR00045**C

State True Log

43.717

County True Log

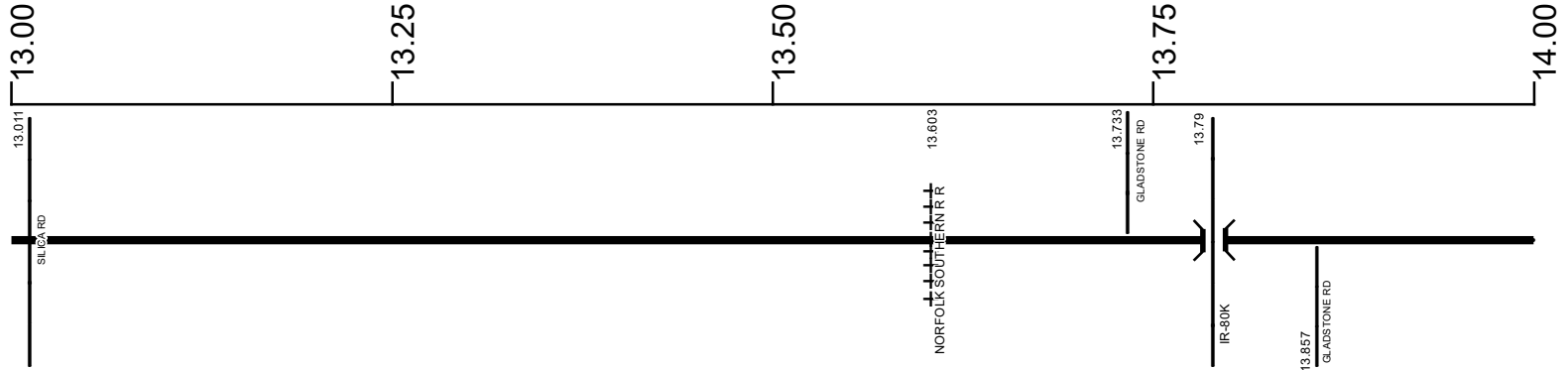

Surface Type & Width (Left / Right)

G (30'/20')	G 50'	G (30'/20')
	13.021 - 13.262	13.262 - 14.142

Base Type (Left / Right)

L / K	L	L / K
	13.021 - 13.262	13.262 - 14.142

Shoulder Type & Width (Left / Right)

	2 (10'/10')
	12.48 - 14.142

Through Lanes

	4
	11.776 - 14.142

Street Name

	N SALEM WARREN RD
	11.776 - 14.142

- | | | | |
|---------------------|-------------------|----------------------|--------------|
| Non-divided Highway | Bridge (on route) | Railroad (at grade) | Intersection |
| Divided Highway | Underpass | Railroad (underpass) | |
| Secondary Segment | Overpass | Railroad (overpass) | |
| Corporation | | | |

Created on: 7/2/2025

transportation.ohio.gov

Prepared by
The Ohio Department of Transportation
Office of Technical Services
Roadway Information

SMAHSR00045**C

State True Log

43.859

County True Log



Surface Type & Width (Left / Right)

G (30'/20')

13.262 - 14.142

Base Type (Left / Right)

L / K

13.262 - 14.142

Shoulder Type & Width (Left / Right)

2 (10'/10')

12.48 - 14.142

Through Lanes

4

11.776 - 14.142

Street Name

N SALEM WARREN RD

11.776 - 14.142

- | | | | |
|---------------------|-------------------|----------------------|--------------|
| Non-divided Highway | Bridge (on route) | Railroad (at grade) | Intersection |
| Divided Highway | Underpass | Railroad (underpass) | |
| Secondary Segment | Overpass | Railroad (overpass) | |
| Corporation | | | |

Created on: 7/2/2025

transportation.ohio.gov

Prepared by
The Ohio Department of Transportation
Office of Technical Services
Roadway Information

Historical Project List for SMAHSR00045**C

Begin Measure	End Measure	Project ID Number	Construction Completion Date	Treatment Category	Treatment Type
0.000	9.647	94140	8-2020	Minor Rehabilitation	60-AC Overlay w/Rpr
0.000	6.545	19849	9-2004	Minor Rehabilitation	60-AC Overlay w/Rpr
9.647	11.776	94140	8-2020	Minor Rehabilitation	38-Fine Poly AC Overlay
11.776	14.142	100306	6-2016	Minor Rehabilitation	38-Fine Poly AC Overlay

Roadway Codes

Access Control Journalized

- F - Full Access Control
- L - Limited Access Control
- N - No Access Control

Access Control Operational

- 1 - Full Access Control
- 2 - Partial Access Control
- 3 - No Access Control

Base Type

- F - Crack and Seat
- H - Rubblize and Roll
- I - Aggregate Base 304 or Traffic Compacted
- K - Water Bound Macadam
- L - Bituminous Concrete Mix or Penetration Macadam
- N - Plain Concrete
- P - Reinforced Concrete
- R - Brick (Flexible)
- T - Brick (Rigid)

Direction of Travel

- B - Both (Two-way)
- F - One-way Cardinal
- T - One-way Non-cardinal

Facility Type

- 1 - One-way Roadway
- 2 - Two-way Roadway
- 4 - Ramp
- 5 - Non-mainline
- 6 - Non-inventory Direction
- 7 - Planned / Unbuilt

Historical Federal Aid Indicator

- N - Not a FAP Route
- Y - FAP Route

Functional Classification

- 01 - Interstate
- 02 - Principal Arterial (Freeways)
- 03 - Principal Arterial (Other)
- 04 - Minor Arterial
- 05 - Major Collector
- 06 - Minor Collector
- 07 - Local

Leave / Reenter Indicator

- Y - Route leaves/reenters at this point
- N - Route does not leave/reenter at this point

Median Type

- 1 - None
- 2 - Unprotected
- 3 - Curbed
- 4 - Positive Barrier (Unspecified)
- 5 - Positive Barrier (Flexible)
- 6 - Positive Barrier (Semi-rigid)
- 7 - Positive Barrier (Rigid)

NHS

- N - National Highway System
- H - Congressional Corridor
- 2 - Major Airport
- 3 - Major Port Facility
- 4 - Major Amtrak Station
- 5 - Major Rail / Truck Terminal
- 6 - Major Intercity Bus Terminal
- 7 - Major Public Transit / Multi-modal Passenger Terminal
- 8 - Major Pipeline Terminal
- 9 - Major Ferry Terminal

Priority System

- G - General
- P - Priority System
- U - Urban

Scenic Byway Code

- A - All American Road
- N - National Scenic Byway
- S - State Scenic Byway

Shoulder Type

- 1 - None
- 2 - Surfaced shoulder exists (bituminous concrete {AC})
- 3 - Surfaced shoulder exists (Portland Cement Concrete {PCC})
- 4 - Stabilized shoulder exists (gravel or other granular material)
- 5 - Combination shoulder exists (two or more surface types)
- 6 - Earth shoulder exists
- 7 - Barrier curb exists; no shoulder in front of curb

Surface Type

- A - Combination
- B - Brick
- C - Continuous Reinforced Concrete
- D - Reinforced Concrete
- E - Plain Concrete
- G - Bituminous Concrete
- I - Chipseal on Granular
- K - Open Graded Bituminous
- L - Chipseal or Micro
- M - Gravel
- U - Unimproved
- X - Right of Way Only