

SMAHSR00046**C

State True Log 11.135

12.135

County True Log

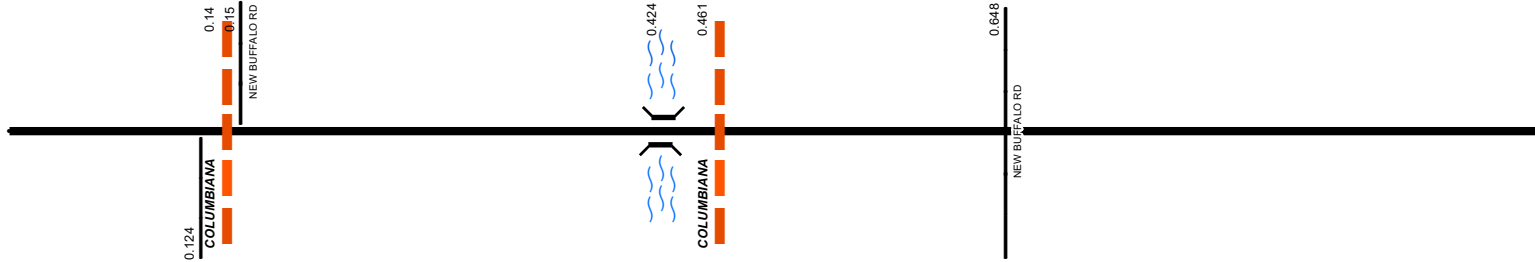

Surface Type & Width (Left / Right)

G 48'	G 24'
0 - 0.12	0.12 - 4.493

Base Type (Left / Right)

L / P	P
0 - 0.12	0.12 - 4.493

Shoulder Type & Width (Left / Right)

1 (0'/0')	5 (2'1/2')
0 - 0.12	0.12 - 4.424

Through Lanes

	2
	0 - 9.407

Street Name

	COLUMBIANA CANFIELD RD
	0 - 8.597

Non-divided Highway	Bridge (on route)	Railroad (at grade)	Intersection
Divided Highway	Underpass	Railroad (underpass)	
Secondary Segment	Overpass	Railroad (overpass)	
Corporation			

Created on: 7/2/2025

transportation.ohio.gov

Prepared by
The Ohio Department of Transportation
Office of Technical Services
Roadway Information

SMAHSR00046**C

State True Log

13.135

County True Log

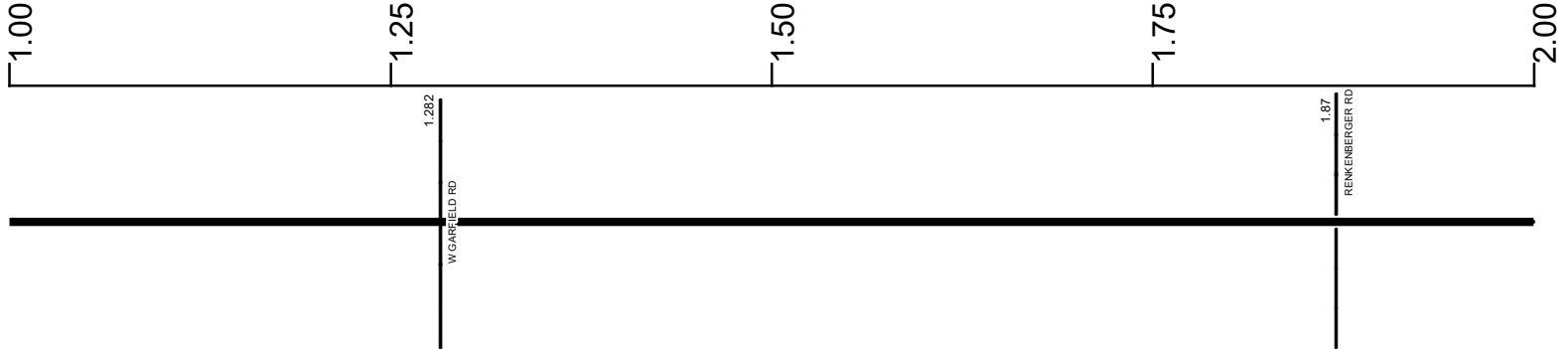

Surface Type & Width (Left / Right)

G 24'
0.12 - 4.493

Base Type (Left / Right)

P
0.12 - 4.493

Shoulder Type & Width (Left / Right)

5 (2/2)
0.12 - 4.424

Through Lanes

2
0 - 9.407

Street Name

COLUMBIANA CANFIELD RD
0 - 8.597

- | | | | |
|---------------------|-------------------|----------------------|--------------|
| Non-divided Highway | Bridge (on route) | Railroad (at grade) | Intersection |
| Divided Highway | Underpass | Railroad (underpass) | |
| Secondary Segment | Overpass | Railroad (overpass) | |
| Corporation | | | |

Created on: 7/2/2025



transportation.ohio.gov

Prepared by
The Ohio Department of Transportation
Office of Technical Services
Roadway Information

SMAHSR00046**C

State True Log

14.135

County True Log

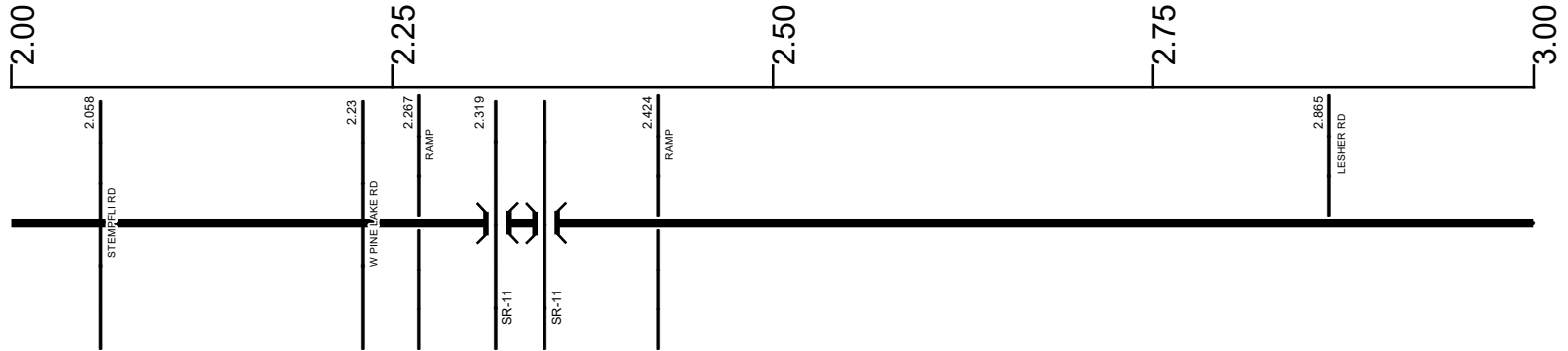

Surface Type & Width (Left / Right)

G 24'
0.12 - 4.493

Base Type (Left / Right)

P
0.12 - 4.493

Shoulder Type & Width (Left / Right)

5 (2 1/2)
0.12 - 4.424

Through Lanes

2
0 - 9.407

Street Name

COLUMBIANA CANFIELD RD
0 - 8.597

- | | | | |
|---------------------|-------------------|----------------------|--------------|
| Non-divided Highway | Bridge (on route) | Railroad (at grade) | Intersection |
| Divided Highway | Underpass | Railroad (underpass) | |
| Secondary Segment | Overpass | Railroad (overpass) | |
| Corporation | | | |

Created on: 7/2/2025



transportation.ohio.gov

Prepared by
The Ohio Department of Transportation
Office of Technical Services
Roadway Information

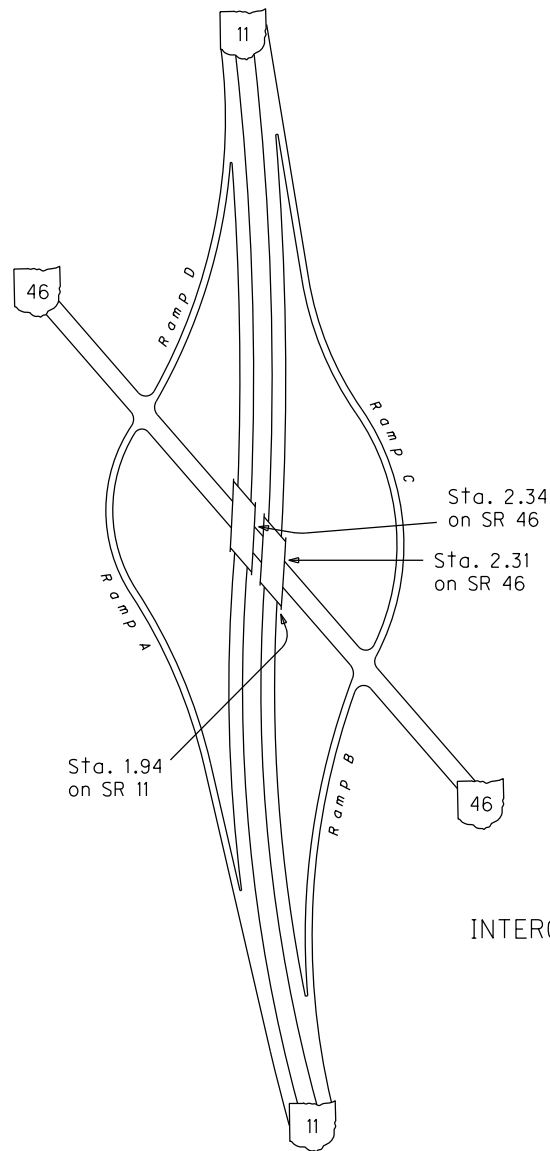

INTERCHANGE
 SR 11 & SR 46
 MAHONING COUNTY
 INTERCHANGE ID NUMBER = 065300

SMAHSR00046**C

State True Log

15.135

County True Log

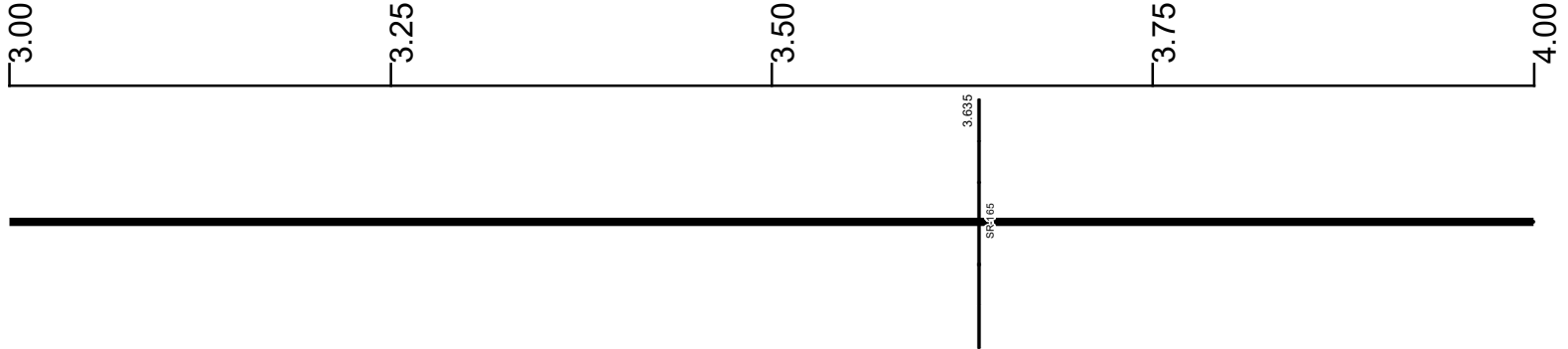

Surface Type & Width (Left / Right)

G 24'
0.12 - 4.493

Base Type (Left / Right)

P
0.12 - 4.493

Shoulder Type & Width (Left / Right)

5 (2/2)
0.12 - 4.424

Through Lanes

2
0 - 9.407

Street Name

COLUMBIANA CANFIELD RD
0 - 8.597

- | | | | |
|---------------------|-------------------|----------------------|--------------|
| Non-divided Highway | Bridge (on route) | Railroad (at grade) | Intersection |
| Divided Highway | Underpass | Railroad (underpass) | |
| Secondary Segment | Overpass | Railroad (overpass) | |
| Corporation | | | |

Created on: 7/2/2025



transportation.ohio.gov
 Prepared by
 The Ohio Department of Transportation
 Office of Technical Services
 Roadway Information

SMAHSR00046**C

State True Log

16.135

County True Log

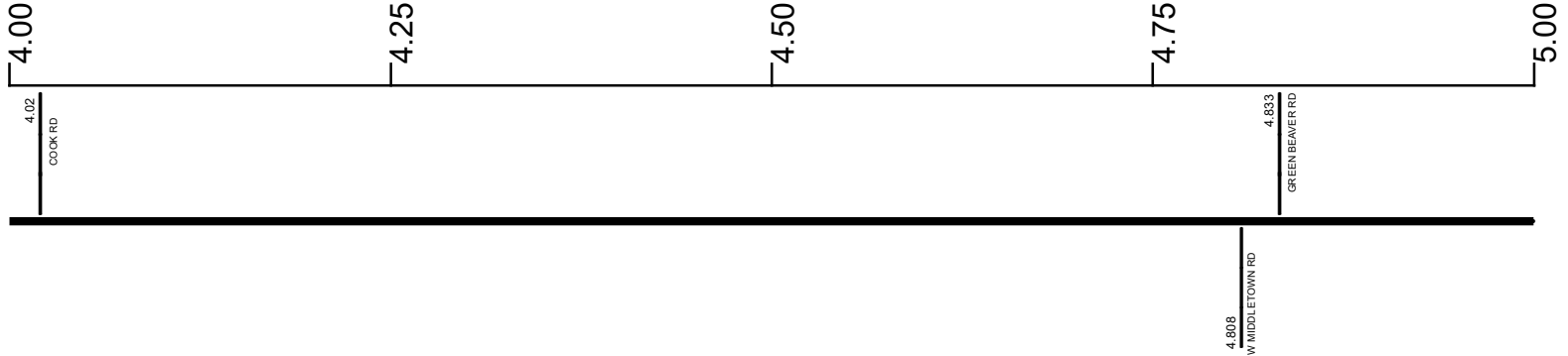

Surface Type & Width (Left / Right)

G 24'	G (24'/23') G (24'/12')	G 24'
0.12 - 4.493	4.493 - 4.552 4.552 - 4.611	4.611 - 5.828

Base Type (Left / Right)

P	P / L	P
0.12 - 4.493	4.493 - 4.611	4.611 - 5.828

Shoulder Type & Width (Left / Right)

5 (2'/2')	5 (4'/4')	5 (2'/2')
0.12 - 4.424	4.424 - 4.69	4.69 - 8.276

Through Lanes

2
0 - 9.407

Street Name

COLUMBIANA CANFIELD RD
0 - 8.597

- Non-divided Highway
- Divided Highway
- Secondary Segment
- Corporation
- Bridge (on route)
- Underpass
- Overpass
- Railroad (at grade)
- Railroad (underpass)
- Railroad (overpass)
- Intersection

Created on: 7/2/2025

transportation.ohio.gov

Prepared by
The Ohio Department of Transportation
Office of Technical Services
Roadway Information

SMAHSR00046**C

State True Log

17.135

County True Log



Surface Type & Width (Left / Right)

G 24'	G (18'/6')
4.611 - 5.828	5.828 - 6.06

Base Type (Left / Right)

P	L / K
4.611 - 5.828	5.828 - 6.06

Shoulder Type & Width (Left / Right)

5 (2'/2')
4.69 - 8.276

Through Lanes

2
0 - 9.407

Street Name

COLUMBIANA CANFIELD RD
0 - 8.597

- Non-divided Highway
 Bridge (on route)
 Railroad (at grade)
 Intersection
- Divided Highway
 Underpass
 Railroad (underpass)
- Secondary Segment
 Overpass
 Railroad (overpass)
- Corporation**

Created on: 7/2/2025

transportation.ohio.gov

Prepared by

The Ohio Department of Transportation

Office of Technical Services

Roadway Information

SMAHSR00046**C

State True Log

18.135

County True Log

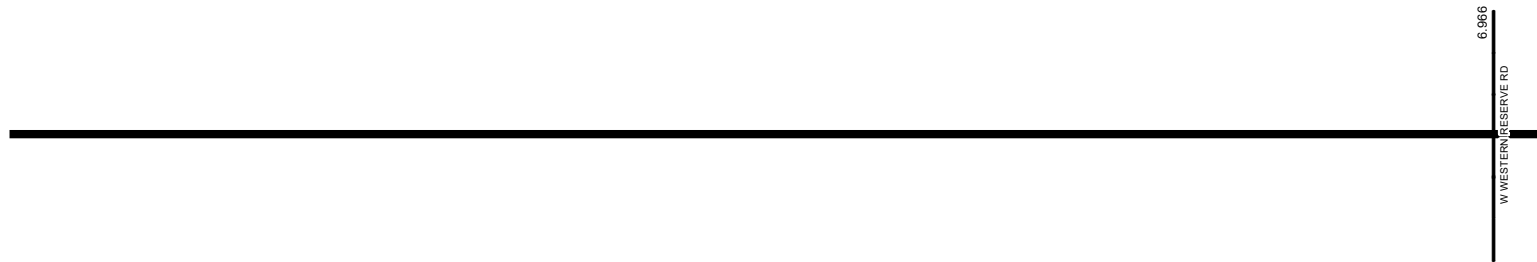

Surface Type & Width (Left / Right)

G (18'/6")	G 24'	G (18'/6")
5.828 - 6.06	6.06 - 6.462	6.462 - 8.276

Base Type (Left / Right)

L / K	K	L / K
5.828 - 6.06	6.06 - 6.462	6.462 - 8.545

Shoulder Type & Width (Left / Right)

	5 (2'/2')
	4.69 - 8.276

Through Lanes

	2
	0 - 9.407

Street Name

	COLUMBIANA CANFIELD RD
	0 - 8.597

- Non-divided Highway
 Bridge (on route)
 Railroad (at grade)
 Intersection
- Divided Highway
 Underpass
 Railroad (underpass)
- Secondary Segment
 Overpass
 Railroad (overpass)
- Corporation**

Created on: 7/2/2025

transportation.ohio.gov

Prepared by
The Ohio Department of Transportation
Office of Technical Services
Roadway Information

SMAHSR00046**C

State True Log

19.135

County True Log

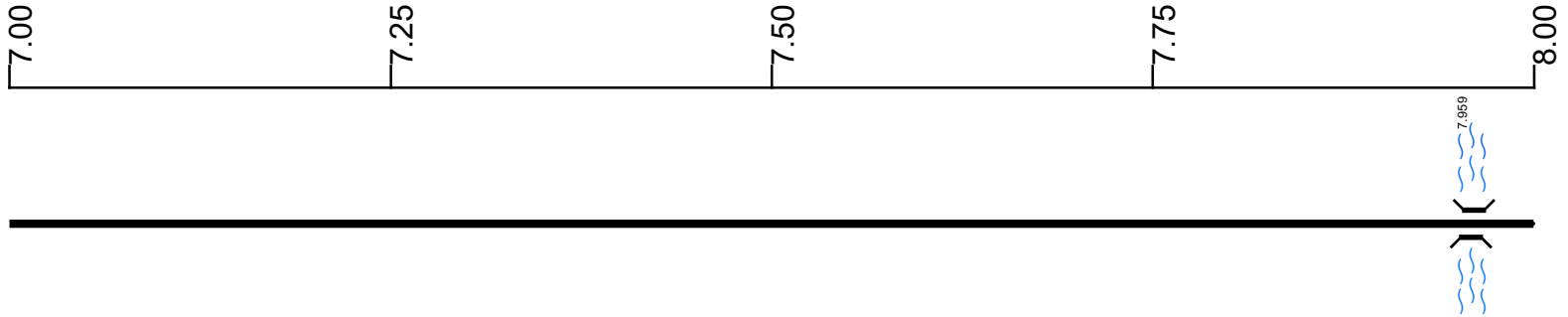

Surface Type & Width (Left / Right)

G (18'/6')
6.462 - 8.276

Base Type (Left / Right)

L / K
6.462 - 8.545

Shoulder Type & Width (Left / Right)

5 (2'/2')
4.69 - 8.276

Through Lanes

2
0 - 9.407

Street Name

COLUMBIANA CANFIELD RD
0 - 8.597

- | | | | |
|---------------------|-------------------|----------------------|--------------|
| Non-divided Highway | Bridge (on route) | Railroad (at grade) | Intersection |
| Divided Highway | Underpass | Railroad (underpass) | |
| Secondary Segment | Overpass | Railroad (overpass) | |
| Corporation | | | |

Created on: 7/2/2025

transportation.ohio.gov

Prepared by
The Ohio Department of Transportation
Office of Technical Services
Roadway Information

SMAHSR00046**C

State True Log

20.135

County True Log

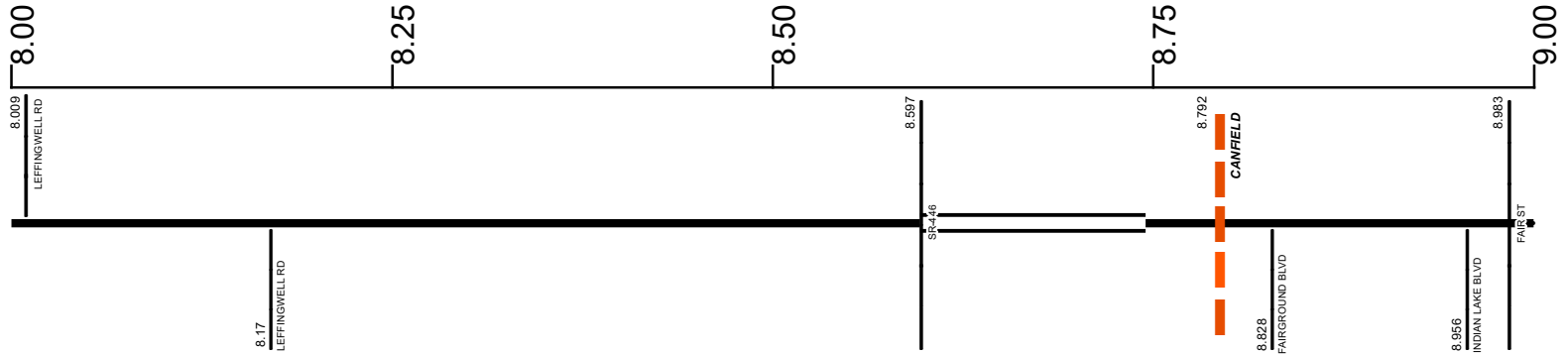

Surface Type & Width (Left / Right)

G (18'6") 6.462 - 8.276	G (20'4") 8.276 - 8.597	G (14'12") 8.597 - 8.745	G (20'4") 8.745 - 8.988	G (18'6") 8.988 - 9.407
----------------------------	----------------------------	-----------------------------	----------------------------	----------------------------

Base Type (Left / Right)

L / K 6.462 - 8.545	K / L 8.545 - 8.988
N / L 8.988 - 9.407	

Shoulder Type & Width (Left / Right)

5 (2'2") 4.69 - 8.276	2 (10'10") 8.276 - 8.597	2 (6'6") 8.597 - 8.745	1 (0'0") 8.745 - 9.289
--------------------------	-----------------------------	---------------------------	---------------------------

Median Type and Width

2 (80') 8.597 - 8.745

Through Lanes

2 0 - 9.407

Street Name

COLUMBIANA CANFIELD RD 0 - 8.597	S BROAD ST 8.597 - 9.407
-------------------------------------	-----------------------------

- | | | | |
|--|---|---|---|
| <ul style="list-style-type: none"> Non-divided Highway Divided Highway Secondary Segment Corporation | <ul style="list-style-type: none"> Bridge (on route) Underpass Overpass | <ul style="list-style-type: none"> Railroad (at grade) Railroad (underpass) Railroad (overpass) | <ul style="list-style-type: none"> Intersection |
|--|---|---|---|

Created on: 7/2/2025

transportation.ohio.gov

Prepared by
The Ohio Department of Transportation
Office of Technical Services
Roadway Information

SMAHSR00046**C

State True Log

21.135

County True Log

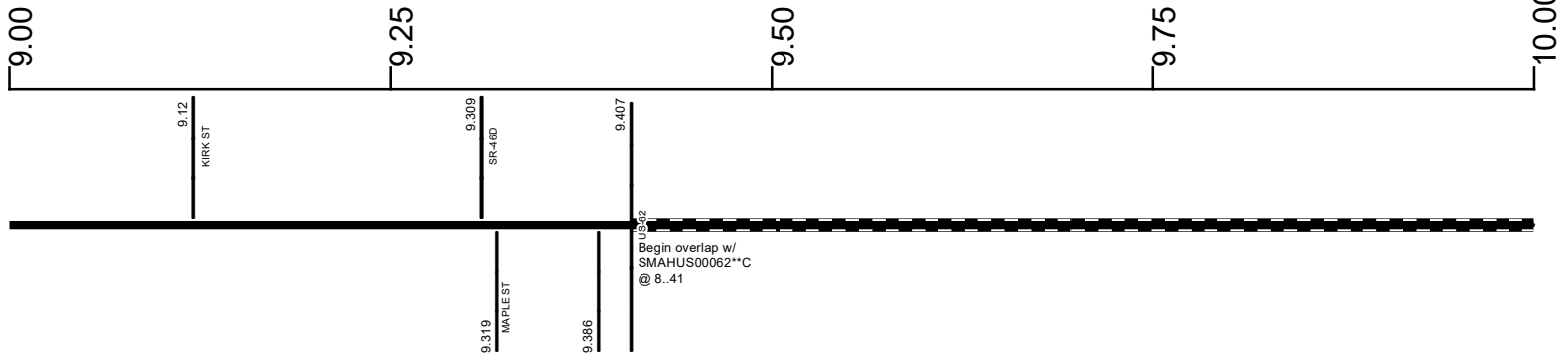

Surface Type & Width (Left / Right)	
G (18'6")	
8.988 - 9.407	
Base Type (Left / Right)	
N / L	
8.988 - 9.407	
Shoulder Type & Width (Left / Right)	
1 (0'0")	2 (3'3")
8.745 - 9.289	9.289 - 9.407

Through Lanes	
2	
0 - 9.407	
Street Name	
S BROAD ST	
8.597 - 9.407	

<ul style="list-style-type: none"> Non-divided Highway Divided Highway Secondary Segment Corporation 	<ul style="list-style-type: none"> Bridge (on route) Underpass Overpass 	<ul style="list-style-type: none"> Railroad (at grade) Railroad (underpass) Railroad (overpass) 	<ul style="list-style-type: none"> Intersection
--	---	---	---

Created on: 7/2/2025

transportation.ohio.gov

Prepared by
The Ohio Department of Transportation
Office of Technical Services
Roadway Information

SMAHSR00046**C

State True Log
County True Log

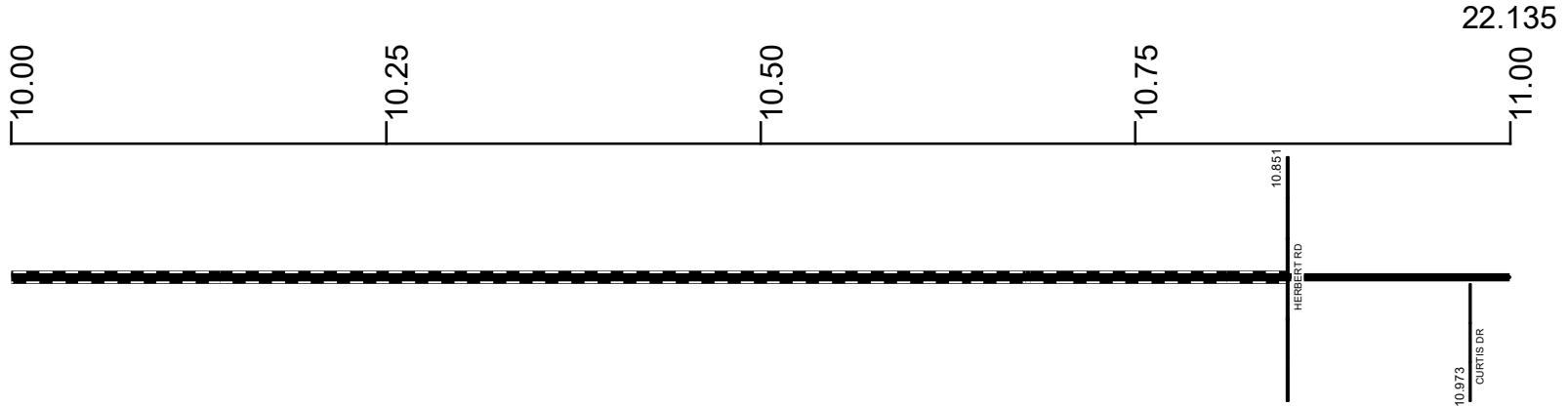

Surface Type & Width (Left / Right)

G (20'/12') G (20'/4')

10.851 - 10.963 10.963 - 12.071

Base Type (Left / Right)

K / L

10.851 - 12.071

Shoulder Type & Width (Left / Right)

1 (0'/0') 2 (6'/6')

10.851 - 10.963 10.963 - 13.509

Resurface Year

2021

10.851 - 13.48

Through Lanes

2

10.851 - 13.509

Street Name

S CANFIELD NILES RD

10.851 - 14.698

- Non-divided Highway
 Bridge (on route)
 Railroad (at grade)
 Intersection
- Divided Highway
 Underpass
 Railroad (underpass)
- Secondary Segment
 Overpass
 Railroad (overpass)
- Corporation**

Created on: 7/2/2025



transportation.ohio.gov

Prepared by
The Ohio Department of Transportation
Office of Technical Services
Roadway Information

SMAHSR00046**C

State True Log

23.135

County True Log

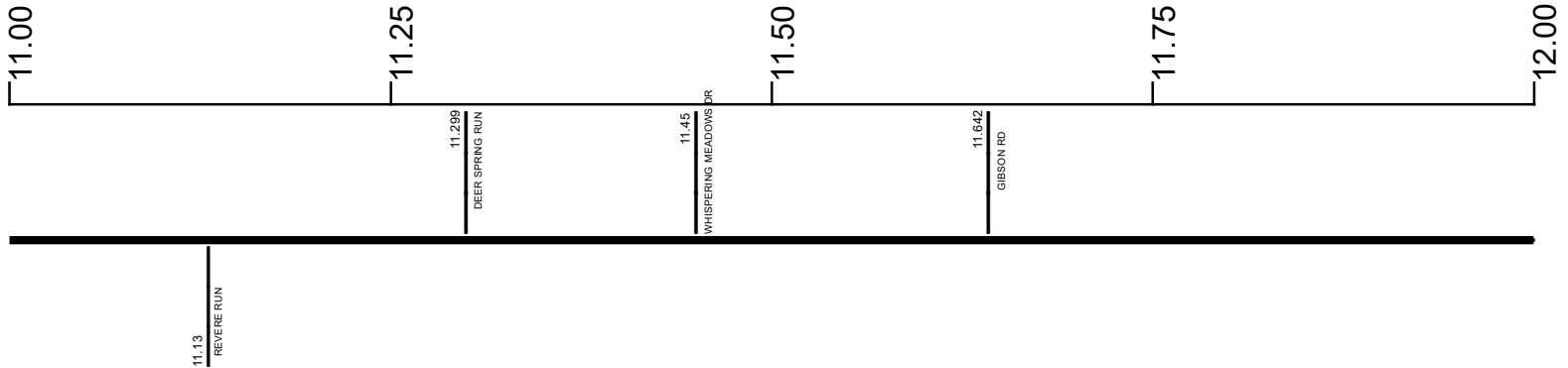

Surface Type & Width (Left / Right)

G (20'4')
10.963 - 12.071

Base Type (Left / Right)

K / L
10.851 - 12.071

Shoulder Type & Width (Left / Right)

2 (6'6")
10.963 - 13.509

Resurface Year

2021
10.851 - 13.48

Through Lanes

2
10.851 - 13.509

Street Name

S CANFIELD NILES RD
10.851 - 14.698

- | | | | |
|---------------------|-------------------|----------------------|--------------|
| Non-divided Highway | Bridge (on route) | Railroad (at grade) | Intersection |
| Divided Highway | Underpass | Railroad (underpass) | |
| Secondary Segment | Overpass | Railroad (overpass) | |
| Corporation | | | |

Created on: 7/2/2025

transportation.ohio.gov

Prepared by
The Ohio Department of Transportation
Office of Technical Services
Roadway Information

SMAHSR00046**C

State True Log

24.135

County True Log

12.00

12.25

12.50

12.75

13.00

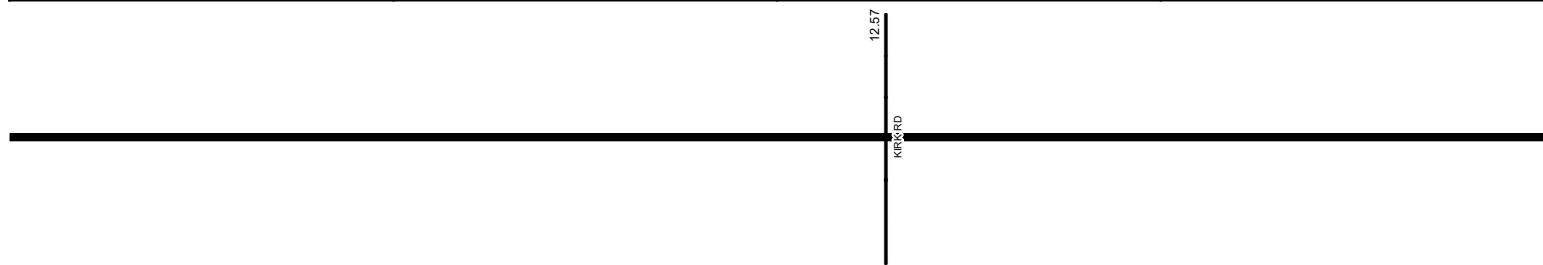

Surface Type & Width (Left / Right)

G (20'/4')	G (4'/20')	G (4'/30')	G (4'/20')
10.963 - 12.071	12.071 - 12.34	12.34 - 12.49	12.49 - 13.509

Base Type (Left / Right)

K / L	N / L
10.851 - 12.071	12.071 - 14.659

Shoulder Type & Width (Left / Right)

	2 (6'/6')
	10.963 - 13.509

Resurface Year

	2021
--	------

10.851 - 13.48

Through Lanes

	2
--	---

10.851 - 13.509

Street Name

	S CANFIELD NILES RD
--	---------------------

10.851 - 14.698

- Non-divided Highway
 Bridge (on route)
 Railroad (at grade)
 Intersection
- Divided Highway
 Underpass
 Railroad (underpass)
- Secondary Segment
 Overpass
 Railroad (overpass)
- Corporation**

Created on: 7/2/2025



Prepared by
 The Ohio Department of Transportation
 Office of Technical Services
 Roadway Information

SMAHSR00046**C

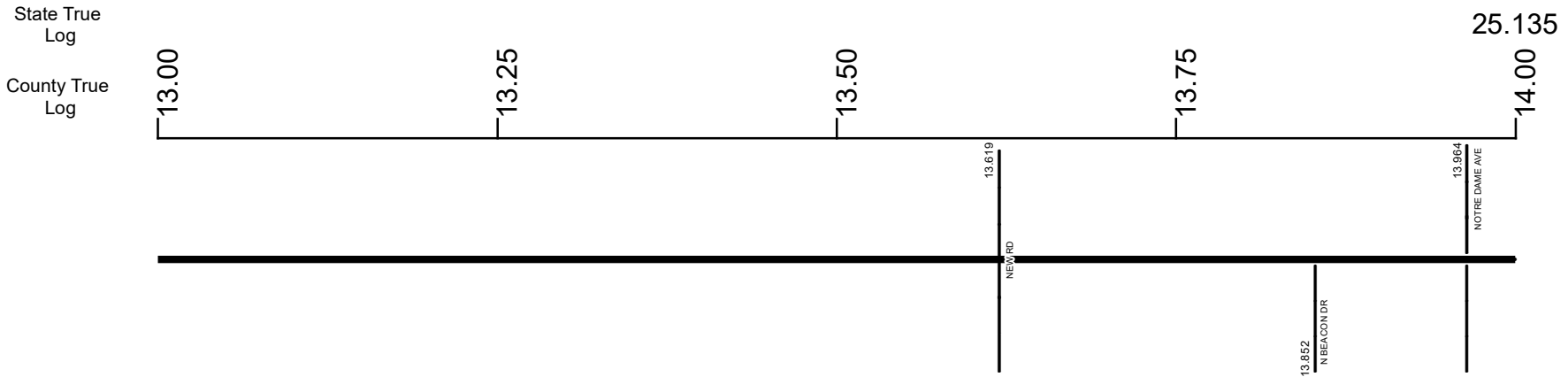

Surface Type & Width (Left / Right)	
G (4'/20') 12.49 - 13.509	G (4'/56') 13.509 - 14.659
Base Type (Left / Right)	
N / L 12.071 - 14.659	
Shoulder Type & Width (Left / Right)	
2 (6'/6') 10.963 - 13.509	1 (0'/0') 13.509 - 16.909
Resurface Year	
2021 10.851 - 13.48	
Through Lanes	
2 10.851 - 13.509	4 13.509 - 16.909
Street Name	
S CANFIELD NILES RD 10.851 - 14.698	

<ul style="list-style-type: none"> Non-divided Highway Divided Highway Secondary Segment Corporation 	<ul style="list-style-type: none"> Bridge (on route) Underpass Overpass 	<ul style="list-style-type: none"> Railroad (at grade) Railroad (underpass) Railroad (overpass) 	<ul style="list-style-type: none"> Intersection
--	---	---	---

Created on: 7/2/2025

transportation.ohio.gov

Prepared by
 The Ohio Department of Transportation
 Office of Technical Services
 Roadway Information

SMAHSR00046**C

State True Log
County True Log

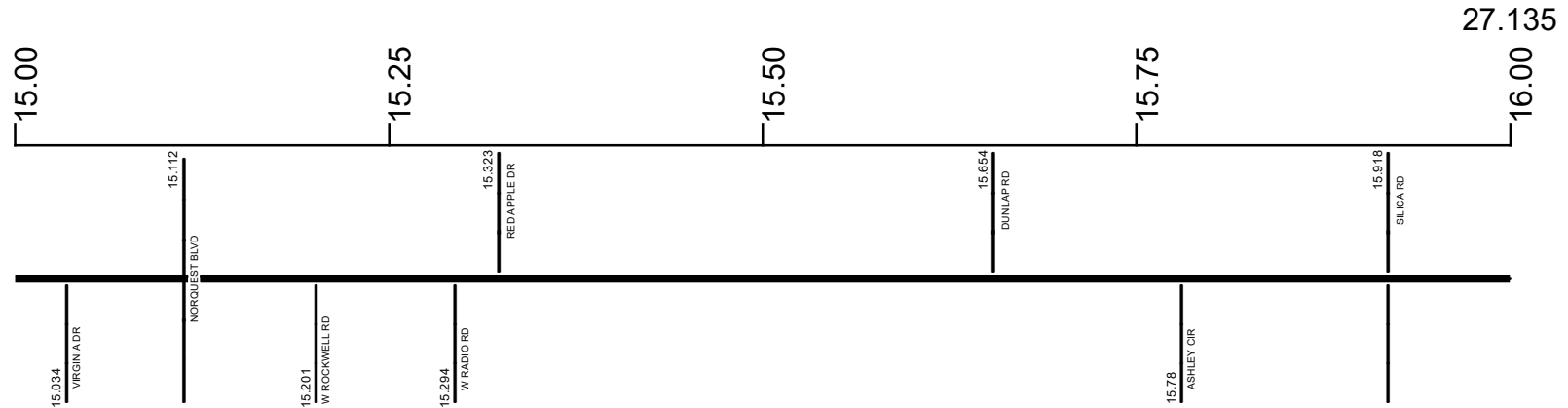

Surface Type & Width (Left / Right)

G 60'	G 48'	G 60'
14.837 - 15.191	15.191 - 15.764	15.764 - 16.909

Base Type (Left / Right)

L
14.837 - 17.114

Shoulder Type & Width (Left / Right)

1 (0/0')
13.509 - 16.909

Through Lanes

4
13.509 - 16.909

Street Name

N CANFIELD NILES RD
14.698 - 17.114

- Non-divided Highway
- Divided Highway
- Secondary Segment
- Corporation
- Bridge (on route)
- Underpass
- Overpass
- Railroad (at grade)
- Railroad (underpass)
- Railroad (overpass)
- Intersection

Created on: 7/2/2025

transportation.ohio.gov

Prepared by
The Ohio Department of Transportation
Office of Technical Services
Roadway Information

SMAHSR00046**C

State True Log
County True Log

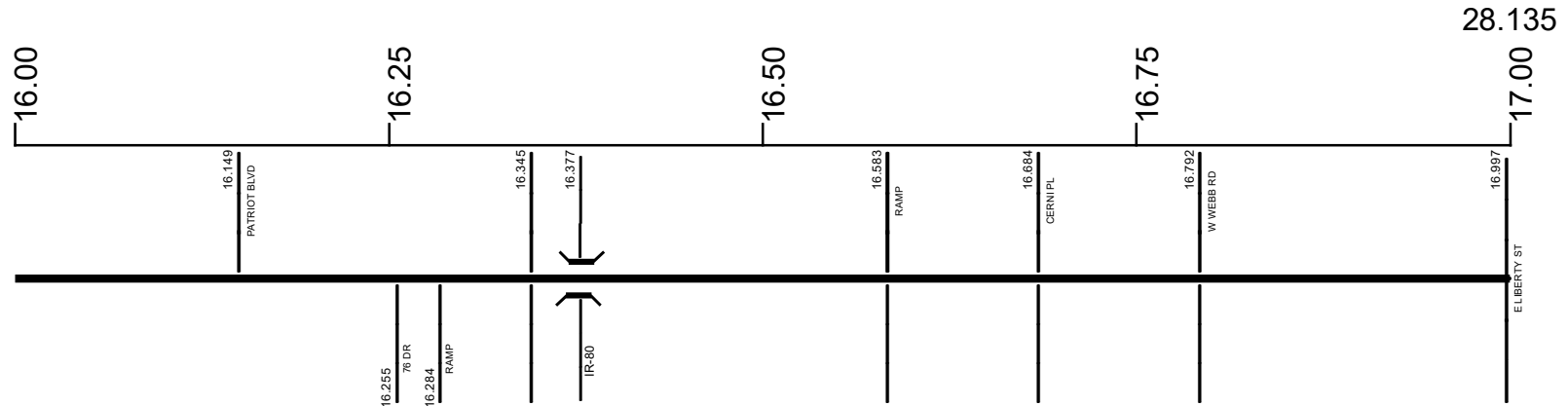

Surface Type & Width (Left / Right)

G 60'	G 22'
15.764 - 16.909	16.909 - 17.114

Base Type (Left / Right)

L
14.837 - 17.114

Shoulder Type & Width (Left / Right)

1 (0'0")	2 (6'6")
13.509 - 16.909	16.909 - 17.114

Through Lanes

4	2
13.509 - 16.909	16.909 - 17.114

Street Name

N CANFIELD NILES RD
14.698 - 17.114

- Non-divided Highway
- Divided Highway
- Secondary Segment
- Corporation
- Bridge (on route)
- Underpass
- Overpass
- Railroad (at grade)
- Railroad (underpass)
- Railroad (overpass)
- Intersection

Created on: 7/2/2025

transportation.ohio.gov

Prepared by
The Ohio Department of Transportation
Office of Technical Services
Roadway Information

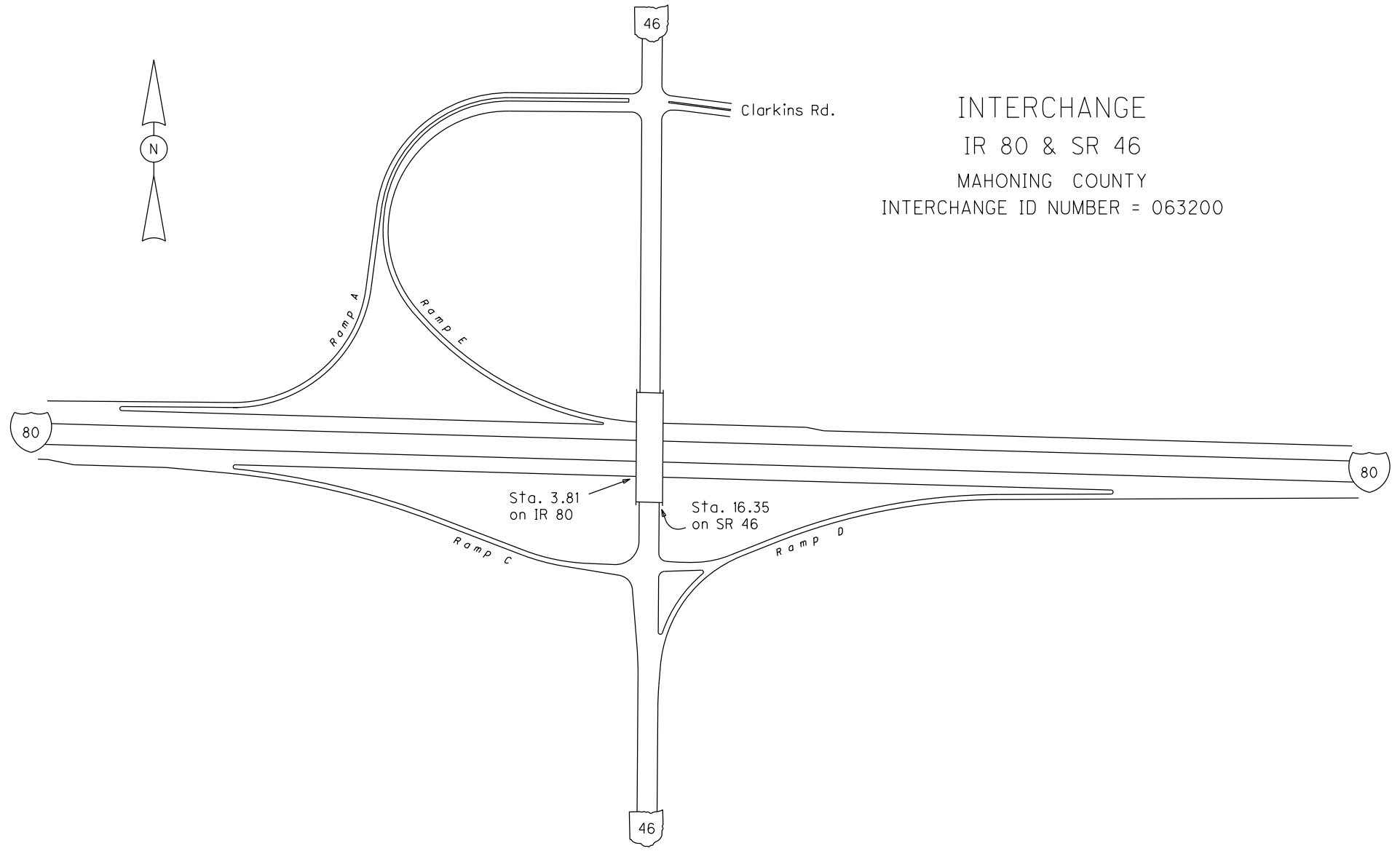

INTERCHANGE
IR 80 & SR 46
MAHONING COUNTY
INTERCHANGE ID NUMBER = 063200

SMAHSR00046**C

State True Log

28.249

County True Log

17.00

17.25

17.50

17.75

18.00

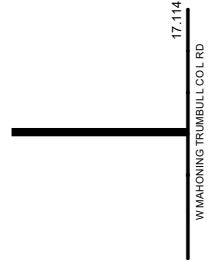

Surface Type & Width (Left / Right)

G 22'
16.909 - 17.114

Base Type (Left / Right)

L
14.837 - 17.114

Shoulder Type & Width (Left / Right)

2 (6'/6')
16.909 - 17.114

Through Lanes

2
16.909 - 17.114

Street Name

N CANFIELD NILES RD
14.698 - 17.114

- Non-divided Highway
- Divided Highway
- Secondary Segment
- Corporation
- Bridge (on route)
- Underpass
- Overpass
- Railroad (at grade)
- Railroad (underpass)
- Railroad (overpass)
- Intersection

Created on: 7/2/2025

transportation.ohio.gov
Prepared by
The Ohio Department of Transportation
Office of Technical Services
Roadway Information

Historical Project List for SMAHSR00046**C

Begin Measure	End Measure	Project ID Number	Construction Completion Date	Treatment Category	Treatment Type
0.000	0.140	88888	9-2017	Minor Rehabilitation	60-AC Overlay w/Rpr
0.000	8.808	19849	9-2004	Minor Rehabilitation	60-AC Overlay w/Rpr
0.140	8.543	88888	9-2017	Minor Rehabilitation	60-AC Overlay w/Rpr
4.434	4.808	92443	12-2013	Minor Rehabilitation	60-AC Overlay w/Rpr
8.543	8.799	94139	8-2016	Minor Rehabilitation	60-AC Overlay w/Rpr
8.799	9.289	94139	8-2016	Minor Rehabilitation	60-AC Overlay w/Rpr
8.808	9.407	22568	9-2005	Minor Rehabilitation	60-AC Overlay w/Rpr
9.309	9.407	92643	12-2013	Minor Rehabilitation	60-AC Overlay w/Rpr
10.851	13.509	101045	9-2022	Preventive Maintenance	30-Microsurfacing
10.851	12.071	101043	11-2018	Preventive Maintenance	30-Microsurfacing
10.851	13.509	77856	1-2012	Minor Rehabilitation	60-AC Overlay w/Rpr
12.071	16.909	100306	6-2016	Minor Rehabilitation	38-Fine Poly AC Overlay
16.099	16.841	9016	7-2005	Major Rehabilitation	100-New Flexible Pvmt
16.684	17.114	102103	1-2020	Major Rehabilitation	100-New Flexible Pvmt
16.909	17.114	83520	9-2011	Minor Rehabilitation	60-AC Overlay w/Rpr

Roadway Codes

Access Control Journalized

- F - Full Access Control
- L - Limited Access Control
- N - No Access Control

Access Control Operational

- 1 - Full Access Control
- 2 - Partial Access Control
- 3 - No Access Control

Base Type

- F - Crack and Seat
- H - Rubblize and Roll
- I - Aggregate Base 304 or Traffic Compacted
- K - Water Bound Macadam
- L - Bituminous Concrete Mix or Penetration Macadam
- N - Plain Concrete
- P - Reinforced Concrete
- R - Brick (Flexible)
- T - Brick (Rigid)

Direction of Travel

- B - Both (Two-way)
- F - One-way Cardinal
- T - One-way Non-cardinal

Facility Type

- 1 - One-way Roadway
- 2 - Two-way Roadway
- 4 - Ramp
- 5 - Non-mainline
- 6 - Non-inventory Direction
- 7 - Planned / Unbuilt

Historical Federal Aid Indicator

- N - Not a FAP Route
- Y - FAP Route

Functional Classification

- 01 - Interstate
- 02 - Principal Arterial (Freeways)
- 03 - Principal Arterial (Other)
- 04 - Minor Arterial
- 05 - Major Collector
- 06 - Minor Collector
- 07 - Local

Leave / Reenter Indicator

- Y - Route leaves/reenters at this point
- N - Route does not leave/reenter at this point

Median Type

- 1 - None
- 2 - Unprotected
- 3 - Curbed
- 4 - Positive Barrier (Unspecified)
- 5 - Positive Barrier (Flexible)
- 6 - Positive Barrier (Semi-rigid)
- 7 - Positive Barrier (Rigid)

NHS

- N - National Highway System
- H - Congressional Corridor
- 2 - Major Airport
- 3 - Major Port Facility
- 4 - Major Amtrak Station
- 5 - Major Rail / Truck Terminal
- 6 - Major Intercity Bus Terminal
- 7 - Major Public Transit / Multi-modal Passenger Terminal
- 8 - Major Pipeline Terminal
- 9 - Major Ferry Terminal

Priority System

- G - General
- P - Priority System
- U - Urban

Scenic Byway Code

- A - All American Road
- N - National Scenic Byway
- S - State Scenic Byway

Shoulder Type

- 1 - None
- 2 - Surfaced shoulder exists (bituminous concrete {AC})
- 3 - Surfaced shoulder exists (Portland Cement Concrete {PCC})
- 4 - Stabilized shoulder exists (gravel or other granular material)
- 5 - Combination shoulder exists (two or more surface types)
- 6 - Earth shoulder exists
- 7 - Barrier curb exists; no shoulder in front of curb

Surface Type

- A - Combination
- B - Brick
- C - Continuous Reinforced Concrete
- D - Reinforced Concrete
- E - Plain Concrete
- G - Bituminous Concrete
- I - Chipseal on Granular
- K - Open Graded Bituminous
- L - Chipseal or Micro
- M - Gravel
- U - Unimproved
- X - Right of Way Only