

# SMAHSR00165\*\*C

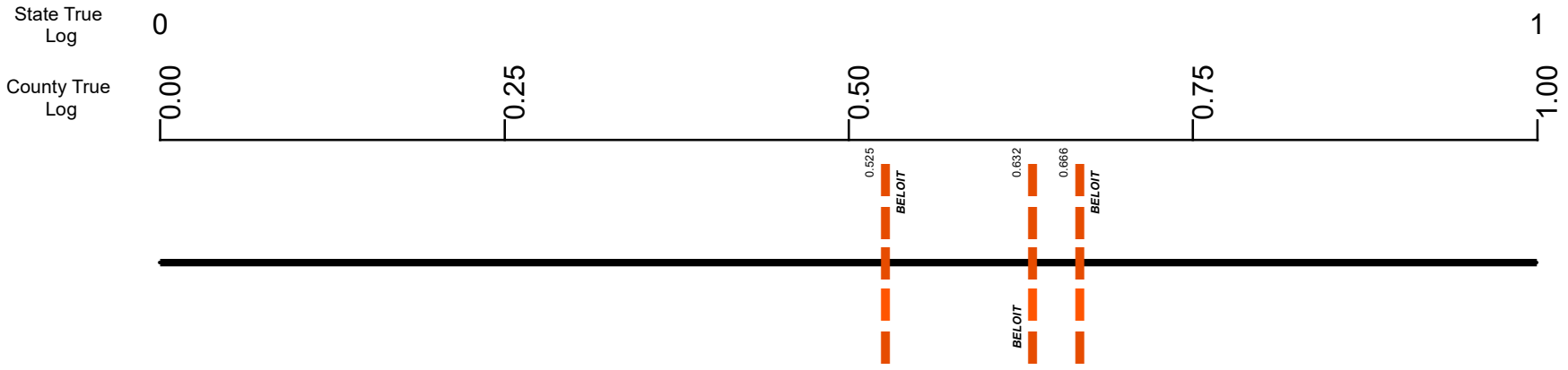

Surface Type & Width (Left / Right)	G (20'4') 0 - 1.297		
Base Type (Left / Right)	L 0 - 1.487		
Shoulder Type & Width (Left / Right)	2 (4'4') 0 - 1.327		
Through Lanes	2 0 - 25.903		
Street Name	<table style="width: 100%; border-collapse: collapse;"> <tr> <td style="width: 60%; border: 1px solid black; text-align: center;">BELOIT SNODES RD 0 - 0.666</td> <td style="width: 40%; border: 1px solid black; text-align: center;">MAIN ST 0.666 - 1.74</td> </tr> </table>	BELOIT SNODES RD 0 - 0.666	MAIN ST 0.666 - 1.74
BELOIT SNODES RD 0 - 0.666	MAIN ST 0.666 - 1.74		

- |                     |                   |                      |              |
|---------------------|-------------------|----------------------|--------------|
| Non-divided Highway | Bridge (on route) | Railroad (at grade)  | Intersection |
| Divided Highway     | Underpass         | Railroad (underpass) |              |
| Secondary Segment   | Overpass          | Railroad (overpass)  |              |
| <b>Corporation</b>  |                   |                      |              |

Created on: 7/2/2025

transportation.ohio.gov

Prepared by  
The Ohio Department of Transportation  
Office of Technical Services  
Roadway Information

# SMAHSR00165\*\*C

State True Log

County True Log

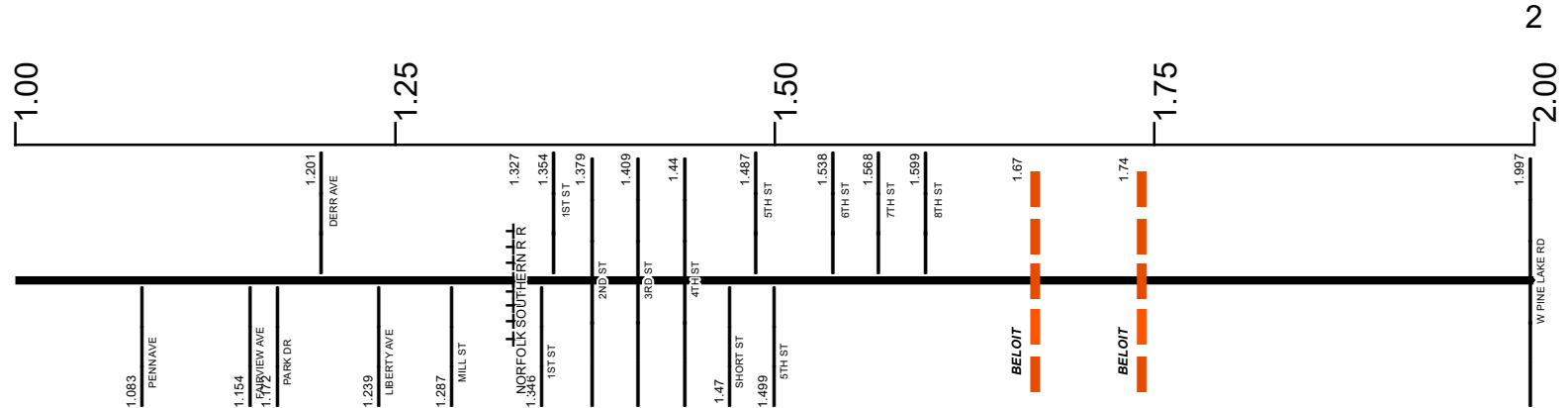

**Surface Type & Width (Left / Right)**

G (20'4") 0 - 1.297	E (20'4") 1.297 - 1.327	E (13'14") 1.327 - 1.487	G (18'4") 1.487 - 5.471
------------------------	----------------------------	-----------------------------	----------------------------

**Base Type (Left / Right)**

L 0 - 1.487
----------------

**Base Type (Left / Right)**

N/L 1.648 - 1.668	K/L 1.668 - 5.471
----------------------	----------------------

**Shoulder Type & Width (Left / Right)**

2 (4'4") 0 - 1.327	1 (0'0") 1.327 - 1.487	2 (3'3") 1.487 - 5.471
-----------------------	---------------------------	---------------------------

**Through Lanes**

2 0 - 25.903
-----------------

**Street Name**

MAIN ST 0.666 - 1.74	BELOIT SNODES RD 1.74 - 3
-------------------------	------------------------------

- Non-divided Highway
- Divided Highway
- Secondary Segment
- Corporation
- Bridge (on route)
- Underpass
- Overpass
- Railroad (at grade)
- Railroad (underpass)
- Railroad (overpass)
- Intersection

Created on: 7/2/2025

transportation.ohio.gov

Prepared by  
The Ohio Department of Transportation  
Office of Technical Services  
Roadway Information

# SMAHSR00165\*\*C

State True Log

County True Log

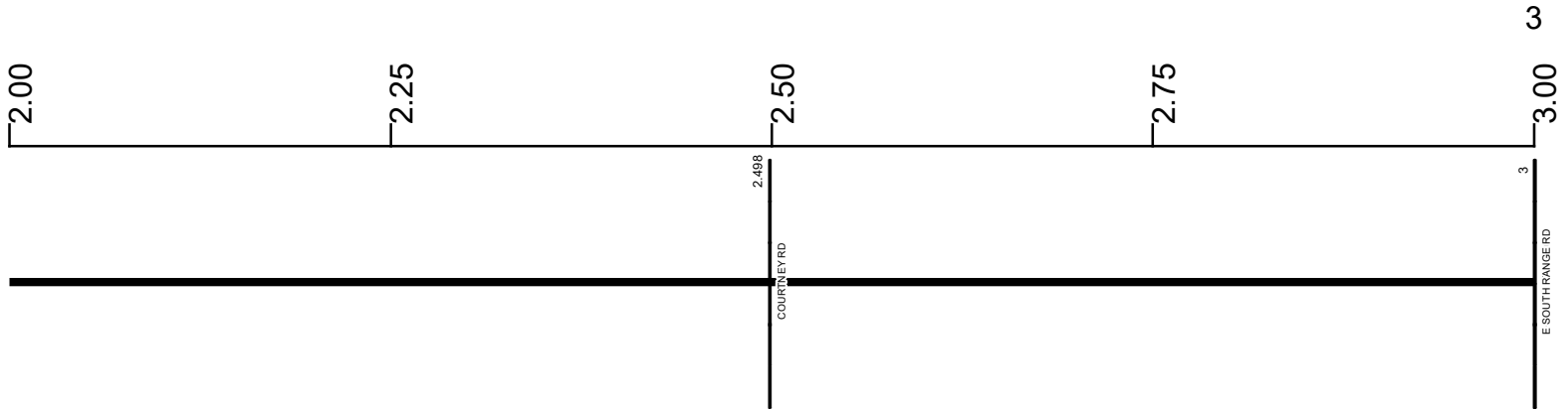

Surface Type & Width (Left / Right)

G (18'/4')  
1.487 - 5.471

Base Type (Left / Right)

K / L  
1.668 - 5.471

Shoulder Type & Width (Left / Right)

2 (3'/3')  
1.487 - 5.471

Through Lanes

2  
0 - 25.903

Street Name

BELOIT SNODES RD  
1.74 - 3

- |                     |                   |                      |              |
|---------------------|-------------------|----------------------|--------------|
| Non-divided Highway | Bridge (on route) | Railroad (at grade)  | Intersection |
| Divided Highway     | Underpass         | Railroad (underpass) |              |
| Secondary Segment   | Overpass          | Railroad (overpass)  |              |
| Corporation         |                   |                      |              |

Created on: 7/2/2025

  
 transportation.ohio.gov  
 Prepared by  
 The Ohio Department of Transportation  
 Office of Technical Services  
 Roadway Information

# SMAHSR00165\*\*C

State True Log

4

County True Log

3.00

3.25

3.50

3.75

4.00



Surface Type & Width (Left / Right)

G (18/4')  
1.487 - 5.471

Base Type (Left / Right)

K / L  
1.668 - 5.471

Shoulder Type & Width (Left / Right)

2 (3/3')  
1.487 - 5.471

Through Lanes

2  
0 - 25.903

Street Name

W SOUTH RANGE RD  
3 - 20.585

- |                     |                   |                      |              |
|---------------------|-------------------|----------------------|--------------|
| Non-divided Highway | Bridge (on route) | Railroad (at grade)  | Intersection |
| Divided Highway     | Underpass         | Railroad (underpass) |              |
| Secondary Segment   | Overpass          | Railroad (overpass)  |              |
| Corporation         |                   |                      |              |

Created on: 7/2/2025



Prepared by  
The Ohio Department of Transportation  
Office of Technical Services  
Roadway Information

# SMAHSR00165\*\*C

State True Log

5

County True Log

4.00

4.25

4.50

4.75

5.00



Surface Type & Width (Left / Right)

G (18'/4')  
1.487 - 5.471

Base Type (Left / Right)

K / L  
1.668 - 5.471

Shoulder Type & Width (Left / Right)

2 (3'/3')  
1.487 - 5.471

Through Lanes

2  
0 - 25.903

Street Name

W SOUTH RANGE RD  
3 - 20.585

- |                     |                   |                      |              |
|---------------------|-------------------|----------------------|--------------|
| Non-divided Highway | Bridge (on route) | Railroad (at grade)  | Intersection |
| Divided Highway     | Underpass         | Railroad (underpass) |              |
| Secondary Segment   | Overpass          | Railroad (overpass)  |              |
| Corporation         |                   |                      |              |

Created on: 7/2/2025



transportation.ohio.gov  
 Prepared by  
 The Ohio Department of Transportation  
 Office of Technical Services  
 Roadway Information

# SMAHSR00165\*\*C

State True Log

6

County True Log

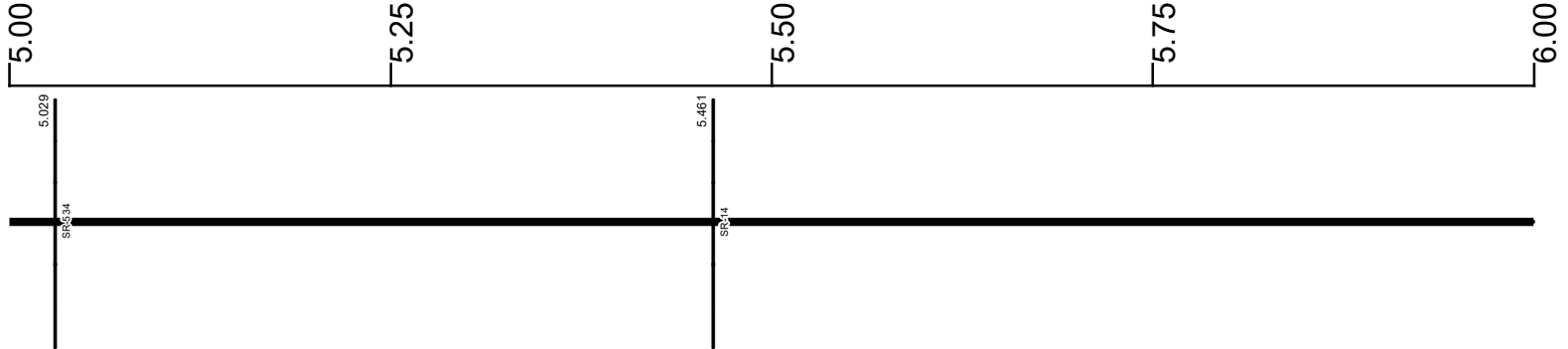

**Surface Type & Width (Left / Right)**

G (18'/4') 1.487 - 5.471	G (16'/2') 5.471 - 10.191
-----------------------------	------------------------------

**Base Type (Left / Right)**

K / L 1.668 - 5.471	K / I 5.471 - 10.191
------------------------	-------------------------

**Shoulder Type & Width (Left / Right)**

2 (3'/3') 1.487 - 5.471	2 (2'/2') 5.471 - 10.191
----------------------------	-----------------------------

**Resurface Year**

2023 5.461 - 16.606
------------------------

**Through Lanes**

2 0 - 25.903
-----------------

**Street Name**

W SOUTH RANGE RD 3 - 20.585
--------------------------------

- Non-divided Highway
- Divided Highway
- Secondary Segment
- Corporation
- Bridge (on route)
- Underpass
- Overpass
- Railroad (at grade)
- Railroad (underpass)
- Railroad (overpass)
- Intersection

Created on: 7/2/2025

transportation.ohio.gov

Prepared by  
The Ohio Department of Transportation  
Office of Technical Services  
Roadway Information

# SMAHSR00165\*\*C

State True Log

7

County True Log

6.00

6.25

6.50

6.75

7.00

6.068  
SEACRIST RD



Surface Type & Width (Left / Right)

G (16'/2')  
5.471 - 10.191

Base Type (Left / Right)

K / I  
5.471 - 10.191

Shoulder Type & Width (Left / Right)

2 (2'/2')  
5.471 - 10.191

Resurface Year











2023

Through Lanes

2  
0 - 25.903

Street Name

W SOUTH RANGE RD  
3 - 20.585

- |   |   |  |  |
|---|---|--|--|
|  Non-divided Highway |  Bridge (on route) |  Railroad (at grade)  |  Intersection |
|  Divided Highway     |  Underpass         |  Railroad (underpass) |  |
|  Secondary Segment   |  Overpass          |  Railroad (overpass)  |  |
|  Corporation         |   |  |  |

Created on: 7/2/2025



transportation.ohio.gov  
Prepared by  
The Ohio Department of Transportation  
Office of Technical Services  
Roadway Information

# SMAHSR00165\*\*C

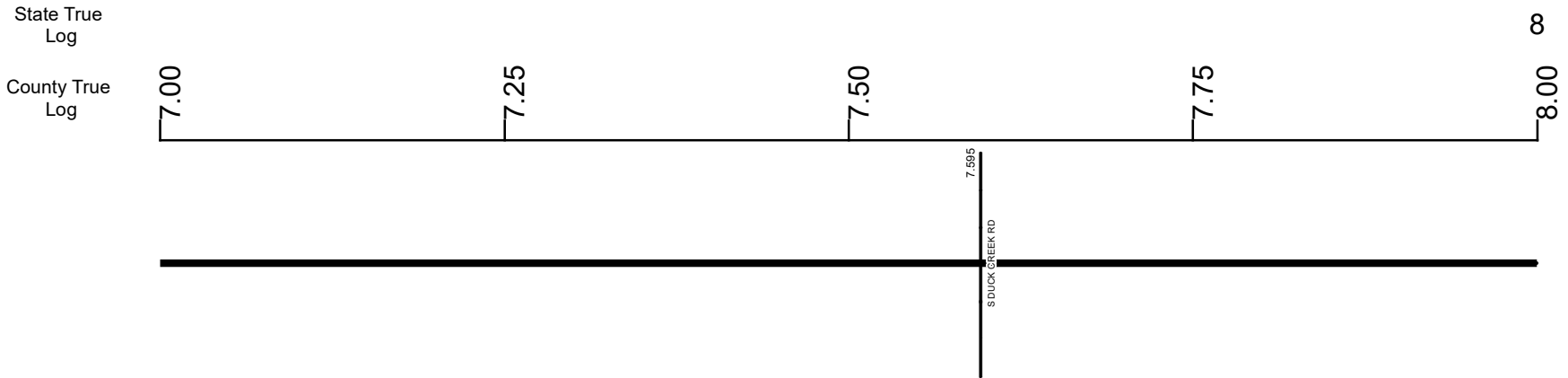

Surface Type & Width (Left / Right)	G (16'/2') 5.471 - 10.191
Base Type (Left / Right)	K / I 5.471 - 10.191
Shoulder Type & Width (Left / Right)	2 (2'/2') 5.471 - 10.191
Resurface Year	2023
Through Lanes	2 5.461 - 16.606
Street Name	W SOUTH RANGE RD 3 - 20.585

Non-divided Highway	Bridge (on route)	Railroad (at grade)	Intersection
Divided Highway	Underpass	Railroad (underpass)	
Secondary Segment	Overpass	Railroad (overpass)	
Corporation			

Created on: 7/2/2025

transportation.ohio.gov

Prepared by  
The Ohio Department of Transportation  
Office of Technical Services  
Roadway Information

# SMAHSR00165\*\*C

State True Log

County True Log

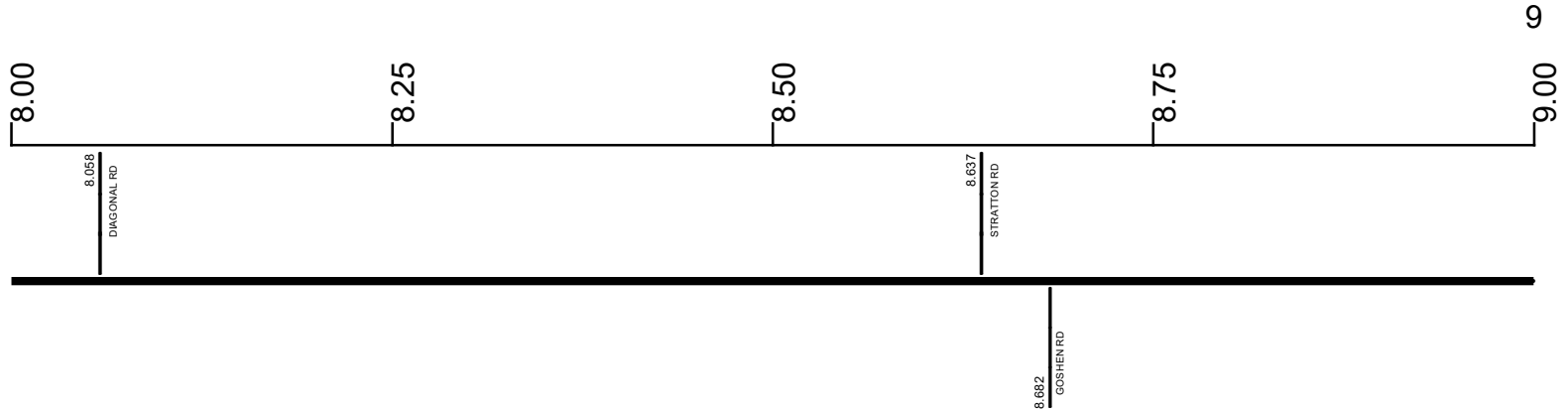

Surface Type & Width (Left / Right)

G (16'/2')  
5.471 - 10.191

Base Type (Left / Right)

K / I  
5.471 - 10.191

Shoulder Type & Width (Left / Right)

2 (2'/2')  
5.471 - 10.191

Resurface Year

2023  
5.461 - 16.606

Through Lanes

2  
0 - 25.903

Street Name

W SOUTH RANGE RD  
3 - 20.585

- |                     |                   |                      |              |
|---------------------|-------------------|----------------------|--------------|
| Non-divided Highway | Bridge (on route) | Railroad (at grade)  | Intersection |
| Divided Highway     | Underpass         | Railroad (underpass) |              |
| Secondary Segment   | Overpass          | Railroad (overpass)  |              |
| Corporation         |                   |                      |              |

Created on: 7/2/2025



transportation.ohio.gov  
Prepared by  
The Ohio Department of Transportation  
Office of Technical Services  
Roadway Information

# SMAHSR00165\*\*C

State True Log

County True Log

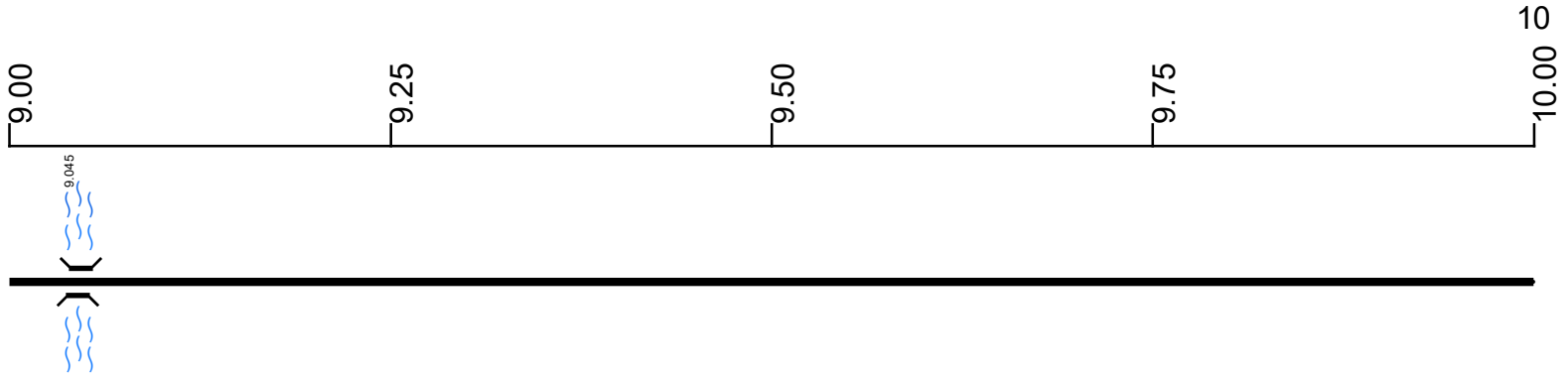

Surface Type & Width (Left / Right)

G (16'/2')  
5.471 - 10.191

Base Type (Left / Right)

K / I  
5.471 - 10.191

Shoulder Type & Width (Left / Right)

2 (2'/2')  
5.471 - 10.191

Resurface Year

2023

Through Lanes

2  
0 - 25.903

Street Name

W SOUTH RANGE RD  
3 - 20.585

- |                     |                   |                      |              |
|---------------------|-------------------|----------------------|--------------|
| Non-divided Highway | Bridge (on route) | Railroad (at grade)  | Intersection |
| Divided Highway     | Underpass         | Railroad (underpass) |              |
| Secondary Segment   | Overpass          | Railroad (overpass)  |              |
| Corporation         |                   |                      |              |

Created on: 7/2/2025



transportation.ohio.gov  
 Prepared by  
 The Ohio Department of Transportation  
 Office of Technical Services  
 Roadway Information

# SMAHSR00165\*\*C

State True Log  
County True Log

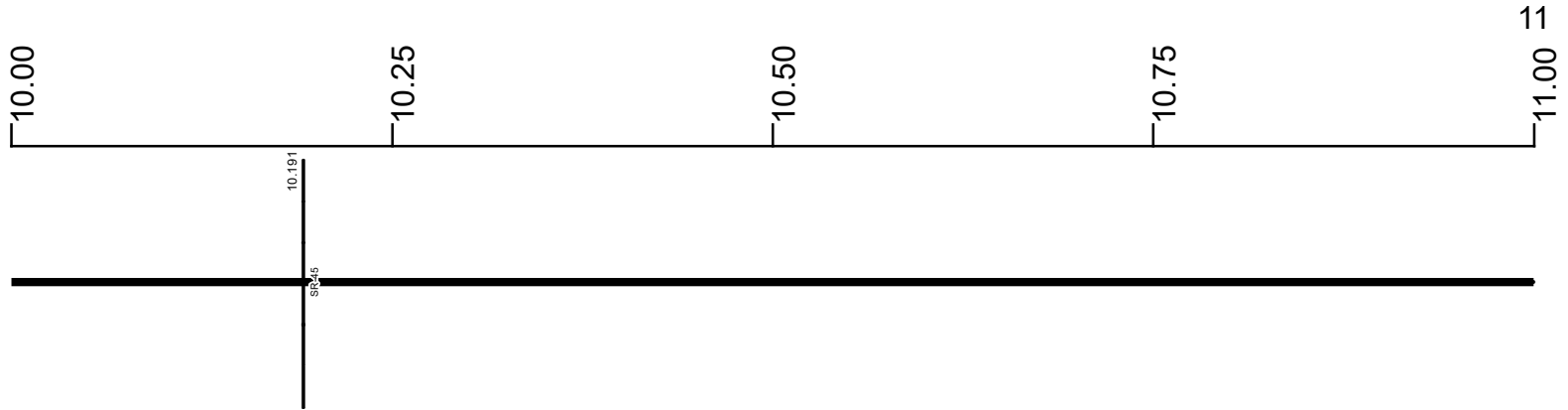

**Surface Type & Width (Left / Right)**

G (16'2") 5.471 - 10.191	G 20' 10.191 - 10.471	G (16'2") 10.471 - 11.081
-----------------------------	--------------------------	------------------------------

**Base Type (Left / Right)**

K / I 5.471 - 10.191	L 10.191 - 10.471	K / I 10.471 - 11.081
-------------------------	----------------------	--------------------------

**Shoulder Type & Width (Left / Right)**

2 (2'2") 5.471 - 10.191	2 (4'4") 10.191 - 10.471	2 (2'2") 10.471 - 11.081
----------------------------	-----------------------------	-----------------------------

**Resurface Year**

2023
------

**Through Lanes**

5.461 - 16.606 2 0 - 25.903
-----------------------------------

**Street Name**

W SOUTH RANGE RD 3 - 20.585
--------------------------------

- Non-divided Highway
- Divided Highway
- Secondary Segment
- Corporation
- Bridge (on route)
- Underpass
- Overpass
- Railroad (at grade)
- Railroad (underpass)
- Railroad (overpass)
- Intersection

Created on: 7/2/2025

transportation.ohio.gov  
Prepared by  
The Ohio Department of Transportation  
Office of Technical Services  
Roadway Information

# SMAHSR00165\*\*C

State True Log  
County True Log

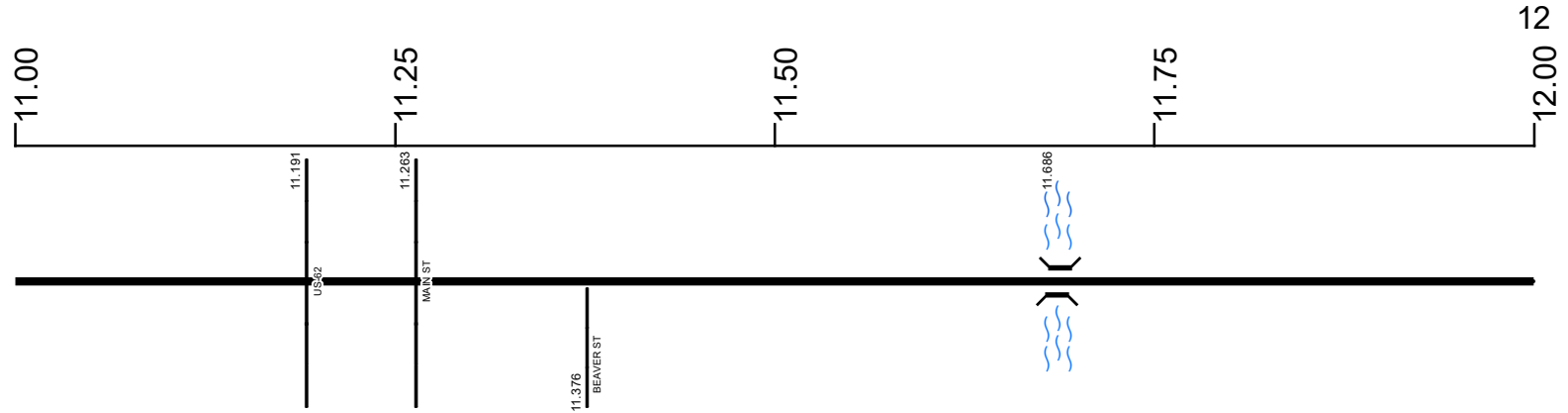

**Surface Type & Width (Left / Right)**

G (16'2')	G 20'	G (16'2')
10.471 - 11.081	11.081 - 11.263	11.263 - 16.606

**Base Type (Left / Right)**

K / I	P	K / I
10.471 - 11.081	11.081 - 11.263	11.263 - 16.606

**Shoulder Type & Width (Left / Right)**

2 (2'2')	2 (5'5')	2 (2'2')
10.471 - 11.081	11.081 - 11.263	11.263 - 17.136

**Resurface Year**

	2023	
	5.461 - 16.606	

**Through Lanes**

	2	
	0 - 25.903	

**Street Name**

	W SOUTH RANGE RD	
	3 - 20.585	

- Non-divided Highway
- Divided Highway
- Secondary Segment
- Corporation
- Bridge (on route)
- Underpass
- Overpass
- Railroad (at grade)
- Railroad (underpass)
- Railroad (overpass)
- Intersection

Created on: 7/2/2025

transportation.ohio.gov

Prepared by  
The Ohio Department of Transportation  
Office of Technical Services  
Roadway Information

# SMAHSR00165\*\*C

State True  
Log

13

County True  
Log

12.00

12.25

12.50

12.75

13.00



Surface Type & Width (Left / Right)

G (16'/2')  
11.263 - 16.606

Base Type (Left / Right)

K / I  
11.263 - 16.606

Shoulder Type & Width (Left / Right)

2 (2'/2')  
11.263 - 17.136

Resurface Year

2023

Through Lanes

2  
0 - 25.903

Street Name

W SOUTH RANGE RD  
3 - 20.585

- |                     |                   |                      |              |
|---------------------|-------------------|----------------------|--------------|
| Non-divided Highway | Bridge (on route) | Railroad (at grade)  | Intersection |
| Divided Highway     | Underpass         | Railroad (underpass) |              |
| Secondary Segment   | Overpass          | Railroad (overpass)  |              |
| Corporation         |                   |                      |              |

Created on: 7/2/2025

# SMAHSR00165\*\*C

State True Log  
County True Log

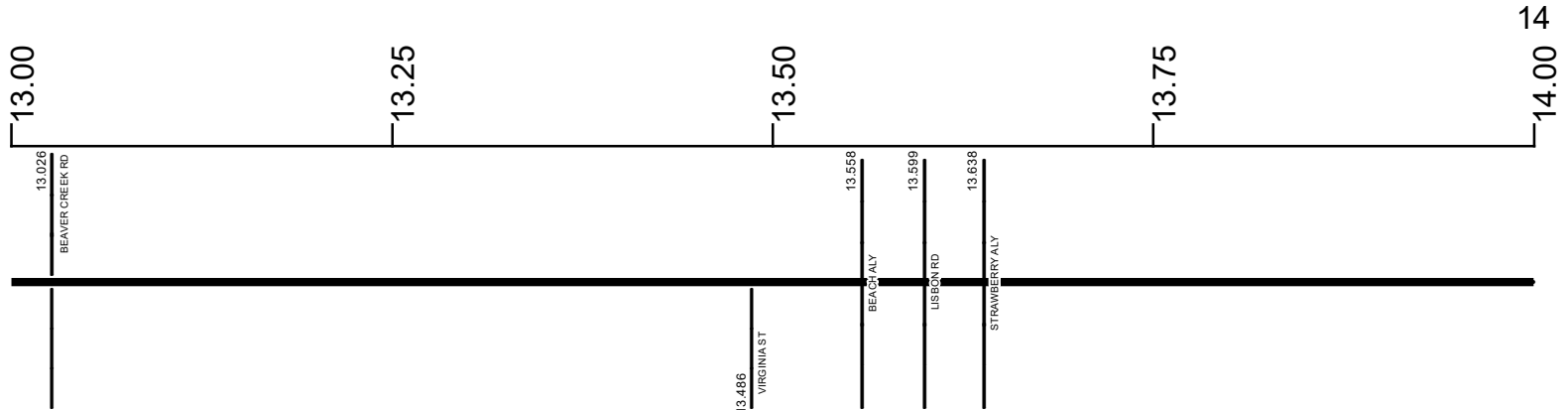

Surface Type & Width (Left / Right)	G (16'/2') 11.263 - 16.606
Base Type (Left / Right)	K / I 11.263 - 16.606
Shoulder Type & Width (Left / Right)	2 (2'/2') 11.263 - 17.136
Resurface Year	2023 5.461 - 16.606
Through Lanes	2 0 - 25.903
Street Name	W SOUTH RANGE RD 3 - 20.585

- |                     |                   |                      |              |
|---------------------|-------------------|----------------------|--------------|
| Non-divided Highway | Bridge (on route) | Railroad (at grade)  | Intersection |
| Divided Highway     | Underpass         | Railroad (underpass) |              |
| Secondary Segment   | Overpass          | Railroad (overpass)  |              |
| Corporation         |                   |                      |              |

Created on: 7/2/2025

transportation.ohio.gov

Prepared by  
The Ohio Department of Transportation  
Office of Technical Services  
Roadway Information

# SMAHSR00165\*\*C

State True Log  
County True Log

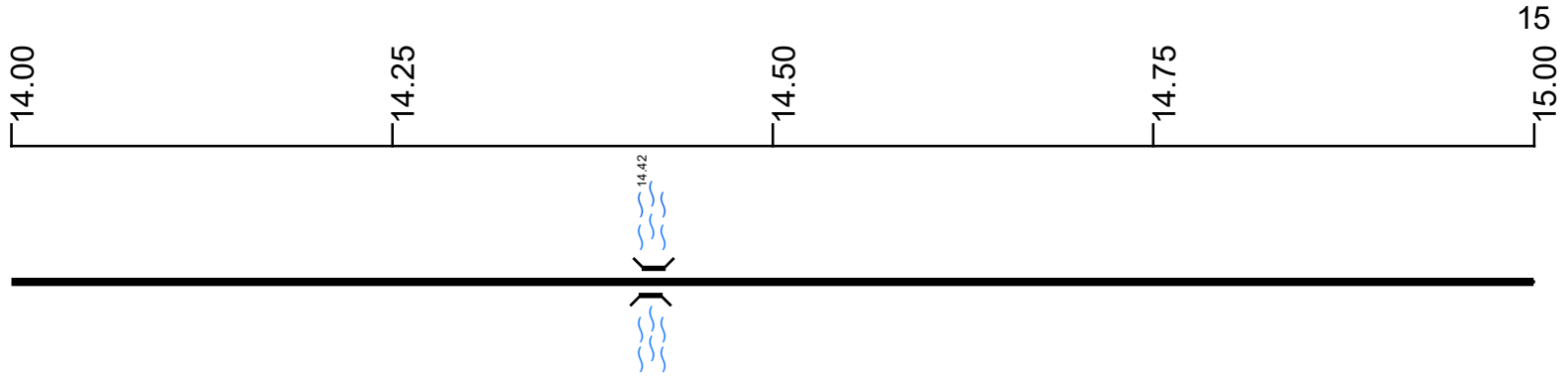

Surface Type & Width (Left / Right)

G (16'/2')  
11.263 - 16.606

Base Type (Left / Right)

K / I  
11.263 - 16.606

Shoulder Type & Width (Left / Right)

2 (2'/2')  
11.263 - 17.136

Resurface Year

2023

Through Lanes

2  
0 - 25.903

Street Name

W SOUTH RANGE RD  
3 - 20.585

- |                     |                   |                      |              |
|---------------------|-------------------|----------------------|--------------|
| Non-divided Highway | Bridge (on route) | Railroad (at grade)  | Intersection |
| Divided Highway     | Underpass         | Railroad (underpass) |              |
| Secondary Segment   | Overpass          | Railroad (overpass)  |              |
| Corporation         |                   |                      |              |

Created on: 7/2/2025



transportation.ohio.gov  
Prepared by  
The Ohio Department of Transportation  
Office of Technical Services  
Roadway Information

# SMAHSR00165\*\*C

State True Log

County True Log

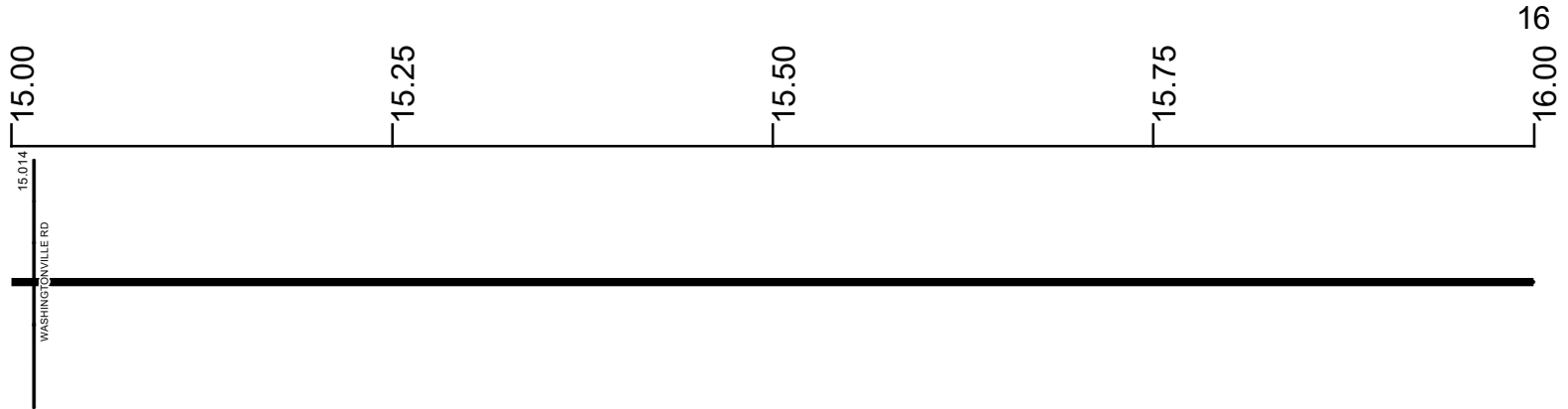

Surface Type & Width (Left / Right)

G (16'2')  
11.263 - 16.606

Base Type (Left / Right)

K / I  
11.263 - 16.606

Shoulder Type & Width (Left / Right)

2 (2'2')  
11.263 - 17.136

Resurface Year

2023

Through Lanes

2  
0 - 25.903

Street Name

W SOUTH RANGE RD  
3 - 20.585

- |                     |                   |                      |              |
|---------------------|-------------------|----------------------|--------------|
| Non-divided Highway | Bridge (on route) | Railroad (at grade)  | Intersection |
| Divided Highway     | Underpass         | Railroad (underpass) |              |
| Secondary Segment   | Overpass          | Railroad (overpass)  |              |
| Corporation         |                   |                      |              |

Created on: 7/2/2025



transportation.ohio.gov  
 Prepared by  
 The Ohio Department of Transportation  
 Office of Technical Services  
 Roadway Information

# SMAHSR00165\*\*C

State True Log  
County True Log

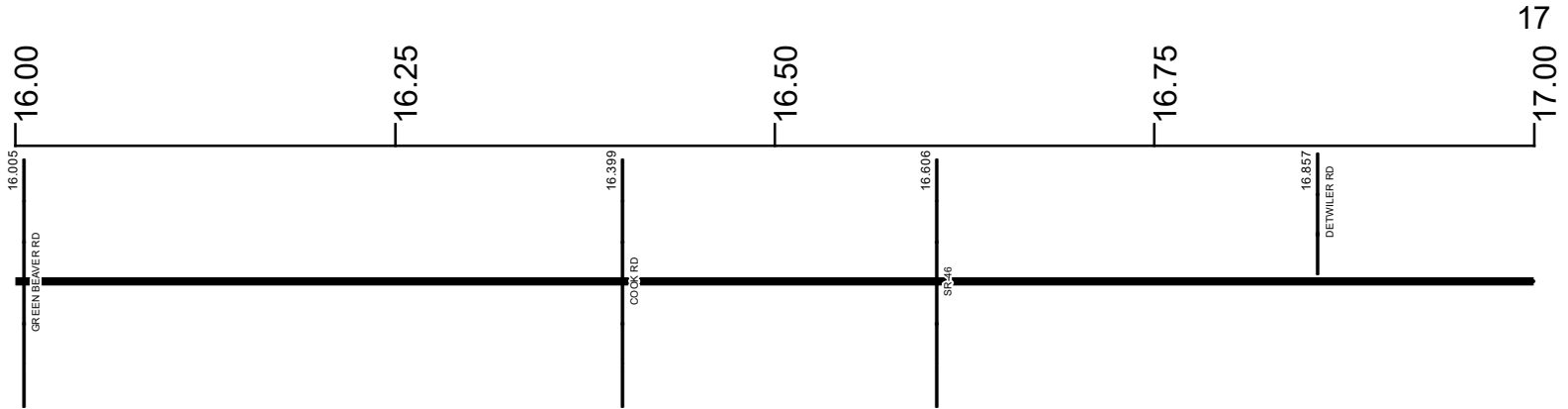

**Surface Type & Width (Left / Right)**

G (16'/2')	G (14'/4')
11.263 - 16.606	16.606 - 17.136

**Base Type (Left / Right)**

K / I	T / K
11.263 - 16.606	16.606 - 17.136

**Shoulder Type & Width (Left / Right)**

2 (2'/2')
11.263 - 17.136

**Resurface Year**

2023
5.461 - 16.606

**Through Lanes**

2
0 - 25.903

**Street Name**

W SOUTH RANGE RD
3 - 20.585

- Non-divided Highway
- Divided Highway
- Secondary Segment
- Corporation
- Bridge (on route)
- Underpass
- Overpass
- Railroad (at grade)
- Railroad (underpass)
- Railroad (overpass)
- Intersection

Created on: 7/2/2025

transportation.ohio.gov

Prepared by  
The Ohio Department of Transportation  
Office of Technical Services  
Roadway Information

# SMAHSR00165\*\*C

State True  
Log

18

County True  
Log

17.00

17.25

17.50

17.75

18.00



**Surface Type & Width (Left / Right)**

G (14'/4') 16.606 - 17.136	G 24' 17.136 - 17.415	G (14'/4') 17.415 - 20.585
-------------------------------	--------------------------	-------------------------------

**Base Type (Left / Right)**

T / K 16.606 - 17.136	I 17.136 - 17.415	T / K 17.415 - 20.585
--------------------------	----------------------	--------------------------

**Shoulder Type & Width (Left / Right)**

2 (2'/2') 11.263 - 17.136	2 (8'/8') 17.136 - 17.415	2 (2'/2') 17.415 - 20.585
------------------------------	------------------------------	------------------------------

**Through Lanes**

2 0 - 25.903
-----------------

**Street Name**

W SOUTH RANGE RD 3 - 20.585
--------------------------------

- Non-divided Highway
- Divided Highway
- Secondary Segment
- Corporation
- Bridge (on route)
- Underpass
- Overpass
- Railroad (at grade)
- Railroad (underpass)
- Railroad (overpass)
- Intersection

Created on: 7/2/2025

transportation.ohio.gov

Prepared by  
The Ohio Department of Transportation  
Office of Technical Services  
Roadway Information

# SMAHSR00165\*\*C

State True Log  
County True Log

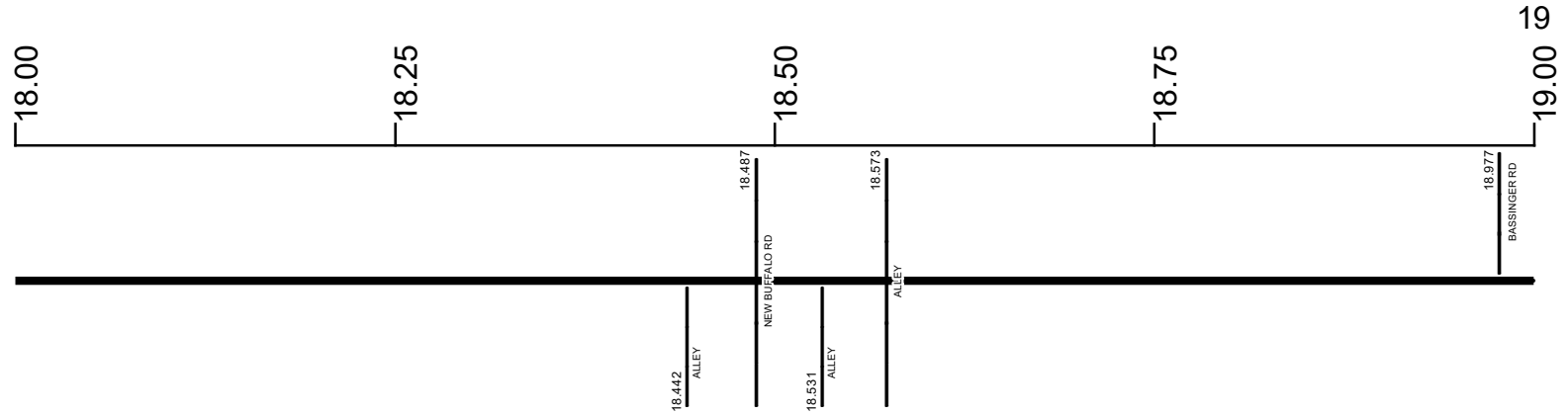

Surface Type & Width (Left / Right)

G (14'4')  
17.415 - 20.585

Base Type (Left / Right)

T / K  
17.415 - 20.585

Shoulder Type & Width (Left / Right)

2 (2'2')  
17.415 - 20.585

Through Lanes

2  
0 - 25.903

Street Name

W SOUTH RANGE RD  
3 - 20.585

- |                     |                   |                      |              |
|---------------------|-------------------|----------------------|--------------|
| Non-divided Highway | Bridge (on route) | Railroad (at grade)  | Intersection |
| Divided Highway     | Underpass         | Railroad (underpass) |              |
| Secondary Segment   | Overpass          | Railroad (overpass)  |              |
| Corporation         |                   |                      |              |

Created on: 7/2/2025



transportation.ohio.gov  
Prepared by  
The Ohio Department of Transportation  
Office of Technical Services  
Roadway Information

# SMAHSR00165\*\*C

State True Log  
County True Log

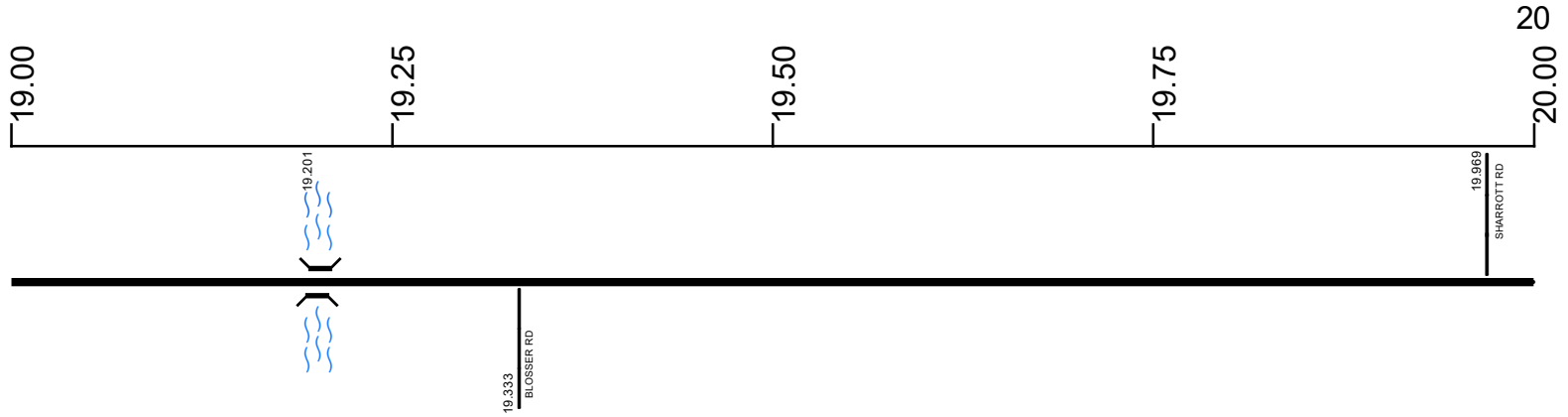

Surface Type & Width (Left / Right)	G (14'4') 17.415 - 20.585
Base Type (Left / Right)	T / K 17.415 - 20.585
Shoulder Type & Width (Left / Right)	2 (2'2') 17.415 - 20.585
Through Lanes	2 0 - 25.903
Street Name	W SOUTH RANGE RD 3 - 20.585

<ul style="list-style-type: none"> <li> Non-divided Highway</li> <li> Divided Highway</li> <li> Secondary Segment</li> <li> Corporation</li> </ul>	<ul style="list-style-type: none"> <li> Bridge (on route)</li> <li> Underpass</li> <li> Overpass</li> </ul>	<ul style="list-style-type: none"> <li> Railroad (at grade)</li> <li> Railroad (underpass)</li> <li> Railroad (overpass)</li> </ul>	<ul style="list-style-type: none"> <li> Intersection</li> </ul>
--	---	---	---

Created on: 7/2/2025

transportation.ohio.gov

Prepared by  
The Ohio Department of Transportation  
Office of Technical Services  
Roadway Information

# SMAHSR00165\*\*C

State True Log  
County True Log

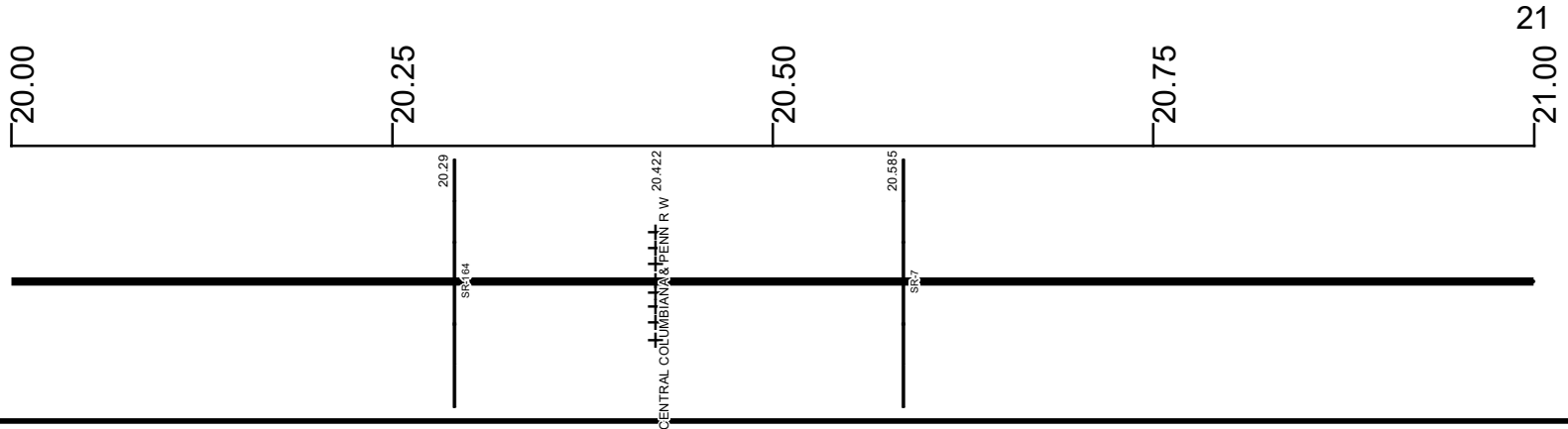

Surface Type & Width (Left / Right)	
G (14'4") 17.415 - 20.585	G (15'5") 20.585 - 21.758
Base Type (Left / Right)	
T / K 17.415 - 20.585	T / L 20.585 - 23.586
Shoulder Type & Width (Left / Right)	
2 (2'2") 17.415 - 20.585	2 (3'3") 20.585 - 21.758
Through Lanes	
2 0 - 25.903	
Street Name	
W SOUTH RANGE RD 3 - 20.585	E SOUTH RANGE RD 20.585 - 21.758

<ul style="list-style-type: none"> <li> Non-divided Highway</li> <li> Divided Highway</li> <li> Secondary Segment</li> <li> Corporation</li> </ul>	<ul style="list-style-type: none"> <li> Bridge (on route)</li> <li> Underpass</li> <li> Overpass</li> </ul>	<ul style="list-style-type: none"> <li> Railroad (at grade)</li> <li> Railroad (underpass)</li> <li> Railroad (overpass)</li> </ul>	<ul style="list-style-type: none"> <li> Intersection</li> </ul>
--	---	---	---

Created on: 7/2/2025

transportation.ohio.gov

Prepared by  
The Ohio Department of Transportation  
Office of Technical Services  
Roadway Information

# SMAHSR00165\*\*C

State True Log  
County True Log

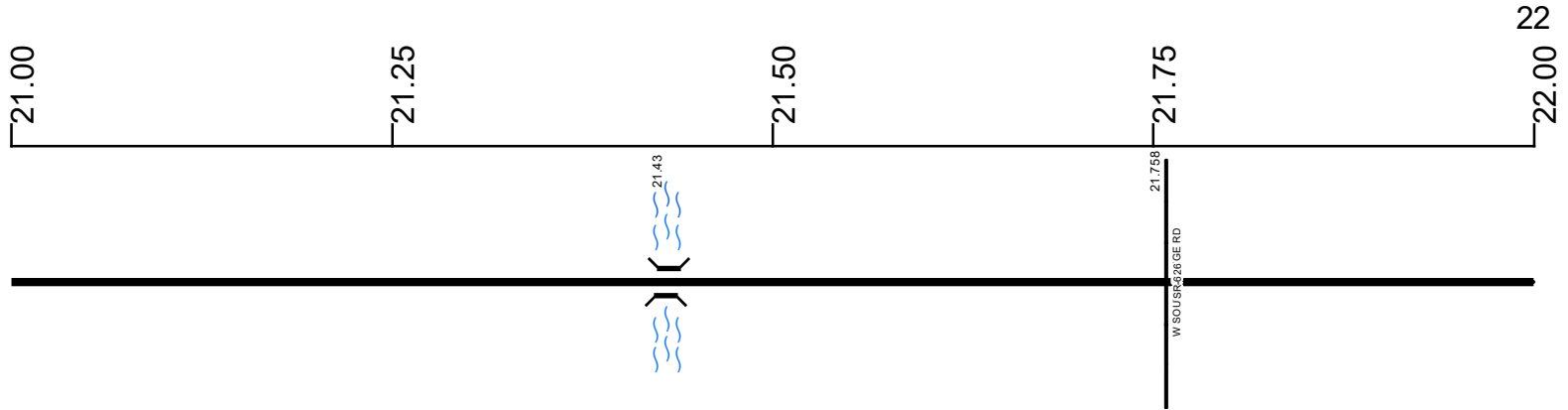

**Surface Type & Width (Left / Right)**

G (15'5") 20.585 - 21.758	G (15'7") 21.758 - 23.586
------------------------------	------------------------------

**Base Type (Left / Right)**

T / L 20.585 - 23.586	
--------------------------	--

**Shoulder Type & Width (Left / Right)**

2 (3'3") 20.585 - 21.758	2 (1'1") 21.758 - 23.586
-----------------------------	-----------------------------

**Resurface Year**

2024 21.758 - 25.903
-------------------------

**Through Lanes**

2 0 - 25.903
-----------------

**Street Name**

E SOUTH RANGE RD 20.585 - 21.758	WOODWORTH RD 21.758 - 25.903
-------------------------------------	---------------------------------

- Non-divided Highway
- Divided Highway
- Secondary Segment
- Corporation
- Bridge (on route)
- Underpass
- Overpass
- Railroad (at grade)
- Railroad (underpass)
- Railroad (overpass)
- Intersection

Created on: 7/2/2025

transportation.ohio.gov

Prepared by  
The Ohio Department of Transportation  
Office of Technical Services  
Roadway Information

# SMAHSR00165\*\*C

State True Log

County True Log

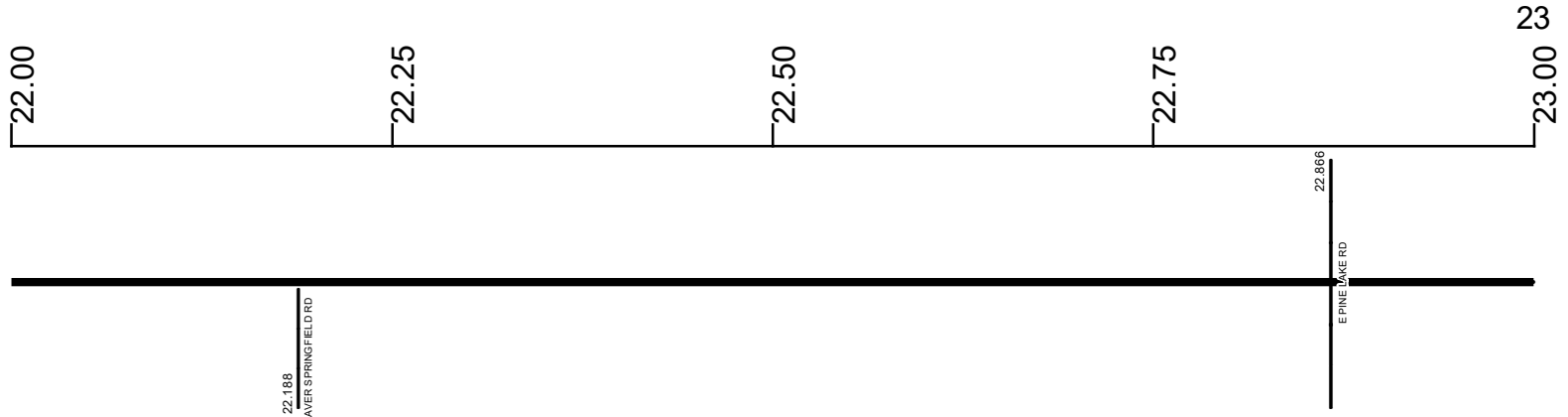

Surface Type & Width (Left / Right)

G (15/7')  
21.758 - 23.586

Base Type (Left / Right)

T / L  
20.585 - 23.586

Shoulder Type & Width (Left / Right)

2 (1/1')  
21.758 - 23.586

Resurface Year

2024

Through Lanes

2  
0 - 25.903

Street Name

WOODWORTH RD  
21.758 - 25.903

- |                     |                   |                      |              |
|---------------------|-------------------|----------------------|--------------|
| Non-divided Highway | Bridge (on route) | Railroad (at grade)  | Intersection |
| Divided Highway     | Underpass         | Railroad (underpass) |              |
| Secondary Segment   | Overpass          | Railroad (overpass)  |              |
| Corporation         |                   |                      |              |

Created on: 7/2/2025



transportation.ohio.gov  
 Prepared by  
 The Ohio Department of Transportation  
 Office of Technical Services  
 Roadway Information

# SMAHSR00165\*\*C

State True Log  
County True Log

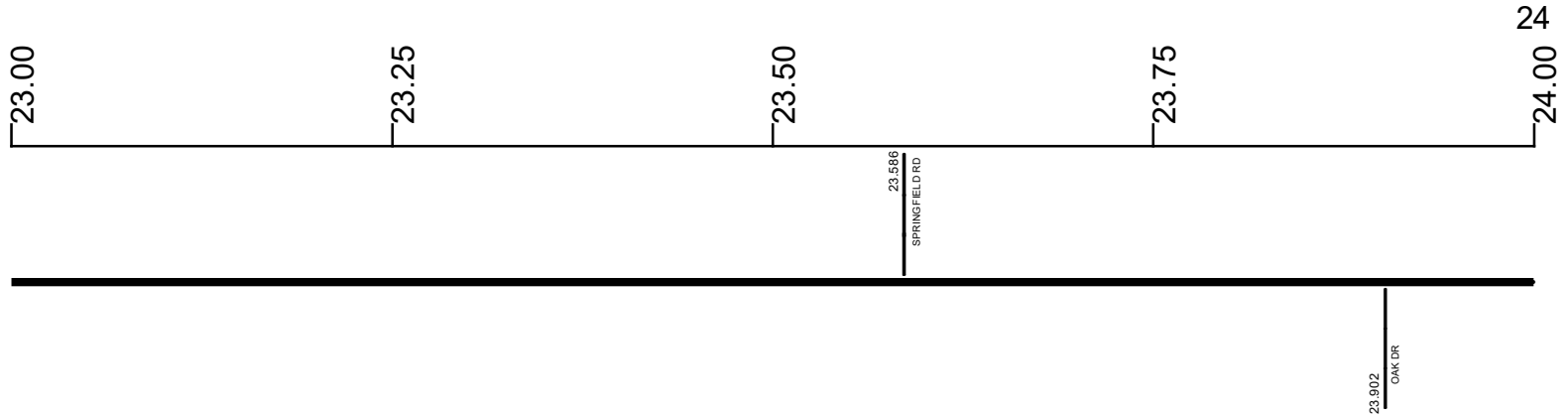

<b>Surface Type &amp; Width (Left / Right)</b>	
G (15'7") 21.758 - 23.586	G 24' 23.586 - 24.57
<b>Base Type (Left / Right)</b>	
T / L 20.585 - 23.586	P 23.586 - 24.217
<b>Shoulder Type &amp; Width (Left / Right)</b>	
2 (1'1") 21.758 - 23.586	2 (2'2") 23.586 - 25.903
<b>Resurface Year</b>	2024
<b>Through Lanes</b>	2 21.758 - 25.903
<b>Street Name</b>	WOODWORTH RD 21.758 - 25.903

- Non-divided Highway
- Divided Highway
- Secondary Segment
- Corporation
- Bridge (on route)
- Underpass
- Overpass
- Railroad (at grade)
- Railroad (underpass)
- Railroad (overpass)
- Intersection

Created on: 7/2/2025

transportation.ohio.gov

Prepared by  
The Ohio Department of Transportation  
Office of Technical Services  
Roadway Information

# SMAHSR00165\*\*C

State True Log  
County True Log

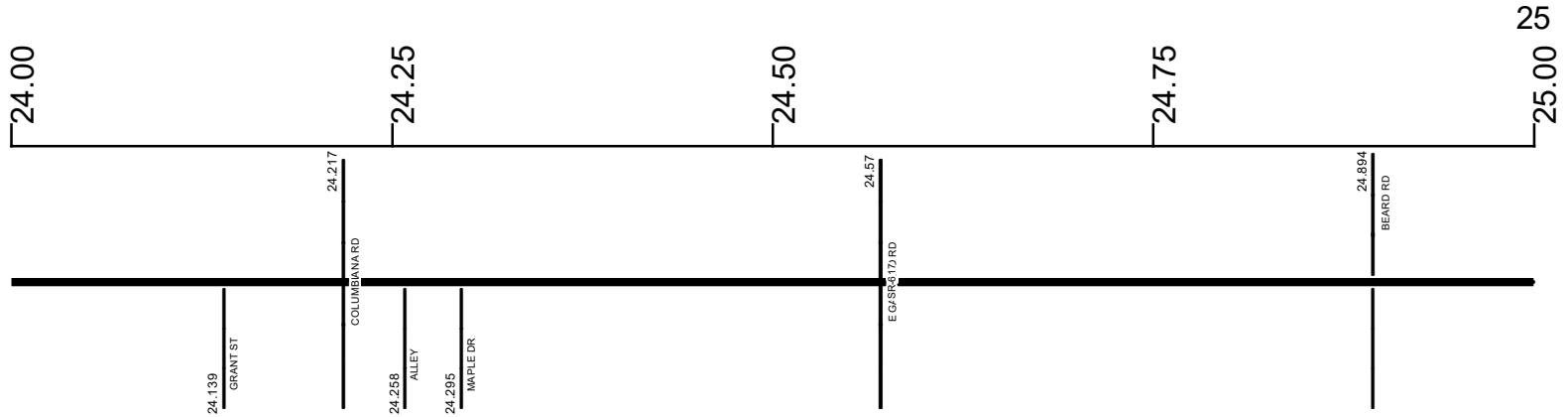

Surface Type & Width (Left / Right)	
G 24' 23.586 - 24.57	G (17'1/5') 24.57 - 25.903
Base Type (Left / Right)	
P 23.586 - 24.217	K 24.217 - 24.57
Shoulder Type & Width (Left / Right)	
2 (2'1/2) 23.586 - 25.903	
Resurface Year	
2024 21.758 - 25.903	
Through Lanes	
2 0 - 25.903	
Street Name	
WOODWORTH RD 21.758 - 25.903	

- Non-divided Highway
- Divided Highway
- Secondary Segment
- Corporation
- Bridge (on route)
- Underpass
- Overpass
- Railroad (at grade)
- Railroad (underpass)
- Railroad (overpass)
- Intersection

Created on: 7/2/2025

transportation.ohio.gov

Prepared by  
The Ohio Department of Transportation  
Office of Technical Services  
Roadway Information

# SMAHSR00165\*\*C

State True Log

25.903

County True Log



Surface Type & Width (Left / Right)

G (17'5")  
24.57 - 25.903

Base Type (Left / Right)

K / I  
24.57 - 25.903

Shoulder Type & Width (Left / Right)

2 (2'2")  
23.586 - 25.903

Resurface Year

2024

Through Lanes

2  
0 - 25.903

Street Name

WOODWORTH RD  
21.758 - 25.903

- |                     |                   |                      |              |
|---------------------|-------------------|----------------------|--------------|
| Non-divided Highway | Bridge (on route) | Railroad (at grade)  | Intersection |
| Divided Highway     | Underpass         | Railroad (underpass) |              |
| Secondary Segment   | Overpass          | Railroad (overpass)  |              |
| <b>Corporation</b>  |                   |                      |              |

Created on: 7/2/2025



transportation.ohio.gov

Prepared by  
The Ohio Department of Transportation  
Office of Technical Services  
Roadway Information

## Historical Project List for SMAHSR00165\*\*C

Begin Measure	End Measure	Project ID Number	Construction Completion Date	Treatment Category	Treatment Type
0.000	1.648	88890	6-2017	Minor Rehabilitation	60-AC Overlay w/Rpr
0.000	1.738	22465	8-2004	Minor Rehabilitation	60-AC Overlay w/Rpr
1.648	5.471	100239	8-2017	Preventive Maintenance	25-Chip Seal
1.738	5.471	76323	10-2010	Minor Rehabilitation	60-AC Overlay w/Rpr
5.471	16.606	110680	12-2023	Minor Rehabilitation	60-AC Overlay w/Rpr
5.471	16.606	101043	11-2018	Preventive Maintenance	30-Microsurfacing
5.471	16.606	84600	9-2013	Minor Rehabilitation	60-AC Overlay w/Rpr
5.471	16.606	21295	8-2002	Minor Rehabilitation	60-AC Overlay w/Rpr
16.606	21.758	102419	7-2018	Minor Rehabilitation	38-Fine Poly AC Overlay
16.606	21.758	87449	9-2010	Minor Rehabilitation	60-AC Overlay w/Rpr
21.758	24.570	82909	9-2012	Minor Rehabilitation	60-AC Overlay w/Rpr
24.570	25.903	76321	7-2009	Minor Rehabilitation	60-AC Overlay w/Rpr

# Roadway Codes

## Access Control Journalized

- F - Full Access Control
- L - Limited Access Control
- N - No Access Control

## Access Control Operational

- 1 - Full Access Control
- 2 - Partial Access Control
- 3 - No Access Control

## Base Type

- F - Crack and Seat
- H - Rubblize and Roll
- I - Aggregate Base 304 or Traffic Compacted
- K - Water Bound Macadam
- L - Bituminous Concrete Mix or Penetration Macadam
- N - Plain Concrete
- P - Reinforced Concrete
- R - Brick (Flexible)
- T - Brick (Rigid)

## Direction of Travel

- B - Both (Two-way)
- F - One-way Cardinal
- T - One-way Non-cardinal

## Facility Type

- 1 - One-way Roadway
- 2 - Two-way Roadway
- 4 - Ramp
- 5 - Non-mainline
- 6 - Non-inventory Direction
- 7 - Planned / Unbuilt

## Historical Federal Aid Indicator

- N - Not a FAP Route
- Y - FAP Route

## Functional Classification

- 01 - Interstate
- 02 - Principal Arterial (Freeways)
- 03 - Principal Arterial (Other)
- 04 - Minor Arterial
- 05 - Major Collector
- 06 - Minor Collector
- 07 - Local

## Leave / Reenter Indicator

- Y - Route leaves/reenters at this point
- N - Route does not leave/reenter at this point

## Median Type

- 1 - None
- 2 - Unprotected
- 3 - Curbed
- 4 - Positive Barrier (Unspecified)
- 5 - Positive Barrier (Flexible)
- 6 - Positive Barrier (Semi-rigid)
- 7 - Positive Barrier (Rigid)

## NHS

- N - National Highway System
- H - Congressional Corridor
- 2 - Major Airport
- 3 - Major Port Facility
- 4 - Major Amtrak Station
- 5 - Major Rail / Truck Terminal
- 6 - Major Intercity Bus Terminal
- 7 - Major Public Transit / Multi-modal Passenger Terminal
- 8 - Major Pipeline Terminal
- 9 - Major Ferry Terminal

## Priority System

- G - General
- P - Priority System
- U - Urban

## Scenic Byway Code

- A - All American Road
- N - National Scenic Byway
- S - State Scenic Byway

## Shoulder Type

- 1 - None
- 2 - Surfaced shoulder exists (bituminous concrete {AC})
- 3 - Surfaced shoulder exists (Portland Cement Concrete {PCC})
- 4 - Stabilized shoulder exists (gravel or other granular material)
- 5 - Combination shoulder exists (two or more surface types)
- 6 - Earth shoulder exists
- 7 - Barrier curb exists; no shoulder in front of curb

## Surface Type

- A - Combination
- B - Brick
- C - Continuous Reinforced Concrete
- D - Reinforced Concrete
- E - Plain Concrete
- G - Bituminous Concrete
- I - Chipseal on Granular
- K - Open Graded Bituminous
- L - Chipseal or Micro
- M - Gravel
- U - Unimproved
- X - Right of Way Only