

# SMAHSR00534\*\*C

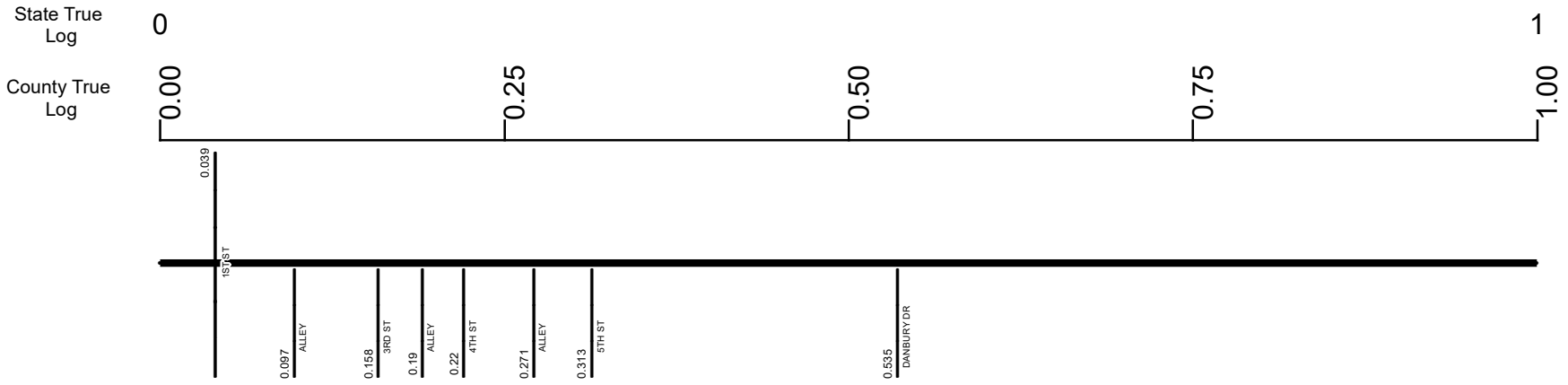

Surface Type & Width (Left / Right)	G 18' 0 - 1.097
Base Type (Left / Right)	K 0 - 1.635
Shoulder Type & Width (Left / Right)	5 (4/4') 0 - 1.097
Through Lanes	2 0 - 16.258
Street Name	S PRICETOWN RD 0 - 13.732

- |  |   |   |   |
|--|---|---|---|
| <ul style="list-style-type: none"> <li> Non-divided Highway</li> <li> Divided Highway</li> <li> Secondary Segment</li> <li> Corporation</li> </ul> | <ul style="list-style-type: none"> <li> Bridge (on route)</li> <li> Underpass</li> <li> Overpass</li> </ul> | <ul style="list-style-type: none"> <li> Railroad (at grade)</li> <li> Railroad (underpass)</li> <li> Railroad (overpass)</li> </ul> | <ul style="list-style-type: none"> <li> Intersection</li> </ul> |
|--|---|---|---|

Created on: 7/2/2025

transportation.ohio.gov

Prepared by  
The Ohio Department of Transportation  
Office of Technical Services  
Roadway Information

# SMAHSR00534\*\*C

State True Log

County True Log

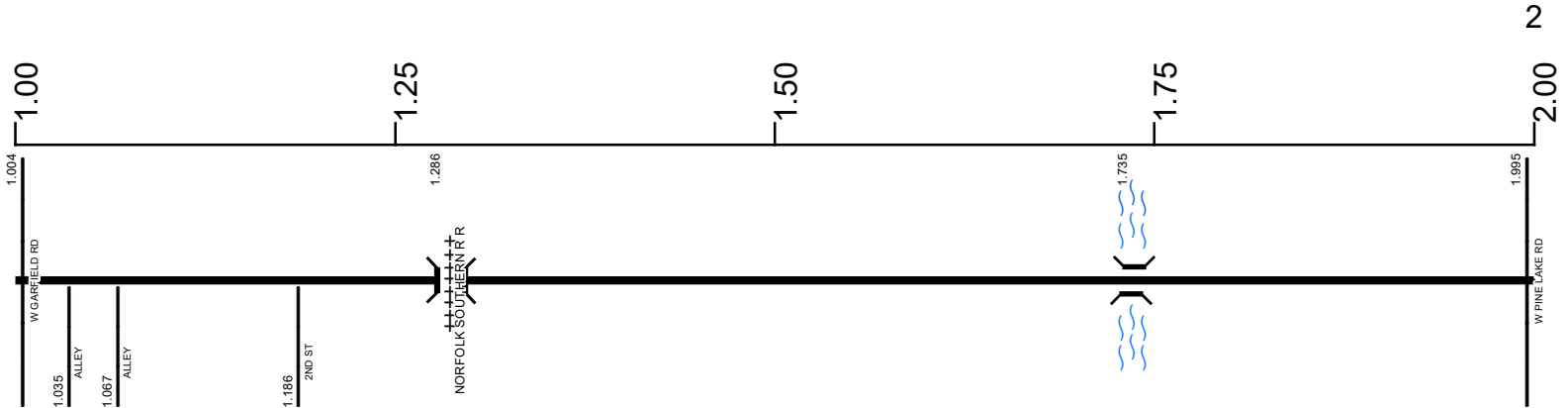

**Surface Type & Width (Left / Right)**

G 18'	G 36'	G (9'/10')	G 24'
0 - 1.097	1.097 - 1.406	1.406 - 1.635	1.635 - 2.124

**Base Type (Left / Right)**

K	L
0 - 1.635	1.635 - 2.124

**Shoulder Type & Width (Left / Right)**

5 (4/4')	1 (0/0')	5 (3/3')	5 (6/6')	2 (4/4')
0 - 1.097	1.097 - 1.406	1.406 - 1.635	1.635 - 1.785	1.785 - 2.124

**Through Lanes**

	2
0 - 16.258	

**Street Name**

	S PRICETOWN RD
0 - 13.732	

- Non-divided Highway
- Divided Highway
- Secondary Segment
- Corporation
- Bridge (on route)
- Underpass
- Overpass
- Railroad (at grade)
- Railroad (underpass)
- Railroad (overpass)
- Intersection

Created on: 7/2/2025

transportation.ohio.gov

Prepared by  
The Ohio Department of Transportation  
Office of Technical Services  
Roadway Information

# SMAHSR00534\*\*C

State True  
Log

3

County True  
Log



**Surface Type & Width (Left / Right)**

G 24'	G (9'/10')
1.635 - 2.124	2.124 - 3.4

**Base Type (Left / Right)**

L	K
1.635 - 2.124	2.124 - 13.732

**Shoulder Type & Width (Left / Right)**

2 (4'/4')	5 (3'/3')
1.785 - 2.124	2.124 - 3.4

**Through Lanes**

	2
	0 - 16.258

**Street Name**

	S PRICETOWN RD
	0 - 13.732

- |                     |                   |                      |              |
|---------------------|-------------------|----------------------|--------------|
| Non-divided Highway | Bridge (on route) | Railroad (at grade)  | Intersection |
| Divided Highway     | Underpass         | Railroad (underpass) |              |
| Secondary Segment   | Overpass          | Railroad (overpass)  |              |
| <b>Corporation</b>  |                   |                      |              |

Created on: 7/2/2025

transportation.ohio.gov

Prepared by  
The Ohio Department of Transportation  
Office of Technical Services  
Roadway Information

# SMAHSR00534\*\*C

State True Log

4

County True Log

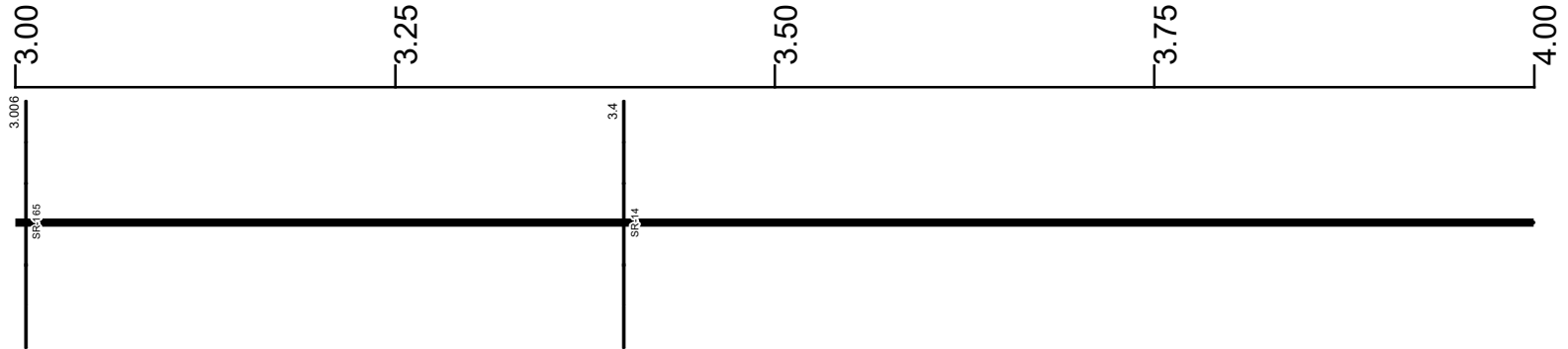

**Surface Type & Width (Left / Right)**

G (9'/10') 2.124 - 3.4	G 18' 3.4 - 4.475
---------------------------	----------------------

**Base Type (Left / Right)**

K 2.124 - 13.732	
---------------------	--

**Shoulder Type & Width (Left / Right)**

5 (3'/3') 2.124 - 3.4	5 (5'/5') 3.4 - 5.223
--------------------------	--------------------------

**Resurface Year**

2023 3.006 - 4.48	
----------------------	--

**Through Lanes**

2 0 - 16.258	
-----------------	--

**Street Name**

S PRICETOWN RD 0 - 13.732	
------------------------------	--

- Non-divided Highway
- Divided Highway
- Secondary Segment
- Corporation
- Bridge (on route)
- Underpass
- Overpass
- Railroad (at grade)
- Railroad (underpass)
- Railroad (overpass)
- Intersection

Created on: 7/2/2025

transportation.ohio.gov  
Prepared by  
The Ohio Department of Transportation  
Office of Technical Services  
Roadway Information

# SMAHSR00534\*\*C

State True Log

County True Log

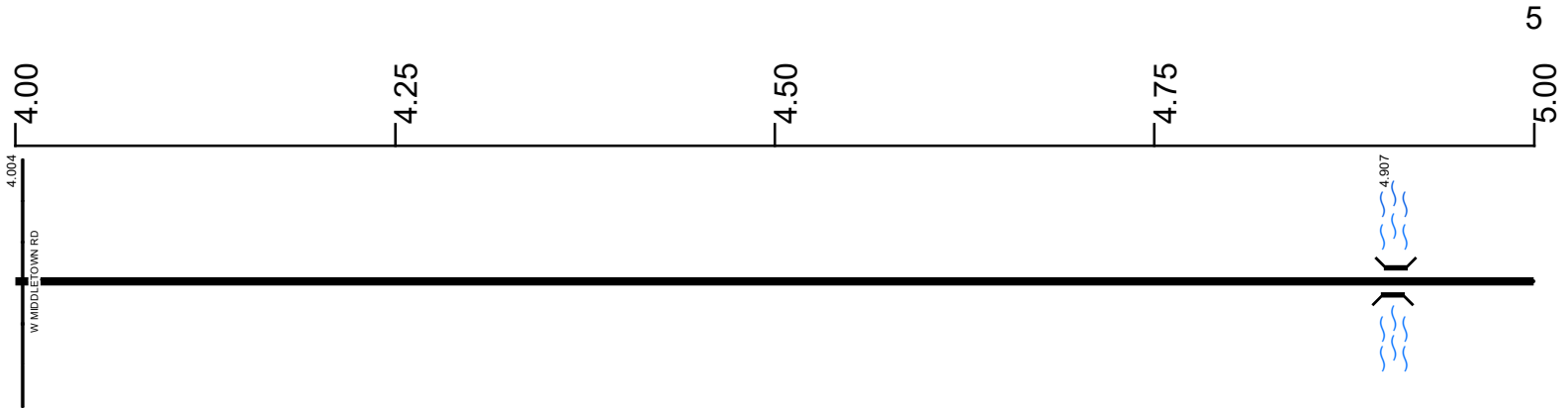

**Surface Type & Width (Left / Right)**

G 18' 3.4 - 4.475	G 20' 4.475 - 5.223
----------------------	------------------------

**Base Type (Left / Right)**

K 2.124 - 13.732
---------------------

**Shoulder Type & Width (Left / Right)**

5 (5/5) 3.4 - 5.223
------------------------

**Resurface Year**

2023 3.006 - 4.48
----------------------

**Through Lanes**

2 0 - 16.258
-----------------

**Street Name**

S PRICETOWN RD 0 - 13.732
------------------------------

- |  |   |   |   |
|--|---|---|---|
| <ul style="list-style-type: none"> <li> Non-divided Highway</li> <li> Divided Highway</li> <li> Secondary Segment</li> <li> Corporation</li> </ul> | <ul style="list-style-type: none"> <li> Bridge (on route)</li> <li> Underpass</li> <li> Overpass</li> </ul> | <ul style="list-style-type: none"> <li> Railroad (at grade)</li> <li> Railroad (underpass)</li> <li> Railroad (overpass)</li> </ul> | <ul style="list-style-type: none"> <li> Intersection</li> </ul> |
|--|---|---|---|

Created on: 7/2/2025

transportation.ohio.gov

Prepared by  
The Ohio Department of Transportation  
Office of Technical Services  
Roadway Information

# SMAHSR00534\*\*C

State True Log

6

County True Log

5.00

5.25

5.50

5.75

6.00

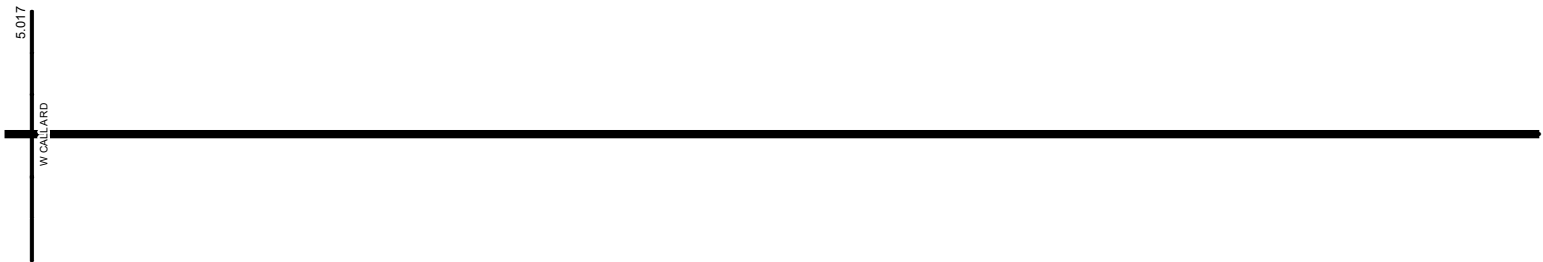

**Surface Type & Width (Left / Right)**

G 20' 4.475 - 5.223	G 18' 5.223 - 13.732
------------------------	-------------------------

**Base Type (Left / Right)**

K 2.124 - 13.732
---------------------

**Shoulder Type & Width (Left / Right)**

5 (5/5') 3.4 - 5.223	5 (4/4') 5.223 - 8.567
-------------------------	---------------------------

**Through Lanes**

2 0 - 16.258
-----------------

**Street Name**

S PRICETOWN RD 0 - 13.732
------------------------------

- Non-divided Highway
- Divided Highway
- Secondary Segment
- Corporation
- Bridge (on route)
- Underpass
- Overpass
- Railroad (at grade)
- Railroad (underpass)
- Railroad (overpass)
- Intersection

Created on: 7/2/2025

transportation.ohio.gov

Prepared by  
The Ohio Department of Transportation  
Office of Technical Services  
Roadway Information

# SMAHSR00534\*\*C

State True Log

7

County True Log

6.00

6.25

6.50

6.75

7.00

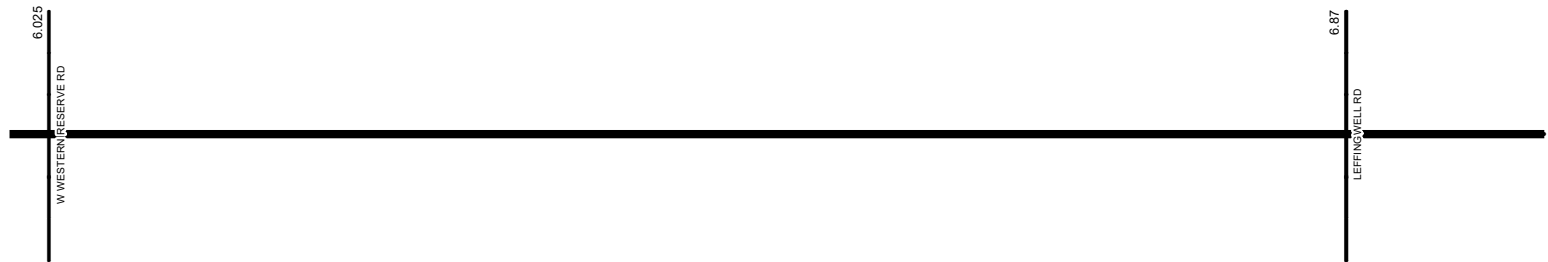

Surface Type & Width (Left / Right)

G 18'  
5.223 - 13.732

Base Type (Left / Right)

K  
2.124 - 13.732

Shoulder Type & Width (Left / Right)

5 (4/4')  
5.223 - 8.567

Through Lanes

2  
0 - 16.258

Street Name

S PRICETOWN RD  
0 - 13.732

Non-divided Highway	Bridge (on route)	Railroad (at grade)	Intersection
Divided Highway	Underpass	Railroad (underpass)	
Secondary Segment	Overpass	Railroad (overpass)	
Corporation			

Created on: 7/2/2025



transportation.ohio.gov  
Prepared by  
The Ohio Department of Transportation  
Office of Technical Services  
Roadway Information

# SMAHSR00534\*\*C

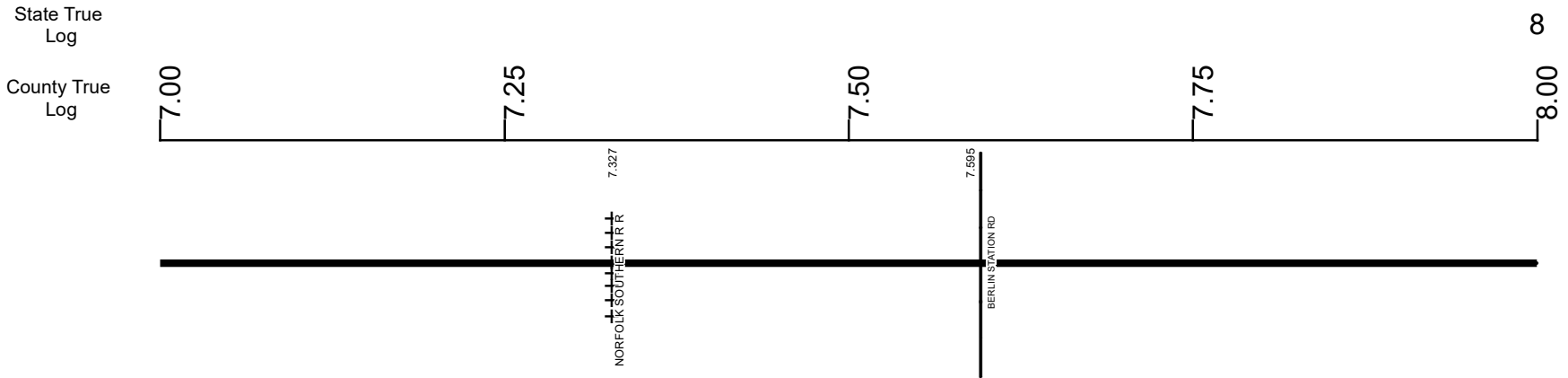

Surface Type & Width (Left / Right)	G 18'
	5.223 - 13.732
Base Type (Left / Right)	K
	2.124 - 13.732
Shoulder Type & Width (Left / Right)	5 (4 1/4')
	5.223 - 8.567
Through Lanes	2
	0 - 16.258
Street Name	S PRICETOWN RD
	0 - 13.732

- |  |   |   |   |
|--|---|---|---|
| <ul style="list-style-type: none"> <li> Non-divided Highway</li> <li> Divided Highway</li> <li> Secondary Segment</li> <li> Corporation</li> </ul> | <ul style="list-style-type: none"> <li> Bridge (on route)</li> <li> Underpass</li> <li> Overpass</li> </ul> | <ul style="list-style-type: none"> <li> Railroad (at grade)</li> <li> Railroad (underpass)</li> <li> Railroad (overpass)</li> </ul> | <ul style="list-style-type: none"> <li> Intersection</li> </ul> |
|--|---|---|---|

Created on: 7/2/2025

transportation.ohio.gov

Prepared by  
The Ohio Department of Transportation  
Office of Technical Services  
Roadway Information

# SMAHSR00534\*\*C

State True Log

County True Log

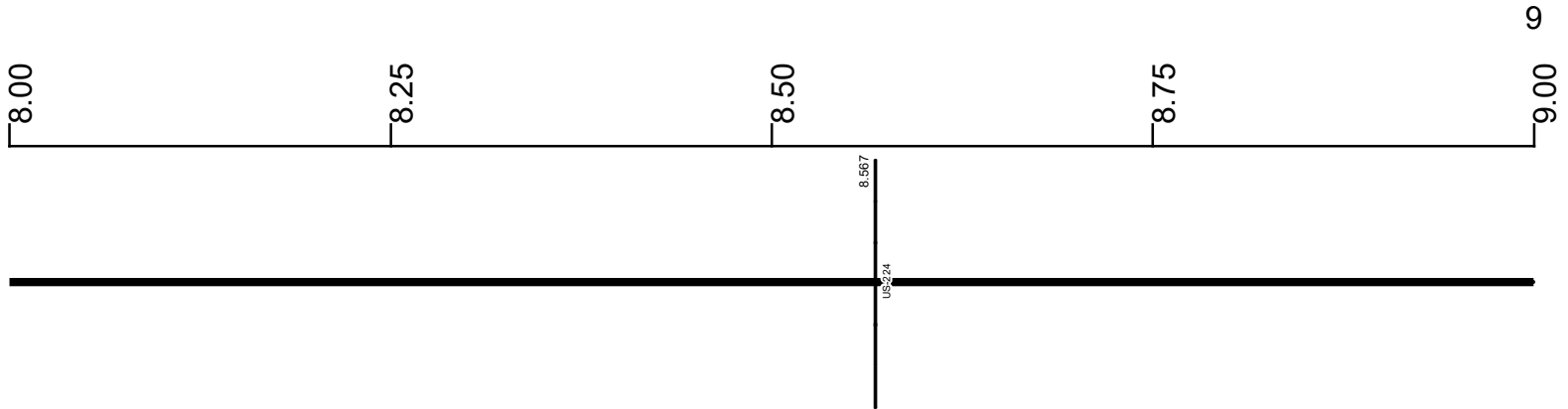

Surface Type & Width (Left / Right)

	G 18'
5.223 - 13.732	

Base Type (Left / Right)

	K
2.124 - 13.732	

Shoulder Type & Width (Left / Right)

5 (4'/4')	5 (5'/5')
5.223 - 8.567	8.567 - 13.732

Through Lanes

	2
0 - 16.258	

Street Name

	S PRICETOWN RD
0 - 13.732	

- |  |   |   |   |
|--|---|---|---|
| <ul style="list-style-type: none"> <li> Non-divided Highway</li> <li> Divided Highway</li> <li> Secondary Segment</li> <li> Corporation</li> </ul> | <ul style="list-style-type: none"> <li> Bridge (on route)</li> <li> Underpass</li> <li> Overpass</li> </ul> | <ul style="list-style-type: none"> <li> Railroad (at grade)</li> <li> Railroad (underpass)</li> <li> Railroad (overpass)</li> </ul> | <ul style="list-style-type: none"> <li> Intersection</li> </ul> |
|--|---|---|---|

Created on: 7/2/2025

transportation.ohio.gov

Prepared by  
The Ohio Department of Transportation  
Office of Technical Services  
Roadway Information

# SMAHSR00534\*\*C

State True Log

County True Log

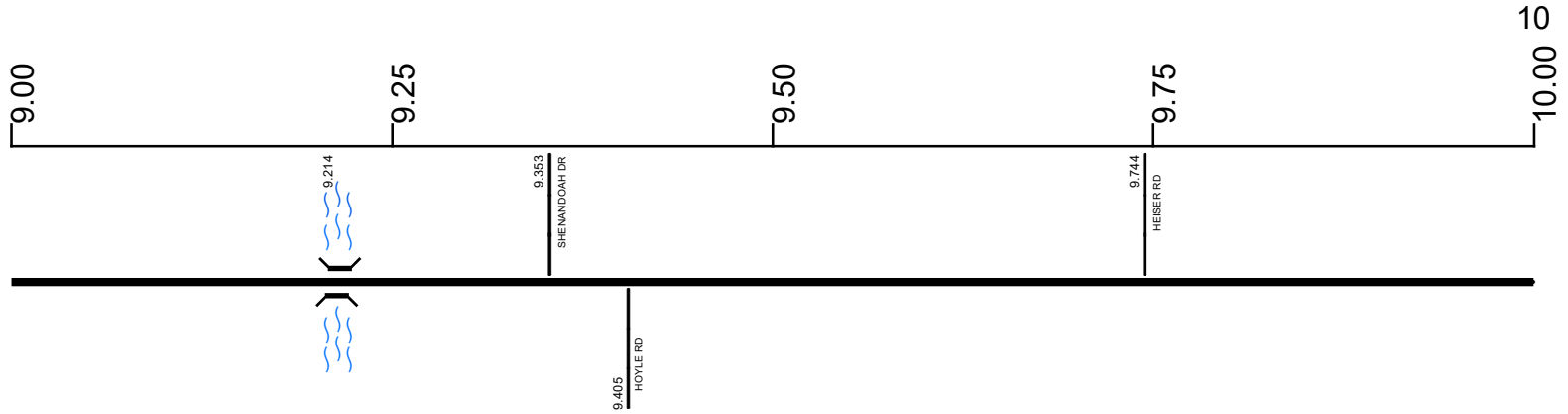

Surface Type & Width (Left / Right)

G 18'  
5.223 - 13.732

Base Type (Left / Right)

K  
2.124 - 13.732

Shoulder Type & Width (Left / Right)

5 (5/5)  
8.567 - 13.732

Through Lanes

2  
0 - 16.258

Street Name

S PRICETOWN RD  
0 - 13.732

- |                     |                   |                      |              |
|---------------------|-------------------|----------------------|--------------|
| Non-divided Highway | Bridge (on route) | Railroad (at grade)  | Intersection |
| Divided Highway     | Underpass         | Railroad (underpass) |              |
| Secondary Segment   | Overpass          | Railroad (overpass)  |              |
| Corporation         |                   |                      |              |

Created on: 7/2/2025



transportation.ohio.gov  
 Prepared by  
 The Ohio Department of Transportation  
 Office of Technical Services  
 Roadway Information

# SMAHSR00534\*\*C

State True Log

County True Log

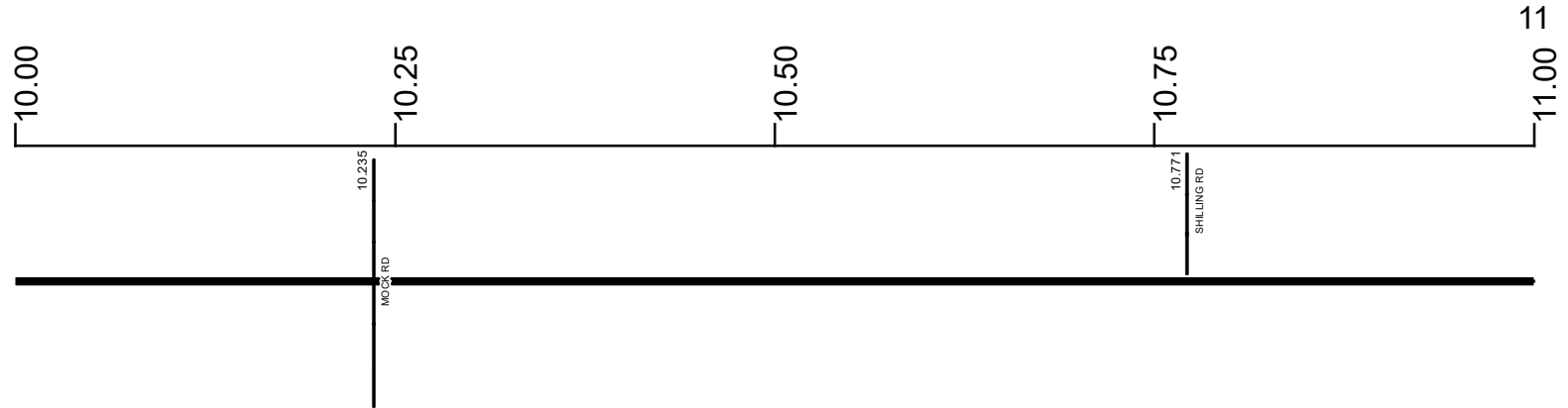

Surface Type & Width (Left / Right)

G 18'  
5.223 - 13.732

Base Type (Left / Right)

K  
2.124 - 13.732

Shoulder Type & Width (Left / Right)

5 (5/5)  
8.567 - 13.732

Through Lanes

2  
0 - 16.258

Street Name

S PRICETOWN RD  
0 - 13.732

- |                     |                   |                      |              |
|---------------------|-------------------|----------------------|--------------|
| Non-divided Highway | Bridge (on route) | Railroad (at grade)  | Intersection |
| Divided Highway     | Underpass         | Railroad (underpass) |              |
| Secondary Segment   | Overpass          | Railroad (overpass)  |              |
| Corporation         |                   |                      |              |

Created on: 7/2/2025



transportation.ohio.gov  
Prepared by  
The Ohio Department of Transportation  
Office of Technical Services  
Roadway Information

# SMAHSR00534\*\*C

State True Log  
County True Log

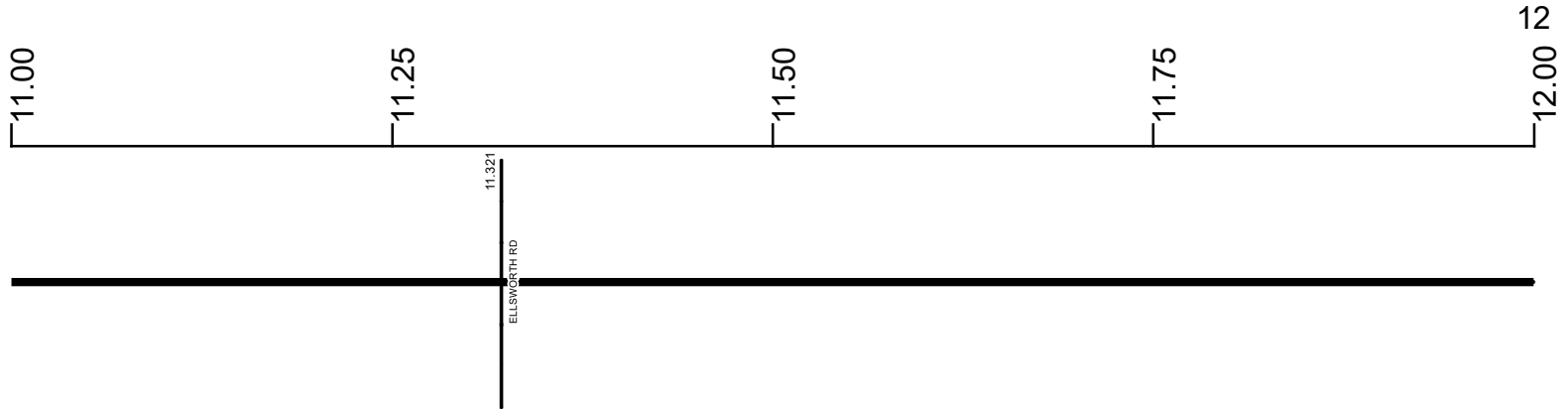

Surface Type & Width (Left / Right)

G 18'  
5.223 - 13.732

Base Type (Left / Right)

K  
2.124 - 13.732

Shoulder Type & Width (Left / Right)

5 (5/5)  
8.567 - 13.732

Through Lanes

2  
0 - 16.258

Street Name

S PRICETOWN RD  
0 - 13.732

- |                     |                   |                      |              |
|---------------------|-------------------|----------------------|--------------|
| Non-divided Highway | Bridge (on route) | Railroad (at grade)  | Intersection |
| Divided Highway     | Underpass         | Railroad (underpass) |              |
| Secondary Segment   | Overpass          | Railroad (overpass)  |              |
| Corporation         |                   |                      |              |

Created on: 7/2/2025



transportation.ohio.gov  
 Prepared by  
 The Ohio Department of Transportation  
 Office of Technical Services  
 Roadway Information

# SMAHSR00534\*\*C

State True Log  
County True Log

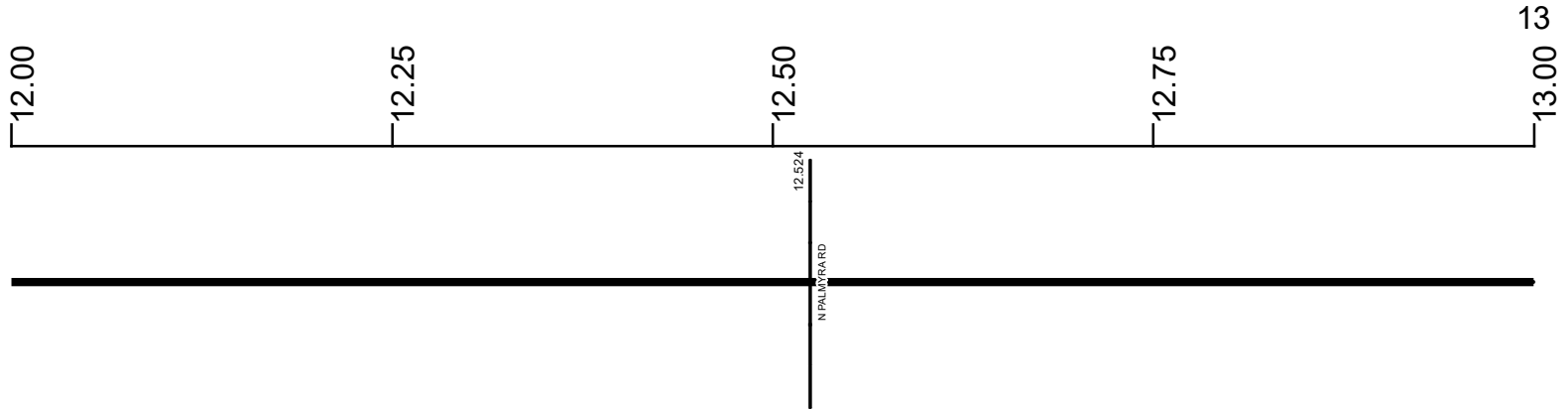

Surface Type & Width (Left / Right)

G 18'  
5.223 - 13.732

Base Type (Left / Right)

K  
2.124 - 13.732

Shoulder Type & Width (Left / Right)

5 (5/5)  
8.567 - 13.732

Through Lanes

2  
0 - 16.258

Street Name

S PRICETOWN RD  
0 - 13.732

- |                     |                   |                      |              |
|---------------------|-------------------|----------------------|--------------|
| Non-divided Highway | Bridge (on route) | Railroad (at grade)  | Intersection |
| Divided Highway     | Underpass         | Railroad (underpass) |              |
| Secondary Segment   | Overpass          | Railroad (overpass)  |              |
| Corporation         |                   |                      |              |

Created on: 7/2/2025



transportation.ohio.gov  
Prepared by  
The Ohio Department of Transportation  
Office of Technical Services  
Roadway Information

# SMAHSR00534\*\*C

State True Log  
County True Log

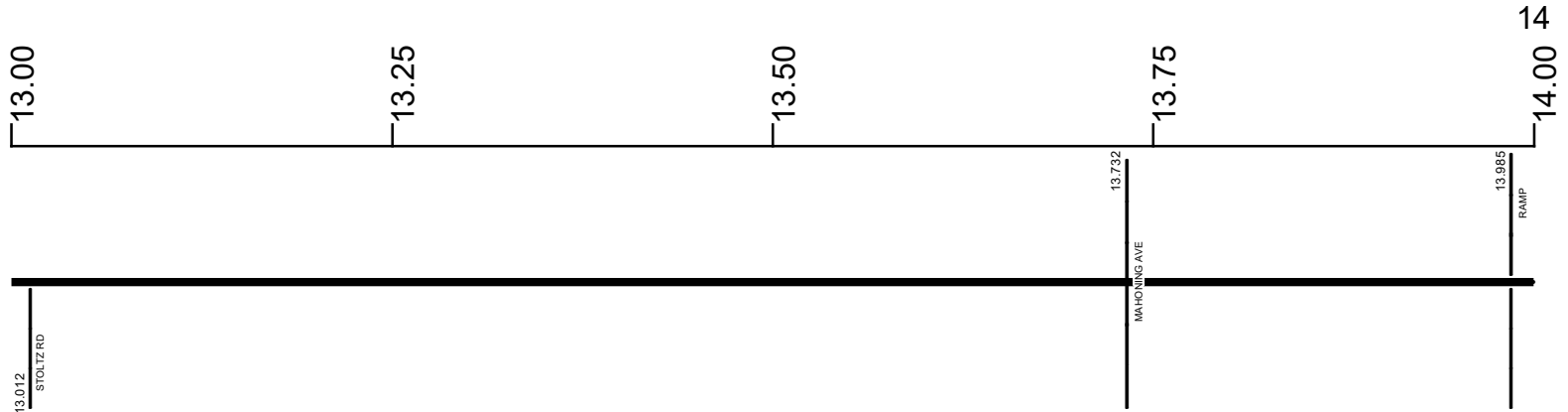

**Surface Type & Width (Left / Right)**

G 18'	G 24'
5.223 - 13.732	13.732 - 16.258

**Base Type (Left / Right)**

K	I
2.124 - 13.732	13.732 - 16.258

**Shoulder Type & Width (Left / Right)**

5 (5/5')	2 (10/10')
8.567 - 13.732	13.732 - 16.258

**Through Lanes**

	2
	0 - 16.258

**Street Name**

S PRICETOWN RD	N PRICETOWN RD
0 - 13.732	13.732 - 16.258

- Non-divided Highway
- Divided Highway
- Secondary Segment
- Corporation
- Bridge (on route)
- Underpass
- Overpass
- Railroad (at grade)
- Railroad (underpass)
- Railroad (overpass)
- Intersection

Created on: 7/2/2025

transportation.ohio.gov

Prepared by  
The Ohio Department of Transportation  
Office of Technical Services  
Roadway Information

# SMAHSR00534\*\*C

State True Log  
County True Log

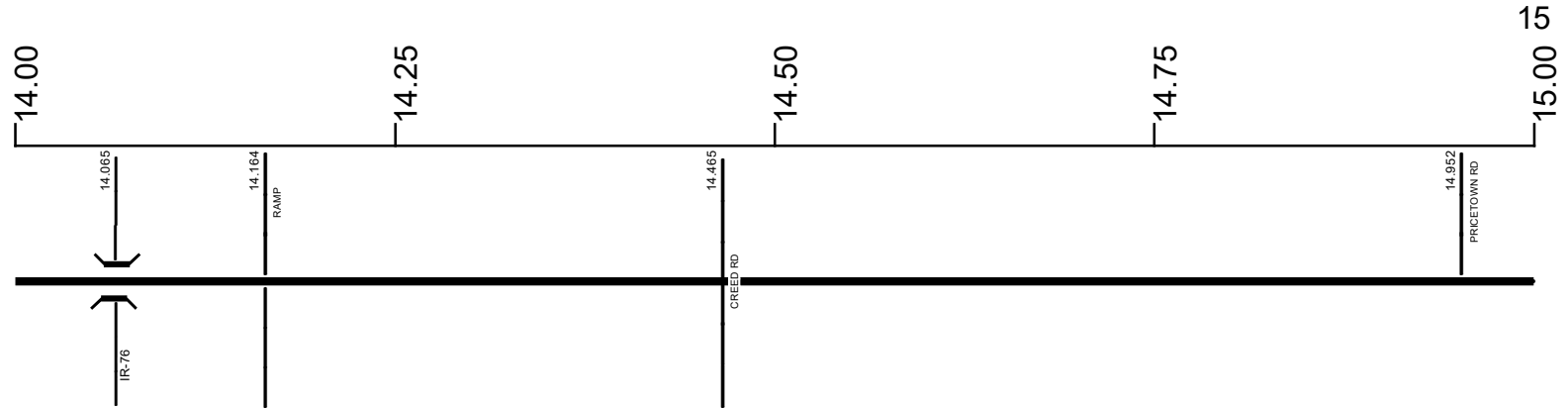

Surface Type & Width (Left / Right)

G 24'  
13.732 - 16.258

Base Type (Left / Right)

I  
13.732 - 16.258

Shoulder Type & Width (Left / Right)

2 (10'/10')  
13.732 - 16.258

Through Lanes

2  
0 - 16.258

Street Name

N PRICETOWN RD  
13.732 - 16.258

- |                     |                   |                      |              |
|---------------------|-------------------|----------------------|--------------|
| Non-divided Highway | Bridge (on route) | Railroad (at grade)  | Intersection |
| Divided Highway     | Underpass         | Railroad (underpass) |              |
| Secondary Segment   | Overpass          | Railroad (overpass)  |              |
| Corporation         |                   |                      |              |

Created on: 7/2/2025



transportation.ohio.gov  
Prepared by  
The Ohio Department of Transportation  
Office of Technical Services  
Roadway Information

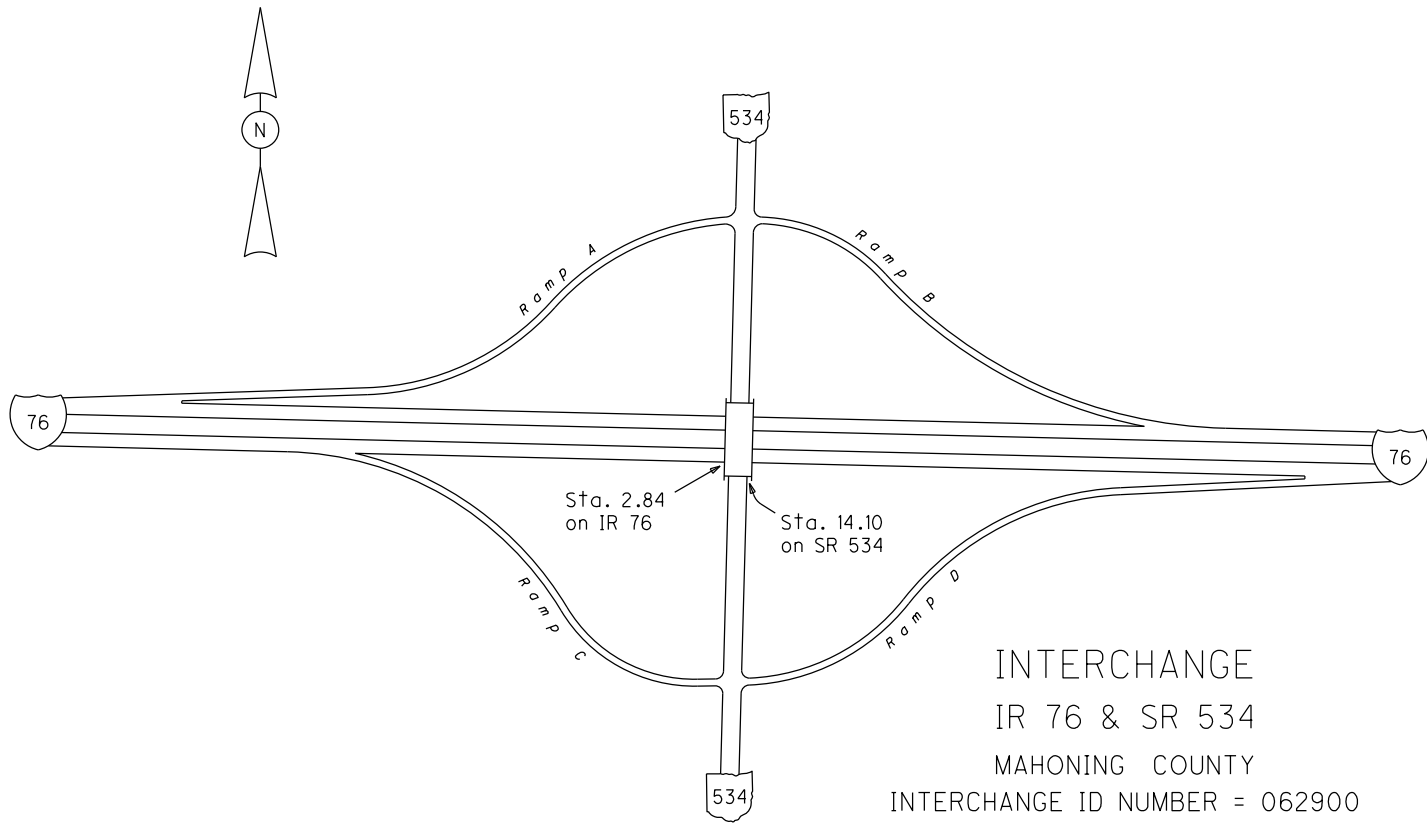

INTERCHANGE  
IR 76 & SR 534  
MAHONING COUNTY  
INTERCHANGE ID NUMBER = 062900

# SMAHSR00534\*\*C

State True Log

County True Log

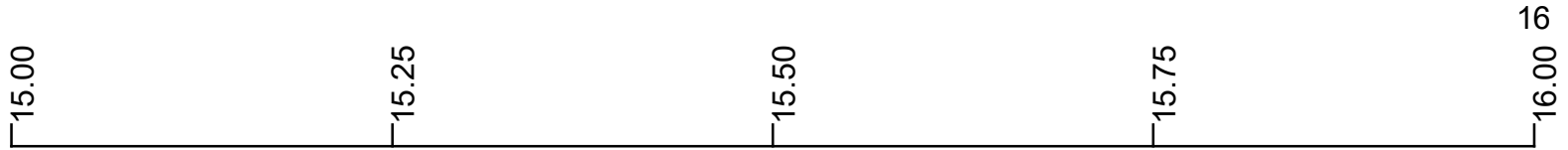

Surface Type & Width (Left / Right)

G 24'  
13.732 - 16.258

Base Type (Left / Right)

I  
13.732 - 16.258

Shoulder Type & Width (Left / Right)

2 (10'/10')  
13.732 - 16.258

Through Lanes

2  
0 - 16.258

Street Name

N PRICETOWN RD  
13.732 - 16.258

- |                     |                   |                      |              |
|---------------------|-------------------|----------------------|--------------|
| Non-divided Highway | Bridge (on route) | Railroad (at grade)  | Intersection |
| Divided Highway     | Underpass         | Railroad (underpass) |              |
| Secondary Segment   | Overpass          | Railroad (overpass)  |              |
| <b>Corporation</b>  |                   |                      |              |

Created on: 7/2/2025

Prepared by  
The Ohio Department of Transportation  
Office of Technical Services  
Roadway Information

SMAHSR00534\*\*C

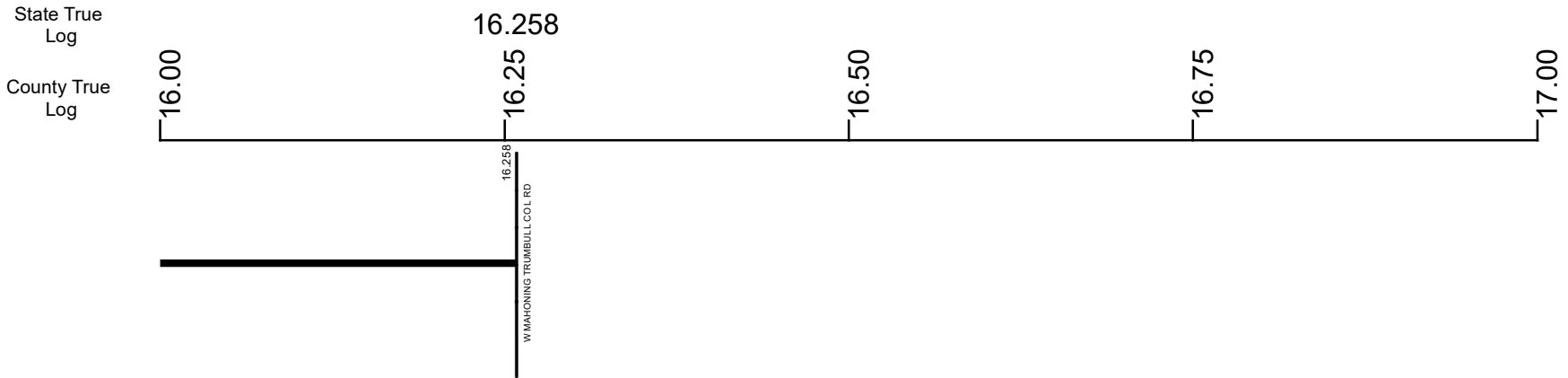

Surface Type & Width (Left / Right)

G 24'

13.732 - 16.258

Base Type (Left / Right)

I

13.732 - 16.258

Shoulder Type & Width (Left / Right)

2 (10'/10')

13.732 - 16.258

Through Lanes

2

0 - 16.258

Street Name

N PRICETOWN RD

13.732 - 16.258

- Non-divided Highway
- Divided Highway
- Secondary Segment
- Corporation
- Bridge (on route)
- Underpass
- Overpass
- Railroad (at grade)
- Railroad (underpass)
- Railroad (overpass)
- Intersection

Created on: 7/2/2025



transportation.ohio.gov

Prepared by

The Ohio Department of Transportation

Office of Technical Services

Roadway Information

## Historical Project List for SMAHSR00534\*\*C

Begin Measure	End Measure	Project ID Number	Construction Completion Date	Treatment Category	Treatment Type
0.000	3.006	101061	9-2023	Preventive Maintenance	25-Chip Seal
0.000	4.475	100239	8-2017	Preventive Maintenance	25-Chip Seal
3.006	4.475	110680	12-2023	Minor Rehabilitation	60-AC Overlay w/Rpr
3.006	8.567	22465	8-2004	Minor Rehabilitation	60-AC Overlay w/Rpr
4.475	8.457	100321	8-2017	Minor Rehabilitation	38-Fine Poly AC Overlay
8.467	16.258	84601	10-2014	Minor Rehabilitation	60-AC Overlay w/Rpr
8.567	13.732	24671	8-2004	Preventive Maintenance	30-Microsurfacing

# Roadway Codes

## Access Control Journalized

- F - Full Access Control
- L - Limited Access Control
- N - No Access Control

## Access Control Operational

- 1 - Full Access Control
- 2 - Partial Access Control
- 3 - No Access Control

## Base Type

- F - Crack and Seat
- H - Rubblize and Roll
- I - Aggregate Base 304 or Traffic Compacted
- K - Water Bound Macadam
- L - Bituminous Concrete Mix or Penetration Macadam
- N - Plain Concrete
- P - Reinforced Concrete
- R - Brick (Flexible)
- T - Brick (Rigid)

## Direction of Travel

- B - Both (Two-way)
- F - One-way Cardinal
- T - One-way Non-cardinal

## Facility Type

- 1 - One-way Roadway
- 2 - Two-way Roadway
- 4 - Ramp
- 5 - Non-mainline
- 6 - Non-inventory Direction
- 7 - Planned / Unbuilt

## Historical Federal Aid Indicator

- N - Not a FAP Route
- Y - FAP Route

## Functional Classification

- 01 - Interstate
- 02 - Principal Arterial (Freeways)
- 03 - Principal Arterial (Other)
- 04 - Minor Arterial
- 05 - Major Collector
- 06 - Minor Collector
- 07 - Local

## Leave / Reenter Indicator

- Y - Route leaves/reenters at this point
- N - Route does not leave/reenter at this point

## Median Type

- 1 - None
- 2 - Unprotected
- 3 - Curbed
- 4 - Positive Barrier (Unspecified)
- 5 - Positive Barrier (Flexible)
- 6 - Positive Barrier (Semi-rigid)
- 7 - Positive Barrier (Rigid)

## NHS

- N - National Highway System
- H - Congressional Corridor
- 2 - Major Airport
- 3 - Major Port Facility
- 4 - Major Amtrak Station
- 5 - Major Rail / Truck Terminal
- 6 - Major Intercity Bus Terminal
- 7 - Major Public Transit / Multi-modal Passenger Terminal
- 8 - Major Pipeline Terminal
- 9 - Major Ferry Terminal

## Priority System

- G - General
- P - Priority System
- U - Urban

## Scenic Byway Code

- A - All American Road
- N - National Scenic Byway
- S - State Scenic Byway

## Shoulder Type

- 1 - None
- 2 - Surfaced shoulder exists (bituminous concrete {AC})
- 3 - Surfaced shoulder exists (Portland Cement Concrete {PCC})
- 4 - Stabilized shoulder exists (gravel or other granular material)
- 5 - Combination shoulder exists (two or more surface types)
- 6 - Earth shoulder exists
- 7 - Barrier curb exists; no shoulder in front of curb

## Surface Type

- A - Combination
- B - Brick
- C - Continuous Reinforced Concrete
- D - Reinforced Concrete
- E - Plain Concrete
- G - Bituminous Concrete
- I - Chipseal on Granular
- K - Open Graded Bituminous
- L - Chipseal or Micro
- M - Gravel
- U - Unimproved
- X - Right of Way Only