

SMEDSR00083**C

State True Log 120.508

121.508

County True Log

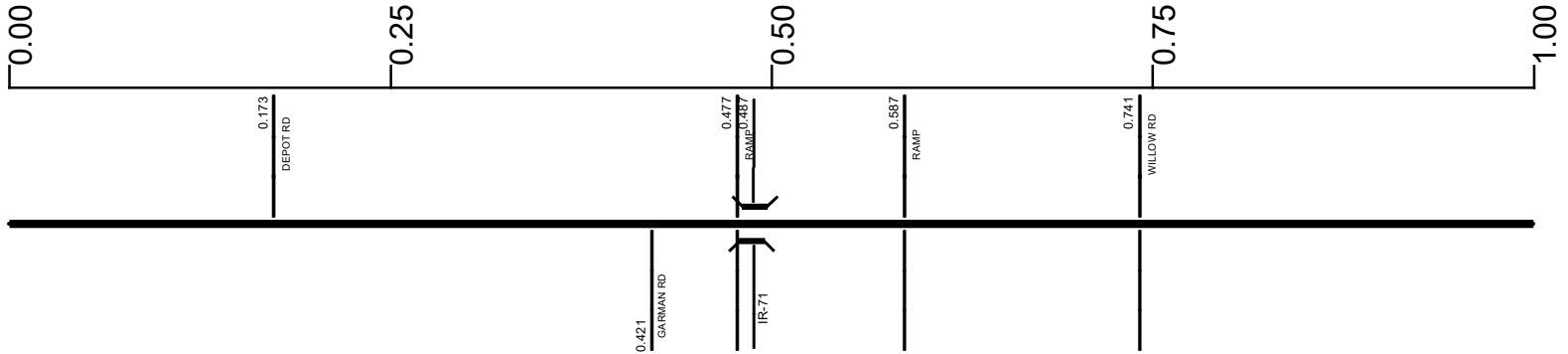

Surface Type & Width (Left / Right)

G 24'	D 36'	D 60'	D 48'	G 22'
0 - 0.297	0.297 - 0.537	0.537 - 0.712	0.712 - 0.911	0.911 - 2.609

Base Type (Left / Right)

L
0 - 0.297

Base Type (Left / Right)

I / L
0.911 - 2.609

Shoulder Type & Width (Left / Right)

2 (11'/11')	2 (4'/4')	1 (0'/0')	2 (4'/4')	2 (2'/2')
0 - 0.297	0.297 - 0.369	0.369 - 0.712	0.712 - 0.911	0.911 - 3.088

Resurface Year

2020
0 - 0.3

Resurface Year

2024
0.911 - 2.609

Through Lanes

2
0 - 12.826

Street Name

AVON LAKE RD
0 - 2.609

- Non-divided Highway
- Divided Highway
- Secondary Segment
- Corporation
- Bridge (on route)
- Underpass
- Overpass
- Railroad (at grade)
- Railroad (underpass)
- Railroad (overpass)
- Intersection

Created on: 7/2/2025

transportation.ohio.gov

Prepared by
The Ohio Department of Transportation
Office of Technical Services
Roadway Information



INTERCHANGE
IR 71 & SR 83
MEDINA COUNTY
INTERCHANGE ID NUMBER = 066200

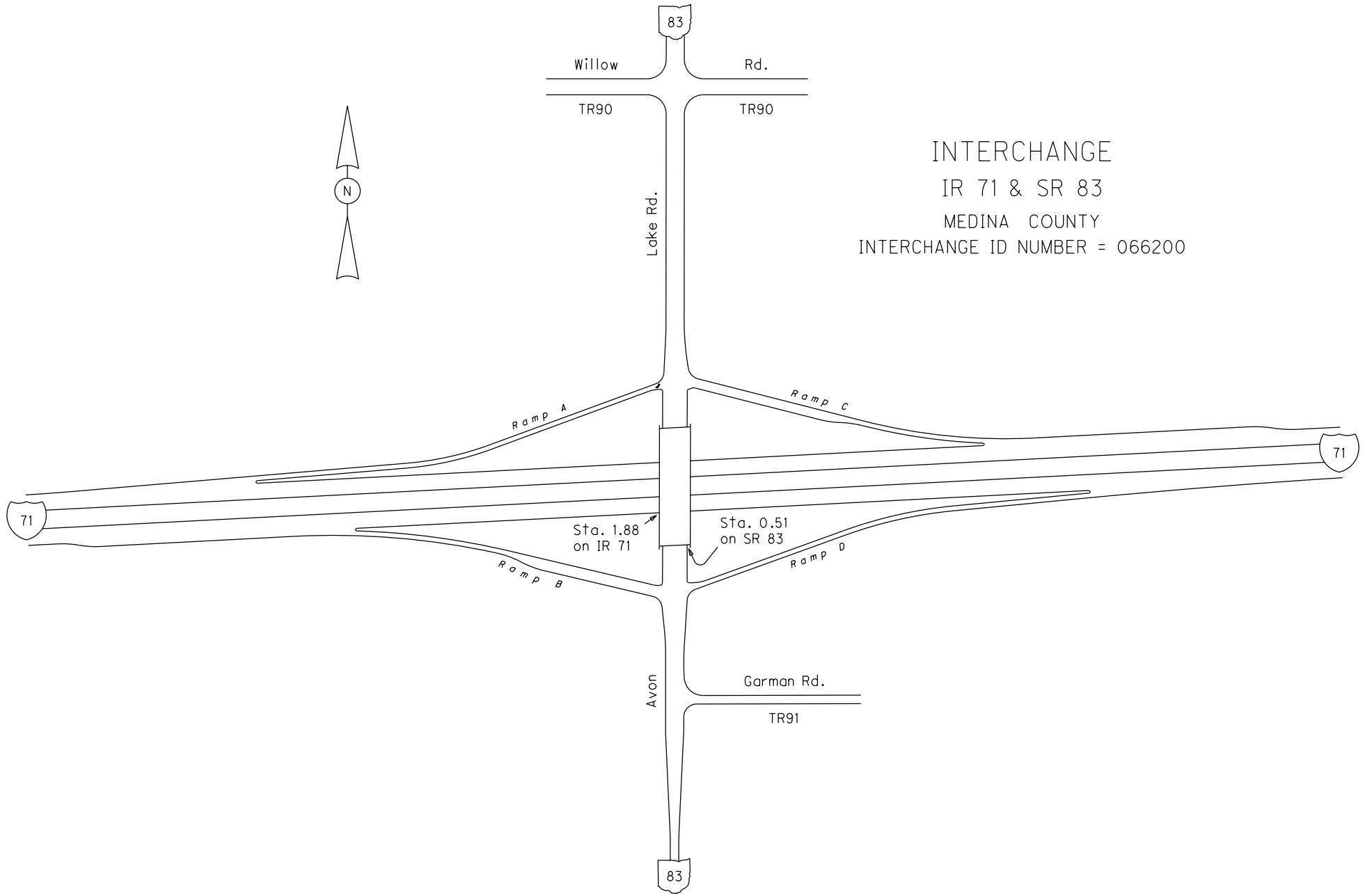

SMEDSR00083**C

State True Log

122.508

County True Log

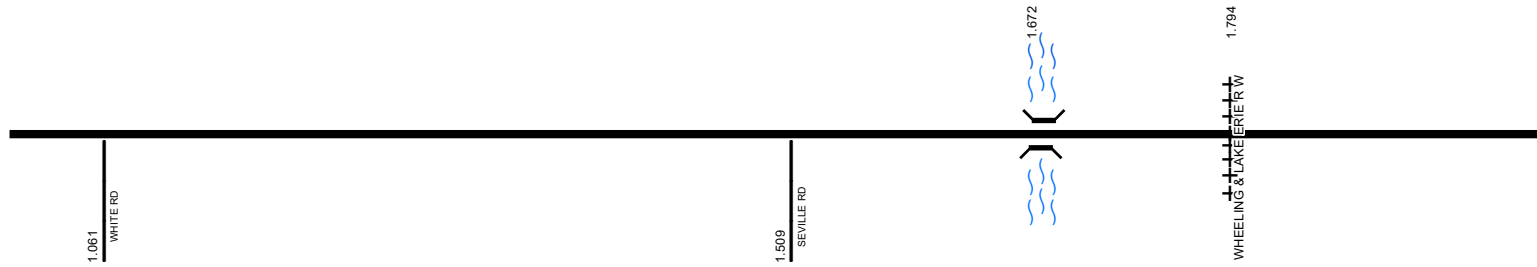

Surface Type & Width (Left / Right)

	G 22'
	0.911 - 2.609

Base Type (Left / Right)

	I / L
	0.911 - 2.609

Shoulder Type & Width (Left / Right)

	2 (2'/2')
	0.911 - 3.088

Resurface Year

	2024
	0.911 - 2.609

Through Lanes

	2
	0 - 12.826

Street Name

	AVON LAKE RD
	0 - 2.609

- | | | | |
|---------------------|-------------------|----------------------|--------------|
| Non-divided Highway | Bridge (on route) | Railroad (at grade) | Intersection |
| Divided Highway | Underpass | Railroad (underpass) | |
| Secondary Segment | Overpass | Railroad (overpass) | |
| Corporation | | | |

Created on: 7/2/2025

transportation.ohio.gov

Prepared by
The Ohio Department of Transportation
Office of Technical Services
Roadway Information

SMEDSR00083**C

State True Log

123.508

County True Log

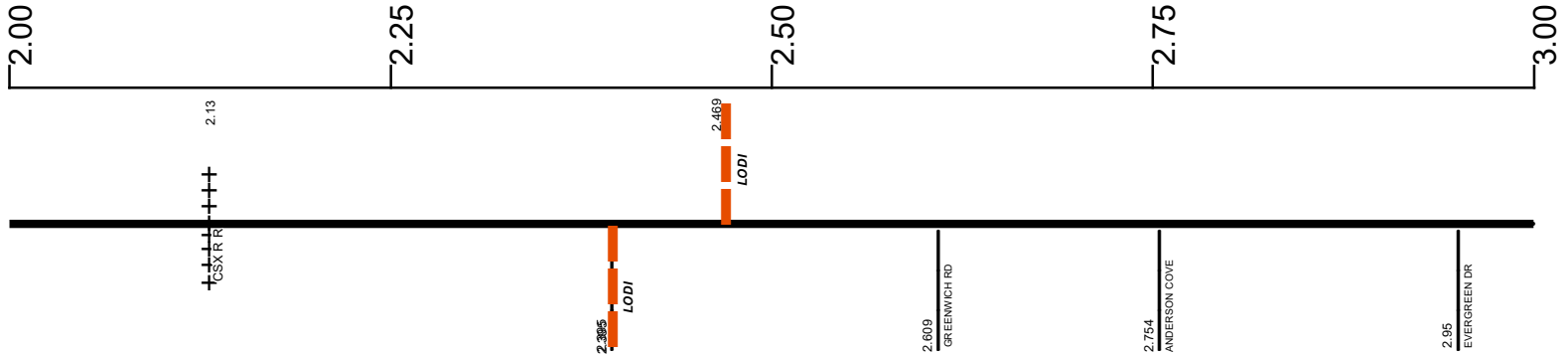

Surface Type & Width (Left / Right)

G 22'	G 24'
0.911 - 2.609	2.609 - 3.088

Base Type (Left / Right)

I / L	K
0.911 - 2.609	2.609 - 3.397

Shoulder Type & Width (Left / Right)

2 (2'/2')
0.911 - 3.088

Resurface Year

2024
0.911 - 2.609

Through Lanes

2
0 - 12.826

Street Name

AVON LAKE RD	WOOSTER ST
0 - 2.609	2.609 - 3.466

- Non-divided Highway
- Divided Highway
- Secondary Segment
- Corporation
- Bridge (on route)
- Underpass
- Overpass
- Railroad (at grade)
- Railroad (underpass)
- Railroad (overpass)
- Intersection

Created on: 7/2/2025

transportation.ohio.gov

Prepared by
The Ohio Department of Transportation
Office of Technical Services
Roadway Information

SMEDSR00083**C

State True Log

124.508

County True Log

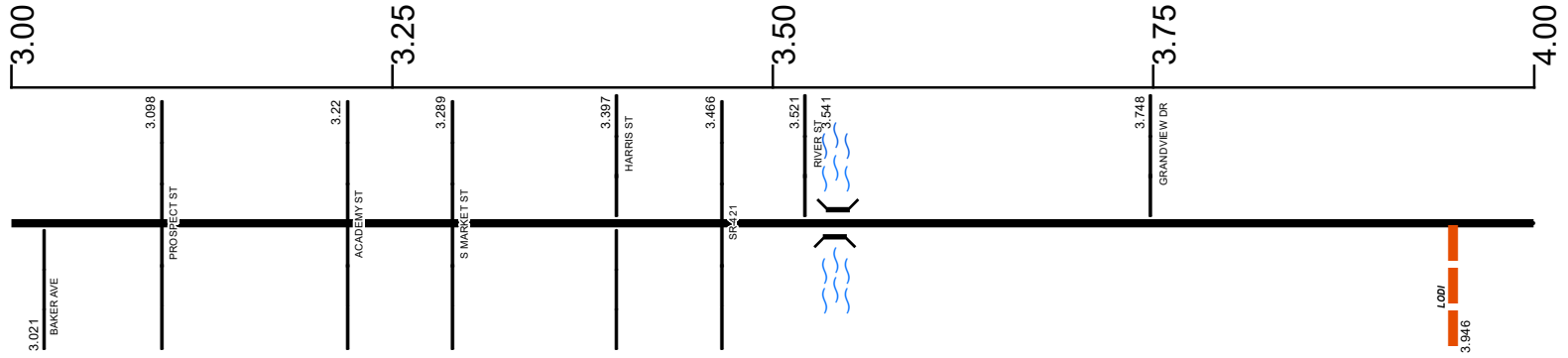

Surface Type & Width (Left / Right)

G 24'	G 30'	G (30'/26')	G (10'/18')	G (10'/12')	G (10'/14')
2.609 - 3.088	3.088 - 3.397	3.397 - 3.466	3.466 - 3.63	3.63 - 3.95	3.95 - 12.826

Base Type (Left / Right)

K	K / I	N / I
2.609 - 3.397	3.397 - 3.466	3.466 - 12.826

Shoulder Type & Width (Left / Right)

2 (2'/2')	1 (0'/0')	2 (2'/2')
0.911 - 3.088	3.088 - 3.63	3.63 - 12.826

Through Lanes

2
0 - 12.826

Street Name

WOOSTER ST	ELYRIA ST	AVON LAKE RD
2.609 - 3.466	3.466 - 3.946	3.946 - 12.826

- Non-divided Highway
- Divided Highway
- Secondary Segment
- Corporation
- Bridge (on route)
- Underpass
- Overpass
- Railroad (at grade)
- Railroad (underpass)
- Railroad (overpass)
- Intersection

Created on: 7/2/2025

transportation.ohio.gov

Prepared by
The Ohio Department of Transportation
Office of Technical Services
Roadway Information

SMEDSR00083**C

State True Log

125.508

County True Log

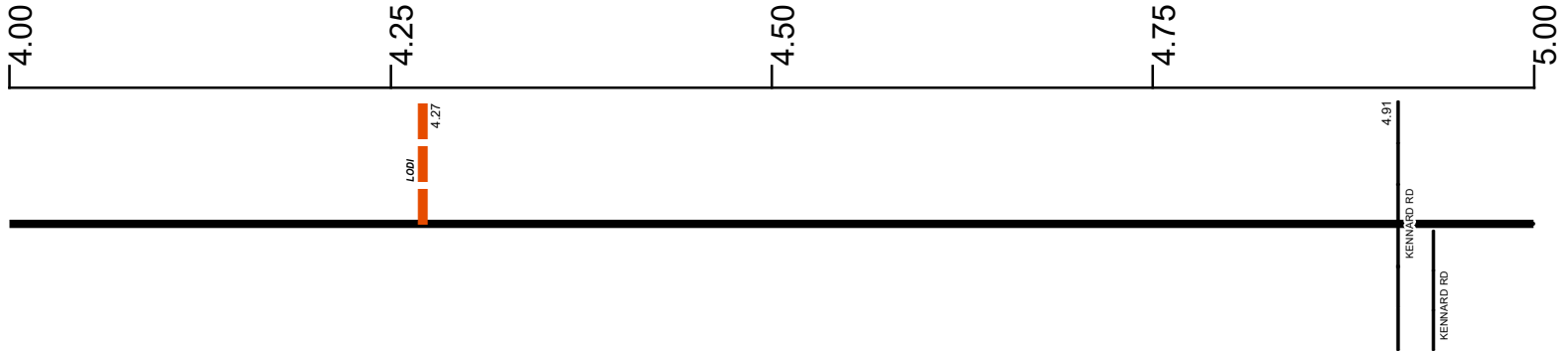

Surface Type & Width (Left / Right)

G (10/14')
3.95 - 12.826

Base Type (Left / Right)

N / I
3.466 - 12.826

Shoulder Type & Width (Left / Right)

2 (2/2')
3.63 - 12.826

Through Lanes

2
0 - 12.826

Street Name

AVON LAKE RD
3.946 - 12.826

- | | | | |
|---------------------|-------------------|----------------------|--------------|
| Non-divided Highway | Bridge (on route) | Railroad (at grade) | Intersection |
| Divided Highway | Underpass | Railroad (underpass) | |
| Secondary Segment | Overpass | Railroad (overpass) | |
| Corporation | | | |

Created on: 7/2/2025

transportation.ohio.gov

Prepared by
The Ohio Department of Transportation
Office of Technical Services
Roadway Information

SMEDSR00083**C

State True Log

126.508

County True Log

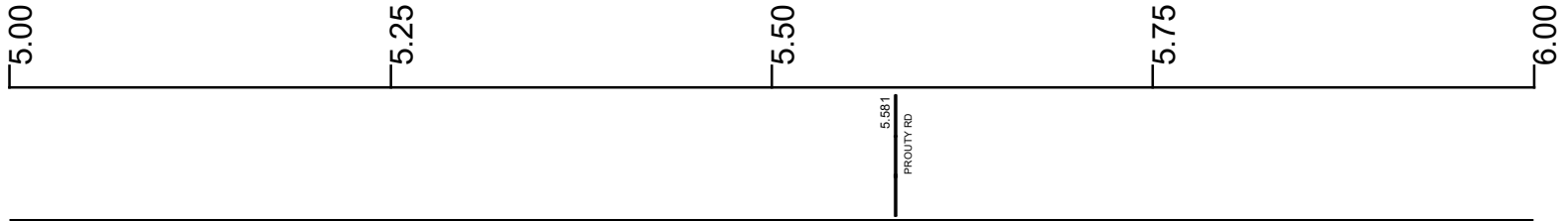

Surface Type & Width (Left / Right)

G (10/14')
3.95 - 12.826

Base Type (Left / Right)

N / I
3.466 - 12.826

Shoulder Type & Width (Left / Right)

2 (2/2')
3.63 - 12.826

Through Lanes

2
0 - 12.826

Street Name

AVON LAKE RD
3.946 - 12.826

- | | | | |
|---------------------|-------------------|----------------------|--------------|
| Non-divided Highway | Bridge (on route) | Railroad (at grade) | Intersection |
| Divided Highway | Underpass | Railroad (underpass) | |
| Secondary Segment | Overpass | Railroad (overpass) | |
| Corporation | | | |

Created on: 7/2/2025



transportation.ohio.gov

Prepared by
The Ohio Department of Transportation
Office of Technical Services
Roadway Information

SMEDSR00083**C

State True Log

127.508

County True Log



Surface Type & Width (Left / Right)

G (10/14')
3.95 - 12.826

Base Type (Left / Right)

N / I
3.466 - 12.826

Shoulder Type & Width (Left / Right)

2 (2/2')
3.63 - 12.826

Through Lanes

2
0 - 12.826

Street Name

AVON LAKE RD
3.946 - 12.826

- | | | | |
|---------------------|-------------------|----------------------|--------------|
| Non-divided Highway | Bridge (on route) | Railroad (at grade) | Intersection |
| Divided Highway | Underpass | Railroad (underpass) | |
| Secondary Segment | Overpass | Railroad (overpass) | |
| Corporation | | | |

Created on: 7/2/2025

transportation.ohio.gov

Prepared by
The Ohio Department of Transportation
Office of Technical Services
Roadway Information

SMEDSR00083**C

State True Log

128.508

County True Log

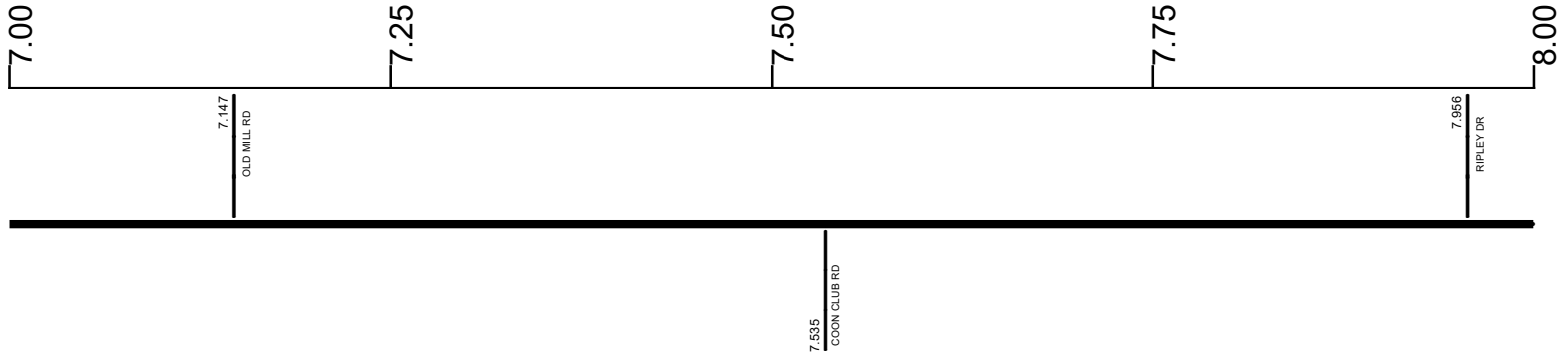

Surface Type & Width (Left / Right)

G (10/14')
3.95 - 12.826

Base Type (Left / Right)

N / I
3.466 - 12.826

Shoulder Type & Width (Left / Right)

2 (2/2')
3.63 - 12.826

Through Lanes

2
0 - 12.826

Street Name

AVON LAKE RD
3.946 - 12.826

- | | | | |
|---------------------|-------------------|----------------------|--------------|
| Non-divided Highway | Bridge (on route) | Railroad (at grade) | Intersection |
| Divided Highway | Underpass | Railroad (underpass) | |
| Secondary Segment | Overpass | Railroad (overpass) | |
| Corporation | | | |

Created on: 7/2/2025

transportation.ohio.gov

Prepared by
The Ohio Department of Transportation
Office of Technical Services
Roadway Information

SMEDSR00083**C

State True Log

129.508

County True Log

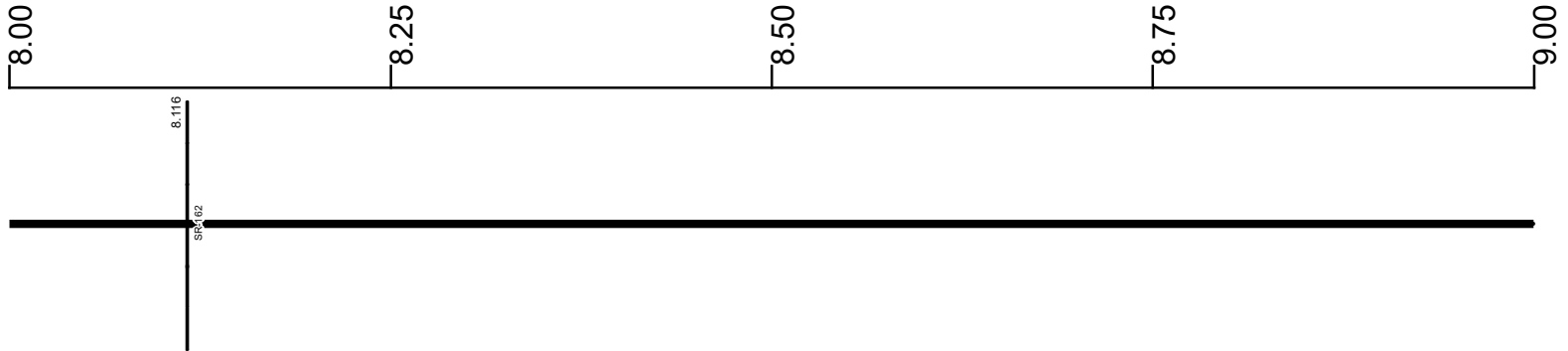

Surface Type & Width (Left / Right)

G (10/14')
3.95 - 12.826

Base Type (Left / Right)

N / I
3.466 - 12.826

Shoulder Type & Width (Left / Right)

2 (2/2')
3.63 - 12.826

Through Lanes

2
0 - 12.826

Street Name

AVON LAKE RD
3.946 - 12.826

- | | | | |
|---------------------|-------------------|----------------------|--------------|
| Non-divided Highway | Bridge (on route) | Railroad (at grade) | Intersection |
| Divided Highway | Underpass | Railroad (underpass) | |
| Secondary Segment | Overpass | Railroad (overpass) | |
| Corporation | | | |

Created on: 7/2/2025



transportation.ohio.gov

Prepared by
The Ohio Department of Transportation
Office of Technical Services
Roadway Information

SMEDSR00083**C

State True Log

130.508

County True Log

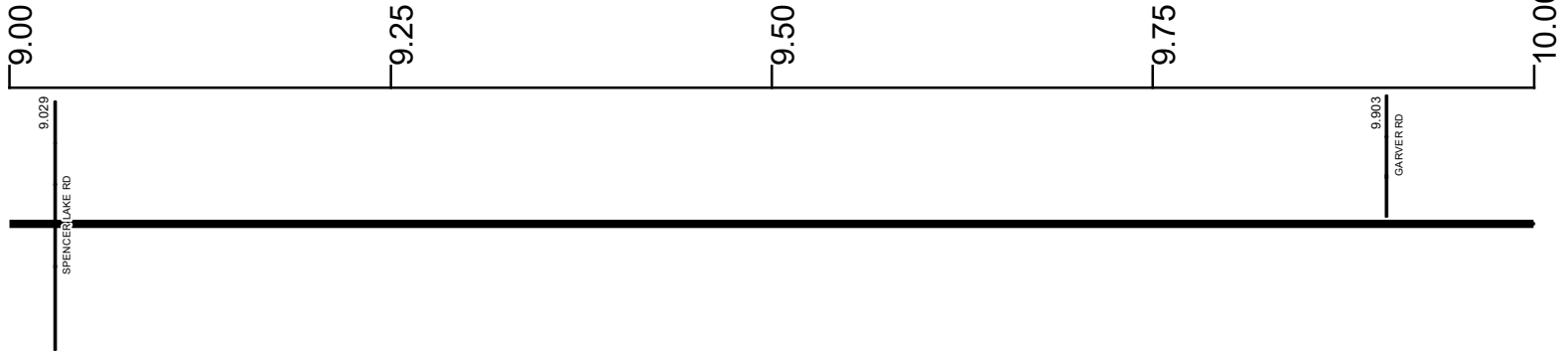

Surface Type & Width (Left / Right)

G (10'/14')
3.95 - 12.826

Base Type (Left / Right)

N / I
3.466 - 12.826

Shoulder Type & Width (Left / Right)

2 (2'/2')
3.63 - 12.826

Through Lanes

2
0 - 12.826

Street Name

AVON LAKE RD
3.946 - 12.826

- | | | | |
|---------------------|-------------------|----------------------|--------------|
| Non-divided Highway | Bridge (on route) | Railroad (at grade) | Intersection |
| Divided Highway | Underpass | Railroad (underpass) | |
| Secondary Segment | Overpass | Railroad (overpass) | |
| Corporation | | | |

Created on: 7/2/2025

transportation.ohio.gov

Prepared by
The Ohio Department of Transportation
Office of Technical Services
Roadway Information

SMEDSR00083**C

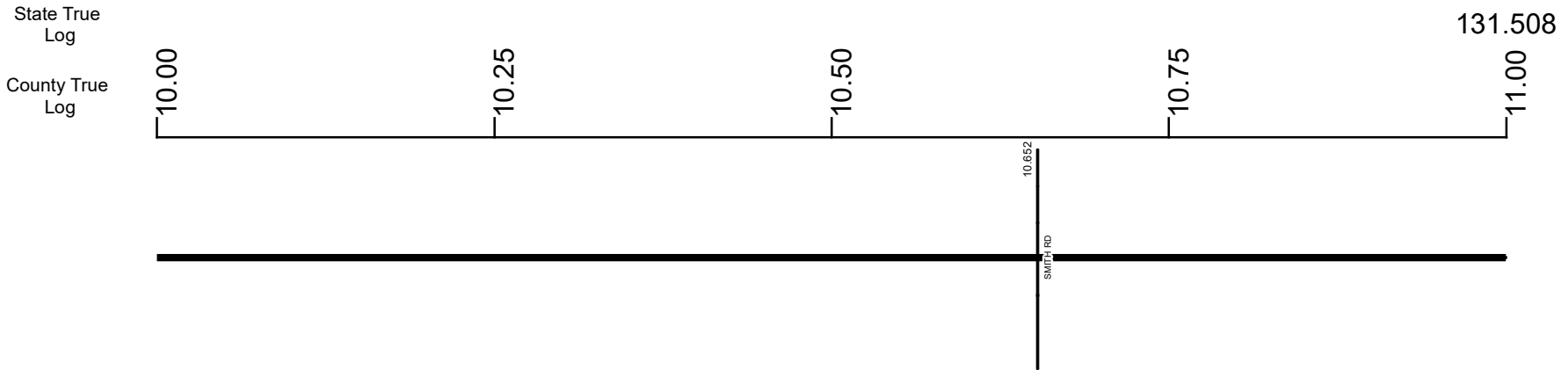

Surface Type & Width (Left / Right)	G (10/14')
	3.95 - 12.826
Base Type (Left / Right)	N / I
	3.466 - 12.826
Shoulder Type & Width (Left / Right)	2 (2/2')
	3.63 - 12.826
Through Lanes	2
	0 - 12.826
Street Name	AVON LAKE RD
	3.946 - 12.826

- | | | | |
|---------------------|-------------------|----------------------|--------------|
| Non-divided Highway | Bridge (on route) | Railroad (at grade) | Intersection |
| Divided Highway | Underpass | Railroad (underpass) | |
| Secondary Segment | Overpass | Railroad (overpass) | |
| Corporation | | | |

Created on: 7/2/2025

transportation.ohio.gov

Prepared by
The Ohio Department of Transportation
Office of Technical Services
Roadway Information

SMEDSR00083**C

State True Log

132.508

County True Log

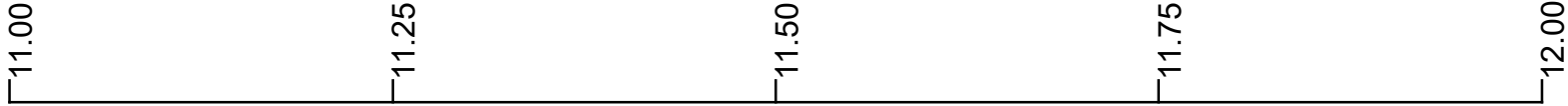

11.671
SHANK RD

Surface Type & Width (Left / Right)

G (10/14')
3.95 - 12.826

Base Type (Left / Right)

N / I
3.466 - 12.826

Shoulder Type & Width (Left / Right)

2 (2/2')
3.63 - 12.826

Through Lanes

2
0 - 12.826

Street Name

AVON LAKE RD
3.946 - 12.826

- | | | | |
|---------------------|-------------------|----------------------|--------------|
| Non-divided Highway | Bridge (on route) | Railroad (at grade) | Intersection |
| Divided Highway | Underpass | Railroad (underpass) | |
| Secondary Segment | Overpass | Railroad (overpass) | |
| Corporation | | | |

Created on: 7/2/2025

transportation.ohio.gov

Prepared by
The Ohio Department of Transportation
Office of Technical Services
Roadway Information

SMEDSR00083**C

State True Log
County True Log

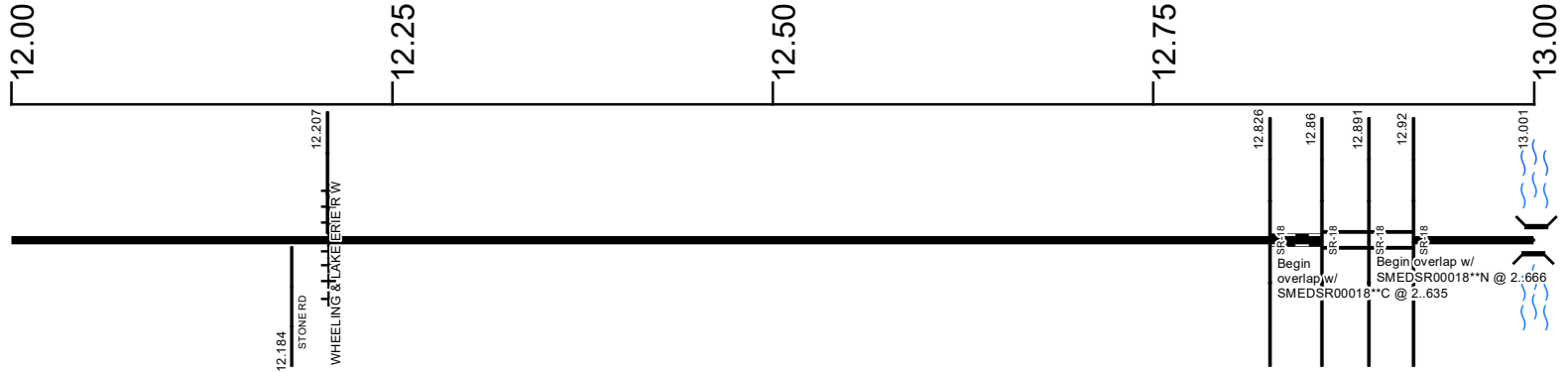

Surface Type & Width (Left / Right)

G (10'/14')
3.95 - 12.826

Base Type (Left / Right)

N / I
3.466 - 12.826

Shoulder Type & Width (Left / Right)

2 (2'/2')
3.63 - 12.826

Surface Type & Width (Left / Right)

G (10'/14')
12.86 - 15.104

Base Type (Left / Right)

N / I
12.86 - 15.104

Shoulder Type & Width (Left / Right)

2 (4'/4') 2 (2'/2')
12.86 - 12.92 12.92 - 15.104

Median Type and Width

3 (315')
12.86 - 12.92

Through Lanes

2
0 - 12.826

Through Lanes

2
12.86 - 15.104

Street Name

AVON LAKE RD
3.946 - 12.826

AVON LAKE RD
12.86 - 15.104

- Non-divided Highway
- Divided Highway
- Secondary Segment
- Corporation
- Bridge (on route)
- Underpass
- Overpass
- Railroad (at grade)
- Railroad (underpass)
- Railroad (overpass)
- Intersection

Created on: 7/2/2025



transportation.ohio.gov

Prepared by
The Ohio Department of Transportation
Office of Technical Services
Roadway Information

SMEDSR00083**C

State True
Log

135.508

County True
Log

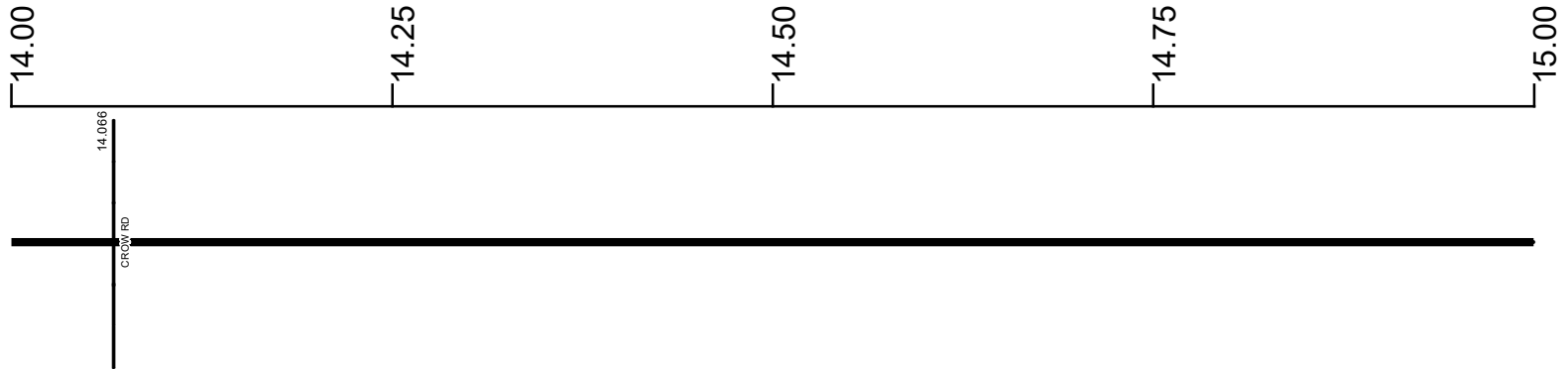

Surface Type & Width (Left / Right)

	G (10/14')
	12.86 - 15.104

Base Type (Left / Right)

	N / I
	12.86 - 15.104

Shoulder Type & Width (Left / Right)

	2 (2/2')
	12.92 - 15.104

Through Lanes

	2
	12.86 - 15.104

Street Name

	AVON LAKE RD
	12.86 - 15.104

- | | | | |
|---------------------|-------------------|----------------------|--------------|
| Non-divided Highway | Bridge (on route) | Railroad (at grade) | Intersection |
| Divided Highway | Underpass | Railroad (underpass) | |
| Secondary Segment | Overpass | Railroad (overpass) | |
| Corporation | | | |

Created on: 7/2/2025

transportation.ohio.gov

Prepared by
The Ohio Department of Transportation
Office of Technical Services
Roadway Information

SMEDSR00083**C

State True Log

135.612

County True Log

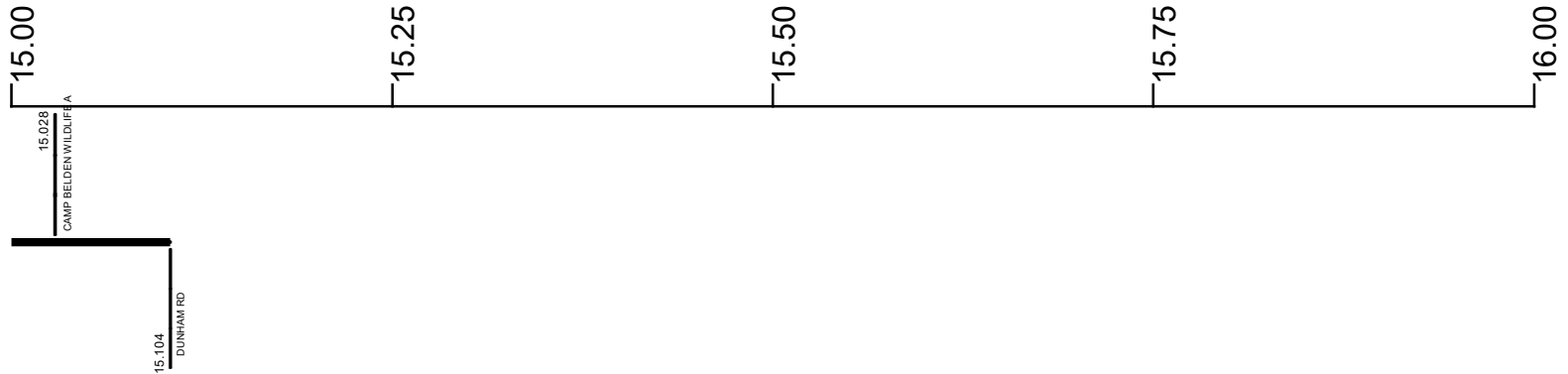

Surface Type & Width (Left / Right)

G (10'/14')
12.86 - 15.104

Base Type (Left / Right)

N / I
12.86 - 15.104

Shoulder Type & Width (Left / Right)

2 (2'/2')
12.92 - 15.104

Through Lanes

2
12.86 - 15.104

Street Name

AVON LAKE RD
12.86 - 15.104

- | | | | |
|---------------------|-------------------|----------------------|--------------|
| Non-divided Highway | Bridge (on route) | Railroad (at grade) | Intersection |
| Divided Highway | Underpass | Railroad (underpass) | |
| Secondary Segment | Overpass | Railroad (overpass) | |
| Corporation | | | |

Created on: 7/2/2025



transportation.ohio.gov
 Prepared by
 The Ohio Department of Transportation
 Office of Technical Services
 Roadway Information

Historical Project List for SMEDSR00083**C

Begin Measure	End Measure	Project ID Number	Construction Completion Date	Treatment Category	Treatment Type
0.000	0.297	105455	8-2021	Minor Rehabilitation	60-AC Overlay w/Rpr
0.000	0.297	83434	9-2012	Preventive Maintenance	30-Microsurfacing
0.901	12.776	23574	10-2009	Minor Rehabilitation	60-AC Overlay w/Rpr
2.609	4.273	87719	5-2018	Minor Rehabilitation	38-Fine Poly AC Overlay
4.273	12.826	108894	10-2020	Preventive Maintenance	30-Microsurfacing
12.920	15.104	87719	5-2018	Minor Rehabilitation	38-Fine Poly AC Overlay
12.920	15.104	25663	9-2008	Minor Rehabilitation	60-AC Overlay w/Rpr

Roadway Codes

Access Control Journalized

- F - Full Access Control
- L - Limited Access Control
- N - No Access Control

Access Control Operational

- 1 - Full Access Control
- 2 - Partial Access Control
- 3 - No Access Control

Base Type

- F - Crack and Seat
- H - Rubblize and Roll
- I - Aggregate Base 304 or Traffic Compacted
- K - Water Bound Macadam
- L - Bituminous Concrete Mix or Penetration Macadam
- N - Plain Concrete
- P - Reinforced Concrete
- R - Brick (Flexible)
- T - Brick (Rigid)

Direction of Travel

- B - Both (Two-way)
- F - One-way Cardinal
- T - One-way Non-cardinal

Facility Type

- 1 - One-way Roadway
- 2 - Two-way Roadway
- 4 - Ramp
- 5 - Non-mainline
- 6 - Non-inventory Direction
- 7 - Planned / Unbuilt

Historical Federal Aid Indicator

- N - Not a FAP Route
- Y - FAP Route

Functional Classification

- 01 - Interstate
- 02 - Principal Arterial (Freeways)
- 03 - Principal Arterial (Other)
- 04 - Minor Arterial
- 05 - Major Collector
- 06 - Minor Collector
- 07 - Local

Leave / Reenter Indicator

- Y - Route leaves/reenters at this point
- N - Route does not leave/reenter at this point

Median Type

- 1 - None
- 2 - Unprotected
- 3 - Curbed
- 4 - Positive Barrier (Unspecified)
- 5 - Positive Barrier (Flexible)
- 6 - Positive Barrier (Semi-rigid)
- 7 - Positive Barrier (Rigid)

NHS

- N - National Highway System
- H - Congressional Corridor
- 2 - Major Airport
- 3 - Major Port Facility
- 4 - Major Amtrak Station
- 5 - Major Rail / Truck Terminal
- 6 - Major Intercity Bus Terminal
- 7 - Major Public Transit / Multi-modal Passenger Terminal
- 8 - Major Pipeline Terminal
- 9 - Major Ferry Terminal

Priority System

- G - General
- P - Priority System
- U - Urban

Scenic Byway Code

- A - All American Road
- N - National Scenic Byway
- S - State Scenic Byway

Shoulder Type

- 1 - None
- 2 - Surfaced shoulder exists (bituminous concrete {AC})
- 3 - Surfaced shoulder exists (Portland Cement Concrete {PCC})
- 4 - Stabilized shoulder exists (gravel or other granular material)
- 5 - Combination shoulder exists (two or more surface types)
- 6 - Earth shoulder exists
- 7 - Barrier curb exists; no shoulder in front of curb

Surface Type

- A - Combination
- B - Brick
- C - Continuous Reinforced Concrete
- D - Reinforced Concrete
- E - Plain Concrete
- G - Bituminous Concrete
- I - Chipseal on Granular
- K - Open Graded Bituminous
- L - Chipseal or Micro
- M - Gravel
- U - Unimproved
- X - Right of Way Only