

# SMERSR00118\*\*C

State True Log 17.619

18.619

County True Log



<b>Surface Type &amp; Width (Left / Right)</b>	
G (20'/4') 0 - 0.469	G (18'/6') 0.469 - 2.483
<b>Base Type (Left / Right)</b>	
I / L 0 - 4.605	
<b>Shoulder Type &amp; Width (Left / Right)</b>	
2 (6'/6') 0 - 0.469	2 (3'/3') 0.469 - 2.483
<b>Through Lanes</b>	
2 0 - 13.42	
<b>Street Name</b>	
SR 118 0 - 3.912	

<ul style="list-style-type: none"> <li> Non-divided Highway</li> <li> Divided Highway</li> <li> Secondary Segment</li> <li> Corporation</li> </ul>	<ul style="list-style-type: none"> <li> Bridge (on route)</li> <li> Underpass</li> <li> Overpass</li> </ul>	<ul style="list-style-type: none"> <li> Railroad (at grade)</li> <li> Railroad (underpass)</li> <li> Railroad (overpass)</li> </ul>	<ul style="list-style-type: none"> <li> Intersection</li> </ul>
--	---	---	---

Created on: 7/2/2025

transportation.ohio.gov

Prepared by  
The Ohio Department of Transportation  
Office of Technical Services  
Roadway Information

# SMERSR00118\*\*C

State True Log

19.619

County True Log

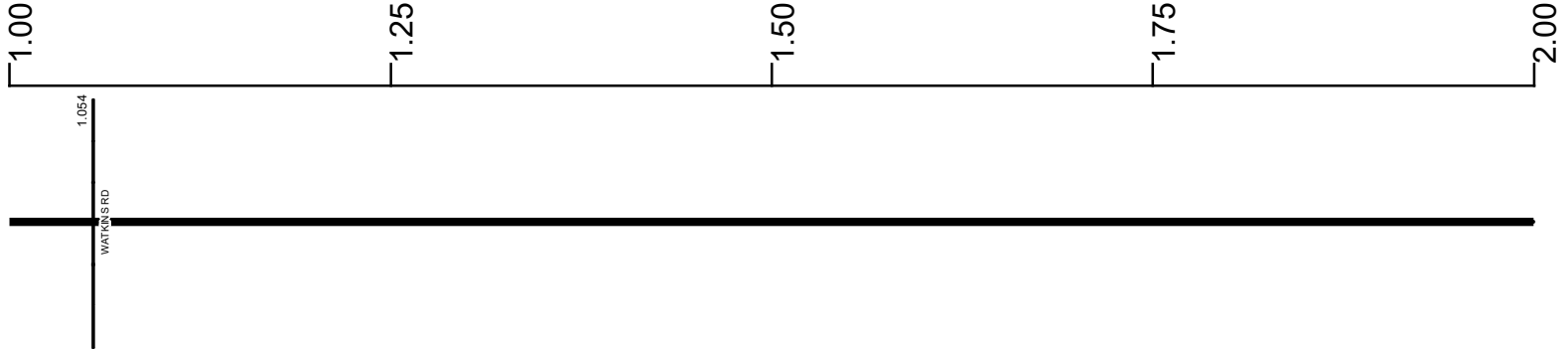

Surface Type & Width (Left / Right)

G (18/6')  
0.469 - 2.483

Base Type (Left / Right)

I / L  
0 - 4.605

Shoulder Type & Width (Left / Right)

2 (3/3')  
0.469 - 2.483

Through Lanes

2  
0 - 13.42

Street Name

SR 118  
0 - 3.912

- |                     |                   |                      |              |
|---------------------|-------------------|----------------------|--------------|
| Non-divided Highway | Bridge (on route) | Railroad (at grade)  | Intersection |
| Divided Highway     | Underpass         | Railroad (underpass) |              |
| Secondary Segment   | Overpass          | Railroad (overpass)  |              |
| Corporation         |                   |                      |              |

Created on: 7/2/2025

transportation.ohio.gov

Prepared by  
The Ohio Department of Transportation  
Office of Technical Services  
Roadway Information

# SMERSR00118\*\*C

State True Log

20.619

County True Log

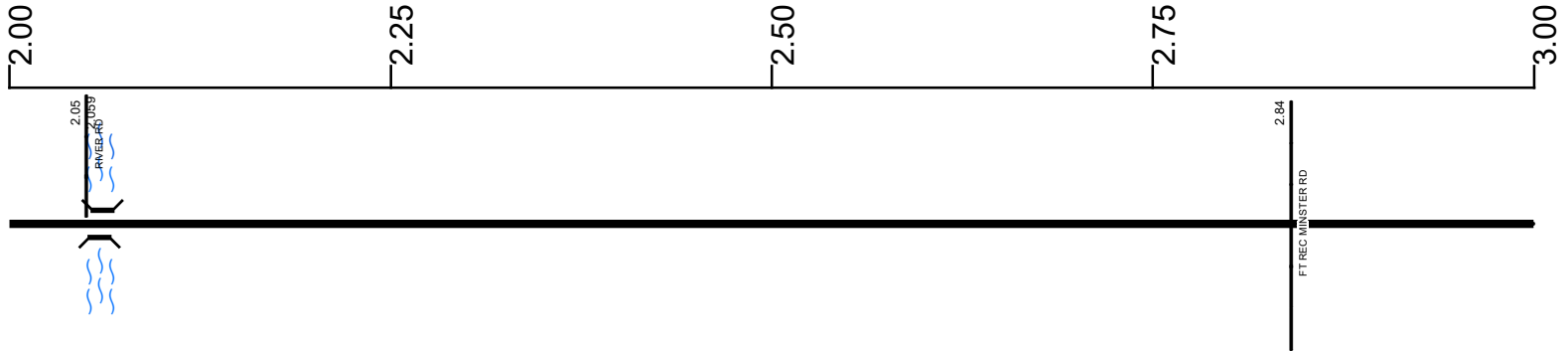

**Surface Type & Width (Left / Right)**

G (18'6") 0.469 - 2.483	G (20'4") 2.483 - 2.84	G (18'6") 2.84 - 4.063
----------------------------	---------------------------	---------------------------

**Base Type (Left / Right)**

I / L 0 - 4.605
--------------------

**Shoulder Type & Width (Left / Right)**

2 (3'3") 0.469 - 2.483	2 (6'6") 2.483 - 2.84	2 (3'3") 2.84 - 4.063
---------------------------	--------------------------	--------------------------

**Through Lanes**

2 0 - 13.42
----------------

**Street Name**

SR 118 0 - 3.912
---------------------

- Non-divided Highway
- Divided Highway
- Secondary Segment
- Corporation
- Bridge (on route)
- Underpass
- Overpass
- Railroad (at grade)
- Railroad (underpass)
- Railroad (overpass)
- Intersection

Created on: 7/2/2025

transportation.ohio.gov

Prepared by  
The Ohio Department of Transportation  
Office of Technical Services  
Roadway Information

# SMERSR00118\*\*C

State True Log

21.619

County True Log

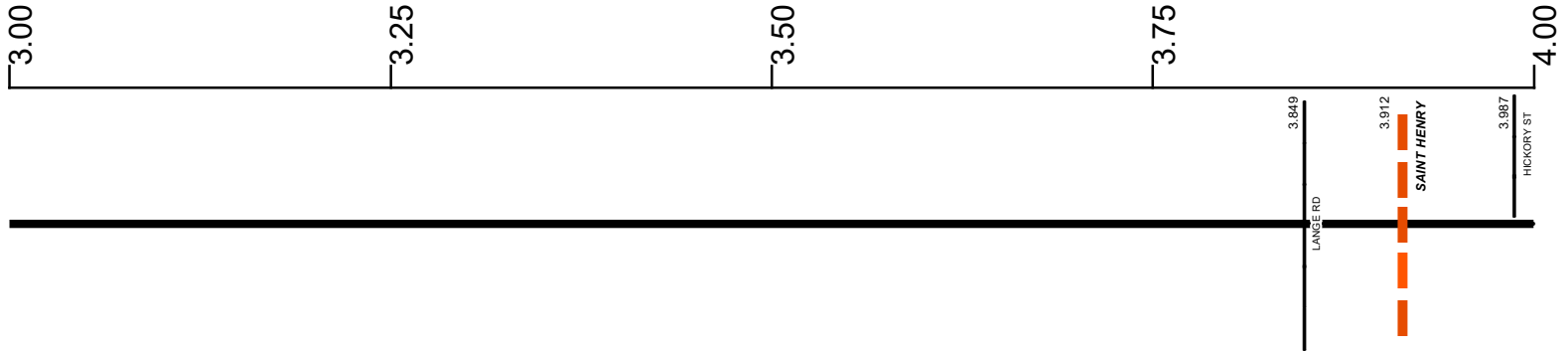

Surface Type & Width (Left / Right)

	G (18/6')
	2.84 - 4.063

Base Type (Left / Right)

	1 / L
	0 - 4.605

Shoulder Type & Width (Left / Right)

	2 (3/3')
	2.84 - 4.063

Through Lanes

	2
	0 - 13.42

Street Name

	SR 118		EASTERN AVE
	0 - 3.912		3.912 - 5.377

- |                     |                   |                      |              |
|---------------------|-------------------|----------------------|--------------|
| Non-divided Highway | Bridge (on route) | Railroad (at grade)  | Intersection |
| Divided Highway     | Underpass         | Railroad (underpass) |              |
| Secondary Segment   | Overpass          | Railroad (overpass)  |              |
| <b>Corporation</b>  |                   |                      |              |

Created on: 7/2/2025

transportation.ohio.gov

Prepared by  
The Ohio Department of Transportation  
Office of Technical Services  
Roadway Information

# SMERSR00118\*\*C

State True Log

22.619

County True Log

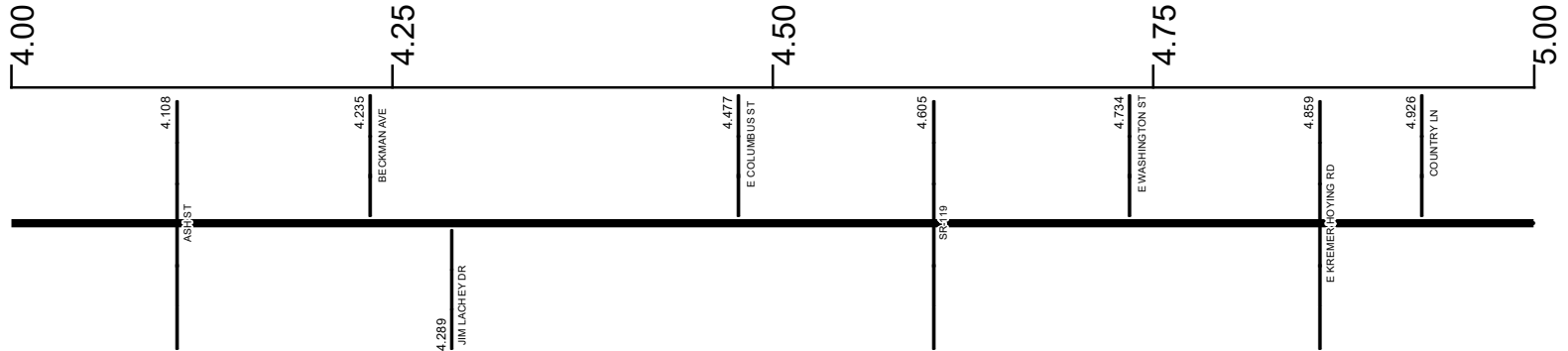

**Surface Type & Width (Left / Right)**

G (18'/6')	G (18'/12')	G (18'/22')	G (20'/24')
2.84 - 4.063	4.063 - 4.203	4.203 - 4.605	4.605 - 5.377

**Base Type (Left / Right)**

I / L 0 - 4.605	N / L 4.605 - 5.377
--------------------	------------------------

**Shoulder Type & Width (Left / Right)**

2 (3'/3')	2 (0'/3')	1 (0'/0')
2.84 - 4.063	4.063 - 4.203	4.203 - 5.377

**Through Lanes**

	2 0 - 13.42
--	----------------

**Street Name**

	EASTERN AVE 3.912 - 5.377
--	------------------------------

- Non-divided Highway
- Divided Highway
- Secondary Segment
- Corporation
- Bridge (on route)
- Underpass
- Overpass
- Railroad (at grade)
- Railroad (underpass)
- Railroad (overpass)
- Intersection

Created on: 7/2/2025

transportation.ohio.gov

Prepared by  
The Ohio Department of Transportation  
Office of Technical Services  
Roadway Information

# SMERSR00118\*\*C

State True Log

23.619

County True Log



**Surface Type & Width (Left / Right)**

G (20'/24') 4.605 - 5.377	G (20'/4') 5.377 - 8.388
------------------------------	-----------------------------

**Base Type (Left / Right)**

N / L 4.605 - 5.377	N / I 5.377 - 8.388
------------------------	------------------------

**Shoulder Type & Width (Left / Right)**

1 (0'/0') 4.203 - 5.377	2 (6'/6') 5.377 - 8.388
----------------------------	----------------------------

**Through Lanes**

	2 0 - 13.42
--	----------------

**Street Name**

EASTERN AVE 3.912 - 5.377	SR 118 5.377 - 8.348
------------------------------	-------------------------

- |  |   |   |   |
|--|---|---|---|
| <ul style="list-style-type: none"> <li> Non-divided Highway</li> <li> Divided Highway</li> <li> Secondary Segment</li> <li> Corporation</li> </ul> | <ul style="list-style-type: none"> <li> Bridge (on route)</li> <li> Underpass</li> <li> Overpass</li> </ul> | <ul style="list-style-type: none"> <li> Railroad (at grade)</li> <li> Railroad (underpass)</li> <li> Railroad (overpass)</li> </ul> | <ul style="list-style-type: none"> <li> Intersection</li> </ul> |
|--|---|---|---|

Created on: 7/2/2025

transportation.ohio.gov

Prepared by  
The Ohio Department of Transportation  
Office of Technical Services  
Roadway Information

# SMERSR00118\*\*C

State True Log

24.619

County True Log

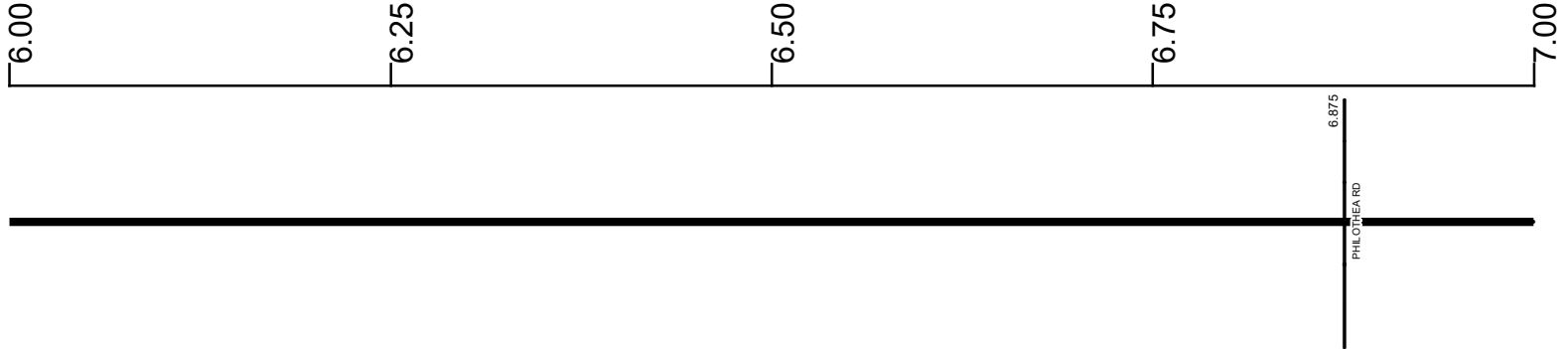

Surface Type & Width (Left / Right)

G (20'4')  
5.377 - 8.388

Base Type (Left / Right)

N / I  
5.377 - 8.388

Shoulder Type & Width (Left / Right)

2 (6'6')  
5.377 - 8.388

Through Lanes

2  
0 - 13.42

Street Name

SR 118  
5.377 - 8.348

- |                     |                   |                      |              |
|---------------------|-------------------|----------------------|--------------|
| Non-divided Highway | Bridge (on route) | Railroad (at grade)  | Intersection |
| Divided Highway     | Underpass         | Railroad (underpass) |              |
| Secondary Segment   | Overpass          | Railroad (overpass)  |              |
| Corporation         |                   |                      |              |

Created on: 7/2/2025

transportation.ohio.gov

Prepared by  
The Ohio Department of Transportation  
Office of Technical Services  
Roadway Information

# SMERSR00118\*\*C

State True Log

25.619

County True Log

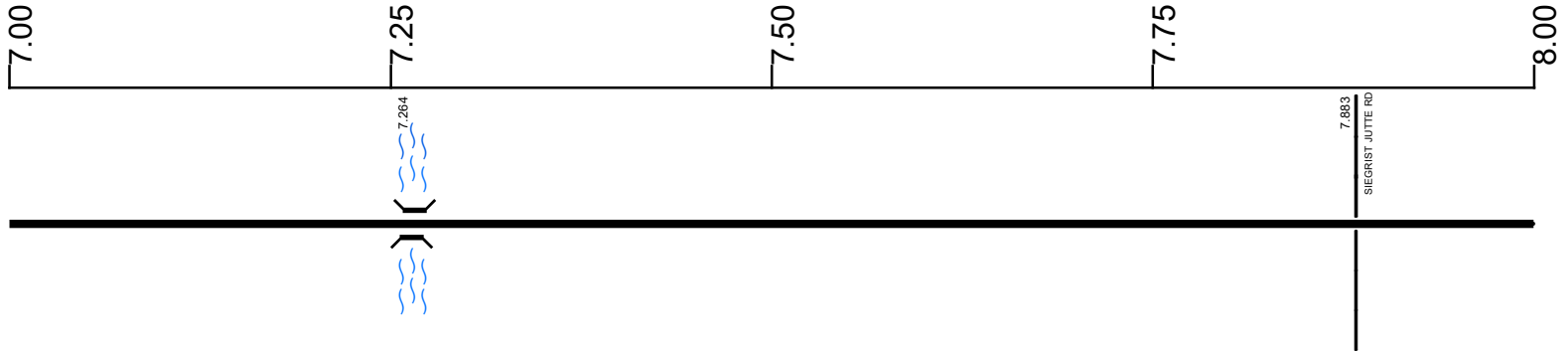

Surface Type & Width (Left / Right)

G (20'4')  
5.377 - 8.388

Base Type (Left / Right)

N / I  
5.377 - 8.388

Shoulder Type & Width (Left / Right)

2 (6'6')  
5.377 - 8.388

Through Lanes

2  
0 - 13.42

Street Name

SR 118  
5.377 - 8.348

- |                     |                   |                      |              |
|---------------------|-------------------|----------------------|--------------|
| Non-divided Highway | Bridge (on route) | Railroad (at grade)  | Intersection |
| Divided Highway     | Underpass         | Railroad (underpass) |              |
| Secondary Segment   | Overpass          | Railroad (overpass)  |              |
| Corporation         |                   |                      |              |

Created on: 7/2/2025



transportation.ohio.gov

Prepared by  
The Ohio Department of Transportation  
Office of Technical Services  
Roadway Information

# SMERSR00118\*\*C

State True Log

26.619

County True Log

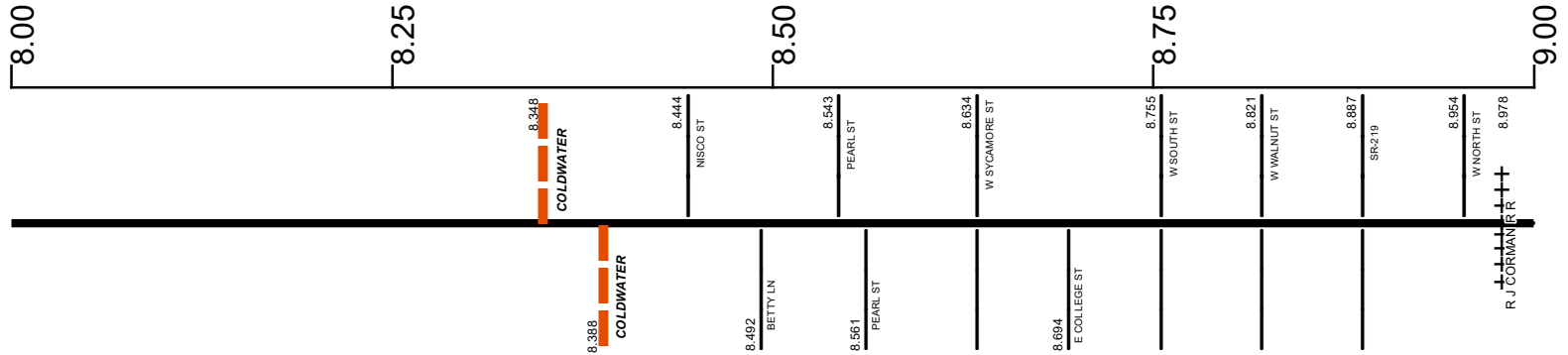

**Surface Type & Width (Left / Right)**

G (20'/4')	G 34'	G 46'
5.377 - 8.388	8.388 - 8.809	8.809 - 9.126

**Base Type (Left / Right)**

N / I	N
5.377 - 8.388	8.388 - 9.195

**Shoulder Type & Width (Left / Right)**

2 (6'/6')	1 (0'/0')
5.377 - 8.388	8.388 - 9.58

**Through Lanes**

2
0 - 13.42

**Street Name**

SR 118	2ND ST
5.377 - 8.348	8.348 - 9.889

<ul style="list-style-type: none"> <li> Non-divided Highway</li> <li> Divided Highway</li> <li> Secondary Segment</li> <li> Corporation</li> </ul>	<ul style="list-style-type: none"> <li> Bridge (on route)</li> <li> Underpass</li> <li> Overpass</li> </ul>	<ul style="list-style-type: none"> <li> Railroad (at grade)</li> <li> Railroad (underpass)</li> <li> Railroad (overpass)</li> </ul>	<ul style="list-style-type: none"> <li> Intersection</li> </ul>
--	---	---	---

Created on: 7/2/2025

transportation.ohio.gov

Prepared by  
The Ohio Department of Transportation  
Office of Technical Services  
Roadway Information

# SMERSR00118\*\*C

State True  
Log

27.619

County True  
Log

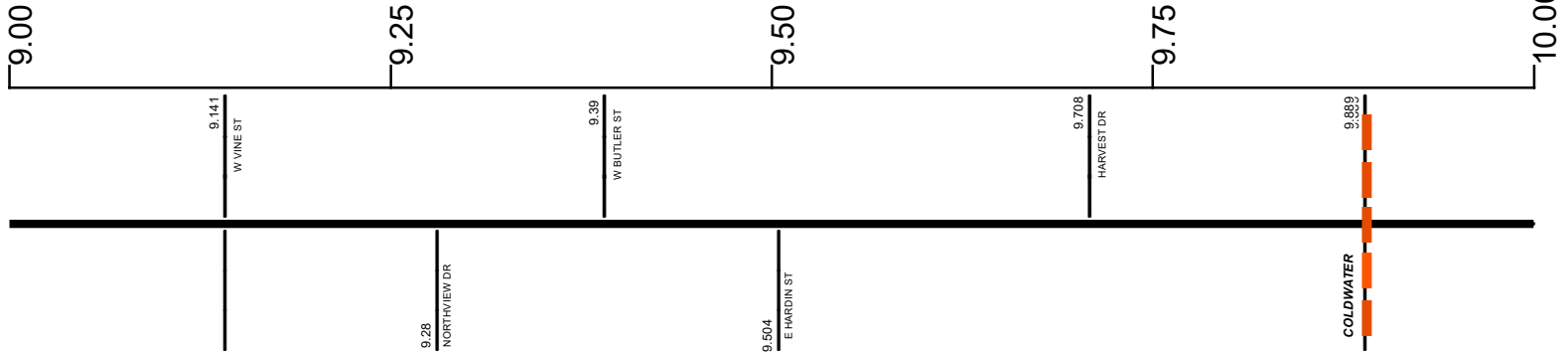

**Surface Type & Width (Left / Right)**

G 46'	G (19'/20')	G 24'
8.809 - 9.126	9.126 - 9.195	9.195 - 13.42

**Base Type (Left / Right)**

N	I
8.388 - 9.195	9.195 - 13.42

**Shoulder Type & Width (Left / Right)**

1 (0'/0')	2 (6'/6')
8.388 - 9.58	9.58 - 13.42

**Through Lanes**

	2
	0 - 13.42

**Street Name**

2ND ST	SR 118
8.348 - 9.889	9.889 - 13.42

- |  |   |   |   |
|--|---|---|---|
| <ul style="list-style-type: none"> <li> Non-divided Highway</li> <li> Divided Highway</li> <li> Secondary Segment</li> <li> Corporation</li> </ul> | <ul style="list-style-type: none"> <li> Bridge (on route)</li> <li> Underpass</li> <li> Overpass</li> </ul> | <ul style="list-style-type: none"> <li> Railroad (at grade)</li> <li> Railroad (underpass)</li> <li> Railroad (overpass)</li> </ul> | <ul style="list-style-type: none"> <li> Intersection</li> </ul> |
|--|---|---|---|

Created on: 7/2/2025

transportation.ohio.gov

Prepared by  
The Ohio Department of Transportation  
Office of Technical Services  
Roadway Information

# SMERSR00118\*\*C

State True Log

28.619

County True Log

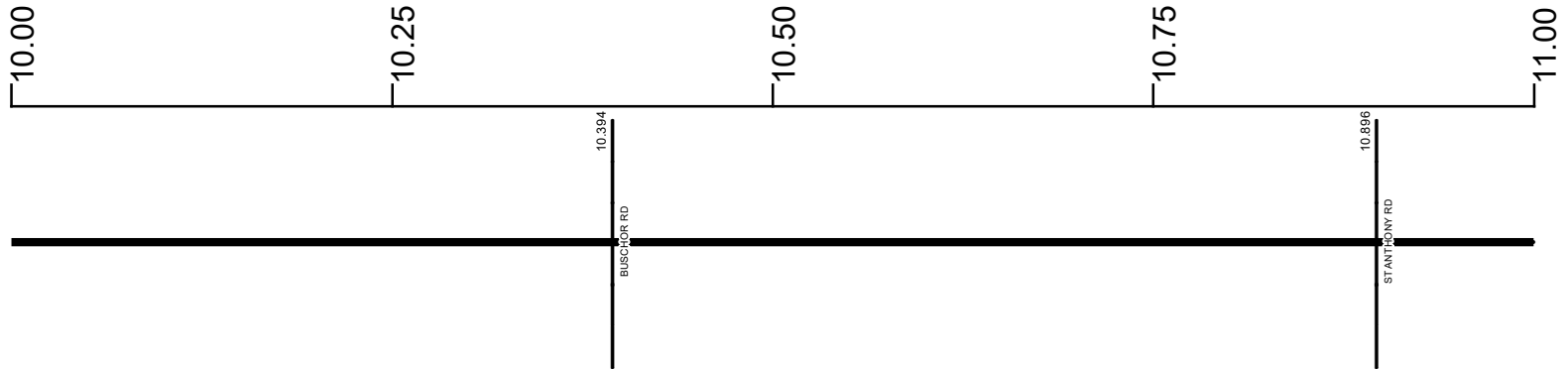

Surface Type & Width (Left / Right)

G 24'  
9.195 - 13.42

Base Type (Left / Right)

I  
9.195 - 13.42

Shoulder Type & Width (Left / Right)

2 (6/6)  
9.58 - 13.42

Through Lanes

2  
0 - 13.42

Street Name

SR 118  
9.889 - 13.42

- |                     |                   |                      |              |
|---------------------|-------------------|----------------------|--------------|
| Non-divided Highway | Bridge (on route) | Railroad (at grade)  | Intersection |
| Divided Highway     | Underpass         | Railroad (underpass) |              |
| Secondary Segment   | Overpass          | Railroad (overpass)  |              |
| Corporation         |                   |                      |              |

Created on: 7/2/2025

transportation.ohio.gov

Prepared by  
The Ohio Department of Transportation  
Office of Technical Services  
Roadway Information

# SMERSR00118\*\*C

State True Log

29.619

County True Log

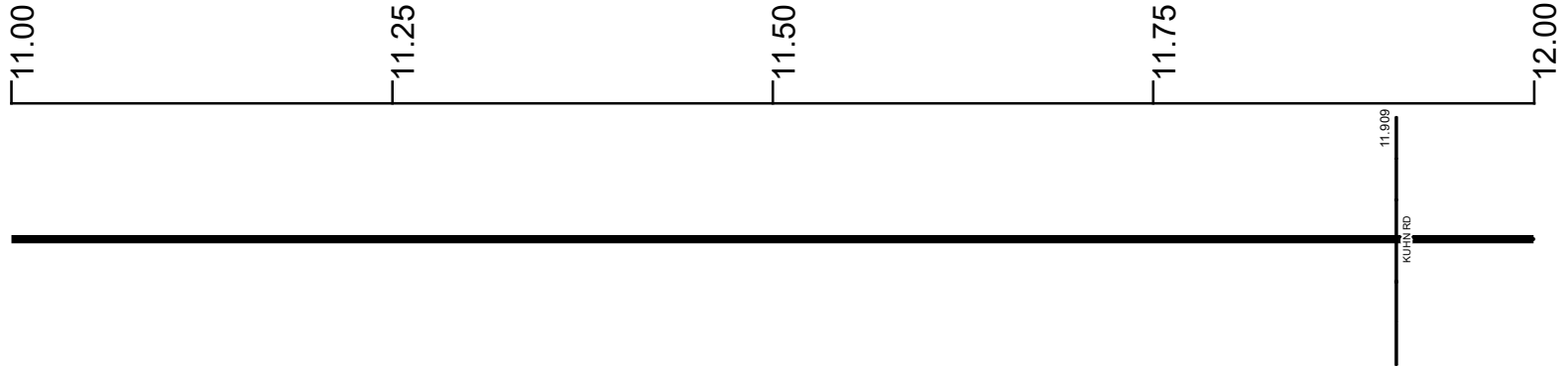

Surface Type & Width (Left / Right)

G 24'  
9.195 - 13.42

Base Type (Left / Right)

I  
9.195 - 13.42

Shoulder Type & Width (Left / Right)

2 (6/6)  
9.58 - 13.42

Through Lanes

2  
0 - 13.42

Street Name

SR 118  
9.889 - 13.42

- |                     |                   |                      |              |
|---------------------|-------------------|----------------------|--------------|
| Non-divided Highway | Bridge (on route) | Railroad (at grade)  | Intersection |
| Divided Highway     | Underpass         | Railroad (underpass) |              |
| Secondary Segment   | Overpass          | Railroad (overpass)  |              |
| Corporation         |                   |                      |              |

Created on: 7/2/2025



transportation.ohio.gov  
 Prepared by  
 The Ohio Department of Transportation  
 Office of Technical Services  
 Roadway Information

# SMERSR00118\*\*C

State True Log

30.619

County True Log

12.00

12.25

12.50

12.75

13.00



Surface Type & Width (Left / Right)

G 24'  
9.195 - 13.42

Base Type (Left / Right)

I  
9.195 - 13.42

Shoulder Type & Width (Left / Right)

2 (6/6)  
9.58 - 13.42

Through Lanes

2  
0 - 13.42

Street Name

SR 118  
9.889 - 13.42

- |                     |                   |                      |              |
|---------------------|-------------------|----------------------|--------------|
| Non-divided Highway | Bridge (on route) | Railroad (at grade)  | Intersection |
| Divided Highway     | Underpass         | Railroad (underpass) |              |
| Secondary Segment   | Overpass          | Railroad (overpass)  |              |
| <b>Corporation</b>  |                   |                      |              |

Created on: 7/2/2025

transportation.ohio.gov

Prepared by  
The Ohio Department of Transportation  
Office of Technical Services  
Roadway Information

# SMERSR00118\*\*C

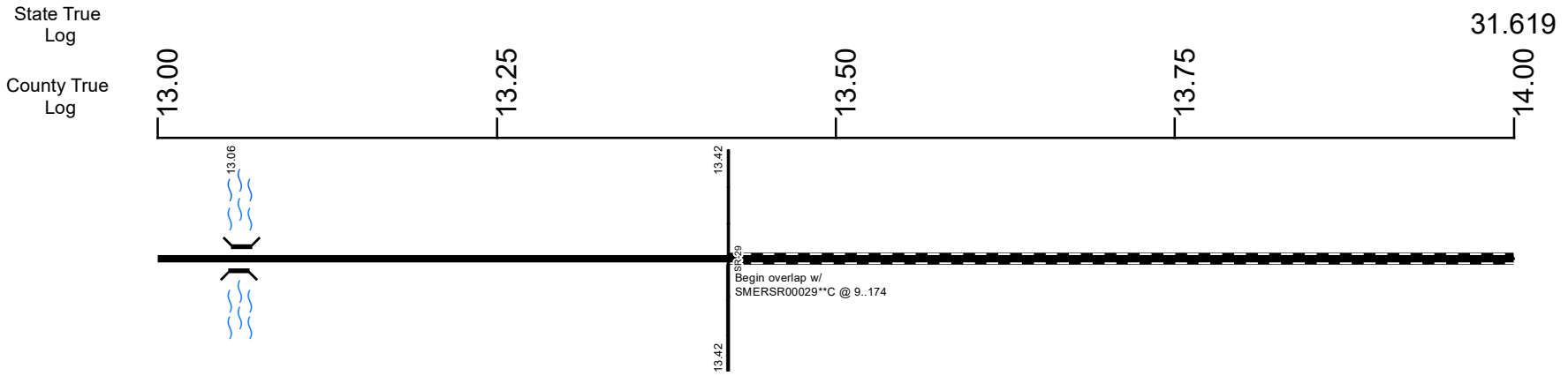

Surface Type & Width (Left / Right)	G 24'
	9.195 - 13.42
Base Type (Left / Right)	I
	9.195 - 13.42
Shoulder Type & Width (Left / Right)	2 (6'/6')
	9.58 - 13.42
Through Lanes	2
	0 - 13.42
Street Name	SR 118
	9.889 - 13.42

- |                     |                   |                      |              |
|---------------------|-------------------|----------------------|--------------|
| Non-divided Highway | Bridge (on route) | Railroad (at grade)  | Intersection |
| Divided Highway     | Underpass         | Railroad (underpass) |              |
| Secondary Segment   | Overpass          | Railroad (overpass)  |              |
| Corporation         |                   |                      |              |

Created on: 7/2/2025



transportation.ohio.gov  
 Prepared by  
 The Ohio Department of Transportation  
 Office of Technical Services  
 Roadway Information

# SMERSR00118\*\*C

State True Log  
County True Log

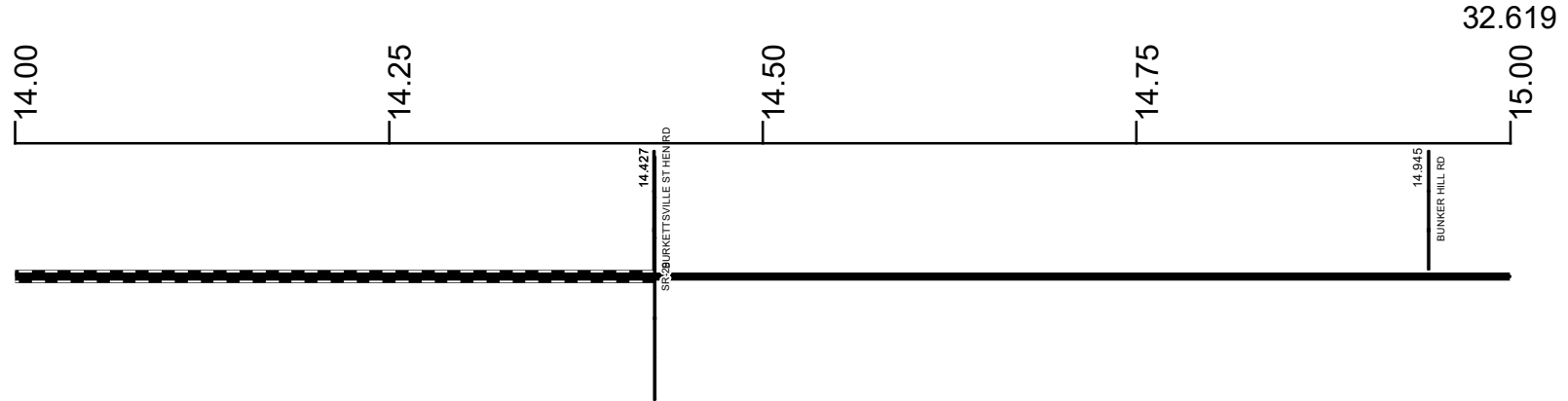

**Surface Type & Width (Left / Right)**

G 24'  
14.427 - 20.858

**Base Type (Left / Right)**

I  
14.427 - 20.858

**Shoulder Type & Width (Left / Right)**

5 (2'/2')  
14.427 - 18.979

**Through Lanes**

2  
14.427 - 24.19

**Street Name**

SR 118  
14.427 - 24.002

- |                     |                   |                      |              |
|---------------------|-------------------|----------------------|--------------|
| Non-divided Highway | Bridge (on route) | Railroad (at grade)  | Intersection |
| Divided Highway     | Underpass         | Railroad (underpass) |              |
| Secondary Segment   | Overpass          | Railroad (overpass)  |              |
| Corporation         |                   |                      |              |

Created on: 7/2/2025



transportation.ohio.gov  
Prepared by  
The Ohio Department of Transportation  
Office of Technical Services  
Roadway Information

# SMERSR00118\*\*C

State True Log

33.619

County True Log

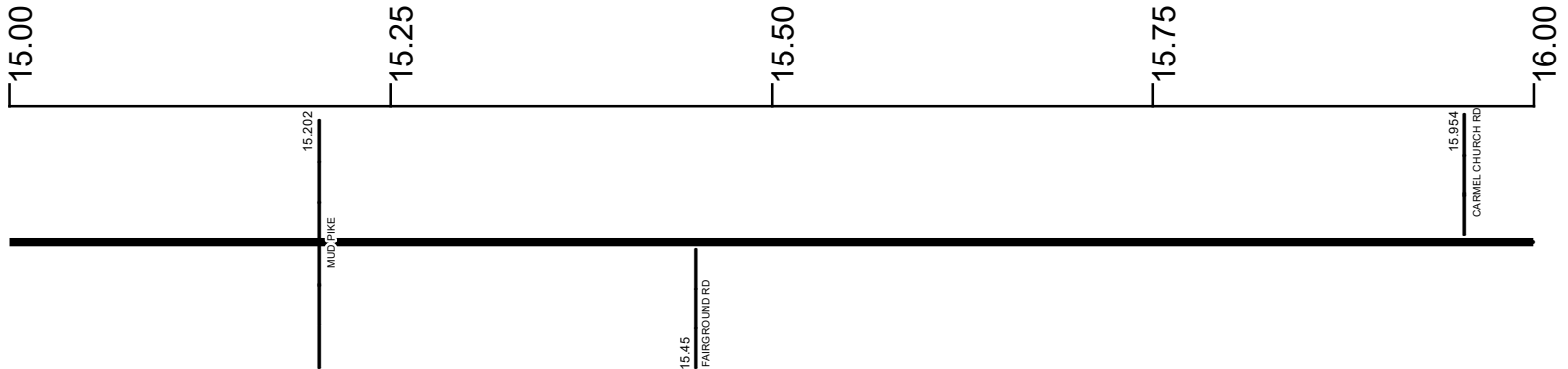

Surface Type & Width (Left / Right)

G 24'  
14.427 - 20.858

Base Type (Left / Right)

I  
14.427 - 20.858

Shoulder Type & Width (Left / Right)

5 (2/2)  
14.427 - 18.979

Through Lanes

2  
14.427 - 24.19

Street Name

SR 118  
14.427 - 24.002

- |                     |                   |                      |              |
|---------------------|-------------------|----------------------|--------------|
| Non-divided Highway | Bridge (on route) | Railroad (at grade)  | Intersection |
| Divided Highway     | Underpass         | Railroad (underpass) |              |
| Secondary Segment   | Overpass          | Railroad (overpass)  |              |
| Corporation         |                   |                      |              |

Created on: 7/2/2025

transportation.ohio.gov

Prepared by  
The Ohio Department of Transportation  
Office of Technical Services  
Roadway Information

# SMERSR00118\*\*C

State True Log

34.619

County True Log

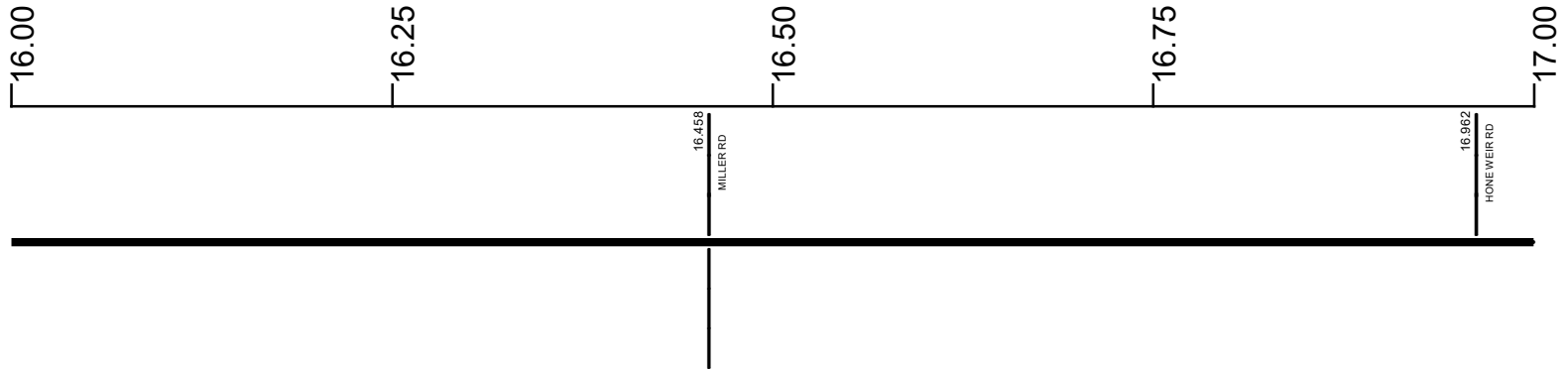

Surface Type & Width (Left / Right)

G 24'  
14.427 - 20.858

Base Type (Left / Right)

I  
14.427 - 20.858

Shoulder Type & Width (Left / Right)

5 (2/2)  
14.427 - 18.979

Through Lanes

2  
14.427 - 24.19

Street Name

SR 118  
14.427 - 24.002

- |                     |                   |                      |              |
|---------------------|-------------------|----------------------|--------------|
| Non-divided Highway | Bridge (on route) | Railroad (at grade)  | Intersection |
| Divided Highway     | Underpass         | Railroad (underpass) |              |
| Secondary Segment   | Overpass          | Railroad (overpass)  |              |
| Corporation         |                   |                      |              |

Created on: 7/2/2025



Prepared by  
The Ohio Department of Transportation  
Office of Technical Services  
Roadway Information

# SMERSR00118\*\*C

State True Log  
County True Log

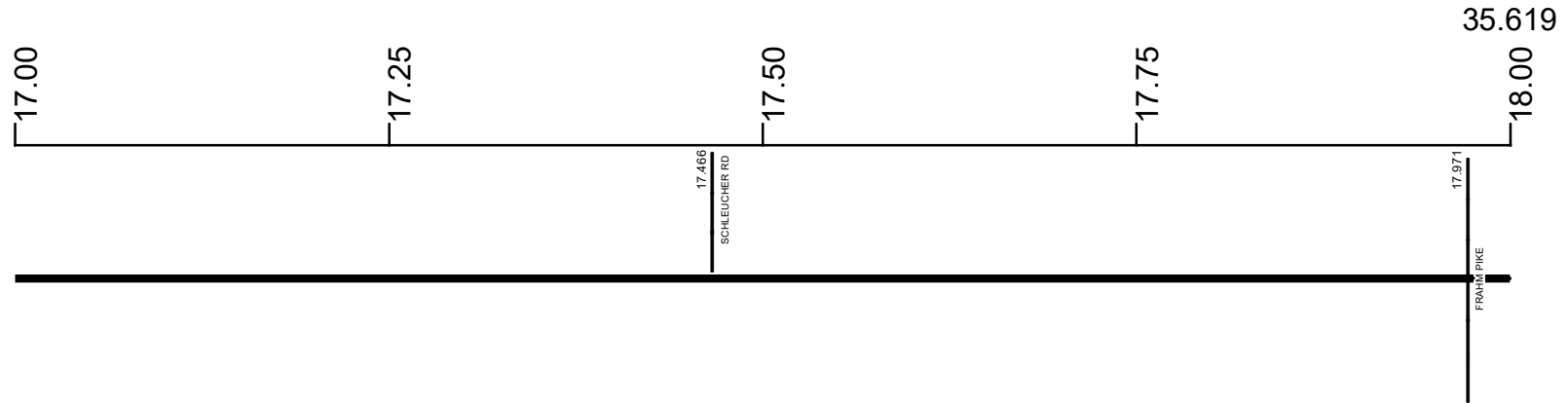

Surface Type & Width (Left / Right)	G 24'
	14.427 - 20.858
Base Type (Left / Right)	I
	14.427 - 20.858
Shoulder Type & Width (Left / Right)	5 (2/2')
	14.427 - 18.979
Through Lanes	2
	14.427 - 24.19
Street Name	SR 118
	14.427 - 24.002

Non-divided Highway	Bridge (on route)	Railroad (at grade)	Intersection
Divided Highway	Underpass	Railroad (underpass)	
Secondary Segment	Overpass	Railroad (overpass)	
Corporation			

Created on: 7/2/2025

transportation.ohio.gov

Prepared by  
The Ohio Department of Transportation  
Office of Technical Services  
Roadway Information



# SMERSR00118\*\*C

State True Log

37.619

County True Log

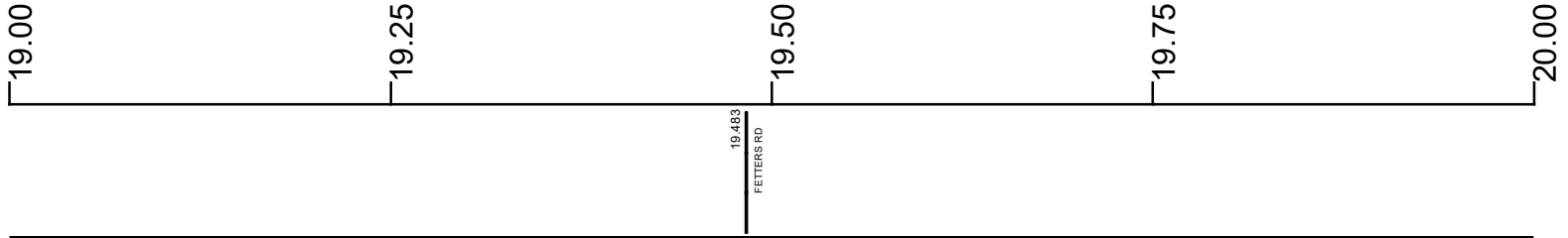

Surface Type & Width (Left / Right)

G 24'  
14.427 - 20.858

Base Type (Left / Right)

I  
14.427 - 20.858

Shoulder Type & Width (Left / Right)

2 (2'/2')  
18.979 - 20.858

Through Lanes

2  
14.427 - 24.19

Street Name

SR 118  
14.427 - 24.002

- |                     |                   |                      |              |
|---------------------|-------------------|----------------------|--------------|
| Non-divided Highway | Bridge (on route) | Railroad (at grade)  | Intersection |
| Divided Highway     | Underpass         | Railroad (underpass) |              |
| Secondary Segment   | Overpass          | Railroad (overpass)  |              |
| Corporation         |                   |                      |              |

Created on: 7/2/2025



transportation.ohio.gov  
Prepared by  
The Ohio Department of Transportation  
Office of Technical Services  
Roadway Information

# SMERSR00118\*\*C

State True Log

38.619

County True Log

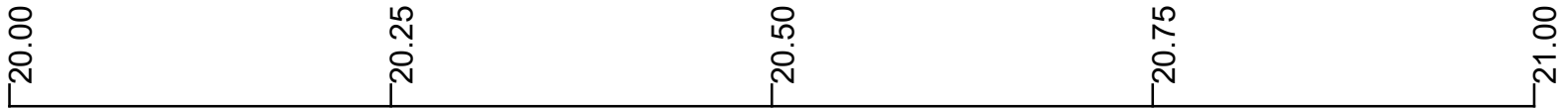

Surface Type & Width (Left / Right)

G 24'	G (14'/10')
14.427 - 20.858	20.858 - 21.843

Base Type (Left / Right)

I	N / L
14.427 - 20.858	20.858 - 21.843

Shoulder Type & Width (Left / Right)

2 (2'/2')	5 (2'/2')
18.979 - 20.858	20.858 - 23.867

Through Lanes

2	
14.427 - 24.19	

Street Name

SR 118	
14.427 - 24.002	

- Non-divided Highway
  Bridge (on route)
  Railroad (at grade)
  Intersection
- Divided Highway
  Underpass
  Railroad (underpass)
- Secondary Segment
  Overpass
  Railroad (overpass)
- Corporation**

Created on: 7/2/2025

transportation.ohio.gov

Prepared by

The Ohio Department of Transportation

Office of Technical Services

Roadway Information

# SMERSR00118\*\*C

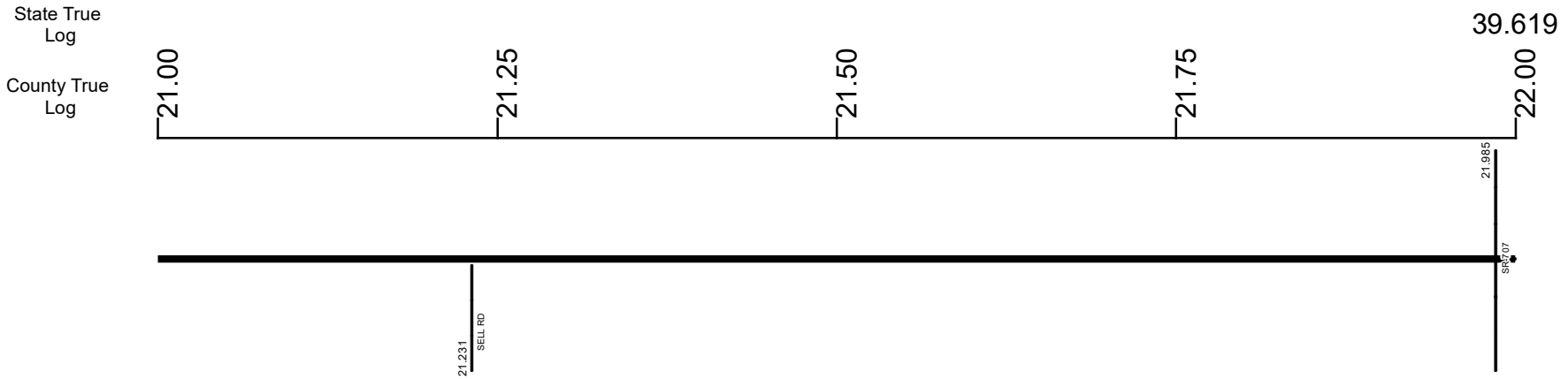

**Surface Type & Width (Left / Right)**

G (14'/10') 20.858 - 21.843	G 26' G (14'/10') 21.843 - 21.951 21.951 - 23.433
--------------------------------	--

**Base Type (Left / Right)**

N / L 20.858 - 21.843	L N / L 21.843 - 21.951 21.951 - 23.433
--------------------------	--

**Shoulder Type & Width (Left / Right)**

5 (2'/2') 20.858 - 23.867	
------------------------------	--

**Resurface Year**

2023 21.828 - 21.977
-------------------------

**Through Lanes**

2 14.427 - 24.19	
---------------------	--

**Street Name**

SR 118 14.427 - 24.002	
---------------------------	--

- Non-divided Highway
- Divided Highway
- Secondary Segment
- Corporation
- Bridge (on route)
- Underpass
- Overpass
- Railroad (at grade)
- Railroad (underpass)
- Railroad (overpass)
- Intersection

Created on: 7/2/2025

transportation.ohio.gov

Prepared by  
The Ohio Department of Transportation  
Office of Technical Services  
Roadway Information

# SMERSR00118\*\*C

State True Log

40.619

County True Log

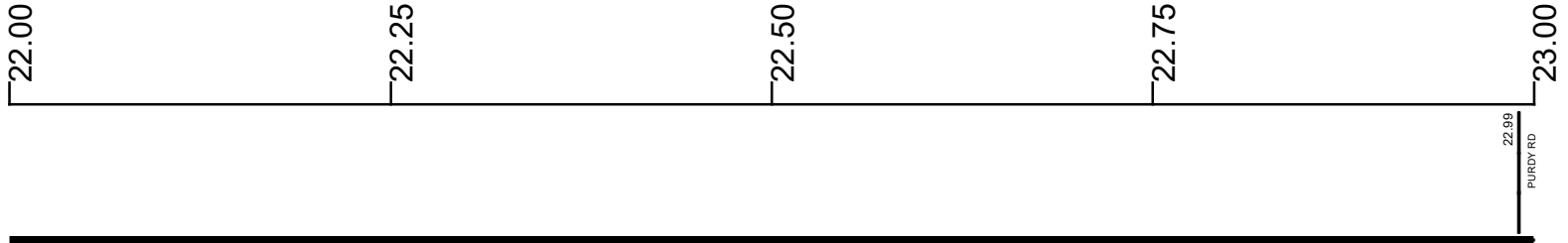

Surface Type & Width (Left / Right)

G (14'/10')  
21.951 - 23.433

Base Type (Left / Right)

N / L  
21.951 - 23.433

Shoulder Type & Width (Left / Right)

5 (2'/2')  
20.858 - 23.867

Through Lanes

2  
14.427 - 24.19

Street Name

SR 118  
14.427 - 24.002

- |                     |                   |                      |              |
|---------------------|-------------------|----------------------|--------------|
| Non-divided Highway | Bridge (on route) | Railroad (at grade)  | Intersection |
| Divided Highway     | Underpass         | Railroad (underpass) |              |
| Secondary Segment   | Overpass          | Railroad (overpass)  |              |
| Corporation         |                   |                      |              |

Created on: 7/2/2025



transportation.ohio.gov

Prepared by

The Ohio Department of Transportation  
Office of Technical Services  
Roadway Information

# SMERSR00118\*\*C

State True Log

41.619

County True Log

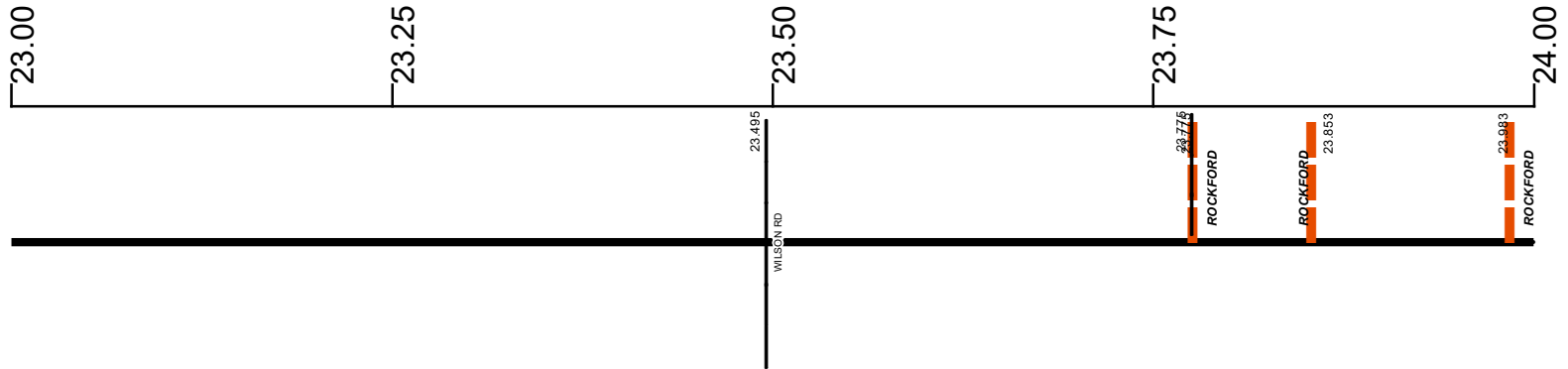

**Surface Type & Width (Left / Right)**

G (14'/10')	G (20'/4')	G (14'/10')
21.951 - 23.433	23.433 - 23.867	23.867 - 24.131

**Base Type (Left / Right)**

N / L	K / L	N / K
21.951 - 23.433	23.433 - 23.867	23.867 - 24.131

**Shoulder Type & Width (Left / Right)**

5 (2'/2')	5 (3'/3')
20.858 - 23.867	23.867 - 24.131

**Through Lanes**

2
14.427 - 24.19

**Street Name**

SR 118
14.427 - 24.002

- Non-divided Highway
- Divided Highway
- Secondary Segment
- Corporation
- Bridge (on route)
- Underpass
- Overpass
- Railroad (at grade)
- Railroad (underpass)
- Railroad (overpass)
- Intersection

Created on: 7/2/2025

transportation.ohio.gov

Prepared by  
The Ohio Department of Transportation  
Office of Technical Services  
Roadway Information

# SMERSR00118\*\*C

State True Log  
County True Log

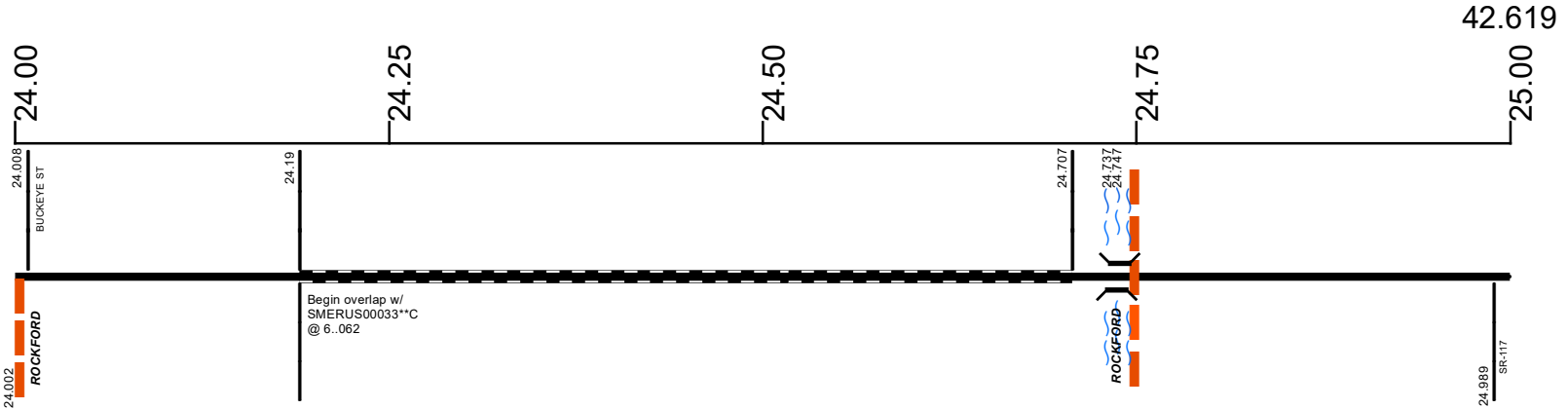

**Surface Type & Width (Left / Right)**

G (14'/10')	G 26'
23.867 - 24.131	24.131 - 24.19

**Base Type (Left / Right)**

N / K	T
23.867 - 24.131	24.131 - 24.19

**Shoulder Type & Width (Left / Right)**

5 (3'/3')	1 (0'/0')
23.867 - 24.131	24.131 - 24.19

**Through Lanes**

2
14.427 - 24.19

SR 118	MAIN ST
14.427 - 24.002	24.002 - 24.19

**Surface Type & Width (Left / Right)**

G (20'/4')
24.707 - 27.094

**Base Type (Left / Right)**

N / K
24.707 - 27.094

**Shoulder Type & Width (Left / Right)**

5 (2'/2')
24.707 - 27.094

**Through Lanes**

2
24.707 - 27.094

**Street Name**

MAIN ST	SR 118
24.707 - 24.747	24.747 - 27.094

- Non-divided Highway
- Divided Highway
- Secondary Segment
- Corporation
- Bridge (on route)
- Underpass
- Overpass
- Railroad (at grade)
- Railroad (underpass)
- Railroad (overpass)
- Intersection

Created on: 7/2/2025



transportation.ohio.gov  
Prepared by  
The Ohio Department of Transportation  
Office of Technical Services  
Roadway Information

# SMERSR00118\*\*C

State True Log

43.619

County True Log

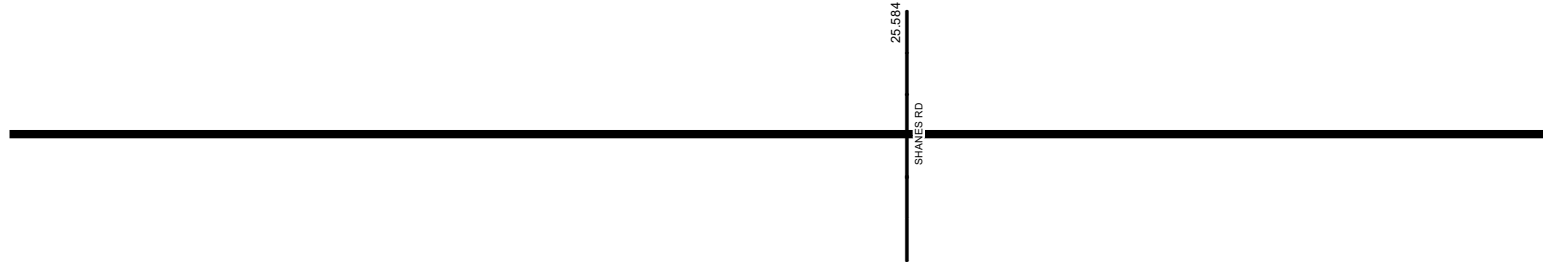

Surface Type & Width (Left / Right)	G (20'4') 24.707 - 27.094
Base Type (Left / Right)	N / K 24.707 - 27.094
Shoulder Type & Width (Left / Right)	5 (2'2') 24.707 - 27.094
Through Lanes	2 24.707 - 27.094
Street Name	SR 118 24.747 - 27.094

Non-divided Highway	Bridge (on route)	Railroad (at grade)	Intersection
Divided Highway	Underpass	Railroad (underpass)	
Secondary Segment	Overpass	Railroad (overpass)	
Corporation			

Created on: 7/2/2025

transportation.ohio.gov

Prepared by  
The Ohio Department of Transportation  
Office of Technical Services  
Roadway Information

# SMERSR00118\*\*C

State True Log

44.619

County True Log

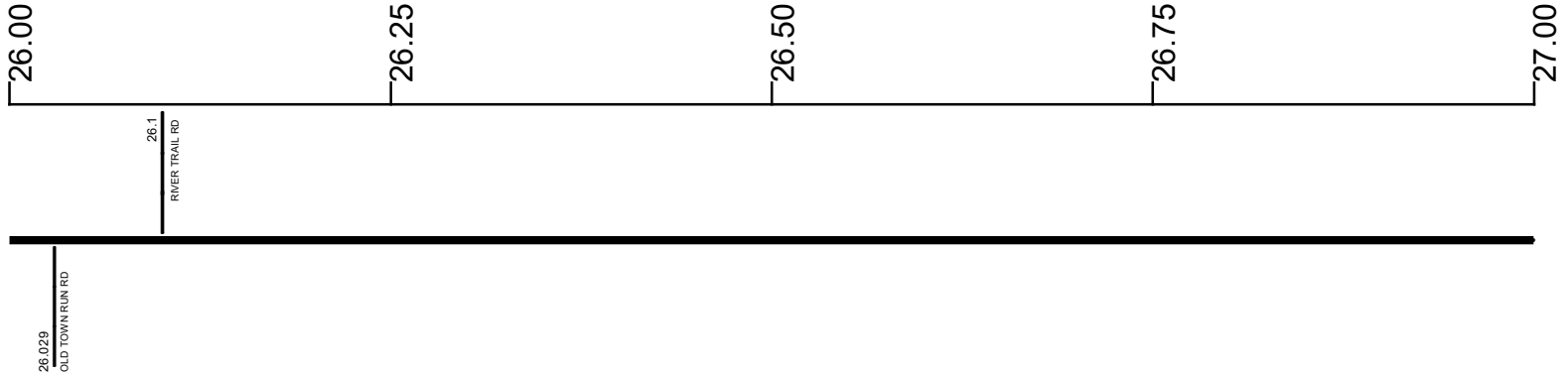

Surface Type & Width (Left / Right)	G (20'/4')
	24.707 - 27.094
Base Type (Left / Right)	N / K
	24.707 - 27.094
Shoulder Type & Width (Left / Right)	5 (2'/2')
	24.707 - 27.094
Through Lanes	2
	24.707 - 27.094
Street Name	SR 118
	24.747 - 27.094

- |                     |                   |                      |              |
|---------------------|-------------------|----------------------|--------------|
| Non-divided Highway | Bridge (on route) | Railroad (at grade)  | Intersection |
| Divided Highway     | Underpass         | Railroad (underpass) |              |
| Secondary Segment   | Overpass          | Railroad (overpass)  |              |
| Corporation         |                   |                      |              |

Created on: 7/2/2025

transportation.ohio.gov

Prepared by  
The Ohio Department of Transportation  
Office of Technical Services  
Roadway Information

# SMERSR00118\*\*C

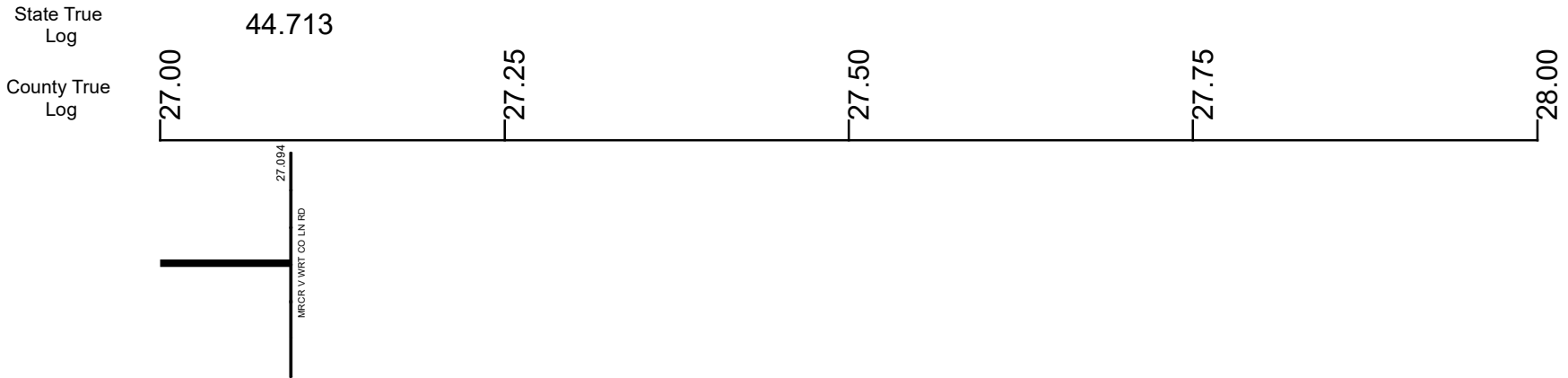

**Surface Type & Width (Left / Right)**

G (20'4')  
24.707 - 27.094

**Base Type (Left / Right)**

N / K  
24.707 - 27.094

**Shoulder Type & Width (Left / Right)**

5 (2'2')  
24.707 - 27.094

**Through Lanes**

2  
24.707 - 27.094

**Street Name**

SR 118  
24.747 - 27.094

- |                     |                   |                      |              |
|---------------------|-------------------|----------------------|--------------|
| Non-divided Highway | Bridge (on route) | Railroad (at grade)  | Intersection |
| Divided Highway     | Underpass         | Railroad (underpass) |              |
| Secondary Segment   | Overpass          | Railroad (overpass)  |              |
| Corporation         |                   |                      |              |

Created on: 7/2/2025



transportation.ohio.gov

Prepared by  
The Ohio Department of Transportation  
Office of Technical Services  
Roadway Information

## Historical Project List for SMERSR00118\*\*C

Begin Measure	End Measure	Project ID Number	Construction Completion Date	Treatment Category	Treatment Type
0.000	3.910	101052	10-2017	Preventive Maintenance	25-Chip Seal
0.000	4.610	19851	6-2003	Minor Rehabilitation	60-AC Overlay w/Rpr
3.910	8.340	100360	12-2016	Minor Rehabilitation	50-AC Overlay w/o Rpr
4.610	13.420	23369	7-2004	Minor Rehabilitation	50-AC Overlay w/o Rpr
8.340	9.890	101088	4-2018	Minor Rehabilitation	50-AC Overlay w/o Rpr
9.890	13.420	100357	11-2016	Minor Rehabilitation	38-Fine Poly AC Overlay
14.427	17.974	100940	11-2019	Minor Rehabilitation	60-AC Overlay w/Rpr
14.427	21.992	77224	9-2004	Preventive Maintenance	41-Thin AC Overlay w/o Rpr
17.984	21.992	100357	11-2016	Minor Rehabilitation	38-Fine Poly AC Overlay
21.992	23.740	88687	1-2017	Minor Rehabilitation	50-AC Overlay w/o Rpr
24.757	27.094	88687	1-2017	Minor Rehabilitation	60-AC Overlay w/Rpr

# Roadway Codes

## Access Control Journalized

- F - Full Access Control
- L - Limited Access Control
- N - No Access Control

## Access Control Operational

- 1 - Full Access Control
- 2 - Partial Access Control
- 3 - No Access Control

## Base Type

- F - Crack and Seat
- H - Rubblize and Roll
- I - Aggregate Base 304 or Traffic Compacted
- K - Water Bound Macadam
- L - Bituminous Concrete Mix or Penetration Macadam
- N - Plain Concrete
- P - Reinforced Concrete
- R - Brick (Flexible)
- T - Brick (Rigid)

## Direction of Travel

- B - Both (Two-way)
- F - One-way Cardinal
- T - One-way Non-cardinal

## Facility Type

- 1 - One-way Roadway
- 2 - Two-way Roadway
- 4 - Ramp
- 5 - Non-mainline
- 6 - Non-inventory Direction
- 7 - Planned / Unbuilt

## Historical Federal Aid Indicator

- N - Not a FAP Route
- Y - FAP Route

## Functional Classification

- 01 - Interstate
- 02 - Principal Arterial (Freeways)
- 03 - Principal Arterial (Other)
- 04 - Minor Arterial
- 05 - Major Collector
- 06 - Minor Collector
- 07 - Local

## Leave / Reenter Indicator

- Y - Route leaves/reenters at this point
- N - Route does not leave/reenter at this point

## Median Type

- 1 - None
- 2 - Unprotected
- 3 - Curbed
- 4 - Positive Barrier (Unspecified)
- 5 - Positive Barrier (Flexible)
- 6 - Positive Barrier (Semi-rigid)
- 7 - Positive Barrier (Rigid)

## NHS

- N - National Highway System
- H - Congressional Corridor
- 2 - Major Airport
- 3 - Major Port Facility
- 4 - Major Amtrak Station
- 5 - Major Rail / Truck Terminal
- 6 - Major Intercity Bus Terminal
- 7 - Major Public Transit / Multi-modal Passenger Terminal
- 8 - Major Pipeline Terminal
- 9 - Major Ferry Terminal

## Priority System

- G - General
- P - Priority System
- U - Urban

## Scenic Byway Code

- A - All American Road
- N - National Scenic Byway
- S - State Scenic Byway

## Shoulder Type

- 1 - None
- 2 - Surfaced shoulder exists (bituminous concrete {AC})
- 3 - Surfaced shoulder exists (Portland Cement Concrete {PCC})
- 4 - Stabilized shoulder exists (gravel or other granular material)
- 5 - Combination shoulder exists (two or more surface types)
- 6 - Earth shoulder exists
- 7 - Barrier curb exists; no shoulder in front of curb

## Surface Type

- A - Combination
- B - Brick
- C - Continuous Reinforced Concrete
- D - Reinforced Concrete
- E - Plain Concrete
- G - Bituminous Concrete
- I - Chipseal on Granular
- K - Open Graded Bituminous
- L - Chipseal or Micro
- M - Gravel
- U - Unimproved
- X - Right of Way Only